

Tools Needed:
6mm Hex Key, 8mm Hex Key

kuat[®]

- ① Open the tire arm. Using the 8mm Hex Key, remove the Pivot Arm Bolt connecting the tire arms to the tray. Remove the Arm to Tray Cap.

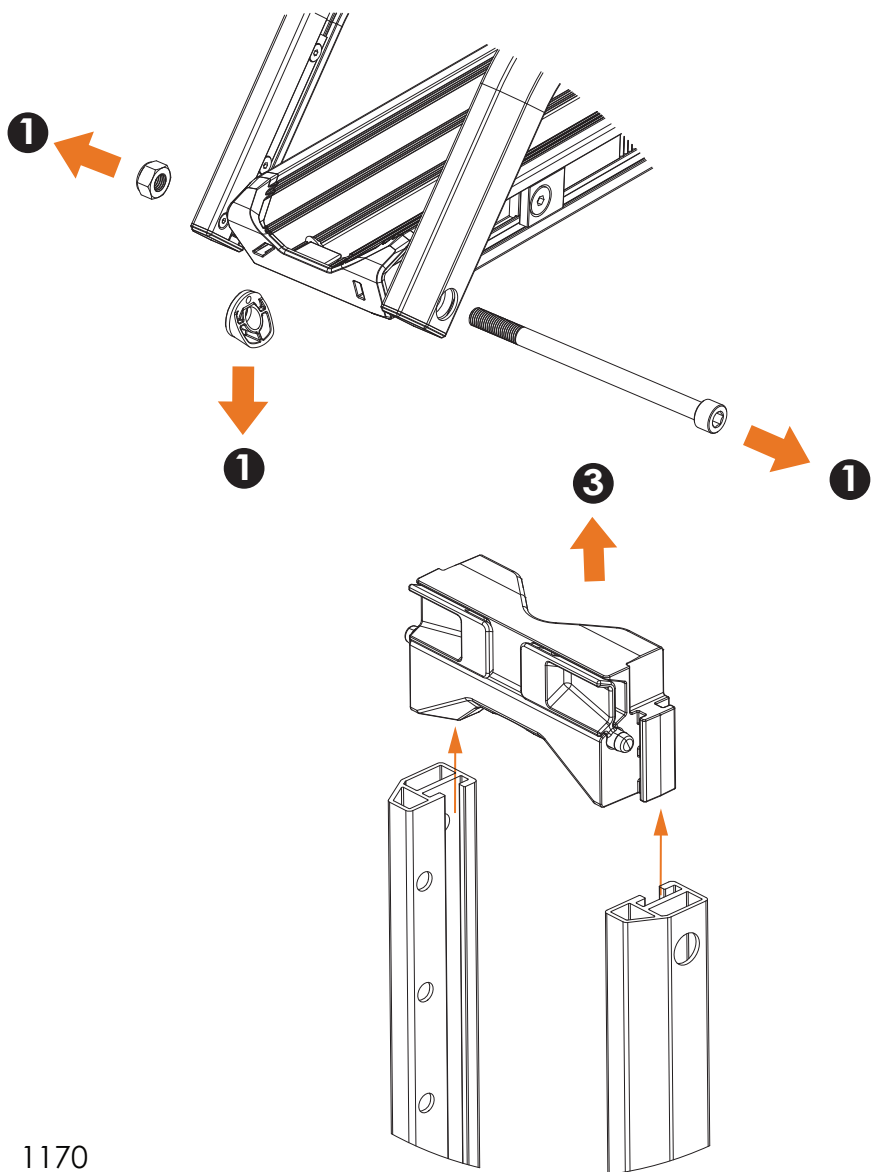

- ② Remove Tire Arm Bridge from Tire Arms with M6 bolts and Tire Arm Bridge Mounting Nuts attached.

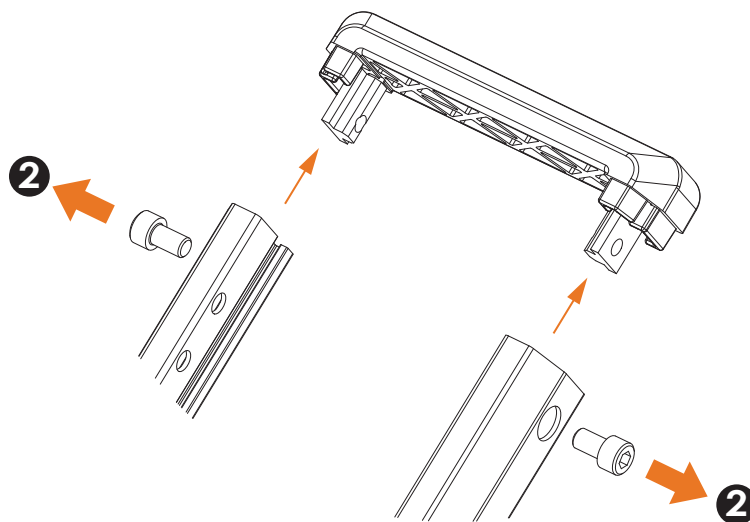

- ③ Remove Tire Arm Chock from Tire Arm T-channels.

- ④ Install the new Tire Arm and reinsert the Tire Arm Bridge and hardware by following steps 1, 2 & 3 in reverse. Torque the two M6 screws to 12 Nm and the Pivot Arm Bolt to 16 Nm.