

Tools Needed: 10 mm Wrench, Flat Head Screwdriver

1. Open the Panel Door.
2. Release the Spring Clip on the door end of the Gas Spring by depressing the Red Lever.
3. The Gas Spring can now be dislodged from the Ball Stud Bracket. Note: the Flat Head Screwdriver can be used to gently pry the ball and socket joint apart if needed. The Gas Spring can now be rotated out of the way.
4. Using the 10 mm Wrench, remove the M6 Locknuts and Washers. The Gas Spring Bracket can now be removed.
5. Replace the Gas Spring Bracket by following step 4 in reverse. Torque the M6 nuts to 5 Nm. \*\*See Note\*\*
6. Press the Gas Spring onto the Gas Spring Bracket and engage the Spring Clip.

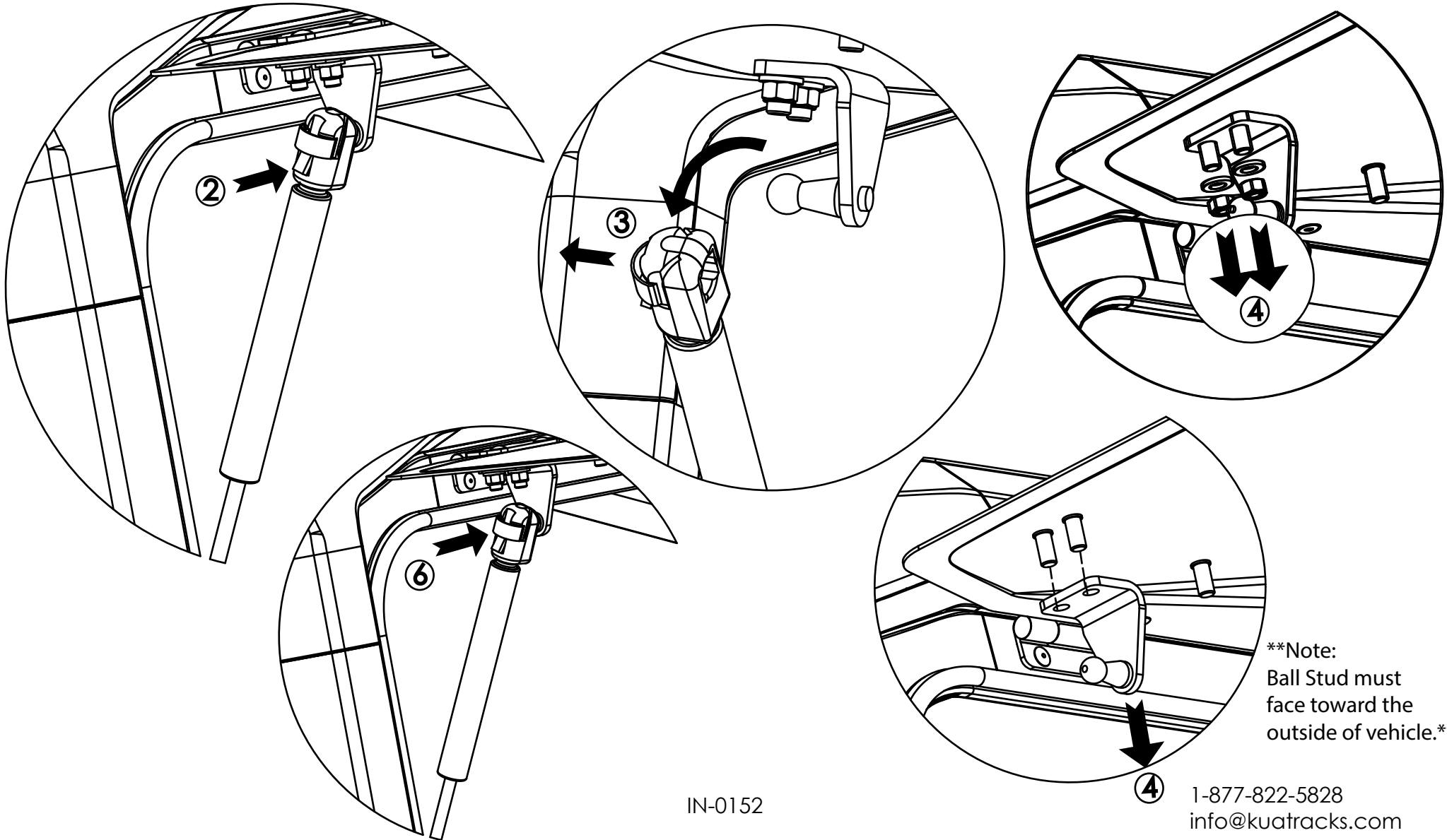

**\*\*Note:**  
Ball Stud must  
face toward the  
outside of vehicle.\*\*