

מוסדי הישיבה בסידני

כ"ה

YESHIVA COLLEGE INSTITUTIONS

SYDNEY—AUSTRALIA

DEDICATED TO THE FURTHERANCE OF JEWISH IDENTITY AND EDUCATION

Synagogue & College — Central Offices:

26, 36 Flood St.,  
Bondi, N.S.W. 2026, Australia

Community Welfare Centre:

55 Anglesea St.,  
Bondi, N.S.W. 2026, Australia

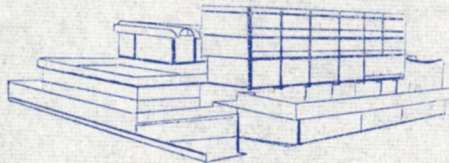

Tel.: 389-9028

Cable Address: Yeshcol

Kindergarten:

32 Flood St.,  
Bondi, N.S.W. 2026 Aust.

Strathfield College Branch:

19 Florence St.,  
Strathfield, N.S.W. 2135, Aust.

PLEASE ADDRESS ALL CORRESPONDENCE TO THE CENTRAL OFFICE

2nd November, 1973.

PATRONS:

The Rt. Hon. W. McMAHON, C.H., M.P.,  
Former Prime Minister of Australia.

The Hon. Sir W. ASTON, K.C.M.G.,  
Ex Speaker of the House of  
Representatives.

Mr. S. D. EINFELD,  
Deputy Leader of the Opposition,  
Member of the Legislative Assembly,  
President, Jewish Welfare Society of  
Aust.

Mr. J. RIORDAN,  
Member of Parliament.

Rabbi Dr. I. PORUSH, O.B.E.,  
President of Rabbinical Council of  
Australia and New Zealand.

Mr. L. KLEIN, C.B.E.,  
President, Executive Council of Aust.  
Jewry, Chairman, United Israel Appeal  
of Australia, President, Israel-Australia  
Chamber of Commerce.

Mr. E. KALDOR, M.I.E.A.,  
President, B'nai B'rith,  
District Grand Lodge No. 21  
of Australia and New Zealand.

Mr. B. FERSTER,  
President, Zionist Federation of  
Australia and New Zealand.

Mr. S. J. GERSTL, B.Ec., J.P.,  
Director, Jewish National Fund of  
Australia and New Zealand.

TRUSTEES:

Mr. M. STARK  
Mr. S. GREENBAUM  
Mr. N. GOODMAN

Dean and Spiritual Leader:  
Rabbi PINCHUS FELDMAN

Headmaster:

Mr. R. H. BREAKSPEAR

Director For Development:

Mr. LAIBL WOLF, LL.B.

Rabbi Dr. N. Lamm,  
The Jewish Centre,  
131 W. 86th Street, N.Y. 10024.  
U.S.A.

Dear Rabbi Lamm,

I trust that you and your wife are well and recovered somewhat. Needless to say I assume that you are fully involved with the war effort. We hear marvellous news of support from the American Jewish community.

Enclosed is a further report and incidental material relating to it.

I will be, G-d willing, in U.S.A. during January and certainly hope that we will see each other.

Although you sounded at the time somewhat uncertain as to whether we could find support for our College in U.S.A., when we last spoke, please try to find at least one or two persons who might look favourably upon our needs. Their outlook need only be that of 'positive feelings' concerning us, with no immediate thought of tangible aid. I am quite prepared to invest years in developing someone's favourable disposition'. I would use the opportunity of my stay in U.S.A. to make an initial contact with one or two such people that you might advise me to see.

Shalom Uverachah,

Sincerely,

L. WOLF, DIRECTOR FOR DEVELOPMENT.

LW/IMcD.

★ Kashrut Supervision ★ Shatnes Laboratory ★ Assimilation Prevention Centre ★ Sporting Facilities ★ Anti Missionary Activities ★ Day Schools ★ Counselling Facilities ★ Kindergartens ★ Adult Education ★ Publications

American & Canadian Friends of Yeshiva College Institutions

Professor S. Green, Dept. Social  
Work, Yeshiva University.

Rabbi S. Riskin,  
Educator and Rabbi.

Mr. M. Hornstein,  
Businessman and Yeshiva  
Supporter.

Mr. Mendelson,  
Educator and Rabbi.

Rebbetsin E. Jungreis,  
Educator and Writer.

Rabbi N. Lamm, Educator and  
Rabbi, Lecturer at Yeshiva  
University.

Professor Rabbi B. Hersch,  
Dept. Psychology, Hofstra  
University.

Rabbi I. Swift,  
Educator and Rabbi.

Mr. Y. Levy,  
Businessman and Yeshiva  
Supporter.

Rabbi Z. Parnes,  
Yeshiva Administrator and  
Educator.

Dr. N. Mindel,  
Author and Educationalist.

Professor Y. Block,  
Dept. Philosophy, University of  
Western Ontario.

Rabbi H. Schachter,  
Educator and Rabbi.

Dr. E. Green, Dept. Hebrew and  
Judaica, Hofstra University,  
President, Hebrew Lecturers  
Association of U.S.A.

Rabbi K. Kastel,  
Director, Lubavitch University  
and College Council.