



LINEAR SOLUTIONS

THE NATION'S LEADING INDEPENDENT SUPPLIER OF
ELECTRICAL RACEWAY PRODUCTS, WIRE & CABLE
PROUDLY MADE IN NORTH AMERICA



LINEAR S



HEADQUARTERS

149 S Colfax St., Griffith, IN 46319

+1 219 237 2399

www.linearsolutionsinc.com

orders@linearsolutionsinc.com

SOLUTIONS



**WE DELIVER ANYWHERE.
TO YOUR STOCK, OR TO YOUR
CUSTOMER'S JOB SITE.**

TABLE OF CONTENTS

MESSAGE FROM THE CEO & FOUNDER.....	5
ABOUT US.....	6
OUR PRODUCTS	
ELECTRICAL CONDUITS.....	10
EMT.....	11
IMC.....	13
GRC.....	14
ARC.....	15
PVC.....	16
FOAM CORE PVC.....	18
COLORED EMT.....	19
FITTINGS.....	23
EMT ELBOWS.....	24
ARC ELBOWS.....	28
GRC ELBOWS.....	29
COUPLINGS.....	31
NIPPLES.....	32
CONDUIT SUPPORT PRODUCTS.....	33
THREADED RODS.....	34
STRUT.....	35
GROUND RODS.....	38
COPPER PLATED GROUND RODS & GALVANIZED GROUND RODS.....	39
WIRE AND CABLE.....	41
THHN COPPER BUILDING WIRE...	42
URD CABLE.....	44
XHHW ALUMINUM.....	45
XHHW TRIPLEX.....	46

MESSAGE FROM THE CEO

To our valued partners,

Linear Solutions began as the underdog — a small team of engineers, sales professionals, and operations experts who saw what the electrical supply industry had become and believed there was a better way. **Electrical distributors were being treated as a channel, not a customer.** Service was slow. Flexibility was nonexistent. Innovation had stalled. And pricing pressure from large manufacturers and big-box competitors was forcing distributors to sacrifice margin just to keep their customers happy.

We built Linear Solutions to change that.

From day one, we made a promise: we work for the electrical distributor — not against them. That means fast will-call service, flexible delivery schedules, custom solutions, real support, and pricing strategies designed to help distributors win business, not lose it. We broke the rules that didn't make sense — and the market responded.

Today, we are one of the fastest-growing independent suppliers of raceway products, wire, and cable in North America. As reshoring and supply-chain realignment reshape our industry, we are investing heavily in North American manufacturing, long-term supplier partnerships, and smart inventory strategies that strengthen distributors' competitiveness and profitability.

Growth will continue. Product lines will expand. Our capabilities will scale. But one thing will never change: Distributors are not our channel — they are our customers. Your success is the reason we exist.

Thank you for your trust, your partnership, and your belief in what we are building together. The legacy players in our industry had decades to shape the market. We are just a few years in — and already proving what's possible when a supplier puts distributors first.

We are up for the challenge. We always will be.

Patrick Fay
CEO & Founder, Linear Solutions Inc



Patrick Fay CEO & Founder Linear Solutions

Cell: +1.734.730.0438

Office: +1.219.237.2595 x 104

patrick.fay@linearsolutionsinc.com

www.linearsolutionsinc.com

Manufacturing Facility and
Corporate Headquarters
Griffith, Indiana

ABOUT US

Linear Solutions Inc. is a fast-growing independent supplier of electrical raceway products, wire, and cable — built to serve electrical distributors first. Headquartered in Northwest Indiana near Chicago, our company is rooted in hard work, responsiveness, and a relentless focus on helping distributors win business in competitive markets.

Looking Ahead

Our commitment is simple: more products, more capability, more value for electrical distributors. We are excited for what's ahead and grateful for your partnership.

Linear Solutions: The independent alternative to the industry giants.



Our Story

Linear Solutions Inc. started as a small, family-owned business with a simple goal — to bring speed, quality, and reliability to the electrical supply industry. Through hard work and strong partnerships, we have grown into a trusted national provider of raceway products, wire, and cable.

Our success is built on the same values we began with: do the right thing, deliver great products, and take care of our customers.

Our Mission

To add value to electrical distributors through supply chain excellence, consistent quality, and reliable service. We are **100% channel-driven** and exist to support electrical distributors as our customers and partners — not competitors.

Our Partners





What We Do

Linear Solutions supplies a complete electrical raceway and grounding system for commercial and industrial construction. Our product offering includes:

Electrical Conduit: Steel, aluminum, galvanized, and PVC in 10 ft & 20 ft lengths

Wire & Cable: High-performance building wire for dependable electrical installations

Conduit Fittings: Elbows, couplings, nipples and sweeps in all standard sizes and bends

Strut & Threaded Rod: Structural support for electrical and mechanical systems

Grounding Products: Copper-bonded and galvanized ground rods in multiple sizes

We stock the core products electrical distributors need.

Our Commitment

We put our customers first. Every distributor has unique needs, and we work to provide solutions that fit, perform, and deliver real value. Our team is always available with technical support, fast responses, and reliable service — making sure you get the right products, on time, every time.





Service and Flexibility

Our greatest strength is service. We built Linear Solutions around the needs of electrical distributors, not the other way around.

- No minimum order quantities, order what you need, when you need it
- Fast turnaround times, same-day and next-day shipping available on most orders
- Flexible delivery options, to distributor stock or direct to job sites
- White-glove delivery on our fleet of trucks for tight-window and high-priority projects

We understand how demanding the electrical distribution business is. Projects change, deadlines shift, and new needs arise without warning. That's why we don't force our customers into rigid rules, we adapt to theirs. At Linear Solutions, personalized service and unmatched flexibility aren't selling points — they're our identity.

Our Values

At Linear Solutions, our values shape how we design, manufacture, and deliver product. Our culture and performance are built around the word ACTION.

A. Accountability: We take responsibility for our decisions, performance, and outcomes.

C. Customer Centric: We stay focused on the needs of our customers and continuously refine our solutions to help them win.

T. Transparency & Honesty: We conduct business with openness and integrity. We tell the truth, even when it's hard.

I. Inspect What We Expect: We demand excellence and verify it. Quality is not assumed, it is measured.

O. Own Decisions: We make informed decisions, and we stand by them. We learn, we adapt and get better.

N. No Blame, Only Fixing: We solve problems instead of pointing fingers. Challenges are opportunities to improve, not to criticize.

We sell UL LISTED products.



ELECTRICAL CONDUIT

Electrical conduit is a durable tubing system engineered to protect and route electrical wiring in commercial, industrial, and residential environments. It safeguards conductors from mechanical damage, moisture, and environmental exposure, ensuring the integrity and safety of electrical installations.

Linear Solutions offers a comprehensive portfolio of electrical conduit, including **aluminum, steel, galvanized, and PVC**, with ongoing expansion aligned to the needs of electrical distributors, contractors, and the evolving electrical industry.

ELECTRICAL METALLIC TUBING (EMT)



In 2024, working closely with our manufacturing partner and driven directly by customer feedback, **we re-engineered our EMT to deliver industry-leading wire-pulling performance.** The result is a proprietary ultra-low-friction interior coating that reduces pull force, eliminates snags, and gets circuits installed faster. Electricians notice it immediately. Contractors save on labor. Distributors build loyalty with every job.

- **Ultra-Slick Interior Coating for Effortless Pulls**
- UL 797 compliant for proven safety and regulatory confidence
- Low carbon steel (SAE J403) for strength, formability, and consistency
- ASME B18.31.3 compliant mechanical properties for reliable performance in the field
- Hot-dip galvanized exterior for superior corrosion resistance in harsh environments
- Compatible with all standard EMT fittings and connectors
- Powder coating available on EMT and elbows, including custom colors for spec-driven and architectural jobs.
- Fast fulfillment, core SKUs stocked for immediate shipment; specialty orders can ship as soon quickly as a few days lead time.

ELECTRICAL METALLIC TUBING (EMT) SPECIFICATIONS

TRADE SIZE	DESCRIPTION	DIMENSIONS				WALL THICKNESS		WEIGHT (min.)	
		O.D.	LENGTH						
		in.	mm.	ft.	m.	in.	mm.	lbs/ft.	kg/m.
½"	EMT TUBING ½"	0.706	17.93	10	3.05	0.042	1.07	0.285	0.424
¾"	EMT TUBING ¾"	0.922	23.42	10	3.05	0.049	1.24	0.435	0.647
1"	EMT TUBING 1"	1.163	29.54	10	3.05	0.057	1.45	0.640	0.952
1¼"	EMT TUBING 1¼"	1.510	38.35	10	3.05	0.065	1.65	0.950	1.414
1½"	EMT TUBING 1½"	1.740	44.20	10	3.05	0.065	1.65	1.10	1.637
2"	EMT TUBING 2"	2.197	55.80	10	3.05	0.065	1.65	1.40	2.083
2½"	EMT TUBING 2½"	2.875	73.03	10	3.05	0.072	1.83	2.05	3.051
3"	EMT TUBING 3"	3.500	88.90	10	3.05	0.072	1.83	2.50	3.720
3½"	EMT TUBING 3½"	4.000	101.60	10	3.05	0.083	2.11	3.25	4.837
4"	EMT TUBING 4"	4.500	114.30	10	3.05	0.083	2.11	3.70	5.506

ELECTRICAL METALLIC TUBING (EMT) PACKAGING

TRADE SIZE	METRIC DESIGNATOR	BUNDLE				MASTER BUNDLE			
		PIECES	FEET	METERS	NOMINAL Wt/Lbs	PIECES	FEET	METERS	NOMINAL Wt/Lbs
½"	16	10	100	30.48	30.0	700	7,000	2,133.6	2,100
¾"	21	10	100	30.48	46.0	500	5,000	1,524	2,300
1"	27	10	100	30.48	67.0	300	3,000	914.4	2,010
1¼"	35	5	50	15.24	50.5	200	2,000	609.6	2,020
1½"	41	5	50	15.24	58.0	150	1,500	457.2	1,740
2"	53	3	30	9.14	44.4	120	1,200	365.8	1,776
2½"	63	1	10	3.05	21.6	61	610	185.9	1,318
3"	78	1	10	3.05	26.3	51	510	155.4	1,341
3½"	91	1	10	3.05	34.9	37	370	112.8	1,291
4"	103	1	10	3.05	39.3	30	300	91.4	1,179



INTERMEDIATE METAL CONDUIT (IMC)



Engineered for Durability and Efficiency

- UL1242 Listed for proven safety, performance, and regulatory compliance.
- Optimized for outdoor use and secure conduit connections in commercial, industrial, and utility environments.
- Protects insulated conductors and cables from mechanical and environmental damage.
- Approximately 1/3 lighter than Rigid Metal Conduit (RMC) for easier handling and faster overhead installation.
- Manufactured from high-strength lightweight steel to balance rigidity and workability.
- Hot-dip galvanized exterior coating delivers long-term corrosion resistance in harsh outdoor environments.
- Smooth, defect-free interior and exterior ensures easy, low-friction wire pulling.
- Standard 10-ft lengths for full compatibility with industry tooling and fitting.



INTERMEDIATE METAL CONDUIT (IMC) SPECIFICATIONS

TRADE SIZE DESIGNATOR		AVERAGE OUTSIDE DIAMETER*		AVERAGE WALL THICKNESS**		APPROX. WT. PER 100 FT. (30.5M)		QTY. IN MASTER BUNDLE		END CAP COLOR
in.	mm.	in.	mm.	in.	mm.	lbs.	kg.	ft.	pcs.	
½"	16	0.815	20.70	0.078	1.98	61.46	27.88	3,500	350	Yellow
¾"	21	1.029	26.13	0.083	2.10	83.58	37.91	2,500	250	Green
1"	27	1.290	32.76	0.093	2.35	118.66	53.82	1,700	170	Orange
1¼"	35	1.638	41.60	0.095	2.42	157.23	71.32	1,350	135	Green
1½"	41	1.883	47.82	0.100	2.54	190.64	86.47	1,100	110	Yellow
2"	53	2.360	59.94	0.105	2.67	253.39	114.94	800	80	Orange
2½"	63	2.857	72.56	0.150	3.81	434.62	197.14	370	37	Yellow
3"	78	3.476	88.29	0.150	3.81	533.81	242.13	300	30	Orange
3½"	91	3.971	100.86	0.150	3.81	613.42	278.24	240	24	Yellow
4"	103	4.466	113.43	0.150	3.81	692.39	314.06	240	24	Orange

GALVANIZED RIGID CONDUIT (GRC)



Most rigid conduit in the marketplace is ERW only, which often leads to: brittleness during field bending, cracking failures during threading, inconsistent performance under heavy mechanical stress.

Linear Solutions does not manufacture ERW-only rigid. Our rigid is **FULL-BODY ANNEALED**, delivering: outstanding flexibility without cracking, reliable field bends with standard equipment, higher mechanical resilience under extreme jobsite conditions. This is the difference serious contractors feel the moment they thread or bend it.

- UL6 Listed for commercial, industrial, and mission-critical installations.
- Hot-dip galvanized INSIDE AND OUT to protect conductors and metal body from corrosion — most suppliers only galvanize the exterior.
- Organic topcoat layer adds protection against white rust and chemical exposure.
- Thick-wall tubing engineered for threading — threads hold strong over decades.
- Smooth interior = easier wire pulls, lower friction, faster installs.

LINEAR SOLUTIONS RIGID	TYPICAL COMPETITOR RIGID
Full-Body annealed	ERW-Only, no anneal
Galvanized inside and outside	Outside only
Superior field bend reliability	Cracking risk on bends
Fast, smooth wire pulling	Rough interior, higher pull force

GALVANIZED RIGID CONDUIT (GRC) SPECIFICATIONS

TRADE SIZE DESIGNATOR		APPROX. WT. PER 100 FT. (30.5M)		AVERAGE OUTSIDE DIAMETER*		AVERAGE WALL THICKNESS**		QTY. IN MASTER BUNDLE		APPROX. WEIGHT		VOLUME		END CAP COLOR
mm.	in.	lbs.	kg.	mm.	in.	mm.	in.	ft.	m.	lbs.	kg.	cu. ft.	cu. m.	
16	½"	82	37,2	21,30	0,840	2,60	0.104	2500	762.5	2050	929.7	20.8	0.59	Black
21	¾"	109	49,4	26,70	1,050	2,70	0.107	2000	610.0	2180	988.7	24.3	0.69	Red
27	1"	161	73,0	33,40	1,315	3,20	0.126	1250	381.3	2013	912.9	21.7	0.61	Blue
35	1¼"	218	98,9	42,20	1,660	3,40	0.133	900	274.5	1962	889.8	23.3	0.66	Red
41	1½"	263	119,3	48,30	1,900	3,50	0.138	800	244.0	2104	954.2	27.8	0.79	Black
53	2"	350	158,7	60,30	2,375	3,70	0.146	600	183.0	2100	952.4	33.8	0.96	Blue
63	2½"	559	253,5	73,00	2,875	4,90	0.193	370	112.9	2068	937.9	29.2	0.83	Black
78	3"	727	329,7	88,90	3,500	5,20	0.205	300	91.5	2181	989.1	31.3	0.89	Blue
91	3½"	880	399,1	101,60	4,000	5,50	0.215	250	76.3	2200	997.7	34.7	0.98	Black
103	4"	1030	467,1	114,30	4,500	5,70	0.225	200	61	2060	934.2	33.7	0.95	Blue
129	5"	1400	634,9	141,30	5,563	6,20	0.245	150	45.8	2010	952.4	41.3	1.17	Blue
155	6"	1840	834,5	168,30	6,625	6,80	0.266	100	30.5	1840	834.5	38.9	1.10	Blue

ALUMINUM RIGID CONDUIT (ARC)



Choose Aluminum. Work Faster. Spend Less

- T5-tempered 6063 alloy — the perfect balance of strength and bendability on-site
- Up to **70% lighter than steel** → safer lifts, less fatigue, faster overhead work
- Corrosion-proof performance → ideal for coastal, damp, or chemical environments
- Installs with standard fittings, no specialty hardware or training required
- UL6A Listed & Schedule 40 → inspectors approve it, electricians love it
- Reduced labor costs, crews move quicker and get more done in a day
- **15-ft lengths** available by request, fewer couplings, cleaner runs, faster job completion.



ALUMINUM RIGID CONDUIT (ARC) SPECIFICATIONS

MEASURE		APROX. WEIGHT PER 10' TUBE	EXTERNAL DIAMETER		WALL THICKNESS		CAP COLOR
in.	mm.		in.	mm.	in.	mm.	
1/2	12.700	2.877	0.840	21.336	0.104	2.642	Black
3/4	19.050	3.825	1.050	26.670	0.107	2.718	Red
1	25.400	5.573	1.315	33.401	0.124	3.150	Blue
1 1/4	31.750	7.322	1.660	42.164	0.126	3.200	Red
1 1/2	38.100	9.070	1.900	48.260	0.136	3.454	Black
2	50.800	12.090	2.375	60.325	0.143	3.632	Blue
2 1/2	63.500	19.191	2.875	73.025	0.188	4.775	Black
3	76.200	24.859	3.500	88.900	0.196	4.978	Blue
3 1/2	88.900	30.265	4.000	101.600	0.207	5.258	Black
4	101.600	35.408	4.500	114.300	0.215	5.461	Blue
5	127.000	47.836	5.563	141.300	0.230	5.842	Blue
6	152.400	63.564	6.625	168.275	0.257	6.528	Blue

POLYVINYL CHLORIDE CONDUIT (PVC)



BUILT FOR POWER, FIBER & INFRASTRUCTURE
Build America, Buy America Act (BABA) & Buy American Act (BAA) Compliant — MADE IN USA PVC In Stock

Linear Solutions provides premium PVC conduit for demanding indoor and outdoor applications — from commercial construction to mission-critical data-center and infrastructure projects. Our portfolio supports both federal-funded / spec-driven jobs AND price-sensitive commercial projects, ensuring distributors always have the right product for the situation.

Two Product Sources — One Supply Partner

TYPE	MARKET FITS	NOTES
Made in USA PVC (JM Eagle)	Government, DOT, utilities, infrastructure, data centers	BABA + BAA Compliant (In Stock)
Import PVC	Standard commercial and residential construction	Cost-competitive option for everyday jobs

- Linear Solutions gives distributors the flexibility to win every type of bid — spec-driven AND price-driven.

Performance Highlights

- 90°C wire-system rating printed on every length
- Non-metallic — no rust, no chemical corrosion, no sunlight degradation
- High-impact strength for trenching and heavy-equipment zones
- Ideal for direct burial & corrosive soils
- Smooth interior = faster wire pulls, lower labor cost
- Standard lengths: 10 ft & 20 ft
- Compatible with standard solvent-weld fittings and couplings

Available in Two PVC Constructions

CONSTRUCTION	BENEFITS	IDEAL USES
Solid-Wall PVC	Maximum strength & durability, electrical power	Industrial, data centers, substations
Foam-Core PVC	Easier handling & faster installation, long horizontal runs	Commercial, residential, LV/Comms

Where Linear Solutions PVC is Winning Today

- Data Center Projects
- Utilities & Power Distribution
- Telecom / Fiber Backbone
- Industrial Facilities
- Renewable Energy & EV Infrastructure
- Civil Construction & Direct Burial
- When corrosion risk, trenching, moisture, or soil chemistry is involved.



POLYVINYL CHLORIDE CONDUIT (PVC) SPECIFICATIONS SCHEDULE 40

TRADE SIZE DESIGNATOR	AVERAGE OUTSIDE DIAMETER*	MINIMUM AVG INSIDE DIAMETER	MINIMUM WALL	WEIGHT PER 100 FT.	10 FT QTY
in.	in.	in.	in.	lbs.	Pack
1/2	0.840	0.578	0.109	17	6,000
3/4	1.050	0.780	0.113	23	4,400
1	1.315	1.004	0.133	34	3,600
1 1/4	1.660	1.335	0.140	46	3,300
1 1/2	1.900	1.564	0.145	55	2,250
2	2.375	2.021	0.154	73	1,400
2 1/2	2.875	2.414	0.203	124	930
3	3.500	3.008	0.216	163	880
3 1/2	4.000	3.486	0.226	196	630
4	4.500	3.961	0.237	232	570
5	5.563	4.975	0.258	315	380
6	6.625	5.986	0.280	409	260
8	8.625	7.853	0.322	607	180

SCHEDULE 80

TRADE SIZE DESIGNATOR	AVERAGE OUTSIDE DIAMETER*	MINIMUM AVG INSIDE DIAMETER	MINIMUM WALL	WEIGHT PER 100 FT.	10 FT QTY
in.	in.	in.	in.	lbs.	Pack
1/2	0.840	0.502	0.147	21	6,000
3/4	1.050	0.698	0.154	30	4,400
1	1.315	0.910	0.179	44	3,600
1 1/4	1.660	1.227	0.191	60	3,300
1 1/2	1.900	1.446	0.200	72	2,250
2	2.375	1.881	0.218	101	1,400
2 1/2	2.875	2.250	0.276	154	930
3	3.500	2.820	0.300	210	880
3 1/2	4.000	3.280	0.318	250	630
4	4.500	3.737	0.377	308	570
5	5.563	4.713	0.375	428	380
6	6.625	5.646	0.432	588	260

FOAM CORE POLYVINYL CHLORIDE CONDUIT(PVC)



Installation:

- Lightweight, economical and easy to install.
- Field-cut with a power saw or handsaw;
- bevel without complicated machinery.
- Does not need lining, wrapping, coating,
- or cathodic protection to prevent galvanic corrosion.
- JM Eagle™ Electrical Conduit Installation Guide.

Features:

- Unaffected by corrosive elements, sewer gas, sulfuric acid, alkaline, or acidic soils.
- Structurally sound joints provide a rigid connection.

Product Standard: NEMA TC-2

Certification: UL651

Nominal Laying Length: 10/20 feet. Laying length tolerances are in accordance with approval standards.

Pipe Ending Options: Bell End

NOMINAL LAYING LENGTH	10/20 feet
PIPE SIZES	1.5" / 2" / 3" / 4" / 6"
PIPE COLOR	Grey

NEMA TC-2 / UL651 SCHEDULE 40
SAME SPEC AS TRADITIONAL SCH 40 CONDUIT
MADE IN THE USA
UP TO 40% LIGHTER THAN TRADITIONAL SCH 40 CONDUIT

Rated for 90° C conductor

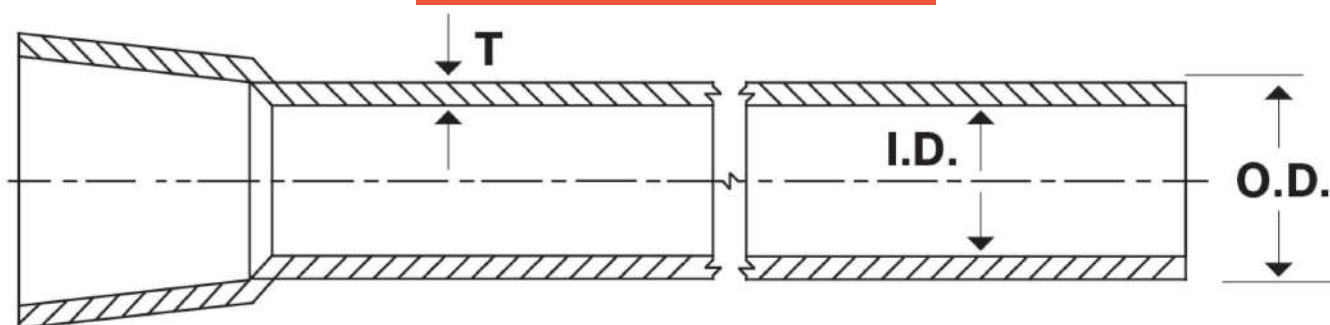

T: Wall Thickness

I.D.: Inside Diameter

O.D.: Outside Diameter

PIPE SIZE (IN)	AVG. O.D. (ID)	NOM. I.D. (IN)	MIN.T. (IN)	APPROX. WT/FT	PIPE STIFNESS (PSI)
1.5	1.900	1.593	0.145	0.383	600
2	2.375	2.049	0.154	0.500	300
3	3.500	3.042	0.216	1.050	300
4	4.500	3.998	0.237	1.450	200
6	6.625	6.031	0.280	2.450	120

COLORED CONDUIT

EMT, GRC, IMC & Elbows



Linear Solutions provides a complete system of powder-coated colored conduit across EMT, Rigid, IMC, and elbows, ensuring full color continuity from the panel all the way to the device. Colored conduit is increasingly specified for data centers, industrial facilities, hospitals, and high-visibility commercial projects where fast circuit identification and safety zoning are critical.

Standard colors: White, Green, Black, Red, Orange, Yellow, Blue, Purple.

Custom color matching available upon request.



- The only fully matched system: EMT, Rigid, IMC, and elbows in the same color, same sheen, same batch.
- Engineered for jobsite durability — premium powder-coat finish resists scratches and chipping
- Perfect for **data center** projects where speed, zone identification, and troubleshooting efficiency drive labor savings.
- Consistent color lot-to-lot for large multi-phase projects.
- Indoor and outdoor performance for harsh environments.
- Stenciling, striping, and custom labeling available to support spec-driven environments.

Colored conduit isn't just aesthetic — it reduces wiring mistakes, accelerates troubleshooting, speeds commissioning, improves safety, and simplifies inspections, especially on large-scale data center builds where time equals money.



COMMON COLOR APPLICATIONS

COLOR		TYPICAL APPLICATIONS
○	White	Architectural spaces · Clean aesthetic · Light interiors
●	Red	Emergency circuits · Fire protection · Security systems
●	Yellow	Safety awareness · High-risk / equipment-dense zones
●	Orange	Data centers · Fiber optic · Low-voltage infrastructure
●	Purple	Specialized circuits · Controlled access / security wiring
●	Green	Hospitals · Healthcare · Grounding & critical power
●	Blue	Networking · Data · Video & communications systems
●	Black	Low-visibility installations · Performance venues



Coloring Application





We provided all the EMT for **Delivery Station and Fulfillment Center** Wilmington-Pender County area of North Carolina.



We supplied a significant volume of threaded rod for the **AI Data Center** project in Mount Pleasant, Wisconsin.



We provided colored conduit for **AI Data Center** project in South Bend, Indiana.



We provided colored IMC, colored RIGID, white strut and colored EMT for the construction of **Ellendale AI Data Center**.



FITTINGS

Elbows is typically fitted at an angle of **15°, 22.5°, 30°, 45°, or 90°**, is a pipe fitting that is placed between two lengths of pipe or tubing to allow for a change in direction.

Couplings are specifically used to connect two lengths of pipe and has female threaded connections on either side.

Nipples, which is a short length of threaded conduit, are utilized between two boxes or enclosures or between conduit and fittings, boxes, and enclosures.

EMT ELBOWS



Engineered for Superior Performance & Code Compliance

- Manufactured from low-carbon steel per SAE J403 for optimal strength and cold-workability
- Fully compliant with ASME B18.31.3 material and mechanical property standards
- Precision-formed bends ensure smooth wire pulls and consistent sweep radius across all sizes
- Hot-dip galvanized coating delivers outstanding long-term corrosion resistance in indoor and outdoor environments
- Meets or exceeds UL797 performance standards for electrical conduit safety, reliability, and installation compatibility
- Compatible with all standard EMT fittings and couplings for fast and straightforward field installation

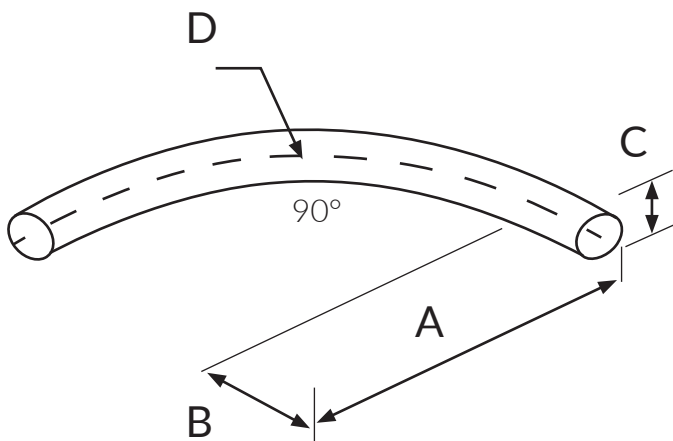
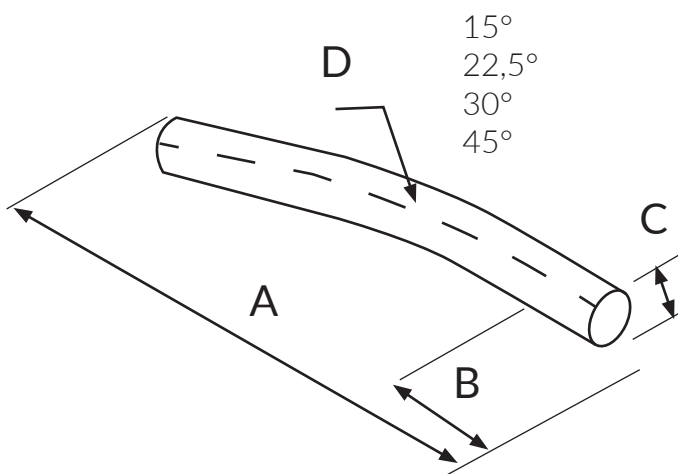

15° EMT ELBOWS SPECIFICATIONS

TRADE SIZE	DECRPTION	DIMENSIONS								WALL THICKNESS		APPROX. WEIGHT	
		(A)		(B) length of straight end		(C) outside diameter		(D) radius to centerline		in.	mm.	lb.	kg.
		in.	mm.	in.	mm.	in.	mm.	in.	mm.				
1 ¼"	EMT ELBOW 1 ¼"	9.094	231	3.583	91	1.510	38.35	7.25	184	0.065	1.65	0.74	0.34
1 ½"	EMT ELBOW 1 ½"	9.134	232	3.465	88	1.740	44.20	8.25	210	0.065	1.65	0.86	0.39
2"	EMT ELBOW 2"	11.929	303	4.646	118	2.197	55.80	9.50	241	0.065	1.65	1.43	0.65
2 ½"	EMT ELBOW 2 ½"	17.047	433	7.086	180	2.875	73.03	10.50	267	0.072	1.83	3.03	1.37
3"	EMT ELBOW 3"	19.843	504	8.149	207	3.500	88.90	13.00	330	0.072	1.83	4.36	1.97
3 ½"	EMT ELBOW 3 ½"	19.882	505	7.874	200	4.000	101.60	15.00	381	0.083	2.11	5.20	2.36
4"	EMT ELBOW 4"	19.960	507	7.756	197	4.500	114.30	16.00	406	0.083	2.11	6.16	2.79

22.5° EMT ELBOWS SPECIFICATIONS

TRADE SIZE	DECRPTION	DIMENSIONS								WALL THICKNESS		APPROX. WEIGHT	
		(A)		(B) length of straight end		(C) outside diameter		(D) radius to centerline		in.	mm.	lb.	kg.
		in.	mm.	in.	mm.	in.	mm.	in.	mm.				
1 ¼"	EMT ELBOW 1 ¼"	9.055	230	2.000	79	1.510	38.35	7.25	184	0.065	1.65	0.74	0.34
1 ½"	EMT ELBOW 1 ½"	9.842	250	2.000	84	1.740	44.20	8.25	210	0.065	1.65	0.93	0.42
2"	EMT ELBOW 2"	11.811	300	2.000	103	2.197	55.80	9.50	241	0.065	1.65	1.46	0.66
2 ½"	EMT ELBOW 2 ½"	16.889	429	3.000	163	2.875	73.03	10.50	267	0.072	1.83	3.04	1.38
3"	EMT ELBOW 3"	19.645	499	3.125	185	3.500	88.90	13.00	330	0.072	1.83	4.35	1.98
3 ½"	EMT ELBOW 3 ½"	19.763	502	3.250	175	4.000	101.60	15.00	381	0.083	2.11	5.56	2.52
4"	EMT ELBOW 4"	19.881	505	3.750	170	4.500	114.30	16.00	406	0.083	2.11	6.17	2.80

30° EMT ELBOWS SPECIFICATIONS

TRADE SIZE	DECRPTION	DIMENSIONS								WALL THICKNESS		APPROX. WEIGHT	
		(A)		(B) length of straight end		(C) outside diameter		(D) radius to centerline		in.	mm.	lb.	kg.
		in.	mm.	in.	mm.	in.	mm.	in.	mm.				
1 ¼"	EMT ELBOW 1 ¼"	8.897	226	2.637	67	1.510	38.35	7.25	184	0.065	1.65	0.74	0.33
1 ½"	EMT ELBOW 1 ½"	9.724	247	2.755	70	1.740	44.20	8.25	210	0.065	1.65	0.93	0.43
2"	EMT ELBOW 2"	11.692	297	3.425	87	2.197	55.80	9.50	241	0.065	1.65	1.46	0.66
2 ½"	EMT ELBOW 2 ½"	16.653	423	5.708	145	2.875	73.03	10.50	267	0.072	1.83	3.05	1.38
3"	EMT ELBOW 3"	19.370	492	6.456	164	3.500	88.90	13.00	330	0.072	1.83	4.35	1.97
3 ½"	EMT ELBOW 3 ½"	23.307	592	7.952	202	4.000	101.60	15.00	381	0.083	2.11	5.78	2.62
4"	EMT ELBOW 4"	23.464	596	7.677	195	4.500	114.30	16.00	406	0.083	2.11	6.61	3.00

45° EMT ELBOWS SPECIFICATIONS

TRADE SIZE	DECRPTION	DIMENSIONS								WALL THICKNESS		APPROX. WEIGHT	
		(A)		(B) length of straight end		(C) outside diameter		(D) radius to centerline		in.	mm.	lb.	kg.
		in.	mm.	in.	mm.	in.	mm.	in.	mm.				
1 ¼"	EMT ELBOW 1 ¼"	9.212	234	2.086	53	1.510	38.35	7.25	184	0.065	1.65	0.77	0.35
1 ½"	EMT ELBOW 1 ½"	10.075	256	2.125	54	1.740	44.20	8.25	210	0.065	1.65	1.00	0.45
2"	EMT ELBOW 2"	12.362	314	2.834	72	2.197	55.80	9.50	241	0.065	1.65	1.55	0.70
2 ½"	EMT ELBOW 2 ½"	18.267	464	5.748	146	2.875	73.03	10.50	267	0.072	1.83	3.62	1.64
3"	EMT ELBOW 3"	18.503	470	4.724	120	3.500	88.90	13.00	330	0.072	1.83	4.40	2.00
3 ½"	EMT ELBOW 3 ½"	27.165	690	8.976	228	4.000	101.60	15.00	381	0.083	2.11	7.40	3.36
4"	EMT ELBOW 4"	27.480	698	8.582	218	4.500	114.30	16.00	406	0.083	2.11	9.06	4.11

90° EMT ELBOWS SPECIFICATIONS

TRADE SIZE	DECRPTION	DIMENSIONS								WALL THICKNESS		APPROX. WEIGHT	
		(A)		(B) length of straight end		(C) outside diameter		(D) radius to centerline		in.	mm.	lb.	kg.
		in.	mm.	in.	mm.	in.	mm.	in.	mm.				
½"	EMT ELBOW ½"	6.141	156	1.500	38	0.706	17.93	4.00	102	0.042	1.07	0.25	0.11
¾"	EMT ELBOW ¾"	6.811	173	1.500	38	0.922	23.42	4.50	114	0.049	1.24	0.43	0.19
1"	EMT ELBOW 1"	8.425	214	1.875	48	1.163	29.54	5.75	146	0.057	1.45	0.73	0.33
1 ¼"	EMT ELBOW 1 ¼"	10.787	274	2.000	51	1.510	38.35	7.25	184	0.065	1.65	1.40	0.64
1 ½"	EMT ELBOW 1 ½"	11.929	303	2.000	51	1.740	44.20	8.25	210	0.065	1.65	2.06	0.93
2"	EMT ELBOW 2"	14.370	365	2.000	51	2.197	55.80	9.50	241	0.065	1.65	2.71	1.23
2 ½"	EMT ELBOW 2 ½"	18.385	497	3.000	76	2.875	73.03	10.50	267	0.072	1.83	5.29	2.40
3"	EMT ELBOW 3"	19.251	489	3.125	79	3.500	88.90	13.00	330	0.072	1.83	6.54	2.97
3 ½"	EMT ELBOW 3 ½"	25.590	650	3.250	83	4.000	101.60	15.00	381	0.083	2.11	9.88	4.48
4"	EMT ELBOW 4"	25.275	642	3.750	86	4.500	114.30	16.00	406	0.083	2.11	12.45	5.65

15° EMT ELBOWS PACKAGING

TRADE SIZE	METRIC DESIGNATOR	PIECES PER BOX / BUNDLE	BOXES / BUNDLES PER PALLET	PIECES PER PALLET	PALLET WEIGHT IN LB.	PALLET WEIGHT IN KG.
1 ¼"	35	45	45	2,025	1,574	714
1 ½"	41	40	36	1,440	1,296	588
2"	53	28	24	672	1,033	469
2 ½"	63	3	112	336	1,071	486
3"	78	3	72	216	913	414
3 ½"	91	2	88	176	1,001	454
4"	103	2	72	144	933	423

22.5° EMT ELBOWS PACKAGING

TRADE SIZE	METRIC DESIGNATOR	PIECES PER BOX / BUNDLE	BOXES/BUNDLES PER PALLET	PIECES PER PALLET	PALLET WEIGHT IN LB.	PALLET WEIGHT IN KG.
1 ¼"	35	45	45	2,025	1,570	712
1 ½"	41	40	36	1,260	1,248	566
2"	53	28	24	672	1,047	475
2 ½"	63	3	112	336	1,076	488
3"	78	3	72	216	972	441
3 ½"	91	2	88	176	1,008	457
4"	103	2	72	144	926	420

30° EMT ELBOWS PACKAGING

TRADE SIZE	METRIC DESIGNATOR	PIECES PER BOX / BUNDLE	BOXES/BUNDLES PER PALLET	PIECES PER PALLET	PALLET WEIGHT IN LB.	PALLET WEIGHT IN KG.
1 ¼"	35	40	45	1,800	1,396	633
1 ½"	41	45	36	1,260	1,248	566
2"	53	24	24	576	917	416
2 ½"	63	3	112	336	1,071	486
3"	78	3	72	216	985	447
3 ½"	91	2	66	132	904	410
4"	103	2	45	90	951	431

45° EMT ELBOWS PACKAGING

TRADE SIZE	METRIC DESIGNATOR	PIECES PER BOX / BUNDLE	BOXES/BUNDLES PER PALLET	PIECES PER PALLET	PALLET WEIGHT IN LB.	PALLET WEIGHT IN KG.
1 ¼"	35	40	45	1,800	1,537	697
1 ½"	41	30	36	1,080	1,111	504
2"	53	24	24	576	995	541
2 ½"	63	3	112	336	1,243	564
3"	78	3	66	198	904	410
3 ½"	91	2	44	88	730	331
4"	103	2	40	80	794	360

90° EMT ELBOWS PACKAGING

TRADE SIZE	METRIC DESIGNATOR	PIECES PER BOX / BUNDLE	BOXES / BUNDLES PER PALLET	PIECES PER PALLET	PALLET WEIGHT IN LB.	PALLET WEIGHT IN KG.
½"	16	50	120	6,000	1,548	702
¾"	21	50	84	4,200	1,795	814
1"	27	40	54	2,160	1,625	737
1 ¼"	35	20	30	600	904	410
1 ½"	41	20	30	600	1,127	511
2"	53	10	32	320	974	442
2 ½"	63	3	48	144	807	366
3"	78	3	36	108	748	339
3 ½"	91	2	36	72	829	376
4"	103	2	30	60	776	352

Elbows 1 " to 2" are packaged in cardboard boxes and labeled in accordance to UL 797.

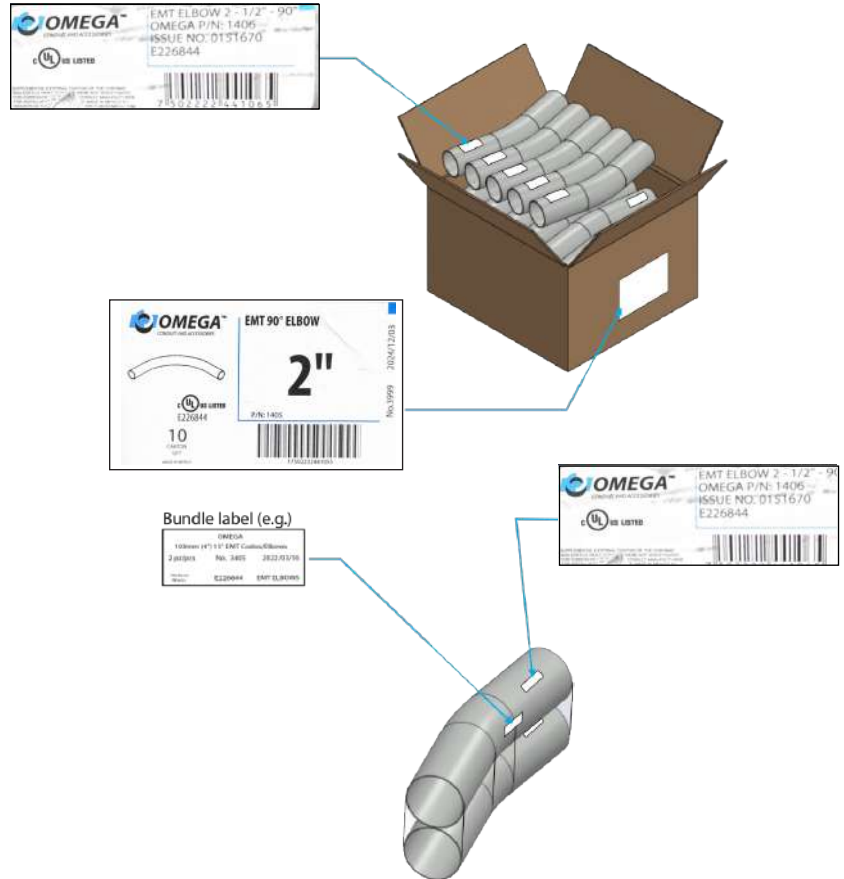

Elbows 2 1/2" to 4" are wrapped in plastic and labelled in accordance to UL 797

Boxed Elbows Pallet

Pallet content description sheet ■
Label with total pallet weight ■

Boxes are strapped to pallet and stretch wrapped
Wooden pallet treated for export

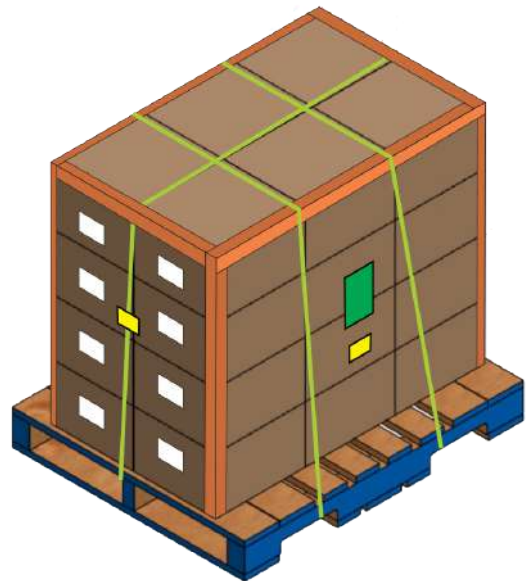

Wrapped Elbows Pallet

Pallet content description sheet ■
Label with total pallet weight ■

Wrapped elbows are strapped to pallet and stretch wrapped
Wooden pallet treated for export

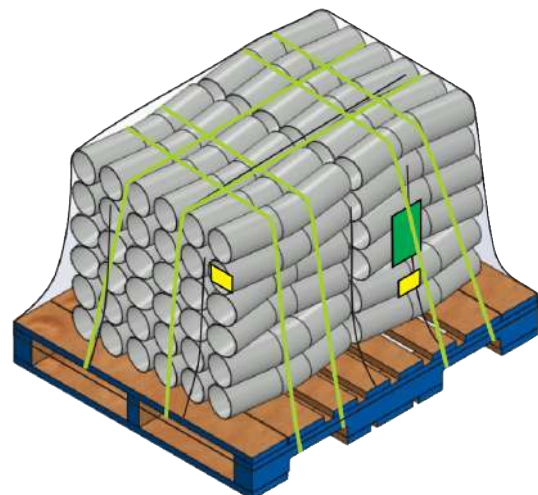

ARC ELBOWS

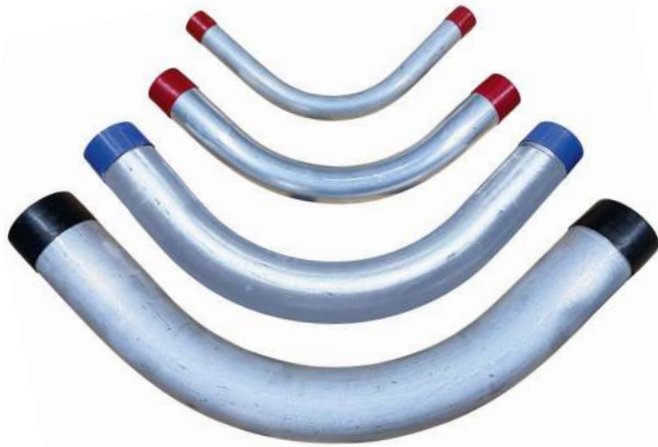

- Up to 1/3 the weight of RMC for easier handling, lifting, and installation, especially overhead and in long-run applications
- Naturally corrosion-resistant aluminum alloy, ideal for coastal, chemical, wastewater, utility, and industrial atmospheres
- Easily cut, threaded, and modified in the field, no specialized equipment required.
- Smooth mandrel-formed bends ensure fast, low-tension wire pulls with no sharp edges or binding points.
- Will not rust, stain, or oxidize internally, helping maintain conductor integrity and a clean appearance over the life of the installation.
- Available in all standard trade sizes and bend angles (45°, 90°).
- Compatible with all rigid aluminum conduit systems and standard threaded fittings.

ALUMINUM RIGID ELBOWS SPECIFICATIONS 45°

TRADE SIZE DESIGNATOR		APPROX. WT. PER 100 PCS.		AVERAGE DIMENSIONS				STANDARD PACKAGE
in.	mm.	lbs.	kg.	Radius (A)		Height (B)		Pcs.
				in.	mm.	in.	mm.	
1/2	16	29	13.2	4.00	101.6	1.89	48.00	100
3/4	21	43	14.5	4.50	114.3	2.13	54.10	50
1	27	71	32.2	5.75	146.1	2.28	57.91	30
1 1/4	35	110	49.9	7.25	184.2	2.76	70.10	25
1 1/2	41	153	69.4	8.25	209.6	3.27	57.91	25
2	53	249	112.9	9.50	241.3	3.94	100.07	15
2 1/2	63	437	198.2	10.50	266.7	4.53	115.06	20
3	78	767	347.9	13.00	330.2	5.91	150.11	15
3 1/2	91	1036	469.9	15.00	381.0	7.09	180.08	12
4	103	1228	557.0	16.00	406.4	7.87	199.90	12
5	129	2490	1129.5	24.00	609.6	8.13	206.50	8
6	155	3850	1746.3	30.00	762.0	13.25	336.55	6

90°

TRADE SIZE DESIGNATOR		APPROX. WT. PER 100 PCS.		AVERAGE DIMENSIONS						STANDARD PACKAGE
in.	mm.	lbs.	kg.	Radius (A)		Height (B)		Tangent (C)		Pcs.
				in.	mm.	in.	mm.	in.	mm.	
1/2	16	29	13.2	4.00	101.6	6.19	157.20	2.19	55.6	100
3/4	21	43	14.5	4.50	114.3	6.75	171.50	2.25	57.2	50
1	27	71	32.2	5.75	146.1	8.63	219.20	2.88	73.2	30
1 1/4	35	110	49.9	7.25	184.2	10.06	255.50	2.81	71.4	25
1 1/2	41	153	69.4	8.25	209.6	11.56	293.60	3.31	84.1	25
2	53	249	112.9	9.50	241.3	14.06	357.10	4.56	115.8	15
2 1/2	63	437	198.2	10.50	266.7	16.00	406.40	5.50	139.7	20
3	78	767	347.9	13.00	330.2	18.81	477.80	5.81	147.6	15
3 1/2	91	1036	469.9	15.00	381.0	22.19	563.60	7.19	182.6	12
4	103	1228	557.0	16.00	406.4	23.94	608.10	7.94	201.7	12
5	129	2490	1129.5	24.00	609.6	36.13	917.70	12.13	308.1	8
6	155	3850	1746.3	30.00	762.0	41.94	1065.30	11.94	303.3	6

GRC ELBOWS

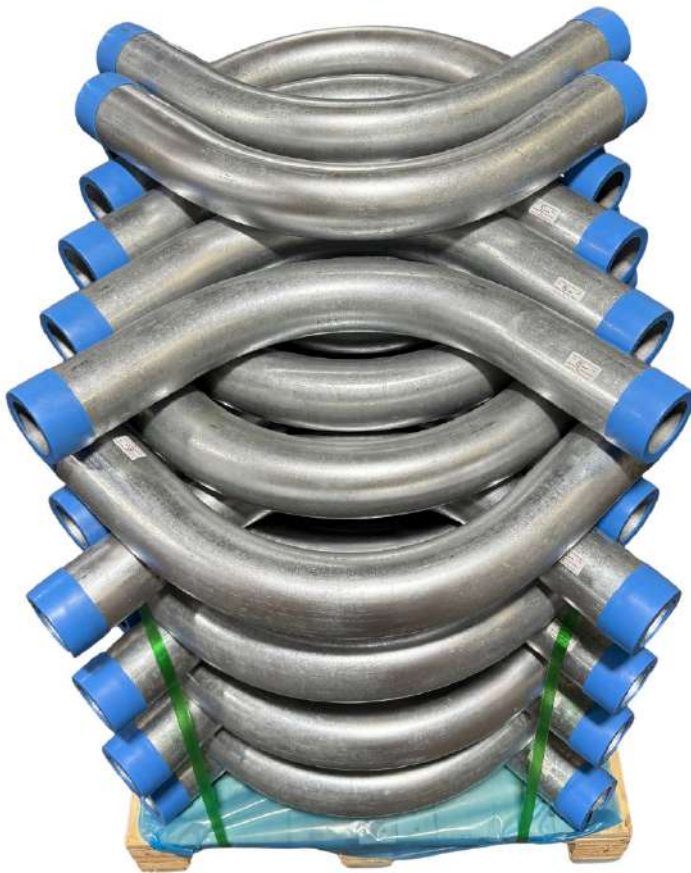

Heavy-Duty Rigid Metal Protection

- Manufactured from Schedule-40 hot-dipped galvanized steel for maximum strength and long-term performance in demanding environments
- Galvanized inside and out + organic top-coat for industry-leading corrosion protection and resistance against white rust
- Precision mandrel-bent for perfect radius integrity and uniform wall thickness, ensuring fast, snag-free wire pulls
- Standard threading compatibility for seamless fit with all rigid conduit systems and couplings
- Ideal for commercial, industrial, utility, manufacturing, data center, and infrastructure projects
- Available in all standard trade sizes and bends **(15°, 22.5°, 30°, 45°, 90°)**
- Custom angles and lengths available upon request to match unique routing and retrofit applications
- Sweep elbows stocked — **long-radius sweeps** reduce pulling friction, minimize conductor stress, and simplify long-distance wire runs (critical for fiber/data/utility installations)

GALVANIZED STEEL LARGE RADIUS RIGID ELBOWS SPECIFICATIONS

90°

TRADE SIZE	24"		36"		48"	
	Part Number	lbs	Part Number	lbs	Part Number	lbs
2	2" x 90 x 24"	17	2" x 90 x 36"	22	2" x 90 x 48"	29
3	3" x 90 x 24"	35	3" x 90 x 36"	46	3" x 90 x 48"	59
4	4" x 90 x 24"	49	4" x 90 x 36"	65	4" x 90 x 48"	84
5	5" x 90 x 24"	-	5" x 90 x 36"	87	5" x 90 x 48"	112
6	6" x 90 x 24"	-	6" x 90 x 36"	21	6" x 90 x 48"	156

GALVANIZED STEEL RIGID ELBOWS SPECIFICATIONS

15°

TRADE SIZE in.	STANDARD PACKAGE
1/2	50
3/4	50
1	25
1 1/4	20
1 1/2	15
2	10
2 1/2	100
3	100
3 1/2	50
4	50
5	40
6	30

22.5°

TRADE SIZE in.	STANDARD PACKAGE
1/2	50
3/4	50
1	25
1 1/4	20
1 1/2	15
2	10
2 1/2	100
3	100
3 1/2	50
4	50
5	40
6	30

30°

TRADE SIZE in.	STANDARD PACKAGE
1/2	50
3/4	50
1	25
1 1/4	20
1 1/2	15
2	10
2 1/2	100
3	100
3 1/2	50
4	50
5	40
6	30

45°

TRADE SIZE in.	UL MIN. RADIUS (A)	UL MIN. STRAIGHT END (B)	STANDARD PACKAGE
1/2	4	2.875	50
3/4	4.5	2.875	50
1	5.75	3	25
1 1/4	7.25	3.25	20
1 1/2	8.25	3.625	15
2	9.5	4.1875	10
2 1/2	10.5	5.25	100
3	13	5.8125	100
3 1/2	15	6.75	50
4	16	6.9375	50
5	24	8.125	40
6	30	13.25	30

90°

TRADE SIZE in.	UL MIN. RADIUS (A)	UL MIN. STRAIGHT END (B)	OFFSET (C)	STANDARD PACKAGE
1/2	4	2.875	6.343	50
3/4	4.5	2.875	6.781	50
1	5.75	3	8.901	25
1 1/4	7.25	3.25	10.25	20
1 1/2	8.25	3.625	11.937	15
2	9.5	4.1875	14.031	10
2 1/2	10.5	5.25	16	100
3	13	5.8125	18.947	70
3 1/2	15	6.75	22.218	50
4	16	6.9375	23.437	40
5	24	11.125	36.156	30
6	30	12.4375	41.46	28

THREADED GALVANIZED AND ALUMINUM COUPLINGS



- Manufactured to ANSI/UL standards for guaranteed compatibility with all rigid conduit, elbows, and nipples.
- OEM-grade, not aftermarket: sourced from the same manufacturer used by major North American rigid conduit producers, delivering the same fit, finish, and reliability contractors expect from factory-installed couplings.
- Precision NPT threads ensure tight metal-to-metal continuity and maintain grounding/bonding integrity across the raceway.
- Electro-plated galvanized steel inside and out for maximum corrosion resistance in industrial, utility, coastal, and outdoor environments.
- Smooth interior bore and lead-in threads support fast wire pulls with minimal friction and insulation wear.
- Extra-deep thread engagement for maximum mechanical strength during torquing and installation.

RIGID COUPLINGS SPECIFICATIONS

TRADE SIZE DESIGNATOR		APPROX. WT. PER 100 FT. (30.5M)		NOMINAL OUTSIDE DIAMETER		LENGTH		STANDARD PACKAGE
in.	mm.	lbs.	kg.	in.	mm.	in.	mm.	mm.
1/2	16	9.0	4.08	1.63	41.4	1.563	39.70	100
3/4	21	20.0	9.07	1.64	41.7	1.625	41.28	50
1	27	30.0	13.60	1.97	50.0	2.000	50.80	30
1 1/4	35	40.0	18.14	2.03	51.6	2.063	52.40	20
1 1/2	41	56.0	25.40	2.06	52.3	2.063	52.40	20
2	53	60.0	27.21	2.13	54.1	2.125	53.94	20
2 1/2	63	200.0	90.71	2.19	55.6	3.125	79.38	10
3	78	225.0	102.05	3.31	84.1	3.250	82.55	16
3 1/2	91	375.0	170.09	3.41	86.6	3.375	85.73	16
4	103	325.0	147.41	3.52	89.4	3.500	88.90	10
5	129	550.0	249.47	3.95	100.3	3.750	96.25	6
6	155	400.0	181.43	4.25	108.8	4.000	101.60	6

ALUMINUM COUPLINGS SPECIFICATIONS

TRADE SIZE DESIGNATOR		APPROX. WT. PER 100 FT. (30.5M)		NOMINAL OUTSIDE DIAMETER		LENGTH		STANDARD PACKAGE
in.	mm.	lbs.	kg.	in.	mm.	in.	mm.	mm.
1/2	16	6.1	2.8	1.08	27.4	1.560	39.60	100
3/4	21	9.1	4.1	1.33	33.8	1.620	41.10	50
1	27	12.5	5.7	1.56	39.6	2.000	50.80	30
1 1/4	35	18.9	8.6	1.95	49.5	2.060	52.30	25
1 1/2	41	23.3	10.6	2.22	56.4	2.060	52.30	25
2	53	34.6	15.7	2.75	69.8	2.120	53.80	15
2 1/2	63	68.3	31.0	3.28	83.3	3.120	79.20	20
3	78	91.4	41.5	3.94	100.8	3.250	82.60	15
3 1/2	91	108.0	49.0	4.44	112.8	3.370	85.60	12
4	103	142.0	64.4	5.00	127.0	3.500	88.90	12
5	129	241.9	109.7	6.30	160.0	3.750	96.30	8
6	155	321.0	145.6	7.39	187.7	4.000	101.60	6

GALVANIZED RIGID NIPPLES

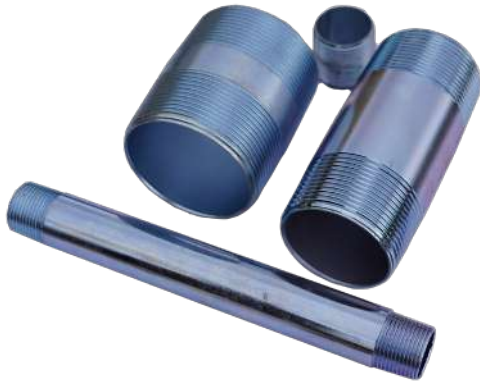

- Meets ANSI/UL specifications for guaranteed compatibility with rigid conduit, elbows, and couplings
- Available in all standard trade sizes and lengths, including close, short, and extended nipples, with custom lengths available upon request.
- Used to extend conduit runs and create secure transitions between fittings, boxes, enclosures, panels, and threaded openings
- Ideal for box-to-box connections, enclosure penetrations, tight-clearance areas, and locations where installing full conduit lengths is not practical
- Precision machined NPT threads ensure tight mechanical engagement and consistent grounding/bonding continuity across the raceway
- Smooth interior bore and thread lead-in support fast, low-friction wire pulls and reduce insulation wear.
- **Linear Solutions can manufacture any custom length nipple up to 120" in house.**

GALVANIZED STEEL NIPPLES SPECIFICATIONS

1/2"		3/4"		1"		1 1/4"		1-1/2"		2"	
TRADE SIZE	STD PKG	TRADE SIZE	STD PKG	TRADE SIZE	STD PKG	TRADE SIZE	STD PKG	TRADE SIZE	STD PKG	TRADE SIZE	STD PKG
in.		in.		in.		in.		in.		in.	
Close	25	Close	25	Close	25	Close	25	Close	25	Close	25
1 1/2	25	1 1/2	24	2	24	2	25	2	25	2 1/2	25
2	25	2	25	2 1/2	25	2 1/2	25	2 1/2	25	3	25
2 1/2	25	2 1/2	25	3	25	3	25	3	25	3 1/2	25
3	25	3	25	3 1/2	25	3 1/2	25	3 1/2	25	4	25
3 1/2	25	3 1/2	25	4	25	4	25	4	25	5	25
4	25	4	25	5	25	5	25	5	25	6	25
5	25	5	25	6	25	6	25	6	25	8	10
6	25	6	25	8	25	8	25	8	25	10	12
7	25	7	25	10	25	10	25	10	20	12	10
8	25	8	25	12	25	12	25	12	20	18	1
9	25	9	25	18	1	18	1	18	1	24	1
10	25	10	25	24	1	24	1	24	1		
12	25	12	25								
18	1	18	1								
24	1	24	1								

2-1/2"		3"		3-1/2"		4"		5"		6"	
TRADE SIZE	STD PKG	TRADE SIZE	STD PKG	TRADE SIZE	STD PKG	TRADE SIZE	STD PKG	TRADE SIZE	STD PKG	TRADE SIZE	STD PKG
in.		in.		in.		in.		in.		in.	
Close	10	Close	1	Close	10	Close	10	Close	5	Close	1
3	10	3	1	4	5	4	6	5	1	5	1
3 1/2	10	3 1/2	1	5	10	5	6	6	1	6	1
4	10	4	1	6	5	6	5	8	1	8	1
5	10	5	1	8	5	8	3	10	1	10	1
6	10	6	1	10	5	10	3	12	1	12	1
8	10	8	5	12	5	12	3				
10	5	10	10	18	1	18	1				
12	5	12	5	24	1	24	1				
18	1	18	1								
24	1	24	1								

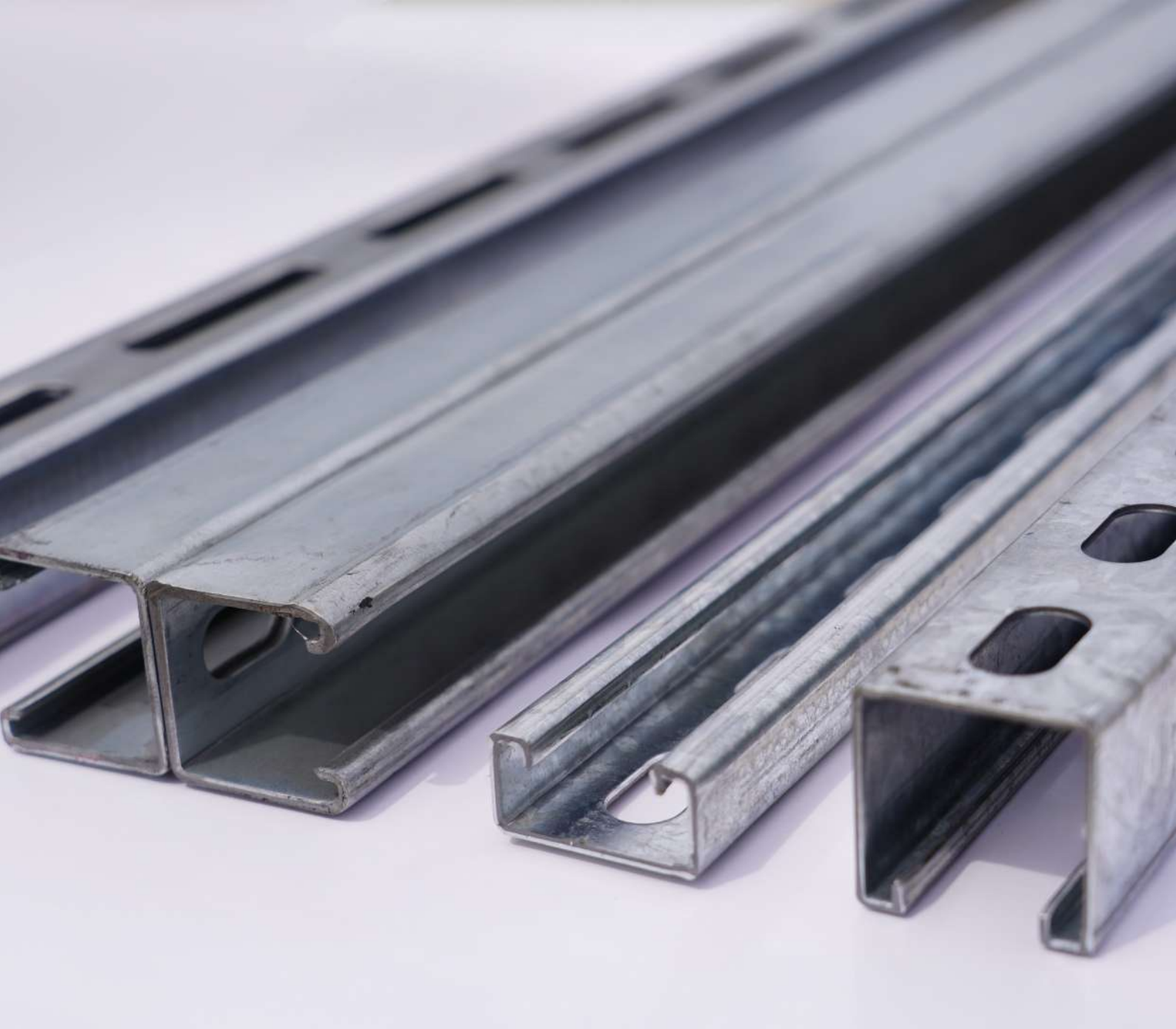

CONDUIT SUPPORT PRODUCTS

Comprehensive range of support components engineered for electrical raceway systems. Includes strut, and accessories designed to provide structural stability and proper conduit alignment. Manufactured from high-quality materials for maximum load capacity, corrosion resistance, and long-term performance in commercial and industrial installations.

THREADED RODS



Manufactured from low-carbon steel per SAE J403 for reliable strength and ductility across commercial and industrial installations. Meets ASME B18.31.3 material and mechanical property requirements for predictable load performance and inspection compliance. Rolled threads conform to ASME B1.1 — ensuring precise fit with nuts and hardware and maximizing thread strength vs. cut-thread imports.

Electro-galvanized (ASTM B633 compliant) finish provides proven corrosion resistance for indoor and light outdoor applications.

Job-ready packaging: stretch-wrapped bundles packed inside heavy cardboard tubes to protect threads during transport and handling.

- Color-coded end caps provide fast size identification on job sites and in warehouse pick locations.
- Available in all common diameters and lengths, including **6' and 10' standard lengths** (custom cutting available upon request).
- ASTM A153 hot-dip galvanized threaded rod available for harsh outdoor/corrosive environments.
- Stainless steel threaded rod (304/316) available for specialty applications.
- **Threaded rod demand is spiking due to critical need for supporting high-density cable trays as DATA CENTERS expand server capacity.**



THREADED ROD SPECIFICATIONS

COLOR CODED CAPS	DESCRIPTION	LENGTH	WEIGHT PER PIECE	PIECES PER TUBE	WEIGHT PER TUBE	TUBES PER MASTER BUNDLE	WEIGHT PER MASTER BUNDLE	RODS PER MASTER BUNDLE
		ft.	lb.	pcs.	lb.	pcs.	lb.	pcs.
Yellow	1/4"-20 Threaded Rod	6	0.73	50	38.52	38	1.464	1.900
		10	1.22	50	64.40	28	1.803	1.400
Blue	5/16"-18 Threaded Rod	6	1.18	35	43.44	38	1.651	1.330
		10	1.98	35	72.56	28	2.032	980
Green	3/8"-16 Threaded Rod	6	1.74	25	45.71	38	1.737	950
		10	2.91	25	77.76	28	2.177	700
Red	1/2"-13 Threaded Rod	6	3.15	12	39.73	38	1.510	456
		10	5.24	12	67.44	28	1.888	336
Blue	5/8"-11 Threaded Rod	6	4.91	8	41.36	38	1.572	304
		10	8.20	8	69.06	28	1.933	224

STRUT

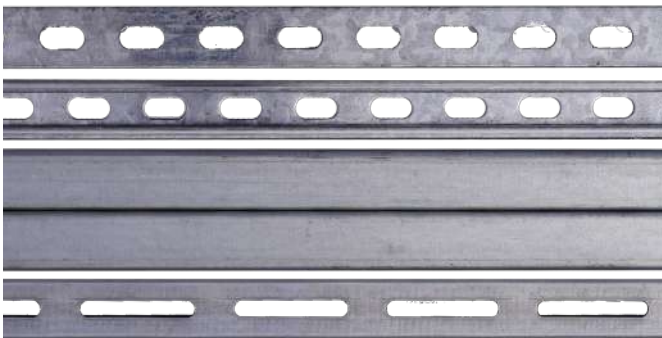

- Cold-formed from high-quality low-carbon steel for consistent strength and dimensional accuracy in support systems.
- Pre-galvanized per ASTM A653 for proven corrosion resistance in commercial and industrial environments.
- Available in multiple gauges to match load requirements:
 - 12 Ga (2.7 mm) for heavy duty applications
 - 14 Ga (1.9 mm)
- Wide range of profiles and configurations stocked, including:
 - Solid (no holes)
 - Slotted (short oval or 3" long slot)
 - Back-to-Back (ideal for added load capacity and long spans)
- Stainless Steel strut for harsh/corrosive environments (if applicable)
- **Standard lengths in 10' and 20'**; custom cutting and bundling available upon request.
- Engineered for universal compatibility with standard strut nuts, brackets, fasteners, and fittings used across electrical, mechanical, HVAC, and solar applications.
- Hot-dip galvanized (ASTM A123) available for outdoor/utility/saltwater environments.
- Powder-coated strut available in **custom colors** for OEM, solar, and architectural installations.

STRUT SPECIFICATIONS

	CHANNEL DIMENSIONS	SLOT DIMENSIONS		SPACE BETWEEN SLOT CENTERS	THICKNESS	LENGTH	APROX. WEIGHT PER PIECE		MASTER BUNDLE	MASTER BUNDLE WEIGHT	
		(A)	(B)								
	in.	in.	in.	(C) in.		ft.	Lbs.	Kg.	Pieces	Lbs.	Kg.
SLOTTED 3" x 7/16"	1-5/8"X1-5/8"	1-1/8" (28.57mm)	9/16" (14.28mm)	2" (50.8mm)	B-16 Ga.	10'	10.91	4.95	50	545.5	247.5
	1-5/8"X13/16"	1-1/8" (28.57mm)	9/16" (14.28mm)	2" (50.8mm)	B-16 Ga.	10'	7.63	3.46	50	381.5	173.0
	1-5/8"X1-5/8"	1-1/8" (28.57mm)	9/16" (14.28mm)	2" (50.8mm)	C-14 Ga.	10'	12.74	5.78	50	637.0	289.0
	1-5/8"X13/16"	1-1/8" (28.57mm)	9/16" (14.28mm)	2" (50.8mm)	C-14 Ga.	10'	8.82	4.00	50	441.0	200.0
	1-5/8"X1-5/8"	1-1/8" (28.57mm)	9/16" (14.28mm)	2" (50.8mm)	D-12 Ga.	10'	18.52	8.40	50	926.0	420.0
	1-5/8"X13/16"	1-1/8" (28.57mm)	9/16" (14.28mm)	2" (50.8mm)	D-12 Ga.	10'	12.83	5.82	50	641.5	291.0
	1-5/8"X1-5/8"	3" (76.20mm)	7/16" (11.11mm)	4" (101.6mm)	C-14 Ga.	10'	13.27	6.02	50	663.5	301.0
	1-5/8"X13/16"	3" (76.20mm)	7/16" (11.11mm)	4" (101.6mm)	C-14 Ga.	10'	8.59	3.90	50	429.9	195.0
	1-5/8"X1-5/8"	3" (76.20mm)	7/16" (11.11mm)	4" (101.6mm)	D-12 Ga.	10'	17.76	8.06	50	888.46	403.0
	1-5/8"X13/16"	1-1/8" (28.57mm)	7/16" (11.11mm)	4" (101.6mm)	D-12 Ga.	10'	12.69	5.76	50	634.5	288.0

SHORT OVAL HOLES



B-14 Ga.

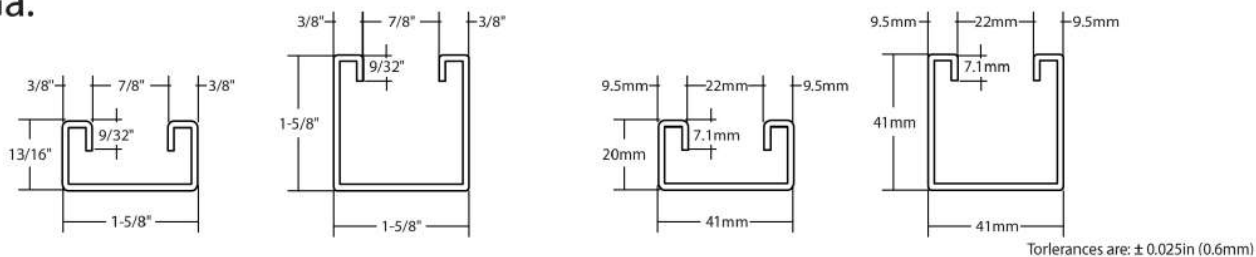

B-12 Ga.

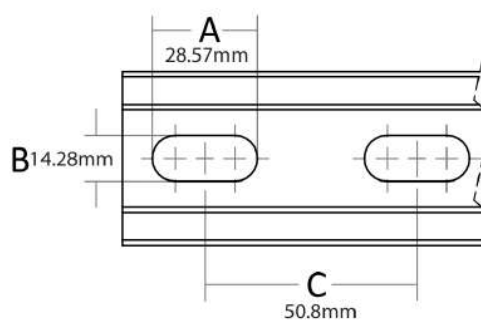
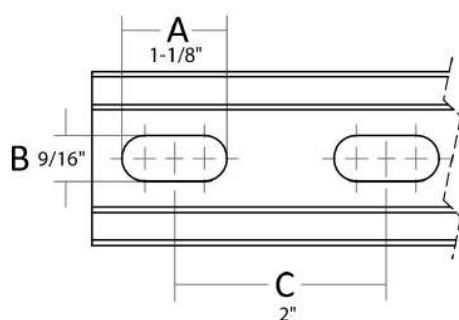
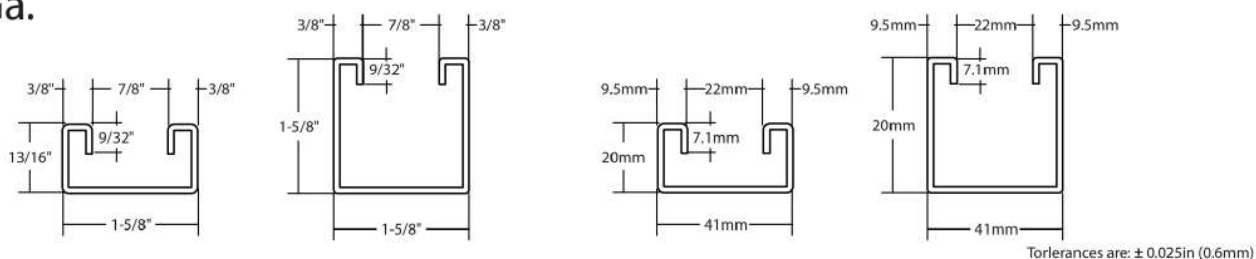

3" LONG SLOTS

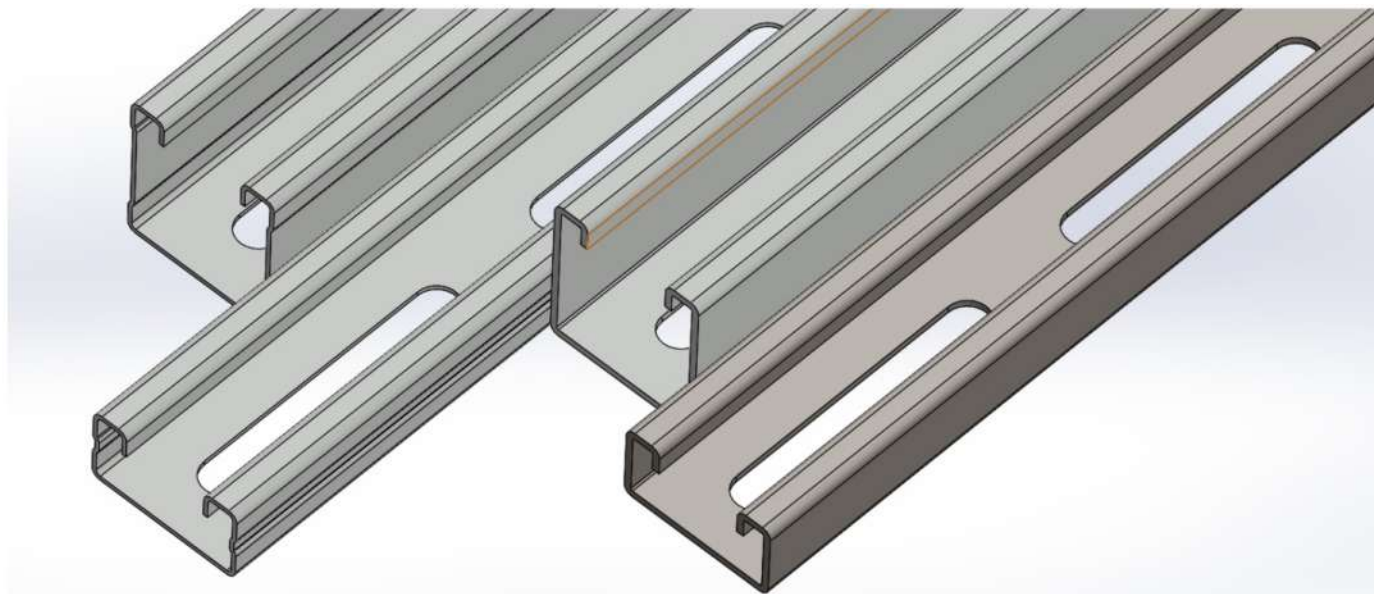

C-14 Ga.

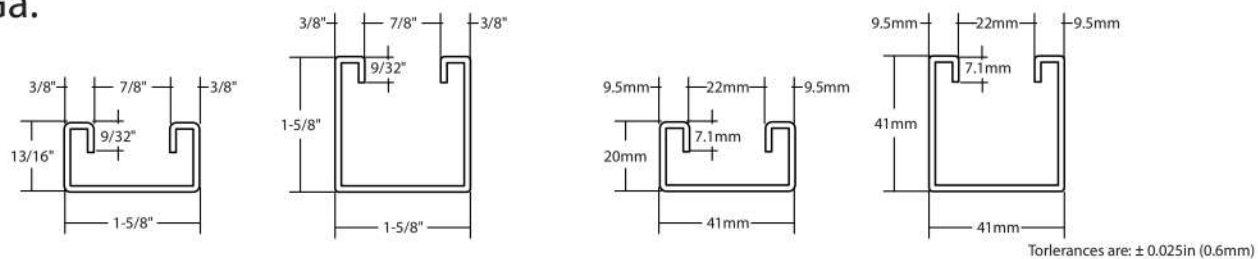

D-12 Ga.

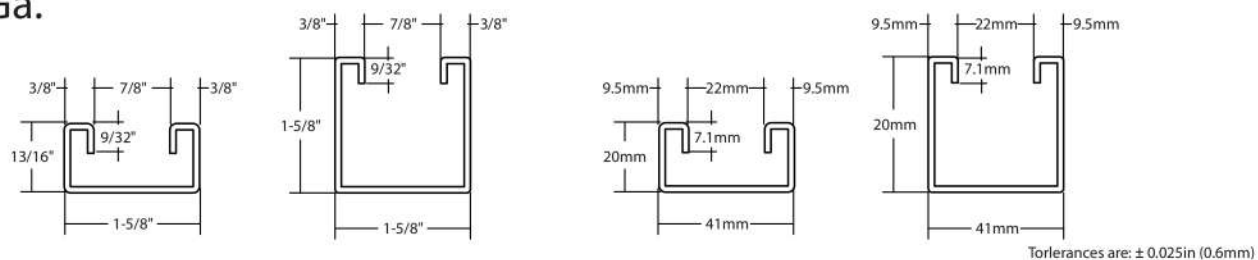

Slot dimensions

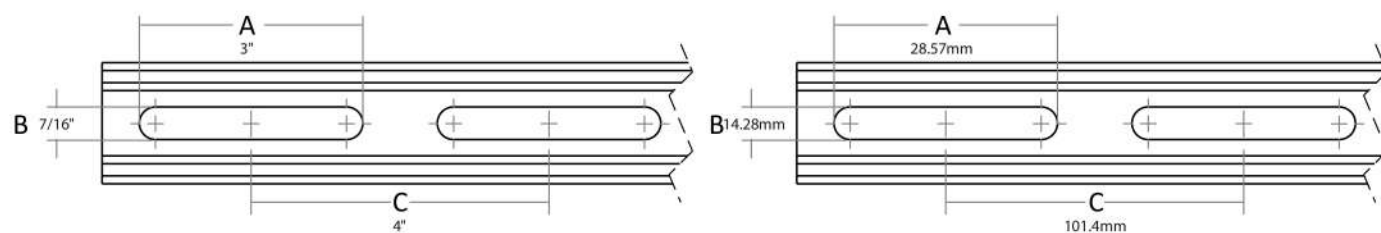

B tolerances are: $+0.000$ in (0.00mm), -0.030 in (0.76mm)



GROUND RODS

High performance wire and grounding solutions designed to ensure safe, efficient, and reliable electrical connections. Our product line includes ground rods engineered to meet UL standards. Manufactured for superior conductivity, corrosion resistance, and long term durability in both commercial and industrial applications.

COPPER PLATED GROUND RODS & GALVANIZED GROUND RODS



- Manufactured from high-strength steel cores for dependable driving strength and long-term service life in the earth
- Available in both Copper-Bonded and Hot-Dip Galvanized constructions to satisfy project specifications and budget requirements
- Copper-Bonded rods feature 99.9% pure copper electro-bonded coating **(254 μ m / 10 mil minimum)** — Per UL 467 the industry benchmark for maximum corrosion resistance and conductivity in all soil conditions
- Hot-Dip Galvanized rods deliver a cost-effective grounding solution with excellent corrosion resistance in normal and mildly aggressive environments
- Electrolytic copper bonding eliminates cracking, flaking, and delamination, unlike mechanically bonded or flash-plated imports
- Engineered for performance across all soil types including clay, sand, moisture-rich regions, rocky terrain, and high-salinity areas (copper-bonded recommended for extreme corrosion environments)
- Meets or exceeds NEC®, NEMA®, IEEE®, UL®, and ANSI requirements (can list exact standard numbers if preferred)
- Available diameters: 1/2", 5/8", and 3/4"
- Available lengths: **8 ft and 10 ft standard** (additional lengths and tapered tips available by request)
- Compatible with standard clamps, compression connectors, and exothermic welding systems to ensure secure electrical continuity
- Copper-Bonded & Hot-Dip Galvanized Ground Rods — **1/2", 5/8", 3/4" in 8' & 10' lengths**

GROUND ROD SPECIFICATIONS

SKU	TYPE	DIAMETER	LENGTH
12-8CCSGR	Copper	1/2 in.	8 feet
58-8CCSGR	Copper	5/8 in.	8 feet
58-10CCSGR	Copper	5/8 in.	10 feet
34-10CCSGR	Copper	3/4 in.	10 feet
58-8GSGR	Galvanized	5/8 in.	8 feet

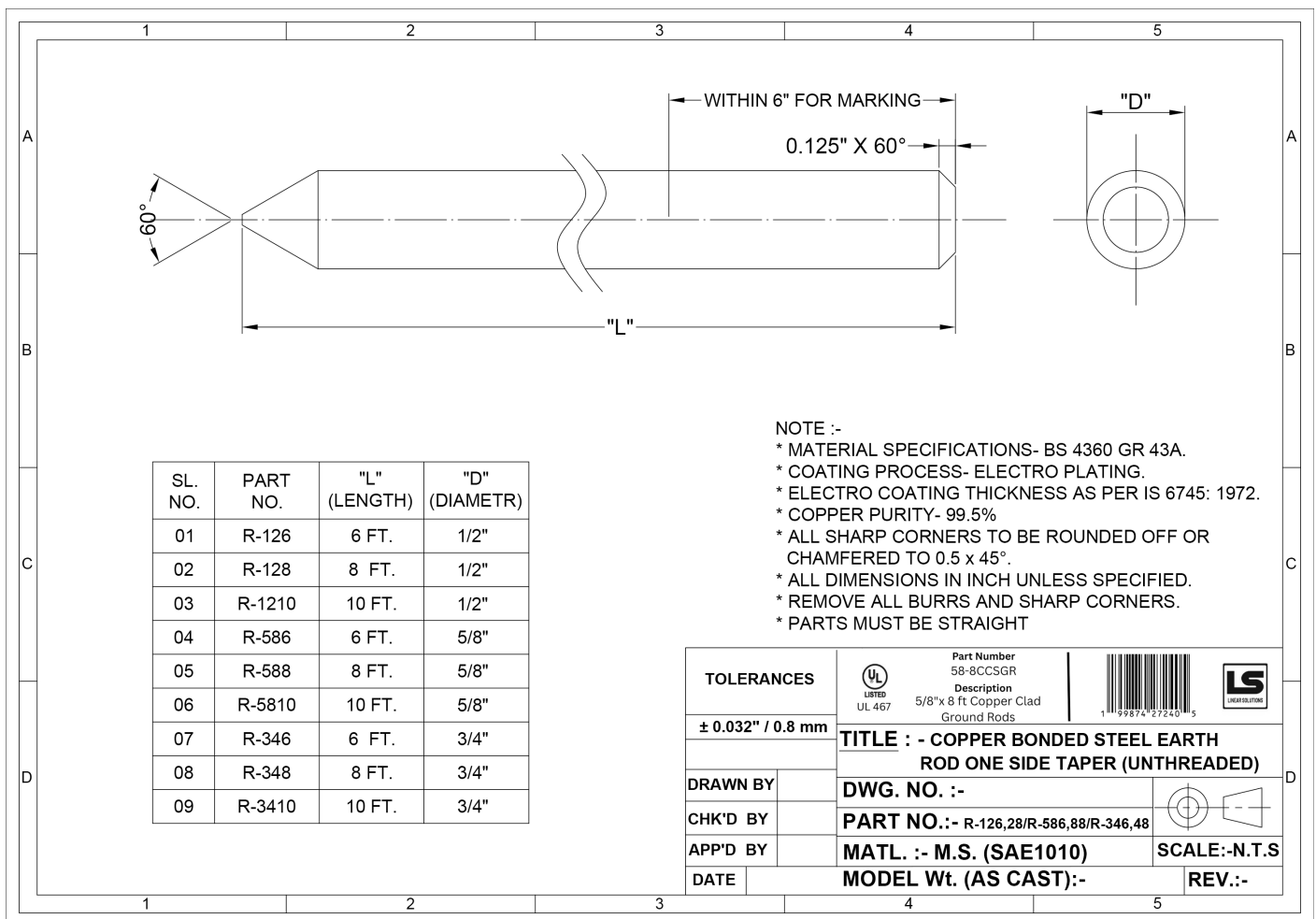
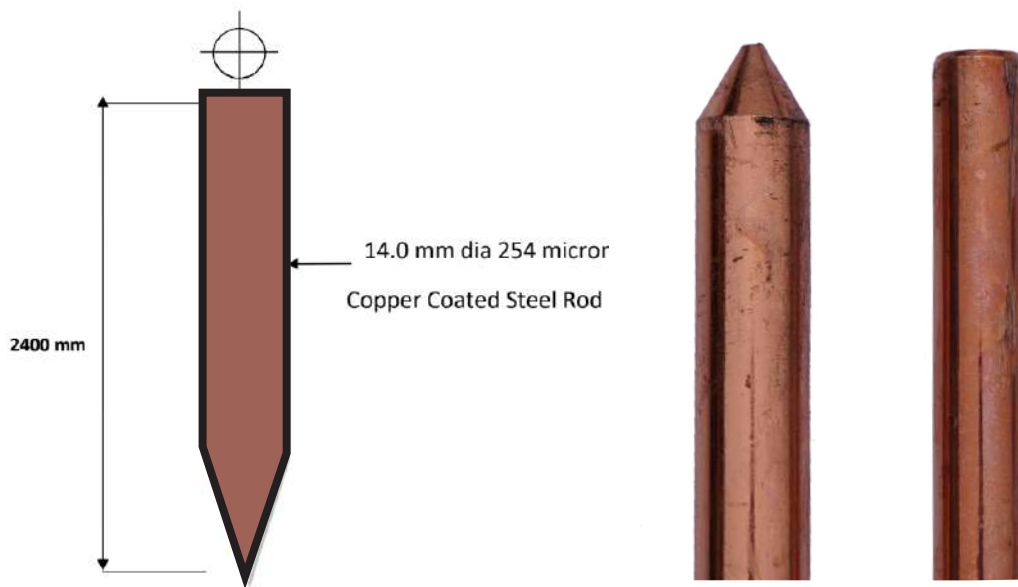



WIRE AND CABLE

Built to pull faster. Engineered to last longer. All Linear Solutions building wire features self-lubricated, low-friction jackets that reduce installation effort and eliminate the need for external pulling lubricants. Contractors get cleaner installs, less labor, and fewer chemical issues related to conduit and insulation compatibility. In addition to standard constructions, Linear Solutions offers custom cable builds driven by real distributor demand — including our Twisted Speed Pack pulling solution, engineered to deliver faster pulls and easier handling for high-volume jobs. Every product meets or exceeds UL, NEC, and ASTM requirements, ensuring accuracy in stranding, stripability, insulation, and long-term performance.

Key Advantages

- Dual-rated THHN / THWN-2 — approved for 90°C in both wet and dry locations for maximum installation flexibility and code compliance
- Ultra-low friction coefficient provides fast, snag-free pulls through long and complex conduit runs
- **Self-lubricating jacket formulation** — no pulling lubricant required, even on extended and tight-radius runs
- Abrasion-resistant and mechanical impact resistant for harsh commercial and industrial applications
- Flame-retardant PVC insulation with nylon jacket for long-term durability and mechanical toughness

Applications:

- Designed for general wiring in commercial, industrial, institutional, and infrastructure installations, including:
- Public buildings, Hotels, Warehouses
- Manufacturing & chemical plants
- Petrochemical facilities, Utility & municipal facilities

Performance Features:

- Resistant to: heat, humidity, solvents, oils (PR I & PR II), gasoline (GR I & GR II), grease & chemical agents
- Maintains jacket integrity during high-temperature pulls and terminations
- Suitable for wet and dry environments

Packaging & Availability

- 14 & 12 AWG: 4 × 500 ft spools per carton (2,000 ft/carton)
- 10 AWG: 2 × 500 ft spools per carton

Color Options:

- Black, Red, Blue, White, Green, Yellow, Brown, Orange, Violet, Pink, Grey

Standards & References:

- ASTM: B3, B8, B787 (19-Wire Combination Unilay-Stranded)
- UL: 83 and 1063
- NOM-ANCE
- VW-1: 14 AWG through 1 AWG
- Sunlight Resistant: 8 AWG and larger
- CT Rated: 1/0 AWG and larger
- National Electrical Code (NEC), NFPA 70 compliant
- FT1: All sizes
- MTW: Stranded constructions only
- TWN 75 / T90

Technical Data:

- Maximum Operating Voltage: 600 V
- Maximum Operating Temperature:
 - 90°C (194°F) dry
 - 90°C (194°F) moist and wet
- Manufacturing Range:
 - Solid: 14 AWG to 10 AWG
 - Stranded: 14 AWG to 1000 kcmil

Put-Ups:

- **500 ft, 1,000 ft, 2,500 ft, 5,000 ft reels**
- Custom cuts may be available upon special request

THHN / THWN-2 COPPER WIRE SPECIFICATIONS

CONDUCTOR		INSULATION THICKNESS	JACKET THICKNESS	NOMINAL O.D.	APPROX. NET. WEIGHT PER 1000'	ALLOWABLE AMPACITIES			STANDARD PACKAGE
Size AWG/kcmil	No. of Strands	mils	mils	mils	lbs.	60°C	75°C	90°C	
14	1	15	102	4	15	15	15	15	AC
12	1	15	119	4	23	20	20	20	AC
10	1	20	150	4	36	30	30	30	AC
14	19	15	109	4	16	15	15	15	AC
12	19	15	128	4	24	20	20	20	AC
10	19	20	161	4	38	30	30	30	AC
8	19	30	213	5	63	40	50	55	AC
6	19	30	249	5	95	55	65	75	ABCD
4	19	40	318	6	152	70	85	100	ABCD
3	19	40	436	6	189	85	100	115	ABCD
2	19	40	378	6	234	95	115	130	ABCD
1	19	50	435	7	299	110	130	145	ABCD
1/0	19	50	474	7	372	125	150	170	ABCD
2/0	19	50	518	7	462	145	175	195	ABCD
3/0	19	50	568	7	575	165	200	225	ABCD
4/0	19	50	624	7	718	195	230	260	ABCD
250	37	60	694	8	851	215	255	290	ABCD
300	37	60	747	8	1112	240	285	320	ABC
350	37	60	797	8	1174	260	310	350	ABC
400	37	60	842	8	1334	280	335	380	ABC
500	37	60	926	8	1655	320	380	430	ABCD
600	61	70	1024	9	1987	350	420	475	ABC
750	61	70	1226	9	2464	400	475	535	BC
1000	61	70	1275	19	3257	455	545	1275	C



URD CABLE



TRIPLEX 600V SPECIFICATIONS

Electrical Data				
CODE WORD	PHASE CONDUCTOR SIZE	DC RESISTANCE @25°C	AMPACITY IN DUCT 90°C	AMPACITY DIRECTLY BURIED 90°C
	AWG/kcmil	Ω/1000ft	A	A
Erskine	6	0,666	70	95
Vassar	4	0,418	90	125
Stephens	2	0,263	120	165
Ramapo	2	0,263	120	165
Brenau	1/0	0,165	160	215
Bergen	1/0	0,165	160	215
Converse	2/0	0,131	180	245
Hunter	2/0	0,131	180	245
Hollins	3/0	0,104	205	280
Rockland	3/0	0,104	205	280
Sweetbriar	4/0	0,083	240	315
Monmouth	4/0	0,083	240	315
Pratt	250	0,069	265	345
Wesleyan	350	0,05	320	415
Holyoke	500	0,035	395	495
Rider	500	0,035	395	495

- Conductor: Strander compressed 1350-H16/H26 (3/4 Hard) aluminum
- Insulation: Cross Linked Polyethylene (XLPE)
- Neutral: Cross Linked Polyethylene (XLPE) with three Yellow Extruded Stripes (YES)

- **Applications:**

Secondary distribution and underground service at 600V, can be installed direct burial or in ducts.

- **Characteristics:**

UL854 – FILE E517138

ASTM B231 Standard Specification for Concentric-Lay-Stranded Aluminum 1350 Conductors

ASTM B609 Standard Specification for Aluminum 1350 Round Wire, Annealed and Intermediate Tempers, for Electrical Purposes

- **Performance:**

Sun Light Resistant

Single conductor are UL listed as type USE-2

- **Technical Data:**

Maximum operating voltage according to selection: 600 V

Preferred max. operating temp:

Dry and wet locations: 90°C

In emergency: 130°C

Short circuit: 250°C

Packaging: Wooden reels

Manufacturing range:

Aluminum: 6 AWG to 750 kcmil

Copper: 8 AWG to 750 kcmil

Standarts: UL 854, ASTM B231, ASTM B609

Dimensional Data											
CODE WORD	PHASE CONDUCTOR SIZE	QUANTITY OF WIRES	DIAMETER OVER PHASE CONDUCTOR	PHASE INSULATION THICKNESS	DIAMETER OVER PHASE INSULATION	NEUTRAL CONDUCTOR SIZE	QUANTITY OF WIRES - NEUTRAL	NEUTRAL INSULATIONS THICKNESS	DIAMETER OVER NEUTRAL INSULATION	APPROX. OVERALL DIAMETER	APPROX. WIGHT
	AWG/kcmil		mil	mil	mil	AWG/kcmil		mil	mil	mil	lb/1000ft
Erskine	6	7	178	60	298	6	7	60	298	645	134
Vassar	4	7	225	60	345	4	7	60	345	745	192
Stephens	2	7	283	60	403	4	7	60	403	870	250
Ramapo	2	7	283	60	403	2	7	60	403	870	277
Brenau	1/0	19	353	80	513	2	7	60	403	1106	388
Bergen	1/0	19	353	80	513	1/0	19	80	513	1106	442
Converse	2/0	19	396	80	556	1	19	80	473	1200	478
Hunter	2/0	19	443	80	603	2/0	19	80	555	1200	535
Hollins	3/0	19	443	80	603	3/0	19	80	512	1303	582
Rockland	3/0	19	500	80	660	2/0	19	80	603	1303	652
Sweetbriar	4/0	19	500	80	660	4/0	19	80	660	1422	710
Monmouth	4/0	19	541	80	701	3/0	19	80	603	1422	795
Pratt	250	37	642	80	802	4/0	19	80	660	1582	855
Wesleyan	350	37	642	95	832	4/0	19	80	660	1795	1106
Holyoke	500	37	790	95	980	300	37	95	785	2115	1545
Rider	500	37	790	95	980	350	37	95	832	2115	1594

XHHW ALUMINUM



- **Technical Data:**

Maximum operating voltage: 600V / 1000V
 Packaging: Wooden reels.
 Manufacturing Range: 6 AWG to 750 kcmil
 Preferred max. operating temp.:
 Dry locations: 90°C / 194°F
 Humid and wet locations: 90°C / 194°F
 In emergency: 130°C / 266°F
 Short circuit: 250°C / 482°F

- Aluminum alloy (8176) conductor.
- Cross Linked Polyethylene (XLPE) black color insulation, moisture resistant, high heat

- **Applications:**

Service Entrance
 Lighting and low voltage power systems
 Power Circuits
 Control Circuits
 Solar and Wind Farms
 Industrial Installations
 Public Buildings
 Recreational Buildings

- **Standards:**

ASTM – B800 and either B801
 UL 44

- **Performance:**

Cross Linked Polyethylene XLPE insulation
 Sun Light Resistant (Black Color)
 PRI and/or PRII – Oil resistant
 GRI and/or GRII – Gasoline resistant
 Wet or Dry locations not exceeding 90°C.
 Suitable for direct burial installation
 Horizontal flame resistant.

XHHW ALUMINUM SPECIFICATIONS

Technical Data					
SIZE	CROSS SECTION	CONDUCTOR DIAMETER	INSULATION THICKNESS XLPE	OVERALL DIAMETER	THEORATICAL WEIGHT
(AWG/kcm)	mm ²	inch	mil	inch	lb/kft
6	13.3	0.17	45	0.26	45.7
4	21.2	0.21	45	0.30	65.2
2	33.6	0.27	45	0.36	85.3
1/0	53.5	0.34	55	0.45	145.8
2/0	67.4	0.38	55	0.49	176.1
3/0	85	0.43	55	0.54	215.7
4/0	107	0.48	55	0.59	263.4
250	127	0.52	65	0.65	317.2
300	152	0.57	65	0.70	372.3
350	177	0.62	65	0.75	426.0
400	203	0.66	65	0.79	478.4
500	253	0.74	65	0.87	585.3
600	304	0.81	80	0.97	721.0
750	380	0.91	80	1.07	877.6
1000	507	1.06	80	1.22	1144.4

Note: The data shown in the table are for 8000 series conductors and are subject to manufacturing tolerances.

XHHW TRIPLEX



- **Maximum Voltage operation:**
600 volts. / 1000 volts.
- **Maximum operation temperature:**

Dry	Wet
90°C	90°C
Emergency	Short Circuit
130°C	250°C

- 3 triplexes conductors
- Compact stranded Aluminum alloy (8176) conductor.
- Cross Linked Polyethylene (XLPE) black, red and white color insulation, moisture resistant, high heat.
- **Applications:**
Lighting and low voltage power systems
Power Circuits
Control Circuits
Solar and Wind Power Farms
Industrial Installations
Public Buildings.
Recreational Buildings
- **Standards:**
ASTM – B800 and either B801
UL 44
NMX-J-451-ANCE
- **Performance:**
Cross Linked Polyethylene XLPE insulation
-40 °C
Sun Light Resistant (All colors available)
PRI and/or PRII
GRI and/or GRII
CT
FT4
Wet or Dry locations not exceeding 90°C.
Suitable for direct burial installation

XHHW TRIPLEX SPECIFICATIONS

Technical Data of Single Conductor								3plexed Conductors		
SIZE	CROSS SECTION	NO. CONDUCTORS	COLOR EACH PHASE	APPROX. CONDUCTOR DIAMETER		INSULATION THICKNESS XLPE		OVERALL DIAMETER		AMPACITY @90°C***
(AWG/kcm)	mm ²			mm	inch	mm	inch	mm	inch	A
6	13.3	3	RD/BK/WH	4.29	0.17	1.14	0.45	16.45	0.65	50
4	21.2	3	RD/BK/WH	5.41	0.21	1.14	0.45	19.24	0.76	75
2	33.6	3	RD/BK/WH	6.81	0.27	1.14	0.45	19.82	0.78	100
1/0	53.5	3	RD/BK/WH	8.55	0.34	1.40	0.55	24.75	0.97	135
2/0	67.4	3	RD/BK/WH	9.55	0.38	1.40	0.55	26.91	1.06	150
3/0	85	3	RD/BK/WH	10.8	0.43	1.40	0.55	29.62	1.17	175
4/0	107	3	RD/BK/WH	12.1	0.48	1.40	0.55	32.50	1.28	205
250	127	3	RD/BK/WH	13.2	0.52	1.65	0.65	35.99	1.42	230
300	152	3	RD/BK/WH	14.5	0.57	1.65	0.65	38.82	1.53	254
350	177	3	RD/BK/WH	15.7	0.62	1.65	0.65	41.42	1.63	280
400	203	3	RD/BK/WH	16.7	0.66	1.65	0.65	43.58	1.72	305
500	253	3	RD/BK/WH	18.7	0.74	1.65	0.65	47.95	1.89	350
600	304	3	RD/BK/WH	20.6	0.81	2.03	0.8	53.77	2.12	380
750	380	3	RD/BK/WH	23	0.91	2.03	0.8	58.97	2.32	435

*** - Based in NEC Table 310.16 for 3 conductors @30°C ambient temperature

RD= RED
BK= BLACK
WH= WHITE



Chicago's Fastest-Growing Companies

#2

LINEAR SOLUTIONS

5-YEAR GROWTH
2,482%



5-year growth: 2,482%

Company description: Electrical conduit, wire and materials supplier

2024 revenue: \$31.7 million

Local employees: 15

Total employees: 15

Headquarters: Griffith, Ind.

Year founded: 2018



Patrick Fay lost his engineering job in 2018, but instead of dwelling on down times, he decided to get to work. Fay launched Linear Solutions, an electrical metal conduit supplier, out of his Chicago apartment that same year. He made the company's first delivery himself, riding the Chicago Transit Authority's Orange Line to the Midway station to rent a truck and then driving to Merrillville, Ind., to hand off the order.

His goal for Linear Solutions was simple: turn enough profit to match his old salary, somewhere between \$100,000 and \$200,000. By his math, that would require \$1 million in annual revenue, and that's roughly what Linear Solutions achieved in its first full year of business.

Five years later, Fay's company is bringing in 30 times that original goal.

The growth came almost entirely through an organic scaling of the business, with Fay and his team signing new clients one by one. "I learned to start small," he said. "And now that I've started small, we just keep leveling up to medium. Then we're going to level up to big. Pretty soon, big corporations are going to be buying from us."

The Linear Solutions team is nimble — just 15 employees strong as of the end of 2024 — but Fay doesn't see that as an inhibitor. "That's what I love about this industry: It just takes hard work and grit," he said. "You usually can make it even if you're small."



LINEAR SOLUTIONS INC

HEADQUARTERS

149 S Colfax St., Griffith, IN 46319

+1 219 237 2399

www.linearsolutionsinc.com

orders@linearsolutionsinc.com

