

# **Meet Information**



## **LSU CROSS COUNTRY COLLEGIATE DIVISION**

**LSU Cross Country Invitational – College Division  
Saturday, September 15, 2018  
Highland Road Park - Baton Rouge, Louisiana**

**College Team Entries**

1. Entries are unlimited.
2. All entries **MUST** be done through [www.DirectAthletics.com](http://www.DirectAthletics.com) by the entry deadline. If you do not have an account, you should set up your account and roster before the entry deadline.
3. Entry Deadline is noon, Wednesday, September 12.
4. No Phone, Email or Faxed entries will be accepted.

**Individual Entries**

1. Enter online at [www.DirectAthletics.com](http://www.DirectAthletics.com) by the entry deadline. You will need an individual account; please set this up in advance of the entry deadline as it takes several days to process. NO PHONE or EMAIL entries will be accepted.
2. Entry deadline is noon, Wednesday, September 12.
2. A \$20 entry fee must be paid online with a credit card at the time of entry.
3. There will be no walk up entries on the day of the meet.

**Unattached College Student Entries**

1. Email Andrea Tepe at [tepeal@lsu.edu](mailto:tepeal@lsu.edu) before noon on Wednesday, September 12 to enter.
2. A \$5 entry fee will be collected at packet pickup with a student ID. An entry fee of \$20 will be charged if no student ID is shown. Online entry fees will not be refunded.

**Team Entry Fee**

The USTFCCCA Preferred Cross Country Entry Fee guidelines will be followed. The regular entry fee will be \$125 per team per gender and the preferred entry fee for USTFCCCA members will be \$75 per team per gender. You can check your current USTFCCCA membership status at <http://www.ustfccca.org/membership-status>. If you are not a member, you can contact [membership@ustfccca.org](mailto:membership@ustfccca.org) for access to your program's online account where you can pay your membership dues. Checks should be made out to: **LSU Athletic Department**. **Entry fees are to be paid at packet pickup.**

**Packet Pickup**

Available at the pavilion on Saturday between 6:30 AM and 8:30 AM. Team and college student entry fees are payable at this time. **There will be no walk up registration available.**

**Meet Site**

The Highland Road Park is located in Baton Rouge on Highland Road, approximately 8 miles south of the LSU Campus and approximately 4 miles from Interstate 10.

Course maps will be available at [www.LSUsports.net/meetinfo](http://www.LSUsports.net/meetinfo).

**Directions to Highland Road Park**

**Approaching on I-10 from the West:** Take the Siegen Lane exit, turning right onto Siegen Lane. Proceed approximately 2 miles to the intersection of Siegen and Highland Road. Turn left onto Highland Road, and proceed approximately ¼ mile. The park will be on the left at the intersection of Highland Road and Amiss Road.

**Approaching on I-10 from the East:** Take the Highland Road exit, then turn left back underneath the overpass. Turn right onto Highland Road, and proceed approximately 4 miles. The park will be on the right at the intersection of Highland Road and Amiss Road.

**From LSU:** Take Nicholson Drive South approximately ¼ mile. Turn left onto Burbank Drive, and proceed approximately 8 miles until it intersects with Highland Road. Turn right onto Highland Road, and proceed approximately ¼ miles. The park will be on the left at the intersection of Highland Road and Amiss Road.

**Tentative Schedule of Events**

College Women 3 mile	7:30 AM
College Men 4 mile	8:10 AM
High School Girls 3 mile	8:50 AM
College Awards Ceremony	9:00 AM
High School Boys 3 mile	9:25 AM
High School Awards Ceremony	10:00 AM

**Awards**

T-shirts will be presented to the top 15 individual finishers.  
The winning team members who did not finish in the top 15 also may receive a T-shirt.



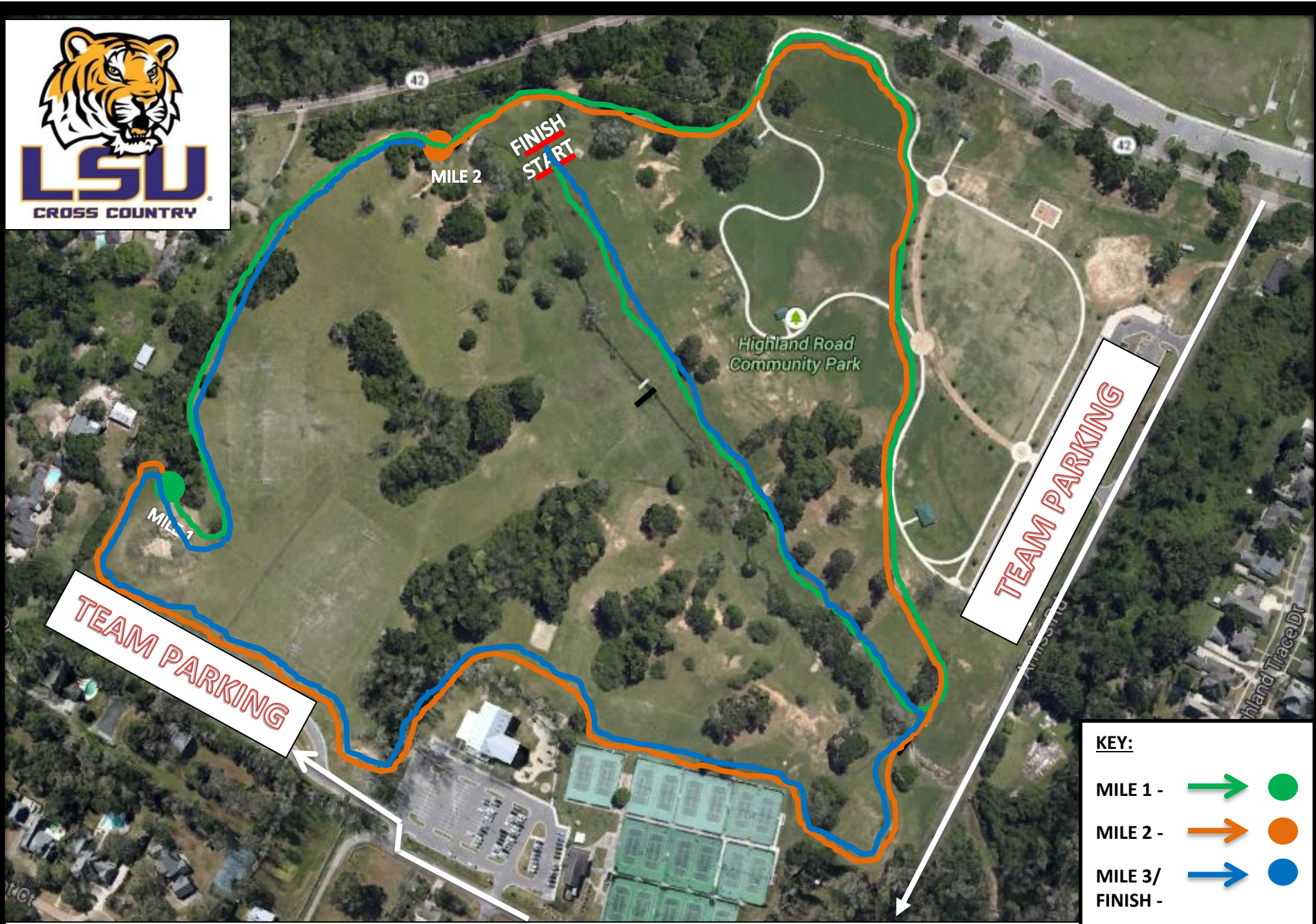

**Additional Information**

For further information, contact the LSU Track & Field Office at (225) 578-8627.





**KEY:**

- MILE 1 -  
- MILE 2 -  
- MILE 3/  
FINISH -  

**HIGHLAND ROAD PARK COLLEGE WOMEN 3 MILE COURSE**



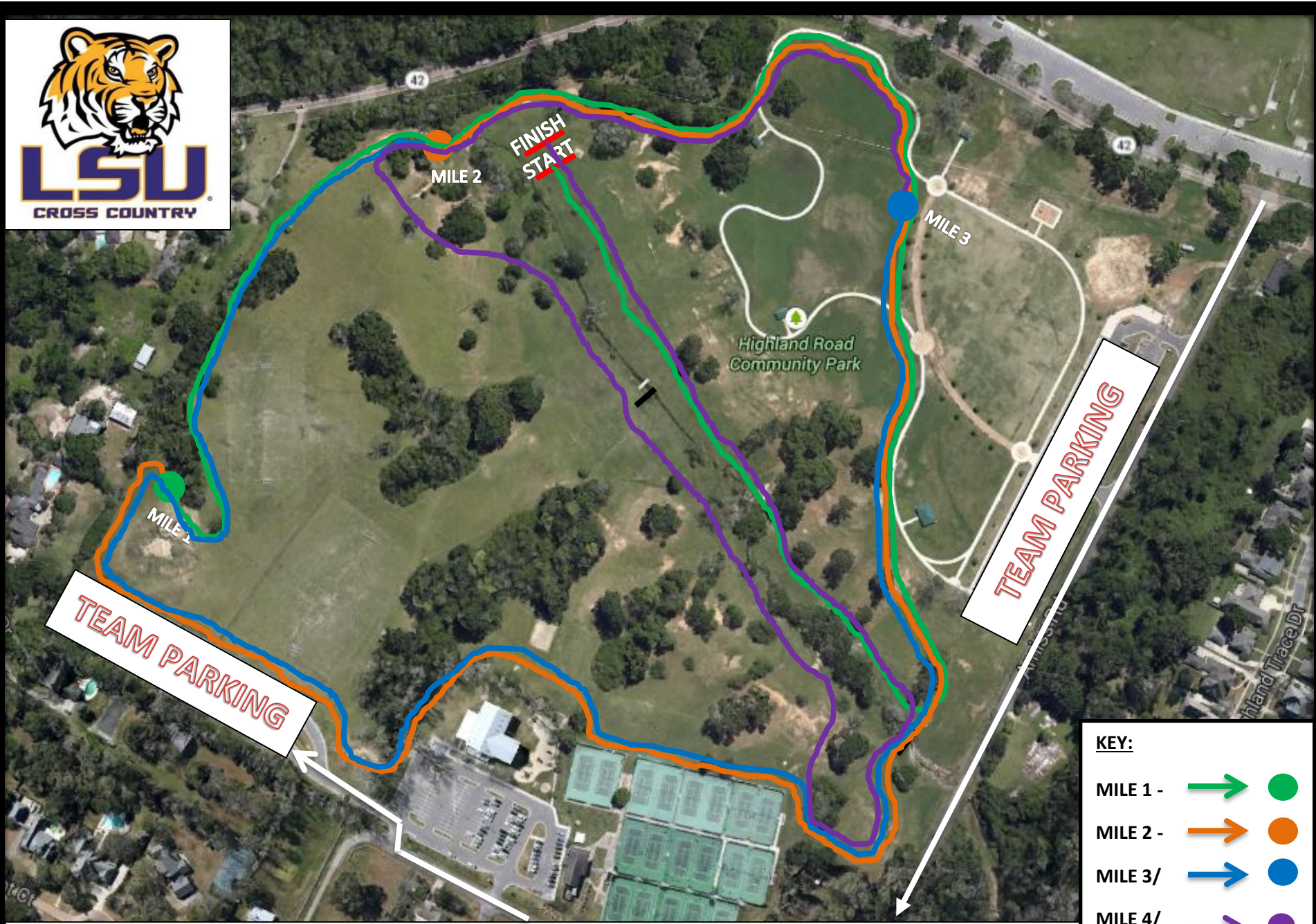

**KEY:**

MILE 1 -	→	●
MILE 2 -	→	●
MILE 3/	→	●
MILE 4/	→	●
FINISH-	→	●

**HIGHLAND ROAD PARK COLLEGE MEN 4 MILE COURSE**