

# TIGER SOFTBALL BY THE NUMBERS

## 1 WOMEN'S COLLEGE WORLD SERIES MOST OUTSTANDING PLAYER

Kristin Schmidt earned Women's College World Series Most Outstanding Player honors at the 2004 WCWS, making her the only player to not win the national championship and earn the honor.

## 2 WOMEN'S COLLEGE WORLD SERIES APPEARANCES

LSU is one of only three schools in SEC history with multiple Women's College World Series appearances and a winning record in WCWS play.

## 2 ACADEMIC ALL-AMERICANS

The Tigers have had two CoSIDA Academic All-Americans in the nine-year history of the program, while no program in the SEC has had more than three.

## 4 SEC TOURNAMENT TITLES

LSU has won an unprecedented four SEC Tournament titles and advanced to the championship game in six of the past seven seasons.

## 5 SEC CHAMPIONSHIPS

LSU claimed an unprecedented four consecutive league titles from 1999-2002. No other school in SEC history has claimed more than two overall titles.

## 5 SEC TOURNAMENT MVP'S

Five of the 10 SEC Tournament Most Valuable Player honors have been won by the Tigers, including an unprecedented five straight from 1999-2004.

## 7 SEC WESTERN DIVISION TITLES

LSU has won more Division titles than any school in the SEC, failing to win just three times in the program's history.

## 8 NCAA REGIONAL APPEARANCES

LSU made seven-straight NCAA Tournament appearances from 1998-2004, tying the Tigers for the most consecutive NCAA Tournament appearances in SEC history.

## 8 50-WIN SEASONS

LSU is one of only two programs in the nation to have posted eight 50-win seasons over the past nine years.

## 9 NFCA ALL-TIME RANKING

LSU ranks No. 9 in the NFCA All-time poll, the highest ranking of any team in the SEC. In addition, the Tigers are the youngest team ranked in the top 10.

## 10 ALL-AMERICANS

The Tigers have 10 NFCA All-Americans in the 10-year history of the program, the most of any school in SEC history.

## 53 WINS PER SEASON

LSU is averaging more than 53 wins a season over the past nine years, the second best average in the nation.

## 54 WEEKS RANKED IN THE ESPN/USA SOFTBALL POLL

The Tigers have been in the ESPN/USA Softball poll for 54 of the 63 weeks since its inception in 2003, while spending 24 weeks ranked in the Top 10.

## 119 WEEKS RANKED IN THE NFCA/USA TODAY POLL

LSU has been ranked in the NFCA/USA Today Coaches poll for 119 of the 140 weeks since the Tigers began play in 1997, including a span of 103 consecutive weeks between Feb. 20, 1998, and March 30, 2005. The Tigers have also been ranked in the Top 10 for 73 weeks.

## .789 WINNING PERCENTAGE

LSU has the fifth-best winning percentage in the nation over the last 10 seasons.

## .765 WINNING PERCENTAGE IN SEC GAMES

LSU has posted the best winning percentage of any school in the conference in league play.

## .732 WINNING PERCENTAGE IN THE SEC TOURNAMENT

LSU has the best winning percentage in SEC Tournament history by more than 20 percentage points.

## .636 WINNING PERCENTAGE IN THE NCAA TOURNAMENT

The Tigers have the fifth-best winning percentage in NCAA Tournament play.



# Contents

INTRO

THIS IS LSU

COACHES

TIGERS

REVIEW

HISTORY

RECORDS

LSU

MEDIA

## INTRODUCTION

- 1 Tiger Softball by the Numbers
- 2 Table of Contents
- 3 Quick Facts
- 4 The New Tiger Park
- 6 2007 Season Outlook
- 8 Roster/Roster Breakdown
- 9 Opponents



## THIS IS LSU

- 14 Campus Life
- 16 City of Baton Rouge
- 17 State of Louisiana
- 18 Academic Success
- 20 Cox Communications Academic Center
- 22 LSU Greats
- 24 Prominent Alumni
- 26 Athletic Training
- 27 Strength and Conditioning
- 28 Tiger Park



## COACHES

- 30 Head Coach Yvette Girouard
- 34 Assistant Coaches
- 35 Support Staff
- 36 2007 Diamond Backers



## MEET THE TIGERS

- 38 Quinlan Duhon
- 39 Tiffany Garcia
- 40 Dee Dee Henderson
- 41 Kristen Hobbs
- 42 Dani Hofer
- 43 Tayl'r Hollis
- 44 Leslie Klein

- 45 Killian Roessner
- 46 Erika Sluss
- 47 Andrea Smith
- 48 Vanessa Soto
- 49 Shannon Stein
- 50 Emily Turner
- 51 Lindsey Hope/Jazz Jackson/  
Rachel Mitchell
- 52 Cody Trahan/Stacey Woods



## 2006 SEASON REVIEW

- 54 2006 Season Review
- 56 2006 Game Results
- 57 2006 Final Statistics
- 58 2006 Game Superlatives
- 59 2006 Honors
- 60 2006 SEC Review
- 62 2006 SEC Rankings
- 63 2006 NCAA Rankings



## HISTORY

- 66 Postseason History
- 68 SEC Tournament Records
- 69 NCAA Tournament Records
- 70 All-Americans/Honor Roll
- 73 Letterwinners
- 74 Tiger Park



## RECORDS

- 76 Individual Game Records
- 77 Team Game Records
- 78 Individual Single-Season Records/  
Pitching Superlatives
- 80 Individual Career Records/  
Miscellaneous Records

- 82 Team Season Records
- 84 Yearly Leaders
- 86 Year-by-Year Results
- 90 All-Time Series Records/  
Coaching Records



## LSU

- 92 President William L. Jenkins
- 93 Chancellor Sean O'Keefe
- 94 Athletics Director Skip Bertman
- 95 Athletics Administration
- 96 LSU Athletics:  
A Championship Tradition
- 98 SEC Information



## MEDIA

- 100 Media Guidelines
- 101 LSU on the Air
- 102 Media List
- 103 LSUsports.net
- 104 Radio/TV Roster

## CREDITS

- EDITOR:** Melissa Foley
- LAYOUT & DESIGN:** Peter Hoang,  
Melissa Foley
- COVER DESIGN:** Peter Hoang
- PRODUCTION ASSISTANTS:** Jason Feirman,  
Krystal Bennett,  
Brandon Jantz
- PHOTOGRAPHY**  
Steve Franz  
Jim Zietz
- PRINTING**  
EBSCO Media - Birmingham, Ala.

*The LSU Softball Media Guide has been rated among the top seven collegiate softball publications in the nation for four of the past five seasons. The media guide was named fifth best in the nation in 2006 by the College Sports Information Directors of America (CoSIDA). The publication ranked third in 2004 and seventh in 2002.*



INTRO

THIS IS LSU

COACHES

TIGERS

REVIEW

HISTORY

RECORDS

LSU

MEDIA

## SOFTBALL STAFF

<b>HEAD COACH:</b>	Yvette Girouard
<b>ALMA MATER, YEAR:</b>	UL-Lafayette, 1976
<b>CAREER RECORD:</b>	1,067-339 (.759, 26 years)
<b>RECORD AT LSU:</b>	308-89 (.776, Six years)
<b>ASSOCIATE HEAD COACH:</b>	James DeFeo
<b>ALMA MATER, YEAR:</b>	Rutgers, 1996
<b>YEAR AT LSU:</b>	Sixth Year
<b>ASSISTANT COACH:</b>	Megan Smith
<b>ALMA MATER, YEAR:</b>	North Carolina, 1999
<b>YEAR AT LSU:</b>	First Year

## TEAM INFORMATION

<b>2006 RECORD:</b>	55-14
<b>2006 SEC RECORD:</b>	22-8 (Second-West)
<b>FINAL NFCA/USA TODAY RANKING:</b>	No. 11
<b>FINAL ESPN/USA SOFTBALL RANKING:</b>	No. 10
<b>STARTERS RETURNING/LOST:</b>	5/4
<b>PITCHERS RETURNING/LOST:</b>	3/1
<b>LETTERWINNERS RETURNING/LOST:</b>	12/7
<b>NEWCOMERS:</b>	6
<b>ALL-TIME RECORD:</b>	525-140 (.789, 10 years)
<b>ALL-TIME SEC RECORD:</b>	221-68 (.765, 10 years)
<b>SEC TITLES:</b>	5 (1999, 2000, 2001, 2002, 2004)
<b>SEC TOURNAMENT APPEARANCES:</b>	9
<b>ALL-TIME SEC TOURNAMENT RECORD:</b>	30-11 (.732)
<b>SEC TOURNAMENT TITLES:</b>	4 (1999, 2001, 2002, 2004)
<b>NCAA TOURNAMENT APPEARANCES:</b>	8
<b>NCAA TOURNAMENT RECORD:</b>	28-16 (.636)
<b>WCWS APPEARANCES:</b>	2 (2001, 2004)
<b>WCWS RECORD:</b>	5-4 (.556)

## UNIVERSITY

<b>LOCATION:</b>	Baton Rouge, La.
<b>FOUNDED:</b>	1860
<b>ENROLLMENT:</b>	29,317
<b>PRESIDENT:</b>	Dr. William L. Jenkins
<b>CHANCELLOR:</b>	Sean O'Keefe
<b>FACULTY REPRESENTATIVE:</b>	Dydia Delyser
<b>NICKNAME:</b>	Tigers or Fighting Tigers
<b>COLORS:</b>	Purple & Gold
<b>MASCOT:</b>	Mike V (live Bengal tiger)
<b>HOME FIELD:</b>	Tiger Park
<b>CAPACITY:</b>	1,000
<b>FIELD DIMENSIONS:</b>	L - 200, C - 220, R - 200
<b>CONFERENCE:</b>	Southeastern

## ATHLETICS DEPARTMENT

<b>ATHLETICS DIRECTOR:</b>	Stanley "Skip" Bertman
<b>SENIOR ASSOCIATE AD/OPERATIONS:</b>	Verge Ausberry
<b>SENIOR ASSOCIATE AD/SWA:</b>	Judy Southard
<b>SENIOR ASSOCIATE AD/EXTERNAL AFFAIRS:</b>	Herb Vincent
<b>ASSOCIATE AD/INTERNAL RELATIONS:</b>	Bo Bahnsen
<b>ASSOCIATE AD/BUSINESS:</b>	Mark Ewing
<b>ASSOCIATE AD/COMPLIANCE:</b>	Chris Howard
<b>ASSISTANT AD/OPERATIONS:</b>	Eddie Nunez
<b>ASSISTANT AD/STUDENT SERVICES:</b>	Miriam Segar

## SPORTS INFORMATION

<b>ASSISTANT AD/SID:</b>	Michael Bonnette
<b>SENIOR ASSOCIATE SID:</b>	Kent Lowe
<b>ASSOCIATE SID:</b>	Laurie Cannon
<b>ASSOCIATE SID:</b>	Bill Franques
<b>ASSOCIATE SID:</b>	Brian Miller
<b>ASSOCIATE SID (SOFTBALL):</b>	Melissa Foley
<b>PUBLICATIONS DIRECTOR:</b>	Jason Feirman
<b>GRAPHIC DESIGN COORDINATOR:</b>	Peter Hoang
<b>GRAPHIC DESIGN COORDINATOR:</b>	Krystal Bennett
<b>PHOTOGRAPHY COORDINATOR:</b>	Steve Franz
<b>ADMINISTRATIVE SECRETARY:</b>	Pat Fredericks

## SPORTS INFORMATION ADDRESS

<b>MAILING:</b>	LSU Sports Information P.O. Box 25095 Baton Rouge, LA 70894
<b>OVERNIGHT:</b>	LSU Sports Information Fifth Floor, Athletics Admin. Bldg. Nicholson Dr. at North Stadium Dr. Baton Rouge, LA 70803

## MEDIA INFORMATION

<b>SOFTBALL SID:</b>	Melissa Foley
<b>SID OFFICE PHONE:</b>	(225) 578-8226
<b>FOLEY'S OFFICE PHONE:</b>	(225) 578-1869
<b>SID FAX:</b>	(225) 578-1861
<b>FOLEY'S HOME PHONE:</b>	(225) 344-2072
<b>FOLEY'S CELL PHONE:</b>	(225) 241-4365
<b>FOLEY'S E-MAIL ADDRESS:</b>	mfoley@lsu.edu
<b>LSU WEBSITE:</b>	www.LSUsports.net/softball

## LSU SPORTS PROPERTIES

<b>DIRECTOR OF TELEVISION/MEDIA:</b>	Kevin Wagner
<b>MANAGER OF TELEVISION:</b>	John Schiebe
<b>TELEVISION PRODUCER:</b>	David Landry
<b>DIRECTOR OF BROADCASTING:</b>	Jim Hawthorne
<b>RADIO PLAY-BY-PLAY:</b>	Patrick Wright
<b>NETWORK PHONE NUMBER:</b>	(225) 578-1882
<b>LSU SPORTS INTERACTIVE MANAGER:</b>	Todd Politz

# New Tiger Park

INTRO

THIS IS LSU

COACHES

TIGERS

REVIEW

HISTORY

RECORDS

LSU

MEDIA



## THE ALL NEW TIGER PARK



The New Tiger Park will feature 1,289 seats, including 587 chair-back seats, and the capability of accommodating 1,200 more fans on an outfield berm.

The softball stadium will also feature first-class team facilities, including a locker room, team lounge, meeting facility, training facility, equipment room, indoor batting cages and umpire locker rooms.

All seats in the New Tiger Park will be angled toward the playing field, and the facility will include an open concourse with concessions areas and video monitors.

Press facilities and private suites will be included in the new stadium, plus enhanced lighting for night and televised games. The stadium will also be designed to allow for future expansion.

The berm/earthwork package was completed last year and has been settling in preparation for construction.

## LSU TIGER SOFTBALL IS ABOUT TO ENTER A NEW ERA!

LSU is in the planning stage for construction of a new softball stadium on the University's campus. The new facility will provide the nationally recognized Tiger Softball program with one of the finest softball stadiums in the nation.

The new stadium will be located on Skip Bertman Drive, across from the LSU School of Veterinary Medicine and adjacent to the LSU Women's Soccer Complex.



All LSU fans will have the opportunity to participate and keep up with the news surrounding the planning and construction phases of the project. You can join in the success of the project by making an online contribution by accessing [www.MakeYourPitch.net/tigerpark](http://www.MakeYourPitch.net/tigerpark), the official web site of the new Tiger softball stadium.

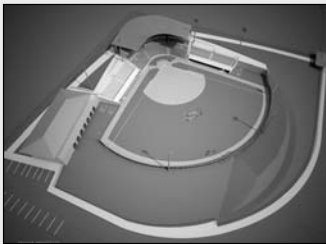

## 2005 NCAA Softball Attendance Leaders\*

SCHOOL	ATT.	DATES	AVG.
1. Fresno State	37,581	20	1,879
2. Michigan	21,077	16	1,317
3. Arizona	31,232	25	1,249
4. Texas	22,184	22	1,008
5. Texas A&M	24,140	24	1,006
6. Alabama	16,485	22	749
7. Oklahoma	13,484	20	674
8. Florida	10,088	15	673
<b>9. LSU</b>	<b>12,746</b>	<b>19</b>	<b>671</b>
10. Washington	7,284	11	662

\* - Most recent figures released by the NCAA



# 2007 Season Outlook

INTRO

THIS IS LSU

COACHES

TIGERS

REVIEW

HISTORY

RECORDS

LSU

MEDIA



## UNFINISHED BUSINESS

Falling one game shy of the Women's College World Series at Arizona last year has made the 2007 LSU softball team return with a renewed dedication to completing their goals and earning the Tigers' third WCWS berth in seven seasons.

"Unfinished business" is the mantra this club has adopted and embraced heading into the 2007 campaign," said head coach Yvette Girovard. "Coming with in one game of returning to the College World Series on the home field of eventual National Champion Arizona in Super Regionals showed the returnees on this team the reality that they are indeed close to the dream."

Having lost four senior starters from the 2006 team, this year's squad went into the fall knowing that many positions were up for grabs and that every player would have to compete for a starting role, which showed the true spirit of the team.

"We had an extremely competitive team in fall drills, in the challenges we presented to them both as a whole and as individuals," said Girovard. "That has shown that this team has great passion and heart."

That heart and passion has led to an eagerness to get better everyday because they know they control their own destiny. The Tigers practice with an aggressiveness that shows they want to be champions and are willing to put in the work.

"Dirty uniforms everyday in practice embodies a unit that will have no excuses or regrets when they leave the field," said Girovard. "They celebrate the effort and know the desired outcome will eventually follow."

Changes defensively to personnel will allow this team to be as sound as any LSU softball team has been. Defense is about an attacking attitude and this team portrays that in their everyday demeanor on the field."

### PITCHERS

After a phenomenal 2006 campaign in the circle that saw Emily Turner (Chula Vista, Calif.) garner both All-SEC and All-America honors, LSU returns three outstanding hurlers while adding a heralded freshman to round out the staff.

Turner posted a 28-9 record as the Tigers' ace a year ago with a 0.93 earned run average and 260 strikeouts. The senior recorded 13 wins over nationally ranked opponents, including LSU's first win over a top-ranked

team when she knocked off No. 1 Arizona in the NCAA Super Regionals.

"Emily Turner returns after an All-American year," said Girovard. "I fully expected Emily's breakout to be in her junior year and she did not disappoint. After turning in her best fall campaign, she is ready to become one of the premier pitchers in the country."

"Her confidence, awareness of competition, reality of what is going on around her and her maturation level are exactly where a senior needs to be. She is ready to be a true leader on the field."

The 2005 Gatorade National High School Player of the Year, Dani Hofer (Safety Harbor, Fla.) did not disappoint in her first season as a Tiger. The sophomore posted 16-5 mark with 160 strikeouts and a no-hitter in her first collegiate outing.

"Dani is a true competitor who is not afraid of challenges and realizes the extra work she needed during the summer," said Girovard. "She spent her summer playing and capturing the magic she possessed at the beginning of last year. 'Been there, done that' will truly be beneficial to Dani in relation to encountering any setbacks. She looked sharper and crisper in the fall and is maturing rapidly inside and outside of the circle."

A breakout star as a relief pitcher before getting injured last season, Tiffany Garcia (LaPorte, Texas) went undefeated a year ago with a perfect 5-0 record and a 0.44 earned run average. The junior also recorded just the third perfect game in school history as part of back-to-back no-hitters.

"Tiffany should see more action this spring as she has a dramatically different look than Emily and Dani," said Girovard. "Realizing the skills she needs to master, she is ready to step into her own role on this team."

A high school All-American out of Little Cypress-Mauriceville High School, Cody Trahan (Orange, Texas) joins the Tigers with an outstanding resume both as a pitcher and a hitter, both of which will be utilized by the team this season. In the circle, the freshman posted a 27-2 record as a senior while being named the Texas 4A Player of the Year and state championship MVP.

"Cody worked really hard during the fall to grasp the Tiger expectations of pitchers," said Girovard. "Good spin and movement are characteristics of Cody's talent. She will also be utilized in the hitting lineup."

### CATCHERS

The Tigers return two veteran catchers in Killian Roessner (Manasquan, N.J.) and Kristen Hobbs (Royal Palm Beach, Fla.). Hobbs saw the most work behind the plate in 2005, but surgery limited her playing time in 2006, allowing Roessner to step into the starting role.

"LSU will have much experience returning at the catcher's position with Kristen and Killian anchoring the defense for the second year in a row," said LSU associate head coach James DeFeo. "Both Hobbs and Roessner have been voted to captain roles and look to provide solid leadership and direction from behind the plate as well as in the batter's box."

Taking over behind the plate last season, Roessner made an immediate impact on the team. The junior began calling her own games, while recording the third most putouts in the Southeastern Conference. In addition, she recorded the third highest number of runners caught stealing compared to stolen base attempts in the league, gunning down 16 runners in 43 attempts.

"Roessner returns for her junior year as one of the more vocal leaders for this Tiger squad," said DeFeo. "We are looking for Killian to build upon last year's game experience and be one of the cornerstones for this veteran-laden roster. Roessner plays the game all out, and provides the passion and fire that it takes to lead a team to their highest level."

Hobbs was sidelined most of last season while she recovered from offseason ulnar collateral ligament reconstruction, commonly known as Tommy John surgery, which limited her to only seven game appearances and five at-bats.

"Being sidelined for most of the 2006 season, we look for Kristen to come back with a vengeance for her senior year," said DeFeo. "Kristen worked incredibly hard all fall on her game and looks to be back to playing form this spring. She is a veteran player that brings knowledge and heart to the team."

### INFIELD

Despite having to replace a pair of departed senior starters in the infield, the Tigers have a wealth of experience and talent to choose from that should make the transition much easier.



**Catcher Killian Roessner**

"Our infield has a different look this year, but still has a tremendous amount of experience," said first-year assistant coach Megan Smith. "They are playing as a cohesive unit and although there have been some changes this year, they look like they have been playing together for a long time."

The group typifies what it means to be a Tiger with their play on the field. They are passionate and are always ready to get the job done, no matter what it takes.

"Every infielder brings an intense and aggressive attitude to the field and it shows in their play," said Smith. "There is never a day of practice that ends without them being covered in dirt. They committed themselves to working harder than they ever have during the fall and it has paid off already."

LSU returns only one starter to the same position from a year ago as shortstop Andrea Smith (Moreno Valley, Calif.) patrols up the middle for the Tigers. The junior standout has routinely made the highlight reel in her first two seasons with a rifle for an arm and an incredible range.

"Andrea has really stepped up her game this fall," said Smith. "After much practice and dedication she has a renewed sense of dominance as our shortstop. She has a knack for making the unbelievable plays look routine."

After earning first-team NFCA All-South Region honors a year ago, two-year starter at second base Vanessa Soto (San Diego, Calif.) makes the transition to first base to replace the departed Stephanie Hill. The steady Soto led the SEC in fielding by a second baseman last season and has recorded only 12 errors in her two years as a Tigers.

"Vanessa will move from second base to first base this season," said Smith. "She is a naturally smooth and effortless defensive player, so the transition has been easy for her. She worked hard in the fall adjusting her game at first base so she is prepared for the season."

In Soto's stead at second will be junior Shannon Stein (Upland, Calif.), who saw time at several positions a year ago after transferring to LSU from Texas A&M-Corpus Christi. As a freshman, she helped guide the Islanders to one of their best seasons in school history.

"Shannon is the sparkplug of our infield," said Smith. "She has stepped into a larger role at second base and has owned it. Her quickness and solid fundamentals will be a huge asset to our infield. Shannon also has become the vocal leader of our infield and she has really helped to improve our communication."

Replacing departed senior Lauren Delahoussaye at third will be junior transfer Tayl'r Hollis. The St. Amant, La., native, joined the Tiger program last spring from Oklahoma, where she started at shortstop and second base for the nationally ranked Sooners as a freshman.

"Tayl'r brings a lot of swagger to our infield," said Smith. "Her fearless attitude makes her a force at third base. She is a fierce competitor who would sacrifice anything to get the out. I look for big things from her."

An all-around athlete, Erika Sluss (Vista, Calif.) has been an outstanding utility payer in her first two seasons. The junior will be called upon once again to help LSU at several key positions.

"Erika will serve many roles for our team this season," said Smith. "She is such a versatile athlete and has worked at both first and second during the fall. Erika is a solid player who simply gets the job done."

An NFCA High School All-American at St. Amant High School, Lindsey Hope (St. Amant, La.) helped the Lady Gators to back-to-back Louisiana state championships. She used the fall to advance her position at third base.

"Lindsey worked in the fall to improve her defensive skills at third base," said Smith. "She has developed better fundamentals and has really improved her game."

## OUTFIELD

The 2007 Tiger outfield returns two of its three starters, including two-time All-American Leslie Klein (Sunrise, Fla.) and two-year starter Quinlan Duhon (Youngsville, La.). LSU will add freshman speedster Jazz Jackson (Houston, Texas) to left field, replacing the departed Camille Harris. When needed, the Tigers can call upon Dee Dee Henderson (Atlanta, Texas) and Rachel Mitchell (LaPorte, Texas) without losing a step.

"The 2007 outfield will once again be anchored in center by All-American Leslie Klein," said DeFeo. "Right field will be patrolled by Quinlan and Jazz Jackson will solidify the defense in left field. Junior speedster Dee Dee Henderson and the hard-hitting freshman Rachael Mitchell make this year's Tiger outfield one of the most talented units in the SEC, if not the country."

Klein earned All-America honors as a freshman in 2004 and again as a junior last season after being slowed as a sophomore during recovery from a second ACL tear in her knee. The senior ranked in the top 10 in the SEC in nine offensive categories a year ago, including batting average, runs scored, RBIs and home runs. In addition, she did not commit an error in the field.

"Throughout her career, Leslie has established herself as one of the most powerful forces on the softball field that the SEC has ever seen," said DeFeo. "With her potent bat and flawless defense, she can beat you in several different ways."

After starting 51 of LSU's 67 games in right last season, Duhon returns for her third season patrolling the Tiger outfield. The junior scored the walk-off game-winning run in the NCAA Regional Championship game last year against UL-Lafayette and posted 10 multiple-hit games on the season.

"Quinlan brings intensity and desire to the playing field that is rivaled by few," said DeFeo. "She has developed her defensive skills to become one of our most dependable defenders. At the plate she can beat you with power, but she is also one of our best situational hitters in the lineup."

The Most Valuable Player of the Texas All-Star Game and a two-time district MVP, Jackson will take in left field. Her quickness will be an effective tool for LSU both at the plate and in the field, continuing the long line of Tiger speedsters in the outfield.

"Jazz will add even more speed to the 2007 Tiger outfield," said DeFeo. "This crafty lefty from Houston can cover a lot of ground in a short amount of time and can make all of the plays defensively. Her arm strength and accuracy has improved greatly since the fall and will be a welcomed asset to the Tiger defense."

One of the most feared base stealers in the SEC for the past two years, Henderson has stepped up her play in the field. Mitchell comes in as a two-time Texas all-state selection that has a tremendous bat. The pair will add great depth to the Tiger outfield.

"Dee Dee's defensive skills have improved greatly and she will be feared for more than her offensive speed in the near future," said DeFeo. "Rachel has been developing all aspects of her game, both on offense and defense, and will prove to be one of LSU's most versatile outfielders in this talent-rich group."

## AT THE PLATE

Despite losing four bats from last season's offense that ranked third in the SEC, LSU returns its top two hitters from a year ago and 60 percent of its RBIs. The majority of the Tiger lineup now has two or more years under its belt and with the added familiarity, LSU is poised to be a dangerous team at the plate.

"LSU returns a wealth of experience to the plate this year as the 2007 Tigers look to build upon their past success and once again be a dominant force in the conference as well as at a national level," said DeFeo.

The Tigers leading hitter in two of her three seasons, Klein will once again be called upon to lead LSU at the plate. The senior already ranks in the top 10 in 10 separate offensive categories in Tiger softball history.

"Leading the Tiger attack offense will be Leslie Klein," said DeFeo. "She has proven to be one of the most dominant offensive forces in LSU history."

The six juniors in the starting lineup will be called upon to step up offensively again this season. Soto ranked second on the team in hitting a year ago, while Duhon, Roessner and Smith provided solid bats in the rotation. New to the lineup this season will be Hollis and Stein, who should both be welcome additions. Sluss



**Two-time All-American outfielder Leslie Klein**

should provide LSU with a solid bat off the bench when called upon.

"The supporting cast of standout juniors will bring this year's squad to another level," said DeFeo. "The spark of having Shannon in the lineup as an everyday player will energize the top of our order while the smooth swinging lefty Vanessa Soto will provide power and consistency."

"Andrea and newcomer Tayl'r Hollis will be counted on to produce clutch hits in prime time situations. Erika is coming off her best semester of fall practice and has emerged as one of the Tigers' biggest bats."

LSU has also added a powerful punch with the addition of a trio of freshmen. Conversely, the addition of Jackson, to go along with Henderson, gives the Tigers the added benefit of having speed on the base paths.

"With the addition of freshmen Cody Trahan, Rachel Mitchell, and Lindsay Hope, the Tigers will get a big boost of power from both sides of the plate," said DeFeo. "Balancing out the Tiger attack offense are speed merchants Dee Dee Henderson and Jazz Jackson."

"This year's offensive unit will have the best of all worlds! Speed, power and consistency, and looks to be one of the most balanced offenses LSU has fielded in years."

## SCHEDULE

Never shying away from tough competition, the Tigers will once again face a challenging schedule in 2007. With 21 games against teams that participated in NCAA Regional play last season, LSU will be put to the test as the Tigers pursue a third Women's College World Series berth.

LSU opens the season at home in the three-day Easton Tiger Classic. At the Crowne Plaza Classic, the Tigers will take on Houston, Indiana, Missouri State, Southern Illinois and Texas State. LSU will once again host the Easton Tiger Classic at Tiger Park. The final pre-conference tournament of the year is at the Washington.

"The pre-conference schedule is an attractive, RPI-boosting, representation of the countries conferences," said Girouard. "We have some new names gracing Tiger Park and we travel to a very good Houston tournament with an exciting trip to Seattle. This schedule should prepare us for the rigors of the highly competitive SEC."

In addition, the Tigers will host non-conference games against Alcorn State, Texas-San Antonio and in-state rivals Centenary, McNeese State, Southeastern Louisiana and UL-Monroe.

The biggest change to the schedule this year takes place during the SEC regular season. The league has shortened the schedule from 30 games to 28. The two mid-week series have now been shortened to doubleheaders. In 2007, the Tigers will have these doubleheader series against Mississippi State and Kentucky.

"The change in the SEC this year is that the mid-week partner is a doubleheader, cutting SEC games down to 28," said Girouard. "The coaches all believe that this will help our RPI, free up some out of conference scheduling and prevent the sister schools from constantly beating up on each other."

In SEC action, the Tigers open league play on the road at Ole Miss. LSU will also take on Auburn, Mississippi State, Arkansas and Georgia on the road. At home, LSU will host Florida, Kentucky, South Carolina and 2006 Women's College World Series participants Alabama and Tennessee.

"Our home SEC schedule spotlights some great programs in Florida, Alabama, Kentucky, South Carolina and preseason favorite Tennessee," said Girouard.

INTRO

THIS IS LSU

COACHES

TIGERS

REVIEW

HISTORY

RECORDS

LSU

MEDIA

# 2007 Roster/Roster Breakdown

INTRO

THIS IS LSU

COACHES

TIGERS

REVIEW

HISTORY

RECORDS

LSU

MEDIA

## NUMERICAL

NO.	NAME	POS.	HT.	B-T	CL./EXP.	HOMETOWN/PREVIOUS SCHOOL
00	Quinlan Duhon	OF	5-7	R-R	Jr./2L	Youngsville, La./St. Thomas More HS
1	Emily Turner	P	5-11	R-R	Sr./3L	Chula Vista, Calif./Bonita Vista HS
2	Tiffany Garcia	P	5-7	R-R	Jr./2L	LaPorte, Texas/LaPorte HS
3	Lindsey Hope	3B	5-7	R-R	Fr./HS	Prairieville, La./St. Amant HS
4	Killian Roessner	C	5-7	R-R	Jr./2L	Manasquan, N.J./Wall HS
5	Dani Hofer	P	5-11	R-R	So./1L	Safety Harbor, Fla./Palm Harbor HS
6	Leslie Klein	OF	5-6	L-L	Sr./3L	Sunrise, Fla./South Plantation HS
9	Jazz Jackson	OF	5-4	L-R	Fr./HS	Houston, Texas/Bellaire HS
10	Kristen Hobbs	C	5-5	R-R	Sr./3L	Royal Palm Beach, Fla./Royal Palm Beach HS
13	Shannon Stein	2B	5-5	R-R	Jr./1L	Upland, Calif./Texas A&M-Corpus Christi
14	Tayl'r Hollis	3B	5-7	R-R	Jr./TR	St. Amant, La./Oklahoma
17	Erika Sluss	UT	5-3	R-R	Jr./2L	Vista, Calif./Rancho Buena Vista HS
22	Cody Trahan	P/1B	6-0	R-R	Fr./HS	Orange, Texas/Little Cypress-Mauriceville HS
24	Vanessa Soto	1B/2B	5-6	L-R	Jr./2L	San Diego, Calif./Mount Carmel HS
27	Andrea Smith	SS	5-5	R-R	Jr./2L	Moreno Valley, Calif./Valley View HS
44	Dee Dee Henderson	OF	5-4	L-R	Jr./2L	Atlanta, Texas/Atlanta HS
55	Rachel Mitchell	OF	5-3	L-R	Fr./HS	LaPorte, Texas/LaPorte HS
	* Stacey Woods	OF	5-2	L-R	Fr./HS	Sulphur, Texas/Sulphur HS

## ALPHABETICAL

NO.	NAME	POS.	HT.	B-T	CL./EXP.	HOMETOWN/PREVIOUS SCHOOL
00	Quinlan Duhon	OF	5-7	R-R	Jr./2L	Youngsville, La./St. Thomas More HS
2	Tiffany Garcia	P	5-7	R-R	Jr./2L	LaPorte, Texas/LaPorte HS
44	Dee Dee Henderson	OF	5-4	L-R	Jr./2L	Atlanta, Texas/Atlanta HS
10	Kristen Hobbs	C	5-5	R-R	Sr./3L	Royal Palm Beach, Fla./Royal Palm Beach HS
5	Dani Hofer	P	5-11	R-R	So./1L	Safety Harbor, Fla./Palm Harbor HS
14	Tayl'r Hollis	3B	5-7	R-R	Jr./TR	St. Amant, La./Oklahoma
3	Lindsey Hope	3B	5-7	R-R	Fr./HS	Prairieville, La./St. Amant HS
9	Jazz Jackson	OF	5-4	L-R	Fr./HS	Houston, Texas/Bellaire HS
6	Leslie Klein	OF	5-6	L-L	Sr./3L	Sunrise, Fla./South Plantation HS
55	Rachel Mitchell	OF	5-3	L-R	Fr./HS	LaPorte, Texas/LaPorte HS
4	Killian Roessner	C	5-7	R-R	Jr./2L	Manasquan, N.J./Wall HS
17	Erika Sluss	UT	5-3	R-R	Jr./2L	Vista, Calif./Rancho Buena Vista HS
27	Andrea Smith	SS	5-5	R-R	Jr./2L	Moreno Valley, Calif./Valley View HS
24	Vanessa Soto	1B/2B	5-6	L-R	Jr./2L	San Diego, Calif./Mount Carmel HS
13	Shannon Stein	2B	5-5	R-R	Jr./1L	Upland, Calif./Texas A&M-Corpus Christi
22	Cody Trahan	P/1B	6-0	R-R	Fr./HS	Orange, Texas/Little Cypress-Mauriceville HS
1	Emily Turner	P	5-11	R-R	Sr./3L	Chula Vista, Calif./Bonita Vista HS
	* Stacey Woods	OF	5-2	L-R	Fr./HS	Sulphur, Texas/Sulphur HS

## COACHING STAFF

<b>Head Coach</b>	Yvette Girouard (UL-Lafayette, 1976)
<b>Associate Head Coach</b>	James DeFeo (Rutgers, 1996)
<b>Assistant Coach</b>	Megan Smith (North Carolina, 1999)

\* - Will medically redshirt in 2007

## TIGERS BY STATE

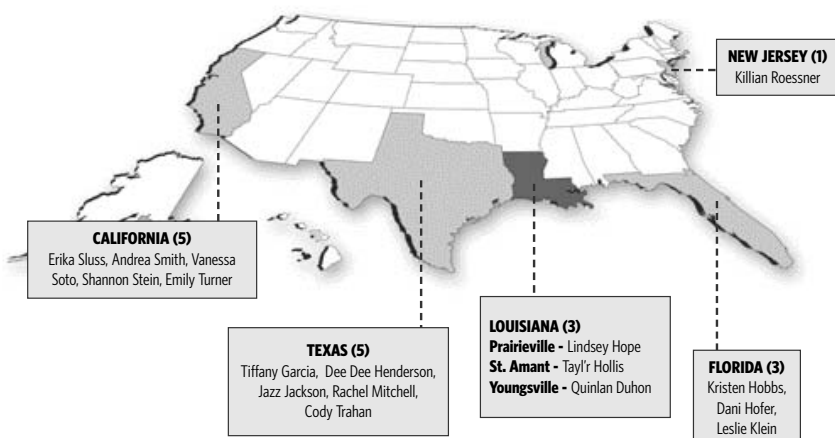

## PRONUNCIATION

### PLAYERS

<b>QUINLAN DUHON</b>	quin-luhn DO-yawn
<b>DANI HOFER</b>	dan-E HOE-fer
<b>KILLIAN ROESSNER</b>	kill-e-uhn rah-sner
<b>ERIKA SLUSS</b>	like slush with no H
<b>ANDREA SMITH</b>	AND-ree-uh
<b>VANESSA SOTO</b>	SO-TOE
<b>CODY TRAHAN</b>	TRAY-han

### COACHING STAFF

<b>YVETTE GIROUARD</b>	E-vette gi-rard
<b>JAMES DEFEO</b>	duh-FAY-o



- INTRO
- THIS IS LSU
- COACHES
- TIGERS
- REVIEW
- HISTORY
- RECORDS
- LSU
- MEDIA



## ALABAMA

March 24 • 1 p.m. (DH)  
 March 25 • 1 p.m.  
 Baton Rouge, La.

### UNIVERSITY INFORMATION

Location: Tuscaloosa, Ala.  
 Enrollment: 23,878  
 Nickname: Crimson Tide  
 Colors: Crimson & White  
 Conference: Southeastern  
 Field: Alabama Softball Complex  
 Capacity: 1,595

### SOFTBALL INFORMATION

Head Coach: Patrick Murphy  
 Assistant Coaches: Alyson Habetz, Vann Stuedeman  
 2006 Record: 54-11  
 2006 SEC/Finish: 25-4/1st-West  
 Overall Series Record: LSU leads 26-19  
 2006 Series Record: LSU won 2-1

### MEDIA INFORMATION

Softball SID: Ben Blevins  
 SID Office: (205) 348-6734  
 SID Fax: (205) 348-8841  
 SID E-mail: bblevins@iaua.edu  
 Website: www.rolltide.com  
 Press Box: (205) 348-0909



## ALCORN STATE

Feb. 27 • 4 p.m. (DH)  
 Baton Rouge, La.

### UNIVERSITY INFORMATION

Location: Alcorn State, Miss.  
 Enrollment: 3193  
 Nickname: Lady Braves  
 Colors: Purple & Gold  
 Conference: Southwestern Athletic  
 Field: Lady Braves Field  
 Capacity: 1,000

### SOFTBALL INFORMATION

Head Coach: Kevin Montgomery  
 Assistant Coach: Yolanda Brown  
 2006 Record: 20-29  
 2006 SWAC/Finish: 13-6/2nd-East  
 Overall Series Record: LSU leads 1-0  
 2006 Series Record: Did not play

### MEDIA INFORMATION

Softball SID: Josh Bean  
 SID Office: (601) 877-6466  
 SID Fax: (601) 877-3821  
 SID E-mail: bean316@yahoo.com  
 Website: www.alcornsports.com  
 Press Box: N/A



## ARKANSAS

April 21 • 1 p.m. (DH)  
 April 22 • 1 p.m.  
 Baton Rouge, La.

### UNIVERSITY INFORMATION

Location: Fayetteville, Ark.  
 Enrollment: 17,938  
 Nickname: Lady Razorbacks  
 Colors: Cardinal & White  
 Conference: Southeastern  
 Field: Lady Back Yard  
 Capacity: 2,000

### SOFTBALL INFORMATION

Head Coach: Jamie Pinkerton  
 Assistant Coaches: Tiffany Redding, Aly Sartini  
 2006 Record: 26-35  
 2006 SEC/Finish: 10-19/6th-West  
 Overall Series Record: LSU leads 3-7  
 2006 Series Record: Arkansas won 2-1

### MEDIA INFORMATION

Softball SID: Deanna Werner  
 SID Office: (479) 575-5786  
 SID Fax: (479) 575-7410  
 SID E-mail: dwerner@uark.edu  
 Website: www.ladybacks.com  
 Press Box: (479) 575-2235



## ARKANSAS-PINE BLUFF

Easton Purple & Gold Challenge  
 Feb. 23 • 3:30 p.m.  
 Baton Rouge, La.

### UNIVERSITY INFORMATION

Location: Pine Bluff, Arkansas  
 Enrollment: 3,200  
 Nickname: Lady Lions  
 Colors: Black & Gold  
 Conference: Southwestern Athletic  
 Field: Martin Luther King, Jr. Park  
 Capacity: 400

### SOFTBALL INFORMATION

Head Coach: Alex Thomas  
 Assistant Coaches: Terry Washington, Detoria Roy  
 2006 Record: 7-34  
 2006 SWAC/Finish: 4-16/4th-West  
 Overall Series Record: LSU leads 1-0  
 2006 Series Record: LSU won 1-0

### MEDIA INFORMATION

Softball SID: Tamara Williams  
 SID Office: (870) 575-7174  
 SID Fax: (870) 575-7881  
 SID E-mail: tbwilliams@yahoo.com  
 Website: www.uapb.edu  
 Press Box: N/A



## AUBURN

March 31 • 1 p.m. (DH)  
 April 1 • 1 p.m.  
 Auburn, Ala.

### UNIVERSITY INFORMATION

Location: Auburn, Ala.  
 Enrollment: 23,333  
 Nickname: Tigers  
 Colors: Burnt Orange & Navy  
 Conference: Southeastern  
 Field: Jane B. Moore Field  
 Capacity: 1,500

### SOFTBALL INFORMATION

Head Coach: Tina Deese  
 Assistant Coaches: Jack Byerley, Steward McGill  
 2006 Record: 36-22  
 2006 SEC/Finish: 15-15/3rd-West  
 Overall Series Record: LSU leads 29-11  
 2006 Series Record: LSU won 3-1

### MEDIA INFORMATION

Softball SID: Hank Hager  
 SID Office: (334) 844-9810  
 SID Fax: (334) 844-9807  
 SID E-mail: hagerhp@auburn.edu  
 Website: www.auburntigers.com  
 Press Box: (334) 844-5232



## CENTENARY

Easton Tiger Classic  
 Feb. 10 • 3:45 p.m. • Baton Rouge, La.  
 March 21 • 5:30 p.m. • Shreveport, La.

### UNIVERSITY INFORMATION

Location: Shreveport, La.  
 Enrollment: 910  
 Nickname: Ladies  
 Colors: Maroon & White  
 Conference: Mid-Continent  
 Field: Centenary Softball Complex  
 Capacity: 500

### SOFTBALL INFORMATION

Head Coach: Mark Montgomery  
 Assistant Coach: Lyndsey Angus  
 2006 Record: 31-25  
 2006 Mid-Con/Finish: 13-9/2nd  
 Overall Series Record: LSU leads 11-0  
 2006 Series Record: LSU won 1-0

### MEDIA INFORMATION

Softball SID: David Pratt  
 SID Office: (318) 869-5092  
 SID Fax: (318) 869-5128  
 SID E-mail: dpratt@centenary.edu  
 Website: www.GoCentenary.com  
 Press Box: N/A



## FLORIDA

March 17 • 1 p.m. (DH)  
 March 18 • 1 p.m.  
 Baton Rouge, La.

### UNIVERSITY INFORMATION

Location: Gainesville, Fla.  
 Enrollment: 48,673  
 Nickname: Gators  
 Colors: Orange & Blue  
 Conference: Southeastern  
 Field: Florida Softball Field  
 Capacity: 1,200

### SOFTBALL INFORMATION

Head Coach: Tim Walton  
 Assistant Coaches: Jennifer Jaime, Jenny Gladding  
 2006 Record: 43-25  
 2006 SEC/Finish: 17-13/3rd-East  
 Overall Series Record: LSU leads 23-7  
 2005 Series Record: LSU won 3-0

### MEDIA INFORMATION

Softball SID: Heidi Johnson  
 SID Office: (352) 375-4683 ext. 6128  
 SID Fax: (352) 375-4809  
 SID E-mail: heidij@gators.ufl.edu  
 Website: www.gatorzone.com  
 Press Box: (352) 379-3066



## GEORGIA

May 5 • 1 p.m. (DH)  
 May 6 • 1 p.m.  
 Athens, Ga.

### UNIVERSITY INFORMATION

Location: Athens, Ga.  
 Enrollment: 33,660  
 Nickname: Bulldogs  
 Colors: Red & Black  
 Conference: Southeastern  
 Field: UGA Soccer/Softball Complex  
 Capacity: 1,400

### SOFTBALL INFORMATION

Head Coach: Lu Harris-Champer  
 Assistant Coaches: Michelle Green, Brent Shaw  
 2006 Record: 54-15  
 2006 SEC/Finish: 24-64/1st  
 Overall Series Record: LSU leads 21-8  
 2005 Series Record: Georgia won 4-0

### MEDIA INFORMATION

Softball SID: Jared Benko  
 SID Office: (706) 542-1621  
 SID Fax: (706) 542-9339  
 SID E-mail: jaredj@sports.uga.edu  
 Website: www.georgiadogs.com  
 Press Box: (706) 425-3359

# 2007 Opponents

INTRO

THIS IS LSU

COACHES

TIGERS

REVIEW

HISTORY

RECORDS

LSU

MEDIA



## HOUSTON

**Crowne Plaza Invitational**  
Feb. 16 • 7 p.m.  
Houston, Texas

### UNIVERSITY INFORMATION

Location: Houston, Texas  
Enrollment: 35,400  
Nickname: Cougars  
Colors: Scarlet & White with Navy  
Conference: Conference USA  
Field: Cougar Softball Stadium  
Capacity: 1,200

### SOFTBALL INFORMATION

Head Coach: Kyla Holas  
Assistant Coaches: Beth McClendon, Adam Roorbach  
2006 Record: 40-23  
2006 C-USA/Finish: 15-9/T-2nd  
Overall Series Record: LSU leads 3-1  
2006 Series Record: Did not play

### MEDIA INFORMATION

Softball SID: Matt Dunaway  
SID Office: (713) 743-9408  
SID Fax: (713) 743-9411  
SID E-mail: mbdunawa@central.uh.edu  
Website: uhcougars.com  
Press Box: (713) 743-8263



## INDIANA

**Crowne Plaza Invitational**  
Feb. 17 • 11 a.m.  
Houston, Texas

### UNIVERSITY INFORMATION

Location: Bloomington, Ind.  
Enrollment: 38,903  
Nickname: Hoosiers  
Colors: Cream & Crimson  
Conference: Big Ten  
Field: IU Softball Field  
Capacity: N/A

### SOFTBALL INFORMATION

Head Coach: Stacey Phillips  
Assistant Coaches: Tarrah Beyster, Michelle Puls  
2006 Record: 30-25-1  
2006 Big Ten/Finish: 8-9/6th  
Overall Series Record: LSU leads 1-0  
2006 Series Record: Did not play

### MEDIA INFORMATION

Softball SID: Ashley Thornburg  
SID Office: (812) 855-4770  
SID Fax: (812) 855-9401  
SID E-mail: arthornb@indiana.edu  
Website: www.iuhoosiers.com  
Press Box: N/A



## KENTUCKY

**April 3 • 4 p.m. (DH)**  
Baton Rouge, La.

### UNIVERSITY INFORMATION

Location: Lexington, Ky.  
Enrollment: 26,439  
Nickname: Wildcats  
Colors: Blue & White  
Conference: Southeastern  
Field: UK Softball Complex  
Capacity: 500

### SOFTBALL INFORMATION

Head Coach: Eileen Schmidt  
Assistant Coaches: Melissa Inouye, Brooke Monroe  
2006 Record: 21-36  
2006 SEC/Finish: 4-26/5th-East  
Overall Series Record: LSU leads 23-1  
2006 Series Record: LSU won 3-0

### MEDIA INFORMATION

Softball SID: Amy Ratliff  
SID Office: (859) 257-8437  
SID Fax: (859) 323-4310  
SID E-mail: amy.ratliff@uky.edu  
Website: www.ukathletics.com  
Press Box: (859) 257-9403



## LOUISIANA TECH

**Easton Purple & Gold Challenge**  
Feb. 23 • 5:45 p.m.  
Baton Rouge, La.

### UNIVERSITY INFORMATION

Location: Ruston, La.  
Enrollment: 11,750  
Nickname: Lady Techsters  
Colors: Red & Blue  
Conference: Western Athletic  
Field: Lady Techster Softball Complex  
Capacity: 1,000

### SOFTBALL INFORMATION

Head Coach: Sarah Dawson  
Assistant Coach: Shelli Manson  
2006 Record: 18-31  
2006 SEC/Finish: 6-11/6th  
Overall Series Record: LSU leads 8-0  
2006 Series Record: Did not play

### MEDIA INFORMATION

Softball SID: Malcolm Butler  
SID Office: (318) 257-3144  
SID Fax: (318) 257-3757  
SID E-mail: mbutler@latech.edu  
Website: www.latechsports.com  
Press Box: N/A



## UL-MONROE

**Feb. 14 • 6 p.m.**  
Baton Rouge, La.

### UNIVERSITY INFORMATION

Location: Monroe, La.  
Enrollment: 9,275  
Nickname: Warhawks  
Colors: Maroon  
Conference: Sun Belt  
Field: ULM Softball Complex  
Capacity: N/A

### SOFTBALL INFORMATION

Head Coach: Rosemary Holloway-Hill  
Assistant Coaches: Lacinda Norman, Heather Hodges  
2006 Record: 27-30  
2006 SLC/Finish: 10-16/8th  
Overall Series Record: LSU leads 2-0  
2006 Series Record: Did not play

### MEDIA INFORMATION

Softball SID: Walt Barton  
SID Office: (318) 342-5461  
SID Fax: (318) 342-5464  
SID E-mail: bartonw@tribe.ulm.edu  
Website: www.ulmathletics.com  
Press Box: N/A



## MCNEESE STATE

**March 7 • 6 p.m.**  
Baton Rouge, La.  
**March 28 • 6 p.m.**  
Lake Charles, La.

### UNIVERSITY INFORMATION

Location: Lake Charles, La.  
Enrollment: 8,992  
Nickname: Cowgirls  
Colors: Royal Blue & Yellow  
Conference: Southland  
Field: Cowgirl Diamond  
Capacity: N/A

### SOFTBALL INFORMATION

Head Coach: Chris Malveau  
Assistant Coaches: Sara Vogt  
2006 Record: 21-30  
2006 SLC/Finish: 13-13/4th  
Overall Series Record: LSU leads 14-0  
2006 Series Record: LSU won 2-0

### MEDIA INFORMATION

Softball SID: Pam LaFosse  
SID Office: (337) 475-5926  
SID Fax: (337) 475-5928  
SID E-mail: plafosse@mcneese.edu  
Website: www.mcneesesports.com  
Press Box: N/A



## MEMPHIS

**Easton Tiger Classic**  
March 9 • 3:30 p.m.  
Baton Rouge, La.

### UNIVERSITY INFORMATION

Location: Memphis, Tenn.  
Enrollment: 20,465  
Nickname: Lady Tigers  
Colors: Royal Blue & Gray  
Conference: Conference USA  
Field: Lady Tigers Stadium  
Capacity: N/A

### SOFTBALL INFORMATION

Head Coach: Windy Thees  
Assistant Coaches: Donald Pickett, Ashley Blanton  
2006 Record: 28-26  
2006 Big 12/Finish: 10-13/7th  
Overall Series Record: First Meeting  
2006 Series Record: Did not play

### MEDIA INFORMATION

Softball SID: Brandon Kolditz  
SID Office: (901) 678-2444  
SID Fax: (901) 678-4134  
SID E-mail: wkolditz@memphis.edu  
Website: www.gotigersgo.com  
Press Box: N/A



## MIDDLE TENNESSEE

**Easton Tiger Classic**  
March 9 • 5:45 p.m.  
Baton Rouge, La./Oxford, Miss.

### UNIVERSITY INFORMATION

Location: Murfreesboro, Tenn.  
Enrollment: 22,863  
Nickname: Blue Raiders  
Colors: Royal Blue & White  
Conference: Sun Belt  
Field: Blue Raider Field  
Capacity: N/A

### SOFTBALL INFORMATION

Head Coach: Leigh Podlesny  
Assistant Coaches: Jodi Chirnelwiski, Liz Davis  
2006 Record: 19-42-1  
2006 SBC/Finish: 6-9/4th  
Overall Series Record: First Meeting  
2006 Series Record: Did not play

### MEDIA INFORMATION

Softball SID: Denise Gideon  
SID Office: (615) 904-8115  
SID Fax: N/A  
SID E-mail: dgideon@mtsu.edu  
Website: www.goblueraiders.com  
Press Box: N/A

- INTRO
- THIS IS LSU
- COACHES
- TIGERS
- REVIEW
- HISTORY
- RECORDS
- LSU
- MEDIA



## MISSISSIPPI STATE

April 14 • 1 p.m. (DH)  
Starkville, Miss.

### UNIVERSITY INFORMATION

Location: Starkville, Miss.  
Enrollment: 15,934  
Nickname: Bulldogs  
Colors: Maroon & White  
Conference: Southeastern  
Field: MSU Softball Field  
Capacity: 750

### SOFTBALL INFORMATION

Head Coach: Jay Miller  
Assistant Coaches: Bo Reid, Annie Smith  
2006 Record: 33-28  
2006 SEC/Finish: 7-22/6th-West  
Overall Series Record: LSU leads 29-5  
2006 Series Record: LSU won 3-0

### MEDIA INFORMATION

Softball SID: Tim Andrzewski  
SID Office: (662) 325-7556  
SID Fax: (662) 325-3654  
SID E-mail: tandrzewski@athletics.msstate.edu  
Website: www.msstateathletics.com  
Press Box: (662) 325-7546



## MISSOURI

Easton Tiger Classic  
Feb. 10 • 1:30 p.m.  
Baton Rouge, La.

### UNIVERSITY INFORMATION

Location: Columbia, Mo.  
Enrollment: 27,003  
Nickname: Tigers  
Colors: Old Gold & Black  
Conference: Big 12  
Field: University Field  
Capacity: 500

### SOFTBALL INFORMATION

Head Coach: Ehren Earleywine  
Assistant Coaches: Melissa Tucci, Mark Redburn  
2006 Record: 26-27  
2006 SEC/Finish: 7-11/7th  
Overall Series Record: LSU leads 1-0  
2006 Series Record: Did not play

### MEDIA INFORMATION

Softball SID: Emily Gatewood  
SID Office: (573) 884-8519  
SID Fax: (573) 882-4720  
SID E-mail: gatewoode@missouri.edu  
Website: www.mutigers.com  
Press Box: (573) 882-3241



## MISSOURI STATE

Crowne Plaza Invitational  
Feb. 16 • 5 p.m.  
Houston, Texas

### UNIVERSITY INFORMATION

Location: Springfield, Mo.  
Enrollment: 20,962  
Nickname: Bears  
Colors: Maroon & White  
Conference: Missouri Valley  
Field: Missouri State Softball Field  
Capacity: 200

### SOFTBALL INFORMATION

Head Coach: Holly Hesse  
Assistant Coaches: Sue Frederick, Beth Perine  
2006 Record: 40-17  
2006 MVC/Finish: 18-4/2nd  
Overall Series Record: First Meeting  
2006 Series Record: Did not play

### MEDIA INFORMATION

Softball SID: Brent Elsassner  
SID Office: (417) 836-5402  
SID Fax: (417) 836-4868  
SID E-mail: BrentElsasser@MissouriState.edu  
Website: missouristatebears.com  
Press Box: N/A



## NORTH DAKOTA STATE

University of Washington Tournament  
March 2 • 11 a.m.  
March 4 • 11 a.m.  
Seattle, Wash.

### UNIVERSITY INFORMATION

Location: Fargo, N.D.  
Enrollment: 12,099  
Nickname: Bison  
Colors: Green & Yellow  
Conference: Independent  
Field: NDSU Softball Complex  
Capacity: 500

### SOFTBALL INFORMATION

Head Coach: Darren Mueller  
Assistant Coaches: Jamie Trachsel, Lindsey Graham  
2006 Record: 24-27  
Overall Series Record: First Meeting  
2006 Series Record: Did not play

### MEDIA INFORMATION

Softball SID: Jeff Schwartz  
SID Office: (701) 231-8223  
SID Fax: (701) 231-8022  
SID E-mail: jeffschwartz@ndsus.edu  
Website: www.gobison.com  
Press Box: (701) 793-0538



## OLE MISS

March 10 • 1 p.m. (DH)  
March 11 • 1 p.m.  
Oxford, Miss.

### UNIVERSITY INFORMATION

Location: Oxford, Miss.  
Enrollment: 17,325  
Nickname: Rebels  
Colors: Cardinal Red & Navy Blue  
Conference: Southeastern  
Field: Ole Miss Softball Complex  
Capacity: 1,000

### SOFTBALL INFORMATION

Head Coach: Missy Dickerson  
Assistant Coaches: Tom McLaughlin, McKewen Dannelly  
2006 Record: 24-36  
2006 SEC/Finish: 10-20/5th-West  
Overall Series Record: LSU leads 32-2  
2006 Series Record: LSU won 3-0

### MEDIA INFORMATION

Softball SID: Joey Jones  
SID Office: (662) 915-7526  
SID Fax: (662) 915-7006  
SID E-mail: joeyj@olemiss.edu  
Website: www.OleMissSports.com  
Press Box: (662) 915-7851



## PORTLAND STATE

University of Washington Tournament  
March 3 • 11 a.m.  
Seattle, Wash.

### UNIVERSITY INFORMATION

Location: Portland, Oregon  
Enrollment: 25,900  
Nickname: Vikings  
Colors: Green, White & Silver  
Conference: Pacific Coast Softball  
Field: Erv Lind Stadium  
Capacity: 2,000

### SOFTBALL INFORMATION

Head Coach: Amy Hayes  
Assistant Coach: Tobin-Echo Hawk, Jenn Poore  
2006 Record: 38-20  
2006 PCCS/Finish: 15-5/1st  
Overall Series Record: LSU leads 1-0  
2006 Series Record: Did not play

### MEDIA INFORMATION

Softball SID: Rick Stupak  
SID Office: (503) 725-5602  
SID Fax: (503) 725-5610  
SID E-mail: rstupak@pdx.edu  
Website: www.olemissports.com  
Press Box: N/A



## SOUTH CAROLINA

April 6 • 4 p.m. (DH)  
April 7 • 1 p.m.  
Baton Rouge, La.

### UNIVERSITY INFORMATION

Location: Columbia, S. C.  
Enrollment: 27,390  
Nickname: Gamecocks  
Colors: Garnet & Black  
Conference: Southeastern  
Field: Beckham Field  
Capacity: 1,500

### SOFTBALL INFORMATION

Head Coach: Joyce Compton  
Assistant Coaches: Angela Thompson, Adrianna Baggetta  
2006 Record: 28-30  
2006 SEC/Finish: 8-21/4th-West  
Overall Series Record: LSU leads 20-10  
2006 Series Record: LSU won 3-0

### MEDIA INFORMATION

Softball SID: Ayanna Wakefield  
SID Office: (803) 777-8017  
SID Fax: (803) 777-2967  
SID E-mail: ayanna@gwm.sc.edu  
Website: www.usccsports.com  
Press Box: (803) 777-8428



## SOUTHEASTERN LA.

April 11 • 6 p.m.  
Baton Rouge, La.  
April 25 • 6 p.m.  
Hammond, La.

### UNIVERSITY INFORMATION

Location: Hammond, La.  
Enrollment: 15,500  
Nickname: Lady Lions  
Colors: Green & Gold  
Conference: Southland  
Field: North Oak Park  
Capacity: 500

### SOFTBALL INFORMATION

Head Coach: Pete Langlois  
Assistant Coach: Karin Smith, Summer Delaneville  
2006 Record: 10-36  
2006 SLC/Finish: 6-21/10th  
Overall Series Record: LSU leads 8-0  
2006 Series Record: LSU won 2-0

### MEDIA INFORMATION

Softball SID: Kemmler Chapple  
SID Office: (985) 549-3221  
SID Fax: (985) 549-3773  
SID E-mail: kchapple@selu.edu  
Website: www.LionSports.net  
Press Box: (985) 974-5466

# 2007 Opponents

INTRO

THIS IS LSU

COACHES

TIGERS

REVIEW

HISTORY

RECORDS

LSU

MEDIA



## SOUTHERN

April 17 • 6 p.m.  
Baton Rouge, La.

### UNIVERSITY INFORMATION

Location: Baton Rouge, La.  
Enrollment: 9,803  
Nickname: Lady Jaguars  
Colors: Columbia Blue & Gold  
Conference: Southwestern Athletic  
Field: Lady Jaguar Softball Field  
Capacity: 500

### SOFTBALL INFORMATION

Head Coach: Nancy Marshall  
Assistant Coach: Thomas Hill  
2006 Record: 26-24  
2006 SWAC/Finish: 17-7/2nd  
Overall Series Record: LSU leads 4-0  
2006 Series Record: Did not play

### MEDIA INFORMATION

Softball SID: Brandon Willis  
SID Office: (225) 771-2601  
SID Fax: (225) 771-2896  
SID E-mail: brawillis@yahoo.com  
Website: www.jagsports.net  
Press Box: N/A



## SOUTHERN ILLINOIS

Crowne Plaza Invitational  
Feb. 18 • 11 a.m.  
Houston, Texas

### UNIVERSITY INFORMATION

Location: Carbondale, Ill.  
Enrollment: 21,003  
Nickname: Salukis  
Colors: Maroon & White  
Conference: Missouri Valley  
Field: Charlotte West Stadium - Rochman Field  
Capacity: 502

### SOFTBALL INFORMATION

Head Coach: Kerri Blaylock  
Assistant Coaches: Mark "Skip" Cosgrove, Christy Conroyer  
2006 Record: 35-13  
2006 MVC/Finish: 15-6/3rd  
Overall Series Record: First Meeting  
2006 Series Record: Did not play

### MEDIA INFORMATION

Softball SID: Matt Crouch  
SID Office: (618) 453-5465  
SID Fax: (618) 453-2648  
SID E-mail: mcrouch@sium.edu  
Website: www.siusalukis.com  
Press Box: (618) 453-7235



## SOUTHERN MISS

Easton Purple & Gold Challenge  
Feb. 24 • 3:45 p.m.  
Baton Rouge, La.

### UNIVERSITY INFORMATION

Location: Hattiesburg, Miss.  
Enrollment: 16,050  
Nickname: Golden Eagles  
Colors: Black & Gold  
Conference: Conference USA  
Field: Southern Miss Softball Complex  
Capacity: 1,500

### SOFTBALL INFORMATION

Head Coach: Gay McNutt  
Assistant Coaches: Robyn Killebrew, Laurie Nelson  
2006 Record: 29-38  
2006 C-USA/Finish: 11-13/6th  
Overall Series Record: LSU leads 14-4  
2006 Series Record: Did not play

### MEDIA INFORMATION

Softball SID: Mallory Haynes  
SID Office: (601) 266-5332  
SID Fax: (601) 266-4507  
SID E-mail: mallory.haynes@usm.edu  
Website: www.southernmiss.com  
Press Box: (601) 583-7345



## TENNESSEE

April 28 • 1 p.m. (DH)  
April 29 • 1 p.m.  
Baton Rouge, La.

### UNIVERSITY INFORMATION

Location: Knoxville, Tenn.  
Enrollment: 25,244  
Nickname: Lady Volunteers  
Colors: Orange & White  
Conference: Southeastern  
Field: Tennessee Field at Tyson Park  
Capacity: 1,000

### SOFTBALL INFORMATION

Co-Head Coaches: Ralph & Karen Weekly  
Assistant Coach: Marty McDaniel  
2006 Record: 61-12  
2006 SEC/Finish: 21-9/2nd-East  
Overall Series Record: LSU leads 16-11  
2006 Series Record: UT won 3-1

### MEDIA INFORMATION

Softball SID: Brian Davis  
SID Office: (865) 974-7478  
SID Fax: (865) 974-8875  
SID E-mail: bdavis16@utk.edu  
Website: www.utladyvols.com  
Press Box: (865) 673-6693



## TEXAS-SAN ANTONIO

March 13 • 6 p.m.  
Baton Rouge, La.

### UNIVERSITY INFORMATION

Location: San Antonio, Texas  
Enrollment: 28,520  
Nickname: Roadrunners  
Colors: Navy Blue, Orange & White  
Conference: Southland  
Field: Roadrunner Field  
Capacity: 300

### SOFTBALL INFORMATION

Head Coach: Lori Cook  
Assistant Coaches: Stephanie Hughes, Michelle Cheatham  
2006 Record: 37-14  
2006 SLC/Finish: 22-5/1st  
Overall Series Record: LSU leads 2-0  
2006 Series Record: Did not play

### MEDIA INFORMATION

Softball SID: Kyle Stephens  
SID Office: (210) 458-4551  
SID Fax: (210) 458-4569  
SID E-mail: kyle.stephens@utsa.edu  
Website: www.goutsa.com  
Press Box: (210) 458-4898



## TEXAS STATE

Crowne Plaza Invitational  
Feb. 17 • 9 a.m.  
Houston, Texas

### UNIVERSITY INFORMATION

Location: San Marcos, Texas  
Enrollment: 27,503  
Nickname: Bobcats  
Colors: Maroon & Gold  
Conference: Southland  
Field: Bobcat Field  
Capacity: 1,000

### SOFTBALL INFORMATION

Head Coach: Ricci Woodard  
Assistant Coaches: Peejay Brun, Aimee Vaughn  
2006 Record: 34-22  
2006 SLC/Finish: 18-5/2nd  
Overall Series Record: LSU leads 2-0  
2006 Series Record: Did not play

### MEDIA INFORMATION

Softball SID: Chris Riley  
SID Office: (512) 245-2988  
SID Fax: (512) 245-2967  
SID E-mail: criley@txstate.edu  
Website: www.txstatebobcats.com  
Press Box: (512) 245-2654



## TROY

Easton Purple & Gold Challenge  
Feb. 24 • 1:30 p.m.  
Houston, Texas

### UNIVERSITY INFORMATION

Location: Troy, Ala.  
Enrollment: 27,113  
Nickname: Trojans  
Colors: Cardinal, Silver & Black  
Conference: Sun Belt  
Field: Lady Trojan Softball Complex  
Capacity: 500

### SOFTBALL INFORMATION

Head Coach: Melanie Davis  
Assistant Coach: Ashley Courtney  
2006 Record: 31-40  
2006 Sun Belt/Finish: 5-10/5th  
Overall Series Record: LSU leads 3-0  
2006 Series Record: LSU won 2-0

### MEDIA INFORMATION

Softball SID: Taylor Bryan  
SID Office: (334) 670-5654  
SID Fax: (334) 670-5665  
SID E-mail: bryant@troj.edu  
Website: www.troytrojans.com  
Press Box: (215) 454-9425



## WASHINGTON

University of Washington Tournament  
March 3 • 3:45 p.m.  
Seattle, Wash.

### UNIVERSITY INFORMATION

Location: Seattle, Wash.  
Enrollment: 34,000  
Nickname: Huskies  
Colors: Purple & Gold  
Conference: Pacific-10  
Field: Husky Softball Stadium  
Capacity: 1,500

### SOFTBALL INFORMATION

Head Coach: Heather Tarr  
Assistant Coaches: Eve Gaw, Geoff Hirai  
2006 Record: 35-25  
2006 Pac-10/Finish: 6-15/7th  
Overall Series Record: Tied 5-5  
2006 Series Record: LSU won 2-0

### MEDIA INFORMATION

Softball SID: Misty Tucci  
SID Office: (206) 685-3119  
SID Fax: (206) 543-5000  
SID E-mail: mistyrc@u.washington.edu  
Website: www.gohuskies.com  
Press Box: (206) 616-6936