

Project Name

Qty

Type

Catalog / Part Number



DF1R, DF2R and DF4R Housings Shown

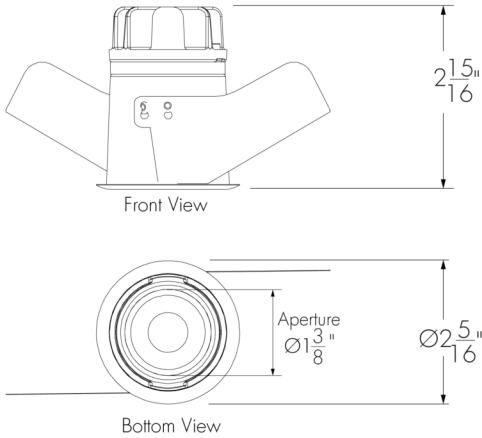

DF1R Housing Shown

Photometric Summary

Consult the Photometric Information section of the Specification Sheet for 3000K CRI 92 data. For all other configurations, consult IES files on the Lumenpulse website.

Color and Color Temperature

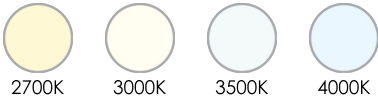

Color Rendering

CRI 92 CRI 98

Control

ON/OFF 0-10V Phase Dimming

Finish



Description

Fixed yet flexible, the DARK FIX Small has a 2-inch aperture and a complete set of optical choices for multiple applications. Play with beam spreads, finishes, number of heads, trim/trimless options, and accessories. These luminaires are typically used in environments where very low glare (UGR <10) is preferred to create an exclusive ambiance and are perfect for hospitality, restaurants, hotels, bars, high-end retail, or specific areas in workplace environments.

Features

Trim Shape

TR: Trim
TRL: Trimless

Output (Nominal Lumens)

L03: 300 lm
L04: 400 lm
L05: 500 lm
L07: 700 lm
L10: 1000 lm
L13: 1300 lm
L20: 2000 lm
L30: 3000 lm

Color and Color Temperature

27K: 2700K
30K: 3000K
35K: 3500K
40K: 4000K

Optic (Nominal Distribution)

NS: Narrow Spot 12°
ENS: Elliptical Narrow Spot 54° x 12°
S: Spot 15°
NF: Narrow Flood 25°
FL: Flood 35°
WFL: Wide Flood 40°
EWFL: Elliptical Wide Flood 47° x 72°

Trim Shape

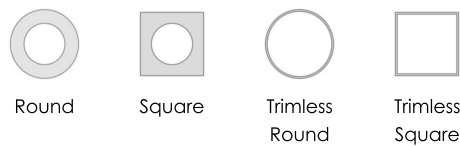

Certifications



Finish	MWHTX: Matte White Txt MBKTX: Matte Black Txt CGY: Concrete Grey GTX: Gold Txt CTX: Copper Txt
Installation Type	RM: Remodel Non-Insulated Ceiling (Non-Plenum Rated) NC: New Construction Non-Insulated Ceiling (Non-Plenum Rated) IC: Insulation Contact Mounting (Can be Used for Plenum Contact, and Air-Tight Mounting Box Applications)
Optical Accessories	Various optical accessories available, see Optical Accessories Section for details
Warranty	5-year limited warranty
Performance	
Maximum Delivered Output	Up to 945 lm (one fixture head, L07, CRI 92, 40K, FL)
Maximum Delivered Intensity	9,536 cd at nadir (one fixture head, L04, CRI 92, 40K, NS)
Efficacy	Up to 98 lm/W (one fixture head, L05, CRI 92, 40K, FL)
Color Rendering	92: CRI 92 98: CRI 98
Color Consistency	2 SDCM
Lumen Maintenance	L70 120,000 hours L95 19,000 hours
UGR	Optical configurations available to achieve <10 UGR. See IES files for performance data based on exact configurations.
Physical	
Housing Material	Die cast aluminum
Optics Material	Polymethyl methacrylate (PMMA)
Accessory Material	Nylon PA12 (accessory primary ring, and frame only)
Cutout	See Ceiling Requirements section of the specification sheet and installation instructions for details
Ceiling Thickness	0.2 in to 0.71 in
Weight	DF1R Housing With Trim: 0.49 lbs (fixture only) DF1R Housing, Trimless: 0.51 lbs (fixture only) DF1S Housing with Trim: 0.71 lbs (fixture only) DF1S Housing, Trimless: 0.73 lbs (fixture only) DF2R Housing With Trim: 1.28 lbs (fixture only) DF2R Housing, Trimless 1.31 lbs (fixture only) DF2S Housing With Trim: 1.28 lbs (fixture only) DF2S Housing, Trimless: 1.31 lbs (fixture only) DF4S Housing With Trim: 2.66 lbs (fixture only) DF4S Housing, Trimless: 2.69 lbs (fixture only) 0.77 lbs (RM Installation Type only) 1.65 lbs (NC Installation Type only) 5.07 lbs (IC Installation Type only) For total weight, combine weight of fixture and weight of installation type

Electrical and Control

Voltage	120/277: 120/277 Volts
Wattage Range	6.8 to 10.3 Watts (one head only)
Control	NO: On/Off Control DIM: 0-10V Dimming 1% PH: Phase Dimming 1%

Environmental

Ingress Protection Rating	IP40
Environment	Damp location (interior applications only)
Operating Temperature (Ceiling Cavity Ambient Temperature)	14 °F to 104 °F

Important

Virtual Patent Marking Notice

This website (<https://www.lmpg.com/patents-trademarks>) is provided to satisfy the virtual patent marking provisions of applicable jurisdictions. Some products listed may be covered by additional patents not referenced here.

Dimensions

DF1R Housing With Trim

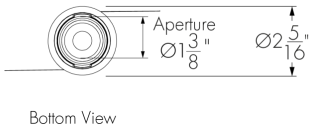
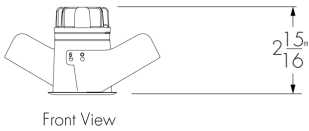

DF1S Housing With Trim

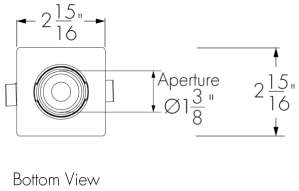
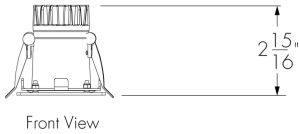

DF1R Housing Trimless

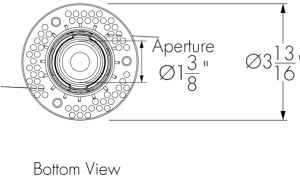
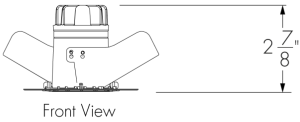

DF1S Housing Trimless

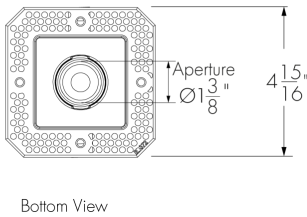
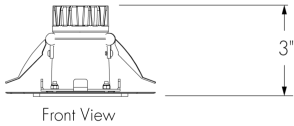

DF2R Housing With Trim



Front View

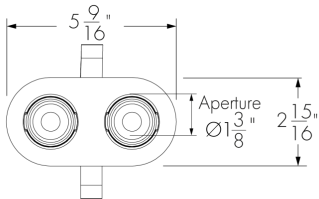

Bottom View

DF2S Housing With Trim

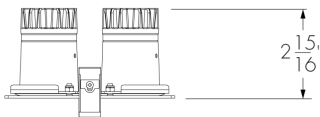

Front View

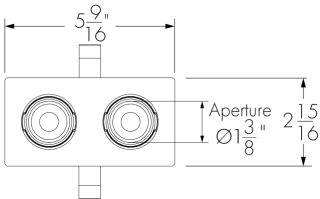

Bottom View

DF2R Housing Trimless

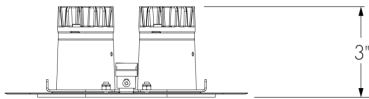

Front View

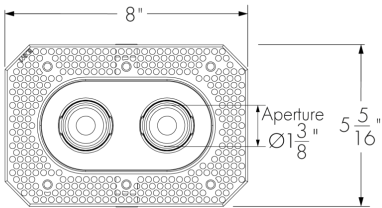

Bottom View

DF2S Housing Trimless



Front View

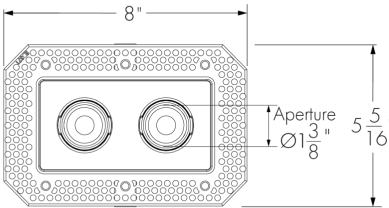

Bottom View

DF4R Housing with Trim

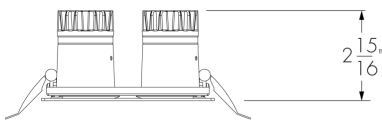

Front View

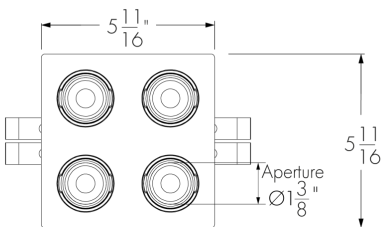

Bottom View

DF4S Housing with Trim

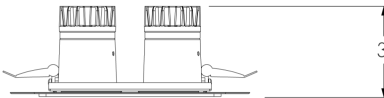

Front View

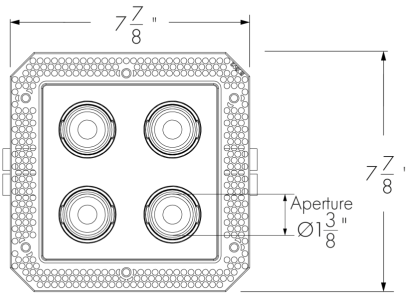

Bottom View

Photometric Information

Spot, L07, 3000K, CRI 92

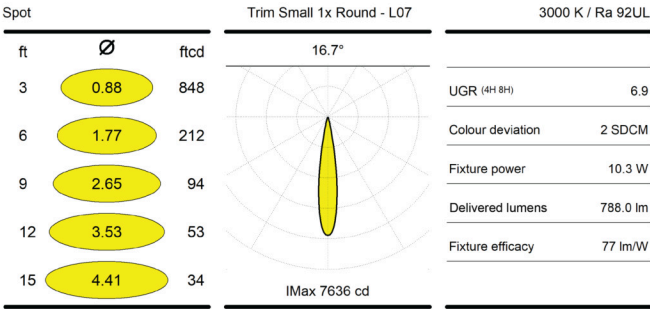

Narrow Flood, L07, 3000K, CRI 92

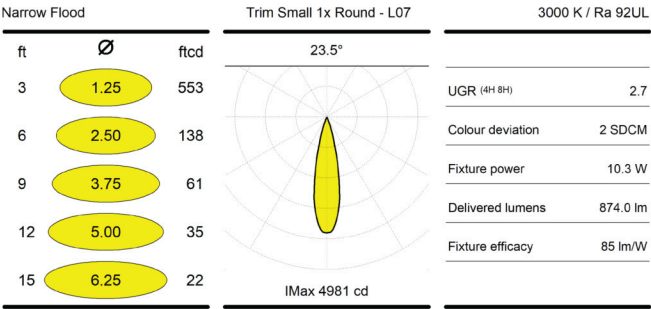

Flood, L07, 3000K, CRI 92

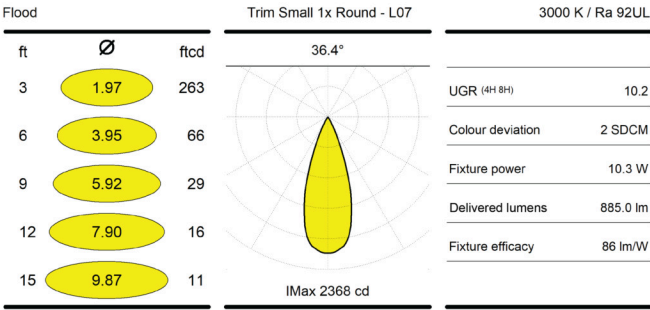

Wide Flood, L07, 3000K, CRI 92

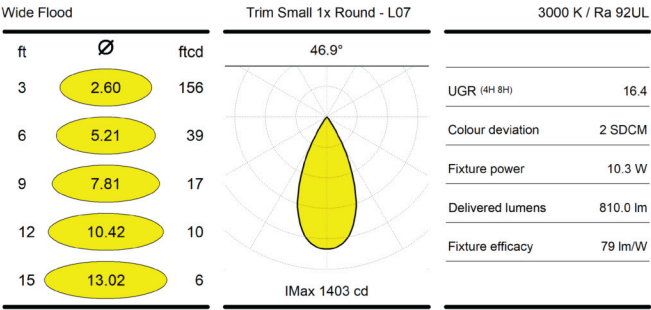

The photometric data shown is for one fixture head.
For all other configurations, consult IES files on the Lumenpulse website.

Optical Accessories

HL - Honeycomb

EL - Elliptical Lens

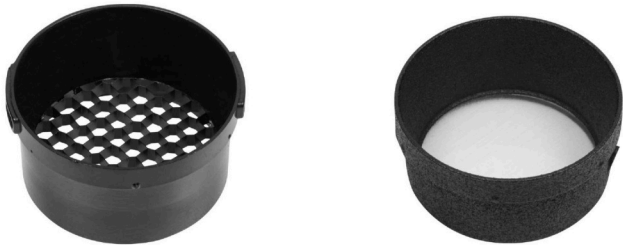

The same accessory will be factory-installed on each fixture head unless CM is specified in the product code. The CM option is available for DF2R, DF2S and DF4S housings only.
When the CM order code is specified, the accessories must be installed on site.
Consult factory for a different accessory for each fixture head.

Installation Types

**RM: Remodel Non-Insulated Ceiling
(Non-Plenum Rated)**

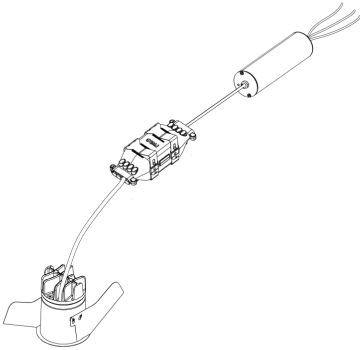

**NC: New Construction Non-Insulated Ceiling
(Non-Plenum Rated)**

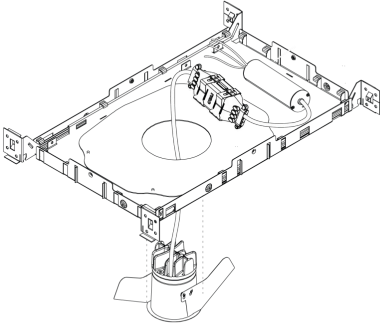

IC: Insulation Contact Mounting

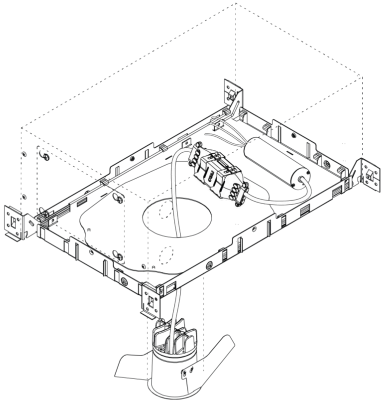

DF1R Housing Shown.

Refer to installation instructions for more details.

Ceiling Requirements

Ceiling Cutout

DF1R Housing With Trim

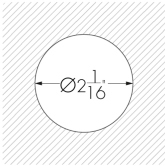

DF1S Housing With Trim and Trimless

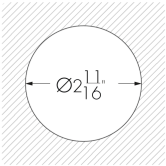

DF1R Housing Trimless

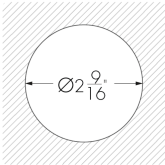

DF2R Housing With Trim and Trimless

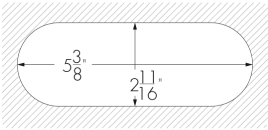

DF2S Housing With Trim

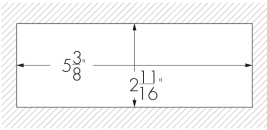

DF2S Housing Trimless

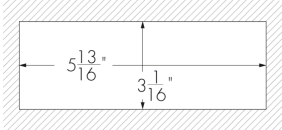

DF4S Housing With Trim and Trimless

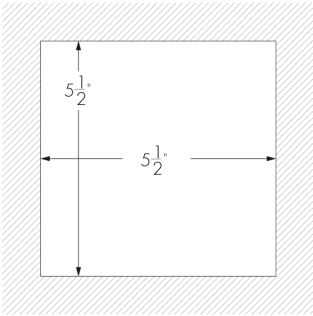

Refer to installation instructions for more details.

How to Order

Housing	Trim Shape	Size	Voltage	Control	Output (Nominal Lumens)	Finish	Color Rendering	Color and Color Temperature	Optic (Nominal Distribution)	Installation Type	Accessories ⁽¹⁸⁾
DF1R DARK FIX 1x Round ⁽¹⁾ ⁽²⁾ ⁽³⁾ DF1S DARK FIX 1x Square ⁽¹⁾ ⁽²⁾ ⁽³⁾ DF2R DARK FIX 2x Round ⁽⁴⁾ ⁽⁵⁾ ⁽⁶⁾ ⁽⁷⁾ DF2S DARK FIX 2x Square ⁽⁴⁾ ⁽⁵⁾ ⁽⁶⁾ ⁽⁷⁾ DF4S DARK FIX 2x2 Square ⁽⁸⁾ ⁽⁹⁾ ⁽¹⁰⁾ ⁽¹¹⁾	TR Trim TRL Trimless	SM Small	120/277 120/277 Volts	NO On/Off Control DIM 0-10V Dimming 1% PH Phase Dimming 1% ⁽¹²⁾	L03 300 lm L04 400 lm L05 500 lm L07 700 lm L10 1000 lm L13 1300 lm L20 2000 lm	MWHTX Matte White Txt MBKTX Matte Black Txt CGY Concrete Grey GTX Gold Txt CTX Copper Txt	92 CRI 92 98 CRI 98 ⁽¹³⁾	27K 2700K 30K 3000K 35K 3500K 40K 4000K	NS Narrow Spot 12° ⁽¹⁾ ⁽⁴⁾ ⁽⁸⁾ ⁽¹⁴⁾ ⁽¹⁵⁾ ENS Elliptical Narrow Spot 54° x 12° ⁽¹⁾ ⁽⁵⁾ ⁽⁹⁾ ⁽¹⁴⁾ ⁽¹⁶⁾ S Spot 15° ⁽⁶⁾ ⁽¹⁰⁾ ⁽¹⁷⁾ NF Narrow Flood 25° ⁽²⁾ ⁽⁶⁾ ⁽¹⁰⁾ FL Flood 35° ⁽²⁾ ⁽⁶⁾ ⁽¹⁰⁾ WFL Wide Flood 40° ⁽⁶⁾ ⁽¹⁰⁾ ⁽¹⁵⁾ ⁽¹⁷⁾ EWFL Elliptical Wide Flood 47° x 72° ⁽³⁾ ⁽⁷⁾ ⁽¹¹⁾ ⁽¹⁶⁾	RM Remodel Non- Insulated Ceiling (Non- Plenum Rated) NC New Construction Non- Insulated Ceiling (Non- Plenum Rated) IC Insulation Contact Mounting (Can be Used for Plenum Contact, and Air-Tight Mounting Box Applications)	NA No Accessory HL Honeycomb ⁽¹⁹⁾ EL Elliptical Lens ⁽²⁰⁾ CM Custom Accessory Combination ⁽²¹⁾ ⁽²²⁾

Notes:

1. When DF1R or DF1S Housing is combined with NS or ENS Optics, only L03 and L04 Outputs are available.

2. When DF1R or DF1S housing is combined with NF or FL optics, only L05 and L07 lumen outputs are available.

3. When DF1R or DF1S housing is combined with EWFL optic, only L04 and L05 lumen outputs are available.

4. When DF2R or DF2S housing is combined with NS optic, only L05 and L07 lumen outputs are available.

5. When DF2R or DF2S housing is combined with ENS optic, only L04, L05 and L07 lumen outputs are available.

6. When DF2R or DF2S housing is combined with S, NF, FL or WFL optics, only L07, L10 and L13 lumen outputs are available.

7. When DF2R or DF2S housing is combined with EWFL optic, only L07 and L13 lumen outputs are available.

8. When DF4S housing is combined with NS optic, only L10 and L13 lumen outputs are available.

9. When DF4S housing is combined with ENS optic, only L07, L10 and L13 lumen outputs are available.

10. When DF4S housing is combined with S, NF, FL or WFL optics, only L13 and L20 lumen outputs are available.

11. When DF4S housing is combined with EWFL optic, only L13 and L20 lumen outputs are available.

12. Phase dimming (PH) is only compatible with 120V power.
13. Available for S, NF, FL, WFL and EWFL optics only.

14. Available for CRI 92 only.

15. Not available for EL accessory.

16. Cannot be combined with accessories.

17. When DF1R or DF1S housing is combined with S or WFL optics, only L04 and L07 lumen outputs are available.

18. The same accessory will be factory-installed on each fixture head unless CM is specified in the product code. The CM option is available for DF2R, DF2S and DF4S housings only. When the CM order code is specified, the accessories must be installed on site.

19. Available with NS, S, NF, FL and WFL optics only.

20. Available with S, NF and FL optics only.

21. Available for DF2R, DF2S and DF4S housings only.

22. Consult factory for a different accessory for each fixture head.