

Project Name

Qty

Type

Catalog / Part Number

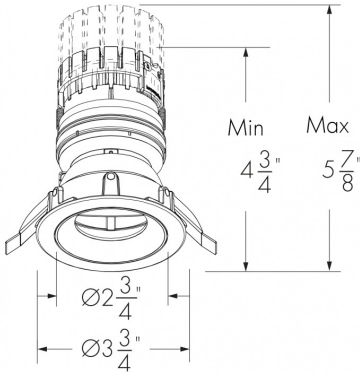
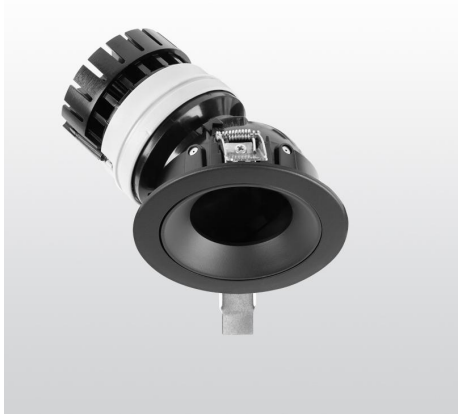

Round trim
(Shown with 1 in ceiling springs)
Round trim ceiling cutout: Ø3.25 in

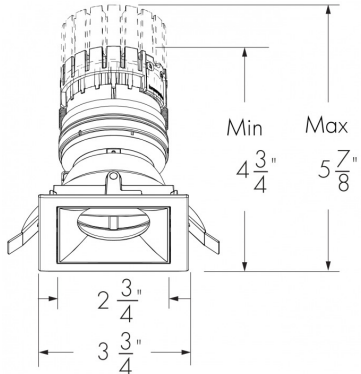

Square trim
(Shown with 1 in ceiling springs)
Square trim ceiling cutout: 3.25 in x 3.25 in

Photometric Summary

Based on Narrow Optic (nominal 25°), 4000K, CRI 80+, 0° Tilt

Nominal output [lm]	Delivered output [lm] ⁽¹⁾	Insulated ceiling		Non-insulated ceiling	
		Power (120V) [W]	Efficacy [lm/W]	Power (120V) [W]	Efficacy [lm/W]
700	503	7.5	67	9.5	53
1000	649	11	59	13	50
1300	900	13	69	15	60

[1] Consult website for latest IES files.

Optics



Color and Color Temperature

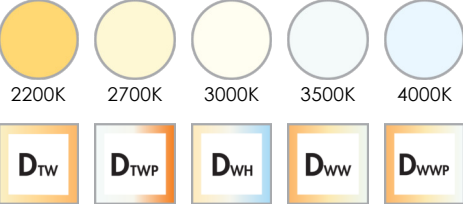

Color Rendering



Description

The Lumencore Nano Adjustable is a high-performance LED downlight for ceiling applications that can be rotated from 0°-358° and tilted 0°-40°. Available in an array of trims and finishes, outputs, optics, color renderings, and accessories, these luminaires are here to outperform. The Lumencore Nano Adjustable possesses a previously unseen lifespan, is quick to install, and can be used with a number of different control options.

Physical

Cutout	R: Round, S: Square
Decorative Bezel	ADB: Adjustable (0°- 358° rotation, 0°-40° tilt)
Trim	RD: Round, TLR: Trimless Round, SQ: Square, SR: Square Trim with Round Hole, TLS: Trimless Square
Ceiling Thickness	1: 0.04 in to 1 in ceiling thickness 2: 1.05 in to 2 in ceiling thickness
Housing Material	Aluminum
TIR Optics Material	Clear polycarbonate
Reflector Material	Aluminum
Weight	3 lbs with RM installation type, 4.2 lbs with NC installation type, 7.2 lbs with PC, IC, IC/AT and RMR installation types (Weights are approximate based on the heaviest fixture configuration)
Ceiling Space Requirements (Length x Width x Height)	Up to 15 in x 8 in x 12 in with RM installation type, Up to 15 in x 9 in x 12 in with NC installation type Up to 18 in x 15 in x 9 in with PC/IC/ICAT/RMR installation types (Dimensions will vary by output and color rendering, refer to Ceiling Requirements table for details.)

Controls

ON/OFF 0-10V PRO 0-10V PH
 PRO PH LUTRON DALI PRO DALI
 DALI8 DMXrdm lumen talk

Ceiling Cutout Shapes

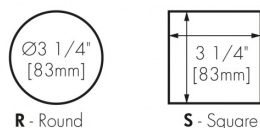

Decorative Bezel (Round Trim)



ADB - Adjustable

Decorative Bezel (Square Rim)



ADB - Adjustable

Standard Finishes for Decorative Bezel



Trim Shapes

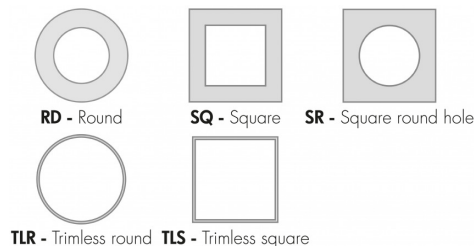

Features

Output (Nominal Lumens)	L07: 700 lm, L10: 1000 lm, L13: 1300 lm, L20: 2000 lm, L30: 3000 lm
Color and Color Temperature	22K: 2200K 27K: 2700K 30K: 3000K 35K: 3500K 40K: 4000K DTW: Dim to Warm DTWP: Dim to Warm Plus DWH: Dynamic White DWW: Dynamic Warm White DWWP: Dynamic Warm White Plus
Optics (Nominal Distribution)	XN: Extra Narrow Spot Distribution 5° VN: Very Narrow Spot Distribution 10° NS: Narrow Spot Distribution 15° N: Narrow Distribution 25° NFR: Narrow Faceted Reflector 25° M: Medium Reflector 40° MFR: Medium Faceted Reflector 40°
Decorative Bezel Finish	MWH: Matte White MBK: Matte Black NKS: Nickel Satin DCH: Dark Chrome BCH: Bright Chrome SWT: Satin Wheat CC: Custom color Trim (specify 4-digit RAL K7 color) SP: Special color (choose from standard Point Source color palette)
Trim Finish	MWH: Matte White MBK: Matte Black NKS: Nickel Satin CC: Custom color Trim (specify 4-digit RAL K7 color) SP: Special color (choose from standard Point Source color palette)
Installation Type	RM: Remodel non-insulated ceiling (non-Plenum rated) NC: New construction non-insulated ceiling (non-Plenum rated) PC: Plenum Non-Insulated Ceiling (enclosed box) IC: New Construction Insulated Ceiling (enclosed box) IC/AT: New Construction Insulated Ceiling (Chicago Plenum/airtight, enclosed box) RMR: Remote Recessed Insulated Ceiling/Plenum (enclosed box)
Option	EBB: Emergency Battery Backup with Hanger Bar (Bodine BSL17C-C2) EBI: Emergency Battery Backup with Hanger Bar (Iota ILB-CP07-A TBTS)
Certifications	UL compliant, RoHS
Warranty	5-year limited warranty
Performance	
Color Rendering	CRI 80+, CRI 90+, CRI 95+, CRI 80+, CRI 90+, CRI 95+

Standard Finishes for Trim



MWH - Matte white



MBK - Matte black



NKS - Nickel satin

CC - Custom color
and finish
(Please specify
4-digit RAL K7
color)SP - Special color
(choose from standard
Point Source
color palette)

Adjustability

0° - 358° rotation



0° - 40° tilt

ADB - Adjustable decorative bezel

Options

Emergency
battery backup

Rating

IP20

Certifications



Maximum Delivered Output	Up to 1,634 lm (Medium Faceted Reflector optic 40°, 4000K, CRI 80, 0° tilt)
Maximum Delivered Intensity	Up to 28,125 cd (Extra Narrow Spot optic 5°, 4000K, CRI 80, 0° tilt)
Efficacy	Up to 69 lm/W (Narrow Spot distribution optic 15°, 4000K, CRI 80, 120V, New Construction Non-insulated Ceiling, 0° tilt), Up to 80 lm/W (Narrow Spot distribution optic 15°, 4000K, CRI 80, 120V, New Construction Insulated Ceiling, 0° tilt)
Color Consistency	2 SDCM, 3 SDCM (XN optic only)
Lumen Maintenance	L95 55,000 hrs (Ta 25 °C) L70 225,000 hrs (Ta 25 °C)

Electrical and control

Voltage	120: 120 volts, 277: 277 volts, 347: 347 volts
Wattage Range	8.5W to 30W (wattage will vary based on voltage, output, color temperature, color rendering, optic, control and installation type, refer to Power Consumption table for details)
Control	NO: On/Off control NO3: On/Off control 347V DAMC: Standard 0-10V dimming to 1% linear curve DA1: Standard 0-10V dimming 1% linear DA2: Standard 0-10V dimming 1% logarithmic DA3: Standard 0-10V dimming 1% linear (347V) PDA1: Pro 0-10V dimming 0.1% linear PDA2: Pro 0-10V dimming 0.1% logarithmic PH: Phase dimming PPH: Pro Phase 1% dimming ESP: Lutron® Hi-lume Premier 0.1% EcoSystem® PEQ0 Soft-on/Fade-to-Black (temporarily unavailable) SDALI1: Standard DALI dimming 1% linear SDALI2: Standard DALI dimming 1% logarithmic DALI1: Pro DALI dimming 0.1% linear DALI2: Pro DALI dimming 0.1% logarithmic DALI8: DALI-2 dimming Type 8 (multi channel capability) DMX/RDM: DMX/RDM (configurable to 1, 2, or 3 channel control via RDM in the field) LT: Lumentalk dimming

Environmental

Ingress Protection Rating	IP20
Environment	Damp location rating (interior applications only)
Operating Temperature (Ceiling Cavity Ambient Temperature)	-4 °F to 104 °F (DA1, DA2, DA3, PDA1, PDA2, SDALI1, SDALI2, DALI1, DALI2, DALI8, LT, DMX/RDM, PH and PPH control options), 14 °F to 104 °F (NO control option), 32 °F to 104 °F (NO3, ESP control options and EBB and EBI options)

Delivery - How It Works

Standard Shipping (1 delivery)

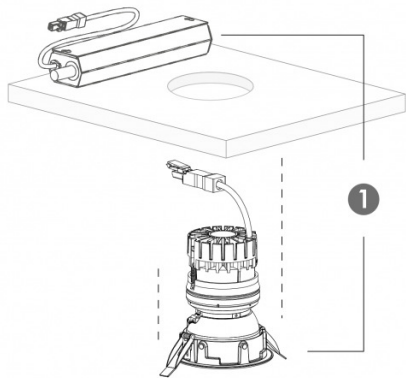

Included

- 1. MTG Mounting kit and complete fixture assembly

Advanced Shipping of Mounting kit (2 Separate Deliveries)

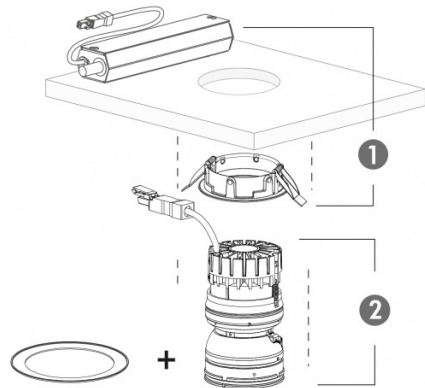

Included

- 1. Optional advanced delivery: MTG Mounting kit and ceiling mounting ring
- 2. Second delivery: LUM Core (heatsink, universal fixing ring, LED module, optic, accessories, adjustable bezel) and trim

Consult factory for Advanced Shipping details.

Exploded Overview - Part Selection

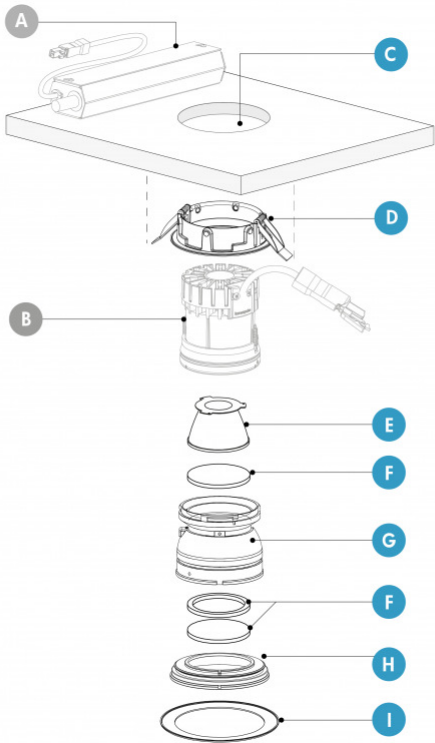

Standard Parts

- A - MTG Mounting kit
- B - LUM Core (heatsink, universal fixing ring, LED module)
- MTG: Mounting Kit
- LUM: Luminaire

Customizable Parts

- C - Ceiling cutout shape (round or square)
- D - Ceiling mounting ring (round or square, based on ceiling cutout selection)
- E - Optic*
- F - Optical accessory and accessory holder (up to two optical accessories can be combined in the fixture, position will vary by accessory type)**
- G - Adjustable mechanism
- H - Adjustable decorative bezel
- I - Trim (round or square, based on ceiling ring selection)

*Optic is field changeable. Consult Interchangeable Optics section of the specification sheet for details.
**Field changeable, consult installation instructions for details. Consult factory for ordering details.

Ceiling Cutout Shape Options

RD - Round Ceiling Cutout

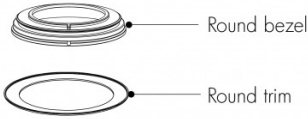

SQ - Square Ceiling Cutout

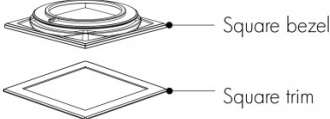

Decorative Bezel Options

RD - Compatible Round Decorative Bezels



SQ - Compatible Square Decorative Bezels



Standard Finishes - Decorative Bezels



*Custom color: specify 4-digit RAL K7 color.

**Special color: choose one of the standard Point Source colors from the Cylinders product brochure or specification sheets. Contact manufacturer for additional information.

Trim Shape Options

RD - Compatible Round Trim Shapes



RD - Round



SR - Square trim with round hole



TLR - Trimless round

SQ - Compatible Square Trim Shapes



SQ - Square



TLS - Trimless Square

Standard Finishes - Trims



MWH - Matte white



MBK - Matte black



NKS - Nickel satin



CC - Custom colour*



SP - Special colour**

*Custom color: specify 4-digit RAL K7 color.
**Special color: choose one of the standard Point Source colors from the Cylinders product brochure or specification sheets. Contact manufacturer for additional information.

Dimensions

Adjustability (L07, L10, L13)

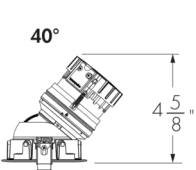
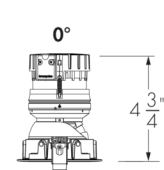

ADB - Adjustable (0°- 358° Rotation, 0°-40° Tilt)
L07, L10, L13

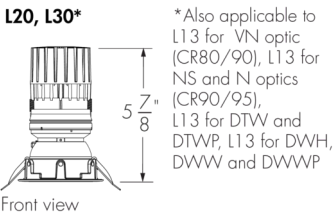
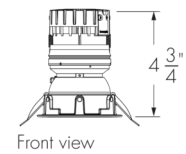

RD - Round Shape, Round Trim

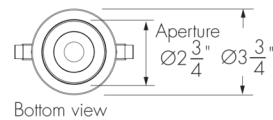

SQ - Square Shape, Square Trim

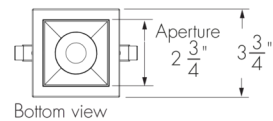

SR - Square Shape, Round Hole

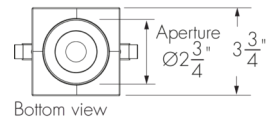

Round ceiling cutout: Ø3.25 in
Square ceiling cutout: 3.25 in x 3.25 in

Adjustability (L20, L30)

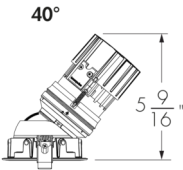
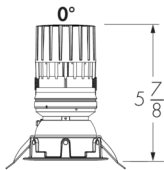

ADB - Adjustable (0°-358° Rotation, 0°-40° Tilt, Trimless Version)
L07, L10, L13

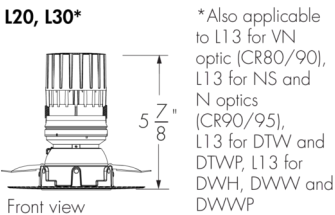
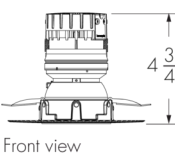

TLR - Trimless Round

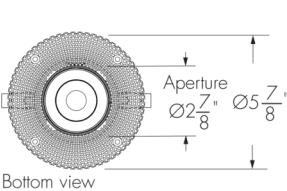

TLS - Trimless Square

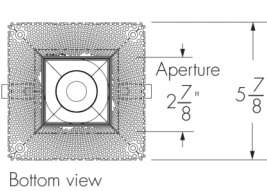

Beam Cutoff Angle

ADB - Adjustable (0° Tilt)

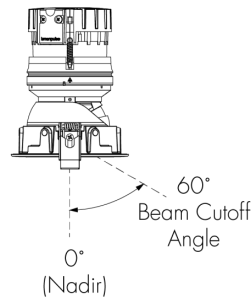

Side view
(Based on 0° tilt)

ADB - Adjustable (40° Tilt)

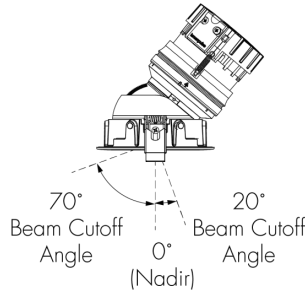

Side view
(Based on 40° max tilt)

Adjustability

Pre-set and lock the angle

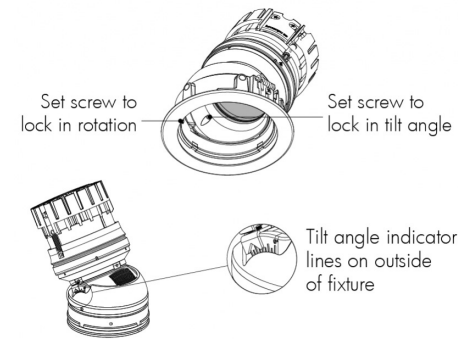

Refer to installation instructions for details.

0° to 40° Tilt Adjustment

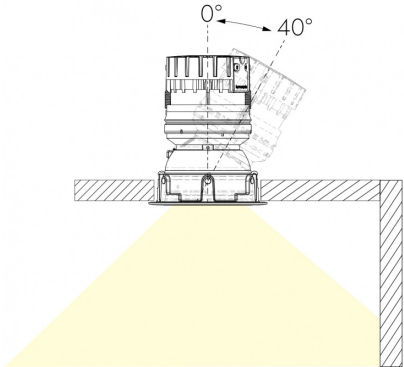

358° Rotation

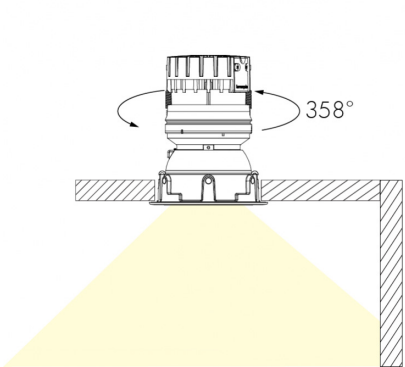

TM-30

CRI 80+

CRI 80 +				
CCT	CIE		TM-30	
3500K	R _a	84	84	R _f
	R ₉	15	97	R _g

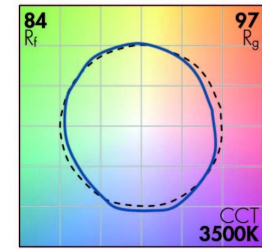

CRI 90+

CRI 90 +				
CCT	CIE		TM-30	
3500K	R _a	92	90	R _f
	R ₉	59	98	R _g

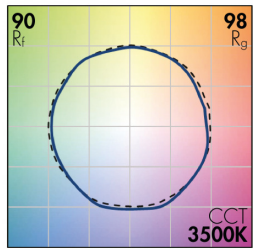

CRI 95+

CRI 95 +				
CCT	CIE		TM-30	
3500K	R _a	97	91	R _f
	R ₉	97	99	R _g

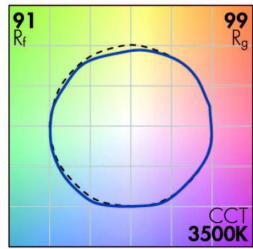

Refer to TM-30 Reference Guide for details.

Color and Color Temperature

Color Temperature Ranges

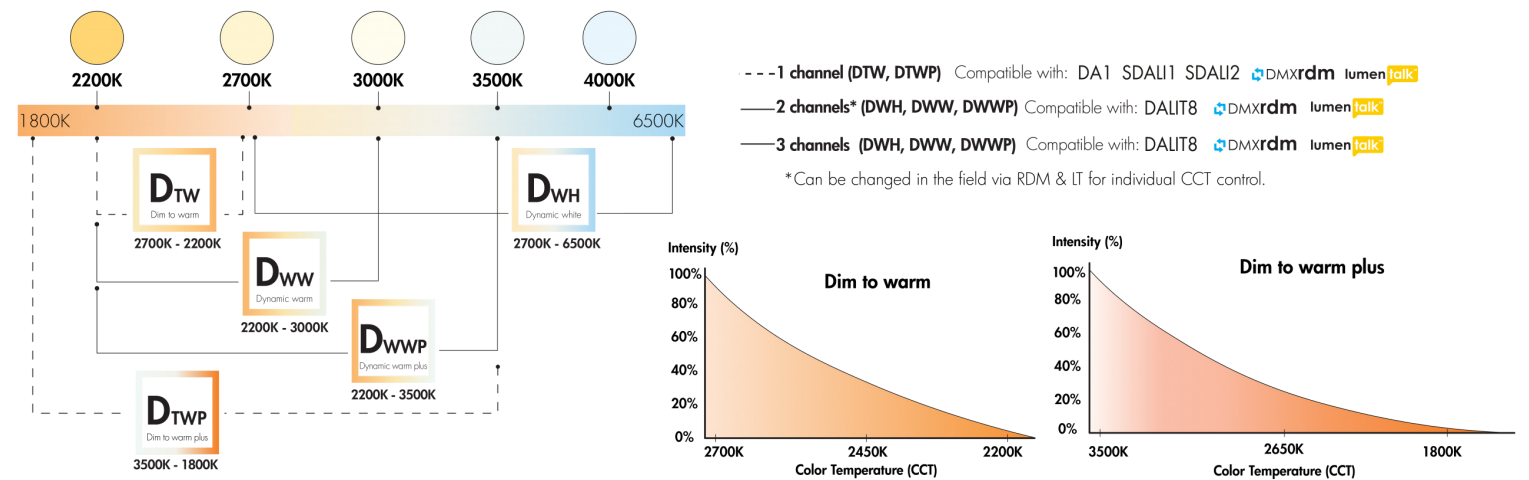

Control

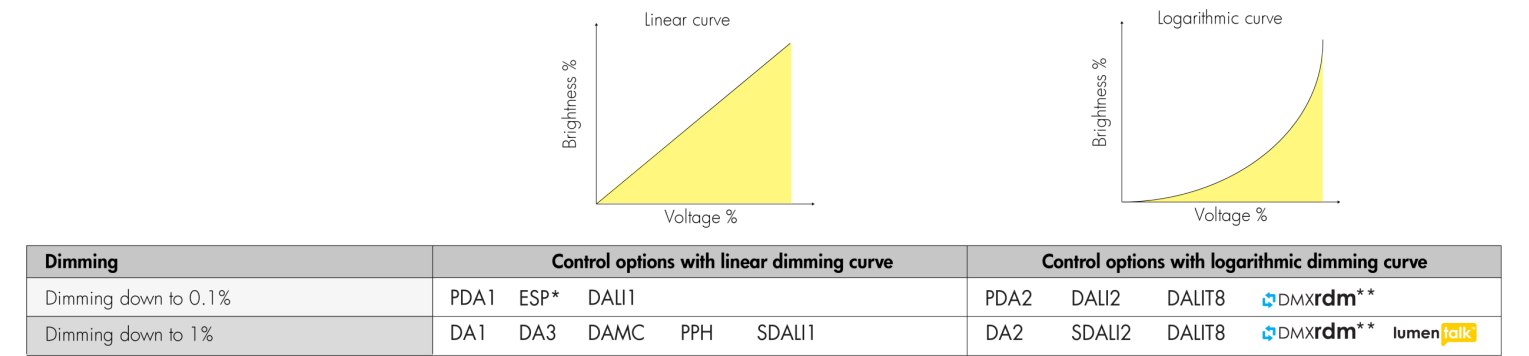

*Temporarily unavailable, consult factory.

**DMX/RDM control can be programmed onsite via RDM for linear dimming curve option. Logarithmic curve is standard from factory. Consult factory for further details.

Refer to website product code for exceptions.

Optics

TIR Optic - Total Internal Reflection



Applicable to XN (5°), VN (10°), NS (15°) and N (25°) distributions.

Semi-Specular Reflector



Applicable to M (40°) distribution.

Faceted Reflector



Applicable to NFR (25°) and MFR (40°) distributions.

Beam Widening Lenses

	Optic installed in fixture						
	XN 5°	VN 10°	NS 15°	N 25°	NFR 25°	M 40°	MFR 40°
BW1	11°	14°	21°	26°	26°	51°	51°
BW2	21°	22°	27°	31°	31°	54°	54°
BW3	30°	32°	35°	38°	38°	58°	58°

The above beam angles are nominal beam angles.
Variations in beam angles can be seen due to different LES sizes. For exact beam calculations please consult factory.
Beam widening lenses should not be used with other accessories with the nominal results above.

Interchangeable Optics

	Optic installed in fixture						
	XN 5°	VN 10°	NS 15°	N 25°	NFR 25°	M 40°	MFR 40°
Interchangeable optics	N/A	N/A	N NFR	NS NFR	NS N	MFR	M

The optic options listed above are field changeable. Consult factory and installation instructions for details.

Power Consumption

Static White Color Temperatures

Power consumption [W]									
Output [lm]	XN (5°) - VN (10°)		NS (15°) - N (25°) - NFR (25°)				M (40°) - MFR (40°)		
	120 V	277 V	120 V		277 V		120 V		277 V
	CR80/CR90		CR80	CR90/CR95	CR80	CR90/CR95	CR80	CR90/CR95	CR80 CR90/CR95
700	13	15	9.5	10	10.5	12	8.5	9	9.5 11
1000	17*	18*	13	14.5	14	16	10	13	12 15
1300	23*	24*	15	20	16	21	13	15	15 16
2000	N/A	N/A	23**	N/A	24**	N/A	20	23	21 24
3000	N/A	N/A	N/A	N/A	N/A	N/A	30	N/A	30 N/A

*Not applicable to XN optic.
**Not applicable to NS and N optics.

Dynamic Colors

Power consumption [W]				
Output [lm]	NFR (25°) - M (40°) - MFR (40°)			
	120 V		277 V	
	DTW - DTWP	DWW - DWH - DWWP	DTW - DTWP	DWW - DWH - DWWP
1000	14	N/A	15	N/A
1300	17	26	19	26

- Power consumption values are for non-insulated ceiling (RM and NC) and remote recessed insulated ceiling/plenum (RMR) installation types. For plenum ceiling (PC), new construction insulated ceiling (IC and IC/AT) installation types, remove 2 watts per fixture.
- Add 3 watts per fixture when specifying LT control option.
- Add 2 watts per fixture when specifying DMX/RDM control option.
- Add 4 watts per fixture when specifying 347V.

Photometric Information

XN - Extra Narrow Spot (Nominal 5°), 4000K, 0° Tilt

Nominal output [lm]	Delivered output [lm]†	
	CR80	CR90
700	635	571

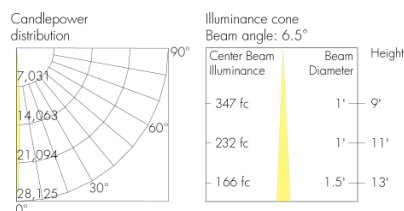

XN - Extra Narrow Spot (Nominal 5°), 4000K, 30° Tilt*

Nominal output [lm]	Delivered output [lm]†	
	CR80	CR90
700	533	480

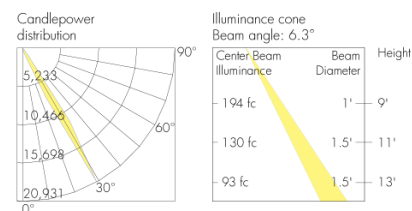

VN - Very Narrow Spot (Nominal 10°), 4000K, 0° Tilt

Nominal output [lm]	Delivered output [lm]†	
	CR80	CR90
700	655	589
1000	846	761
1300	1,175	1,057

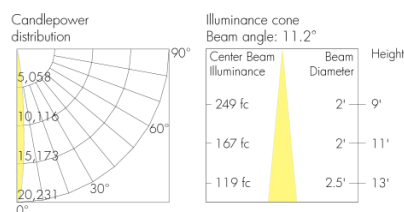

VN - Very Narrow Spot (Nominal 10°), 4000K, 30° Tilt*

Nominal output [lm]	Delivered output [lm]†	
	CR80	CR90
700	536	482
1000	765	689
1300	995	896

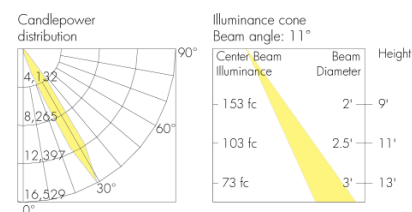

NS - Narrow Spot (Nominal 15°), 4000K, 0° Tilt

Nominal output [lm]	Delivered output [lm]†		
	CR80	CR90	CR95
700	581	604	518
1000	751	782	670
1300	1,042	1,087	930

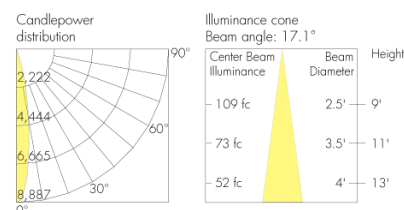

NS - Narrow Spot (Nominal 15°), 4000K, 30° Tilt*

Nominal output [lm]	Delivered output [lm]†		
	CR80	CR90	CR95
700	507	532	456
1000	667	700	600
1300	908	954	817

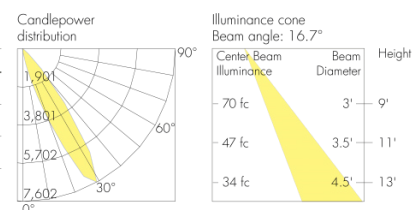

N - Narrow (Nominal 25°), 4000K, 0° Tilt

Nominal output [lm]	Delivered output [lm]†		
	CR80	CR90	CR95
700	503	524	449
1000	649	676	579
1300	900	939	804

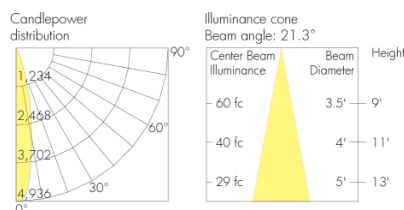

N - Narrow (Nominal 25°), 4000K, 30° Tilt*

Nominal output [lm]	Delivered output [lm]†		
	CR80	CR90	CR95
700	455	478	410
1000	599	629	539
1300	815	856	734

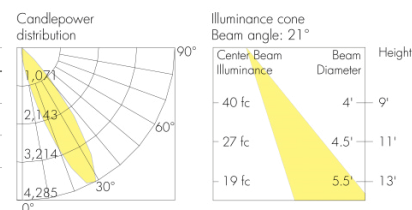

NFR - Narrow Faceted Reflector (Nominal 25°), 4000K, 0° Tilt

Nominal output [lm]	Delivered output [lm]†		
	CR80	CR90	CR95
700	486	506	434
1000	628	654	561
1300	871	909	778
2000	1,358	N/A	N/A

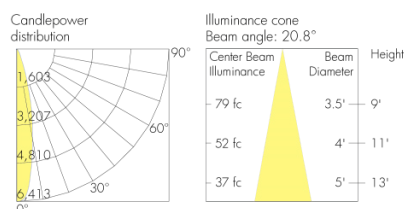

NFR - Narrow Faceted Reflector (Nominal 25°), 4000K, 30° Tilt*

Nominal output [lm]	Delivered output [lm]†		
	CR80	CR90	CR95
700	437	459	393
1000	575	604	518
1300	783	823	705
2000	1,224	N/A	N/A

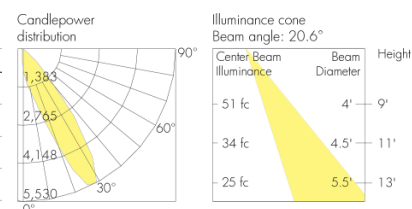

M - Medium Reflector (Nominal 40°), 4000K, 0° Tilt

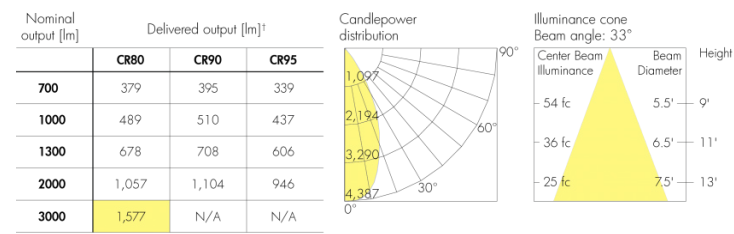

M - Medium Reflector (Nominal 40°), 4000K, 30° Tilt*

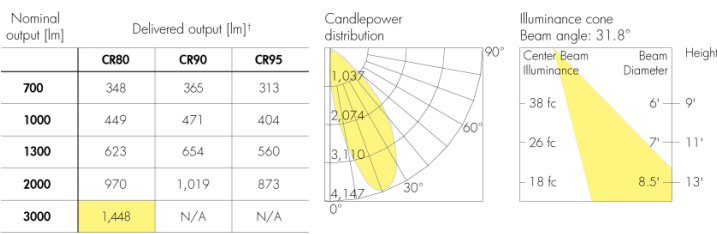

MFR - Medium Faceted Reflector (Nominal 40°), 4000K, 0° Tilt

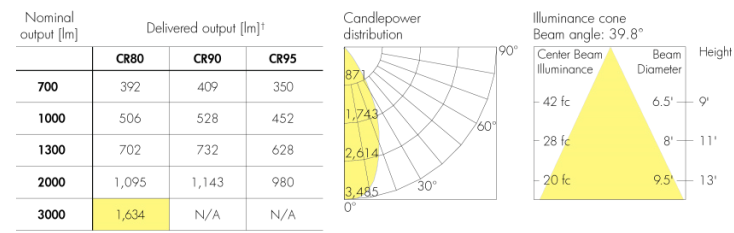

MFR - Medium Faceted Reflector (Nominal 40°), 4000K, 30° Tilt*

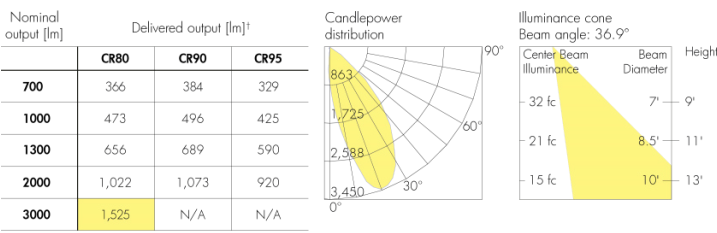

*Based on Adjustable Bezel (set at 30°) and Round or Square trim configuration. The full tilt range of the fixture is 0°-40°.

† Consult website for IES files. Delivered output: +/- 10% tolerance.

Consult Power consumption section for more wattage information.

Ceiling Requirements

Ceiling Cavity Space Requirements (Length x Width x Height)

Installation type	Control	Output/Color Rendering					
		L07	L10	L13	L20		L30
		CR80/90/95			CR80	CR90/95	L40
RM	NO/PH/ESP	12"x 8"x 6" (with trim) 12"x 8"x 8" (trimless)			12"x 10"x 8"		N/A
	DA/DAMC/PDA/SDALI/DALI/LT/DMX-RDM	15"x 8"x 8" (with trim) 15"x 8"x 12" (trimless)					N/A
NC	NO/PH/ESP	15"x 10"x 6" (with trim) 15"x 10"x 8" (trimless)			15"x 10"x 8"		N/A
	DA/DAMC/PDA/SDALI/DALI/LT/DMX-RDM	15"x 10"x 8" (with trim) 15"x 9"x 12" (trimless)					N/A
PC/IC/ICAT/RMR	ALL	14.5"x 10"x 7"			18"x 15"x 9"		N/A

See Installation Type section for dimensional view of keep out and/or MTG mounting kit option.
Above dimensions include any keep out requirements for proper airflow and thermal cooling.

Ceiling Cutout

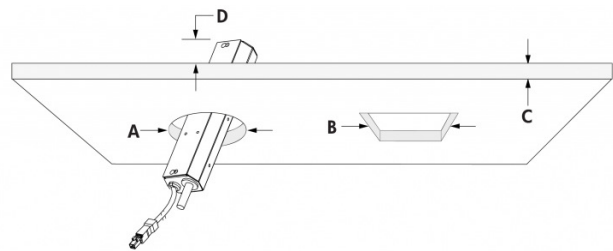

- A - Ceiling cutout: Ø3.25 in
- B - Ceiling cutout: 3.25 in x 3.25 in
- C - Maximum ceiling thickness: 2 in
- D - Minimum ceiling height: refer to Ceiling Cavity Space Requirements table

Ceiling Thickness Options

Ceiling Thickness 1

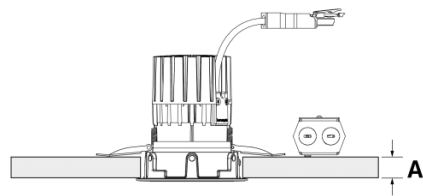

- A - Ceiling thickness range: 0.04 in to 1 in

Ceiling Thickness 2

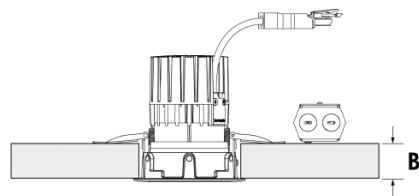

- B - Ceiling thickness range: 1.05 in to 2 in

Ceiling springs are field changeable, consult installation instructions and factory for details.

Installation Types

RM: Remodel Non-Insulated Ceiling (Non-Plenum Rated) (NO, PH, ES and ESP Controls Only)

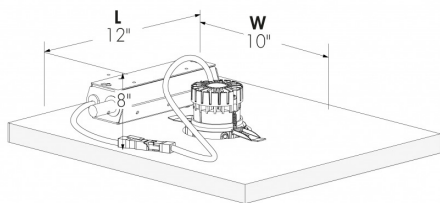

Ceiling cavity space requirements for L20 CR90/95 and L30 CR80 shown.

RM: Remodel Non-Insulated Ceiling (Non-Plenum Rated) (Other Controls)

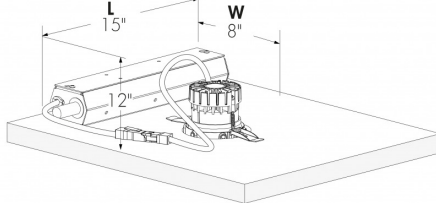

Ceiling cavity space requirements up to L20 CR90/95 and L30 CR80 shown, trimless version.

NC: New Construction Non-Insulated Ceiling (Non-Plenum Rated) (NO, PH, ES and ESP Control Options Only)

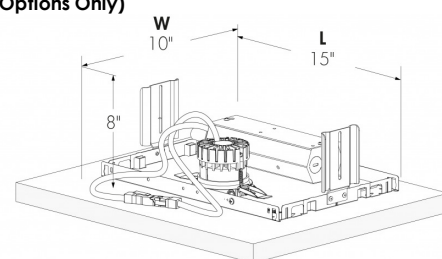

Ceiling cavity space requirements for L20 CR90/95 and L30 CR80 shown.

NC: New Construction Non-Insulated Ceiling (Non-Plenum Rated) (Other Controls)

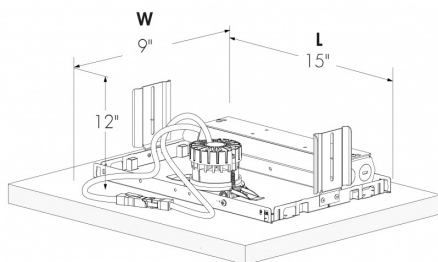

Ceiling cavity space requirements up to L20 CR90/95 and L30 CR80 shown, trimless version.

IC, PC, IC/AT: New Construction Insulated and Non-Insulated Ceiling (Enclosed Box)

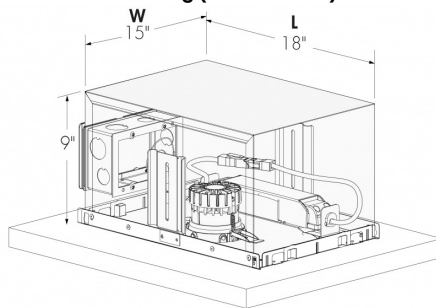

IC - New construction insulated ceiling (enclosed box)

PC - Plenum non-insulated ceiling (enclosed box)

IC/AT - New construction insulated ceiling (Chicago Plenum/airtight, enclosed box)

Ceiling cavity space requirements for L13 CR80/90/95 and L20 CR80 shown.

RMR: Remote Recessed Insulated Ceiling/Plenum (Enclosed Box)

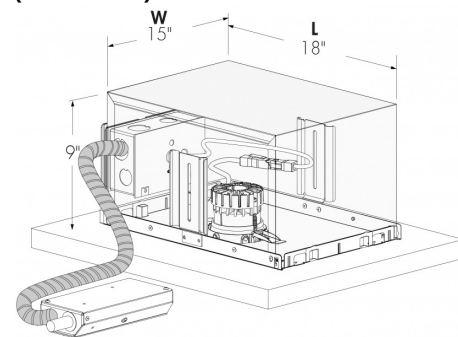

Luminaire ceiling cavity space requirements for L13 CR80/90/95 and L20 CR80 shown. Refer to remote driver box dimensions in installation instructions for space required for driver.

Remote distance is a maximum of 75 ft, consult Lumenpulse Application Engineering Team for longer remote distances.

Fixture shown for reference only. Refer to Ceiling Requirements section and installation instructions for dimensions and ceiling cutout requirements.

Options

EBB - Emergency Battery Backup With Hanger Bar (Bodine BSL17C-C2)

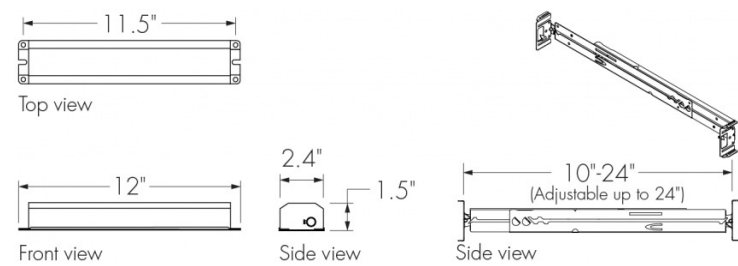

Hardware to mount the battery backup to the hanger bar is included. A test button is included. The unit comes pre-wired with 2 ft flexible conduit in and out. Refer to installation instructions for details.

EBI - Emergency Battery Backup With Hanger Bar (Iota ILB-CP07-A TBTS)

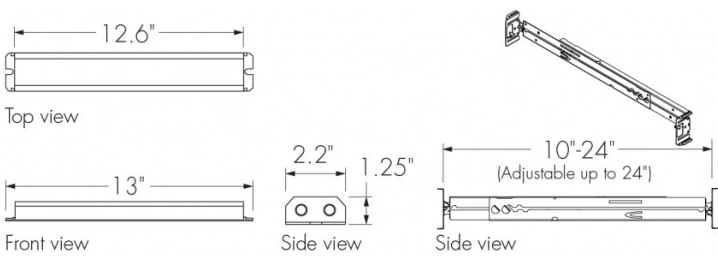

Hardware to mount the battery backup to the hanger bar is included. A test button is included. The unit comes pre-wired with 2 ft flexible conduit in and out. Refer to installation instructions for details.

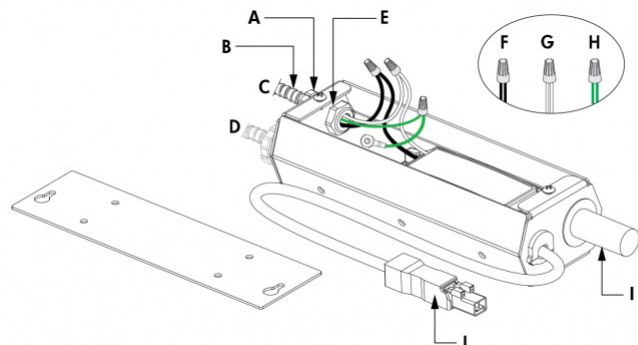
Wiring Details RM: Remodel Non-Insulated Ceiling (Non-Plenum Rated)**NO And PH Controls - Wiring Detail**

- A - Conduit fitting (by others)
- B - Conduit (by others)
- C - Power Input
- D - Optional Output
- E - Locknut (by others)
- F - Line
- G - Neutral
- H - Ground
- I - Thermal protector
- J - Output to luminaire

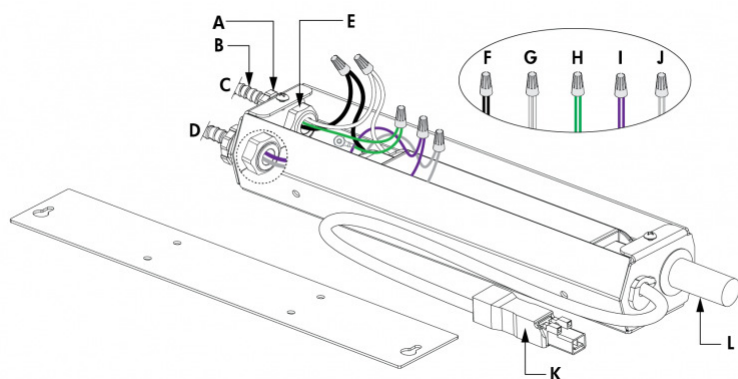
Other Controls - Wiring Detail

- A - Conduit fitting (by others)
- B - Conduit (by others)
- C - Power Input
- D - Data Input from Control System
- E - Locknut (by others)
- F - Line
- G - Neutral
- H - Ground
- I - Data +
- J - Data -
- K - Output to luminaire
- L - Thermal protector

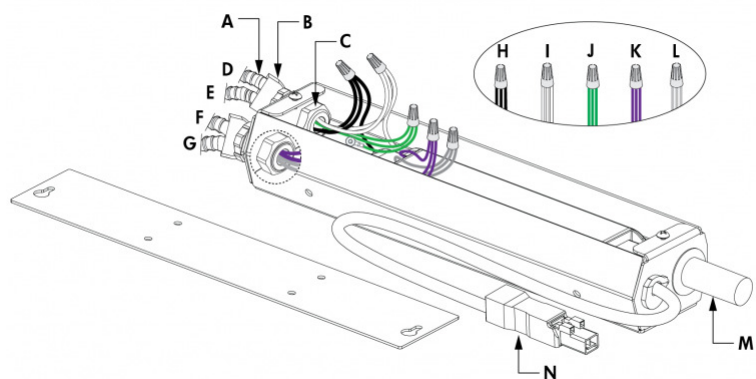
Other controls - daisy chain layout wiring detail

- A - Conduit (by others)
- B - Duplex connector (by others)
- C - Locknut (by others)
- D - Power Output to next luminaire
- E - Power input
- F - Data Output to next luminaire
- G - Data Input from Control System
- H - Line
- I - Neutral
- J - Ground
- K - Data +
- L - Data -
- M - Thermal protector
- N - Output to luminaire

Remodel driver box varies by control option. Refer to installation instructions for additional wiring details.

Optical Accessories

HL - Honeycomb Louver

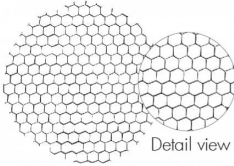

XLVR - Concentric Ring Louver



CL - Clear Glass Lens



SL - Softening Glass Lens



PD - Prismatic Diffuser

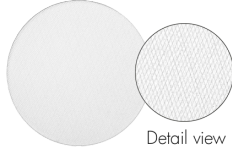

LSN - Linear Spread Lens Narrow (1° x 40°)

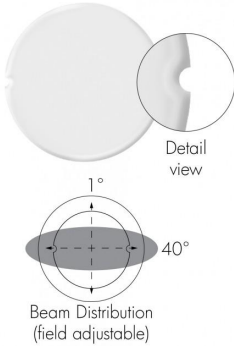

LSW - Linear Spread Lens Wide (1° x 60°)

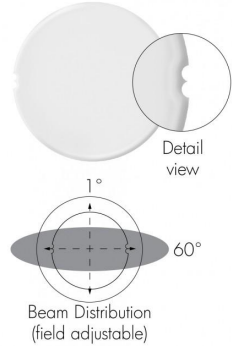

BW1 - Beam Widening Lens (+10°)

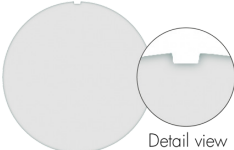

BW2 - Beam Widening Lens (+20°)

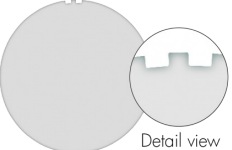

BW3 - Beam widening lens (+30°)

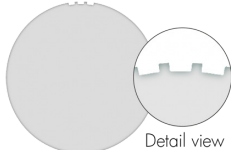

Refer to Beam Widening Lens table for beam distribution based on optic installed in the fixture.

Refer to Beam Widening Lens table for beam distribution based on optic installed in the fixture.

Refer to Beam Widening Lens table for beam distribution based on optic installed in the fixture.

Optical Accessories - Installation Options (Field Changeable)

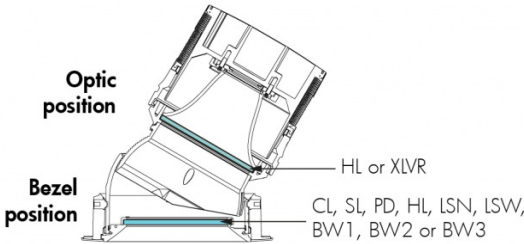

Accessories specified in the fixture code will ship from the factory in the position shown above.

How to Order

Housing ⁽¹⁾	Quickship	Certification	Type	Voltage	Cutout	Output (Nominal Lumens)	Color and Color Temperature	Color Rendering	Optics (Nominal Distribution)	Control ⁽¹⁹⁾
LCRN Lumencore Nano - 2.75 in aperture	QS Quickship ⁽²⁾	A UL/cUL	AD Adjustable	120 120 volts 277 277 volts 347 347 volts ⁽³⁾ ⁽⁴⁾ ⁽⁵⁾	R Round S Square	L07 700 lm L10 1000 lm L13 1300 lm L20 2000 lm L30 3000 lm ⁽⁶⁾ ⁽⁷⁾	22K 2200K ⁽⁸⁾ ⁽⁹⁾ 27K 2700K ⁽⁹⁾ 30K 3000K ⁽⁹⁾ 35K 3500K ⁽⁹⁾ 40K 4000K ⁽⁹⁾ DTW Dim to Warm (2700K to 2200K) ⁽¹⁰⁾ ⁽¹¹⁾ DTWP Dim to Warm Plus (3500K to 1800K) ⁽¹⁰⁾ ⁽¹¹⁾ DWH Dynamic White (2700K to 6500K) ⁽¹²⁾ ⁽¹³⁾ DWW Dynamic Warm White (2200K to 3000K) ⁽¹²⁾ ⁽¹³⁾ DWWP Dynamic Warm White Plus (2200K to 3500K) ⁽¹²⁾ ⁽¹³⁾	80 CRI 80+ 90 CRI 90+ 95 CRI 95+	XN Extra Narrow Spot Distribution 5° ⁽¹⁴⁾ VN Very Narrow Spot Distribution 10° ⁽¹⁵⁾ NS Narrow Spot Distribution 15° ⁽¹⁶⁾ N Narrow Distribution 25° ⁽¹⁶⁾ NFR 25° Faceted Reflector ⁽¹⁷⁾ M 40° Reflector ⁽¹⁸⁾ MFR 40° Faceted Reflector ⁽¹⁸⁾	NO On/Off control ⁽²⁰⁾ ⁽²¹⁾ NO3 On/Off control 347V ⁽³⁾ ⁽⁴⁾ ⁽²²⁾ DAMC Standard 0-10V dimming to 1% linear curve ⁽⁵⁾ ⁽²¹⁾ ⁽²³⁾ ⁽²⁴⁾ DA1 Standard 0-10V dimming 1% linear ⁽²¹⁾ ⁽²⁵⁾ DA2 Standard 0-10V dimming 1% logarithmic ⁽²¹⁾ ⁽²⁵⁾ DA3 Standard 0-10V dimming 1% linear (347V) ⁽³⁾ ⁽⁴⁾ ⁽²²⁾ PDA1 Pro 0-10V dimming 0.1% linear ⁽²¹⁾ ⁽²⁵⁾ PDA2 Pro 0-10V dimming 0.1% logarithmic ⁽²¹⁾ ⁽²⁵⁾ PH Phase dimming ⁽²⁶⁾ ⁽²⁷⁾ PPH Pro Phase 1% dimming ⁽⁴⁾ ⁽⁵⁾ ⁽²⁷⁾ ⁽²⁸⁾ ESP Lutron® Hi-lume Premier 0.1% EcoSystem® PEQ0 Soft-on/Fade-to-Black (temporarily unavailable) ⁽²¹⁾ ⁽²⁹⁾ ⁽³⁰⁾ ⁽³¹⁾ SDALI1 Standard DALI dimming 1% linear ⁽²¹⁾ SDALI2 Standard DALI dimming 1% logarithmic ⁽²¹⁾ DALI1 Pro DALI dimming 0.1% linear ⁽²¹⁾ DALI2 Pro DALI dimming 0.1% logarithmic ⁽²¹⁾ DALI78 DALI-2 dimming Type 8 (multi channel capability) ⁽⁴⁾ ⁽²¹⁾ ⁽³²⁾ ⁽³³⁾ DMX/RDM DMX/RDM (configurable to 1, 2, or 3 channel control via RDM in the field) ⁽²¹⁾ ⁽³⁴⁾ ⁽³⁵⁾ LT Lumentalk dimming ⁽²¹⁾ ⁽³⁶⁾ ⁽³⁷⁾

Notes:

1. Refer to website product configurator for all exceptions.

2. Refer to website for Quickship configurations.

3. Not available for 700 lumens. Not available for 1000 lumens when combined with 80 color rendering option.

4. Not available for XN and VN optics.

5. Not available for DTW, DTWP, DWH, DWW or DWWP color options.

6. Available for M and MFR optics only.

7. Not available with PC, IC, IC/AT or RMR installation types.

8. Available for CRI 80 only.

9. Compatible with all control options except for DALI18.

10. Available for 1000 and 1300 lumens when combined with 90 color rendering option and MFR optic only.

11. Compatible with DA1, SDALI1, SDALI2, DMX/RDM and LT control options only.

12. Available for 1300 lumens when combined with 80 color rendering option and MFR optic only.

13. Compatible with LT, DMX/RDM and DALI18 control options only.

14. Available for 700 lumens when combined with 80 or 90 color rendering options and 27K, 30K, 35K or 40K color temperature options only.

15. Available up to 1300 lumens when combined with 80 or 90 color rendering options and 27K, 30K, 35K or 40K color temperature options only.

16. Available up to 1300 lumens when combined with 80, 90 or 95 color rendering options only.

17. Available up to 2000 lumens when combined with 80 color rendering option and up to 1300 lumens when combined with 80, 90 or 95 color rendering options only.

18. Available up to 3000 lumens when combined with 80 color rendering option and up to 2000 lumens when combined with 80, 90 or 95 color rendering options only.

19. Control options vary according to color temperature, color rendering, optics and installation type combination. Refer to website product configurator for details.

20. Manufacturer's choice driver. Order code may change to NO1.

21. Not available with 347V.

22. Not available for 3000 lumens.
23. Manufacturer's choice driver. Order code may change to DAMC1 or DAMC2.

24. Not available for XN and VN optics.

25. Driver cuts off power to the fixture when the control signal drops below 0.5V.

26. Manufacturer's choice driver. Order code may change to PH1 or PH2.

27. Available for 120V voltage option only.

28. Manufacturer's choice driver. Order code is subject to change.

29. Consult factory for availability.

30. One EcoSystem® address per fixture. Lutron® EcoSystem® Enabled dimming not available for 1300 lumens combined with VN optic. Available for static white color temperatures only.

31. Not available for 3000 lumens.

32. Available for DWH, DWW and DWWP color options only. DALI-2 Type 8 controller required.

33. Not available for PC, IC or IC/AT installation types.

34. Configurable between 8 or 16-bit dimming control via RDM. DMX/RDM requires LumenID, LumenID software and onsite commissioning.

35. A Control Box (CBX-DS or CBX-ST) and lumenID (LID) must be specified.

36. A Lumentranslator 2 (LTL2) and LumentalkID (LIDL) must be specified for Lumentalk applications. Consult Lumentranslator 2 and Lumentalk pages and specification sheets for details.

37. 1% minimum dimming value.

How to Order

Decorative Bezel	Decorative Bezel Finish	Trim	Trim Finish	Installation Type	Ceiling Thickness ⁽⁴⁴⁾	Option	Accessories ⁽⁵⁰⁾
ADB Adjustable (0°- 358° rotation, 0°-40° tilt)	MWH Matte White	RD Round ⁽⁴⁰⁾	MWH Matte White	RM Remodel non-insulated ceiling (non-Plenum rated) ⁽⁴²⁾	1 0.04 in to 1 in ceiling thickness	EBB Emergency Battery Backup with Hanger Bar (Bodine BSL17C-C2) ^{(5) (21) (47) (48) (49)}	NA No accessory
	MBK Matte Black	TLR Trimless Round ⁽⁴⁰⁾	MBK Matte Black	NC New construction non-insulated ceiling (non-Plenum rated) ⁽⁴²⁾	2 1.05 in to 2 in ceiling thickness	EBI Emergency Battery Backup with Hanger Bar (Iota ILB-CP07-A TBTS) ^{(5) (21) (47) (48) (49)}	HL Honeycomb Louver ⁽⁵¹⁾
	NKS Nickel Satin	SQ Square ⁽⁴¹⁾	NKS Nickel Satin	PC Plenum Non-Insulated Ceiling (enclosed box) ^{(31) (43) (44)}			XLVR Concentric Ring Louver ^{(52) (53)}
	DCH Dark Chrome	SR Square Trim with Round Hole ⁽⁴⁰⁾	CC Custom Color Trim ⁽³⁸⁾	IC New Construction Insulated Ceiling (enclosed box) ⁽⁴⁴⁾			CL Clear Glass Lens
	BCH Bright Chrome	TLS Trimless Square ⁽⁴¹⁾	SP Special Point Source Color ⁽³⁹⁾	IC/AT New Construction Insulated Ceiling (Chicago Plenum/airtight, enclosed box) ^{(31) (43) (44)}			SL Softening Glass Lens
	SWT Satin Wheat			RMR Remote Recessed Insulated Ceiling/Plenum (enclosed box) ^{(31) (43) (44) (45)}			PD Prismatic Diffuser ⁽⁵⁴⁾
	CC Custom Color Trim ⁽³⁸⁾						LSN Linear Spread Lens Narrow (1° x 40°) ^{(55) (56)}
	SP Special Point Source Color ⁽³⁹⁾						LSW Linear Spread Lens Wide (1° x 60°) ^{(56) (57)}
							BW1 Beam Widening Lens (+10°) ⁽⁵⁶⁾
							BW2 Beam Widening Lens (+20°) ⁽⁵⁶⁾
							BW3 Beam Widening Lens (+30°) ⁽⁵⁶⁾

- Notes:
5. Not available for DTW, DTWP, DWH, DWW or DWWP color options.

21. Not available with 347V.

31. Not available for 3000 lumens.

38. Longer lead times can be expected for custom RAL color finishes.

39. Refer to Cylinder specification sheet and brochure for color options.

40. Cannot be combined with square ceiling cutout.

41. Cannot be combined with round ceiling cutout.

42. Available for 700 lumens when combined with XN optic and up to 1300 lumens when combined with VN, NS and N optics. Available up to 2000 lumens when combined with NFR optic and up to 3000 lumens when combined with M and MFR optics. Refer to optic option notes for color rendering limitations.

43. Available for 700 lumens when combined with XN optic and up to 1300 lumens when combined with VN, NS, N and NFR optics. Available up to 2000 lumens when combined 80 color rendering option and M and MFR optics. Refer to optic option notes for color rendering limitations.

44. Not available for DWH, DWW or DWWP color options.

45. Remote distance is a maximum of 75 ft. For longer remote distances, please contact Lumenpulse Application Engineering Team for application validation.

46. Ceiling springs are field changeable, consult factory and installation instructions for details.

47. Available for RM and NC installation types only.

48. Emergency battery backup options require ceiling access for test button use. The battery will operate for 90 minutes minimum and maintain a minimum of 1 fc from a 7 ft 2 in height as per UL 924. For indoor use only in dry or damp locations.

49. Emergency battery backup options are field installed and not presided by Lumenpulse. Refer to related installation instructions for details.

50. Maximum one accessory per position (optic and bezel). HL and XLVR accessories are installed in optic position. CL, SL, PD, LSN, LSW, BW1, BW2 and BW3 accessories are installed in bezel position. Refer to specification sheet for details.

51. Not available for DTW and DTWP color options.

52. Available for XN, VN and NS optics only.

53. Can be combined with PD accessory only.

54. Recommended to be combined with HL or XLVR accessory only.

55. Recommended for XN, VN, NS, N and NFR optics when combined with 2200K, 2700K, 3000K, 3500K, 4000K color temperature options. Nominal 10° x 40° distribution when used with the NS optic. Recommended for MFR optic when combined with DTW, DTWP, DWH, DWW or DWWP color options only.

56. For optimal performance, it is not recommended to mix with other accessories.

57. Recommended for XN, VN, NS, N and NFR optics when combined with 2200K, 2700K, 3000K, 3500K, 4000K color temperature options only. Nominal 10° x 60° distribution when used with the NS optic. Recommended for MFR optic when combined with DTW, DTWP, DWH, DWW or DWWP color options only.