

Project Name

Qty

Type

Catalog / Part Number

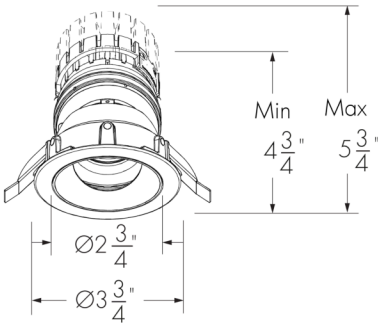

**Round trim**  
(Shown with 1 in ceiling springs)  
Round trim ceiling cutout: Ø3.25 in

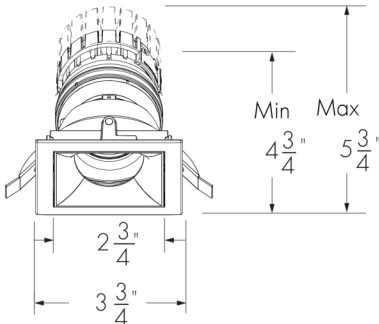

**Square trim**  
(Shown with 1 in ceiling springs)  
Square trim ceiling cutout: 3.25 in x 3.25 in

Photometric Summary

Based on Narrow Optic (nominal 25°), 4000K, CRI 90+

Nominal output [lm]	Delivered output [lm] <sup>(1)</sup>	Insulated ceiling		Non-insulated ceiling	
		Power (120V) [W]	Efficacy [lm/W]	Power (120V) [W]	Efficacy [lm/W]
700	532	7.5	71	9.5	56
1000	700	11	64	13	54
1300	953	13	73	15	64

<sup>1</sup> Consult website for latest IES files.  
<sup>2</sup> Photometric performance is measured in compliance with IESNA LM-79-24.

Optics



Color and Color Temperature

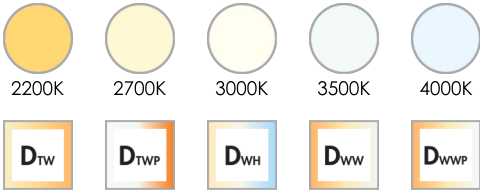

Color Rendering

CRI 80+      CRI 90+      CRI 95+

Description

The Lumencore Recessed Nano Fixed Tilt is a high-performance fixed LED downlight for ceiling applications. Available in an array of trims and finishes, outputs, optics, color renderings, and accessories, these luminaires are here to outperform. The Lumencore Recessed Nano Fixed Tilt possesses a previously unseen lifespan, is quick to install, and can be used with a number of different control options.

Physical

Cutout	<b>R:</b> Round, <b>S:</b> Square
Decorative Bezel	Fixed Tilt (0° rotation, factory set 30° tilt), LED can be fully adjustable behind the bezel
Trim	<b>RD:</b> Round, <b>SR:</b> Square Trim with Round Hole, <b>TLR:</b> Trimless Round, <b>SQ:</b> Square, <b>TLS:</b> Trimless Square
Ceiling Thickness	<b>1:</b> 0.04 in to 1 in Ceiling Thickness <b>2:</b> 1.05 in to 2 in Ceiling Thickness
Housing Material	Aluminum
TIR Optics Material	Clear polycarbonate
Reflector Material	Aluminum
Weight	3 lbs with RM installation type, 4.2 lbs with NC installation type, 7.2 lbs with PC, IC, IC/AT and RMR installation types (Weights are approximate based on the heaviest fixture configuration)  Please consult factory if exact fixture weight is needed

Controls

ON/OFF    0-10V    PRO 0-10V    PH  
PPH PHB    LUTRON    DALI    PRO DALI  
DALI8    DMXrdm    lumen talk

Ceiling Cutout Shapes

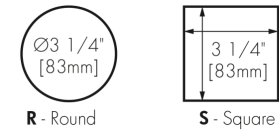

Decorative Bezel (Round Trim)



Decorative Bezel (Square Trim)

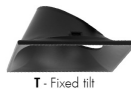

Standard Finishes - Decorative Bezels

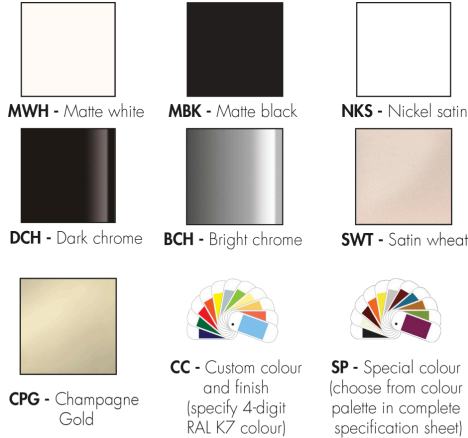

Trim Shapes

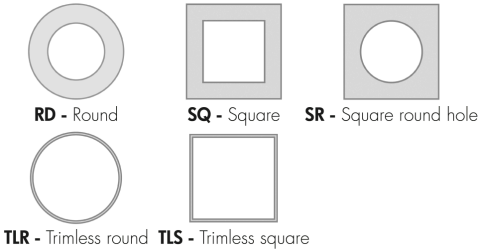

Ceiling Space Requirements (Length x Width x Height)

Up to 15 in x 8 in x 12 in with RM installation type, Up to 15 in x 9 in x 12 in with NC installation type  
Up to 18 in x 15 in x 9 in with PC/IC/ICAT/RMR installation types  
(Dimensions will vary by output and color rendering, refer to Ceiling Requirements table for details.)

Features

Output (Nominal Lumens)	L07: 700 lm, L10: 1000 lm, L13: 1300 lm, L20: 2000 lm, L30: 3000 lm
Color and Color Temperature	22K: 2200K 27K: 2700K 30K: 3000K 35K: 3500K 40K: 4000K DTW: Dim to Warm DTWP: Dim to Warm Plus DWH: Dynamic White DWW: Dynamic Warm White DWWP: Dynamic Warm White Plus

Optics (Nominal Distribution)	XN: Extra Narrow Spot Distribution 5° VN: Very Narrow Spot Distribution 10° NS: Narrow Spot Distribution 15° N: Narrow Distribution 25° NFR: Narrow Faceted Reflector 25° M: Medium Reflector 40° MFR: Medium Faceted Reflector 40°
-------------------------------	---

Decorative Bezel Finish	MWH: Matte White MBK: Matte Black NKS: Nickel Satin DCH: Dark Chrome BCH: Bright Chrome SWT: Satin Wheat CPG: Champagne Gold CC: Custom Color Trim (Specify 4-Digit RAL K7 Color) SP: Special color (Choose From standard Point Source Color Palette)
-------------------------	---

Trim Finish	MWH: Matte White MBK: Matte Black NKS: Nickel Satin CC: Custom Color Trim (Specify 4-Digit RAL K7 Color) SP: Special color (Choose From standard Point Source Color Palette)
-------------	--

Installation Type	RM: Remodel Non-Insulated Ceiling (Non-Plenum Rated) NC: New Construction Non-Insulated Ceiling (Non-Plenum Rated) PC: Plenum Non-Insulated Ceiling (Enclosed Box) IC: New Construction Insulated Ceiling (Enclosed Box) IC/AT: New Construction Insulated Ceiling (Chicago Plenum/airtight, enclosed box) RMR: Remote Recessed Insulated Ceiling/Plenum (enclosed box)
-------------------	--

Standard Finishes for Trim



MWH - Matte white



MBK - Matte black



NKS - Nickel satin



CC - Custom color and finish  
(Please specify 4-digit RAL K7 color)



SP - Special color  
(choose from standard Point Source color palette)

Adjustability



30° fixed tilt

T - Fixed tilt decorative bezel

Options



Emergency battery backup

Rating

IP20

Certifications



UL US



RoHS



5 YEARS  
lumenpulse

Option	<b>EBB:</b> Emergency Battery Backup with Hanger Bar (Bodine BSL17C-C2) <b>EBI:</b> Emergency Battery Backup with Hanger Bar (Iota ILB-CP07-A TBTS)
Certifications	UL compliant, RoHS
Warranty	5-year limited warranty
Electrical and Control	
Voltage	<b>120:</b> 120 Volts, <b>277:</b> 277 Volts, <b>347:</b> 347 Volts
Wattage Range	8.5W to 30W (wattage will vary based on voltage, output, color temperature, color rendering, optic, control and installation type, refer to Power Consumption table for details)
Control	<b>NO:</b> On/Off Control <b>NO3:</b> On/Off Control 347V <b>DAMC:</b> Standard 0-10V Dimming 1% Linear Curve <b>DA1:</b> Standard 0-10V Dimming 1% Linear Curve <b>DA2:</b> Standard 1-10V Dimming 1% Logarithmic Curve <b>DA3:</b> Standard 0-10V Dimming 1% Linear Curve (347V) <b>PDA1:</b> Professional 0-10V Dimming 0.1% Linear Curve <b>PDA2:</b> Professional 0-10V Dimming 0.1% Logarithmic Curve <b>PH:</b> Phase Dimming <b>PPH:</b> Phase Dimming 1% <b>PHB:</b> Pro Phase Dimming ERP PHB Series <b>ESP:</b> Lutron® Hi-lume Premier 0.1% EcoSystem® PEQ0 Soft-on/Fade-to-Black <b>SDALI1:</b> Standard DALI Dimming 1% Linear Curve <b>SDALI2:</b> Standard DALI Dimming 1% Logarithmic Curve <b>DALI1:</b> Professional DALI Dimming 0.1% Linear Curve <b>DALI2:</b> Professional DALI Dimming 0.1% Logarithmic Curve <b>DALIT8:</b> DALI-2 T8 Enabled Dimming 1% <b>DMX/RDM:</b> DMX/RDM Enabled Dimming 1% <b>LT:</b> Lumentalk Enabled Dimming

Performance

Maximum Delivered Output	Up to 1,825 lm (Medium Faceted Reflector optic 40°, 4000K, CRI 80)
Maximum Delivered Intensity	Up to 22,597 cd (Extra Narrow Spot optic 5°, 4000K, CRI 80)
Color Consistency	2 SDCM, 3 SDCM (XN optic only)
Color Rendering	<b>80:</b> CRI 80+, <b>90:</b> CRI 90+, <b>95:</b> CRI 95+
Lumen Maintenance	L95 55,000 hrs (Ta 25 °C) L70 225,000 hrs (Ta 25 °C)

Environmental

Ingress Protection Rating	IP20
Environment	Damp location rating (interior applications only)
Operating Temperature (Ceiling Cavity Ambient Temperature)	-4 °F to 104 °F (DA1, DA2, DA3, PDA1, PDA2, SDALI1, SDALI2, DALI1, DALI2, DALIT8, LT, DMX/RDM, PH and PPH control options), 14 °F to 104 °F (NO control option), 32 °F to 104 °F (NO3, ESP control options and EBB and EBI options)

Accessories (Order Separately)

Control Systems	Pharos® Lighting Control Kit (PHAROS), Pharos® Expert Control Kit (EXPERT)
Diagnostic and Addressing Tools	LumenID (LID)

Important

Virtual Patent Marking Notice

This website (<https://www.lmpg.com/patents-trademarks>) is provided to satisfy the virtual patent marking provisions of applicable jurisdictions. Some products listed may be covered by additional patents not referenced here.

Photometric Information

XN - Extra Narrow Spot (Nominal 5°), 4000K

Nominal output [lm]	Delivered output [lm]†	
	CR80	CR90
700	577	519

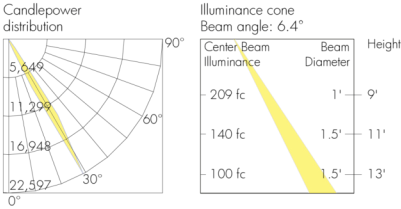

VN - Very Narrow Spot (Nominal 10°), 4000K

Nominal output [lm]	Delivered output [lm]†	
	CR80	CR90
700	617	555
1000	881	793
1300	1,145	1,031

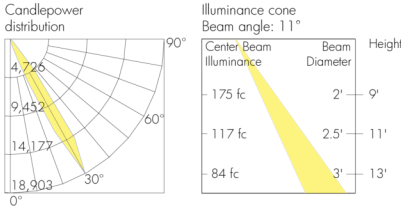

NS - Narrow Spot (Nominal 15°), 4000K

Nominal output [lm]	Delivered output [lm]†	
	CR80/90	CR95
700	586	527
1000	771	694
1300	1,050	945

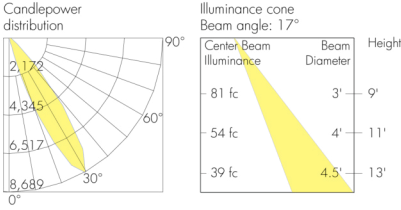

N - Narrow (Nominal 25°), 4000K

Nominal output [lm]	Delivered output [lm]†	
	CR80/90	CR95
700	532	479
1000	700	630
1300	953	858

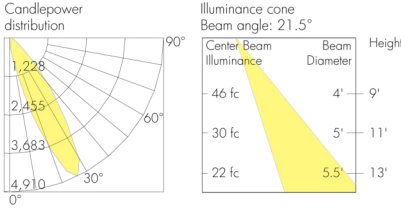

NFR - Narrow Faceted Reflector (Nominal 25°), 4000K

Nominal output [lm]	Delivered output [lm]†	
	CR80/90	CR95
700	515	464
1000	678	610
1300	923	831
2000	1,442	N/A

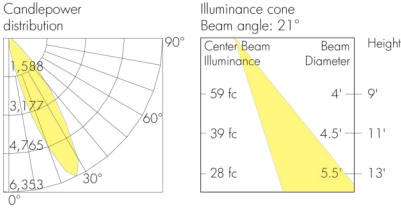

M - Medium Reflector (Nominal 40°), 4000K

Nominal output [lm]	Delivered output [lm]†	
	CR80/90	CR95
700	412	371
1000	532	479
1300	738	664
2000	1,150	1,035
3000	1,717	N/A

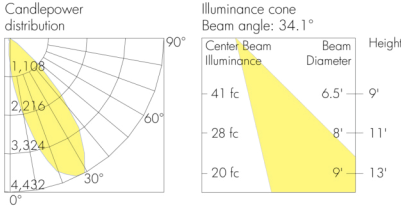

MFR - Medium Faceted Reflector (Nominal 40°), 4000K

Nominal output [lm]	Delivered output [lm]†	
	CR80/90	CR95
700	438	394
1000	566	509
1300	785	706
2000	1,223	1,100
3000	1,825	N/A

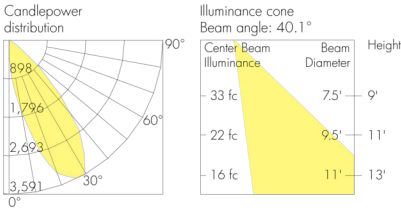

Based on Fixed Tilt Bezel and Round or Square trim configuration.  
† Consult website for IES files. Delivered output: +/- 10% tolerance.  
Consult Power consumption section for more wattage information.

TM-30

CRI 80+

CRI 80 +				
CCT	CIE		TM-30	
3500K	R <sub>a</sub>	84	84	R <sub>f</sub>
	R <sub>9</sub>	15	97	R <sub>g</sub>

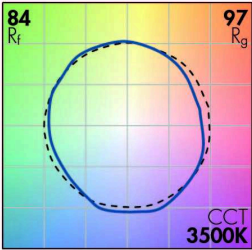

CRI 90+

CRI 90 +				
CCT	CIE		TM-30	
3500K	R <sub>a</sub>	94	91	R <sub>f</sub>
	R <sub>9</sub>	55	98	R <sub>g</sub>

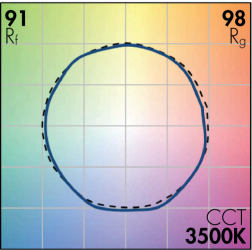

CRI 95+

CRI 95 +				
CCT	CIE		TM-30	
3500K	R <sub>a</sub>	97	91	R <sub>f</sub>
	R <sub>9</sub>	97	99	R <sub>g</sub>

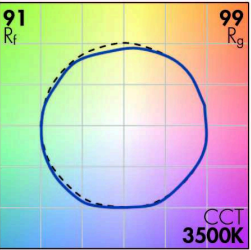

Refer to TM-30 Reference Guide for details.

Exploded Overview - Part Selection

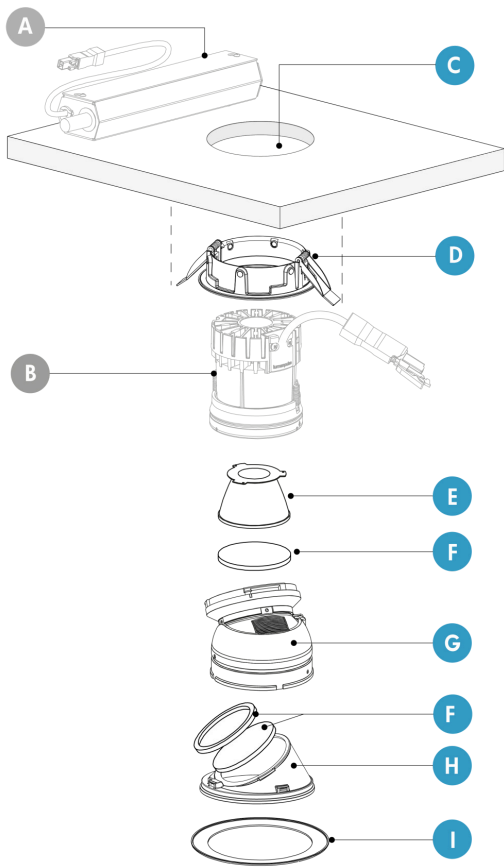

Standard Parts

- A** - MTG Mounting kit  
**B** - LUM Core (heatsink, universal fixing ring, LED module)  
MTG: Mounting Kit  
LUM: Luminaire

Customizable Parts

- C** - Ceiling cutout shape (round or square)  
**D** - Ceiling mounting ring (round or square, based on ceiling cutout selection)  
**E** - Optic\*  
**F** - Optical accessory and accessory holder (up to two optical accessories can be combined in the fixture, position will vary by accessory type)\*\*  
**G** - Adjustable mechanism  
**H** - Fixed tilt decorative bezel  
**I** - Trim (round or square, based on ceiling ring selection)

\* Optic is field changeable. Consult Interchangeable Optics section of the specification sheet for details. Consult factory for ordering details.  
\*\*Field changeable, consult installation instructions for details. Consult factory for ordering details.

Ceiling Requirements

Ceiling Cavity Space Requirements (Length x Width x Height)

Installation type	Control	Output/Color Rendering							
		L07	L10	L13	L20		L30		L40
		CR80/90/95			CR80/90	CR95	CR80/90	CR95	CR80/90
RM	NO/PH/PHB/ESP	12"x 8"x 6" (with trim) 12"x 8"x 8" (trimless)			12"x 10"x 8"		N/A		
	DA/DAMC/PDA/SDALI/DALI/ LT/DMX-RDM	15"x 8"x 8" (with trim) 15"x 8"x 12" (trimless)					N/A		
NC	NO/PH/PHB/ESP	15"x 10"x 6" (with trim) 15"x 10"x 8" (trimless)			15"x 10"x 8"		N/A		
	DA/DAMC/PDA/SDALI/DALI/ LT/DMX-RDM	15"x 10"x 8" (with trim) 15"x 9"x 12" (trimless)					N/A		
PC/IC/ICAT/RMR	ALL	14.5"x 10"x 7"		18"x 15"x 9"		N/A		N/A	

See Installation Type section for dimensional view of keep out and/or MTG mounting kit option.  
Above dimensions include any keep out requirements for proper airflow and thermal cooling.



Installation Types

**RM: Remodel Non-Insulated Ceiling (Non-Plenum Rated) (NO, PH, ES and ESP Controls Only)**

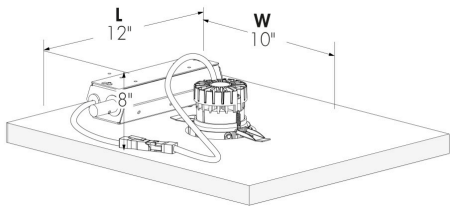

Ceiling cavity space requirements for L20 CR90/95 and L30 CR80/90 shown.

**RM: Remodel Non-Insulated Ceiling (Non-Plenum Rated) (Other Controls)**

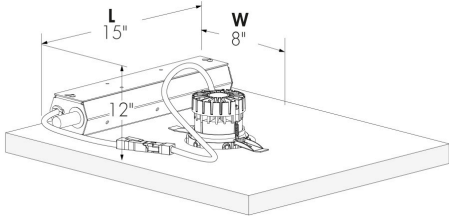

Ceiling cavity space requirements up to L20 CR95 and L30 CR80/CR90 shown, trimless version.

**NC: New Construction Non-Insulated Ceiling (Non-Plenum Rated) (NO, PH, ES and ESP Control Options Only)**

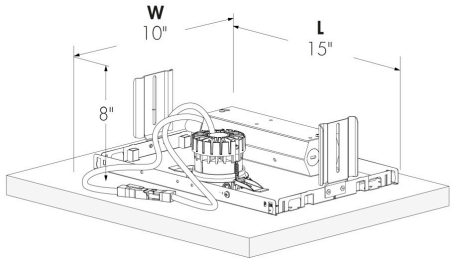

Ceiling cavity space requirements for L20 CR95 and L30 CR80/CR90 shown.

**NC: New Construction Non-Insulated Ceiling (Non-Plenum Rated) (Other Controls)**

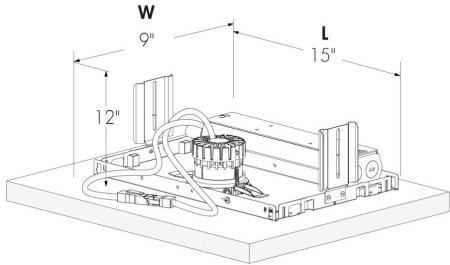

Ceiling cavity space requirements up to L20 CR95 and L30 CR80/CR90 shown, trimless version.

**IC, PC, IC/AT: New Construction Insulated and Non-Insulated Ceiling (Enclosed Box)**

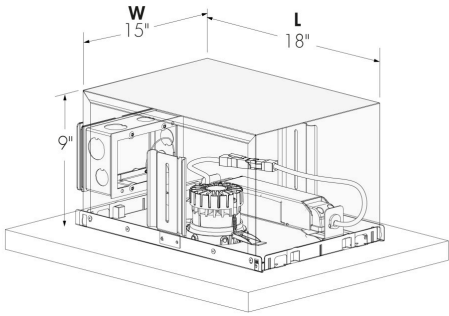

**IC** - New construction insulated ceiling (enclosed box)  
**PC** - Plenum non-insulated ceiling (enclosed box)  
**IC/AT** - New construction insulated ceiling (Chicago Plenum/airtight, enclosed box)  
Ceiling cavity space requirements for L13 CR80/90/95 and L20 CR80/CR90 shown.

**RMR: Remote Recessed Insulated Ceiling/Plenum (Enclosed Box)**

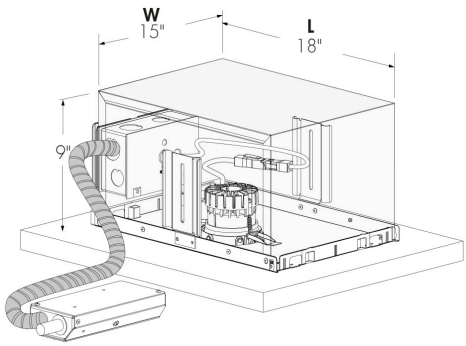

Luminaire ceiling cavity space requirements for L13 CR80/90/95 and L20 CR80/CR90 shown. Refer to remote driver box dimensions in installation instructions for space required for driver.  
Remote distance is a maximum of 75 ft, consult Lumenpulse Application Engineering Team for longer remote distances.

Fixture shown for reference only. Refer to Ceiling Requirements section and installation instructions for dimensions and ceiling cutout requirements.

Ceiling Requirements

Ceiling Cutout

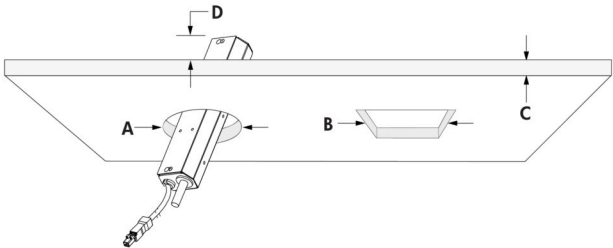

- A - Ceiling cutout: Ø3.25 in
- B - Ceiling cutout: 3.25 in x 3.25 in
- C - Maximum ceiling thickness: 2 in
- D - Minimum ceiling height: refer to Ceiling Cavity Space Requirements table

Ceiling Thickness Options

Ceiling Thickness 1

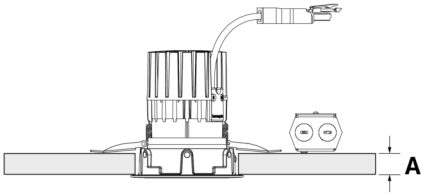

- A - Ceiling thickness range: 0.04 in to 1 in

Ceiling Thickness 2

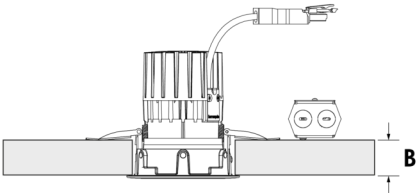

- B - Ceiling thickness range: 1.05 in to 2 in

Ceiling springs are field changeable, consult installation instructions and factory for details.

Dimensions

T - Fixed Tilt (0° Rotation, Factory Set 30° Tilt)

L07, L10, L13

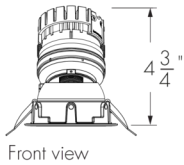

RD - Round Shape, Round Trim

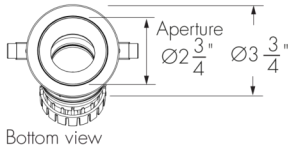

SQ - Square Shape, Square Trim

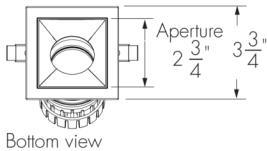

SR - Square Shape, Round Hole

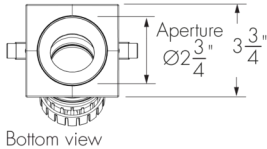

Round ceiling cutout: Ø3.25 in  
Square ceiling cutout: 3.25 in x 3.25 in

Beam Cutoff Angle

T - Fixed Tilt

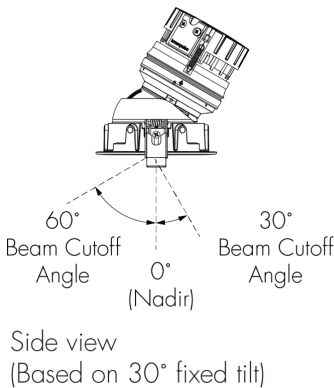

T - Fixed Tilt (0° Rotation, Factory Set 30° Tilt, Trimless Version)

L07, L10, L13

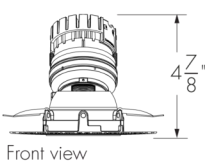

TLR - Trimless Round

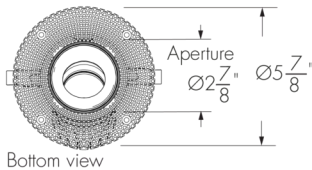

TLS - Trimless Square

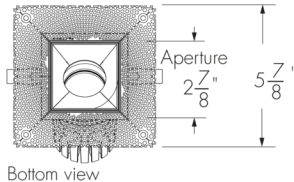

L20, L30\*

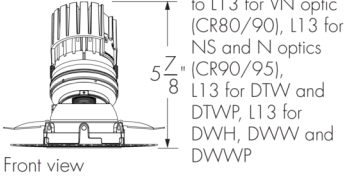

Tilt

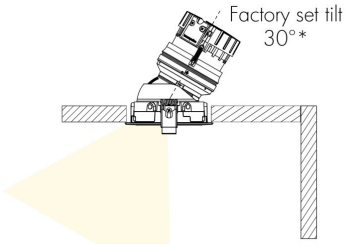

\*Field adjustable from 0° to 40°, see installation instructions for details.

Delivery - How it Works

Standard Shipping (1 delivery)

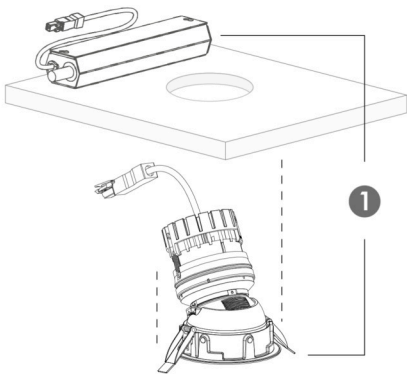

Included

- 1. MTG Mounting kit and complete fixture assembly

Advanced Shipping of Mounting kit (2 Separate Deliveries)

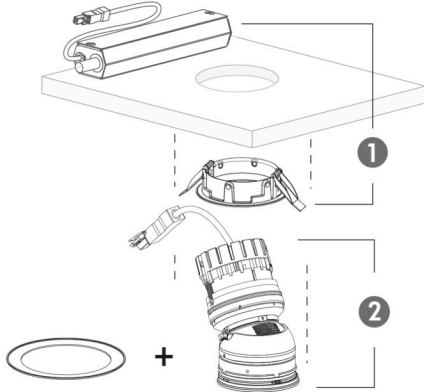

Included

- 1. Optional advanced delivery: MTG Mounting kit and ceiling mounting ring
- 2. Second delivery: LUM Core (heatsink, universal fixing ring, LED module, optic, accessories, decorative bezel) and trim

Consult factory for Advanced Shipping details.

Ceiling Cutout Shape Options

RD - Round Ceiling Cutout

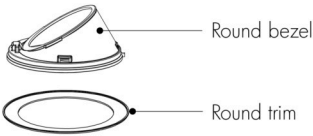

SQ - Square Ceiling Cutout

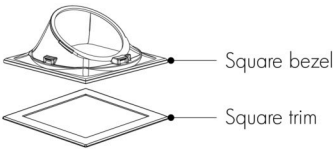

Decorative Bezel Options

RD - Compatible Round Decorative Bezels



SQ - Compatible Square Decorative Bezels

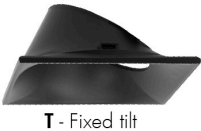

Standard Finishes - Decorative Bezels



\*Custom color: specify 4-digit RAL K7 color.

\*\*Special color: choose one of the standard Point Source colors from the Point Source product brochure or Lumencore Cylinder specification sheets. Contact manufacturer for additional information.

Trim Shape Options

RD - Compatible Round Trim Shapes



SQ - Compatible Square Trim Shapes



Standard Finishes - Trims



MWH - Matte white



MBK - Matte black



NKS - Nickel satin



CC - Custom colour\*



SP - Special colour\*\*

\*Custom color: specify 4-digit RAL K7 color.  
\*\*Special color: choose one of the standard Point Source colors from the Point Source product brochure or Lumencore Cylinder specification sheets. Contact manufacturer for additional information.

Optical Accessories

HL - Honeycomb Louver

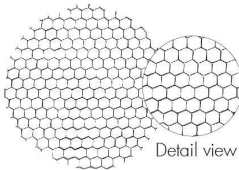

XLVR - Concentric Ring Louver

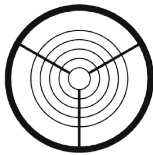

CL - Clear Glass Lens



SL - Softening Glass Lens



PD - Prismatic Diffuser

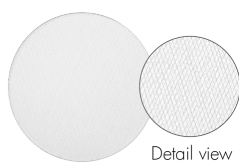

LSN - Linear Spread Lens Narrow (1° x 40°)

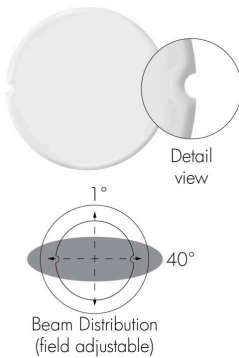

LSW - Linear Spread Lens Wide (1° x 60°)

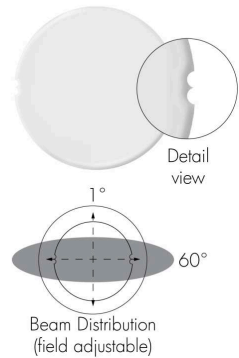

BW1 - Beam Widening Lens (+10°)

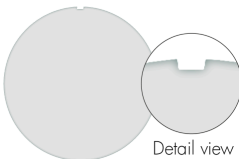

Refer to Beam Widening Lens table for beam distribution based on optic installed in the fixture.

BW2 - Beam Widening Lens (+20°)

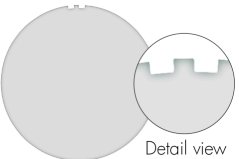

Refer to Beam Widening Lens table for beam distribution based on optic installed in the fixture.

BW3 - Beam widening lens (+30°)

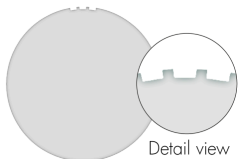

Refer to Beam Widening Lens table for beam distribution based on optic installed in the fixture.

Optical Accessories - Installation Options (Field Changeable)

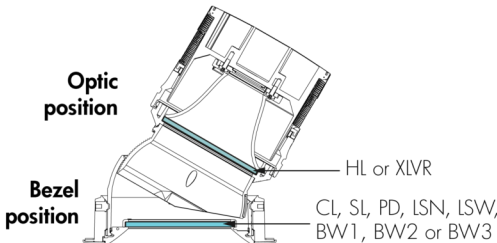

Accessories specified in the fixture code will ship from the factory in the position shown above.

Optics

TIR Optic - Total Internal Reflection



Applicable to XN (5°), VN (10°), NS (15°) and N (25°) distributions.

Semi-Specular Reflector



Applicable to M (40°) distribution.

Faceted Reflector



Applicable to NFR (25°) and MFR (40°) distributions.

Beam Widening Lenses

	Optic installed in fixture						
	XN 5°	VN 10°	NS 15°	N 25°	NFR 25°	M 40°	MFR 40°
BW1	11°	14°	21°	26°	26°	51°	51°
BW2	21°	22°	27°	31°	31°	54°	54°
BW3	30°	32°	35°	38°	38°	58°	58°

The above beam angles are nominal beam angles.  
Variations in beam angles can be seen due to different LES sizes. For exact beam calculations please consult factory.  
Beam widening lenses should not be used with other accessories with the nominal results above.

Interchangeable Optics

	Optic installed in fixture						
	XN 5°	VN 10°	NS 15°	N 25°	NFR 25°	M 40°	MFR 40°
Interchangeable optics	N/A	N/A	N NFR	NS NFR	NS N	MFR	M

The optic options listed above are field changeable. Consult factory and installation instructions for details.



Power Consumption

Static White Color Temperatures

Power consumption [W]										
Output [lm]	XN (5°) - VN (10°)		NS (15°) - N (25°) - NFR (25°)				M (40°) - MFR (40°)			
	120 V	277 V	120 V		277 V		120 V		277 V	
	CR80/90		CR80/90	CR95	CR80/90	CR95	CR80/90	CR95	CR80/90	CR95
700	13	15	9.5	10	10.5	12	8.5	9	9.5	11
1000	17*	18*	13	14.5	14	16	10	13	12	15
1300	23*	24*	15	20	16	21	13	15	15	16
2000	N/A	N/A	23**	N/A	24**	N/A	20	23	21	24
3000	N/A	N/A	N/A	N/A	N/A	N/A	30	N/A	30	N/A

\*Not applicable to XN optic.  
\*\*Not applicable to NS and N optics.

Dynamic Colors

Power consumption [W]				
Output [lm]	NFR (25°) - M (40°) - MFR (40°)			
	120 V		277 V	
	DTW - DTWP	DWW - DWH - DWWP	DTW - DTWP	DWW - DWH - DWWP
1000	14	N/A	15	N/A
1300	17	26	19	26

- Power consumption values are for non-insulated ceiling (RM and NC) and remote recessed insulated ceiling/plenum (RMR) installation types. For plenum ceiling (PC), new construction insulated ceiling (IC and IC/AT) installation types, remove 2 watts per fixture.
- Add 3 watts per fixture when specifying LT control option.
- Add 2 watts per fixture when specifying DMX/RDM control option.
- Add 4 watts per fixture when specifying 347V.

Control

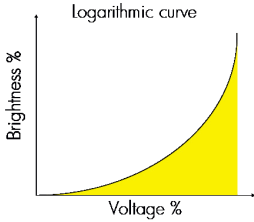
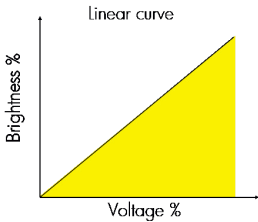

Dimming	Control options with linear dimming curve						Control options with logarithmic dimming curve			
Dimming down to 0.1%	PDA1	ESP	DALI1				PDA2	DALI2	DALI8	
Dimming down to 1%	DA1	DA3	DAMC	PPH	PHB	SDALI1	DA2	SDALI2	DALI8	DMXrdrm* lumen talk

\*DMX/RDM control can be programmed onsite via RDM for linear dimming curve option. Logarithmic curve is standard from factory. Consult factory for further details.  
Refer to website product code for exceptions.

Color and Color Temperature

Color Temperature Ranges

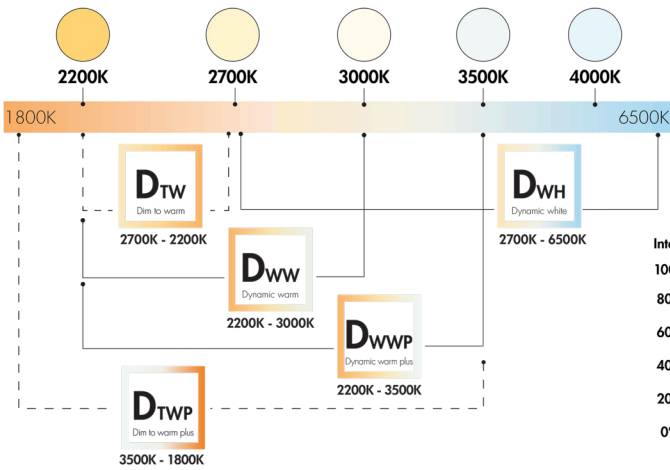

- - -1 channel (DTW, DTWP) Compatible with: DA1 SDALI1 SDALI2 lumen
  - 2 channels\* (DWH, DWW, DWWP) Compatible with: DALI8 lumen
  - 3 channels (DWH, DWW, DWWP) Compatible with: DALI8 lumen
- \*Can be changed in the field via RDM & IT for individual CCT control.

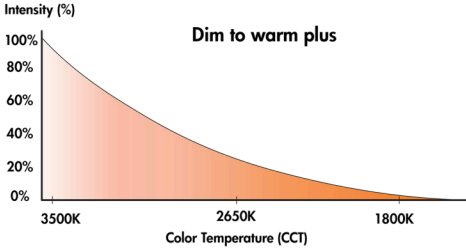
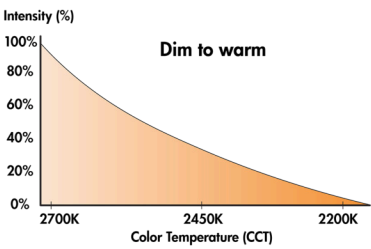

Wiring Details RM: Remodel Non-Insulated Ceiling (Non-Plenum Rated)

NO And PH Controls - Wiring Detail

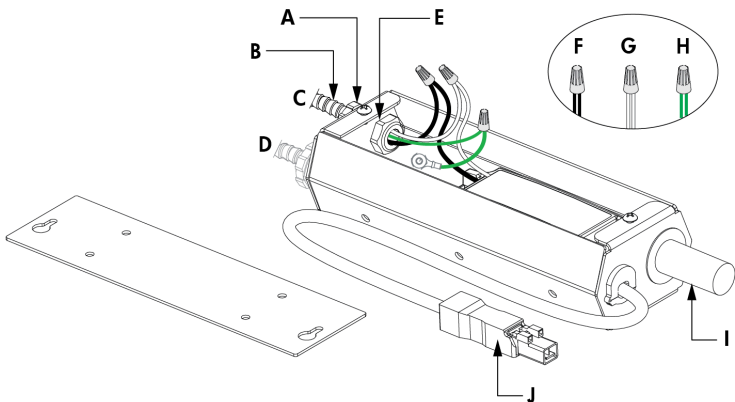

- A - Conduit fitting (by others)
- B - Conduit (by others)
- C - Power Input
- D - Optional Output
- E - Locknut (by others)
- F - Line
- G - Neutral
- H - Ground
- I - Thermal protector
- J - Output to luminaire

Other Controls - Wiring Detail

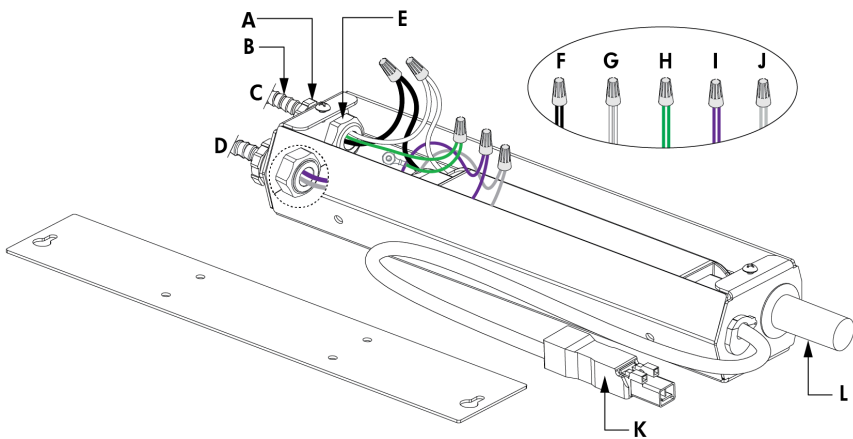

- A - Conduit fitting (by others)
- B - Conduit (by others)
- C - Power Input
- D - Data Input from Control System
- E - Locknut (by others)
- F - Line
- G - Neutral
- H - Ground
- I - Data +
- J - Data -
- K - Output to luminaire
- L - Thermal protector

Other Controls - Daisy Chain Layout Wiring Detail

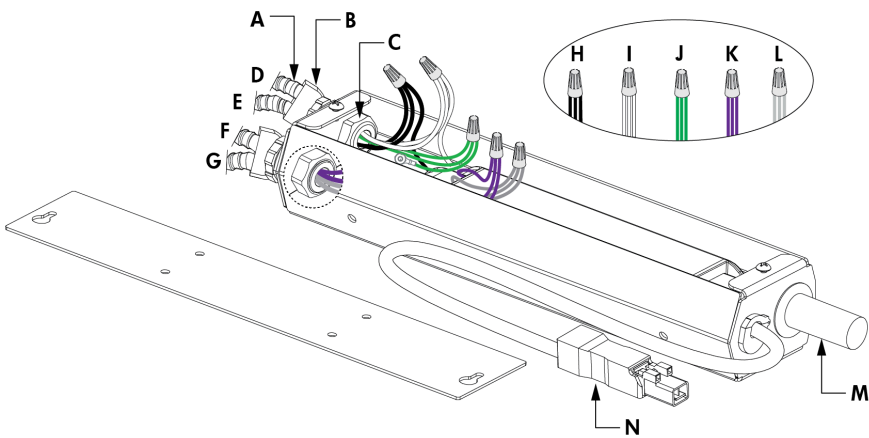

- A - Conduit (by others)
- B - Duplex connector (by others)
- C - Locknut (by others)
- D - Power Output to next luminaire
- E - Power input
- F - Data Output to next luminaire
- G - Data Input from Control System
- H - Line
- I - Neutral
- J - Ground
- K - Data +
- L - Data -
- M - Thermal protector
- N - Output to luminaire

Remodel driver box varies by control option. Refer to installation instructions for additional wiring details.

Options

EBB - Emergency Battery Backup With Hanger Bar (Bodine BSL17C-C2)

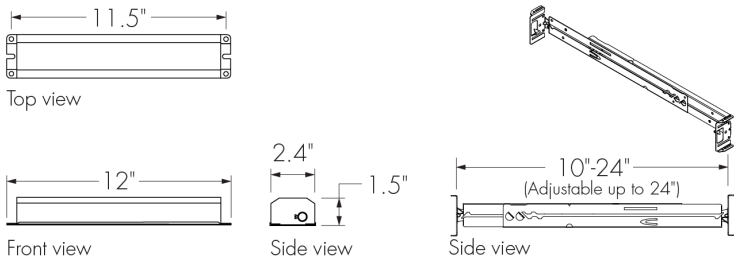

Hardware to mount the battery backup to the hanger bar is included. A test button is included. The unit comes pre-wired with 2 ft flexible conduit in and out. Refer to installation instructions for details.

EBI - Emergency Battery Backup With Hanger Bar (Iota ILB-CP07-A TBTS)

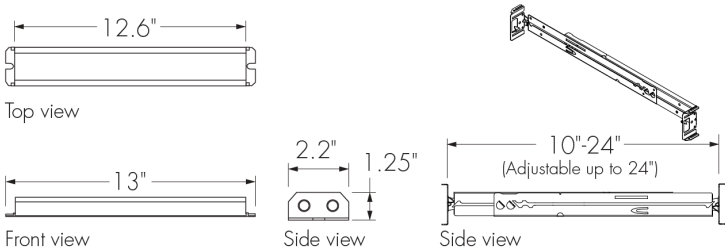

Hardware to mount the battery backup to the hanger bar is included. A test button is included. The unit comes pre-wired with 2 ft flexible conduit in and out. Refer to installation instructions for details.

Diagnostic And Addressing Tools (Order Separately)

LID - LumenID



The updated LumenID (LID) is now your all-in-one diagnostic and addressing solution for both DMX/RDM and Lumentalk (LT) systems. Engineered for versatility, it streamlines commissioning and troubleshooting across protocols—no need for multiple tools. Consult the LID specification sheet for full details.

Control Systems (Order Separately)

PHAROS - Pharos® Designer Lighting Control Kit



The Pharos Designer Lighting Control Kit, available for 1 or 2 DMX universes, allows for complete control of large lighting installations.

EXPERT - Pharos® Expert Control Kit



The Pharos Expert Control Kit, available for 1, 2, 4 or 6 DMX universes, allows for complete control of large lighting installations.

How to Order

Housing <sup>(1)</sup>	Certification	Type	Voltage	Cutout	Output (Nominal Lumens)	Color and Color Temperature	Color Rendering	Optics (Nominal Distribution)	Control <sup>(19)</sup>	Decorative Bezel
LCRN Lumencore Recessed Nano - 2.75 in	A UL/cUL	FT Fixed Tilt	120 120 Volts  277 277 Volts  347 347 Volts <sup>(2)</sup> <sup>(3)</sup> <sup>(4)</sup> <sup>(5)</sup>	R Round  S Square	L07 700 lm  L10 1000 lm  L13 1300 lm  L20 2000 lm  L30 3000 lm <sup>(4)</sup> <sup>(7)</sup>	22K 2200K <sup>(8)</sup> <sup>(9)</sup>  27K 2700K <sup>(9)</sup>  30K 3000K <sup>(9)</sup>  35K 3500K <sup>(9)</sup>  40K 4000K <sup>(9)</sup>  DTW Dim to Warm (2700K to 2200K) <sup>(10)</sup> <sup>(11)</sup>  DTWP Dim to Warm Plus (3500K to 1800K) <sup>(10)</sup> <sup>(11)</sup>  DWH Dynamic White (2700K to 6500K) <sup>(12)</sup> <sup>(13)</sup>  DWW Dynamic Warm White (2200K to 3000K) <sup>(12)</sup> <sup>(13)</sup>  DWWP Dynamic Warm White Plus (2200K to 3500K) <sup>(12)</sup> <sup>(13)</sup>	80 CRI 80+  90 CRI 90+  95 CRI 95+	XN Extra Narrow Spot Distribution 5° <sup>(14)</sup>  VN Very Narrow Spot Distribution 10° <sup>(15)</sup>  NS Narrow Spot Distribution 15° <sup>(16)</sup>  N Narrow Distribution 25° <sup>(16)</sup>  NFR Narrow Faceted Reflector 25° <sup>(17)</sup>  M Medium Reflector 40° <sup>(18)</sup>  MFR Medium Faceted Reflector 40° <sup>(18)</sup>	NO On/Off Control <sup>(20)</sup> <sup>(21)</sup>  NO3 On/Off Control 347V <sup>(2)</sup> <sup>(4)</sup> <sup>(22)</sup>  DAMC Standard 0-10V Dimming 1% Linear Curve <sup>(3)</sup> <sup>(21)</sup> <sup>(23)</sup> <sup>(24)</sup>  DA1 Standard 0-10V Dimming 1% Linear Curve <sup>(21)</sup> <sup>(25)</sup>  DA2 Standard 1-10V Dimming 1% Logarithmic Curve <sup>(21)</sup> <sup>(25)</sup>  DA3 Standard 0-10V Dimming 1% Linear Curve (347V) <sup>(2)</sup> <sup>(4)</sup> <sup>(22)</sup>  PDA1 Professional 0-10V Dimming 0.1% Linear Curve <sup>(21)</sup> <sup>(25)</sup>  PDA2 Professional 0-10V Dimming 0.1% Logarithmic Curve <sup>(21)</sup> <sup>(25)</sup>  PH Phase Dimming <sup>(26)</sup> <sup>(27)</sup>  PPH Phase Dimming 1% <sup>(3)</sup> <sup>(4)</sup> <sup>(27)</sup> <sup>(28)</sup>  PHB Pro Phase Dimming ERP PHB Series <sup>(3)</sup> <sup>(24)</sup> <sup>(29)</sup> <sup>(30)</sup>  ESP Lutron® Hi-lume Premier 0.1% EcoSystem® PEQ0 Soft- on/Fade- to-Black <sup>(21)</sup> <sup>(31)</sup> <sup>(32)</sup>	T Fixed Tilt (0° rotation, factory set 30° tilt)

[illegible]

1. Refer to website product configurator for all exceptions.
2. Not available for 700 lumens. Not available for 1000 lumens when combined with 80 color rendering option.
3. Not available for DTW, DTWP, DWH, DWW or DWWP color options.
4. Not available for XN and VN optics.
5. Not available for CR90.
6. Available for M and MFR optics only.
7. Not available with PC, IC, IC/AT or RMR installation types.
8. Available for CRI 80 only.
9. Compatible with all control options except for DALI18.
10. Available for 1000 and 1300 lumens when combined with 90 color rendering option and MFR optic only.
11. Compatible with DA1, SDALI1, SDALI2, DMX/RDM and LT control options only.
12. Available for 1300 lumens when combined with 80 color rendering option and MFR optic only.
13. Compatible with LT, DMX/RDM and DALI18 control options only.
14. Available for 700 lumens when combined with 80 or 90 color rendering options and 27K, 30K, 35K or 40K color temperature options only.
15. Available up to 1300 lumens when combined with 80 or 90 color rendering options and 27K, 30K, 35K or 40K color temperature options only.
16. Available up to 1300 lumens when combined with 80, 90 or 95 color rendering options only.
17. Available up to 2000 lumens when combined with 80 color rendering option and up to 1300 lumens when combined with 80, 90 or 95 color rendering options only.
18. Available up to 3000 lumens when combined with 80 color rendering option and up to 2000 lumens when combined with 80, 90 or 95 color rendering options only.
19. Control options vary according to color temperature, color rendering, optics and installation type combination. Refer to website product configurator for details.

20. Manufacturer's choice driver. Order code may change to NO1.
21. Not available with 347V.
22. Not available for 3000 lumens.
23. Manufacturer's choice driver. Order code may change to DAMC1 or DAMC2.
24. Not available for XN and VN optics.
25. Driver cuts off power to the fixture when the control signal drops below 0.5V.
26. Manufacturer's choice driver. Order code may change to PH1 or PH2.
27. Available for 120V voltage option only.
28. Manufacturer's choice driver. Order code is subject to change.
29. Not available for 700 lumens.
30. Not available for M and MFR optics when combined with 1000 lumens.
31. Not available for 3000 lumens.
32. One EcoSystem® address per fixture. Lutron® EcoSystem® Enabled dimming not available for 1300 lumens combined with VN optic. Available for static white color temperatures only.
33. Available for DWH, DWW and DWWP color options only. DALI-2 Type 8 controller required.
34. Not available for PC, IC or IC/AT installation types.
35. Configurable between 8 or 16-bit dimming control via RDM. DMX/RDM requires LumenID, LumenID software and onsite commissioning.
36. A Control Box (CBX-DS or CBX-ST) and lumenID (LID) must be specified.
37. Configurable to 1, 2, or 3 channel control via RDM in the field.
38. A Lumentranslator 2 (LT2) and LumenID (LID) must be specified for Lumentalk applications. Consult Lumentranslator 2 and Lumentalk pages and specification sheets for details.

How to Order

Decorative Bezel Finish	Trim	Trim Finish	Installation Type	Ceiling Thickness <sup>(48)</sup>	Option	Accessories <sup>(52)</sup>
<b>MWH</b> Matte White	<b>RD</b> Round <sup>(42)</sup>	<b>MWH</b> Matte White	<b>RM</b> Remodel Non-Insulated Ceiling (Non-Plenum Rated) <sup>(44)</sup>	<b>1</b> 0.04 in to 1 in Ceiling Thickness	<b>EBB</b> Emergency Battery Backup with Hanger Bar (Bodine BSL17C-C2) <sup>(3) (21) (49) (50) (51)</sup>	<b>NA</b> No Accessory
<b>MBK</b> Matte Black	<b>SR</b> Square Trim with Round Hole <sup>(42)</sup>	<b>MBK</b> Matte Black	<b>NC</b> New Construction Non-Insulated Ceiling (Non-Plenum Rated) <sup>(44)</sup>	<b>2</b> 1.05 in to 2 in Ceiling Thickness	<b>EBI</b> Emergency Battery Backup with Hanger Bar (Iota ILB-CP07-A TBTS) <sup>(3) (21) (49) (50) (51)</sup>	<b>HL</b> Honeycomb Louver <sup>(53)</sup>
<b>NKS</b> Nickel Satin	<b>TLR</b> Trimless Round <sup>(42)</sup>	<b>NKS</b> Nickel Satin	<b>PC</b> Plenum Non-Insulated Ceiling (Enclosed Box) <sup>(31) (45) (46)</sup>			<b>XLVR</b> Concentric Ring Louver <sup>(54) (55)</sup>
<b>DCH</b> Dark Chrome	<b>SQ</b> Square <sup>(43)</sup>	<b>CC</b> Custom Color Trim <sup>(40)</sup>	<b>IC</b> New Construction Insulated Ceiling (Enclosed Box) <sup>(31) (45) (46)</sup>			<b>CL</b> Clear Glass Lens
<b>BCH</b> Bright Chrome	<b>TLS</b> Trimless Square <sup>(43)</sup>	<b>SP</b> Special Point Source Color <sup>(41)</sup>	<b>IC/AT</b> New Construction Insulated Ceiling (Chicago Plenum/airtight, enclosed box) <sup>(31) (45) (46)</sup>			<b>SL</b> Softening Glass Lens
<b>SWT</b> Satin Wheat			<b>RMR</b> Remote Recessed Insulated Ceiling/Plenum (enclosed box) <sup>(31) (45) (46) (47)</sup>			<b>PD</b> Prismatic Diffuser <sup>(56)</sup>
<b>CPG</b> Champagne Gold <sup>(39)</sup>						<b>LSN</b> Linear Spread Lens Narrow (1° x 40°) <sup>(57) (58)</sup>
<b>CC</b> Custom Color Trim <sup>(40)</sup>						<b>LSW</b> Linear Spread Lens Wide (1° x 60°) <sup>(58) (59)</sup>
<b>SP</b> Special Point Source Color <sup>(41)</sup>						<b>BW1</b> Beam Widening Lens (+10°) <sup>(58)</sup>
						<b>BW2</b> Beam Widening Lens (+20°) <sup>(58)</sup>
						<b>BW3</b> Beam Widening Lens (+30°) <sup>(58)</sup>

Notes:

- 3.** Not available for DTW, DTWP, DWH, DWW or DWWP color options.

**21.** Not available with 347V.

**31.** Not available for 3000 lumens.

**39.** Coming soon, consult factory for details.

**40.** Longer lead times can be expected for custom RAL color finishes.

**41.** Refer to Cylinder specification sheet and brochure for color options.

**42.** Cannot be combined with square ceiling cutout.

**43.** Cannot be combined with round ceiling cutout.

**44.** Available for 700 lumens when combined with XN optic and up to 1300 lumens when combined with VN, NS and N optics. Available up to 2000 lumens when combined with NFR optic and up to 3000 lumens when combined with M and MFR optics. Refer to optic option notes for color rendering limitations.

**45.** Available for 700 lumens when combined with XN optic and up to 1300 lumens when combined with VN, NS, N and NFR optics. Available up to 2000 lumens when combined 80 color rendering option and M and MFR optics. Refer to optic option notes for color rendering limitations.

**46.** Not available for DWH, DWW or DWWP color options.

**47.** Remote distance is a maximum of 75 ft. For longer remote distances, please contact Lumenpulse Application Engineering Team for application validation.

**48.** Ceiling springs are field changeable, consult factory and installation instructions for details.
- 49.** Available for RM and NC installation types only.

**50.** Emergency battery backup options require ceiling access for test button use. The battery will operate for 90 minutes minimum and maintain a minimum of 1 fc from a 7 ft 2 in height as per UL 924. For indoor use only in dry or damp locations.

**51.** Emergency battery backup options are field installed and not presided by Lumenpulse. Refer to related installation instructions for details.

**52.** Maximum one accessory per position (optic and bezel). HL and XLVR accessories are installed in optic position. CL, SL, PD, LSN, LSW, BW1, BW2 and BW3 accessories are installed in bezel position. Refer to specification sheet for details.

**53.** Not available for DTW and DTWP color options.

**54.** Available for XN, VN and NS optics only.

**55.** Can be combined with PD accessory only.

**56.** Recommended to be combined with HL or XLVR accessory only.

**57.** Recommended for XN, VN, NS, N and NFR optics when combined with 2200K, 2700K, 3000K, 3500K, 4000K color temperature options. Nominal 10° x 40° distribution when used with the NS optic. Recommended for MFR optic when combined with DTW, DTWP, DWH, DWW or DWWP color options only.

**58.** For optimal performance, it is not recommended to mix with other accessories.

**59.** Recommended for XN, VN, NS, N and NFR optics when combined with 2200K, 2700K, 3000K, 3500K, 4000K color temperature options only. Nominal 10° x 60° distribution when used with the NS optic. Recommended for MFR optic when combined with DTW, DTWP, DWH, DWW or DWWP color options only.