

Project Name

Qty

Type

Catalog / Part Number

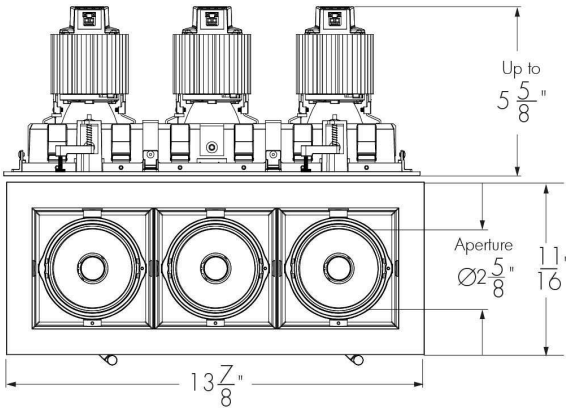

Ceiling cutout: 5 1/4" x 13"
Maximum ceiling thickness: 1"

Photometric Summary

Based on Narrow Optic (nominal 25°), one fixture head, 4000K, CRI 90+

Nominal output [lm]	Delivered output [lm] ^[1]	Insulated ceiling		Non-insulated ceiling	
		Power (120V) [W]	Efficacy [lm/W]	Power (120V) [W] ^[2]	Efficacy [lm/W]
700	728	5	146	7	104
1000	958	6.5	147	8.5	113
1300	1,302			11.5	113
2000	2,030			19	107

[1] Consult website for latest IES files.
[2] Add 3 watts per fixture when specifying Lumentalk™.

Optics

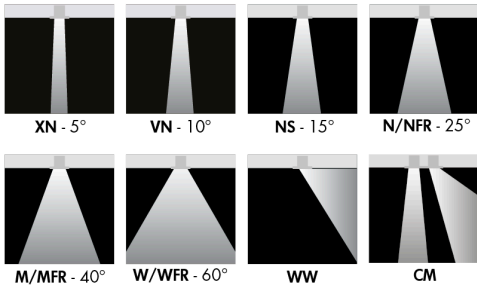

Color and Color temperature

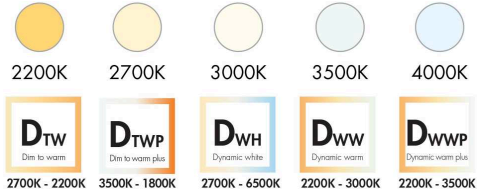

Description

Part of a family of multiple downlights, the Lumencore Recessed Multi 3 is a high-performance, triple gimbal LED downlight. Fully adjustable and providing a range of outputs, the Lumencore Recessed Multi 3 is an ideal replacement for metal halide. The luminaire offers a choice of beam angles (including an asymmetric distribution for wallwashing), color rendering options, a trimless version and accessories.

Features

Output (Nominal Lumens)	700 lm, 1000 lm, 1300 lm, 2000 lm
Color and Color Temperature	2200K 2700K 3000K 3500K 4000K Dim to Warm Dim to Warm Plus Dynamic White Dynamic Warm White Dynamic Warm White Plus
Optics (Nominal Distribution)	Extra Narrow Spot 5°, Very Narrow Spot 10°, Narrow Spot 15°, Narrow/Narrow Faceted Reflector 25°, Medium/Medium Faceted Reflector 40°, Wide/Wide Faceted Reflector 60°, True Asymmetric Wallwash, Custom Optics Combination
Installation Type	Remodel Non-Insulated Ceiling (Non-Plenum Rated), New Construction Non-Insulated Ceiling (Non-Plenum Rated), New Construction Insulated Ceiling (Enclosed Box), New Construction Insulated Ceiling - Chicago Plenum Rated Option (Airtight, Enclosed Box)
Warranty	5-year limited warranty

Controls

ON/OFF 0-10V PRO 0-10V DALI PRO DALI
DALI8 DMXrdrm LUTRON lumen talk PH
PPH

Trim shape

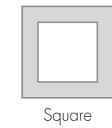

Trim finishes

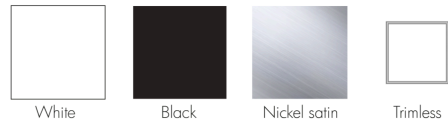

Adjustability



Certifications



Performance

Maximum Delivered Output	Up to 2,711 lm (narrow spot optic 15°, 4000K, CRI 80, one fixture head)
Maximum Delivered Intensity	Up to 63,952 cd (extra narrow spot optic 5°, 4000K, CRI 80, one fixture head)
Efficacy	Up to 129 lm/W (narrow spot optic 15°, 4000K, CRI 80, one luminaire head)
Color Consistency	2 SDCM, 3 SDCM (XN optic only)
Color Rendering	CRI 80+ CRI 90+ CRI 95+
Lumen Maintenance	L95 55,000 hrs L70 225,000 hrs
UGR	< 19 (not applicable to WW optic)

Physical

Housing Material	Aluminum
TIR Optics Material	Clear polycarbonate
Reflector Material	Aluminum
Trim Shape	Square
Interior finish	White, Black
Trim Finish	White, Black, Nickel Satin, Trimless
Adjustability	Up to 30° Tilt (Per Gimbal, Not Available for WW Optic)

Electrical and Control

Voltage	120 Volts, 277 Volts
Control	On/Off Control, Standard 0-10V Dimming 1% (Linear or Logarithmic Curve), Professional 0-10V Dimming 0.1% (Linear or Logarithmic Curve), Standard DALI Dimming 1% (Linear or Logarithmic Curve), Professional DALI Dimming 0.1% (Linear or Logarithmic Curve), DALI-2 T8 Enabled Dimming 1%, DMX/RDM Enabled Dimming 1%, Lutron® Hi-lume 1% EcoSystem® LDE1/PEQ1 Soft-on/Fade-to-Black, Lumentalk Enabled Dimming, Phase Dimming (Consult Factory), Phase Dimming 1%

Environmental

Environment	Damp location rating (interior applications only)
Operating Temperature	-4 °F to 104 °F
Ingress Protection Rating	IP20

Accessories (Order Separately)

Control Systems	Pharos® Expert Control Kit (EXPERT), Pharos® Lighting Control Kit (PHAROS)
Diagnostic and Addressing Tools	LumenID (LID)

Important

Virtual Patent Marking Notice

This website (<https://www.lmpg.com/patents-trademarks>) is provided to satisfy the virtual patent marking provisions of applicable jurisdictions. Some products listed may be covered by additional patents not referenced here.

Static Color Dimensions (22K, 27K, 30K, 35K, 40K)

XN (5°)/ VN (10°)

700lm CR80/CR90
(XN/VN)

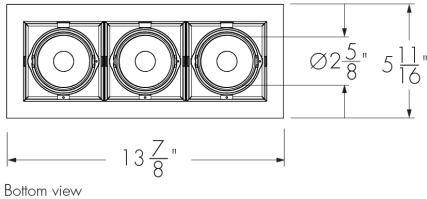
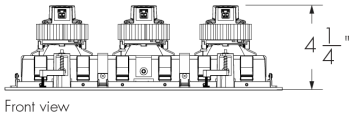

1000lm CR80/CR90
(VN)

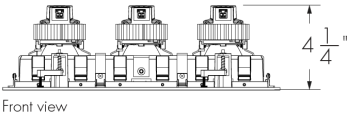

NS (15°)/ N (25°)

700/1000lm CR80/CR90/CR95
1300lm CR80/CR90

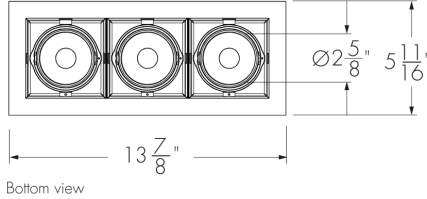
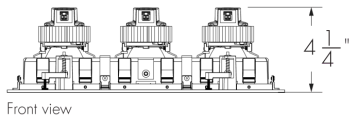

1300lm CR95
2000lm CR80/CR90

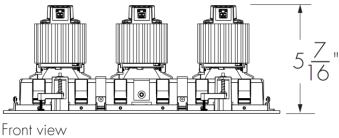

NFR (25°)/ M (40°)/ MFR (40°)/ W (60°)/ WFR (60°)

700/1000/1300lm CR80/CR90/CR95

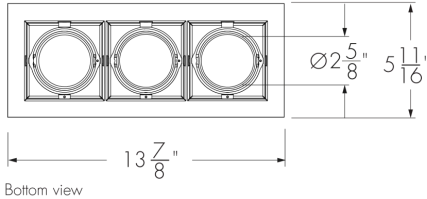
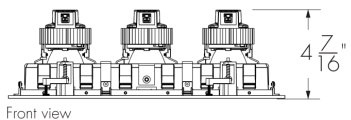

2000lm CR80/CR90/CR95

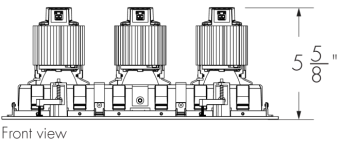

WW

700/1000/1300lm CR80/CR90/CR95

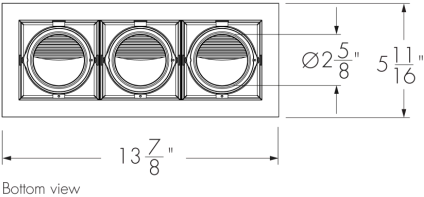
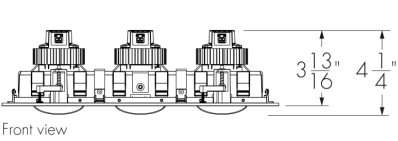

Color temperature options may vary according to optic. Refer to website product configurator for details.

Dynamic Color Dimensions (DTW, DTWP, DWH, DWW, DWWP)

NFR (25°)/ M (40°)/ MFR (40°)/ W (60°)/ WFR (60°)

1000lm CR90
(DTW/DTWP)

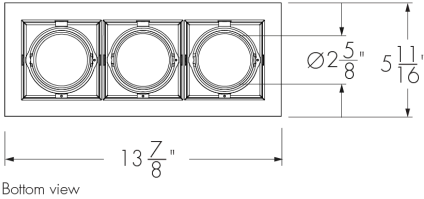
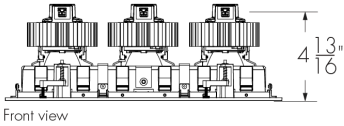

Color temperature options may vary according to optic. Refer to website product configurator for details.

2000lm CR80/CR90

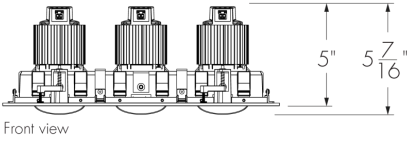

700lm CR80
(DWH/DWW/DWWP)

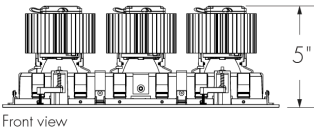

Trimless - Static Color Dimensions (22K, 27K, 30K, 35K, 40K)

XN (5°)/ VN (10°)

700lm CR80/CR90
(XN/VN)

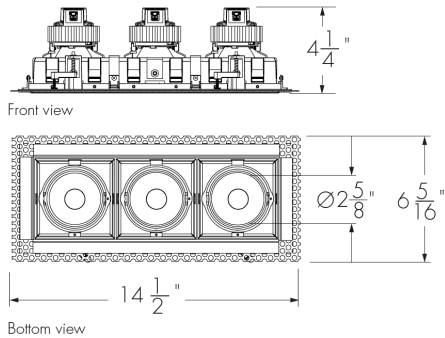

1000lm CR80/CR90
(VN)

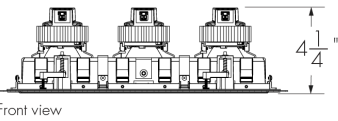

NS (15°)/ N (25°)

700/1000lm CR80/CR90/CR95
1300lm CR80/CR90

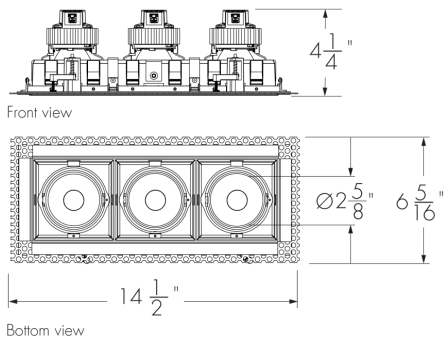

1300lm CR95
2000lm CR80/CR90

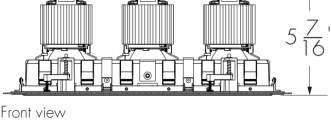

NFR (25°)/ M (40°)/ MFR (40°)/ W (60°)/ WFR (60°)

700/1000/1300lm CR80/CR90/CR95

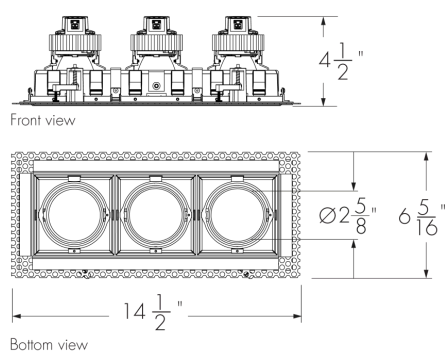

2000lm CR80/CR90/CR95

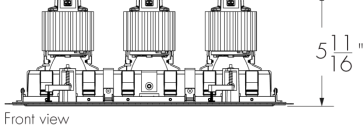

WW

700/1000/1300lm CR80/CR90/CR95

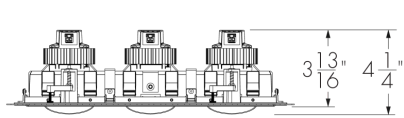

Front view

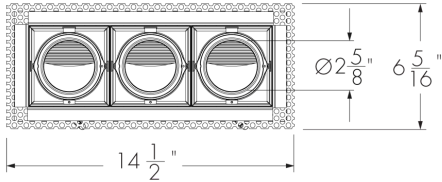

Bottom view

2000lm CR80/CR90

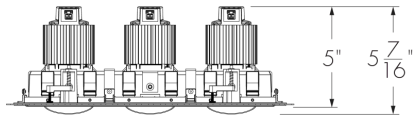

Front view

Color temperature options may vary according to optic. Refer to website product configurator for details.

Trimless - Dynamic Color Dimensions (DTW, DTWP, DWH, DWW, DWWP)

NFR (25°)/ M (40°)/ MFR (40°)/ W (60°)/ WFR (60°)

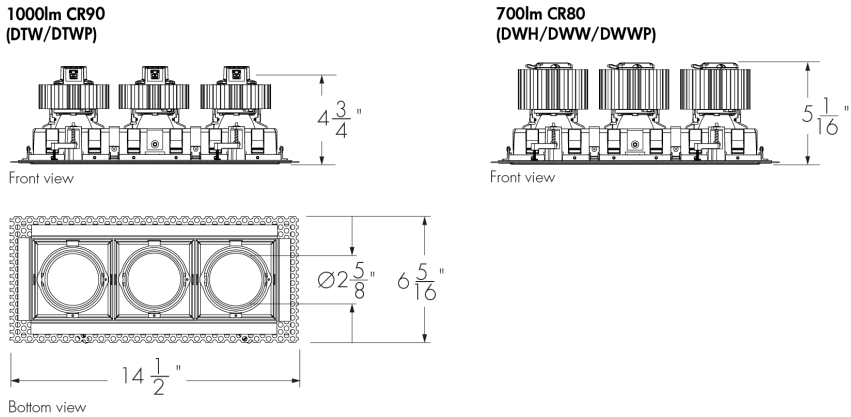

Color temperature options may vary according to optic. Refer to website product configurator for details.

Tilt limits - Typical Layouts

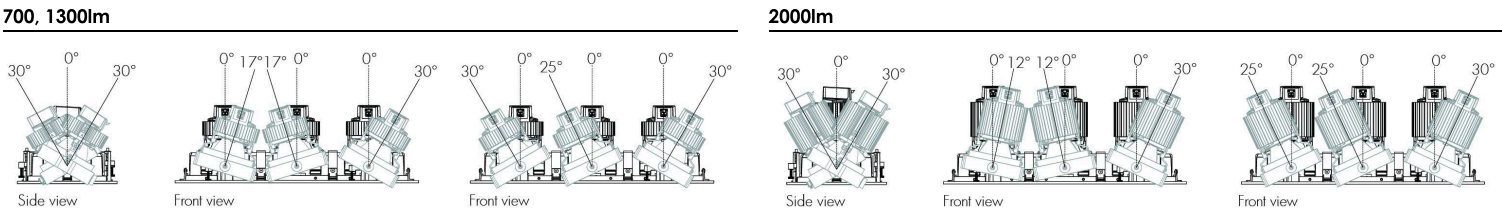

The position of each head will vary by installation. Each head can be tilted in any direction but the heatsinks must not come in contact with one another.

Photometric Information - Color Rendering Options Comparison, 3000K

Color sample	Ra	R1	R2	R3	R4	R5	R6	R7	R8	R9	R10	R11	R12	R13	R14	R15
CRI 80+	84	82	90	97	83	82	88	86	63	15	77	83	68	84	98	75
CRI 90+	94	95	98	99	95	94	97	91	80	55	93	97	83	96	99	89
CRI 95+	97	96	97	99	96	96	95	96	97	97	96	95	86	96	98	97
Radiant CRI 80+	84	83	91	96	81	82	89	83	62	15	79	80	69	85	98	76
Radiant CRI 95+	95	95	94	95	98	94	90	94	96	96	89	95	80	94	98	96

Optics

TIR Optic
XN/VN/NS/N



Semi-Specular reflector
M/W



Faceted reflector
NFR/MFR/WFR



Color and Color Temperature

Color Temperature Ranges

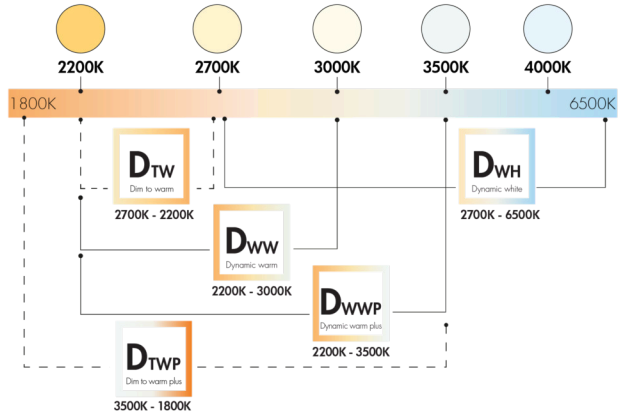

- 1 channel (DTW, DTWP) Compatible with: DA1 SDALI DMXrdm lumen talk
 - 2 channels (DWH, DWW, DWWP) Compatible with: DALI8 DMXrdm lumen talk
 - 3 channels* (DWH, DWW, DWWP) Compatible with: DALI8 DMXrdm lumen talk
- * Can be field changeable via RDM & LT for individual CCT control.

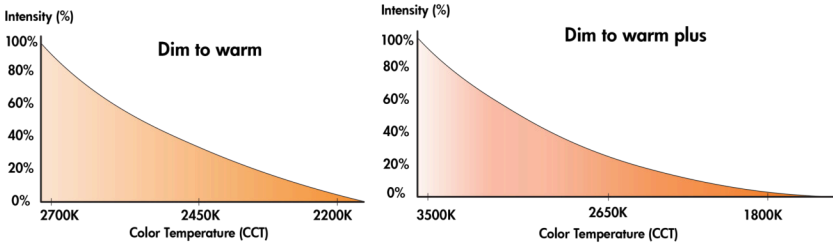

Control

Refer to website product configurator for exceptions

On/off control

NO - On/off control

Standard 0-10V dimming down to 1%

DAMC - Standard 0-10V dimming to 1% linear curve

DA1 - Standard 0-10V dimming, 1% linear

DA2 - Standard 0-10V dimming, 1% logarithmic

Professional 0-10V dimming down to 0.1%

PDA1 - Pro 0-10V dimming, 0.1% linear

PDA2 - Pro 0-10V dimming, 0.1% logarithmic

Standard DALI dimming down to 1%

SDALI1 - Standard DALI dimming, 1% linear

SDALI2 - Standard DALI dimming, 1% logarithmic

Professional DALI dimming down to 0.1%

DALI1 - Pro DALI dimming, 0.1% linear

DALI2 - Pro DALI dimming, 0.1% logarithmic

Lutron® EcoSystem®

ES - Lutron® Hi-lume 1% EcoSystem® LDE1/PEQ1 Soft-on/Fade-to-Black, 1% minimum dimming value

DALI dimming Type 8

DALI8 - DALI dimming Type 8 (multi channel capability)

DMXrdm

DMX/RDM - DMX/RDM enabled

lumen talk dimming

LT - Lumentalk dimming, 1% minimum dimming value

Phase dimming (consult factory)

PH - Phase dimming

PPH - Phase 1% dimming

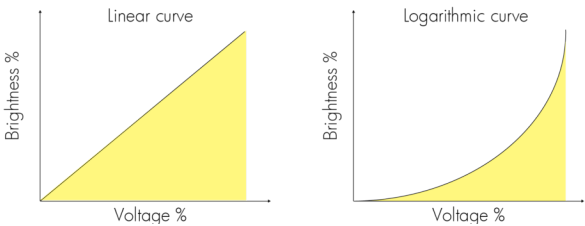

Photometric Information (RM And NC Installation Types)

XN - Extra Narrow Spot (Nominal 5°), 4000K

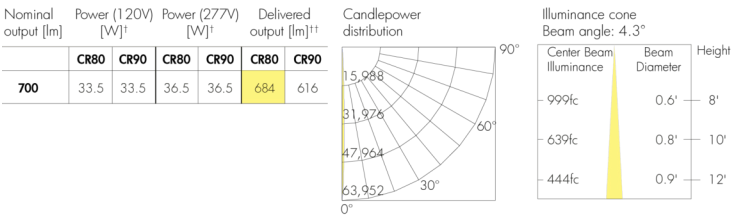

VN - Very Narrow Spot (Nominal 10°), 4000K

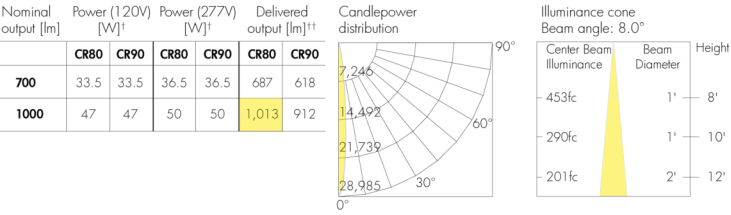

NS - Narrow Spot (Nominal 15°), One Fixture Head, 4000K

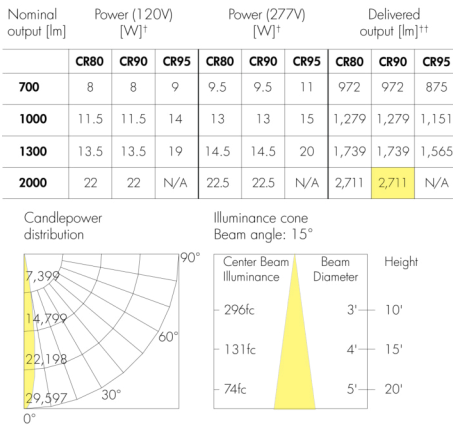

N - Narrow (Nominal 25°), One Fixture Head, 4000K

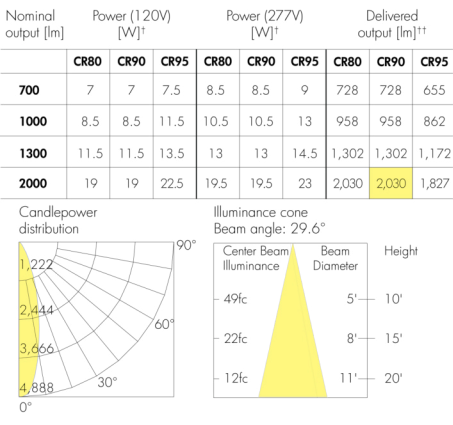

M - Medium (Nominal 40°), One Fixture Head, 4000K

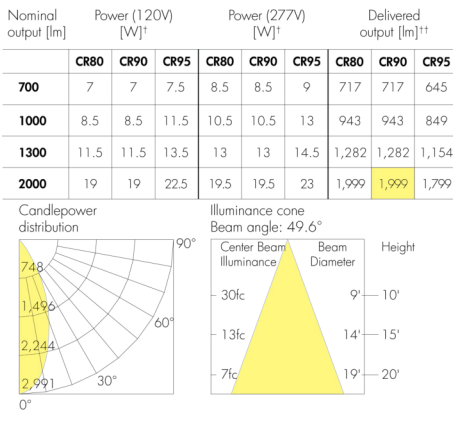

MFR - Medium Faceted Reflector (Nominal 40°), 4000K

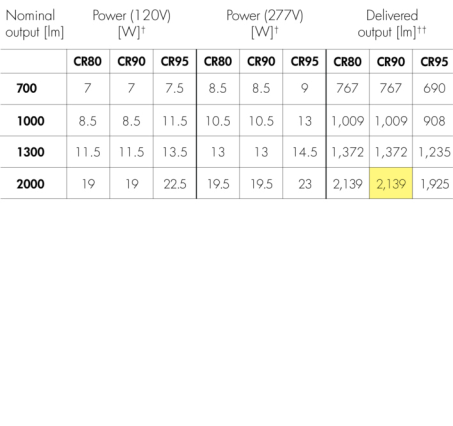

1Remove 2 watts per fixture when specifying new construction insulated ceiling installation types (IC and CP).
2Add 3 watts per fixture when specifying Lumentalk™.
†Delivered wattage: +/- 10% tolerance.
††Consult website for latest IES files. Delivered output: +/- 10% tolerance.
Photometric performance is measured in compliance with IESNA LM-79-24.

W - Wide (Nominal 60°), One Fixture Head, 4000K

Nominal output [lm]	Power (120V) [W]†			Power (277V) [W]†			Delivered output [lm]††		
	CR80	CR90	CR95	CR80	CR90	CR95	CR80	CR90	CR95
700	7	7	7.5	8.5	8.5	9	684	684	616
1000	8.5	8.5	11.5	10.5	10.5	13	900	900	810
1300	11.5	11.5	13.5	13	13	14.5	1,224	1,224	1,102
2000	19	19	22.5	19.5	19.5	23	1,908	1,908	1,717

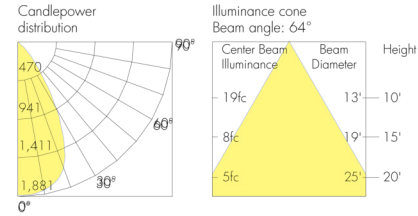

WFR - Wide Faceted Reflector (Nominal 60°), 4000K

Nominal output [lm]	Power (120V) [W]†			Power (277V) [W]†			Delivered output [lm]††		
	CR80	CR90	CR95	CR80	CR90	CR95	CR80	CR90	CR95
700	7	7	7.5	8.5	8.5	9	732	732	659
1000	8.5	8.5	11.5	10.5	10.5	13	963	963	867
1300	11.5	11.5	13.5	13	13	14.5	1,310	1,310	1,179
2000	19	19	22.5	19.5	19.5	23	2,042	2,042	1,837

WW - True Asymmetric Wallwash, One Fixture Head, 4000K

Nominal output [lm]	Power (120V) [W]†			Power (277V) [W]†			Delivered output [lm]††		
	CR80	CR90	CR95	CR80	CR90	CR95	CR80	CR90	CR95
700	9.5	9.5	10.5	11	11	12.5	629	629	566
1000	13	13	15	15	15	17	828	828	745
1300	15	15	20	17	17	21	1,126	1,126	1,013
2000	23	23	N/A	24	24	N/A	1,756	1,756	N/A

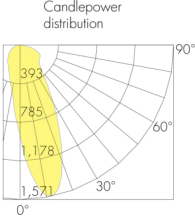

1Remove 2 watts per fixture when specifying new construction insulated ceiling installation types (IC and CP).

2Add 3 watts per fixture when specifying Lumentalk™.

†Delivered wattage: +/- 10% tolerance.

††Consult website for latest IES files. Delivered output: +/- 10% tolerance.

Photometric performance is measured in compliance with IESNA LM-79-24.

Ceiling Requirements

Minimum Ceiling Height

Installation type	700lm	1000lm	1300lm	2000lm
RM	7"			
NC				
IC/CP	9"			

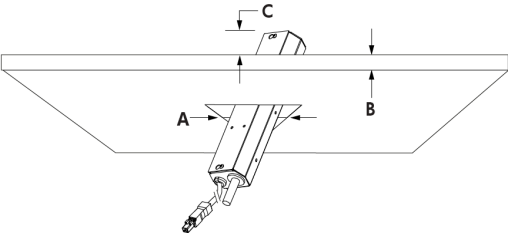

- A - Ceiling cutout : 5 1/4 in x 13 in
- B - Maximum ceiling thickness: 1 in
- C - Minimum ceiling height

Installation Types

RM: Remodel Non-Insulated Ceiling (Non-Plenum Rated) (NO Control and Dimming)

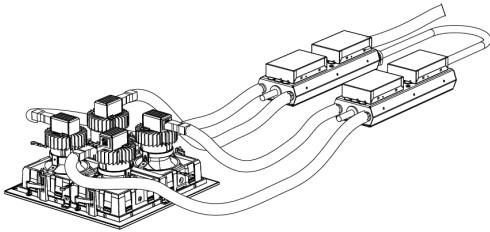

RM: Remodel Non-Insulated Ceiling (Non-Plenum Rated) (LT Control)

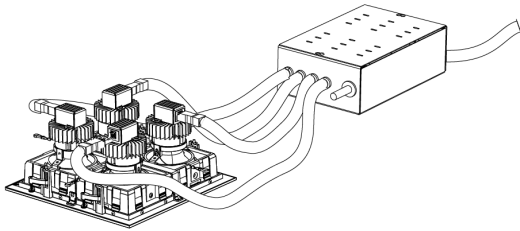

NC: New Construction Non-Insulated Ceiling (Non-Plenum Rated) (NO Control and Dimming)

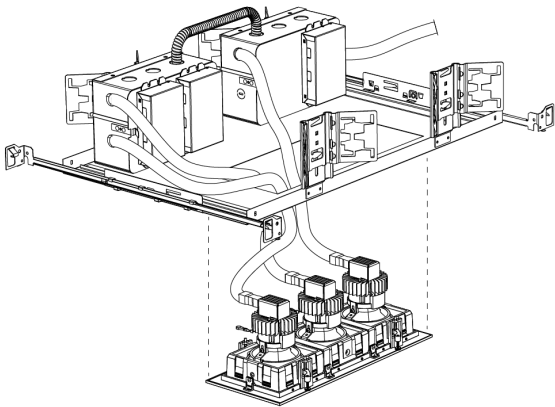

IC/CP: New Construction Insulated Ceiling (Enclosed Box)

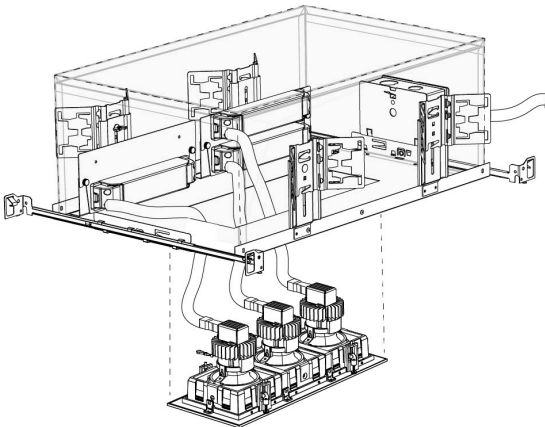

Fixture shown for reference only. Refer to Ceiling Requirements section and installation instructions for dimensions and ceiling cutout requirements.

Wiring Details RM: Remodel Non-Insulated Ceiling (Non-Plenum Rated)

On/Off Control

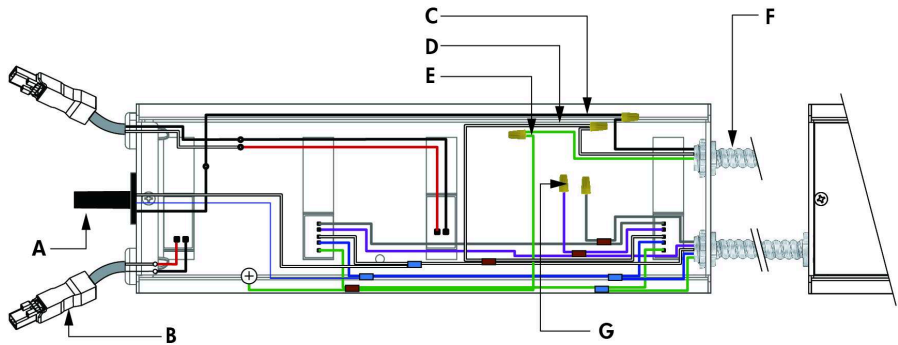

- A - Thermal protector
- B - Output to luminaire
- C - Line (black)
- D - Neutral (white)
- E - Ground (green)
- F - Input (conduit, fitting & locknut by others)
- G - Secure data wires if not in use

Control (DAMC, DA1, DA2, PDA1, PDA2, DALI1, DALI2, EcoSystem®)*

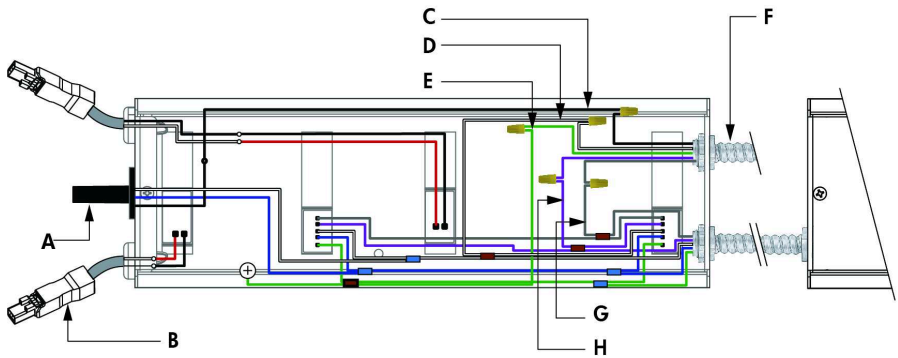

- A - Thermal protector
- B - Output to luminaire
- C - Line (black)
- D - Neutral (white)
- E - Ground (green)
- F - Input (conduit, fitting & locknut by others)
- G - Data - (gray)
- H - Data + (purple)

Control (Daisy Chain Layout) (DAMC, DA1, DA2, PDA1, PDA2, DALI1, DALI2, EcoSystem®)*

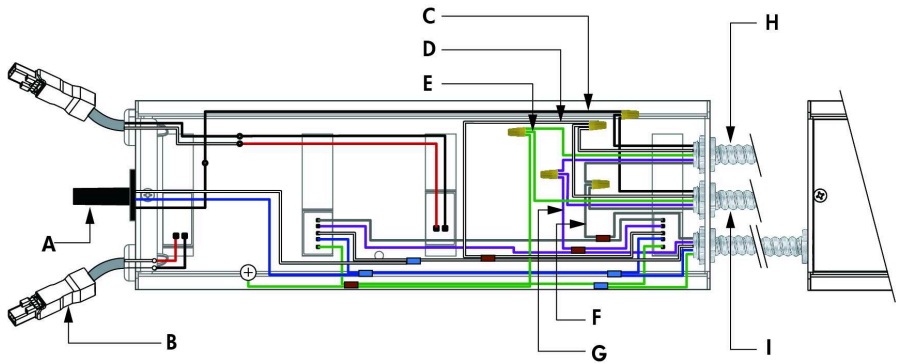

- A - Thermal protector
- B - Output to luminaire
- C - Line (black)
- D - Neutral (white)
- E - Ground (green)
- F - Data + (purple)
- G - Data - (gray)
- H - Input (conduit, fitting & locknut by others)
- I - Output to next luminaire (conduit, fitting & locknut by others)

*Each Lumencore Recessed Multi 3 fixture head has its own address; a Lumencore Recessed Multi 3 fixture has three EcoSystem® addresses. Lutron® EcoSystem® Enabled dimming is not available for 700 lumens or 1000 lumens.

Refer to installation instructions for additional wiring details.

Wiring Details RM: Remodel Non-Insulated Ceiling (Non-Plenum Rated) (LT Control)

Control (LT)

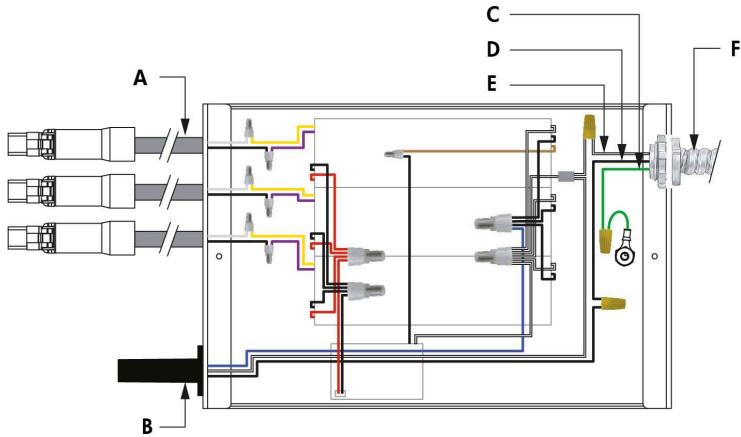

- A - Output to luminaire
- B - Thermal protector
- C - Ground (green)
- D - Line (black)
- E - Neutral (white)
- F - Input (conduit, fitting & locknut by others)

Control (Daisy Chain Layout) (LT)

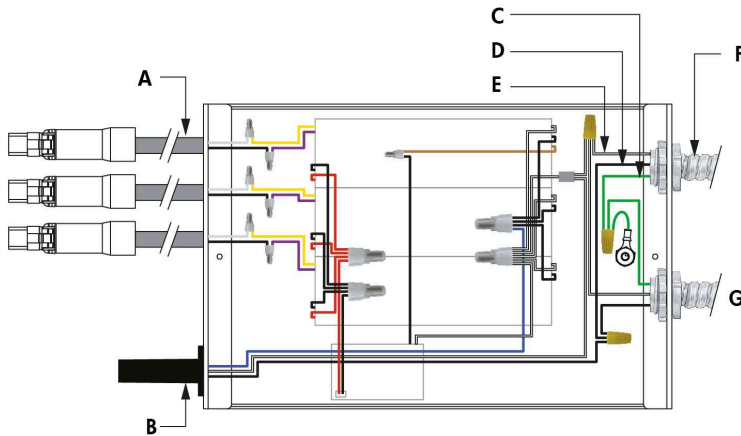

- A - Output to luminaire
- B - Thermal protector
- C - Ground (green)
- D - Line (black)
- E - Neutral (white)
- F - Input (conduit, fitting & locknut by others)
- G - Output to next luminaire

Refer to installation instructions for additional wiring details.

Wiring Details NC: New Construction Non-Insulated Ceiling (Non-Plenum Rated)

On/Off Control

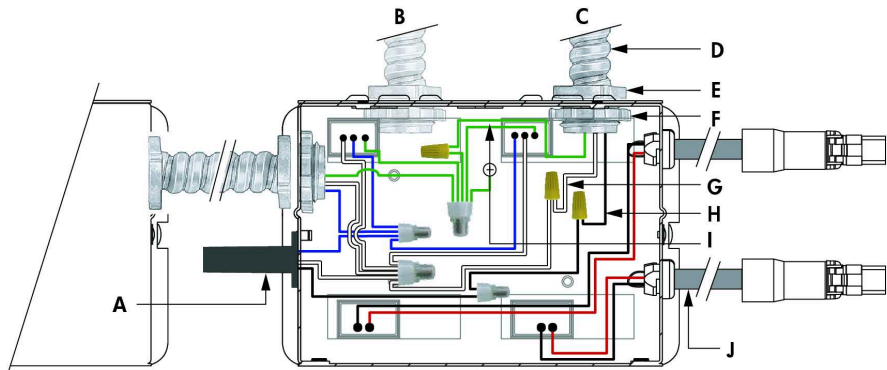

- A - Thermal protector
- B - Optional Output
- C - Power Input
- D - Conduit (by others)
- E - Conduit fitting (by others)
- F - Locknut (by others)
- G - Neutral (white)
- H - Line (black)
- I - Ground (green)
- J - Output to luminaire

Control (DAMC, DA1, DA2, PDA1, PDA2, DALI1, DALI2, EcoSystem®)*

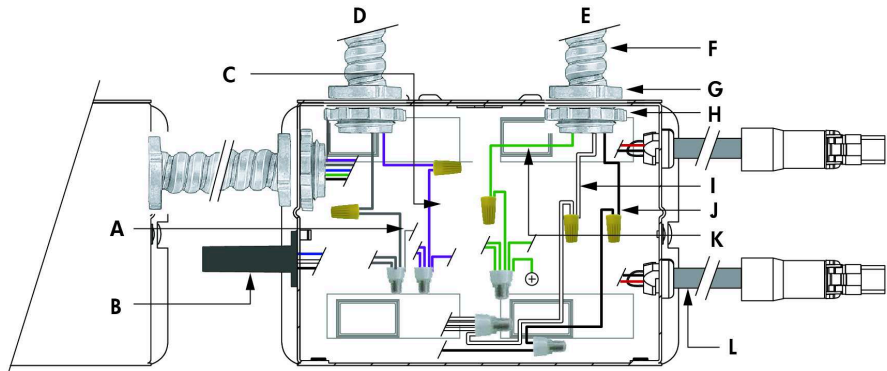

- A - Data - (gray)
- B - Thermal protector
- C - Data + (purple)
- D - Data Input from Control System
- E - Power Input
- F - Conduit (bt others)
- G - Conduit fitting (by others)
- H - Locknut (by others)
- I - Neutral (white)
- J - Line (black)
- K - Ground (green)
- L - Output to luminaire

Control (Daisy Chain Layout) (DAMC, DA1, DA2, PDA1, PDA2, DALI1, DALI2, EcoSystem®)*

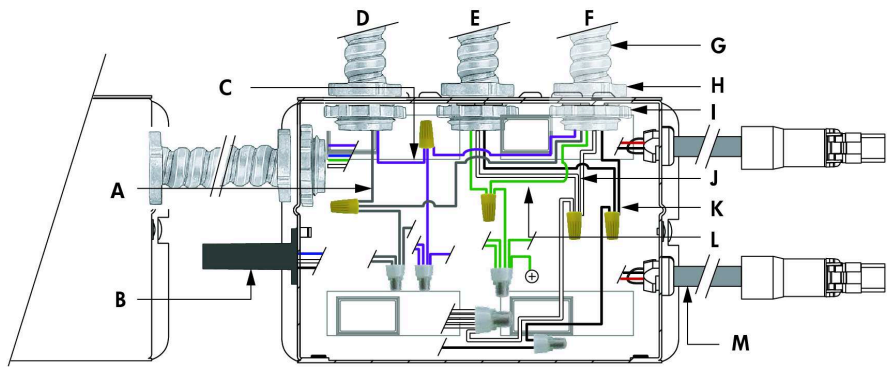

- A - Data - (gray)
- B - Thermal protector
- C - Data + (purple)
- D - Data Input from Control System
- E - Power Input
- F - Optional Output
- G- Conduit (bt others)
- H - Conduit fitting (by others)
- I - Locknut (by others)
- J - Neutral (white)
- K - Line (black)
- L - Ground (green)
- M - Output to luminaire

*Each Lumencore Recessed Multi 3 fixture head has its own address; a Lumencore Recessed Multi 3 fixture has three EcoSystem® addresses. Lutron® EcoSystem® Enabled dimming is not available for 700 lumens or 1000 lumens.

Refer to installation instructions for additional wiring details.

Wiring Details IC/CP: New Construction Insulated Ceiling (Enclosed Box)

On/Off Control

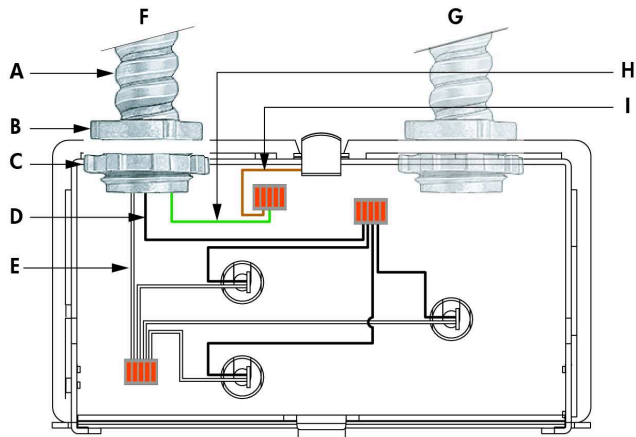

- A - Conduit (by others)
- B - Conduit fitting (by others)
- C - Locknut (by others)
- D - Line (black)
- E - Neutral (white)
- F - Power Input
- G - Optional Output
- H - Ground (green)
- I - Ground (copper)

Control (DA1, DA2, PDA1, PDA2, DALI1, DALI2)

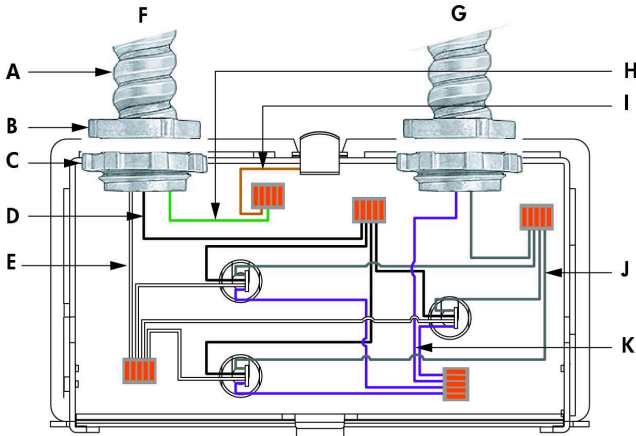

- A - Conduit (by others)
- B - Conduit fitting (by others)
- C - Locknut (by others)
- D - Line (black)
- E - Neutral (white)
- F - Power Input
- G - Data Input from Control System
- H - Ground (green)
- I - Ground (copper)
- J - Data - (gray)
- K - Data + (purple)

Control (Daisy Chain Layout) (DA1, DA2, PDA1, PDA2, DALI1, DALI2)

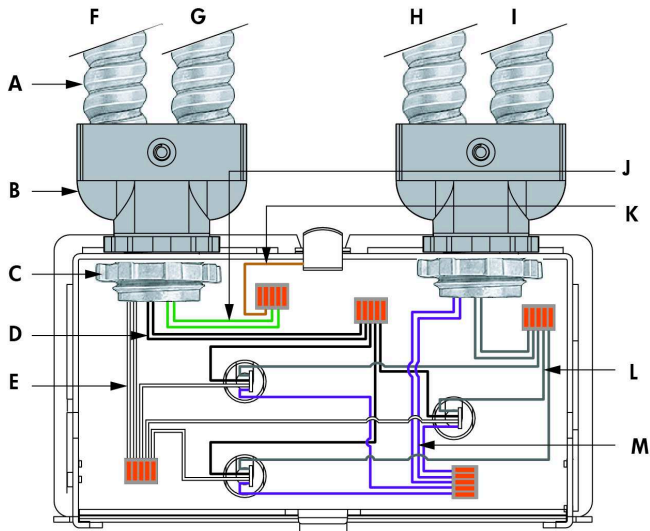

- A - Conduit (by others)
- B - Duplex connector (by others)
- C - Locknut (by others)
- D - Line (black)
- E - Neutral (white)
- F - Power Input
- G - Power Output to next luminaire
- H - Data Input from Control System
- I - Data Output to next luminaire
- J - Ground (green)
- K - Ground (copper)
- L - Data - (gray)
- M - Data + (purple)

Refer to installation instructions for additional wiring details.

Optical Accessories

SL - Softening Glass Lens



CL - Clear Glass Lens



HL - Honeycomb Louver

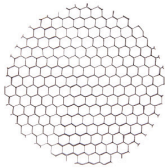

PD - Prismatic Diffuser



XLVR - Concentric Ring Louver

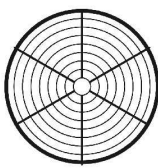

LSN - Linear Spread Lens Narrow (1° x 40°)

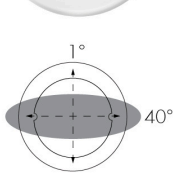

Horizontal Beam Distribution

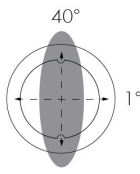

Vertical Beam Distribution

LSW - Linear Spread Lens Wide (1° x 60°)

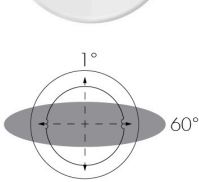

Horizontal Beam Distribution

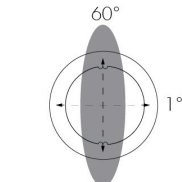

Vertical Beam Distribution

WHSN - White Snoot



BKSN - Black Snoot



Diagnostic And Addressing Tools (Order Separately)

LID - LumenID



The updated LumenID (LID) is now your all-in-one diagnostic and addressing solution for both DMX/RDM and Lumentalk (LT) systems. Engineered for versatility, it streamlines commissioning and troubleshooting across protocols—no need for multiple tools. Consult the LID specification sheet for full details.

Control Systems (Order Separately)

PHAROS - Pharos® Designer Lighting Control Kit

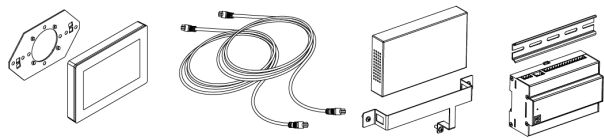

The Pharos Designer Lighting Control Kit, available for 1 or 2 DMX universes, allows for complete control of large lighting installations.

EXPERT - Pharos® Expert Control Kit

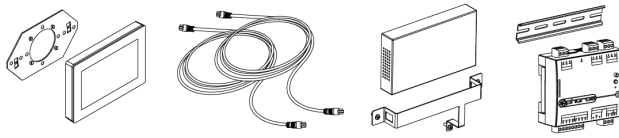

The Pharos Expert Control Kit, available for 1, 2, 4 or 6 DMX universes, allows for complete control of large lighting installations.

How to Order

Housing ⁽¹⁾	Certification	Voltage ⁽²⁾	Output (Nominal Lumens)	Color and Color Temperature	Color Rendering	Optics (Nominal Distribution)	Trim Shape	Interior Finish	Trim Finish
LAMC3 Lumencore Recessed Multi 3	A UL/cUL	120 120 Volts 277 277 Volts	L07 700 lm	22K 2200K ⁽⁵⁾ ⁽⁶⁾	CR80 CRI 80+ ⁽¹²⁾	XN Extra Narrow Spot 5° ⁽¹⁵⁾	SQ Square	IWH White	WH White
			L10 1000 lm ⁽³⁾	27K 2700K	CR90 CRI 90+	VN Very Narrow Spot 10° ⁽¹⁴⁾		IBK Black	BK Black
			L13 1300 lm ⁽⁴⁾	30K 3000K	CR95 CRI 95+ ⁽¹³⁾	NS Narrow Spot 15°			NST Nickel Satin
			L20 2000 lm ⁽⁴⁾	35K 3500K	RCR80 Radiant CRI 80+ ⁽⁶⁾ ⁽¹⁴⁾	N Narrow 25°			TRL Trimless
				40K 4000K	RCR95 Radiant CRI 95+ ⁽⁶⁾ ⁽¹³⁾ ⁽¹⁴⁾	NFR Narrow Faceted Reflector 25°			
				DTW Dim to Warm (2700K to 2200K) ⁽⁷⁾ ⁽⁸⁾ ⁽⁹⁾		M Medium 40°			
				DTWP Dim to Warm Plus (3500K to 1800K) ⁽⁷⁾ ⁽⁸⁾ ⁽⁹⁾		MFR Medium Faceted Reflector 40°			
				DWH Dynamic White (2700K to 6500K) ⁽⁸⁾ ⁽⁹⁾ ⁽¹⁰⁾		W Wide 60°			
				DWW Dynamic Warm White (2200K to 3000K) ⁽⁸⁾ ⁽⁹⁾ ⁽¹⁰⁾		WFR Wide Faceted Reflector 60°			
				DWWP Dynamic Warm White Plus (2200K to 3500K) ⁽⁸⁾ ⁽⁹⁾ ⁽¹⁰⁾		WW True Asymmetric Wallwash ⁽¹⁷⁾ ⁽¹⁸⁾			
				CM Custom Color Temperature Combination ⁽¹¹⁾		CM Custom Optics Combination ⁽¹¹⁾			

Notes:

1. Refer to website product configurator for all exceptions.

2. Consult factory for 347 volts.

3. Available for VN, NS, N, NFR, M, MFR, W, WFR and WW optics only.

4. Available for NS, N, NFR, M, MFR, W, WFR and WW optics only.

5. Available for CR80 only.

6. Not available for XN and VN optics.

7. Available for 1000 lumens when combined with CR90 and NFR, M, MFR, W or WFR optics only.

8. NFR, MFR and WFR faceted reflector optics are recommended for optimal performance.

9. Not available for WW optic.

10. Available for 700 lumens when combined with CR80 and NFR, M, MFR, W or WFR optics only.

11. Refer to the Personalized Multi Submittal Drawing download for ordering information.

12. Available for 2200K, 2700K, 3000K, 3500K, 4000K and DWH, DWW or DWWP color options only.

13. CR95 and RCR95 available up to 1300 lumens for NS and WW optics and up to 2000 lumens for N, NFR, M, MFR, W and WFR optics.

14. Radiant CRI options available for 3000K only.

15. Available for 700 lumens when combined with CR80 or CR90 color rendering options only.

16. Available for 700 and 1000 lumens when combined with CR80 or CR90 color rendering options only.

17. Accessories not available for WW optic.

18. The color of the true asymmetric wallwash baffle matches the interior finish of the fixture. A white baffle is provided for a white interior finish, a black baffle is provided for a black interior finish.

How to Order

Control ⁽²¹⁾	Installation Type	Accessories ⁽¹⁷⁾ ⁽⁴⁴⁾ ⁽⁴⁵⁾
NO On/Off Control ⁽¹⁹⁾ ⁽²⁰⁾ DAMC Standard 0-10V Dimming 1% Linear Curve ⁽²⁰⁾ ⁽²²⁾ ⁽²³⁾ ⁽²⁴⁾ DA1 Standard 0-10V Dimming 1% Linear Curve ⁽²⁵⁾ ⁽²⁶⁾ DA2 Standard 1-10V Dimming 1% Logarithmic Curve ⁽²⁵⁾ ⁽²⁶⁾ PDA1 Professional 0-10V Dimming 0.1% Linear Curve ⁽²⁰⁾ ⁽²⁵⁾ PDA2 Professional 0-10V Dimming 0.1% Logarithmic Curve ⁽²⁰⁾ ⁽²⁵⁾ SDALI1 Standard DALI Dimming 1% Linear Curve ⁽²⁷⁾ SDALI2 Standard DALI Dimming 1% Logarithmic Curve ⁽²⁷⁾ DALI1 Professional DALI Dimming 0.1% Linear Curve ⁽²⁰⁾ ⁽²⁸⁾ DALI2 Professional DALI Dimming 0.1% Logarithmic Curve ⁽²⁰⁾ ⁽²⁸⁾ DALIT8 DALI-2 T8 Enabled Dimming 1% ⁽²⁹⁾ ⁽³⁰⁾ DMX/RDM DMX/RDM Enabled Dimming 1% ⁽³¹⁾ ⁽³²⁾ ⁽³³⁾ ES Lutron® Hi-lume 1% EcoSystem® LDE1/PEQ1 Soft-on/Fade-to-Black ⁽⁶⁾ ⁽²⁰⁾ ⁽³⁴⁾ LT Lumentalk Enabled Dimming ⁽³⁵⁾ ⁽³⁶⁾ PH Phase Dimming (Consult Factory) ⁽³⁷⁾ ⁽³⁸⁾ ⁽³⁹⁾ PPH Phase Dimming 1% ⁽⁶⁾ ⁽²⁰⁾ ⁽³⁸⁾ ⁽⁴⁰⁾	RM Remodel Non-Insulated Ceiling (Non-Plenum Rated) NC New Construction Non-Insulated Ceiling (Non-Plenum Rated) IC New Construction Insulated Ceiling (Enclosed Box) ⁽⁴¹⁾ ⁽⁴²⁾ ⁽⁴³⁾ CP New Construction Insulated Ceiling - Chicago Plenum Rated Option (Airtight, Enclosed Box) ⁽⁴¹⁾ ⁽⁴²⁾ ⁽⁴³⁾	NA No Accessory SL Softening Glass Lens HL Honeycomb Louver ⁽⁴⁶⁾ XLVR Concentric Ring Louver ⁽⁴⁷⁾ CL Clear Glass Lens PD Prismatic Diffuser ⁽⁴⁸⁾ LSN Linear Spread Lens Narrow (1° x 40°) ⁽⁴⁹⁾ LSW Linear Spread Lens Wide (1° x 60°) ⁽⁴⁹⁾ WHSN White Snoot BKSN Black Snoot CM Custom Accessory Combination ⁽¹¹⁾

Notes:

- 6.** Not available for XN and VN optics.

11. Refer to the Personalized Multi Submittal Drawing download for ordering information.

17. Accessories not available for WW optic.

19. Manufacturer's choice driver. Order code may change to NO1.

20. Not available for DTW, DTWP, DWH, DWW or DWWP color options.

21. Control options vary according to color temperature, color rendering, optics and installation type combination. Refer to website product configurator for details.

22. Manufacturer's choice driver. Order code may change to DAMC1 or DAMC2.

23. Not available for XN and VN optics.

24. Available for RM and NC installation types only.

25. Driver cuts off power to the fixture when the control signal drops below 0.5V.

26. Not available for DWH, DWW or DWWP color options.

27. Available for DTW and DTWP color options only, when combined with 1000 lumens.

28. Consult factory for other DALI control options for static color temperatures.

29. Available for DWH, DWW and DWWP color options only. DALI-2 Type 8 controller required.

30. Consult factory for DALIT8 control option.

31. Configurable to 1, 2, or 3 channel control via RDM in the field.

32. A Control Box (CBX-DS or CBX-ST) and lumenID (UID) must be specified.

33. Available for DTW, DTWP, DWH, DWW and DWWP color options only.

34. One EcoSystem® address per fixture. 1% minimum dimming value. Lutron® EcoSystem® Enabled dimming available for RM and NC installation types only. Lutron® EcoSystem® Enabled dimming not available for 700 lumens or 1000 lumens.
- 35.** 1% minimum dimming value. Lumentalk dimming available for RM installation type when combined with 2200K, 2700K, 3000K, 3500K or 4000K color options and any of the optic options. Lumentalk dimming available for NC installation type when combined with 2200K, 2700K, 3000K, 3500K or 4000K color options and XN or VN optic options. Lumentalk is available for RM and NC installation types when combined with DTW, DTWP, DWH, DWW or DWWP color options and NFR, M, MFR, W or WFR optic options. Lumentalk dimming available up to 1000 lumens (CR80, RCR80, CR90, CR95 or RCR95), 1300 lumens (CR80, RCR80 or CR90).

36. A Lumentranslator 2 (LTL2) and LumenID (UID) must be specified for Lumentalk applications. Consult Lumentranslator 2 and Lumentalk pages and specification sheets for details.

37. Manufacturer's choice driver. Order code may change to PH1 or PH2.

38. Available for 120V only. Not available for IC and CP installation types.

39. Available for 2700K, 3000K, 3500K and 4000K color options when combined with XN or VN optics only.

40. Manufacturer's choice driver. Order code is subject to change.

41. Insulated ceiling available up to 700 lumens (CR80, RCR80, CR90, CR95 or RCR95), 1000 lumens (CR80, RCR80 or CR90).

42. Insulated ceiling available for DTW or DTWP color options when combined with the DA1, DA2, SDALI1 or SDALI2 control options.

43. Not available for DWH, DWW or DWWP color options.

44. Factory installed.

45. One lens or honeycomb louver can be installed per fixture. The snoot can be combined with any accessory.

46. HL accessory is available for 2200K, 2700K, 3000K, 3500K and 4000K color options only.

47. Available for XN, VN and NS optics only. The concentric ring louver cannot be combined with other accessories.

48. Can be combined with HL accessory for 2200K, 2700K, 3000K, 3500K and 4000K color options only.

49. Available for XN, VN, NS, N and NFR optics when combined with 2200K, 2700K, 3000K, 3500K, 4000K color options only. Available for NFR optic only when combined with DTW, DTWP, DWH, DWW or DWWP color options only.