

Project Name

Qty

Type

Catalog / Part Number

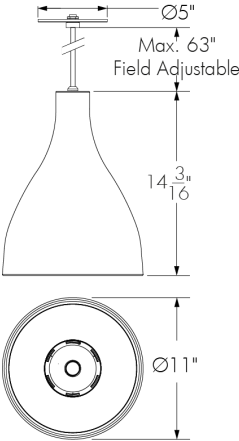

Front View

Bottom View

Photometric Summary

Consult the Photometric Information section of the Specification Sheet for 3000K CRI 92 data. For all other configurations, consult IES files on the Lumenpulse website.

Color and Color Temperature

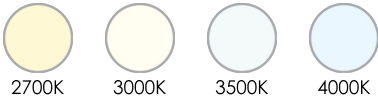

Color Rendering

CRI 92 CRI 98

Control

ON/OFF 0-10V Phase Dimming

Mounting and Cable Finish

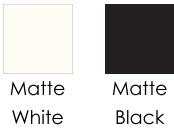

Description

Playful yet powerful, the WILLY Large pendants are inherently decorative; they are designed to be seen, they have a presence, even when unlit. Exenia's command of paints, textures, and finishes makes our pendants especially striking. The vast choice of colored finishes makes them highly applicable to any color scheme or type of space for work or leisure.

Features

Output (Nominal Lumens)	L20: 2000 lm
Color and Color Temperature	27K: 2700K 30K: 3000K 35K: 3500K 40K: 4000K
Mounting and Cable Finish	MWH: Matte White MBK: Matte Black
Finish	GLR: Glossy Red IBR: Italian Brick Red GGR: Glossy Green GYL: Glossy Yellow GWH: Glossy White MBK: Matte Black MBL: Matte Blue CRT: Corten CGY: Concrete Grey CC: Custom Color and Finish (Please Specify RAL Color) SP: Special color (Choose From standard Point Source Color Palette)

Finish



Glossy Red



Italian Brick Red



Glossy Green



Glossy Yellow



Glossy White



Matte Black



Matte Blue



Corten



Concrete Grey



Custom Color & Finish



Special
Point
Source
Color

Bezel Finish



Glossy Red



Italian Brick Red



Glossy Green



Glossy Yellow



Glossy White



Matte Black



Matte Blue



Concrete Grey



Custom Color & Finish



Special Point Source Color

Certifications



Bezel Finish

GLR: Glossy Red
IBR: Italian Brick Red
GGR: Glossy Green
GYL: Glossy Yellow
GWH: Glossy White
MBK: Matte Black
MBL: Matte Blue
CGY: Concrete Grey
CC: Custom Color and Finish (Please Specify RAL Color)
SP: Special Color (Choose From Standard Point Source Color Palette)

Optic (Nominal Distribution)

FL: Flood 35°
WFL: Wide Flood 55°

Warranty

5-year limited warranty

Performance

Maximum Delivered Output	Up to 2,847 lm (L20, CRI 92, 40K, WFL)
Maximum Delivered Intensity	7,498 cd at nadir (L20, CRI 92, 40K, FL)
Efficacy	Up to 107 lm/W (L20, CRI 92, 40K, WFL)
Color Rendering	92: CRI 92 98: CRI 98
Color Consistency	2 SDCM
Lumen Maintenance	L70 120,000 hours L95 19,000 hours

Physical

Housing Material	Spun aluminum (Spun steel for Corten finish)
Reflector Material	Spun aluminum
Weight	4.45 lbs

Electrical and Control

Voltage	120/277: 120/277 Volts
Wattage	26.6 Watts
Control	NO: On/Off Control DIM: 0-10V Dimming 1% PH: Phase Dimming 1%

Flicker	Designed to comply with recommended practices of IEEE 1789:2015
---------	---

Environmental

Ingress Protection Rating	IP20
Environment	Damp location (interior applications only)
Operating Temperature	-4 °F to 86 °F

Important

Virtual Patent Marking Notice

This website (<https://www.lmpg.com/patents-trademarks>) is provided to satisfy the virtual patent marking provisions of applicable jurisdictions. Some products listed may be covered by additional patents not referenced here.

Photometric Information

Flood, L20, 3000K, CRI 92

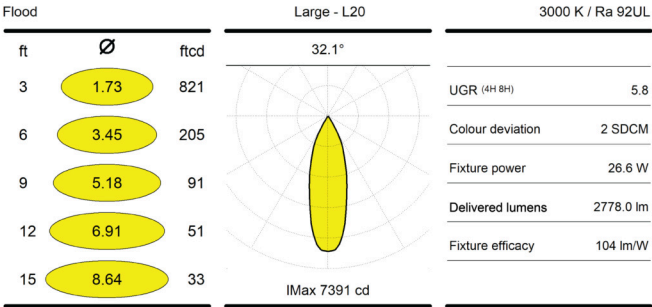

Wide Flood, L20, 3000K, CRI 92

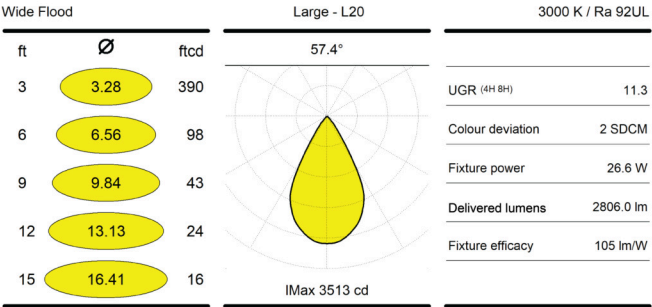

For all other configurations, consult IES files on the Lumenpulse website.

Wattage Information

L20 - Output

FL	Flood	26.6W
WFL	Wide Flood	

How to Order

Housing	Size	Voltage	Control	Output (Nominal Lumens)	Finish	Mounting Option Finish ⁽⁵⁾	Color Rendering	Color and Color Temperature	Bezel Finish	Optic (Nominal Distribution)
WL WILLY	L Large	120/277 120/277 Volts	NO On/Off Control DIM 0-10V Dimming 1% PH Phase Dimming 1% ⁽¹⁾	L20 2000 lm	GLR Glossy Red IBR Italian Brick Red GGR Glossy Green GYL Glossy Yellow GWH Glossy White MBK Matte Black MBL Matte Blue CGY Concrete Grey CRT Corten ⁽²⁾ CC Custom Color & Finish ⁽³⁾ SP Special Color (Choose From Standard Point Source Color Palette) ⁽⁴⁾	MWH Matte White MBK Matte Black	92 CRI 92 98 CRI 98	27K 2700K 30K 3000K 35K 3500K 40K 4000K	GLR Glossy Red IBR Italian Brick Red GGR Glossy Green GYL Glossy Yellow GWH Glossy White MBK Matte Black MBL Matte Blue CGY Concrete Grey CC Custom Color & Finish ⁽³⁾ SP Special Color (Choose From Standard Point Source Color Palette) ⁽⁴⁾	FL Flood 35° WFL Wide Flood 55°

Notes:

1. Phase dimming (PH) is only compatible with 120V power.
2. The Corten finish, achieved through a natural process, may show variations in tone and texture, which are expected and not considered imperfections.
3. Longer lead times can be expected for custom RAL color finishes.
4. Refer to Cylinder specification sheet and brochure for color options.
5. The color of the electrical cable matches the color specified for the mounting option.