

Project Name

Qty

Type

Catalog / Part Number

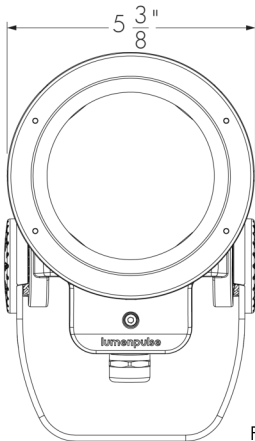

Front View

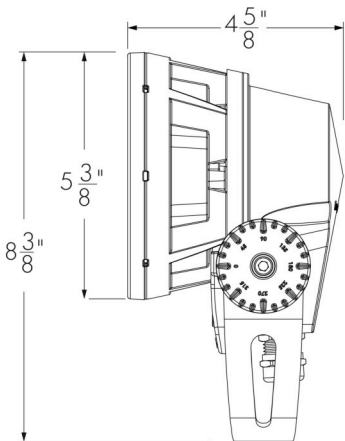

Side View

Photometric Summary

Symmetric

	Delivered output (lm)	Intensity (peak cd)
VN (6°)	930	44,976
NS (10°)	893	31,178
NF (20°)	817	6,934
M (30°)	784	3,619
FL (40°)	760	2,157
WFL (60°)	619	501
VWFL (90°)	767	398

Asymmetric

NAS	835	13,303 (@2.5°)
WW	765	3,394 (@5°)

1. Based on DWH, full output.
2. Photometric performance is measured in compliance with IESNA LM-79-24.
3. Refer to the [Lumenbeam Dynamic White Photometric Guide](#) on [lumenpulse.com](#) for information on other color temperatures.

Optic

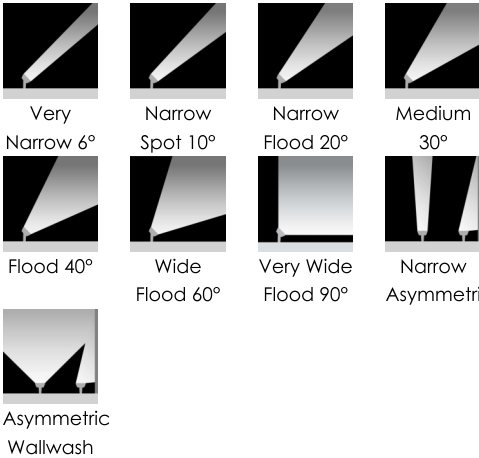

Description

The Lumenbeam Small Dynamic White is a compact, IP66-rated luminaire for lighting landscapes, trees, columns, monuments, and architectural details with a special feature that enables the selection of any color temperature from 2200K to 3000K or from 2700K to 6500K. This dynamic feature gives designers and their clients the freedom to alter the ambiance of a space in response to the time of day or the way a space is used. A number of other options are on offer: optics for flood or accent lighting, as well as accessories, spread lenses, and controls. The luminaire also has an anti-corrosion option for use in harsh, chemical, or coastal environments.

Features

Color and Color Temperature	<b>DWW:</b> Dynamic Warm White (2200K to 3000K), <b>DWH:</b> Dynamic White (2700K to 6500K)
Optics (Nominal Distribution)	<b>VN:</b> VN (6°), <b>NS:</b> NS (10°), <b>NF:</b> NF (20°), <b>M:</b> M (30°), <b>FL:</b> FL (40°), <b>WFL:</b> WFL (60°), <b>VWFL:</b> VWFL (90°), <b>NAS:</b> NAS (Narrow Asymmetric), <b>WW:</b> WW (Asymmetric Wallwash)
Optical Option	<b>LSLH:</b> Linear Spread Lens Horizontal Distribution, <b>LSLV:</b> Linear Spread Lens Vertical Distribution
Mounting Option	<b>SK:</b> Stake Mounting, <b>KN:</b> Knuckle Mounting, <b>CN:</b> Canopy Mounting Option (for Mounting on a Standard Round Junction Box)
Option	<b>RY:</b> Rotational Yoke, <b>3GV:</b> 3G ANSI C136.31-2010 Vibration Rating for Bridge Applications, <b>CRC:</b> Corrosion-Resistant Coating for Hostile Environments
Cable Color	Black, White
Power Consumption	14 W (12 W for DTW control option)
Warranty	5-year limited warranty

Color and Color Temperature



**D<sub>WW</sub>**  
Dynamic  
Warm  
White  
(2200K to  
3000K)



**D<sub>WH</sub>**  
Dynamic  
White  
(2700K to  
6500K)

Control

DIM/DTW    DMX/RDM1    DMX/RDM    DALI  
T8

Ratings

IP66    IK07

Certifications





Performance

Maximum Delivered Output	720 lm (DWW full output, VN 6°, DMX/RDM) 930 lm (DWH full output, VN 6°, DMX/RDM)
Maximum Delivered Intensity	34,811 cd at nadir (DWW full output, VN 6°, DMX/RDM) 44,976 cd at nadir (DWH full output, VN 6°, DMX/RDM)
Illuminance at Distance	Minimum 1 fc at 187 ft (DWW full output, VN 6°, DMX/RDM) Minimum 1 fc at 213 ft (DWH full output, VN 6°, DMX/RDM)
Lumen Maintenance	L70 120,000 hrs (Ta 25 °C)

Physical

Housing Material	Low copper content high pressure die-cast aluminum
Yoke Material	Heavy aluminum
Lens Material	Clear tempered glass
Hardware Material	Stainless steel
Gasket Material	Silicone
Surface Finish	Electrostatically applied polyester powder coat
Weight	5.2 lbs
EPA	Front = 0.19 ft², Side = 0.11 ft²

Electrical and Control

Voltage	100 to 277 volts
Fixture Cable	Power and data in one cable
Conductors	5C #16-5 (DIM/DTW, DALIT8 control) 6C #14-3/ #24-3 (DMX/RDM1, DMX/RDM control)
Control	Dim to Warm via 0-10V (2700K to 2200K), Dim to Warm via Single-Channel DMX/RDM (2700K to 2200K), DMX/RDM Enabled 3-Channel Color Temperature Control, DALI 2 T8 Enabled Dimming 0.1%, Lumentalk system is enabled with LDB accessory - see typical wiring diagrams for details
Resolution (DMX/RDM)	Per fixture, 8-bit or 16-bit
Dynamic Warm Color Temperature Mixing	9 LEDs (3x 2200K, 3x 2700K, 3x 3000K)
Dynamic White Color Temperature Mixing	9 LEDs (3x 2700K, 3x 4000K, 3x 6500K)

Environmental

Storage Temperature	-40 °F to 158 °F (device must reach start-up temperature value before operating)
Start-up Temperature	-13 °F to 122 °F
Operating Temperature	-40 °F to 122 °F
Ingress Protection Rating	IP66 Wet location rated
Impact Resistance Rating	IK07

Application Wind Speed	Luminaires were designed based on AASHTO 2013 standard to ensure highest quality and safety. Installation should be validated by a local project engineer to ensure the luminaires are suitable for the wind speed and exposure of the specific application
------------------------	---

Accessories (Order Separately)

Optical Accessories	Lumenbeam Small Snoot, Lumenbeam Small Visor, Lumenbeam Small Linear Spread Lens Adjustable, Lumenbeam Small Wire Guard, Lumenbeam Small Dome Lens
---------------------	--

Control Boxes	DMX/RDM enabled (Daisy Chain or Star Configuration), Ethernet enabled (Daisy Chain or Star Configuration), Lumentalk Data Bridge
---------------	--

Control Systems	Pharos® Designer Lighting Control Kit (PHAROS), Pharos® Expert Control Kit (EXPERT)
-----------------	---

Diagnostic and Addressing Tools	LumenID (LID)
---------------------------------	---------------

Important

Virtual Patent Marking Notice

This website (<https://www.lmpg.com/patents-trademarks>) is provided to satisfy the virtual patent marking provisions of applicable jurisdictions. Some products listed may be covered by additional patents not referenced here.

Chromaticity Data

TM-30 - DWW

CCT	CIE		TM-30	
DWW	R <sub>a</sub>	86	87	R <sub>f</sub>
Full Output	R <sub>g</sub>	26	97	R <sub>g</sub>

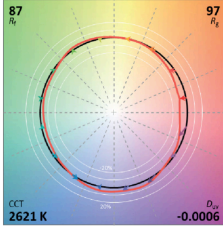

DWW Spectral Power Distribution

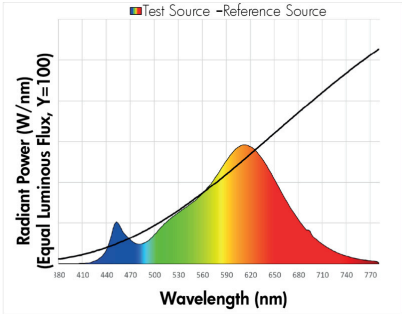

TM-30 - DWH

CCT	CIE		TM-30	
DWH	R <sub>a</sub>	81	80	R <sub>f</sub>
Full Output	R <sub>g</sub>	22	99	R <sub>g</sub>

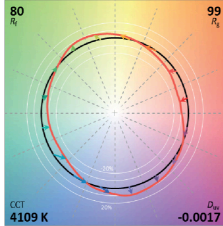

DWH Spectral Power Distribution

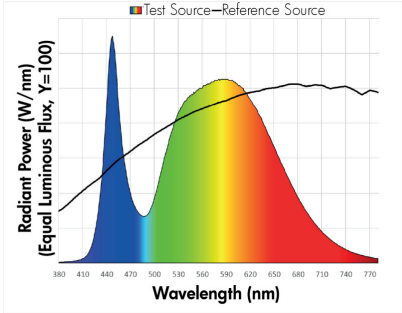

Mounting Options

RY - Rotational Yoke

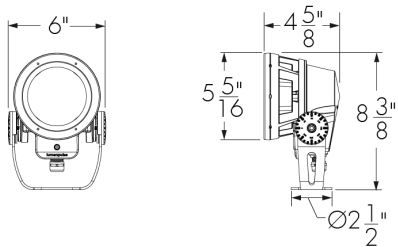

Mounting Details

Mounting Hole Pattern - Standard Yoke

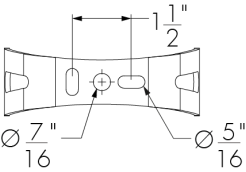

3 bolts are required for wind and vibration resistance, provided by others.

Mounting Hole Pattern - Rotational Yoke

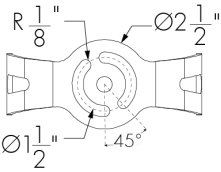

3 bolts are required for wind and vibration resistance, provided by others.

Adjustable Pivot Limits

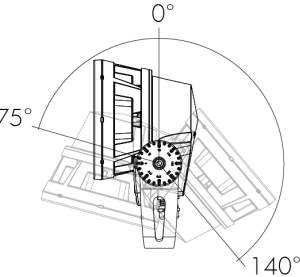

Mounting Options

SK - Stake Mounting

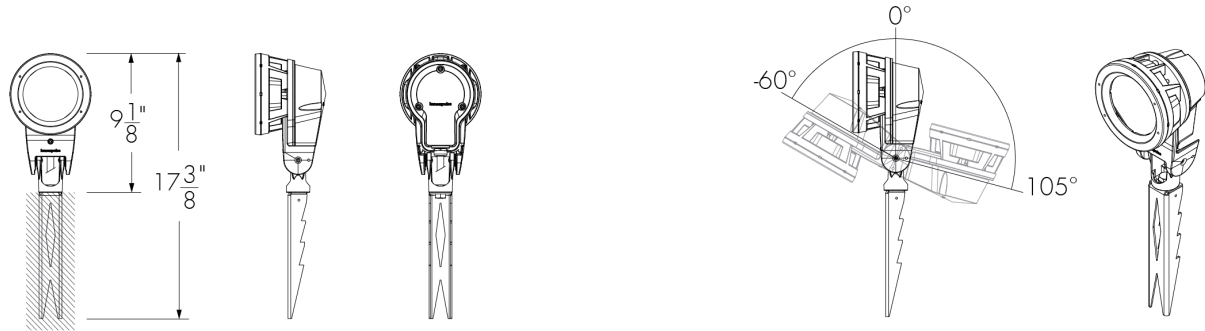

Adjustable Pivot Limits

KN - Knuckle Mounting



Adjustable Pivot Limits

CN - Canopy Cover

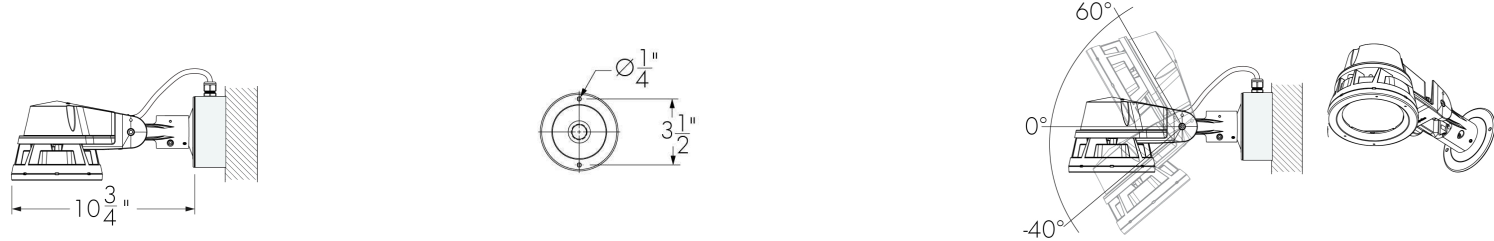

Suitable for standard round junction boxes, surface mounted

Mounting Hole Pattern

Adjustable Pivot Limits

Optical Options

LSLH - Linear Spread Lens Horizontal Distribution

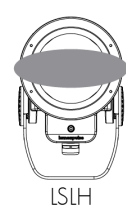

LSLV - Linear Spread Lens Vertical Distribution

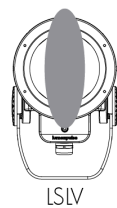

Beam Angles

Optic installed in fixture	Beam angle with LSLH/LSLV
VN	7° x 60°
NS	13° x 66°
NF	16° x 62°
M	23° x 65°
FL	33° x 70°

LLF: 0.88\*  
\*LLF may vary slightly by distribution chosen.

Factory installed, not adjustable on site. Not available for WFL, VWFL, NAS and WW optics.  
See 'Optical Accessories' section for field adjustable spread lens (LSLA).

Mounting Accessories (Order Separately)

Round Pole Mounting Accessory

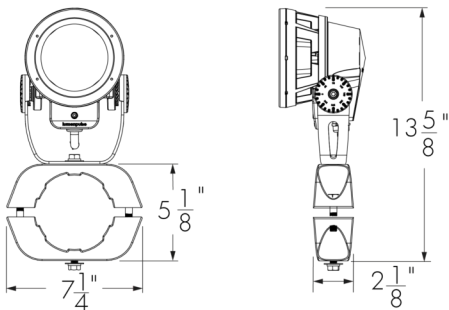

PM4 model shown.  
Consult factory for square pole section.

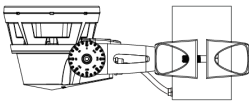

PM4-1, PM4.5-1, PM5-1 - Round Pole Mounting Accessory - Single Fixture

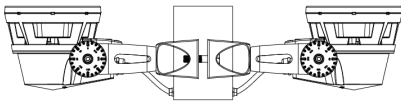

PM4-2, PM4.5-2, PM5-2 - Round Pole Mounting Accessory - Twin Fixtures  
\*One bracket assembly is supplied per 2 fixtures unless otherwise specified.

	PM4	PM4.5	PM5
For pole Ø	4" ± 1/16	4.5" ± 1/16	5" ± 1/16

Consult factory for other pole diameters.

PLTU - Universal Yoke

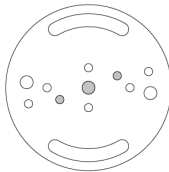
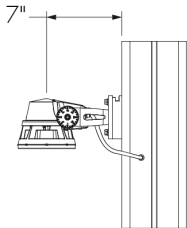
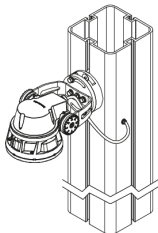

Refer to the Universal Yoke specification sheet and Pole installation instructions for more details. Square Lumentech profile shown.

The mounting holes used for this fixture are shown in gray.

Tenon Adapter

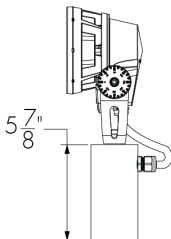
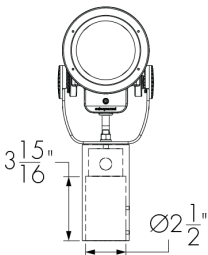
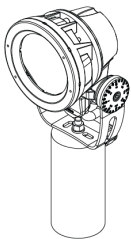

TN2 - Tenon Adapter to Fit on 2 3/8 in O.D. Tenon  
Vertical mounting only. Consult factory for horizontal mounting.

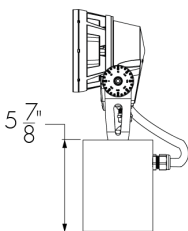
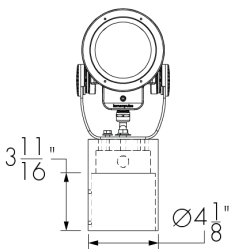
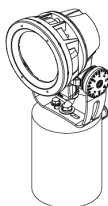

TN4 - Tenon Adpater to Fit on 4 in O.D. Tenon  
Vertical mounting only. Consult factory for horizontal mounting.

Optical Accessories (Order Separately)

Installed optical accessories will affect the maximum pivot limits for each mounting option, consult factory for details.

SN - Snoot

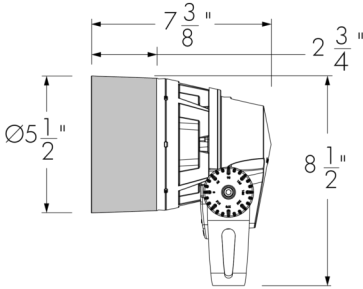

LBSSN-FINISH-BK-OPTIONS (CRC)  
Interior surface painted black. Please specify the exterior **FINISH** from the list of finishes in the fixture order code.

LSLA - Linear Spread Lens Adjustable

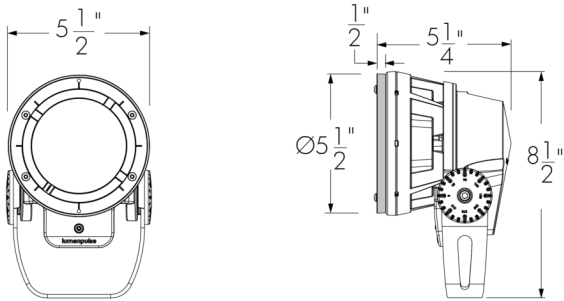

LBSLSLA-FINISH-OPTIONS (CRC)  
Please specify the exterior **FINISH** from the list of finishes in the fixture order code.

Installed optical accessories will affect the maximum pivot limits for each mounting option, consult factory for details.

DM - Dome Lens

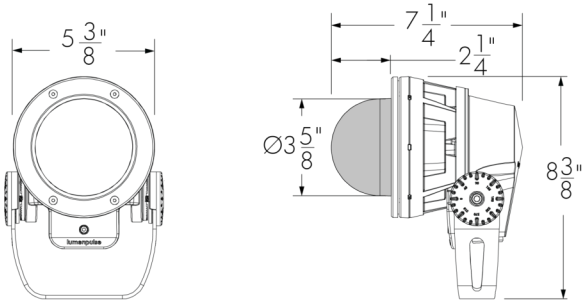

LBSDM-FINISH-OPTIONS (CRC)  
Please specify the exterior **FINISH** from the list of finishes in the fixture order code.

Dome Lens is available with WFL Optic only. The WFL optic must be specified for the fixture.  
Dome Lens cannot be combined with other optical accessories.  
Dome Lens will affect beam distribution. Consult factory for application support and photometric performance.

VS - Visor

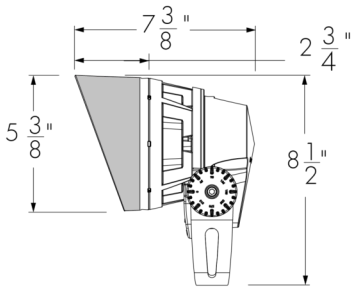

LBSVS-FINISH-BK-OPTIONS (CRC)  
Interior surface painted black. Please specify the exterior **FINISH** from the list of finishes in the fixture order code.

WG - Wire Guard

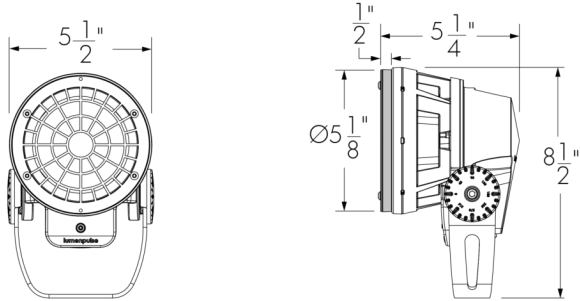

LBSWG-FINISH-OPTIONS (CRC)  
Please specify the exterior **FINISH** from the list of finishes in the fixture order code.

Dome - Standard Yoke - Pivot limits

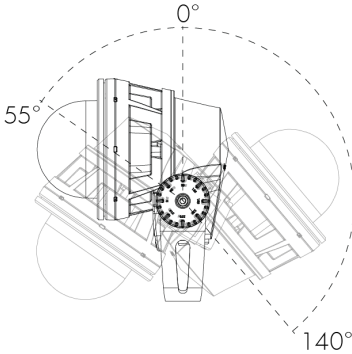

Accessory Combinations

	+	Snoot	Visor
Linear spread lens adjustable		LBSSNLSLA	LBSVSLSLA
Wire guard		LBSSNWWG	LBSVSWWG

Accessory combinations must be ordered together on a single line. A maximum of two accessories can be combined per fixture. Ex: A snoot + wire guard combination order code is LBSSNWWG-FINISH-BK-OPTIONS.

Diffuser Lenses (Intended for Mockup Purposes Only, Order Separately)

Diffuser Lens 1 (1 Notch)

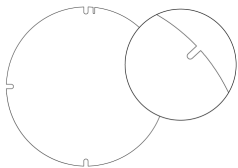

147665

Diffuser Lens 2 (2 Notches)

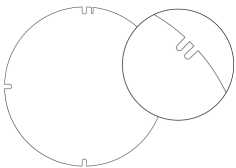

147666

Diffuser Lens 3 (3 Notches)

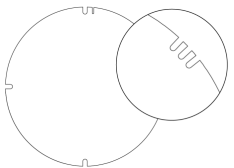

147667

Diffuser Lens 4 (4 Notches)

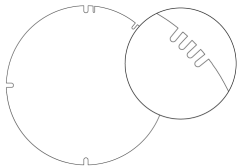

147668

Diffuser Lens 5 (5 Notches)

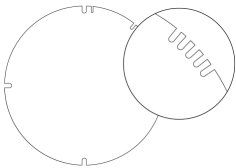

147669

Diffuser Lens 6 (6 Notches)

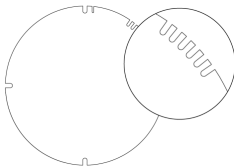

147670

Final Distribution Using Diffuser Lenses

	Final Distribution Using Diffuser Lens					
Original Distribution on Fixture	Diffuser Lens 1 1 Notch	Diffuser Lens 2 2 Notches	Diffuser Lens 3 3 Notches	Diffuser Lens 4 4 Notches	Diffuser Lens 5 5 Notches	Diffuser Lens 6 6 Notches
XN (4°/5°)	VN	NS	NF	M	FL	WFL
VN (6°)	NS					
NS (10°)						
NF (20°)						
M (30°)			FL	WFL		
FL (40°)						
WFL (60°)				VWFL		
VWFL (90°)						

Choose a diffuser lens based on the desired final beam distribution. Refer to the 6-digit part numbers above to order diffuser lenses individually. To order a complete set of 6 diffuser lenses in a bag, refer to the following item names: **LBS**: LBALK-S **LBM/LBMP**: LBALK-M **LBL/LBLP**: LBALK-L **LBG/LBGP**: LBALK-G **LBX/LBXP**: LBALK-X.

The diffuser lenses are intended for mockup purposes only. A lens holder is required to install a diffuser lens on the fixture, order separately using the following names: **LBS**: LBSLSLA-FINISH-LBALK **LBM/LBMP**: LBMLSLSLA-FINISH-LBALK **LBL/LBLP**: LBLLSLSLA-FINISH-LBALK **LBG/LBGP**: LBGLSLA-FINISH-LBALK **LBX/LBXP**: LBXLSLA-FINISH-LBALK

Please specify the exterior **FINISH** from the list of finishes in the fixture order code.

Refer to the Diffuser Lens Installation Instructions on the Lumenpulse website for information on installing the diffuser lenses.



Control Boxes (Order Separately)

CBX-DMX/RDM - DMX/RDM Enabled (Daisy Chain or Star Configuration)

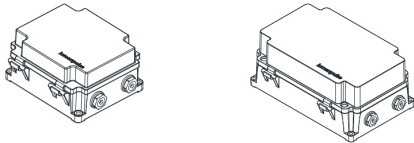

DMX/RDM control box. Up to six power and data outputs to fixtures or fixture runs. Consult CBX specification sheet and installation instructions for details. Lumenterminators provided with CBX (2x for Daisy Chain configuration, 6x for Star configuration), consult factory to order spares.

CBX-ENET - Ethernet Enabled (Daisy Chain or Star Configuration)

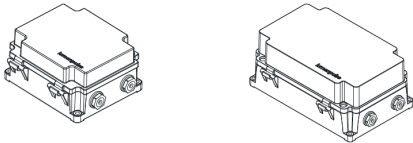

Ethernet control box. Up to four power and data outputs to fixture or fixture runs. Consult Ethernet CBX specification sheet and installation instructions for details.

LDB - Lumentalk Data Bridge

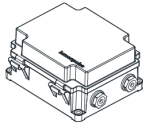

Lumentalk Data Bridge, 0-10V or DMX output. Consult LDB specification sheet for details.

Control Systems (Order Separately)

PHAROS - Pharos® Designer Lighting Control Kit



The Pharos Designer Lighting Control Kit, available for 1 or 2 DMX universes, allows for complete control of large lighting installations.

EXPERT - Pharos® Expert Control Kit

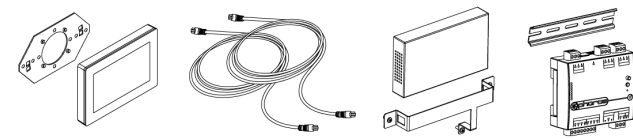

The Pharos Expert Control Kit, available for 1, 2, 4 or 6 DMX universes, allows for complete control of large lighting installations.



Diagnostic And Addressing Tools (Order Separately)

LID - LumenID

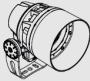
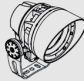

The updated LumenID (LID) is an all-in-one diagnostic and addressing solution for both DMX/RDM and Lumentalk (LT) systems. Engineered for versatility, it streamlines commissioning and troubleshooting across protocols—no need for multiple tools. Cable option may vary; please consult factory. For complete details, refer to the LID specification sheet.

EPA Guide

	LBS	LBS with Snoot	LBS with Visor	LBS with Dome Lens
				
EPA front (sq ft)	0.188	0.188	0.188	0.188
EPA side (sq ft)	0.113	0.186	0.176	0.133

Typical Wiring Diagrams

Wiring Color Code

UL Color Code	USE
Green	Ground
Black	Line
White	Line/Neutral
Red or Purple	0-10V / Data +
Orange	0-10V / Data -
Gray	Signal common (DMX/RDM only)

Lumentalk (LT)

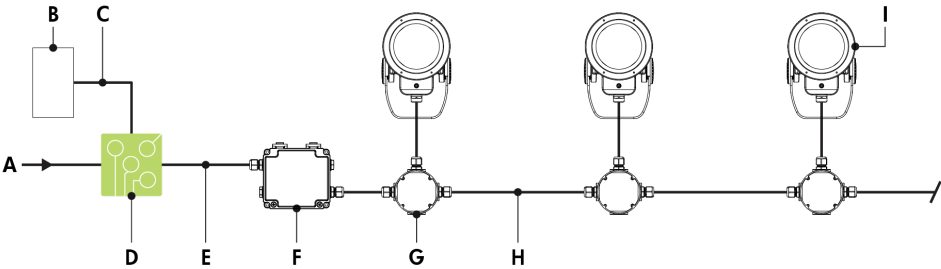

- A - Power input (100-277V AC, wiring by others)
- B - DMX/RDM controller (order separately from Lumenpulse, or by others)
- C - Data wiring (by others)
- D - Lumentranslator 2 (LTL2-DMX)
- E - Power wiring (by others)
- F - Lumentalk Data Bridge (LDB-DMX)
- G - Junction box (by others)
- H - Power and data wiring (by others)
- I - Lumenbeam Small

Lumentalk (LT) - Wiring Detail Using LDB

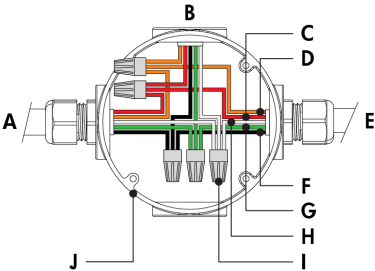

- A - From Lumentalk Data Bridge (control over power line via Lumentalk system) or from previous fixture
- B - To fixture
- C - 0-10 V + / Data +
- D - 0-10 V - / Data -
- E - To next fixture
- F - Line
- G - Ground
- H - Line/Neutral
- I - Wire-nut (by others)
- J - Junction box (by others)

- Consult factory for specific applications and maximum fixture count/cable length recommendations.
- Lumentalk Data Bridge required for Lumentalk system, see LDB installation instructions for details. Fixtures must be specified as DMX/RDM and the Lumentalk Data Bridge must be specified as DMX. 2-step commissioning process: 1 - DMX/RDM system using LumenID software and a LID, 2 - Lumentalk system using LumentalkID software and a LID. Consult factory for details.
- Maximum of 32 fixtures per LDB-DMX. Consult factory for details.
- 1 DMX controller per Lumentalk network, maximum of 48 DMX channels per Lumentalk network (minimum step transition update rate is 1 second, minimum fade time between two colors is 1 minute). Consult factory for applications that require additional capabilities.
- Maximum of 1 transmitter (Lumentranslator or Lumenlink) per system.
- No third party fixtures allowed on the same circuit.
- 14 watts per fixture (RGBW), 16 watts per fixture (MRGBW30K, MRGBW40K, MRGBA).

Dim to Warm Via 0-10V (DIM/DTW\*)

\*Available For DWW Version Only, 2700K to 2200K

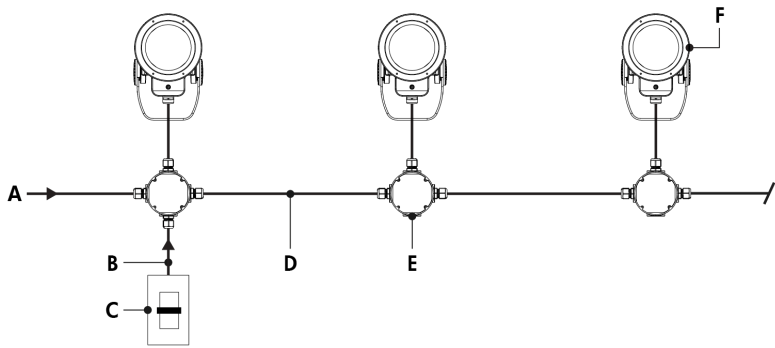

- A - Power input (100-277V AC, wiring by others)
- B - Data wiring (by others)
- C - Dimmer (by others)
- D - Power and data wiring (by others)
- E - Junction box (by others)
- F - Lumenbeam Small

Dim to Warm Via 0-10V (DIM/DTW) - Wiring Detail

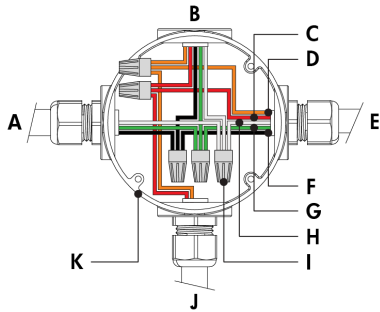

- A - Power input or from previous fixture
- B - To fixture
- C - 0-10 V +
- D - 0-10 V -
- E - To next fixture
- F - Line
- G - Ground
- H - Neutral
- I - Wire-nut (by others)
- J - From dimmer (by others)
- K - Junction box (by others)

- Consult factory for specific applications and maximum fixture count/cable length recommendations.
- 0-10V mA ratings: passive dimmer (Current Sink): 3mA per fixture, active dimmer (Current Source): 0.5mA per fixture.
- 12 watts per fixture.

Star Layout (Dim to Warm Via DMX/RDM1\* or 3-Channel DMX/RDM)

\*Available For DWW Version Only, 2700K To 2200K

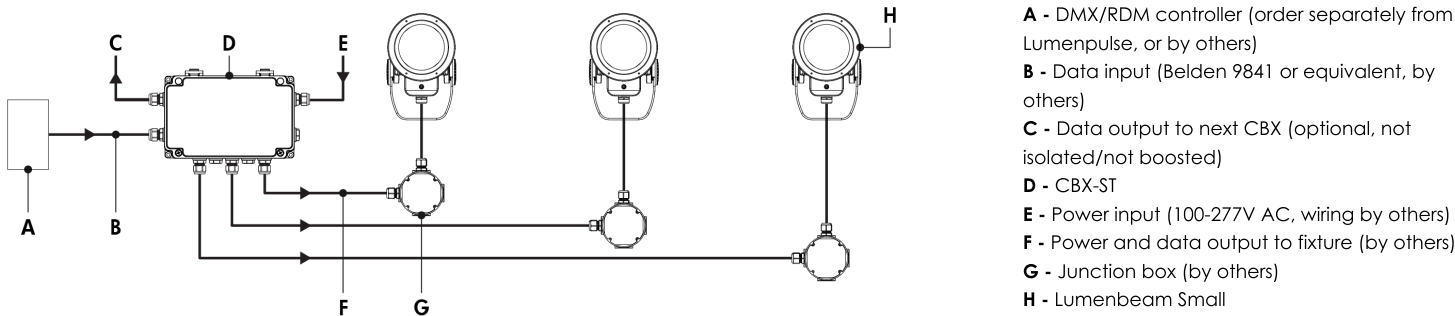

Star Layout (DMX/RDM1 or DMX/RDM) - Wiring Detail



Maximum Fixture Count Per Run

Configuration/Voltage	120V	208V	240V	277V
LBS	32	32	32	32

Based on 15A maximum, 16AWG cable, fixtures spaced 10 ft on center, first fixture 50 ft from CBX.

- Consult CBX installation instructions for additional wiring details.
- Consult factory for specific applications and maximum fixture count/cable length recommendations.
- The DMX/RDM protocol states a maximum of 32 DMX/RDM enabled fixtures on any single run.
- Maximum of 4 DMX/RDM repeaters/CBX cascading in line.
- Maximum of 6 outputs per CBX-ST.
- DMX/RDM1 control option requires 1 DMX address. DMX/RDM control option requires 3 DMX addresses.
- DMX terminator is required at the end of each run to maintain data integrity. Six (6x) DMX lumenterminators included per CBX-ST. See installation instructions for details.
- 14 watts per fixture.

Daisy Chain Layout (Dim to Warm Via DMX/RDM1\* or 3-Channel DMX/RDM)

\*Available for DWW Version Only, 2700K to 2200K

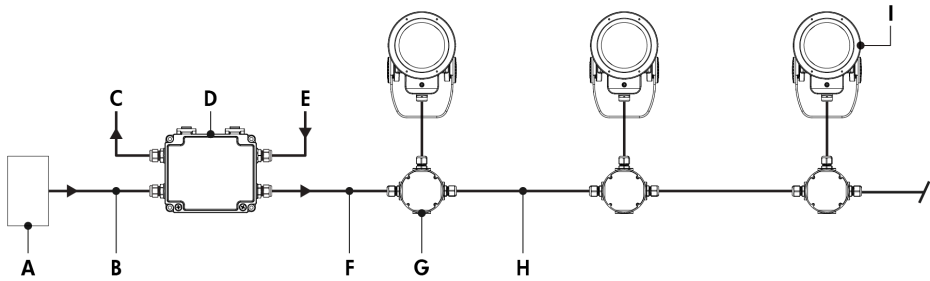

- A - DMX/RDM controller (order separately from Lumenpulse, or by others)
- B - Data input (Belden 9841 or equivalent, by others)
- C - Data output to next CBX (optional, not isolated/not boosted)
- D - CBX-DS
- E - Power input (100-277V AC, wiring by others)
- F - Power and data output to fixture (wiring by others)
- G - Junction box (by others)
- H - Power and data wiring (by others)
- I - Lumenbeam Small

Daisy Chain Layout (DMX/RDM1 or DMX/RDM) - Wiring Detail (First or Middle of Run)

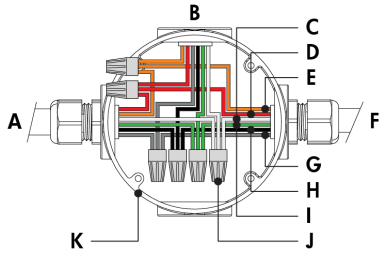

- A - From CBX or previous fixture
- B - To fixture
- C - Neutral
- D - Data +
- E - Data -
- F - To next fixture
- G - Signal common
- H - Line
- I - Ground
- J - Wire-nut (by others)
- K - Junction box (by others)

Daisy Chain Layout (DMX/RDM1 or DMX/RDM) - Wiring Detail (End of Run)

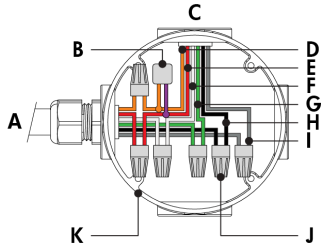

- A - From CBX or previous fixture
- B - Lumeterminator
- C - To fixture
- D - Data -
- E - Data +
- F - Neutral
- G - Ground
- H - Line
- I - Signal common
- J - Wire-nut (by others)
- K - Junction box (by others)

Maximum Fixture Count Per Run

Configuration/Voltage	120V	208V	240V	277V
LBS	32	32	32	32

Based on 15A maximum, 16AWG cable, fixtures spaced 10 ft on center, first fixture 50 ft from CBX.

- Consult CBX installation instructions for additional wiring details.
- Consult factory for specific applications and maximum fixture count/cable length recommendations.
- The DMX/RDM protocol states a maximum of 32 DMX/RDM enabled fixtures on any single run.
- Maximum of 4 DMX/RDM repeaters/CBX cascading in line.
- Maximum of 1 output per CBX-DS.
- Maximum of 3 ft cable length between fixture and next junction box for daisy chain layout.
- DMX/RDM1 control option requires 1 DMX address. DMX/RDM control option requires 3 DMX addresses.
- DMX terminator is required at the end of each run to maintain data integrity. Two (2x) DMX lumeterminators included per CBX-DS. See installation instructions for details.
- 14 watts per fixture.

DALI 2 T8 (DALIT8)

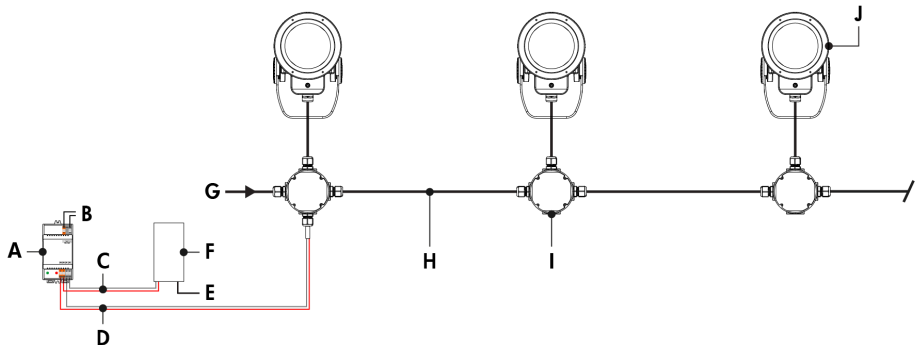

- A - DALI bus power supply (by others)
- B - Power input for DALI bus power supply (wiring by others)
- C - Data output to DALI controller (wiring by others)
- D - Data output to fixture (wiring by others)
- E - Power input for DALI controller (if required, wiring by others)
- F - DALI controller (by others)
- G - Power input (100-277V AC, wiring by others)
- H - Power and data wiring (by others)
- I - Junction box (by others)
- J - Lumenbeam Small

DALI 2 T8 (DALIT8) - Wiring Detail

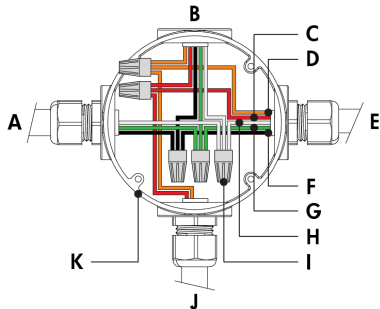

- A - Power input or from previous fixture
- B - To fixture
- C - DA +
- D - DA -
- E - To next fixture
- F - Line
- G - Ground
- H - Neutral
- I - Wire-nut (by others)
- J - From DALI controller (by others)
- K - Junction box (by others)

- Consult factory for specific applications and maximum fixture count/cable length recommendations.
- Maximum of 64 DALI fixtures per DALI loop.
- The Lumenbeam responds to RGBWAF controls.
- Commissioning may be required based on the selection of 3rd party DALI controller. Controller and commissioning provided by others.
- 14 watts per fixture.
- Consult factory for specific applications and maximum fixture count/cable length recommendations.
- Maximum of 64 DALI fixtures per DALI loop.
- The Lumenbeam responds to RGBWAF controls.
- Commissioning may be required based on the selection of 3rd party DALI controller. Controller and commissioning provided by others.
- 14 watts per fixture (RGBW), 16 watts per fixture (MRGBW30K, MRGBW40K, MRGBA).

How to Order

Housing	Voltage	Color and Color Temperature	Optic	Optical Option <sup>(3)</sup> <sup>(5)</sup>	Finish	Control <sup>(9)</sup> <sup>(11)</sup>	Mounting Option <sup>(15)</sup>	Option	Certification	Cable Length <sup>(13)</sup> <sup>(23)</sup>	Cable Color	Buy America.n Act
LBS Lumenbeam™ Small	100 100 Volts	DWW Dynamic Warm White (2200K to 3000K)  DWH Dynamic White (2700K to 6500K)  240 240 Volts  277 277 Volts	VN Very Narrow 6° <sup>(1)</sup>	LSLH Linear Spread Lens Horizontal Distribution <sup>(4)</sup>	BK Black Sandtex®	DIM/DTW Dim to Warm via 0-10V (2700K to 2200K) <sup>(10)</sup>	SK Stake Mounting	RY Rotational Yoke <sup>(14)</sup> <sup>(17)</sup>	UL UL Compliant	3FT 3 ft <sup>(13)</sup> <sup>(23)</sup>	BK Black	BAA Buy America.n <sup>(24)</sup> <sup>(25)</sup>
	120 120 Volts		NS Narrow Spot 10° <sup>(1)</sup>		BRZ Bronze Sandtex®		KN Knuckle Mounting	3GV 3G ANSI C136.31-2010 Vibration Rating for Bridge Applications <sup>(18)</sup>	CE CE Compliant <sup>(21)</sup> <sup>(22)</sup>	10FT 10 ft	WH White <sup>(24)</sup>	
	208 208 Volts		NF Narrow Flood 20° <sup>(1)</sup>	LSLV Linear Spread Lens Vertical Distribution <sup>(4)</sup>	SI Silver Sandtex®	DMX/RDM1 Dim to Warm via Single-Channel DMX/RDM (2700K to 2200K) <sup>(10)</sup> <sup>(12)</sup> <sup>(13)</sup>	CN Canopy Mounting Option		CEII CE Compliant Class II Double Insulated <sup>(21)</sup>	20FT 20 ft		
	220 220 Volts		M Medium 30° <sup>(1)</sup>		WH Smooth White			CRC Corrosion-Resistant Coating <sup>(19)</sup> <sup>(20)</sup>		30FT 30 ft		
	240 240 Volts		FL Flood 40° <sup>(1)</sup>		BKTX Textured Black	DMX/RDM 3-Channel Color Temperature Control via DMX/RDM <sup>(12)</sup> <sup>(13)</sup>				50FT 50 ft		
	277 277 Volts		WFL Wide Flood 60° <sup>(1)</sup> <sup>(2)</sup>		BRZTX Textured Bronze Non-Metallic					70FT 70 ft		
			VWFL Very Wide Flood 90° <sup>(1)</sup>		GRATX Textured Medium Gray	DALIT8 DALI 2 T8 Enabled Dimming 0.1% <sup>(14)</sup>				100FT 100 ft		
			NAS Narrow Asymmetric <sup>(1)</sup>		GRNTX Textured Green							
			WW Asymmetric Wallwash <sup>(1)</sup>		WHTX Textured White							
					CC Custom Color & Finish <sup>(6)</sup> <sup>(7)</sup> <sup>(8)</sup>							

Notes:

1. Factory installed, not interchangeable on site.

2. A dome lens accessory is available, order separately. For compatibility, a WFL optic must be specified for the fixture.

3. Optical options are factory installed and cannot be changed in the field.

4. Field adjustable spread lens optical accessory available, order separately.

5. Not available with WFL, VWFL, NAS and WW optics.

6. Lumenpulse offers a wide selection of RAL CLASSIC (K7) colors with a smooth texture and high-gloss finish. Please consult factory for a list of available K7 colors, other RAL textures and glosses, or to match alternate color charts. Final color matching results may vary.

7. Setup charges apply for RAL colors. Consult factory for details.

8. Longer lead times can be expected for custom RAL color finishes.

9. Lumentalk system is enabled with LDB-DMX accessory. DMX/RDM must be specified in the order code. See the typical wiring diagrams in the specification sheet for details.

10. Available for DWW color temperature option only.

11. A Lumentranslator 2 (LTL2) and LumenID (LID) must be specified for Lumentalk applications. Consult Lumentranslator 2 and Lumentalk pages and specification sheets for details.
12. A control box (CBX) and LumenID (LID) must be specified.

13. Maximum of 3 ft cable length for daisy chain DMX applications with CBX-DS.

14. DALI 2 T8 controller required, provided by others. DALI2 T8 control uses a single DALI short address.

15. The standard yoke is provided unless an alternate mounting option is specified as part of the order code.

16. Consult factory for applications with 3GV requirements.

17. The Rotational Yoke cannot be combined with any other mounting option.

18. 3GV option is available for standard yoke mounting only.

19. Use only when exposed to salt spray. This option is not required for normal outdoor exposure.

20. Setup charges apply. Consult factory for details.

21. Consult European specification sheets and installation instructions for CE and CE Class II wiring information.

22. Not available with DALIT8 control option.

23. 3 ft cable length is standard unless otherwise specified.

24. Not available with CE or CEII certification options.

25. Contact your Lumenpulse Sales Representative for more information on order volume details.