

Project Name _____ Qty _____

Type _____ Catalog / Part Number _____

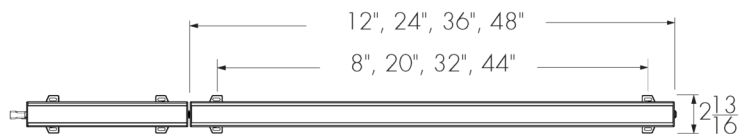

Top View

ST Mounting Option Shown

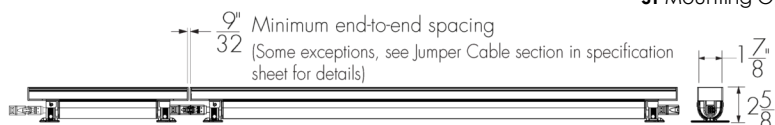

Front and Side Views

Photometric Summary (13 W/ft)

	Delivered Output (lm)	Intensity (Peak cd)
Symmetric		
10°x10°	5,173	71,572
10°x30°	5,100	27,021
10°x60°	5,043	14,813
30°x10°	4,921	19,165
60°x10°	4,878	12,976
30°x60°	4,901	7,624
30°x30°	4,919	9,753
60°x60°	4,858	4,149
90°x90°	4,748	2,286
Asymmetric		
NAS	4,301	5,192
WW	4,541	21,257

1. Based on 4000K, 48 in.
 2. Photometric performance is measured in compliance with IESNA LM-79-24.
 3.

Refer to the [Lumencore Linear Graze White and Static Colors Photometric Guide](#) on Lumenpulse website for information on other color temperatures.

Optic

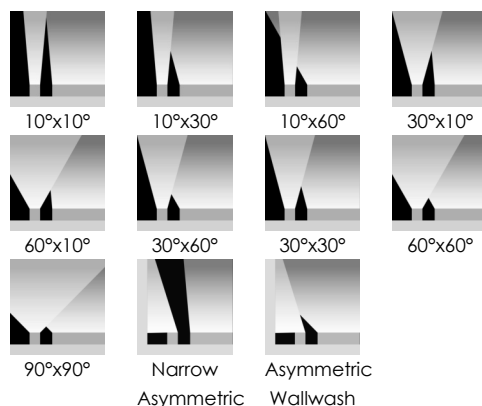

Description

The Lumencore Linear Graze fixture is designed to provide exceptional, consistent illumination for architectural applications. Featuring high CRI and R9 values, this luminaire delivers vibrant, true-to-life color rendering, enhancing the visual quality of any space. Its sleek design allows for seamless integration into walls and ceilings, making it ideal for grazing textured surfaces and accentuating architectural details. With impressive lumen output and customizable beam angles, the Lumencore Linear Graze ensures effective lighting for any style of architecture. Perfect for creating inviting atmospheres, this fixture combines performance and aesthetics to elevate your design vision.

Features

Length (Nominal)

12: 12 in, **24:** 24 in, **36:** 36 in, **48:** 48 in

Color and Color Temperature

- 22K:** 2200K
- 27K:** 2700K
- 30K:** 3000K
- 35K:** 3500K
- 40K:** 4000K
- RD:** Red
- GR:** Green
- BL:** Blue
- AMB:** Phosphor Converted Amber (PC Amber)

Color and Color Temperature

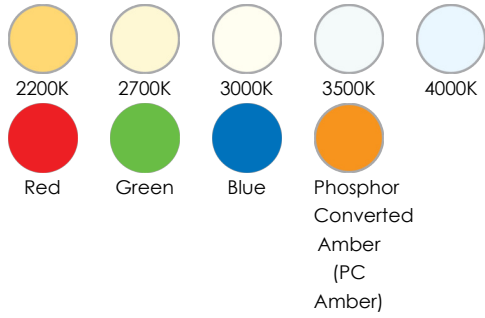

Control

ON/OFF 0-10V DALI 2 T6 DMX/RDM

Certifications



Optic	10x10: 10°x10° 10x30: 10°x30° 10x60: 10°x60° 30x10: 30°x10° 60x10: 60°x10° 30x60: 30°x60° 30x30: 30°x30° 60x60: 60°x60° 90x90: 90°x90° NAS: Narrow Asymmetric WW: Asymmetric Wallwash
--------------	--

Compact Mounting Options	ST: Standard Mounting SM: Slim Adjustable Mounting Continuously Adjustable
---------------------------------	---

Wall Mounting Options	WMC3: Wall Mounting Continuously Adjustable 3 in to Optical Center WMC6: Wall Mounting Continuously Adjustable 6 in to Optical Center WMC18: Wall Mounting Continuously Adjustable 18 in to Optical Center	WMC4: Wall Mounting Continuously Adjustable 4 in to Optical Center WMC12: Wall Mounting Continuously Adjustable 12 in to Optical Center WMC24: Wall Mounting Continuously Adjustable 24 in to Optical Center
------------------------------	---	---

Finish	MWH: Matte White MBK: Matte Black CC: Custom Color and Finish (Please Specify RAL Color) SP: Special Color (Choose From Standard Point Source Color Palette)
---------------	---

Cable Color	WH: White BK: Black
--------------------	--------------------------------------

Optical Accessories	VS: Visor LV: Louver HL: Honeycomb Louver SN: Snoot SH: Shield
----------------------------	---

Warranty	5-year limited warranty
-----------------	-------------------------

Performance

Maximum Delivered Output	Up to 1464 lm (4 W/ft, 4 ft fixture, 4000K, CRI 90+, 10° x 10°) Up to 2705 lm (7 W/ft, 4 ft fixture, 4000K, CRI 90+, 10° x 10°) Up to 3880 lm (10 W/ft, 4 ft fixture, 4000K, CRI 90+, 10° x 10°) Up to 5173 lm (13 W/ft, 4 ft fixture, 4000K, CRI 90+, 10° x 10°)
---------------------------------	--

Maximum Delivered Intensity	Up to 20,255 cd (4 W/ft, 4 ft fixture, 4000K, CRI 90+, 10° x 10°) Up to 37,432 cd (7 W/ft, 4 ft fixture, 4000K, CRI 90+, 10° x 10°) Up to 53,679 cd (10 W/ft, 4 ft fixture, 4000K, CRI 90+, 10° x 10°) Up to 71,572 cd (13 W/ft, 4 ft fixture, 4000K, CRI 90+, 10° x 10°)
------------------------------------	--

Illuminance at Distance	Minimum 1 fc at 142 ft (4 W/ft, 4 ft fixture, 4000K, CRI 90+, 10° x 10°) Minimum 1 fc at 193 ft (7 W/ft, 4 ft fixture, 4000K, CRI 90+, 10° x 10°) Minimum 1 fc at 231 ft (10 W/ft, 4 ft fixture, 4000K, CRI 90+, 10° x 10°) Minimum 1 fc at 267 ft (13 W/ft, 4 ft fixture, 4000K, CRI 90+, 10° x 10°)
Color Rendering	CRI 90+, with the exception of CRI 80+ for 2200K
Color Consistency	2 SDCM
Lumen Maintenance	L70>78,000 hrs Ta 77 °F (TM-21 reported) L70>150,000 hrs Ta 77 °F (projected)* L95=29,900 hrs Ta 77 °F (TM-21 reported) *Estimated based on in-situ case temperature and LM-80 report

Physical

Housing Material	Aluminum
Diffuser Material	Polymethyl methacrylate (PMMA)
TIR Optics Material	Polymethyl methacrylate (PMMA, for 22K, 27K, 30K, 35K and 40K Color Temperatures) Polycarbonate (for RD, GR, BL and AMB Static Colors only)
End Cap Material	Die cast aluminum
Weight	1.5 lbs (12 in fixture) 2.94 lbs (24 in fixture) 3.82 lbs (36 in fixture) 5.69 lbs (48 in fixture)

Electrical and Control

Voltage	120 Volts to 277 Volts
Wattage	4W: 4 W/ft, 7W: 7 W/ft, 10W: 10 W/ft, 13W: 13 W/ft
Control	NO: On/Off Control PDA1: Professional 0-10V Dimming 0.1% Linear Curve PDA2: Professional 0-10V Dimming 0.1% Logarithmic Curve DALI: DALI 2 T6 Enabled Dimming 0.1% DMX/RDM: DMX/RDM Enabled Dimming 0.1%
Flicker	Designed to comply with recommended practices of IEEE 1789:2015
Inrush Current (Peak)	Meets NEMA-410 requirements

Accessories - Optional (Order Separately)

Cables	LCVALC: Lumencore Linear Leader Cable LCVAJC: Lumencore Linear Jumper Cable
Installation Accessories	LCVAT: Lumencore Linear Alignment Track LCVARC: Lumencore Linear Alignment Track Cover

Control Boxes	<p>CBX-DMX/RDM: DMX/RDM enabled (Daisy Chain or Star Configuration)</p> <p>CBX-ENET: Ethernet enabled (Daisy Chain or Star Configuration)</p> <p>LDBI: Lumentalk Data Bridge Indoor</p> <p>WC: Wiring Compartment for Lumencore Linear Graze and Cove</p>
----------------------	---

Control System	<p>PHAROS: Pharos® Designer Lighting Control Kit</p> <p>EXPERT: Pharos® Expert Control Kit</p>
-----------------------	--

Diagnostic and Addressing Tools	LID: LumenID
--	---------------------

Environmental

Storage Temperature	-40 °F to 122 °F
----------------------------	------------------

Start-up Temperature	-4 °F to 122 °F
-----------------------------	-----------------

Operating Temperature	-40 °F to 122 °F
------------------------------	------------------

Environment	Damp location rating (interior applications only)
--------------------	---

Ingress Protection Rating	IP20
----------------------------------	------

Important

Virtual Patent Marking Notice

This website (<https://www.lmpg.com/patents-trademarks>) is provided to satisfy the virtual patent marking provisions of applicable jurisdictions. Some products listed may be covered by additional patents not referenced here.

Photometric Information

4 W/ft (3000K)

	Delivered Output (lm)	Intensity (Peak cd)
Symmetric		
10°x10°	1,350	18,675
10°x30°	1,331	7,050
10°x60°	1,316	3,865
30°x10°	1,284	5,001
60°x10°	1,273	3,386
30°x60°	1,279	1,989
30°x30°	1,283	2,545
60°x60°	1,268	1,083
90°x90°	1,239	597
Asymmetric		
NAS	1,122	1,355
WW	1,185	5,546

7 W/ft (3000K)

	Delivered Output (lm)	Intensity (Peak cd)
Symmetric		
10°x10°	2,494	34,513
10°x30°	2,459	13,030
10°x60°	2,432	7,143
30°x10°	2,373	9,241
60°x10°	2,352	6,257
30°x60°	2,363	3,676
30°x30°	2,372	4,703
60°x60°	2,343	2,001
90°x90°	2,290	1,102
Asymmetric		
NAS	2,074	2,504
WW	2,190	10,250

10 W/ft (3000K)

	Delivered Output (lm)	Intensity (Peak cd)
Symmetric		
10°x10°	3,577	49,492
10°x30°	3,527	18,685
10°x60°	3,487	10,243
30°x10°	3,403	13,253
60°x10°	3,373	8,973
30°x60°	3,389	5,272
30°x30°	3,401	6,745
60°x60°	3,359	2,869
90°x90°	3,283	1,581
Asymmetric		
NAS	2,974	3,590
WW	3,140	14,699

13 W/ft (3000K)

	Delivered Output (lm)	Intensity (Peak cd)
Symmetric		
10°x10°	4,770	65,990
10°x30°	4,702	24,913
10°x60°	4,650	13,658
30°x10°	4,537	17,670
60°x10°	4,498	11,964
30°x60°	4,519	7,029
30°x30°	4,535	8,993
60°x60°	4,479	3,825
90°x90°	4,378	2,108
Asymmetric		
NAS	3,966	4,787
WW	4,187	19,599

Based on 4 ft fixture length, CRI 90, full output.

Consult website for IES files. Delivered output: +/- 10% tolerance.

Photometric performance is measured in compliance with IESNA LM-79-24.

Refer to Photometric Guide on Lumenpulse website for information on other color temperatures.

4 W/ft (4000K)

	Delivered Output (lm)	Intensity (Peak cd)
	Symmetric	
10°x10°	1,464	20,255
10°x30°	1,443	7,647
10°x60°	1,427	4,192
30°x10°	1,393	5,424
60°x10°	1,380	3,672
30°x60°	1,387	2,158
30°x30°	1,392	2,760
60°x60°	1,375	1,174
90°x90°	1,344	647
Asymmetric		
NAS	1,217	1,469
WW	1,285	6,016

7 W/ft (4000K)

	Delivered Output (lm)	Intensity (Peak cd)
	Symmetric	
10°x10°	2,705	37,432
10°x30°	2,667	14,132
10°x60°	2,637	7,747
30°x10°	2,574	10,023
60°x10°	2,551	6,786
30°x60°	2,563	3,987
30°x30°	2,573	5,101
60°x60°	2,541	2,170
90°x90°	2,483	1,196
Asymmetric		
NAS	2,250	2,715
WW	2,375	11,118

10 W/ft (4000K)

	Delivered Output (lm)	Intensity (Peak cd)
	Symmetric	
10°x10°	3,880	53,679
10°x30°	3,825	20,266
10°x60°	3,782	11,110
30°x10°	3,691	14,374
60°x10°	3,659	9,732
30°x60°	3,676	5,718
30°x30°	3,689	7,315
60°x60°	3,644	3,112
90°x90°	3,561	1,715
Asymmetric		
NAS	3,226	3,894
WW	3,406	15,943

13 W/ft (4000K)

	Delivered Output (lm)	Intensity (Peak cd)
	Symmetric	
10°x10°	5,173	71,572
10°x30°	5,100	27,021
10°x60°	5,043	14,813
30°x10°	4,921	19,165
60°x10°	4,878	12,976
30°x60°	4,901	7,624
30°x30°	4,919	9,753
60°x60°	4,858	4,149
90°x90°	4,748	2,286
Asymmetric		
NAS	4,301	5,192
WW	4,541	21,257

Based on 4 ft fixture length, CRI 90, full output.

Consult website for IES files. Delivered output: +/- 10% tolerance.

Photometric performance is measured in compliance with IESNA LM-79-24.

Refer to Photometric Guide on Lumenpulse website for information on other color temperatures.

Chromaticity Data

TM-30 - 4000K

CCT	CIE		TM-30	
4000K	R _a	96	91	R _f
	R _g	72	98	R _g

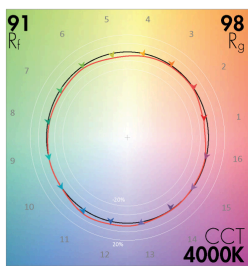

Spectral Power Distribution

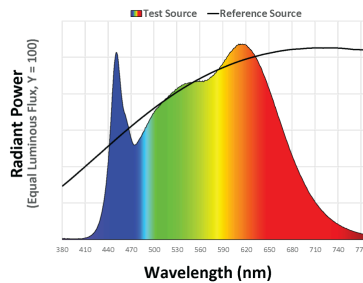

Refer to Spectral Information download on Lumenpulse website for more information.

Spectral Information

	CRI	R9	M/P Ratio	MDER
2200K	82	7	0.342	0.310
2700K	93	59	0.496	0.45
3000K	95	64	0.584	0.529
3500K	95	68	0.654	0.593
4000K	96	72	0.771	0.699

M/P: Melanopic/Photopic Ratio

MDER: Melanopic Daylight Equivalence Ratio

SP - Special Colours (Palette for Fixture and Shield Finish)

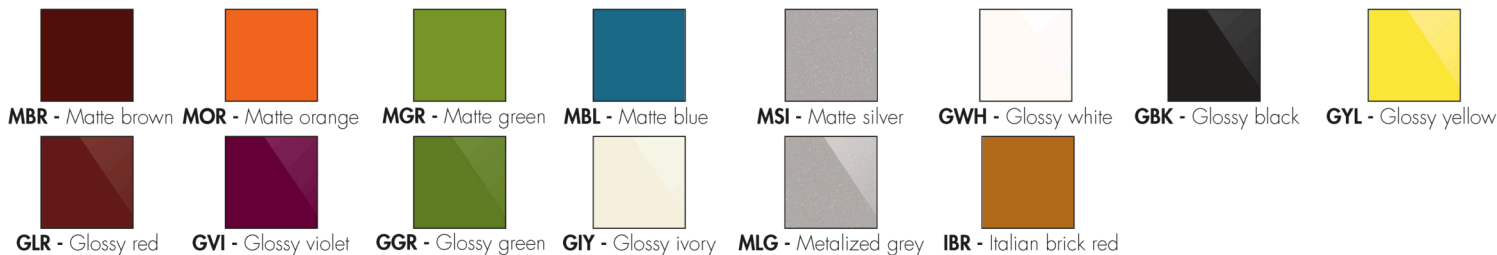

Mounting Bracket Placement

ST - Standard Mounting

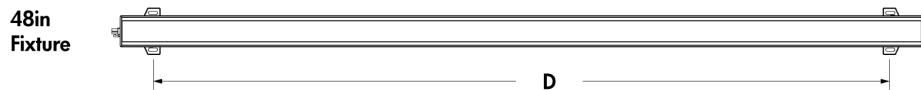
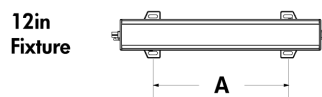

Top view

Fixed Dimensions Between Brackets

- A - 8 in
- B - 20 in
- C - 32 in
- D - 44 in

Mounting Bracket Placement (Minimum and Maximum Distances)

SM - Slim Adjustable Mounting

WMC - Wall Mounting Continuously Adjustable

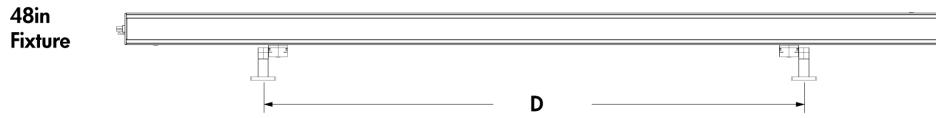
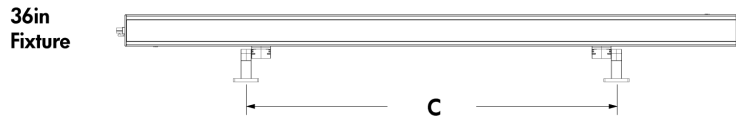
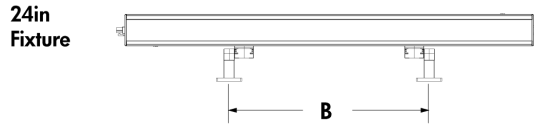
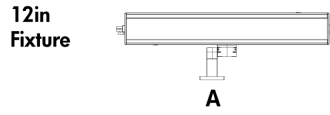

Top view

- A** - Bracket in the center of the fixture
- B** - Minimum 10 in to maximum 16 in
- C** - Minimum 15 in to maximum 28 in
- D** - Minimum 20 in to maximum 40 in

WMC3 mounting brackets shown.

Adjustment

Maximum Angle Adjustment

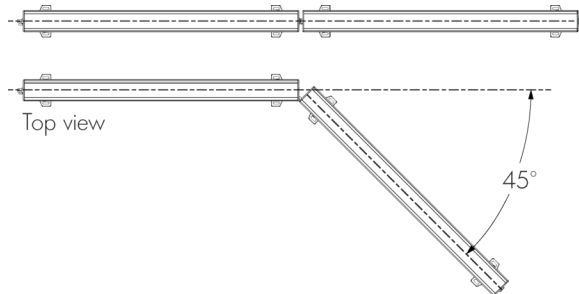

Minimum Radius

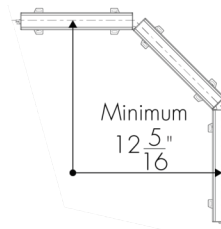

Suggested Installation Dimensions

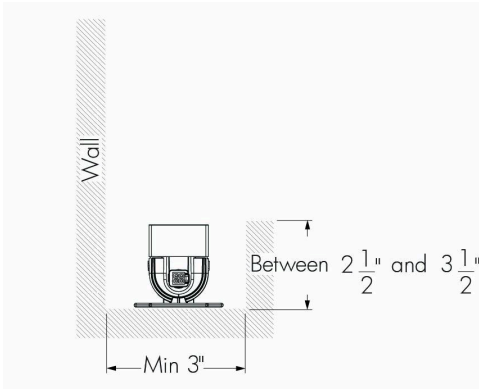

For WW or NAS, a setback ratio of 1:8 is suggested, i.e., 1 foot of set-back for an 8-foot-high wall.

Adjust the setback according to the height of the wall to be illuminated.

Mounting Options

ST - Standard Mounting

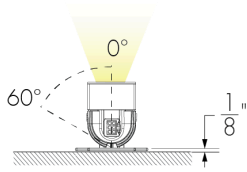

Two mounting brackets provided for all fixture lengths.

Weight of one SM Mounting Bracket: 0.09 lbs.

Weight of two SM Mounting Brackets: 0.19 lbs.

The weight of the mounting bracket is in addition to the weight of the fixture.

SM - Slim Adjustable Mounting

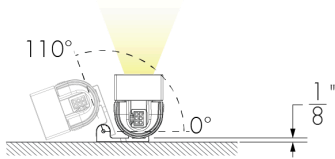

The angle range will be impacted if optical accessories is added.

One mounting bracket provided for 12 in fixtures. Two mounting brackets provided for 24 in, 36 in and 48 in fixtures.

Weight of one SM Mounting Bracket: 0.09 lbs.

Weight of two SM Mounting Brackets: 0.19 lbs.

The weight of the mounting bracket is in addition to the weight of the fixture.

ST - Mounting Hole Pattern

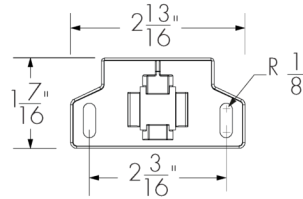

SM - Mounting Hole Pattern

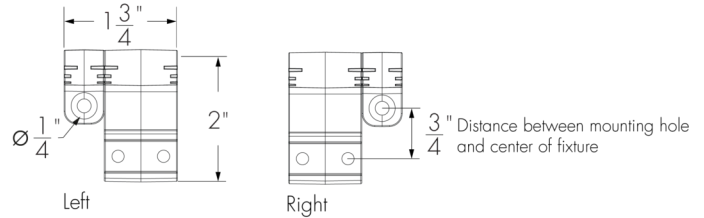

WMC3 - Wall Mounting Continuous Adjustable 3 in to Optical Center

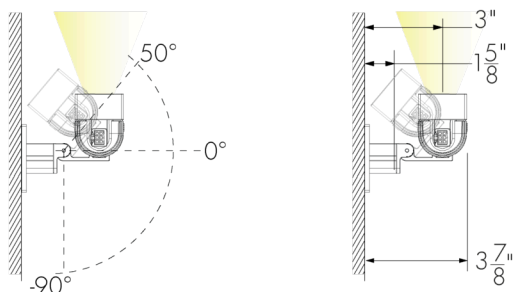

The angle range will be impacted if optical accessories is added.

One mounting bracket provided for 12 in fixtures. Two mounting brackets provided for 24 in, 36 in and 48 in fixtures.

Weight of one WMC3 Mounting Bracket: 0.24 lbs.

Weight of two WMC3 Mounting Brackets: 0.49 lbs.

The weight of the mounting bracket is in addition to the weight of the fixture.

WMC3 - Mounting Hole Pattern

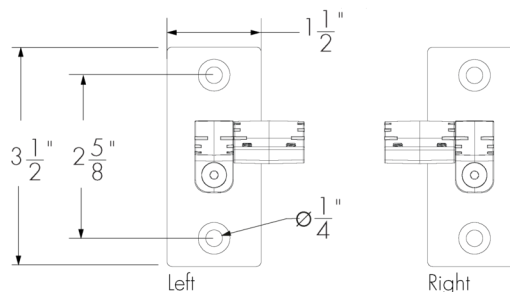

WMC4 - Wall mounting Continuous adjustable 4 in to Optical Center

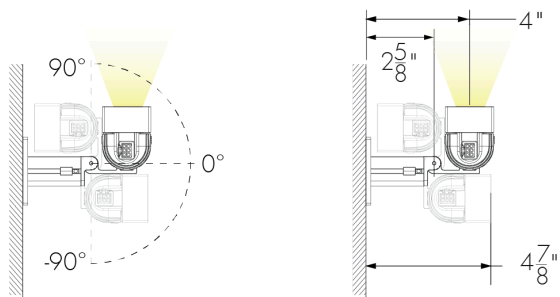

One mounting bracket provided for 12 in fixtures. Two mounting brackets provided for 24 in, 36 in and 48 in fixtures.

Weight of one WMC4 Mounting Bracket: 0.3 lbs.

Weight of two WMC4 Mounting Brackets: 0.6 lbs.

The weight of the mounting bracket is in addition to the weight of the fixture.

WMC4 - Mounting Hole Pattern

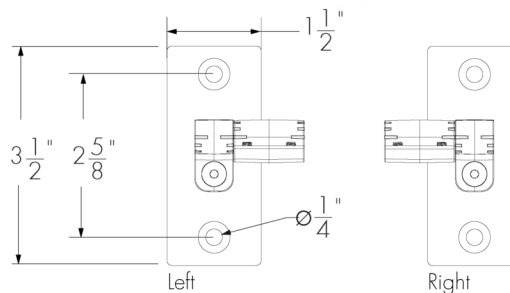

WMC6 - Wall Mounting Continuous Adjustable 6 in to Optical Center

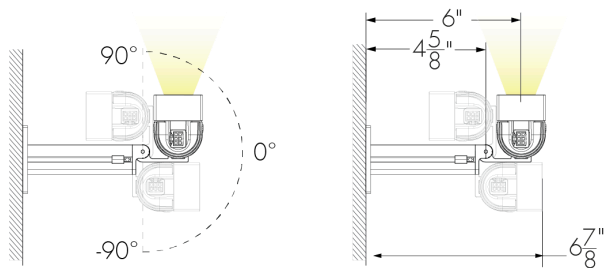

One mounting bracket provided for 12 in fixtures. Two mounting brackets provided for 24 in, 36 in and 48 in fixtures.

Weight of one WMC6 Mounting Bracket: 0.4 lbs.

Weight of two WMC6 Mounting Brackets: 0.79 lbs.

The weight of the mounting bracket is in addition to the weight of the fixture.

WMC6 - Mounting Hole Pattern

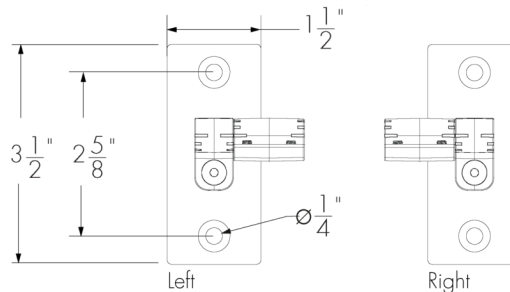

WMC12 - Wall Mounting Continuous Adjustable 12 in to Optical Center

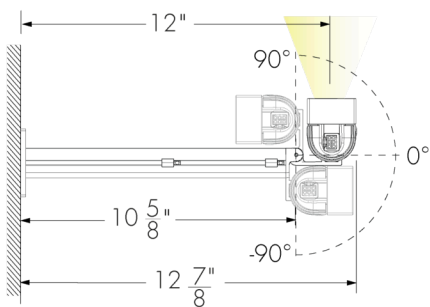

One mounting bracket provided for 12 in fixtures. Two mounting brackets provided for 24 in, 36 in and 48 in fixtures.

Weight of one WMC12 Mounting Bracket: 0.72 lbs.

Weight of two WMC12 Mounting Brackets: 1.43 lbs.

The weight of the mounting bracket is in addition to the weight of the fixture.

WMC12 - Mounting Hole Pattern

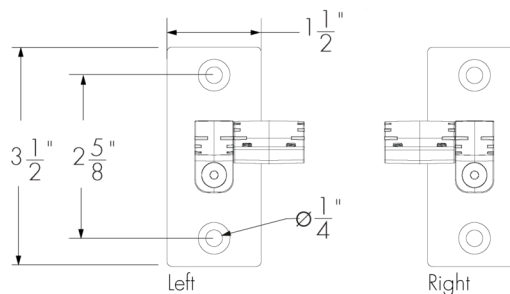

WMC18 - Wall Mounting Continuous Adjustable 18 in to Optical Center

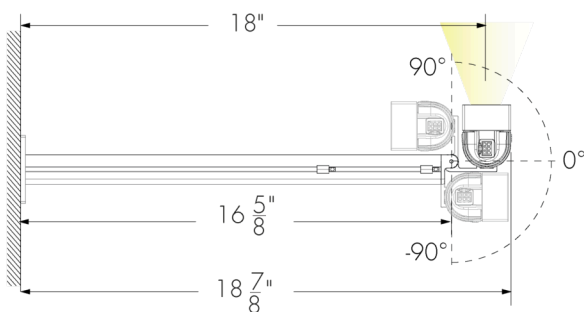

One mounting bracket provided for 12 in fixtures. Two mounting brackets provided for 24 in, 36 in and 48 in fixtures.

Weight of one WMC18 Mounting Bracket: 1.03 lbs.

Weight of two WMC18 Mounting Brackets: 2.05 lbs.

The weight of the mounting bracket is in addition to the weight of the fixture.

WMC18 - Mounting Hole Pattern

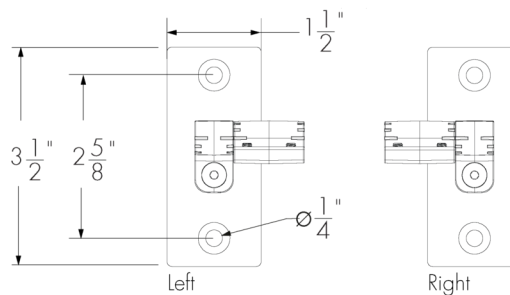

WMC24 - Wall Mounting Continuous Adjustable 24 in to Optical Center

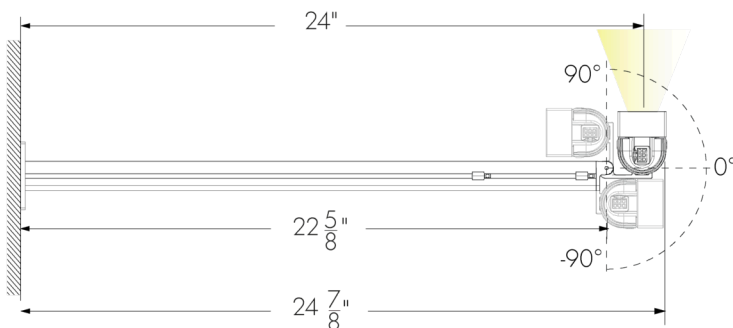

One mounting bracket provided for 12 in fixtures. Two mounting brackets provided for 24 in, 36 in and 48 in fixtures.

Weight of one WMC24 Mounting Bracket: 1.34 lbs.

Weight of two WMC24 Mounting Brackets: 2.69 lbs.

The weight of the mounting bracket is in addition to the weight of the fixture.

WMC24 - Mounting Hole Pattern

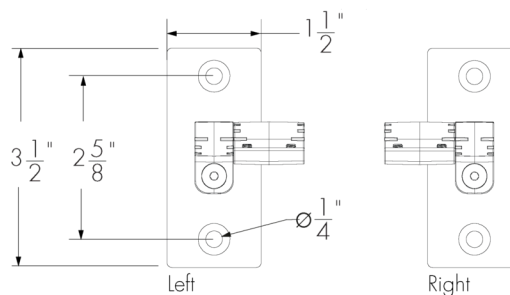

Cable Management System for Wall Mounting Brackets

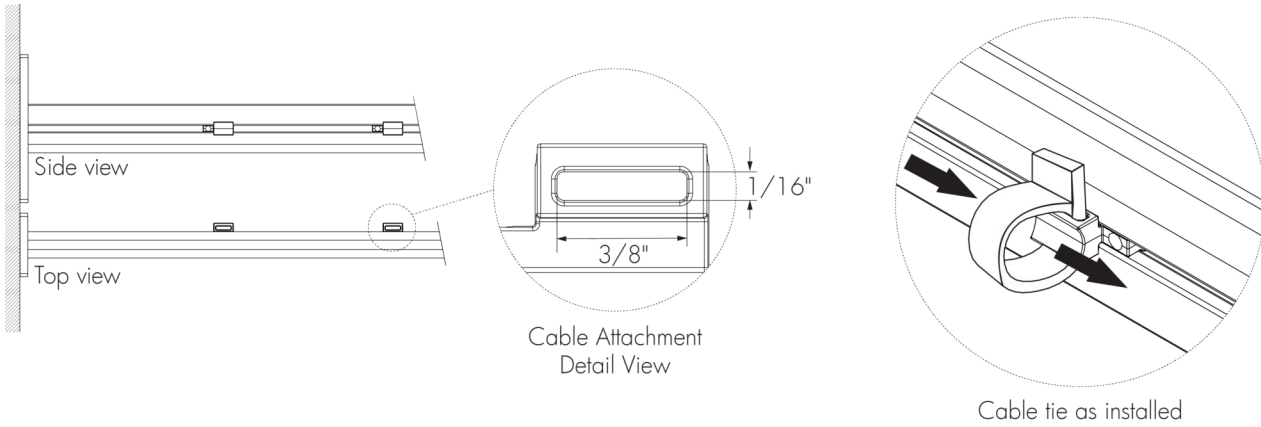

No cable attachment provided for WMC3.

One cable attachment provided for WMC4 & WMC6.

Two cable attachments provided for WMC12 & WMC18.

Three cable attachments provided for WMC24.

Maximum cable tie size: 0.35 in width, 0.08 in in thickness.

Cable ties are recommended, provided by others.

Accessories

VS - Visor

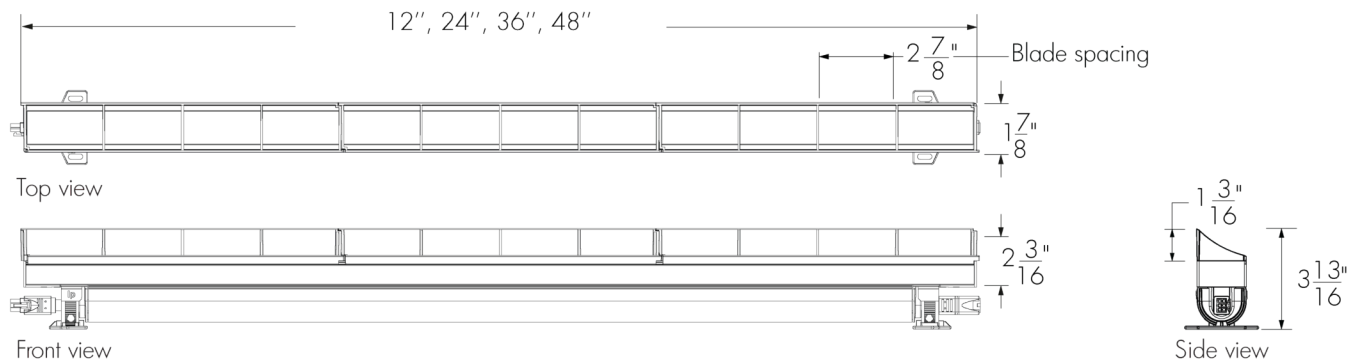

Accessories come in 12 in sections. 12 in Fixture requires 1 accessory, 24 in fixture requires 2 accessories, 36 in fixture requires 3 accessories, 48 in fixture requires 4 accessories.

Weight of 1 accessory: 0.1 lbs, weight of 2 accessories: 0.2 lbs, weight of 3 accessories: 0.3 lbs, weight of 4 accessories: 0.4 lbs.

Note: The weight of the accessory is in addition to the weight of the fixture.

- A Visor will affect beam distribution. Consult factory for application support.
- The Visor is field installable. The Visor can be combined with the Shield accessory; all other combinations are not possible.
- The exterior finish of the accessory will match the finish specified in the fixture order code. Interior surface is matte black.

LV - Louver (Static White)

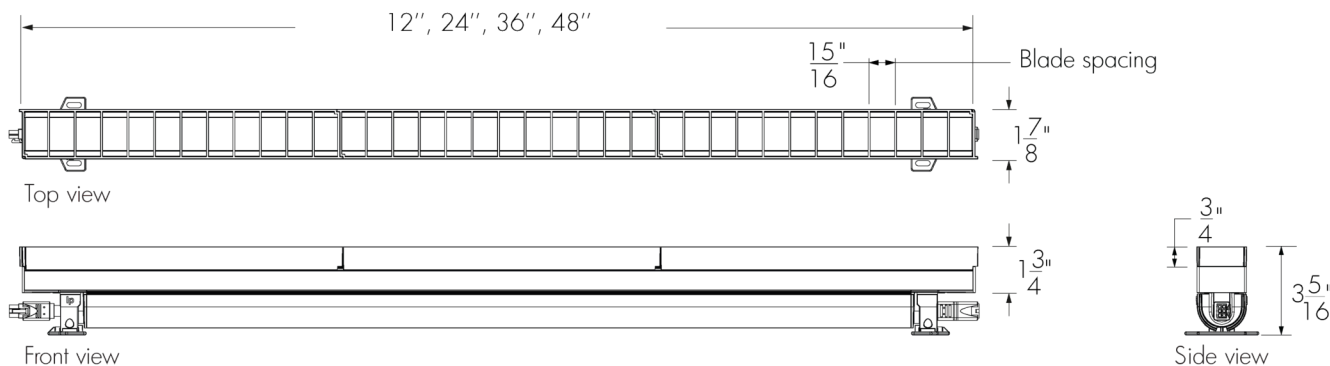

Accessories come in 12 in sections. 12 in Fixture requires 1 accessory, 24 in fixture requires 2 accessories, 36 in fixture requires 3 accessories, 48 in fixture requires 4 accessories.

Weight of 1 accessory: 0.13 lbs, weight of 2 accessories: 0.26 lbs, weight of 3 accessories: 0.4 lbs, weight of 4 accessories: 0.53 lbs.

Note: The weight of the accessory is in addition to the weight of the fixture.

- A Louver will affect beam distribution. Consult factory for application support.
- The Louver is field installable. The Louver can be combined with the Shield accessory; all other combinations are not possible.
- The exterior finish of the accessory will match the finish specified in the fixture order code. Interior surface is matte black.

LV - Louver (Static Color)

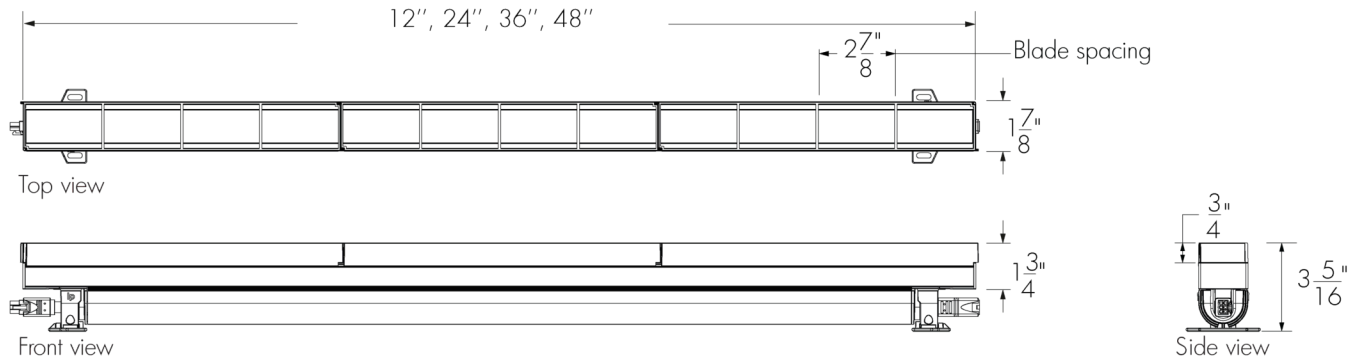

Accessories come in 12 in sections. 12 in fixture requires 1 accessory, 24 in fixture requires 2 accessories, 36 in fixture requires 3 accessories, 48 in fixture requires 4 accessories.

Weight of 1 accessory: 0.13 lbs, weight of 2 accessories: 0.26 lbs, weight of 3 accessories: 0.4 lbs, weight of 4 accessories: 0.53 lbs.

Note: The weight of the accessory is in addition to the weight of the fixture.

- A Louver will affect beam distribution. Consult factory for application support.
- The Louver is field installable. The Louver can be combined with the Shield accessory; all other combinations are not possible.
- The exterior finish of the accessory will match the finish specified in the fixture order code. Interior surface is matte black.

HL - Honeycomb Louver

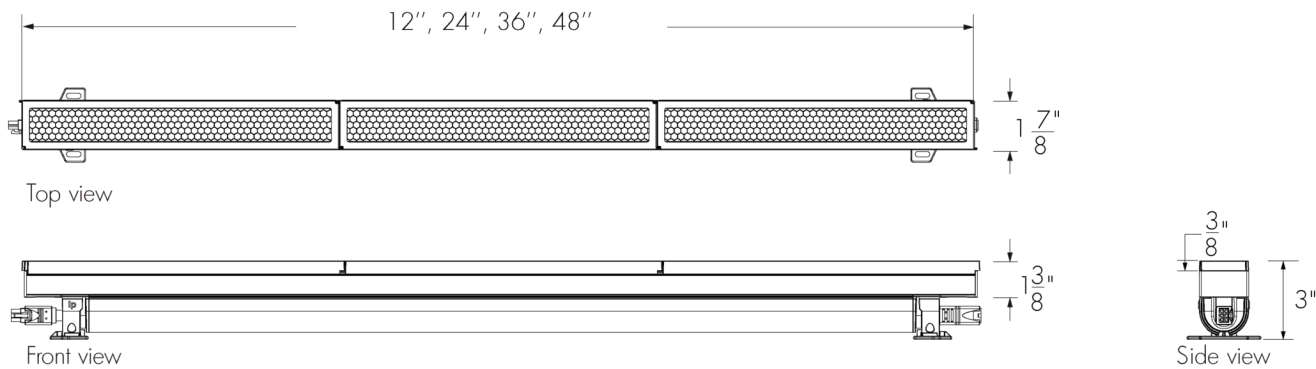

Accessories come in 12 in sections. 12 in Fixture requires 1 accessory, 24 in fixture requires 2 accessories, 36 in fixture requires 3 accessories, 48 in fixture requires 4 accessories.

Weight of 1 accessory: 0.09 lbs, weight of 2 accessories: 0.18 lbs, weight of 3 accessories: 0.26 lbs, weight of 4 accessories: 0.35 lbs.

Note: The weight of the accessory is in addition to the weight of the fixture.

- A Honeycomb Louver will affect beam distribution. Consult factory for application support.
- The Honeycomb Louver is field installable. The Honeycomb Louver can be combined with the Shield accessory; all other combinations are not possible.
- The exterior finish of the accessory will match the finish specified in the fixture order code. Interior surface is matte black.

SN - Snoot

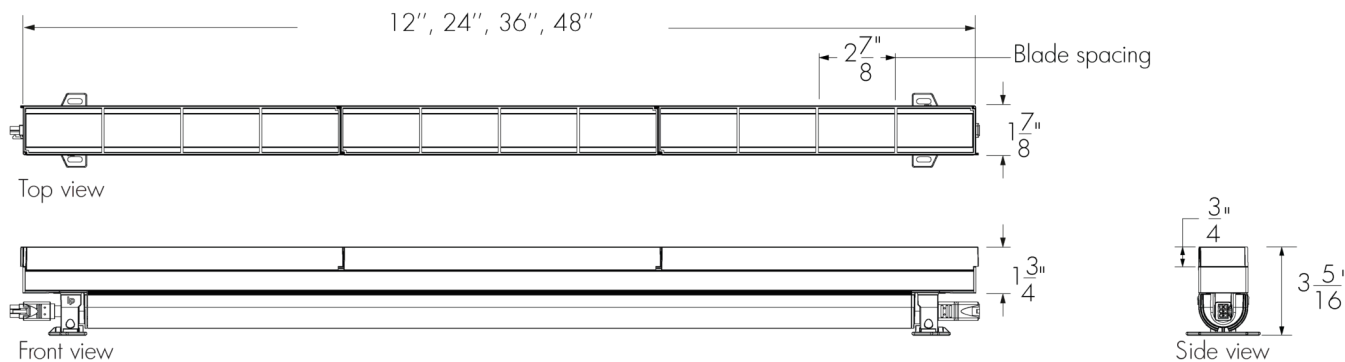

Accessories come in 12 in sections. 12 in fixture requires 1 accessory, 24 in fixture requires 2 accessories, 36 in fixture requires 3 accessories, 48 in fixture requires 4 accessories.

Weight of 1 accessory: 0.1 lbs, weight of 2 accessories: 0.2 lbs, weight of 3 accessories: 0.3 lbs, weight of 4 accessories: 0.4 lbs.
 Note: The weight of the accessory is in addition to the weight of the fixture.

- A Snoot will affect beam distribution. Consult factory for application support.
- The Snoot is field installable. The Snoot can be combined with the Shield accessory; all other combinations are not possible.
- The exterior finish of the accessory will match the finish specified in the fixture order code. Interior surface is matte black.

SH - Shield

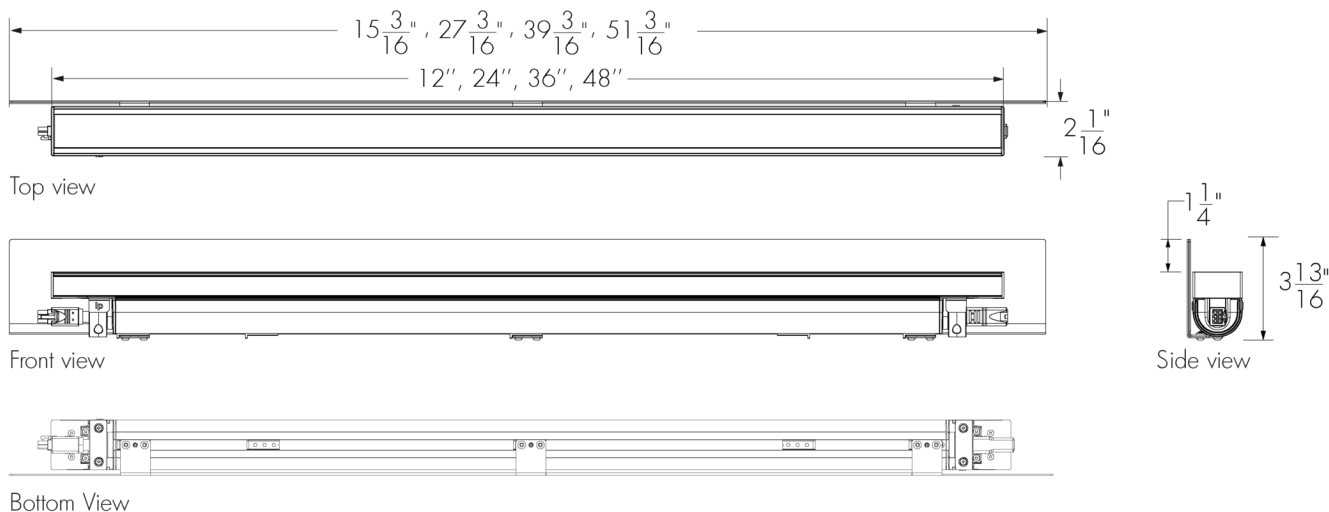

Weight of 12 in accessory: 0.31 lbs, weight of 24 in accessory: 0.55 lbs, weight of 36 in accessory: 0.79 lbs, weight of 48 in accessory: 1.05 lbs.
 Note: The weight of the accessory is in addition to the weight of the fixture.

- The Shield can only be used with WMC or SM mounting options.
- A Shield will affect beam distribution. Consult factory for application support.
- The Shield is field installable. The Shield can be combined with one other accessory.
- The exterior finish of the accessory will match the finish specified in the fixture order code (interior surface painted matte black).

Weight Table

Weight (lbs)

	Fixture Only	Fixture With Visor	Fixture With Louver	Fixture With Honeycomb Louver	Fixture With Snoot	Fixture With Shield
1ft	1.54	1.64	1.68	1.63	1.64	1.85
2ft	3.09	3.28	3.35	3.26	3.28	3.70
3ft	4.63	4.93	5.03	4.89	4.93	5.56
4ft	6.17	6.57	6.70	6.53	6.57	7.41

Asymmetric Optic Details (NAS and WW)

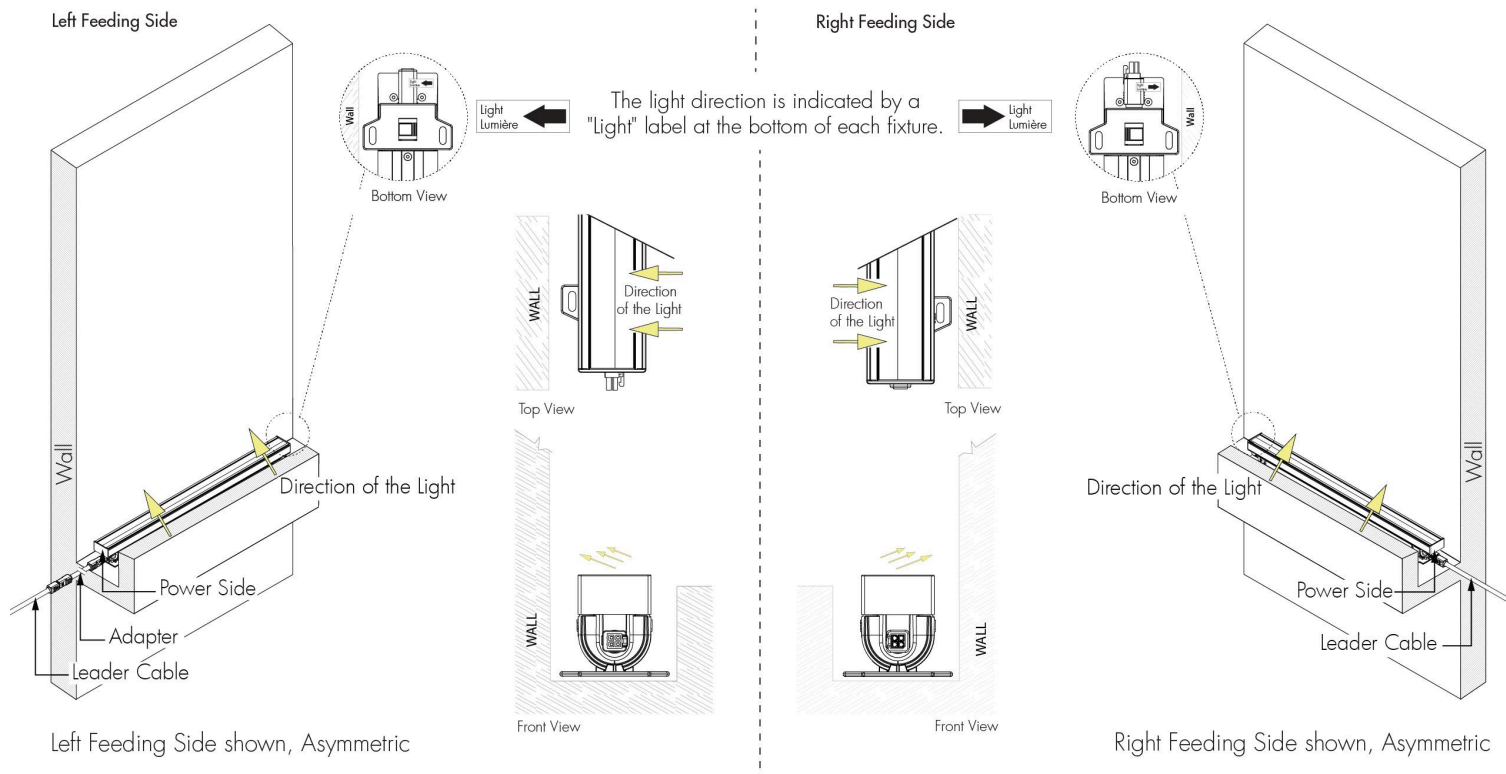

Resolution Details

DMX/RDM Control, Resolution Per Segment: Each 12 in Segment is Addressed Independently

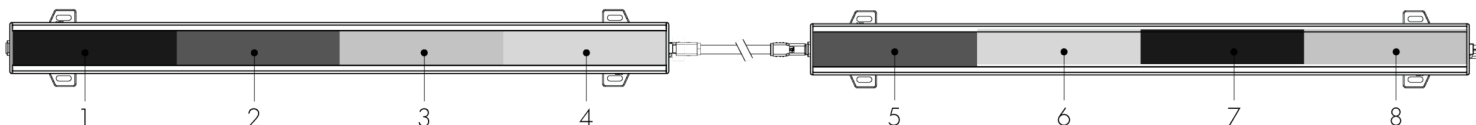

DMX/RDM Control, Resolution Per Fixture: Each Fixture is Addressed Independently

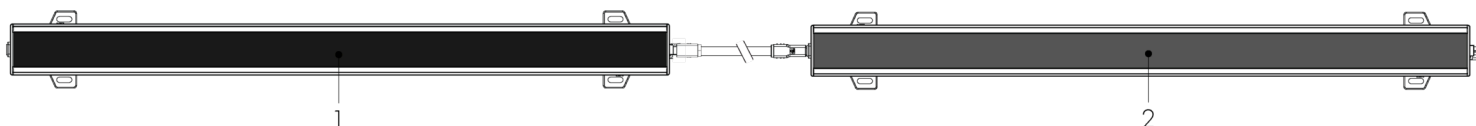

Wiring Color Code

On/Off

UL Color Code	Use
Green	Ground
Black	Line
White	Neutral

DALI, PDA1 or PDA2

UL Color Code	Use
Green	Ground
Black	Line
White	Neutral
Purple	Data +
Pink	Data -

DMX/RDM

UL Color Code	Use
Green	Ground
Black	Line
White	Neutral
Red	Data +
Grey	Data Return
Orange	Data -

Maximum Fixture Run Length Table

Lumencore Linear 4W/ft

	120V	277V
Maximum Run of Fixtures	284ft	664ft

Lumencore Linear 7W/ft

	120V	277V
Maximum Run of Fixtures	172ft	400ft

Lumencore Linear 10W/ft

	120V	277V
Maximum Run of Fixtures	124ft	284ft

Lumencore Linear 13W/ft

	120V	277V
Maximum Run of Fixtures	96ft	224ft

Based on 48 in fixtures, power limitations only, and a 10 ft Leader Cable for an end-to-end run, with no Jumper Cables between fixtures. Restrictions may apply based on control type.

The current in the Leader Cable shall not exceed 11A, and the voltage on any fixture shall not be lower than 90V during steady-rate operation. Refer to Typical Wiring Diagrams for Control Protocol specific run length rules.

Typical Wiring Diagrams

NO (On/Off Control)

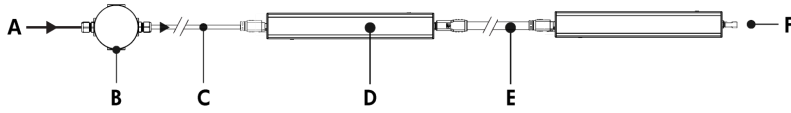

- A - Power input (120 to 277V, wiring by others)
- B - Junction box (by others)
- C - Leader Cable (LCVALC MDR3P)
- D - Lumencore Linear
- E - Jumper Cable (optional, LCVAJC MDR3P)
- F - End Cap

0-10V Dimming 0.1% Linear (PDA1) or 0.1% Logarithmic (PDA2)

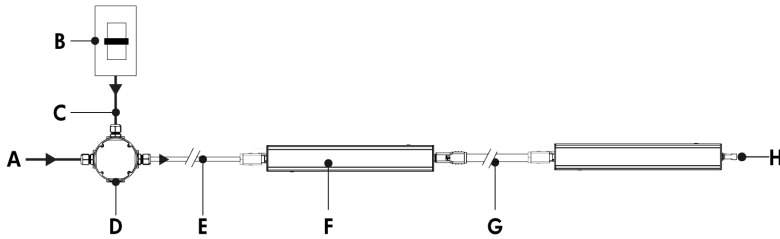

- A - Power input (120 to 277V, wiring by others)
- B - Third-party dimmer
- C - Data wiring (by others)
- D - Junction box (by others)
- E - Leader Cable (LCVALC MDR3P2D)
- F - Lumencore Linear
- G - Jumper Cable (optional, LCVAJC MDR3P2D)
- H - End Cap

0-10V mA ratings: passive dimmer (Current Sink): 1mA per fixture, active dimmer (Current Source): 0.5mA per fixture.

Less than 0.1% minimum dimming value.

0-10V, DALI or DMX Dimming With Lumentalk Data Bridge Indoor

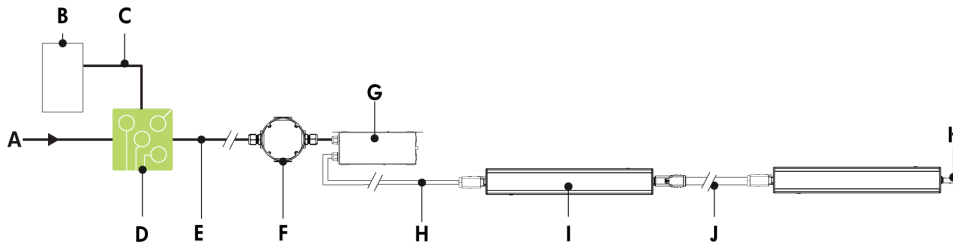

- A - Power input (120 to 277V, wiring by others)
- B - Dimmer/controller (order separately from Lumenpulse, or by others)
- C - Data wiring (wiring by others)
- D - Lumentranslator 2 (LTL2-DIM, -DMX)
- E - Power wiring (by others)
- F - Junction box (by others)
- G - Lumentalk Data Bridge Indoor (LDBI-DIM or LDBI-DMX)
- H - Leader Cable (LCVALC MDR3P2D or LCVALC MDR3P3D)
- I - Lumencore Linear
- J - Jumper Cable (optional, LCVAJC MDR3P2D or LCVAJC MDR3P3D)
- K - End Cap

Consult factory for specific applications and maximum fixture count/cable length recommendations.

For DMX applications: 1 DMX controller per Lumentalk network, maximum of 48 DMX channels per Lumentalk network (minimum step transition update rate is 1 second, minimum fade time between two colors is 1 minute). Consult factory for applications that require additional capabilities.

Maximum of 1 transmitter (Lumentranslator or Lumenlink) per system.

No third-party fixtures allowed on the same circuit.

Consult factory for DALI Lumentalk applications.

DALI T6 Control (DALI)

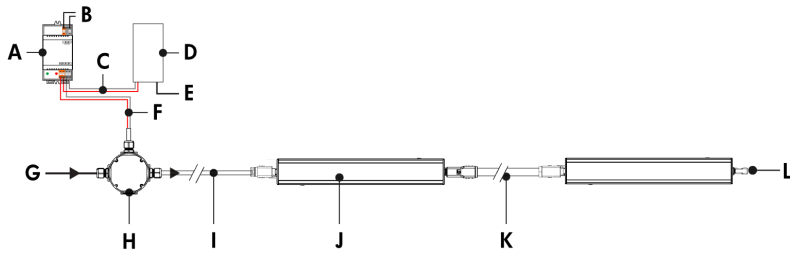

- A** - DALI bus power supply (by others)
- B** - Power input for DALI bus power supply (wiring by others)
- C** - Data output to DALI controller (wiring by others)
- D** - DALI controller (by others)
- E** - Power input for DALI controller (if required, wiring by others)
- F** - Data output to fixture (wiring by others)
- G** - Power input (120-277V, wiring by others)
- H** - Junction box (by others)
- I** - Leader Cable (LCVALC MDR3P2D)
- J** - Lumencore Linear
- K** - Jumper Cable (optional, LCVAJC MDR3P2D)
- L** - End Cap

64 DALI addressable device limitation (each fixture is an addressable device).

DALI does not allow for control by foot, only by fixture.

Commissioning may be required based on the selection of 3rd party DALI controller. Controller and commissioning provided by others.

Less than 0.1% minimum dimming value.

Daisy Chain Layout (DMX/RDM)

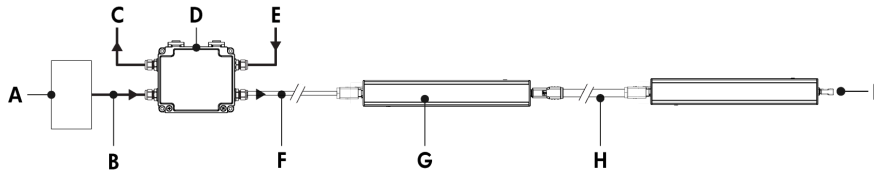

- A** - Third-party DMX/RDM controller
- B** - Data input (Belden 9841 or equivalent, by others)
- C** - Data output to next CBX (optional, not isolated/not boosted)
- D** - CBX-DS
- E** - Power input (120 to 277V, wiring by others)
- F** - Leader Cable (LCVALC MDR3P3D)
- G** - Lumencore Linear
- H** - Jumper Cable (optional, LCVAJC MDR3P3D)
- I** - DMX/RDM Terminator

Consult CBX installation instructions for additional wiring details.

800 ft maximum DMX/RDM "Bus" length.

1 DMX universe = 128 @ 4-channel controllable segments.

Maximum of 4 DMX/RDM repeaters/CBX cascading in line.

Maximum of 6 outputs per CBX-ST; maximum of 1 output per CBX-DS.

Star Layout (DMX/RDM)

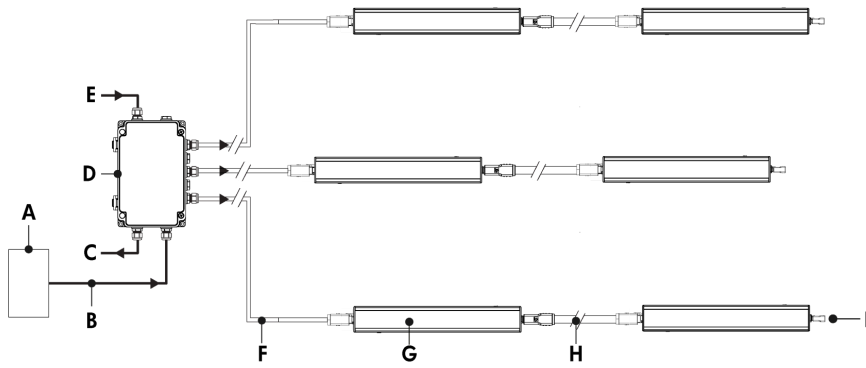

- A** - Third-party DMX/RDM controller
- B** - Data input (Belden 9841 or equivalent, by others)
- C** - Data output to next CBX (optional, not isolated/not boosted)
- D** - CBX-ST
- E** - Power input (120 to 277V, wiring by others)
- F** - Leader Cable (LCVALC MDR3P3D)
- G** - Lumencore Linear
- H** - Jumper Cable (optional, LCVAJC MDR3P3D)
- I** - DMX/RDM Terminator

Consult CBX installation instructions for additional wiring details.

800 ft maximum DMX/RDM "Bus" length.

1 DMX universe = 128 @ 4-channel controllable segments.

Maximum of 4 DMX/RDM repeaters/CBX cascading in line.

Maximum of 6 outputs per CBX-ST; maximum of 1 output per CBX-DS.

Leader Cable STD Option (Order Separately)

LCVALC - Lumencore Linear Leader Cable (MDR3P)

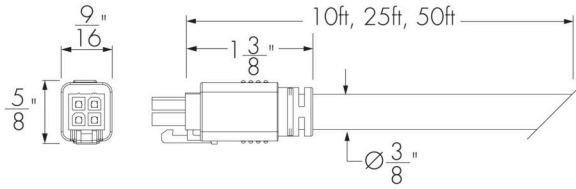

LCVALC - Lumencore Linear Leader Cable (MDR3P2D)

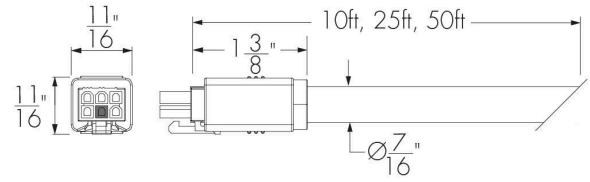

LCVALC - Lumencore Linear Leader Cable (MDR3P3D)

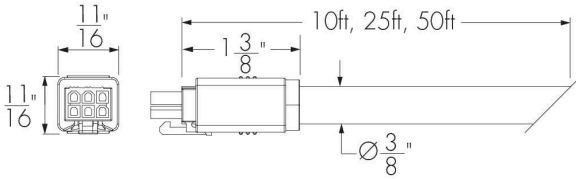

LCVALC-UL-CERTIFICATION-VOLTAGE-CONTROL-LENGTH-CABLE COLOR-OPTION

Please specify:

CERTIFICATION: UL

VOLTAGE: 120_277

CONTROL:

MDR3P: On/Off

MDR3P2D: 0-10V and DALI

MDR3P3D: DMX/RDM

LENGTH: 10 ft, 25 ft, 50 ft

CABLE COLOR: WH (White), BK (Black)

OPTION: STD

A DMX/RDM Terminator is mandatory at the end of a fixture run. One (1) included with every MDR3P3D Leader Cable.

Cable Bend Radius:

MDR3P: Minimal bend radius 2 in

MDR3P2D: Minimal bend radius 3 in

MDR3P3D: Minimal bend radius 2 in

Consult Lumencore Linear Leader Cable specification sheet for additional information.

MDR3P and MDR3P2D: End Cap is provided

MDR3P3D: DMX/RDM Terminator is provided

Leader Cable ASY Option (Order Separately)

LCVALC - Lumencore Linear Leader Cable (MDR3P)

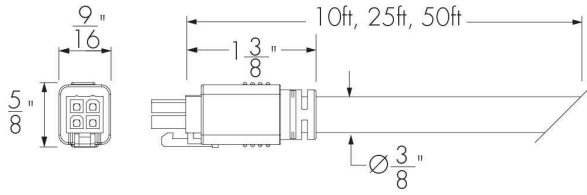

Lumencore Linear Leader Cable Adapter (MDR3P)

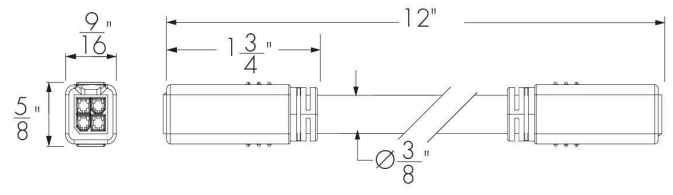

LCVALC - Lumencore Linear Leader Cable (MDR3P2D)

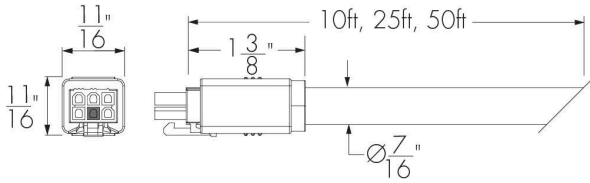

Lumencore Linear Leader Cable Adapter (MDR3P2D)

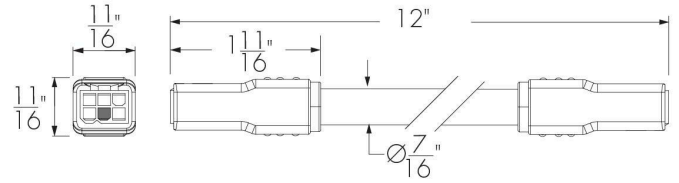

LCVALC - Lumencore Linear Leader Cable (MDR3P3D)

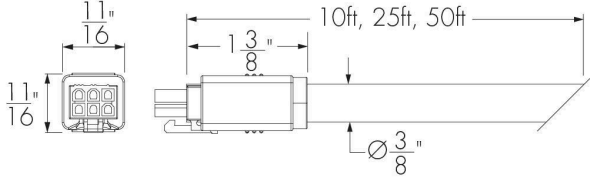

Lumencore Linear Leader Cable Adapter (MDR3P3D)

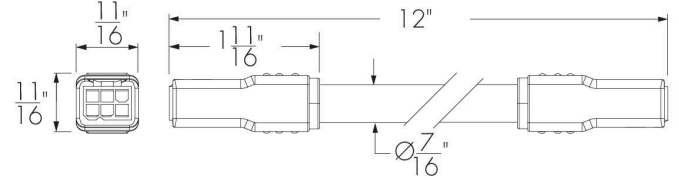

LCVALC-UL-CERTIFICATION-VOLTAGE-CONTROL-LENGTH-CABLE COLOR-OPTION

Please specify:

CERTIFICATION: UL

VOLTAGE: 120_277

CONTROL:

MDR3P: On/Off

MDR3P2D: 0-10V and DALI

MDR3P3D: DMX/RDM

LENGTH: 10 ft, 25 ft, 50 ft

CABLE COLOR: WH (White), BK (Black)

OPTION: ASY

A DMX/RDM Terminator is mandatory at the end of a fixture run. One (1) included with every MDR3P3D Leader Cable.

Cable Bend Radius:

MDR3P: Minimal bend radius 2 in

MDR3P2D: Minimal bend radius 3 in

MDR3P3D: Minimal bend radius 2 in

Consult Lumencore Linear Leader Cable specification sheet for additional information.

MDR3P and MDR3P2D: End Cap is provided

MDR3P3D: DMX/RDM Terminator is provided

Leader Cable Adapter provided with ASY option.

Jumper Cable (Order Separately)

LCVAJC - Lumencore Linear Jumper Cable (MDR3P)

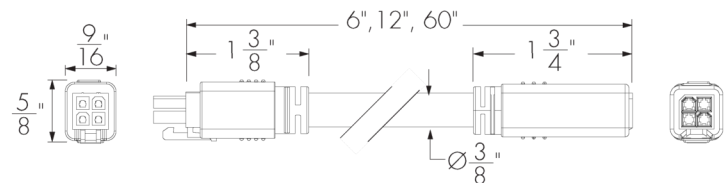

LCVAJC - Lumencore Linear Jumper Cable (MDR3P2D)

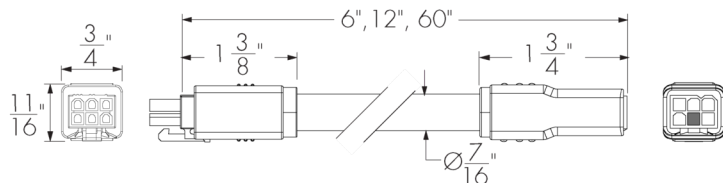

LCVAJC - Lumencore Linear Jumper Cable (MDR3P3D)

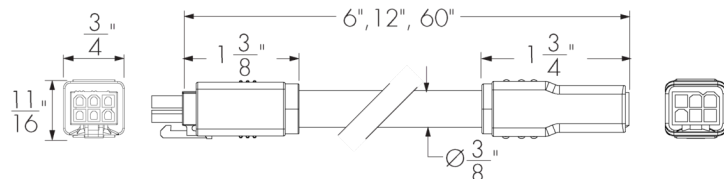

LCVAJC-UL-CERTIFICATION-VOLTAGE-CONTROL-LENGTH-CABLE COLOR

Specify:

CERTIFICATION: UL

VOLTAGE: 120_277

CONTROL:

MDR3P: On/Off

MDR3P2D: 0-10V and DALI

MDR3P3D: DMX/RDM

LENGTH: 6 in, 1 ft or 5 ft

CABLE COLOR: WH (White), BK (Black)

Cable Bend Radius:

MDR3P: Minimal bend radius 2 in

MDR3P2D: Minimal bend radius 3 in

MDR3P3D: Minimal bend radius 2 in

Consult Lumencore Linear Jumper Cable specification sheet for additional information. Minimum spacing two fixtures in a row: 0.28 in (nominal).

Control Systems (Order Separately)

PHAROS - Pharos® Designer Lighting Control Kit

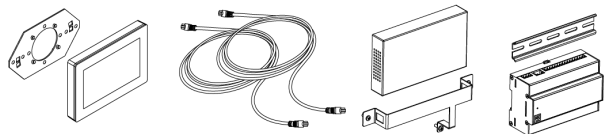

The Pharos Designer Lighting Control Kit, available for 1 or 2 DMX universes, allows for complete control of large lighting installations.

EXPERT - Pharos® Expert Control Kit

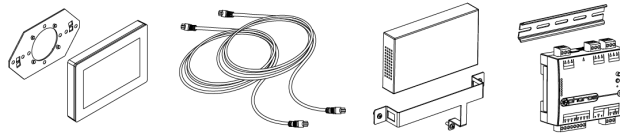

The Pharos Expert Control Kit, available for 1, 2, 4 or 6 DMX universes, allows for complete control of large lighting installations.

Diagnostic And Addressing Tools (Order Separately)

LID - LumenID



The updated LumenID (LID) is an all-in-one diagnostic and addressing solution for both DMX/RDM and Lumentalk (LT) systems. Engineered for versatility, it streamlines commissioning and troubleshooting across protocols—no need for multiple tools. Cable option may vary; please consult factory. For complete details, refer to the LID specification sheet.

Control Boxes (Order Separately)

CBX-DMX/RDM - DMX/RDM Enabled (Daisy Chain or Star Configuration)

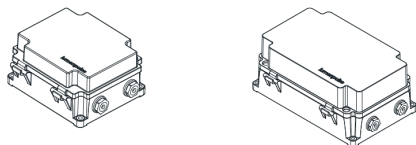

DMX/RDM control box. Up to six power and data outputs to fixtures or fixture runs. Consult CBX specification sheet and installation instructions for details. Lumenterminators provided with CBX (2x for Daisy Chain configuration, 6x for Star configuration), consult factory to order spares.

CBX-ENET - Ethernet Enabled (Daisy Chain or Star Configuration)

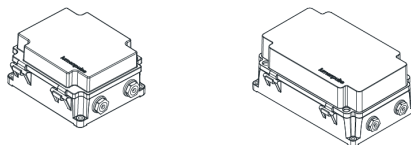

Ethernet control box. Up to four power and data outputs to fixture or fixture runs. Consult Ethernet CBX specification sheet and installation instructions for details.

LDBI - Lumentalk Data Bridge Indoor

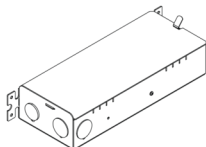

The Lumentalk Data Bridge Indoor is a digital interface that connects non-Lumentalk luminaires to the Lumentalk network, 0-10V or DMX output. Consult the Lumentalk Data Bridge Indoor specification sheet and installation instructions for details.

WC - Wiring Compartment

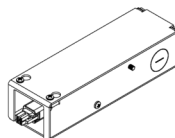

The Lumenpulse Wiring Compartment is pre-wired with a leader cable, allowing the quick connection of conduits. Consult the Wiring Compartment specification sheet and installation instructions for details.

Alignment Track (Order Separately)

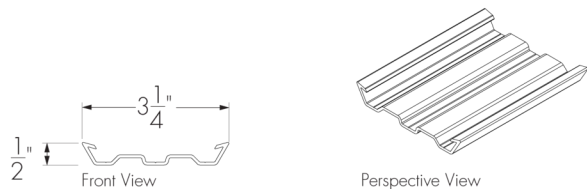

LCVAT-LENGTH-COLOR

LENGTH: 5 ft

COLOR: WH (White)

Alignment Track can only be used with ST Mounting Option. Alignment Track must be cut on site to desired length.

Alignment Track Cover (Order Separately)

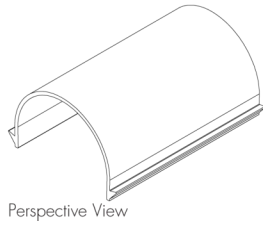
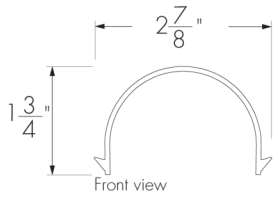
**LCVARC-LENGTH-COLOR****LENGTH:** 5 ft**COLOR:** WH (White)

Alignment Track Cover must be used in combination with Alignment Track.

Alignment Track Cover can be used to cover cable between two fixtures. To be cut on site to desired length.

How to Order

Housing	Certification	Voltage	Length	Wattage	Color and Color Temperature	Color Rendering (2)	Optic	Control (7)	Mounting Options	Finish
LCVA Lumencore Linear Graze	UL UL Compliant	120 277 120 Volts to 277 Volts	12 12 in	4W 4 W/ft	22K 2200K	80 CRI 80+ (3)	10x10 10°x10°	NO On/Off Control PDA1 Professional 0-10V Dimming 0.1% Linear Curve PDA2 Professional 0-10V Dimming 0.1% Logarithmic Curve DALI DALI 2 T6 Enabled Dimming 0.1% (8) DMX/RDM DMX/RDM Enabled Dimming 0.1% (9) NAS Narrow Asymmetric (5) (6) WW Asymmetric Wallwash (5) (6)	ST Standard Mounting (10) (11) (12) (13) SM Slim Adjustable Mounting Continuously Adjustable (14) WMC3 Wall Mounting Continuously Adjustable 3 in to Optical Center (14) WMC4 Wall Mounting Continuously Adjustable 4 in to Optical Center (14) WMC6 Wall Mounting Continuously Adjustable 6 in to Optical Center (14) WMC12 Wall Mounting Continuously Adjustable 12 in to Optical Center (14) WMC18 Wall Mounting Continuously Adjustable 18 in to Optical Center (14) WMC24 Wall Mounting Continuously Adjustable 24 in to Optical Center (14)	MWH Matte White MBK Matte Black CC Custom Color & Finish (10) (15) (16) (17) SP Special Color (Choose From Standard Point Source Color Palette) (18)
			24 24 in	7W 7 W/ft	27K 2700K	90 CRI 90+ (4)	10x30 10°x30°			
			36 36 in	10W 10 W/ft	30K 3000K		10x60 10°x60°			
			48 48 in	13W 13 W/ft	35K 3500K		30x10 30°x10°			
					40K 4000K		60x10 60°x10°			
					RD Red (1)		30x60 30°x60°			
					GR Green (1)		30x30 30°x30°			
					BL Blue (1)		60x60 60°x60°			
					AMB Phosphor Converted Amber (PC Amber) (1)		90x90 90°x90°			

Notes:

- Not available for NAS and WW optics.
- Available for 22K, 27K, 30K, 35K and 40K color temperatures only.
- Available for 22K Color Temperature only.
- Available for 27K, 30K, 35K and 40K color temperatures only.
- Not available for static Red (RD), Green (GR), Blue (BL) or Amber (AMB) color options.
- Not available with LV, HL or SN Accessories.
- Lumentalk system is enabled with Lumentalk Data Bridge Indoor (LDBI) accessory. A PDA1, PDA2 or DMX/RDM Control Option must be specified in fixture code. See the typical wiring diagrams and consult factory for more details.
- DALI 2 T6 controller required, provided by others.
- A Control Box (CBX-DS or CBX-ST) and lumenID (LID) must be specified.
- ST Mounting Option not available with CC Custom Color and Finish, or SP Special Color Finishes.
- ST Mounting Option is required if the LCVAT Alignment Track will be ordered separately.
- ST Mounting Option is not compatible with SH Shield Accessory.
- Two mounting brackets provided for each fixture length.
- One mounting bracket provided for 12 in fixtures. Two mounting brackets provided for 24 in, 36 in and 48 in fixtures.
- Textured colours and finishes are not available.
- Setup charges apply for RAL colors. Consult factory for details.
- Longer lead times can be expected for custom RAL color finishes.
- Concrete Grey (CGY) and Parget White (PWH) are not available as special colors.

How to Order

--	--	--	--	--

Cable Color ⁽¹⁹⁾	Accessories	Shield	Shield Finish	Buy American Act
WH White	NA No Accessory	NH No Shield	MWH Matte White	BAA Buy American ⁽²⁷⁾
BK Black	VS Visor ⁽²⁰⁾ ⁽²¹⁾ ⁽²²⁾	SH Shield ⁽²⁴⁾ ⁽²⁵⁾	MBK Matte Black	
	LV Louver ⁽¹⁾ ⁽²⁰⁾ ⁽²¹⁾ ⁽²²⁾ ⁽²³⁾		CC Custom Color & Finish ⁽¹⁰⁾ ⁽¹⁵⁾ ⁽¹⁶⁾ ⁽¹⁷⁾ ⁽²⁶⁾	
	HL Honeycomb Louver ⁽¹⁾ ⁽²⁰⁾ ⁽²¹⁾ ⁽²²⁾		SP Special Color (Choose From Standard Point Source Color Palette) ⁽¹⁸⁾	
	SN Snoot ⁽¹⁾ ⁽²⁰⁾ ⁽²¹⁾ ⁽²²⁾			

Notes:

- 1. Not available for NAS and WW optics.
- 10. ST Mounting Option not available with CC Custom Color and Finish, or SP Special Color Finishes.
- 15. Textured colours and finishes are not available.
- 16. Setup charges apply for RAL colors. Consult factory for details.
- 17. Longer lead times can be expected for custom RAL color finishes.
- 18. Concrete Grey (CGY) and Parget White (PWH) are not available as special colors.
- 19. The Cable Color must match the Fixture Finish, unless CC or SP is specified in the product code. If CC or SP is specified as the Fixture Finish in the product code, a WH or BK cable can be specified.
- 20. Accessories are sold in 12 in sections. The length specified for the fixture will determine the number of accessories provided.
- 21. Matte black interior surface, exterior finish matches housing color.
- 22. Not available if CC Custom Color and Finish or SP Special Color is specified in the product code.
- 23. If fixture is specified with 22K, 30K, 35K or 40K Color Temperature, a 12-Cell Louver is provided. If fixture is specified with a RD, GR, BL or AMB Static Color, a 4-Cell Louver is provided.
- 24. The SH Shield Accessory is not available with ST Mounting Option.
- 25. The SH Shield Accessory can be combined with one other accessory.
- 26. Lumenpulse offers a wide selection of RAL CLASSIC (K7) colors with a smooth texture and high-gloss finish. Please consult factory for a list of available K7 colors, other RAL textures and glosses, or to match alternate color charts. Final color matching results may vary.
- 27. Contact your Lumenpulse Sales Representative for more information on order volume details.