

Project Name

Qty

Type

Catalog / Part Number

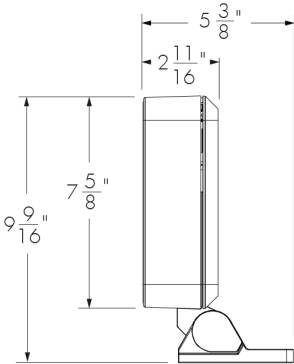

Side View



Front View

Photometric Summary

Symmetric

	Delivered output (lm)	Intensity (peak cd)
XN (3°)	1,342	186,978
VN (6°)	906	47,949
NS (10°)	1,419	20,764
NF (20°)	1,238	12,472
M (30°)	1,297	7,185
FL (40°)	1,163	2,960
WFL (60°)	977	762
VWFL (90°)	946	470

Asymmetric

	Delivered output (lm)	Intensity (peak cd)
NAS	947	14,011 (@2.5°)
WW	11,06	3,013 (@5°)

Roadway

	Delivered output (lm)	BUG rating
2-Type II	911	B:0 U:0 G:0
3-Type III	987	B:0 U:0 G:0
4-Type IV	774	B:0 U:0 G:0
5S-Type VS	923	B:1 U:0 G:0

1. Based on 4000K.  
2. Photometric performance is measured in compliance with IESNA LM-79-24.  
3. Refer to IES files for photometric information on distributions with backlight shield options (2BLS, 3BLS and 4BLS).  
4. Refer to the Lumenquad White and Static Colors Photometric Guide on Lumenpulse website for information on other color temperatures.

Description

The Lumenquad Small, 14W LED luminaire, has a sleek 2 11/16 in profile with no visible wiring or hardware and seamlessly integrates with any architecture. Lumenpulse's latest generation of LED boards possess an optimised candela and lumens recipe for both Narrow and Wide optics. The Lumenquad Small is the epitome of versatility and can be configured with numerous options including optics for wallwash, floodlighting, or street lighting, a choice of colour temperatures and colours, as well as various mounting options, accessories, controls, and multiple standard finishes.

Features

Color and Color Temperature	22K: 2200K, 27K: 2700K, 30K: 3000K, 35K: 3500K, 40K: 4000K, 57K: 5700K, RD: Red, GR: Green, BL: Blue
Optics (Nominal Distribution)	XN: XN (3°), VN: VN (6°), NS: NS (10°), NF: NF (20°), M: M (30°), FL: FL (40°), WFL: WFL (60°), VWFL: VWFL (90°), NAS: NAS (Narrow Asymmetric), WW: WW (Asymmetric Wallwash), 2: Type II, 2BLS: Type II Backlight Shield, 3: Type III, 3BLS: Type III Backlight Shield, 4: Type IV, 4BLS: Type IV Backlight Shield, 5S: Type VS
Mounting Options	SM: Surface Mount, WM: Wall Mount Bracket with Decorative Cover, WMNC: Wall Mount Bracket without Decorative Cover, RJBOX: Recessed JBOX Wall Mount with Decorative Cover, RJBOXNC: Recessed JBOX Wall Mount Without Decorative Cover, PM: Pole Mount, TN: Tenon Mount, SK: Stake Mount, STM: Stud mount
Optical Options (Factory Installed)	LSLH: Linear Spread Lens Horizontal Distribution, LSLV: Linear Spread Lens Vertical Distribution, HL: Honeycomb Louver
Option	CRC: Corrosion-Resistant Coating for Hostile Environments
Power Consumption	14W
Warranty	5-year limited warranty

Optic

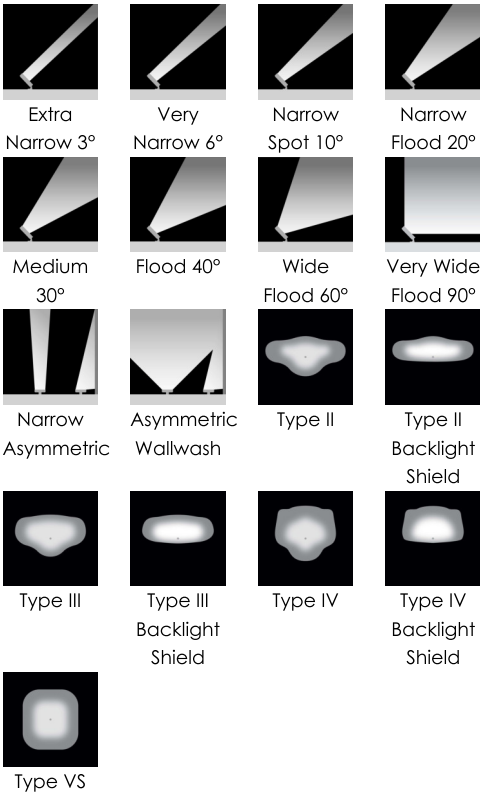

Color and Color Temperature

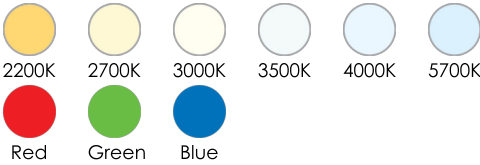

Control



Ratings

IP66 IK10

Certifications



Performance

Maximum Delivered Output	1,419 lm (4000K, NS 10°)
Maximum Delivered Intensity	186,978 cd at nadir (4000K, XN 3°)
Illuminance at Distance	Minimum 1 fc at 434 ft (4000K, XN 3°)
Color Consistency	3 SDCM
Color Rendering	CRI 80+
Lumen Maintenance	L70 > 250,000 hrs (Ta 25 °C) (> 80,000 hrs for XN 3°, VN 6°, NAS optics only)

Physical

Housing Material	Low copper content high pressure die-cast aluminum
Lens Material	Clear tempered glass
Hardware Material	Stainless steel
Gasket Material	Silicone
Surface Finish	Electrostatically applied polyester powder coat
Weight	6.65 lbs
EPA	Front = 0.43 ft², Side = 0.21 ft², Front 45°= 0.41 ft²

Electrical and Control

Voltage	120-277 Volts
Fixture Cable	Power and data in one cable
Conductors	3C #16-3 (NO control) 5C #16-5 (DIM, DALI control) 6C #14-3/ #24-3 (DMX/RDM control)
Control	On/Off Control, 0-10V Dimming, DALI Dimming, DMX/RDM Enabled, Lumentalk system is enabled with LDB accessory - see typical wiring diagrams for details
Resolution (DMX/RDM)	Per fixture, 8-bit or 16-bit

Environmental

Storage Temperature	-40 °F to 158 °F (device must reach start-up temperature value before operating)
Start-up Temperature	-13 °F to 122 °F
Operating Temperature	-40 °F to 122 °F
Ingress Protection Rating	IP66 Wet location rated
Impact Resistance Rating	IK10
Application Wind Speed	Luminaires were designed based on AASHTO 2013 standard to ensure highest quality and safety. Installation should be validated by a local project engineer to ensure the luminaires are suitable for the wind speed and exposure of the specific application

Accessories (Order Separately)

Optical Accessories	Snoot, Visor, Linear Spread Lens Adjustable, Wire Guard
Control Boxes	DMX/RDM enabled (Daisy Chain or Star Configuration), Ethernet enabled (Daisy Chain or Star Configuration), Lumentalk Data Bridge
Control Systems	Pharos® Designer Lighting Control Kit (PHAROS), Pharos® Expert Control Kit (EXPERT)
Diagnostic and Addressing Tools	LumenID (LID)

Important

Virtual Patent Marking Notice

This website (<https://www.lmpg.com/patents-trademarks>) is provided to satisfy the virtual patent marking provisions of applicable jurisdictions. Some products listed may be covered by additional patents not referenced here.

Chromaticity Data

TM-30 - 4000K

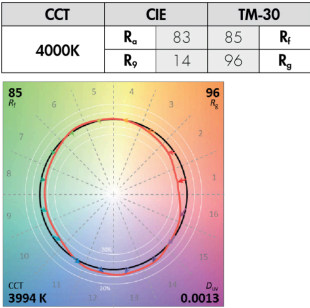

Spectral Power Distribution

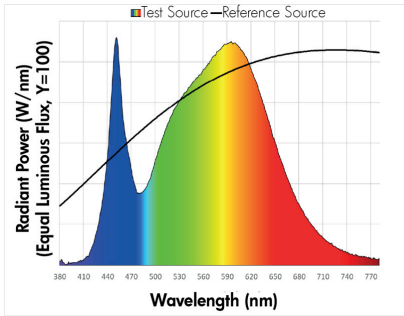

Mounting Options

SM - Surface Mount

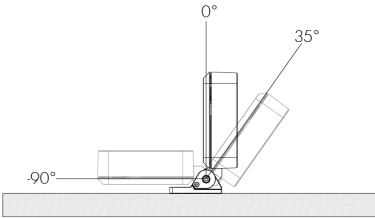

SM - Mounting Hole Pattern

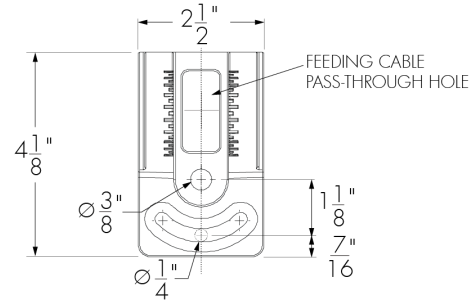

The SM mounting option cannot be interchanged with any other mounting option. All others mountings are interchangeable. Consult factory for details.

WM - Wall Mount Bracket with Decorative Cover

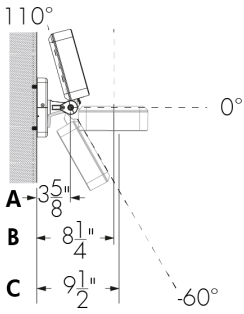

WMNC - Wall Mount Bracket Without Decorative Cover

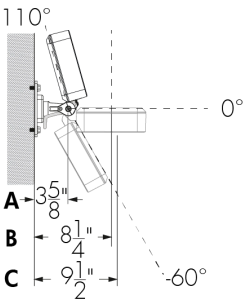

- A - Dimension from wall to pivot.
- B - Dimension from wall to the geometric center of the fixture.
- C - Dimension from wall to the center of the board.

WAM - Wall Mount Bracket With Decorative Cover  
6 in, 12 in, 18 in or 24 in

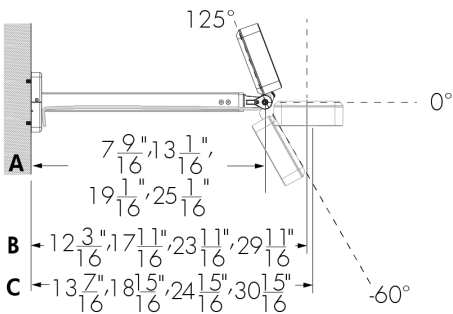

A cable length of 10 ft or greater must be specified for the WAM24 mounting option.

WAMNC - Wall Mount Bracket Without Decorative Cover  
6 in, 12 in, 18 in or 24 in

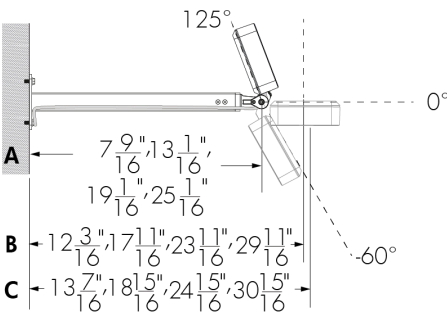

A cable length of 10 ft or greater must be specified for the WAM24 mounting option.

WMRJB - Recessed JBOX Wall Mount With Decorative Cover

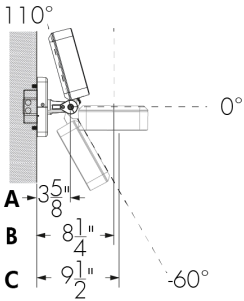

Fixture cable length is determined by Lumenpulse.

WMRJBNC - Recessed JBOX Wall Mount Without Decorative Cover

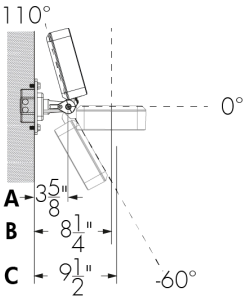

Fixture cable length is determined by Lumenpulse.

WAMRJB - Recessed JBOX Wall Arm Mount With  
Decorative Cover 6 in, 12 in, 18 in or 24 in

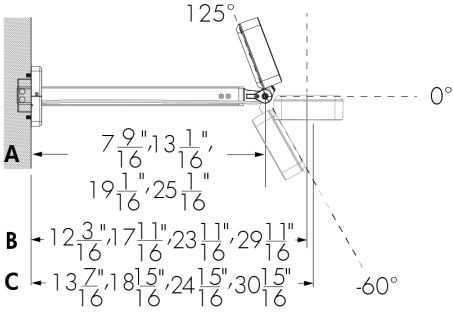

Wall Mount Horizontal Pivot Limits

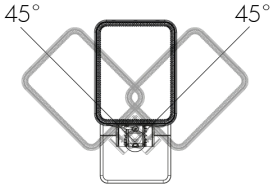

WAMRJBNC - Recessed JBOX Wall Arm Mount  
Without Decorative Cover 6 in, 12 in, 18 in or 24 in

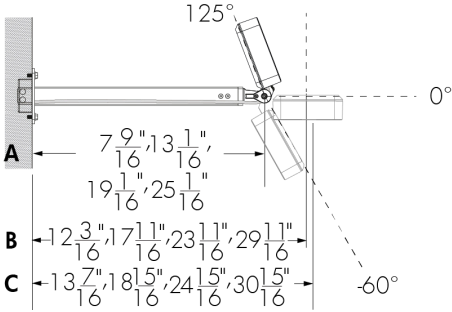

WM, WAM, WMRJB and WAMRJB - Mounting Hole  
Pattern

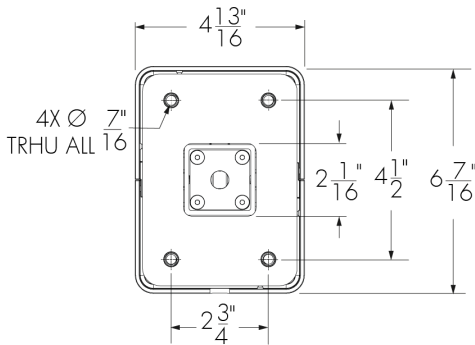

WMNC, WAMNC, WMRJBNC and WAMRJBNC -  
Mounting Hole Pattern

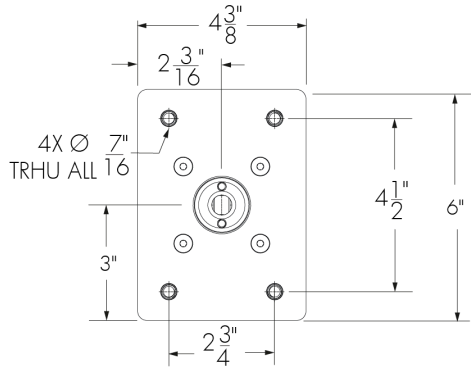

RPM4/1, RPM4.5/1, RPM5/1 - Round Pole Mount

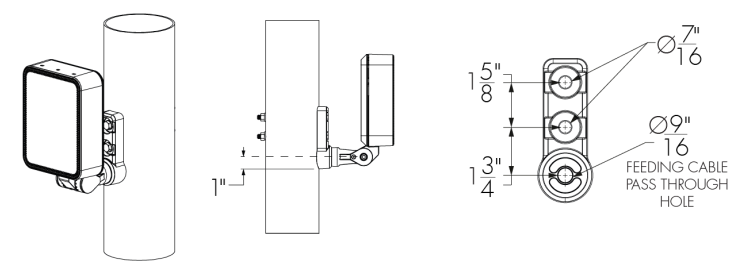

	RPM4/1	RPM4.5/1	RPM5/1
For pole Ø	4" ± 1/16	4.5" ± 1/16	5" ± 1/16
Bolt length	5 1/4	5 3/4	6 1/4

Consult factory for other pole diameters.  
Hardware included with accessory.

Round Pole Mount Horizontal Pivot Limits

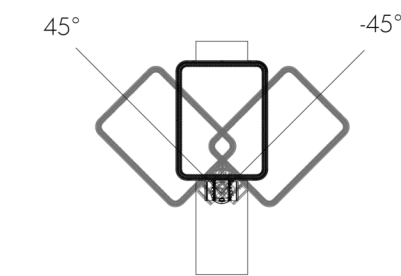

PLTU - Universal Yoke

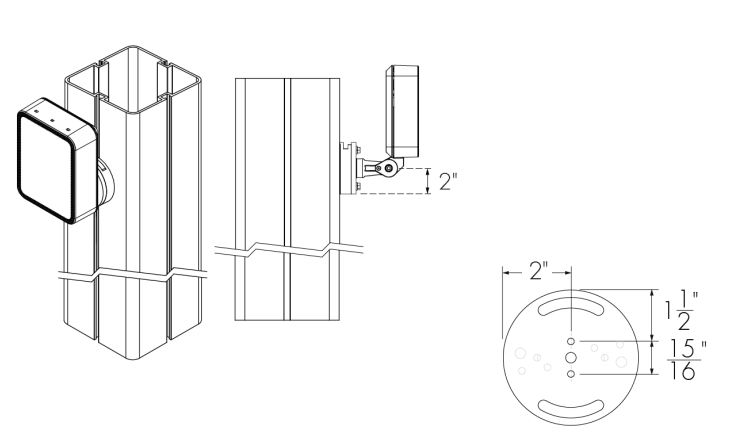

Refer to the Universal Yoke specification sheet and Pole nstallation instructions for more details. Square Lumentech profile shown.

All mounting options (except for SM mounting) are interchangeable. Consult factory for details.

RPM4/2, RPM4.5/2, RPM5/2 - Round Pole Mount For Two Fixtures

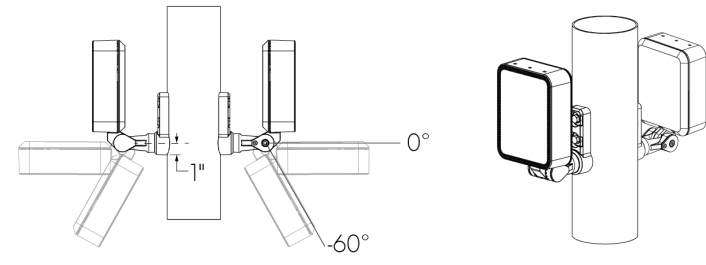

	RPM4/2	RPM4.5/2	RPM5/2
For pole Ø	4" ± 1/16	4.5" ± 1/16	5" ± 1/16
Bolt length	5 3/4	6 1/4	7"

Consult factory for other pole diameters.  
Hardware included with accessory.

TN2 - Tenon Adapter For 2 3/8 in O.D. Pole

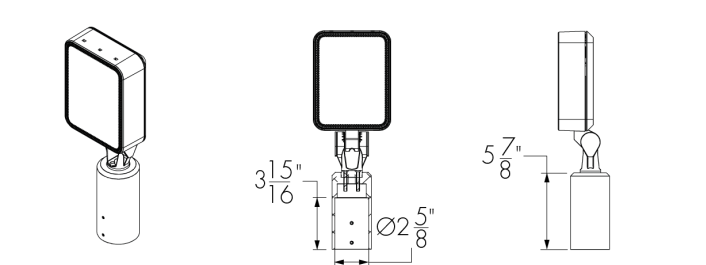

Vertical mounting only. Consult factory for horizontal mounting.

TN4 - Tenon Adapter For 4 in O.D. Pole

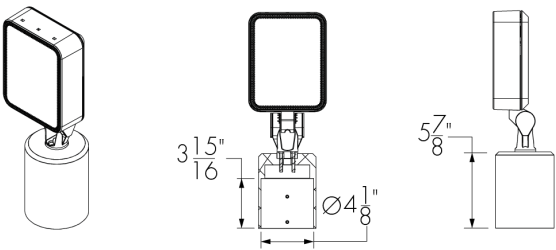

Vertical mounting only. Consult factory for horizontal mounting.

SK - Stake Mount

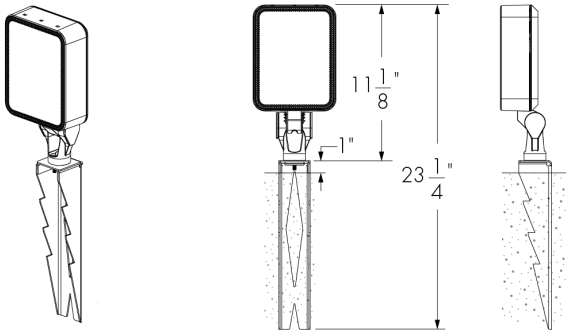

All mounting options (except for SM mounting) are interchangeable. Consult factory for details.

STM - Stud Mount

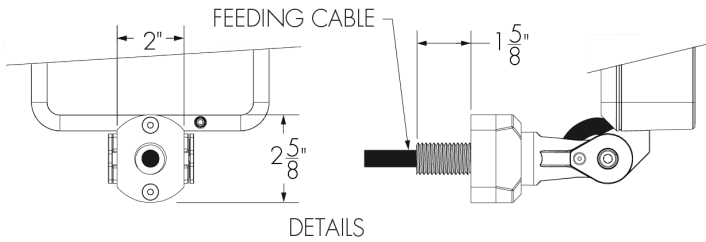
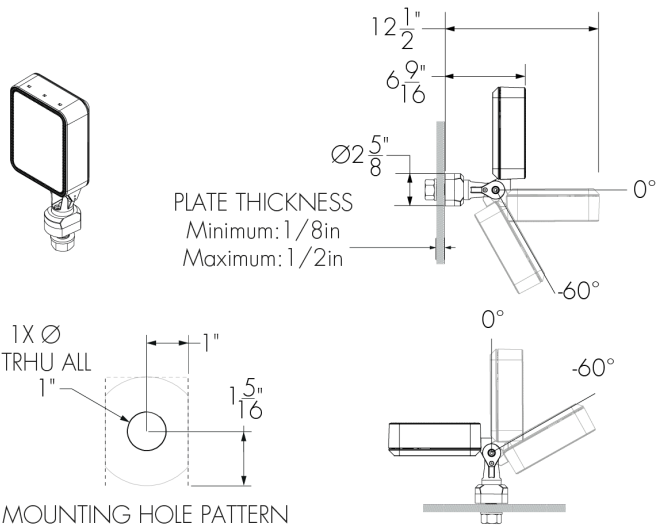

Vertical or horizontal mounting

All mounting options (except for SM mounting) are interchangeable. Consult factory for details.

Optical Options

LSLH - Linear Spread Lens Horizontal Distribution

LSLV - Linear Spread Lens Vertical Distribution

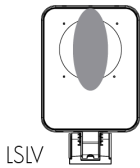
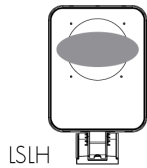

Factory installed, not adjustable on site. Not available for WFL, VWFL, NAS, WW, 2, 2BLS, 3, 3BLS, 4, 4BLS and 5S optics.

See 'Optical Accessories' section for field adjustable spread lens (LSLA).

	Beam angle with LSLH/LSLV
XN	5° x 60°
VN	7° x 60°
NS	13° x 60°
NF	18° x 65°
M	25° x 66°
FL	35° x 70°

LLF: 0.88\*  
\*LLF may vary slightly by distribution chosen.

HL - Honeycomb Louver

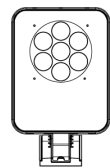

Factory installed, not adjustable on site. HL not available for WFL, VWFL, NAS, WW, 2, 2BLS, 3, 3BLS, 4, 4BLS and 5S optics.

The addition of a honeycomb louver will affect beam distribution. Consult factory for application support.

LLF: 0.90\*  
\*LLF may vary slightly by distribution chosen.



Optical Accessories (Factory Installed, Order Separately)

Installed optical accessories will affect the maximum pivot limits for each mounting option, consult factory for details.

SN - Snoot

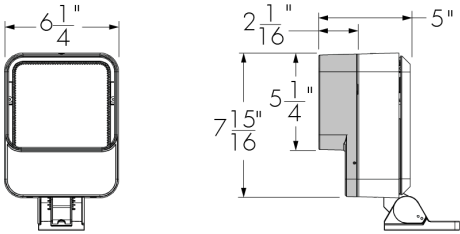

LQSSN-FINISH-BK-OPTIONS (CRC)  
Interior surface painted black. Please specify the exterior **FINISH** from the list of finishes in the fixture order code.

VS - Visor

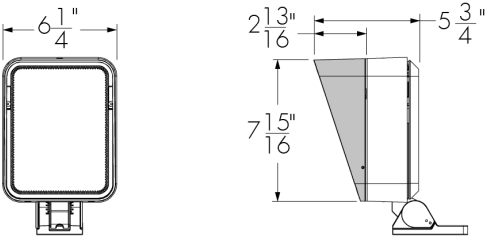

LQSVS-FINISH-BK-OPTIONS (CRC)  
Interior surface painted black. Please specify the exterior **FINISH** from the list of finishes in the fixture order code.

The Visor is not recommended for the WW optic.

LSLA - Linear Spread Lens Adjustable

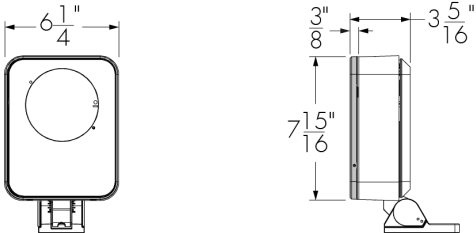

LQSLSLA-FINISH-OPTIONS (CRC)  
Please specify the exterior **FINISH** from the list of finishes in the fixture order code.

WG - Wire Guard

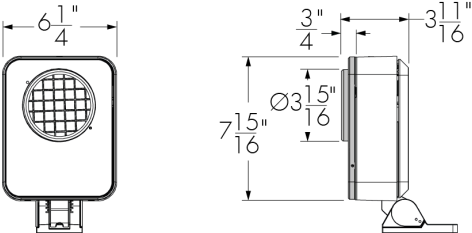

LQSWG-FINISH-OPTIONS (CRC)  
Please specify the exterior **FINISH** from the list of finishes in the fixture order code.

Accessory Combinations

	+	Snoot	Visor	Wire guard
Linear spread lens adjustable		YES	YES	NO
Wire guard		YES	YES	N/A

Accessory combinations must be ordered together on a single line. Ex: A snoot + wire guard combination order code is LQSSNWG-BK-BK. A maximum of two accessories can be combined per fixture.

Diffuser Lenses (Intended for Mockup Purposes Only, Order Separately)

Diffuser Lens 1 (1 Notch)

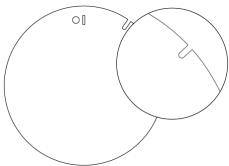

147695

Diffuser Lens 2 (2 Notches)

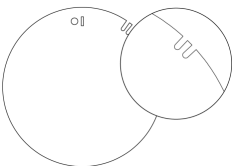

147696

Diffuser Lens 3 (3 Notches)

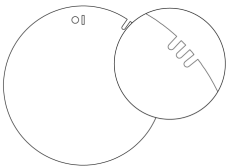

147697

Diffuser Lens 4 (4 Notches)

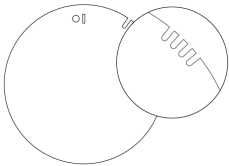

147698

Diffuser Lens 5 (5 Notches)

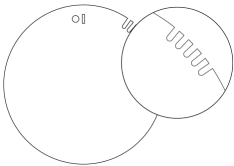

147699

Diffuser Lens 6 (6 Notches)

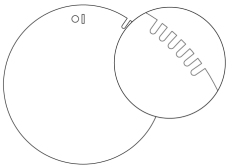

147700

Final Distribution Using Diffuser Lenses

	Final Distribution Using Diffuser Lens					
Original Distribution on Fixture	Diffuser Lens 1 1 Notch	Diffuser Lens 2 2 Notches	Diffuser Lens 3 3 Notches	Diffuser Lens 4 4 Notches	Diffuser Lens 5 5 Notches	Diffuser Lens 6 6 Notches
XN (4°/5°)	VN	NS	NF	M	FL	WFL
VN (6°)	NS					
NS (10°)						
NF (20°)						
M (30°)			FL	WFL		
FL (40°)						
WFL (60°)			VWFL			
VWFL (90°)						

Choose a diffuser lens based on the desired final beam distribution. Refer to the 6-digit part numbers above to order diffuser lenses individually. To order a complete set of 6 diffuser lenses in a bag, refer to the following item names: **LQS**: LQALK-S **LQM**: LQALK-M **LQL**: LQALK-L **LQG**: LQALK-G

The diffuser lenses are intended for mockup purposes only. A lens holder is required to install a diffuser lens on the fixture, order separately using the following names: **LQS**: LQSLSLA-FINISH-LQALK **LQM**: LQMLSLA-FINISH-LQALK **LQL**: LQLLSLA-FINISH-LQALK **LQG**: LQGSLSLA-FINISH-LQALK

Please specify the exterior **FINISH** from the list of finishes in the fixture order code.  
Refer to the Diffuser Lens Installation Instructions on the Lumenpulse website for information on installing the diffuser lenses.

Control Boxes (Order Separately)

CBX-DMX/RDM - DMX/RDM Enabled (Daisy Chain or Star Configuration)

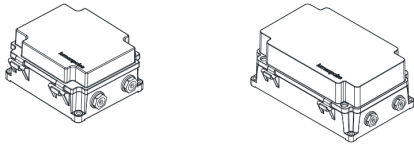

DMX/RDM control box. Up to six power and data outputs to fixtures or fixture runs. Consult CBX specification sheet and installation instructions for details. Lumenterminators provided with CBX (2x for Daisy Chain configuration, 6x for Star configuration), consult factory to order spares.

CBX-ENET - Ethernet Enabled (Daisy Chain or Star Configuration)

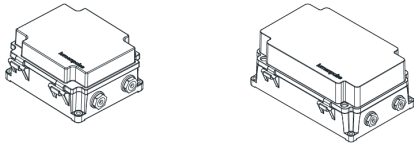

Ethernet control box. Up to four power and data outputs to fixture or fixture runs. Consult Ethernet CBX specification sheet and installation instructions for details.

LDB - Lumentalk Data Bridge

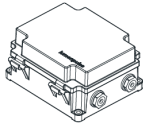

Lumentalk Data Bridge, 0-10V or DMX output. Consult LDB specification sheet for details.

Control Systems (Order Separately)

PHAROS - Pharos® Designer Lighting Control Kit

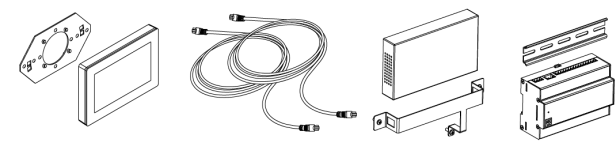

The Pharos Designer Lighting Control Kit, available for 1 or 2 DMX universes, allows for complete control of large lighting installations.

EXPERT - Pharos® Expert Control Kit

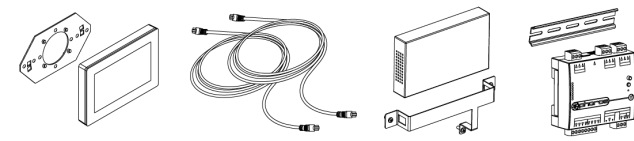

The Pharos Expert Control Kit, available for 1, 2, 4 or 6 DMX universes, allows for complete control of large lighting installations.



Diagnostic And Addressing Tools (Order Separately)

LID - LumenID

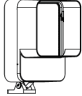

The updated LumenID (LID) is an all-in-one diagnostic and addressing solution for both DMX/RDM and Lumentalk (LT) systems. Engineered for versatility, it streamlines commissioning and troubleshooting across protocols—no need for multiple tools. Cable option may vary; please consult factory. For complete details, refer to the LID specification sheet.

EPA Guide

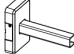
	FIXTURE			MOUNTING OPTIONS*			
	LQS	LQS with Snoot	LQS with Visor	WAM/WAMRJB			
							
				6	12	18	24
EPA Front (sq ft)	0.431	0.517	0.517	N/A	N/A	N/A	N/A
EPA Side (sq ft)	0.205	0.334	0.334	0.134	0.287	0.440	0.593
EPA Front 45° (sq ft)	0.409	0.592	0.592	N/A	N/A	N/A	N/A

\*Mounting arm only. Fixture EPA calculation must also be considered.

Typical Wiring Diagrams

Wiring Color Code

UL Color Code	USE
Green	Ground
Black	Line 120-277V AC
White	Line/Neutral
Red or Purple	0-10V / Data +
Orange	0-10V / Data -
Gray	Signal common (DMX/RDM only)

On/Off Control (NO)

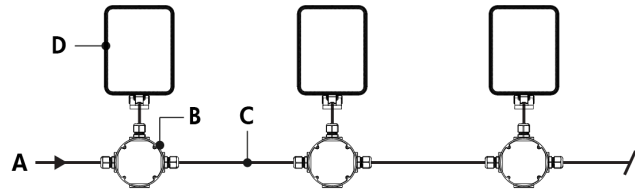

- A - Power input (120-277V, wiring by others)
- B - Junction box (by others)
- C - Power wiring (by others)
- D - Lumenquad Small

On/Off Control (NO) - Wiring Detail

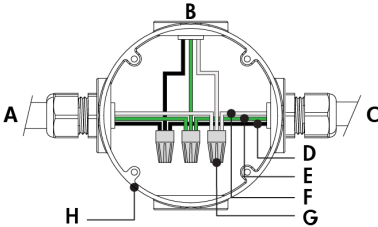

- A - Power input or from previous fixture
- B - To fixture
- C - To next fixture
- D - Line
- E - Ground
- F - Line/Neutral
- G - Wire-nuts (by others)
- H - Junction box (by others)

- Consult factory for specific applications and maximum fixture count/cable length recommendations. 14 watts per fixture.

Lumentalk (LT)

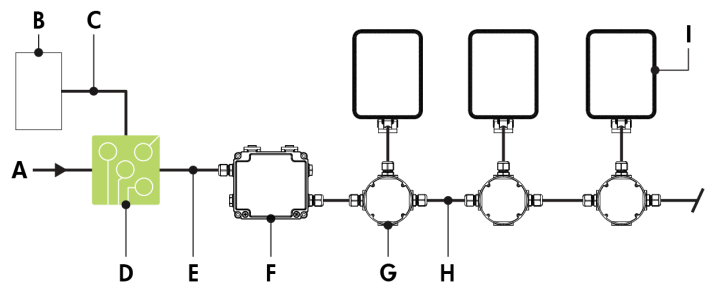

- A - Power input (120-277V AC, wiring by others)
- B - Dimmer/controller (order separately from Lumenpulse, or by others)
- C - Data wiring (by others)
- D - Lumentranslator 2 (LTL2-DIM, -DMX, -TRIAC, -DALI)
- E - Power wiring (by others)
- F - Lumentalk Data Bridge (LDB-DIM or LDB-DMX)
- G - Junction box (by others)
- H - Power and data wiring (by others)
- I - Lumenquad Small

Lumentalk (LT) - Wiring Detail Using LDB

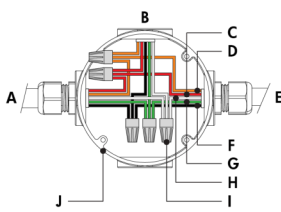

- A - From Lumentalk Data Bridge (control over power line via Lumentalk system) or from previous fixture
- B - To fixture
- C - 0-10 V + / Data +
- D - 0-10 V - / Data -
- E - To next fixture
- F - Line
- G - Ground
- H - Line/Neutral
- I - Wire-nut (by others)
- J - Junction box (by others)

- Consult factory for specific applications and maximum fixture count/cable length recommendations.
- Lumentalk Data Bridge required for Lumentalk system, see LDB installation instructions for details.
- For applications with all fixtures controlled as 1 zone: fixtures and Lumentalk Data Bridge must be specified as DIM. Maximum of 10 fixtures per LDB-DIM, consult factory for applications that require additional capabilities.
- For applications with fixtures controlled individually: fixtures and Lumentalk Data Bridge must be specified as DMX, 2-step commissioning process: 1 - DMX/RDM system using LumenID software and a LID, 2 - Lumentalk system using LumentalkID software and a LID. Maximum of 32 fixtures per LDB-DMX. Consult factory for details.
- For DMX applications: 1 DMX controller per Lumentalk network, maximum of 48 DMX channels per Lumentalk network (minimum step transition update rate is 1 second, minimum fade time between two colors is 1 minute). Consult factory for applications that require additional capabilities.
- Maximum of 1 transmitter (Lumentranslator or Lumenlink) per system.
- No third party fixtures allowed on the same circuit.
- Consult factory for DALI Lumentalk applications.
- 1% minimum dimming value.
- 14 watts per fixture.

0-10V Dimming (DIM)

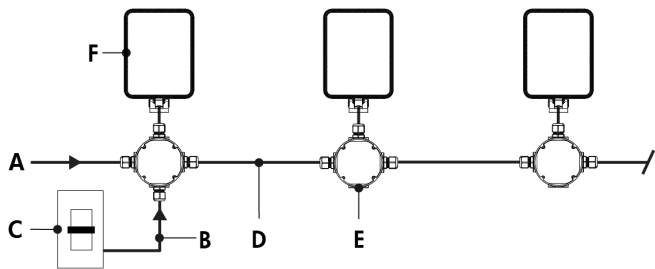

- A - Power input (120-277V, wiring by others)
- B - Data wiring (by others)
- C - Dimmer (by others)
- D - Power and data wiring (by others)
- E - Junction box (by others)
- F - Lumenquad Small

0-10V Dimming (DIM) - Wiring Detail

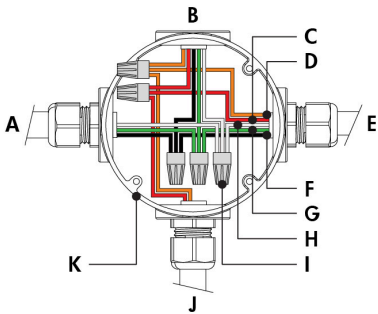

- A - Power input or from previous fixture
- B - To fixture
- C - 0-10 V +
- D - 0-10 V -
- E - To next fixture
- F - Line
- G - Ground
- H - Neutral
- I - Wire-nuts (by others)
- J - From dimmer (by others)
- K - Junction box (by others)

- Consult factory for specific applications and maximum fixture count/cable length recommendations.
- 0-10V mA ratings: passive dimmer (Current Sink): 3mA per fixture, active dimmer (Current Source): 0.5mA per fixture.
- 1% minimum dimming value. 14 watts per fixture.

DALI Dimming (DALI)

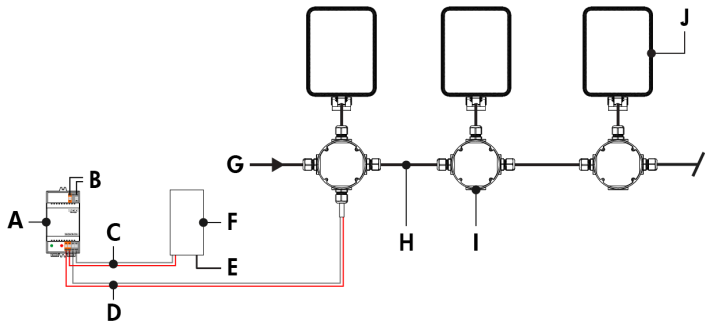

- A - DALI bus power supply (by others)
- B - Power input for DALI bus power supply (wiring by others)
- C - Data output to DALI controller (wiring by others)
- D - Data output to fixture (wiring by others)
- E - Power input for DALI controller (if required, wiring by others)
- F - DALI controller (by others)
- G - Power input (120-277V AC, wiring by others)
- H - Power and data wiring (by others)
- I - Junction box (by others)
- J - Lumenquad Small

DALI Dimming (DALI) - Wiring Detail

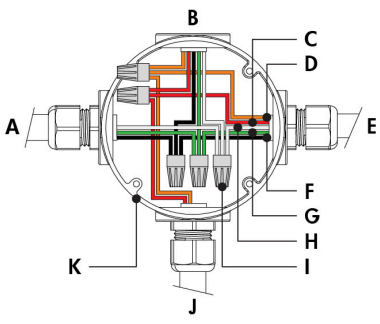

- A - Power input or from previous fixture
- B - To fixture
- C - DA +
- D - DA -
- E - To next fixture
- F - Line
- G - Ground
- H - Neutral
- I - Wire-nuts (by others)
- J - From DALI controller (by others)
- K - Junction box (by others)

- Consult factory for specific applications and maximum fixture count/cable length recommendations.
- Maximum of 64 DALI fixtures per DALI loop.
- Commissioning may be required based on the selection of 3rd party DALI controller. Controller and commissioning provided by others.
- 1% minimum dimming value.
- 14 watts per fixture.



Star Layout (DMX/RDM)

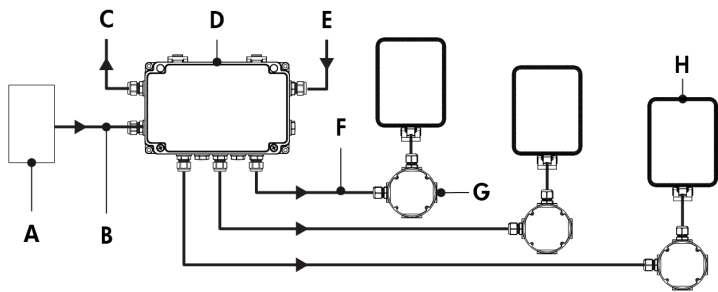

- A - DMX/RDM controller (order separately from Lumenpulse, or by others)
- B - Data input (Belden 9841 or equivalent, by others)
- C - Data output to next CBX (optional, not isolated/not boosted)
- D - CBX-ST
- E - Power input (120-277V, wiring by others)
- F - Power and data output to fixture (wiring by others)
- G - Junction box (by others)
- H - Lumenquad Small

Star Layout (DMX/RDM) - Wiring Detail

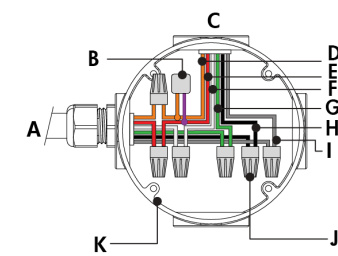

- A - From CBX or previous fixture
- B - Lumenterminator\*
- C - To fixture
- D - Data -
- E - Data +
- F - Neutral
- G - Ground
- H - Line
- I - Signal common
- J - Wire-nuts (by others)
- K - Junction box (by others)

Maximum Fixture Count

Maximum number of fixtures per run (Based on 15A maximum, 16AWG cable, fixtures spaced 10ft on center, first fixture 50ft from CBX)				
Configuration/Voltage	120V	208V	240V	277V
LQS	32	32	32	32

Based on 15A maximum, 16AWG cable, fixtures spaced 10 ft on center, first fixture 50 ft from CBX.

- Consult CBX installation instructions for additional wiring details.
- Consult factory for specific applications and maximum fixture count/cable length recommendations.
- The DMX/RDM protocol states a maximum of 32 DMX/RDM enabled fixtures on any single run.
- Maximum of 4 DMX/RDM repeaters/CBX cascading in line.
- Maximum of 6 outputs per CBX-ST.
- Each fixture requires 1 DMX address.
- DMX terminator is required at the end of each run to maintain data integrity. Six (6x) DMX lumenterminators included per CBX-ST. See installation instructions for details.
- 1% minimum dimming value.
- 14 watts per fixture.

Daisy Chain Layout (DMX/RDM)

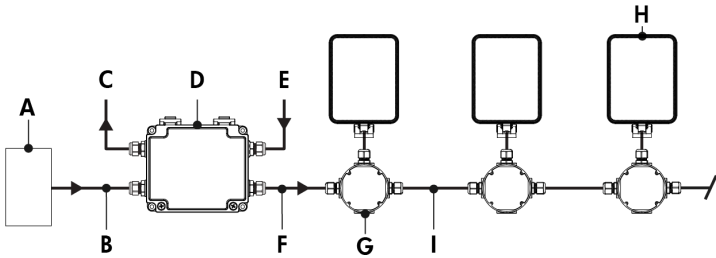

- A - DMX/RDM controller (order separately from Lumenpulse, or by others)
- B - Data input (Belden 9841 or equivalent, by others)
- C - Data output to next CBX (optional, not isolated/not boosted)
- D - CBX-DS
- E - Power input (120-277V, wiring by others)
- F - Power and data output to fixture (wiring by others)
- G - Junction box (by others)
- H - Lumenquad Small
- I - Power and data wiring (by others)

Daisy Chain Layout (DMX/RDM) - Wiring Detail (First or Middle of Run)

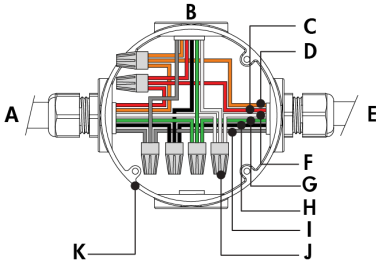

- A - From CBX or previous fixture
- B - To fixture
- C - Data -
- D - Data +
- E - To next fixture
- F - Neutral
- G - Line
- H - Ground
- I - Signal common
- J - Wire-nuts (by others)
- K - Junction box (by others)

Maximum Fixture Count

Maximum number of fixtures per run (Based on 15A maximum, 16AWG cable, fixtures spaced 10ft on center, first fixture 50ft from CBX)				
Configuration/Voltage	120V	208V	240V	277V
LQS	32	32	32	32

Daisy Chain Layout (DMX/RDM) - Wiring Detail (End of Run)

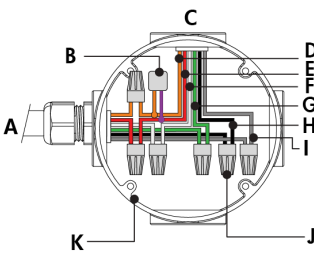

- A - From CBX or previous fixture
- B - Lumenterminator\*
- C - To fixture
- D - Data -
- E - Data +
- F - Neutral
- G - Ground
- H - Line
- I - Signal common
- J - Wire-nuts (by others)
- K - Junction box (by others)

Based on 15A maximum, 16AWG cable, fixtures spaced 10 ft on center, first fixture 50 ft from CBX.

- Consult CBX installation instructions for additional wiring details.
- Consult factory for specific applications and maximum fixture count/cable length recommendations.
- The DMX/RDM protocol states a maximum of 32 DMX/RDM enabled fixtures on any single run.
- Maximum of 4 DMX/RDM repeaters/CBX cascading in line.
- Maximum of 1 output per CBX-DS.
- Maximum of 3 ft cable length between fixture and next junction box for daisy chain layout.
- Each fixture requires 1 DMX address.
- DMX terminator is required at the end of each run to maintain data integrity. Two (2x) DMX lumenterminators included per CBX-DS. See installation instructions for details.
- 1% minimum dimming value.
- 14 watts per fixture.

How to Order

Housing	Voltage <sup>(2)</sup>	Color and Color Temperature <sup>(3)</sup>	Optic	Optical Option <sup>(8)</sup>	Mounting Options <sup>(10)</sup>
<b>LQS</b> Lumenquad Small <sup>(1)</sup>	<b>120</b> 120 Volts <b>208</b> 208 Volts <b>220</b> 220 Volts <b>240</b> 240 Volts <b>277</b> 277 Volts	<b>22K</b> 2200K <b>27K</b> 2700K <b>30K</b> 3000K <b>35K</b> 3500K <b>40K</b> 4000K <b>57K</b> 5700K <b>RD</b> Red <sup>(4)</sup> <sup>(5)</sup> <sup>(6)</sup> <b>GR</b> Green <sup>(4)</sup> <sup>(5)</sup> <sup>(6)</sup> <b>BL</b> Blue <sup>(4)</sup> <sup>(5)</sup> <sup>(6)</sup>	<b>XN</b> Extra Narrow 3° <sup>(7)</sup> <b>VN</b> Very Narrow 6° <sup>(7)</sup> <b>NS</b> Narrow Spot 10° <sup>(7)</sup> <b>NF</b> Narrow Flood 20° <sup>(7)</sup> <b>M</b> Medium 30° <sup>(7)</sup> <b>FL</b> Flood 40° <sup>(7)</sup> <b>WFL</b> Wide Flood 60° <sup>(7)</sup> <b>VWFL</b> Very Wide Flood 90° <sup>(7)</sup> <b>NAS</b> Narrow Asymmetric <sup>(7)</sup> <b>WW</b> Asymmetric Wallwash <sup>(7)</sup> <b>2</b> Type II <sup>(7)</sup> <b>2BLS</b> Type II Backlight Shield <sup>(7)</sup> <b>3</b> Type III <sup>(7)</sup> <b>3BLS</b> Type III Backlight Shield <sup>(7)</sup> <b>4</b> Type IV <sup>(7)</sup> <b>4BLS</b> Type IV Backlight Shield <sup>(7)</sup> <b>5S</b> Type VS <sup>(7)</sup>	<b>LSLH</b> Linear Spread Lens Horizontal Distribution <sup>(9)</sup> <b>LSLV</b> Linear Spread Lens Vertical Distribution <sup>(9)</sup> <b>HL</b> Honeycomb Louver <sup>(9)</sup>	<b>SM</b> Surface Mount <b>WM</b> Wall Mount Bracket with Decorative Cover <b>WMNC</b> Wall Mount Bracket without Decorative Cover <b>WAM6</b> Wall Arm Mount 6 in with Decorative Cover <b>WAM6NC</b> Wall Arm Mount 6 in without Decorative Cover <b>WAM12</b> Wall Arm Mount 12 in with Decorative Cover <b>WAM12NC</b> Wall Arm Mount 12 in without Decorative Cover <b>WAM18</b> Wall Arm Mount 18 in with Decorative Cover <b>WAM18NC</b> Wall Arm Mount 18 in without Decorative Cover <b>WAM24</b> Wall Arm Mount 24 in with Decorative Cover <sup>(11)</sup> <b>WAM24NC</b> Wall Arm Mount 24 in without Decorative Cover <sup>(11)</sup> <b>WAMRJB</b> Recessed JBOX Wall Mount with Decorative Cover <b>WAMRJBNC</b> Recessed JBOX Wall Mount without Decorative Cover <b>WAMRJB6</b> Recessed JBOX Wall Arm Mount 6 in with Decorative Cover <b>WAMRJB6NC</b> Recessed JBOX Wall Arm Mount 6 in without Decorative Cover <b>WAMRJB12</b> Recessed JBOX Wall Arm Mount 12 in with Decorative Cover <b>WAMRJB12NC</b> Recessed JBOX Wall Arm Mount 12 in without Decorative Cover <b>WAMRJB18</b> Recessed JBOX Wall Arm Mount 18 in with Decorative Cover <b>WAMRJB18NC</b> Recessed JBOX Wall Arm Mount 18 in without Decorative Cover <b>WAMRJB24</b> Recessed JBOX Wall Arm Mount 24 in with Decorative Cover <b>WAMRJB24NC</b> Recessed JBOX Wall Arm Mount 24 in without Decorative Cover <b>RPM4/1</b> Round Pole Mount 4 in <b>RPM4.5/1</b> Round Pole Mount 4.5 in <b>RPM5/1</b> Round Pole Mount 5 in <b>RPM4/2</b> Round Pole Mount 4 in for two fixtures <b>RPM4.5/2</b> Round Pole Mount 4.5 in for two fixtures <b>RPM5/2</b> Round Pole Mount 5 in for two fixtures <b>PLTU</b> Lumentech Pole Mount <sup>(12)</sup> <b>TN2</b> Tenon Adapter for 2 3/8 in O.D. Pole <b>TN4</b> Tenon Adapter for 4 in O.D. Pole

					<div><div>SK</div><div>Stake Mount</div><div>STM</div><div>Stud mount <sup>(13)</sup></div></div>
--	--	--	--	--	---

Notes:

1. Consult factory for products that are BAA-approved (Buy American Act).

2. Consult factory for 100 volts.

3. Consult factory for availability of static Royal Blue, 6500K and 90+ CRI.

4. Not available for XN optic.

5. Consult factory for availability with type 2, 2BLS, 3, 3BLS, 4, 4BLS and 5S distributions.

6. Static colors made to order 8-10 weeks.

7. Factory installed, not interchangeable on site.

8. Optical options are factory installed and cannot be changed in the field.
9. Not available for WFL, VWFL, NAS, WW, 2, 2BLS, 3, 3BLS, 4, 4BLS and 5S optics.

10. All mounting options (except for SM mounting) are interchangeable. Consult factory for details.

11. A cable length of 10 ft or greater must be specified.

12. Available for Lumentech poles with a square or round profile. A PLTU - Universal Yoke accessory must be ordered with the Lumentech pole for the Lumentech to fit with the PLTU mounting option. Refer to Lumentech specification sheet and installation instructions for more details.

13. For thru-wall mounting.

How to Order

Finish	Control <sup>(17)</sup> <sup>(18)</sup>	Option	Certification	Cable Length <sup>(20)</sup> <sup>(24)</sup> <sup>(26)</sup>
<b>BK</b> Black Sandtex®	<b>NO</b> On/Off Control	<b>CRC</b> Corrosion-Resistant Coating <sup>(21)</sup> <sup>(22)</sup>	<b>UL</b> UL Compliant	<b>3FT</b> 3 ft <sup>(20)</sup> <sup>(25)</sup>
<b>BRZ</b> Bronze Sandtex®	<b>DIM</b> 0-10V Dimming		<b>CE</b> CE Compliant <sup>(23)</sup>	<b>10FT</b> 10 ft
<b>SI</b> Silver Sandtex®	<b>DALI</b> DALI Dimming			<b>20FT</b> 20 ft
<b>WH</b> Smooth White	<b>DMX/RDM</b> DMX/RDM Enabled <sup>(19)</sup> <sup>(20)</sup>			<b>30FT</b> 30 ft
<b>BKTX</b> Textured Black				<b>50FT</b> 50 ft
<b>BRZTX</b> Textured Bronze Non-Metallic				<b>70FT</b> 70 ft
<b>GRATX</b> Textured Medium Gray				<b>100FT</b> 100 ft
<b>GRNTX</b> Textured Green				
<b>WHTX</b> Textured White				
<b>CC</b> Custom Color & Finish <sup>(14)</sup> <sup>(15)</sup> <sup>(16)</sup>				

Notes:

- 14.** Lumenpulse offers a wide selection of RAL CLASSIC (K7) colors with a smooth texture and high-gloss finish. Please consult factory for a list of available K7 colors, other RAL textures and glosses, or to match alternate color charts. Final color matching results may vary.

**15.** Longer lead times can be expected for custom RAL color finishes.

**16.** Setup charges apply for RAL colors. Consult factory for details.

**17.** Lumentalk system is enabled with LDB accessory. DIM or DMX/RDM must be specified in the order code. See the typical wiring diagrams in the specification sheet for details.

**18.** A Lumentranslator 2 (LTL2) and LumenID (LID) must be specified for Lumentalk applications. Consult Lumentranslator 2 and Lumentalk pages and specification sheets for details.

**19.** A control box (CBX) and LumenID (LID) must be specified.
- 20.** Maximum of 3 ft cable length for daisy chain DMX applications with CBX-DS.

**21.** Use only when exposed to salt spray. This option is not required for normal outdoor exposure.

**22.** Setup charges apply. Consult factory for details.

**23.** Consult European specification sheet and installation instructions for CE wiring information.

**24.** Not applicable to WMRJB, WMRJBNC and WAMRJB 6 in to 24 in mounting options (with or without decorative cover). Cable lengths for these mounting options are determined by the length of the mounting bracket.

**25.** Not available with WAM24 or WAM24NC mounting options.

**26.** UL fixtures specified with a Smooth white finish and a SM, WM, WMNC, or WAM 6 in to 24 in mounting option (with or without decorative cover) are provided with a white cable. A black cable is provided for all other fixture configurations.