

Project Name

Qty

Type

Catalog / Part Number

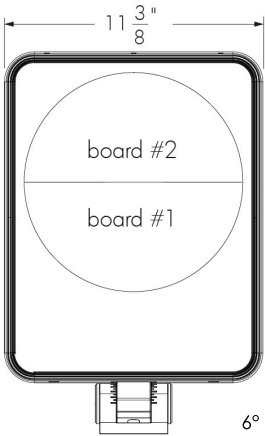

Front View  
6° Increment Pivot

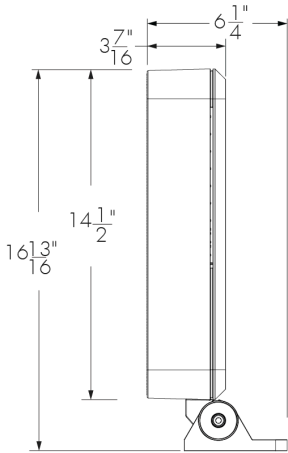

Side View

Photometric Summary

Symmetric

	Delivered output (lm)	Intensity (peak cd)
XN (3°)	8,357	1,032,800
VN (6°)	7,825	562,416
NS (10°)	7,882	304,148
NF (20°)	12,483	129,569
M (30°)	11,447	48,334
FL (40°)	10,500	23,266
WFL (60°)	9,537	8,410
VWFL (90°)	9,065	4,208

Asymmetric

	Delivered output (lm)	Intensity (peak cd)
NAS	6,556	108,502 (@2.5°)
WW	9,951	25,111 (@5°)

Roadway

	Delivered output (lm)	BUG rating
2-Type II	10,177	B:2 U:0 G:2
3-Type III	10,568	B:2 U:0 G:2
4-Type IV	9,321	B:2 U:0 G:2
5S-Type VS	10,184	B:3 U:0 G:2

1. Based on 4000K.  
2. Photometric performance is measured in compliance with IESNA LM-79-24.  
3. Refer to IES files for photometric information on distributions with backlight shield options (2BLS, 3BLS and 4BLS).  
4. Refer to the [Lumenquad White and Static Colors Photometric Guide](#) on Lumenpulse website for information on other color temperatures.

Description

The Lumenquad Grande, 100W LED luminaire, has a sleek 3 7/16 in profile with no visible wiring or hardware and seamlessly integrates with any architecture. Lumenpulse's latest generation of LED boards possess an optimized candela and lumens recipe for both Narrow and Wide optics. The Lumenquad Grande is the epitome of versatility and can be configured with numerous options including optics for wallwash, floodlighting, or street lighting, a choice of color temperatures and colors, as well as various mounting options, accessories, controls, and multiple standard finishes.

Features

Color and Color Temperature

**22K:** 2200K, **27K:** 2700K, **30K:** 3000K, **35K:** 3500K, **40K:** 4000K, **57K:** 5700K, **RD:** Red, **GR:** Green, **BL:** Blue

Optics (Nominal Distribution)

**XN:** XN (3°), **VN:** VN (6°), **NS:** NS (10°), **NF:** NF (20°), **M:** M (30°), **FL:** FL (40°), **WFL:** WFL (60°), **VWFL:** VWFL (90°), **NAS:** NAS (Narrow Asymmetric), **WW:** WW (Asymmetric Wallwash), **2:** Type II, **2BLS:** Type II Backlight Shield, **3:** Type III, **3BLS:** Type III Backlight Shield, **4:** Type IV, **4BLS:** Type IV Backlight Shield, **5S:** Type VS

Mounting Options

**SM:** Surface Mount, **WM:** Wall Mount Bracket with Decorative Cover, **WMNC:** Wall Mount Bracket without Decorative Cover, **RJBOX:** Recessed JBOX Wall Mount with Decorative Cover, **RJBOXNC:** Recessed JBOX Wall Mount Without Decorative Cover, **PM:** Pole Mount, **TN:** Tenon Mount, **SK:** Stake Mount, **NOTE:** All mounting options have a pivot adjustable in 6° increments, consult factory for universal pivot option.

Optical Options (Factory Installed)

**LSLH:** Linear Spread Lens Horizontal Distribution, **LSLV:** Linear Spread Lens Vertical Distribution, **HL:** Honeycomb Louver

Option

**CRC:** Corrosion-Resistant Coating for Hostile Environments

Power Consumption

100 W

Warranty

5-year limited warranty

Optic

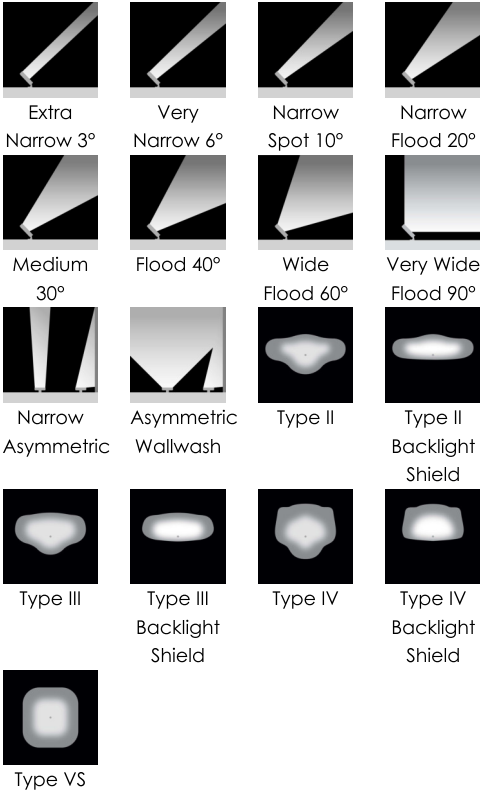

Color and Color Temperature

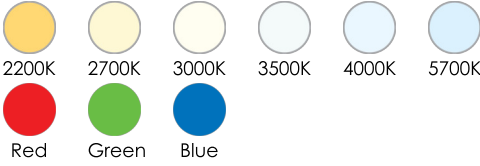

Control



Ratings



Certifications



Performance

Maximum Delivered Output	12,483 lm (4000K, NF 20°)
Maximum Delivered Intensity	1,032,800 cd at nadir (4000K, XN 3°)
Illuminance at Distance	Minimum 1 fc at 1020 ft (4000K, XN 3°)
Color Consistency	3 SDCM
Color Rendering	CRI 80+
Lumen Maintenance	L70 > 250,000 hrs (Ta 25 °C) (> 80,000 hrs for XN 3°, VN 6°, NAS optics only)

Physical

Housing Material	Low copper content high pressure die-cast aluminum
Lens Material	Clear tempered glass
Hardware Material	Stainless steel
Gasket Material	Silicone
Surface Finish	Electrostatically applied polyester powder coat
Weight	23 lbs
EPA	Front = 1.34 ft², Side = 0.35 ft², Front 45° = 1.23 ft²

Electrical and Control

Voltage	100 to 277 volts
Fixture Cable	Power and data in one cable
Conductors	3C #16-3 (NO, LT control) 5C #16-5 (DIM, DALI, ES control) 6C #14-3/ #24-3 (DMX/RDM control)
Control	On/Off Control, Lumentalk, 0-10V Dimming, DALI Dimming, DMX/RDM Enabled
Resolution (DMX/RDM)	Per fixture, 8-bit or 16-bit

Environmental

Storage Temperature	-40 °F to 185 °F (device must reach start-up temperature value before operating)
Start-up Temperature	-13 °F to 122 °F
Operating Temperature	-40 °F to 122 °F
Ingress Protection Rating	IP66 Wet location rated
Impact Resistance Rating	IK10
Application Wind Speed	Luminaires were designed based on AASHTO 2013 standard to ensure highest quality and safety. Installation should be validated by a local project engineer to ensure the luminaires are suitable for the wind speed and exposure of the specific application

Accessories (Order Separately)

Optical Accessories	Visor, Snoot, Linear Spread Lens Adjustable, Wire Guard
---------------------	---

Control Boxes	DMX/RDM enabled (Daisy Chain or Star Configuration), Ethernet enabled (Daisy Chain or Star Configuration)
Control Systems	Pharos® Designer Lighting Control Kit (PHAROS), Pharos® Expert Control Kit (EXPERT)
Diagnostic and Addressing Tools	LumenID (LID)

Important

Virtual Patent Marking Notice

This website (<https://www.lmpg.com/patents-trademarks>) is provided to satisfy the virtual patent marking provisions of applicable jurisdictions. Some products listed may be covered by additional patents not referenced here.

Chromaticity Data

TM-30 - 4000K

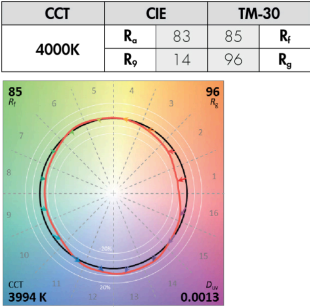

Spectral Power Distribution

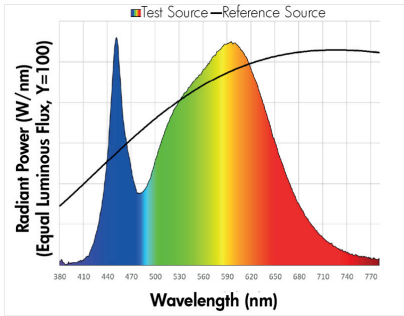

Mounting Options

SM - Surface Mount

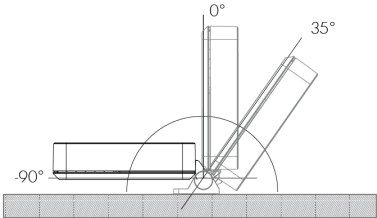

SM - Mounting Hole Pattern

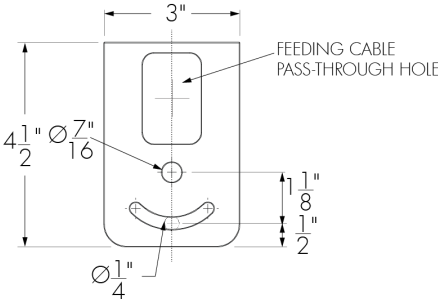

The SM mounting option cannot be interchanged with any other mounting option. All others mountings are interchangeable. Consult factory for details.

WM - Wall Mount Bracket with Decorative Cover

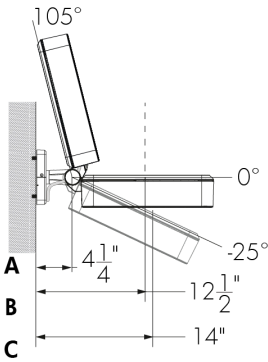

WMNC - Wall Mount Bracket Without Decorative Cover

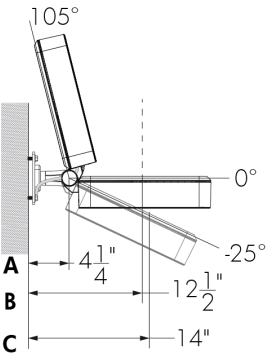

- A - Dimension from wall to pivot.
- B - Dimension from wall to the geometric center of the fixture.
- C - Dimension from wall to the center of the board.

WAM - Wall Mount Bracket With Decorative Cover  
6 in, 12 in, 18 in or 24 in

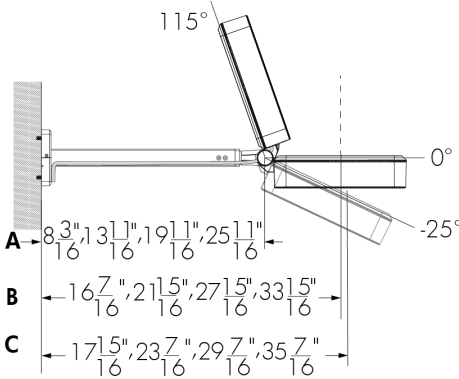

WAMNC - Wall Mount Bracket Without Decorative Cover  
Cover 6 in, 12 in, 18 in or 24 in

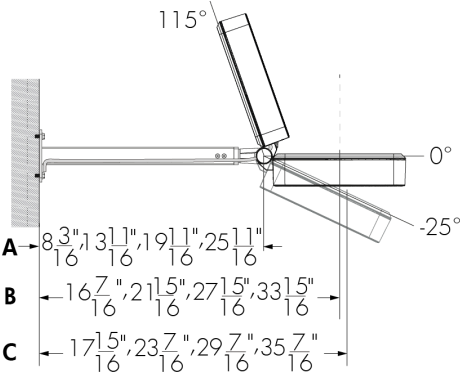

A cable length of 10 ft or greater must be specified for the WAM24 mounting option.

A cable length of 10 ft or greater must be specified for the WAM24 mounting option.

WMRJB - Recessed JBOX Wall Mount With Decorative Cover

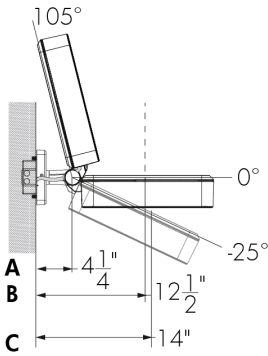

WMRJBNC - Recessed JBOX Wall Mount Without Decorative Cover

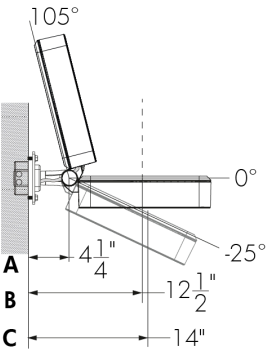

Fixture cable length is determined by Lumenpulse.

Fixture cable length is determined by Lumenpulse.

WAMRJB - Recessed JBOX Wall Arm Mount With  
Decorative Cover 6 in, 12 in, 18 in or 24 in

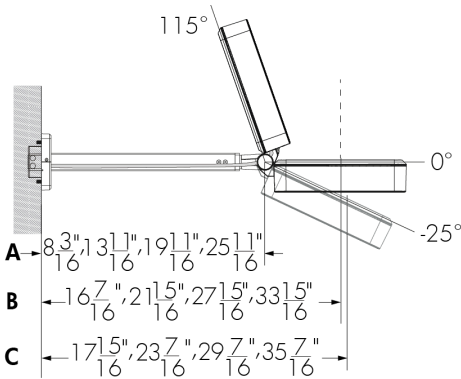

Fixture cable length is determined by Lumenpulse.

Wall Mount Horizontal Pivot Limits

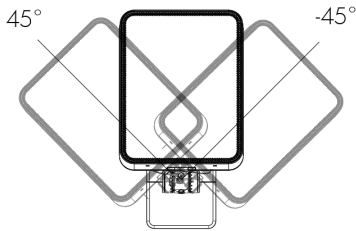

WAMRJBNC - Recessed JBOX Wall Arm Mount  
Without Decorative Cover 6 in, 12 in, 18 in or 24 in

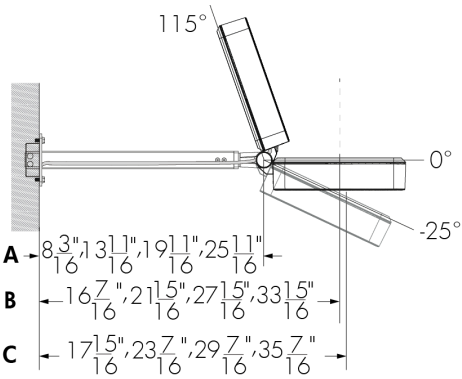

Fixture cable length is determined by Lumenpulse.

WM, WAM, WMRJB and WAMRJB - Mounting Hole  
Pattern

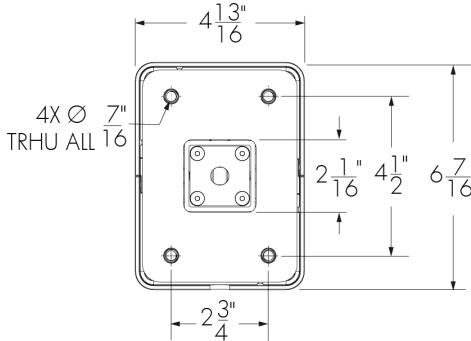

**A** - Dimension from wall to pivot.

**B** - Dimension from wall to the geometric center of the fixture.

**C** - Dimension from wall to the center of the board.

WMNC, WAMNC, WMRJBNC and WAMRJBNC -  
Mounting Hole Pattern

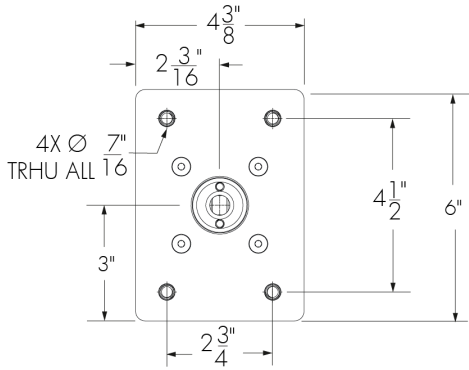

RPM4/1, RPM4.5/1, RPM5/1 - Round Pole Mount

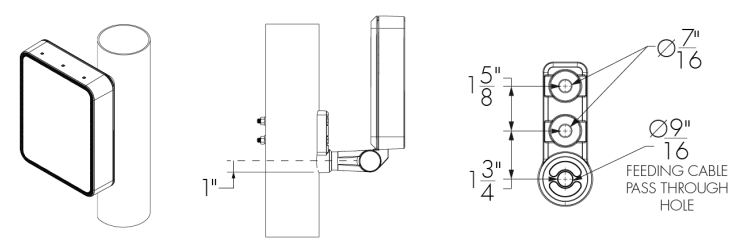

	RPM4/1	RPM4.5/1	RPM5/1
For pole Ø	4" ± 1/16	4.5" ± 1/16	5" ± 1/16
Bolt length	5 1/4	5 3/4	6 1/4

Consult factory for other pole diameters.  
Hardware included with accessory.

Round Pole Mount Horizontal Pivot Limits

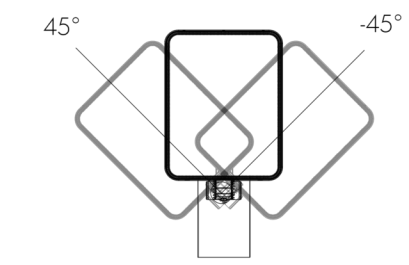

PLTU - Universal Yoke

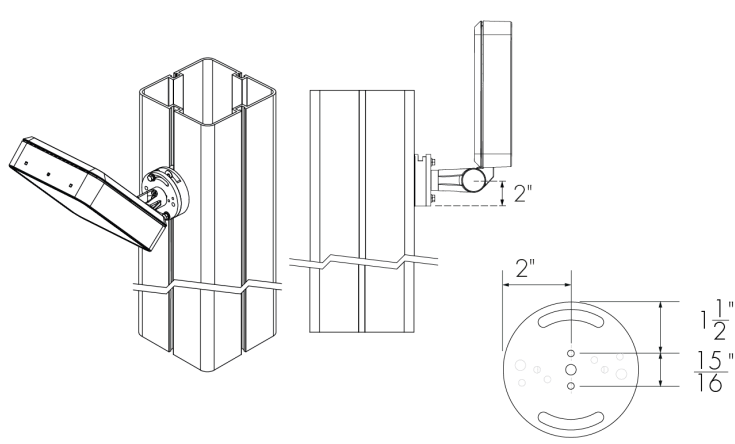

Refer to the Universal Yoke specification sheet and Pole installation instructions for more details. Square Lumentech profile shown.

All mounting options (except for SM mounting) are interchangeable. Consult factory for details.  
All mounting options have a pivot adjustable in 6° increments, consult factory for universal pivot option.

RPM4/2, RPM4.5/2, RPM5/2 - Round Pole Mount For Two Fixtures

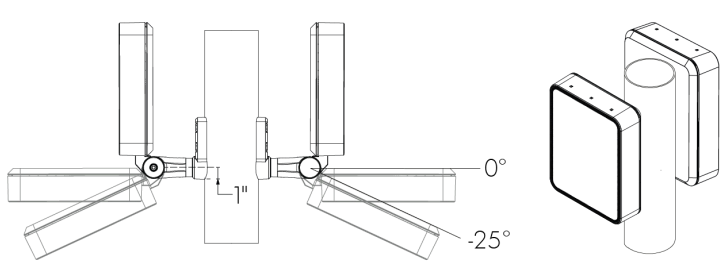

	RPM4/2	RPM4.5/2	RPM5/2
For pole Ø	4" ± 1/16	4.5" ± 1/16	5" ± 1/16
Bolt length	5 3/4	6 1/4	7"

Consult factory for other pole diameters.  
Hardware included with accessory.

TN2 - Tenon Adapter For 2 3/8 in O.D. Pole

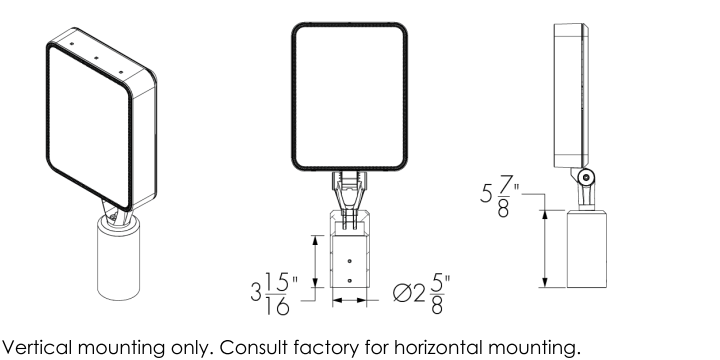

Vertical mounting only. Consult factory for horizontal mounting.

TN4 - Tenon Adapter For 4 in O.D. Pole

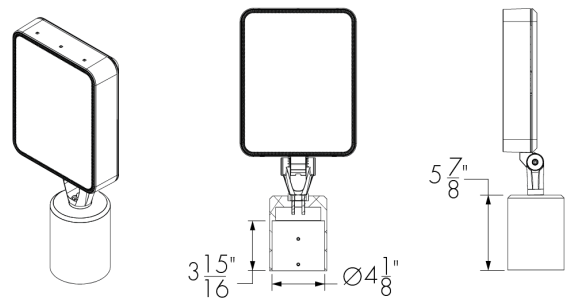

Vertical mounting only. Consult factory for horizontal mounting.

SK - Stake Mount

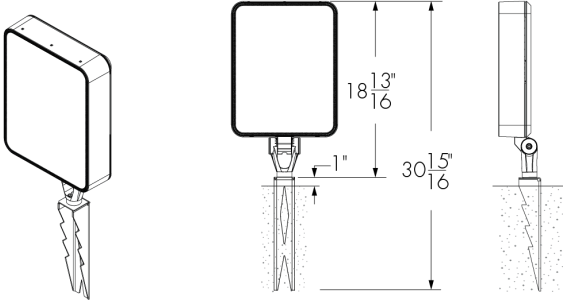

All mounting options (except for SM mounting) are interchangeable. Consult factory for details.  
All mounting options have a pivot adjustable in 6° increments, consult factory for universal pivot option.

Optical Options

- LSLH - Linear Spread Lens Horizontal Distribution
- LSLV - Linear Spread Lens Vertical Distribution

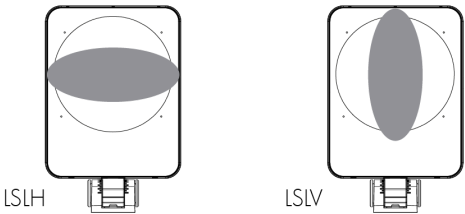

Factory installed, not adjustable on site. Not available for WFL, VWFL, NAS, WW, 2, 2BLS, 3, 3BLS, 4, 4BLS and 5S optics.

See 'Optical Accessories' section for field adjustable spread lens (LSLA).

	Beam angle with LSLH/LSLV
XN	5° x 60°
VN	7° x 60°
NS	9° x 60°
NF	16° x 65°
M	25° x 66°
FL	35° x 70°

LLF: 0.88\*  
\*LLF may vary slightly by distribution chosen.

HL - Honeycomb Louver

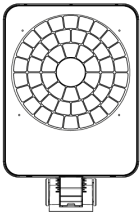

Factory installed, not adjustable on site. HL not available for WFL, VWFL, NAS, WW, 2, 2BLS, 3, 3BLS, 4, 4BLS and 5S optics.

The addition of a honeycomb louver will affect beam distribution. Consult factory for application support.

LLF: 0.90\*  
\*LLF may vary slightly by distribution chosen.

Optical Accessories (Factory Installed, Order Separately)

Installed optical accessories will affect the maximum pivot limits for each mounting option, consult factory for details.

SN - Snoot

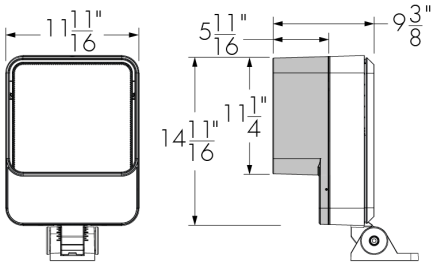

LQGSN-FINISH-BK-OPTIONS (CRC)  
Interior surface painted black. Please specify the exterior **FINISH** from the list of finishes in the fixture order code.

VS - Visor

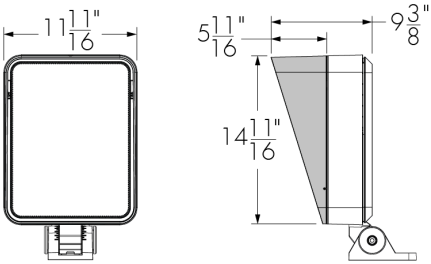

LQGVVS-FINISH-BK-OPTIONS (CRC)  
Interior surface painted black. Please specify the exterior **FINISH** from the list of finishes in the fixture order code.

The Visor is not recommended for the WW optic.

LSLA - Linear Spread Lens Adjustable

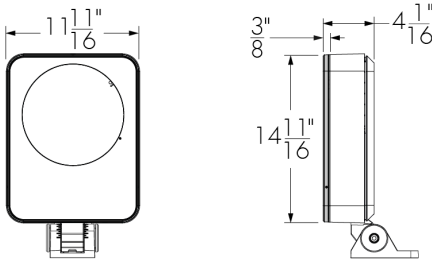

LQGLSLA-FINISH-OPTIONS (CRC)  
Please specify the exterior **FINISH** from the list of finishes in the fixture order code.

WG - Wire Guard

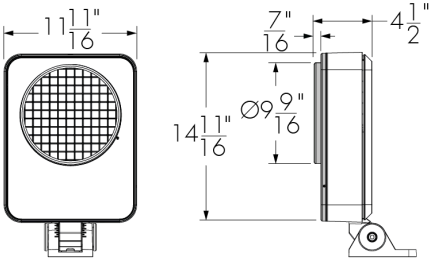

LQGWG-FINISH-OPTIONS (CRC)  
Please specify the exterior **FINISH** from the list of finishes in the fixture order code.

Accessory Combinations

	+	Snoot	Visor	Wire guard
Linear spread lens adjustable		YES	YES	NO
Wire guard		YES	YES	N/A

Accessory combinations must be ordered together on a single line. Ex: A snoot + wire guard combination order code is LQGSNWG-BK-BK. A maximum of two accessories can be combined per fixture.



Diffuser Lenses (Intended for Mockup Purposes Only, Order Separately)

Diffuser Lens 1 (1 Notch)

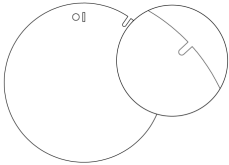

147713

Diffuser Lens 2 (2 Notches)

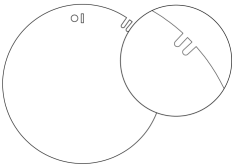

147714

Diffuser Lens 3 (3 Notches)

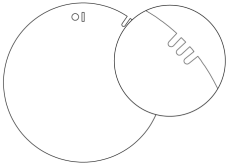

147715

Diffuser Lens 4 (4 Notches)

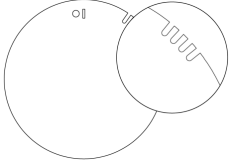

147716

Diffuser Lens 5 (5 Notches)

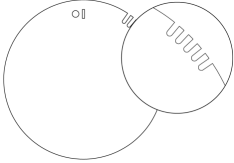

147717

Diffuser Lens 6 (6 Notches)

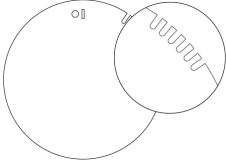

147718

Final Distribution Using Diffuser Lenses

	Final Distribution Using Diffuser Lens					
Original Distribution on Fixture	Diffuser Lens 1 1 Notch	Diffuser Lens 2 2 Notches	Diffuser Lens 3 3 Notches	Diffuser Lens 4 4 Notches	Diffuser Lens 5 5 Notches	Diffuser Lens 6 6 Notches
XN (4°/5°)	VN	NS	NF	M	FL	WFL
VN (6°)	NS					
NS (10°)						
NF (20°)						
M (30°)			FL	WFL		
FL (40°)						
WFL (60°)				VWFL		
VWFL (90°)						

Choose a diffuser lens based on the desired final beam distribution. Refer to the 6-digit part numbers above to order diffuser lenses individually. To order a complete set of 6 diffuser lenses in a bag, refer to the following item names: **LQS**: LQALK-S **LQM**: LQALK-M **LQL**: LQALK-L **LQG**: LQALK-G

The diffuser lenses are intended for mockup purposes only. A lens holder is required to install a diffuser lens on the fixture, order separately using the following names: **LQS**: LQSLSLA-FINISH-LQALK **LQM**: LQMLSLA-FINISH-LQALK **LQL**: LQLLSLA-FINISH-LQALK **LQG**: LQGSLA-FINISH-LQALK

Please specify the exterior **FINISH** from the list of finishes in the fixture order code.  
Refer to the Diffuser Lens Installation Instructions on the Lumenpulse website for information on installing the diffuser lenses.

Control Boxes (Order Separately)

CBX-DMX/RDM - DMX/RDM Enabled (Daisy Chain or Star Configuration)

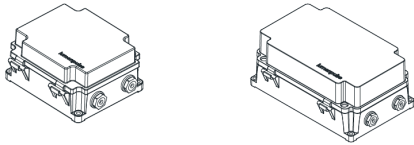

DMX/RDM control box. Up to six power and data outputs to fixtures or fixture runs. Consult CBX specification sheet and installation instructions for details. Lumenterminators provided with CBX (2x for Daisy Chain configuration, 6x for Star configuration), consult factory to order spares.

CBX-ENET - Ethernet Enabled (Daisy Chain or Star Configuration)

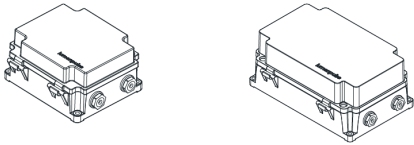

Ethernet control box. Up to four power and data outputs to fixture or fixture runs. Consult Ethernet CBX specification sheet and installation instructions for details.

Control Systems (Order Separately)

PHAROS - Pharos® Designer Lighting Control Kit

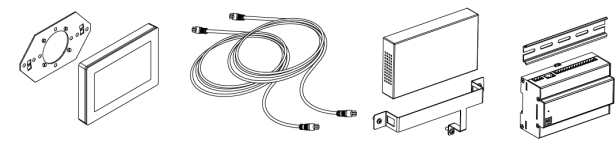

The Pharos Designer Lighting Control Kit, available for 1 or 2 DMX universes, allows for complete control of large lighting installations.

EXPERT - Pharos® Expert Control Kit



The Pharos Expert Control Kit, available for 1, 2, 4 or 6 DMX universes, allows for complete control of large lighting installations.



Diagnostic And Addressing Tools (Order Separately)

LID - LumenID

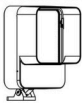

The updated LumenID (LID) is an all-in-one diagnostic and addressing solution for both DMX/RDM and Lumentalk (LT) systems. Engineered for versatility, it streamlines commissioning and troubleshooting across protocols—no need for multiple tools. Cable option may vary; please consult factory. For complete details, refer to the LID specification sheet.

EPA Guide

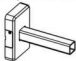
	FIXTURE			MOUNTING OPTIONS*			
	LQG	LQG with Snoot	LQG with Visor	WAM/WAMRJB			
							
EPA Front (sq ft)	1.336	1.585	1.585	N/A	N/A	N/A	N/A
EPA Side (sq ft)	0.346	1.016	1.016	0.134	0.287	0.440	0.593
EPA Front 45° (sq ft)	1.233	2.06	2.06	N/A	N/A	N/A	N/A

Typical Wiring Diagrams

Wiring Color Code

UL Color Code	USE
Green	Ground
Black	Line 100-277V AC
White	Line/Neutral
Red or Purple	0-10V / Data +
Orange	0-10V / Data -
Gray	Signal common (DMX/RDM only)

On/Off Control (NO)

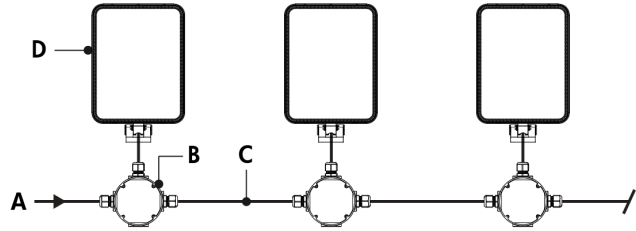

- A - Power input (100-277V, wiring by others)
- B - Junction box (by others)
- C - Power wiring (by others)
- D - Lumenquad Grande

On/Off Control (NO) - Wiring Detail

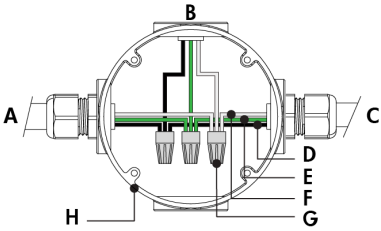

- A - Power input or from previous fixture
- B - To fixture
- C - To next fixture
- D - Line
- E - Ground
- F - Line/Neutral
- G - Wire-nuts (by others)
- H - Junction box (by others)

- Consult factory for specific applications and maximum fixture count/cable length recommendations. 100 watts per fixture.

Lumentalk (LT)

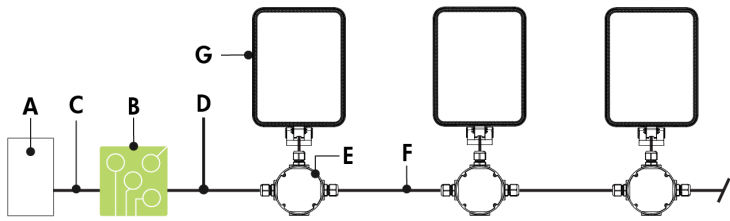

- A** - Dimmer/controller (order separately from Lumenpulse, or by others)
- B** - Lumentranslator 2 (LTL2-DIM, -DMX, -TRIAC, -DALI)
- C** - Data wiring (by others)
- D** - Power line (100-277V, wiring by others)
- E** - Junction box (by others)
- F** - Power wiring (by others)
- G** - Lumenquad Grande

Lumentalk (LT) - Wiring Detail

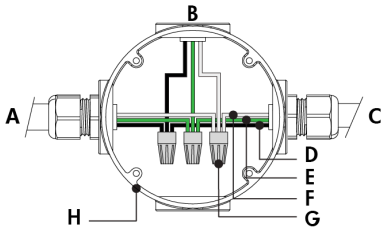

- A** - Power input (control over power line via Lumentalk system) or from previous fixture
- B** - To fixture
- C** - To next fixture
- D** - Line
- E** - Ground
- F** - Line/Neutral
- G** - Wire-nuts (by others)
- H** - Junction box (by others)

- Consult factory for specific applications and maximum fixture count/cable length recommendations.
- Lumentalk enabled fixtures must be commissioned using LumentalkID software and a LID. Consult factory for details.
- Maximum of 1 transmitter (Lumentranslator or Lumenlink) per system. No third party fixtures allowed on the same circuit.
- For DMX applications: 1 DMX controller per Lumentalk network, maximum of 48 DMX channels per Lumentalk network (minimum step transition update rate is 1 second, minimum fade time between two colors is 1 minute). Consult factory for applications that require additional capabilities.
- Consult factory for DALI Lumentalk applications.
- 1% minimum dimming value. 100 watts per fixture.

0-10V Dimming (DIM)

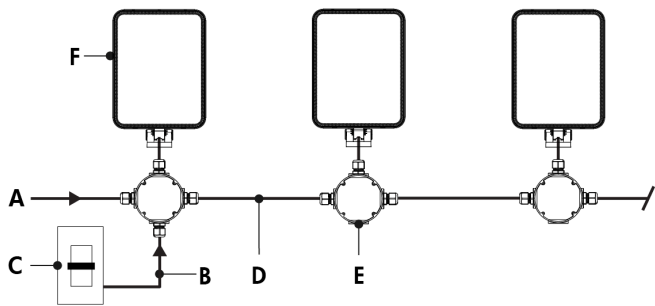

- A - Power input (100-277V, wiring by others)
- B - Data wiring (by others)
- C - Dimmer (by others)
- D - Power and data wiring (by others)
- E - Junction box (by others)
- F - Lumenquad Grande

0-10V Dimming (DIM) - Wiring Detail

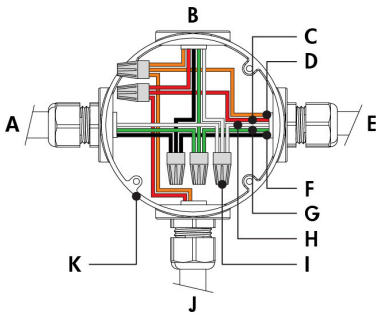

- A - Power input or from previous fixture
- B - To fixture
- C - 0-10 V +
- D - 0-10 V -
- E - To next fixture
- F - Line
- G - Ground
- H - Neutral
- I - Wire-nuts (by others)
- J - From dimmer (by others)
- K - Junction box (by others)

- Consult factory for specific applications and maximum fixture count/cable length recommendations.
- 0-10V mA ratings: passive dimmer (Current Sink): 3mA per fixture, active dimmer (Current Source): 0.5mA per fixture.
- 1% minimum dimming value. 100 watts per fixture.

DALI Dimming (DALI)

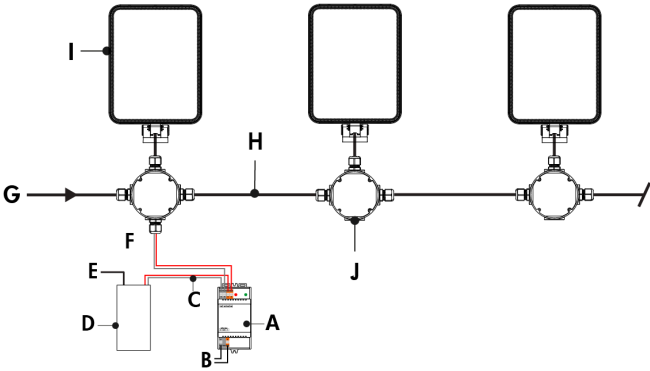

- A - DALI bus power supply
- B - Power input for DALI bus power supply (wiring by others)
- C - Data output to DALI controller (by others)
- D - DALI controller (by others)
- E - Power input for DALI controller (if required, wiring by others)
- F - Data output to fixture
- G - Power input (100-277V)
- H - Power and data wiring (by others)
- I - Junction box (by others)
- J - Lumenquad Grande

DALI Dimming (DALI) - Wiring Detail

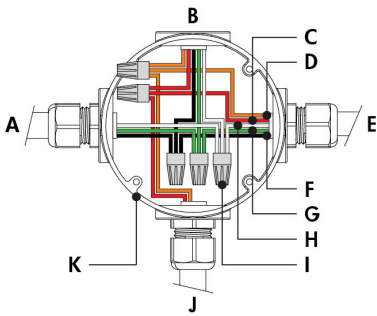

- A - Power input or from previous fixture
- B - To fixture
- C - DA +
- D - DA -
- E - To next fixture
- F - Line
- G - Ground
- H - Neutral
- I - Wire-nuts (by others)
- J - From DALI controller (by others)
- K - Junction box (by others)

- Consult factory for specific applications and maximum fixture count/cable length recommendations.
- Maximum of 64 DALI fixtures per DALI loop.
- 1% minimum dimming value. 100 watts per fixture.

Star Layout (DMX/RDM)

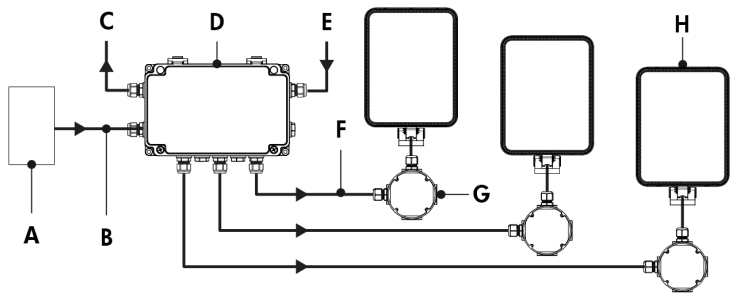

- A - DMX/RDM controller (order separately from Lumenpulse, or by others)
- B - Data input (Belden 9841 or equivalent, by others)
- C - Data output to next CBX (optional, not isolated/not boosted)
- D - CBX-ST
- E - Power input (100-277V, wiring by others)
- F - Power and data output to fixture (wiring by others)
- G - Junction box (by others)
- H - Lumenquad Grande

Star Layout (DMX/RDM) - Wiring Detail

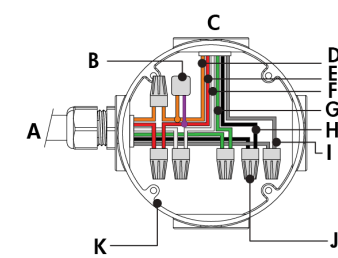

- A - From CBX or previous fixture
- B - Lumenterminator\*
- C - To fixture
- D - Data -
- E - Data +
- F - Neutral
- G - Ground
- H - Line
- I - Signal common
- J - Wire-nuts (by others)
- K - Junction box (by others)

Maximum Fixture Count

Maximum number of fixtures per run (Based on 15A maximum, 16AWG cable, fixtures spaced 10ft on center, first fixture 50ft from CBX)				
Configuration/Voltage	120V	208V	240V	277V
LQG	10	16	18	21

- Refer to CBX installation instructions for additional wiring details.
- Consult factory for specific applications and maximum fixture count/cable length recommendations.
- The DMX/RDM protocol states a maximum of 32 DMX/RDM enabled fixtures on any single run.
- Maximum of 4 DMX/RDM repeaters/CBX cascading in line.
- Maximum of 6 outputs per CBX-ST.
- Each fixture requires 1 DMX address.
- 1% minimum dimming value.
- 100 watts per fixture.

\*DMX terminator is required at the end of each run to maintain data integrity. (6x) DMX lumenterminators included per CBX-ST. See installation instructions for details.

Daisy Chain Layout (DMX/RDM)

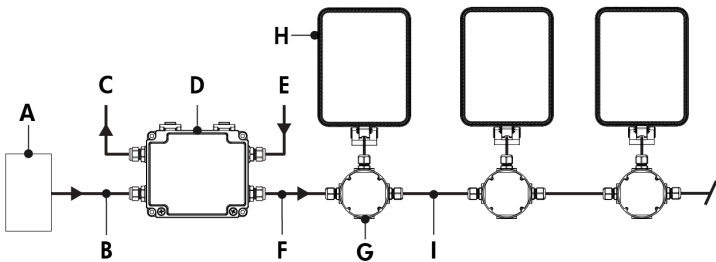

- A - DMX/RDM controller (order separately from Lumenpulse, or by others)
- B - Data input (Belden 9841 or equivalent, by others)
- C - Data output to next CBX (optional, not isolated/not boosted)
- D - CBX-DS
- E - Power input (100-277V, wiring by others)
- F - Power and data output to fixture (wiring by others)
- G - Junction box (by others)
- H - Lumenquad Grande
- I - Power and data wiring (by others)

Daisy Chain Layout (DMX/RDM) - Wiring Detail (First or Middle of Run)

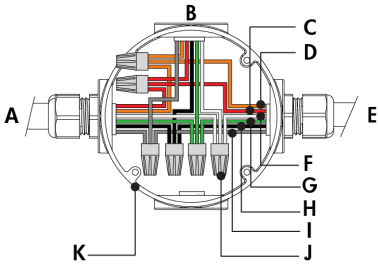

- A - From CBX or previous fixture
- B - To fixture
- C - Data -
- D - Data +
- E - To next fixture
- F - Neutral
- G - Line
- H - Ground
- I - Signal common
- J - Wire-nuts (by others)
- K - Junction box (by others)

Maximum Fixture Count

Maximum number of fixtures per run (Based on 15A maximum, 16AWG cable, fixtures spaced 10ft on center, first fixture 50ft from CBX)				
Configuration/Voltage	120V	208V	240V	277V
LQG	10	16	18	21

Daisy Chain Layout (DMX/RDM) - Wiring Detail (End of Run)

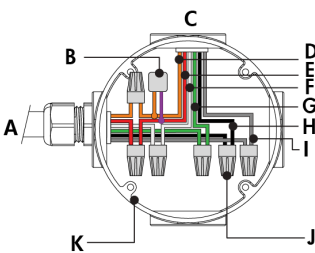

- A - From CBX or previous fixture
- B - Lumenterminator\*
- C - To fixture
- D - Data -
- E - Data +
- F - Neutral
- G - Ground
- H - Line
- I - Signal common
- J - Wire-nuts (by others)
- K - Junction box (by others)

- Refer to CBX installation instructions for additional wiring details.
- Consult factory for specific applications and maximum fixture count/cable length recommendations.
- The DMX/RDM protocol states a maximum of 32 DMX/RDM enabled fixtures on any single run.
- Maximum of 4 DMX/RDM repeaters/CBX cascading in line.
- Maximum of 1 output per CBX-DS.
- Maximum of 3 ft cable length between fixture and next junction box for daisy chain layout.
- Each fixture requires 1 DMX address.
- 1% minimum dimming value. 100 watts per fixture.

\* DMX terminator is required at the end of each run to maintain data integrity. (2x) DMX lumenterminators included per CBX-DS. See installation instructions for details.



How to Order

Housing	Voltage	Color and Color Temperature <sup>(2)</sup>	Optic1	Optic2	Optical Option <sup>(7)</sup>
<b>LQG</b> Lumenquad Grande <sup>(1)</sup>	<b>100</b> 100 Volts	<b>22K</b> 2200K	<b>XN</b> Extra Narrow 3° <sup>(5)</sup>	<b>XN</b> Extra Narrow 3° <sup>(5)</sup>	<b>LSLH</b> Linear Spread Lens Horizontal Distribution <sup>(8)</sup>  <b>LSLV</b> Linear Spread Lens Vertical Distribution <sup>(8)</sup>  <b>HL</b> Honeycomb Louver <sup>(8)</sup>
	<b>120</b> 120 Volts	<b>27K</b> 2700K	<b>VN</b> Very Narrow 6° <sup>(5)</sup>	<b>VN</b> Very Narrow 6° <sup>(5)</sup>	
	<b>208</b> 208 Volts	<b>30K</b> 3000K	<b>NS</b> Narrow Spot 10° <sup>(5)</sup>	<b>NS</b> Narrow Spot 10° <sup>(5)</sup>	
	<b>220</b> 220 Volts	<b>35K</b> 3500K	<b>NF</b> Narrow Flood 20° <sup>(5)</sup>	<b>NF</b> Narrow Flood 20° <sup>(5)</sup>	
	<b>240</b> 240 Volts	<b>40K</b> 4000K	<b>M</b> Medium 30° <sup>(5)</sup>	<b>M</b> Medium 30° <sup>(5)</sup>	
	<b>277</b> 277 Volts	<b>57K</b> 5700K	<b>FL</b> Flood 40° <sup>(5)</sup>	<b>FL</b> Flood 40° <sup>(5)</sup>	
		<b>RD</b> Red <sup>(3) (4)</sup>	<b>WFL</b> Wide Flood 60° <sup>(5) (4)</sup>	<b>WFL</b> Wide Flood 60° <sup>(5) (4)</sup>	
		<b>GR</b> Green <sup>(3) (4)</sup>	<b>VWFL</b> Very Wide Flood 90° <sup>(5) (4)</sup>	<b>VWFL</b> Very Wide Flood 90° <sup>(5) (4)</sup>	
		<b>BL</b> Blue <sup>(3) (4)</sup>	<b>NAS</b> Narrow Asymmetric <sup>(5)</sup>	<b>NAS</b> Narrow Asymmetric <sup>(5)</sup>	
			<b>WW</b> Asymmetric Wallwash <sup>(5)</sup>	<b>WW</b> Asymmetric Wallwash <sup>(5)</sup>	
			<b>2</b> Type II <sup>(5) (4)</sup>	<b>2</b> Type II <sup>(5) (4)</sup>	
			<b>2BLS</b> Type II Backlight Shield <sup>(5) (4)</sup>	<b>2BLS</b> Type II Backlight Shield <sup>(5) (4)</sup>	
			<b>3</b> Type III <sup>(5) (4)</sup>	<b>3</b> Type III <sup>(5) (4)</sup>	
			<b>3BLS</b> Type III Backlight Shield <sup>(5) (4)</sup>	<b>3BLS</b> Type III Backlight Shield <sup>(5) (4)</sup>	
			<b>4</b> Type IV <sup>(5) (4)</sup>	<b>4</b> Type IV <sup>(5) (4)</sup>	
			<b>4BLS</b> Type IV Backlight Shield <sup>(5) (4)</sup>	<b>4BLS</b> Type IV Backlight Shield <sup>(5) (4)</sup>	
			<b>5S</b> Type VS <sup>(5) (4)</sup>	<b>5S</b> Type VS <sup>(5) (4)</sup>	

Notes:

1. Consult factory for products that are BAA-approved (Buy American Act).

2. Consult factory for availability of static Royal Blue, 6500K and 90+ CRI.

3. Static colors made to order 8-10 weeks.

4. Consult factory for availability with type 2, 2BLS, 3, 3BLS, 4, 4BLS and 5S distributions.
5. Factory installed, not interchangeable on site.

6. Cannot be combined with other optics.

7. Optical options are factory installed and cannot be changed in the field.

8. Not available for WFL, VWFL, NAS, WW, 2, 2BLS, 3, 3BLS, 4, 4BLS and 5S optics.

How to Order

Mounting Options <sup>(9)</sup> <sup>(10)</sup>	Finish	Control	Option	Certification	Cable Length <sup>(18)</sup> <sup>(23)</sup> <sup>(25)</sup>
<b>SM</b> Surface Mount	<b>BK</b> Black Sandtex®	<b>NO</b> On/Off Control	<b>CRC</b> Corrosion-Resistant Coating <sup>(19)</sup> <sup>(20)</sup>	<b>UL</b> UL Compliant	<b>3FT</b> 3 ft <sup>(18)</sup> <sup>(24)</sup>
<b>WM</b> Wall Mount Bracket with Decorative Cover	<b>BRZ</b> Bronze Sandtex®	<b>LT</b> Lumentalk <sup>(14)</sup>		<b>CE</b> CE Compliant <sup>(21)</sup>	<b>10FT</b> 10 ft
<b>WMNC</b> Wall Mount Bracket without Decorative Cover	<b>SI</b> Silver Sandtex®	<b>DIM</b> 0-10V Dimming		<b>CEII</b> CE Compliant Class II Double Insulated <sup>(21)</sup> <sup>(22)</sup>	<b>20FT</b> 20 ft
<b>WAM6</b> Wall Arm Mount 6 in with Decorative Cover	<b>WH</b> Smooth White	<b>DALI</b> DALI Dimming			<b>30FT</b> 30 ft
<b>WAM6NC</b> Wall Arm Mount 6 in without Decorative Cover	<b>BKTX</b> Textured Black	<b>DMX/RDM</b> DMX/RDM Enabled <sup>(17)</sup> <sup>(18)</sup>			<b>50FT</b> 50 ft
<b>WAM12</b> Wall Arm Mount 12 in with Decorative Cover	<b>BRZTX</b> Textured Bronze Non-Metallic				<b>70FT</b> 70 ft
<b>WAM12NC</b> Wall Arm Mount 12 in without Decorative Cover	<b>GRATX</b> Textured Medium Gray				<b>100FT</b> 100 ft
<b>WAM18</b> Wall Arm Mount 18 in with Decorative Cover	<b>GRNTX</b> Textured Green				
<b>WAM18NC</b> Wall Arm Mount 18 in without Decorative Cover	<b>WHTX</b> Textured White				
<b>WAM24</b> Wall Arm Mount 24 in with Decorative Cover <sup>(11)</sup>	<b>CC</b> Custom Color & Finish <sup>(13)</sup> <sup>(14)</sup> <sup>(15)</sup>				
<b>WAM24NC</b> Wall Arm Mount 24 in without Decorative Cover <sup>(11)</sup>					
<b>WMRJB</b> Recessed JBOX Wall Mount with Decorative Cover					
<b>WMRJBNC</b> Recessed JBOX Wall Mount without Decorative Cover					
<b>WAMRJB6</b> Recessed JBOX Wall Arm Mount 6 in with Decorative Cover					
<b>WAMRJB6NC</b> Recessed JBOX Wall Arm Mount 6 in without Decorative Cover					
<b>WAMRJB12</b> Recessed JBOX Wall Arm Mount 12 in with Decorative Cover					
<b>WAMRJB12NC</b> Recessed JBOX Wall Arm Mount 12 in without Decorative Cover					
<b>WAMRJB18</b> Recessed JBOX Wall Arm Mount 18 in with Decorative Cover					
<b>WAMRJB18NC</b> Recessed JBOX Wall Arm Mount 18 in without Decorative Cover					
<b>WAMRJB24</b> Recessed JBOX Wall Arm Mount 24 in with Decorative Cover					
<b>WAMRJB24NC</b> Recessed JBOX Wall Arm Mount 24 in without Decorative Cover					

<b>RPM4/1</b> Round Pole Mount 4 in					
<b>RPM4.5/1</b> Round Pole Mount 4.5 in					
<b>RPM5/1</b> Round Pole Mount 5 in					
<b>RPM4/2</b> Round Pole Mount 4 in for two fixtures					
<b>RPM4.5/2</b> Round Pole Mount 4.5 in for two fixtures					
<b>RPM5/2</b> Round Pole Mount 5 in for two fixtures					
<b>PLTU</b> Lumentech Pole Mount <sup>(12)</sup>					
<b>TN2</b> Tenon Adapter for 2 3/8 in O.D. Pole					
<b>TN4</b> Tenon Adapter for 4 in O.D. Pole					
<b>SK</b> Stake Mount					

Notes:

9. All mounting options (except for SM mounting) are interchangeable. Consult factory for details.

10. All mounting options have a pivot adjustable in 6° increments, consult factory for universal pivot option.

11. A cable length of 10 ft or greater must be specified.

12. Available for Lumentech poles with a square or round profile. A PLTU - Universal Yoke accessory must be ordered with the Lumentech pole for the Lumentech to fit with the PLTU mounting option. Refer to Lumentech specification sheet and installation instructions for more details.

13. Lumenpulse offers a wide selection of RAL CLASSIC (K7) colors with a smooth texture and high-gloss finish. Please consult factory for a list of available K7 colors, other RAL textures and glosses, or to match alternate color charts. Final color matching results may vary.

14. Setup charges apply for RAL colors. Consult factory for details.

15. Longer lead times can be expected for custom RAL color finishes.

16. A Lumentranslator 2 (LTL2) and LumenID (LID) must be specified for Lumentalk applications. Consult Lumentranslator 2 and Lumentalk pages and specification sheets for details.
17. A control box (CBX) and LumenID (LID) must be specified.

18. Maximum of 3 ft cable length for daisy chain DMX applications with CBX-DS.

19. Use only when exposed to salt spray. This option is not required for normal outdoor exposure.

20. Setup charges apply. Consult factory for details.

21. Consult European specification sheets and installation instructions for CE and CE Class II wiring information.

22. Available for 220 or 240 volts only.

23. Not applicable to WMRJB, WMRJBNC and WAMRJB 6 in to 24 in mounting options (with or without decorative cover). Cable lengths for these mounting options are determined by the length of the mounting bracket.

24. Not available with WAM24 or WAM24NC mounting options.

25. UL fixtures specified with a Smooth white finish and a SM, WM, WMNC, or WAM 6 in to 24 in mounting option (with or without decorative cover) are provided with a white cable. A black cable is provided for all other fixture configurations.