

Project Name

Qty

Type

Catalog / Part Number

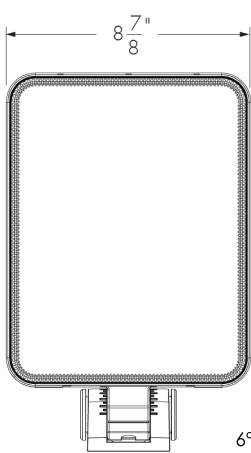

Front View  
6° Increment Pivot

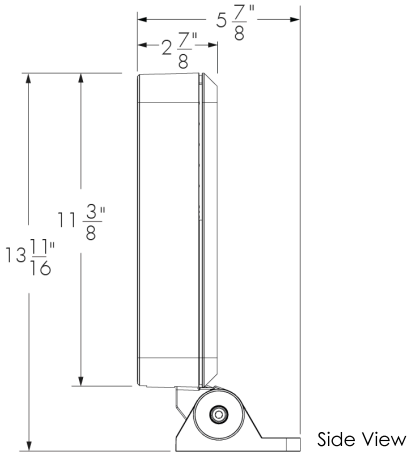

Side View

Photometric Summary

Symmetric

	Delivered output (lm)	Intensity (peak cd)
VN (6°)	3,335	173,787
NS (10°)	3,570	126,603
NF (20°)	3,522	33,089
M (30°)	3,233	14,616
FL (40°)	3,037	7,496
WFL (60°)	2,525	2,622
VWFL (90°)	3,131	1,623

Asymmetric

NAS	3,711	57,155 (@2.5°)
WW	3,071	13,650 (@5°)

1. Based on DWH, full output.
2. Photometric performance is measured in compliance with IESNA LM-79-24.
3. Refer to the [Lumenquad Dynamic White Photometric Guide](#) on Lumenpulse website for information on other color temperatures.

Optic

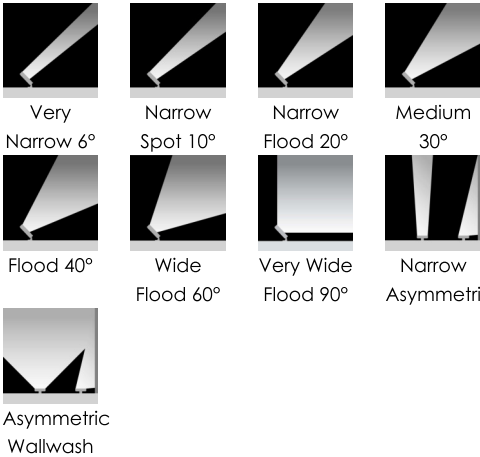

Description

The Lumenquad Large Dynamic White, 50W LED luminaire, has a sleek 2 7/8 in profile with no visible wiring or hardware and seamlessly integrates with any architecture. Its Dynamic White feature enables smooth variations in color temperature, from 2200K to 3000K or from 2700K to 6500K, and gives you the freedom to update the color of light in response to the way a space is used. Lumenpulse's latest generation of LED boards possess an optimized candela and lumens recipe for both Narrow and Wide optics. The Lumenquad Large Dynamic White is the epitome of versatile and can be configured with numerous options including optics for wallwash and floodlighting, as well as various mounting options, accessories, controls, and multiple standard finishes.

Features

Color and Color Temperature

**DWW:** Dynamic Warm White (2200K to 3000K), **DWH:** Dynamic White (2700K to 6500K)

Optics (Nominal Distribution)

**VN:** VN (6°), **NS:** NS (10°), **NF:** NF (20°), **M:** M (30°), **FL:** FL (40°), **WFL:** WFL (60°), **VWFL:** VWFL (90°), **NAS:** NAS (Narrow Asymmetric), **WW:** WW (Asymmetric Wallwash)

Mounting Options

**SM:** Surface Mount, **WM:** Wall Mount Bracket with Decorative Cover, **WMNC:** Wall Mount Bracket without Decorative Cover, **RJBOX:** Recessed JBOX Wall Mount with Decorative Cover, **RJBOXNC:** Recessed JBOX Wall Mount Without Decorative Cover, **PM:** Pole Mount, **TN:** Tenon Mount, **SK:** Stake Mount, **NOTE:** All mounting options have a pivot adjustable in 6° increments, consult factory for universal pivot option.

Optical Options (Factory Installed)

**LSLH:** Linear Spread Lens Horizontal Distribution, **LSLV:** Linear Spread Lens Vertical Distribution, **HL:** Honeycomb Louver

Option

**CRC:** Corrosion-Resistant Coating for Hostile Environments

Power Consumption

50 W (LT and DMX/RDM control), 43 W (DIM/DTW and DMX/RDM1 control)

Color and Color Temperature

D<sub>ww</sub>

Dynamic Warm White  
(2200K to 3000K)

D<sub>wh</sub>

Dynamic White  
(2700K to 6500K)

Control

DIM/DTW

DMX/RDM1

DMX/RDM

lumen talk

DALI T8

Ratings

IP66    IK10

Certifications

Warranty	5-year limited warranty
Performance	
Maximum Delivered Output	2,872 lm (DWW full output, NAS, DMX/RDM) 3,711 lm (DWH full output, NAS, DMX/RDM)
Maximum Delivered Intensity	134,511 cd at nadir (DWW full output, VN 6°, DMX/RDM) 173,787 cd at nadir (DWH full output, VN 6°, DMX/RDM)
Illuminance at Distance	Minimum 1 fc at 368 ft (DWW full output, VN 6°, DMX/RDM) Minimum 1 fc at 419 ft (DWH full output, VN 6°, DMX/RDM)
Lumen Maintenance	L70 120,000 hrs (Ta 25 °C)
Physical	
Housing Material	Low copper content high pressure die-cast aluminum
Lens Material	Clear tempered glass
Hardware Material	Stainless steel
Gasket Material	Silicone
Surface Finish	Electrostatically applied polyester powder coat
Weight	15 lbs
EPA	Front = 0.84 ft², Side = 0.23 ft², Front 45°= 0.79 ft²
Electrical and Control	
Voltage	100 to 277 volts
Fixture Cable	Power and data in one cable
Conductors	3C #16-3 (LT control) 5C #16-5 (DIM/DTW control) 6C #14-3/ #24-3 (DMX/RDM1, DMX/RDM control)
Control	Lumentalk, Dim to Warm via 0-10V (2700K to 2200K), Dim to Warm via Single-Channel DMX/RDM (2700K to 2200K), DMX/RDM Enabled 3-Channel Color Temperature Control, DALI 2 T8 Enabled Dimming 0.1%
Resolution (DMX/RDM)	Per fixture, 8-bit or 16-bit
Dynamic Warm Color Temperature Mixing	36 LEDs (12x 2200K, 12x 2700K, 12x 3000K)
Dynamic White Color Temperature Mixing	36 LEDs (12x 2700K, 12x 4000K, 12x 6500K)
Environmental	
Storage Temperature	-40 °F to 185 °F (device must reach start-up temperature value before operating)
Start-up Temperature	-13 °F to 122 °F
Operating Temperature	-40 °F to 122 °F
Ingress Protection Rating	IP66 Wet location rated
Impact Resistance Rating	IK10

Application Wind Speed

Luminaires were designed based on AASHTO 2013 standard to ensure highest quality and safety. Installation should be validated by a local project engineer to ensure the luminaires are suitable for the wind speed and exposure of the specific application

Accessories (Order Separately)

Optical Accessories

Snoot, Lumenquad Large Visor, Linear Spread Lens Adjustable, Wire Guard

Control Boxes

DMX/RDM enabled (Daisy Chain or Star Configuration), Ethernet enabled (Daisy Chain or Star Configuration)

Control Systems

Pharos® Designer Lighting Control Kit (PHAROS), Pharos® Expert Control Kit (EXPERT)

Diagnostic and Addressing Tools

LumenID (LID)

Important

Virtual Patent Marking Notice

This website (<https://www.lmpg.com/patents-trademarks>) is provided to satisfy the virtual patent marking provisions of applicable jurisdictions. Some products listed may be covered by additional patents not referenced here.

Chromaticity Data

TM-30 - DWW

CCT	CIE		TM-30	
DWW	R <sub>a</sub>	86	87	R <sub>f</sub>
Full Output	R <sub>g</sub>	26	97	R <sub>g</sub>

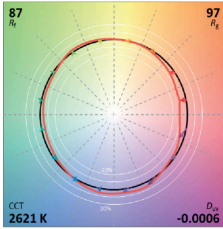

DWW Spectral Power Distribution

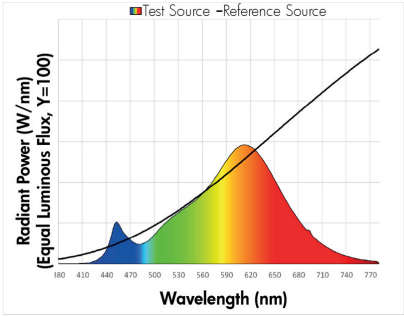

TM-30 - DWH

CCT	CIE		TM-30	
DWH	R <sub>a</sub>	81	80	R <sub>f</sub>
Full Output	R <sub>g</sub>	22	99	R <sub>g</sub>

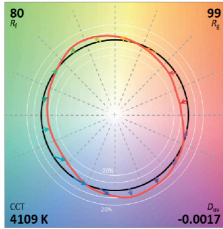

DWH Spectral Power Distribution

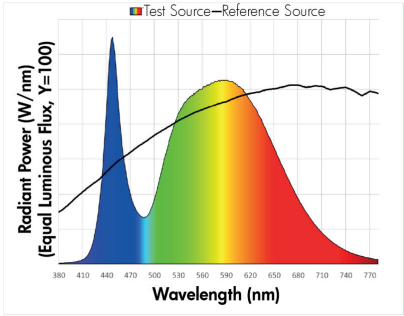

Mounting Options

SM - Surface Mount

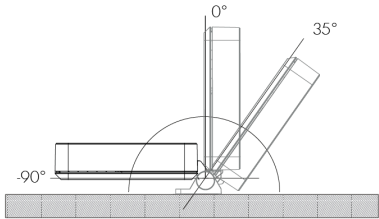

SM - Mounting Hole Pattern

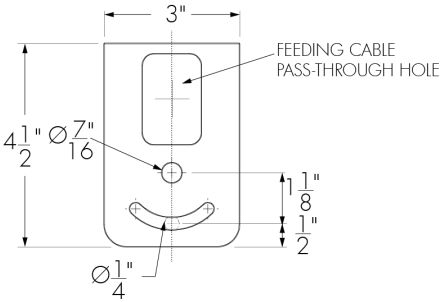

The SM mounting option cannot be interchanged with any other mounting option. All others mountings are interchangeable. Consult factory for details.

WM - Wall Mount Bracket with Decorative Cover

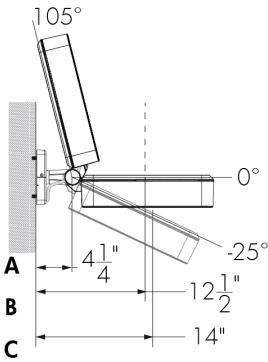

WMNC - Wall Mount Bracket Without Decorative Cover

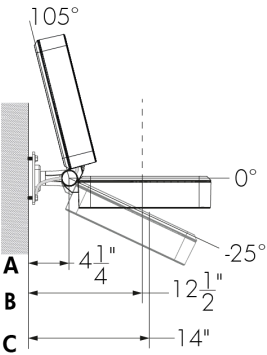

- A - Dimension from wall to pivot.
- B - Dimension from wall to the geometric center of the fixture.
- C - Dimension from wall to the center of the board.

WAM - Wall Mount Bracket With Decorative Cover  
6 in, 12 in, 18 in or 24 in

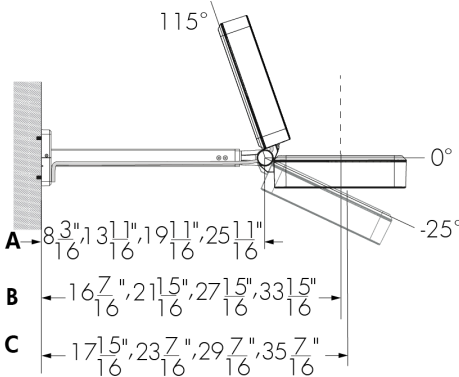

WAMNC - Wall Mount Bracket Without Decorative Cover  
Cover 6 in, 12 in, 18 in or 24 in

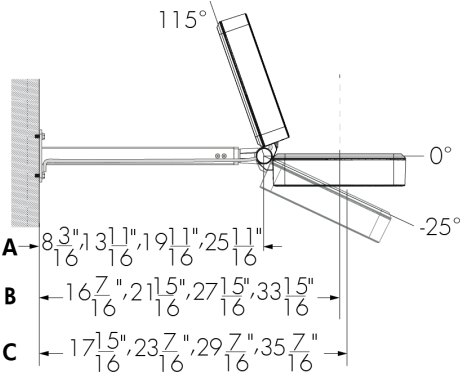

A cable length of 10 ft or greater must be specified for the WAM24 mounting option.

A cable length of 10 ft or greater must be specified for the WAM24 mounting option.

WMRJB - Recessed JBOX Wall Mount With Decorative Cover

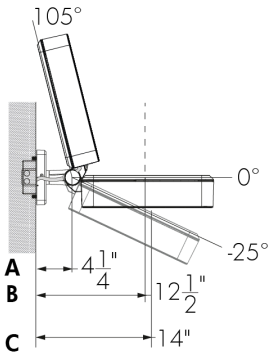

WMRJBNC - Recessed JBOX Wall Mount Without Decorative Cover

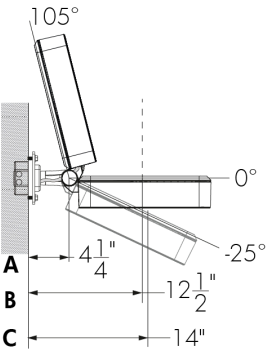

Fixture cable length is determined by Lumenpulse.

Fixture cable length is determined by Lumenpulse.

WAMRJB - Recessed JBOX Wall Arm Mount With  
Decorative Cover 6 in, 12 in, 18 in or 24 in

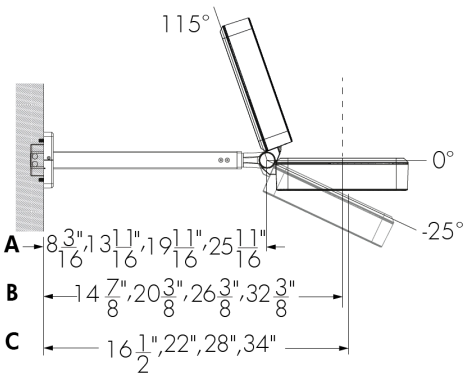

Wall Mount Horizontal Pivot Limits

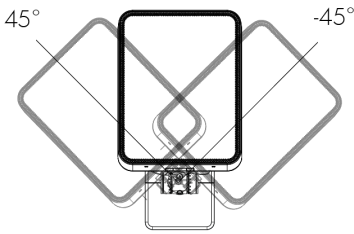

WAMRJBNC - Recessed JBOX Wall Arm Mount  
Without Decorative Cover 6 in, 12 in, 18 in or 24 in

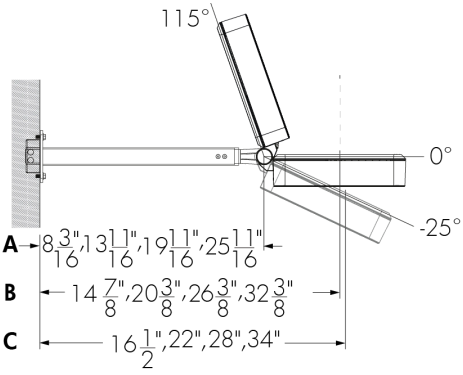

WM, WAM, WMRJB and WAMRJB - Mounting Hole  
Pattern

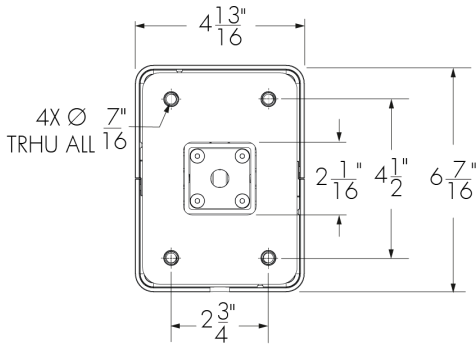

A - Dimension from wall to pivot.

B - Dimension from wall to the geometric center of the fixture.

C - Dimension from wall to the center of the board.

WMNC, WAMNC, WMRJBNC and WAMRJBNC -  
Mounting Hole Pattern

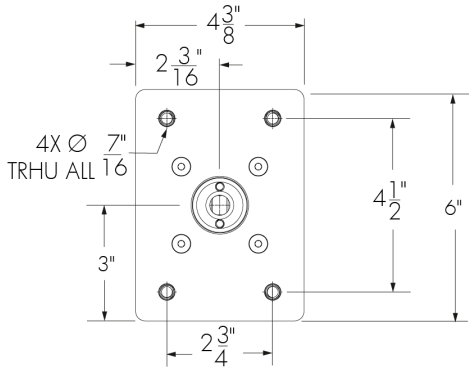

RPM4/1, RPM4.5/1, RPM5/1 - Round Pole Mount

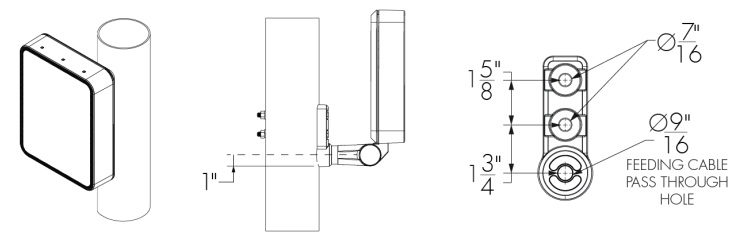

	RPM4/1	RPM4.5/1	RPM5/1
For pole Ø	4" ± 1/16	4.5" ± 1/16	5" ± 1/16
Bolt length	5 1/4	5 3/4	6 1/4

Consult factory for other pole diameters.  
Hardware included with accessory.

Round Pole Mount Horizontal Pivot Limits

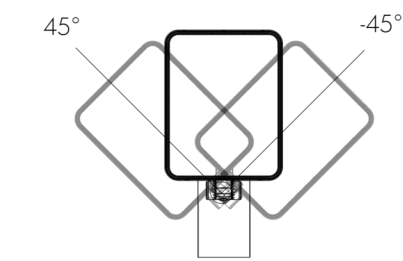

PLTU - Universal Yoke

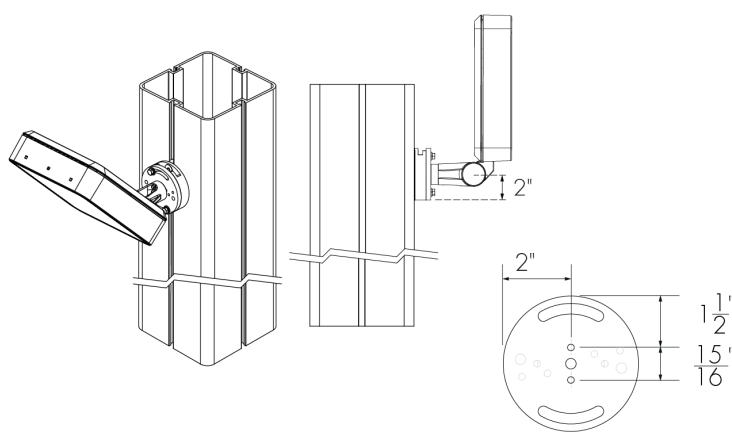

Refer to the Universal Yoke specification sheet and Pole installation instructions for more details. Square Lumentech profile shown.

All mounting options (except for SM mounting) are interchangeable. Consult factory for details.  
All mounting options have a pivot adjustable in 6° increments, consult factory for universal pivot option.

RPM4/2, RPM4.5/2, RPM5/2 - Round Pole Mount For Two Fixtures

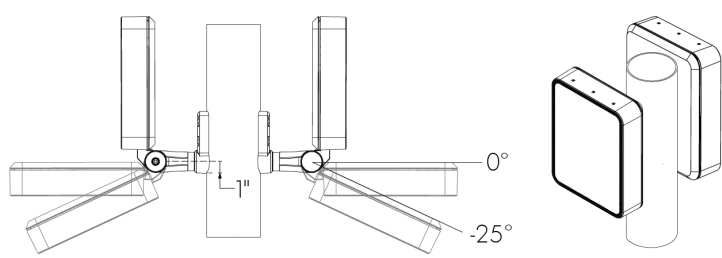

	RPM4/2	RPM4.5/2	RPM5/2
For pole Ø	4" ± 1/16	4.5" ± 1/16	5" ± 1/16
Bolt length	5 3/4	6 1/4	7"

Consult factory for other pole diameters.  
Hardware included with accessory.

TN2 - Tenon Adapter For 2 3/8 in O.D. Pole

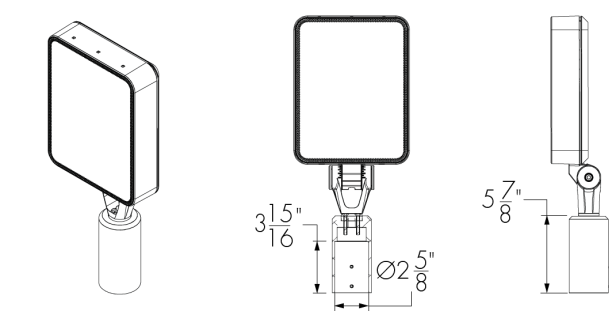

Vertical mounting only. Consult factory for horizontal mounting.

TN4 - Tenon Adapter For 4 in O.D. Pole

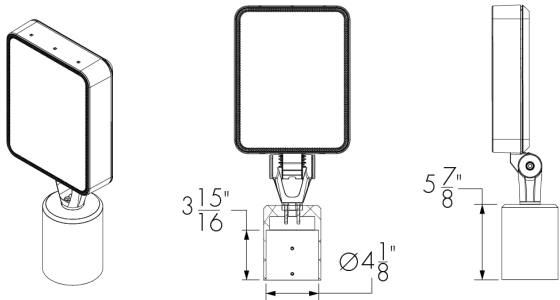

Vertical mounting only. Consult factory for horizontal mounting.

SK - Stake Mount

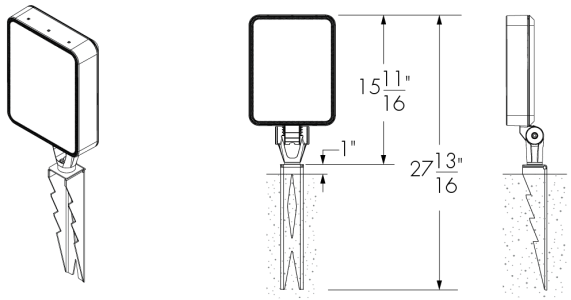

All mounting options (except for SM mounting) are interchangeable. Consult factory for details.  
All mounting options have a pivot adjustable in 6° increments, consult factory for universal pivot option.

Optical Options

- LSLH - Linear Spread Lens Horizontal Distribution
- LSLV - Linear Spread Lens Vertical Distribution

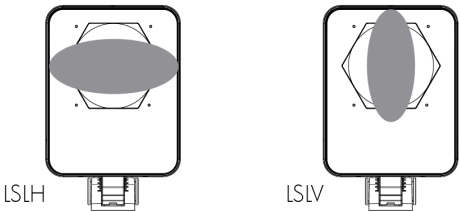

Factory installed, not adjustable on site. Not available for WFL, VWFL, NAS and WW optics.

See 'Optical Accessories' section for field adjustable spread lens (LSLA).

	Beam angle with LSLH/LSLV
VN	7° x 60°
NS	13° x 60°
NF	18° x 65°
M	25° x 66°
FL	35° x 70°

LLF: 0.88\*  
\*LLF may vary slightly by distribution chosen.

HL - Honeycomb Louver

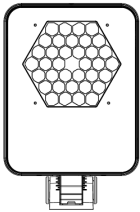

Factory installed, not adjustable on site. HL not available for WFL, VWFL, NAS and WW optics.

The addition of a honeycomb louver will affect beam distribution. Consult factory for application support.

LLF: 0.90\*  
\*LLF may vary slightly by distribution chosen.



Optical Accessories (Factory Installed, Order Separately)

Installed optical accessories will affect the maximum pivot limits for each mounting option, consult factory for details.

SN - Snoot

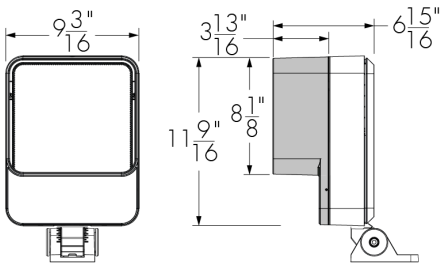

LQLSN-FINISH-BK-OPTIONS (CRC)  
Interior surface painted black. Please specify the exterior **FINISH** from the list of finishes in the fixture order code.

VS - Visor

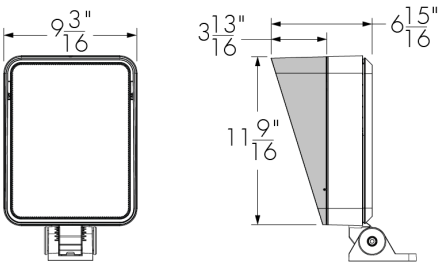

LQLVS-FINISH-BK-OPTIONS (CRC)  
Interior surface painted black. Please specify the exterior **FINISH** from the list of finishes in the fixture order code.

The Visor is not recommended for the WW optic.

LSLA - Linear Spread Lens Adjustable

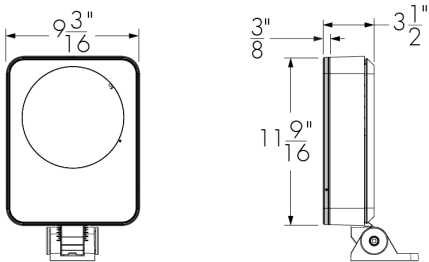

LQLLSLA-FINISH-OPTIONS (CRC)  
Please specify the exterior **FINISH** from the list of finishes in the fixture order code.

WG - Wire Guard

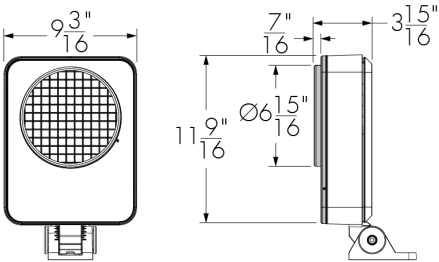

LQLWG-FINISH-OPTIONS (CRC)  
Please specify the exterior **FINISH** from the list of finishes in the fixture order code.

Accessory Combinations

	+	Snoot	Visor	Wire guard
Linear spread lens adjustable		YES	YES	NO
Wire guard		YES	YES	N/A

Accessory combinations must be ordered together on a single line. Ex: A snoot + wire guard combination order code is LQLSNWG-BK-BK. A maximum of two accessories can be combined per fixture.

Diffuser Lenses (Intended for Mockup Purposes Only, Order Separately)

Diffuser Lens 1 (1 Notch)

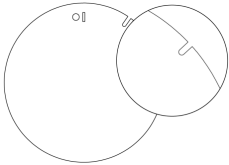

147707

Diffuser Lens 2 (2 Notches)

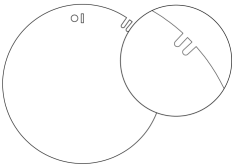

147708

Diffuser Lens 3 (3 Notches)

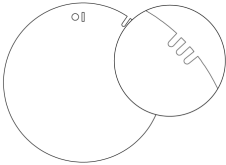

147709

Diffuser Lens 4 (4 Notches)

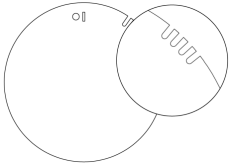

147710

Diffuser Lens 5 (5 Notches)

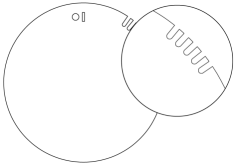

147711

Diffuser Lens 6 (6 Notches)

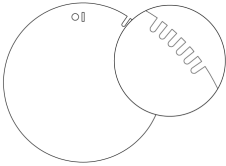

147712

Final Distribution Using Diffuser Lenses



	Final Distribution Using Diffuser Lens					
Original Distribution on Fixture	Diffuser Lens 1 1 Notch	Diffuser Lens 2 2 Notches	Diffuser Lens 3 3 Notches	Diffuser Lens 4 4 Notches	Diffuser Lens 5 5 Notches	Diffuser Lens 6 6 Notches
XN (4°/5°)	VN	NS	NF	M	FL	WFL
VN (6°)	NS					
NS (10°)						
NF (20°)						
M (30°)			FL	WFL		
FL (40°)						
WFL (60°)				VWFL		
VWFL (90°)						

Choose a diffuser lens based on the desired final beam distribution. Refer to the 6-digit part numbers above to order diffuser lenses individually. To order a complete set of 6 diffuser lenses in a bag, refer to the following item names: **LQS**: LQALK-S **LQM**: LQALK-M **LQL**: LQALK-L **LQG**: LQALK-G

The diffuser lenses are intended for mockup purposes only. A lens holder is required to install a diffuser lens on the fixture, order separately using the following names: **LQS**: LQSLSLA-FINISH-LQALK **LQM**: LQMLSLA-FINISH-LQALK **LQL**: LQLLSLA-FINISH-LQALK **LQG**: LQGSLA-FINISH-LQALK

Please specify the exterior **FINISH** from the list of finishes in the fixture order code.  
Refer to the Diffuser Lens Installation Instructions on the Lumenpulse website for information on installing the diffuser lenses.

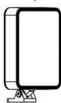
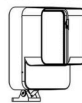
EPA Guide

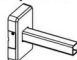
	FIXTURE			MOUNTING OPTIONS*			
	LQL	LQL with Snoot	LQL with Visor	WAM/WAMRJB			
					6	12	18
EPA Front (sq ft)	0.841	0.997	0.997	N/A	N/A	N/A	N/A
EPA Side (sq ft)	0.231	0.596	0.596	0.134	0.287	0.440	0.593
EPA Front 45° (sq ft)	0.787	1.256	1.256	N/A	N/A	N/A	N/A

\*Mounting arm only. Fixture EPA calculation must also be considered.

Control Boxes (Order Separately)

CBX-DMX/RDM - DMX/RDM Enabled (Daisy Chain or Star Configuration)

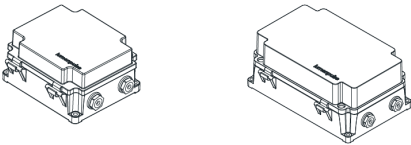

DMX/RDM control box. Up to six power and data outputs to fixtures or fixture runs. Consult CBX specification sheet and installation instructions for details. Lumenterminators provided with CBX (2x for Daisy Chain configuration, 6x for Star configuration), consult factory to order spares.

CBX-ENET - Ethernet Enabled (Daisy Chain or Star Configuration)

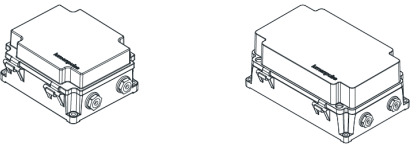

Ethernet control box. Up to four power and data outputs to fixture or fixture runs. Consult Ethernet CBX specification sheet and installation instructions for details.

Control Systems (Order Separately)

PHAROS - Pharos® Designer Lighting Control Kit



The Pharos Designer Lighting Control Kit, available for 1 or 2 DMX universes, allows for complete control of large lighting installations.

EXPERT - Pharos® Expert Control Kit

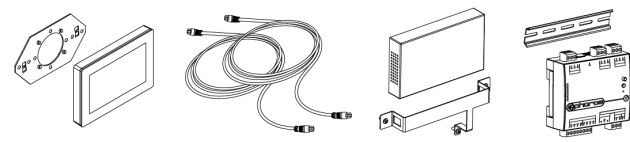

The Pharos Expert Control Kit, available for 1, 2, 4 or 6 DMX universes, allows for complete control of large lighting installations.

Diagnostic And Addressing Tools (Order Separately)

LID - LumenID



The updated LumenID (LID) is an all-in-one diagnostic and addressing solution for both DMX/RDM and Lumentalk (LT) systems. Engineered for versatility, it streamlines commissioning and troubleshooting across protocols—no need for multiple tools. Cable option may vary; please consult factory. For complete details, refer to the LID specification sheet.

Typical Wiring Diagrams

Wiring Color Code

UL Color Code	USE
Green	Ground
Black	Line 100-277V AC
White	Line/Neutral
Red or Purple	0-10V / Data +
Orange	0-10V / Data -
Gray	Signal common (DMX/RDM only)

Dim to Warm Via 0-10V (DIM/DTW\*)

\*Available For DWW Version Only, 2700K to 2200K

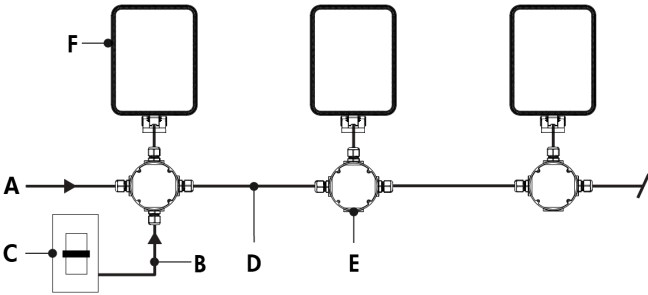

- A - Power input (100-277V, wiring by others)
- B - Data wiring (by others)
- C - Dimmer (by others)
- D - Power and data wiring (by others)
- E - Junction box (by others)
- F - Lumenquad Large

Dim to Warm Via 0-10V (DIM/DTW) - Wiring Detail

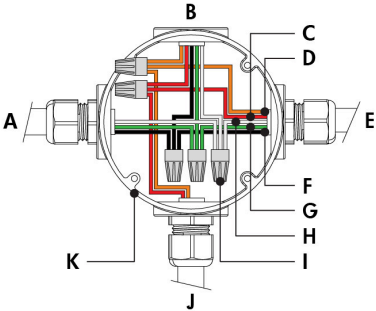

- A - Power input or from previous fixture
- B - To fixture
- C - 0-10 V +
- D - 0-10 V -
- E - To next fixture
- F - Line
- G - Ground
- H - Neutral
- I - Wire-nuts (by others)
- J - From dimmer (by others)
- K - Junction box (by others)

- Consult factory for specific applications and maximum fixture count/cable length recommendations.
- 0-10V mA ratings: passive dimmer (Current Sink): 3mA per fixture, active dimmer (Current Source): 0.5mA per fixture.
- 43 watts per fixture.

Star Layout (Dim to Warm Via DMX/RDM1\* or 3-Channel DMX/RDM)  
\*Available for DWW Version Only, 2700K To 2200K

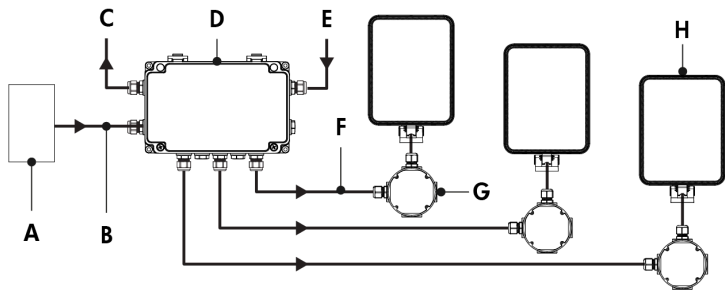

- A - DMX/RDM controller (order separately from Lumenpulse, or by others)
- B - Data input (Belden 9841 or equivalent, by others)
- C - Data output to next CBX (optional, not isolated/not boosted)
- D - CBX-ST
- E - Power input (100-277V, wiring by others)
- F - Power and data output to fixture (wiring by others)
- G - Junction box (by others)
- H - Lumenquad Large

Maximum Fixture Count

Maximum number of fixtures per run (Based on 15A maximum, 16AWG cable, fixtures spaced 10ft on center, first fixture 50ft from CBX)				
Configuration/Voltage	120V	208V	240V	277V
LQL	18	28	32	32

DMX/RDM1 controlled fixtures typically draw less power than DMX/RDM controlled fixtures, consult factory for maximum run length information.

- Refer to CBX installation instructions for additional wiring details.
- Consult factory for specific applications and maximum fixture count/cable length recommendations.
- The DMX/RDM protocol states a maximum of 32 DMX/RDM enabled fixtures on any single run.
- Maximum of 4 DMX/RDM repeaters/CBX cascading in line.
- Maximum of 6 outputs per CBX-ST.
- DMX/RDM1 control option requires 1 DMX address. DMX/RDM control option requires 3 DMX addresses.
- 43 watts per fixture for DMX/RDM1 control, 50 watts per fixture for DMX/RDM control.

\* DMX terminator is required at the end of each run to maintain data integrity. (6x) DMX lumenterminators included per CBX-ST. See installation instructions for details.

Star Layout (DMX/RDM1 or DMX/RDM) - Wiring Detail

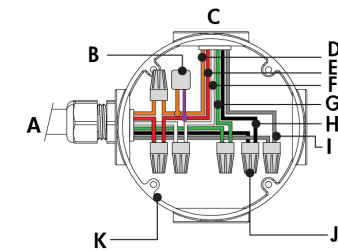

- A - From CBX or previous fixture
- B - Lumenterminator\*
- C - To fixture
- D - Data -
- E - Data +
- F - Neutral
- G - Ground
- H - Line
- I - Signal common
- J - Wire-nuts (by others)
- K - Junction box (by others)

Daisy Chain Layout (Dim to Warm Via DMX/RDM1\* or 3-Channel DMX/RDM)  
\*Available for DWW Version Only, 2700K to 2200K

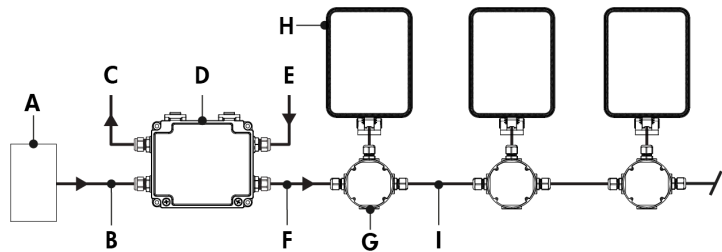

- A - DMX/RDM controller (order separately from Lumenpulse, or by others)
- B - Data input (Belden 9841 or equivalent, by others)
- C - Data output to next CBX (optional, not isolated/not boosted)
- D - CBX-DS
- E - Power input (100-277V, wiring by others)
- F - Power and data output to fixture (wiring by others)
- G - Junction box (by others)
- H - Lumenquad Large
- I - Power and data wiring (by others)

Daisy Chain Layout (DMX/RDM1 or DMX/RDM) - Wiring Detail (First or Middle of Run)

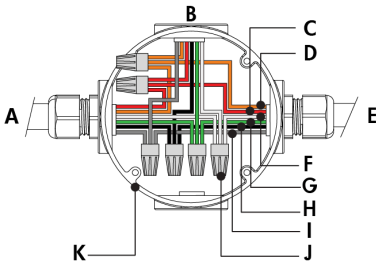

- A - From CBX or previous fixture
- B - To fixture
- C - Data -
- D - Data +
- E - To next fixture
- F - Neutral
- G - Line
- H - Ground
- I - Signal common
- J - Wire-nuts (by others)
- K - Junction box (by others)

Maximum Fixture Count

Maximum number of fixtures per run (Based on 1.5A maximum, 16AWG cable, fixtures spaced 10ft on center, first fixture 50ft from CBX)				
Configuration/Voltage	120V	208V	240V	277V
LQL	18	28	32	32

DMX/RDM1 controlled fixtures typically draw less power than DMX/RDM controlled fixtures, consult factory for maximum run length information.

Daisy Chain Layout (DMX/RDM1 or DMX/RDM) - Wiring Detail (End of Run)

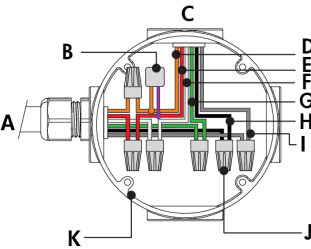

- A - From CBX or previous fixture
- B - Lumenterminator\*
- C - To fixture
- D - Data -
- E - Data +
- F - Neutral
- G - Ground
- H - Line
- I - Signal common
- J - Wire-nuts (by others)
- K - Junction box (by others)

- Refer to CBX installation instructions for additional wiring details.
- Consult factory for specific applications and maximum fixture count/cable length recommendations.
- The DMX/RDM protocol states a maximum of 32 DMX/RDM enabled fixtures on any single run.
- Maximum of 4 DMX/RDM repeaters/CBX cascading in line.
- Maximum of 1 output per CBX-DS.
- Maximum of 3 ft cable length between fixture and next junction box for daisy chain layout.
- DMX/RDM1 control option requires 1 DMX address. DMX/RDM control option requires 3 DMX addresses.
- 43 watts per fixture for DMX/RDM1 control, 50 watts per fixture for DMX/RDM control.

\* DMX terminator is required at the end of each run to maintain data integrity. (2x) DMX lumenterminators included per CBX-DS. See installation instructions for details.

DALI 2 T8 (DALIT8)

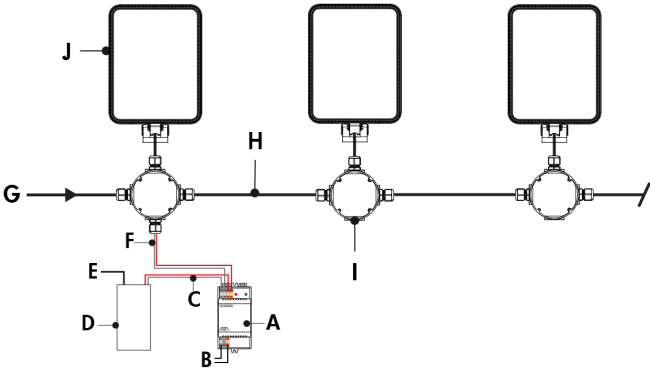

- A - DALI bus power supply
- B - Power input for DALI bus power supply (wiring by others)
- C - Data output to DALI controller (by others)
- D - DALI controller (by others)
- E - Power input for DALI controller (if required, wiring by others)
- F - Data output to fixture
- G - Power input (100-277V)
- H - Power and data wiring (by others)
- I - Junction box (by others)
- J - Lumenquad (LQL-DALIT8)

DALI 2 T8 (DALIT8) - Wiring Detail

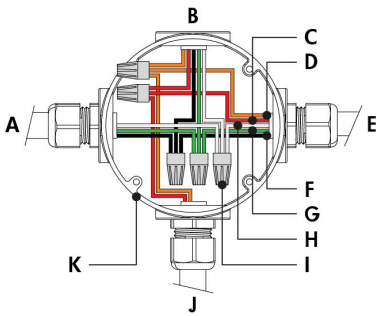

- A - Power input or from previous fixture
- B - To fixture
- C - DA +
- D - DA -
- E - To next fixture
- F - Line
- G - Ground
- H - Neutral
- I - Wire-nuts (by others)
- J - From DALI controller (by others)
- K - Junction box (by others)

- Consult factory for specific applications and maximum fixture count/cable length recommendations.
- Maximum of 64 DALI fixtures per DALI loop.
- 100 watts per fixture.
- The Lumenquad Large responds to RGBWAF controls.
- Commissioning may be required based on the selection of 3rd party DALI controller. Controller and commissioning provided by others.

How to Order

Housing	Voltage	Color and Color Temperature	Optic	Optical Option <sup>(3)</sup>	Mounting Options <sup>(5) (6)</sup>	Finish	Control	Option	Certification	Cable Length <sup>(15) (17) (21)</sup>
LQL Lumenquad Large <sup>(1)</sup>	100 100 Volts	DWW Dynamic Warm White (2200K to 3000K)  DWH Dynamic White (2700K to 6500K)	VN Very Narrow 6° <sup>(2)</sup>	LSLH Linear Spread Lens Horizontal Distribution <sup>(4)</sup>  LSLV Linear Spread Lens Vertical Distribution <sup>(4)</sup>  HL Honeycomb Louver <sup>(4)</sup>	SM Surface Mount	BK Black Sandtex®	LT Lumentalk <sup>(12)</sup>	CRC Corrosion-Resistant Coating <sup>(16) (17)</sup>	UL UL Compliant	3FT 3 ft <sup>(15) (20)</sup>
	120 120 Volts		WM Wall Mount Bracket with Decorative Cover		BRZ Bronze Sandtex®	DIM/DTW Dim to Warm via 0-10V (2700K to 2200K) <sup>(13)</sup>	CE CE Compliant <sup>(16)</sup>			10FT 10 ft
	208 208 Volts		WMNC Wall Mount Bracket without Decorative Cover		SI Silver Sandtex®	DMX/RDM1 Dim to Warm via Single-Channel DMX/RDM (2700K to 2200K) <sup>(13) (14) (15)</sup>	CEII CE Compliant Class II Double Insulated <sup>(18)</sup>			20FT 20 ft
	220 220 Volts		WAM6 Wall Arm Mount 6 in with Decorative Cover		WH Smooth White	DMX/RDM 3-Channel Color Temperature Control via DMX/RDM <sup>(14) (15)</sup>	DALIT8 DALI 2 T8 Enabled Dimming 0.1%			30FT 30 ft
	240 240 Volts		WAM6NC Wall Arm Mount 6 in without Decorative Cover		BKTX Textured Black	GRATX Textured Medium Gray				50FT 50 ft
	277 277 Volts		WAM12 Wall Arm Mount 12 in with Decorative Cover		BRZTX Textured Bronze Non-Metallic	GRNTX Textured Green				70FT 70 ft
			WAM12NC Wall Arm Mount 12 in without Decorative Cover		WHTX Textured White	CC Custom Color & Finish <sup>(9) (10) (11)</sup>				100FT 100 ft
			WAM18 Wall Arm Mount 18 in with Decorative Cover							
			WAM18NC Wall Arm Mount 18 in without Decorative Cover							
			WAM24 Wall Arm Mount 24 in with Decorative Cover <sup>(7)</sup>							
			WAM24NC Wall Arm Mount 24 in without Decorative Cover <sup>(7)</sup>							
			WMRJB Recessed JBOX Wall Mount with Decorative Cover							
			WMRJBNC Recessed JBOX Wall Mount without Decorative Cover							
			WAMRJB6 Recessed JBOX Wall Arm Mount 6 in with Decorative Cover							
			WAMRJB6NC Recessed JBOX Wall Arm Mount 6 in without Decorative Cover							
	WAMRJB12 Recessed JBOX Wall Arm Mount 12 in with Decorative Cover									
	WAMRJB12NC Recessed JBOX Wall Arm Mount 12 in without Decorative Cover									
	WAMRJB18 Recessed JBOX Wall Arm Mount 18 in with Decorative Cover									
	WAMRJB18NC Recessed JBOX Wall Arm Mount 18 in without Decorative Cover									
	WAMRJB24 Recessed JBOX Wall Arm Mount 24 in with Decorative Cover									
	WAMRJB24NC Recessed JBOX Wall Arm Mount 24 in without Decorative Cover									
	RPM4/1 Round Pole Mount 4 in									
	RPM4.5/1 Round Pole Mount 4.5 in									



					<div><div>RPM5/1</div><div>Round Pole Mount 5 in</div></div> <div><div>RPM4/2</div><div>Round Pole Mount 4 in for two fixtures</div></div> <div><div>RPM4.5/2</div><div>Round Pole Mount 4.5 in for two fixtures</div></div> <div><div>RPM5/2</div><div>Round Pole Mount 5 in for two fixtures</div></div> <div><div>PLTU</div><div>Lumentech Pole Mount <sup>(8)</sup></div></div> <div><div>TN2</div><div>Tenon Adapter for 2 3/8 in O.D. Pole</div></div> <div><div>TN4</div><div>Tenon Adapter for 4 in O.D. Pole</div></div> <div><div>SK</div><div>Stake Mount</div></div>				
--	--	--	--	--	--	--	--	--	--

Notes:

1. Consult factory for products that are BAA-approved (Buy American Act).

2. Factory installed, not interchangeable on site.

3. Optical options are factory installed and cannot be changed in the field.

4. Not available with WFL, VWFL, NAS and WW optics.

5. All mounting options (except for SM mounting) are interchangeable. Consult factory for details.

6. All mounting options have a pivot adjustable in 6° increments, consult factory for universal pivot option.

7. A cable length of 10 ft or greater must be specified.

8. Available for Lumentech poles with a square or round profile. A PLTU - Universal Yoke accessory must be ordered with the Lumentech pole for the Lumentech to fit with the PLTU mounting option. Refer to Lumentech specification sheet and installation instructions for more details.

9. Lumenpulse offers a wide selection of RAL CLASSIC (K7) colors with a smooth texture and high-gloss finish. Please consult factory for a list of available K7 colors, other RAL textures and glosses, or to match alternate color charts. Final color matching results may vary.

10. Setup charges apply for RAL colors. Consult factory for details.
11. Longer lead times can be expected for custom RAL color finishes.

12. A Lumentranslator 2 (LTL2) and LumenID (LID) must be specified for Lumentalk applications. Consult Lumentranslator 2 and Lumentalk pages and specification sheets for details.

13. Available for DWW color temperature option only.

14. A control box (CBX) and LumenID (LID) must be specified.

15. Maximum of 3 ft cable length for daisy chain DMX applications with CBX-DS.

16. Use only when exposed to salt spray. This option is not required for normal outdoor exposure.

17. Setup charges apply. Consult factory for details.

18. Consult European specification sheets and installation instructions for CE and CE Class II wiring information.

19. Not applicable to WMRJB, WMRJBNC and WAMRJB 6 in to 24 in mounting options (with or without decorative cover). Cable lengths for these mounting options are determined by the length of the mounting bracket.

20. Not available with WAM24 or WAM24NC mounting options.

21. UL fixtures specified with a Smooth white finish and a SM, WM, WMNC, or WAM 6 in to 24 in mounting option (with or without decorative cover) are provided with a white cable. A black cable is provided for all other fixture configurations.