



MODEL HONDA CBR 600 RR

YEAR 2007-2012

LINE POWER STEEL

MUFFLER SUONO

SCHEMATIC

ELENCO PARTI / PARTS LIST

| # | QTÀ / QTY | DESCRIZIONE / DESCRIPTION | CODICE / CODE |
|----|-----------|---|---------------|
| 1 | 1 | NOT IN USE | NOT IN USE |
| 2 | 1 | Db Killer forato / Drilled DB killer | 50.DK.071.0 |
| 3 | 2 | Tassello grande / Rubber big block | 50.73.203.1 |
| 4 | 1 | Silenziatore / Muffler | SUONO 270 |
| 5 | 1 | Fermo filettato / Threaded stop | 50.73.213.1 |
| 6 | 1 | Fermo forato / Drilled stop | 50.73.214.1 |
| 7 | 3 | Vite M6x35 / Screw M6x35 | 50.73.228.1 |
| 8 | 1 | Staffa in carbonio / Carbon fiber bracket | 50.SS.184.1 |
| 9 | 2 | Distanziale in alluminio / Aluminium spacer | 50.73.124.1 |
| 10 | 2 | Dado M8 flangiato / Flanged nut M8 | 50.73.052.1 |
| 11 | 2 | Rondella M6 / Washer M6 | 50.73.187.1 |
| 12 | 1 | Staffa / Bracket | 50.SS.232.1 |
| 13 | 1 | Staffa / Bracket | 50.SS.231.1 |
| 14 | 1 | Dado M6 / Nut M6 | 50.73.146.1 |
| 15 | 1 | Rondella in alluminio / Aluminium washer | 50.73.248.1 |
| 16 | 1 | Vite M8x25 / Screw M8x25 | 50.73.064.1 |
| 17 | 1 | Tappo per sonda lambda / Stopper for lambda probe | 50.73.198.1 |
| 18 | 1 | Molla corta / Short Spring | 50.73.123.1 |
| 19 | 10 | Molla lunga / Long Spring | 50.71.080.1 |
| 20 | 11 | Tubo in gomma per molla / Rubber pipe for spring | 50.73.210.1 |

ELENCO PARTI / PARTS LIST

| # | QTÀ / QTY | DESCRIZIONE / DESCRIPTION | CODICE / CODE |
|----|-----------|--|---------------|
| 21 | 1 | Tubo di raccordo / Link pipe | |
| 22 | 1 | Tubo di raccordo / Link pipe | |
| 23 | 1 | Tubo di raccordo 2-1 - Link pipe 2-1 | |
| 24 | 1 | Tubo di raccordo (#1,#2) / Link pipe (#1,#2) | |
| 25 | 1 | Tubo di raccordo (#3,#4) / Link pipe (#3,#4) | |
| 26 | 1 | Collettore #1 / Down pipe #1 | |
| 27 | 1 | Collettore #2 / Down pipe #2 | |
| 28 | 1 | Collettore #3 / Down pipe #3 | |
| 29 | 1 | Collettore #4 / Down pipe #4 | |

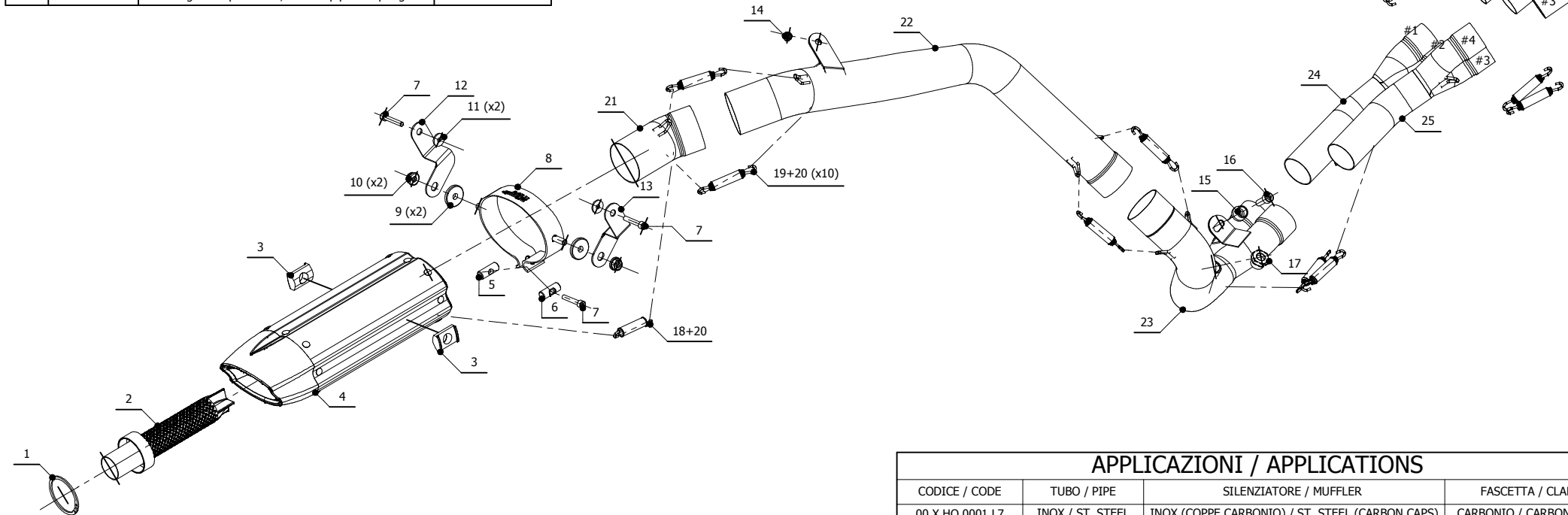
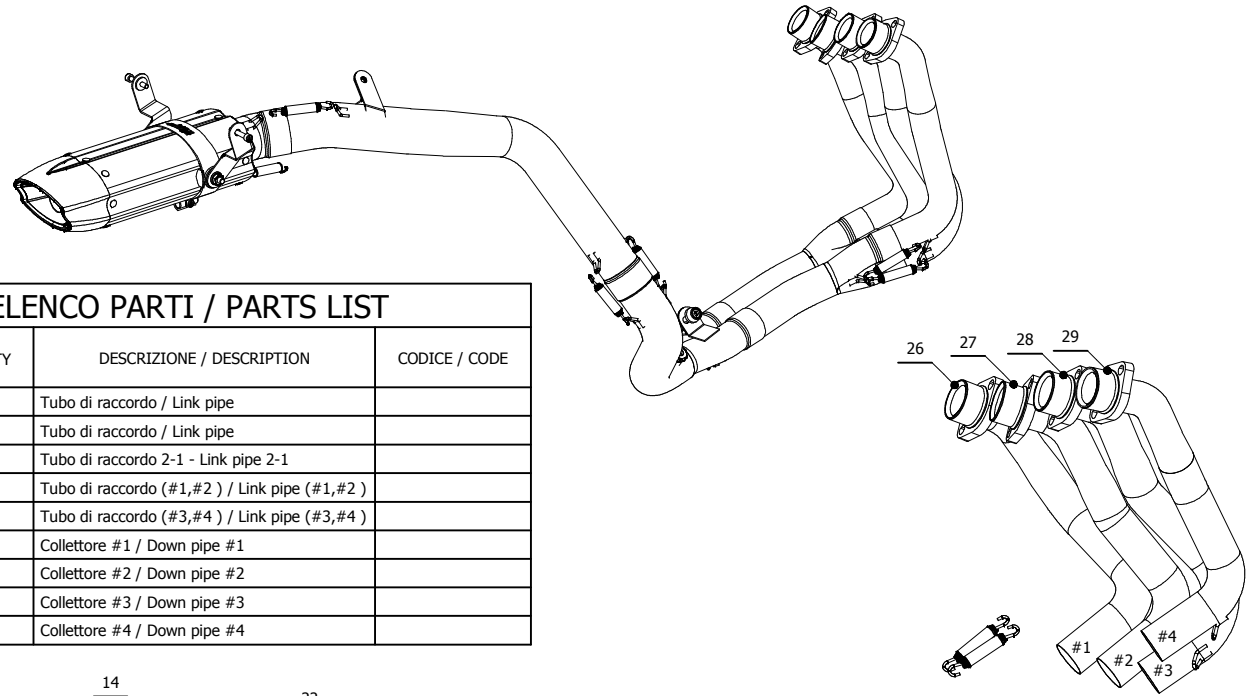

APPLICAZIONI / APPLICATIONS

| CODICE / CODE | TUBO / PIPE | SILENZIATORE / MUFFLER | FASCETTA / CLAMP |
|-----------------|------------------|---|-------------------------|
| 00.X.HO.0001.L7 | INOX / ST. STEEL | INOX (COPPE CARBONIO) / ST. STEEL (CARBON CAPS) | CARBONIO / CARBON FIBER |