



MODEL HONDA CBR 600 RR

YEAR 2007-2012

LINE POWER EVO

MUFFLER SUONO FULL TITANIUM

SCHEMATIC

ELENCO PARTI / PARTS LIST

#	QTÀ / QTY	DESCRIZIONE / DESCRIPTION	CODICE / CODE
1	1	Db Killer forato / Drilled DB killer	50.DK.038.0
2	1	Silenziatore / Muffler	SUONO 270
3	1	Vite M5x8 / Screw M5x8	50.73.233.1
4	1	Tappo in gomma / Rubber Stopper	50.73.266.1
5	2	Tassello grande / Rubber big block	50.73.203.1
6	1	Staffa in carbonio / Carbon fiber bracket	50.SS.184.1
7	1	Fermo filettato / Threaded stop	50.73.213.1
8	1	Fermo forato / Drilled stop	50.73.214.1
9	3	Vite M6x35 / Screw M6x35	50.73.228.1
10	2	Dado M8 flangiato / Flanged nut M8	50.73.052.1
11	2	Distanziale in alluminio / Aluminium spacer	50.73.124.1
12	2	Rondella M6 / Washer M6	50.73.187.1
13	1	Staffa sinistra / Left bracket	50.SS.232.1
14	1	Staffa destra / Right bracket	50.SS.231.1
15	1	Dado M6 / Nut M6	50.73.146.1
16	1	Tappo per sonda lambda / Stopper for lambda probe	50.73.299.1
17	1	Rondella in alluminio / Aluminium washer	50.73.248.1
18	1	Vite M8x25 / Screw M8x25	50.73.064.1
19	11	Tubo in gomma per molla / Rubber pipe for spring	50.73.210.1
20	1	Molla corta / Short Spring	50.73.123.1
21	10	Molla lunga / Long spring	50.71.080.1

ELENCO PARTI / PARTS LIST

#	QTÀ / QTY	DESCRIZIONE / DESCRIPTION	CODICE / CODE
22	1	Tubo di raccordo / Link pipe	
23	1	Tubo di raccordo / Link pipe	
24	1	Tubo di raccordo 2-1 - Link pipe 2-1	
25	1	Tubo di raccordo (#1,#2) / Link pipe (#1,#2)	
26	1	Tubo di raccordo (#3,#4) / Link pipe (#3,#4)	
27	1	Collettore #1 / Down pipe #1	
28	1	Collettore #2 / Down pipe #2	
29	1	Collettore #3 / Down pipe #3	
30	1	Collettore #4 / Down pipe #4	

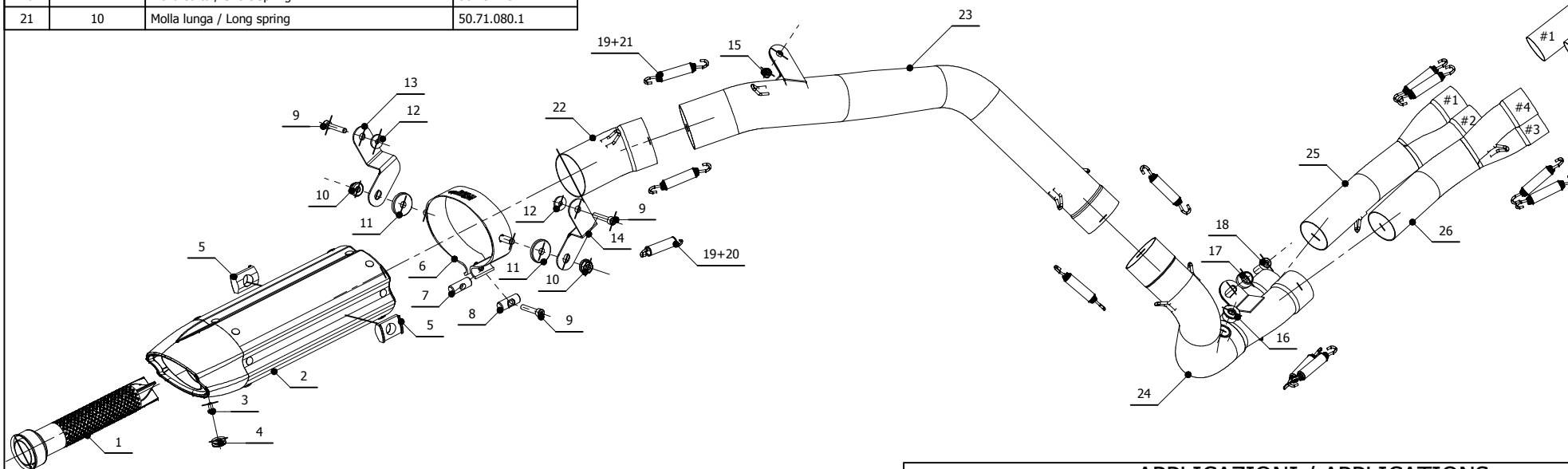
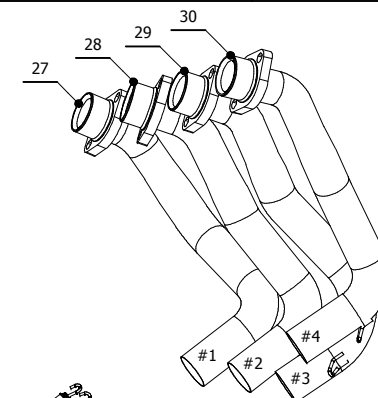
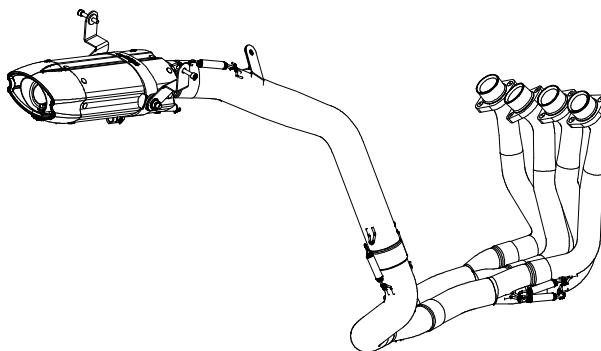

APPLICAZIONI / APPLICATIONS

CODICE / CODE	TUBO / PIPE	SILENZIATORE / MUFFLER	FASCETTA / CLAMP
00.R.HO.0001.S8	TITANIO / TITANIUM	TITANIO (COPPA CARBONIO) / TITANIUM (CARBON CAP)	CARBONIO / CARBON FIBER