



Revision: 1.2 - 05/10/2011

# LA-7500-74 Adjustable Rear Lowering Kit

**CAUTION!** We Strongly recommend that a qualified technician install this kit if you do not completely understand the instructions prior to the install.

### INCLUDED IN THE KIT:

(bushings pre-installed in kit)	(1) Baron VN900 Lowering Kit
---------------------------------	------------------------------

### TOOLS REQUIRED:

Factory Service Manual	Pliers (std. and needle nose)
Phillips and Flat Screwdrivers	10mm Open End Wrench
10 & 12 mm Sockets	3, 4, & 5 mm Allen Wrenches

### INSTRUCTIONS:

**WARNING:** Installing a lowering kit will decrease initial ground clearance. Care should be taken to avoid bottoming, especially over bumps or turns. To maintain proper balanced geometry, the front and rear of the motorcycle should ne lowered equally. Failure to properly install the lowering kit and operate the motorcycle after installation may result in serious injury or death to the rider.

**LIMITED GUARANTEE:** Because we cannot control the application of our products, buyer assumes risks for any and all damage caused to him or herself or any third party by virtue of any failure of these parts. **GUARANTEE** for such parts is limited to our replacement costs thereof. This **GUARANTEE** is in lieu of all other guaranties or warranties express or implied, and all other such guaranties or warranties are hereby expressly disclaimed. By installation of these parts, buyer irrevocably agrees to the foregoing. **NOTE:** Our install guides provide a basic outline on the proper installation of our products. Further tuning and/or fitment may be required. Baron bears no responsibility on installation costs associated with this product.

1. Remove the following: Side covers (left and right - Seat (must use key for removal)- Lower left hand chrome cover - Exhaust pipes - Coolant Reservoir

**REMOVAL TIPS:** Things to consider during removal of the above parts, side covers are secured by one screw in the upper corner of each cover. Exhaust pipes are secured by 4 nuts at the front of the engine, 3 bolts and 1 nut at the rear of the exhaust, and 2 bolts at the center brace, remove them in this order for best results. It is not necessary to disconnect the coolant line from the reservoir, temporarily secure the reservoir to another area on the bike during installation. As you remove parts from your motorcycle, keep them together for ease of reinstallation.

2. Lift and support the rear of the bike. The rear wheel needs to be high enough off the ground to be able to place a jack underneath it. Using the jack, raise the rear wheel enough to remove pressure from the swing arm.

3. Remove the following: Lower link arm bolt - Upper link arm bolt - Link arm (See illustration, looks similar to supplied lowering kit)

**NOTE:** Since the link arm is secured by the upper and lower link arm bolts, when these are removed, the link will be free for removal. 4. Prepare the new Barons adjustable link arm for installation by greasing the roller

Our install guides provide a basic outline on the proper installation of our products. Further tuning and/or fitment may be required. LA Choppers bears no responsibility on installation costs associated with this product.  
© 2013 LA Choppers

bearings.

5. To install the new Barons link arm, insert the upper link arm bolt, but do not tighten. Insert the lower link bolt. Guide the lower link bolt through the hole on the link arm that corresponds to the desired amount that you want the bike lowered (see photo above). It may be necessary to raise or lower the rear tire to be able to feed the lower link bolt through the link arm. Torque the upper link arm bolt to 80-ft lbs, and the lower link arm bolt to 60-ft lbs.

6. Remove the jack from the rear tire and lower the motorcycle to the ground.

7. Reinstall the items removed in Step 1:

Side covers (left and right) - Seat (must use key for removal)- Lower left hand chrome cover - Exhaust pipes - Coolant Reservoir

8. Check the look and feel of your lowered motorcycle.

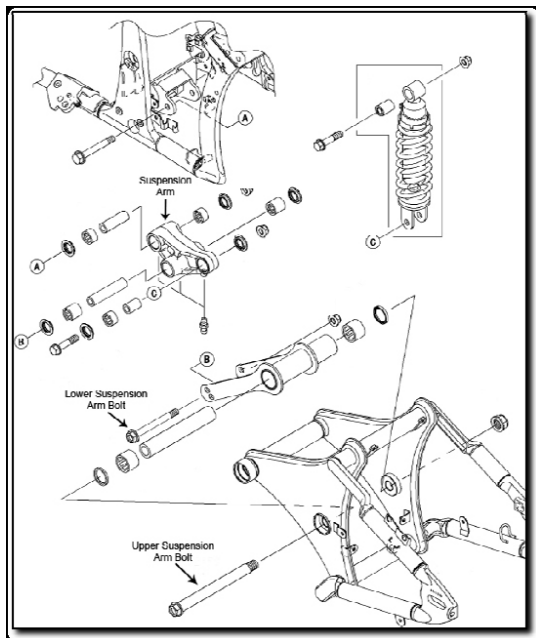

**CAUTION:** Check your motorcycle for proper parking lean angle. After lowering, you may need to purchase a short side stand. Always be careful when you park a lowered bike.

Our install guides provide a basic outline on the proper installation of our products. Further tuning and/or fitment may be required. LA Choppers bears no responsibility on installation costs associated with this product.  
© 2013 LA Choppers