



## MOUNTING INSTRUCTIONS

2321-0056 SPORTSHIELD YAMAHA 1300 V-STAR DETACHABLE

### ! WARNING

Read and follow these directions carefully.

During installation, make certain that when turning the forks, there can be no interference with wiring or cables AND, that the windshield can not hit the gas tank, through the windshield's full range of adjustment.

This is a detachable windshield, ALWAYS make sure the Locking Mechanism is Fully Engaged after installing the windshield!

The improper installation of this kit and related components could result in serious injury or death.

Additional tools required, that are not included in this kit. Thin blade screwdriver to pry-up trim topper.

**1. Cover gas tank and front fender with towels to avoid damage during installation.**

2. Install the windshield mounting plates onto the windshield, using the bolts that are pre-assembled on the mounting plates. The Santoprene grommets should be inserted through the holes in the windshield so that the flat round part lies flat on each side of the plastic. *NOTE: Tabs will point in towards headlight when properly installed.* (see Figure 1)

3. Locate and remove the two trim toppers, located on the upper triple tree. (see Figure 2)

4. Using a 4mm Allen wrench remove the lower Turn Signal trim. *Take care not to loose the small Brass Bushings.* Also remove both Turn Signals with a 5mm Allen wrench. (See Figure 2)

5. Install throttle side bracket by loosely installing new 10mm x 20mm SS Button Head Bolt with one washer in front and two washers on back in upper triple tree as shown in Fig 3, Screw, washer, bracket then two washers.

6. Install Turn Signal and lower Bracket using new 8mm Socket Head Cap Screw with Spacer and washer in this order; Screw, washer, bracket, spacer and through Turn Signal and loosely tighten into lower triple tree. Tighten both upper and lower screw. (See figure 3) Repeat steps 5 and 6 on Clutch side.

7. Install the windshield by placing the lower slots into the lower mounting bushings. Slip the upper slots into the upper mounting bushings and gently but firmly seat the slots into place. Lock the locking mechanism into place. (see figure 4)

8. Tighten all mounting bolts. Adjust the height, angle and alignment of the windshield and tighten *ALL* bolts. (See Figure 5)

**Note: This is a detachable windshield, ALWAYS make sure the Locking Mechanism is Fully Engaged after installing the windshield! (see figure 4)**

### CAUTION

#### IMPORTANT CARE AND CLEANING INSTRUCTIONS

Memphis Shades Windshields and Lowers are made of Lucite® acrylic, and will last for years with proper care. Clean your windshield with plenty of soapy water — mild dishwashing liquid is best — and a soft cotton cloth. Use your bare hand to feel and dislodge bugs, or cover with a wet soapy towel and let it soak. Don't use paper towels and don't scrape with anything. Small scratches can be removed with NOVUS # 2.

NEVER use any glass cleaning products, petroleum based chemicals, or cleaning agents with ammonia, bleach or any other harsh chemicals. This includes (but not limited to) RainX, brake fluid, acetone, paint thinner, benzene and gasoline. "If it hurts your nose, it will hurt the plastic."

**Glass cleansing agents will cause severe damage to your windshield, and will void your warranty.**

NOTE: At certain times of the day the Sunlight can reflect off the curvature of a windshield and cause extreme heat build-up on motorcycle instruments and instrument panel. Take care when parking. Park facing the sun, place an opaque object over the instruments or adjust the windshield to avoid reflections.

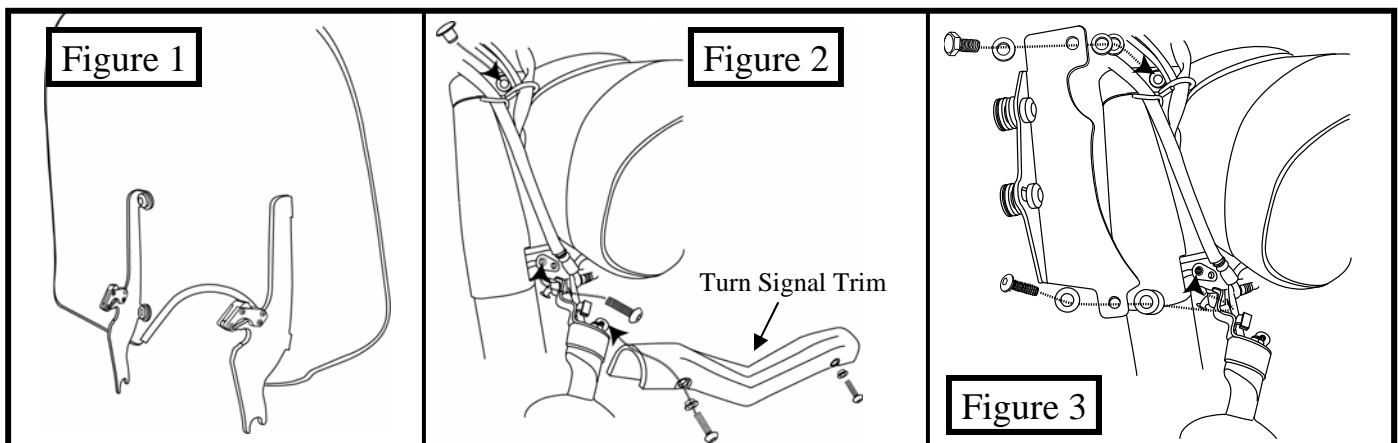



# MOUNTING INSTRUCTIONS

## 2321-0056 SPORTSHIELD YAMAHA 1300 V-STAR DETACHABLE

Part#	Description	Qty
M8921	Mounting Instructions	1
M1139	Left Sports Plate	1
M1140	Right Sports Plate	1
M1141	Left 1300 V-Star Bracket	1
M1142	Right 1300 V-Star Bracket	1
R349	10mm x 20mm SS Button Head Bolt	2
R337	10mm SS Washer	6
M366	8mm x 30mm Socket Head Cap Screw	2
R312	8mm SS Flat Washer	2
R336	3/4"x3/8" Lower Bolt Spacer	2
R323	Bushing Assembly (2 part)	4
R324	#207 EPDM O-Ring	4
R318	1" Socket Shoulder Washer	4

Part#	Description	Qty
M303	1/4"-20x3/4" Socket Head Cap Screw	4
R321	1" Recessed Spacer	4
M543	Santoprene Grommet	4
M504	Socket Shoulder Washer	4
M302	1/4"-20x1/2" Socket Head Cap Screw	4
M505	Button Nut	8
R322C	Clutch Side Latch Assembly	1
R322T	Throttle Side Latch Assembly	1
R334	6-32x3/8" Flat Head SS Screw	8
R326	SS Spring	2
M310	3/16" Short Arm Allen Wrench	1
M313	3/16" Allen Wrench Cover	1
M312	4mm Short Arm Allen Wrench	1
R306	5mm Long Arm Allen Wrench	1
M311	6mm Short Arm Allen Wrench	1

**BUSHING ASSEMBLY**

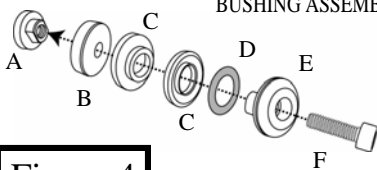

A. M505  
B. R321  
C. R323  
D. R324  
E. R318  
F. M303

1. M1142
2. M1140
3. M1141
4. M1139
5. R349
6. R337
7. M366
8. R312
9. R336

**Figure 4**

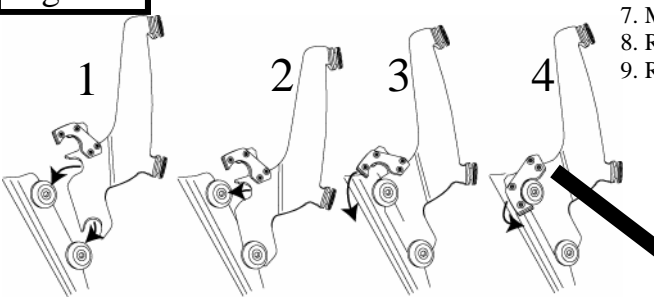

1. Place lower slot into lower bushing. 2. Rotate top slot into place. 3. & 4. Secure locking Mechanism.

**Figure 5**

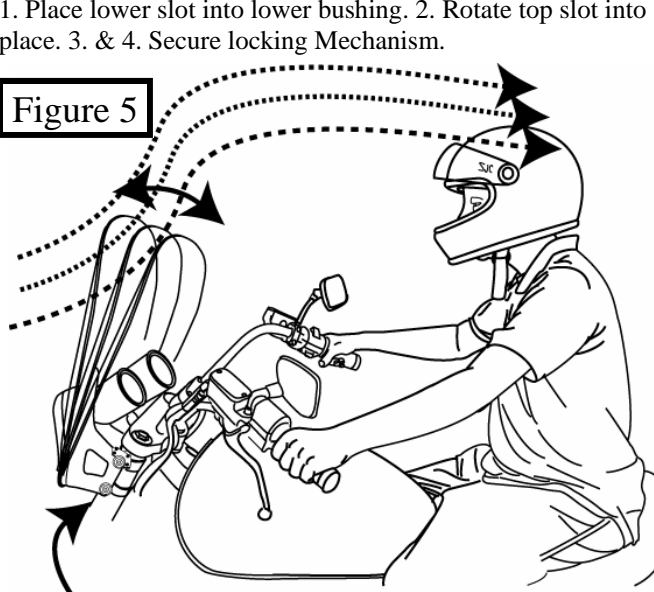

Loosen Allen Bolt to adjust angle, then re-tighten Allen Bolt.

**MEM8921 SPORTSHIELD KIT**

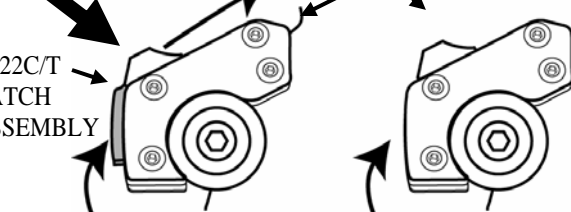

**NOT CORRECT**      **CORRECT Fully engaged**

Memphis Shades warrants all product components, metal and plastic, against defects in materials and workmanship for 24 months.

**FOR PARTS AND WARRANTY HELP, CONTACT:**  
MEMPHIS SHADES  
P. O. Box 429  
Rossville, TN 38066  
(901) 853-0293

Visit us on the web at [www.memphisshades.com](http://www.memphisshades.com) or you can also reach us at [customerservice@memphisshades.com](mailto:customerservice@memphisshades.com)