



Part No. 2321-0090

M8985 101408

Honda VTX1800 Chrome covered forks.
2002 to 2008
Fats / Slims Mounting Kit

CAUTION!
GAS TANK DAMAGE WILL OCCUR
on some versions of this model if fork
clamps are installed too high on the forks



WARNING

1. During installation, make sure that the windshield and hardware do not interfere with any cables or wiring when the forks are turned all the way in either direction. Also make sure, through the full range of adjustment, that the windshield and hardware do not hit the gas tank.
2. If the adjustable clamps are installed backwards, it will result in serious gas tank damage. Always check for proper gas tank clearance before tightening hardware.
3. This is a detachable windshield, always make sure the locking mechanism is fully engaged after installing the windshield.
4. The improper installation of this kit and related components could result in serious injury or death.



CAUTION

1. Memphis Shades windshields and Lowers are made from Lucite® acrylic, and will last for years with proper care. Clean your windshield with plenty of soapy water (mild dishwashing liquid is best) and a soft cotton cloth. Use your bare hands to feel and dislodge bugs, or cover with a wet, soapy towel and let it soak. Don't use paper towels and scrape with anything. Small scratches can be removed with NOVUS #2.
2. Never use any glass cleaning products, petroleum based chemicals, or cleaning agents with ammonia, bleach or any other harsh chemicals. This includes (but not limited to) RainX, brake fluid, acetone, paint thinner, benzene and gasoline. "If it hurts your nose, it will hurt the plastic."
3. Glass cleansing agents will cause severe damage to your windshield, and will void your warranty.
4. At certain times of the day the sunlight can reflect off the curvature of a windshield and cause extreme heat build up on motorcycle instruments and instrument panel. Take care when parking. Park facing the sun, place an opaque object over the instruments or adjust the windshield to avoid reflections

1. Kit Contents

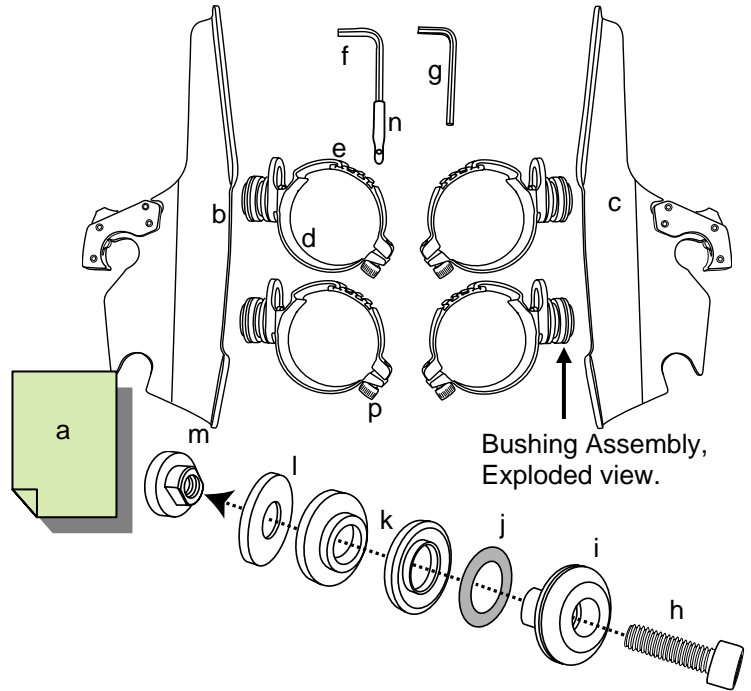

Ref	Part #	Description	Qty
(a)	M8985	Mounting Instructions	1
(b)	M1175	Left Plate Assembly	1
(c)	M1174	Right Plate Assembly	1
(d)	M533	M Outer Clamp, Detachable, with tape	4
(e)	M523	Large, Inner Adjustable Clamp, with tape	4
(f)	M310	3/16" Short Arm Allen Wrench	1
(g)	R352	1/8" Short Arm Allen Wrench	1
(h)	M306	1/4-20x5/8" SS Socket Head Cap Screw	4
(i)	R318	1" Socket Shoulder Washer	4
(j)	R324	#207 O Ring, EPDM	4
(k)	R323	Bushing Assembly (2 piece)	4
(l)	M369	0.75x0.25x0.036 SS Washer	4
(m)	R329	5/8" Slot Nut	4
(n)	M313	3/16" Allen Wrench Cover	1
(p)	R351	1/4-20x3/4" SS Low Head Socket Screw	4

Memphis Shades warrants all product components, metal and plastic, against defects in materials and workmanship for 24 months.

For Parts and Warranty Help, Contact:

Memphis Shades, Inc.
P.O. Box 429
Rossville, TN 38066
(901) 853 0293

Visit us on the web at www.memphisshades.com or you can also reach us by email:

customerservice@memphisshades.com

Honda VTX1800 Chrome covered forks.
2002 to 2008
Fats / Slims Mounting Kit

2. Mounting Instructions

CAUTION!
GAS TANK DAMAGE WILL OCCUR
on some versions of this model if fork
clamps are installed too high on the forks

1. Additional tools required, not included in this kit:
7/16" or 11mm wrench.
2. **Cover the gas tank and front fender with towels to Avoid damage during installation.**
3. Install the two mounting plates onto the windshield, using the bottom and third bolt up. Leave the nylon washers off. The small tab goes to the bottom, the big one to the top. The tabs point in toward the headlight. (See Fig 1)
4. Loosely install the fork clamps, approximately 1 3/4" apart, with the lower clamps touching the lower triple tree. (See Fig 2)
5. Start with each fork clamp bushing adjusted to the rear of the slot. (See Fig 3)
6. Slip the windshield mounting plates and windshield onto the fork clamp bushing. (See Fig 4)
7. Secure the Left and Right side Trigger Lock, locking mechanism. (Fig 5)
8. Adjust the height, angle and alignment of the windshield then tighten **all** bolts

Fig 1

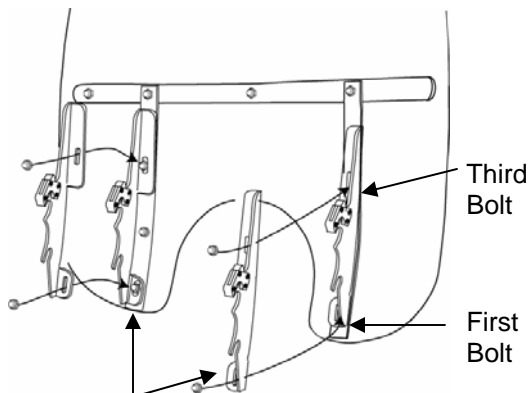

Tabs face in towards headlight.

Fig 2

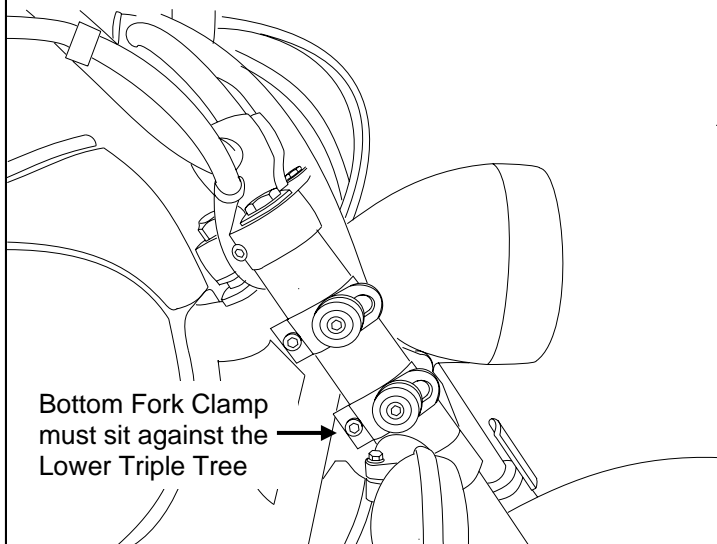

Fig 3

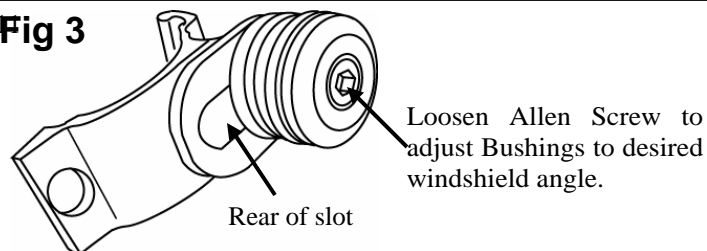

Fig 4

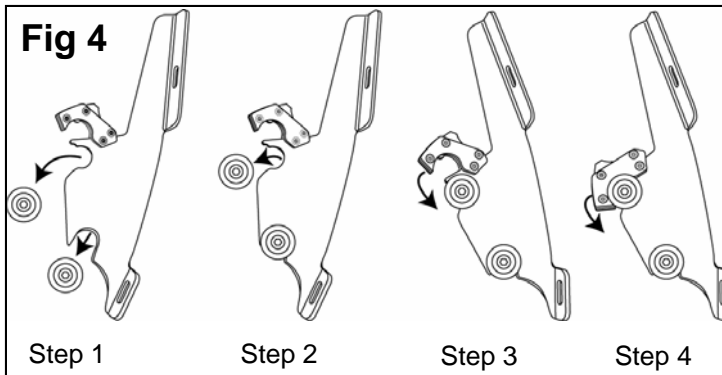

Fig 5

