



# MOUNTING INSTRUCTIONS

## 2321-0154 SPORTSHIELD DETACHABLE MOUNTING KIT 2010 HONDA FURY

### ▲ WARNING

Read and follow these directions carefully.

During installation, make sure that the windshield and hardware do not interfere with any cables or wiring when the forks are turned all the way in either direction. Also make sure, through the full range of adjustment, that the windshield and hardware do not hit the tank.

This is a detachable windshield, ALWAYS make sure the Locking Mechanism is Fully Engaged after installing the windshield!

The improper installation of this kit and related components could result in serious injury or death.

Additional tools required: 8mm and 10mm wrench for bracket removal.

1. Cover gas tank and front fender with a towel to avoid damage during installation.

2. Install the windshield mounting plates onto the windshield, using the bolts that are pre-assembled on the mounting plates.

The Santoprene grommets should be inserted through the holes in the windshield so that the flat round part of the grommet lies flat on each side of the plastic. **Tab point in towards the headlight.** (Fig 1)

3. Remove the bolt from both turn signal clamps using the 8mm and 10mm wrench. (Fig 2)

4. Remove the turn signal bracket. (Fig 2)

5. Remove the clutch side wire loom and twist it off of the wiring harness to free the turn signal wires and then reinstall the wire loom. The throttle side wire loom does not require removal to slip out the turn signal wires.

6. Take the turn signal bracket from the clutch side fork, invert it, and use on the throttle side fork. Repeat on other side.

7. Slide the turn signal clamps down the forks until the alignment tab slips into the pinch bolt slot. Allow enough room for the wiring harness to pass underneath.

8. Dress and align the turn signal cables, making sure they will not interfere with operation of the motorcycle.

9. Align the turn signal clamp with the turn signal

bracket and fix in place with the bolt.

10. Loosely install the four Fork Clamps on the forks, approximately 2" apart. (Fig 3)

11 Start with Fork Clamp Bushing adjusted to rear of slot. Then adjust as needed and check for clearance.

12. Slip the windshield mounting plates and windshield onto the fork clamps, and secure the left and right side locking mechanism (Fig 4 & Fig 5)

13. Adjust the height, angle and alignment of the windshield and tighten **ALL** bolts.

**Note: This is a detachable windshield, ALWAYS make sure the Locking Mechanism is Fully Engaged after installing the windshield!**

### CAUTION

#### IMPORTANT CARE AND CLEANING INSTRUCTIONS

Memphis Shades Windshields and Lowers are made of Lucite® acrylic, and will last for years with proper care. Clean your windshield with plenty of soapy water — mild dishwashing liquid is best — and a soft cotton cloth. Use your bare hand to feel and dislodge bugs, or cover with a wet soapy towel and let it soak. Don't use paper towels and don't scrape with anything. Small scratches can be removed with NOVUS # 2.

NEVER use any glass cleaning products, petroleum based chemicals, or cleaning agents with ammonia, bleach or any other harsh chemicals. This includes (but not limited to) RainX, brake fluid, acetone, paint thinner, benzene and gasoline. "If it hurts your nose, it will hurt the plastic."

**Glass cleansing agents will cause severe damage to your windshield, and will void your warranty.**

NOTE: At certain times of the day the Sunlight can reflect off the curvature of a windshield and cause extreme heat build-up on motorcycle instruments and instrument panel. Take care when parking. Park facing the sun, place an opaque object over the instruments or adjust the windshield to avoid reflections.

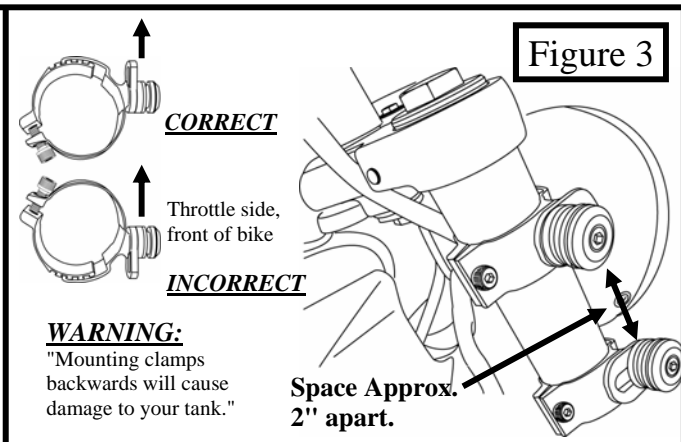
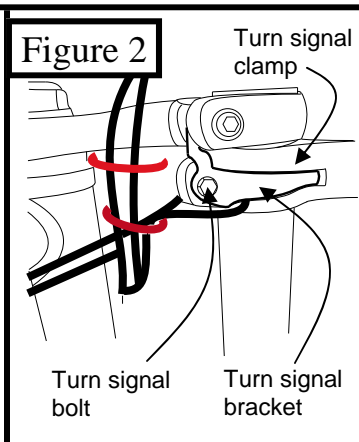
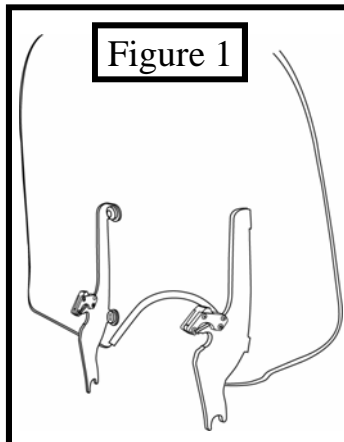



# MOUNTING INSTRUCTIONS

## 2321-0154 SPORTSHIELD DETACHABLE MOUNTING KIT 2010 HONDA FURY

PART #	DESCRIPTION	QTY.
I1922	MOUNTING INSTRUCTIONS	1
M1135	LEFT SPORTSHIELD MOUNTING PLATE	1
M1136	RIGHT SPORTSHIELD MOUNTING PLATE	1
M520	INNER ADJUSTABLE FORK CLAMP	4
M533	MEDIUM DETACHABLE ADJUSTABLE FORK CLAMP	4
M504	SOCKET SHOULDER WASHER	4
M505	BUTTON NUT	4
M543	SANTOPRENE GROMMET	4
M302	1/4"-20 x 1/2" SS SOCKET HEAD CAP SCREW	4
M369	STAINLESS STEEL WASHER	4
M306	1/4"-20 x 5/8" SS SOCKET HEAD CAP SCREW	4

PART #	DESCRIPTION	QTY.
R329	SLOT NUT	4
R323	BUSHING ASSEMBLY (2 PART)	4
R318	1" SOCKET SHOULDER WASHER	4
R324	#207 EPDM O-RING	4
R322 C/T	LATCH ASSEMBLY	2
M303	1/4"-20 x 3/4" SS SOCKET HEAD CAP SCREW	4
M313	3/16" ALLEN WRENCH COVER	1
M310	3/16" SHORT ARM ALLEN WRENCH	1

Figure 4

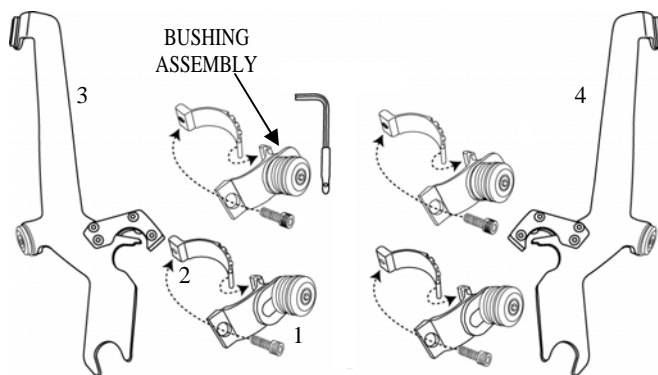
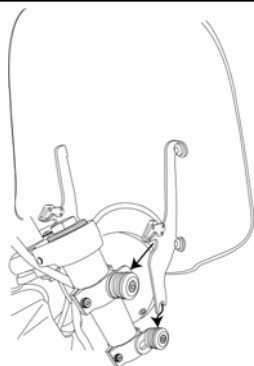
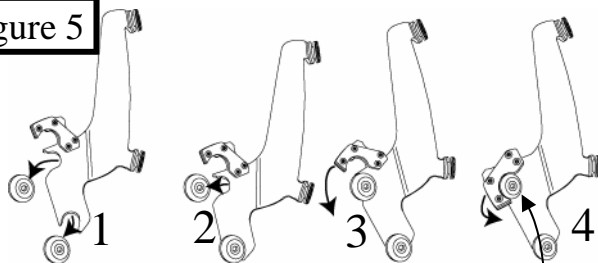
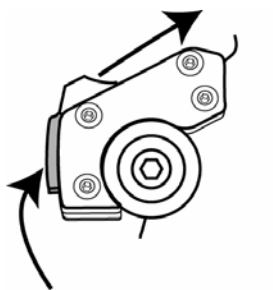

Figure 5



1. Place lower slot into lower bushing. 2. Rotate top slot into place. 3. & 4. Secure locking Mechanism.



**NOT CORRECT**

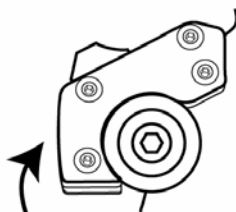

**CORRECT**  
**Fully engaged**  
**Locking mechanism**

### 2321-0154 SPORTSHIELD KIT

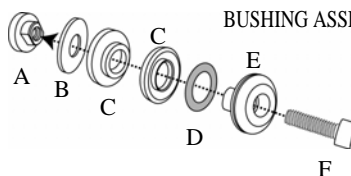

- BUSHING ASSEMBLY
- A. R329
  - B. M369
  - C. R323
  - D. R324
  - E. R318
  - F. M306

Memphis Shades warrants all product components, metal and plastic, against defects in materials and workmanship for 24 months.

**FOR PARTS AND WARRANTY HELP, CONTACT:**

MEMPHIS SHADES  
P. O. Box 429  
Rossville, TN 38066  
(901) 853-0293

Visit us on the web at [www.memphisshades.com](http://www.memphisshades.com) or

You can also reach us at  
[customerservice@memphisshades.com](mailto:customerservice@memphisshades.com)