



KINETIC GRIPS FOR 7/8" BARS & SCOUT, GLOSS BLACK

6368

Thank You For Choosing Kuryakyn!

Protect yourself and others from potential injury and property damage or loss. Pay close attention to all instructions, warnings, cautions, and notices regarding the installation, use, and care of this product.

WARNING

THIS INDICATION ALERTS YOU TO THE FACT THAT IGNORING THE CONTENTS DESCRIBED HEREIN CAN RESULT IN POTENTIAL DEATH OR SERIOUS INJURY.

NOTICE

This indication alerts you to the fact that ignoring the contents described herein may negatively affect product performance and functionality or damage the product itself or the product to which it is being attached.

ENSURE THAT THE FOLLOWING PARTS HAVE BEEN INCLUDED IN THE KIT:

- 1 Left Kinetic Grip
- 1 Right Kinetic Grip
- 2 Adhesive Tubes
- 1 Installation Instructions

YOU WILL ALSO NEED:

Utility Knife with a sharp blade, Sandpaper, Non-Permanent Marker

NOTICE

These installation instructions contain important information. Ensure that the end user receives this copy and is aware of its importance for future use.

- STEP 1** Read and understand all steps in the instructions before starting the installation. Park the motorcycle on a hard, level surface and turn **IGN OFF**. Remove the main fuse.

WARNING

THE END USER'S SAFETY DEPENDS UPON PROPER INSTALLATION OF THIS PRODUCT. IF A STEP IN THESE INSTRUCTIONS IS NOT WITHIN YOUR CAPABILITIES OR YOU DO NOT HAVE THE CORRECT TOOLS, HAVE YOUR DEALER PERFORM THE PROCEDURE. IMPROPER INSTALLATION OF THIS PRODUCT COULD RESULT IN DEATH OR SERIOUS INJURY.

ACCIDENTAL VEHICLE START-UP COULD CAUSE DEATH OR SERIOUS INJURY, REMOVE THE MAIN FUSE BEFORE PROCEEDING.

- STEP 2** Remove the existing grips. Using a razor blade or utility knife, cut the grips lengthwise from the switch housings outwards. Ensure that you do not cut through the throttle sleeve. Peel the grips away from the handlebar and throttle sleeve.

- STEP 3** Use sandpaper or emery cloth to remove all grip and adhesive residue from both the throttle sleeve (right side) and exposed handlebar (left side). If the throttle sleeve has ribbed marks or other protrusions, it will have to be sanded or ground smooth to allow the Kinetic Grip to slide into place. The surface should be completely clean and slightly roughed from sanding. Use an ammonia based cleaner and a clean rag to prepare the surfaces for adhesive.

- STEP 4** Locate the clutch-side Grip in the package; it will have a smaller inner diameter than the throttle-side Grip. Slide the Grip onto the handlebar to determine how it will be oriented when glued.

- STEP 5** Locate the throttle-side Grip; it has a slightly larger inside diameter than the clutch-side Grip. Decide if you want the throttle-side Grip's pads to match the clutch side when the bike is at rest or underway with the throttle slightly opened. Without using the included glue, slide the Grip into place and determine its position. Mark the positions of both Grips and switch housings with a non-permanent marker. Remove the Grips.

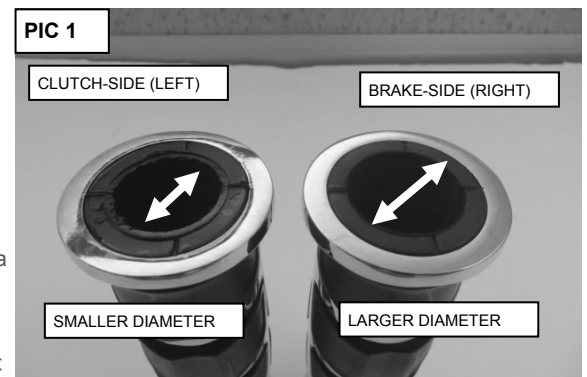



⚠ WARNING

USE EXTREME CARE WHEN USING THE GLUE INCLUDED WITH THIS KIT. READ ALL PRECAUTIONS AND AVOID CONTACT WITH SKIN OR EYES.

NOTE: The Grips should slide into place with slight resistance.

NOTICE

Avoid damage to the motorcycle. Protect painted surfaces with a soft cloth or blanket.

STEP 6 Refer to **PIC 2**. Cut a 1" hole and a slit in the backing card from the Grip package. Slide the cardboard onto the handlebar next to the switch housing. The cardboard will act as a "barrier" and should keep most of the glue that is "plowed up" away from the housing. After installing the grip, carefully pull up on the cardboard to remove it from the handlebar. Be prepared to wipe up any excess glue.

PIC 2

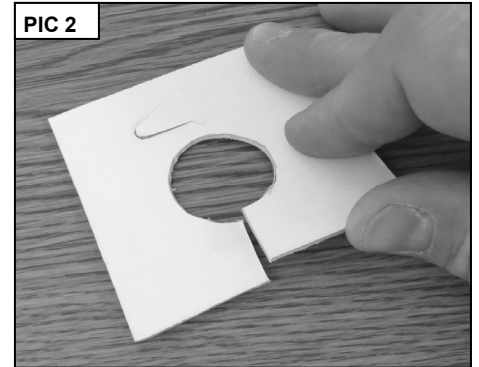

NOTICE

Be very careful not to get glue between the sleeve and the bar. This will permanently glue the bar to the sleeve, leaving it inoperable.

The included glue sets up ALMOST INSTANTLY. There is enough time to slide the grip into place, but once it stops moving, it cannot be adjusted.

STEP 7 Apply the Adhesive from one of the included tubes directly onto the THROTTLE SLEEVE. Ensure that no glue gets between the sleeve and the handlebar.

STEP 8 Slide the grip into place, rotating it clockwise as you slide it on to help distribute the glue evenly and keep the grip from "plowing up" the glue against the switch housing. Be prepared to wipe away any excess glue. Once in place, squeeze the Grip firmly to press the rubber against the bar and hold it for 15 seconds. Full bonding will occur in 24 hours.

STEP 9 Apply the Adhesive from the remaining tube onto the inner side-walls of the clutch-side Grip. Rotating the Grip while applying the adhesive will distribute it evenly. Make sure you get the glue all the way to the end of the rubber insert in the Grip

STEP 10 In one smooth motion, slide the Grip onto the end of the bar all the way into position. Rotate it clockwise as you slide it on to help distribute the glue evenly and keep the Grip from "plowing" the Adhesive up against the switch housing. Once in place, squeeze the Grip firmly to press the rubber against the bar and hold for 15 seconds. Full bonding will occur in 24 hours.

STEP 11 Reinstall main fuse.

NOTICE

It is the end user's responsibility to ensure that all fasteners (including pre-assembled) are tightened before operation of the motorcycle. Kuryakyn will not provide warranty coverage on products or components lost or damaged due to improper installation or lack of maintenance. Periodic inspection and maintenance are required on all fasteners.

LIMITED WARRANTY

Küryakyn warrants that any Küryakyn products sold hereunder, shall be free of defects in materials & workmanship for a period of one (1) year from the date of purchase by the consumer excepting the following provisions:

1. Küryakyn shall have no obligation in the event the customer is unable to provide a receipt showing the date the customer purchased the product(s).
2. The product must be properly installed, maintained & operated under normal conditions.
3. Küryakyn shall not be liable for any consequential & incidental damages, including labor & paint, resulting from failure of a Küryakyn product, failure to deliver, delay in delivery, delivery in nonconforming condition, or for any breach of contract or duty between Küryakyn & a customer.
4. Küryakyn products are often intended for use in specific applications. Küryakyn makes no warranty if a Küryakyn product is used in applications other than intended.
5. Küryakyn electrical products are warranted for one (1) year from the date of purchase by the consumer. L.E.D.'s contained in components of Küryakyn products will be warranted for defects in materials & workmanship for 3 years from the date of purchase whereas all other components shall be warranted for one (1) year.
6. Merchandise purchased directly from Internet auction sites or any other third party seller is considered sold as is & shall not carry a Küryakyn warranty. All warranty claims must be directed to the original seller. If unsure please contact the seller to verify they are an authorized Küryakyn retailer.

RETURN POLICY

Merchandise determined to be defective may be returned up to one year from the date of purchase. Returns must be processed through original seller. Returned merchandise for any other reason other than warranty claims must be in like new condition & subject to a 20% restocking fee. All returns are subject to inspection for determination of full or partial credit. Any returned part that shows evidence of being used or installed contrary to manufacturer's instructions, &/or subjected to improper handling, packaging or return shipping by the customer, will not be eligible for exchange, refund or warranty consideration. All returned electrical items will be inspected & tested. If electrical item is deemed functional, no credit will be issued & item will be returned. All sales are final on discontinued or closeout merchandise.