

EnergiVm

CE .RU MH 28269

MV12120(12V12Ah)

PHYSICAL SPECIFICATION

Nominal Voltage Nominal Capacity (20HR)		12V 12Ah
Dimension	Length	151±1mm (5.94 inches)
	Width	99±1mm (3.90 inches)
	Container Height	95±1mm (3.74 inches)
	Total Height	101±1mm (3.98 inches)
Weight		Approx. 3.47 Kg (7.64lbs)
Standard Terminal		Fasten Tab No.187E

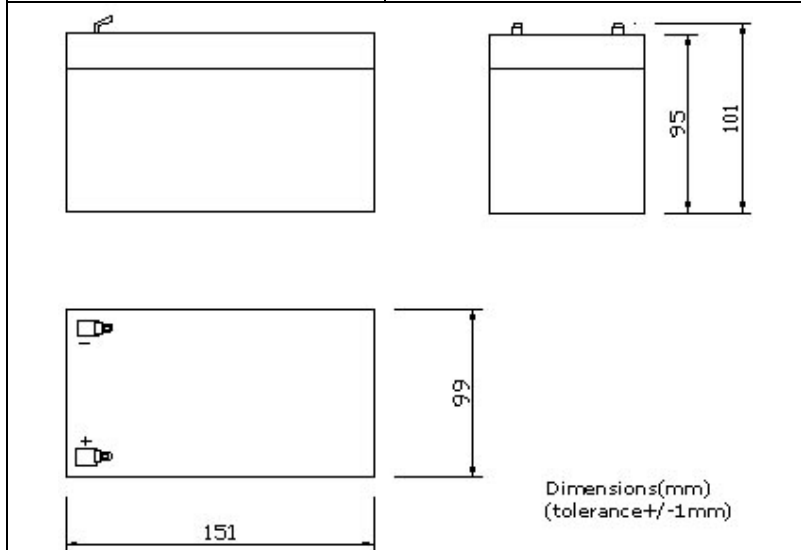

F1(Fasten Tab No.187E)
Standard Terminal

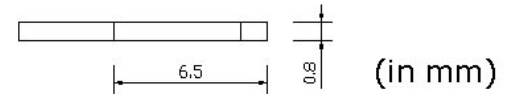
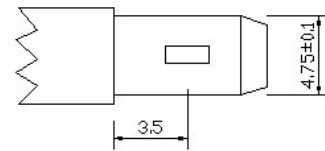

ELECTRICAL SPECIFICATION

Characteristics											
Capacity	<table border="1"> <tr> <td>20 hour rate (0.6A)</td> <td>12Ah</td> </tr> <tr> <td>10 hour rate (1.08A)</td> <td>11.4Ah</td> </tr> <tr> <td>5 hour rate (2.04A)</td> <td>10.2Ah</td> </tr> <tr> <td>3 hour rate (3.0A)</td> <td>9.0Ah</td> </tr> <tr> <td>1hour rate (7.2A)</td> <td>7.2Ah</td> </tr> </table>	20 hour rate (0.6A)	12Ah	10 hour rate (1.08A)	11.4Ah	5 hour rate (2.04A)	10.2Ah	3 hour rate (3.0A)	9.0Ah	1hour rate (7.2A)	7.2Ah
20 hour rate (0.6A)	12Ah										
10 hour rate (1.08A)	11.4Ah										
5 hour rate (2.04A)	10.2Ah										
3 hour rate (3.0A)	9.0Ah										
1hour rate (7.2A)	7.2Ah										
Capacity affected by temperature	<table border="1"> <tr> <td>40°C (104 °F)</td> <td>102%</td> </tr> <tr> <td>25°C (77 °F)</td> <td>100%</td> </tr> <tr> <td>0°C (32 °F)</td> <td>85%</td> </tr> </table>	40°C (104 °F)	102%	25°C (77 °F)	100%	0°C (32 °F)	85%				
40°C (104 °F)	102%										
25°C (77 °F)	100%										
0°C (32 °F)	85%										
Internal Resistance	Full charged battery (25°C, 77 °F) 25mΩ										
Constant Voltage Charge	Cycle Initial Charging Current less than 3.6A Voltage 14.4~15.0V at 25°C (77 °F) Temperature Coefficient -30mV/°C										
	Standby No limit on Initial Charging Current Voltage 13.5~13.8V at 25°C (77 °F) Temperature Coefficient -20mV/°C										

Discharge curves @ 25°C (77 ° F)

