

# User Guide

Human Radar Sensor

eMotion

LinknLink Pty Ltd  
 Manufacturer: Hangzhou LinknLink Technology Co., Ltd.  
 Website: www.linknlink.com  
 Service & Support: support@linknlink-iot.com  
 Address: Room 2502, Building A, 57 Jiang'er Road,  
 Binjiang, Hangzhou, 310052, P.R. China

021118V11

## 1 OVERVIEW

What's Include

eMotion×1, USB cable ×1, Reset pin×2,  
 Double side tape×1, User guide×1.

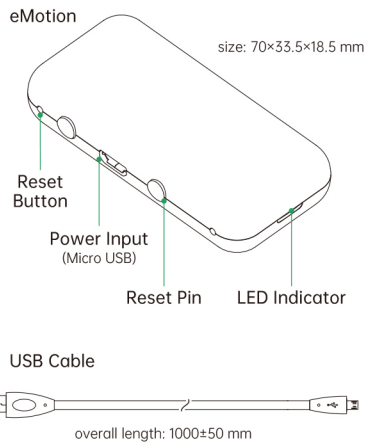

Status	Indication
Flashes intermittently	Device is in setup mode and waiting to be added
Flashes slowly then off	Device is being set up and added to network
Flashes slowly continuously	Device is failed to connect to network or disconnected from network

### • Reset for Setup

When the device is not in setup mode, take out the reset pin and use it to press and hold the Reset Button for 5s until the LED indicator flashes intermittently.

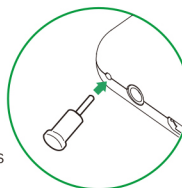

## 2 INSTALLATION STEPS

### STEP 1 Requirements

#### Wi-Fi Router with Internet Access



#### Power On

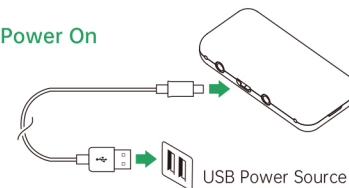

- A smartphone or tablet running iOS 9.0 / Android 5.1 or above.
- A 2.4GHz Wi-Fi network with Internet access.
- Make sure the device is on and the blue LED indicator is flashing intermittently.

## 3 LOG IN TO THE APP

### STEP 2 Get the App



- Connect your smartphone to your home Wi-Fi network (2.4GHz only).
- Open your phone's camera, point it at the QR code, download the latest "LinknLink" APP from the App Store or Google Play, and install it on your smart phone.

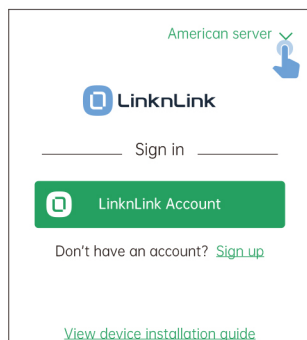

- Open the LinknLink APP, click on the server selection in the top right corner, then
- click on "LinknLink Account" and log into your cloud account.
- If you don't have an account, click "Sign up" to create a new one.

## 4 ADD DEVICE

### STEP 1 Add eMotion

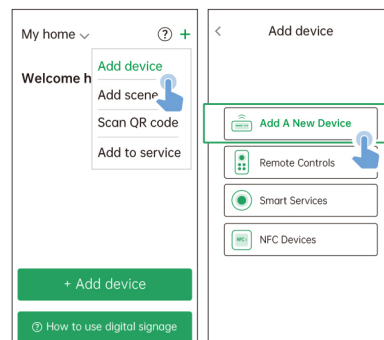

- Power on the eMotion, **making sure the indicator light is Flashing intermittently in blue.**
- Turn on your phone's Bluetooth service, click on the "+" in the top right corner -
- "Add device" - "Add a new device" - "eMotion series device" - "eMotion".
- The APP will start to automatically scan for nearby eMotion devices, which may take up to 10 seconds.

### STEP 2 Connect eMotion to Wi-Fi

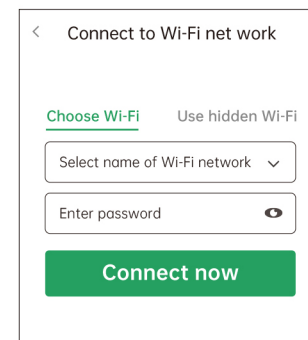

- Select your home Wi-Fi network, enter the password and click "Connect now", the LED indicator will **flash slower and then turn off.**
- Device is successfully connected.
- Choose a room and name the device.

## 5 USE EMOTION SENSOR

### STEP 1 View Status & History

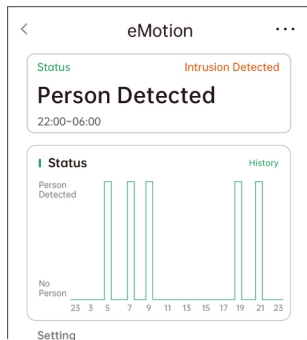

- In the LinknLink App, click on the eMotion device, you can check the real-time occupancy status (Person Detected, No Person or Continuous No Person) and quick history for last 24 hours.
- You can click "History Records" to view previous history for last 1 month.
- You can click "... " > "Export Data" and input your email to get a full history record.

### STEP 2

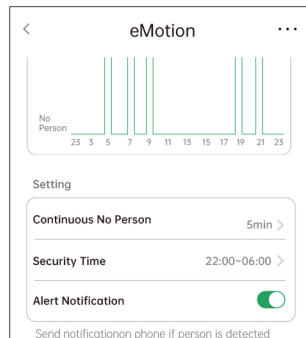

- You can set the "Security Time" and enable "Alert Notification" for intrusion alert.
- A warning sign will be displayed on device page, and you will also receive a push notification if person is detected during the security time.

### STEP 3 Add Widget on Phone

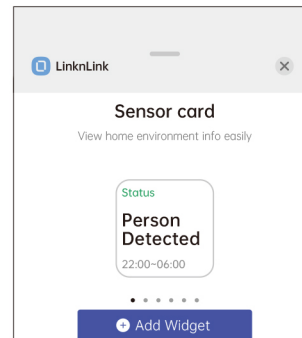

- For Android/iOS widgets, on the phone, firstly find and select the LinknLink App widget.
- Then from the device card, select the human radar sensor.
- After adding the widget to the phone's home screen, long press on it to configure.

## 6 QUERY DATA WITH MODBUS TCP

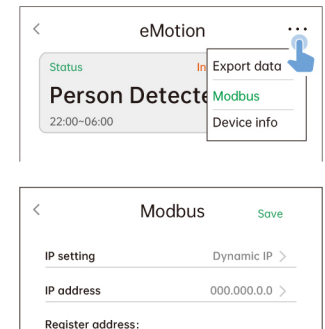

- Click "... " > "Modbus" to set a fixed IP address for eMotion and find Modbus register address.
- Use your custom software to query current sensor status via Modbus TCP protocol.

## 7 USE ALEXA / GOOGLE HOME

### STEP 1 Link to LinknLink skill

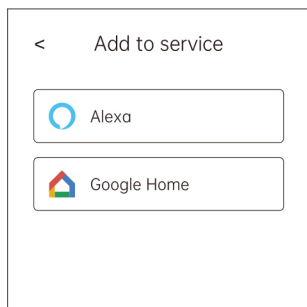

- If you're already logged into the Alexa or Google Home APP, you can now directly link to the LinknLink skill.
- On the App homepage, click on the "+" in the top right corner and select "Add Voice Assistant".
- Select "Alexa" or "Google Home", then click "Link Now".

### STEP 2 Complete and Discover Devices

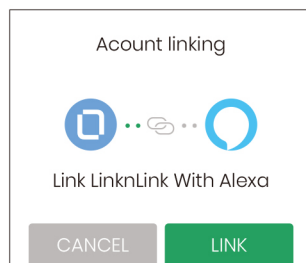

- You will be redirected to the Alexa / Google Home APP and click "Link" to complete this process.
- After successfully discovering the device, you will be able to control the device through the Alexa / Google Home APP or speaker.

## 8 HOME AUTOMATION

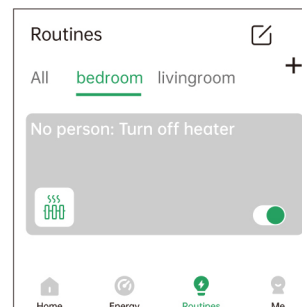

- Use the "Routines" in LinknLink App, the sensors in eHub can be used as trigger conditions, and the remote control can be used as execution device. Ex. turn off the heater when the room is continuously unoccupied.
- Similarly, use the "Routine" in Alexa / Google Home to set up the automation you need.

## FCC RADIATION EXPOSURE STATEMENT

Contains FCC ID: 2A9BE-LL8720-P  
This device complies with part 15 of the FCC rules. Operation is subject to the following two conditions:

- (1) This device may not cause harmful interference, and
- (2) this device must accept any interference received, including interference that may cause undesired operation.

Made in China

