



M.2
22x42
22x60
22x80
22x110



M.2 ↔ **M.2**
SATA NVMe



3.5" ↔ **M.2**
SATA NVMe



2.5" ↔ **M.2**
SATA NVMe

ICY BOX IB-2915MSCL-C31

Docking & CloneStation for M.2 NVMe SSD and 2.5"/3.5" SATA SSD/HDD

Key features

- Finally! Cloning from SATA to PCIe NVMe (bidirectional)
- For M.2 SATA and 2.5"/3.5" drives
- For M.2 SSDs of sizes 22x 42/60/80/110 mm
- USB 3.2 Gen 2 – high data transfer rates (up to 10 Gbit/s)
- LED for drive status and clone progress
- Quick, easy and toolless drive installation
- Cloning without computer (stand-alone)
- Use as HDD/SSD/NVMe DockingStation



Packing content

1x IB-2915MSCL-C31, 1x Power supply, 1x USB cable, 3x M.2 rubber fixation, 1x Manual

Technical data

Model	IB-2915MSCL-C31
Article no.	61017
EAN code	4250078173496
Colour	Black
Material	Plastic
Interface to host computer	USB 3.2 Gen 2 Type-C® / Type-A
Transfer rate	Up to 10 Gbit/s
Drive size	M.2, 2.5", 3.5"
	M.2 22x 42/60/80/110 mm
Drive height	Unlimited
Drive interface	SATA I,II,III (6 Gbit/s) M.2 SATA, PCIe NVMe

UASP support	Yes
Plug & Play	Yes
ON/OFF button	Yes
LED	Power, access and clone progress
Cooling	Passive
Power supply	12 V power adapter
DC-Plug dimension	5.5 x 2.1 x 10 mm (Ø outside x Ø inside x length)
Operating system	Windows®, macOS®
System requirements	One free USB 3.2 Gen 2 Type-C® or Type-A port One M.2 PCIe NVMe SSD 22x 30/42/60/80 mm One M.2/2.5"/3.5" SATA SSD/HDD



M.2
22x42
22x60
22x80
22x110



M.2 ◀ ▶ **M.2**
SATA NVMe



3.5" ◀ ▶ **M.2**
SATA NVMe



2.5" ◀ ▶ **M.2**
SATA NVMe

ICY BOX **IB-2915MSCL-C31**

Docking & CloneStation for M.2 NVMe SSD
and 2.5"/3.5" SATA SSD/HDD

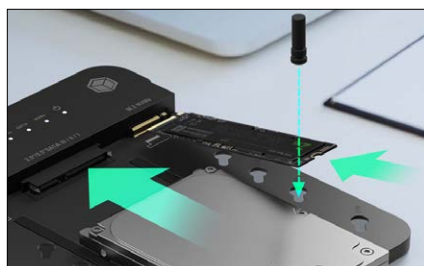

Simply clone everything

SATA to PCIe NVMe or PCIe NVMe to SATA, 2.5"/3.5" hard disks to M.2 or the other way round or M.2 to M.2: here, just anything goes with everything, and incredibly easily! The data media are installed and cloned completely without tools. The cloning direction is simply selected using a slide switch.



Cloning made easy

Bit by bit and byte by byte without complicated software. The data carriers are simply inserted into the respective slot and cloned at the touch of a button. No matter whether from M.2/2.5"/3.5" SATA to M.2 NVMe or vice versa. Bidirectional and cross-technology cloning is now really easy.



Flexible connection

Can also be used as external storage in DockingStation mode. With the included USB 3.2 Gen 2 combination cable, which is equipped with a USB Type-C® and the standard Type-A connection, the appropriate host connection can always be selected. The data races through the line at up to 10 Gbit/s.

Logistical data

Packing unit: 20 pcs. / carton
Total weight: 9.340 kg
Gross weight: (with packing): 0.429 kg
Net weight: 0.155 kg

Dimension/carton: 360x390x330 mm
Dimension (with packing): 65x145x170 mm
Dimension of article: 165x140x15 mm
Country of origin: Taiwan