

# Swing trays installation instruction

Name	T=Cabinet	Width*Depth*Height
Swing trays	900 mm	785*468*(600-730)
Swing trays	1200 mm	960*475*(600-730)

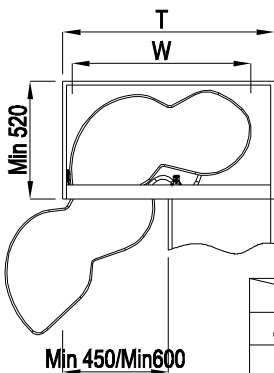

Description	Picture	Quantity
Handle support		2
Handle support		2
Peg		2
Bottom fixing glue		1
Top fixing glue		1
Drilling plate		1
ST3.5*16 tapping screw		10
ST5.0*18 tapping screw		16

	A	B	C	D
	900 mm L	411-418	Max. 450	Min. 860 600-700
	900 mm R	411-418	Max. 450	Min. 860 600-700
	1200 mm L	561-568	Max. 600	Min. 1060 600-700
	1200 mm R	561-568	Max. 600	Min. 1060 600-700

Steps 1.

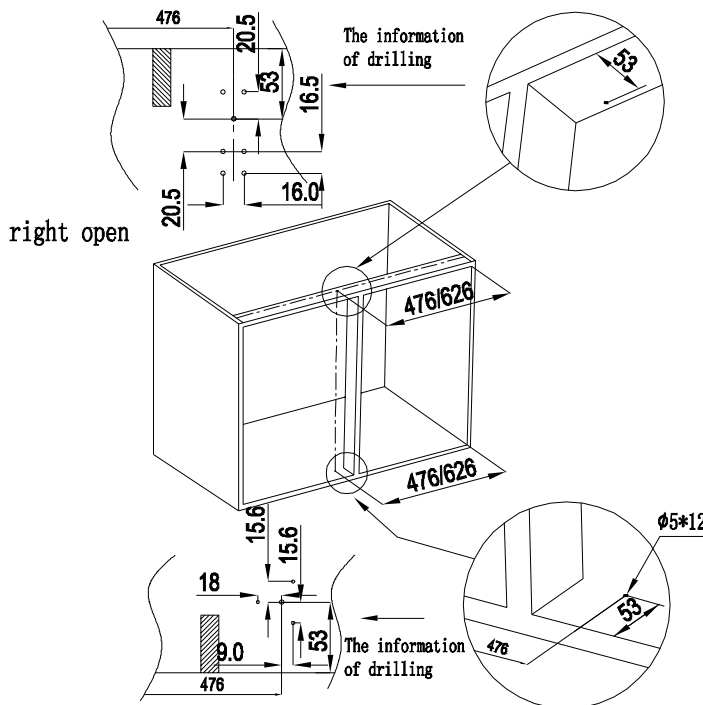
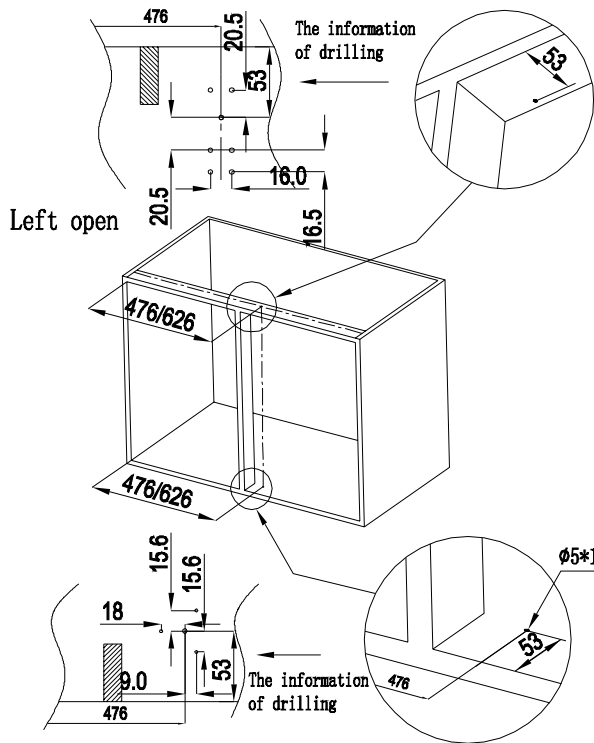
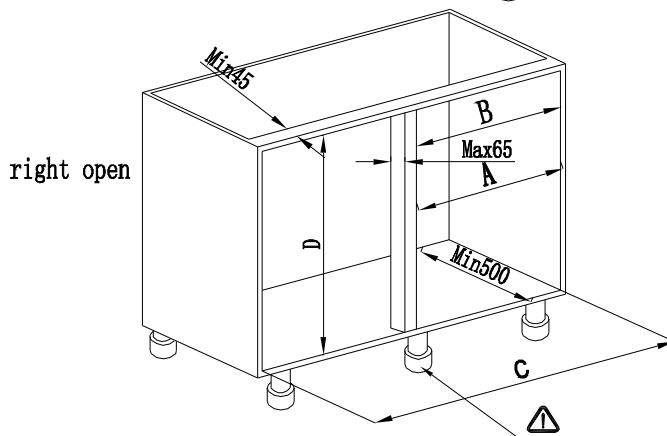
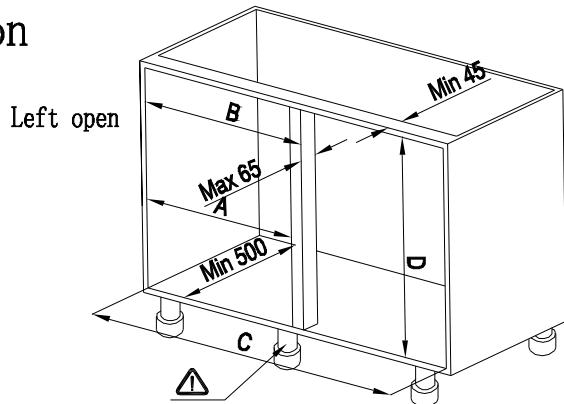

Attn: This instruction is fit for the Left open, right open is symmetry.

Steps 2.

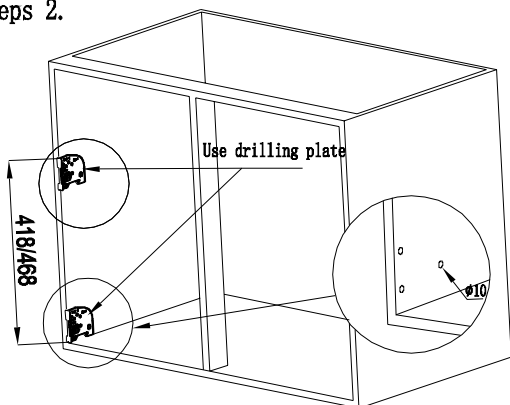

Steps 3.

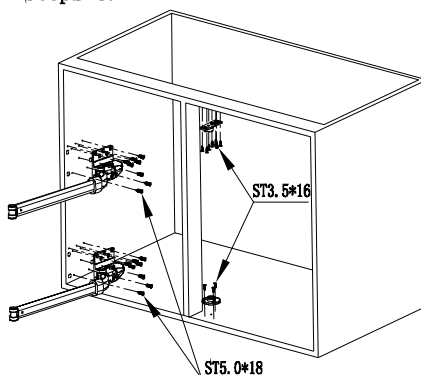

Steps 4.

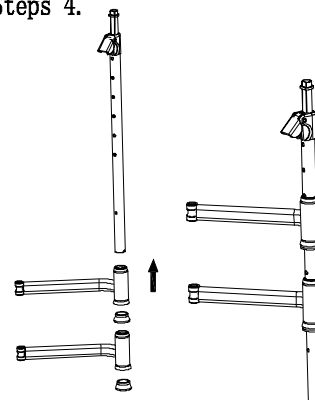

Steps 5.

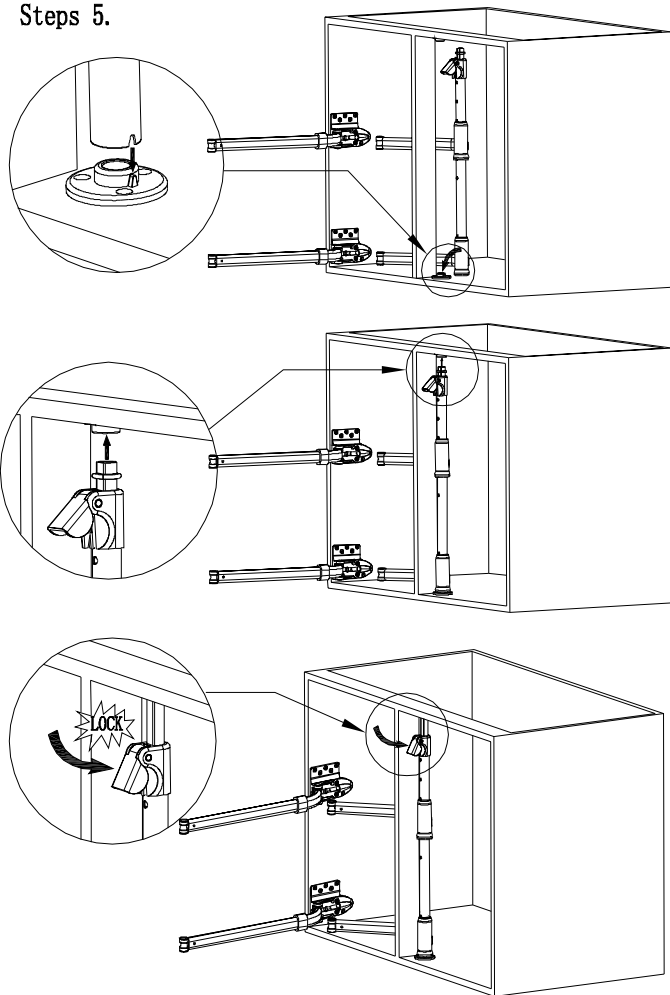

Steps 6.

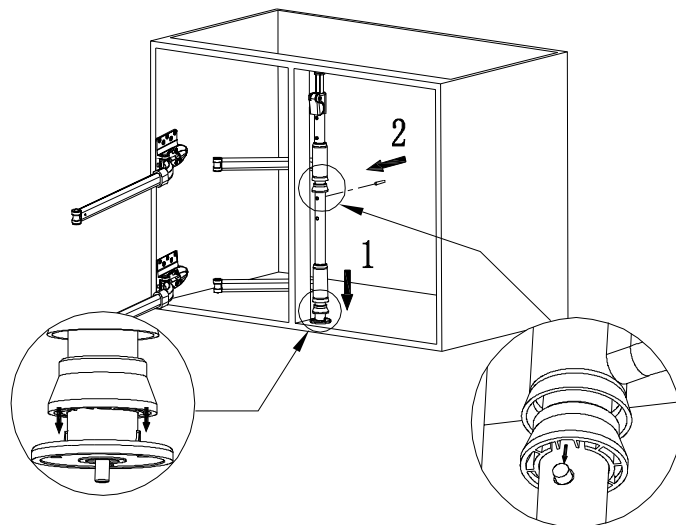

Steps 7.

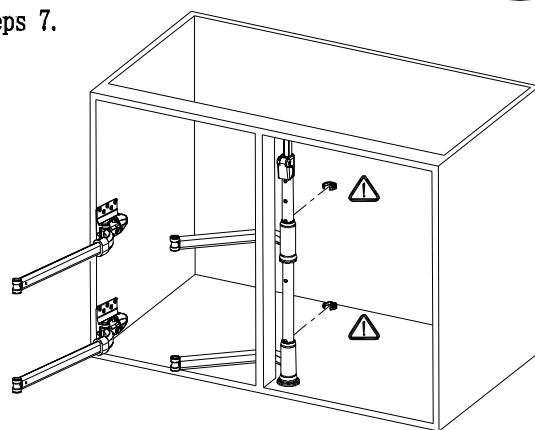

Steps 8.

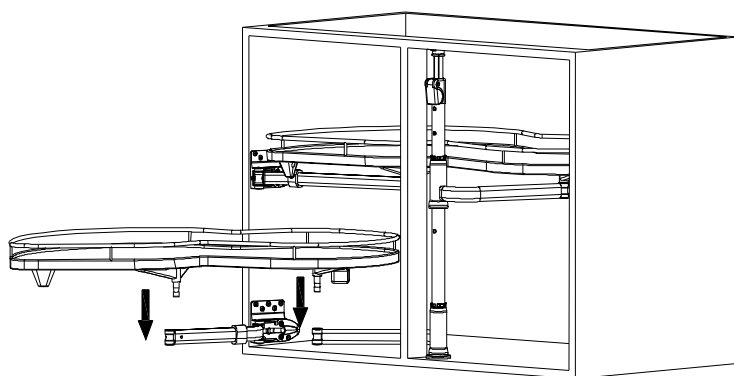

Steps 10.

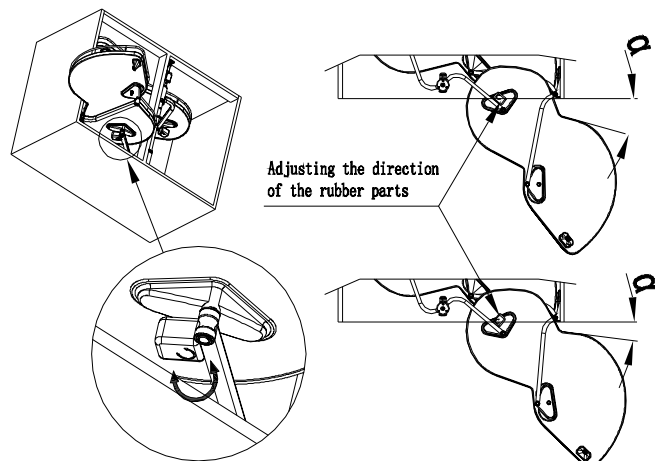

Steps 9.

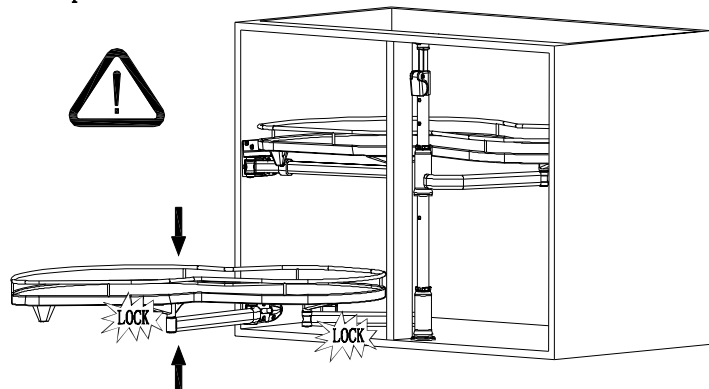

Steps 11.

