

PRESENTING OUR NEWEST INNOVATION

PARALLEL REEL PAYOUT WAGON

The Parallel Reel Payout Wagon (PRW) transports high-volume cable reels with or without additional material handling equipment. This unit features a slim profile to fit easily through 34-inch door openings, but it is sized to carry up to 5,000 pounds of product. The PRW is available with virtually any combination of reels to meet specific applications, from custom paralleling to long-term storage.

The Most Portable Parallel Reel Payout to Date

An ergonomic pivoting handle allows users to maneuver the unit around tight corners manually, while two-way fork pockets provide portability via lift truck. Heavy-duty casters move easily through narrow aisles.



Prevents Product Damage

Smooth payout and steel flanges keep wire and cable safe, even in harsh environments. Store and dispense up to 5,000 pounds of product on a single unit.



Custom Reel Configurations

Choose any combination of multi-compartment reels, or add five independent storage reels. Ideal for on-site custom paralleling, combining multiple pulls into one easy motion.



Ergonomic Features

Even payout limits musculoskeletal strain during pulls. A pivoting push/pull handle assists manual handling.



Fully Mobile

A narrow frame fits through standard doorways and narrow aisles. Position the unit manually on heavy-duty casters or transport via forklift with frame-mounted fork pockets.

CONTACT THE BHS SALES TEAM FOR MORE INFORMATION ABOUT THIS PRODUCT

Flip sheet over to learn more about this electrical solution.

 sales@bhs1.com

 **1.800.BHS.9500**

PARALLEL REEL PAYOUT WAGON

WIRE & CABLE HANDLING

Heavy-Duty Construction

2" (51 mm) solid steel center shaft equipped with locking pin

Customizable

Custom reel configurations and laser cutting available

Flexible Payout

Choose multi-compartment reels to simultaneously payout two or more lines of cable, or add a free-spinning reel for each type of conductor.

Versatile Arbor Holes

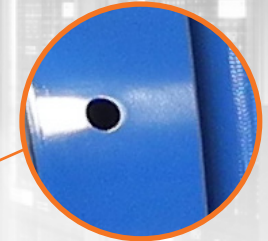

0.75", 1", and 1.13" (19 mm, 25 mm, and 29 mm) arbor holes for a variety of wire gauges

Portable Payout



Includes additional pivoting handle for navigating tight corners and narrow aisles

Stabilize Mobile Equipment

Optional floor lock keeps unit stationary when not in use

Travels Anywhere

The PRP wagon models are BHS's most mobile PRP model to date. It features casters as well as a shortened base frame designed to fit 34" (864 mm) minimum door openings with ease.

High Load Capacity

This PRP model is capable of holding up to 5,000 lb of cable

Full Mobility

Two-way fork pocket design enables transporting from the ends of the unit by forklift

Maximum Durability

2" x 4" x 0.25" (51 mm x 102 mm x 6 mm) wall tube base frame design and 0.75" (19 mm) UHMW alignment strips for center shaft prevent wear of components

Multiple Payout Options Available

The PRP wagon is the most portable model, with a pivoting push/pull handle, standard fork pockets, and a narrow, 32" width.

One 1-position free-spinning reel & one 4-position reel

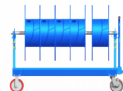

PRW-1

Two 1-position free-spinning reel & one 3-position reel

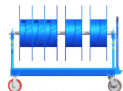

PRW-2

Three 1-position free-spinning reel & one 2-position reel

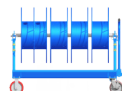

PRW-3

Two 1-position free-spinning reels

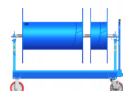

PRW-4-1

Four 1-position free spinning reels

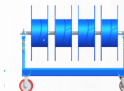

PRW-4

Five 1-position free spinning reels

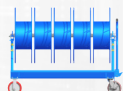

PRW-5

Model	Overall Height	Overall Width	Overall Length	Rated Load Capacity	Height with Casters
PRW	50.06" / 1272 mm	32" / 813 mm	60" / 1524 mm	5,000 lb / 2268 kg	50.06" / 1272 mm

WAGON REELS

WIRE AND CABLE HANDLING

WAGON REELS

Compatible with Parallel Reel Payout Wagon (PRW) and W-Stand-6032

Model	Description	Width	Diameter
RW-1	1 compartment reel -	10" / 254 mm	32" / 813 mm
RW-2	2 compartment reel - -	15" / 381 mm	32" / 813 mm
RW-3	3 compartment reel - - -	22" / 559 mm	32" / 813 mm
RW-4	4 compartment reel - - - -	34" / 864 mm	32" / 813 mm
RW-4-1	1 compartment reel - - -	35" / 889 mm	32" / 813 mm

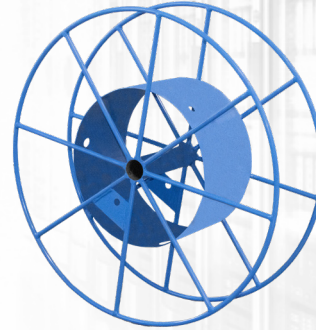

RW-1

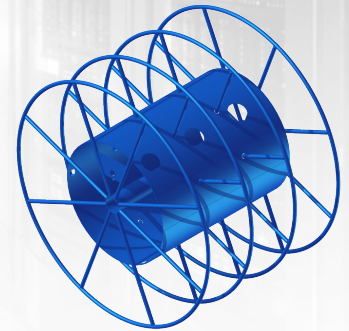

RW-3

REEL COMPARTMENT CAPACITY (REEL CAPACITY IS BASED ON 75% OF A PERFECT WIND)						
WIRE SIZE	WIRE DIAMETER (INCHES)	-	- -	- - -	- - - -	- - -
		RW-1	RW-2	RW-3	RW-4	RW-4
750 MCM	1.16	192	144	143	211	726
600 MCM	1.06	230	173	171	253	870
500 MCM	0.925	302	227	225	332	1142
400 MCM	0.842	365	274	271	400	1378
350 MCM	0.796	408	306	303	448	1542
300 MCM	0.747	464	348	344	509	1751
250 MCM	0.694	537	403	399	589	2029
4/0	0.624	664	498	494	729	2509
3/0	0.568	802	601	596	880	3029
2/0	0.518	964	723	716	1058	3641
1/0	0.474	1151	863	855	1263	4349
1 GA	0.443	1318	988	979	1446	4979
2 GA	0.381	1782	1336	1324	1955	6731
3 GA	0.35	2111	1584	1569	2317	7976
4 GA	0.322	2495	1871	1854	2737	9424
6 GA	0.253	4041	3031	3002	4434	15265
8 GA	0.216	5544	4158	4119	6083	20943
10 GA	0.164	9616	7212	7146	10551	36329
12 GA	0.131	15072	11304	11199	16537	56937
14 GA	0.112	20619	15464	15321	22623	77894
CAT5 DATA CABLE	0.215	5595	4196	4158	6139	21138

Capacity calculated with wire wrapped 1.5" from edge of reels.

WAGON REEL STAND

WIRE AND CABLE HANDLING

Narrow Models

Features a shortened base frame designed to fit through 34" (864 mm) minimum door openings for use inside an existing facility or new construction.

Wagon Style Model

W-STAND comes equipped with casters, and pivoting handle

Smooth Payout

The steel shaft rides effortlessly on 0.75" (19 mm) UHMW alignment strips to prevent wear of components

Secured Shaft

Shaft safety locks equipped with locking pin

Transport Via Forklift

W-STAND features two-way fork pockets enabling transport from the ends by forklift, allowing optimum positioning.

W-STAND

Heavy-Duty Construction

All-steel construction and a protective powder-coat finish provide a lifetime of service

Options

Additional Ground Reel (PRP-AUX)

Auxiliary reel attachment to add a single spinning reel.

Floor Lock (89822002)

Locking floor brake prevents unwanted movement of the unit.

Pull Brake Clamp (PRP-PB-C)

One drop-down self-leveling steel arm with a heavy-duty leveling rubber brake pad.

1 1/2" SHAFT (STAND-1.5)

Alternate 1.5" shaft for use with existing third-party reels

Model	Description	Overall Width	Overall Length	Capacity	Max Spool Width	Max Spool Diameter	Shaft Size	Weight
W-STAND-6032	Reel stand Includes Axle, Casters, Fork Pockets and Push/Pull Handle	32" (813 mm)	60" (1524 mm)	5,000 lb (2268 kg)	55" (1397 mm)	52" (1321 mm)	2" OD x 60" L (51 mm x 1524 mm)	312 lb (142 kg)

CREATE A TOTAL WIRE HANDLING SOLUTION

Purchase a whole Parallel Reel Payout Wagon System or individual components to address your cable handling needs.



WAGON STAND

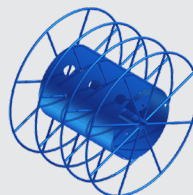

WAGON REELS

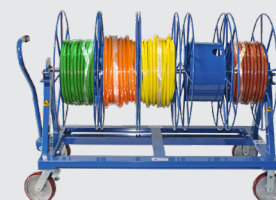

PARALLEL REEL PAYOUT WAGON