



2024 COOLING SEASON

LINEBACKER
HEAVY GRADE MOTOR RUN CAPACITOR

35 + 5 μ F \pm 5%
370/440VAC 50/60HZ
Meets US STD EIA-456A - 70°C
Rated AS SEEN ON Instagram
Externally Protected 10000 AMP

THE PRODUCTS & BRANDS
TECHNICIANS ARE TALKING ABOUT

SUPCO
TRADEFox

SOLDERWELD

PIPE VISE



TABLE OF CONTENTS

SOLDERWELD® BRAZING & SOLDERING	3-5
PIPE VISE™ PREMIUM PIPE TOOLS	6-7
AC INSTALLATION & SERVICE	8-9
AC & REFRIGERATION SERVICE	10-16
AC HARD STARTS	17-18
ELECTRONIC VACUUM GAUGES	19
BLUETOOTH® AND APP-CONNECTED METERS	20
ELECTRICAL	21-27
TRADEFOX® TECHNICIAN-INVENTED PRODUCTS	28-37
CONTROLS	38-40
DOMESTIC & COMMERCIAL REFRIGERATION	41-45
HVAC	46
INDOOR AIR QUALITY	47
CHEMICALS	48-49

NEW

SOLDERWELD® RS

Brazing Rod Saver

BRAZING ROD SAVER

- Holds and dispenses brazing rods
- Keeps fingers safe from heat
- Get the most out of each rod – use it down to the last bit!
- Works with most brazing and soldering rods, round or flat
- Fits perfectly in Solderweld® Tech Repair Kits
- Made of lightweight aluminum
- Ergonomic design

Supco® P/N

SW-RS



SOLDERWELD® BRAZING & SOLDERING



Distributed to the Wholesale HVACR market by SUPCO®

HOT BLOCK HEAT ABSORPTION PUTTY



As a 100% re-usable and non-toxic heat-absorbing putty, Hot Block will block direct and conductive heat transfer on all types of surfaces and metals including: joints, valves, fittings, composite panels, rubber, and plastics. Stops the transfer of heat up to 3000° F.

Supco® P/N

SW-HB1

1 LB ECONOMY SIZE

#BLOCKTHEBURN IN A BIG WAY.

MAGNETIC FLAME RESISTANT BLANKET



The SolderWeld® Magnetic Flame Resistant Blanket contains firm grip magnets, grommets, kevlar reinforced stitching and an opening slit so it can be easily snapped into place and removed during repairs.

Supco® P/N

SW-MFRB



Air and water tight canister helps keep all brazing material safe and in one place. All kits include Aluminum to Copper rods. Sil-Phos options also available. Orange canister holder sold separately.

HVAC ALL-IN-ONE KITS & ACCESSORIES

Supco® P/N	Description
SW-HVAK	HVAC All-In-One Brazing Kit (no Sil-Phos)
SW-HVAK00	0% Sil-Phos HVAC All-In-One Brazing Kit
SW-HVAK05	5% Sil-Phos HVAC All-In-One Brazing Kit
SW-HVAK15	15% Sil-Phos HVAC All-In-One Brazing Kit
SW-OBC	Orange Canister (EMPTY)
SW-STOBC	Rip & Grip Orange Canister Holder

ALUMINUM COIL TECH REPAIR KITS

Supco® P/N	Description
SW-ACRTB	Alum Coil Repair Tech Bag - Black
SW-ACRTC	Alum Coil Repair Tech Bag - Camo
SW-ACRTB0	Alum Coil Repair Tech Bag - Black (EMPTY)
SW-ACRTC0	Alum Coil Repair Tech Bag - Camo (EMPTY)

The most popular solution for aluminum coil repair. Convenient straps attach directly to a belt or bag.



SILVER SOLDERS

Supco® P/N	Description
SW-SS0003S	SIL SOL 0% Phos-Copper Round, 3 Rod Pack
SW-SS0028R	SIL SOL 0% Phos-Copper Round, 1 lb.
SW-SS05F1K	SIL SOL 5% Sil-Phos Flat, 1 lb.
SW-SS05F14K	SIL SOL 5% - Sil-Phos 1/2 lb Sleeve Flat
SW-SS05F3S	SIL SOL 5% Sil-Phos Flat, 3 Rod Pack
SW-SS15F1	SIL SOL 15% Sil-Phos Flat, 1 lb.
SW-SS1503S	SIL SOL 15% Sil-Phos Round, 3 Rod Pack
SW-SS1512K	SIL SOL 15% Sil-Phos 1/2 lb Sleeve Round
SW-SS1524K	SIL SOL 15% Sil-Phos Round, 1 lb.
SW-SS5602K	SIL SOL 56% Flux Coated Round, 2 Rod Pack
SW-SS5610K	SIL SOL 56% Flux Coated Round, 10 Rod Pack



Silver phosphorous rods for day-to-day copper brazing. No flux necessary. Available in flat and the highly preferred round rods with better flow for more effective joints.

The 56% flux coated rods allow for brazing of dissimilar metals such as copper to brass or stainless steel to copper.

ALUMINUM TO COPPER BRAZING

Supco® P/N	Description
SW-ALCU5.5	AL-COP Braze 8", 5 Rod Pack
SW-ALCU5K	AL-COP Braze 18", 5 Rod Pack
SW-ALCU8K	AL-COP Braze 18", 8 Rod Pack



The only Aluminum-to-Copper brazing rods on the market. Flux core is the solution to copper to aluminum transitions.

LOW TEMP DISSIMILAR METAL SOLDER

Supco® P/N	Description
SW-MS09306K	Multi Sol 18", 6 Rod Pack
SW-MS09312K	Multi Sol 18", 12 Rod Pack
SW-MS09305.5	Multi SOL 8", 5 Rod Pack
SW-MS09305K	Multi SOL 18", 5 Rod Pack
SW-MSF2	Multi SOL FLUX .7oz



350°, 20,000 PSI RATING

ALUMINUM REPAIR

Supco® P/N	Description
SW-AS09305.5	Alloy SOL 8", 5 Rod Pack
SW-AS09305K	Alloy SOL 18", 5 Rod Pack HVAC Kit
SW-AS09310K	Alloy SOL 18", 10 Rod Pack Kit Top
SW-AS09320K	Alloy SOL 18", 20 Rod Pack Kit
SW-ASF1	Alloy SOL Flux™ White Aluminum Brazing and Soldering Flux
SW-ABFC05K	Alloy Braze Flux Cored Aluminum Repair 18", 5 Rod Pack
SW-ABFC15K	Alloy Braze Flux Cored Aluminum Repair 18", 15 Rod Pack



PIPE VISE™

PIPEVISE.COM

PREMIUM PIPE TOOLS FOR PROFESSIONALS

STEEL PIPE VISES

1.5" Cap. Portable
Steel Pipe Vise



SUPCO® P/N: PV01

2" Cap. Portable
Steel Pipe Vise



SUPCO® P/N: PV02

2" Cap. Mountable
Steel Pipe Vise



SUPCO® P/N: MV02

5" Cap. Mountable
Steel Pipe Vise



SUPCO® P/N: MV05

ALUMINUM PIPE VISES

1.5" Cap. Portable
Alum. Pipe Vise



SUPCO® P/N: APV01

2" Cap. Portable
Alum. Pipe Vise



SUPCO® P/N: APV02

5" Cap. Heavy Duty Portable
Alum. Pipe Vise



SUPCO® P/N: APV05

ALUMINUM PIPE WRENCHES

1" Cap. Self Adjusting
Alum. Pipe Wrench



SUPCO® P/N: ASW7-1

3" Cap. Heavy Duty Self
Adjusting Alum. Pipe Wrench



SUPCO® P/N: ASW24-3

14" Aluminum
Pipe Wrench



SUPCO® P/N: APW14

14" Aluminum Offset
Pipe Wrench



SUPCO® P/N: OAPW14

STEEL PIPE WRENCHES

8 - 14mm Nut Capacity
Self-Adjusting Micro Wrench



MICRO 5

SUPCO® P/N: SW127-14

**SELF-ADJUSTING
RATCHETING JAWS**
FOR NUTS & BOLTS 8MM-19MM

1" Cap. Compact Self-
Adjusting Pipe Wrench



AMIGO STEEL

SUPCO® P/N: SW7-1

1" Capacity Self-Adjusting
Steel Pipe Wrench



AMIGO SLIM L

SUPCO® P/N: SW12-1S

1" Cap. Extended Leverage
Self-Adjusting
Steel Pipe Wrench



AMIGO XL

SUPCO® P/N: SW16-1

8 - 14mm Nut Capacity
Extended Reach Self-
Adjusting Micro Wrench



MICRO 10

SUPCO® P/N: SW254-14

PIPE VISE™ PREMIUM PIPE TOOLS

10" Slim Jaw Pliers

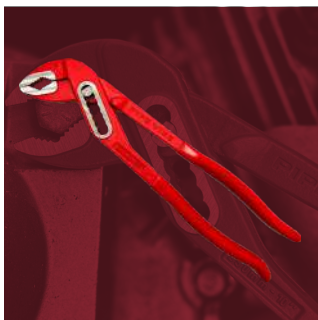

SUPCO® P/N: WPP10

Basin Wrench Socket



SUPCO® P/N: BWS-1

NEW

BRUSHES

DOPE/ACID BRUSH

Supco® P/N	Description	OAL	Filament
BRS10007	Dope/Acid Brush	7"	Horsehair
BRS10001	Acid Brush	6"	Horsehair



CHIP BRUSH

Supco® P/N		Filament
BRS67192	1"	White Natural Bristle
BRS67194	2"	White Natural Bristle
BRS67196	3"	White Natural Bristle



FIN WISK BRUSH

Supco® P/N	OAL	Filament
BRS02026	6-1/2"	Polyester



FURNACE BRUSH

Supco® P/N	OAL	Filament
BRS76200	48"	Crimped Brass
BRS76210	48"	Stainless Steel
BRS76220	48"	Grey Tampico



SCRATCH BRUSH

Supco® P/N	OAL	Filament
BRS81002	7-3/4"	Stainless Steel



CONDENSER BRUSH

Supco® P/N	OAL
BRS00408	30"



INDUSTRIAL TUBE BRUSH

Supco® P/N	OAL	Filament
BRS14518	15"	Nylon



UTILITY WIRE BRUSH

Supco® P/N	OAL	Filament
BRS81234	9.5"	Tempered Steel



BOILER BRUSH

Supco® P/N	OAL	Filament
BRS46304	48"	Spring Grade Tempered Wire
BRS14477	30"	Natural Bristle
BRS14466	30"	Crimped Carbon Steel
BRS14468	46"	Crimped Carbon Steel



FITTING BRUSH

Supco® P/N	OAL	OD	ID
BRS00924	5-3/4"	1/4"	1/8"
BRS00925	6-5/8"	3/8"	1/4"
BRS00926	6-5/8"	1/2"	3/8"
BRS00927	6-5/8"	5/8"	1/2"
BRS00928	6-5/8"	3/4"	5/8"

Supco® P/N	OAL	OD	ID
BRS00929	6-5/8"	7/8"	3/4"
BRS00931	6-5/8"	1-1/8"	1"
BRS00932	6-5/8"	1-3/8"	1-1/4"
BRS00934	6-5/8"	1-5/8"	1-1/2"
BRS00935	6-5/8"	2-1/8"	2"



2-IN-1 BRUSH

Supco® P/N	OD	ID
BRS009951	1/4"	1/8"
BRS009955	3/8"	1/4"
BRS009956	1/2"	3/8"
BRS009953	5/8"	1/2"
BRS009954	3/4"	5/8"
BRS009952	7/8"	3/4"

MINI-SPLIT CONDENSATE PUMPS



FLOWWATCH® 2

- 2-year warranty
- Can use with optional mounting kit

Supco® P/N	Volts
DE05LUB100	120 V
DE05LUB110	240 V



MOUNTING KIT

- For Siccom® mini split pumps only

Supco® P/N
GC1KFX2010



MINI-SPLIT RUN CAPACITORS



Supco® P/N	Description
RC8X450	8MFD 450V
RC10X450	10MFD 450V
RC12.5X450	12.5MFD 450V
RC15X450	15MFD 450V
RC20X450	20MFD 450V

Supco® P/N	Description
RC1X450	1MFD 450V
RC1.5X450	1.5MFD 450V
RC2X450	2MFD 450V
RC2.5X450	2MFD 450V
RC3X450	3MFD 450V
RC3.5X450	3.5MFD 450V
RC4X450	4MFD 450V
RC4.5X450	4.5MFD 450V
RC5X450	5MFD 450V
RC6X450	6MFD 450V
RC7.5X450	7.5MFD 450V

MINI-SPLIT BRACKETS

Supco® P/N	Size	Max Capacity
MB100	14.5" X 17.75"	240 lb.
MB500	19.25" X 21.63"	265 lb.
MB600	15.35" X 17"	330 lb.
MB700	18" X 18"	440 lb.



MINI-SPLIT CATCH ALL™

- Fully adjustable from 47" x 25" for wall unit, to 47" x 47" for ceiling units
- Durable construction and material for multi-use
- Includes storage and carry bag

Supco® P/N
ZCA24



MINI-FIT™ FLEXIBLE MINI-SPLIT ADAPTER

- Adapts 1/4" hose fitting to 5/16" Mini-Split R-410A fitting
- Eases access to service ports in tight fitting ductless condensing unit applications
- High Quality Brass Design with high pressure hose
- Rated for use with all refrigerants

Supco® P/N
ZMF56

LIGHT meets MIGHT



PORT-A-BLASTER®

Weighing only 11 lbs., this rugged coil cleaning machine blasts dirt from evaporator and condenser coils using a patented, pressure activated pump.

Supco® P/N
ZPB140



- Lightweight for easy carrying
- Two pressure settings for mini-split indoor coils and outdoor coils
- Includes durable quick-connect hoses, wand, and trigger sprayer
- On-board storage cabinet for all accessories
- Durable construction and rugged housing

- Volts 120 VAC
- Watts 80 W
- Flow Rate 0.25 GPM
- Max. Pressure 140 PSI
- Weight 11 lbs
- Size 12"H x 7"W x 11.5"L
- Handle 1.5"W

NEW

30" EXTENSION WAND & 90°

Supco® P/N
ZPBE90



LED MEGOHMMETER

The M500 provides fast and accurate measurements to verify the condition of the insulation.

- Zone scale to indicate insulation condition
- Measure insulation values up to 1000 megohms @ 500VAC
- Hand held
- Test leads store in case
- Operates on 2 C batteries (not included)
- Impact resistant
- Soft carrying case included

The Megohmmeter recommended by OEM for properly diagnosing inverter compressors & fan motors.

Supco® P/N
M500

CAPACITOR TESTER

With one hand operation, the MFD10 provides the fastest measurements of capacitor values.



- Rubber grips & 12" magnetic leads
- Range: 0.001μF to 9999 μF
- Auto-ranging
- Includes rugged carrying case and alligator clips

Supco® P/N
MFD10



RESIDENTIAL / LIGHT COMMERCIAL NEGATIVE PRESSURE WATERLESS TRAP



- Eliminates the geyser effect that is caused when the standard P-Trap dries out and condensate begins to form
- Requires less than half the height of a standard P-Trap.
- Operates dry except when condensate is being produced
- Will not freeze
- No sludge build-up in bottom of trap
- Easily comes apart for cleaning

Supco® P/N
FCN

RESIDENTIAL WATERLESS TRAP



- Prevents air from entering or escaping
- No more "dry-trap"
- Reduces trap height by up to 60%
- Eliminates sludge build-up

Supco® P/N	Description
RLC051	White
RLC051C	Clear

POSITIVE & NEGATIVE PRESSURE WATERLESS TRAPS

- Vertical or Horizontal mount
- Allows condensate to drain from HVAC equipment
- Prevents air from entering or escaping the system
- Operates wet or dry
- Schedule 40 Clear PVC or Schedule 40 White PVC

Supco® P/N	Horizontal	Description
PPC34V	NPC34H	3/4", CLEAR
PPC1V	NPC1H	1", CLEAR
PPC114V	NPC114H	1 1/4", CLEAR
PPC112V	NPC112H	1 1/2", CLEAR
PPW34V	NPW34H	3/4", WHITE
PPW1V	NPW1H	1", WHITE
PPW114V	NPW114H	1 1/4", WHITE
PPW112V	NPW112H	1 1/2", WHITE

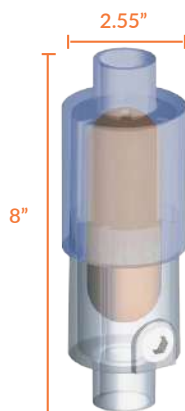

HVAC AIR-TRAP™ WATERLESS TRAPS



HVAC AIR-TRAP™ PLP-SERIES AC CONDENSATE TRAP

The PLP-051 is a new addition to Des Champs Technologies' PLP Series. A solution for lower pressures, 0-5" WC pressure, the PLP-051 requires only 2" height.



- Will never "dry out" or freeze because it does not depend on water to seal
- Eliminates sludge buildup that normally accumulates in standard "P" traps
- Does not require standing water to prevent air leakage



Supco® P/N	Connection Size	Length	Max Pos. Pressure of WC	Max Neg. Pressure of WC
PLP-051	3/4"	5.6 in	0-40 in	N/A



HOSE CLAMPS

- Made of 24 gauge stainless steel
- Uses an anodized steel hex screw

Supco® P/N	Description
CL4H	HOSE CLAMP 7/32" - 5/8"
CL6H	HOSE CLAMP 7/16" - 25/32"
CL8H	HOSE CLAMP 1/2" - 29/32"
CL10H	HOSE CLAMP 9/16" - 1 1/16"
CL12H	HOSE CLAMP 11/16" - 1 1/4"
CL16H	HOSE CLAMP 13/16" - 1 1/2"

Supco® P/N	Description
CL20H	HOSE CLAMP 13/16" - 1 3/4"
CL24H	HOSE CLAMP 1 1/16" - 2"
CL28H	HOSE CLAMP 1 5/16" - 2 1/4"
CL32H	HOSE CLAMP 1 9/16" - 2 1/2"
CL36H	HOSE CLAMP 1 13/16" - 2 3/4"
CL48H	HOSE CLAMP 2 9/16" - 3 1/2"
CL72H	HOSE CLAMP 1 7/8" - 5"



WATER GUARD

- Powered by 9V battery (not included)
- Low battery indicator
- Alarms up to 72 hours
- Floating case
- Compact design, fits around appliances
- Powerful 90dB alarm
- Responds to direct contact with water

Supco® P/N

WG1

ELECTRONIC WATER OVERFLOW ALARM



- Shuts down system in the event of water leakage
- Use in conjunction with condensate pump as an additional safety mechanism
- LED indicators: Green: normal operation; Red: alarm condition
- Hermetically sealed, waterproof housing

Supco® P/N

WGW24



JONES® VALVE CONDENSATE CLEANOUT

- Most compact size on the market
- No cutting or repairing drain line
- Single Schrader allows for one hose hook-up
- 1/4" hose connection, 3/4" condensate line

Supco® P/N

JV1



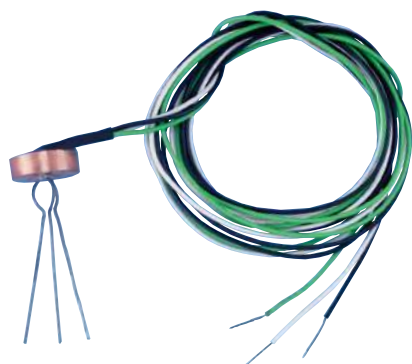

UNIVERSAL DRAIN HEATER

All SUPCO® Drain and Door Heaters are designed for continuous use to protect drains from ice build up. All of these heaters cannot be cut, spliced, extended or altered in any way.

- Cannot be cut, spliced, extended, or altered in any way
- Silicone construction
- These heaters are water resistant only, not water proof.

Supco® P/N	Volts	Watts
SH250	120	3



CONDENSATE PUMP DRAIN TUBING

- Vinyl drain tubing

Supco® P/N	Size
CPT3825	3/8 x 25'
CPT38100	3/8 x 100'



CONDENSATE PUMPS

High quality pump designed to remove condensate from AC systems, condensing furnaces and boilers, ice machines, drinking fountains, and coolers. These pumps incorporate an audible alarm, and an overflow switch that can be used to shut down the system.

- 1/4" quick connect terminals
- 3/8" rubber ball check valve
- 22 feet of standard lift @ 10 GPH
- 3 inlet holes
- 3 terminals provided for easy connection
- 6 foot power cord included
- Independent NC safety switch & motor switch
- Independent NO audible alarm switch rated @ 80 dB
- Metal side mount tabs, 11.5" on center
- Specially designed leak-free motor and safety float
- Suitable for acidic condensate
- Vibration absorbing feet

Supco® P/N	Volts
SPCP115	115
SPCP230	230



CONDENSATE DRAIN HEATERS

Supco® P/N	Volts	Watts	Size	Leads
SH500	120	11	9"	18"
SH502	120	15	13"	18"
SH503	240	15	13"	18"
SH504	120	25	21"	18"
SH505	240	25	21"	18"

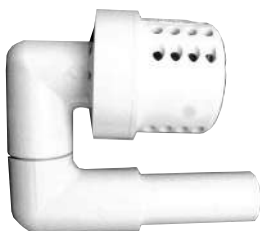

DRAIN PLUS CONDENSATE DRAIN

- Eliminates "dry-trap" Syndrome
- Fits 3/4" drain lines

Supco® P/N
DP34



SLIMEOUT® CONDENSATE PAN CONDITIONING TABS

Supco® P/N	Description	Tablets/Jar
SO100	Slime Out	100
ST200	Slime Tab	200

LIQUID LINE FILTER DRIERS



FLARE SAE

Supco® P/N	Supco® P/N
LLD032	LLD084
LLD052	LLD163
LLD053	LLD164
LLD082	LLD165
LLD083	LLD304

SOLDER ODF

Supco® P/N	Supco® P/N
LLD032S	LLD163S
LLD052S	LLD164S
LLD053S	LLD165S
LLD082S	LLD304S
LLD083S	LLD305S
LLD084S	LLD306S
	LLD307S

HP SERIES BI-DIRECTIONAL



FLARE SAE

Supco® P/N
HP083
HP163
HP164
HP165

SOLDER ODF

Supco® P/N
HP083S
HP163S
HP164S
HP165S

SSLD SERIES SUCTION LINE DRIERS

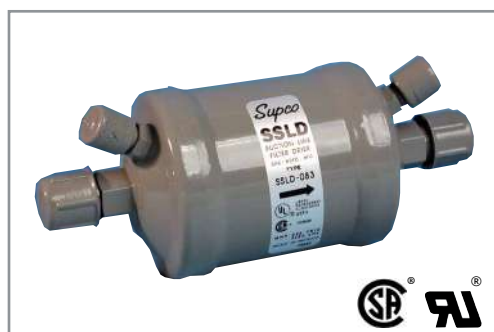

FLARE SAE

Supco® P/N	Supco® P/N	Supco® P/N
SSLD85	SSLD83S	SSLD167S
SSLD164	SSLD84S	SSLD307S
SSLD305	SSLD85S	SSLD305S
SSLD83	SSLD165S	SSLD306S
	SSLD166S	SSLD309S
		SSLD419S

SOLDER ODF

CSLD SERIES COMPACT SUCTION LINE DRIERS



SOLDER ODF

Supco® P/N
CSLD1454
CSLD1456
CSLD1457
CSLD1459

DRIERS WITH UV DYE & MAGNETIC FILTERS



Supco® P/N	Replaces
SUD8358	5303918288 & more



SPUN SERIES COPPER DRIERS



Supco® P/N	Supco® P/N
SUD103	SUD113
SUD109	SUD114
SUD110	SUD115
SUD111	SUD116
SUD112	

SPUN COPPER STRAINERS

Specifically Designed for Re-opened Systems. Each Strainer Contains an Oversized Screen Area for Filtering Large Quantities of burnt out Foreign Matter from System.

Supco® P/N	Inlet	Outlet	OAL	O.D.	Feed
S210	1/4"	.098 Cap Tube	2 3/4"	3/4"	1
S211	1/4"	.125 Cap Tube	2 3/4"	3/4"	1
S212	1/4"	1/4" Copper Tube	2 3/4"	3/4"	1
S214	3/8"	.125 Cap Tube	4 1/2"	5/8"	2
S215	3/8"	.125 Cap Tube	4 1/2"	5/8"	3
S216	3/8"	3/8" Copper Tube	4 1/2"	5/8"	1
S218	3/8"	.125 Cap Tube	4 1/2"	5/8"	1
S219	3/8"	.146 Cap Tube	5"	7/8"	4
S220	3/8"	.112 Cap Tube	4 1/2"	7/8"	6
MD5	1/4"	Cap	1"		



ALLIN LIQUID EYE® SIGHT GLASSES

- Unique "See-Thru" feature that is more readable than other Sight Glasses
- Solid Brass Body
- Shock Resistant Glass
- Available in Flare or Solder
- Color Bar Designed for HFC Refrigerants



ALLIN LIQUID EYE® MOISTURE REACTORS

- Easy to Read in Minimal Light
- When Moisture is Present, the Color Bars on the Band within the Tube Change Color
- Solid Brass Body
- Shock Resistant Glass
- Available in Flare or Solder
- Color Bar Designed for HFC Refrigerants

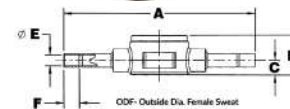

SSG SERIES MOISTURE INDICATOR

- 3% relative humidity sensitivity
- Maximum Working Pressure (MWP): 680 PSIG

VIBRATION ABSORBERS

Supco® P/N	Tube Size O.D.	Length	Max Working Pressure PSI
VAS-218	2 1/8"	20 1/2"	390
VAS-158	1 5/8"	16 3/4"	500
VAS-138	1 3/8"	15 1/2"	500
VAS-118	1 1/8"	13"	500
VAS-078	7/8"	11 7/8"	500
VAS-034	3/4"	10 1/2"	500
VAS-058	5/8"	9 3/4"	500
VAS-012	1/2"	8 7/8"	500
VAS-038	3/8"	8 1/2"	500
VAS-014	1/4"	8"	500



- Unique proven design for high pressure applications rated for R410A
- Compatible with all refrigerants
- Burst pressure 2500 (psig)
- 100% helium and hydrogen leak tested



LINE DRIVER CO₂ DRAIN LINE GUN

Easy to carry drain line gun makes clearing clogged drain lines a breeze. Just load a cartridge, pull the trigger, and watch the line clear.

- Compact, portable design
- High pressure CO₂ cartridges deliver 800 PSI
- Flexible hose

Supco® P/N

DLG-1



LINE DRIVER CO₂ SMOOTH CARTRIDGES

ESP™ CO₂ cartridges pack a punch at a great price and are compatible with all industry drain line guns.

- Sold in packs of 12
- 12 Pack Threaded Cartridges Also Available

Supco® P/N	Description
CO2-12	12 Pack - Smooth
CO2-12T	12 Pack - Threaded

WE OFFER OVER 340 SKUS OF V-BELT TYPES

All belts clearly identify RMA classic part number and dimensionally equivalent FHP number.

See the full offering at supco.com, search keyword "Belt"

MULTI-PLUS DUAL BRAND V-BELTS

3L SECTION FHP V BELTS

- 3/8" top width
- 7/32" thick

A SECTION CLASSICAL V BELTS

- 1/2" top width
- 11/32" thick
- Dual brand A & 4L

B SECTION CLASSICAL V BELTS

- 21/32" top width
- 13/32" thick
- Dual brand B & 5L



As the Pioneer of the Two-Wire Hard Start Kit, SUPCO offers a Hard Start technology to meet every system need and budget.

HOW TO CHOOSE THE RIGHT HARD START KIT:

SYSTEMS WITH FIXED ORIFICES

PTC Technology | 2-Wire Only



- ✓ EASY TWO-WIRE INSTALLATION
- ✓ INCREASES TORQUE UP TO 600%
- ✓ LOW COST & DURABLE

Supco® P/N	Increase In Torque
SPP	250%
SPP5	300%
SPP6	500%
SPP7S	600%



E146162



SYSTEMS WHERE A TXV IS USED

Mechanical Potential Relay Technology | **2-Wire**



- ✓ EASY TWO-WIRE INSTALLATION
- ✓ INSTANT RECYCLING
- ✓ ALSO AVAILABLE WITH RELAY COVER
- ✓ TWO KITS COVER SYSTEMS UP TO 5 TONS

Supco® P/N	Application	Capacitor Size (μF)	Can Substitute for Kickstart®
WITHOUT RELAY COVER			
SPR5	1 – 3 ton	189-227 μF	TO-5
SPR1	3.5 – 5 ton	270-324 μF	KS-1
WITH RELAY COVER			
MPR5	1 – 3 ton	189-227 μF	TO-5
MPR1	3.5 – 5 ton	270-324 μF	KS-1

SYSTEMS WHERE A TXV IS USED

Mechanical Potential Relay Technology | **3-Wire**



- ✓ EZ-SNAP BRACKET INCLUDED FOR MOUNTING
- ✓ THREE-WIRE MOST SIMILAR TO OEM STYLE
- ✓ CHOOSE A CLOSELY MATCHED RELAY AND CAPACITOR

Supco® P/N	Application	Capacitor Size (μF)	Can Substitute for 5-2-1®
3W1	1 – 3 ton	88 – 108 μF	CSRU1
3W2	3.5 – 5 ton	189 – 227 μF	CSRU2
3W3	4 – 5 ton	270 – 324 μF	CSRU3

2 PARTS REPLACE 1-5 TONS - 3W1, 3W2

SYSTEMS WHERE A TXV IS USED

Electronic Potential Relay Technology | **2-Wire Only**



- ✓ EASY TWO-WIRE INSTALLATION
- ✓ ONE KIT (SPP8E) COVERS 1 TON AND UP
- ✓ BACKUP SAFETY TIMER PROTECTS COMPRESSOR FROM OVERHEATING

Supco® P/N	Application	Capacitor Size (μF)
SPP6E	1/2 – 3 hp	88-106 μF
SPP7E	1 – 4 hp	130-156 μF
SPP8E	1 – 5 hp	189-227 μF
SPP10E	3 hp and up	270-324 μF

References to original equipment and other manufacturers' names, models, trademarks and part numbers are used for identification purposes only and SUPCO® replacement products are not in any way affiliated, endorsed or sponsored by such manufacturers.

DIGITAL VACUUM GAUGE

- Ultra Fine Resolution
- Easy-to-Clean LIFETIME Sensor Never Needs Replacing
- Reads Vacuum in 7 International Units
- Display Updates Every 1/2 Second
- Convenient Built in magnetic holding strap
- Low Battery Indicator
- Power Source: 3 AA Batteries (not included)
- Auto Shutoff

Supco® P/N

VG64



SUPCO® BLUETOOTH® VACUUM GAUGE

- Remote Bluetooth® monitoring from up to 200 ft. away
- Revolutionary contaminant and oil resistant Lifetime Sensor
- Record and export the evacuation process to PDF/Excel/CSV
- Includes vacuum coupler and convenient magnetic holding strap

Supco® P/N

VG640TL



POWERED BY MEASUREQUICK



Scan to download
the FREE Supco®
TechLink™ app to
easily document
system evacuations.

ELECTRONIC VACUUM GAUGE

10 Segment Color Coded LED Readout Provides Fast Response of Vacuum Measurements

- Pocket Size - Only 5 1/2" x 1 3/4" x 1 1/2"
- Cleanable Sensor
- Single Switch Operation
- Built-in Hanger
- Soft Case Included

Supco® P/N

VG60



VACUUM GAUGE COUPLER FOR ALL VACUUM GAUGES

- 1/4" Female flare connections
- Brass construction

Supco® P/N

VGC





SUPCO®-REDFISH WIRELESS CLAMP METER

Measure AC Volts, AC Amps, system kW and the power factor. Use App-captured data to discuss system operating costs on jobs.

- Bluetooth® connectivity via BTLE (v4.0)
- Tested to IEC/EN61010 safety standards 600V CATIV and 1000V CATIII
- Advanced application diagnostics and guided tests
- Includes line splitter, test leads, carry bag, alligator clip and 9V battery

Supco® P/N

iDVM550

WORKS WITH

measureQuick



**SUPCO®
TECHLINK™**
POWERED BY MEASUREQUICK



SUPCO®-REDFISH WIRELESS MULTIMETER

Use the Supco® TechLink™ App for guided tests for capacitors, flame sensors, electrical circuits and systems.

- Bluetooth® connectivity via BTLE (v4.0)
- True RMS
- Ingress Protection – IP54 protects from dirt and splashed water
- 6,000 count (3-3/4 digit) resolution
- Advanced application diagnostics and guided tests
- Includes, test leads and 9V battery

Supco® P/N

iDVM510

WORKS WITH

measureQuick

GET A LINEBACKER® ON YOUR TEAM.



Introducing

LINEBACKER®

OEM-GRADE MOTOR RUN CAPACITORS

A Supco® BRAND

Sure to catch an eye on the shelf, the Linebacker® is designed to reduce inventory, perform like its OEM counterparts and save you money.

ELECTRICAL

NEVER SETTLE FOR JUST GOOD ENOUGH

Linebacker® Motor Run Capacitors are built for longevity and performance. Engineered by an ISO certified manufacturer with over twenty years' experience in OEM capacitor fabrication, Linebacker® capacitors come off the same production line as the OEM and are 100% in-line production tested to the same rigorous international standards.

Built Tough | Meets EIA-456A accelerated life test at 70° C for 60,000 hours

Works Harder | Life tested to 85° C operating temperature for 10,000 cycles

Approved | US and Canada UL approved (C22.2NO.190)

Protected | 10,000 AFC pressure sensitive short circuit interrupting capability

Tested | Continuous life tested, oil leak tested and dielectric tested for insulation effectiveness

THE GUTS TO GET IT DONE.

Linebacker® capacitors are manufactured with thick polypropylene foil to handle increased operating temperatures and PCB-free oil to prevent over-heating.

Voltage	Up to 440 VAC
Standard Tolerance	+/- 5%
Operating Temperature	-40° C to 85° C
Foil Thickness	6.0 µm +/- 5%

SLIM YOUR STOCK

(Trust us, **it works.**)

A common misconception is that you must have a 370V capacitor to replace a 370V capacitor. However, the voltage rating on a run capacitor displays the voltage that should not be exceeded. Stocking Linebacker® capacitors means with less parts you can handle applications up to 440V, so those 370V applications are good to go. Now you can start making plans for that extra shelf space you've just gained.

WE'VE GOT YOUR BACK.

Premium performance, not price.

SUPCO's long-standing reputation in manufacturing and sourcing allows us to offer a top-grade capacitor at extremely competitive market prices.

3 Year Warranty.

We stand behind the quality and performance of the Linebacker® with a 3-year warranty from the date of purchase.



SINGLE ROUND

Supco® P/N	MF Rating
LCR2X440R	2 MFD X 440V
LCR3X440R	3 MFD X 440V
LCR4X440R	4 MFD X 440V
LCR5X440R	5 MFD X 440V
LCR6X440R	6 MFD X 440V
LCR7.5X440R	7.5 MFD X 440V
LCR10X440R	10 MFD X 440V
LCR12.5X440R	12.5 MFD X 440V
LCR15X440R	15 MFD X 440V
LCR17.5X440R	17.5 MFD X 440V
LCR20X440R	20 MFD X 440V
LCR25X440R	25 MFD X 440V
LCR30X440R	30 MFD X 440V
LCR35X440R	35 MFD X 440V
LCR40X440R	40 MFD X 440V
LCR45X440R	45 MFD X 440V
LCR50X440R	50 MFD X 440V
LCR55X440R	55 MFD X 440V
LCR60X440R	60 MFD X 440V
LCR70X440R	70 MFD X 440V
LCR80X440R	80 MFD X 440V
LCR90X440R	90 MFD X 440V

SINGLE OVAL

Supco® P/N	MF Rating
LCR2X440	2 MFD X 440V
LCR2.5X440	2.5 MFD X 440V
LCR3X440	3 MFD X 440V
LCR4X440	4 MFD X 440V
LCR5X440	5 MFD X 440V
LCR6X440	6 MFD X 440V
LCR7.5X440	7.5 MFD X 440V
LCR10X440	10 MFD X 440V
LCR12.5X440	12.5 MFD X 440V
LCR15X440	15 MFD X 440V
LCR17.5X440	17.5 MFD X 440V
LCR20X440	20 MFD X 440V
LCR25X440	25 MFD X 440V
LCR30X440	30 MFD X 440V
LCR35X440	35 MFD X 440V
LCR40X440	40 MFD X 440V
LCR45X440	45 MFD X 440V
LCR50X440	50 MFD X 440V
LCR55X440	55 MFD X 440V
LCR60X440	60 MFD X 440V
LCR65X440	65 MFD X 440V
LCR70X440	70 MFD X 440V
LCR75X440	75 MFD X 440V
LCR80X440	80 MFD X 440V

DUAL ROUND

Supco® P/N	MF Rating
LCD10+5X440R	10+5 MFD X 440V
LCD15+5X440R	15+5 MFD X 440V
LCD20+5X440R	20+5 MFD X 440V
LCD20+15X440R	20+15 MFD X 440V
LCD25+3X440R	25+3 MFD X 440V
LCD25+5X440R	25+5 MFD X 440V
LCD25+7.5X440R	25+7.5 MFD X 440V
LCD25+10X440R	25+10 MFD X 440V
LCD25+15X440R	25+15 MFD X 440V
LCD30+3X440R	30+3 MFD X 440V
LCD30+4X440R	30+4 MFD X 440V
LCD30+5X440R	30+5 MFD X 440V
LCD30+7.5X440R	30+7.5 MFD X 440V
LCD35+3X440R	35+3 MFD X 440V
LCD35+4X440R	35+4 MFD X 440V
LCD35+5X440R	35+5 MFD X 440V
LCD35+6X440R	35+6 MFD X 440V
LCD35+7.5X440R	35+7.5 MFD X 440V
LCD35+10X440R	35+10 MFD X 440V
LCD40+3X440R	40+3 MFD X 440V
LCD40+4X440R	40+4 MFD X 440V
LCD40+5X440R	40+5 MFD X 440V
LCD40+6X440R	40+6 MFD X 440V
LCD40+7.5X440R	40+7.5 MFD X 440V
LCD40+10X440R	40+10 MFD X 440V
LCD45+3X440R	45+3 MFD X 440V
LCD45+4X440R	45+4 MFD X 440V
LCD45+5X440R	45+5 MFD X 440V
LCD45+6X440R	45+6 MFD X 440V

Supco® P/N	MF Rating
LCD10+5X440	10+5 MFD X 440V
LCD15+4X440	15+4 MFD X 440V
LCD15+5X440	15+5 MFD X 440V
LCD20+5X440	20+5 MFD X 440V
LCD20+15X440	20+15 MFD X 440V
LCD25+5X440	25+5 MFD X 440V
LCD25+7.5X440	25+7.5 MFD X 440V
LCD25+10X440	25+10 MFD X 440V
LCD30+4X440	30+4 MFD X 440V
LCD30+5X440	30+5 MFD X 440V
LCD30+7.5X440	30+7.5 MFD X 440V
LCD30+10X440	30+10 MFD X 440V
LCD35+3X440	35+3 MFD X 440V
LCD35+4X440	35+4 MFD X 440V
LCD35+5X440	35+5 MFD X 440V
LCD35+7.5X440	35+7.5 MFD X 440V
LCD35+8.5X440	35+8.5 MFD X 440V

Supco® P/N	MF Rating
LCD45+7.5X440R	45+7.5 MFD X 440V
LCD45+10X440R	45+10 MFD X 440V
LCD50+5X440R	50+5 MFD X 440V
LCD50+7.5X440R	50+7.5 MFD X 440V
LCD50+10X440R	50+10 MFD X 440V
LCD50+12.5X440R	50+12.5 MFD X 440V
LCD55+5X440R	55+5 MFD X 440V
LCD55+7.5X440R	55+7.5 MFD X 440V
LCD55+10X440R	55+10 MFD X 440V
LCD60+3X440R	60+3 MFD X 440V
LCD60+5X440R	60+5 MFD X 440V
LCD60+7.5X440R	60+7.5 MFD X 440V
LCD60+10X440R	60+10 MFD X 440V
LCD60+12.5X440R	60+12.5 MFD X 440V
LCD60+15X440R	60+15 MFD X 440V
LCD65+5X440R	65+5 MFD X 440V
LCD65+10X440R	65+10 MFD X 440V
LCD70+5X440R	70+5 MFD X 440V
LCD70+7.5X440R	70+7.5 MFD X 440V
LCD70+10X440R	70+10 MFD X 440V
LCD75+5X440R	75+5 MFD X 440V
LCD75+7.5X440R	75+7.5 MFD X 440V
LCD75+10X440R	75+10 MFD X 440V
LCD80+5X440R	80+5 MFD X 440V
LCD80+7.5X440R	80+7.5 MFD X 440V
LCD80+10X440R	80+10 MFD X 440V
LCD85+5X440R	85+5 MFD X 440V
LCD85+7.5X440R	85+7.5 MFD X 440V
LCD85+10X440R	85+10 MFD X 440V

Supco® P/N	MF Rating
LCD35+10X440	35+10 MFD X 440V
LCD40+3X440	40+3 MFD X 440V
LCD40+5X440	40+5 MFD X 440V
LCD40+7.5X440	40+7.5 MFD X 440V
LCD45+5X440	45+5 MFD X 440V
LCD45+7.5X440	45+7.5 MFD X 440V
LCD50+5X440	50+5 MFD X 440V
LCD50+7.5X440	50+7.5 MFD X 440V
LCD55+5X440	55+5 MFD X 440V
LCD55+10X440	55+10 MFD X 440V
LCD60+5X440	60+5 MFD X 440V
LCD60+7.5X440	60+7.5 MFD X 440V
LCD65+7.5X440	65+7.5 MFD X 440V
LCD65+10X440	65+10 MFD X 440V
LCD80+5X440	80+5 MFD X 440V
LCD80+7.5X440	80+7.5 MFD X 440V
LCD80+10X440	80+10 MFD X 440V

ELECTRICAL



DEFINITE PURPOSE CONTACTORS

- Silver cadmium oxide contacts
- Compact universal design and interchangeable mounting plate allow for easy replacement of most brands.
- Space saving dimensions
- Economically priced



1.5 POLE

Supco® P/N	Full Load Amps	Coil Voltage
DP25241	25	24
DP251201	25	120
DP252401	25	240
DP30241	30	24
DP301201	30	120
DP302401	30	240

2 POLE

Supco® P/N	Full Load Amps	Coil Voltage
DP20242	20	24
DP201202	20	120
DP202402	20	240
DP25242	25	24
DP251202	25	120
DP252402	25	240
DP30242	30	24
DP301202	30	120
DP302402	30	240
DP40242	40	24
DP401202	40	120
DP402402	40	240

3 POLE

Supco® P/N	Full Load Amps	Coil Voltage
DP25243	25	24
DP251203	25	120
DP252403	25	240
DP254803	25	480
DP30243	30	24
DP301203	30	120
DP302403	30	240
DP304803	30	480
DP40243	40	24
DP401203	40	120
DP402403	40	240
DP404803	40	480
DP50243	50	24
DP501203	50	120
DP502403	50	240
DP60243	60	24
DP601203	60	120
DP602403	60	240
DP75243	75	24
DP751203	75	120
DP752403	75	240
DP90243	90	24
DP901203	90	120
DP902403	90	240



2 POLE MAGNETIC LINE CONTACTOR

- Non-Positional
- Replaces Mars® 18001 (exact) and Honeywell® R850B1146, Packard® C18001
- Includes 4 Terminals and 4 Screws
- UL® File Number E328772



Supco® P/N
SMC11



3 POLE AUXILIARY SWITCH FOR CONTACTORS

Add additional load switching capability for low load accessories.

Supco® P/N	Contactor	Current	Switch Action
DPAUX1	25A to 40A	10A at 300 VAC	SPDT (1)
DPAUX2	25A to 40A	10A at 300 VAC	SPDT (2)
DPAUX3	25A to 40A	10A at 600 VAC	(1) SPNO, (1) SPNC
DPAUX4	25A to 40A	10A at 600 VAC	SPNO (2)
DPAUX5	50A to 60A	10A at 300 VAC	SPDT (1)
DPAUX6	75A to 90A	10A at 300 VAC	SPDT (2)

References to original equipment and other manufacturers' names, models, trademarks and part numbers are used for identification purposes only and SUPCO® replacement products are not in any way affiliated, endorsed or sponsored by such manufacturers.

ELIMINATE UNNECESSARY SKUS & SAVE SHELF SPACE

WITH OUR WIRE-TO-WIRE UNIVERSAL POTENTIAL RELAYS

DROP-IN



OR

DIAL-IN



UNIVERSAL POTENTIAL RELAYS

SUPR

ADJUSTABLE POTENTIAL RELAYS

APR5

Time Function	RELAY TYPE	Adjustable Voltage Sensing
Electronic Potential Relay (EPR)	RELAY TECHNOLOGY	Electronic Potential Relay (EPR)
1.0 to 1.5 Seconds	SAFETY TIMEOUT	1.0 to 1.5 Seconds
110 - 270 VAC	OPERATING VOLTAGE	110 - 270 VAC
30 AMPS	AMPERAGE	30 AMPS
Single-Phase Up to 5hp	MOTOR POWER RATING	Single-Phase Up to 5hp
Screw-On or Push-On	TERMINALS	Screw-On or Push-On
Universal Mounting Bracket	MOUNTING	Universal Mounting Bracket
1.75"W x 2.25"L x 1.50"H	DIMENSIONS	1.75"W x 2.25"L x 1.50"H

ELECTRICAL

90XX SERIES POTENTIAL RELAYS

- Voltage sensitive relay
- Safety time delay
- Instant re-start
- Use with any size suitable start capacitor

Supco® P/N	Continuous Coil Voltage	Pick-Up Min.	Pick-Up Max.	Drop Max
9063	168	140	153	45
9064	395	242	272	140
9065	332	168	182	90
9066	395	204	233	130
9067	420	280	310	121
9068	502	314	342	135
9069	338	180	195	105
9070	332	285	305	85
9071	420	223	259	121

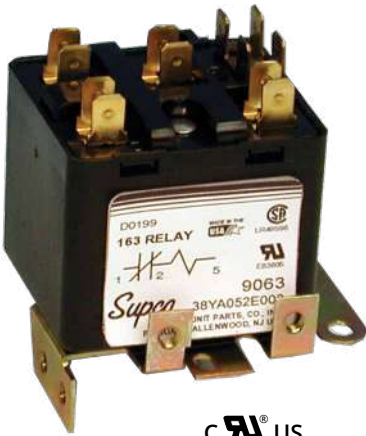

c  US

cRU[®] US

903X SERIES GENERAL PURPOSE SWITCHING RELAYS DOUBLE POLE DOUBLE THROW

Supco [®] P/N	Coil Voltage	FLA 120V	FLA 208V	FLA 240V	FLA 277V	HP	Essex [®] /RBM [®]	Honeywell [®]
90340	24	13.8	7.6	6.9	6	3/4	90-340	R8222D1014
90341	120	13.8	7.6	6.9	6	3/4	90-341	R4222D1013
90342	208/240	13.8	7.6	6.9	6	3/4	90-342	R4222N1021

FAN RELAYS

Supco [®] P/N	Type	FLA 250V	LRA 250V	Coil VAC
90290	SPST	8	18	24V
90291	SPST	8	25	120V
90292	SPST	8	25	240V
90293	SPDT	8	18	24V
90294	SPDT	8	25	120V
90295	SPDT	8	25	240V

Supco [®] P/N	Type	FLA 125V	LRA 125V	FLA 250V	LRA 250V	Coil VAC
90370	SPDT	12	60	8	48	24V
90372	SPDT	14	84	8	48	120V
90374	SPDT	14	84	8	48	240V
90380	NO/NC	12	60	8	48	24V
90382	NO/NC	12	60	8	48	120V
90384	NO/NC	12	60	8	48	240V

RU[®]

- Single or Double Pole
- Meets All Safety Requirements

TIME DELAY RELAYS



TD60 SERIES DELAY ON MAKE TIMERS (DOM)

- 6 sec. to 8 min adjustable
- 12/case

Supco[®] P/N

TD68

TD69



TD70 SERIES DELAY ON BREAK TIMERS (DOB)

- 6 sec. to 5 min adjustable
- 12/case

Supco[®] P/N

TD72

TD73



UNIVERSAL ELECTRONIC DEFROST TIMERS

The EDT Series defrost timers utilize adjustable timing and industry standard wiring to replace most domestic and many commercial defrost timers.

Supco [®] P/N	Description	Voltage	Max Compressor Rating	Max Resistive Load (Amps)
EDT10	Electronic Defrost Timer	115 VAC	1/3 HP	10
EDT11	Electronic Defrost Timer	115 VAC	3/4 HP	15
EDT20	Electronic Defrost Timer	208/240 VAC	3/4 HP	5
EDT21	Electronic Defrost Timer	208/240 VAC	3/4 HP	15
UET120	Universal Electronic Timer	120 VAC	1/2 HP	10
UET240	Universal Electronic Timer	120 VAC	1/2 HP	5

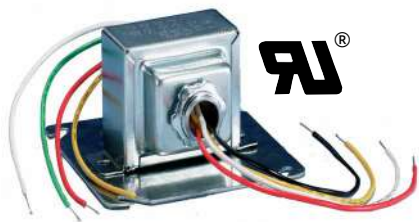

UNIVERSAL TRANSFORMER

Supco® P/N	VA	Primary VAC	Secondary VAC	H	W	D	MW
T45	48	120/208/240	2.5, 8, 12, 16 & 24	2 1/16"	3 1/4"	2 3/4"	2 13/16"

- 50/60 Hz.
- Enclosed frame - plate, foot or knock-out mount
- Includes 4"x4" mounting plate, wire nuts, 1/2" conduit & 8" leads

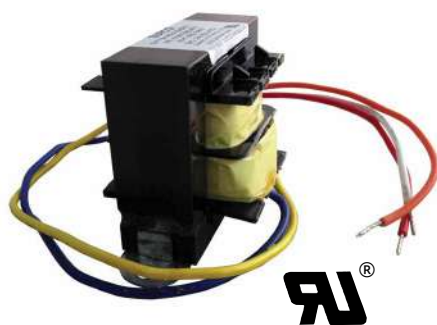

CONTROL TRANSFORMERS

Foot Mount Transformers Specifications

Supco® P/N	Primary V	Secondary VAC	Output VA	Breaker/Fuse	Agency
SXT100R	120/208/240/480	24	100	Breaker	UR®
SXT101	120/208/240	2.5/12/24	40	Fuse	UR®
SXT105	120/208/240	24	40	No	UR®
SXT114	120/208/240	24	20	No	UR® CSA®
SXT115*	120/208/240	24	40	No	UR® CSA®
SXT116	120	24	40	No	UR® CSA®
SXT79R	120/208/240/480	24	75	Breaker	UR®

*Includes Metal Shroud



MULTI-MOUNT TRANSFORMERS SPECIFICATIONS

Supco® P/N	Primary V	Secondary VAC	Output VA	Breaker/Fuse
SXT106	120/208/240	24	40	No
SXT111	120/208/240	2.5/12/24	40	Fuse
SXT113	208/240	40	40	No
SXT148	120/208/240	2.5/12/24	48	No
SXT150	120/208/240	24	50	Fuse



UNIVERSAL FAN CENTERS

Supco® P/N	VA	Primary VAC	Secondary VAC	HP	Jard®	Mars®	Steveco®
FC4011	40	120	24	3/4	4011FC	24013	90-113
FC4031	40	120/208/240	24	3/4	4031FC	24010	90-130

- DPDT plug-in style relay (90340)
- 40 VA transformer
- Mounts directly to 4" x 4" electrical box
- Color coded wiring for easy installation
- Universal FC4031 includes multi-tap primary voltages for all applications, reduces inventory



INVENTOR PROGRAM

Under the SUPCO TradeFox® Inventor Program, we work with technicians to bring their ideas to life and to the market through our years of experience in **engineering, manufacturing, marketing and national and global distribution.**

Visit **SUPCOTRADEFOX.COM** to learn more.



Supco® P/N

MUKIT

ADJUSTABLE MAGNETIC UMBRELLA KIT

- 60" wide
- Waterproof, UV-coated umbrella w/ durable and flexible fiberglass ribs
- Patented base swivels and locks
- Heavy-duty magnet attaches securely to any metal housing
- Includes NEW SUPCO TRADEFOX® Lanyard to secure the umbrella



JOSH COOLEY

SUPCO TRADEFOX® AND PRODUCT DEVELOPMENT MANAGER

Josh works directly with HVAC technician-inventors, who come to us through our Inventor Program, as well as with our engineering and manufacturing teams to add innovative new products under the SUPCO TradeFox® line. Josh understands technicians and the trade.

Not only does he have extensive hands-on experience in the HVACR field, having owned and operated a fifteen-truck HVAC Company in Phoenix and Nashville, but Josh is a SUPCO TradeFox® in his own right.

He is the inventor behind the SUPCO TradeFox® Magnetic Umbrella that so many Techs in our industry know and love. He has since invented the Fire Rated Magnetic Umbrella and accessories which allows other trades, such as line workers, the versatility to benefit from the patented adjustable umbrella system.

BRING MORE FLEXIBILITY TO YOUR SUPCO TRADEFOX® MAGNETIC UMBRELLA WITH THESE **ADD-ON ACCESSORIES.**



EXTENSION POLE FOR MAGNETIC UMBRELLA

- Adds 9" in height to umbrella (total height approx. 46")
- Easy installation - no tools required
- Attaches between umbrella and base
- Designed to use with MUKIT
- Intended to be used with MUKIT only when the umbrella is in vertical position

Supco® P/N

MUPOLE



SECURE CLAMP FOR MAGNETIC UMBRELLA

- Replaces magnetic base so umbrella can clamp to a variety of non-magnetic surfaces for more working flexibility
- Made from heavy-duty steel

Supco® P/N

MUCLAMP

NOW, EVEN MORE TRADE WORKERS CAN BENEFIT FROM THE VERSATILITY OF OUR **ADJUSTABLE UMBRELLA SYSTEM.**



FIRE-RATED ADJUSTABLE MAGNETIC UMBRELLA KIT

Designed with NFPA 701 fire-rated fabric for a wide variety of applications.

Supco® P/N

MUKIT-FR

KIT INCLUDES:



- 60" wide umbrella with NFPA 701 fire-rated fabric, fiberglass shaft and plastic ribs



- Patented, adjustable base swivels and locks
- Heavy-duty magnet to attach to any ferrous metal surface
- Lanyard to help secure umbrella



- Heavy-duty steel clamp

NEW**KNEELING PAD**

TradeFox® and Solderweld® have teamed up to offer technicians a high-density, compact kneeling pad designed for optimal comfort so you can focus on the job.

- High-Density EVA foam Construction
- Excellent shock absorption and cushioning
- Compact size and handle for easy carrying and storage
- Dual-sided branding

Supco® P/N

TFXKP

NEW**UNIVERSAL TAPE DISPENSER**

Keep your tape clean and within reach on the job site with this convenient magnetic tape holder.

- Use with all types of tape up to 3" width
- Magnetic bottom holds securely to metal surfaces
- Serrated cutting edge
- Handy squeegee storage

Supco® P/N

TFXUTD

NEW**UNIVERSAL PIPE LEVEL**

This technician-invented clamp level takes the headache out of balancing levels on copper pipe or PVC. Just clamp it on and level up your HVAC and Plumbing game.

- Accurate and easy to level copper and PVC pipe sizes from 3/8" to 2"
- Clamp firmly attaches to the various pipe sizes for hands-free leveling
- Made from Durable ABS plastic that won't wear out quickly or become loose like typical pipe levels

Supco® P/N

TFXUPL

- Easily clamps to your bag for quick access
- Use it everywhere. Clamp it or free set it to level duct work, air handlers, furnaces, drain pans, drain line pitch and so much more.

**MIKE FLYNN**

SUPCO TRADEFOX®



With an impressive Instagram following, HVAC technician Mike Flynn (@flynnstone1) is known for meticulously checking that pipes are plum and level. Push-on levels were always a challenge for him because the plastic gave way easily. It was also difficult and time-consuming to hold a drill and a level to the pipe, so he resorted to zip ties. Seeking a better way, Mike invented the clamp-on Universal Pipe Level as a versatile, hands-free option to save time and effort.

ELIMINATE COMPRESSOR SHORT CYCLING AND START THE SYSTEM SAFELY - *WHEN YOU'RE READY TO START IT.*

JUMPER KING™ MULTI-JUMPER WITH SELECTOR

This patented all-in-one kit allows you to quickly bypass any low voltage thermostat regardless of style.

- Innovative circuit selector switches to activate leads/circuits of your choosing
- Resettable popper fuse
- Includes 20 interchangeable tips - alligator clamps, magnetic tips, self-piercing insulation tips and spade adapters

Supco® P/N

TFXJK



INCLUDES STORAGE CASE!



ROBERT KRAFT SUPCO TRADEFOX®

HVAC technician Robert Kraft wanted a safer way to start a unit, other than standard jumper wires, to minimize the risk of damaging a compressor. After many prototypes, he designed a versatile tool that can start the unit,

bypass switches, and diagnose low voltage shorts with a 3 Amp pop-out fuse, and named it- rightly so, The Jumper King®.

JONES VALVE® CONDENSATE CLEANOUT

- Most compact size on the market
- No cutting or repairing drain line
- Single Schrader allows for one hose hook-up
- 1/4" hose connection, 3/4" condensate line

Supco® P/N

JV1



ANDY JONES SUPCO TRADEFOX®

The Jones Valve® was invented by Andy Jones, an HVAC technician who was looking for a way to permanently mount a multi-directional cleanout device on a condensate line so cleanouts would be faster and easier on service and maintenance calls.

Andy wanted something compact and fast. The theory of being able to service drain lines without having to cut the line influence the International Code Council to change the International Mechanical Code 307.2.5 in 2015 to state "Condensate drain lines shall be configured to permit the clearing of blockages and performance of maintenance without requiring the drain line to be cut".

NEW

MAGNATEMP

Telescopic Temperature Probe

The Magnatemp telescopic temperature probe allows you to accurately check air temperature in most situations inside the ceiling duct. Its patented design eliminates the need to pull out a ladder or struggle with inaccurate laser gun measurements.

- Extends from 10.5" to 36"
- Magnet and hook for convenience
- Easy to read digital face
- 5.5" flexible probe with protective cover
- Measures in °F or °C
- Temperature Range: -58°F to 572°F (-50°C to 300°C)
- Tolerance: ±2°F (±1°C)
- Uses one LR44 battery (included)

Supco® P/N
MTEMP

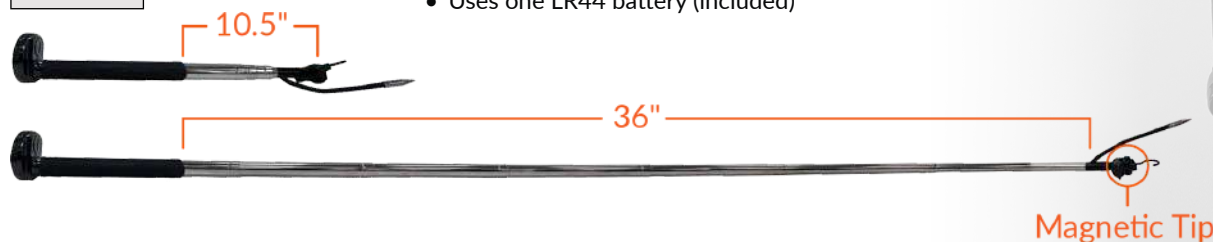

COOLPRESSOR

High-Powered Magnetic Compressor Cooler

- Uses high powered magnet
- Saves time
- Creates a powerful cascade of water
- No messy backsplash
- Attaches to garden hose

Supco® P/N
CPPRO



EXTENDABLE FILTER BRACES

Holds filters in place to prevent them from being sucked into the return

- Extends from 16" - 31"
- Magnetic ends to hold in place
- Can use multiple braces for added support
- Sold in packs of 6

Supco® P/N
TFXEFB

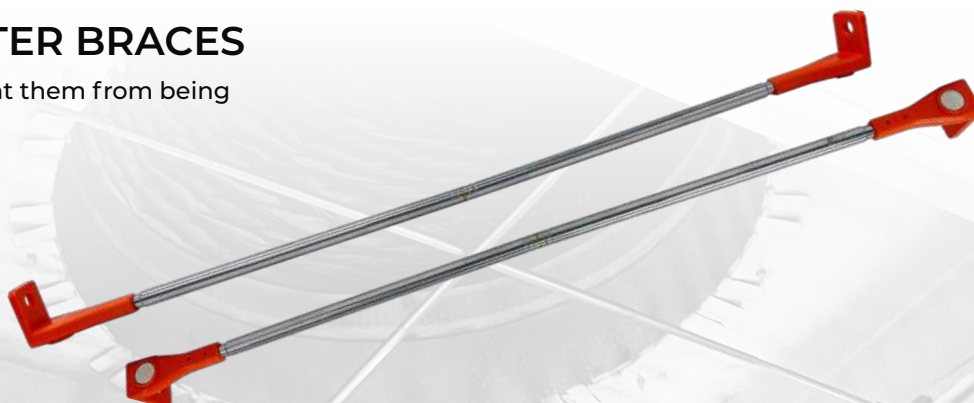

RAY VALDEZ

SUPCO TRADEFOX®

HVAC technician Ray Valdez would often open a return filter grill to find the filter had been sucked up past the flanges. This was problematic because the air restriction could affect the efficiency of the A/C system, and cause other system issues. To fix the issue, he would have to struggle to run two pieces of metal plumbers tape across the area and screw the two ends to make a brace. This took a lot of trial and error and often looked bad. When one of his customers told him he got cut by the straps when changing the filter, Ray was determined to create a product that solved the problem. He invented the magnetic extendable filter braces to be quick, easy and safe.

Ray Valdez is also the inventor of the Magnetic Compressor Cooler and Magnatemp Telescopic Temperature Probe.

WATER HEATER HANDLES

Supco® P/N

TFXWHH

- Steel "T" shaped handles with 1" female steel threaded end
- Screws onto the inlet and outlet of water heater for secure gripping and carrying
- Includes 1" to 3/4" steel reducer
- Carrying strap acts as a bottom sling for an easier two person lift, especially on stairs



SAL MURGOLO SUPCO TRADEFOX®

While struggling to remove a water heater in a tight stairwell, HVAC technician Sal Murgolo came up with the idea of the water heater handles. Since the top of water heaters offer no effective area to hold onto, he developed easy grip handles to attach to the inlet and outlet areas of the unit. His goal was to make the removal of old water heaters easier for plumbers and technicians, especially in tight spaces.

TUGBOAT COMPRESSOR TOTE

Supco® P/N

TB100

- Heavy-duty steel construction
- Can accommodate all types of compressors
- Adjustable grips
- Quick setup
- Breaks down for easy storage



JACOB CELIS SUPCO TRADEFOX®

Jacob and his business partner Thaddeus started building the Tugboat at home focusing on quality materials for heavy and safe lifts, including an adjustable height. Thaddeus helped to raise awareness of the Tugboat on social media and Mike Mayberry (@hvac_refer_guy) received the product. Mike recommended Jacob inquire into the SUPCO® TradeFox® Inventor Program for help getting the Tugboat produced on a mass scale and exposed to supply houses on a wide-scale national basis.

POCKET CONTINUITY TESTER

Supco® P/N

TFXCT

- Visual light indicator
- Alarm indicator
- Alligator clips for handsfree use
- Magnet on case sticks to metal surfaces
- Shorter lead length eliminates tangling
- Uses one AAA battery



SUPCO TRADEFOX®: BRINGING TECHNICIANS' IDEAS TO LIFE

The pocket Continuity Tester was invented by HVAC technician, Josh Cooley, who was looking for something easier, smaller and faster than a volt meter to test connectivity and save battery life.

FUSED MULTI-JUMPER

Supco® P/N

TFXMJ

- 3 Amp Fusible Link
- Magnetic Jumper Leads with Removable Rubber Caps
- Removable Male Banana Plugs
- Female Banana Terminals
- Convenient, space-saving size



SUPCO TRADEFOX®: BRINGING TECHNICIANS' IDEAS TO LIFE

Tired of piggy-backing multiple electric circuit jumpers together, HVAC technician Hughie Meehan invented a way to energize multiple outputs as well as protect the tip of the electrical conductor not in use.

NEW

NITROGEN PURGE BOOT

The Nitrogen Purge Boot was designed to assist the technician in the purging and brazing process. O-rings fit and seal over various sizes of ACR tubing creating a "hands-free" and hassle-free solution between your nitrogen regulator and the refrigerant line.

- Works on 3/8", 1/2", 5/8", 3/4", 7/8", and 1 1/8" OD ACR
- O-Rings are compatible with all refrigerant oils and flushing agents

Supco® P/N

TFXNPB

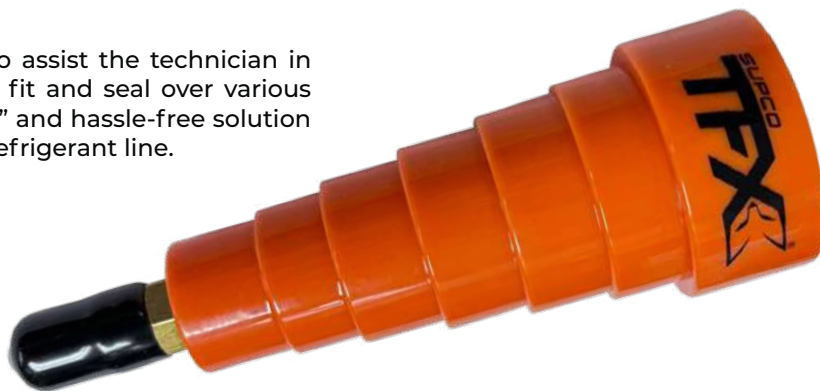

CHRIS HUGHES

SUPCO TRADEFOX®

The Nitrogen Purge Boot was invented by HVAC technician Chris Hughes after a challenging job scenario forced him and his crew to come up with makeshift solutions to push nitrogen through a large copper line set.

He walked away from the job with the idea for a hands-free tool that could easily pop on and pop off of line sets of various sizes with a flared end for hoses.

**NEW**

DISCONNECT MOUNTING PLATE

A universal way to secure the disconnect to the unit, without blocking access to the electrical panel.

- Designed to fit the various layouts of all single phase disconnect boxes using 1/2" length screws
- Cross pattern mounting design allows for universal installation on any caged or stamped condensing or packaged unit
- Uses hex nuts for easy installation with 5/16" nut driver
- Eliminates potential damage to the unit during installation
- Made of weather-resistant galvanized metal

Supco® P/N

TFXDMP

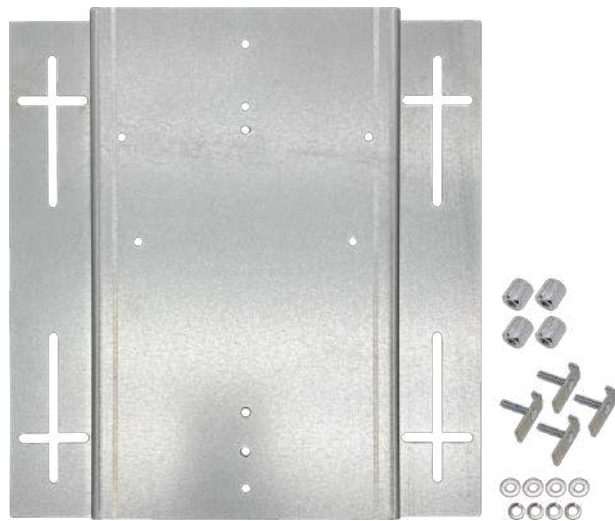

JUSTIN PETRY

SUPCO TRADEFOX®

The Disconnect Mounting Plate was invented by HVAC technician Justin Petry. Justin was inspired during a rooftop installation when he struggled to open the access panel because the disconnect was mounted directly to the door of a split system condenser. He came up with the idea of the mounting plate as a way to firmly and securely mount the disconnect when there is no other suitable mounting structure.

He also created it to help avoid some of the risky problems that can come from makeshift mounting fabrications which may damage a coil or block access to electrical panels.



UNIVERSAL ECM TESTER

- 24" wire length
- Short circuit protection
- 24 VAC operating voltage & indicating light
- Convenient magnet on back of unit
- No batteries required

Supco® P/N

ECMPRO

SUPCO TRADEFOX®: BRINGING TECHNICIANS' IDEAS TO LIFE

The ECMPRO was invented by an HVAC technician who was looking for a simple way to check if an Electronically Commutated Motor was good or bad in order to make a quicker diagnosis for the necessary repair.



ATTIC PRO® UTILITY LIFT

- Adjustable beam distance from 14" to 24"
- 20 ft. cable
- Lifts up to 250 lbs.

Supco® P/N

ATP1



STEVE SNYDER

SUPCO TRADEFOX®

The Attic PRO® was invented by Steve Snyder, an HVAC technician who was also a fireman. As a one-man operation, he was looking for a way to help lift furnaces and air handlers up into attics. One day on a training exercise, he used a winch to pull a person out of a man-hole - and the Attic PRO idea was born.



INCLUDES CARRYING CASE & STRAPS!

REFRIGERANT SAFETY LOCKING CAPS

- No special tools required; uses a standard 3/16" hex key for removal
- Resists fat, grease, oils & solvents
- Compatible with R717, R12, R22, R134a, R404A, R410A and other refrigerants
- Code compliant for tamper resistance
- UV resistant thermoplastic
- Patented cam action cap that easily tightens by hand



MATTHEW GROSS

SUPCO TRADEFOX®

The plastic Safety Locking Caps were invented by Matthew Gross, an HVAC technician who was looking for a more cost efficient way to comply with tamper resistance codes, and make them easier for service techs to install, remove and carry. "The colorful and expensive locking caps I used seemed to draw more attention than less, and I heard several comments from my customers about their high cost. It got me thinking there has to be another way."



Supco® P/N	Description	
SFL1402	2 Pack	1/4"
SFL1410	10 Pack	1/4"
SFL1450	50 Pack	1/4"
SFL51602	2 Pack	5/16"
SFL51610	10 Pack	5/16"
SFL51650	50 Pack	5/16"

COIL CLEANING BRUSH

- Two tempered stainless steel cleaning heads built into a single unit
- Adjustable brush head pivots up to 120°
- Patented stiffness adjustment slide
- Handles extends to 4 ft.

Supco® P/N

CCB100



REFRIGERANT LINE CLEANING KIT

Contains everything you need to remove oil from residential and commercial refrigerant lines without messy flushing.

Supco® P/N

RLC100

30 Foam Line Cleaners:

- | | |
|------------|----------|
| (5) 1 3/8" | (5) 3/4" |
| (5) 1 1/8" | (5) 5/8" |
| (5) 7/8" | (5) 1/2" |



3 Launchers:

- (1) 1 3/8"
(1) 7/8"
(1) 5/8"



4 Adapters:

- (1) 1 3/8" - 1 1/8"
(1) 7/8" - 3/4"
(1) 5/8" - 1/2"
(1) 5/8" - 3/8"



**INCLUDES CONVENIENT
CARRYING CASE!**

(1) Catch Net

TIGHT TAPER® FOIL & MASTIC TAPE APPLICATOR

- Lightweight and durable applicator presses tape onto seams in tight spaces
- Non slip silicone ends help to easily release tape and smooth it evenly without tears or snags
- Applicator has both inches and cm for measuring tape length required

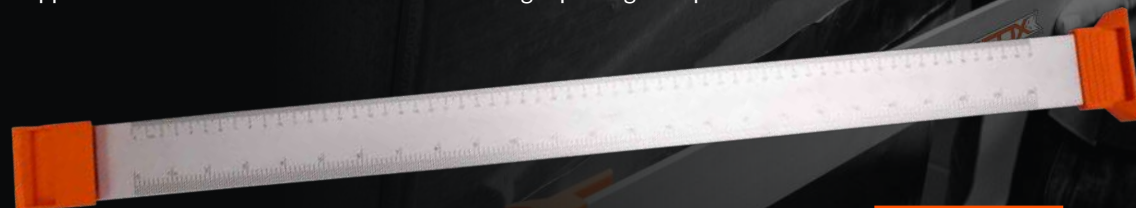

Supco® P/N

TT100



CHRIS PRANTL
SUPCO TRADEFOX®

DRIP PAN HANGERS

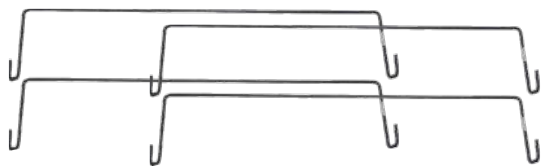

- Holds up to a 33" wide secondary safety pan
- 1/4" Epoxy Coated Steel Rod Construction
- Can be installed on Unistrut up to 1.75" wide
- To be used ONLY in conjunction with a secondary drain, NOT A SAFETY SWITCH
- Minimum 2 hangers used in standard installation
- 4pc/package

Supco® P/N

DPH33

FILTER PULLERS



- Makes getting hard to reach filters easy

Supco® P/N	Description
FP18	18" Extension
FP48	48" Extension

FUSE TESTING SUPER KIT

- (1) Standard Blade to 1/4" Fuse Adapter
- (1) Standard Blade to 5mm Fuse Adapter
- (1) Standard Blade to 4.5mm Fuse Adapter
- (1) Supco® Fuse Pro 3 AMP Tester with Light
- (1) Supco® Fuse Pro 5 AMP Tester with Light
- Auxiliary Wire Harness

Supco® P/N

DPH33



FUSE PRO BREAKERS



Supco® P/N	Description
BRK3	3 Amp Breaker
BRK5	5 Amp Breaker

- Two available sizes: 3 or 5 amp
- Plugs directly into PC boards
- Built in light for dark control board locations
- Eliminates wasted fuses

MAGNETIC TEST LEADS



- Ideal for low voltage, 30V
- Powerful magnets
- 20" wire length

Supco® P/N	Description
MAG1YL	Yellow Leads
MAG1BL	Blue Leads
MAG1BK	Black Leads
MAG1GR	Green Leads
MAG1RD	Red Leads



STEVE FISCHER

SUPCO TRADEFOX®

The MagJumper™ was invented by Steve Fischer, an HVAC technician who wanted to find a way to keep alligator clips from popping off thermostat subbases. He taped magnets to alligator clips and his concept was born. Steve also invented the BRK3 and BRK5 Fuse PROs because he was wasting job time making trips to the gas station for fuses. He came up with the Fuse PRO to take the place of the fuse during low voltage circuit testing until the short is identified.

And, the extendable filter pullers? "I was tired of my clothes getting dirty reaching for filters," Steve said. "Plus, with the magnetic tip, it doubles as a magnetic reach tool." SUPCO manufactures Steve's filter pullers in 18" (FP18) and 48" (FP48) versions.

AFFORDABLE THERMOSTATS *DESIGNED WITH CONTRACTORS IN MIND.*

WALL THERMOSTATS

- 2 Heat / 2 Cool Heat Pump Systems
- System Powered w/ Battery Backup

MECHANICAL THERMOSTAT



Supco® P/N
43004A



Supco® P/N
43005A

- Heat / Cool
- Snap Action Switching
- Mercury Free

DIGITAL THERMOSTAT



Supco® P/N
43054

- Non-Programmable
- Filter Change Indicator
- Indiglo Backlight

5/2 DAY PROGRAMMABLE THERMOSTAT



Supco® P/N
43154

- Pre-Programmed
- 4 Periods Per Day
- Indiglo Backlight



THERMOSTAT GUARDS

Supco® P/N	Dimensions
BTG-K	5 ¼" x 4 ¾" x 3"
BTG-EK	3 7/8" x 3 ½" x 2 ½"
BTG-RK	6 ¾" x 3 ½" x 3"
BTG-RWM	6 ¾" x 3 ½" x 3 ¼"
BTG-UK2	8 ¼" x 5 ¾" x 3 ½"

Supco® P/N	Dimensions
BTG-UN	7.3" W x 5.25" H x 1.8"
BTG-UM	8 ¼" x 5 ¾" x 3 ½"
BTG-UWM	6 ¾" x 4 ½" x 3 9/16"
BTG-54VL	6 ¼" x 4 ¼" x 3 ½"
BTG-54VLW	6" x 3 ¾" x 3 ½"

UNIVERSAL THERMOSTAT GUARD



FEATURES & SPECIFICATIONS

- ✓ Fits Thermostats Up to 7.3" W x 5.25" H x 1.8" D
- ✓ Tamper Resistant Lock
- ✓ Durable Clear Plastic Protects Against Thermostat Damage
- ✓ Vented For Proper Air Flow
- ✓ For New and Existing Thermostat Applications
- ✓ Slim Contemporary Style

1 YEAR LIMITED WARRANTY

Supco® P/N
BTG-UN

**REPLACES OVER 100
THERMOSTAT GUARDS**



HIGH PRESSURE OPEN ON PRESSURE RISE

Supco® P/N	Open PSI (Cut Out)	Close PSI (Cut In)	Tolerance +/- PSI	Mars®	Johnson Controls®	Ranco®	Robertshaw®	R410A Application
SHP250150	250	150	15	33354/43322	N/A	N/A	N/A	
SHP250180	250	180	15		N/A	N/A	N/A	
SHP275195	275	195	15	33310/43324	P100CC9C	MPH7102	3100-112	
SHP300200	300	200	15	33355/43325	N/A	MPH7103	N/A	
SHP325225	325	225	15	43326	N/A	MPH7104	N/A	
SHP325230	325	230	15	33313	N/A	N/A	N/A	
SHP350250	350	250	15	33356/33316/ 43327	N/A	MPH71053101201/ 3100150		
SHP375265	375	265	15	33319/43328	N/A	MPH7106	3100111	
SHP400200	400	200	15	33357/43329	N/A	N/A	3100152	
SHP400280	400	280	15	33322/43330	N/A	N/A	N/A	
SHP400300	400	300	15	33358/33370	P100CA1C/ P100CP1C	MPH7107	3101202/3100151/ MG21-112	
SHP425300	425	300	15	33325/43332	N/A	N/A	N/A	
SHP425325	425	325	15	43333	P100CA2C/ P100CP2C	MPH7108	3100100/3100203/ MG211046	
SHP450250	450	250	15	33359/43334	N/A	N/A	N/A	
SHP480380	480	380	15	N/A	N/A	N/A	N/A	X
SHP550450	550	450	15	N/A	P100CE11D	N/A	N/A	X
SHP600475	600	475	15	33361/43335	N/A	N/A	N/A	X
SHP610420	610	420	15	43366/43376	N/A	N/A	N/A	X
SHP665565	665	565	15	N/A	P100CP85D	N/A	N/A	X
SLP90120	90	120	5	43375	N/A	N/A	N/A	X



MANUAL HIGH PRESSURE OPEN ON PRESSURE RISE

Supco® P/N	Open PSI (Cut Out)	Close PSI (Cut In)	Tolerance +/- PSI	Mars®	Johnson Controls®	Ranco®	Robertshaw®	R410A Application
SMR375	375	Manual	15	43312	P100DC3C	MPH7109	N/A	
SMR410	410	Manual	15	33365/43313	P100DA1C	MPH7110	3101301/3100103	
SMR440	440	Manual	15	33352/43315	N/A	N/A	3100104	
SMR575	575	Manual	15	43368	P100DA86D	N/A	N/A	X
SMR610	610	Manual	15	43369	N/A	N/A	N/A	X
SMR630	630	Manual	15	N/A	P100DA81C/D	N/A	N/A	X

References to original equipment and other manufacturers' names, models, trademarks and part numbers are used for identification purposes only and SUPCO® replacement products are not in any way affiliated, endorsed or sponsored by such manufacturers.



LOW PRESSURE OPEN ON PRESSURE DROP

Supco® P/N	Open PSI (Cut Out)	Close PSI (Cut In)	Tolerance +/- PSI	Mars®	Johnson Controls®	Ranco®	Robertshaw®
SLP0520	5	20	5	33329	P100AC1C	MPL7001	3101001
SLP0530	5	30	5	43342	N/A	N/A	3100002/ MG201132
SLP1025	10	25	5	33330	P100AP201C	MPL7011	3100050
SLP1032	10	32	5	33330	P100AP201C	MPL7011	3100050
SLP1535	15	35	5	43371	P100AC2	MPL7002	3100001/ MG201026
SLP2045	20	45	5	43345	N/A	N/A	3100003/ MG201133
SLP2550	25	50	5	43372	N/A	MPL7012	MG212033
SLP2565	25	65	5	33336/43347	N/A	N/A	3101002
SLP2580	25	80	5	33363/43348	N/A	MPL7003	3101003/3100051
SLP2580	25	80	5	33363/43348	N/A	MPL7003	3101003/3100051
SLP3560	35	60	5	43349	N/A	MPL7004	3100004/ MG201593
SLP4560	45	60	5	43351	P100AP2C	MPL7005	N/A
SLP4080	40	80	5	33364/43350	N/A	MPL7014	3101005/3100052
SLP5090	50	90	5	33339/43374	N/A	N/A	N/A
SLP75100	75	100	5	33342/43353	N/A	N/A	N/A
SLP90120	90	120	5	43375	N/A	N/A	N/A



FAN CYCLE CLOSE ON PRESSURE RISE

Supco® P/N	Open PSI	Close PSI	Tolerance	Mars®	Johnson Controls®	Ranco®	Robertshaw®	R410A Application
SFC75120	75	120	15	43301	N/A	MPF7006	N/A	
SFC110170	110	170	15	43302	N/A	MPF7007	N/A	
SFC125265	125	265	15	33340/43303	N/A	N/A	N/A	
SFC210275	210	275	15	33341	N/A	MPF7009	3101101/3100079	
SFC150225	150	225	15	43304	P100AP3C	MPF7008	N/A	
SFC170250	170	250	15	N/A	P100AP4C	N/A	N/A	
SFC200240	200	240	15	N/A	N/A	N/A	3100080	
SFC200365	200	365	15	N/A	N/A	N/A	N/A	X
SFC300400	300	400	15	43307	N/A	MPF7010	N/A	X
SFC275350	275	350	15					X

ORIGINAL SERIES

SYSTEMS WITHOUT RUN CAPACITORS

Add new life to old refrigerators and freezers by providing a boost to the compressor.

3 'N 1 RELAY, OVERLOAD & START CAPACITOR COMBINATION

Supco® P/N	Run Load Amps
RCO210	13.3
RCO410	6.8
RCO810	4.0

All 120 Volt



UNIVERSAL SERIES

SYSTEMS WITH OR WITHOUT RUN CAPACITORS

Add a closely matched run capacitor for a total solution.

UNIVERSAL 4 'N 1 RELAY CAPACITOR, OVERLOAD & RUN CAPACITOR

Supco® P/N	Run Load Amps	Run Cap. Size μ FD
URCO210RC	13.3	20
URCO410RC	6.8	15
URCO810RC	4.0	12.5

All 120 Volt



UNIVERSAL 3 'N 1 RELAY OVERLOAD & START CAPACITOR

Supco® P/N	Run Load Amps
URCO210	13.3
URCO410	6.8
URCO810	4.05

All 120 Volt

Provides a boost for high efficiency compressors or helps older compressors run cooler.

References to original equipment and other manufacturers' names, models, trademarks and part numbers are used for identification purposes only and SUPCO® replacement products are not in any way affiliated, endorsed or sponsored by such manufacturers.

DOMESTIC & COMMERCIAL REFRIGERATION - HARD STARTS



UNIT BEARING WATT MOTORS

ALUMINUM

Supco® P/N	Watts	Volts	Amps	Rotation	Shaft Diameter	Shaft Length
SM5109	2	120	0.28	CWOSE	1/4" Threaded	1/2"
SM5211	4	120	0.36	CWOSE	1/4" Threaded	1/2"
SM5212	4	120	0.32	CCWOSE	1/4" Threaded	1/2"
SM5221	4	240	0.16	CWOSE	1/4" Threaded	1/2"
SM5222	4	240	0.16	CCWOSE	1/4" Threaded	1/2"
SM5311	6	120	0.52	CWOSE	1/4" Threaded	1/2"
SM5312	6	120	0.43	CCWOSE	1/4" Threaded	1/2"
SM5411	9	120	0.60	CWOSE	1/4" Threaded	1/2"
SM5412	9	120	0.64	CCWOSE	1/4" Threaded	1/2"
SM5421	9	240	0.32	CWOSE	1/4" Threaded	1/2"
SM5422	9	240	0.32	CCWOSE	1/4" Threaded	1/2"
SM5811	16	120	0.92	CWOSE	1/4" Threaded	1/2"
SM5812	16	120	0.92	CCWOSE	1/4" Threaded	1/2"
SM5821	16	240	0.48	CWOSE	1/4" Threaded	1/2"
SM5822	16	240	0.48	CCWOSE	1/4" Threaded	1/2"



CAST IRON

Supco® P/N	Watts	Volts	Amps	Rotation	Shaft Diameter	Shaft Length
SM351	35	120	1.4	CWOSE	1/4" Threaded	1/2"
SM352	35	120	1.4	CCWOSE	1/4" Threaded	1/2"
SM353	35	240	0.7	CWOSE	1/4" Threaded	1/2"
SM354	35	240	0.7	CCWOSE	1/4" Threaded	1/2"
SM501	50	120	1.7	CWOSE	3/8" Smooth Flatted	1/2"
SM502	50	120	1.7	CCWOSE	3/8" Smooth Flatted	1/2"
SM503	50	240	0.85	CWOSE	3/8" Smooth Flatted	1/2"
SM504	50	240	0.85	CCWOSE	3/8" Smooth Flatted	1/2"

References to original equipment and other manufacturers' names, models, trademarks and part numbers are used for identification purposes only and SUPCO® replacement products are not in any way affiliated, endorsed or sponsored by such manufacturers.

THERMODISC®

ML SERIES - DEFROST THERMOSTATS



Supco® P/N	Open °F	Close °F	Diff. °F	Mars®	Uniline®
ML37*	37	47	10		
ML45	45	20	25	33008	31-001 17001
ML50	50	20	30	33009	31-002 17003
ML55	55	20	35	33010	31-003 17005
ML60	60	20	40	33011	31-004 17007
ML70	70	20	50	33012	31-005 17009
ML80	80	50	30	33020	31-006 17011

*Closes on rise

SLT SERIES



Supco® P/N	Open °F	Close °F	Diff. °F
SLT45	45	22	23
SLT50	50	10	40
SLT55	55	25	30
SLT60	60	30	30

- Metal case with waterproof epoxy potting
- Heavy Duty Rating 10 Amps @ 120 V / 5 Amps @ 240 V
- Switching is SPST
- Uses SL249 tube clip

FIRE STAT

Supco® P/N
SMRL130



- Opens at 130°F
- Close when temperature differential is reached

ECONOMICAL FREEZE PROTECTION CONTROL

Protects air conditioning evaporator coils from freezing.

- Opens 35°F / Close 50°F
- Fits 7/8" O.D. tubing
- Rated 10A@120V, 5A @ 240V
- 12" leads

Supco® P/N
SMRL130



SL SERIES EXACT REPLACEMENT REFRIGERATION THERMOSTATS

- 2-wire Heater Limit
- SPST
- Resistive Amps: 25
- Volts AC: 120/240



Supco® P/N	Open °F	Close °F	Mount	Replaces
SL5708	75	40	Surface	Bohn®, Larkin®, Chandler®, Climate Control® 5708L & 4752C



Supco® P/N	Open °F	Close °F	Mount	Replaces
SL5709	55	35	Surface	Bohn®, Larkin®, Chandler®, Climate Control® 5709L & 4751C

- Surface Mount
- 3-wire Defrost Terminator and Fan Control (Exact Replacement)
- SPDT
- Resistive Amps: 25
- Volts AC: 120/240



Supco® P/N	Open °F	Close °F	Mount	Replaces
SL79002	55	35	Tube	Russell® 103079002
SL79005	65	30	Surface	Russell® 103079005

- 3-wire Defrost Terminator and Fan Control (Exact Replacement)
- SPDT
- Resistive Amps: 25
- Volts AC: 120/240



EVAPORATOR CONDENSATE PANS

Supco® P/N	Capacity	Dissipation Rate Per Day
CP801	1 3/4 qt.	3 gal.
CP802	2 1/2 qt.	6 gal.
CP802-240	2 1/2 qt.	6 gal.
CP804	4 1/2 qt.	6 gal.
CP804-240	4 1/2 qt.	6 gal.
CP804HD	7 1/2 qt.	6 gal.
CP804HD-240	7 1/2 qt.	6 gal.
CP807	7 1/2 qt.	10 gal.
CP807-240	7 1/2 qt.	10 gal.

Supco® P/N	Capacity	Dissipation Rate Per Day
CP808	15 qt.	8 gal.
CP815	15 qt.	12 gal.
CP815-240	15 qt.	12 gal.
CP816	7 qt.	4.5 gal.
CP817	7 qt.	8 gal.
CP818	7 qt.	8 gal.
CP819	7 qt.	12 gal.
CP820	7 qt.	12 gal.
CP821	15 qt.	12 gal.



REPLACEMENT FLOATS

For CP Series Pans

Supco® P/N	Description
CPFLOAT	3" Shaft
CPFLOAT4	4.5" Shaft



COMMERCIAL PAN MICROSWITCH

- Replacement micro switch all commercial condensate pans

Supco® P/N
CPS800



CAST EVAPORATOR CONDENSATE PANS

Supco® P/N	Capacity	Volts	Watts	Rate	Size
70*	50 oz.	120	300	4 - 5 oz./hr	12 1/4" x 4 3/4" x 3"
75	75 oz.	120	320	14 oz./hr	10" x 9" x 2 3/4"
30-OS	38 oz.	120	160	8 oz./hr	10" x 4" x 2 7/8"
31	500 oz.	120	160	60 oz./hr	10" x 4 1/2" x 3 3/8"

Cast Aluminum Evaporator Condensate Pans complete with long life heating element and mounting legs. 220V models also available. See supco.com

*UL & NSF® Approved



FLOAT VALVES

Supco® P/N	Can Replace
RM292PN	General Purpose
RM292V508	Ice-O-Matic® 9131111-01
RM29212N	Scotsman® 02-2217-02



VALVE AND RESERVOIR ASSEMBLIES

Supco® P/N	Can Replace
RM2241V457	Scotsman® 02-2217-01
RM2211V312	Ice-O-Matic® 9131032-01
RM2221JN	107-2221J-N General Purpose

References to original equipment and other manufacturers' names, models, trademarks and part numbers are used for identification purposes only and SUPCO® replacement products are not in any way affiliated, endorsed or sponsored by such manufacturers.

BPV SERIES BULLET PIERCING VALVES



*BPV21, BPV31 and BPV31D are furnished with adapters for indicated multiple applications

Supco® P/N	O.D. Tubing Size	Packaging
BPV31*	1/4", 5/16", 3/8"	12/Box
BPV31D*	1/4", 5/16", 3/8"	48/Box
BPV21*	1/2", 5/8"	8/Box
BPV14	1/4"	12/Box
BPV56	5/16"	12/Box
BPV38	3/8"	12/Box
BPV34	3/4"	1/Box
BPV78	7/8"	1/Box

A1 & A2 ADJUSTABLE LINE TAP VALVES



Supco® P/N	Tube Size O.D.	Packaging
A1	1/4", 5/16", 3/8"	12/Box
A2	1/2", 5/8"	12/Box



SELF-TAPPING WATER VALVE

- Fits 3/8" - 1 3/8" O.D. tubing or pipe

Supco® P/N
STV2LL

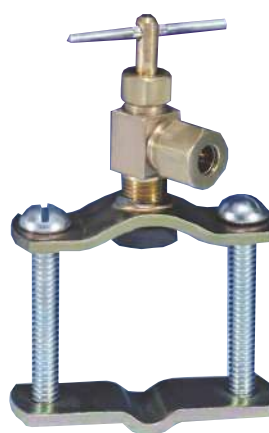

CONVENTIONAL "DRILL" TYPE VALVE

- Includes all fittings for 1/4" O.D. Copper and plastic tubing

Supco® P/N
STV2DLL

BC SERIES BULLET® RESTRICTO CAPILLARY TUBING

Standard Service Packs

Supco® P/N	Old Part No.	Length	Description
BC26X16		16 ft.	.026 ID X .071 OD
BC5		10 ft.	.028 ID X .071 OD
BC1	BC31X10	10 ft.	.031 ID X .081 OD
BC36X12		12 ft.	.036 ID X .086 OD
BC2	BC40X12	12 ft.	.040 ID X .093 OD
BC42X12		12 ft.	.042 ID X .093 OD
BC44X12		12 ft.	.044 ID X .093 OD
BC46X12		12 ft.	.046 ID X .093 OD
BC49X11		11 ft.	.049 ID X .093 OD
BC50X11		11 ft.	.050 ID X .093 OD
BC3	BC52X12	12 ft.	.052 ID X .093 OD
BC54X11		11 ft.	.054 ID X .106 OD
BC55X11		11 ft.	.055 ID X .112 OD
BC59X10		10 ft.	.059 ID X .112 OD
BC4	BC64X12	12 ft.	.064 ID X .125 OD
BC70X12		12 ft.	.070 ID X .125 OD
BC75X9		9 ft.	.075 ID X .125 OD
BC80X10		10 ft.	.080 ID X .145 OD
BC85X9		9 ft.	.085 ID X .145 OD
BC90X7		7 ft.	.090 ID X .145 OD

100 Foot Bulk Packs

Supco® P/N	Old Part No.	Length	Description
BC26X100		100 ft.	.026 ID X .071 OD
BC5-100	BC28X100	100 ft.	.028 ID X .071 OD
BC1-100	BC31X100	100 ft.	.031 ID X .081 OD
BC36X100		100 ft.	.036 ID X .086 OD
BC2-100	BC40X100	100 ft.	.040 ID X .093 OD
BC42X100		100 ft.	.042 ID X .093 OD
BC44X100		100 ft.	.044 ID X .093 OD
BC46X100		100 ft.	.046 ID X .093 OD
BC49X100		100 ft.	.049 ID X .093 OD
BC50X100		100 ft.	.050 ID X .093 OD
BC3-100	BC52X100	100 ft.	.052 ID X .093 OD
BC54X100		100 ft.	.054 ID X .106 OD
BC55X100		100 ft.	.055 ID X .112 OD
BC59X100		100 ft.	.059 ID X .112 OD
BC4-100	BC64X100	100 ft.	.064 ID X .125 OD
BC70X100		100 ft.	.070 ID X .125 OD
BC75X100		100 ft.	.075 ID X .125 OD
BC80X100		100 ft.	.080 ID X .145 OD
BC85X100		100 ft.	.085 ID X .145 OD
BC90X100		100 ft.	.090 ID X .145 OD

Fits ANY Domestic and Commercial Refrigerator, Freezer or Application, Air Conditioner from 1/8 - 5 hp.

- Precision Bore, Plus or Minus .001"
- Specification: ASTM B360



5PAK - INCLUDES BC1, BC2, BC3, BC4, BC5



- SM675 is Thermally Protected
- SM675 Includes Fan Blade FB550 Only
- SM670, SM672, SM673 and SM690C Include Fan Blades FB402 and FB550
- Motor Kits Include Complete Hardware and Mounting Kits

SM600 SERIES EXACT REPLACEMENT & UTILITY MOTOR KITS

Supco® P/N	Type	Volts AC	RPM	Shaft (in.)	Stack (in.)	Rotation (Reversible)
SM670	Sleeve	120	3000	3/16" x 1 1/4"	5/8"	CW/CCW
SM671	Sleeve	120	3000	3/16" x 1 1/4"	5/8"	CW/CCW
SM672	Sleeve	240	3000	3/16" x 1 1/4"	5/8"	CW/CCW
SM673	Sleeve	120	3000/1550	3/16" x 1 1/4"	5/8"	CW/CCW
SM675	Sleeve	120/240	3000	3/16" x 2 3/8"	1"	CW/CCW
SM690C	Sleeve	120	3000	3/16" x 1 1/4"	5/8"	CW/CCW

FAN HOOD MOTORS



RU
E472635

CAN REPLACE NUTONE® RANGE HOOD VENTILATORS

*2 Pack

Supco® P/N	Volts	Speeds	RPM	Rotation	Shaft Diameter	Shaft Length
SM550	120	1	3000	CCW	7/32" Flat	1 3/4"
SM550P2*	120	1	3000	CCW	7/32" Flat	1 3/4"
SM551	120	2	3000/1640	CW	7/32" Flat	1 7/16"
SM552	120	1	3000	CCW	7/32" Flat	1 1/4"
SM553	120	1	3000	CCW	7/32" Flat	1 3/4"
SM554	120	2	3000/1500	CCW	7/32" Flat	1 7/16"
SM555	120	1	3000	CCW	7/32" Flat	2 3/8"



UNIVERSAL 3.3" EVAPORATOR FAN MOTOR

- Open Ventilation; Reversible
- Sleeve Bearing
- 115/230V; 1550 RPM
- 1.1/6 AMPS

CAN REPLACE 100 OEMS

Supco® P/N
SM1127



MOTOR KIT ASSEMBLY

- 120V / 3000RPM
- 3/16" X 1-1/4" Shaft
- 5/8" Stack
- Replaces Acme Miami® 700
- OEM Replacement for Bohn®, Heatcraft®, Uppco®, Singer®, GE® 33 Series
- Kit Includes Reversible Motor, Three Fan Blades (FB402, FB455 & FB550), Hardware Kit and Instructions

Supco® P/N
SM6700B

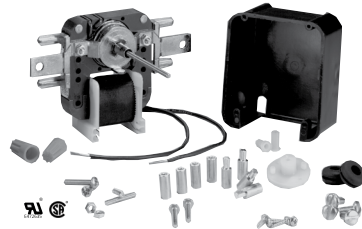

UNIVERSAL EVAPORATOR FAN MOTOR KIT

- 120 VAC, 3000 RPM, 1/200 HP, Impedance Protected
- Replaces over 450 different evaporator type motors
- Pre-fastened multi fit, break off mounting bracket
- Break off 2" motor shaft with breakaways at 1/2" and 1 1/2"
- Includes all mounting accessories and hardware
- Reversible rotation
- Single speed

- Shaft diameter 1/8"
- Can Replace: Packard® 65248, 65249, 65999, 90999, Robertshaw® 33-110, GEMLINE® EM241 - EM249 Series

Supco® P/N
SM999



EXACT REPLACEMENT PLASTIC IMPELLERS

Supco® P/N	Replaces	Blade O.D.	Hole I.D.
SB001	Nutone® 68920	4 5/8"	.181

MOTOR MOUNT BRACKET KIT



- Used with 5.5" motors
- Grommets and eyelets included
- For applications with 9" or 10" bolt circle diameters.

Supco® P/N	Description
MB55	3 leg
MB554	4 leg

ECONOMIC MOTOR PROTECTION

with full voltage range and adjustable imbalance.



UNIVERSAL THREE-PHASE MOTOR PROTECTOR

- Line Voltage: 180-600VAC
- Imbalance: Adjustable 4% to 20%
- Contact Type: SPDT 10A@240 VAC
- Short Cycle Adj: 10 Sec. to 5 Min.

Supco® P/N
TPMPU



THREE-PHASE MOTOR PROTECTOR

- Line Voltage: 208-277VAC
- Imbalance: Fixed 7%
- Contact Type: SPDT 5A@240 VAC

Supco® P/N
TPMP2



Photoelectric 4-Wire Duct Smoke Detector

Supco® P/N
DUCTSD



Photoelectric 4-Wire Duct Smoke Detector - 120V

Supco® P/N
D4120



Watertight Photoelectric 4-Wire Duct Smoke Detector

Supco® P/N
D4120W



Multi-Signaling Accessory with Add-on Strobe

Supco® P/N
RTS2-AOS

SEE THE FULL LINE OF SYSTEM SENSOR® DETECTION AT SUPCO.COM



Supco® P/N
IAQ1040

IAQ FAN CYCLE TIMER

- Button selection for FAN ON cycle time in increments of 10, 20, 30 or 40 minutes per hour
- LEDs indicate when fan is running or in off-cycle
- Monitors the FAN ON green wire from the thermostat and runs the selected On/Off cycle as long as the thermostat does not call for heat/cool
- Provides a delay function when AC shuts off to prevent bringing excessive moisture from water condensation on the AC coil into the room

INNOVAIRFLEX® DUCT SAMPLING TUBES

Supco® P/N	Description	Supco® P/N	Description
DST1	Ducts up to 1 ft.	DST5	Ducts 4-8 ft.
DST1.5	Ducts 1.5 ft.	DST10	Ducts 8-12 ft.
DST2	Ducts to 2 ft.	DST22	Ducts 22 ft.
DST2.5	Ducts to 2.5 ft.	DST34	Ducts to 34 ft.
DST3	Ducts 2-4 ft.	DST42	Ducts to 42 ft.



WHEN IAQ IS CRUCIAL, WE HAVE SOLUTIONS.



PCO

UUV-CBM-PCO 24VAC & 110 VAC

- ✓ 16" UV germicidal coil cleaner
- ✓ Improve energy efficiency
- ✓ Destroy mold & odors
- ✓ Various mounting scenarios
- ✓ Over/under voltage indicator
- ✓ LCD w/ real time status
- ✓ Countdown purifier animation
- ✓ Call-back indicator
- ✓ Photocatalytic Oxidation
- ✓ Captures volatile organic compounds



MASTER

UUV-CBM 24VAC & 110 VAC

- ✓ 16" UV germicidal coil cleaner
- ✓ Improve energy efficiency
- ✓ Destroy mold & odors
- ✓ Various mounting scenarios
- ✓ Over/under voltage indicator
- ✓ LCD w/ real time status
- ✓ Countdown purifier animation
- ✓ Call-back indicator
- Photocatalytic Oxidation
- Captures volatile organic compounds



ADVANCED

UUV-CBA 18-32V AC OR DC

- ✓ 16" UV germicidal coil cleaner
- ✓ Improve energy efficiency
- ✓ Destroy mold & odors
- ✓ Various mounting scenarios
- ✓ Over/under voltage indicator
- LCD w/ real time status
- Countdown purifier animation
- Call-back indicator
- Photocatalytic Oxidation
- Captures volatile organic compounds

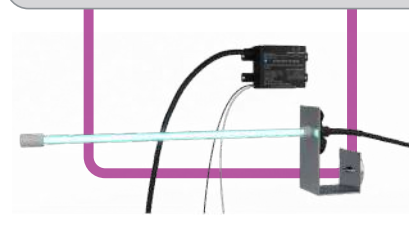

REPLACEMENT BULB FOR ALL MODELS

Supco® P/N
UUV-LP160T5

Will also replace other brands

LIFETIME BALLAST WARRANTY | 1-YEAR UV LAMP WARRANTY

Universal Solutions® Clear Blue® line of residential UV systems are distributed exclusively by SUPCO. These products are the smart answer to reduce bacteria, viruses and mold in the air and on the HVAC coil.



LEAK LOCK® & LEAK LOCK® GOLD BRUSHABLE PASTE WITH TEFLON JOINT COMPOUND

Supco® P/N	Leak Lock® Gold P/N	Size
HS10001	HS11001	1-1/3 oz Tube
HS10004	HS11004	4 oz. Brush Top Plastic Jar
HS10016	HS11016	16 oz. Brush Top Plastic Jar

- 12 per case

LEAK LOCK ONE STEP PVC CEMENT



The only no primer, fast setting, all weather low VOC One step PVC Cement

- Works on WET, dry & flexible pipe
- Allows immediate pressure testing
- Meets ASTM D2564
- 12 per case

Supco® P/N	Size
HS10604	4 oz. metal bottle
HS10608	8 oz. metal bottle



THREAD SEALANT - SINGLE PACKS

Supco® P/N	Description
HS10002	Blue
HS11002	Gold



SUPCO® SYSTEM SAFE SEALANT

From the trusted manufacturer of Leak Lock®, SUPCO® System Safe Sealant will not cause system contamination, restrictions, fouling or failure.

- Supreme leak prevention for NPT, flares, Schrader cores & O-rings
- Formulated to work with all refrigerants and refrigeration lubricants
- Soft, pliable formula with a non stringy, mess-free application
- Compact, 1oz applicator tube with carabiner easily attaches to tool pouches
- Manufactured in the USA
- Sold in cases of 12

Supco® P/N
3S

THREE STEP INSTANT HVACR REPAIR KIT



Instant Repair Complete Kit combines high strength bonding fluid and specialized bonding cells to form a permanent bond similar to a weld. Within seconds, it seals holes and cracks in all types of pipe and materials used in the HVAC/R industry.

- Pressure Rating: Up to 1800PSI
- Temperature Range: -60°F to 200°F (51°C to 93°C)
- Hardness: Shore D 85+

Supco® P/N
HS32050

NEW

CELLOTHERM™ HIGH TEMPERATURE FURNACE & RETORT CEMENT



- Seals doors and joints
- Bonds fire brick and combustion chambers
- Adheres to all surfaces
- Shrink and crack proof
- Lowest freeze storage

Supco® P/N	Size
HS19114	.5 gal.



SPORE GO® BROAD SPECTRUM CLEANER

- Cleans Away Mold and Mildew
- Australian Tea Tree oil
- Mitigates Moisture and Water Damage
- Multi-Surface, Broad Spectrum Cleaner
- Coil Cleaner - Evaporator and Condenser
- 4/case

Supco® P/N

HS53128



ICEMAX® NICKEL SAFE ICE MACHINE CLEANER

- 12 per case

Supco® P/N

HS50004



GREEN PAN TABS

- Economical Condensate Drain Pan Treatment
- 12/case

Supco® P/N

HS52200



COILMAX® COIL CLEANER

- 16 oz. jar
- Sold 12/case

Supco® P/N

HS56008

PINK STUFF - ACID BASED COIL CLEANER GREEN STUFF - ALKALINE BASED COIL CLEANER



Supco® P/N	Size	PKG
HS58128	1 gal.	4/case
HS58520	18 oz. can	12/case
HS59128	1 gal.	4/case
HS59520	19 oz. can	12/case

SUPER FLUSH AC/R INTERNAL SYSTEM CLEANER



- Biodegradable
- Cleans in a single treatment
- Compatible with all refrigerants and refrigeration oils
- Does not contain halogenated solvents

Supco® P/N	Size	PKG
HS55032	32 oz.	12/case
HS55128	1 gal.	6/case

DETECTORS AND TESTERS



Supco® P/N	Name	Description
HS22008	Gas Leak Detect - Low	8 oz. 12/case
HS22032	Gas Leak Detect - Low	32 oz. 12/caseHS
HS23008	Gas Leak Detect - Mid	8 oz. 12/case
HS23032	Gas Leak Detect - Mid	32 oz. 12/caseHS
HS23128	Gas Leak Detect - Mid	Gallon 12/case
HS16001	The Acid Test	4 tests per kit; 12 per case
HS16501	Oil Checker	Two test per kit; 12/case
HS20004	Trace® Leak Detect	4oz. 12/case
HS20016	Trace® Leak Detect	16 oz. 12/case
HS21004	Trace 2® Leak Detect	4 oz. 12/case
HS21016	Trace 2® Leak Detect	16 oz. 12/case

HIGHSIDE® QUICK SERVICE KITS

- 6 per case



Supco® P/N	Name	Description
HS18002	Acid Neutralizer	2 oz.
HS18022*	Acid Neutralizer	Kit Refill - 2 pre-charged injectors
HS19002*	PRO-A	Frees sticky expansion valves
HS19022*	PRO-A	Kit Refill - 2 pre-charged injectors
HS60002*	AC Leak Repair	All-in-one lubricator w/ UV dye
HS60022*	AC Leak Repair	Kit Refill - 2 pre-charged injectors
HS21002*	Trace 2	2 oz. pre-charged red UV injector
HS21022*	Trace 2	Kit Refill - 2 pre-charged injectors
HS17002	Thawzone	2oz. pre-charged injector; 4/case
HS17022*	Thawzone	Kit Refill - 2 pre-charged injectors