

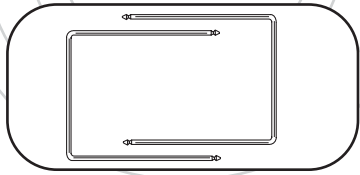

86-3528
INSTALLATION
INSTRUCTIONS

Pontiac GTO factory
Head Unit Removal
Keys



1-800-221-0932 www.metraonline.com
© COPYRIGHT 2004 METRA ELECTRONICS CORPORATION



86-3528
INSTALLATION
INSTRUCTIONS

Pontiac GTO factory
Head Unit Removal
Keys

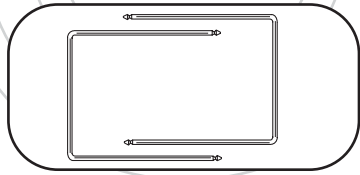

1-800-221-0932 www.metraonline.com
© COPYRIGHT 2004 METRA ELECTRONICS CORPORATION



86-3528
INSTALLATION
INSTRUCTIONS

Pontiac GTO factory
Head Unit Removal
Keys

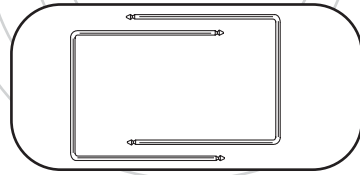

1-800-221-0932 www.metraonline.com
© COPYRIGHT 2004 METRA ELECTRONICS CORPORATION



86-3528
INSTALLATION
INSTRUCTIONS

Pontiac GTO factory
Head Unit Removal
Keys

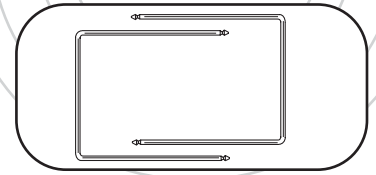

1-800-221-0932 www.metraonline.com
© COPYRIGHT 2004 METRA ELECTRONICS CORPORATION



86-3528
INSTALLATION
INSTRUCTIONS

Pontiac GTO factory
Head Unit Removal
Keys

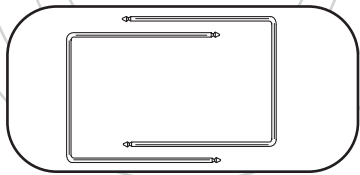

1-800-221-0932 www.metraonline.com
© COPYRIGHT 2004 METRA ELECTRONICS CORPORATION



86-3528
INSTALLATION
INSTRUCTIONS

Pontiac GTO factory
Head Unit Removal
Keys

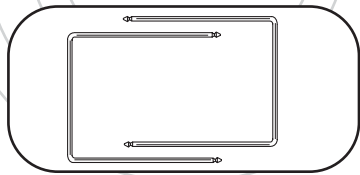

1-800-221-0932 www.metraonline.com
© COPYRIGHT 2004 METRA ELECTRONICS CORPORATION



86-3528
INSTALLATION
INSTRUCTIONS

Pontiac GTO factory
Head Unit Removal
Keys

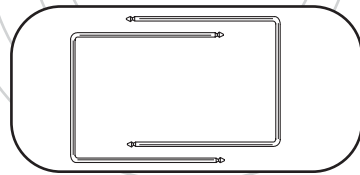

1-800-221-0932 www.metraonline.com
© COPYRIGHT 2004 METRA ELECTRONICS CORPORATION



86-3528
INSTALLATION
INSTRUCTIONS

Pontiac GTO factory
Head Unit Removal
Keys

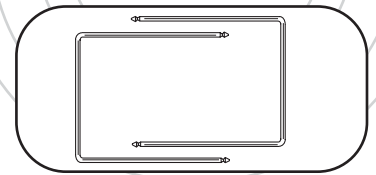

1-800-221-0932 www.metraonline.com
© COPYRIGHT 2004 METRA ELECTRONICS CORPORATION



REV. 091604

Disconnect the negative battery terminal to prevent an accidental short circuit

1. Insert the Head Unit removal Keys into the holes on either side of the factory head unit.
2. Push the keys into the holes until the retaining clips are released.
3. Grasp the keys tightly and pull the unit from the dash cavity.

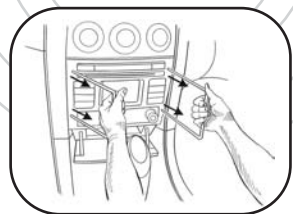

REV. 091604

Disconnect the negative battery terminal to prevent an accidental short circuit

1. Insert the Head Unit removal Keys into the holes on either side of the factory head unit.
2. Push the keys into the holes until the retaining clips are released.
3. Grasp the keys tightly and pull the unit from the dash cavity.

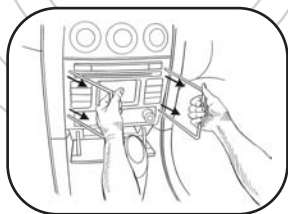

REV. 091604

Disconnect the negative battery terminal to prevent an accidental short circuit

1. Insert the Head Unit removal Keys into the holes on either side of the factory head unit.
2. Push the keys into the holes until the retaining clips are released.
3. Grasp the keys tightly and pull the unit from the dash cavity.

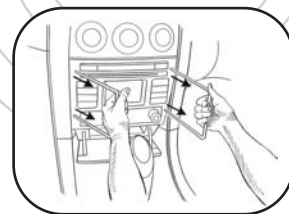

REV. 091604

Disconnect the negative battery terminal to prevent an accidental short circuit

1. Insert the Head Unit removal Keys into the holes on either side of the factory head unit.
2. Push the keys into the holes until the retaining clips are released.
3. Grasp the keys tightly and pull the unit from the dash cavity.

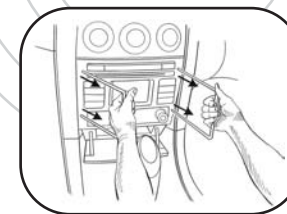

REV. 091604

Disconnect the negative battery terminal to prevent an accidental short circuit

1. Insert the Head Unit removal Keys into the holes on either side of the factory head unit.
2. Push the keys into the holes until the retaining clips are released.
3. Grasp the keys tightly and pull the unit from the dash cavity.

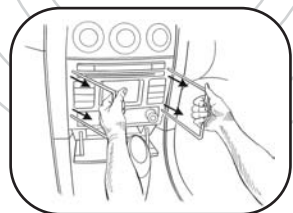

REV. 091604

Disconnect the negative battery terminal to prevent an accidental short circuit

1. Insert the Head Unit removal Keys into the holes on either side of the factory head unit.
2. Push the keys into the holes until the retaining clips are released.
3. Grasp the keys tightly and pull the unit from the dash cavity.

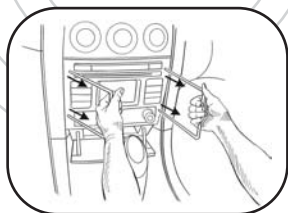

REV. 091604

Disconnect the negative battery terminal to prevent an accidental short circuit

1. Insert the Head Unit removal Keys into the holes on either side of the factory head unit.
2. Push the keys into the holes until the retaining clips are released.
3. Grasp the keys tightly and pull the unit from the dash cavity.

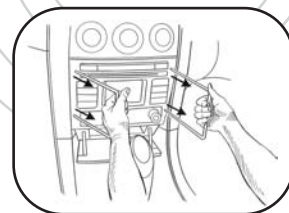

REV. 091604

Disconnect the negative battery terminal to prevent an accidental short circuit

1. Insert the Head Unit removal Keys into the holes on either side of the factory head unit.
2. Push the keys into the holes until the retaining clips are released.
3. Grasp the keys tightly and pull the unit from the dash cavity.

