

# PONDEROSA PAVILION

Occupancy:  
 800 Dining  
 1713 Theater  
 2399 Standing

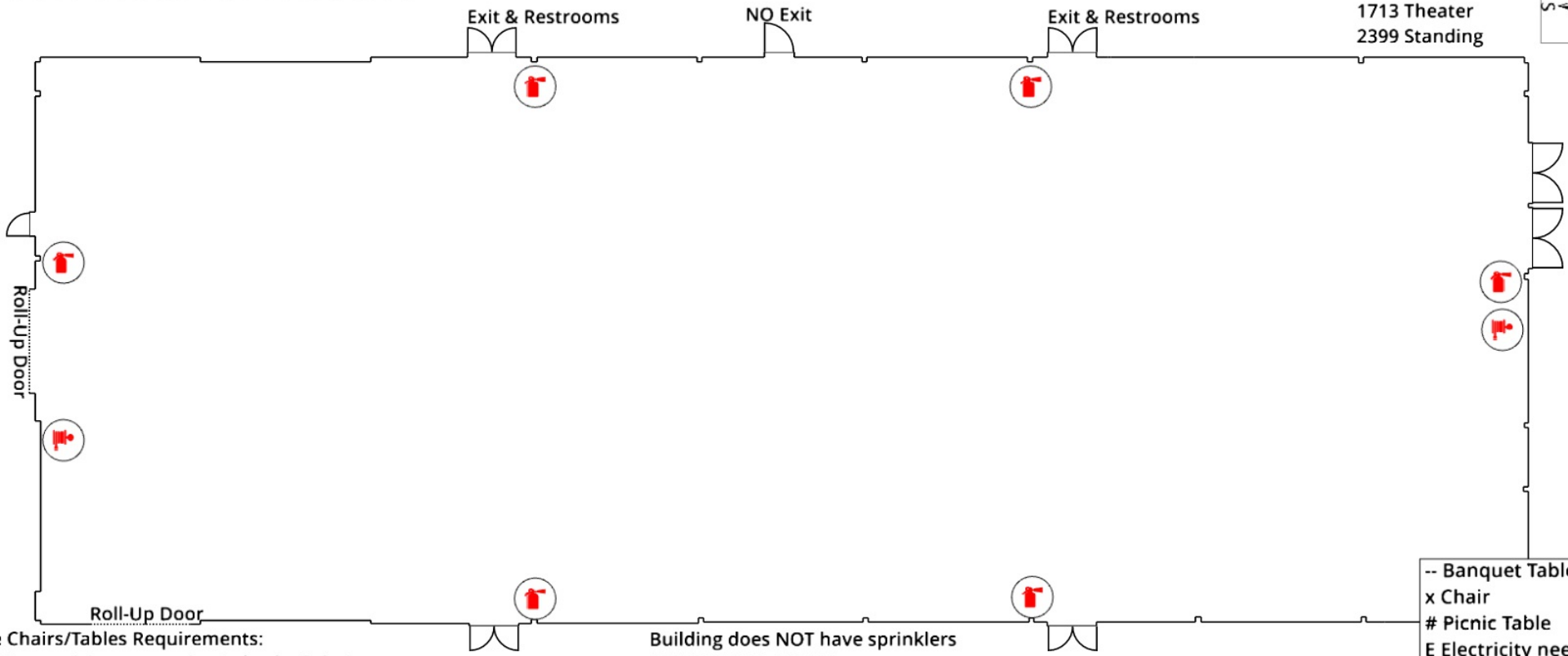

Cal Fire Chairs/Tables Requirements:  
 12" minimum aisle access edge to back of chairs  
 Aisles shall not exceed 30ft. travel to choice of two exits  
 Provide minimum 44" aisle width throughout

Building does NOT have sprinklers  
 BLDG WIDTH: 68.5FT.  
 BLDG LENGTH: 180FT.  
 12,300sf

Diagram Key:  
 -- Banquet Table  
 x Chair  
 # Picnic Table  
 E Electricity needed...  
 O Round Table