



Irene Gomez-Bethke Papers.

## **Copyright Notice:**

This material may be protected by copyright law (U.S. Code, Title 17). Researchers are liable for any infringement. For more information, visit [www.mnhs.org/copyright](http://www.mnhs.org/copyright).

# ONALES

## The Hispanic Community and Census 2000

By Irene Gomez-Bethke

I currently work for the US Department of Commerce, Census Bureau, as a Community Partnership Specialist. The purpose of the Partnership program is to create awareness, reduce barriers, and encourage participation in the Census, especially, those communities that were undercounted in the past. The program serves to support Census operations conducted through the local Census offices.

I strongly believe that the Census is so important to our State and our community. As a Community Partnership Specialist, I work with community-based organizations, religious groups and local businesses in areas with highly diverse populations. I help them to identify area challenges for enumeration. The Hispanic community has specific concerns such as employment, confidentiality and language accessibility.

Time and again, members of the Hispanic community have shared their concerns about the activities of Immigration and Naturalization Service. The rounding up of people peacefully playing in a park, the raids that have occurred here in Minnesota and the fear those actions have generated are daunting barriers. The immediate action is to talk to them about Title 13 and how this law protects the confidentiality of their response. The Census Bureau cannot share their answers with the IRS, FBI, Welfare, Immigration or any other



Irene Gomez-Bethke

government body! Not even the president of the United States can access their responses! All of us who work for the Census are sworn to confidentiality. We face a fine of \$5,000 and a five-year prison term if we give out any information.

The mistrust of government, fear of reprisal, lack of English skills, prosecution and deportation are some of the reasons Hispanics shy away from answering questions. Another factor, is the lack of knowledge about the federal funds that could benefit their community programs and services as a result of being counted.

The Partnership program uses speeches, presentations and exhibits to let communities know that the Census is safe. Its confidentiality is protected by title 13. I have been meeting with various persons and organizations to form partnerships. We discussed the need to develop an action plan organizing the Hispanic community and to identify individuals that would serve on

complete count committees.

I am very happy to say that several community-based organizations and also the State of Minnesota, Chicano Latino Affairs Council, have become partners with the Census 2000. They agreed to the following activities:

- Create awareness of the Census through their newsletters, distribution of posters, promotional Materials, and use of other media.

- Create and organize a complete count committee by identifying and recruiting individuals willing to serve on this important committee.

- They are donating space for meetings, for office space, for testing and training.

- They are providing liaison staff to work with the Census 2000.

- They are willing to invite groups, religious, business, civic and others to gather and work towards an accurate count and to be counted 100%.

- They are planning community events in the near future to create awareness of the Census, to reduce barriers, and to do recruitment of volunteers to help implement the strategic plans.

These actions are part of the activities the complete count committees engage in to meet our mutual goal, to be counted 100%. This effort is really building community. We need you to ensure that our communities are counted. Working together we can do it! Muchas Gracias, thank you.



**UNITED STATES DEPARTMENT OF COMMERCE  
Bureau of the Census**

Irene Gomez-Bethke  
Community Partnership Specialist

190 Fifth Street East, 4<sup>th</sup> Floor  
St. Paul, MN 55101  
[irenegombeth@hotmail.com](mailto:irenegombeth@hotmail.com)

Office (651) 290-4294  
Fax (651) 290-4497  
Pager 888-541-1929

July 19, 1999,

Mr. Paul Carrizales  
HACER  
330 HHH Center  
301 19<sup>th</sup> Avenue South  
Minneapolis, MN. 55455

Dear Mr. Carrizales:

Thank you for giving me the opportunity to discuss with you Census 2000, the Partnership Program and the importance of being counted in the next Census to the people of Minnesota and specifically, the Hispanic community.

Census 2000 needs community leaders such as you to help the Hispanic community understand why it is important to be counted on April 1, 2000. The salient reasons to be counted are reapportionment for political and voting empowerment in the U.S. House of Representatives, state legislatures and local governments. In addition, the count is also the basis for allocation of billions of federal dollars for programs and services.

As I told you in our discussion, the Partnership Program was initiated by the Census Bureau to create awareness, reduce barriers and encourage participation in the Census. It is vitally important that community leaders set the clock in motion! You have done this by forming a partnership with the Census Bureau to ensure that this time, there will be a complete count of the Hispanic community. I look forward to working with you on this very important undertaking.

Sincerely,

Irene Gomez-Bethke  
Community Partnership Specialist  
Bureau of the Census



**UNITED STATES DEPARTMENT OF COMMERCE  
Bureau of the Census**

Irene Gomez-Bethke  
Community Partnership Specialist

190 Fifth Street East, 4<sup>th</sup> Floor  
St. Paul, MN 55101  
[irenegombeth@hotmail.com](mailto:irenegombeth@hotmail.com)

Office (651) 290-4294  
Fax (651) 290-4497  
Pager 888-541-1929

July 19, 1999,

Mr. Eduardo Barrera  
Neighborhood Development Alliance  
481 South Wabasha Street  
St. Paul, MN. 55107

Dear Mr. Barrera:

Thank you for giving me the opportunity to discuss with you Census 2000, the Partnership Program and the importance of being counted in the next Census to the people of Minnesota and specifically, the Hispanic community.

Census 2000 needs community leaders such as you to help the Hispanic community understand why it is important to be counted on April 1, 2000. The salient reasons to be counted are reapportionment for political and voting empowerment in the U.S. House of Representatives, state legislatures and local governments. In addition, the count is also the basis for allocation of billions of federal dollars for programs and services.

As I told you in our discussion, the Partnership Program was initiated by the Census Bureau to create awareness, reduce barriers and encourage participation in the Census. It is vitally important that community leaders set the clock in motion! You have done this by forming a partnership with the Census Bureau to ensure that this time, there will be a complete count of the Hispanic community. I look forward to working with you on this very important undertaking.

Sincerely,

Irene Gomez-Bethke  
Community Partnership Specialist  
Bureau of the Census





UNITED STATES DEPARTMENT OF COMMERCE  
Bureau of the Census

Irene Gomez-Bethke  
Community Partnership Specialist

190 Fifth Street East, 4<sup>th</sup> Floor  
St. Paul, MN 55101  
[irenegombeth@hotmail.com](mailto:irenegombeth@hotmail.com)

Office (651) 290-4294  
Fax (651) 290-4497  
Pager 888-541-1929

August 5, 1999

Ms. Lupe Monzon  
Bilingual Counselor  
Esperanza para Mujeres/Hope for Women  
Gaylord Lakeview Home  
640 3<sup>rd</sup> Street  
Gaylord, Minnesota 55334

Dear Ms. Monzon:

Thank you for giving me the opportunity to discuss with you Census 2000, the Partnership Program and the importance of being counted in the next Census to the people of Minnesota and specifically the Hispanic community.

Census 2000 needs community leaders such as you to help the Hispanic community understand why it is important to be counted on April 1, 2000. The salient reasons to be counted are reapportionment for political and voting empowerment in the U.S. House of Representatives, state legislatures and local governments. In addition, the count is also the basis for allocation of billions of federal dollars for programs and services.

As I told you in our discussion, the Partnership Program was initiated by the Census Bureau to create awareness, reduce barriers and encourage participation in the Census. It is vitally important that community leaders set the clock in motion! You have done this by forming a partnership with the Census Bureau to ensure that this time, there will be a complete count of the Minnesota Hispanic community. I have enclosed your copy of the Partnership Agreement that you signed. I look forward to working with you on this very important undertaking.

Sincerely,

A handwritten signature in cursive script, reading "Irene", is positioned above the typed name.

Irene Gomez-Bethke  
Community Partnership Specialist  
Bureau of the Census



UNITED STATES DEPARTMENT OF COMMERCE  
Bureau of the Census

Irene Gomez-Bethke  
Community Partnership Specialist

190 Fifth Street East, 4<sup>th</sup> Floor  
St. Paul, MN 55101  
[irenegombeth@hotmail.com](mailto:irenegombeth@hotmail.com)

Office (651) 290-4294  
Fax (651) 290-4497  
Pager 888-541-1929

August 5, 1999

Ms. Luz Jimenez  
Outreach Director  
Pioneer Public TV GED on TV  
P.O.Box 1732  
Willmer, Minnesota 56201

Dear Ms. Jimenez:

Thank you for giving me the opportunity to discuss with you Census 2000, the Partnership Program and the importance of being counted in the next Census to the people of Minnesota and specifically the Hispanic community.

Census 2000 needs community leaders such as you to help the Hispanic community understand why it is important to be counted on April 1, 2000. The salient reasons to be counted are reapportionment for political and voting empowerment in the U.S. House of Representatives, state legislatures and local governments. In addition, the count is also the basis for allocation of billions of federal dollars for programs and services.

As I told you in our discussion, the Partnership Program was initiated by the Census Bureau to create awareness, reduce barriers and encourage participation in the Census. It is vitally important that community leaders set the clock in motion! You have done this by forming a partnership with the Census Bureau to ensure that this time, there will be a complete count of the Minnesota Hispanic community. I have enclosed your copy of the Partnership Agreement that you signed. I look forward to working with you on this very important undertaking.

Sincerely,

A handwritten signature in cursive script, appearing to read "Irene", is placed above the typed name.

Irene Gomez-Bethke  
Community Partnership Specialist  
Bureau of the Census



UNITED STATES DEPARTMENT OF COMMERCE  
Bureau of the Census

Irene Gomez-Bethke  
Community Partnership Specialist

190 Fifth Street East, 4<sup>th</sup> Floor  
St. Paul, MN 55101  
[irenegombeth@hotmail.com](mailto:irenegombeth@hotmail.com)

Office (651) 290-4294  
Fax (651) 290-4497  
Pager 888-541-1929

August 5, 1999

Mr. Rudy Rios  
Family Counselor  
Greater Minnesota Family Services  
Box 796  
Gaylord, Minnesota 55334

Dear Mr. Rios:

Thank you for giving me the opportunity to discuss with you Census 2000, the Partnership Program and the importance of being counted in the next Census to the people of Minnesota and specifically the Hispanic community.

Census 2000 needs community leaders such as you to help the Hispanic community understand why it is important to be counted on April 1, 2000. The salient reasons to be counted are reapportionment for political and voting empowerment in the U.S. House of Representatives, state legislatures and local governments. In addition, the count is also the basis for allocation of billions of federal dollars for programs and services.

As I told you in our discussion, the Partnership Program was initiated by the Census Bureau to create awareness, reduce barriers and encourage participation in the Census. It is vitally important that community leaders set the clock in motion! You have done this by forming a partnership with the Census Bureau to ensure that this time, there will be a complete count of the Minnesota Hispanic community. I have enclosed your copy of the Partnership Agreement that you signed. I look forward to working with you on this very important undertaking.

Sincerely,

Irene Gomez-Bethke  
Community Partnership Specialist  
Bureau of the Census



**UNITED STATES DEPARTMENT OF COMMERCE  
Bureau of the Census**

Regional Census Center  
10015 NW Executive Hills Blvd., 2nd Floor  
Kansas City, MO 64153-1364

July 12, 1999,

Mr. Adolfo Cardona,  
President and Publisher  
Latina Midwest  
909 Selby Avenue  
St. Paul, Minnesota 55104

Dear Mr. Cardona:

Thank you for giving me the opportunity to discuss with you Census 2000, the Partnership Program and the importance of being counted in the next Census to the people of Minnesota and specifically, the Hispanic community.

Census 2000 needs community leaders such as you to help the Hispanic community understand why it is important to be counted on April 1, 2000. The salient reasons to be counted are reapportionment for political and voting empowerment in the U.S. House of Representatives, state legislatures and local governments. In addition, the count is also the basis for allocation of billions of federal dollars for programs and services.

As I told you in our discussion, the Partnership Program was initiated by the Census Bureau to create awareness, reduce barriers and encourage participation in the Census. It is vitally important that community leaders set the clock in motion! You have done this by forming a partnership with the Census Bureau to ensure that this time, there will be a complete count of the Hispanic community. I have enclosed a copy of your Partnership Agreement and I look forward to working with you on this very important undertaking.. *omit*

Sincerely,

Irene Gomez-Bethke  
Community Partnership Specialist

*✓ d sent  
Rido  
+  
letter to  
Alvaro Ortiz*



---

INTEROFFICE MEMORANDUM

---

TO: IRENE GOMEZ BETHKE  
FROM: MARIA VEGA CARRERAS *MVC*  
SUBJECT: MIGRANT EDUCATION PROGRAM  
DATE: 03/10/00  
CC: HARVEY

*Spanish Materials*

\* WEDNESDAY MARCH 15, 2000, 4:30 P.M. – 6 P.M.

STAFF TRAINING OF CENSUS 2000

ENERGY PARK DRIVE, ST. PAUL

AND

\* TUESDAY MARCH 21, 2000, 6:30 P.M. – 8:30 P.M.

THREE COMMUNITY ORGANIZATIONS WILL BE PRESENT:

- HUMBOLDT PARENT GROUP,
- GET READY PROGRAM AND
- MIGRANT PROGRAM

INFORMATIONAL AND RECRUITING PRESENTATION, POSSIBLE GROUP SIZE 30.

CAN ANY SERVICES BE PROVIDED BY THE CENSUS BUREAU?

- TRANSPORTATION
- SNACKS

CONTACT PERSON IS NOEMI TREVINO 651/793-5548

MIGRANT EDUCATION PROGRAM.

## CITY OF RICHFIELD

## Memorandum

DATE: January 21, 2000  
TO: Irene Gomez-Bethke, Bureau of the Census  
FROM: Kathy Farris  
SUBJECT: Richfield Census Awareness Committee

The following people are the core group of the Richfield Census Awareness Committee:

Kathy Farris, Human Services Planner/Coordinator, City of Richfield (Chair)  
Gertrude Ulrich, Richfield League of Women Voters  
Lil Hipp, Community Center Manager, City of Richfield  
Julianne Schielz, Director, Richfield Community Apartment Program  
Lesli Kerkhoff, Coordinator, Richfield FamiLink Resource Center  
Virginia Morris, Librarian, Augsburg Park Community Library

The schedule for the Cable Program you did for us is as follows for the rest of this month and the month of February: Tuesdays, 5:00 p.m.; Saturdays, 8:00 p.m.; Time Warner Cable - Channel 15 (in Richfield). The name of the program is "Inside the Issues," sponsored by the Richfield League of Women Voters. I will get a copy of the tape to you as it becomes available.

I will also try to fax to you a list of our Richfield Census Awareness Committee Activities within the next few weeks.

① Feb. 14th Presentation at City Hall 6700 Portland.

② X As I indicated before, you are scheduled to speak for about 15 minutes after a church service on Saturday, March 11, at about 7:15 p.m. The church service is at the Elliot Education Center, 7001 Elliot Avenue South, Richfield. Please be at the Center at 7:00 p.m. The name of the pastor is Juan Aguayo, 612-798-5870 (home); 612-743-9400 (cell phone). Because many in the congregation speak Spanish, please have materials, including questionnaires, in both Spanish and English. Please cover the basics of the purpose and importance of the census at this presentation.

③ I will get back to you regarding presentations at the Augsburg Park Community Library.

④ For your information, the Library is located at 7100 Nicollet Avenue South, Richfield. Possible speaking dates are March 4 or 18, 10:30 a.m. Again, the participants would need materials in both English and Spanish.

As I indicated to you before, we need materials to be placed at various sites, which include posters and general flyers. If possible, we would like materials in English, Spanish, Laotian and Somalian.

Thank you again for all of your assistance. Please feel free to contact me at anytime at 612-861-9754; Fax: 612-861-9749; Email: [Kfarris@ci.richfield.mn.us](mailto:Kfarris@ci.richfield.mn.us).



UNION DEPOT PLACE  
214 EAST FOURTH STREET • SAINT PAUL, MN 55101  
651/224-5153 • FAX 651/298-8414  
www.spnn.org • E-MAIL: info@spnn.org

3/13/2000

TO: Irene Gomez Becky, Census 2000  
From: Dan Reiva, Saint Paul Neighborhood News

SAINT PAUL'S COMMUNITY CHANNELS  
EDUCATIONAL ACCESS CHANNEL 32  
PUBLIC ACCESS CHANNEL 33  
MULTIFAITH ACCESS CHANNEL 34  
COMMUNITY PROGRAMMING CHANNEL 35  
INTERNATIONAL CHANNEL 77

RE: Saint Paul Forum Program Tues., March 14, 7PM

Thank you for agreeing to be a guest on our live discussion program concerning Census 2000. We are particularly interested in discussing the importance of minority groups and recent immigrant groups participating in the Census.

The other participants will be David Zander and Valene Cha.

The following are some of the questions we hope to cover. Please fill free to add questions, clarify questions or give any feedback you would like.

- 1) The theme of the Asian-American kick-off was showcasing the waves of Asian Pacific immigrants over the last hundred years. What were these waves
- 2) Do you think Minnesotans would be surprised at the broad diversity of Asian Pacific communities?
- 3) What efforts are being made to make sure of a "complete count" of Asian Pacific residents?
- 4) Are recent immigrants able to get Census forms in their own languages?
- 5) What other groups in St. Paul and are at-risk for being undercounted?
- 6) Why might some ethnic or immigrant groups be wary or participating in the Census?
- 7) Why was Frogtown along University Ave. a focal point for kick-off activities?
- 8) Why is it important that all neighborhoods and communities be counted accurately for the 2000 Census?
- 9) Are two different Census forms being sent out? How will they differ?
- 10) What kind of follow-up is done by Census workers?

BUILDING COMMUNITY *through* TELEVISION

## RESPONSE TO PEOPLE WHO INDICATE THAT THEY HAVE RECEIVED MORE THAN ONE CENSUS QUESTIONNAIRE

Q. Why am I receiving two or more duplicate questionnaires from the Census Bureau?

▼ In preparing our address list for mailing Census questionnaires, we tried to be as inclusive as possible. We started with our 1990 address list and added address information from the U.S. Postal Service, and local and tribal governments as well as field checks by census workers to build a comprehensive address list. However, this inclusive process sometimes results in duplicate addresses and, thus, multiple questionnaires. Before we eliminate any address from our list, we have a number of census operations which review and verify these addresses. These review procedures are designed to resolve duplicate addresses and will continue through spring and summer of this year.

Q. What should I do when I receive duplicate forms?

▼ We understand we may have delivered more than one census questionnaire to your residence. We are asking you:

- \* to select the addressed form that best represents your current, correct address.

- \*Please ignore the other questionnaires and return your selected form in the postage-paid return envelope that has your current, correct address.

- \*We ask that you do not use or mail back the other questionnaires.

You may be visited by a Census taker, even if you mail back your questionnaire. We will be continuing to verify census information.

Q. Why are you wasting the taxpayers' money?

▼ This is not a waste of the taxpayers' money. Our process is designed to produce the most complete count of the Nation's population. Only a small proportion of households in the United States will receive multiple questionnaires. We would appreciate your help in doing what you can to mail back the questionnaire with the correct address information.

03/10/00

**RESPONSE TO PEOPLE WHO INDICATE THAT THEY HAVE NOT YET RECEIVED  
THEIR QUESTIONNAIRES**

Q. I have heard from (my neighbors/friends/relatives, the media, etc.) that I already should have received a census questionnaire. Why haven't I?

▼ **The majority of people will receive their questionnaires between now and March 22<sup>nd</sup>. It is important to wait until that date before you take any other measure to obtain a questionnaire.** Do not be concerned that you have not as yet received your questionnaire. We have a number of different methods for delivering questionnaires to residences. Most questionnaires are delivered by the United States Postal Service while others are delivered by Census takers.

▼ If by March 22<sup>nd</sup> you still have not received a questionnaire, please call our Telephone Questionnaire Assistance number, which is 1-800-471-9424. The staff answering those calls will be happy to mail out a form to you at that time.

▼ We thank you for your patience and understanding that the United States Postal Service and our own census takers are still delivering the forms through most of March. We urge you to complete the form when you receive it.



## WHERE TO COUNT BOARDING SCHOOL STUDENTS IN CENSUS 2000

**Rule:** According to Census 2000 Residence Rule #7, students attending school away from home below the college level, such as at a boarding school or a Bureau of Indian Affairs boarding school, are to be counted at their parental home.

**History and Rationale:** It has been the practice since the first U.S. census in 1790 to count boarding school students at the parental home. The reasons for this are the young ages of the students, their dependency on their parents, and the likelihood that they would return to their parents' residences after completing school. Equally important is the fact that the risk of double counting these students would be much greater if they were enumerated at the school, because their parents would likely report them as living at home, regardless of the procedures.

This rule has been upheld in the courts. For example, in the Court's opinion in *Borough of Bethel Park v Stans* (449 F 2d 575 [3d Cir.1971], this practice was found to be acceptable.

**Application of Rule #7:** The rule must be applied uniformly to all boarding school students, regardless of their parents' residence.

Guidance Memorandum on the use of  
United States Postal Service Temporary Mailboxes

We have received a number of inquiries regarding the use of temporary mailboxes during Census 2000.

The U.S. Census Bureau supports all measures that will foster greater participation in Census 2000. Our advertising and promotional strategy encourages everyone to fill out their form and mail it back as soon as they receive the form.

United States Postal Service Temporary Mailboxes may offer additional outlets and greater convenience for respondents, therefore leading to increased participation in Census 2000.

Temporary Mailboxes must not be used in any circumstance that could lead to the delay of any person mailing back his or her census form, or instances where the forms would be held. Examples include events that suggest entrance or prizes based on providing a completed census form.

Any organization or entity interested in Temporary Mailboxes should work directly with the United States Postal Service.

FOR IMMEDIATE RELEASE

Contact: Bernie Du Clos  
Media Specialist  
(612) 334-4360 ext 125

## SEVERAL MILLION CENSUS FORMS TO BE HAND DELIVERED

*The (Local Census Office) Will Distribute (number) Forms*

A large percent of the approximately 120 million housing unit addresses that have been identified by the Census Bureau will have their Census 2000 forms hand-delivered.

Beginning March 3, census workers will fan out into rural areas of the country to deliver Census 2000 forms to residents with rural and rural post office box addresses. They'll request residents to fill out their forms and mail them in on April 1. When census workers find no one home, they'll leave the census forms at the door.

Census 2000 workers may be identified by their red, white, and blue badges, which say, "Census Enumerator." The white plastic badges have the U. S. Flag on the upper left corner and have the seal of the "United States Department of Commerce-Bureau of the Census" printed in the middle of the badge. Their badges are displayed prominently and have the worker's name on the front side.

Contact your local census office for more information about Census 2000 or job opportunities:

*(Local Census Office Number)*

or

1-888-325-7733

# # #

### Editor's Notes:

News releases issued by the Census Bureau 2000 as well as other activities can be found easily on our Internet home page at ([www.census.gov](http://www.census.gov)). Click on the News button to view releases by date and subject, or for Census 2000 information.

The Census Bureau guarantees that the answers given on Census forms are kept strictly confidential and never shared. Information collected in Census 2000 will provide local area data needed for communities to receive federal program funds and for private sector and community planning.

The Census Bureau--pre-eminent collector and provider of timely, relevant and quality data about the people and economy of the United States, conducts a population and housing census every 10 years, an economic census every five years and more than 100 demographic and economic surveys every year, all of them evolving from the first census in 1790.



## Making the Global Local

Dear Mrs. Gomez-Bethke:

Here comes the promised fax on the Census 2000 Forum on Feb. 26. It will be held in the El Mercado Central, located on 1515 E. Lake Street in Minneapolis. The forum will be set up in the center of the Mercado to reach as many people as possible.

It will start at 11:00 a.m., but it would be nice if you could be there around 10:30 a.m. since you are on the panel.

Yes, please bring posters or any other kind of information material.

Issues to be addressed:

1. Why are Latinos under represented?
2. Why does the media not perceive or address the importance of the census for the Latino community?
3. In general - the role of the mainstream media in advocating the census for minorities in Minnesota?
4. Why does the media not perceive the importance of the Latino community?
5. Why is a complete count important?

The idea behind the forum is to bring people together, to fuel discussion and understanding.

The other members on the panel will be: Ytmar Santiago, Esq. Executive Director, Chicano Affairs Council and Mario Vargas Chair of the Complete Count Committee.

If you have any further questions, you can reach us under 651-523-2314 or fax us under 651-523-3170.

I hope you are feeling better.

Sincerely,

Nicole Zeuner  
Administrative Assistant  
Making the Global Local

Making the  
Global Local  
is a formal  
partnership of

**HAMLIN**  
**UNIVERSITY**

and



in association with:

American Refugee Committee

College of St. Benedict/  
St. John's University

Insight News

KFAL Radio

La Prensa

Star Tribune

University of Minnesota

## Memorandum

**DATE:** January 20, 2000  
**TO:** Irene Gomez-Bathke  
**FROM:** Stephanie Walter - Housing Coordinator  
**RE:** Census Presentation

Dear Irene,

This is confirm your Census presentations at the Harriet Tubman Center on the following dates and times;

**Tuesday, January 25th 10:00a.m. - 11:00a.m. - Shelter Residents**

Harriet Tubman Center - 3111 1st Avenue South, Minneapolis (please use the administration entrance on first avenue and ask the receptionist for me)

Beverly Dusso, the Executive Director, and I will be able to meet with you at 9:30a.m. on Tuesday, January 25th, before your presentation, to discuss the proposed census contract.

**Saturday, February 12th 9:30a.m. - 10:30a.m. - Transitional Housing Residents**

5th Precinct Community Room - 3101 Nicollet Avenue South, Minneapolis (Located across the street from the Harriet Tubman Center)

We would like you give an overview of what the census is, it's importance, and how people can participate. If you have any written materials that we can pass out, that would be helpful. About 10- 15 people will participate in each group.

If you have any questions, please contact me 612-821-4720. I look forward to meeting you on Tuesday. I will see you at 9:30a.m..

Stephanie Walter

*Done Feb. 12 [15 days]*



**Harriet Tubman Center**  
**3111 First Avenue South, Minneapolis, MN 55408**  
**(612) 825-3333**

★ = Harriet Tubman Center location

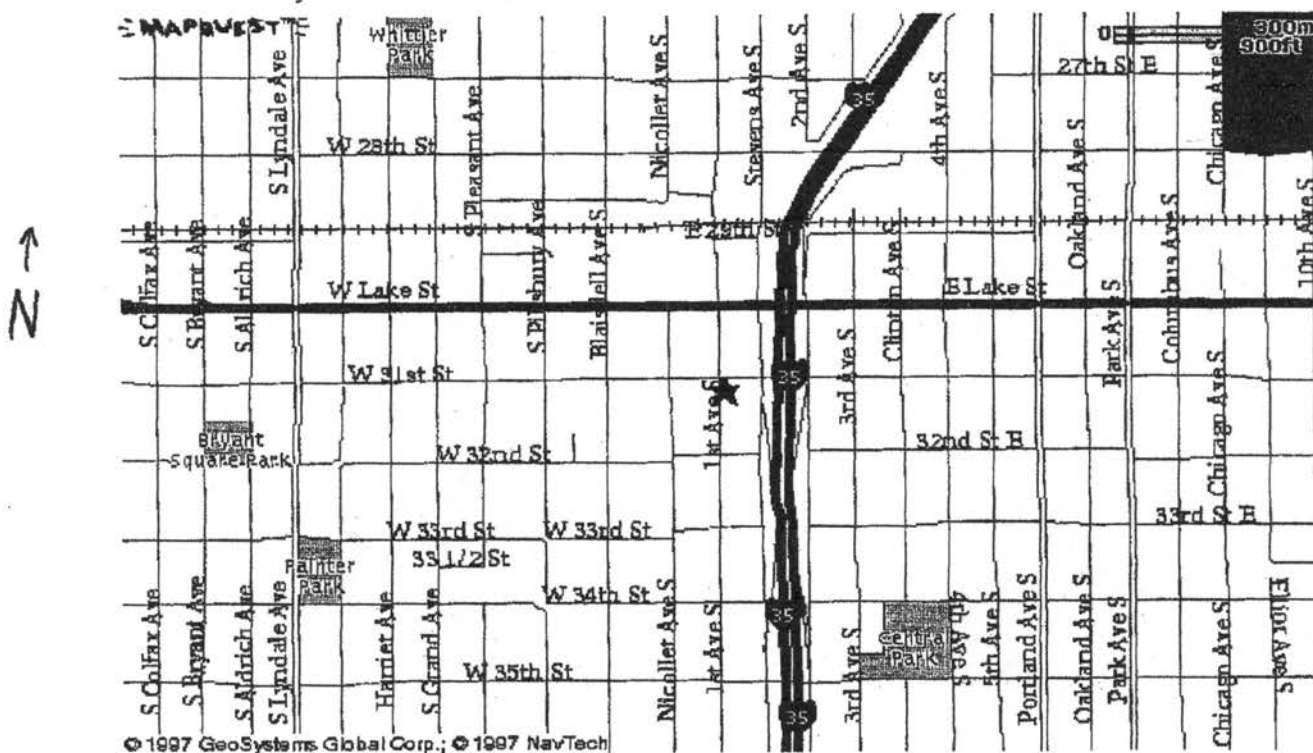

**Harriet Tubman Center (HTC)** is a 3-story, beige and tan, prairie-style stucco building. Please park and enter the building from the south side (off of First Avenue, near the playground equipment). Overflow parking is located southeast ("kitty corner") from the main lot, adjacent to Redeemer Missionary Baptist Church. You may also park on First Avenue, on the left (west) side of the street. Please do not park in the Minnesota Teen Challenge lot.

### Driving Directions

From the North: South on 35W. Take 35th/36th Street exit. Take *immediate* right (west) on 35th Street (a one-way street). Take a right (north) on 1st Avenue (a one-way street). HTC is 4 blocks north, on the right.

From the East: West on 94, take exit to 35W South. Take 35th/36th Street exit (*Note:* This exit comes up quickly - merge right as soon as you can). Take *immediate* right (west) on 35th Street (a one-way street). Take a right (north) on 1st Avenue (a one-way street). HTC is 4 blocks north, on the right.

From the South: North on 35W. Take 35th/36th Street exit. Take a left (west) on 35th Street (a one-way street). Take a right (north) on 1st Avenue (a one-way street). HTC is 4 blocks north, on the right.

From the West: East on 394. Access 94 East near the Basilica. Get onto 35W South. Take 35th/36th Street exit. Take *immediate* right (west) on 35th Street (a one-way street). Take a right (north) on 1st Avenue (a one-way street). HTC is 4 blocks north, on the right.

From the Southwest: East on either Hwy. 62 (Crosstown) or 494 (the Strip). Get onto 35W North. Take 35th/36th Street exit. Take a left (west) on 35th Street (a one-way street). Take a right (north) on 1st Avenue (a one-way street). HTC is 4 blocks north, on the right.

From the Northwest (St. Cloud, etc.): East on 94 to 694 East (94 and 694 combined). Get onto 35W South. Take 35th/36th Street exit. Take *immediate* right (west) on 35th Street (a one-way street). Take a right (north) on 1st Avenue (a one-way street). HTC is 4 blocks north, on the right.



3111 First Avenue South ♦ Minneapolis, MN 55408  
Phone: (612) 825-3333 ♦ Fax: (612) 825-6666 ♦ Crisis Line: (612) 825-0000  
info@harriettubman.org ♦ www.harriettubman.org

## *Preventing Tomorrow's Violence Today*

### Fax Transmission

To: Trevor Gomez-Buon From: Stephanie C. Porter  
Company: Consur Date: 1/20/00  
Fax number: 334-4385 Time: \_\_\_\_\_  
cc: \_\_\_\_\_ Number of pages including cover 3

Message:

**If you do not receive all pages, please contact 825-3333.**

Confidentiality Notice: The documents accompanying this transmission may contain confidential information intended for a specific individual or purpose. The information is private, and is legally protected by law. If you are not the intended recipient, you are hereby notified that any disclosure, copying, distribution, or the taking of any action in reliance on the contents of this telecopied information is strictly prohibited.