

15-1 E

On Line, Montana Division

September 5, 1926

Mr. A. H. Hogeland:

You will recall when we were at Waterton Lake on August 10 we discussed the windows on the lake or front side of the hotel. I think the lower sash should have fair sized window lights of plate glass so as to enable people sitting in the lobby and in the dining room to have an unobstructed view up the lake. Mr. Cromarty, Superintendent of Waterton Park, who I believe is an architect, mentioned this same thing to me the other day and said that he felt we would be disappointed in the result if we proceeded with window lights as small as 12 x 18. I think they should be at least four times that large.

Ralph Budd

Copy-

Mr. Louis W. Hill



CANADIAN NATIONAL PARKS BRANCH  
WATERTON LAKES PARK

WATERTON PARK, ALBERTA, September 5th. 1928.

Dear Mr. Hill,

In accordance with your request that we should prepare the sketch plans for you, I am now enclosing herewith a blue print shewing suggested types of the bungalows which you contemplated building in connection with the Prince of Wales Hotel, at Waterton Lakes Park.

These are intended to be tentative sketches only and are submitted for your approval, personally however I think they are very attractive, and as a matter of fact the blueprint contains sufficient information to enable Oland to proceed with construction work if you should desire him to do so. I would be very glad to make any additional drawings he might require, and if you will inform me as to how many cottages you wish to erect this year I would also make a suitable layout plan.

With kindest regards to Miss Hill, the boys and yourself.

I am,

Yours sincerely,

A handwritten signature in cursive script, appearing to read 'W. Brown'.

P.S. I am sending a copy of this letter and a blueprint to you at your office in St. Paul also.

Louis W. Hill Esq.  
St. Paul. Minn.

15-18

On Northern Pacific Railway  
September 7, 1926

Mr. Louis W. Hill:

I went over to Yellowstone Park last night to see Mr. Albright, because I had had up with him, while you were away, the matter of getting the roads improved in Glacier Park and wanted a definite understanding with him about them. He says the Two Medicine road will positively be ready for the opening of the 1927 season and that the new road from Glacier Park where it connects with the road Walter Hill built, will be ready a year later. He also says he expects to obtain authority to rebuild the road from Babb to Many Glacier.

I think when the Two Medicine road is finished we could make quite a feature of the fact that Glacier Park is situated on our main line and that by stopping over only 12 hours - from morning to evening - travelers east or west may spend a day in the heart of the Rockies at Two Medicine Lake, which will only be thirty minutes from our station. A park that is not on the main line is worth nothing to a railway except ninety days during the park season, but Glacier Park, if well advertised, can be an asset to the Great Northern all the year round and if we had a small, permanent hotel at Two Medicine Lake, I do not believe there is any reason why we should not keep it open from the middle of May until the middle of November.

In any event, I am strongly in favor of featuring the fact that the Great Northern is the southern boundary of Glacier National Park for sixty miles and that travelers on our line enjoy the park twelve months in the year instead of three months.

Ralph Budd ✓

15-1 J

W. J. Miller  
noted

Noted  
W. J. Miller

On Northern Pacific Railway

September 7, 1926

Mr. Louis W. Hill:

One cannot spend a day riding through Yellowstone Park without being tremendously impressed with the fine work done by the Park authorities. The roads are in good condition and everything is exceptionally well kept. With upwards of 175,000 people in Yellowstone Park this year, the camp grounds and road sides are cleaner and freer of rubbish than Glacier Park, and the whole place contrasts with the run down appearance in Glacier Park, very much to the latter's discredit. I understand a new Superintendent will come to Glacier Park, and certainly it will be a good thing as we have practically been without one for two years.

As an evidence of the care with which the Park authorities look after the tourist needs, I enclose copy of the Manual for Railroad Visitors and the Motorists' Guide. Similar manuals are gotten out for other visitors.

The second class hotel accommodations impressed me very favorably, because they enable the hotel management to take care of travelers at very much less cost than to put them in the large hotels, and the people must approve of them because of the large number that stop at the second class hotels in preference to the main hotels. The majority of the railroad visitors use these camps and not the main hotels. As you no doubt know, there are four grades of accommodations, the large hotels, the second class hotels or camps, the family camps where cooking is permitted in the quarters, and the auto tourist camps which are provided by the Government free, except that a nominal charge is made for wood and water.

I am inclined to think that Mr. Albright would be willing to do something for Glacier Park, because I think he really appreciates it. It is certainly discouraging to think of the neglect it has had at the hands of the same Government that has given so much attention and care to Yellowstone.

Ralph Budd ✓



15-1E

CANADIAN ROCKIES HOTEL COMPANY, LIMITED.

175 East 4th St.,  
St. Paul, Minnesota,  
September 7, 1926.

Messrs. L. W. Hill  
Ralph Budd  
W. P. Kenney  
C. O. Jenks  
G. R. Martin

Dear Sir:

In accordance with Article 127 of "The Companies Act" of the Province of Alberta, Canada, notice is hereby given of the first statutory meeting of the Members of the Company, to be held on Tuesday, September 14th, 1926, at 10 o'clock A. M., at 175 E. 4th Street, St. Paul, Minnesota.

As required by the following paragraphs, we the undersigned, certify as follows:

- (a) The total number of shares allotted is five, issued as follows:

|               |         |
|---------------|---------|
| L. W. Hill,   | 1 share |
| Ralph Budd,   | 1 "     |
| W. P. Kenney, | 1 "     |
| C. O. Jenks,  | 1 "     |
| G. R. Martin, | 1 "     |

which have been paid for in cash.

- (b) The total amount of cash received by the Company in respect of such shares is \$500.00.
- (c) An abstract of receipts and payments of the Company on capital account to July 31st, 1926, is attached hereto.
- (d) The names and addresses and descriptions of Directors and officers of the Company are as follows:

| <u>Directors</u> |                 |                    |
|------------------|-----------------|--------------------|
| <u>Name</u>      | <u>Address</u>  | <u>Description</u> |
| L. W. Hill,      | St. Paul, Minn. | Railroader         |
| Ralph Budd,      | do              | do                 |
| C. O. Jenks,     | do              | do                 |
| W. P. Kenney,    | do              | do                 |
| G. R. Martin,    | do              | do                 |

[9-7-1926]

| <u>Officers</u>   |                                |                 |                   |
|-------------------|--------------------------------|-----------------|-------------------|
| <u>Name</u>       | <u>Office</u>                  | <u>Address</u>  | <u>Occupation</u> |
| L. W. Hill,       | President,                     | St. Paul, Minn. | Railroader        |
| W. P. Kenney,     | Vice President,                | do              | do                |
| C. O. Jenks,      | do                             | do              | do                |
| F. L. Paetzold,   | Secretary & Treas.             | do              | do                |
| Geo. H. Hess, Jr. | Comptroller,                   | do              | do                |
| A. H. Hogeland,   | Chief Engineer,                | do              | do                |
| V. P. Turnburke,  | Auditor for stock-<br>holders, | do              | do                |

- (e) Agreement dated July 15, 1926, between Douglas Graham Oland and James Carlton Scott of Cardston, Alberta, doing business as "Oland and Scott", hereinafter called the "Contractor," and the Canadian Rockies Hotel Company, Limited, covering the construction of a hotel at Waterton Lakes Park, Alberta, the construction of which was authorized by the Directors at a meeting held June 22, 1926, is to be submitted to the members for ratification.

Very truly yours,

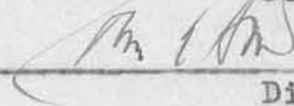
  
 Director.  
  
 Director.

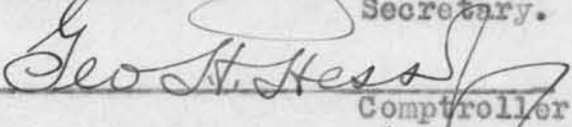
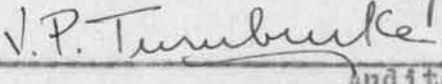
  
 Secretary.  
  
 Comptroller.  
  
 Auditor.

## GLACIER PARK HOTEL COMPANY

Glacier Park, Mont., Sept. 7, 1926.

Mr. W. P. Kenney:

Mr. E. K. Burlew and Mr. J. F. Gartland arrived at Glacier Park the evening of August 27th and departed the evening of August 31st. These gentlemen were from the Department of the Interior, their mission being to investigate conditions in the National Parks. Mr. Burlew, as I understand, is Executive Assistant to Dr. Work, Secretary of the Interior. I do not know Mr. Gartland's official capacity but I inferred that he was something in the nature of a Chief Inspector and he has been very active in making recommendations direct to the Secretary for securing greater efficiency and effecting economies in various departments. Both of these men seemed to be of a very high caliber and were not the ordinary type of investigator looking for small or petty things to criticize. In fact it developed that they were not investigating the concessioner but were looking for inefficiency or weak spots in the conduct of the National Park Service and were more concerned with this than they were with the services rendered by the concessioners themselves, although they apparently were absorbing as much information on all phases of the National Park as they could in the time at their disposal.

Mr. Emery and Myself took them to Two Medicine, Cut Bank, St. Mary, Going-to-the-Sun Camp and Many Glacier Hotel. Although it was storming very hard they desired to make a trip over a typical mountain trail and Mr. Noffsinger and myself took them up over the Swiftcurrent Pass trail. I gathered from their remarks that they would probably make certain recommendations to the Secretary of the Interior which would result in a re-organization of the National Park Service with a view to putting it on a more efficient basis.

After going over the roads they were very frank to say that Glacier Park had not been properly treated in that the Government had been far behind in their obligations to the public in not providing proper road facilities.

They seemed much impressed by Glacier Park and the fact that all the concessioners were working just as harmoniously as if they were one institution and all endeavoring to give proper service. In answer to their questions I told them that the concessioners in Glacier Park had never had any complaint so far as the Government was concerned, except the question of roads and trails and that our officials had never criticized anything on the part of the Government except the lack of suitable roads and trails to properly handle the tourist travel. They made a note of the fact that work on the present Two Medicine road was proceeding very slowly. They were also much impressed with the necessity for bringing the road from Babb to Many Glacier up to the same standard as the new road that is being constructed by Appelgate.

They stated that Mr. H. M. Albright had been appointed Assistant Director, which of course was announced in the papers, and that he would probably be the one that would be responsible hereafter for the re-organization of the National Park Service. When they left here they stated frankly that they had come in here expecting to find a rather unpleasant situation existing and that they found nothing but what the concessioners were to be commended for, but the Park Service was in a very inefficient and disorganized condition, and while they made no definite statements, my inference was that they would make their reports back in Washington and that

[9-7-1926]

W. P. Kenney, #2.

between now and the first of the year it is quite likely that some definite steps would be taken to put the Park Service on a more efficient basis. They gave me the impression, without stating so definitely, that it was quite likely they will have to appoint a new Superintendent for Glacier Park but that this would be a matter probably for Mr. Albright to decide. I think their impression of the present Superintendent was much what nearly everyone who has come in contact with him receives, and that is that he is not sufficiently practical to handle in an executive way a problem which is largely a practical engineering one of building and maintaining roads and trails.

On leaving they told me that within a short time a Mr. Gable, an Inspector from the Department, would be here and they would appreciate our giving him as much advice and information as possible.

I feel that as a result of their investigation here we would be justified in looking forward to a considerable improvement in the National Park Service organization locally in Glacier Park.

I urged them to stay another day, Wednesday, as they would have an opportunity to meet and talk with you, but they had stayed a day longer than they intended to because Mr. Burlew was sick the first day they were here and they regretted very much indeed, not having the opportunity to meeting and talking with you.

H. A. Noble

HANEMO



St. Paul, Minnesota, September 10, 1926.

L. W. Hill, Esq:

After you had seen Mr. Tucker about the golf course he came here. In order to have a distinct understanding I dictated a memorandum while he was present indicating just what he should do for the eight per cent commission which he charges.

I understood that the salary and expenses of the construction superintendent would be paid for by Tucker, but later it seems he intended that we should stand that part of the construction cost. The proposition as now agreed upon is as follows:

The Hotel Company will furnish:

- Grading,
- Water works,
- Sodding and seeding,
- Planting,
- Fencing and other structures

or improvements.

- Construction superintendent,

(salary and transportation expense)

William H. Tucker & Son, Inc., for eight per cent on the cost, will furnish:

- Surveying party,
- Office force for plans

and specifications,

- Supervision by William H. Tucker, Sr. and office force.

Mr. Tucker is asking whether we want him to proceed on this basis. We have held him off all summer, because Mr. Maher felt, and I think rightly, that if we had Mr. Tucker do any work around the hotel it would have made the land cost us too much.

Ralph Budd. ✓

A MACHINE is made,  
a horse is born;  
No four-wheel brakes,  
no screaming horn—  
But hoofs take trails  
that wheels don't know  
With saddle cinch  
and latigo. — x 6

"See America First"

COMPLETE OUTFITS  
FURNISHED FOR  
REGULAR TOURS  
THROUGH PARK AND  
FOR HUNTING,  
FISHING AND  
EXPLORING  
PARTIES IN NORTH-  
ERN MONTANA

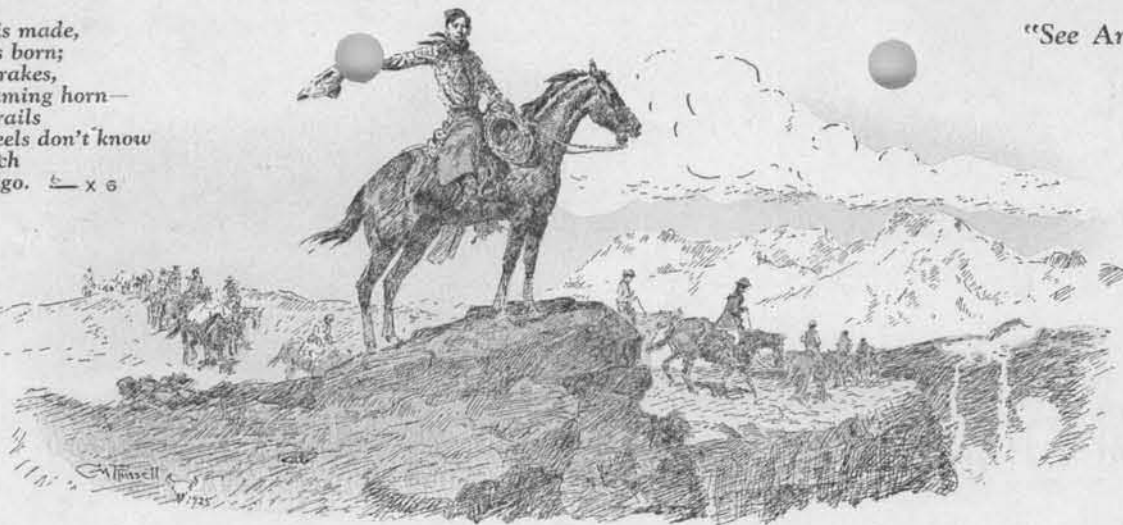

SOLE CONCESSION-  
ERS FOR CAMPING,  
PACK AND  
SADDLE HORSE  
TRANSPORTATION

GUIDES AND  
SADDLE HORSES  
ON SHORT NOTICE

GENERAL ADDRESS:  
KALISPELL, MONTANA

## PARK SADDLE HORSE COMPANY

Glacier National Park

KALISPELL, MONTANA

DURING PARK SEASON:  
GLACIER PARK, MONTANA

Glacier Park, Mont.  
Sept. 11th, 1926.

P e r s o n a l

Mr. Louis W. Hill,  
1127 G. N. Ry. Bldg.,  
St. Paul, Minn.

Dear Mr. Hill:-

I am hoping that we may have the pleasure of a visit from you out here within the next month. Will be here that long and should you care to go into the Park for a little trip would be pleased to make the arrangements for horses or if you should want to go to Waterton and will let me know will have my car here to meet and take you up there. At the present time the road from Cardston to Waterton is impassable for a car, a condition that may exist during the Park Season next year unless the road is graveled. We have provisions at our camp at Waterton which we cannot get out until road conditions improve and last year had finally to go in with a team the last of October to get them. I mention this to illustrate road conditions. We have had rain since the latter part of August though and it should clear up soon and we should get some nice weather yet. The roads dry very rapidly and a few days will put them in condition.

Had a nice trip and visit with Louis Jr. to Waterton. As he is now working suppose that it will be impossible for him to come along. He is a mighty fine boy.

We had some investigators here a short while ago who were sent out by Dr. Work. They seemed very fair and we got them out on some trails or rather one trail in a rain storm and they inquired very closely as to the condition of trails and Mr. Noble as well as myself saw to it that they were correctly informed. We advised them that we did not have as many trails as we did ten years ago. Mr. Albright was here just before and he and these investigators were very much displeased that the Logan Pass trail was closed. They stated that it should never have been closed and assured me that it would not be closed next year. This resulted in a considerable loss of business to us and much dissatisfaction

Mr. Louis W. Hill

No. 2.

Sept. 11th, 1926.

to the tourists. Very little or no work was done on the trails this year, especially on the West side. The passes opened themselves. Of course, the fires took a great deal of time.

Our business on account of fires and rain has been poor this year; As you know I trebled our capacity on the North Circle this year and we did not do quite as much business on it as last year but this was due to the smoke and stormy weather. Did not have over ten nice days in August. September so far has been stormy and no business.

Mr. Burlew and Mr. Gartland were the investigators sent out by Dr. Work and they advised that they did not belong to the Park Service but to the Interior Department. They stated that Dr. Work wanted the operators to get a square deal and that the Park Service did its part. My impression was that they were both agreed that conditions here were bad.

Trusting that you had a most enjoyable summer abroad and with very kind personal regards, I remain,

Yours very truly,

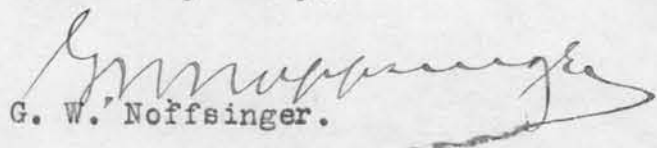
  
G. W. Noffsinger.



# Killmer's Northern Nurseries

Snelling and Larpenieur Aves.

St. Paul, Minn.

Sept 13th 1926.

Mr Louis W Hill.  
% Great Northern Railway Co,  
St Paul, Minn.  
Dear Sir,

We have a block of peonias which we have to remove this fall, on account of extending our seedlings shrub beds another year in extending our irrigation system which we are going to sacrifice on the price. This collection consists of 50 varieties of White, Pink and Red 3/5 eye carefully divided and will consist of approximately 3000 roots one third of each color. some of them range from 75¢ea to \$250 per root retail but we want to clean them out in a hurry to one person if possible They are all double varieties, blooming peroid from the earliest to the latest as we made the selection with this in mind so as to have a long blooming peroid. If you could use this entire lot we would make the price to you for \$250.00 per M or \$700.00 for the 3 M. providing they could be moved within the next two weeks.

We would appreciate your consideration of this offer and trust you will let us know if you are interested, We will if you wish bring you samples of the roots soas you may know exactly what you can expect, We are,

Respectfully yours,  
KILLMERS NORTHERN NURSERIES

ECK/K

*Handwritten notes:*  
L.H.K.  
I have some  
order for 1/2 ton  
for Mr.  
I want to know how  
fast you can get it

GUARANTEE OF GENUINENESS—If any nursery stock, etc., proves untrue to description under which it was sold, we hold ourselves in readiness on proper proof, to replace all such nursery stock, etc., that may prove otherwise, or refund the amount paid, but we shall in no case be liable for any sum greater than the amount originally received for said nursery stock.

"Quality Renders Greater Service Than Price"



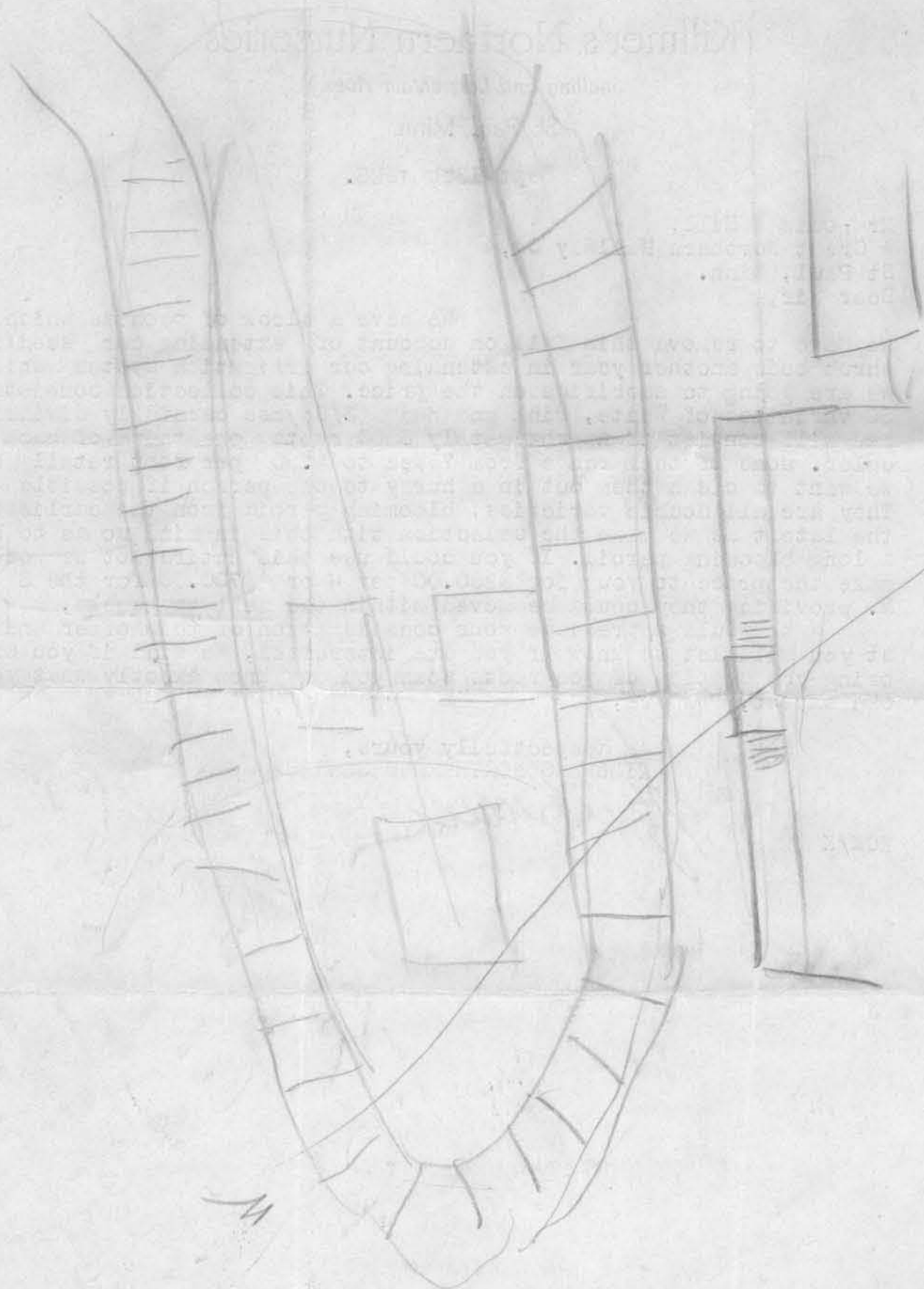

15-1E

St. Paul, Minn., September 14, 1926.

Mr. A. H. Hogeland:

Sorry not to have seen you before leaving town today.

Upon my return here, I looked over the final plans of the Waterton Lake Hotel, and, as they were not satisfactory as to the size of rooms and arrangements thereof, or as to the exterior, and as to general arrangements of the main building - although the contract is let - I talked with Mr. Budd and he suggested a consulting architect.

Accordingly, we had Mr. B. W. Day, of Toltz, King & Day, come in and we discussed the matter with him and I think he will be able to help us. I furnished Mr. Day with a set of plans, as well as the preliminary drawings we had, and gave him my suggestions.

As time is short and we do not wish to delay construction, I think it important to have Mr. Day meet with our Architect, Mr. McMahon, so they can arrange to cooperate on the work that is to be done by Mr. Day. I expect Mr. Day will have his suggestions in line by the time I return - say by next Monday, September 20.

I think it would be well for Mr. Day to meet with Mr. McMahon, so they can advise the contractor where the possible changes may occur. I suggest you have Mr. Day and Mr. McMahon meet and go over this matter as soon as convenient - possibly tomorrow.

Louis W. Hill.

Copy to Mr. B. W. Day,  
c/o Toltz, King & Day,  
Builders Exchange,  
St. Paul, Minnesota.

15-1 E

St. Paul, Minn., September 14, 1926.

Mr. Ralph Budd,  
Mr. W. P. Kenney,  
Mr. C. O. Jenks.

The present plans of the Waterton Lake hotel only call for about sixty-five bed rooms. I think we should consider preparing plans to build the "Help's Dormitory", to be located as originally proposed, some distance - probably west and north from the main hotel. This could be used for hotel guests as an overflow, and no doubt would be full during the Park season. Later, when we add materially to the hotel, it will become the dormitory for the help.

I think we should also prepare rough plans, estimates, and consider building garage, or part of the garage ultimately required, with rooms above. The rooms, for the present, could be used for hotel help and, later, be used for auto and bus drivers.

I think we should also consider building a few - say six or more - small cottages, on the order of photographs of one of several called the "Doll House" group at Carmel, California. These cottages, with rooms which are small - not much larger than a Pullman stateroom - seem to please tourists and are very inexpensive to build from odds and ends of lumber. Such cottages accommodate approximately six persons - sometimes more and sometimes less. Such cottages would be the cheapest way of accommodating an overflow of people and no doubt would be popular. As regards the small cottages, I suggest we write to Carmel and ask the builder to sell us a set of plans covering the one photographed. I am certain he would be pleased to do so.

I would like a report outlining plans for water supply, electric light, heat, etc., for the Waterton Lake hotel. All of this should be on the basis of ultimately taking care of our complete plans, which of course are not of that capacity at present, but the plans should provide so that we can work present installations out in such a way as to fit in with the ultimate scheme.

Louis W. Hill.

Copy to Mr. A. H. Hogeland,  
Mr. B. W. Day.  
*Mr. A. A. Noble*  
*Mr. W. R. Mills*

September 16, 1926.

Killmer's Northern Nurseries,  
Snelling and Carpenter Aves.,  
St. Paul, Minnesota.

Dear Sirs:

Attention: Mr. E. C. Killmer.

Referring to your letter of September 13, to Mr. Louis W. Hill,  
and confirming our telephone conversation of this morning, about block  
of 3000 peonies, consisting of fifty varieties of white, pink and red.

We will be glad to take the entire lot of 3000 roots at price  
of \$700.00.

As suggested in our telephone conversation, it is desired that  
you start digging the roots immediately, and in packing them we would  
prefer barrels, as the roots will probably be shipped out of town. Please  
also bear in mind to have the barrels numbered or labeled so as to indicate  
whether the roots are of white, pink or red variety.

We will advise you more definitely later as to where the roots  
should be delivered for our account.

Yours very truly,

(SIGNED) H. W. KASH  
Secretary to Mr. Hill.

*Copy to Mr. Dishmaker*



(C O P Y)

St. Paul, Minn., September 16, 1926.

Mr. Ralph Budd,  
President.

Dear Sir:

Referring to last paragraph of Mr. Hill's letter of the 14th instant asking for report outlining plans for water supply, electric light, heat, etc. for Waterton Lakes Park Hotel:

*Ind*  
We are proposing to secure water from Waterton Lake near the Narrows, placing pump house down near the water surface there; one pump of about 250 gallons per minute capacity operated by electric motor, and a second pump for emergency of about the same capacity, operated by gasoline or kerosene engine; an 8" wood pipe line about 1,400' long extending thence to a steel tank of 100,000 gallons capacity on steel tower 80' high, located on a knoll about 500' north-westerly from the hotel - water to be distributed from this tank through 6" and 4" pipes to the hotel building and to other buildings, and to fire hydrants located on the grounds outside of the buildings; the power house to be built in a depression in the ground about 350' north-westerly from the building, in which will be placed a boiler, or boilers, of sufficient capacity to furnish steam for heating the hotel and other buildings and to operate an electric generator to furnish current for lighting and for the motors required for pumping<sup>in</sup> and about the hotel building. Either coal or fuel oil to be used in the power plant, whichever proves most economical.

Yours truly,

(Sgd) A. H. HOGELAND.

# Killmer's Northern Nurseries

*Snelling and Larpenleur Aves,*

St. Paul, Minn.

Sept 17th 1936.

Mr Louis W Hill.  
% Great Northern Ry Co  
St Paul, Minn.

Dear Sir;

We are in receipt of your order for the 3000 peonias roots, and will say that we are pleased to state that we are in the process of digging them now and we will have them out by 23th if we do not have to bad wether to dig, We will call you up when ready so that you may give us shipping instructions on same. Thanking you, We are,

Respt yours,

KILLMERS NORTHERNNURSERIES

ECK/K



GUARANTEE OF GENUINENESS—If any nursery stock, etc., proves untrue to description under which it was sold, we hold ourselves in readiness on proper proof, to replace all such nursery stock, etc., that may prove otherwise, or refund the amount paid, but we shall in no case be liable for any sum greater than the amount originally received for said nursery stock.

"Quality Renders Greater Service Than Price"

*Mr. Hill*  
St. Paul, Minn., September 18th, 1926

Mr. Ralph Budd,  
President.

Dear Sir:-

Referring to Mr. Hill's letter 14th instant suggesting larger layout at Waterton Lakes Park:

I think we should go slowly there and not do more than already planned, until we see some definite move made towards gravelling the road Cardston to the Park Boundary.

As you know, this road was practically impassible for several days early in August, and when Mr. McMahon and I were there September 6th to 9th it was in even worse condition, all the hauling of material for the new hotel being at a stand still for over a week.

It was suggested while I was there the last time that it might be a good plan, if we really have in mind a larger layout there now, that you write Mr. J. Y. Card, President, Cardston Commercial Club, to the effect that the Hotel Company desires to make a considerably larger layout, but does not think it wise to construct more than this sixty-five room unit until the road is gravelled and put in first class shape for continuous use during the Park season from Cardston to the hotel site.

Yours truly,

A. N. Hogeland

Cy:- Mr. L. W. Hill ✓

*Mr. Hill!*  
*Mr. Day will be glad submit some plans any time you can see him.*  
*Black 9/20/26.*

| CLASS OF SERVICE   | SYMBOL |
|--|--------|
| Telegram   |        |
| Day Letter   | Blue   |
| Night Message  | Nite   |
| Night Letter   | N L    |
| If none of these three symbols appears after the check (number of words) this is a telegram. Otherwise its character is indicated by the symbol appearing after the check. |        |

# WESTERN UNION



# TELEGRAM

NEWCOMB CARLTON, PRESIDENT

GEORGE W. E. ATKINS, FIRST VICE-PRESIDENT

| CLASS OF SERVICE   | SYMBOL |
|--|--------|
| Telegram   |        |
| Day Letter   | Blue   |
| Night Message  | Nite   |
| Night Letter   | N L    |
| If none of these three symbols appears after the check (number of words) this is a telegram. Otherwise its character is indicated by the symbol appearing after the check. |        |

The filing time as shown in the date line on full rate telegrams and day letters, and the time of receipt at destination as shown on all messages, is STANDARD TIME.

RECEIVED AT 332 ROBERT STREET, ST. PAUL, MINN.

1926 SEP 17 PM 1 58

CC17 2/16

AND WILL BRING HELP TO HANDLE PARTY IF NECESSARY UNDER YOUR  
MAN'S SUPERVISION YOURS VERY TRULY

MARSHALL NEILAN.

*3 Copies made for Mr Kenney's office*



|               |      |
|---------------|------|
| Telegram      |      |
| Day Letter    | Blue |
| Night Message | Nite |
| Night Letter  | N L  |

If none of these three symbols appears after the check (number of words) this is a telegram. Otherwise its character is indicated by the symbol appearing after the check.

# WESTERN UNION



# TELEGRAM

NEWCOMB CARLTON, PRESIDENT

GEORGE W. E. ATKINS, FIRST VICE-PRESIDENT

|               |      |
|---------------|------|
| Telegram      |      |
| Day Letter    | Blue |
| Night Message | Nite |
| Night Letter  | N L  |

If none of these three symbols appears after the check (number of words) this is a telegram. Otherwise its character is indicated by the symbol appearing after the check.

The filing time as shown in the date line on full rate telegrams and day letters, and the time of receipt at destination as shown on all messages, is STANDARD TIME.

RECEIVED AT 332 ROBERT STREET, ST. PAUL, MINN.

1926 SEP 17 PM 1 58

*Louis W. Hill  
En route  
Capt. Williams, N.D.*  
CC17 75 BLUE 1/59

*Following message from Marshall Neilan; Quot.*

B LOSANGELES CALIF 17 1029A

LOUIS W HILL

CARE GREAT NORTHERN RAILWAY CO STPAUL MINN

DEAR MISTER HILL, WIRE ME MY EXPENSE EIGHTEEN FORTY FIVE  
GLENDALE BOULEVARD, LOSANGELES CALIFORNIA, WILL IT BE  
POSSIBLE FOR YOU TO GRANT ME PERMISSION TO USE GLACIER  
NATIONAL PARK FOR ABOUT WEEKS WORK STOP AM MAKING PICTURE  
OF NORTHWEST IN NATURAL COLOR STOP MY PARTY WOULD CONSIST  
OF ABOUT FORTY PEOPLE STOP WOULD LIKE TO USE HOTEL FOR  
ACCOMMODATIONS

FAST MESSAGE



BE BRIEF

St. Paul, Minnesota, September 17, 1926.

H. A. Noble,  
Glacier Park  
Montana.

For your information following telegram from Marshall Heilan has been sent to Mr. Hill at Lake Williams North Dakota. Quote. Dear Mister Hill. Wire me my expense eighteen forty five Glendale Boulevard Los Angeles California. Will it be possible for you to grant me permission to use Glacier National Park for about weeks work Stop. Am making picture of Northwest in natural color Stop. My party would consist of about forty people Stop. Would like to use Hotel for accommodations and will bring help to handle party if necessary under your mans supervision Yours very truly. Unquote. Mr. Kenney with Mr. Hill. Will advise further when reply is received from Mr. Hill.

H. W. Kask.



# TELEGRAM—BE BRIEF

M.

2lje

Lake Williams Sept 17 1926

Harry Kask

Louis Hill GN

Saint Paul



Wire Marshall Neilan, Glad get message, Permission granted,  
Hope meet you there account season closed organization breaking  
up, Suggest you wire direct H A Noble Glacier Park your  
plans and requirements Also dates arrival departure Kindest  
regards Harry, Send Noble copy Neilan telegram and this reply

Louis W Hill

1110am

18th

FAST MESSAGE



BE BRIEF

COPY

Lake Williams, Sept. 17, 1926.      21 je

Harry Kask,  
c/o Louis Hill,      GN  
St. Paul,

Wire Marshall Neilan. Glad get message. Permission granted. Hope meet you there account season closed organization breaking up. Suggest you wire direct H. A. Noble Glacier Park your plans and requirements. Also dates arrival departure. Kindest regards. Harry Send Noble copy Neilan telegram and this reply.

Louis W. Hill.

7 Copies sent Mr Kenney's office  
C&G 9/18/26



## CLASS OF SERVICE DESIRED

|               |                                     |
|---------------|-------------------------------------|
| Telegram      | <input checked="" type="checkbox"/> |
| Day Letter    | <input type="checkbox"/>            |
| Night Message | <input type="checkbox"/>            |
| Night Letter  | <input type="checkbox"/>            |

Patrons should mark an X opposite the class of service desired; OTHERWISE THE MESSAGE WILL BE TRANSMITTED AS A FULL-RATE TELEGRAM

# WESTERN UNION TELEGRAM

NEWCOMB CARLTON, PRESIDENT

GEORGE W. E. ATKINS, FIRST VICE-PRESIDENT

Receiver's No.

Check

Time Filed

Send the following message, subject to the terms  
on back hereof, which are hereby agreed to

St. Paul, Minnesota, September 18, 1936.

Marshall Weilan  
1845 Glendale Boulevard,  
Los Angeles California.

Glad get message. Permission granted. Hope meet you there <sup>^</sup>account  
season closed organization breaking up. Suggest you wire direct H. A. Noble  
Glacier Park your plans and requirements. Also dates arrival departure.  
Kindest regards.

Louis W. Hill

W. U. Frank 38139

Copy to Mr. W. P. Kenney

FAST MESSAGE



BE BRIEF

*Mr. W. P. Kenney*  
St. Paul, Minnesota, September 18, 1926.

H. A. Noble,  
Glacier Park,  
Montana.

Following from Chairman Lake Williams North Dakota. Quote. Wire Marshall Heilan Glad got message. Permission granted. Hope meet you there account season closed organization breaking up. Suggest you wire direct H. A. Noble Glacier Park your plans and requirements. Also dates arrival departure. Kindest regards. Unquote.

H. W. Kask.

Copy to Mr. W. P. Kenney:



# MINNESOTA HISTORICAL SOCIETY

Copyright in this digital version belongs to the Minnesota Historical Society and its content may not be copied without the copyright holder's express written permission. Users may print, download, link to, or email content, however, for individual use.

To request permission for commercial or educational use, please contact the Minnesota Historical Society.



[www.mnhs.org](http://www.mnhs.org)