



Emily Anne Staples Tuttle papers.

Copyright Notice:

This material may be protected by copyright law (U.S. Code, Title 17). Researchers are liable for any infringement. For more information, visit

www.mnhs.org/copyright.

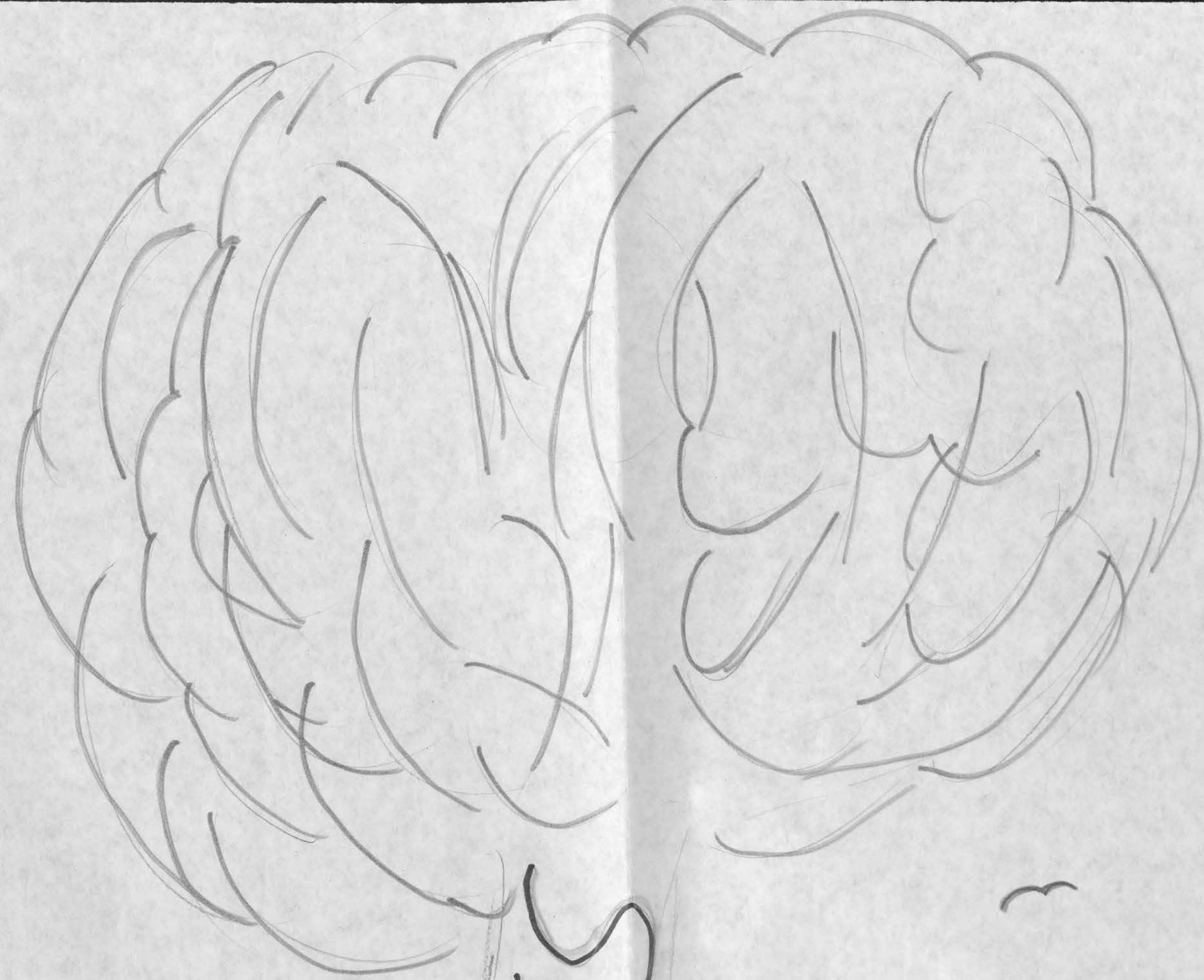

STAPLES

District 43 Topsoil

Energy & Housing
Hennepin County Library Board
HEALTH CARE
HISTORIC PRESERVATION
HUMAN RESOURCES
Employment
SMALL BUSINESS PEOPLE
GIFTED & TALENTED STUDENTS
Education
SENIOR CITIZENS
SCHOOL BOARDS
Economic STATUS FOR
Task Force
Voters
COUNCIL on
Aging
VETERANS
DAY CARE
MINNESOTA NURSERY MUSEUM

20 Year

BED ROCK



What's HIS NAME??

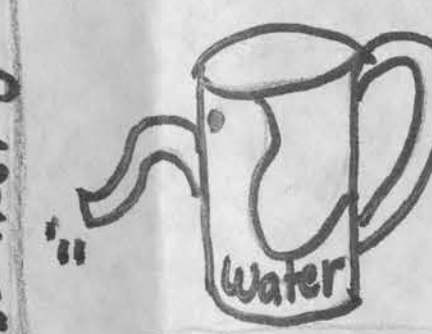

ERENZEL



Roots system (under-development)



CITY OF PLYMOUTH

STREET MAP



SCALE OF MILES

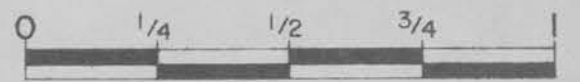

19100 BROCKTON
19000 ALVARADO
18900 ZIRCON
18800 YELLOWSTONE
18700 XANTHUS
18600 WALNUT GROVE
18500 VAGABOND
18400 URBANDALE
18300 TROY
18200 SHADYVIEW
18100 RANIER
18000 QUEENSLAND
17900 PEONY
17800 OLIVE
17700 NARCISUS
17600 MERRIMAC
17500 LAWDALE
17400 KIMBERLY
17300 JEWEL
17200 INLAND
17100 HOLLY
17000 GARLAND
16900 FOUNTAIN
16800 EVEREST
16700 DUNKIRK
16600 CONSTOCK
16500 BLACK OAKS
16400 ARCHER
16300 ZANZIBAR
16200 YUMA
16100 XENE
16000 WESTON
15900 VICKSBURG
15800 UPLAND
15700 TERRACEVIEW
15600 SHENANDOAH
15500 RANCHVIEW
15400 QUANTICO
15300 POLARIS
15200 ORCHID
15100 NIAGARA
15000 MINNESOTA
14900 LANEWOOD
14800 KINGSVIEW
14700 JUNEAU
14600 ITHACA
14500 HARBOR
14400 GLACIER
14300 FERNBROOK
14200 EMPIRE
14100 DALLAS
14000 CHESHIRE
13900 BERKSHIRE
13800 ANNAPOLIS
13700 ZINNIA
13600 YUCCA
13500 XENIUM
13400 WEDGEWOOD
13300 VINEWOOD
13200 UNDERWOOD
13100 TEAKWOOD
13000 SYCAMORE
12900 ROSEWOOD
12800 QUINWOOD
12700 PINEVIEW
12600 OAKVIEW
12500 NORWOOD
12400 MAGNOLIA
12300 LARCH
12200 KIRKWOOD
12100 JONQUIL
12000 IVES
11900 HEMLOCK
11800 GOLDENROD
11700 FORESTVIEW
11600 EVERGREEN
11500 DEERWOOD
11400 COTTONWOOD
11300 BALSAM
11200 ARROWOOD
11100 ZACHARY
11000 YORKTOWN
10900 XIMINES
10800 WELLINGTON
10700 VALLEY FORGE
10600 UNION TERRACE
10500 TRENTON
10400 SARATOGA
10300 REVERE
10200 QUAKER
10100 PILGRIM
10000 ORLEANS
9900 NATHAN
9800 MONTICELLO
9700 LANCASTER
9600 KILMER
9500 CO RD NO 18

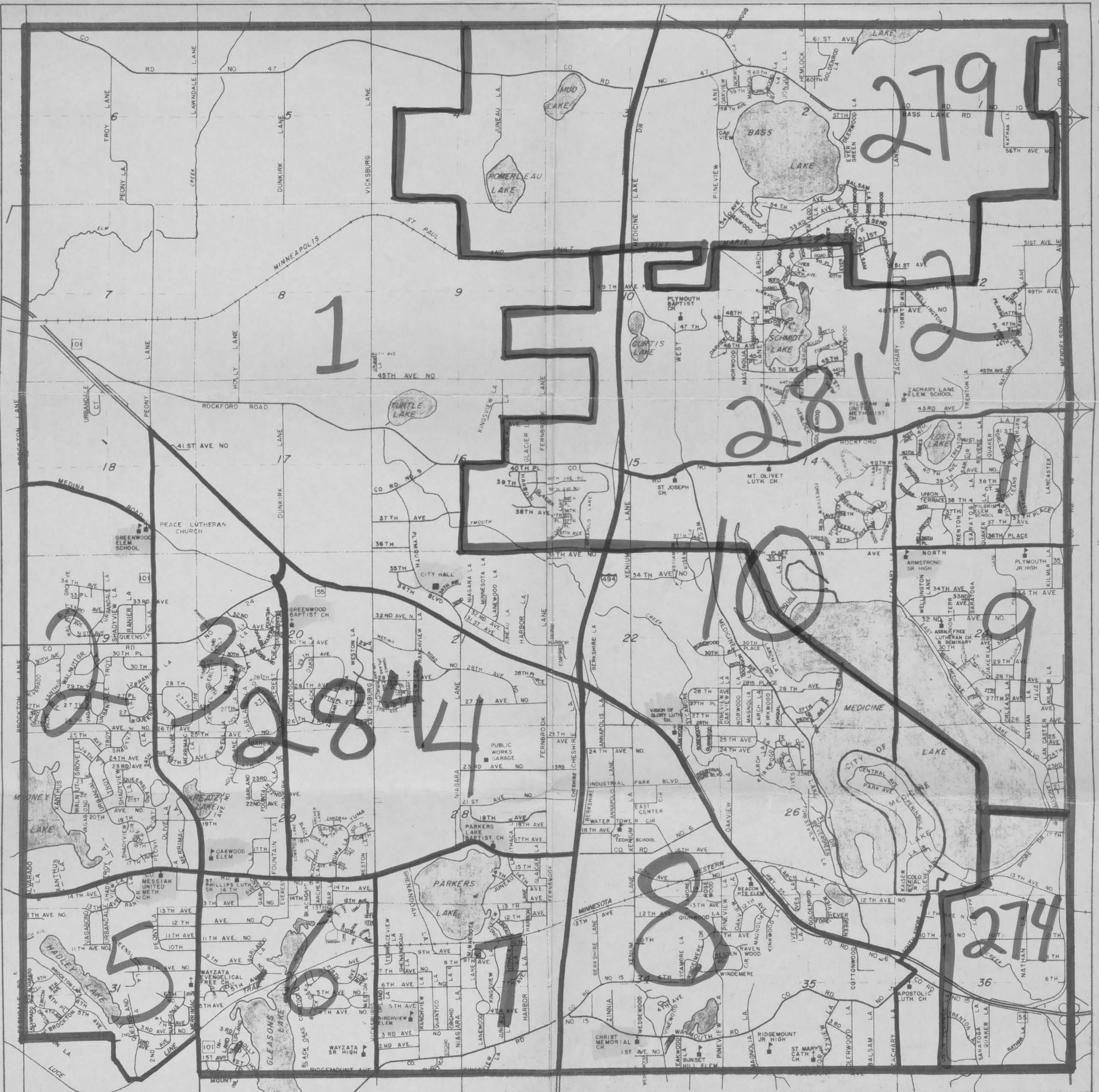

Polling places marked in yellow
Even numbers on North and East side of street
Odd numbers on South and West side of street

School Districts outlined in green
Hopkins - 274
Osseo - 279
Robbinsdale - 281
Wayzata - 284

PLYMOUTH VILLAGE

HENNEPIN CO., MINN.

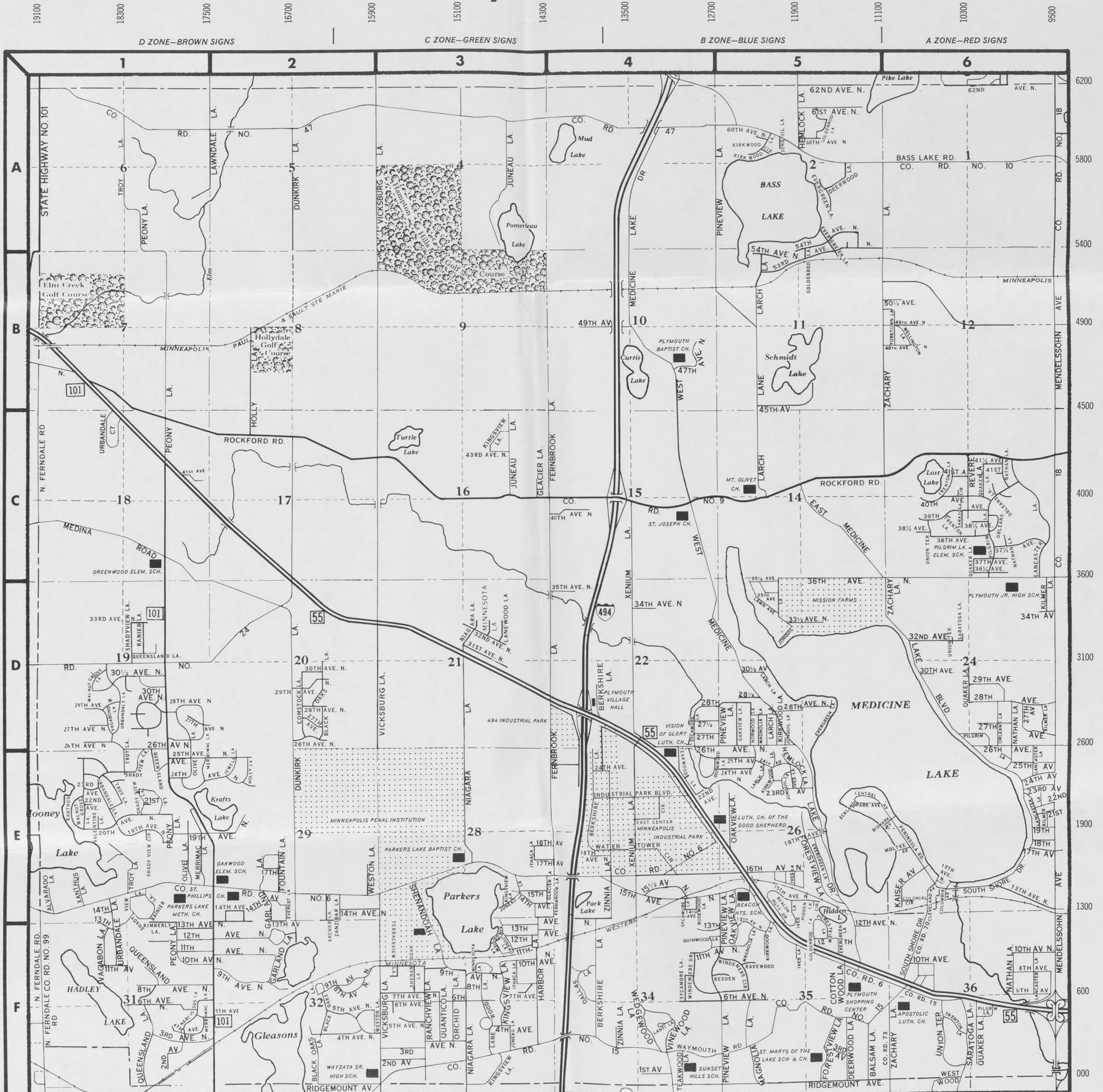
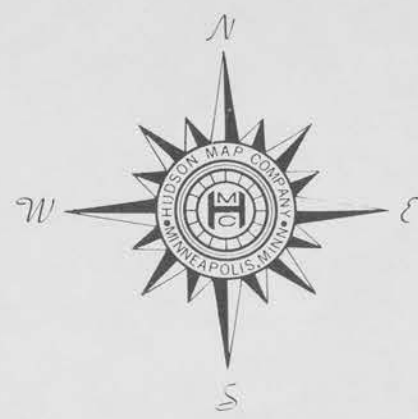

Alvarado La. E-1	Co. Rd. 10..... A-6	Forestview La. E-5, F-5	Jewell La. E-2	Magnolia La. D-5, F-5	Orchid La. F-3	Revere La. C-6	Tray La. A-1, E-1	Windmere Dr. F-4	8th Ave. N. F-6	25th Ave. N. E-1, E-6	37th Ave. N. C-6
Archer La. F-2	Co. Rd. 15..... F-4, F-6	Fountain La. E-2	Jonquil La. A-5, E-5	Medicine Lake Blvd. C-5	Orleans La. C-6, D-6	Ridgmont Ave. F-2, F-5	Union Terr. C-6, F-6	Xanthus La. E-1	9th Ave. N. F-3	26th Ave. N. D-1, E-6	37 1/2 Ave. N. E-6
Balsam La. F-5	Co. Rd. 18..... A-6, C-6	Garland La. F-2	Juneau La. A-3, F-3	Medicine Lake Blvd. C-5	Park Ave. E-5	Rockford Rd. C-2, C-5	Urbandale Ct. C-1	Xenium La. D-4, E-4	10th Ave. N. F-1, F-6	27th Ave. N. D-1, D-6	38th Ave. N. C-6
Bass Lake Rd. A-6	Co. Rd. 24..... D-2	Glacier La. C-3, E-3			Peninsula Rd. E-6	Rosedale La. E-4	Urbandale La. D-1, F-1	Yorktown La. B-6	11th Ave. N. F-1, F-6	27 1/2 Ave. N. D-4	38 1/2 Ave. N. C-6
Beacon Hgts. Dr. E-5	Co. Rd. 47..... A-2, A-4	Goldenrod La. A-5, F-5			Peony La. A-1, F-1	Saratoga La. C-6	Vagabon La. D-1, F-1		12th Ave. N. F-1, F-6	28th Ave. N. D-1, D-6	39th Ave. N. C-6
Berkshire La. D-4, F-4	Co. Rd. 99..... F-1				Pilgrim La. C-6, F-6	Saratoga La. C-6	Valentine La. E-1		13th Ave. N. F-1, F-6	28 1/2 Ave. N. D-5	40th Ave. N. C-6
Bismark Ave. E-5					Pineview La. A-5, F-5	Shadyview Cir. E-1	Vickburg La. A-3, F-3		14th Ave. N. F-1, F-6	29th Ave. N. D-1, D-6	41st Ave. N. C-1, C-6
Black Oaks La. D-2, F-2					Quaker La. C-6, F-6	Shadyview Cir. E-1	Vineyard La. E-4, F-4		15th Ave. N. F-1, F-6	30th Ave. N. D-1, D-6	41 1/2 Ave. N. C-6
Central Ave. E-5					Quintaco La. F-3	Shore Dr. F-6	Waymouth La. F-4		16th Ave. N. F-1, F-6	30 1/2 Ave. N. D-1, D-6	43rd Ave. N. C-3
Cleveland Ave. E-6					Quintaco La. F-3	State Hwy. 101, A-1, F-2	Waymouth Rd. F-4		17th Ave. N. F-1, F-6	31st Ave. N. D-3	43rd Ave. N. C-3
Colonial Cir. E-6					Quintaco La. F-3	State Hwy. 101, A-1, F-2	Waymouth Rd. F-4		18th Ave. N. F-1, F-6	32nd Ave. N. D-3	45th Ave. N. B-5
Columbia Ave. E-6					Quintaco La. F-3	State Hwy. 101, A-1, F-2	Waymouth Rd. F-4		19th Ave. N. F-1, F-6	33rd Ave. N. D-3	45th Ave. N. B-5
Comstock La. D-2					Quintaco La. F-3	State Hwy. 101, A-1, F-2	Waymouth Rd. F-4		20th Ave. N. F-1, F-6	34th Ave. N. D-3	47th Ave. N. B-5
Cottonwood La. F-5					Quintaco La. F-3	State Hwy. 101, A-1, F-2	Waymouth Rd. F-4		21st Ave. N. F-1, F-6	35th Ave. N. D-3	48th Ave. N. B-5
Co. Rd. 6..... E-2, F-5					Quintaco La. F-3	State Hwy. 101, A-1, F-2	Waymouth Rd. F-4		22nd Ave. N. F-1, F-6	35 1/2 Ave. N. D-5	50 1/2 Ave. N. B-5
Co. Rd. 9..... C-4					Quintaco La. F-3	State Hwy. 101, A-1, F-2	Waymouth Rd. F-4		23rd Ave. N. F-1, F-6	36th Ave. N. D-5	54th Ave. N. A-5
					Quintaco La. F-3	State Hwy. 101, A-1, F-2	Waymouth Rd. F-4		24th Ave. N. F-1, F-6	36 1/2 Ave. N. D-6	60th Ave. N. A-5
					Quintaco La. F-3	State Hwy. 101, A-1, F-2	Waymouth Rd. F-4				61st Ave. N. A-5
					Quintaco La. F-3	State Hwy. 101, A-1, F-2	Waymouth Rd. F-4				62nd Ave. N. A-5, A-6

STATE OF MINNESOTA

OFFICE OF THE GOVERNOR

ST. PAUL 55155

ALBERT H. QUIE
GOVERNOR

December 17, 1979

The Honorable Emily Anne Staples
1640 Xanthus Lane
Plymouth, Minnesota 55391

Dear Emily Anne,

As the holiday season approaches and the year draws to a close, I want to take this opportunity to extend best wishes to you and your family.

I have enjoyed working with you these past 12 months and approach 1980 with eagerness, confidence and enthusiasm. It is my hope that the spirit of this season - love, concern and sharing - will undergird our actions in 1980 as we continue to share in the responsibility of service to the people of Minnesota.

Similar to families, whose individual members may have diverse and conflicting opinions, goals and interests, but are drawn together in a oneness of spirit at this time of year, so, too, may the oneness of spirit we share in love for Minnesota and its people give added meaning to this special time.

I look forward to working with you in the coming months and anticipate a New Year filled with peace and good will toward all.

Sincerely,

ALBERT H. QUIE
GOVERNOR

Fund raisers

cocktail party for lobbyists - in a home
women's party -
young people

most vital people
telephone

sign

mailing

scheduling - people with me at all times

- manager is the key - calendar

July - Nov
day by day

relate to campaign manager

On to one level is the only way to win.

Know every area of dist.

Sat. morning - good for door knocking

enter
first mailing - getting to know you

brochure - image - issues

logo

adviser from legislature - resource research

Treas.

Mgt.

Calendar coordinator - every day

Myna Morosky (Harry's) - Paul Wozak

mailing coordinator

image person (P.R.)

last have 2 or 3

committees!

get them

working - bigger

and bigger thing!

{for comrades -
all committees

- Meet once a week -

sign chairman - get choice spots

① in door knocking
as soon as possible

promotion

get a pro for
literature

② be sure you have
someone to maintain
them!

sign! logo!

handouts

door knocker

put picture

everywhere

Candida in

district - issue

oriented

(good spot for toring)

③ get a hqr.

~~the~~

family fund raisers during campaign
weiner roast

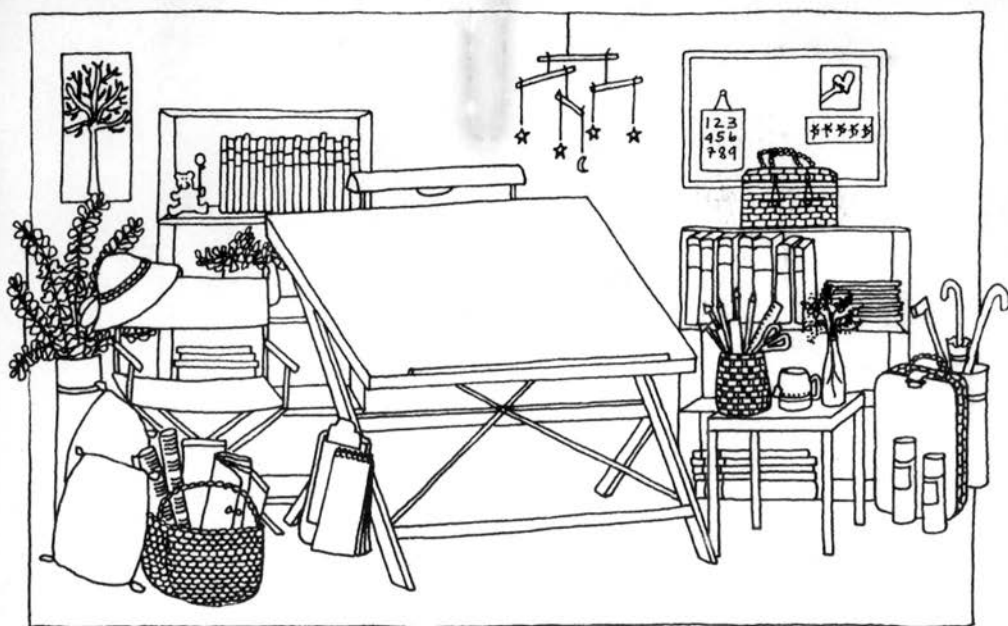

back to the old drawing board

EAS -

Can't reach you by phone
but want you to know we
don't have any time to
look back ... you must
run for lieutenant
governor. You'd be perfect,
the time is right and we
can do it.

Over and over what I am
hearing is the crisis in
leadership and the need
to moderate our approach.
Don't look back - it was
awful - look ahead and
become a phoenix!

Call me soon. CSW

BARBARA STUHLER

11/6/80

Dear Emily,

Damn!

Barbara

P.S. Let me know if you
need contributions for
any expenses incurred
and unpaid.

First Bank System

First Bank System, Inc.
1400 First National Bank Building
P.O.Box 522
Minneapolis, Minnesota 55480
612 370-5106

J. Ron Pratt
Vice President
Corporate and
Governmental Relations

November 6, 1980

Senator Emily Anne Staples
1640 Xanthus Lane
Plymouth, MN 55391

Dear Emily Anne:

I am crushed. I don't know what else to say.
There are no words adequate to express my
bitter disappointment in your loss.

Those of us who have been privileged to work
with you have been enriched by that experience.
For that, I will always be most grateful.

Sincerely,

A handwritten signature in dark ink, appearing to be 'J. Ron Pratt', written in a cursive style.

J. Ron Pratt

JRP:bg

GEORGE S. PILLSBURY

Senator 42nd District

1320 Bracketts Point Road

Wayzata, Minnesota 55391

(612) 473-9634

Offices:

130 State Office Building

St. Paul, Minnesota 55155

(612) 296-4121

930 Dain Tower

Minneapolis, Minnesota 55402

(612) 338-3873

Senate

State of Minnesota

November 5, 1980

Honorable Emily Anne Staples
1640 Xanthus Lane
Plymouth, Minnesota 55447

Dear Emily

As you know, I have always been very, very sorry that we are in opposite camps and this ultimately caused your defeat. You will be sorely missed in St Paul, particularly on the Employment Committee.

Certainly when you do visit the Capitol, please drop by. There are many issues where I need your advice and counsel.

With all best wishes.

Sincerely,



GSP/rap

COMMITTEES • Elections, Employment, Finance, Rules and Administration •
Legislative Audit Commission

SERVING • Corcoran, Dayton, Deephaven, Excelsior, Greenfield, Greenwood, Hanover, Hassan, Independence, Long Lake, Loretto, Maple Grove, Maple Plain, Medina, Minnetonka Beach, Minnetrista, Mound, Orono, Rogers, St. Bonifacius, Shorewood, Spring Park, Tonka Bay, Wayzata, Woodland



TRACY WHITEHEAD

Wednesday -

Dear Emily Anne -

Just want you to know
that you've been in my thoughts
all day. I am so very, very
sorry - mainly for you, but
also for the people of Minnesota.
We've all lost a super person.
One consolation - you're in good
company! McGovern, Bayh, Church,
etc.

You ran a good race - I
was very impressed (as I always
am) with your organization, your

commitments, your articulate and
thoughtful comments. \$52,000 and
the superstars is too much for anyone.
I do hope this isn't the end of
your "public life." We need you
now —

So rest, recuperate — and then
run again. Your terrific and
we'll all support you — anyplace!

Fondly,
Tracy

CSI

Dear Emily,

Just a line to
tell you we share
the sentiments of
many who will miss
you in St Paul next
winter.

You are bright
light — and we need
you. Let this be

just a temporary
pause —

Affectionately.

Connie

JAMES C. OTIS
7 CROCUS HILL
ST. PAUL, MINNESOTA 55102

Nov 6

Dear Ernie

On a positive note, do
us the favor of hanging
in for the next round.

The Trib editorial says it
all. We need you at the
Capitol so start campaigning
right now for 1982. In any
case you still have a life time
pass to the judges dining room.
Affectionately - Jim

ALLAN H. SPEAR
2204 Seabury Avenue
Minneapolis, Minnesota
55406

November 6, 1980

Sen. Emily Staples
1640 Xanthus Lane,
Plymouth, MN 55447

Dear Emily,

What can I say? Except that I'm certainly going to miss you. Of all the disasters that befell Democrats on Tuesday, the two that I wept most about were yours and George McGovern's. From all I've heard, you did everything you could-- but it's pretty hard to fight unlimited dollars. So keep your chin up -- I sense that we're going to be seeing you back here in the not too distant future.

Best,

Allan

Allan Spear

AHS/dj

JOHN TRACY ANDERSON
1239 WEST COMO BOULEVARD
SAINT PAUL, MINNESOTA 55103

Nov. 5, 1980

Dear Emily,

I know the hurt
and you can be sure I
share your feelings at this
time.

Don't forget you still
have a lot of friends made
during your legislative
service. I count myself
as one.

Hope we can still get
together in the future.

Sincerely,
John

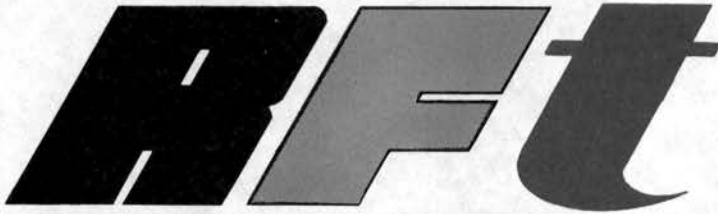

ROBBINSDALE FEDERATION of TEACHERS

LOCAL 872 AMERICAN FEDERATION of TEACHERS, AFL-CIO
2040 Douglas Dr. N., Minneapolis, MN 55422-Phone 546-5244

November 6, 1980

Senator Emily Staples
1640 Xanthus Lane
Plymouth, Mn. 55391

Dear Emily:

Though I cannot offer you victory congratulations, I can for a splendid campaign. Unfortunately, Emily, your district was targeted by forces outside of our state who are attempting to eliminate influential Democrats. I think the editorial in the morning Tribune summarizes the feeling that many of us hold: "Staples has been a humane, hardworking legislator. Moreover, the outcome is disturbing evidence that slick, well-financed campaigns may change the nature of legislative races as they have changed statewide and congressional races."

Upon the completion of re-districting should you decide to challenge Mr. Ramstad, you can count on our support.

Sincerely,

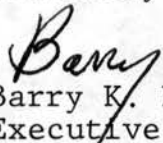
Barry K. Noack
Executive Secretary

cc: Sandra Peterson
Lois Wendt

Ideas from Bob Hurner, Mondale's office.

Team:

4 key people:

1. Treasurers
2. Schedulers
3. Expeditors -- literature
4. Volunteer Coordinators

and

Key persons in every precinct.

Mondale's office has information per each legislative district on a precinct by precinct basis. This info also indicates by district the ages, whether vote DFL or Republican and other general characteristics.

Important: Your volunteers and key precinct people should be the first to see any new literature / brochures / newsletters and signs, fundraiser info. etc.

Don't have a name on the disclaimer of your literature that alienates. Search for a non-controversial person if you have to.

Voter Identification

Important especially
in identifying new
residents and apartment
dwellers

Correctly identify the:

1. names
2. addresses
3. phone numbers
4. political affiliations
5. if registered to vote

of everyone in the district.

Resources:

1. Manpower: Need 8-10 people every night in a phone bank for 2-3 weeks (Thurs. are best nights) ^{tho Tuesday, Wed., and}
2. Voter registration lists obtained from the County
3. A current (May) reverse directory obtained from the phone company.
4. 3x5 cards
5. Voter identification materials from other campaigns

Best technique after 10 years:

"I'm calling from the Plymouth DFL Club and we're trying to identify the Democrats in Plymouth."

"Why?"

"So we can send them some literature." Then proceed.....

Always have someone in charge of the records.

If you get a really friendly person on the phone, ask them if they would mind helping the campaign at some future time, such as putting up a door sign in their yard ^{for} about 2 weeks in November. Note on the 3x5 card if the person is really interested.

Every time you get a new voter registered, have your cards immediately send out a thank you -- re: Glad you care enough to vote; upon calling place is... included campaign literature. A soft sell approach.

Phones. Best to use a phone bank of 5-10 phones. Lists get lost, etc. if people are phoning from their own homes and data may not be recorded as accurately or uniformly.

Pick up people in 2 or 3 cars.

Have an exact time, say 5:30 to 9:30 pm.

Plan on one break. Serve cookies or something light.

Have a set "orientation speech."

Door Knocking

Candidate. It is important that the voters/campaign workers know that the candidate is doing more work than they are. One way the candidate establishes this fact, is to door knock the district.

The candidate should be able to cover 25 to 30 houses per hour. If the houses are close together, 40 to 60 houses should be covered in an hour. A schedule based on the number of houses covered per hour, each day, each month must be developed so you know how much time the candidate will have to spend door knocking during the campaign.

The candidate should not spend much time at each house. "Presume your interrupting" the homeowner. All the candidate has to say is:

"Hi, I'm Emily Staples. I'm running for the Senate. I'd like to be your state senator.

Here's a newsletter (or whatever) that explains my background and my position on issues."

If the homeowner has any questions, get their name (if you don't have it) and their concern and tell them you'll get back to them. The candidate absolutely can't talk to the voters. There aren't four voters in 1000 who want to talk issues. The "talkers" are usually activists who have already made up their mind. The

out on a map who is door knocking
what, so when the candidate returns
to door knock the homes he/she hasn't
covered, these homes will be readily
identifiable and geographically close
together.

Candidate should have voter
registration materials when door knocking.

Also, candidate should leave
something at a residence even if the
voter is gone indicating "while you
were out, I stopped by, etc."

This may just be written out on the
literature ahead of time (so the candi-
date doesn't have to stop during her/his
door knocking to write it out). This should
be personalized, if possible, i.e.,
"Mr. and Mrs. Bob Jones"

candidate will lose 25 voters for every 1 voter he/she spends much time talking to.

The candidate should doorknock daily, all the time. Afternoons and evenings. At a minimum, the candidate should be able to doorknock the district 1 1/2 times. MUST COVER THE ENTIRE DISTRICT AT LEAST ONCE.

The candidate should begin doorknocking

1. Homes on heavily travelled streets
2. Homes of delegates and alternates and those who attended the Feb. precinct caucus
3. Heavy DFZ districts / precincts.

Doorknock Republican precincts in the middle of your doorknocking effort.

Doorknock the Democrats again, near the end of your doorknocking effort.

When doorknocking heavily travelled streets the candidate can spend more time here, because he/she should ask them if they'd be willing to put up lawn signs for her. Shoot for the corner lots.

Initially, to pace the candidate, it may be wise to have someone else accompany the candidate and doorknock the opposite side of the street. However, the side of the street covered by this "someone else" should not be counted as covered by the candidate. If "someone else" does accompany the candidate, it is important to plot

Door Knocking

Volunteers.

Time to
begin
is 5:00
pm.

There should be a weekly door knock in the district. Someone in the district should host it. People should come right from work. Each volunteer is given no more than an hour's assignment. Also, a map of the doors to be knocked is provided to each volunteer. Cards, to be filled out, for identifying people willing to put up lawn signs are given to the workers.

The worker says, "Hi, I'm working for By the way, can we put up a lawn sign to get her name out."

The door knocking is done over the dinner hour. If the homeowner seems disrupted, the worker says, "See, I'm sorry to interrupt you but"

With weekly door knocks of this type, the district could probably be covered in 12 weeks.

The person (s) hosting each door knock provide a simple supper . . . Chili / hot dogs / sloppy joes / beers.

Weekly door knocks generate activity on a regular basis. Also, provide an opportunity for workers to socialize, get to know each other, and make campaign cohesive.

Wednesday nights or middle of the week nights are probably best since the volunteer has no "weekend conflicts." Also, the voter is more likely to be home.

The weekly door knocks, in most cases, should concentrate on single dwellings.

continued

In door knocking one should always start with a precinct. One may prioritize precincts according to importance, but don't get carried away with this. Break each precinct down by DFL Index.

Since the door knockers may be arriving at various times just send each out with literature and a map at whatever time he/she arrives.

Feed the door knockers as they return from door knocking. The meal will be informal, so everyone doesn't have to eat at the same time. Some will probably just hang around to socialize after eating, so conversation etc. will be no problem, plus the "host" will always be around.

DFL Sample Ballot

The door knockers drop the DFL Sample ballot at every identified DFL residence the Saturday before the election. They give the DFL voter a special pitch such as "I'm Bob Doe, from the Robbinsdale DFL Club. I've got your sample ballot for Tuesday's election."

Also, the door knockers should find out if the voter is unregistered, and tell him/her about election day registration.

Door knockers might well be informed of the polling place if they are working in particular precincts.

The door knockers should not leave a sample ballot at a residence if the voter isn't at home. In this

7
situation, a sample ballot should be mailed to the resident by 3:00 pm on Saturday so he/she gets it in Monday's mail.

Take alot of volunteers, but only give them as many sample ballots as they can handle. Mail out the rest.

Design - Literature; Lawn Signs

Put someone or two in charge of design, not an entire committee. Then have a small group decide for approval.

Literature

"Personalizing", that is, having the candidate personally sign each piece of literature is a lot of baloney, and not worth the effort.

About \$125.00 → Buy a "master addresser" (there's a place in St. Louis Park that sells 'em). These use a stencil (each stencil costs about 2¢ a piece). One can address about 10,000 pieces of literature in about 2 hours. Also, one can borrow another "master addresser" from another candidate and really whip 'em out.

The stencils should:

1. Have the name, address, and some precinct code, for every DFL'er in the district. This is your master DFL list.
2. You may add names to your list of those who support your candidate, regardless of political affiliation.

Another list you should prepare is a card file on "lawn sign" locations -- names, and addresses, etc. of everyone who says they'd put up a lawn sign for your candidate on their property.

Many candidates prefer to use one-piece mailings.

A post card should be sent out the Saturday before the election so the voter will receive it on Monday -- just before Tuesday's election.

There should be one or two mailings specifically geared to Democrats.

If there's no primary, wait and mail closer to the General Election.

However, something should be sent out early.

Send something out each day during the last week of the campaign.

Get the unions to do their sample ballot and a mailing to you. They may not release their membership lists, but they probably will do a mailing to all of their members in your district for you.

A tabloid, with pictures, is something that's particularly good for your workers for the first time they door-knock.

Immediately the candidate needs something indicating

1. Biography
2. About 10 good reasons why someone should support the candidate.

Don't go heavy on newspaper advertising.

Weekly Newsletter

11

There should be a weekly publication to the volunteers.

The newsletter is mailed such that the volunteers get the publication on Monday. They are phoned on Tuesday, say to door-knock for Wednesday night.

Volunteers of the "core group" should be the precinct delegates and alternates. Therefore, these people should receive the newsletter, in addition to any other volunteers.

The newsletter should contain locations for the upcoming doorknocks. Also, praise for workers of the previous week, such as, "Bill Doe was super, he got 12 lawn sign locations last week." The newsletter can also highlight "special guests" who can be lined up to go door-knocking one week such as "Joan Braine, Minnesota's Secretary of state is going to knock with us on" The newsletter should contain information on upcoming fundraisers too.

Maps

Buy several maps -- the biggest ones of the district. Insist on having the biggest maps, although it may be hard for the city to reproduce them. These can be obtained from city hall and may cost up to \$32.00. Get "zoning maps" which show the actual lots. This way you can identify the number of pieces of literature you need.

Also, reproducing portions of these maps will be useful when candidate and volunteers go door-knocking.

One map may be "colored-in" to show how much of the district has been door-knocked by the candidate; ditto for volunteers. This may serve to "pace" both and provide incentive and a sense of achievement. May use large pieces of styrofoam to pin maps onto.

heavily
haunted
streets

Put up four 8' x 16' signs by July 4. Use great care in placing these "beggies." Must be in absolutely prime locations. Decide first where you want these "beggies", then get them there. Approach the property owner/renter and ask him/her to let you install the sign. You may even have to offer them money (\$25 to \$50) to place the sign where you want it & to keep it there.

Don't worry about sign ordinances. If the City or anyone else informs you that you're violating an ordinance, have your attorney write them a letter indicating the ordinance violates your rights under the first amendment, it's a temporary sign and it will be down after the elections.

Glue -- Use wall paper paste. Nagele may allow you to obtain a garbage can of their old paste at the end of the day when you need it. You provide the garbage can & the paste keeps for about 2-3 weeks.

Silk screen -- a good technique to use. If using 2 color signs, use day-glow for contrast. Don't get arty.

The "NAME" is the most important. May indicate "SENATOR" (the office candidate is running for). No more than 4 words ever. Don't use all capital letters.

Lawn Signs

Get all the lawn sign locations you can get, then select

Don't put up until 2-3 weeks before the election.

Have the names, addresses, and phone numbers in a separate file, of all who have indicated their willingness to have a lawn sign in their yard / on their property. Use this list to "pick and choose" from in determining where to put the signs. Not everyone who has said they'll put up a lawn sign will necessarily get one, if your card file is super extensive.

Lawn signs should have LOTS OF NAME IDENTIFICATION. Very little else, if anything.

Put up ^{2'x4'} lawn signs 2 weeks before the election (you may want to put 'em up before a primary, but then take 'em down again until 2 weeks before the general election).

Use about 1,000 2'x4' signs. Don't use cardboard -- damage too easily. Buy 4'x8' plywood and cut into quarters.

Always place perpendicular to the house.

Use 4' or 5' reinforcing metal ^{wire} rods -- buy scrap.

Should have some big signs. 15 to 20, 4'x8' signs. Put up 20, 4'x8' signs as soon as possible or about first 2 weeks into the campaign.

Persuading the Other Side

Recruit volunteers at coffee parties. But you don't persuade them to vote at the party. The idea of the coffee party is only to recruit.

Start out with community lists.

Pretend you need a whole new organization.

Always have a "ringer" at the onset of the party who pretends (or in fact may be) a member of the group and speaks for the group.

The "ringer" greets everyone at the door, shows them where to get their name tags, where there's a brochure/literature on the candidate. Has them sign up on a list indicating their name, address, phone numbers. Tells them that the candidate is out door knocking but will be arriving soon.

When the candidate arrives someone gives him/her a nice introduction. The group is told the candidate can only stay until "such and such a time." The candidate gives a 15 minute pep talk.

Another person (group member + supporter of candidate) inquires as to who would like to volunteer to work for the candidate or to make a contribution. The "ringer" is the first to volunteer.

The candidate must not stay very long... no more than 45 minutes. It is explained that the candidate is very busy, even if he/she is not.

XYZ Church
Civic Clubs

1,000 2' x 4' signs may cost about \$4.00 a piece for a total of \$4,000.

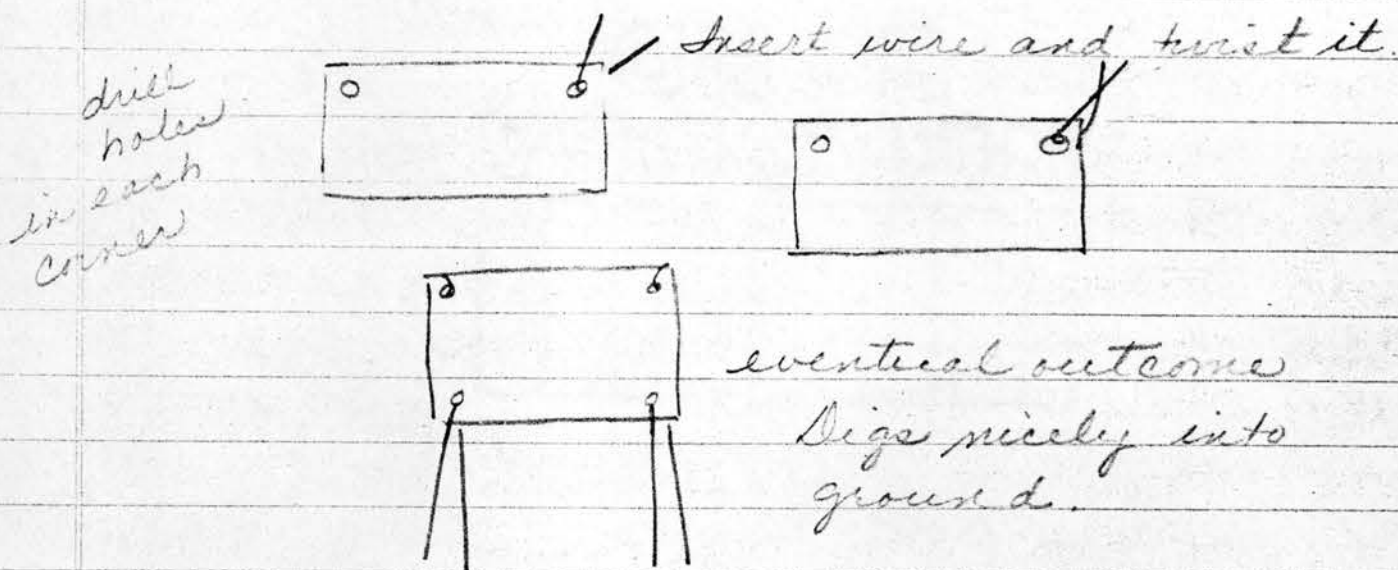

Learn sign locations obtained by:

1. Candidate asking people while he/she is out door knocking.
2. Volunteers asking people while door knocking--ask every house.
3. Voter identification workers asking if they get a friendly persons on the telephone
4. Perhaps having someone call all DFLers just for this purpose.

Dear ~~Hard Working~~ Educator:

This has been a long and difficult campaign but one that is approaching a successful conclusion, largely due to your good ~~I needed your~~ ^{hard work,} and wonderful support, and enthusiasm. ~~have made a difference~~

Occasionally I have felt

There have been brief moments of feeling overwhelmed by the constant distortions and deliberate misstatements made about my efforts on behalf of our children and the ^{yo} dedicated persons like yourself who hold the key to our future through your work with our children. But each of these moments were quickly erased by the thought of how much you individually and collectively have supported my efforts.

You sustained me during my four years of work in the Minnesota Senate, seeking greater help for our educational process and you have sustained me even more in this long fight to continue to represent your views in the legislature.

My ~~love~~ appreciation and gratitude goes deeper than mere words can express.

On November 4th, we will be voting on simple terms -- either we go forward, as we have together in the past -- or we allow the clock to be turned back to the days of the Guffey Reader. As I needed and received your support during the campaign, I ask for it in the final decision. I know you will be at the polling place.

I ask you to ^{encourage} ~~make certain that~~ ^{your friends & colleagues} ~~as many others~~ who feel as strongly as we about our children's future ^{to keep me working for education} ~~join you in keeping me as your~~ ^{vote for me on Nov. 4th} ~~concerned and working voice in the Minnesota Senate.~~ ^{our commitment}

In this election, the ballot you file may easily be the deciding vote.

Gratefully, and sincerely,

Dear Educator:

This has been a long and difficult campaign but one that is approaching a successful conclusion, thanks in part to your support and enthusiasm.

your contributions and your work.

Occasionally I have felt overwhelmed by the distortions (deliberate fabrications, deliberate misstatements) made about my efforts on behalf ~~(of our children)~~ of education, ~~(and on behalf of teachers)~~. Perhaps my opponent felt that he must distort my record in order to gain your support. Perhaps he felt guilty because he "forgot" *did not*

to vote for the Wayzata School Referendum. Perhaps I have worried too much. *you know that*

Some months ago *Not only my campaign promises, but also*
the MFT, the MEA, and the RFT examined my (voting) record on (education.)

(educational issues) and then endorsed me and contributed to me campaign fund. I thank you for both the vote of confidence and for the financial support.

More recently, many of you have personally worked with me on this campaign - walking, phoning, mailing literature. Never glamorous, this sometimes tedious work has been essential to my re-election campaign. You have helped sustain me in this long fight. I appreciate your personal commitment immensely.

On November 4th, we will be voting on simple terms -- either we go forward together, as we have in the past, or we allow the clock to be turned back to the days of the Mc Guffey ~~Reader~~. As I ~~needed~~ and received your support during the campaign, I ask for it, *again* in the final decision. (I know you will be at the polling place.) I ask you to encourage your friends and colleagues who feel as strongly as we about our children's future to vote for me then.

In this election, the ballot you file may easily be the deciding vote.

Sincerely,

my party and I are your allies at the State legislature. We care more about kids.

Michael Bucalo
Amber Woods H.O.A.
3510 Urbandale Lane
Plymouth, MN 55391

S. A. Knapp
Greentree West H.O.A.
2825 Alvarado Lane
Plymouth, MN 55391

John Hatlestad
Northeast Parker's Lake
14515 - 17th Avenue N.
Plymouth, MN 55441

Robert Scribner
AMLAC
2015 Medicine Lake Road
Plymouth, MN 55441

James M. Olson
Greentree West H.O.A.
2860 Alvarado Lane
Plymouth, MN 55391

Robert Johnson
Oakwood Hills Homeowners
1815 Merrimac Lane
Plymouth, MN 55391

Sylvia Schultz
Bass Lake Improvement Assoc.
5920 Kirkwood Lane
Plymouth, MN 55442

Joe Cosentino
Hadley Hills Homeowners
1200 Vagabond Lane
Plymouth, MN 55391

Ralph Goodwin
Pinetree Pond Homeowners
1430 Ranier Lane
Plymouth, MN 55391

C. K. Ornborg
Birchwood Estates Homeowners
16405 - 5th Avenue N.
Plymouth, MN 55391

Joel Fleming
Imperial Hills H.O.A.
18125 - 19th Avenue N.
Plymouth, MN 55391

Gerald Wilson
Pineview Homeowners
540 Pineview Lane N.
Plymouth, MN 55391

Larry Graham
Birch Valley H.O.A.
5315 Goldenrod Lane
Plymouth, MN 55441

Dan Speace
Imperial Hills H.O.A.
1815 Shadyview Circle
Plymouth, MN 55391

Robert E. Tetzloff
Schmidt Lake Woods H.O.A.
5160 Goldenrod Lane
Plymouth, MN 55442

Kathy Barnes
Chelsea Mews H.O.A.
1801 Yuma Lane
Plymouth, MN 55391

George Wray
Shenandoah H.O.A.
2733 Shenandoah Lane
Plymouth, MN 55391

Bonnie Hackner
Chelsea Woods Homeowners
1635 Black Oaks Place
Plymouth, MN 55391

James Hand
Lost Lake Homeowners
10515 - 40th Avenue N.
Plymouth, MN 55442

Fred Jahnke
Shorewood Hills H.O.A.
5940 Kirkwood Circle
Plymouth, MN 55442

Betty Haas
Cimarron Ponds H.O.A.
1024 Zanzibar Lane
Plymouth, MN 55391

John MacNeil, Pres.
Mapledell H.O.A.
2720 Comstock Lane
Plymouth, MN 55391

Harry R. Foster
Sun Valley Mobile Home Pa
10717 - 10th Avenue N.
Plymouth, MN 55441

Lee Lovisolo
Creekwood Heights Citizens
12710 - 26th Avenue N.
Plymouth, MN 55441

John DeSanto
Meadowood H.O.A.
2730 Queensland Lane
Plymouth, MN 55391

Tiburón H.O.A.
3399 Pilgrim Lane N.
Plymouth, MN 55441

Bill Dittmore
Ferndale North H.O.A.
425 Zircon Lane
Plymouth, MN 55391

James Olson
Mid-Plymouth Property Owners
3820 Fernbrook Lane
Plymouth, MN 55441

Rick Brandt
Tri-Comm H.O.A.
2620 Fountain Lane
Plymouth, MN 55391

Richard Hargarten
Greentree West H.O.A.
2935 Xanthus Lane
Plymouth, MN 55391

Lee Tomlinson
Middle East Homeowners
4020 Orleans Lane
Plymouth, MN 55441

Helen Kemmerling
Tri-Comm H.O.A.
16700 - 24th Avenue N.
Plymouth, MN 55391

Douglas Kesatie, Pres.
Tri-Comm H.O.A.
2830 Jewel Lane
Plymouth, MN 55447

Jim Guddal
Vicksburg Lane Homeowners
4465 Vicksburg Lane
Plymouth, MN 55446

Jeff Schachtman
Wood Creek H.O.A.
3205 N. Wellington Lane
Plymouth, MN 55441

Marv Glemmings
Zachary Lane Homeowners
4200 Yorktown Lane
Plymouth, MN 55442

Vale-Hoff Homeowners
5625 Evergreen Lane N.
Plymouth, MN 55442

Fred Sattler
Mapledell H.O.A.
16440 - 28th Avenue
Plymouth, MN 55447

Clarence Dietz
Westridge H.O.A.
P. O. Box 1385
Minneapolis, MN 55440

REF#	LASTNAME, FIRST	STREET	CITY, STATE	ZIP	PHONE
895	FOLLINGSTAD, MARLENE K	4095 LAKELAND AV N	ROBBINSDALE, MN	55422	612-533-5723
987	WOOLHOUSE, BETTE ANN	4017 QUAIL AVE N	ROBBINSDALE, MN	55422	612-535-0365
1088	HIGH, DARLENE	3506 31ST AVE NO	ROBBINSDALE, MN	55422	612-529-0434
1131	MOORE, ARDES	4367 COLORADA	CRYSTAL, MN	55422	612-537-7983
1277	HOLLOWAY, MARY	3307 LYLE AVE N	GOLDEN VALLEY, MN	55422	612-588-2086
1413	BARTON, COLLETTE V.	4206 BEARD N	ROBBINSDALE, MN	55422	612-536-9033
1414	ASLAKSON, JEAN	4106 VERA CRUZ AV N	ROBBINSDALE, MN	55422	612-537-9084
1456	REICHERT, MARY	4404 ABBOTT AV N	ROBBINSDALE, MN	55422	612-533-2904
1637	MLYNEK, ELLEN M.	4551 GRIMES AVE. N	ROBBINSDALE, MN	55422	612-535-5472
2041	BROUGHTON, WILLARD & NANCY	3940 REGENT AV N	ROBBINSDALE, MN	55422	612-533-5704
2076	BENTLEY, LINDA G	4047 VERA CRUZ AV N	ROBBINSDALE, MN	55422	612-535-7071
2368	LUBINSKI, KAREN	2913 ORCHARD AV N	GOLDEN VALLEY, MN	55422	612-588-5832
2590	EVANS, NANCY LEE	3929 SCOTT AV N	ROBBINSDALE, MN	55422	612-537-0048
2650	LARSEN, PRISCILLA	3537 LEE N	CRYSTAL, MN	55422	612-588-5477
2654	JORGENSEN, DONNA	3520 KYLE N	CRYSTAL, MN	55422	612-522-7696

TOTALS =

15 HITS
FUNCTION;

REF#	LASTNAME, FIRST	STREET	CITY, STATE	ZIP	PHONE
140	MANTEI, FAYE	5705 ELMHURST N	CRYSTAL, MN	55428	612-535-1235
141	MC CARTY, KATHY	8735 N BROOK CIRCLE	BROOKLYN PARK, MN	55428	612-535-6035
581	DOHERTY, EILEEN	5337 KENTUCKY AVE. N.	CRYSTAL MN	55428	612-533-4628
607	BLAEDE, SHARON	6417 46TH PL. N.	CRYSTAL, MN	55428	612-537
663	CHENVERT, MARGARET L.	4233 LOUISIANA N.	CRYSTAL, MN	55428	612-533-2384
668	KAISER, LAVERNA C.	5849 OREGON AVE. N.	CRYSTAL, MN	55428	612-535-2504
846	BECKER, BARBARA	1608 HILLSBORO AVE. N.	GOLDEN VALLEY, MN	55427	612-544-7644
887	ANDRESS, LEONA R.	1552 QUEBEC AVE N.	GOLDEN VALLEY, MN	55427	612-545-6087
960	WEIR, CAROL M	6918 46TH PLACE	CRYSTAL, MN	55428	612-533-1282
978	TAYLOR, JANELLE M	8540 MEDICINE LAKE RD	NEW HOPE, MN	55427	612-544-5608
1048	GOEBEL, AUDREY	7731 47 1/2 AVE N	NEW HOPE, MN	55428	612-533-5236
1132	BROSE, NAOMI	6632 FLAG AVE N	BROOKLYN PARK, MN	55428	612-535-7011
1190	GOETZ, PATRICIA A.	7012 MARKWOOD DR.	CRYSTAL, MN.	55427	612/535-2625
1227	ELLINGHUSEN, PAMELA	2120 WINETKA N	GOLDEN VALLEY, MN	55427	0
1228	LEI, CHERYL	6428 38TH AVE N	CRYSTAL, MN	55427	612-422-0534
1235	BRANDT, ARDIS	7825 NOID AVE N	BROOKLYN PARK, MN	55428	612-533-0979
1236	STREZEWSKI, LONA	6102 JERSEN AVE N	CRYSTAL, MN	55428	612-533-4118
1239	RYHTI, ELIZABETH	3019 YUKON N	CRYSTAL, MN	55427	612-544-1321
1262	HOFHENKE, JACQUELINE	6121 HAMPSHIRE AVE N	CRYSTAL, MN	55428	612-535-4727
1360	CORLISS, SHIRLEY	8718 NORTHBROOK AVE.	BROOKLYN PARK, MN.	55428	612/533-9364
1372	ANTILLA, DELORES M	6548 GEORGIA AVE N	BROOKLYN PARK, MN	55428	612-537-3524
1390	HAWES, NINA	5937 KENTUCKY N	CRYSTAL, MN	55428	612-537-0304
1548	ANDERSON, SHEILA M.	8001 IRIS DR.	BROOKLYN PARK, MN	55428	612-535-2498
1692	LEADENS, EVA	5704 WINNETKA AV	NEW HOPE, MN	55428	612-537-4442
1845	MC ELROY, MARY P	1320 EDGEWOOD AV N	GOLDEN VALLEY, MN	55427	612-545-3806
1917	ROSECRANS, SHARMAN S	7816 66TH AV N	BROOKLYN PARK, MN	55428	612-533-1307
2040	TURNQUIST, VALERA L	433 ENSIGN AV N	GOLDEN VALLEY, MN	55427	612-546-3916
2306	DRILL, SHERRY	4230 KENTUCKY AV N	CRYSTAL, MN	55428	612-535-0214
2369	QUAST, PHYLLIS	6722 FAIRVIEW	CRYSTAL, MN	55428	612-537-6269
2370	WALTER, CONSTANCE	5237 IDAHO N	CRYSTAL, MN	55428	612-533-2384
2378	KOKES, LINDA	6724 43RD AV N	CRYSTAL, MN	55428	612-535-6298
2382	MANGELDORF, JANET	4601 OREGON N	NEW HOPE, MN	55428	612-531-3582
2508	WALDRON, SHARON	4120 NEVADA AV N	NEW HOPE, MN	55428	612-535-4707
2514	SMITH, PEGGY	6800 34TH AV N	CRYSTAL, MN	55427	612-535-0154
2515	ALPERT, ROBYN	9224 40 1/2 AV N	NEW HOPE, MN	55427	612-544-6136
2516	TIBBETTS, MARGARET	7572 KENTUCKY N	BROOKLYN PARK, MN	55428	612-560-3318
2562	ZIGERLIG, SUSAN	5965 DECATER AV N	NEW HOPE, MN	55428	612-535-6379
2564	HAMMERSTAD, MARGARET	4825 KENTUCKY N	CRYSTAL, MN	55428	612-535-4549
2623	BETESH, DONNA	3325 LOUISIANA N	CRYSTAL, MN	55427	612-533-2595
2668	PEARSON, MARY JO	5009 WISCONSIN N	NEW HOPE, MN	55428	612-533-5030
2722	TABOR, SHARON	7216 GEORGIA AV N	BROOKLYN PARK, MN	55428	612-561-4524
2723	KEIFER, PHYLLIS	6601 44TH AV N	CRYSTAL, MN	55428	612-533-9522

TOTALS =

42 HITS
FUNCTION;

REF#	LASTNAME, FIRST	STREET	CITY, STATE	ZIP	PHONE
975	PAPERMASTER, BARBARA	2730 PINEVIEW LANE NW	PLYMOUTH, MN	55441	612-553-1862
976	WESTPHAL, DELORES	214 LANEWOOD LANE N.	PLYMOUTH, MN	55441	612-473-4495
977	STADSVOLD, RUTH	9610 27TH AVE N.	MPLS, MN	55441	612-544-2955
1275	DAHL, ROSE	3420 XENIUM AVE N	PLYMOUTH, MN	55441	612-559-4211
1544	DEMING, SHARON KAY	725 KINGSVIEW LN	PLYMOUTH, MN	55441	612-475-1480
2038	WILEY, MARGUERITE	730 KINGSVIEW LANE	PLYMOUTH, MN	55441	612-475-3496
2075	ANGULSKI, DONNA	4120 REVERE N	PLYMOUTH, MN	55441	612-559-9351
2304	FOSS, JOANN E	10120 28TH AV N	PLYMOUTH, MN	55441	612-545-1618
2305	GIANOTTI, JANET G	14224 CO RD 15	PLYMOUTH, MN	55441	612-475-0141
2510	KLEIN, MARY LOU	10119 37TH AV N	PLYMOUTH, MN	55441	612-544-7541
2621	BACKMAN, BARBARA	12035 26TH AV N	PLYMOUTH, MN	55441	612-559-2352
2653	REMSKI, GLORIA	940 WINDEMERE CURVE	PLYMOUTH, MN	55441	612-542-9985
2669	PAGE, GLORY	4050 NATHAN LANE	PLYMOUTH, MN	55441	612-559-3965

TOTALS =

13 HITS
FUNCTION;

7/28/80 1101 , PAGE 1

REF#	LASTNAME, FIRST	STREET	CITY, STATE	ZIP	PHONE
1247	MALMSTROM, ELIZABETH ANN	2940 URBANDALE LANE	PLYMOUTH, MN	55447	612-473-2375
2066	SIELOFF, KATHRYN	17225 12TH AV N	PLYMOUTH, MN	55447	612-473-3560

TOTALS =

2 HITS
FUNCTION;

SPRING HILL CENTER

WORKSHOP ON "CAMPAIGNING FOR PUBLIC OFFICE: 1978 AND AFTER"

February 11-12, 1977

PARTICIPANTS

Salisbury Adams	Geri Joseph
Charles Backstrom	John Keefe
Charles Bailey	Wayne Kepplinger
Joel Barker	Gerald Knickerbocker
Mrs. Joel Barker	David M. Lebedoff
Dan Biersdorf	James H. Miles
Nancy Brataas	Mrs. James H. Miles
Ronnie Brooks	G. Theodore Mitau
Ruth Cain	Mrs. G. Theodore Mitau
Representative for Nicholas Coleman	William D. Morris
Earl D. Craig, Jr.	Edith Mucke
John Davis, Jr.	Arthur Naftalin
Harry P. Day	Richard Nolan
Mrs. Harry Day	Todd Otis
Mark Dayton	David Roe
Jane Ferguson	James Rupp
Hank Fisher	Bernie Shellum
William Flanigan	Frank Sorauf
Douglas Franzen	Emily Ann Staples
Donald M. Fraser	George Thiss
William E. Frenzel	James H. Werntz, Jr.
David Graven	Thomas Wicker
Joyce Jackson	Carol Wold
Linda Jadwin	Barbara Young
	Ronald Youngren
	Edward Zabinsky

DJ and Harry Day

spring hill center

Sandhills Citizen
Hamlet, N.C.
NC, Virg. Tenn. N.Y.

Reprint of Bernie Shellen's
articles in Trib.

Frank Saurhoff

Changes taking place in the electorate -

- 1) Less alignment to parties - more to issues
- 2) Parties losing their vitality
- 3) New technology - TV + Computers
- 4) Legislative regulation of candidates

Tom Wicker

① Campaign financing

Subsidy law - limit of contributions
limited advantage of Republicans
and made both parties equal

House and Senate races

\$1,000 limit favors incumbents

* Possibility of raising this

Reduced citizen participation by
eliminating contributions by individuals
after the conventions -

Particularly limit of funding for
buttons, signs etc.

* Combine raising of private funds
(to a limit \$4000) with subsidy.

Equal time provision

spring hill center

- ② 1 two party system limits participation of minor parties - ^① bringing up issues -
② represent unrepresented constituencies

2 party system is basic instrument of the status quo - yet state laws make it very difficult to get on the ballot
Federal campaign financing shuts out minor party candidates.

- ③ Value of the debates -

Works strongly against bold & thoughtful statements

Should they be education? Do we really want debates?

3 reforms

1) Invite minor party candidates - at least serious ones

2) Reporters should be eliminated.
(on 1st Amendment grounds)
personal exchanges

3) Have round robin including the v.p. candidates.

Problem of incumbents.

30 pt. margin for Carter was unrealistic.

spring hill center

Incumbency is a valuable weapon.
Just 2 mos. of campaign he really
played at being President.
How can we minimize that advantage?

- 1) No pres. candidate allowed to
fly around in an Air Force plane.
- 2) No more pres. news conferences.
- 3) Elections Commission should be
empowered to make a report
during the campaign pointing
a finger at blatant misuse of
power of incumbency.

Low Voter Turnout -

55% of voters in 1972

Theories

Didn't matter (elitist)

American public alienated

Too difficult to vote

1932-68 - 58% of votes turned out

1932 - 52%

1948 - 51% (Truman - Dewey)

Pool of potential voters (with 18 yrs.
old enfranchisement) reduced
percentage

spring hill center

1960-63% (Kennedy-Nixon)
Televised debates?

low turnout in 1976 - because of
difficulty in voting.

U of Calif study: if registration until
1 wk before election day - 4.5 mil
more voters.

* 3 part program.

1) Easy registration

lists used only for voting

2) Abandon traditional Tues.

3 day election - 6 AM. Fri - 9 PM Sun

3) Massive advertising campaign
urging people to vote

* Electoral college reform to reflect
popular vote.

1) Electoral vote reflect pop. vote.

2) " " by Cong. dists.

3) Only system which precludes
the pitfalls is direct popular
election. (Baby proposal - at least
40% of vote necessary)

spring hill center

no return to a disciplined 2 party
system in this country.

David Ibadoff

No such thing as a national political
party right now.

Def? Mechanism for endorsement of
Candidates base on caucus systems
Caucus: delegation of function of getting
to know the candidates.

Who selects the name that bears the
party label?

Party Doorway - not barrier to effective
participation in politics.

The kind of party David is talking about
is growing - not declining in N.Y. (4% go
to precinct caucus)

In primary situation you need to have
either great personal wealth or
a previously famous name.

Can't talk about endorsing candidates
and discussing issues as separate.

Why pol. parties are in trouble

1) power of incumbency

(3 parties - Dem. GOP. incumbents)

Permanence of incumbents precludes
some participation.

spring hill center

- 2) Hard to develop a national party with a strong incumbent
- 3) Caucus system not designed to handle strong - one issue - protest.
- 4) Party structure ^{should} could be link to pres. for instance
- 5) In zeal for reform have passed procedures which are too cumbersome. - a poll tax by the educated on the less educated.

Minigraph Commission to look at National party participation in primaries. Fed elections commission - recommending that bumper stickers, buttons & signs be exempted from regulations.

George Shus

Micro Council elections - opportunity for unique kind of campaign
What will cable - 2 way communication
do? IBM to ATF

Wally Conheim
Lance Hethcote

James Rupp - Duane Wilson
Regents Office

spring hill center

Significant emerging forces to impact
on area in next 10 yrs.

would look at single issue and
geographic identity

impact of new technology on caucus
system

500,000 people elected in a 4 yr. cycle

Chuck - Seen Up

- 1) Reforms creating new problems
- 2) Continuing and improving access to process
- 3) Can national parties control primaries?
- 4) Incumbency problem

Credibility?

Exchange of ideas?

TO

Emily Ann

FROM

Wm Graham

Route #7

Brainerd, Minnesota 56401

SUBJECT

DATE 10/14/74

MESSAGE It was so nice seeing you in Mpls.

Mrs. Stephen (Grace) Nicholas

Room 25 - State Capitol

317 North 10th Street

Brainerd, Minnesota 56401

218-829-7384

Very best of luck with the campaign

SIGNED

*Bill***REPLY***Alcohol & drug program*Mr. James Hesketh - pub affairs
3532 Elmo Circle - Hopkins
938-1736

Pres: Mrs.

H.F.

Wm. (Lola) Umhoefer
401 - 20th St. S.W.

Austin 55912

507

433-2171

296-5090

SIGNED

DATE / /

Rediform® 4S 472

SEND PARTS 1 AND 3 WITH CARBON INTACT. - PART 3 WILL BE RETURNED WITH REPLY.

Poly Pak (50 sets) 4P472

Campaign Finance Bill

Ronnie Brooks 296-4866

Jois 296-4386

1) Relax 2) Read 3) Think 4) ask

File declaration of candidacy with IRS in order to be deductible
Forms to file by July 7

Registration form - Statement of organization
EC Form 1

Must file a copy w/ County auditor (Zerov) of
EC 1 + EC 2

Schedule A - over \$50 - alphabetical order!
(\$50 does not need to be disclosed)
anonymous contributions over \$20 not acceptable
Signator of the check in joint account

Schedule B - Coffee parties for example
Contribution under \$20 does not need to be
reported

Schedule D - itemize expenditures

Schedule I - May apply

Expenditures by district must be accounted
for if you benefit from proceeds.

\$750 is limit to be given by anyone individual
(1% of total)

Can accumulate petty cash funds during a
reporting period (\$20 per week?)

(Have to keep track of contributions over \$20)?
Have to report contributions over \$50

Dear DFL'er

We'd like to call your attention to one of the most promising new candidates we've had in years. Emily Anne Staples, one of our neighbors, is the D.F.L. endorsed candidate for the District 43A state legislative seat. We can't urge you strongly enough to give Emily Anne your whole-hearted support.

As you can see from the biographical sketch, (on the reverse side) Emily Anne is particularly well qualified. Her experience in public affairs, her knowledge of the issues and her ability to understand and evaluate them combine to give her insight into community problems that few others have. We've known Emily Anne for quite awhile now and can testify that her dedication to the community will insure enlightened representation for District 43A in the legislature.

A top-notch candidate isn't enough to win an election. It takes support and hard work from a lot of people. We need your help. Please take a few minutes to check the ways you would like to help in this important campaign. Just drop it in the mail and we'll get in touch with you.

Thanks for your attention. With your help, we think we've got a winner!

Sincerely yours,

Lillian + Bill

Lillian & Bill Leeper

Lorraine - Ollie

Lorraine & Ollie Clausen

Myrna & Larry

Myrna & Larry Marofsky

Polly & Gene

Polly & Gene Sander

Barb & Frank

Barbara & Frank Dvorak

Kaye & Dennis

Kaye & Dennis Erickson

Please detach and return in the enclosed envelope.

I would like to make a contribution to the campaign of \$50.00 _____
\$25.00 _____ \$10.00 _____ \$5.00 _____ Other \$ _____

I also would be willing to help in the following areas:

_____ You have my/our permission to use my/our names(s) in an endorsement.

Signature(s) _____

- _____ Willing to have a lawn sign in my yard.
_____ Willing to work on telephone committee.
_____ Willing to do clerical work (stuff envelopes, etc.)
_____ Willing to do block work with and/or for Emily.

Please make checks payable to Emily Anne Staples Volunteer Committee. All contributions are deductible up to specified amounts for Federal and State income tax.

Please print: NAME _____ PHONE # _____

ADDRESS _____ ZIP CODE _____

* EMPLOYER _____

* Present Minnesota campaign laws requires this information on contributions over \$50.00.

Some facts about

EMILY ANNE STAPLES - *Candidate for Legislature*

Married to Loring M. Staples, Jr., former Mayor of Plymouth and member of the Metropolitan Transit Commission

Four children - Mary 19, Tom 17, Greg 15 and Kathryn 10

17 - year resident of Plymouth

Life-long resident of the metropolitan area

Attended John Burroughs, Annunciation, Ramsey Junior High

Graduated from Washburn High School

B.A. in Liberal Arts from the University of Minnesota - 1950

Former research associate - Minnesota Womens' Center - University of Minnesota

Current volunteer involvement

United Way of the Minneapolis Area - Board of Directors and Executive Committee

Abbott-Northwestern Hospital - Board of Directors and Executive Committee

University of Minnesota - College of Liberal Arts Alumni Board

Breck School Board of Trustees

Hennepin County Bicentennial Planning Commission - vice chairman

National Trust for Historic Preservation - Membership and Public Relations Comm.

Past volunteer involvement

Minnesota Department of Human Rights - Women's Advisory Committee
Member 1968-1970 chairman 1970-1972

Interstate/Association of Commissions on the Status of Women - Board 1970-1972

Minneapolis Junior League - President 1967-1969

Co-founder - Minnesota Women's Political Caucus

Chaired Year-round School Committee - Wayzata School Board - 1969

St. Bartholomew School Board member - 1967-1968



MINNESOTA
DEMOCRATIC
FARMER LABOR
STATE CENTRAL
COMMITTEE

730 East 38th Street Minneapolis, Minnesota 55407 (612) 827-5421

HENRY E. FISCHER
CHAIRMAN

RUTH CAIN
ASSOCIATE CHAIRMAN

BOB MEER
SECRETARY

KINGSLEY HOLMAN
TREASURER

October 24, 1974

To: Metro Area Legislative Candidates and GOV Coordinators
From: Ruth Cain
Re: Phone Bank Volunteers

1. Please report names, addresses and phone numbers of volunteers recruited to date for the Minneapolis and St. Paul phone banks to Mary Jane O'Keefe at 914 Marquette in Minneapolis (339-1974) by Monday, October 28.
KEEP RIGHT ON RECRUITING!
2. Volunteers will receive a confirmation letter (copy enclosed) immediately and a thank-you after the election.
3. Please give us a telephone number for rides to the polls for your legislative district. As phone bank volunteers receive requests for rides, voters will be asked to call the appropriate legislative campaign at the number you supply.
4. Lists of polling places and accurate precinct finders for suburban areas will greatly improve the effectiveness of phone bank calling. Please give us this information if you possibly can.

RC/mm
enc
opeiu:12

MEMBERS

NATIONAL COMMITTEE

GOV. WENDELL ANDERSON
FARL D. CRAIG JR.
KORYNE HORBAL
ANN OBER
DAVID ROE

GERALDINE RICHARDSON
BARBARA AMRAM
DARLENE HERZOG
MARY MURPHY
RAY ANDERSON
ROBERT J. HARRIS

LARRY BYE
ARLO A. MOYSTAD
JOE GUINNESS
TOM KEIM
STEVE NICHOLS
CINDY WYANT

DISTRICT CHAIRMEN AND
ASSOCIATE CHAIRMEN

1 BARBARA CLARK
1 OPAL PETERSEN
2 ROBERT SCHMIDT
2 STELLA JENSEN

1 ROSEMARY DAVIS
1 TOM TINKHAM
4 ROGER CHRISTIANSON
1 JEAN MCGRILEY
5 JOAN CAMPBELL
5 TED PATRICK

6 TERRY MONTGOMERY
6 EVELYN LEITER
7 HENRY TWETEN
7 ANNE RICHTER
8 DON L. BYE
8 MARY KAY WHITEHEAD

{Sample}

Mr.
Mrs.
Ms.
{Address}

Dear _____

Your gracious support to my campaign has been recorded by our finance committee. These funds will be spent judiciously in the months ahead in my candidacy for the assembly.

I look forward to working with you personally and meeting your friends and neighbors in the weeks ahead to make this a winning campaign. I welcome any suggestions you may make to me or the committees staffing my campaign.

Again thank you for your generous contribution and let's win in '74.

Yours sincerely,

Emily Staples



Senate
District 4

Senator Jerry Willet



205 State Capitol, St. Paul, MN 55155
(612) 296-4147

207 Mill Road, Park Rapids, MN 56470
(218) 732-3520

September 12, 1980

To: All DFL Senators and Candidates

Fm: Jerry Willet

When I was campaigning the other day in a senior citizen housing project, I received a very positive reaction from the residents about a piece of literature I am using. I am enclosing a copy for you that you may be able to use or pick apart and use parts of. I've started carrying some in my coat on my other doorknocking rounds for when I bump into seniors.

The DFL has done a good job for our retired citizens. We have been responsive in several areas from property tax relief to free fishing licenses and free admissions to state parks for our seniors. I have been pointing that out to my senior constituents and am getting a good response. On the back panel, you will notice a listing of local services available to seniors. It is a handy listing for them, and they're keeping it near their phones. That means they're keeping my name in their homes!

This seems to be an effective piece for me. If you can use it or any part of it, please feel free to do so. You can get the listings for services available in your district from the pamphlet that the Minnesota Board on Aging puts out. They are located at 204 Metro Square Building, St. Paul, Mn. 55101.

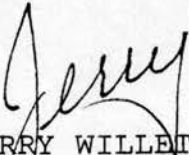
JERRY WILLET
State Senator

P.S. Keep knocking those doors!!

J O H N S O N



P R I N T I N G C O M P A N Y , I N C .

300 FIRST AVENUE NORTH / MINNEAPOLIS, MINNESOTA 55401 612/338-7531

ORIGINAL

INVOICE
6/22/79

NO: 3191

SHIPPED TO:

Senor Emily Staples Vol. Comm.
1640 Xanthus Lane
Plymouth, MN 55391

ATTN:

SENATOR EMILY STAPLES VOL COMM
1640 XANTHUS LANE
PLYMOUTH, MINNESOTA 55391
CUSTOMER P.O. #
SALESMAN: SHEAR, F
JOB NUMBER: 5513C

TITLE: INVITATIONS & ENVELOPES
DESCRIPTION:

PAID \$329.00 CK#854 ON 5/23/79, PAID
\$463.04 ON 5/25/79, PAID 24.44 CK#481 ON 5/31/79,
PAID IN FULL

INVOICE QUANTITY 2500.

INVITATIONS	446.00
ENVELOPES	317.00
A 2 ENVELOPES	23.50
STATE SALES TAX ON \$786.50	31.46
TOTAL DUE	\$ 817.96

TERMS: COD

Terms: Net Cash Thirty Days from date of shipment

unless otherwise specified above.

Subject to 1% per month interest charge thereafter.

(Annual percentage rate 12%)

No Statement of Account will be rendered

JOHNSON



PRINTING COMPANY, INC.

300 FIRST AVENUE NORTH / MINNEAPOLIS, MINNESOTA 55401 612/338-7531

DUPLICATE

INVOICE
6/29/79

NO: 6191.

SHIPPED TO:

Senor Emily Staples Vol. Comm.
1640 Xanthus Lane
Plymouth, MN 55391
ATTN:

SENATOR EMILY STAPLES VOL COMM
1640 XANTHUS LANE
PLYMOUTH, MINNESOTA 55391
CUSTOMER P.O.:
SALESMAN: SHEAR, F
JOB NUMBER: 55130

TITLE: INVITATIONS & ENVELOPES
DESCRIPTION:

PAID \$329.68 CK#854 ON 5/23/79. PAID
\$463.04 ON 5/25/79. PAID 24.44 CK#401 ON 5/31/79.
PAID IN FULL

INVOICE QUANTITY 2500.

INVITATIONS	446.00
ENVELOPES	317.00
A 2 ENVELOPES	23.50
STATE SALES TAX ON \$706.50	31.46
TOTAL DUE	\$ 817.96

TERMS: COD

Terms: Net Cash Thirty Days from date of shipment

unless otherwise specified above.

Subject to 1% per month interest charge thereafter.

(Annual percentage rate 12%)

No Statement of Account will be rendered

SPIRIT OF '76

Published by the DFL State Senate Campaign Committee, 1000 Northern Federal Building, St. Paul, 55102, Nick Coleman, Treasurer

Information Resources

The Secretary of the Senate's Office provides many services to the public and you may find some of them useful in your campaign.

The Senate Office (Room 231, State Capitol, 612-296-2343) will provide any member of the public copies of particular bills introduced, bills passed into law and daily journals of the Senate.

If you need such information as the file number of a bill, what bills were introduced on a particular subject or where a vote on a bill is listed in the Senate Journal, call Senate Index at 612-296-2887. They keep an extensive index of the Senate Journal which may be helpful when researching issues and/or the record of your opponent. If you are doing a great deal of research, you or a member of your campaign committee may want to come into the Senate Office, use the microfilm reader and confer with Senate Index personally.

If you are researching committee action on a bill or your opponent's voting record in committee, etc., you should contact the committee secretary or a committee administrative assistant.

If your opponent is an incumbent member of the House, the Chief Clerk's office (Room 214, State Capitol, 612-296-2314) and House Index (612-296-6646) provide services similar to their counterparts in the Senate.

HOTLINE - 612-296-4196

As part of our program to assist DFL Senate candidates, we have established a telephone hotline for candidates facing an immediate need for help. If you are in urgent need of information or advice, please contact John Kaul, at 612-296-4196.

NICHOLAS D. COLEMAN
SENATOR 65TH DISTRICT
MAJORITY LEADER



State of Minnesota
SENATE

Dear DFL'er:

This is the first issue of a new publication guaranteed to liven up your mail every two weeks -- the new DFL Senate newsletter "The Spirit of '76."

Designed to stimulate and enlighten DFL Senators and Future DFL Senators, the newsletter will:

--Keep you informed of the latest Senate campaign developments around the state,

--Provide a forum for exchanging effective campaign techniques and strategies,

--Give you up - to - date information on fundraising events, and

--Provide background information on major legislative issues to better enable you to respond to questions and formulate your positions.

The success of "The Spirit of '76" (and ultimately our campaigns) depends on our sharing of ideas on campaign strategies and issues. I am relying on your help in making the newsletter most useful to you. I need to know what the "hot" legislative issues are in your district. Please call or write soon with a list of those issues and your general suggestions for the format and contents of future newsletters. I am enclosing a postcard for your initial thoughts.

We must hang together or they're sure to hang us individually!

Sincerely,

Nicholas H. Coleman

KEY 1976 CAMPAIGN DATES

JULY 6---FILING FOR OFFICE OPENS

JULY 20---LAST DAY TO FILE FOR OFFICE

AUG. 24---ADVANCE VOTER REGISTRATION
CLOSES FOR THE PRIMARY

SEPT. 6---CAMPAIGN FINANCE REPORT DUE

SEPT. 14---PRIMARY ELECTION

OCT. 12---(APPROXIMATE) MONIES FROM
PARTY ACCOUNTS IN CHECKOFF
DISTRIBUTED

OCT. 12---ADVANCE VOTER REGISTRATION
CLOSES

OCT. 25---CAMPAIGN FINANCE REPORT DUE

NOV. 30---(APPROXIMATE) MONIES IN
GENERAL ACCOUNT IN CHECKOFF
DISTRIBUTED

JAN. 31---FINAL 1976 CAMPAIGN FINANCE
REPORT DUE

MAJOR DFL ACCOMPLISHMENTS --- 1973-76

AGRICULTURE & RURAL DEVELOPMENT

1. Corporate Farm Act
2. Collective Bargaining for Farmers
3. Family Farm Security Act

COMMERCE

4. Increase Usury Ceiling
5. Franchise Regulation
6. Utility Regulation
7. Small Business Set-Aside

CONSUMER

8. No Fault Auto Insurance
9. Drug Price Advertising
10. Funeral Cost Itemization
11. Mechanics Lien Law
12. Mobile Home Warrantees
13. Generic Drug Substitutions
14. Open Dating
15. Landlord Tenant Laws

CORRECTIONS & CRIMINAL JUSTICE

16. Prison Ombudsman
17. Handgun Control
18. Criminal Sexual Conduct
19. Community Corrections Subsidies
20. Aid to Victims of Sexual Assault
21. Minimum Sentences for Felonies with Dangerous Weapons
22. Crime Victims Reparations Board

EDUCATION

23. Increased Foundation Aids
24. Increased State Share of Educational Costs
25. Increased State Funding for Special Education
26. Expanded Student Loan Program
27. Medical Student Loan Program
28. Higher Education Reciprocity

ELECTIONS

29. Campaign Finance and Ethics Reform Bill
30. Party Designation
31. Post Card Voter Registration
32. Election Day Registration

ENERGY

33. Creation of Energy Agency
34. Energy Conservation Act
35. Lighting and Insulation Standards
36. Car Pooling State Employees

ENVIRONMENT & NATURAL RESOURCES

37. Critical Areas Act
38. Environmental Policy Act
39. Wild & Scenic Rivers Act
40. Solid Waste Recycling
41. Environmental Education Council
42. BWCA Protection Act
43. Environmental Permits Coordination
44. Hazardous Waste Control
45. Limiting Sale and Use of PCBs
46. Ban on Detachable Tabs on Cans
47. Drainage Act
48. Mineland Reclamation
49. Outdoor Recreation Act
50. Flood Plain Management
51. Shade Tree Disease Control

GOVERNMENT REFORM & REORGANIZATION

52. Open Meeting Law
53. Administrative Procedures Act
54. Finance, Personnel & Transp. Depts.
55. Standardization of Boards & Commissions
56. Reporters Shield Law

HANDICAPPED

57. Community Facilities for the Retarded
58. Commission on the Handicapped
59. Education for Handicapped Children
60. Mental Retardation Protection Act
61. Family Grants for Home Care

ACCOMPLISHMENTS -- CONTD.

HEALTH & WELFARE

62. Supplemental Security Income Act
63. Nutrition Program for the Elderly
64. Catastrophic Health Insurance
65. Child Abuse Reporting
66. Patients' Bill of Rights
67. Nut. for Exp. Mothers & Pre-Schoolers
68. HMO Establishment & Regulation
69. Medical Malpractice Insurance
70. Foster Grandparents Program
71. State Takeover of Additional Medical Assistance & Indigent Care Costs

HOUSING

72. Redlining Bill
73. Urban Homesteading
74. Housing Finance Agency

CIVIL RIGHTS & LIBERTIES

75. Equal Rights Amendments
76. Age of Majority
77. Privacy Laws

LABOR

78. Minimum Wage
79. Unemployment Compensation Improvements
80. Workers Compensation Improvements
81. Occupational Health & Safety Act
82. Little Davis Bacon Act
83. Private Pension Guarantee
84. Public Employee Pension Reform
85. Summer Youth Employment
86. Child Labor Standards Act

METROPOLITAN GOVERNMENT

87. Metropolitan Reorganization Act
88. Metropolitan Parks & Open Space Comm.
89. Metropolitan Land Use Planning
90. Metropolitan Solid Waste

TRANSPORTATION

91. Department of Transportation
92. Bridge Bonding Bill
93. Expansion of Public Transit
94. Bus Improvement Program
95. Moratorium on Freeway Construction in Metro Area
96. Minnesota Rail Service Improvement Act

SENIOR CITIZENS

97. Pilot Dental Care Program
98. Council on Aging
99. Old Age Lien Law Repealed
100. Free College Tuition
101. Free Entry into State Parks
102. Nursing Home Reform Bills
103. Long Term Care Policy

TAXES

104. Renters Credit
105. Working Poor
106. Circuit Breaker Tax Relief
107. Increase in Inheritance Tax Exemptions

MISCELLANEOUS

108. Veterans Bonus
109. State Arts Council
110. Commission on the Future
118. State Zoo

Bright Ideas Department



Fishermen:
*Don't let this
 one get away!*
 — VOTE —
SIKORSKI
 State Senate
 DFL/51

front

FISH	WORLD RECORD	MINNESOTA RECORD
Bass, Largemouth	22 lbs., 4 oz.	10 lbs., 2 oz.
Bass, Smallmouth	11 lbs., 15 oz.	8 lbs.
Catfish, Channel	58 lbs.	37 lbs.
Crapple	5 lbs., 3 oz.	5 lbs.
Muskellunge	69 lbs., 15 oz.	56 lbs., 8 oz.
Perch	4 lbs., 12 oz.	3 lbs., 4 oz.
Pike, Northern	46 lbs., 2 oz.	45 lbs., 12 oz.
Salmon, Chinook	92 lbs.	18 lbs., 8 oz.
Sauger	8 lbs., 12 oz.	6 lbs., 2 1/2 oz.
Sunfish	4 lbs., 8 oz.	2 lbs., 13 oz.
Trout, Brook	14 lbs., 8 oz.	9 lbs.
Trout, Brown	39 lbs., 8 oz.	16 lbs., 8 oz.
Trout, Lake	65 lbs.	43 lbs., 8 oz.
Trout, Rainbow	42 lbs., 2 oz.	17 lbs., 6 oz.
Walleye	25 lbs.	16 lbs., 11 oz.

Paid for by Sikorski for Senate Vol. Comm., Ed Cass, Stillwater, Treasurer

back

INCUMBENT AND DFL ENDORSED CANDIDATES

DIST.

- | | |
|---|--|
| <p>1 MARV HANSON
HALLOCK, MINNESOTA 56728
(INCUMBENT - R. FITZSIMONS)</p> | <p>11 * WAYNE OLHOFT
HERMAN, MINNESOTA 56248</p> |
| <p>2 * ROGER MOE
706 EAST 3RD AVENUE
ADA, MINNESOTA 56510</p> | <p>12 * MYRT WEGENER
BERTHA, MINNESOTA 56437</p> |
| <p>3 * NORBERT ARNOLD
ROUTE 1, BOX 93
PENGILLY, MINNESOTA 55775</p> | <p>13 * WIN BORDEN
BOX 411
BRainerd, MINNESOTA 56401</p> |
| <p>4 * JERRY WILLET
207 MILL ROAD
PARK RAPIDS, MINNESOTA 56470</p> | <p>14 * FLORIAN CHMIELEWSKI
STURGEON LAKE, MINNESOTA 55783</p> |
| <p>5 * GEORGE PERPICH
104 1/2 WEST LAKE
CHISHOLM, MINNESOTA 55719</p> | <p>15 ROGER STRAND
CYRUS, MINNESOTA 56323
(INCUMBENT - CHARLES BERG)</p> |
| <p>6 * TONY PERPICH
4 LAKESIDE DRIVE SOUTH
EVELETH, MINNESOTA 55734</p> | <p>16 * ED SCHROM
ALBANY, MINNESOTA 56307</p> |
| <p>7 * SAM SOLON
1005 GLEN PLACE
APT. 24
DULUTH, MINNESOTA 55807</p> | <p>17 * JACK KLEINBAUM
1100 - 23RD AVENUE NORTH
ST. CLOUD, MINNESOTA 56301</p> |
| <p>10 COLIN PETERSON
BOX 63
DETROIT LAKES, MINNESOTA 56501
(INCUMBENT - ROGER HANSEN)</p> | <p>19 * J. C. ANDERSON
BOX 503
NORTH BRANCH, MINNESOTA 55056</p> |

DIST.

- | | | | |
|----|--|----|---|
| 20 | JIM NICHOLS
LAKE BENTON, MINNESOTA 56149
(INCUMBENT - J. A. JOSEFSON) | 36 | * BOB SCHMITZ
ROUTE 1
JORDAN, MINNESOTA 55352 |
| 21 | * ALEC OLSON
ROUTE 1
SPICER, MINNESOTA 56388 | 38 | BOB BENEDICT
2021 WEST OLD SHAKOPEE ROAD
BLOOMINGTON, MINNESOTA 55431
(INCUMBENT - JEROME BLATZ) |
| 24 | * CLARENCE PURFEERST
BOX 419A, ROUTE 1
FARIBAULT, MINNESOTA 55021 | 41 | * BOB LEWIS
7010 HIGHWAY #7
ST. LOUIS PARK, MINNESOTA 55426 |
| 26 | MIKE MENNING
100 EAST CENTRAL
EDGERTON, MINNESOTA 56128
(INCUMBENT - JOHN OLSON) | 42 | MARY WILLIS
200 MILL STREET
EXCELSIOR, MINNESOTA 55331
(INCUMBENT - GEORGE PILLSBURY) |
| 27 | * HOWARD OLSON
ROUTE 3
ST. JAMES, MINNESOTA 56081 | 43 | EMILY ANNE STAPLES
1640 XANTHUS LANE
WAYZATA, MINNESOTA 55391
(INCUMBENT - ROLF NELSON) |
| 29 | MONTY PURRIER
419 MOUND AVENUE
MANKATO, MINNESOTA 56001
(INCUMBENT - ARNULF UELAND) | 44 | * SKIP HUMPHREY
8116 - 40TH AVENUE NORTH
NEW HOPE, MINNESOTA 55427 |
| 31 | * BALDY HANSEN
STATE BANK OF ROSE CREEK
ROSE CREEK, MINNESOTA 55970 | 45 | BILL LUTHER
6925 DALLAS ROAD
BROOKLYN CENTER, MINNESOTA 55430
(INCUMBENT - AL KOWALCZYK) |
| 34 | * ROGER LAUFENBURGER
BOX 6
LEWISTON, MINNESOTA 55952 | 46 | * DAVID SCHAAF
6550 EAST RIVER ROAD, #215
FRIDLEY, MINNESOTA 55432 |
| 35 | JEROME GUNDERSON
BOX 308
MABEL, MINNESOTA 55954
(INCUMBENT - LEW LARSON) | 47 | * GENE MERRIAM
2924 - 116TH AVENUE N.W.
COON RAPIDS, MINNESOTA 55433 |

DIST.

48 BOB LASHOMB
2587 RICE
ST. PAUL, MINNESOTA 55113
(INCUMBENT - ROBERT ASHBACH)

* JOHN MILTON
4101 EAST COUNTY LINE
WHITE BEAR LAKE, MINNESOTA 55110

50 * JERRY HUGHES
1978 PAYNE AVENUE
ST. PAUL, MINNESOTA 55117

51 JERRY SIKORSKI
102 OAK PARK HEIGHTS BANK BLDG.
STILLWATER, MINNESOTA 55082
(INCUMBENT - ROBERT BROWN)

52 CONRAD VEGA
407 - 11TH AVENUE SOUTH
SOUTH ST. PAUL, MINNESOTA 55015
(INCUMBENT - ROBERT STASSEN)

54 * ED GEARTY
1102 WEST BROADWAY
MINNEAPOLIS, MINNESOTA 55411

55 * GENE STOKOWSKI
2231 STINSON BLVD.
MINNEAPOLIS, MINNESOTA 55418

56 * BOB TENNESSEN
4940 VIKING DRIVE
MINNEAPOLIS, MINNESOTA 55435

57 * ALLAN SPEAR
2204 SEABURY AVENUE
MINNEAPOLIS, MINNESOTA 55406

58 BETTE BEDOR
3701 COLFAX AVENUE SOUTH
MINNEAPOLIS, MINNESOTA 55409
(INCUMBENT - HARMON OGDahl)

59 * STEVE KEEFE
4217 GARFIELD AVENUE SOUTH
MINNEAPOLIS, MINNESOTA 55409

60 * JACK DAVIES
2100 SUMMIT AVENUE
ST. PAUL, MINNESOTA 55105

61 FRANK KNOLL
5316 - 1ST AVENUE SOUTH
MINNEAPOLIS, MINNESOTA 55419
(INCUMBENT - MEL HANSEN)

63 RONNIE BROOKS
1671 PINEHURST
ST. PAUL, MINNESOTA 55116
(INCUMBENT - JOSEPH O'NEILL)

64 * PETER STUMPF
1283 DANFORTH
ST. PAUL, MINNESOTA 55117

65 * NICHOLAS D. COLEMAN
835 OSCEOLA
ST. PAUL, MINNESOTA 55105

66 * JOHN CHENOWETH
1126 IVY AVENUE EAST
ST. PAUL, MINNESOTA 55106

67 * BILL McCUTCHEON
2238 EDGEBROOK
ST. PAUL, MINNESOTA 55119

* INCUMBENT DFL SENATORS

SENIOR CITIZENS CONCERN ALL OF US

Why Willet is Concerned . . .

- Seniors make-up an ever growing segment of our population — rising from 4 percent of the population in 1900 to 11 percent today. Minnesota's 450,000 seniors make-up not only 11 percent of our total population, but head 21 percent (300,000) of our state's 1.4 million households.
- Many seniors are forced to live on meager fixed incomes. In fact, the median income of Minnesota seniors is less than half that of Minnesotans as a whole. Twenty-five percent of our seniors live on incomes below the poverty level.
- Seniors have special needs in such areas as housing, transportation and health care. Senator Jerry Willet, for example, has frequently pointed out that annual medical expense for seniors runs 3 times as high as those of the population as a whole.
- In short, Jerry Willet knows and understands the special problems and needs of Minnesota's senior population. Senator Willet also understands that government has a very real responsibility to help our most senior residents meet those needs. As Jerry puts it, "We must ensure that living longer means living better. Our senior population, throughout their adult life, has worked and paid taxes to help finance our schools, highways and human service programs. We cannot forget that contribution when we deal with today's senior issues. We must ensure Minnesota's most senior residents can live an independent life, marked by respect and dignity."

What Willet Has Done . . .

In recent legislative sessions Jerry Willet has authored or supported legislation:

- that provides additional income tax relief for seniors through such measures as increases in the dependent credit available to seniors (from \$42 to \$120); the establishment and expansion of the low income tax credit program; and increases in the pension income exemption for public and private pensioners.
- that provides increased property tax relief and renters credits for seniors.
- allowing the deferment of special assessments on senior citizens homes.
- repealing the old age lien law.
- expanding Medical Assistance eligibility and benefits.
- that provides free fishing licenses and admission to state parks for seniors.
- providing significant nursing home reform.
- that funds the Foster Grandparents, Retired Senior Volunteer and Senior Companion Programs.
- establishing a senior nutritional program.
- that established a pilot senior citizen dental care delivery program.
- providing home improvement grants for seniors.
- raising the mandatory retirement age from 65 to 70.
- prohibiting discrimination in employment and education on the basis of age.
- establishing a program of home-based services for the elderly and disabled.
- increasing the nursing home personal needs allowance and preventing its misuse by nursing homes and third parties.
- providing sales tax exemption for senior citizen organizations.
- establishing a nursing home pre-admission screening pilot program, to prevent inappropriate nursing home placements and to study containment of health care costs associated with inappropriate placements.
- calling for medical assistance income eligibility cost-of-living increases (7% each year).

Willet's Continued Commitment . . .

If Jerry Willet is re-elected he will support legislation:

- designed to reduce the income and property tax burden for seniors.
- designed to provide medical assistance benefits which keep pace with the rising cost of health care.
- designed to provide meaningful energy purchase aid.
- designed to enable seniors to take advantage of alternatives to nursing home care, such as the use of in-home service and home-based health care.
- designed to ensure that those Minnesotans who need the care and services of a nursing home will receive high quality care at a fair and reasonable cost.
- designed to provide expanded employment and volunteer opportunities for seniors, so that they may remain active and independent — and so the community can benefit from their experience and expertise.

Places to Seek Assistance . . .

There are several services available to Senior Citizens that Jerry Willet thinks are excellent, and he wants you to know where they are located nearest your home. The following is a listing you should keep in a handy place for easy referral.

Local Senior Citizen Centers

Nevis652-2022
Bena665-2260
Hackensack675-6474
Menahga564-4858
Backus947-3844
Sebeka837-6058

Health Assistance

Hubbard County Clinic732-9749
Beltrami County Health Service751-7300
Ext. 131
Wadena County Health Services631-1344
Itasca County Nursing Service326-9491

Nutrition Assistance

Headwaters Nutrition Program732-3967
(serving Park Rapids, Nevis, Bemidji)
Tri-County CAP - Little Falls632-3691
(serving Menahga, Pine River, Remer,
Swanville, Verndale, Boy River)
Grand Rapids Home Delivered Meals .326-9491
(serving Deer River)
Leech Lake Nutrition Program335-2286
(serving Ball Club, Bena, Cass Lake,
Walker, Squaw Lake, Onigum)

Transportation Assistance

Beltrami Senior Transportation
Project — Bemidji751-4631
Mahnomen/Hubbard
Senior Transportation
Project — Detroit Lakes847-9252
Cass County Transportation
Coordinator — Walker547-1340

Other Assistance Centers

Region II Area Agency on Aging, Bemidji751-3108
Hubbard County Chore Service, Park Rapids732-3339
Beltrami Housing & Energy Project, Bemidji751-4631
Region V Area Agency on Aging, Staples894-3233
Wadena County Chore Services, Wadena631-2832
Leech Lake Legal Services, Leech Lake335-2223
Information Phone for Seniors, Little Falls892-8574
(serves Cass & Wadena Counties)

In addition to the above local offices, Jerry Willet indicates information and assistance is also available from the Minnesota Board on Aging, 204 Metro Square Building, St. Paul, MN 55101. Their toll-free number is 1-800-652-9747.

Prepared and paid for by the Committee to Re-elect Senator Willet: Dick Ness, Chairman, Park Rapids, Minnesota

special report on senior citizens

From the office of State Senator

Jerry Willet



PAID
U.S. POSTAGE
BULK RATE
PERMIT NO. 25
PARK RAPIDS, MN

Committee to Re-elect Senator Willet
P.O. Box 32
Park Rapids, MN 56470

The DFL Is Born



IN 1944, RESPONSIBLE, younger liberals who were appearing on the Minnesota political scene realized that the time to re-examine their differences was long overdue. Moreover, they were eager to close their ranks and join together to build one statewide political organization. How else could they ever hope to challenge Republican supremacy within the state?

In Washington, national Democratic leaders, anxious to elect President Roosevelt to an unprecedented fourth term, vigorously pressed for a merger of Minnesota's liberal forces to guarantee FDR strong state support.

MONTHS OF NEGOTIATION

'Fusion' became the coveted goal for liberals throughout the state. Nonetheless, long months of patient negotiation and compromise were required before the necessary procedures could be evolved.

Then, the long-sought moment was at hand. By pre-arrangement, on Friday, April 14, 1944, after the date had nervously been changed three times, both the Minnesota Farmer-Labor Party and the state Democratic Party met at separate conventions in adjacent Minneapolis hotels. On the opening day of their meetings, a delegation from the Democratic Party convention attended the Farmer-Labor convention and formally issued an invitation to the Farmer-Labor Party to join Democratic ranks. Farmer-Laborites then nominated a nine-man committee to discuss the details of this invitation with a similar size Democratic Party committee.

The top leadership in both parties, however, was literally holding its breath. Until the very end, a group within the Farmer-



Clustered about the speakers' table in the late 1940's: John Blatnik, far left, Hubert Humphrey; John Simmons, talking to Humphrey; Eugene McCarthy; Don Fraser, far right; Barney Allen, hand on head.

GENUINE "TWO-PARTYISM" FOR MINNESOTA

So began the start of genuine two-partyism in Minnesota. Instead of ineffective and fragmented dissent, now there were to be two significant parties and the long march of world history suggests that the two-party system with its majorities and responsible opposition "serves the vitality of democracy best."

An interesting observation has been made that two-partyism has characterized two of the world's most enduring democracies, the United States and Great Britain, while multi-partyism has generally prevailed in some of democracy's more tragic failures, such as Weimar Germany and inter-war France. Certainly in Minnesota, multi-partyism, by diffusing its strength, all too often tended to perpetuate the very conditions it set out to correct.

HUMPHREY'S FORCEFUL LEADERSHIP

In Minnesota, one of the young men who played a leading role in bringing the new DFL Party into existence was an emerging political dynamo with the improbable name of Hubert Horatio Humphrey.

Then a young political science instructor at Macalester College,

John Blatnik, in 1966, Dean of Minnesota's DFL congressional delegation. Only three new Democratic Congressmen were elected nationally in 1946 when Blatnik won his seat in Congress. Said Blatnik, "If you called a meeting of all the liberal Congressmen from the midwest then in Washington, you could hold it in a telephone booth."



defeat domestic Communism, just as affirmative policies are needed to make the United States the effective leader of the free world in its struggle against world Communism.

WALLACEITES TRY DFL TAKE-OVER

The Communist leadership within the DFL Party stiffened its opposition. They were determined to beat the Humphrey group and bring the DFL Party intact into the new Wallace third party camp. In 1948, Henry Wallace had become the Presidential candidate of the recently formed Independent-Progressive Party, which had come upon the national scene to oppose both Truman and Dewey. Despite its name, its platform and program were neither independent nor progressive; instead they were frankly and avidly pro-Communist.

What particularly drew the fire of the Humphrey wing and revealed the nature of the basic split within the Minnesota DFL Party was the new Party's foreign policy.

The Humphrey forces were then vigorously supporting the Truman doctrine with its program for economic and military aid to Greece and Turkey; the DFL left wing was not.

The Humphrey wing championed the Marshall Plan which would dramatically aid European recovery; its opponents in the DFL branded it a Wall Street plot.

Humphrey denounced the recent Communist seizure of power in Czechoslovakia, but Wallace, his Progressive Party, the Communists and the left wing of the DFL justified it.

Humphrey's final trump card was to expose the "take-over" strategy by which the DFL Party leadership was planning to align the DFL Party on Wallace's side. Once the Wallace group had control of the state party machinery, they planned to put Wallace's name on the ballot not as a third party candidate, but as the official Democratic Party nominee.

If Harry Truman received endorsement for President later at

Labor Party strongly rejected all fusion overtures, and, understandably, both sides approached the merger cautiously, insisting that the new party be a true partnership dominated by no side or faction. After a determined, all-night session of the 18-man fusion committee, the last objections faded away. Acceptance of the merger by both party conventions was at long last assured.

THE DFL IS BORN

At 11:45 a.m., Saturday, April 15, 1944, the merger was officially accomplished. A series of legal documents was filed with the Secretary of State. The first of these changed the name of the Farmer-Labor Party to the Fellowship Party, a technicality which freed the name "Farmer-Labor" so that it could become part of the new name of the Democratic Party. The Fellowship Party was born solely so that it could expire later that year. One candidate did seek office using its name, but he received so few votes that the Fellowship Party was declared officially dead on November 21, 1944, by the state canvassing board.

The new Democratic-Farmer-Labor Party had been more than one hundred and sixty years in the making. Henceforth, it would function as the state arm of the national Democratic Party, but "Farmer-Labor" was deliberately added to the Democratic Party's name to continue the great tradition by which liberalism had been kept alive in the state, public indignation mobilized and injustice corrected.

Four early DFL party builders: left to right: Prof. E. M. Kirkpatrick, Barney Allen, Hubert Humphrey and Arthur Naftalin. The latter three were then frequently referred to as "Faith, Hope and Charity."

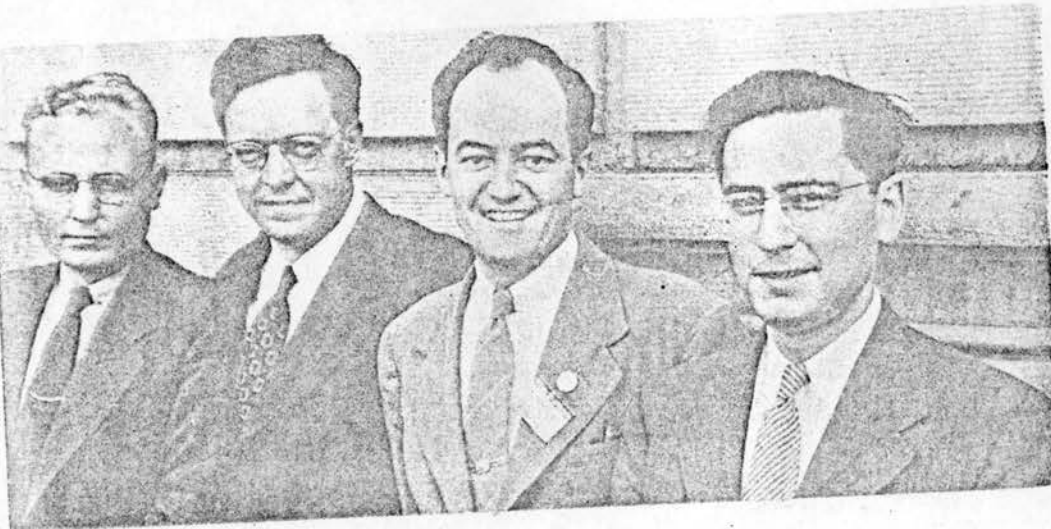

Clustered about the speakers' table in far left, Hubert Humphrey; John Simon, Eugene McCarthy; Don Fraser, far right.

GENUINE "TWO-PARTYISM"

So began the start of genuine two-partyism. Instead of ineffective and fragmented two significant parties and the long march that the two-party system with its opposition "serves the vitality of democracy."

An interesting observation has been characterized two of the world's modern democracies, the United States and Great Britain, while prevailed in some of democracy's history. Weimar Germany and inter-war France, by multi-partyism, by diffusing its strength, perpetuate the very conditions it set

HUMPHREY'S FORCE

In Minnesota, one of the young men in bringing the new DFL Party into a political dynamo with the improbable force of Hubert Humphrey.

Then a young political science in

Humphrey was generally accepted as the leader and spokesman of the state's liberal forces. As Chairman of the 1944 Minnesota Democratic Party convention, Humphrey reminded the delegates assembled together during the momentous weekend of fusion that the history of the Democratic Party was the history of a free America. The Democratic Party, he declared, had given plain people the chance to become great people. He readily disposed of the entire Republican program as offering "protection for the greedy, depression for the needy, chaos for our world and despair for our youth."

The brand-new DFL adjourned in high spirits, but not before it had affirmatively supported a "Win the War" program and endorsed FDR for a fourth term. Nationally, the new party was hailed as representing "common sense for common ends."

Humphrey, who had been defeated for Mayor the previous year, then launched his own meteoric political career by winning election as Mayor of Minneapolis with the largest plurality in the history of the city. In 1947, he was re-elected by an even greater plurality. A vigorous, ebullient Mayor, Humphrey declared war on vice and gambling rampant in the city and tackled scores of pressing civic problems.

But his new DFL Party was not destined to "live happily ever after."

AN OLD FOE REAPPEARS

In 1944, the DFL achieved a swift measure of initial success by electing two Congressmen, William Gallagher (3rd District) and labor leader Frank Starkey (4th District). Shortly thereafter, however, there were visible signs of strain within the young party as Communist infiltration again began to produce sharp friction. In dismay, Mayor Humphrey and a group of his loyal supporters watched the dismal DFL returns in the 1946 elections. The only bright note was the election of John Blatnik of Chisholm as 8th District Congressman. Blatnik, a recently returned World War II hero, had previously served two terms in the state Senate. It was again apparent that overthrow of the party's left wing leadership was essential if the DFL were to gain broad state public support.

The Humphrey forces began a two-year drive to out-organize, out-argue, and out-vote the Communists within the DFL. They fought them democratically and squarely on the issues. Humphrey never lost sight of the fact that positive ideas are required to

John Blatnik, in 1966, Dean of Minnesota's DFL congressional delegation. Only three new Democratic Congressmen were elected nationally in 1946 when Blatnik won his seat in Congress. Said Blatnik, "If you called a meeting of all the liberal Congressmen from the midwest then in Washington, you could hold it in a telephone booth."

defeat domestic Communism, just as affirm to make the United States the effective in its struggle against world Communism

WALLACEITES TRY DFL

The Communist leadership within the opposition. They were determined to bring the DFL Party intact into the camp. In 1948, Henry Wallace had become date of the recently formed Independent had come upon the national scene to Dewey. Despite its name, its platform a independent nor progressive; instead they pro-Communist.

What particularly drew the fire of revealed the nature of the basic split within the Party was the new Party's foreign policy.

The Humphrey forces were then v Truman doctrine with its program for Greece and Turkey; the DFL left wing

The Humphrey wing championed the would dramatically aid European recovery. The DFL branded it a Wall Street plot.

Humphrey denounced the recent Communist in Czechoslovakia, but Wallace, his Pro communists and the left wing of the DFL joined

Humphrey's final trump card was the strategy by which the DFL Party leaders the DFL Party on Wallace's side. Once control of the state party machinery, they name on the ballot not as a third party candidate Democratic Party nominee.

If Harry Truman received endorsement

the Democratic National Convention, the only way in which he could get on the presidential ballot in Minnesota would be by running not as a Democrat but as an "Independent." Wallace, the announced Progressive, would be Minnesota's "Democrat!"

Outraged DFL supporters turned out en masse to save their party.

Precinct caucus night, April 30, 1948, as well as the May county conventions that year represented tremendous triumphs for the Humphrey troops.

The left-wingers, defeated and infuriated, held their own rump meeting, and decided to bolt the state DFL convention held in June, 1948, at Brainerd. They had won so few delegates to this convention that their presence would have been completely ineffective. They withdrew from the DFL, formed a separate Progressive Party in Minneapolis, and elected their own slate of delegates to attend the national convention of Wallace's Progressive Party.

Thus, ignominiously, ended one of the most determined attempts ever waged by the Communist Party to take over a legal state party in America. Later that year, their candidate, Henry Wallace, fared equally ignominiously in the November, 1948 elections.

Whistle-stopping through Minnesota in 1948, Harry Truman welcomes Mayor Humphrey and Eugene McCarthy. Long after Truman succeeded FDR, Mrs. Roosevelt recalled, "I knew then he was a good man. Later I thrilled to watch him grow into greatness. With every decision, he grew, until to the entire world, he was a towering figure."



★ ★ ★

The Rise of the

★ ★ ★ ★ ★

THE ELATED BAND OF Humphrey supporters to build the DFL without the element nearly wrecked it. Many of Humphrey worked hard to help shatter the left-wing DFL leaders—Orville Freeman and came Governors of Minnesota; Arthur three terms as Mayor of Minneapolis, Eugenie Anderson of Red Wing was ambassador to Denmark, Minister to Bulgaria to the United Nations.

Many other young men and women are in those early party struggles including Heaney, Ray Hemenway, William Kub Nehotte and others far too numerous justifiably claim that their names should

PARTY GOALS OUT

At the 1948 Hennepin County DFL called upon the United States to become oppressed, the hungry, the war weary and He asked the United States to take "the and freedom;" he emphasized the importance rights at home to the success of America

Now later that year there was still and would do battle for these objectives. The cratic National Convention which assembled in Philadelphia.