



Emily Anne Staples Tuttle papers.

## **Copyright Notice:**

This material may be protected by copyright law (U.S. Code, Title 17). Researchers are liable for any infringement. For more information, visit

[www.mnhs.org/copyright](http://www.mnhs.org/copyright).

DEMOCRATS

---

**YOU'RE GONNA LIKE  
THIS GOVERNOR.**



**MIKE HATCH  
AND HIS LIEUTENANT  
GOVERNOR.**



**EMILY ANNE STAPLES**

---

DFL PRIMARY - SEPT. 11

# YOU'RE GONNA LIKE THIS FAMILY, TOO.



Mike and wife Patti, a teacher, with their daughters Katharine, Elizabeth and Anne. Plus the family pooch, Lady. Mike hails from Duluth and Patti is from Keewatin.

## *Hatch Staples* **DEMOCRATS**

- Health Care Should Be a Right.
- Quit Destroying Our Forests, Groundwater and Air.
- Smaller Classroom Size.
- Lower Property Taxes.

---

**VOTE IN THE DFL PRIMARY, SEPT. 11**

Prepared and paid for by Hatch Volunteer Committee, P.O. Box 1990, Pioneer Station, St. Paul, MN 55101, Verna Lunz, treasurer.

AFTER THE EVENTS OF THE LAST WEEK, A RUMOR WAS CIRCULATING THAT THIS MORNING I WOULD ANNOUNCE THAT BORIS YELTSIN WAS JOINING THE TICKET.

BUT I HAVE DONE A WHOLE LOT BETTER THAN THAT. I HAVE THE PLEASURE OF NOMINATING EMILY ANNE STAPLES AS MY RUNNING MATE. THERE ARE SEVERAL CRITERIA TO CONSIDER IN SELECTING A RUNNING MATE: COMPETENCE, LEADERSHIP. INTEGRITY. INTELLIGENCE. EMILY ANNE STAPLES POSSESSES ALL OF THESE QUALITIES. BUT MOST OF ALL, I DID NOT WANT A YES MAN. AND SHE IS NEITHER. I'M EXCEEDINGLY PROUD TO HAVE HER AS MY RUNNING MATE.

LET ME READ TO YOU A QUOTE:

"THE DEMOCRATIC PARTY TRIUMPHS, NOT IN SPITE OF CONTROVERSY, BUT BECAUSE OF IT. NOT BECAUSE WE AVOID PROBLEMS, BUT BECAUSE WE FACE THEM. WE HAVE WON, NOT BECAUSE WE BENT AND DILUTED OUR PRINCIPLES BUT BECAUSE WE STOOD FAST TO THE IDEALS WHICH REPRESENT THE MOST NOBLE AND GENEROUS PORTION OF THE AMERICAN SPIRIT."

NOW, THOSE WORDS, MY FRIENDS, ARE THE WORDS OF ROBERT F. KENNEDY. I BORROWED THEM BECAUSE NOTHING I COULD SAY SO FIRMLY DESCRIBES THE HEART AND SOUL OF YOUR PARTY AND MINE.

I WANT TO BE YOUR GOVERNOR. I WANT TO BE YOUR GOVERNOR BECAUSE I BELIEVE IN THE PRINCIPLES UPON WHICH THIS PARTY WAS BUILT.

I APPEAR BEFORE YOU TODAY WILLINGLY, WITHOUT RESERVATION. YOU DID NOT HAVE TO PERSUADE ME TO BE HERE. YOU HAVE NEVER HEARD ME HEDGE OR WAFFLE ON THE VALUE OF THE DFL PARTY. I BELIEVE IN OUR PARTY;

MOST OF YOU KNEW ME LONG BEFORE YOUR NAME APPEARED ON A DELEGATE NOMINATION CARD.



I'LL BE A GOVERNOR WHO REMEMBERS HIS ROOTS, HIS FRIENDS, AND HIS PARTY. A GOVERNOR WHOSE HEAD WON'T BE TURNED BY BRIGHT LIGHTS AND SLICK DEALS.

THIS IS A UNIQUE TIME IN MINNESOTA POLITICS. THE WINDS OF CHANGE THAT BLOW IN THE SOVIET UNION, IN EUROPE AND IN OUR OWN COUNTRY'S RECENT ELECTIONS DO NOT STOP AT THE BORDERS OF MINNESOTA. THERE WILL BE CHANGE IN NOVEMBER. IF THERE IS ANYTHING THAT SATURDAY'S MINNESOTA POLL SHOWED, IT IS THAT THE VOTERS WANT A NEW GOVERNOR. YOU HAVE THE POWER TO EFFECT CHANGE. AND IF THIS PARTY IS NOT AN AGENT OF CHANGE, IT MAY BE A VICTIM OF CHANGE.

OVER THE LAST SEVERAL MONTHS I HAVE TRAVELLED THIS STATE AND I HAVE LISTENED TO MINNESOTANS. THEY HAVE A LOT TO SAY.

A SENIOR CITIZEN IN FERGUS FALLS TOLD ME THAT SHE HAS TO SKIP A MEAL TO BUY A PRESCRIPTION.

A HOSPITAL WORKER IN ST. PAUL TOLD ME HE CAN'T AFFORD COVERAGE FOR HIS DAUGHTER TO GET TREATMENT IN THE HOSPITAL WHERE HE WORKS.

AN EMPLOYER TOLD ME HE OFFERED A SICK EMPLOYEE A BONUS TO QUIT HIS JOB AND REDUCE THE COMPANY'S HEALTH PREMIUMS.

THEY WANT CHANGE.

MINNESOTANS ALSO TALKED ABOUT HOUSING. THIS COUNTRY HAS CUT BACK ON LOW INCOME HOUSING TO THE POINT THAT WE SEE FAMILIES ON THE STREET. THEY WANT CHANGE.

MINNESOTANS SPOKE TO ME ABOUT THE ENVIRONMENT. THEY SAY WE ARE TEARING UP OUR FORESTS, POLLUTING OUR GROUNDWATER, AND ALLOWING CORPORATIONS - IN THE NAME OF PROGRESS - DEVASTATE OUR NATURAL RESOURCES.

THEY WANT CHANGE.

MINNESOTANS TALKED TO ME ABOUT EDUCATION. THEY SAY WE DO NOT SUPPORT OUR TEACHERS - THAT OUR CLASSROOMS ARE TOO LARGE - AND THAT WE PROMOTE GIMMICKS AND DEMOTE PROFESSIONALISM. NO AMOUNT OF GIMMICKS OR MANDATES WILL REPLACE THE IMPACT OF ONE DEDICATED TEACHER.

THEY WANT CHANGE.

MINNESOTANS TOLD ME THEY WANT US TO KEEP FAITH WITH OUR FAMILY FARMERS. THE PRESSURES ON THEIR HOSPITALS, CLINICS, FARMS, SCHOOLS AND HIGHWAYS SHOULD NOT BE IGNORED.

THEY WANT CHANGE.

MINNESOTANS ALSO TOLD ME THEY WANT TO LOOK TO THE FUTURE. VERY SIMPLY, THEY SAY THAT FOURTEEN YEARS IS TOO LONG FOR ANYONE TO BE GOVERNOR.

MINNESOTANS WANT CHANGE.

THEY ARE WEARY OF WORLD CLASS RACE TRACKS AND TRADE CENTERS. THEY ARE TIRED OF ONE SHOT MIRACLES LIKE SATURN AND ENDOTRONICS. MINNESOTANS SNAT MORE THAN SUPERBOWLS AND MEGAMALLS. THEY HAVE LOST THEIR PATIENCE WITH THE POLITICS OF MEDIA MANIPULATION AND MEDIA TRIVIA.

IF WE DON'T REJECT THE POLITICS OF TRIVIA,  
IF WE DO NOT RESTORE OUR PARTY'S BOND WITH MINNESOTA,  
IF WE TURN A DEAF EAR TO THE DEMANDS OF CHANGE, THE ONLY  
ALTERNATIVE WILL BE THE REPUBLICANS.

MINNESOTANS ARE FOCUSED ON THE FUTURE. I HAVE AN AGENDA FOR THE FUTURE AND I WANT TO SHARE IT WITH YOU.

I BELIEVE THAT HEALTH CARE IS A RIGHT, NOT A PRIVILEGE. HEALTH CARE ACCESS WILL BE MY NUMBER ONE PRIORITY.

WE SPEND MORE THAN ANY OTHER SOCIETY ON HEALTH CARE, AND YET WE HAVE MORE PEOPLE WITHOUT ACCESS TO IT. I WON'T QUIT UNTIL THIS ISSUE IS RESOLVED. NO MORE COMMISSIONS. NO MORE TASK FORCES. NO MORE CONSTITUTIONAL AMENDMENTS. VERY SIMPLY, WE DON'T NEED A CONSTITUTIONAL AMENDMENT TO FIND OUT IF HEALTH CARE IS A RIGHT. IF YOU VOTE FOR ME, IT IS A RIGHT.

I BELIEVE THAT CHILDREN HAVE A RIGHT TO A ROOF OVER THEIR HEADS. YOU KNOW, WHEN I WAS IN GOVERNMENT, I DROVE BY THE DOROTHY DAY CENTER IN ST. PAUL EVERY MORNING. COLD MORNINGS. AND I'D SEE WOMEN. CHILDREN. STANDING IN LINE. SOME WHO LIVED IN A CAR. THEY ARE THE CASUALTIES OF REAGONOMICS. IT IS SO WRONG JUST TO SAY IT IS A FEDERAL ISSUE. I WON'T REST ONE NIGHT UNDER THE COMFORT OF THAT MANSION UNTIL I FEEL I HAVE DONE EVERYTHING I COULD TO PUT A ROOF OVER THE HEAD OF OUR CHILDREN.

I BELIEVE THAT WE SHOULD BE JEALOUSLY POSSESSIVE OF OUR ENVIRONMENT. I WILL NOT ALLOW ANY COMPANY - I DON'T CARE HOW BIG - TO ABUSE OUR LAND, OUR FORESTS, OUR WATER. TO QUOTE AN OLD INDIAN SAYING, "WE DO NOT INHERIT THIS EARTH FROM OUR PARENTS, WE BORROW IT FROM OUR CHILDREN." WELL FOLKS, WE HAVE BEEN BORROWING SO MUCH FROM OUR CHILDREN, WE CAN'T BEGIN TO PAY IT BACK. IN THE HATCH/STAPLES ADMINISTRATION, NO COMPANY - PARTICULARLY ONE WITH NON-UNION EMPLOYEES IMPORTED FROM THE SOUTH- WILL BE TEARING UP OUR NATURAL RESOURCES.



I BELIEVE THAT MINNESOTA CAN PROVIDE A QUALITY EDUCATION FOR ALL OF ITS CHILDREN. PROFESSIONAL TEACHERS SHOULD NOT BE THE WHIPPING POSTS FOR POLITICIANS AND BUREAUCRATS.

THAT DOESN'T MAKE SENSE. NO AMOUNT OF GIMMICKS WILL ASSIST THE TEACHER. VERY SIMPLY, TO IMPROVE THE QUALITY OF OUR EDUCATION, WE MUST REDUCE CLASSROOM SIZE.

I BELIEVE THAT OUR STATE SHOULD BE A CHAMPION OF INDIVIDUAL RIGHTS. ALL MINNESOTANS, REGARDLESS OF THEIR RACE, RELIGION, SEX, CREED, OR SEXUAL ORIENTATION ARE ENTITLED TO DIGNITY, RESPECT AND FREEDOM FROM OPPRESSION.

I AM THE FATHER OF THREE DAUGHTERS. AND I PROMISE YOU THIS: IN THE HATCH/STAPLES ADMINISTRATION, WHEN A FOREIGN DIGNITARY VISITS THIS STATE, HE WON'T THINK THAT ALL MINNESOTANS ARE 50 YEARS OLD WHITE MALES. IN OUR ADMINISTRATION, WOMEN, BLACKS AND MINORITIES WILL BE INVITED TO THE TABLE. AND THEY WILL BE IN MY CABINET TOO.

I BELIEVE IN A RIGHT TO PRIVACY AND CHOICE. I RESPECT THE OPINIONS OF PEOPLE WHO DISAGREE WITH ME ON THIS ISSUE. I RESPECT THEM MORE THAN POLITICIANS WHOSE POSITION TWIRLS LIKE A WEATHER VANE DEPENDING ON THE DIRECTION OF THE POLITICAL WINDS. I WANT YOU ALL TO KNOW MY POSITION, MY CONSISTENT POSITION, ON THIS ISSUE: IT IS LIKELY THAT A BILL RESTRICTING THE PRIVACY RIGHTS OF WOMEN UNDER ROE V. WADE WILL PASS THE LEGISLATURE. THE ISSUE IS WHETHER THE GOVERNOR WILL SIGN IT. RUDY PERPICH SAYS HE WILL SIGN IT. I WILL VETO IT.

I WANT TO THANK YOU FOR YOUR PARTICIPATION. WE ARE AT A CROSSROAD AND YOU CONTROL THE FUTURE COURSE OF THIS PARTY. YOU REPRESENT NOT ONLY THE DELEGATES AT YOUR PRECINCT CAUCUS, BUT YOU

ALSO REPRESENT THE HISTORY OF THIS PARTY, AND SUCH A GLORIOUS HISTORY.

WE HAVE MARCHED FOR CIVIL RIGHTS...TOGETHER.

WE HAVE LABORED FOR WORKING PEOPLE...TOGETHER.

WE HAVE FOUGHT FOR FAMILY FARMERS...TOGETHER.

WE HAVE PROTECTED THE VULNERABLE IN SOCIETY...TOGETHER.

WE HAVE DEFENDED THE ENVIRONMENT...TOGETHER.

WE HAVE SOUGHT PEACE ... TOGETHER.

IMAGINE ALL THAT WE CAN DO IN THE NEXT FOUR YEARS....TOGETHER.



GOVERNOR / LT. GOVERNOR

P.O. Box 1990, Pioneer Station, St. Paul, MN 55101

(612) 649-3636

WEDNESDAY, SEPTEMBER 5, 1990

Mike and Emily Anne

7:00 am      Wheels up - Crystal Airport

8:30 am      Arrive Fargo

8:30 am      Interview at airport with Austin Schauer of WDAY-TV (Mike)

9:00 am      News conference in West Terminal Boardroom.

9:30 am      Wheels up - Fargo

12:00 pm     Arrive Fergus Falls. News conference at airport.\*

12:30 pm     Wheels up - Fergus Falls

1:30 pm      Arrive Mankato. News conference at airport.\*

2:00 pm      Wheels up - Mankato

2:30 pm      Arrive Austin. News conference at airport.\*

3:00 pm      Wheels up - Austin

3:30 pm      Arrive Rochester. News conference at airport.\*

4:00 pm      Wheels up - Rochester

5:00 pm      Arrive Crystal airport

6:45 pm      Arrive Science Museum, St. Paul.

7:00 pm to    Sierra Club Gubernatorial Forum, Auditorium.  
9:00 pm      Moderator: George Latimer

\* News conference held in Main Terminal Conference where available.

NOTE: 20 to 25 minutes allotted for each news conference.



## DOUG KELLEY... on Abortion

---

Abortion is a difficult and divisive issue. While the next governor must offer leadership in the public debate on abortion, he must approach the issue responsibly, with a moderate voice, tolerant of the views of those who disagree with his position. During the debate, and once the issue has been decided, the governor must act to bring people together and to build a consensus of support for our public policy.

Abortion became an issue in this gubernatorial election when the U.S. Supreme Court stated in its Webster decision that the U.S. Constitution permitted state legislatures to impose some restrictions on abortions. No longer can politicians posture on the issue without regard to the consequences of their actions. It is an issue of immediacy to voters, both men and women.

True leaders confront the tough issues head-on. This statement describes how I would act on the issue as governor of the state of Minnesota.

I would work to reduce abortions in Minnesota with policies to avoid unwanted pregnancies. I strongly favor a comprehensive family planning program, including counseling and health care. Family planning must be realistic and understandable to be effective. I would also work with communities hardest hit by teenage pregnancies to mobilize grassroots solutions to the problem.

We must also make available to vulnerable women information necessary to make the decision on whether to carry their pregnancies to term. The information must be provided objectively, and we must impress upon young women that this is an important decision that will have an impact on the rest of their lives. We must also ensure that adoption is a real alternative for expectant mothers.

Our obligation to an expectant mother does not end with providing information and alternatives. It must also include a commitment to help disadvantaged mothers during their pregnancies and in the early years of raising their children.

While these policies will help ensure a considered decision, we are still left with the question of when abortions should be allowed. My private belief is that I am opposed to abortions except to save the life of the mother and in cases of rape and incest.



People arrive at their decisions about abortion on the basis of deeply held, strongly felt convictions. I recognize that many Minnesotans disagree with my private beliefs. I respect their views. I hope they respect mine.

The governor has a duty to represent all state citizens and to help formulate the best possible public policy. In doing so, I believe that I must separate my private views from those that I would employ as governor. Unduly restrictive abortion laws would tear at our social fabric. Public policy is not served well by enacting laws that will be met with widespread violations by those with strong and sincerely held beliefs. I have spent many years of my life enforcing the law as a federal prosecutor and I know how untenable such a situation would be.

I agree with the observation of Charles Kelbley in the December 16, 1985 Newsweek that "If Lincoln were alive today I can imagine him saying simply and directly that when there are grave doubts about the morality of a position; when philosophers, theologians and scientists cannot agree, then it should be resolved in favor of freedom, not in favor of prohibition."

Thus, I believe the laws of the state of Minnesota should allow a period of decision up to the time of viability in which a woman would have the right to choose an abortion without government intervention. However, by the time a fetus has reached viability, abortions should be allowed only when the life of the mother is threatened or in the case of a life-threatening fetal defect.

I would favor government funding for abortions for poor women to save the life of the mother and in cases of rape and incest.

Finally, in my administration, competence and integrity would be the only criteria for the selection of judges and other state officials.



# CITIZENS JURY



1990 MINNESOTA GUBERNATORIAL ELECTION

IMMEDIATE RELEASE  
August 30, 1990

CONTACT: Virginia Sweeny  
Project Director  
612-333-5300

METRO CITIZENS JURY ISSUES  
FINAL POLICY STATEMENTS AND  
RATINGS OF GUBERNATORIAL CANDIDATES ON ISSUES

St. Paul, Minn.--The three Twin Cities panels of the 1990 Minnesota Gubernatorial Citizens Jury, meeting in St. Paul, today announced their ratings of five candidates for governor on the issues covered in public hearings this week.

Here are the 12-member panels' ratings of the candidates on the issues. Scores are ranked 1 to 10, with 10 as the highest.

	Arne Carlson	Jon Grunseth	Doug Kelley	Mike Hatch	Rudy Perpich
CORE METRO					
Youth Dev.	7	5.75	7.25	5.75	6.75
Leadership	7.75	5.5	7.75	4.75	5.75
Econ. Dev.	8	7.25	7	5.75	7.75
EAST METRO					
Education	9.25	8.75	9	5.75	6.75
Governing	9	7.75	8.5	6	7
Human Services	8	7.75	8.5	6.75	6.75
WEST METRO					
Education	7.75	6.75	6.75	5	6
Revenue Mgmt	8.5	7.25	6.75	5.25	5.25
Health Care	6.5	7	6.75	4.75	5.75

(0-10, 10 is highest)

The panel's ratings came after three days of testimony by 36 witnesses and one-hour interviews with each of five gubernatorial

## Citizens Jury -2

Jon Grunseth and Doug Kelley; and Democrats Mike Hatch and Gov. Rudy Perpich. The Citizens Jury does not endorse candidates for public office.

The Citizens Jury is co-sponsored by the Minneapolis-based Jefferson Center and the League of Women Voters of Minnesota. The panel's members were selected from a randomly drawn pool of eligible voters to be representative of Minnesotans in terms of party identification, age, gender, race and locale.

Panels have already met in Rochester and Duluth. The three Twin Cities panels consist of core metro centered on Minneapolis and St. Paul proper; east metro, centered on St. Paul suburbs; and west metro, centered on Minneapolis suburbs. The sixth and final primary election panel will convene in St. Cloud on Tuesday, Sept. 4.

The Twin Cities panels adopted final policy statements in eight topic areas, including capability to govern, economic development, health care, human services, leadership, revenue management, youth health and development, and two statements on education.

Here are the panels' issue statements and commentary on candidate ratings.

Youth Health and Development

The most important part of drug fighting is prevention, including early family childhood education, Head Start, and comprehensive drug education programs, kindergarten-12. The governor should understand the complexity of education issues and be able to deal with that complexity in a comprehensive way. The governor should be brave enough to take on innovative approaches to education. Schools and teachers are limited in what they can do so there is a need for a health community for young people, including such things as after-school community education stressing self-esteem, family education and also better ways of making people aware of what is already available. Day care should be available to all who cannot afford it, as public education is. Basic health care should be available to all Minnesotans with an emphasis on preventive care (without increasing health care costs; for instance, by capping the cost of malpractice and by investigating ways to make delivery of health care services more cost effective). The governor should be more creative in funding needed programs without increasing taxes. The governor should be held accountable for budgeting and be held responsible for spending.

<u>Ratings on Youth Health &amp; Development</u>										
Arne Carlson		-----	7	-----						
Mike Hatch		-----	5.75	-----						
Jon Grunseth		-----	5.75	-----						
Doug Kelley		-----	7.25	-----						
Rudy Perpich		-----	6.75	-----						
		+	+	+	+	+	+	+	+	+
		1	2	3	4	5	6	7	8	9 10

All the candidates put a priority on education. All the candidates recognized the need for affordable primary health care for all Minnesotans. Kelley ranked first because of -his high priorities on early childhood development, women and infants -innovative approach to education -willingness to dedicate a substantial portion of his time to these issues -informing the public on the educational system. Carlson finished high because of his emphasis on preventative measures. His concerns spanned all issues from education through youth issues through health care. We recognize Perpich's past achievements and his dedication to education.

Leadership

Core Metro

The gubernatorial candidate should make clear his past track record including: - specific accomplishments  
- what kinds of risks he has been willing to take

Appointments to office should be based on merit. The candidate should make clear what process he will use to make appointments.

The candidate should make clear how his priorities will be reflected in the budget and how he would mobilize public support for this.

The candidate should make clear, if he were faced with a budget deficit whether he would raise taxes or cut spending to balance the budget.

The candidate should make clear how he would translate his visions into concrete action.

The candidate should make clear how he will provide leadership in changing campaign funding and should name some specific changes he will make.

We want someone who is a leader not only with the public but also within his administration and with the legislature.

+-----+-----+-----+-----+-----+-----+-----+-----+-----+-----+										
<u>Ratings on Leadership</u>										
Arne Carlson		-----		7.75	-----					
Mike Hatch		----		4.75	----					
Jon Grunseth		-----		5.5	-----					
Doug Kelley		-----		7.75	-----					
Rudy Perpich		-----		5.75	-----					
+---+---+---+---+---+---+---+---+---+---+										
1    2    3    4    5    6    7    8    9    10										
+-----+-----+-----+-----+-----+-----+-----+-----+-----+-----+										

All candidates showed leadership ability, but their styles differed. What we liked about Carlson in the area of leadership was: -his experience and background in politics. -his approach to appointments. -good management style. -ability to motivate others to carry out initiatives. -his honesty and straightforwardness with the public and -he gave us a clear statement of his position on ethical issues. What we liked about Kelley was -his charismatic and engaging style - his background and experience in various leadership roles - his presentation to us was well organized, precise and yet delivered in a personal way. -his expression of innovative ideas.

Economic Development

Core Metro

The Governor needs to understand the world economy and Minnesota's role in it.

The Governor needs to help create an environment where the private sector can take the lead in state economic development.

Quality education is cornerstone in Minnesota economy and the Governor should take a leadership role to strongly improve education in Minnesota, including leadership in performance criteria and teacher empowerment and choice for consumers, retraining programs, and defining the research mission of the U of M?

The Governor needs to improve the tax structure for both business and individuals.

Transportation systems are at the center of state infrastructure and support economic activity. The Governor should lead effort to reallocate transportation funds to more efficiently and effectively support economic activity.

The Governor needs to protect the environment in developing new businesses.

The Governor needs to be an advocate for effective use of human resources - training, etc. of refugees, dislocated workers, and single mothers, etc.

The Governor, in times of crisis, should take a firm stand on an economy that would benefit all - business sector and public at large.

+-----+-----+-----+-----+-----+-----+-----+-----+-----+-----+											
<u>Ratings on Economic Development</u>											
Arne Carlson		-----			8	-----					
Mike Hatch		-----		5.75	-----						
Jon Grunseth		-----			7.25	-----					
Doug Kelley		-----			7	-----					
Rudy Perpich		-----			7.75	-----					
		+	+	+	+	+	+	+	+	+	
		1	2	3	4	5	6	7	8	9	10
+-----+-----+-----+-----+-----+-----+-----+-----+-----+-----+											

If a budget shortfall were to occur all candidates agreed they would protect the educational and social services. What we liked about Carlson in the economic development area was: -he is fiscally competent; he will do a good job of managing the state's finances. -he is willing to set financial priorities. What we liked about Perpich was: he recognizes Minnesota's role in a global economy. - he has a good record in this area since 1983.



Education

East Metro

The Governor should provide personal leadership in directing the role of education.

Education should have specific and measureable goals and be available equally to all students.

Education should prepare its citizens for life in a productive and ever-changing society.

Fitting compensation and incentives for teachers and administrators should be made part of educational policy. Evaluation of teachers should be based on review by peers, parents, students and the community.

And, innovative approaches to education should always be sought to improve the educational system.

+-----+-----+-----+-----+-----+-----+-----+-----+-----+-----+										
<u>Ratings on Education</u>										
Arne Carlson		-----			9.25	-----				
Mike Hatch		-----			5.75	-----				
Jon Grunseth		-----			8.75	-----				
Doug Kelley		-----			9	-----				
Rudy Perpich		-----			6.75	-----				
+---+---+---+---+---+---+---+---+---+---+										
1 2 3 4 5 6 7 8 9 10										
+-----+-----+-----+-----+-----+-----+-----+-----+-----+-----+										

All candidates expressed the need for education as number one with family-based education at the core. Grunseth most clearly supported re-empowering parents, teachers and community to take control of education and encouraged innovations and alternative approaches to education.



Ability to Govern

East Metro

The Governor must revive the citizens' responsibility and concern for the common good.

The Governor must have a clear and realistic vision, direction, and goal for our state.

The Governor must set the course for business, government and citizens to reach out and achieve this vision for the common good of all. The Governor must have the wisdom and ability to appoint the best people to direct our fiscal and public policy and must accept responsibility for their performance.

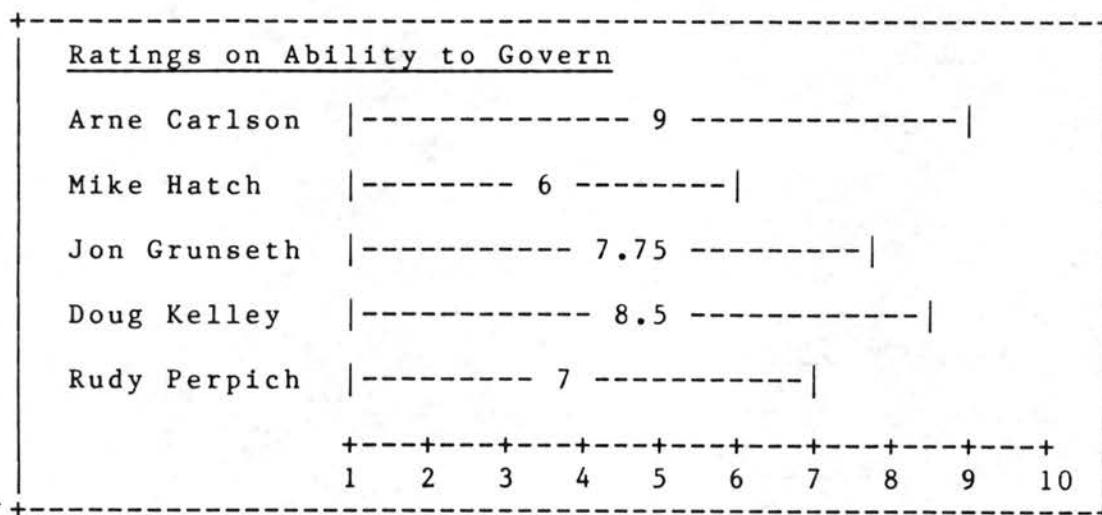

These two candidates provided a good mix of vision and realism to approach a common goal. Kelley showed the ability and energy to guide the state forward. Carlson showed the stability and experience to realistically guide the state through economic difficulties.

Human Services

East Metro

The Governor must assume the responsibility to insure the building of mentally and physically healthy, productive families.

The Governor must promote affordable and necessary family based services to those most in need using both Government and Community resources.

He or she must become an advocate in the Education of the general public and legislature to the needs for family based services such as

1. affordable and accessible child care
2. child protection programs
3. affordable housing
4. elderly care
5. health coverage

The Governor must provide commitment at the state level for funding these services.

<u>Ratings on Human Services</u>											
Arne Carlson		-----	8	-----							
Mike Hatch		-----	6.75	-----							
Jon Grunseth		-----	7.75	-----							
Doug Kelley		-----	8.5	-----							
Rudy Perpich		-----	6.75	-----							
		+	+	+	+	+	+	+	+		
		1	2	3	4	5	6	7	8	9	10

All candidates recognized a need for funding human services programs and the relationship to education as a preventive measure. All candidates expressed an understanding that breaking the social services cycle is necessary, to empower the family unit toward self sufficiency. Candidates Carlson and Kelley stated detailed solutions and examples of their strategies for providing services.

Education

West Metro

In the area of education, the governor should:

- encourage cooperative program sharing between school districts to reduce individual district costs
- provide leadership toward implementing a longer school year
- prepare for special needs of future students; for instance, gifted, slow learners, chemically impaired babies.
- encourage consistent family involvement, especially in early education
- reduce class size / student:teacher ratio
- support local control of spending while maintaining accountability
- focus on crime / drug prevention (as opposed to control)
- focus on outcome-based education / benchmark testing with state-wide standards
- support strong consequences for inappropriate behaviors in schools (stand behind teachers)
- focus on needs of younger children: age 0-5, grades K-3

+-----+-----+-----+-----+-----+-----+-----+-----+-----+-----+										
<u>Ratings on Education</u>										
Arne Carlson		-----	7.75	-----						
Mike Hatch		-----	5	-----						
Jon Grunseth		-----	6.75	-----						
Doug Kelley		-----	6.75	-----						
Rudy Perpich		-----	6	-----						
		+	+	+	+	+	+	+	+	+
		1	2	3	4	5	6	7	8	9 10
+-----+-----+-----+-----+-----+-----+-----+-----+-----+-----+										

We rated Carlson high on education because: his responses were more commensurate with the conclusions of our panel which include: -incentives for teachers. -retention of programs. -early childhood programs. -teacher-administrator partnership. -greater local control of school district funding (elimination of unnecessary mandates).

Revenue Management

West Metro

The governor should support outcome-based spending and provide for independent program evaluations. The same person should not evaluate the same program more than twice. He should then prioritize spending based on results of program evaluation.

The governor should create a favorable business tax environment to attract and retain businesses, especially industrial and high tech businesses.

The governor should define an appropriate role for the state in funding services provided by local governments.

The governor must be realistic and conservative about future revenues and cost of programs.

When the private sector can provide services more cost-effectively than the government, it should be encouraged to do so.

The governor should carefully consider alternatives before raising taxes.

+-----+-----+-----+-----+-----+-----+-----+-----+-----+-----+										
<u>Ratings on Revenue Management</u>										
Arne Carlson		-----	8.5	-----						
Mike Hatch		-----	5.25	-----						
Jon Grunseth		-----	7.25	-----						
Doug Kelley		-----	6.75	-----						
Rudy Perpich		-----	5.25	-----						
		+	+	+	+	+	+	+	+	+
		1	2	3	4	5	6	7	8	9 10
+-----+-----+-----+-----+-----+-----+-----+-----+-----+-----+										

We rated Mr. Carlson high on revenue management because he was more direct on issues such as workers compensation reform and he favors long-term financial planning. He was strongly realistic and conservative with regard to future revenues and cost of programs. We support his conviction in rejecting all spending bills until the legislature approves the budget.

## Health Care

West Metro

In the area of health care, the governor should:

1. Convene a task force consisting of employers and community leaders to communicate and implement program changes in health care by developing a strategy for a uniform assessment system which uses an independent assessor and will provide for the citizens a method of comparison for health care cost, quality and availability.
2. Encourage consolidation of existing programs to make them more available and more efficient.
3. Focus attention on providing access to health insurance for those who lack insurance, or are under-insured.

<u>Ratings on Health Care</u>											
Arne Carlson		-----	6.5	-----							
Mike Hatch		----	4.75	----							
Jon Grunseth		-----	7	-----							
Doug Kelley		-----	6.75	-----							
Rudy Perpich		-----	5.75	-----							
		+	+	+	+	+	+	+	+		
		1	2	3	4	5	6	7	8	9	10

We rated Grunseth highest on health care because he was strong on cost containment and had a strong conviction to provide affordable health care for all Minnesotans. We rated Kelley a close second in health care because he addressed cutting excess mandates. He proposed providing cost and quality information to individuals to enable them to knowledgeably select health care providers.

After having reviewed the candidates' television commercials during the week, the panels offered these observations:

East Metro: "Campaign dollars could be better spent distributing position papers to the voting public. Candidates should organize more of their own town meetings to bring voters together on issues. The media could be much more responsive to covering issues."

West Metro: "We pity the public who would vote solely on the basis of commercials. The only purpose they serve is name recognition. We feel this group of commercials had a positive tone."

Core Metro: "In general, political commercials lacked substance. They are a total waste of the public's time. Negative ads are counterproductive."

Virginia Sweeny, director of the Citizens Jury project, commended the work of the panels. "We hope voters will find the Citizens Jury reports helpful in cutting through the clutter of 30-second commercials," said Sweeny. "Minnesotans have long had the best record of voter participation in the nation. Our aim is to help voters also become the best informed."

A full copy of the panel's report may be obtained by writing the Citizens Jury at P.O. Box 26, Minneapolis, Minn. 55458.

*You are cordially invited to the home of*

*Emily Anne Staples*

*Candidate for Lieutenant Governor*

*On Wednesday, the twenty-fifth of July  
from seven o'clock to nine o'clock in the evening*

*At 1640 Xanthus Lane, Plymouth  
for a special reception with*

*Mike Hatch*

*Candidate for governor*

*\$100 per person suggested*

*Please R.S.V.P. at 612/649-3636*

*Make checks payable to the Hatch Volunteer Committee  
(see directions on back)*



Directions to Emily Anne Staples'  
Home  
1640 Xanthus Lane, Plymouth

Take Highway 12 (394) West to 101  
North (just past the turnoff to  
Wayzata). Take 101 North to County  
Road 6 (stoplight). Left to Xanthus  
Lane (3/4 mile on right).  
1640 Xanthus Lane is at the  
end of drive.

Prepared and paid for by the Hatch Volunteer  
Committee, P.O. Box 1990, Pioneer Station, St.  
Paul, MN 55101.

*You are cordially invited to the home of*

*Emily Anne Staples*

*Candidate for Lieutenant Governor*

*On Wednesday, the twenty-fifth of July  
from seven o'clock to nine o'clock in the evening*

*At 1640 Xanthus Lane, Plymouth  
for a special reception with*

*Mike Hatch*

*Candidate for governor*

*\$100 per person suggested*

*Please R.S.V.P. at 612/649-3636*

*Make checks payable to the Hatch Volunteer Committee  
(see directions on back)*

Directions to Emily Anne Staples'  
Home  
1640 Xanthus Lane, Plymouth

Take Highway 12 (394) West to 101  
North (just past the turnoff to  
Wayzata). Take 101 North to County  
Road 6 (stoplight). Left to Xanthus  
Lane (3/4 mile on right).  
1640 Xanthus Lane is at the  
end of drive.

Prepared and paid for by the Hatch Volunteer  
Committee, P.O. Box 1990, Pioneer Station, St.  
Paul, MN 55101.

*You are cordially invited to a special reception for*

*Mike Hatch*

*Candidate for Governor*

*and*

*Emily Anne Staples*

*Candidate for Lieutenant Governor*

*On Tuesday, the thirty-first of July*

*at six o'clock in the evening*

*at the home of*

*Nazie Eftekhari*

*9180 Flyway Circle, Eden Prairie*

*\$50 per person suggested*

*Please R.S.V.P. at 612/649-3636*

*Make checks payable to the Hatch Volunteer Committee*

*(See back for directions)*

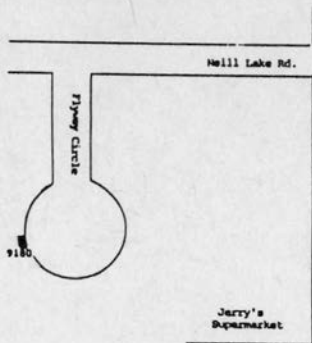

Anderson Lakes Pkwy

DIRECTIONS TO NAZIE AND ANDREW MCILVAIN'S HOME:

TAKE 18 South approx. 2 miles to first traffic light past 494. Turn right on to Anderson Lakes Pkwy. Follow through to Neill Lake Road. Turn left. Follow road to 4th street on your left- Flyway Circle. 9180 is white brick two story persian house at the end of the cul-de-sac.

Telephone: 944-0517

10000 18

494



Sunday 7/1/90

12:30 pm Taste of MN w/Mike

Anne Berget

Jane Le Ronx

Tori Houston

Richard Kleinbaum

Rod Nelson

Celeste Lerie, Rick Kothe & family -tentative

4:15 pm - meet volunteers at campaign

5:15 pm - line-up - ~~parade~~ Blaine Blazin' 4<sup>th</sup>  
91<sup>st</sup> + Polk

6:00 pm - parade begins here up No. 2 of Div. E  
w/mike

Ray Hess

Lonise & Curt Sonnenburg

Kristin Devine

Julie Goloff

John, Bea, & Natasha Ludens

Mike Feriancek

Al Gilbert, Carol Hooten, & son

Ann Bjerken

Celeste Lerie, Rick Kothe, & family -tentative

# Hatch Staples

GOVERNOR / LT. GOVERNOR

P.O. Box 1990, Pioneer Station, St. Paul, MN 55101

(612) 649-3636

MONDAY, JULY 2, 1990

8:30 am      Coffee with Eric Eskola  
meet at his office -  
basement <sup>of capitol</sup> in press office

10:00 -      Press Conference - 181 SOB

10:30 am      Car to shop

6:00 pm      meet at headquarters

6:30 pm      meet <sup>some</sup> volunteers at parade  
site

7:00 pm      Roserille parade begins  
not registered - WORK crowd







PUBLIC SUBSIDY AGREEMENT - CONSTITUTIONAL OFFICE  
1990 ELECTION

This is a legal document. Please read carefully before signing.  
To be signed by CANDIDATE only.

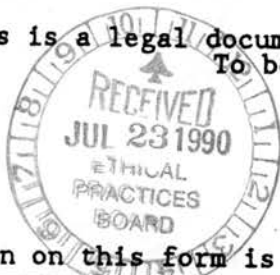

Office Sought (check one)

<input checked="" type="checkbox"/> Governor	<input type="checkbox"/> Secretary of State
<input checked="" type="checkbox"/> Lt. Governor	<input type="checkbox"/> State Auditor
<input type="checkbox"/> Attorney General	<input type="checkbox"/> State Treasurer

(All the information on this form is public information)

NOTICE TO ALL CANDIDATES under Minn. Stat. §10A.32; subd. 2:  
Minn. Stat. §10A.25 LIMITS ON CAMPAIGN EXPENDITURES.

Subd. 10 - The expenditure limits imposed by this section apply only to candidates whose major political party opponents agree to be bound by the limits and who themselves agree to be bound by the limits as a condition of receiving a public subsidy for their campaigns in the form of an allocation of money from the state elections campaign fund. A candidate of a major political party who agrees to be bound by the limits and receives a public subsidy who has an opponent who: (1) is a candidate of a major political party; and (2) does not agree to be bound by the limits but is otherwise eligible to receive a public subsidy, is not longer bound by the limits, including those in Minn. Stat. §10A.324, subd. 1(c), but is still eligible to receive a public subsidy.

CANDIDATE'S NAME EMILY ANNE STAPLES

ADDRESS 1640 XANTHUS LANE CITY Plymouth STATE MN ZIP 55447

1. As a candidate in the 1990 general election, I request a public subsidy from the State Elections Campaign Fund and voluntarily agree to the following statutory conditions:

- I will not incur cash and in-kind campaign expenditures in 1990 in excess of amount checked on back of form.
- I will return that amount of public financing received that exceeds the 1990 campaign spending limit. (See other side).
- I will return that amount of public financing received that exceeds my actual campaign expenditures for 1990.
- I will return the amount in excess of \$15,000 by which actual aggregate contributions received exceed the "aggregate contribution limit".

2. The return of public financing, if necessary, will accompany the report of receipts and expenditures my principal campaign committee files on or before January 31, 1991. The check or money order will be payable to the State of Minnesota for deposit in the General Fund of the State.

3. I will abide by the statutory spending limit until my principal campaign committee is dissolved or filings open for this office in 1994, whichever occurs first.

4. I will file an affidavit with the Board by October 1, 1990, stating I have received contributions (including unexpended balances from 1989) during 1990 equal to 20% of the Board's August 15, 1990, estimate of my share of the State Elections Campaign Fund.

REMINDER:

You must establish and register with the Board a single principal campaign committee and deposit all receipts therein, if you receive more than \$100 in contributions from sources other than your own personal funds or if you qualify to receive money from the State Elections Campaign Fund.

NOTICE:

Any person who signs and certifies to be true a statement knowing it contains false information or who knowingly omits required information is guilty of a gross misdemeanor.

Upon the proper filing of this document, you may request from the Board office a supply of Official Credit Receipt forms.

I, Emily Anne Staples,

a candidate in the 1990 election, have read and understood the foregoing agreement. I agree to the terms as stated in this written agreement with the Ethical Practices Board.

Emily Anne Staples  
Signature of Candidate

Date: 7/24/90

To be valid, this Agreement must be delivered to the Board office,  
625 North Robert Street, St. Paul, MN 55101-2520, by 4:30 p.m.  
on September 4, 1990, or postmarked on or before September 4, 1990.

ET 000010-10 Please make a copy of both sides of this Agreement for your records.

# Mike Hatch

for

## G O V E R N O R

P.O. Box 1990, Pioneer Station, St. Paul, MN 55101

(612) 649-3636

### ANSWERS TO MEA SCREENING QUESTIONS

1) Although state spending on education has steadily increased over the years, the budget for education as a percentage of the overall state budget has declined. This is wrong. In addition, the state share of funding for schools has gone down while the local share has increased.

A strong investment in education will pay greater dividends than any other investment we can make. Our goal should be to not only substantially increase the overall percentage of the state budget allocated to education but also to increase the state's share to local districts.

2) As a professional, the teacher should be given a fair opportunity to respond to criticism from parents, students, and administrators. Disciplinary proceedings brought against a teacher ought to be conducted by a fair and impartial hearing officer. The current system, which permits the school board to appoint its own hearing officer, has been criticized in several cases as having the appearance of impropriety. Such proceedings should be provided by hearing officers appointed by an impartial agency, such as the Office of State Administrative Law Judges. Unless the school board can demonstrate a clear error in the hearing officer's findings, it should follow his or her recommendations.

3) The teacher is a professional and should be recognized by society as such. And that means empowering the teacher to have more input in decisions regarding the learning environment, in such areas as class size and curriculum. PELRA ought to be amended to permit such input by the professional.



4) The Hatch Administration supports, within budget constraints, changing the base of retirement benefits from the high five years to the high three years.

5) A top priority in the Hatch Administration is to provide an adequate, reliable and fair system of funding schools to provide a high quality education. Minnesotans will make such a commitment if we can demonstrate that the system is efficiently structured. We support financial incentives which will encourage districts to restructure where such restructuring will result in a higher quality system. The financial incentives should address concerns of students, staff and the community concerning job protection, transportation, salaries, early retirement incentives and severance payments.

6) The current disparity in preparation time between secondary teachers and primary teachers is inappropriate. The Hatch plan will require that there be parity of preparation time. Mike's wife, Patti Hatch, an elementary teacher of almost twenty years, will personally lobby on this proposal!

7) The Hatch administration supports public education. Attempts to increase assistance to private schools run counter to the state's constitutional charge to provide a quality public system.

8) The Hatch plan also recognizes that local control is one of the great strengths of our educational system and that school boards offer duly elected public officials who are able to make their own decisions as to how much revenue can be raised within the school district. Restriction by the state on such local funding is presumptuous and ought to be curtailed. The fact that other districts have low property values ought not restrict their ability to raise additional revenue.

The percentage of the state budget allocated to education has decreased. We should give education a higher budget priority, and fund the general education formula in a way that compensates the poorer but efficiently structured districts.



9) There must be a more coordinated approach to governance of the post-secondary system in Minnesota. Such coordination should be achieved in a voluntary manner. If necessary, however, the state should move forward to restructure the system on a statewide basis.

10) The Hatch administration supports continued funding.

# Mike Hatch

for

G O V E R N O R

---

P.O. Box 1990, Pioneer Station, St. Paul, MN 55101

(612) 649-3636

THURSDAY, JULY 5, 1990

Emily's Schedule

11:00 am	Meeting - Dayton/Hudson
12:00 pm	Lunch with Betty Wilson of <u>Star Tribune</u> Bigelow's
evening	Dinner? This was penciled in on schedule, but I don't know where and with whom



2nd Division 58A

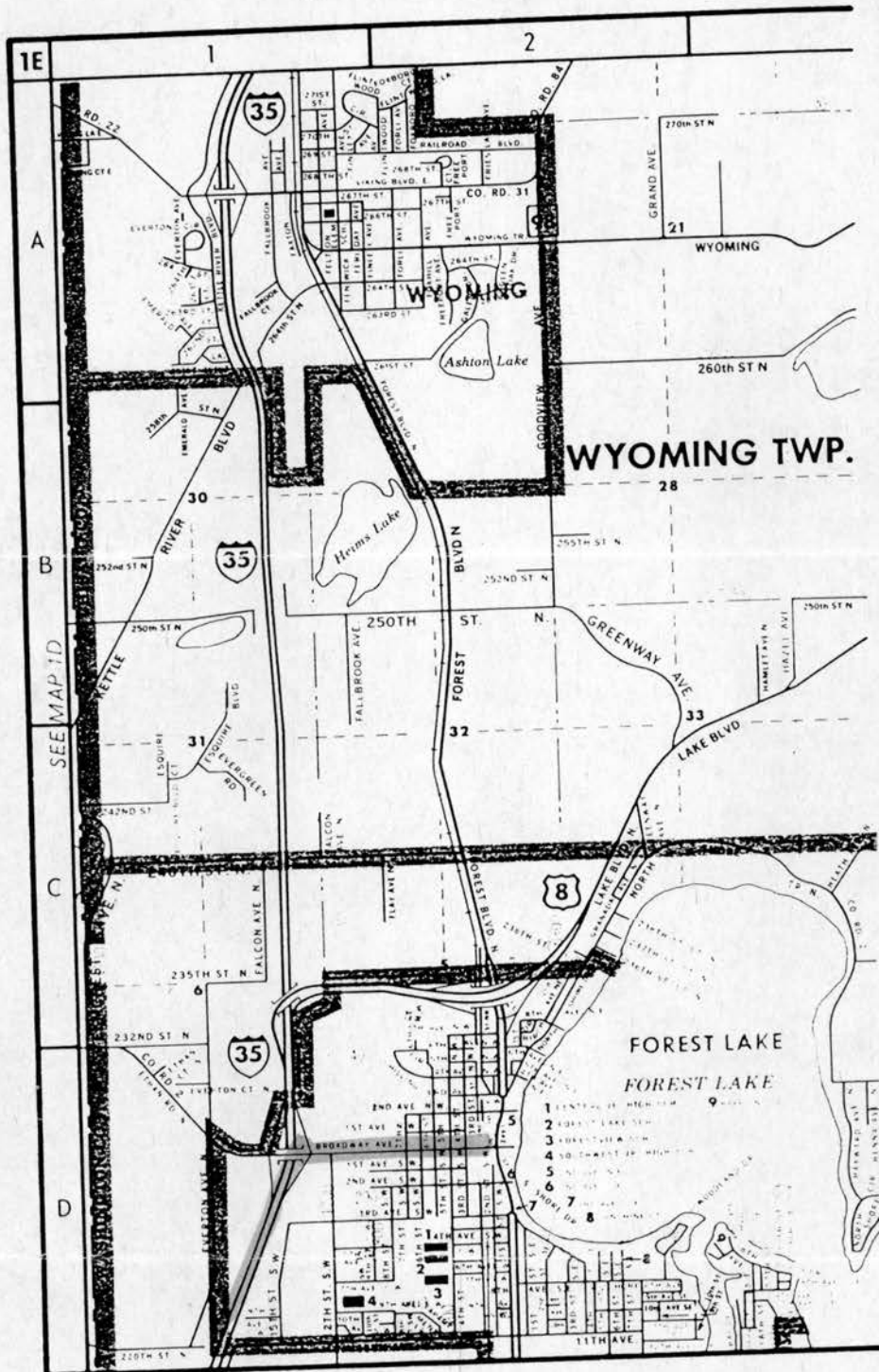



Monday, July 16

Waldorf plant gate, off Cretin Avenue in St. Paul, 3:00 p.m.  
(Hatch and Staples)

Wednesday, July 18

Aquatennial torchlight parade, 8:00 p.m., Minneapolis (Hatch  
and Staples)

Friday, July 20

Coalition of Greater Minnesota Cities Gubernatorial  
Candidates Forum, 10:15 a.m., Brainerd (Hatch)

Elk River parade, 6:00 p.m. (Hatch)

Saturday, July 21

Hibbing parade, 10:00 a.m. (Hatch)

Hastings parade, 11:00 a.m. (Staples)

Aitkin parade, 12:00 p.m. (Hatch)

Mendota parade, 1:00 p.m. (Staples)

Duluth for Viking Fest on the Bayfront, 3:30 p.m. (Hatch)

Randall Centennial Celebration parade, 5:30 p.m. (Staples)

*Mike Hatch*  
for

G O V E R N O R

*Emily*

P.O. Box 1990, Pioneer Station, St. Paul, MN 55101

(612) 649-3636

JUNE 26, 1990

Emily's Schedule

2:00 pm	Ruhr
4:00 pm	Literacy Meeting
5:45 pm	Meet volunteers at Hubert's (outside) located at Chicago Av. and 6th Street in downtown Minneapolis.
6:00 pm	Lit. drop until 7:00 pm. Work gates outside of Dome with volunteers. Volunteers will bring all materials.



# Hatch Staples

GOVERNOR / LT. GOVERNOR

P.O. Box 1990, Pioneer Station, St. Paul, MN 55101

(612) 649-3636

FRIDAY, September 7, 1990

9:30 am ARC News Conference  
10:15 am Wheels Up - Holman Field  
11:15 am Winona  
12:00 pm Wheels Up  
12:30 pm Rochester  
1:15 pm Wheels Up  
1:45 pm Austin  
2:15 pm Wheels Up  
3:00 pm Mankato  
3:30 pm Wheels Up  
4:00 pm Arrive Holman  
5:00 pm to 7:00 pm MN Press Club  
Gub. Forum  
Holiday Inn, Downtown Mpls.





GOVERNOR / LT. GOVERNOR

P.O. Box 1990, Pioneer Station, St. Paul, MN 55101

(612) 649-3636

THURSDAY, SEPTEMBER 6, 1990

Mike and Emily Anne's Schedule

6:45 am	Arrive Crystal Airport
7:00 am	Wheels up - Crystal
8:00 am	Arrive Duluth - Sky Harbor Airport Meet Bud or Peg Hargraves
8:30 am	Meet with Duluth News Tribune Editorial Board at their offices, 2nd Floor Publisher's Conf. Room re: endorsement
10:30 am	News Conference at Duluth Office
11:30 am	Wheels up - Duluth Sky Harbor Airport
12:00 pm	Arrive Hibbing Airport. Interview with Mesabi Daily News, Linda Vanderwerf
12:30 pm	Meet Emil Parantala for ride to Hibbing at airport
1:00 pm to 2:00 pm	Speak to National Association of Railroad Retirees and Volunteers, Hibbing Moose Lodge
2:15 pm	Wheels up - Hibbing
3:15 pm	Arrive Crystal
late afternoon	News Conference

Mike  
only

6:00 pm Meet volunteers at campaign for N. St. Paul parade

7:00 pm Parade begins. Details provided Thursday afternoon

Emily Anne - see next page





GOVERNOR / LT. GOVERNOR

P.O. Box 1990, Pioneer Station, St. Paul, MN 55101

(612) 649-3636

THURSDAY, SEPTEMBER 6, 1990

Emily Anne's Schedule

5:00 pm to  
7:00 pm

Lt. Governor's Reception hosted by Women's Consortium in Women's Building basement conference room, 550 Rice St., St. Paul

Introductions by Kay Williams, Co-Chair of Steering Committee, between 5:30 and 6:30 pm

5 minutes are allotted for each with  
1 1/2 mn. for intro. and 3 1/2 mn. for speech

Bring literature for tables (approx. 100 attendees)







Aronson  
Ward Inc.

*The  
Executive  
Training  
Company*

Suite 230  
Bigelow  
Building,  
450 North  
Syndicate,  
St. Paul, MN  
55104

Phone  
612/647-1366  
Fax  
612/647-0911

May 24, 1990

To: Emily Anne Staples  
From: Gail A. Ward  
President  
Re: Media interview coaching session

This is to confirm your media interview coaching session with Aronson Ward Inc., and to inform you of how to prepare and what to expect in the session. Heidi Strommen has arranged the session, which will begin promptly at 4:00 and conclude at 8:00 p.m. on May 30, 1990. Training will take place at our St. Paul studios; a map with directions is enclosed. A working dinner will be provided, please notify us of any dietary concerns.

Please come prepared with five questions, on any one subject, that may be asked in at the news conference.

During the session you will be videotaped several times in simulated media interviews. Our trainer will give you immediate feedback, addressing your concerns. The session will include an overview of media interview and preparation techniques.

All coaching is confidential. We ask that you not make or receive any phone calls, except in an emergency, to avoid interruption of the session. Should an emergency arise to prevent you from participating in the session, please notify our office and Heidi Strommen immediately.

We look forward to working with you. Please call if you have any questions.

enclosure

/sl

cc: Heidi Strommen

*Differences between the two of us?*



# ABORTION. . . DEMOCRATS. . . PERPICH. . .

## The Politics of Confusion

Not a record that either the Democrats or Perpich can take pride in. And, 1990 is the election year of accountability.

## The Politics of Confusion -- The Perpich History

- |         |   |
|---------|---|
| 1970    | Elected Lt. Governor.   |
| 1971    | Supports abortion reform.   |
| 1976    | Becomes Governor with Anderson "self-appointment" to Senate.  |
| 1973-78 | Remains silent on the issue and right-wing attempts to take over Party.   |
| 1978    | Signs bill that denies abortion services to poor women -- uproar causes him to blast the DFL Feminist Caucus for maintaining a vigil to urge him to veto the statute (which is still in force). |
| 1978    | Defeated for Governor -- out "anti-abortion" by the original born-again, Al Quie.   |

## The Politics of Confusion -- The Perpich History, Part II

- |      |  |
|------|--|
| 1982 | Perpich shuns and berates the DFL Party and runs in the primary; holds high the shield of the right-wing anti-abortion forces. |
|------|--|

## The Politics of Confusion

To his ticket, he adds Marlene Johnson -- to lead some women and others to believe that a non-voting Lt. Governor holds significance.

## The Politics of Confusion Continues in 1982

THE PROMISE, made to the MCCL and marketed in select areas, that one half of the judgeships would go to those professing anti-abortion stances.

## The Politics of Confusion

THE PROMISE -- one that violates the integrity of an independent judiciary -- affects mainly judgeships outside the scrutiny of the metro area. Look also, however, at the Court of Appeals. Promise kept.

## The Politics of Confusion

Queen bee process of appointments engineered to silence women's organizations. A history of middle, upper class appointments.

## **The Politics of Confusion -- Blaming the Victim**

Why would a Governor allow, tolerate, condone the out-right acts of terrorism and violence perpetrated against pro-choice citizens if not to create confusion? If not to blame choicers?

## **The Politics of Confusion**

The media learns that Perpich believes his privacy is violated when outraged choice supporters peacefully picket the Governor's Mansion in 1989-90.

## **1990, AN END TO THE POLITICS OF CONFUSION**

If time be the coin of our lives, then we have been robbed of twenty years.

Protecting and advocating for women to make their own decisions has been costly. Appointments, jobs, rightful access to the corridors and halls of power have been denied. . . castigation, insults, threats, slurs have been the hallmark of the Perpich years.

LET'S ADD IT UP: Minnesotans for Choice have had to counter

- ▶ 146 legislative introductions since 1971
- ▶ passage of 7 anti-abortion bills
- ▶ countless expensive trips to court
- ▶ work for platform positions at 10 national conventions
- ▶ organizing for 11 statewide precinct caucuses  
(44,000 precinct caucuses)
- ▶ 4,422 legislative campaigns
- ▶ 176 congressional races
- ▶ 22 State Conventions

♀ ♀ ♀ ♀

All this despite the fact that the 1973 U.S. Supreme Court decisions on abortion ruled that women have a Constitutional right to determine their future.

♀ ♀ ♀ ♀

## **RUDY: RETIRE**

And before you go, apologize for the twenty years of our lives you have stolen.



Prepared, paid for and distributed by the DFL Feminist Caucus



GOVERNOR / LT. GOVERNOR

P.O. Box 1990, Pioneer Station, St. Paul, MN 55101

(612) 649-3636

FRIDAY, AUGUST 31, 1990

Emily Anne's Schedule

10:00 am            Wheels Up - Mpls. International, Page Terminal  
Directions: Take Crosstown East to 28th Av.  
Go south on 28th Av. to "T". Turn left. Go  
to Page Terminal building and turn right. 626-5214

*720-9085-Marit*

11:00 am            Arrive Austin

12:00 pm to        DFL Gubernatorial Debate - Taped  
1:00 pm

1:30 pm            Wheels Up - Austin

2:30 pm            Arrive Minneapolis

afternoon          State Fair

6:00 pm            Guthrie

7:00 pm            DFL Gubernatorial Debate airs - PBS Stations





GOVERNOR / LT. GOVERNOR

P.O. Box 1990, Pioneer Station, St. Paul, MN 55101

(612) 649-3636

MONDAY, SEPTEMBER 10, 1990

Mike and Emily Anne

8:30 am Meet at campaign to prepare for news conference  
9:30 am Metro News Conference at United Hospital  
333 N. Smith Av., St. Paul  
re: Health Care (with Larry Nash)  
11:00 am Wheels up - Crystal (KSTP news crew will join)  
11:30 am Arrive St. Cloud for news conference  
12:00 pm Wheels up - St. Cloud  
12:45 pm Arrive Brainerd for news conference  
1:15 pm Wheels up - Brainerd  
2:00 pm Arrive Bemidji for news conference  
2:30 pm Wheels up - Bemidji  
3:30 pm Arrive Duluth - Sky Harbor Airport  
3:45 pm News conference at headquarters  
4:30 pm Wheels up - Duluth Sky Harbor  
5:30 pm Arrive Crystal





## I. Finance

### A. Cash Flow (Hatch and Strommen pick up personally)

1. Kelm - \$25,000
2. Opperman - \$25,000

Deliver to Ruhr on Wednesday

### B. Unions - Dave Damjanovich (Draw lists now)

1. Call list of bigwigs for Wed. Dinner
  - a. arrangements - Lenor  
Hatch home - 12 people
2. Set up unity breakfast with union reps  
arrangements Dave for 30 - Normandy Inn - 10:00 a.m. Sat 9/15

### C. Law firms - Joe Anthony and Lew Remele

1. Set up meeting with firm representatives for Friday breakfast  
8:00 a.m. - Normandy Inn Friday 9/14  
arrangements - Lenor for 20
2. At Friday meeting as well as before, set up meetings with  
law firms starting Tuesday, 9/18 at 8:00 a.m.  
Meetings should be one hour each, Schedule Tues, Wed, Thurs

### D. \$1,000/couple fundraiser, St. Paul Hotel (List, arrangements Kris Eiden) Saturday, 9/29 6:30 cocktails, 7:30 dinner.

1. draw up list of lobbyists
2. draw up letter
3. draw up ticket

### E. Direct mail - Lori

1. 40,000 DFL contributors - Letter #1
2. 10,000 DFL caucus - Letter #1
3. Hatch - Letter #1
4. 10,000 choice survey volunteers - Letter #2
5. 30,000 ARC - Letter #2

#### Draft:

1. Letter of solicitation
2. Invite to rally
3. Two letters
  - one for Abortion rights lists
  - one for DFL lists and Hatch list
4. Deliver to mail house (mail date - 9/29 mail hit - 10/5)
5. Cost = \$25,000
6. R.S.V.P. for money and rally
7. Rally date - Sunday 10/14 at St. Paul Civic Center (Hall)  
or St. Paul Radisson or Mpls. Convention Center

- F. Private fundraisers: Strommen and Eiden draw up lists
  - 1. Roitenberg
  - 2. Sam Kaplan
  - 3. Warren Spannaus
- G. Phone Bank - Marit
  - 1. Call lists with expanded bank
- H. Public financing
  - 1. \$400,000 to be paid by 10/10
  - 2. \$200,000 to be paid by 11/20
  - 3. Bank loans: method to use state payment as collateral

## II. Field Organization - Heidi

- A. Unity Lunch - Lebedoff
  - 1. Friday, 9/14 Normandy Inn
  - 2. Constitutional candidates; mayors(include Duluth); congressman legislative leadership; party officers, congressional district chairs and associate chairs (but not directors).
- B. Fly-around
  - 1. Wednesday, September 12: Southbound
    - a. St. Paul, 9:00 a.m.
    - b. Winona, 11:00 a.m.
    - c. Rochester, Noon
    - d. Austin, 1:00 p.m.
    - e. Mankato, 2:00 p.m.
    - f. Worthington, 3:15 p.m.
    - g. St. Cloud - 4:45 p.m.
      - 1. Paula Dykstra call for dinner at 5:15 p.m. Americana Inn
    - h. St. Paul - 7:30 p.m.
    - i. Labor dinner, 8:00 p.m.
  - 2. Thursday
    - a. Moorhead breakfast - 8:00 to 9:15 a.m.  
Marit (Legislators and c.c.)
    - b. Bemidji - 11:00 a.m. - coffee  
Marit (legislators and c.c.)
    - c. Duluth luncheon - 1:00 p.m.  
Bud Hargraves and Marit - Chinese Lantern
    - d. Tour UMD - 3:00 p.m.
    - e. Press Conference - 5:30 p.m. Keewatin



f. Keewatin - dinner - Senior Center - 7:00 p.m.

Food: Damjanovich (lasagna, salad, red wine and beer)

3. Steering Committee - draw up list and invite for Monday at Normandy

9/17 - 8:00 a.m.

Heidi - Chair

Heidi - draw up outline

4. Spinning the DFL Campers ( Monday - 9/10)

1. Todd Otis - David Lebedoff

2. Mark Dayton - David Lebedoff

3. Roger Moe - Tom Kelm

4. Bob Vanacek - Tom Kelm

5. Joan Grove - Tom Kelm

6. Skip Humphrey - Paul Thatcher

### III. Media - Lori

A. Actualities - Cut Tuesday night with Naiden

Run Wednesday morning

1. Questions

-What are our chances to win?

-What will be the issues in the campaign?

-How will you achieve unity?

2. Run ads immediately

-Dinner table (Krass and Valerie)

-Chubb farmer

-Announcement ad; middle class, value issue, one generation to next

3. Prepare negative ads

a. Carlson (Eiden)

- "You can get Arne Carlson out of New York..."

b. Grunseth (Desai)

- "Mr. Chemical, Mr. Lobbyist"

4. Financial ad

a. Look at Feds

b. Look at other states

c. Look at Minnesota

d. Financial help to Grunseth and Carlson is financial (Cooper)

5. Hire Peter Hart - Gates and Lebedoff draft a memo now to Hart

a. issues:

1. Do we defend Perpich policies and say voters rejected antics of Perpich and "time for change"?

2. Do we condemn Perpich policies and DFL administration?

3. Do we attack Bush and IRs?

4. IR weaknesses

5. S & L crisis

### IV. GET OUT THE VOTE

A. Union disks for health mailing

B. Disks for pamphlet (ours)

C. Order more phones

D. Hire phoners

SEPTEMBER

	3 Labor Day	4 GOTV	5	6	7	8
9 GOTV	10 Spin DFL leaders	11 Primary Day  Cut Actualities	12 Pick up checks (\$50G) & deliver to Ruhr Run actualities Flyaround-Southbound St. Cloud dinner 5:15 Labor dinner - Hatch's 8:00 p.m.  Hire Peter Hart Order phones/hire phoners	13 Flyaround - North Moorhead Brkfst 8:00 Bemidji coffee 11:00 Duluth Lunch - 1:00 UMD tour 3:00 p.m. Keewatin Press Conf &Dinner 5:30/7:00	14 8:00 Lawyers Brkfst Normandy  Noon - DFL Unity Lunch - Normandy  Mail invites to \$1000 dinner	15 Union Unity Brkfst 10:00 a.m. Normandy
6	17 Steering Committee Brkfst 8:00 a.m. Normandy  Phone bank	18 Meet with Law firms  phone bank	19 Meet with law firms	20 Meet with law firms	21	22
3	24 Steering Committee 8:00 a.m.	25	26	27	28	29 Deliver direct mail to P.O.  6:30 p.m. \$1000 dinner
hone bank						

# OCTOBER

	1	2	3	4	5 Direct mail hits	6
	8	9	10 Public financing \$400,000	11	12	13
4 Rally 1:00 p.m.	15	16	17	18	19	20
1	22	23	24	25	26	27





GOVERNOR / LT. GOVERNOR

P.O. Box 1990, Pioneer Station, St. Paul, MN 55101

(612) 649-3636

MONDAY, SEPTEMBER 10, 1990

Mike and Emily Anne

8:30 am	Meet at campaign to prepare for news conference
9:30 am	Metro News Conference at United Hospital 333 N. Smith Av., St. Paul re: Health Care (with Larry Nash)
11:00 am	Wheels up - Crystal (KSTP news crew will join)
11:30 am	Arrive St. Cloud for news conference
12:00 pm	Wheels up - St. Cloud
12:45 pm	Arrive Brainerd for news conference
1:15 pm	Wheels up - Brainerd
2:00 pm	Arrive Bemidji for news conference
2:30 pm	Wheels up - Bemidji
3:30 pm	Arrive Duluth - Sky Harbor Airport
3:45 pm	News conference at headquarters
4:30 pm	Wheels up - Duluth Sky Harbor
5:30 pm	Arrive Crystal





GOVERNOR / LT. GOVERNOR

P.O. Box 1990, Pioneer Station, St. Paul, MN 55101

(612) 649-3636

MONDAY, SEPTEMBER 10, 1990.                      Mike and Emily Anne

8:30 am              Meet at campaign to prepare for news conference  
9:30 am              Metro News Conference at United Hospital  
                         333 N. Smith Av., St. Paul  
                         re: Health Care (with Larry Nash)  
11:00 am              Wheels up - Crystal (KSTP news crew will join)  
11:30 am              Arrive St. Cloud for news conference  
12:00 pm              Wheels up - St. Cloud  
12:45 pm              Arrive Brainerd for news conference  
1:15 pm              Wheels up - Brainerd  
2:00 pm              Arrive Bemidji for news conference  
2:30 pm              Wheels up - Bemidji  
3:30 pm              Arrive Duluth - Sky Harbor Airport  
3:45 pm              News conference at headquarters  
4:30 pm              Wheels up - Duluth Sky Harbor  
5:30 pm              Arrive Crystal





GOVERNOR / LT. GOVERNOR

P.O. Box 1990, Pioneer Station, St. Paul, MN 55101

(612) 649-3636

THURSDAY, AUGUST 9, 1990

Mike and Emily Anne

7:30 am	Meet at campaign to go to Duluth and Range
10:30 am	Press conference at Duluth Campaign office
11:00 am	Call St. Paul office to get update on interview schedule for day.
11:00 am to 1:00 pm	Sr. Citizens Picnic - Park Point, Duluth (Mike or Emily Anne)
11:00 am to 1:00 pm	Visit various Sr. High Rises in Duluth - to be arranged by Bud Hargraves (Mike or Emily Anne)
2:30 pm to 3:15 pm	Hibbing Tac plant shift change - work crowd
3:30 pm	20 mn. taped interview with Kathy Lynn of WKKQ Radio, Hibbing Located at end of Townline Rd.
afternoon	Other possible interviews
5:30 pm	Line-up begins for Duluth Spirit Valley Days parade at 59th Av. W. and Grand Avenue, <u>Section Blue, #17.</u>
6:00 pm	Parade begins.

#### Volunteers

Gary Printup - campaign  
John Jarpe - campaign  
Warren High - Duluth News Conference and for day  
Bud and Peg Hargraves - Duluth News Conference and for day





THANK YOU for taking part in the 14th Annual  
Spirit Valley Days Parade. Line-up will be at  
5:30 p.m. Thursday, August 9th, on lower 59th  
Ave. W. Go west on Grand Ave. to 59th Ave. W.  
Turn left and find the color of your section.

Your section color is Blue  
Your number in the parade is 17

See you 5:30 p.m. Thursday, August 9th

P.S. Please no throwing of candy on the  
Parade Route. Thanks

*A backyard fundraiser!  
for gubernatorial ticket*

**Mike Hatch**  
*and*  
**Emily Anne Staples**

at the Hatch home  
320 East 135th Street, Burnsville

**Wednesday, June 27th**  
**6:30 p.m.**

*Please R.S.V.P. by June 25th*

**\$50**

*612/649-3636*

*(see back for directions)*

To Minneapolis

N  
1

MINNESOTA RIVER

To ST. Paul

Highway 13

Nichols Avenue

124 B ST

21

35W

HATCH HOME

35E

I-35

To Iowa



*You are cordially invited to a cocktail reception for*

*Mike Hatch*

*Candidate for Governor*

*and*

*Emily Anne Staples*

*Candidate for Lt. Governor*

*At the Minneapolis Club*

*729 Second Avenue South, Minneapolis*

*On Thursday, the sixteenth of August*

*from five o'clock to seven o'clock in the evening*

*\$100 per person*

*Co-sponsors:*

*Joe and Gail Anthony*

*Terry Fruth*

*Mary Knoblauch*

*John Cotter*

*Denis Grande*

*Paul Floyd*

*David Lebedoff*

*Mark Feinberg*

*Dr. Aaron Nathenson*

*Ed Anderson*

*David Wendt*

*Fred and Barbara Lukerman*

*Ed Benson*

*Barbara Forster*

*Nancy Randall*

*Mark Wine*

*Charles and Pat McGill*

*Ann Sheldon Duff*

*Sandra K. Butler*

*Martha Gabbert*

*Mary Lee Dayton*

*Sarah and Sheldon Rockler*

*Penny Rand Winton*

*Mary Vaughan*

*Virginia Greenman*

*Robert Shutes*

*Please R.S.V.P. at 612/649-3636*

# CHUCK RUHR ADVERTISING

1221 NICOLLET MALL MINNEAPOLIS, MN 55403 TEL. 612-332-4565

## TELEVISION SCRIPT

CLIENT: <u>HATCH</u>	JOB NO: <u>0-198-021A</u>
CODE NO: <u>XXRQ - 9033</u>	LENGTH: <u>:30</u>
TITLE: <u>"CHOICE"</u>	DATE: <u>R2-6/26/90</u> <u>(12:00)</u>

VIDEO	AUDIO
-------	-------

Mike with super: Mike Hatch	Mike:	Respected experts have said the abortion question is essentially one of controlling women, and women's right to privacy.
-----------------------------------	-------	---

Mike voice over Family scenes from existing video		As the parents of three daughters, Patti and I are working on building a better, freer world for women... including the right to make their own choices and their right to privacy.
--	--	---

Mike close up		Rudy Perpich would take that choice away from women and give it to the politicians.
------------------	--	---

End billboard	LOU:	If you believe in a woman's right to choose, there is only one choice.
	WOODY:	Mike Hatch. You're gonna like this Governor.
	LOU:	Vote in the DFL Primary, September 11th.

BT/sg



# CHUCK RUHR ADVERTISING

1221 NICOLLET MALL MINNEAPOLIS, MN 55403 TEL. 612-332-4565

## TELEVISION SCRIPT

CLIENT:	<b>HATCH</b>	JOB NO:	<b>0-198-021B</b>
CODE NO:	<b>XXRQ - 9034</b>	LENGTH:	<b>:30</b>
TITLE:	<b>ABANDONED</b>	DATE:	<b>R3-6/26/90</b>
			<b>(5:00)</b>

VIDEO	AUDIO
-------	-------

LOU:

First it was the Austrian castle...  
Abandoned.

Then the World Trade Center...  
Abandoned.

Peat development...  
Abandoned.

Greater Minnesota Corporation...  
Abandoned.

Environmental Institute...  
Abandoned.

Endotronics...  
Abandoned.

When the glitz is gone...so is Rudy Perpich.

Can we afford four more years?

We need guts...not glitz.

WOODY:

Mike Hatch. You're gonna like this governor.

HATCH/STAPLES LOGO:

LOU:

Vote in the DFL Primary, September 11th.

# CHUCK RUHR ADVERTISING

1221 NICOLLET MALL MINNEAPOLIS, MN 55403 TEL. 612-332-4565

## TELEVISION SCRIPT

CLIENT: HATCH JOB NO: 0-198-021D  
CODE NO: XXRQ - 9036 LENGTH: :30  
TITLE: "CHANGE" DATE: R2-6/26/90  
(12:00)

VIDEO

AUDIO

EMILY ANNE:

Why is this Minnesota lake so clean and clear?

Change.

Without natural renewal, these waters would soon be stagnant. Just like state government.

Rudy Perpich has been governor ten years...and wants to make it fourteen.

It's time for a change.

To end stagnation...

With fresh thinking...

More responsiveness...

And a new governor named Mike Hatch.

Vote for Mike in the DFL Primary

September 11th, and I promise...

HATCH/STAPLES

You're gonna like this governor.

LOGO

MIKE: I was shocked to learn of a businessman who can't afford healthcare coverage for his employees..

Touched that an elderly widow skips meals to buy medicine...

Disturbed to hear a man can't afford to send his daughter to the hospital where he works.

Rudy Perpich passes the buck...says healthcare is a federal problem.

I say the buck stops here...and will fight to make healthcare the right of every Minnesotan.

WOODY: Mike Hatch. You're gonna like this governor.

MIKE: Vote in the DFL Primary, September 11th.



GOVERNOR / LT. GOVERNOR

P.O. Box 1990, Pioneer Station, St. Paul, MN 55101

(612) 649-3636

June 14, 1990

Mr. John Stanoch  
Perpich for Governor  
590 Park Street Suite 300  
St. Paul, MN 55103

Dear John:

The voters of Minnesota clearly want and deserve the opportunity to compare and contrast candidates for public office. The most direct forum for such a comparison to occur is in a public debate. We believe that such a debate would serve the interests of both campaigns as well as the voters by opening up the process.

Accordingly, I propose that we schedule a debate between the two candidates, Mike and Rudy, before the primary election in September. I believe that a joint effort on the part of our campaigns to hold this event would send a clear signal to voters that both candidates want to educate the public on their positions.

I will await your response.

Very truly yours,

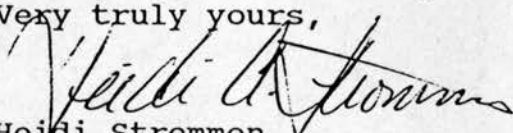
  
Heidi Strommen





GOVERNOR / LT. GOVERNOR

P.O. Box 1990, Pioneer Station, St. Paul, MN 55101

(612) 649-3636

SATURDAY, AUGUST 25, 1990

Emily Anne's Schedule

10:00 am to 5:00 pm      State Fair

5:30 pm to 8:30 pm      Take Back the Night Rally  
Loring Park, Minneapolis  
(Not a speaking engagement)

Volunteers

State Fair

9:00 am to 1:00 pm

Mike Frisch  
Rachel Reinsche  
Mike Fratto  
Dr. Lescault - tent.  
Dr. Dunn - tent.

1:00 pm to 5:00 pm

Bob Anderson  
Larry Nash  
JoHanna Hawthorne  
Kathleen Maloney

Take Back the Night

JoHanna Hawthorne  
Kathleen Maloney  
(They will be going with  
you from the fair. JoHanna  
has her own car and Kathleen  
will need a ride. She lives  
behind the Guthrie.)





Port Arthur  
Wash



GOVERNOR / LT. GOVERNOR

P.O. Box 1990, Pioneer Station, St. Paul, MN 55101

(612) 649-3636

SUNDAY, AUGUST 26, 1990

Emily Anne's Schedule

10:00 am to 3:00 pm      State Fair

Volunteers

9:00 am to 1:00 pm

Judy Rothschadl  
John House  
John Retzlaff  
Rolly Theiler

1:00 pm to 5:00 pm

Larry Nash  
Mike Mobley  
Mike Bryant





GOVERNOR / LT. GOVERNOR

P.O. Box 1990, Pioneer Station, St. Paul, MN 55101

(612) 649-3636

MONDAY, AUGUST 27, 1990

Emily Anne's Schedule

10:00 am to 3:00 pm      State Fair - Senior Day

Volunteers

9:00 am to 1:00 pm

Marshall Friedell  
Mike Frisch  
Larry Nash  
Jeanne Hagen  
Bob Hagen

1:00 pm to 5:00 pm

Diane Shuda  
Linda Notch  
Jim Naiden



MIKE HATCH  
Convention Speech  
0-198-019  
June 4, 1990

TODAY...I ASK YOU FOR YOUR ENDORSEMENT FOR GOVERNOR.

I APPEAR WILLINGLY AND WITHOUT RESERVATION. YOU DID NOT HAVE TO COAX ME OR URGE ME TO COME HERE. I'M PRESENT...WITH PRIDE. IN MY YEARS SERVING THE DFL YOU HAVE NEVER HEARD ME HEDGE OR WAFFLE ABOUT THE VALUE OF OUR PARTY OR ITS PROCESS.

IN FACT, TEN YEARS AGO TODAY, YOU WERE KIND ENOUGH TO ELECT ME DFL STATE CHAIR. I THANK YOU FOR YOUR CONFIDENCE IN ME.

THOSE WERE TROUBLED TIMES. RONALD REAGAN WAS ABOUT TO BE ELECTED PRESIDENT BY THE LARGEST LANDSLIDE IN HISTORY. IN MINNESOTA...THE REPUBLICANS HAD A LOCK ON THE GOVERNORSHIP, BOTH U.S. SENATE SEATS, FIVE OF EIGHT CONGRESSIONAL SEATS...AND HAD A HOUSE DIVIDED IN ST. PAUL.

BUT WORKING TOGETHER...WE REBUILT THIS PARTY. BY 1982...WE RESTORED THE DEMOCRATIC-FARMER-LABOR PARTY TO ITS RIGHTFUL PLACE AS THE MAJORITY PARTY IN MINNESOTA.

NOW WE APPROACH ANOTHER CROSSROAD. WE CAN EITHER BUILD ANEW...AND REMAIN THE MAJORITY PARTY...OR REST ON THE PAST...AND MEEKLY ALLOW THE REPUBLICANS TO WIN IN NOVEMBER.

TO BE SURE...MINNESOTA HAS THE NUMBERS TO RANK AMONG THE LEADING STATES IN QUALITY OF LIFE. BUT AS ONE PERCEPTIVE SOUL PUT IT, "THERE ARE THREE KINDS OF LIES. LIES...DAMNED LIES...AND STATISTICS." I'M NOT SURE WHO SAID IT...BUT IT SOUNDS LIKE HARRY TRUMAN.

AND THERE'S A DARK SIDE TO OUR STATISTICS. HUNDREDS OF THOUSANDS OF MINNESOTANS CAUGHT IN THE TERROR OF HIGH CRIME...THE FEAR OF HIGH HEALTHCARE COSTS...AND THE DESPAIR OF HIGH UNDEREMPLOYMENT.

IT'S HIGH TIME WE ATTACK THESE PROBLEMS. AND I'M READY TO LEAD THE CHARGE.

OVER THE PAST SEVERAL MONTHS, I HAVE LISTENED TO MANY MINNESOTANS. AND THEY'VE HAD A LOT TO SAY.

A SENIOR CITIZEN TOLD ME SHE HAS TO SKIP A MEAL TO BUY PRESCRIPTIONS. THAT'S SAD.

A HOSPITAL WORKER TOLD ME HE CAN'T AFFORD COVERAGE FOR HIS DAUGHTER TO GET TREATMENT IN THE HOSPITAL WHERE HE WORKS. THAT'S SHAMEFUL.

AND AN EMPLOYER TOLD ME HE OFFERED A SICK EMPLOYEE A BONUS TO QUIT HIS JOB TO REDUCE THE COMPANY'S HEALTH INSURANCE PREMIUMS. THAT'S OUTRAGEOUS.

I COMMEND GOVERNOR PERPICH ON THE VISIT BY PRESIDENT GORBACHEV. I ADMIT I WON'T BE AS COSMOPOLITAN. BUT I CAN PROMISE YOU THIS. I WILL ROLL UP MY SLEEVES AND PUT EVERY OUNCE OF MY



ENERGY INTO ASSURING EVERY MAN, WOMAN AND CHILD IN THIS STATE THE DIGNITY OF A RIGHT TO HEALTHCARE. EVERYONE.

OTHER MINNESOTANS TALKED TO ME ABOUT HOUSING. WHILE OUR TAX POLICIES SUBSIDIZE THE HOMEOWNER...WE HAVE CUT BACK ON SUBSIDIES TO LOW INCOME HOUSING TO THE POINT THAT WE SEE FAMILIES ON THE STREET.

I CONGRATULATE THE GOVERNOR ON THE OLYMPIC FESTIVAL. I WON'T BE AS GLAMOROUS. BUT I PROMISE YOU THIS. I WON'T REST ONE NIGHT UNDER THE ROOF OF THAT MANSION UNTIL I HAVE DONE EVERYTHING POSSIBLE TO PUT A ROOF OVER THE HEADS OF THOSE CHILDREN.

SOME MINNESOTANS SPOKE TO ME ABOUT THE ENVIRONMENT. THEY SAY WE'RE UPROOTING OUR FORESTS...POLLUTING OUR GROUNDWATER...AND ALLOWING CORPORATIONS...IN THE NAME OF "PROGRESS"...TO DEVASTATE OUR NATURAL RESOURCES. I CONGRATULATE RUDY PERPICH ON CELEBRATE MINNESOTA. I WON'T BE AS DAZZLING. BUT I PROMISE YOU THIS. I WILL BE AN UNFLINCHING TRUSTEE OF OUR WOODS, WATERS AND SKIES. I WILL NOT LET ANY COMPANY...I DON'T CARE HOW BIG...ABUSE THEM.

MANY MINNESOTANS TALKED TO ME ABOUT EDUCATION. THEY SAY WE DO NOT SUPPORT OUR TEACHERS...THAT OUR CLASS SIZES ARE TOO LARGE...AND THAT OUR SCHOOLS ARE FLUNKING IN MATH AND SCIENCE. I CONGRATULATE GOVERNOR PERPICH ON OPEN ENROLLMENT, THE SCHOOL OF THE ARTS, AND POST SECONDARY OPTIONS. I WON'T BE AS GOOD AT SHOW-AND-TELL. BUT I PROMISE YOU THIS. I WILL NOT DIVERT ATTENTION FROM THE FACT THAT WE OWE EVERY YOUNG MINNESOTAN A

QUALITY EDUCATION...AND THE FUNDS TO MAKE SURE THEY GET IT. OUR TEACHERS ARE PROFESSIONALS WHO DESERVE OUR RESPECT AND SUPPORT AS BUILDERS OF AMERICA'S FUTURE. NO AMOUNT OF EDUCATIONAL GIMMICKS WILL TAKE THE PLACE OF ONE DEDICATED TEACHER.

SCORES OF MINNESOTANS TOLD ME ABOUT TAXATION. THEY DON'T LIKE PROPERTY TAXES. YOU MIGHT SAY IT HURTS THEM WHERE THEY LIVE. WELL, I'M AN OLD FASHIONED, UNRECONSTRUCTED DFLer. I BELIEVE IN PROGRESSIVE TAXATION. I ALSO BELIEVE THAT IF WE LOWER INCOME TAX BRACKETS AND INCREASE SPENDING...SOME OTHER TAX WILL GO UP...PROBABLY A REGRESSIVE ONE LIKE PROPERTY TAXES. I CONGRATULATE GOVERNOR PERPICH ON THE MINNESOTA CORPORATION. I WON'T BE AS GRADIOSE. BUT I PROMISE YOU THIS. I WILL VIGOROUSLY OPPOSE ANY EFFORTS TO LAY MORE OF A TAX BURDEN ON THE BACKS OF THOSE WHO CAN LEAST AFFORD IT.

MANY MINNESOTANS TOLD ME THEY WANT OUR STATE TO REGAIN ITS STATURE AS A CHAMPION OF INDIVIDUAL RIGHTS. FOR EXAMPLE, THE FASTEST GROWING TYPE OF CRIME IN AMERICAN SOCIETY TODAY IS HATE CRIME. WELL, I PROMISE YOU THIS. I'LL DO EVERYTHING IN MY POWER AS GOVERNOR TO STOP THE HATEMONGERS...AND I'LL WORK HARD FOR OPPORTUNITY FOR PEOPLE OF COLOR AND FOR EQUAL OPPORTUNITY FOR ALL...REGARDLESS OF RACE, RELIGION, GENDER OR SEXUAL ORIENTATION.

MOST MINNESOTANS TOLD ME THEY WANT A RIGHT TO PRIVACY. WE DEMOCRATS ARE AND HAVE ALWAYS BEEN A PARTY OF DIVERSITY. I RESPECT THE BELIEFS OF THOSE OF YOU WHO DISAGREE WITH ME ON THIS

ISSUE...AND SO SHOULD WE ALL. I CERTAINLY RESPECT YOU MORE THAN POLITICIANS WHOSE POSITION TWIRLS LIKE A WEATHER VANE...WHICHEVER WAY THE WIND BLOWS. MY POSITION REMAINS THE SAME AS IT HAS BEEN THROUGHOUT MY PUBLIC CAREER. IT IS VIRTUALLY CERTAIN A BILL RESTRICTING THE PRIVACY RIGHTS OF WOMEN UNDER ROE VS. WADE WILL PASS THE LEGISLATURE. THE ISSUE IS WHETHER THE GOVERNOR WILL SIGN IT. RUDY PERPICH SAYS HE'LL SIGN IT. I PLEDGE TO YOU... I WILL VETO IT.

MINNESOTANS ALSO TOLD ME THEY ARE TIRED OF THE POLITICS PLAYED WITH WORKERS' COMPENSATION. ENOUGH IS ENOUGH. I PROMISE YOU I WILL WORK TO RESTORE THE RATE REGULATION THAT EXISTED IN 1982...AND NOT ONE BENEFIT WILL BE COMPROMISED UNTIL THAT IS DONE.

THROUGHOUT THE STATE, MINNESOTANS TOLD ME THEY WANT US TO KEEP FAITH WITH OUR FAMILY FARMERS. THE PRESSURES THEY FACE...IN TERMS OF THEIR FARMS, HOSPITALS, CLINICS, SCHOOLS, HIGHWAYS AND BRIDGES CAN NO LONGER BE IGNORED. I PROMISE THEY WON'T.

AND COUNTLESS NUMBERS OF YOU HAVE TOLD ME THE DFL NEEDS A NEW GOVERNOR AS ITS TITULAR LEADER. TO RESTORE THIS PARTY AND HELP IT GROW. TO FUND OUR CANDIDATES AND BE A BRIDGE BETWEEN ELECTED OFFICIALS AND THE PARTY.

WE'VE BEEN MISSING THAT KIND OF LEADER IN RECENT YEARS...AND THE DFL PARTY HAS BECOME A MERE SHADOW OF ITS DAYS OF GLORY. THIS YEAR, WE HAD THE SMALLEST PRECINCT CAUCUS TURNOUT IN TWO DECADES. WE'RE IN DEBT. WE'RE ALLOWED LITTLE INPUT IN POLICY DECISIONS. TWO YEARS AGO, A BILL SIGNED BY THE GOVERNOR GUTTED

THE CAUCUS SYSTEM IN PRESIDENTIAL POLITICS. THIS YEAR, THE LEGISLATURE DEBATED WHETHER ALL PRIMARIES SHOULD BE MOVED UP...A PROPOSAL THAT WILL DESTROY THE CAUCUS SYSTEM THAT REMAINS. THAT BILL CAN BE HEARD NEXT SESSION. AND IF IT PASSES...THIS MAY BE THE LAST DFL STATE CONVENTION WITH ANY REAL MEANING.

I PROMISE YOU THIS. I WILL VETO THAT BILL. WHAT'S MORE...I WON'T HIDE OUT ON SUMMIT AVENUE WHEN MY PARTY MEETS. I'LL BE HERE...TO HELP YOU RESTORE THE DFL TO ITS EMINENCE AS THE PARTY OF THE PEOPLE. THIS CONVENTION WILL NO LONGER BE USED AS A DOORMAT AT THE GOVERNOR'S CONVENIENCE.

THAT'S CHANGE. AND CHANGE IS WHAT A VAST MAJORITY OF MINNESOTANS TOLD ME THEY WANT. THEY ARE TIRED OF WORLD CLASS RACE TRACKS AND MEGAMALLS. THEY ARE WEARY OF ONE SHOT MIRACLES LIKE SATURN AND ENDOTRONICS. THEY ARE FED UP WITH BREAD AND CIRCUSES. THEY HAVE LOST THEIR PATIENCE. THEY'RE READY FOR THE FUTURE.

IN SHORT, FOURTEEN YEARS IS TOO LONG FOR ANYONE TO BE GOVERNOR. IF WE DON'T FACE THAT FACT RIGHT HERE IN THIS CONVENTION...COME NOVEMBER, THE VOTERS WILL DO IT FOR US.

IF WE DON'T REJECT THE POLITICS OF TRIVIA...IF WE DON'T RESTORE OUR PARTY'S SPECIAL BOND WITH MINNESOTANS...IF WE TURN A DEAF EAR TO THEIR DEMANDS FOR CHANGE...THEIR ONLY ALTERNATIVE WILL BE THE REPUBLICANS.

WHAT A DISMAL PROSPECT.

I've supported him, I've contributed to him

We were sent here to exercise our best judgement

45% negative

Voter want a change.

The winds of change don't stop at our borders.

We do not want to be ~~a~~ single issue

We have an agenda for the future -

People will vote for a well thought-out program to address their needs

As a senator I supported choice

I have always been concerned about issues.

He has a vision for the future. I share that vision.

I served on the NEW Commission on National Health Insurance - Mike's No 1 priority.



AND SO I ASK FOR YOUR ENDORSEMENT...INVOKING THESE WORDS OF  
ROBERT F. KENNEDY...

"THE DEMOCRATIC PARTY TRIUMPHED, NOT IN SPITE OF CONTROVERSY,  
BUT BECAUSE OF IT. NOT BECAUSE WE AVOIDED PROBLEMS, BUT BECAUSE  
WE FACED THEM. WE HAVE WON, NOT BECAUSE WE BENT AND DILUTED  
OUR PRINCIPLES, BUT BECAUSE WE STOOD FAST TO THE IDEALS WHICH  
REPRESENT THE MOST NOBLE AND GENEROUS PORTION OF THE AMERICAN  
SPIRIT."

TONIGHT, LET US NOT AVOID OUR PROBLEMS, BUT SOLVE THEM. IN  
NOVEMBER, LET US TRIUMPH BECAUSE WE FACED THE FUTURE.

THANK YOU.

AFTER THE EVENTS OF THE LAST WEEK, A RUMOR WAS CIRCULATING THAT THIS MORNING I WOULD ANNOUNCE THAT BORIS YELTSIN WAS JOINING THE TICKET.

BUT I HAVE DONE A WHOLE LOT BETTER THAN THAT. I HAVE THE PLEASURE OF NOMINATING EMILY ANNE STAPLES AS MY RUNNING MATE. THERE ARE SEVERAL CRITERIA TO CONSIDER IN SELECTING A RUNNING MATE: COMPETENCE, LEADERSHIP. INTEGRITY. INTELLIGENCE. EMILY ANNE STAPLES POSSESSES ALL OF THESE QUALITIES. BUT MOST OF ALL, I DID NOT WANT A YES MAN. AND SHE IS NEITHER. I'M EXCEEDINGLY PROUD TO HAVE HER ~~WAS~~ MY RUNNING MATE.

MY NAME IS MIKE HATCH, AND I WANT TO BE YOUR GOVERNOR. I WANT TO BE YOUR GOVERNOR BECAUSE I BELIEVE IN THE PRINCIPLES UPON WHICH THIS PARTY WAS BUILT.

"THE DEMOCRATIC PARTY TRIUMPHS, NOT IN SPITE OF CONTROVERSY, BUT BECAUSE OF IT. NOT BECAUSE WE AVOID PROBLEMS, BUT BECAUSE WE FACE THEM. WE HAVE WON, NOT BECAUSE WE BENT AND DILUTED OUR PRINCIPLES BUT BECAUSE WE STOOD FAST TO THE IDEALS WHICH REPRESENT THE MOST NOBLE AND GENEROUS PORTION OF THE AMERICAN SPIRIT."

THOSE WORDS, MY FRIENDS, ARE NOT MINE BUT THE WORDS OF ROBERT F. KENNEDY. I BORROWED THEM BECAUSE NOTHING I COULD SAY SO ~~FITTINGLY~~ FITTINGLY DESCRIBES THE HEART AND SOUL OF YOUR PARTY AND MINE.

I APPEAR BEFORE YOU TODAY WILLINGLY, WITHOUT RESERVATION. YOU DID NOT HAVE TO PERSUADE ME TO BE HERE. YOU HAVE NEVER HEARD ME HEDGE OR WAFFLE ON THE VALUE OF THE DFL PARTY. I BELIEVE IN OUR PARTY;

I BELIEVE IN THE CAUCUS SYSTEM. THIS PARTY IS LIKE FAMILY TO ME. I'VE BEEN TO YOUR COUNTIES; I'VE BEEN TO YOUR HOMES. MOST OF

TO MISSY STAPLES  
@ THOMPSON ASSOC.

FROM: STAPLES

473-9120

2 PAGES

YOU KNEW ME LONG BEFORE YOUR NAME APPEARED ON A DELEGATE CARD. I'LL BE A GOVERNOR WHO REMEMBERS HIS ROOTS, HIS FRIENDS, AND HIS PARTY. A GOVERNOR WHOSE HEAD WON'T BE TURNED BY BRIGHT LIGHTS AND SLICK DEALS. IN JANUARY 1991, I'LL BE PROUD TO SAY: "I AM A DFL GOVERNOR."

THIS IS A UNIQUE TIME IN MINNESOTA POLITICS. THE WINDS OF CHANGE THAT BLOW IN THE SOVIET UNION, IN EUROPE AND IN OUR OWN COUNTRY'S RECENT ELECTIONS DO NOT STOP AT THE BORDERS OF MINNESOTA. THERE WILL BE CHANGE IN NOVEMBER. IF THERE IS ANYTHING THAT SATURDAY'S MINNESOTA POLL SHOWED, IT IS THAT THE VOTERS WANT A NEW GOVERNOR. YOU HAVE THE POWER TO EFFECT CHANGE. AND IF THIS PARTY IS NOT AN AGENT OF CHANGE, IT MAY BE A VICTIM OF CHANGE. I BELIEVE IN MY HEART WE CAN WIN IN NOVEMBER AND IN JANUARY 1991, I'LL BE PROUD TO SAY: "I AM A DFL GOVERNOR."

OVER THE LAST SEVERAL MONTHS I HAVE TRAVELLED THIS STATE AND I HAVE LISTENED TO MINNESOTANS. THEY HAVE A LOT TO SAY.

A SENIOR CITIZEN IN FERGUS FALLS TOLD ME THAT SHE HAS TO SKIP A MEAL TO BUY A PRESCRIPTION.

A HOSPITAL WORKER IN ST. PAUL TOLD ME HE CAN'T AFFORD COVERAGE FOR HIS DAUGHTER TO GET TREATMENT IN THE HOSPITAL WHERE HE WORKS.

AN EMPLOYER TOLD ME HE OFFERED A SICK EMPLOYEE A BONUS TO QUIT HIS JOB AND REDUCE THE COMPANY'S HEALTH PREMIUMS.

THEY WANT CHANGE.

MINNESOTANS ALSO TALKED ABOUT HOUSING. THIS COUNTRY HAS CUT BACK ON LOW INCOME HOUSING TO THE POINT THAT WE SEE FAMILIES ON THE STREET. THEY WANT CHANGE.

*Speak*

MINNESOTANS SPOKE TO ME ABOUT THE ENVIRONMENT. THEY SAY WE ARE TEARING UP OUR FORESTS, POLLUTING OUR GROUNDWATER, AND ALLOWING CORPORATIONS - IN THE NAME OF PROGRESS - DEVASTATE OUR NATURAL RESOURCES.

THEY WANT CHANGE.

MINNESOTANS TALKED TO ME ABOUT EDUCATION. THEY SAY WE DO NOT SUPPORT OUR TEACHERS - THAT OUR CLASSROOMS ARE TOO LARGE - AND THAT WE PROMOTE GIMMICKS AND DEMOTE PROFESSIONALISM. NO AMOUNT OF GIMMICKS OR MANDATES WILL REPLACE THE IMPACT OF ONE DEDICATED TEACHER.

THEY WANT CHANGE.

*tell*

MINNESOTANS TOLD ME THEY WANT US TO KEEP FAITH WITH OUR FAMILY FARMERS. THE PRESSURES ON THEIR HOSPITALS, CLINICS, FARMS, SCHOOLS AND HIGHWAYS SHOULD NOT BE IGNORED.

THEY WANT CHANGE.

MINNESOTANS ALSO TOLD ME THEY WANT TO LOOK TO THE FUTURE. VERY SIMPLY, THEY SAY THAT FOURTEEN YEARS IS TOO LONG FOR ANYONE TO BE GOVERNOR.

MINNESOTANS WANT CHANGE.

THEY ARE WEARY OF WORLD CLASS RACE TRACKS AND TRADE CENTERS. THEY ARE TIRED OF ONE SHOT MIRACLES LIKE SATURN AND ENDOTRONICS.

MINNESOTANS <sup>*want*</sup> ~~SNAT~~ MORE THAN SUPERBOWLS AND MEGAMALLS. THEY HAVE LOST THEIR PATIENCE WITH THE POLITICS OF MEDIA MANIPULATION AND MEDIA TRIVIA.



IF WE DON'T REJECT THE POLITICS OF TRIVIA,  
IF WE DO NOT RESTORE OUR PARTY'S BOND WITH MINNESOTA,  
IF WE TURN A DEAF EAR TO THE DEMANDS OF CHANGE, THE ONLY  
ALTERNATIVE WILL BE THE REPUBLICANS.

MINNESOTANS ARE FOCUSED ON THE FUTURE. I HAVE AN AGENDA FOR THE  
FUTURE AND I WANT TO SHARE IT WITH YOU.

I BELIEVE THAT HEALTH CARE IS A RIGHT, NOT A PRIVILEGE. HEALTH  
CARE ACCESS WILL BE MY NUMBER ONE PRIORITY.

WE SPEND MORE THAN ANY OTHER SOCIETY ON HEALTH CARE, AND YET WE HAVE  
MORE PEOPLE WITHOUT ACCESS TO IT. I WON'T QUIT UNTIL THIS ISSUE  
IS RESOLVED. NO MORE COMMISSIONS. NO MORE TASK FORCES.  
NO MORE CONSTITUTIONAL AMENDMENTS. VERY SIMPLY, WE DON'T NEED A  
CONSTITUTIONAL AMENDMENT TO FIND OUT IF HEALTH CARE IS A RIGHT.  
IF YOU VOTE FOR ME, IT IS A RIGHT.

I BELIEVE THAT CHILDREN HAVE A RIGHT TO A ROOF OVER THEIR HEADS.  
YOU KNOW, WHEN I WAS IN GOVERNMENT, I DROVE BY THE  
DOROTHY DAY CENTER IN ST. PAUL EVERY MORNING. COLD MORNINGS. AND  
I'D SEE WOMEN. CHILDREN. STANDING IN LINE. SOME WHO LIVED IN A  
CAR. THEY ARE THE CASUALTIES OF REAGONOMICS. IT IS SO WRONG JUST  
TO SAY IT IS A FEDERAL ISSUE. I WON'T REST ONE NIGHT UNDER THE  
COMFORT OF THAT MANSION UNTIL I FEEL I HAVE DONE EVERYTHING I  
COULD TO PUT A ROOF OVER THE HEAD OF OUR CHILDREN.

I BELIEVE ~~THAT~~ WE SHOULD BE JEALOUSLY POSSESSIVE OF OUR  
ENVIRONMENT. I WILL NOT ALLOW ANY COMPANY - I DON'T CARE HOW BIG  
- TO ABUSE OUR LAND, OUR FORESTS, OUR WATER. TO QUOTE AN OLD  
INDIAN SAYING, "WE DO NOT INHERIT THIS EARTH FROM OUR PARENTS,  
WE BORROW IT FROM OUR CHILDREN." WELL FOLKS, WE HAVE BEEN

BORROWING SO MUCH FROM OUR CHILDREN, WE CAN'T BEGIN TO PAY IT BACK. IN THE HATCH/STAPLES ADMINISTRATION, NO COMPANY - PARTICULARLY ONE WITH NON-UNION EMPLOYEES IMPORTED FROM THE SOUTH- WILL BE TEARING UP OUR NATURAL RESOURCES.

I BELIEVE THAT MINNESOTA CAN PROVIDE A QUALITY EDUCATION FOR ALL OF ITS CHILDREN. PROFESSIONAL TEACHERS SHOULD NOT BE THE WHIPPING POSTS FOR POLITICIANS AND BUREAUCRATS.

THAT DOESN'T MAKE SENSE. NO AMOUNT OF GIMMICKS WILL ASSIST THE TEACHER. VERY SIMPLY, TO IMPROVE THE QUALITY OF OUR EDUCATION, WE MUST REDUCE CLASSROOM SIZE.

I BELIEVE THAT OUR STATE SHOULD BE A CHAMPION OF INDIVIDUAL RIGHTS. ALL MINNESOTANS, REGARDLESS OF THEIR RACE, RELIGION, SEX, CREED, OR SEXUAL ORIENTATION ARE ENTITLED TO DIGNITY, RESPECT AND FREEDOM FROM OPPRESSION.

I AM THE FATHER OF THREE DAUGHTERS. AND I PROMISE YOU THIS: IN THE HATCH/STAPLES ADMINISTRATION, WHEN A FOREIGN DIGNITARY VISITS THIS STATE, HE WON'T THINK THAT ALL MINNESOTANS ARE 50 YEAR~~4~~ OLD WHITE MALES. IN OUR ADMINISTRATION, WOMEN, BLACKS AND MINORITIES WILL BE INVITED TO THE TABLE. AND THEY WILL BE IN MY CABINET TOO.

I BELIEVE IN A RIGHT TO PRIVACY AND CHOICE. I RESPECT THE OPINIONS OF PEOPLE WHO DISAGREE WITH ME ON THIS ISSUE. I RESPECT THEM MORE THAN POLITICIANS WHOSE POSITION TWIRLS LIKE A WEATHER VANE DEPENDING ON THE DIRECTION OF THE POLITICAL WINDS. I WANT YOU ALL TO KNOW MY POSITION, MY CONSISTENT POSITION, ON THIS ISSUE: IT IS LIKELY THAT A BILL RESTRICTING THE PRIVACY RIGHTS OF WOMEN UNDER ROE V. WADE WILL PASS THE LEGISLATURE. THE ISSUE

IS WHETHER THE GOVERNOR WILL SIGN IT. RUDY PERPICH SAYS HE WILL SIGN IT. I WILL VETO IT.

*(I'm saying to you today,)*

I BELIEVE IN A WORK ETHIC AND I BELIEVE IN THE RIGHTS OF WORKING PEOPLE. I WILL NOT COMPROMISE THOSE RIGHTS OR ALLOW POLITICIANS TO PLAY GAMES WITH THEM. MINNESOTA WORKERS WHO ARE INJURED ON THE JOB DESERVE TO BE COMPENSATED FAIRLY. AND OUR MAIN STREET BUSINESSES DESERVE TO PAY A FAIR RATE FOR WORKERS' COMPENSATION INSURANCE. I WILL WORK TO RESTORE THE RATE REGULATION WHICH EXISTED IN 1982 AND BENEFITS WILL NOT EVEN BE DISCUSSED UNTIL THAT IS DONE.

I BELIEVE IN THE DFL PARTY. I WANT TO WORK WITH YOU TO RESTORE THIS PARTY WHICH, IN RECENT YEARS, HAS DIMINISHED TO A MERE SHADOW OF ITS PAST. *As you know* WE HAD OUR SMALLEST PRECINCT TURNOUT IN TWO DECADES. WE ARE IN DEBT. WE HAVE LITTLE INPUT IN POLICY DECISIONS. TWO YEARS AGO, A BILL SIGNED BY THE GOVERNOR GUTTED THE CAUCUS SYSTEM IN PRESIDENTIAL POLITICS. THIS YEAR THE LEGISLATURE DEBATED WHETHER ALL PRIMARIES SHOULD BE MOVED UP, A PROPOSAL WHICH WILL GUT THE CAUCUS SYSTEM THAT REMAINS. THE ST. PAUL PAPER PREDICTED THAT IT WILL PASS. IF IT PASSES, THIS WILL BE THE LAST STATE CONVENTION OF ANY MEANING.

I PROMISE YOU THIS: I WILL VETO THAT BILL. BETTER THAN THAT, I WILL SHOW UP IN YOUR COUNTIES AND EVEN TELL YOU ABOUT IT BEFOREHAND. FOR TOO LONG, THIS CONVENTION HAS BEEN A DOORMAT FOR GUBERNATORIAL POLITICS.

I WANT TO THANK YOU FOR YOUR PARTICIPATION. WE ARE AT A CROSSROAD AND YOU CONTROL THE FUTURE COURSE OF THIS PARTY. YOU

REPRESENT NOT ONLY THE DELEGATES AT YOUR PRECINCT CAUCUS, BUT YOU ALSO REPRESENT THE HISTORY OF THIS PARTY, AND SUCH A GLORIOUS HISTORY.



WE HAVE MARCHED FOR CIVIL RIGHTS...TOGETHER.

WE HAVE LABORED FOR WORKING PEOPLE...TOGETHER.

WE HAVE FOUGHT FOR FAMILY FARMERS...TOGETHER.

WE HAVE PROTECTED THE VULNERABLE IN SOCIETY...TOGETHER.

WE HAVE DEFENDED THE ENVIRONMENT...TOGETHER.

WE HAVE SOUGHT PEACE ... TOGETHER.

IMAGINE ALL THAT WE CAN DO IN THE NEXT FOUR YEARS....TOGETHER.

Emily Ann Staples' Convention Speech  
June 6, 1990  
Draft 1

THIS MORNING I APPEAR BEFORE YOU TO SEEK YOUR ENDORSEMENT FOR  
LIEUTENANT GOVERNOR. TO RUN WITH MIKE HATCH

IT IS SAID THAT EVERYONE HAS <sup>Their</sup> HIS DAY...AND THAT SOME DAYS LAST  
LONGER THAN OTHERS.

LADIES AND GENTLEMEN - ~~FELLOW DELEGATES~~...FOURTEEN YEARS IS A  
LONG DAY...AND THE VOTERS OF MINNESOTA HAVE CLEARLY SIGNALLED  
THAT <sup>They believe</sup> IT IS TIME FOR A CHANGE.

~~AND THERE WILL BE A CHANGE - THERE WILL BE A CHANGE IN~~ and it will come  
in NOVEMBER...THE VOTERS HAVE MADE IT CLEAR THAT COME NOVEMBER THERE  
WILL BE A NEW GOVERNOR.

I WANT THAT GOVERNOR TO BE MIKE HATCH.....~~NOT A REPUBLICAN.~~  
~~AND IT BETTER NOT BE A REPUBLICAN~~

\* \* \* \*

~~ALL~~  
<sup>MANY</sup>  
~~MOST~~ OF YOU KNOW ME. FOR FOUR YEARS I WAS A STATE SENATOR FROM  
~~THE~~ \_\_\_\_\_ DISTRICT. <sup>43</sup> I HAVE WORKED WITH YOU AND I SHARE YOUR  
CONCERNS AND BELIEVE IN YOUR GOALS. I HAVE CONTRIBUTED TO,  
WORKED FOR AND SUPPORTED PARTY CANDIDATES. I HAVE BEEN LOYAL TO  
THE PARTY.



MORE IMPORTANTLY, I HAVE BEEN LOYAL TO MY IDEALS AND TO MY PRINCIPLES.....AND THAT IS <sup>WHY</sup> ~~WAY~~ I AM SUPPORTING MIKE HATCH.

MIKE HATCH IS A MAN OF IDEAS WHO IS WILLING TO STAND UP AND BE COUNTED ON THE ISSUES.

2  
HE IS A CANDIDATE FOR GOVERNOR WITH A PROGRAM FOR MINNESOTA....A PLAN FOR MINNESOTA THAT HAS SUBSTANCE AND MEANING. ~~A PLAN FOR MINNESOTA THAT IS IN THE TRADITION OF HUMPHREY, MCCARTHY, AND MONDALE.~~ A PLAN ~~FOR MINNESOTA~~ THAT RELIES ON SOUND ANALYSIS AND A VIGOROUS APPROACH TO THE PROBLEMS CONFRONTING OUR STATE. MIKE HATCH'S PLAN FOR MINNESOTA LOOKS BEYOND THE TEMPORARY EUPHORIA THAT IS CREATED BY THE NEXT FANCY DEAL. ~~For today's governor~~ <sup>He</sup> ~~has~~ the ability to set goals and follow through on them. ~~Leadership is a clear legislative agenda and he will to push it through.~~ MIKE HATCH SHARES MANY OF THE <sup>SOME</sup> ~~SAME~~ VISIONS THAT I HAVE FOR ALL OF US. LET ME SHARE THOSE VISIONS WITH YOU.

*His visions are not of today well in tomorrow's*  
IN 1978 I WAS THE ONLY MINNESOTAN ON <sup>CARTERS</sup> ~~THE~~ PRESIDENT'S NATIONAL COMMISSION ON <sup>NATIONAL INSURANCE</sup> ~~HEALTH CARE~~. I STUDIED THE ISSUES THEN AND I AM FAMILIAR WITH THEM NOW.

IN THE <sup>TWELVE</sup> ~~LAST FOURTEEN~~ YEARS <sup>SINCE THEN</sup> THE HEALTH CARE CRISIS HAS WORSENERED. ALL THE COMMISSIONS, THE TASK FORCES, ~~AND~~ THE HOOPLA AND HYPE, HAVE DONE NOTHING TO ADDRESS THE PROBLEM OF AFFORDABLE HEALTH CARE. HISTORICALLY, MINNESOTA HAS LED THE COUNTRY IN FINDING CREATIVE AND WORKABLE SOLUTIONS TO THE CHALLENGES OF THE MODERN

HEALTH CARE SYSTEM. IN THE LAST <sup>TWELVE</sup> ~~FOURTEEN~~ YEARS WE HAVE ABANDONED  
THAT TRADITION ~~AND~~ THAT IS WHY IT IS TIME FOR A CHANGE.

OF ALL THE CANDIDATES RUNNING FOR GOVERNOR ONLY ONE SHARES MY  
BELIEF THAT QUALITY HEALTH CARE IS A RIGHT - NOT A PRIVILEGE -  
THAT CANDIDATE IS MIKE HATCH.

OF ALL THE CANDIDATES RUNNING FOR GOVERNOR ONLY ONE CANDIDATE HAS  
A WELL CONSTRUCTED HEALTH CARE PROGRAM THAT IS IN THE BEST  
INTERESTS OF MINNESOTANS. THAT CANDIDATE IS MIKE HATCH.

APPOINTING ANOTHER TASK FORCE TO STUDY THE HEALTH CARE CRISIS  
WILL NOT SOLVE THE PROBLEM - ELECTING MIKE HATCH WILL.

IN ADDITION TO <sup>HEALTH CARE,</sup>  
~~AS A STATE SENATOR,~~ I <sup>HAVE</sup> MADE EDUCATION ONE OF MY PRIORITIES.

AS GOVERNOR, MIKE HATCH WON'T JUST TALK ABOUT BRAIN POWER - HE  
WILL APPLY IT. ~~A CHOICE AMONG SEVERAL INFERIOR SCHOOLS IS NO~~  
~~CHOICE AT ALL.~~ WE MUST LOWER CLASSROOM SIZE AND RESPECT TEACHERS  
AS THE GUARDIANS OF OUR STATE'S FUTURE. OUR CHILDREN MUST HAVE

MUST <sup>that</sup> ~~that~~ <sup>REALIZE</sup> ~~REALIZE~~ BUSINESS and ECONOMIC DEVELOPMENT IS DRIVEN BY  
THE QUALITY OF THE EDUCATION WE PROVIDE FOR OUR CHILDREN  
AFFORDABLE ACCESS TO QUALITY EDUCATION BEGINNING WITH DAY CARE. <sup>AND WE ALL</sup>  
FINALLY, AND MOST IMPORTANTLY....

~~I ALWAYS HAVE....AND ALWAYS WILL..~~ I SUPPORT A WOMAN'S RIGHT TO  
CHOOSE.

WHILE I RESPECT THE RIGHT OF OTHERS TO THINK DIFFERENTLY....I  
HAVE CONCLUDED FOR MYSELF....THAT THE RIGHT TO CHOOSE IS A  
DECISION THAT CANNOT BE ABANDONED TO POLITICIANS OR GOVERNMENT  
BUREAUCRATS.

FOR YEARS I HAVE FOUGHT FOR THE RIGHTS OF ~~FREE~~ WOMEN TO EXERCISE  
CONTROL OVER THEIR DESTINY....AND I AM NOT ABOUT TO ABANDON MY  
PRINCIPLES ON THIS ISSUE....OR <sup>TO</sup> ~~TO~~ SACRIFICE THEM ON THE ALTAR OF  
POLITICAL EXPEDIENCY.

IF MIKE HATCH AND I ARE ELECTED YOU HAVE OUR WORD .THAT

ANY LEGISLATION WHICH ATTEMPTS TO LIMIT ROE V. WADE AND A WOMAN'S  
RIGHT TO CHOOSE <sup>WILL</sup> ~~SHALL~~ BE VETOED.

\* \* \* \*

UNLESS WE CHANGE WE ARE DESTINED FOR DEFEAT...THE RECENT  
MINNESOTA POLL STATED IT PLAINLY AND SIMPLY.

OVER 45% OF THE GENERAL POPULATION GIVES OUR CURRENT GOVERNOR A ~~AN~~  
~~NEGATIVE~~ <sup>THAT</sup> ~~UNFAVORABLE~~ RATING. THE SIGNAL IS CLEAR ~~AND~~ THE TIMES ARE  
CHANGING.

~~OUR DUTY~~ <sup>DUTY</sup> ~~AS~~ DELEGATES <sup>IS</sup> ~~IS TO PUT ASIDE ANY PERSONAL AFFECTION THAT~~  
~~WE MIGHT HAVE FOR AN INCUMBENT...~~ WE WERE ELECTED TO USE OUR BEST  
JUDGMENT AND TO STAND BY OUR IDEALS AND OUR PRINCIPLES.

OUR JOB IS TO EXERCISE <sup>THAT</sup> ~~OUR~~ BEST JUDGMENT TO MAKE SURE THAT WE  
HAVE A DFL GOVERNOR IN THE FALL.

IF YOU BELIEVE...AS I DO...

THAT WOMEN AND MINORITIES HAVE A PLACE AT OUR TABLE...

THAT A WOMAN'S RIGHT TO CHOOSE IS MORE IMPORTANT THAN A  
BUREAUCRAT'S RIGHT TO CONTROL...

THAT QUALITY EDUCATION AND AFFORDABLE HEALTH CARE ARE  
RIGHTS.....NOT PRIVILEGES,

~~NOMINATING~~  
THEN JOIN WITH ME IN ~~NOMINATING~~ ENDORSING AND SUPPORTING THE NEXT GREAT  
GOVERNOR OF THE STATE OF MINNESOTA -- MICHAEL HATCH.

Mike looks beyond disappointing yet another commission  
to study. an issue

Commitment - follow through  
Won't abandon ideals when  
times are rough

The St Paul Pioneer Press has a story about  
a month ago describing ~~as~~ popular <sup>power</sup> children's names  
for the 90's. Many of them are gender neutral  
such as Alex or Chris<sup>or so</sup>. My favorite quote  
was that you can <sup>be sure</sup> ~~bet~~ that <sup>woman with the soft frame of</sup> Emily Anne will never  
be CEO of General Motors. However it gives me  
great satisfaction to think that she can be  
Lt. Gov. of Minn. Obviously times are changing.\*



Sue 475-1254

# CHUCK RUHR ADVERTISING

Sandy Koeffler  
667-3556  
Katie - 475-2454  
Shirley billed \$11.50  
per hr

June 26, 1990

## PHASE III HATCH PRODUCTION SCHEDULE

### Wed., 6/27 - SHOOT

8am Crew Call on location: Lake of the Isles - Southside  
near soccer field.

8:30am - 10am Shoot Emily Anne

10am - 10:30am Travel to Hatch residence

11am - 12:30pm SHOOT Mike

12:30 - 1:00pm WRAP

### Thurs., 6/28 - Record V/O & Edit

9am - 11am Record V/o w/ Lou Bellamy at Silk Purse  
42 S. 12th St.  
Mpls., MN 55403 332-5914

EDIT

4pm - INTERLOCK 2 spots- Choice & Change

### Fri., 6/29 - Finish 4 TV spots

9am Begin finish at Fuller Productions  
5100 Gamble Dr. Suite #150  
Mpls., MN 55416 542-9693

4pm INTERLOCK 2 spots- Abandoned & We Can Do Better (Health  
Care)

# Mike Hatch

for

## G O V E R N O R

P.O. Box 1990, Pioneer Station, St. Paul, MN 55101

(612) 649-3636

*July 4, 1990*

- 8:00 am Meet volunteers at campaign for Forest Lake parade
- 9:00 am Parade line-up begins. You are in 2nd Division, #58A. Directions: Take 35 North to Broadway Av. Exit in Forest Lake. Turn right (west) onto Broadway. See map. Parade volunteers will direct you to line-up position.
- 10:00 am Parade begins. Travel directly from parade to Richfield. Parade should last approximately 1 1/2 hours.
- 12:00 pm Richfield parade begins. We are not registered, so work crowd. Directions: Take 35 South to 76th St. exit. Turn left onto 76th St. and drive to Llyndale. Turn left on Lyndale and drive to 70th St. Turn right onto 70th St. and drive to Pillsbury Av. Meet at 67th and Pillsbury. You cannot park here, so you may have to find somewhere else to park nearby. 67th and Pillsbury is directly across a field from where parade passes. See map for directions and route.
- 3:00 pm Powderhorn Park Centennial Celebration. Register and meet other volunteers at Park Building at 15th Av. and 31st Street. We do not have a table set up, so work crowd. Events are taking place all day and into the evening.

### Parade Participants

#### Forest Lake

Carla Heyl & friend  
Don Cheatham  
Gena Doyscher's friends  
working on others

#### Richfield

Heidi & John Strommen  
Lil Schulman & family  
Ludens  
Joe Waters  
Marit Berntson  
M.T. Johnson

#### Powderhorn Park

Ludens  
Ed Fesler  
working on others



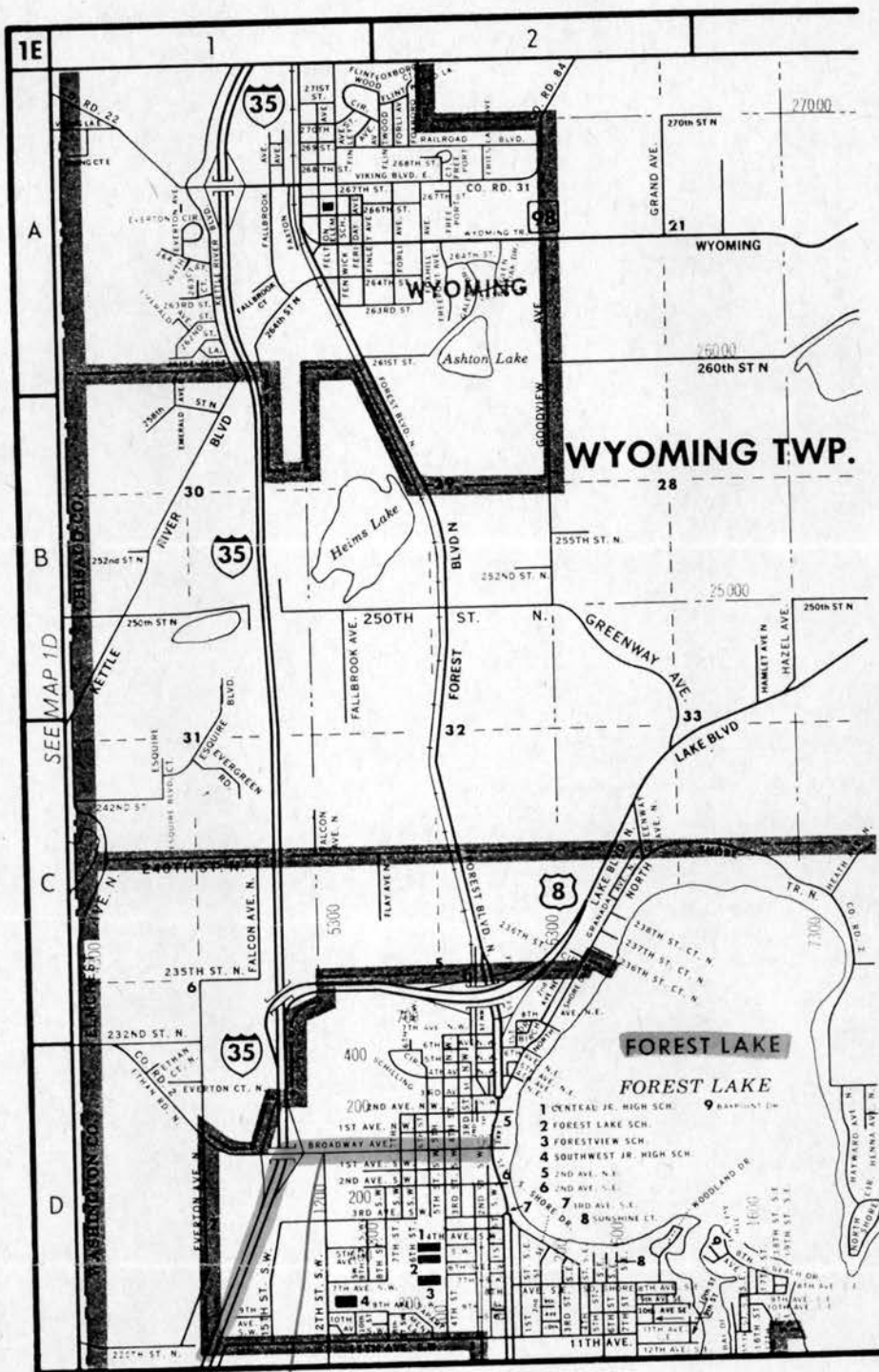

parade volunteers will direct you  
to line-up site. 9 am



*Arch  
for  
Governor*

*parade starts  
here*

*meet here  
12 pm*

*parade ends here*

CITY OF  
**RICHFIELD**

ROSS TOWN HWY 62

BLOOMINGTON

VETERAN'S  
MEMORIAL  
PARK

PORTLAND AVE.

66th ST.

66th ST.

66th ST.

66th ST.

68th ST.

69th ST.

LYNDALE AVE.

PILLSBURY  
PLEASANT  
GRAND  
HARRIET  
GARFIELD

NICOLLET AVE.

NICOLLET AVE.

PORTLAND AVE.

12th

11th  
12th  
13th

65th ST.

INTERSTATE 494

INTERSTATE 494

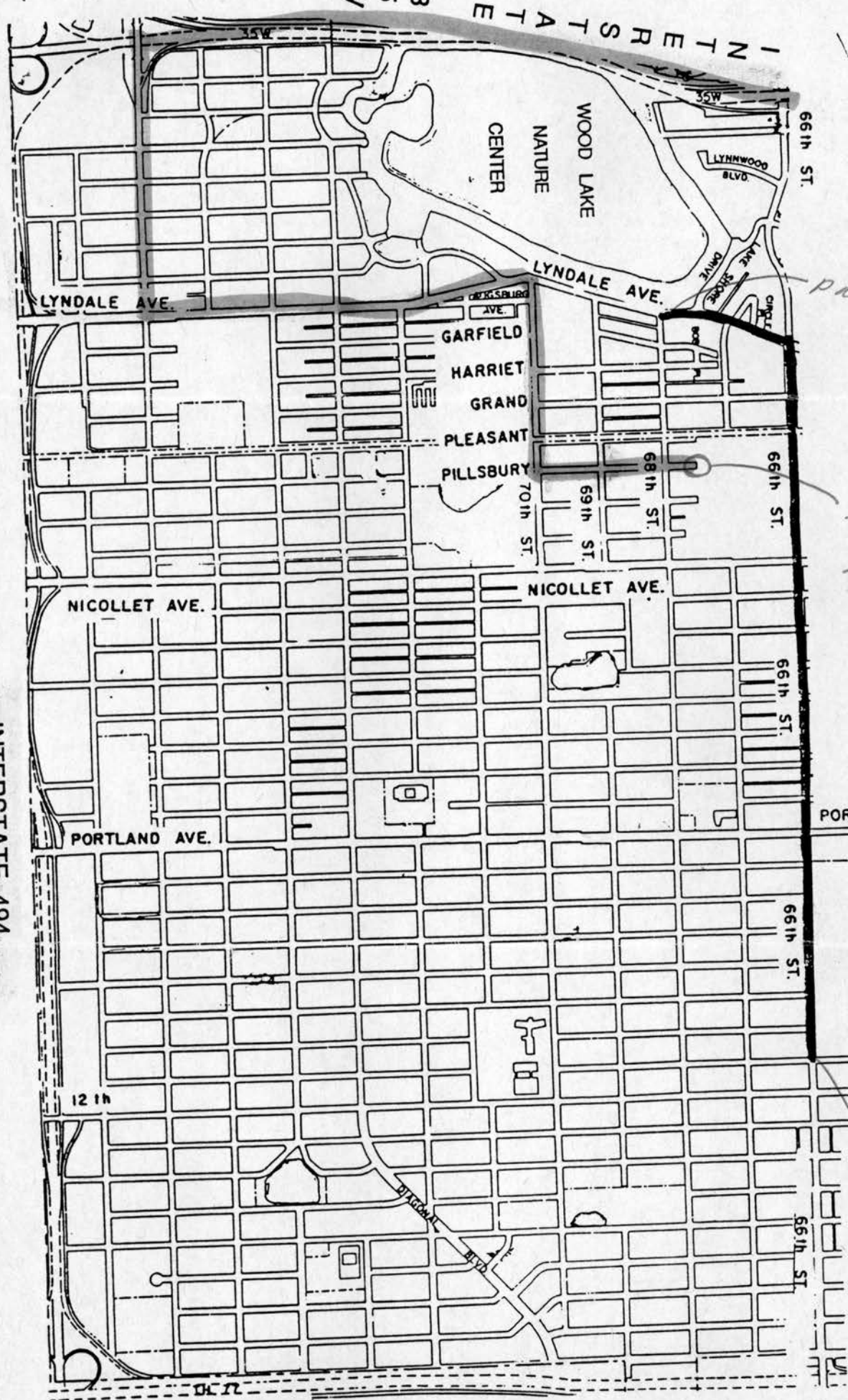



GOVERNOR / LT. GOVERNOR

P.O. Box 1990, Pioneer Station, St. Paul, MN 55101

(612) 649-3636

FRIDAY, JULY 6, 1990

Emily's Schedule

7:30 am	Breakfast at Piper Jaffry
9:00 am	New Freach
10:30 am	Interview with Karen Boros at campaign (291-1035)
12:00 am	hexington
5:45 pm	Meet volunteers at Hubert's to work crowd outside of Metrodome before Opening Ceremonies of U.S. Olympic Fest
6:00 pm to 7:30 pm	Work crowd







GOVERNOR / LT. GOVERNOR

P.O. Box 1990, Pioneer Station, St. Paul, MN 55101

(612) 649-3636

SATURDAY, JULY 7, 1990

Emily's Schedule

- 8:00 am Meet volunteers at headquarters to travel to Hinckley for Korn and Klover Karnival parade
- 9:30 am Line-up begins. Register for line-up number at this time. First come, first up. Meet volunteers.
- Take 35 North to Hinckley. At this point, 35 and 61 are the same road. Go north through the city to Brendon Field for line-up.
- 10:30 am Parade begins. It should last approximately 1 hour.
- 12:30 pm Meet at SuperValu parking lot in Milaca to work crowd at Gateway to the Northland Festival events.
- Take 23 <sup>West</sup>~~East~~ to Milaca. One block past the one and only stoplight in town, turn right onto Milaca's Main Street (actually 2nd Av.). Drive 1-2 blocks to SuperValu.

Events

- 9:00 am to 3:00 pm Craft Fair Taste of Milaca Downtown Milaca
- 12:00 pm to 12:00 am Beer Gardens - liquor store parking lot

Parade Volunteers

Campaign

Hinckley

Milaca

John Jarpe  
Larry Nash

Bud & Peg Hargraves\*  
Mike Fetzick

Pat Nelson

\*Bud and Peg will be picking up supplies and literature from you in Hinckley. They also said they would help out in parade.





GOVERNOR / LT. GOVERNOR

P.O. Box 1990, Pioneer Station, St. Paul, MN 55101

(612) 649-3636

SUNDAY, JULY 7, 1990

Emily's Schedule

11:15 am Meet volunteers at parking lot of J.P. Mulligan's  
at Northwest corner of intersections of 494 and 55.

12:00 pm Parade line-up begins. Line-up number will  
be assigned there.

Take 55 West to Maple Lake. Go through town  
two blocks past stoplight to Rogers Amoco Food  
Shop. Parade volunteers will assist you in  
locating line-up spot.

1:00 pm Maple Lake Centennial Celebration parade begins.  
It should last 1 to 1 1/2 hours.

Parade volunteers

Jill Flanders  
Larry Nash - 776-7225





GOVERNOR / LT. GOVERNOR

P.O. Box 1990, Pioneer Station, St. Paul, MN 55101

(612) 649-3636

MONDAY, JULY 9, 1990

Emily's Schedule

8:00 am	Breakfast meeting with Jennifer Navritel at Sunsets in Wayzata. She is Senator of Southwest State University Student Association and wishes to discuss student loan and tuition issues.
12:00 pm	Lunch meeting with Cheryl Dickson at Spazzo on 2nd floor of World Trade Center.
4:00 pm	Opening of Missy's Housing Complex





# Hatch Staples

GOVERNOR / LT. GOVERNOR

P.O. Box 1990, Pioneer Station, St. Paul, MN 55101

(612) 649-3636

FRIDAY, JULY 13, 1990\*

Mike & Emily

11:45am - Wheels Up - Crystal Airport, Dave Nelson  
Northland Air

1:30 pm - Arrive Fargo, West Terminal  
News Conference

2:15 pm - Wheels Up - Fargo

3:45pm - Arrive Duluth, meet Bud Hargraves

4:30 pm - Grand Opening, Duluth office  
Reception

no scheduled departure

\* typewriter ribbons shall arrive soon!



# Hatch Staples

GOVERNOR / LT. GOVERNOR

P.O. Box 1990, Pioneer Station, St. Paul, MN 55101

(612) 649-3636

SATURDAY, JULY 14, 1990

Emily &  
Mike

9:30 am Meet at campaign for Aquatennial  
Grande Day parade.

10:00 am Begin WORKING CROWD

11:00 am Parade begins

2:00 pm Nicollet Island Ice Cream  
Social. WORK CROWD.

Meet volunteers outside of  
Taps Bar at Riverplace  
plaza along River.

The Cream Social lasts until 6pm.

## Volunteers

Jill Flanders

Heidi Strommen

Jeff Johnson

Larry Nash

Mark Hilst

Celeste Leve & family

Marty Erickson & son

Sheila O'Connell

Vicki Fraher (formerly Cizakowski)

Susan Estill

Dawn Feinstein (Taps)

Joe Waters (Taps)

Dante Damjanovich





# Hatch Staples

GOVERNOR / LT. GOVERNOR

P.O. Box 1990, Pioneer Station, St. Paul, MN 55101

(612) 649-3636

SUNDAY, JULY 15, 1990

Emily

1:15 pm Meet at campaign for Robbinsdale  
for Wiz Bang Days Parade

2:00 pm Line-up begins. Meet at Jr.  
High School at 41st & Regent Av.

3:00 pm Parade begins. It should last  
approx. 2 hours.

## Volunteers

Peggy Shannon  
Dave Dumjanovich  
Kathy McClure  
Era Leonard  
Mike Bryant



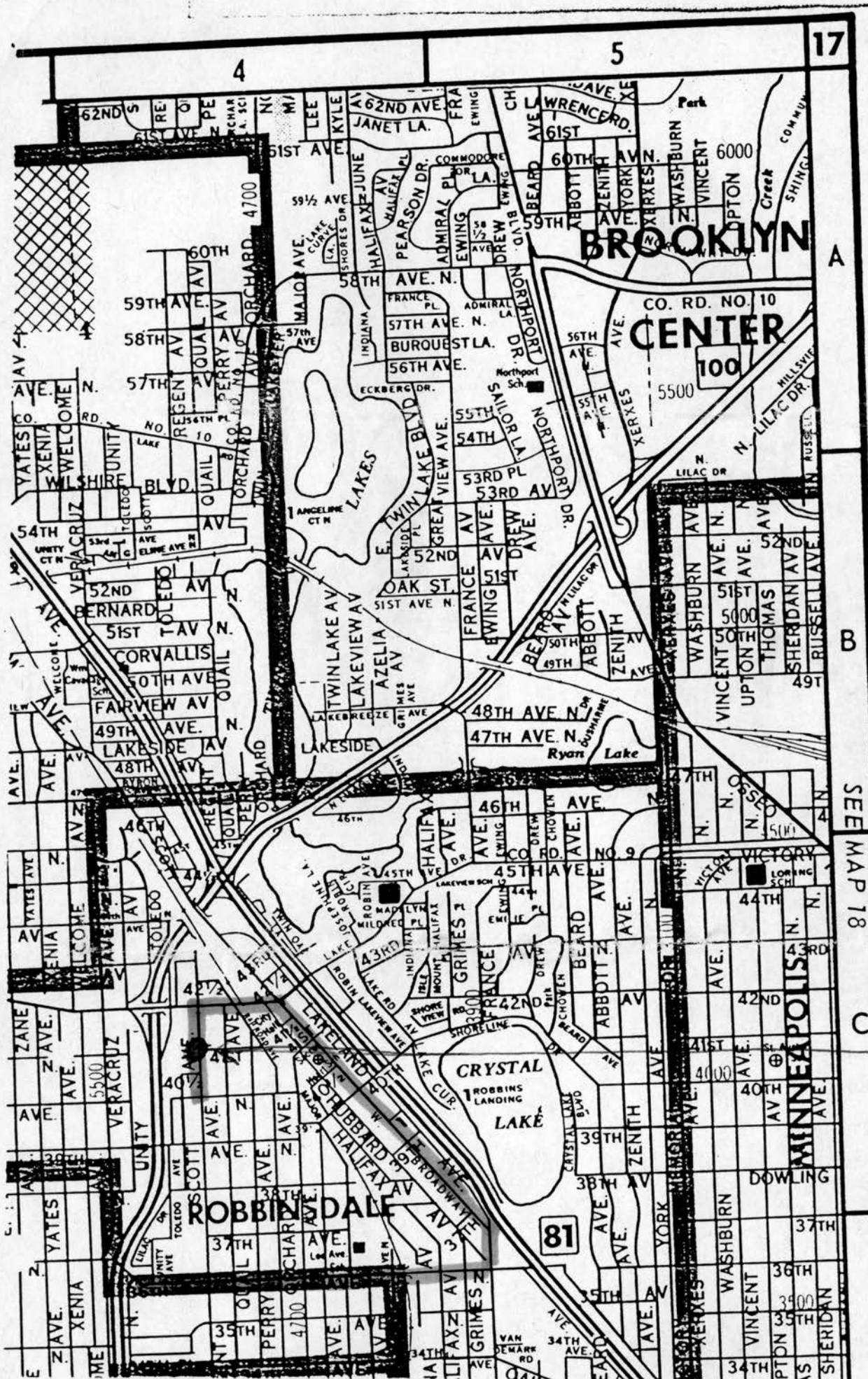

*parade route*

*meet  
here  
JR High School  
41<sup>st</sup> & Regent*

# Hatch Staples

GOVERNOR / LT. GOVERNOR

P.O. Box 1990, Pioneer Station, St. Paul, MN 55101

(612) 649-3636

MONDAY, JULY 16, 1990

Emily

9:00 am

Meeting with Luanne Nyberg  
& Ginny Greeman of Children's  
Defense Fund.

MN Women's Bldg., 550 Rice St.,  
Suite 104 (227-6121)

2:45 pm

Meet at campaign to leave  
for Waldorf paper  
plant shift. Change at 3 pm.





# Hatch Staples

GOVERNOR / LT. GOVERNOR

P.O. Box 1990, Pioneer Station, St. Paul, MN 55101

(612) 649-3636

Call Pat Flater -  
Pete's evaluation to the  
ex comm

THURSDAY, JULY 19, 1990

Emily's Schedule

10:00 am

Accountant

~~3:30~~

~~4:00 pm~~

Meeting - Ruhr

6:30 pm

Dinner in Wayzata



# Hatch Staples

GOVERNOR / LT. GOVERNOR

P.O. Box 1990, Pioneer Station, St. Paul, MN 55101

(612) 649-3636

SATURDAY, JULY 21, 1990

Emily's Schedule

- 8:30 am Meet at campaign for Hastings parade
- 10:00 am Line-up begins in Hastings (details attached) #28
- 11:00 am Hastings parade begins. We are registered.
- 12:30 pm Leave Hastings for Mendota parade.
- 1:00 pm Mendota parade begins. Work crowd (details attached).
- 2:30 pm Meet volunteers at campaign to go to Randall
- 4:30 pm Line-up begins in Randall.
- 5:30 pm Randall Centennial parade begins (details attached).

## Hastings & Mendota

Connie Warr - Hastings  
✓ Sheila O'Connell - campaign  
✓ Sue Berg - campaign  
✓ Sheila Desai - campaign  
Marge Tilley - campaign  
~~Robert Rivera - campaign~~  
✓ Barbara May - campaign  
Barb Picutelli - tent.  
Janet Kramer - tent  
Jane LeRoux - tent. - Hastings  
Tienne Ruppert - campaign  
Elissa Mautner

## Randall

please call this  
afternoon to  
confirm Randall





Mendota parade  
1:00 pm - begins

Take 55 W from Hastings  
to Mendota.

~~Line~~

Parade follows Highway 13  
through the city of Mendota.

(13 intersects with 55)

We are not registered. WORK  
CROWD!

Randall parade

Centennial Celebration

line-up 4:30 pm

parade 5:30 pm

Line-up # 33

Take 10 North past Little Falls  
about 10 miles to Randall.

Parade lines up east of  
Randall on 115.

Randall parade

Centennial Celebration

line-up 4:30 pm

parade 5:30 pm

Line-up #33

Take 10 North past Little Falls  
about 10 miles to Randall.

Parade lines up east of  
Randall on 115.

Called 9/10 to  
 Registrar, Wilder pond  
 information 949-0376  
 Address 949-0376  
 430 530  
 12/2  
 Court of Wilder pond  
 please to

Richard Bermel  
Maureen Hegg  
Patricia Borden  
Charles Andres  
Curt Martinson  
Mardelle Oothoudt  
Bess Weidenbach

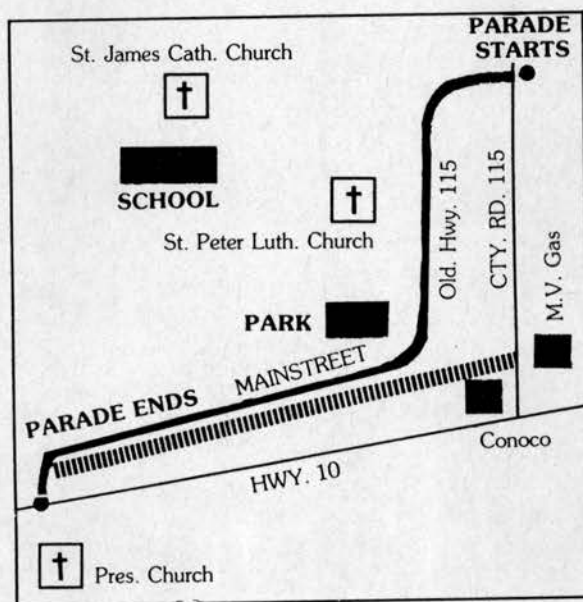





GOVERNOR / LT. GOVERNOR

P.O. Box 1990, Pioneer Station, St. Paul, MN 55101

(612) 649-3636

SATURDAY, AUGUST 3, 1990

Emily's Schedule

11:15 am Meet volunteers at campaign.  
12:15 pm Meet Marty Erickson at McDonald's in Prior Lake.  
16831 Highway 13.  
1:00 pm Parade begins in Prior Lake. We are not registered,  
so work crowd. See attached map.

Volunteers

John Jarpe - campaign  
Kathleen Maloney - campaign  
Marty Erickson - McDonald's  
Celeste Levie and family - campaign  
Linda Notch - tent. at campaign

4:15 pm Meet volunteers at campaign.  
6:00 pm Line-up begins in Pine City. Line-up #59A. See  
attached map. We are in parade.  
7:00 pm Parade begins.

Volunteers

Bill and Maggie Simmons - campaign  
Larry Nash - campaign  
Lona Cheatum - Pine City line-up - she will provide convertible  
Connie Knox and daughter - Pine City line-up.





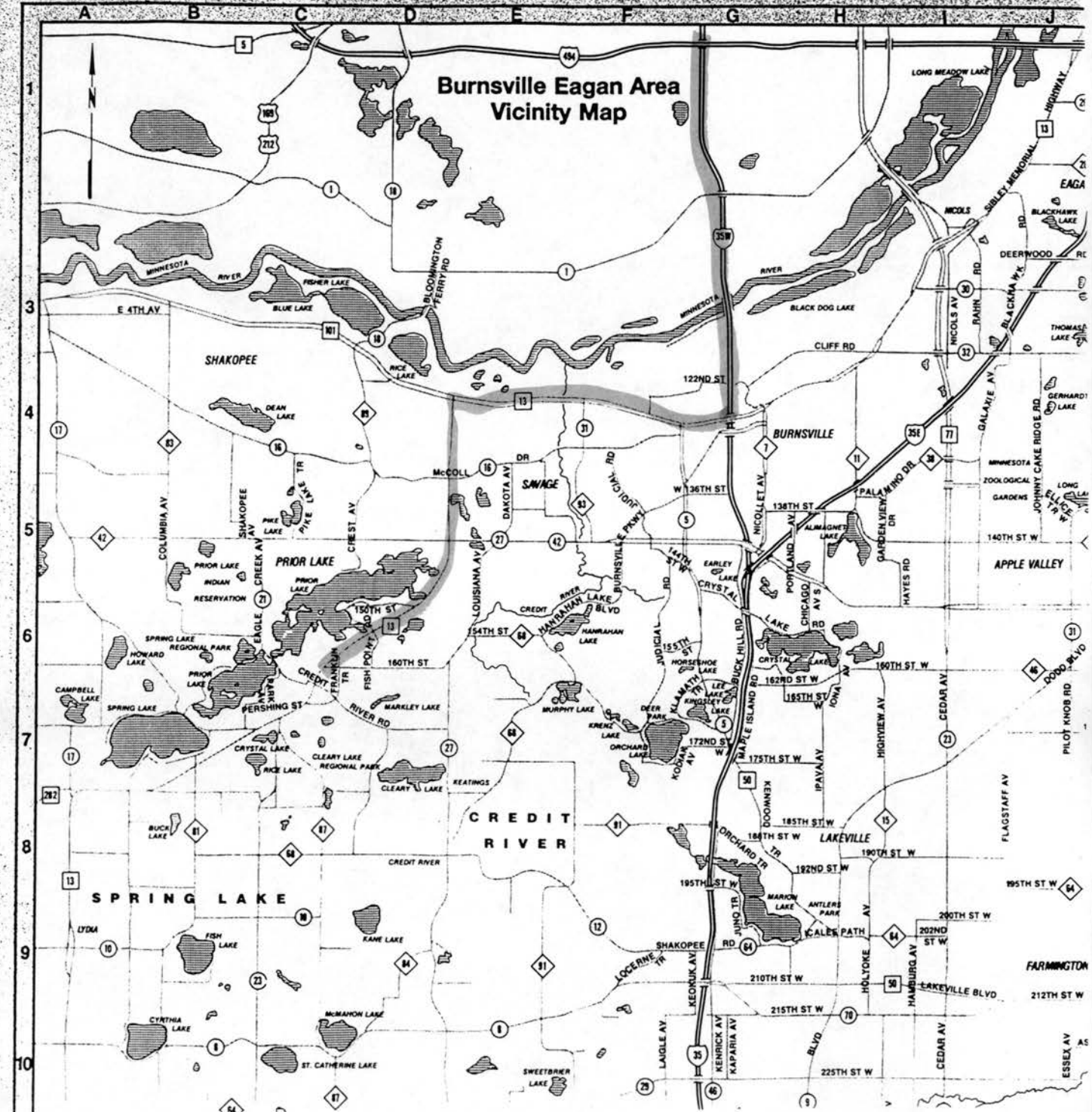

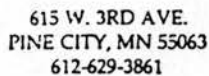

1. Dressing room facilities are available here at the Vocational School building beginning at 5 p.m.

2. Bus parking and unit assembly area in the vocational parking lot
3. Additional bus parking Pine City State Bank and Johnson Building Center
4. All Animal units may use the area North and East of Robinson Park and behind the Pine City Pioneer office  
NO ANIMAL UNITS IN REGULAR LINE UP
5. Starting point will be the North end of Railroad Street

PLEASE LOOK FOR YOUR POSITION NUMBER  
Thanks!!

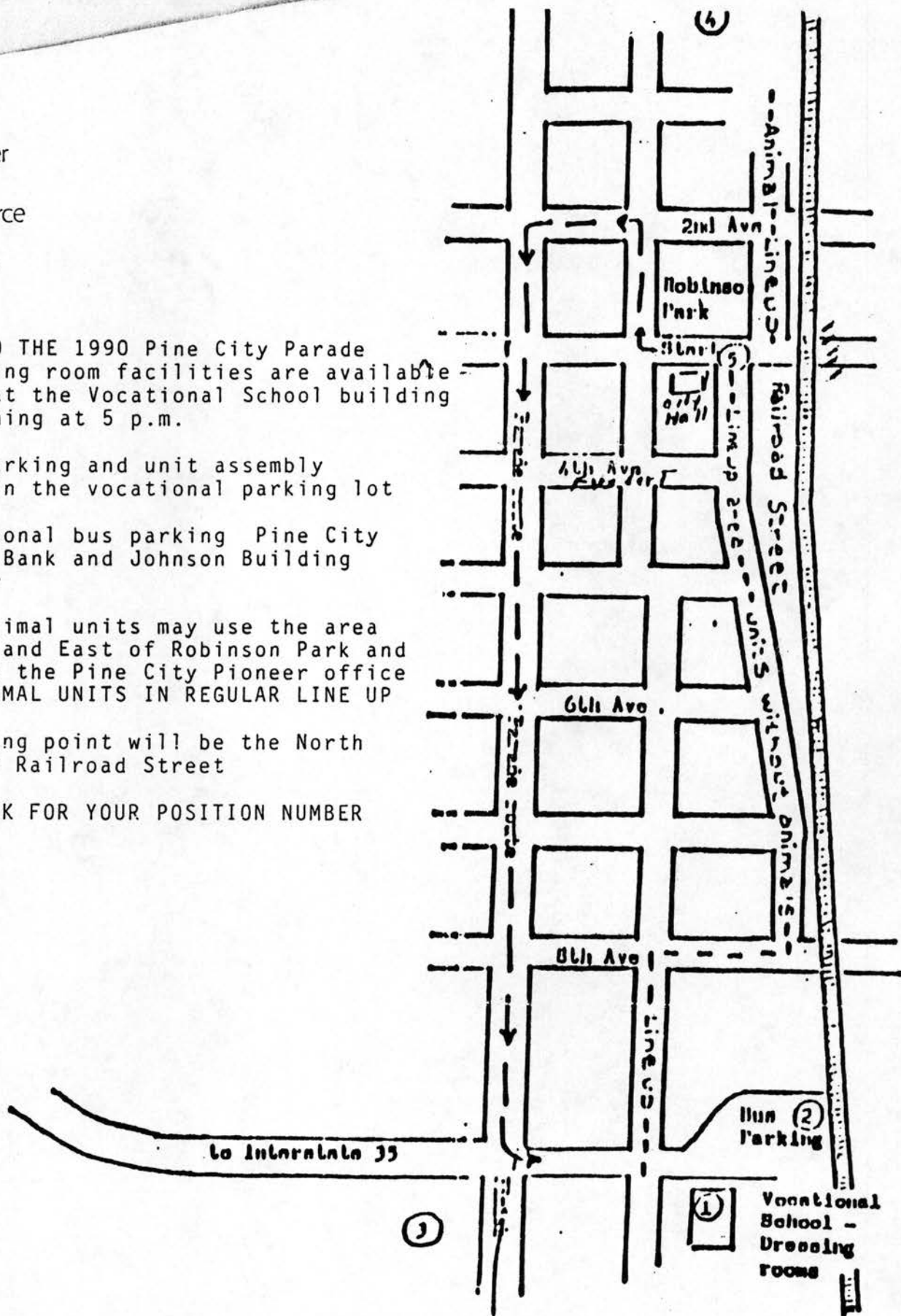



615 W. 3RD AVE.  
PINE CITY, MN 55063  
612-629-3861

444 6215

July 16, 1990  
PINE COUNTY FAIR PARADE

Dear Parade Participant:

We are pleased to have you participate in the 1990 Pine County Parade on Saturday evening August 4, at 7:00 p.m.

You have been assigned parade number 59A

We suggest you be in position approximately 45 minutes before parade time.

We are not obligated to let any unit participate that has not pre-registered and been confirmed by us. We have the right to refuse units that in the director's opinion could be dangerous or annoying in the parade route.

DO TO THE SAFETY FACTOR OF CHILDREN, THERE WILL BE NO THROWING OF CANDY, GUM, ETC. FROM THE UNITS ALONG THE PARADE ROUTE. YOU MAY HAND OUT ITEMS DIRECTLY TO THE CHILDREN.

Your cooperation in following the parade rules and maintaining a safe distance between units will be appreciated.

The local vocational college will be open at 5:00 p.m. for any necessary apparel changes. Bus parking is available there, as well as in the parking lots of the Pine City State Bank and Johnson Building Center. Units requiring assembly space may use the vocational college parking lot.

ATTENTION ANIMAL UNITS\*\*\*\*\*

Any Animal units must provide their own clean up crew. If you do not have clean up, YOU WILL NOT be allowed in the parade. Also-- ALL ANIMAL UNITS must line up in their special area which is just East of Robinson park. You will be admitted into the line up in your correct order from that position. NO Animal units in regular parade line up.

You will not receive any further information unless specifically requested. We are looking forward to having you with us and hope your visit will be enjoyable.

Sincerely,

Pine City Area Chamber of Commerce  
612-629-3861



GOVERNOR / LT. GOVERNOR

P.O. Box 1990, Pioneer Station, St. Paul, MN 55101

(612) 649-3636

SATURDAY, AUGUST 11, 1990

Emily Anne's Schedule

- 10:30 am Meet volunteers at campaign to go to Chatfield.  
12:30 pm Line-up begins. Work crowd!  
1:30 pm Parade begins. See attached for details.

Volunteers

Jill Flanders  
Sheila O'Connell  
Kathleen Maloney

- 5:30 pm Meet at campaign to go to Princeton for Mille Lacs Co. Fair.

- 7:00 pm to Meet Del Blomberg at Fair gates. Work crowd at  
9:00 pm Hatch/Staples table.

Directions: Take 169 North to downtown Princeton.  
In Princeton, take first lights to 14th. Take a  
right on 14th to fairgrounds. Del Blomberg will  
meet you at gate.

Volunteers

JoHanna Hawthorne  
Sheila O'Connell  
Lillian Schultz - Fairgrounds  
Del Blomberg - Fairgrounds  
Dana Kramer - Fairgrounds







# Western Days Inc.

Chatfield, Minnesota 55923



*Hatch for Governor*

July 25, 1990

Greetings!

The 23rd annual Chatfield Western Days celebration is fastly drawing near. This years celebration will prove to be one of the best in Western Days history. Thank you for contributing to this success.

This years parade line up has been established and we are happy that you are participating. Your parade event number is 163. This number will determine where you line up on Saturday also. You will line up on Alley off Division East Fillmore Street. The enclosed map identifies the line up area. Please take a few minutes and locate your number on the enlarged map on the back side.

Please note the parade headquarters located on the corner of Fillmore and Grove Streets. If you need information on parade day, check there or look for the parade coordinators wearing the red chest plates and the black hats.

For those who need dressing rooms, the Chatfield Elementary School will be available for your use. Please use the entrance on Main Street (Hwy 52 and 4th Street). There will be directions at the school to follow or contact Jim Wegnan.

The parade starts at 1:30 P.M. <sup>8-11-90</sup> Please line up by 1:00 P.M. The parade route goes down Main Street from Spring Street to 7th Street.

If you are throwing candy or other items from you unit, please throw them far enough to prevent children (and adults) from having to run into the street. We appreciate you helping to uphold our good safety record.

Please make an effort to maintain close and even spacing between you and the unit in front of you. Our lengthy parade becomes much more enjoyable for all of us.

Horse units will need to load and unload in the Mill Creek Park. Please keep the horses off the softball fields.

Finally, if you have questions or concerns, please contact any of us by phone:

Ken Hanson	(507)-867-4082 - (home)
	(507)-867-4150 - (work)
Gary Borgen	(507)-867-4540 - (home)
	(507)-867-4000 - (work)
Dan Hollermann	(507)-867-4995 - (home)
	(507)-867-4280 - (work)

Thanks for your continued support!



• • •

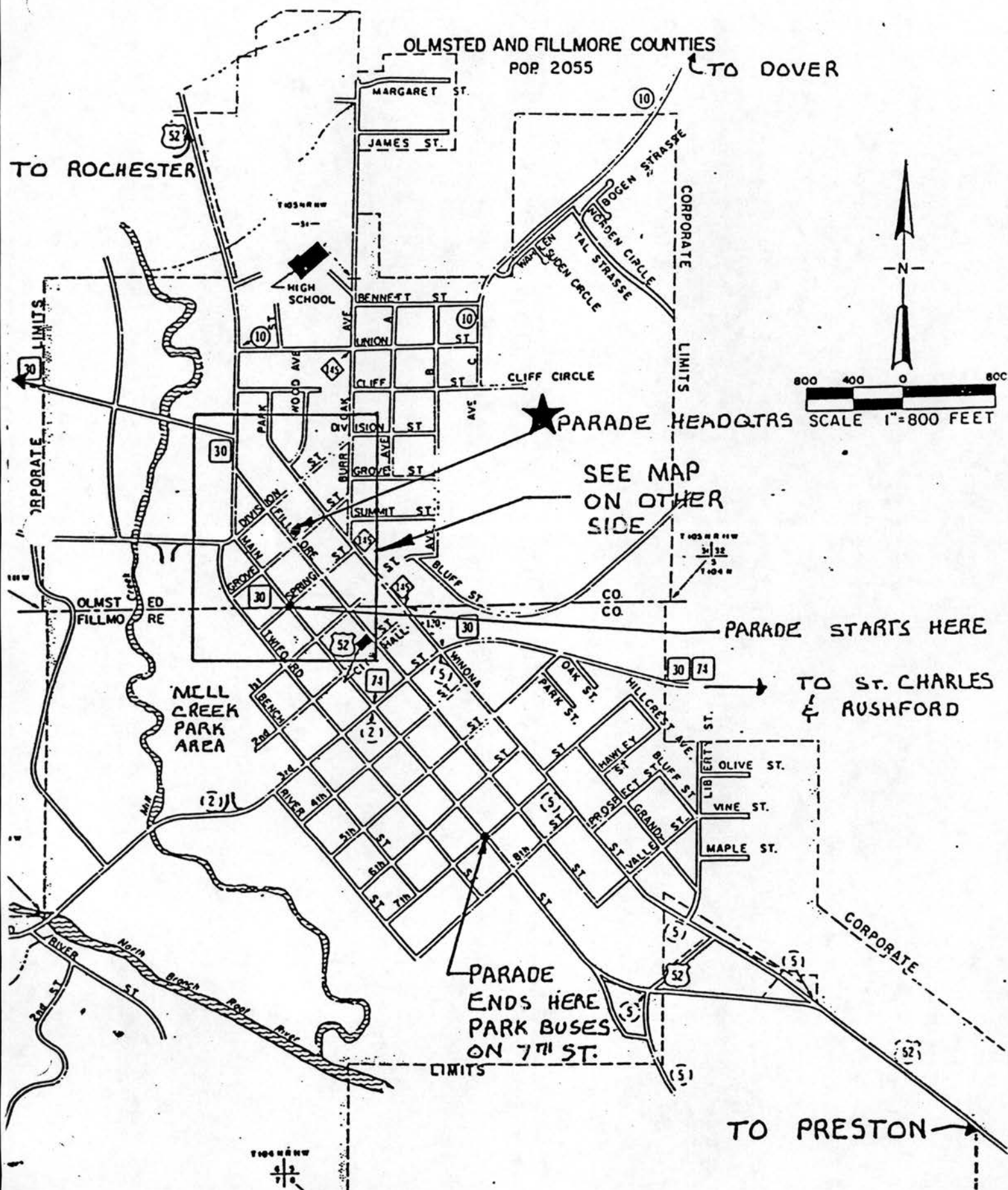



GOVERNOR / LT. GOVERNOR

P.O. Box 1990, Pioneer Station, St. Paul, MN 55101

(612) 649-3636

SUNDAY, AUGUST 12, 1990

Emily Anne's Schedule

11:45 am Meet volunteers at Billy's Lighthouse on Highway 12 just before getting into Long Lake.

12:15 pm Line-up begins. #19A on Willow Drive.

1:00 pm Parade begins.

Directions: Take Highway 12 West to the first yellow blinking light in Long Lake. At blinking light, turn left onto Willow Drive. Parade volunteers will direct you to spot #19A.

#### Volunteers

Jim Naiden  
Carla Heyl  
Larry Nash  
Gary Printup - will find you in parade  
Janet Kramer

4:00 pm Meet volunteers at campaign to go to Highland Fest.

4:15 pm to  
5:30 pm Work crowd at Highland Fest.

#### Volunteers

Lori Swanson  
JoHanna Hawthorne  
Carla Heyl  
Larry Nash  
Jane LeRoux





GOVERNOR / LT. GOVERNOR

P.O. Box 1990, Pioneer Station, St. Paul, MN 55101

(612) 649-3636

MONDAY, AUGUST 13, 1990

Emily Anne's Schedule

8:45 am

Arrive KSTP Radio Station, 2792 Maplewood Dr.

Directions: Take Highway 36 East to Highway 61 in Maplewood. Take 61 North approximately 1 mile to KSTP Station.

9:00 am to  
10:00 am

Live programming with Barbara Carlson on KSTP Talk Radio. Details arranged by Peter Thiel of KSTP.

1:30 pm

Literacy Task Force meeting.





GOVERNOR / LT. GOVERNOR

P.O. Box 1990, Pioneer Station, St. Paul, MN 55101

(612) 649-3636

SUNDAY, SEPTEMBER 9, 1990

Emily Anne's Schedule

- 12:30 pm Meet volunteers in front of bank at Colonial Square parking lot at SW Corner of highways 101 and 12 (near Perkins on 101).
- 1:00 pm Line-up begins for James J. Hill Days parade. Line-up #12 in Wayzata Bay Center parking lot off of Superior Blvd. See attached map.
- 2:00 pm Parade begins.
- until 5:00 pm United Way's Affair of the Heart, Minnehaha Park (if there's time, try to stop by to work the crowd)

Volunteers

Jill Flanders  
Sheila O'Connell  
Mary Kaul - at line-up spot with car  
Bea Ludens  
Mike Fratto - tent.







Greater Wayzata Chamber of Commerce

402 E. Lake Street, Wayzata, MN. 55391

August 30, 1990

Dear *Mike Hatch*

We are pleased and excited to have you as part of this year's "SAIL INTO THE 90's" James J. Hill Days parade on Sunday, September 9, 1990!

The parade unit line up area will be located in the Wayzata Bay Center parking lot. A map showing the entrances and parking lot is enclosed. PLEASE PLAN TO ARRIVE BETWEEN 12:30 AND 1:00 P.M. The parade will begin at 2:00 p.m., sharp. Spaces will be assigned and marked in the parking lot.

Your entry number is listed below and will determine your place in the parade and the line up space that is assigned to you.

YOUR ENTRY NUMBER IS *12*

When you arrive, please enter through the entrance circled. Check in at the information truck located there. Volunteers will be on hand to assist you in locating your correct line up space.

We have also enclosed a copy of the parade route. You will exit the south side of the shopping center, proceed west on Lake Street, north on Barry Avenue, ending at the Park & Ride lot on Old Highway 12.

For safety reasons, we absolutely insist that no parade participants throw candy or any other items to the crowd. You may have someone in the crowd handing items out if you wish.

Please call either Joanie Holst, 544-9667, or Wes Wolff, 473-4296, if you have any questions, problems or find that you will not be able to participate.

Have a great time and we will see you on the 9th!

Sincerely,

*Joanie Holst*

1990 Parade Coordinators  
Joanie Holst  
Wes Wolff

(612)473-9595



JAMES J. HILL PARADE

Sept. 9, 1990

Parts of Bay Center

lot to be blocked off

from 8:00 a.m. to 2:00 p.m.

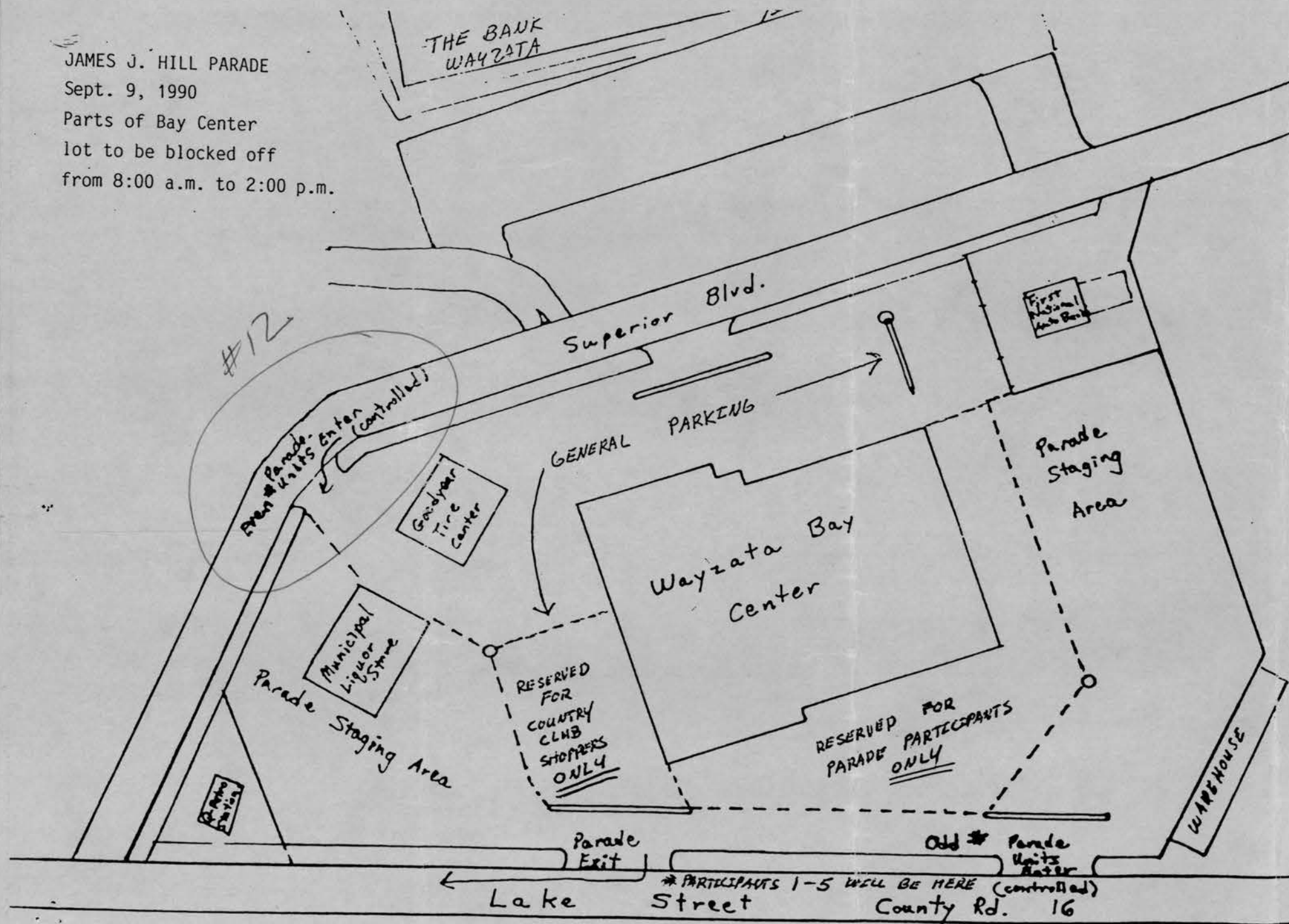

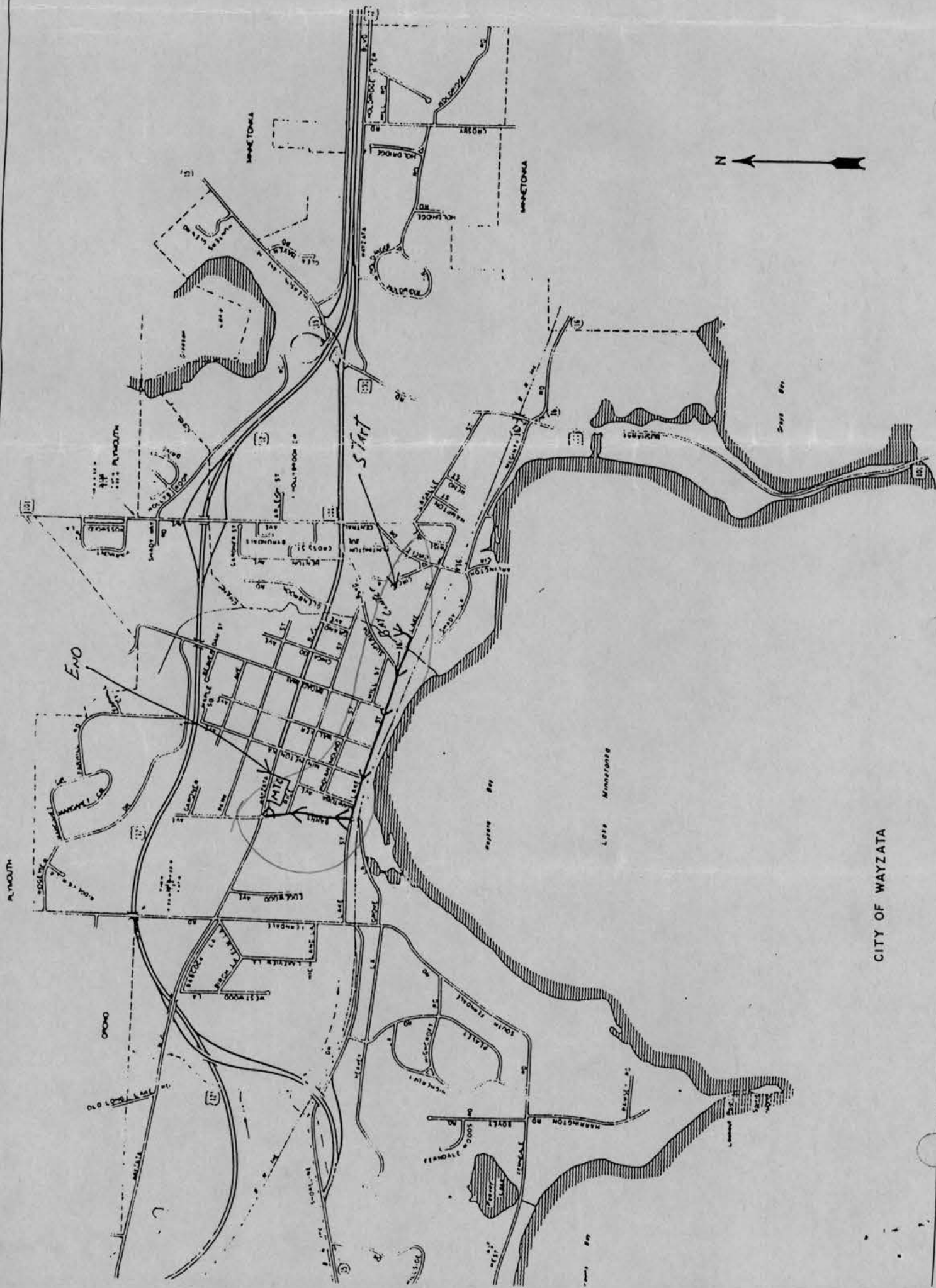

CITY OF WAYZATA



GOVERNOR / LT. GOVERNOR

P.O. Box 1990, Pioneer Station, St. Paul, MN 55101

(612) 649-3636

MONDAY, SEPTEMBER 10, 1990

Mike and Emily Anne's Schedule

9:30 am	Metro News Conference on Health Care location uncertain at this time
11:00 am	Wheels up - Crystal
11:30 am	Arrive St. Cloud - news conference in airport
12:00 pm	Wheels up - St. Cloud
12:45 pm	Arrive Brainerd - news conference in airport
1:15 pm	Wheels up - Brainerd
2:00 pm	Arrive Bemidji - news conference in airport
2:30 pm	Wheels up - Bemidji
3:30 pm	Arrive Duluth - Sky Harbor Airport
3:45 pm	Duluth news conference in headquarters
departure <sup>time</sup>	tentative at this time

