



Housing and Redevelopment Authority
of the City of Saint Paul, Minnesota:
Redevelopment project files

Copyright Notice:

This material may be protected by copyright law
(U.S. Code, Title 17). Researchers are liable for any
infringement. For more information, visit
www.mnhs.org/copyright.

LOCATION MAP

EASTERN REDEVELOPMENT AREA

SAINT PAUL, MINNESOTA

Como Ave.

University Ave.
main existing intercity route

WESTERN REDEVELOPMENT AREA
360 housing units, commercial center,
park and school now in development

freeway westbound

CIRCUMFERENTIAL
DISTRIBUTOR ROUTE
now under construction

area scale:
4 acres



HOUSING AND REDEVELOPMENT AUTHORITY

1745 CITY HALL AND COURT HOUSE, SAINT PAUL 2, MINN.

0 1000 2000 FEET

completed 10-29-57 so official revisions code file

PARK future school site

STATE CAPITOL CENTER
3 major new buildings
now under construction

freeway southbound

CENTRAL BUSINESS DISTRICT

14th St.

Robert St.

Jackson St.

Mississippi St.

INTERSTATE FREEWAY
now under construction

MT. AIRY HOMES
458 housing units
now under construction

EASTERN
REDEVELOPMENT
AREA
about 40 acres ready
for private development

freeway eastbound

Kellogg Blvd.

Shepard Rd.

MISSISSIPPI
RIVER

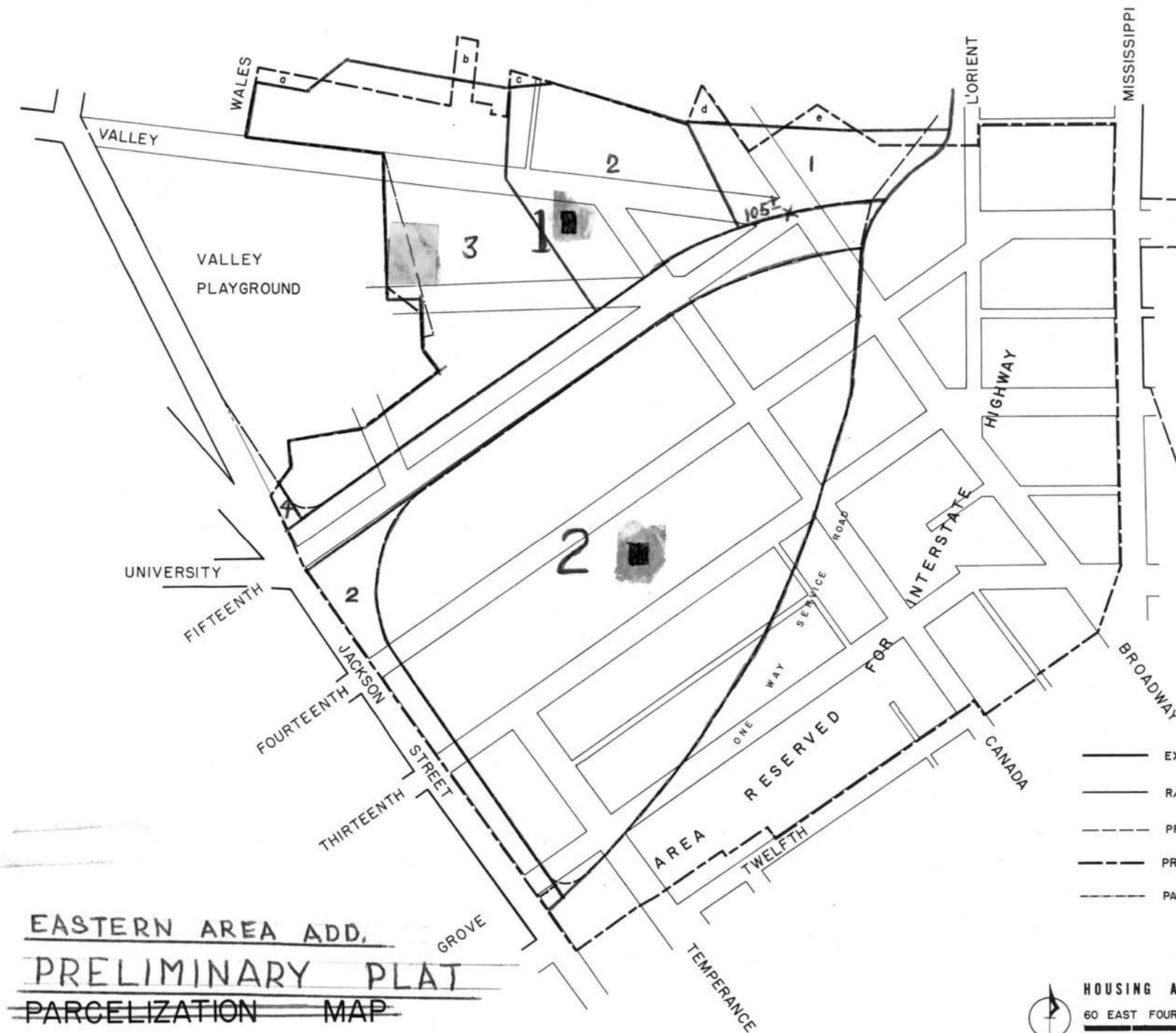

KEY

PROPOSED PARCELIZATION

PARCELS	PROPOSED LAND USE
1 18.24 ACRES	ANCKER HOSPITAL
2 9.32 ACRES	SCHOOL & PARK
3 .36 ACRES	PLAYGROUND

AREAS a, b, c, d, e TOTALING .42 ACRES
WILL BE SOLD TO THE MT. AIRY PUBLIC
HOUSING PROJECT.

AREA RESERVED FOR INTERSTATE
HIGHWAY TOTALS 20.7 ACRES

- EXISTING R/W LINES TO REMAIN
- R/W LINES VACATED OR TO BE VACATED
- - - PROPOSED NEW R/W LINES
- - - PROJECT BOUNDARY
- - - PARCEL BOUNDARIES

**EASTERN AREA ADD.
PRELIMINARY PLAT
PARCELIZATION MAP**