



[Crystal \(Minn.\).](#)  
[City Council Minutes and Agenda Packets.](#)

## **Copyright Notice:**

This material may be protected by copyright law (U.S. Code, Title 17). Researchers are liable for any infringement. For more information, visit [www.mnhs.org/copyright](http://www.mnhs.org/copyright).

## SPECIAL WORK SESSION/COUNCIL AGENDA

September 13, 1990

Pursuant to due call and notice given in the manner prescribed by Section 3.01 of the City Charter, the Special Meeting of the Crystal City Council was held on September 13, 1990, at 7:00 P.M., at 4141 Douglas Drive, Crystal, Minnesota.

The Secretary of the Council called the roll and the following were present:

### Councilmembers

P Carlson  
P Moravec 7:02 p.m.  
P Irving  
P Grimes  
P Herbes  
P Langsdorf 7:12 p.m.  
A Joselyn

### Staff

P Dulgar  
A Olson  
A Kennedy  
P Monk  
A Barber  
P George

The Mayor led the Council and the audience in the Pledge of Allegiance to the Flag.

1. The City Council continued consideration curb opening permits for a proposed bank building at 7009 - 56th Avenue North (building being located in New Hope; two access points on Louisiana Avenue which is a Crystal street). *Those appearing and heard were:*

*Jerry Charomanski, proponent  
Patly and Kevin Long, 5336 Louisiana  
Craig Kraft, 5513 Louisiana  
Estella Filkins, 5342 Louisiana  
Ann Erasku, 5507 Louisiana  
Jane and Gene Commers, 5518 Louisiana  
Reinold Hamm, 5425 Louisiana  
Mark Prince, 5407 Louisiana  
Eileen and Mike Doherty, 5337 Kentucky  
James Mourning, Maryland Avenue (did not state complete address)  
Stax Twedt, 5437 Louisiana  
Barbara Commers, 5506 Louisiana*

Moved by Councilmember M and seconded by Councilmember L to (approve), (deny), (continue until \_\_\_\_\_ the discussion of) curb opening permits for the proposed bank building at 7009 - 56th Avenue North. with conditions set forth by the Public Works director and contingent upon the City of New Hope rezoning the property, as follows:

1. Curb cuts at the North and South ends of the site.
2. Curb cuts permitted exclusively for use as part of the bank proposal as detailed on site plan dated 6-28-90.
3. Improvements to be constructed with the curb cut include concrete curb installation along the entire Louisiana Avenue frontage. Further, the owner shall commit to remove said curb cut upon the discontinuance of the bank use.
4. Establishment of no parking zones along the commercial frontage on Louisiana Avenue in both Crystal and New Hope.

Moved by Councilmember Grimes to amend the motion to include one single full access curb cut to be located in the center of the site. Councilmembers Morales and Langedorf accepted the amendment, in lieu of 2 curb cuts.

On the main motion:

Aye: C, M, & L

No: I, H

Absent: J

Motion Carried.

Moved by Councilmember \_\_\_\_\_ and seconded by Councilmember \_\_\_\_\_ to adjourn the meeting.

Motion Carried.

Meeting adjourned at 8:45 p.m.



**CITY of CRYSTAL**

4141 Douglas Drive North • Crystal, MN 55422-1696 • 537-8421

ADMINISTRATIVE OFFICE

September 5, 1990

Dear Crystal Resident:

The City has received a site plan detailing construction of a bank at 7009 - 56th Avenue North (old Burger King site). Although the parcel is actually in New Hope, two access points are shown on Louisiana Avenue North which is a Crystal street. These curb cuts raise traffic pattern questions similar to those discussed as part of the previous fast food land use.

While the City was initially receptive to the proposal and views the bank as an improvement to fast food or other automotive uses, the City Council is interested in soliciting comments from nearby residents along Louisiana Avenue. A meeting has been scheduled for Thursday, September 13, at 7:00 p.m. in the City Hall Council Chambers, 4141 Douglas Drive, to discuss the proposal more fully. You are invited to attend.

An area map and site plan are attached to allow you to review the proposal prior to the meeting.

Sincerely,

William Monk  
Crystal Public Works Director

WM:jrs

Encl

cc: Mayor & Council  
Jerry Dulgar  
Jerry Choromanski



5419 LOUISIANA AVE N  
CRYSTAL MN 55428

DEBRA B. SWEZEY  
5413 LOUISIANA AVE N  
CRYSTAL MN 55428

MONA L. PRINCE  
5407 LOUISIANA AVE N  
CRYSTAL MN 55428

05-118-21-34-0043  
BETTY JEAN WALTENBERG  
5401 LOUISIANA AVE N  
CRYSTAL MN 55428

05-118-21-43-0006  
ARLENE K. ANDREASEN  
5524 LOUISIANA AVE N  
CRYSTAL MN 55428

05-118-21-43-0007  
EUGENE L. COMMERS  
JANE A. COMMERS  
5518 LOUISIANA AVE N  
CRYSTAL MN 55428

05-118-21-43-0008  
GARY E. DAMBORG  
DEBORA M. DAMBORG  
5512 LOUISIANA AVE N  
CRYSTAL MN 55428

05-118-21-43-0009  
BARBARA A. COMMERS  
5506 LOUISIANA AVE N  
CRYSTAL MN 55428

05-118-21-43-0010  
JOHN D. MC CLELLAN  
JUDITH MC CLELLAN  
5500 LOUISIANA AVE N  
CRYSTAL MN 55428

05-118-21-43-0011  
ARVID R. ANDERSON  
CARMEN D. ANDERSON  
5442 LOUISIANA AVE N  
CRYSTAL MN 55428

05-118-21-43-0012  
RICHARD C. LUNDEN  
IRENE LUNDEN  
5436 LOUISIANA AVE N  
CRYSTAL MN 55428

05-118-21-43-0013  
SCOTT R. FAHEY  
5430 LOUISIANA AVE N  
CRYSTAL MN 55428

05-118-21-43-0014  
BARBARA J. SNETSINGER  
5424 LOUISIANA AVE N  
CRYSTAL MN 55428

05-118-21-43-0015  
FRED R. LEXCEN  
ESTELLE B. LEXCEN  
5418 LOUISIANA AVE N  
CRYSTAL MN 55428

05-118-21-43-0016  
MARY M. PURCELL  
5412 LOUISIANA AVE N  
CRYSTAL MN 55428

05-118-21-43-0017  
GLORIA J. KUBLY  
5406 LOUISIANA AVE N  
CRYSTAL MN 55428

05-118-21-43-0018  
MARK E. ELMQUIST  
5400 LOUISIANA AVE N  
CRYSTAL MN 55428

Number of labels used: 26  
\*\*\* END OF REPORT \*\*\*  
\*\*\* END OF REPORT \*\*\*  
\*\*\* END OF REPORT \*\*\*  
\*\*\* END OF REPORT \*\*\*  
\*\*\* END OF REPORT \*\*\*  
\*\*\* END OF REPORT \*\*\*

Number of labels used: 26  
\*\*\* END OF REPORT \*\*\*  
\*\*\* END OF REPORT \*\*\*  
\*\*\* END OF REPORT \*\*\*  
\*\*\* END OF REPORT \*\*\*  
\*\*\* END OF REPORT \*\*\*  
\*\*\* END OF REPORT \*\*\*

Number of labels used: 26  
\*\*\* END OF REPORT \*\*\*  
\*\*\* END OF REPORT \*\*\*  
\*\*\* END OF REPORT \*\*\*  
\*\*\* END OF REPORT \*\*\*  
\*\*\* END OF REPORT \*\*\*  
\*\*\* END OF REPORT \*\*\*

XXXXXXXXXXXXXXXXXXXXXXXXXXXX  
XXXXXXXXXXXXXXXXXXXXXXXXXXXX  
XXXXXXXXXXXXXXXXXXXXXXXXXXXX  
XXXXXXXXXXXXXXXXXXXXXXXXXXXX  
XXXXXXXXXXXXXXXXXXXXXXXXXXXX  
XXXXXXXXXXXXXXXXXXXXXXXXXXXX  
XXXXXXXXXXXXXXXXXXXXXXXXXXXX  
XXXXXXXXXXXXXXXXXXXXXXXXXXXX

XXXXXXXXXXXXXXXXXXXXXXXXXXXX  
XXXXXXXXXXXXXXXXXXXXXXXXXXXX  
XXXXXXXXXXXXXXXXXXXXXXXXXXXX  
XXXXXXXXXXXXXXXXXXXXXXXXXXXX  
XXXXXXXXXXXXXXXXXXXXXXXXXXXX  
XXXXXXXXXXXXXXXXXXXXXXXXXXXX  
XXXXXXXXXXXXXXXXXXXXXXXXXXXX  
XXXXXXXXXXXXXXXXXXXXXXXXXXXX

XXXXXXXXXXXXXXXXXXXXXXXXXXXX  
XXXXXXXXXXXXXXXXXXXXXXXXXXXX  
XXXXXXXXXXXXXXXXXXXXXXXXXXXX  
XXXXXXXXXXXXXXXXXXXXXXXXXXXX  
XXXXXXXXXXXXXXXXXXXXXXXXXXXX  
XXXXXXXXXXXXXXXXXXXXXXXXXXXX  
XXXXXXXXXXXXXXXXXXXXXXXXXXXX  
XXXXXXXXXXXXXXXXXXXXXXXXXXXX

XXXXXXXXXXXXXXXXXXXXXXXXXXXX  
XXXXXXXXXXXXXXXXXXXXXXXXXXXX  
XXXXXXXXXXXXXXXXXXXXXXXXXXXX  
XXXXXXXXXXXXXXXXXXXXXXXXXXXX  
XXXXXXXXXXXXXXXXXXXXXXXXXXXX  
XXXXXXXXXXXXXXXXXXXXXXXXXXXX  
XXXXXXXXXXXXXXXXXXXXXXXXXXXX  
XXXXXXXXXXXXXXXXXXXXXXXXXXXX

XXXXXXXXXXXXXXXXXXXXXXXXXXXX  
XXXXXXXXXXXXXXXXXXXXXXXXXXXX  
XXXXXXXXXXXXXXXXXXXXXXXXXXXX  
XXXXXXXXXXXXXXXXXXXXXXXXXXXX  
XXXXXXXXXXXXXXXXXXXXXXXXXXXX  
XXXXXXXXXXXXXXXXXXXXXXXXXXXX  
XXXXXXXXXXXXXXXXXXXXXXXXXXXX  
XXXXXXXXXXXXXXXXXXXXXXXXXXXX

XXXXXXXXXXXXXXXXXXXXXXXXXXXX  
XXXXXXXXXXXXXXXXXXXXXXXXXXXX  
XXXXXXXXXXXXXXXXXXXXXXXXXXXX  
XXXXXXXXXXXXXXXXXXXXXXXXXXXX  
XXXXXXXXXXXXXXXXXXXXXXXXXXXX  
XXXXXXXXXXXXXXXXXXXXXXXXXXXX  
XXXXXXXXXXXXXXXXXXXXXXXXXXXX  
XXXXXXXXXXXXXXXXXXXXXXXXXXXX

XXXXXXXXXXXXXXXXXXXXXXXXXXXX  
XXXXXXXXXXXXXXXXXXXXXXXXXXXX  
XXXXXXXXXXXXXXXXXXXXXXXXXXXX  
XXXXXXXXXXXXXXXXXXXXXXXXXXXX  
XXXXXXXXXXXXXXXXXXXXXXXXXXXX  
XXXXXXXXXXXXXXXXXXXXXXXXXXXX  
XXXXXXXXXXXXXXXXXXXXXXXXXXXX  
XXXXXXXXXXXXXXXXXXXXXXXXXXXX

XXXXXXXXXXXXXXXXXXXXXXXXXXXX  
XXXXXXXXXXXXXXXXXXXXXXXXXXXX  
XXXXXXXXXXXXXXXXXXXXXXXXXXXX  
XXXXXXXXXXXXXXXXXXXXXXXXXXXX  
XXXXXXXXXXXXXXXXXXXXXXXXXXXX  
XXXXXXXXXXXXXXXXXXXXXXXXXXXX  
XXXXXXXXXXXXXXXXXXXXXXXXXXXX  
XXXXXXXXXXXXXXXXXXXXXXXXXXXX

XXXXXXXXXXXXXXXXXXXXXXXXXXXX  
XXXXXXXXXXXXXXXXXXXXXXXXXXXX  
XXXXXXXXXXXXXXXXXXXXXXXXXXXX  
XXXXXXXXXXXXXXXXXXXXXXXXXXXX  
XXXXXXXXXXXXXXXXXXXXXXXXXXXX  
XXXXXXXXXXXXXXXXXXXXXXXXXXXX  
XXXXXXXXXXXXXXXXXXXXXXXXXXXX  
XXXXXXXXXXXXXXXXXXXXXXXXXXXX

\*\*\*\*\*  
CRYSTAL  
CRYSTAL  
CRYSTAL  
CRYSTAL  
CRYSTAL  
\*\*\*\*\*

\*\*\*\*\*  
CRYSTAL  
CRYSTAL  
CRYSTAL  
CRYSTAL  
CRYSTAL  
\*\*\*\*\*

\*\*\*\*\*  
CRYSTAL  
CRYSTAL  
CRYSTAL  
CRYSTAL  
CRYSTAL  
\*\*\*\*\*

05-118-21-34-0031  
JAMES F. TOUSIGNANT  
5525 LOUISIANA AVE N  
CRYSTAL MN 55428

05-118-21-34-0032  
BRUCE P. DEBELE  
LINDA J. DEBELE  
5519 LOUISIANA AVE N  
CRYSTAL MN 55428

05-118-21-34-0033  
CRAIG J. KRAFT  
5513 LOUISIANA AVE N  
CRYSTAL MN 55428

05-118-21-34-0034  
BARBARA E. PATTERSON  
5507 LOUISIANA AVE N  
CRYSTAL MN 55428

05-118-21-34-0035  
MAE I. JUUL  
5501 LOUISIANA AVE N  
CRYSTAL MN 55428

05-118-21-34-0036  
GEORGE J. REED  
LORRAINE REED  
5443 LOUISIANA AVE N  
CRYSTAL MN 55428

05-118-21-34-0037  
STANLEY H. TVEDT  
BARBARA TVEDT  
5437 LOUISIANA AVE N  
CRYSTAL MN 55428

05-118-21-34-0038  
SCOTT C. GIERE  
TERRIE A. KANE  
5431 LOUISIANA AVE N  
CRYSTAL MN 55428

05-118-21-34-0039  
ALICE I. RAMM  
5425 LOUISIANA AVE N  
CRYSTAL MN 55428

05-118-21-34-0040  
SANDRA M. ARNLUND

05-118-21-34-0041  
BRUCE L. SWEZEY

05-118-21-34-0042  
MARK G. PRINCE

DATE: August 29, 1990  
TO: Jerry Dular, City Manager  
FROM: Bill Monk, City Engineer  
SUBJECT: Curb Cuts on Louisiana Avenue North at 56th Ave.

As noted in the attachments, a site plan has been received regarding a bank proposal for 7009 - 56th Avenue North (old Burger King site). Although the proposal is in New Hope, two access points are shown on Louisiana Avenue which is a Crystal street.

This same item was considered years back when Burger King was initially proposed. At that time, access permits were denied based on concerns related to traffic from the fast food establishment cutting through Crystal neighborhoods to the south. While the bank proposal does not create the heavy travel or nighttime usage situations encountered with fast food, some use of local streets is bound to occur. It should be noted that the gas station on the west side of Louisiana Avenue does have access to Louisiana and Bass Lake Road.

From a traffic movement perspective the proposed lay out eases the flow on-site as well as the access onto Bass Lake Road. Approval of the curb cuts will also allow Crystal to require curbing be constructed along Louisiana Avenue adjacent to the site as improvements are installed.

The question at this point is whether neighborhood input should be solicited as part of consideration of this item or whether enough data is available to approve the two curb cut permits. As noted in the attached letter, any approvals by Crystal would be conditioned upon New Hope's actions.

  
WM:jrs

Encls



# Full Service Travel<sup>®</sup>

August 28, 1990

Mr. William Monk  
City Engineer, City of Crystal  
4141 N. Douglas Dr.  
Crystal, MN 55422

Dear Bill:

As per our phone conversation on August 27th, I would like to request that the City of Crystal permit access from the Burger King property onto Louisiana Ave. as is indicated in the proposed bank site plan I've enclosed.

I would expect the approval to be conditional upon the City of New Hope rezoning the property to permit the use of the property as a branch bank.

If you have any questions please call me at 566-4408.

Sincerely,

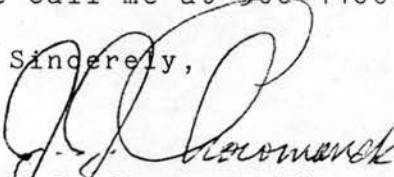
  
J.J. Choromanski

## Crystal

137 Willow Bend  
Crystal Shopping Center  
Crystal, Minnesota 55428  
Phone: 612/535-1731  
FAX: 612/533-0090

## Brooklyn Park

7827 Brooklyn Boulevard  
Brooklyn Park, Minnesota 55445  
Phone: 612/566-9480  
FAX: 612/566-1376

## Maple Grove

13716 83rd Way North  
Maple Grove, Minnesota 55369  
Phone: 612/420-6666  
FAX: 612/420-7621



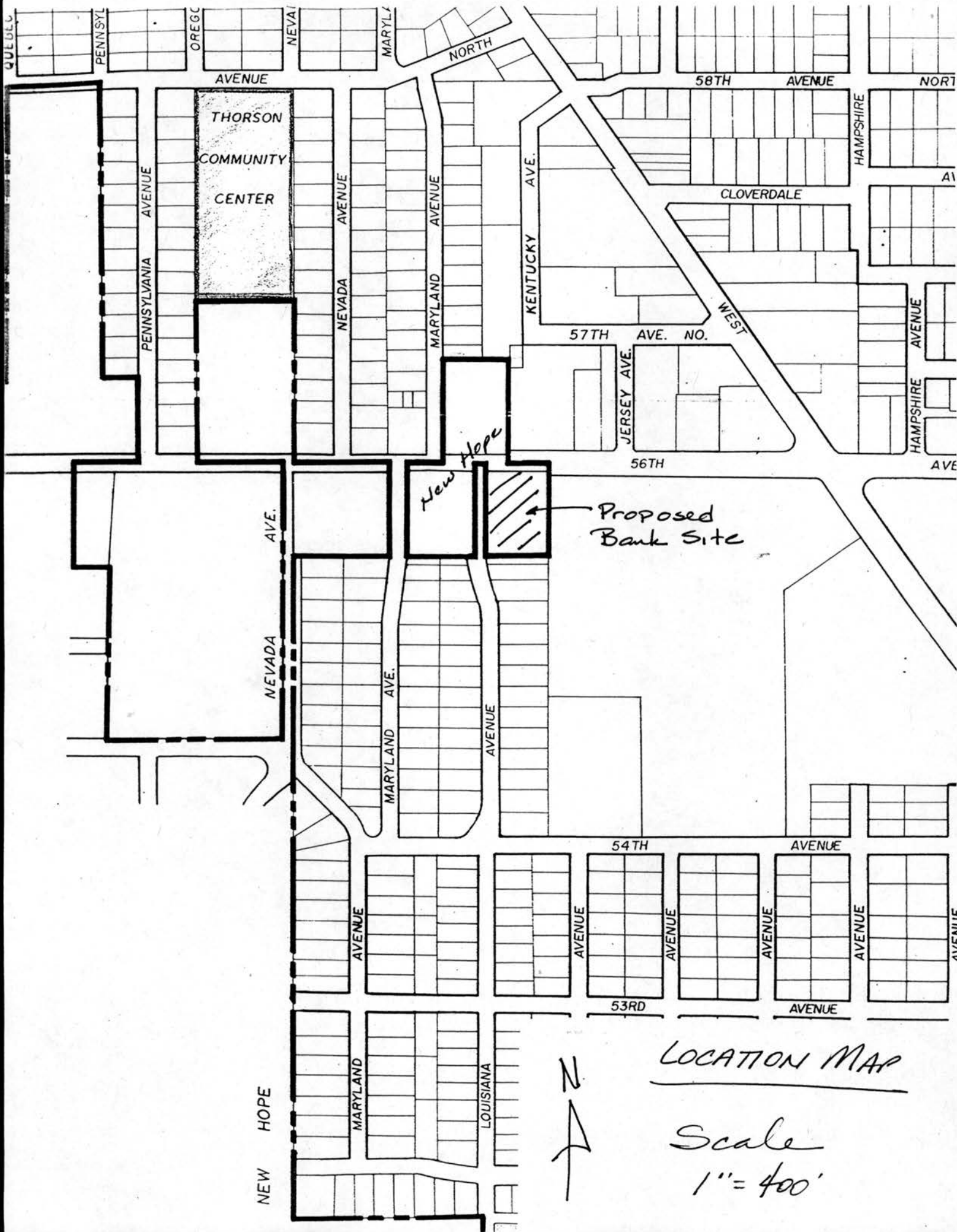

This is a detailed street map of the City of New Hope. The map shows a grid of streets with various names and numbers. A handwritten note "Proposed Bank Site" with an arrow points to a specific lot on the map. The map includes labels for "CITY OF NEW HOPE", "NEVADA AVENUE", "FOREST L. SCHOOL", and "CRYSTAL AIRPORT". The map also shows several parks and a school. The streets are labeled with names like "Kentucky Ave", "57th Ave", "56th Ave", "55th Ave", "54th Ave", "53rd Ave", "52nd Ave", "51st Ave", "50th Ave", "49th Ave", "48th Ave", "47th Ave", "46th Ave", "45th Ave", "44th Ave", "43rd Ave", "42nd Ave", "41st Ave", "40th Ave", "39th Ave", "38th Ave", "37th Ave", "36th Ave", "35th Ave", "34th Ave", "33rd Ave", "32nd Ave", "31st Ave", "30th Ave", "29th Ave", "28th Ave", "27th Ave", "26th Ave", "25th Ave", "24th Ave", "23rd Ave", "22nd Ave", "21st Ave", "20th Ave", "19th Ave", "18th Ave", "17th Ave", "16th Ave", "15th Ave", "14th Ave", "13th Ave", "12th Ave", "11th Ave", "10th Ave", "9th Ave", "8th Ave", "7th Ave", "6th Ave", "5th Ave", "4th Ave", "3rd Ave", "2nd Ave", "1st Ave". The map also shows several parks and a school. The streets are labeled with names like "Kentucky Ave", "57th Ave", "56th Ave", "55th Ave", "54th Ave", "53rd Ave", "52nd Ave", "51st Ave", "50th Ave", "49th Ave", "48th Ave", "47th Ave", "46th Ave", "45th Ave", "44th Ave", "43rd Ave", "42nd Ave", "41st Ave", "40th Ave", "39th Ave", "38th Ave", "37th Ave", "36th Ave", "35th Ave", "34th Ave", "33rd Ave", "32nd Ave", "31st Ave", "30th Ave", "29th Ave", "28th Ave", "27th Ave", "26th Ave", "25th Ave", "24th Ave", "23rd Ave", "22nd Ave", "21st Ave", "20th Ave", "19th Ave", "18th Ave", "17th Ave", "16th Ave", "15th Ave", "14th Ave", "13th Ave", "12th Ave", "11th Ave", "10th Ave", "9th Ave", "8th Ave", "7th Ave", "6th Ave", "5th Ave", "4th Ave", "3rd Ave", "2nd Ave", "1st Ave".

UD.

## ADDITION

4  
R  
6  
B

SCHOOL  
IND. DISTRICT 281

No. 226

PART OF LOT 32

AUD. SUB'D.

CITY OF CRYSTAL  
CITY OF NEW HOPE

LANE

2  
MURRAY

NEVADA AVE.

## ADDITION

4th

4  
5  
6  
7  
8  
9  
10  
11  
12  
13  
14  
15  
16  
17  
18  
19  
20  
21  
22  
23  
24  
25  
26  
27  
28  
29  
30  
31  
32  
33  
34  
35  
36  
37  
38  
39  
40  
41  
42  
43  
44  
45  
46  
47  
48  
49  
50  
51  
52  
53  
54  
55  
56  
57  
58  
59  
60  
61  
62  
63  
64  
65  
66  
67  
68  
69  
70  
71  
72  
73  
74  
75  
76  
77  
78  
79  
80  
81  
82  
83  
84  
85  
86  
87  
88  
89  
90  
91  
92  
93  
94  
95  
96  
97  
98  
99  
100

MURRAY LANE

MARYLAND AVE.

# ADDITION

# SIXTH

HOLMQUIST

PALMER, ADD.

KENTUCKY - AVE

SALSBER  
3RD  
ADD.

KUBINSKI  
AND  
PALMER AD  
337.95

CRYSTAL  
STATE  
BANK  
ADD.

**SUB'D.**

PART OF LOT 41

**No.**  
**CITY OF NEW HOPE**

NEW HOPE NEVADA 3<sup>rd</sup> AVE.  
CRYSTAL

MARYLAND	4:11'41"29"	4:512.44	AVE.
	1590.17	4:11'26"18"	

2019  
2020  
2021  
2022  
2023  
2024  
2025  
2026  
2027  
2028  
2029  
2030  
2031  
2032  
2033  
2034  
2035  
2036  
2037  
2038  
2039  
2040  
2041  
2042  
2043  
2044  
2045  
2046  
2047  
2048  
2049  
2050  
2051  
2052  
2053  
2054  
2055  
2056  
2057  
2058  
2059  
2060  
2061  
2062  
2063  
2064  
2065  
2066  
2067  
2068  
2069  
2070  
2071  
2072  
2073  
2074  
2075  
2076  
2077  
2078  
2079  
2080  
2081  
2082  
2083  
2084  
2085  
2086  
2087  
2088  
2089  
2090  
2091  
2092  
2093  
2094  
2095  
2096  
2097  
2098  
2099  
2100  
2101  
2102  
2103  
2104  
2105  
2106  
2107  
2108  
2109  
2110  
2111  
2112  
2113  
2114  
2115  
2116  
2117  
2118  
2119  
2120  
2121  
2122  
2123  
2124  
2125  
2126  
2127  
2128  
2129  
2130  
2131  
2132  
2133  
2134  
2135  
2136  
2137  
2138  
2139  
2140  
2141  
2142  
2143  
2144  
2145  
2146  
2147  
2148  
2149  
2150  
2151  
2152  
2153  
2154  
2155  
2156  
2157  
2158  
2159  
2160  
2161  
2162  
2163  
2164  
2165  
2166  
2167  
2168  
2169  
2170  
2171  
2172  
2173  
2174  
2175  
2176  
2177  
2178  
2179  
2180  
2181  
2182  
2183  
2184  
2185  
2186  
2187  
2188  
2189  
2190  
2191  
2192  
2193  
2194  
2195  
2196  
2197  
2198  
2199  
2200  
2201  
2202  
2203  
2204  
2205  
2206  
2207  
2208  
2209  
2210  
2211  
2212  
2213  
2214  
2215  
2216  
2217  
2218  
2219  
2220  
2221  
2222  
2223  
2224  
2225  
2226  
2227  
2228  
2229  
2230  
2231  
2232  
2233  
2234  
2235  
2236  
2237  
2238  
2239  
2240  
2241  
2242  
2243  
2244  
2245  
2246  
2247  
2248  
2249  
2250  
2251  
2252  
2253  
2254  
2255  
2256  
2257  
2258  
2259  
2260  
2261  
2262  
2263  
2264  
2265  
2266  
2267  
2268  
2269  
2270  
2271  
2272  
2273  
2274  
2275  
2276  
2277  
2278  
2279  
2280  
2281  
2282  
2283  
2284  
2285  
2286  
2287  
2288  
2289  
2290  
2291  
2292  
2293  
2294  
2295  
2296  
2297  
2298  
2299  
2300  
2301  
2302  
2303  
2304  
2305  
2306  
2307  
2308  
2309  
2310  
2311  
2312  
2313  
2314  
2315  
2316  
2317  
2318  
2319  
2320  
2321  
2322  
2323  
2324  
2325  
2326  
2327  
2328  
2329  
2330  
2331  
2332  
2333  
2334  
2335  
2336  
2337  
2338  
2339  
2340  
2341  
2342  
2343  
2344  
2345  
2346  
2347  
2348  
2349  
2350  
2351  
2352  
2353  
2354  
2355  
2356  
2357  
2358  
2359  
2360  
2361  
2362  
2363  
2364  
2365  
2366  
2367  
2368  
2369  
2370  
2371  
2372  
2373  
2374  
2375  
2376  
2377  
2378  
2379  
2380  
2381  
2382  
2383  
2384  
2385  
2386  
2387  
2388  
2389  
2390  
2391  
2392  
2393  
2394  
2395  
2396  
2397  
2398  
2399  
2400  
2401  
2402  
2403  
2404  
2405  
2406  
2407  
2408  
2409  
2410  
2411  
2412  
2413  
2414  
2415  
2416  
2417  
2418  
2419  
2420  
2421  
2422  
2423  
2424  
2425  
2426  
2427  
2428  
2429  
2430  
2431  
2432  
2433  
2434  
2435  
2436  
2437  
2438  
2439  
2440  
2441  
2442  
2443  
2444  
2445  
2446  
2447  
2448  
2449  
2450  
2451  
2452  
2453  
2454  
2455  
2456  
2457  
2458  
2459  
2460  
2461  
2462  
2463  
2464  
2465  
2466  
2467  
2468  
2469  
2470  
2471  
2472  
2473  
2474  
2475  
2476  
2477  
2478  
2479  
2480  
2481  
2482  
2483  
2484  
2485  
2486  
2487  
2488  
2489  
2490  
2491  
2492  
2493  
2494  
2495  
2496  
2497  
2498  
2499  
2500  
2501  
2502  
2503  
2504  
2505  
2506  
2507  
2508  
2509  
2510  
2511  
2512  
2513  
2514  
2515  
2516  
2517  
2518  
2519  
2520  
2521  
2522  
2523  
2524  
2525  
2526  
2527  
2528  
2529  
2530  
2531  
2532  
2533  
2534  
2535  
2536  
2537  
2538  
2539  
2540  
2541  
2542  
2543  
2544  
2545  
2546  
2547  
2548  
2549  
2550  
2551  
2552  
2553  
2554  
2555  
2556  
2557  
2558  
2559  
2560  
2561  
2562  
2563  
2564  
2565  
2566  
2567  
2568  
2569  
2570  
2571  
2572  
2573  
2574  
2575  
2576  
2577  
2578  
2579  
2580  
2581  
2582  
2583  
2584  
2585  
2586  
2587  
2588  
2589  
2590  
2591  
2592  
2593  
2594  
2595  
2596  
2597  
2598  
2599  
2600  
2601  
2602  
2603  
2604  
2605  
2606  
2607  
2608  
2609  
2610  
2611  
2612  
2613  
2614  
2615  
2616  
2617  
2618  
2619  
2620  
2621  
2622  
2623  
2624  
2625  
2626  
2627  
2628  
2629  
2630  
2631  
2632  
2633  
2634  
2635  
2636  
2637  
2638  
2639  
2640  
2641  
2642  
2643  
2644  
2645  
2646  
2647  
2648  
2649  
2650  
2651  
2652  
2653  
2654  
2655  
2656  
2657  
2658  
2659  
2660  
2661  
2662  
2663  
2664  
2665  
2666  
2667  
2668  
2669  
2670  
2671  
2672  
2673  
2674  
2675  
2676  
2677  
2678  
2679  
2680  
2681  
2682  
2683  
2684  
2685  
2686  
2687  
2688  
2689  
2690  
2691  
2692  
2693  
2694  
2695  
2696  
2697  
2698  
2699  
2700  
27

**ADDITION**

LOUISIANA

~~(Co.Rd.No.K~~

PART OF LOT 40

CITY OF CRYSTAL 61498



56<sup>TH</sup> AVENUE — BASS LAKE ROAD

LOUISIANA STREET

EXISTING CURB CUT

EXISTING CURB CUT

NEW CURB CUT

NEW CURB CUT

FUTURE PARKING

1 2 3 4

PROPOSED BANK SITE PLAN  
1" = 20'-0"

6-28-90

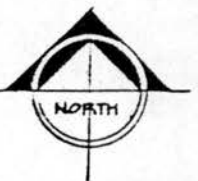

LOUISIANA

### Existing Conditions

11 September, 1990

Mr. William Monk  
Crystal Public Works Director  
City of Crystal  
4141 Douglas Drive North  
Crystal, Minnesota 55422-1696

Gentlemen:

We the people, Louisiana North, would like to know why we need another bank on Bass Lake Road, when Northwest has a main bank and also a drive-through. The issue is, we don't need the bank on a residential street where we live. The street is pretty calm now, therefore, we don't need more traffic on our street. There are new families who have moved in recently because of our quiet neighborhood and, we the people, object to building a bank on our block; it is not right. There are a lot of little children on this block now and to put a bank there would increase traffic a lot and endanger the life of these children and older residents on this block.

Also, who is going to pay for the need of road repair in the future if the bank is built. The bank should take care of our street repair for the increase of traffic. We certainly don't want a lot of traffic on the weekends and after hours during our own personal free time disrupting our lives.

Sincerely,

Residents of Louisiana North

*Mae June - 5501 Louisiana Ave No.*

<i>Paul Krup</i>	5513
<i>Ann Crank</i>	5507
<i>Judy McCallan</i>	5500
<i>George Reed</i>	5443 Louisiana Ave. No.
<i>Andrea Arnlund</i>	5419 " "
<i>Bob Ahrens</i>	5413 " "
<i>Gloria Kubly</i>	5406 " " "
<i>Mary McMurrell</i>	5412 " " "
<i>Fred Leppen</i>	5418
<i>Barbara Ammers</i>	5506 Louisiana Ave N.
<i>August L. Conner</i>	5518 Louisiana Ave N.
<i>Bruce Delele</i>	5519 LOUISIANA AVE N,
<i>Gene Jousignea</i>	5525 LOUISIANA ave NO.

Mr. & Mrs. Eugene Commers  
5518 Louisiana Avenue North  
Crystal, MN 55428

Paul + Gloria Lohmar  
5318 Louisiana Ave No.  
Crystal 55428

We are definitely opposed to the curb cut.  
We were not notified and cannot  
attend the meeting

Mr. & Mrs. Eugene Commers  
5518 Louisiana Avenue North  
Crystal, MN 55428

Jan Moller  
5307 Louisiana Ave NE

Opposed

Mr. & Mrs. Eugene Commers  
5518 Louisiana Avenue North  
Crystal, MN 55428

Jerry & Marie Doherty  
5401 Maryland Ave N.

We are definitely opposed to the  
curb cuts if for no other reason  
than the increased traffic. We are sorry  
that we are unable to attend the meeting because we were not  
notified!

**EUGENE L. COMMERS**

5518 Louisiana Avenue N.  
Crystal, MN 55428

Mr. & Mrs. Alvin Wittick  
5325 Louisiana Ave No.  
Crystal, Mn.

We are definitely not for  
Curt cuts!



*Deleone*

# COUNCIL AGENDA

September 18, 1990

Pursuant to due call and notice thereof, the Regular meeting of the Crystal City Council was held on September 18, 1990, at 7:00 P.M., at 4141 Douglas Drive, Crystal, Minnesota.

The Secretary of the Council called the roll and the following were present:

## Councilmembers

P Carlson

P Moravec

P Irving (*arrived at 8:43pm*)

P Grimes

P Herbes

P Langsdorf

P Joselyn

## Staff

P Dulgar

P Olson

P Kennedy

A Monk

P Barber

P George

The Mayor led the Council and the audience in the Pledge of Allegiance to the Flag.

1. The City Council considered the minutes of the Regular City Council meeting of September 4, 1990 and the Special City Council meeting of September 13, 1990.

Moved by Councilmember G and seconded by Councilmember J to (approve) (approve, making the following exceptions: \_\_\_\_\_

to) the minutes of the Regular City Council meeting of September 4, 1990 and the Special City Council meeting of September 13, 1990.

Motion Carried.

REGULAR AGENDA

1. The City Council considered an application for appointment to the Economic Development Authority Advisory Commission from Phillip L. Eder, 5630 Lakeland Avenue North, a Crystal business owner. *Phillip Eder appeared and was heard.*

Moved by Councilmember C and seconded by Councilmember G to appoint Phillip L. Eder (address) to the Economic Development Authority Advisory Commission for an unexpired term expiring December 31, 1991.

Motion Carried.

2. The City Council considered an itinerant food license application for "Meeting the Candidates", at Bassett Creek Park, on Saturday, September 15, 1990, sponsored by the Volunteers for Vi Underdahl for State Representative 46A as requested by Barbara Lind, 4109 Kentucky Circle.

Moved by Councilmember L and seconded by Councilmember C to (approve) (deny) (continue until \_\_\_\_\_ the discussion of) an itinerant food license for "Meeting the Candidates", at Bassett Creek Park, on Saturday, September 15, 1990, as requested by Barbara Lind, 4109 Kentucky Circle.

Motion Carried.

3. The City Council considered a request from VFW Post #494 to hold a brat and sauerkraut feed with beer in its parking lot at 5222 - 56th Avenue North.

Moved by Councilmember M and seconded by Councilmember G to (approve) (deny) (continue until \_\_\_\_\_ the discussion of) a request from VFW Post #494 to hold a brat and sauerkraut feed, extending limits relating to the on-sale license of the VFW Post #494, of the licensed premises to include the parking lot of VFW Post #494, 5222 - 56th Avenue North, for one day on September 30, 1990.

Motion Carried.

11. 4. <sup>Michael</sup>~~Mr. Mike~~ Erlichman, Chairman of the Regional Transit Board, appeared before the City Council to discuss Light Rail Transit.

*Councilmember Irving arrived (8:43 p.m.)*

- 4-5. The City Council considered a request for a building permit for a 40' x 50' airplane hangar on leased Lot 78C-1 as requested by Patrick Scharber.

*, Crystal Airport,*

Moved by Councilmember M and seconded by Councilmember L to (approve) (deny) (continue until \_\_\_\_\_ the discussion of) a building permit for a 40' x 50' airplane hangar on leased Lot 78C-1 as requested by Patrick Scharber, subject to standard procedure.)

*, Crystal Airport,*

Motion Carried.

- 5 6. The City Council considered a request from the Knights of Columbus for a parking variance of 54 spaces to build an addition at 4947 West Broadway.

*Don Chunilla, Knights of Columbus, appeared and was heard.*

Moved by Councilmember L and seconded by Councilmember M to (approve as recommended by and based on the findings of fact of the Planning Commission) (deny) (continue until \_\_\_\_\_ the discussion of) the authorization pursuant to Section 515.55 of the Crystal City Code to vary or modify the strict application of Section 515.09, Subd. 8 v) to grant a variance of 54 off-street parking spaces of the required 415 parking spaces at Knights of Columbus, 4947 West Broadway, as requested in Application #90-35.

Motion Carried.

- 6 7. The City Council considered a resolution for parking restrictions in the area of 42nd and Brunswick Avenues.

Moved by Councilmember C and seconded by Councilmember M to adopt the following resolution, the reading of which was dispensed with by unanimous consent:

RESOLUTION NO. 90-56

RESOLUTION RESTRICTING PARKING IN  
THE AREA OF 42ND AND BRUNSWICK AVENUES

By roll call and voting aye: C, M, G, H, L,  
J, \_\_\_\_\_; voting no: \_\_\_\_\_; absent, not  
voting: I, \_\_\_\_\_.

Motion carried, resolution declared adopted.

- 7 8. The City Council considered the Second Reading of an Ordinance restricting development on 36th Avenue and Highway 100.

Moved by Councilmember M and seconded by Councilmember C to adopt the following ordinance:

ORDINANCE NO. 90-20

CITY OF CRYSTAL

INTERIM ORDINANCE FOR THE PURPOSE OF  
PROTECTING THE PLANNING PROCESS AND HEALTH,  
SAFETY AND WELFARE OF THE RESIDENTS,  
AND RESTRICTING DEVELOPMENT WITHIN  
REDEVELOPMENT PROJECT NO. 2

and further, that this be the second and final reading.

Motion Carried.

- 8 9. The City Council considered the Second Reading of an Ordinance Amending the Lawful Gambling Ordinance to Conform With State Law.

Moved by Councilmember J and seconded by Councilmember M to adopt the following ordinance:

ORDINANCE NO. 90-21

AN ORDINANCE RELATING TO LAWFUL GAMBLING:  
AMENDING CRYSTAL CITY CODE BY ADDING A SECTION:  
REPEALING CRYSTAL CITY CODE SUBSECTION 1100.19

and further, that this be the second and final reading.

Motion Carried.



9. ~~10.~~ The City Council considered the First Reading of an Ordinance Amendment relating to the State Building Code.

Moved by Councilmember L and seconded by Councilmember J to adopt the following ordinance:

ORDINANCE NO. 90-

AN ORDINANCE RELATING TO CITY GOVERNMENT:  
AMENDING CRYSTAL CITY CODE, SUBSECTION 400.02,  
SUBDIVISION 2, CLAUSE A): SUBSECTION 115.01 AND  
SUBSECTION 100.07

and further, that the second and final reading be held on October 2, 1990.

Motion Carried.

10. ~~11.~~ The City Council considered a contract renewal with Metropolitan Clinic of Counseling - Employee Assistance Program - 9-1-90 through 8-31-91.

Moved by Councilmember G and seconded by Councilmember L to (approve) (deny) (continue until \_\_\_\_\_ the discussion of) contract renewal with Metropolitan Clinic of Counseling - Employee Assistance Program - 9-1-90 through 8-31-91, and further, that the Mayor and City Manager be authorized to sign such agreement.

Motion Carried.

OPEN FORUM

1. Nathan Sherry, 5301 Edgewood, appeared to discuss property at 5231 Douglas Drive, which he recently purchased.

INFORMAL DISCUSSION AND ANNOUNCEMENTS

1. Councilmember Joselyn opened discussion regarding the front of property at 6427-41<sup>st</sup> Ave. No. the City Council directed staff to proceed with legal action to correct problems (exposed gas pipe, hazardous embankment) in front of property.
2. Councilmember Joselyn opened discussion regarding a letter received by the Council from the law firm of Halnes and Graen regarding prosecution services for the City of Crystal. The City Council directed staff to proceed with Request For Proposals for prosecution services for the City of Crystal.

Joselyn - status of police contract approved by Council? Approved + signed today

Grimes - advised conversation w/ Vomhof of District 281 ~~Mr.~~ Thorson = possibly will be renting out (Montessori); will be painting windows.

Herbes - Michele Field - stated school district had not been contacted by City regarding purchase.

Moved by Councilmember J and seconded by Councilmember M to approve the list of license applications.

Motion Carried.

Moved by Councilmember L and seconded by Councilmember I to adjourn the meeting.

Motion Carried.

Meeting adjourned at 9:05 p.m.



**APPLICATIONS FOR LICENSE  
SEPTEMBER 18, 1990**

AUCTIONEER - \$18.25/day

Allen Stutelberg, Auctioneer, two day auction at Knights of Columbus, 4947 West Broadway, September 20 and October 18, 1990

REFUSE HAULERS - (\$50.00 Co. Lic. + \$25.00 ea. vehicle)

Gordon's Rendering, New Brighton, MN

FOOD ESTABLISHMENT - Itinerant (exempt)

VFW Post 494, 5222 56th Ave. No. One Day Only  
Brats and Beer party, September 30, 1990

GAS FITTER'S LICENSE - \$30.25

Countryside Heating & Cooling Services, 10880 Co. Rd. #20, Delano, MN 55328

PLUMBER'S LICENSE - \$30.25

LeVasseum Plumbing, 1010 Ferndale, Maplewood, MN 55119

SIGN HANGER'S LICENSE - \$66.00 Renewals

Attracta Sign, Inc., 7420 W. Lake St., Minneapolis, MN 55426

PERMIT FOR WINE AND BEER IN PARK/COMMUNITY CENTER

Arlene H. Freeberg, 1315 Unity Ave. N., Golden Valley, on  
October 26, 1990 from 8 p.m. to 12 p.m. for a birthday party.

ITINERANT FOOD ESTABLISHMENT - \$30.00:

Lee I. Olson dba Carousel Shows, 8475 Thomas Avenue No. at  
Community Center, 4800 Douglas Drive on September 22, 1990.

PERMIT FOR WINE AND BEER IN PARK/COMMUNITY CENTER

Huy Nguyen, 7611 Edgewood Drive, Moundsview, MN 55112 on  
October 13, 1990 from 6:00 p.m. to 12:00 Midnight for  
a preception.

INCLUDED with Council Packet for 9-18-90 meeting:

Minutes of the Council meets of September 4 and September 13, 1990.

Crystal Planning Commission minutes of 9-10-90.  
Application for appointment to the EDA Advisory Commission from Phil Eder.

Letter from VFW Post 494 dated 9-12-90 re: brat-wurst dinner on 9-30-90.

Memo from Bldg. Inspector dated 9-11-90 re: request for bldg. permit for airplane hangar on Lot 78C-1, Crystal Airport.

Memo from Bldg. Inspector dated 9-11-90 re: 4947 West Broadway (K of C) parking variance.

Memo from City Engr. dated 9-10-90 re: parking at 42nd & Brunswick Ave.; resolution.

Interim ordinance for redevelopment project #2.- 36th Ave. & Highway 100.

Ordinance relating to lawful gambling.

Memo from Bldg. Inspector dated 9-12-90 re: Updating City Code Section 400 - Bldg. Code.; copy of ordinance.

Memo from Asst. Mgr. dated 9-4-90 re: contract renewal - Employee Assistance Program.

Minutes of the EDA ADvisory Commission meeting of 8-14-90.

Letter from Crystal Frolics Committee dated 9-1-90.  
City of Crystal 1990 Expenditure Report as of August 31, 1990.

Article from 9-10-90 Star Tribune "A License To Rent"

Memo from Asst. Mgr. dated 9-17-90 re: Insurance Refund - 1988-90.

Memo from Public Health Sanitarian dated 9-18-90 re: Blue Bell Ice Cream.

Letter from MN Housing Finance Agency dated 9-14-90, regarding program award to the City of Crystal.

*Darlene*

Memorandum

DATE: September 14, 1990  
TO: Mayor and Council  
FROM: Jerry Dulgar, City Manager   
SUBJECT: Preliminary Agenda for the September 18, 1990 Council Meeting

Regular Agenda:

1. Consideration of an application for appointment to the Economic Development Advisory Commission from Phillip L. Eder, 5630 Lakeland Avenue North, a Crystal business owner. Mr. Eder is the owner of the Iron Horse. While we have some calls, etc, to his business place it's my experience he does a very good job of trying to police his own business and he has been more active on the Crystal Business Council then almost any other businessman in town. He might be a very good addition to the advisory commission.

2. Consideration of an itinerant food license. This license application was made too late to be approved at the last meeting. They have met all of our requirements and I would recommend approval.

5. Consideration of a Charitable Gambling license for the Hartinger Foundation at the Paddock, 5540 Lakeland Avenue North. We still don't have all the information back from the state. We might have to pull this but we wanted to get this on if possible.

8. Consideration of a resolution for parking restrictions in the area of 42nd and Brunswick Avenues. This is taking care of implementing changes we said we'd make by Mr. Mann's building on 42nd and Brunswick. I recommend that we approve it.

10. Consideration of Second Reading of an Ordinance Amending the Lawful Gambling Ordinance to Conform With State Law. Dave has sent a letter to the state gambling board asking for clarification on this. He doesn't have an answer yet but we put it on hoping that we would have the answer by Tuesday. If we don't, again, this item might have to be continued.

12. The Employee Assistance Program is a confidential counselling program available for use by all employees including volunteer firefighters. A number of staff members and their families have used the program in the past several years. The rates to the City for use of such program has not increased for three years. It's a good program and I recommend renewal.

Have a great weekend. See you on Tuesday.

kg

COUNCIL AGENDA - SUMMARY

COUNCIL MEETING OF  
September 18, 1990

Call to order

Roll call

Pledge of Allegiance to the Flag

Approval of the minutes of the regular meeting of September 4, 1990.

**Regular Agenda Items**

1. Consideration of an application for appointment to the Economic Development Advisory Commission from Phillip L. Eder, 5630 Lakeland Avenue North, a Crystal business owner.
2. Consideration of an itinerant food license application for "Meeting the Candidates", at Bassett Creek Park, on Saturday, September 15, 1990, sponsored by the Volunteers for Vi Underdahl for State Representative 46A as requested by Barbara Lind, 4109 Kentucky Circle.
3. Consideration of a request from VFW Post #494 to hold a brat and sauerkraut feed with beer in its parking lot at 5222 - 56th Avenue North.
4. Appearance by Mike Erlichman, Chairman of the Regional Transit Board, to discuss Light Rail Transit.
5. Consideration of a Charitable Gambling license for the Hartinger Foundation at the Paddock, 5540 Lakeland Avenue North.
6. Consideration of a request for a building permit for a 40' x 50' airplane hangar on leased Lot 78C-1 as requested by Patrick Scharber.
7. Consideration of a request from the Knights of Columbus for a parking variance of 54 spaces to build an addition at 4947 West Broadway.
8. Consideration of a resolution for parking restrictions in the area of 42nd and Brunswick Avenues.



9. Consideration of the Second Reading of an Ordinance restricting development at 36th Avenue and Highway 100.
10. Consideration of the Second Reading of an Ordinance Amending the Lawful Gambling Ordinance to Conform With State Law.
11. Consideration of First Reading of an Ordinance Amendment relating to the State Building Code.
12. Consideration of contract renewal with Metropolitan Clinic of Counseling - Employee Assistance Program - 9-1-90 through 8-31-91.

**Open Forum**

**Informal Discussion and Announcements**

**Licenses**

**Adjournment**

APPLICATIONS FOR LICENSE  
SEPTEMBER 18, 1990

AUCTIONEER - \$18.25/day

Allen Stutelberg, Auctioneer, two day auction at Knights of Columbus, 4947 West Broadway, September 20 and October 18, 1990

REFUSE HAULERS - (\$50.00 Co. Lic. + \$25.00 ea. vehicle)

Gordon's Rendering, New Brighton, MN

FOOD ESTABLISHMENT - Itinerant (exempt)

VFW Post 494, 5222 56th Ave. No. One Day Only  
Brats and Beer party, September 30, 1990

GAS FITTER'S LICENSE - \$30.25

Countryside Heating & Cooling Services, 10880 Co. Rd. #20, Delano, MN 55328

PLUMBER'S LICENSE - \$30.25

LeVasseum Plumbing, 1010 Ferndale, Maplewood, MN 55119

SIGN HANGER'S LICENSE - \$66.00 Renewals

Attracta Sign, Inc., 7420 W. Lake St., Minneapolis, MN 55426

PERMIT FOR WINE AND BEER IN PARK/COMMUNITY CENTER

Arlene H. Freeberg, 1315 Unity Ave. N., Golden Valley, on  
October 26, 1990 from 8 p.m. to 12 p.m. for a birthday party.

September 4, 1990

page 652

Pursuant to due call and notice thereof, the Regular meeting of the Crystal City Council was held on September 4, 1990 at 7:00 P.M., at 4141 Douglas Drive, Crystal, Minnesota.

The Secretary of the Council called the roll and the following were present: Carlson, Moravec, Irving, Grimes, Herbes, Joselyn. Absent was: Langsdorf. Also in attendance were the following staff members: Jerry Dular, City Manager; John Olson, Assistant City Manager; Dave Kennedy, City Attorney; William Monk, Public Works Director; Bill Barber, Building Inspector; Darlene George, City Clerk; Tom Heenan, Supervising Sanitarian; Nancy Gohman, Assistant Manager.

The Mayor led the Council and the audience in the Pledge of Allegiance to the Flag.

Brigadier General Eugene Andreotti, Minnesota Adjutant General, appeared before the City Council to present a Certificate of Appreciation from the National Committee for Employer Support of the Guard and Reserve to the City of Crystal. Tom Heenan, Supervising Sanitarian, and Mark Gaulke of the Water and Sewer Department, both being members of the Guard and Reserve, accepted the certificates for their respective supervisors.

The Mayor acknowledged a donation to the City of Crystal from the Knights of Columbus, 4947 West Broadway, in the amount of \$2,000.

The Mayor proclaimed the week of September 23 through 29, 1990 as "Toastmasters' Week" in the City of Crystal.

The Mayor proclaimed the week of September 14 through 21, 1990 as "National Ballroom Dance Week" in the City of Crystal.

The Mayor proclaimed the week of September 17 through 23, 1990 as "Constitution Week" in the City of Crystal.

The Mayor proclaimed September 13, 1990 as National Drug Abuse Resistance Education (D.A.R.E.) Day in the City of Crystal.

The City Council considered the minutes of the Regular City Council meeting of August 21, 1990 and the Special Work Session of August 28, 1990.

Moved by Councilmember Moravec and seconded by Councilmember Grimes to approve the minutes of the Regular City Council meeting of August 21, 1990 and the Special Work Session of August 28, 1990.  
Motion Carried.

The City Council considered the following items on the Consent Agenda:



September 4, 1990

page 653

1. Set 7:00 p.m., October 2, 1990, as the date and time for a public assessment hearing for the 1990 Sealcoat Program 90-1; Sidewalk Repair 90-3; Diseased Tree Removal; Debris Removal; Weed Cutting; Delinquent Sewer and Water Bills.
2. Acceptance of a letter of resignation from James Allison of the Human Relations Commission dated 8-26-90 and a request from the Human Relations Commission to remove Bonnie Toenies from the Commission due to unexcused absences and to replace one of these openings with a student member.

Moved by Councilmember Grimes and seconded by Councilmember Carlson to approve the Consent Agenda.

Motion Carried.

The City Council considered the following Public Hearing:

1. It being 7:00 p.m., or as soon thereafter as the matter may be heard, Mayor Herbes declared this was the date and time as advertised for a public hearing at which time the City Council will consider an ordinance vacating a portion of an utility and drainage easement on Lot 3, Block 1, Froehlich Addition. The Mayor asked those present to voice their opinions or to ask questions concerning this matter.

The Mayor closed the Public Hearing.

Moved by Councilmember Irving and seconded by Councilmember Moravec to adopt the following ordinance:

ORDINANCE NO. 90-18

AN ORDINANCE VACATING A  
CERTAIN DRAINAGE AND UTILITY EASEMENT

and further, that this be the second and final reading.

Motion Carried.

The City Council considered the following items on the Regular Agenda:

1. The City Council considered the parking situation at 6024-36 42nd Avenue North. Those appearing and heard were: Arie Mann, owner of the property; Brian Anderson, Total Register Systems; Mr. Ross, Ross Plumbing; Unidentified female employee of Ross Plumbing.

Moved by Councilmember Moravec and seconded by Councilmember Grimes to accept the Public Works Director's recommendations as follows, to take effect upon notification to the owner of the property:

- 1) Provide the west side of Brunswick Avenue North between 42nd and 43rd Avenues for parking of business owners and

September 4, 1990

page 654

employees. This can be accomplished by establishing a policy restricting parking in this area to individuals with a validated permit between 8 a.m. and 6 p.m. Monday through Saturday. Enforcement of such a policy would keep students from parking in this area while allowing area residents to use the parking every evening and Sundays. Twelve permits would be issued to the impacted businesses.

- 2) Maximize the parking along 42nd Avenue for customers by requesting MTC relocate the bus stop presently located at the corner of 42nd and Brunswick Avenues.
- 3) Prohibit parking in the front yard area along 42nd Avenue.
- 4) Designate the boulevard area adjacent to the building along Brunswick Avenue as a loading/delivery zone.
- 5) Install time restriction signs along the inset parking east of Brunswick along westbound 42nd Avenue.

Motion Carried.

2. Mr. Bill Morris of Decision Resources, Inc. appeared before the City Council to discuss the community survey. The Council gave direction to proceed with the survey as discussed.
3. The City Council considered curb opening permits for a proposed bank building at 7009 - 56th Avenue North (building being located in New Hope; two access points on Louisiana Avenue which is a Crystal street). Jerry Choromanski, proponent of the bank building, appeared and was heard.

Moved by Councilmember Grimes to continue to the September 18, 1990 City Council meeting to allow time for notification to residents in the area.

Motion Failed for Lack of a Second.

Moved by Councilmember Irving and seconded by Councilmember Grimes to set 7 p.m. on September 13, 1990 as the date and time for a public informational meeting at which time residents in the area of the proposed bank building may voice their opinions regarding the two proposed access points on Louisiana Avenue.

Motion Carried.

4. The City Council considered the Second Reading of an ordinance amending the Lawful Gambling Ordinance to conform with state law. Those appearing and heard were John Westphal, Jane Elsen and George Haasken, all representing the Knights of Columbus Charitable Gambling Organization.

Moved by Councilmember Grimes and seconded by Councilmember Carlson to continue discussion to the September 18, 1990 City

September 4, 1990

page 655

Council meeting and direct staff to contact the State Gaming Division regarding procedure of approval of Charitable Gambling premises permits.

Motion Carried.

The Mayor called a recess at 9:13 p.m. and the meeting was reconvened at 9:20 p.m.

5. The City Council considered a recommendation from the Human Relations Commission that the City Council send a letter to School District 281 regarding the recent vandalism and desecration problems at Adath Chesel Shel Emes Cemetery, 37th & Winnetka Avenues North.

Moved by Councilmember Carlson and seconded by Councilmember Grimes to direct the Human Relations Commission to send a letter to School District 281 regarding the recent vandalism and desecration problems at Adath Chesel Shel Emes Cemetery, 37th and Winnetka Avenues North, as recommended by the Commission.

Motion Carried.

6. The City Council considered Site Improvement Agreement for Walgreen's at 6918 - 56th Avenue North.

Moved by Councilmember Carlson and seconded by Councilmember Moravec to approve Site Improvement Agreement as part of a condition of building permit issuance for Walgreen's at 6918 - 56th Avenue North, and further, to authorize the Mayor and City Manager to sign such agreement.

Motion Carried.

7. The City Council discussed a feasibility study for drainage improvements at 6321 and 6407 - 46th Place. No action was taken.
8. The City Council considered the Second Reading of an ordinance amending the City Garbage Ordinance addressing backyard composting requirements.

Moved by Councilmember Irving and seconded by Councilmember Moravec to adopt the following ordinance:

ORDINANCE NO. 90-19

AN ORDINANCE RELATING TO PUBLIC HEALTH:  
COMPOSTING: AMENDING CRYSTAL CITY CODE,  
SUBSECTION 605.01: AMENDING CRYSTAL  
CITY CODE SECTION 605 BY ADDING A SUBSECTION

and further, that this be the second and final reading.

Motion Carried.

September 4, 1990

page 656

9. The City Council considered approval of the Pets Under Police Security (PUPS) seven-city animal impound facility.
- A. Moved by Councilmember Carlson and seconded by Councilmember Joselyn to adopt the following resolution, the reading of which was dispensed with by unanimous consent:

RESOLUTION NO. 90-54

RESOLUTION RELATING TO ANIMAL  
CONTROL: AUTHORIZING MEMBERSHIP  
OF THE CITY IN PETS UNDER POLICE SECURITY (PUPS)

By roll call and voting aye: Carlson, Moravec, Irving,  
Grimes, Herbes, Joselyn; absent, not voting: Langsdorf.  
Motion carried, resolution declared adopted.

- B. Moved by Councilmember Irving and seconded by Councilmember Joselyn to appoint the City Manager as a representative on the PUPS Board and Councilmember Carlson as the alternate representative.

Motion Carried.

10. The City Council discussed a resolution that was adopted by the Crystal Police Relief Association relating to the retirement benefits of and member contributions to the Crystal Police Relief Association.

Moved by Councilmember Irving and seconded by Councilmember Grimes to deny the resolution relating to the retirement benefits of and member contributions to the Crystal Police Relief Association; restating the Board's determination of the maximum rate of monthly salary of a first grade patrol officer, adopted by the Crystal Police Relief Association on July 26, 1990.

Motion Carried.

11. Consideration of a resolution and an interim ordinance relating to a moratorium on development at 36th Avenue and Highway 100.
- A. Moved by Councilmember Joselyn and seconded by Councilmember Moravec to adopt the following resolution, the reading of which was dispensed with by unanimous consent:

RESOLUTION NO. 90-55

RESOLUTION PLACING A MORATORIUM ON DEVELOPMENT  
WITHIN REDEVELOPMENT PROJECT NO. 2

By roll call and voting aye: Carlson, Moravec, Irving,  
Grimes, Herbes, Joselyn; absent, not voting: Langsdorf.  
Motion carried, resolution declared adopted.

September 4, 1990

page 657

- B. Moved by Councilmember Joselyn and seconded by Councilmember Irving to adopt the following ordinance:

ORDINANCE NO. 90-

AN INTERIM ORDINANCE FOR THE PURPOSE OF PROTECTING  
THE PLANNING PROCESS AND HEALTH, SAFETY AND WELFARE OF THE  
RESIDENTS, AND RESTRICTING DEVELOPMENT WITHIN  
REDEVELOPMENT PROJECT NO. 2

and further, that the second and final reading be held on  
September 18, 1990.

Motion Carried.

12. The City Council considered the designation of voting and alternate voting delegates for the National League of Cities Annual Congress of Cities in Houston, Texas, December 1-5, 1990; and discussion regarding policy proposals and resolutions for consideration at the Congress of Cities Conference.

Moved by Councilmember Irving and seconded by Councilmember Joselyn to designate Mayor Herbes as the voting delegate and Councilmember Carlson as the alternate voting delegate for the National League of Cities Annual Congress of Cities Conference in Houston, Texas, on December 1-5, 1990.

Motion Carried.

13. The City Council discussed setting meetings for the 1991 City of Crystal Budget discussions.

Moved by Councilmember Joselyn and seconded by Councilmember Irving to set 7:00 p.m. on October 23, 1990 and 7:00 p.m. on October 30, 1990 to discuss the 1991 City of Crystal Budget.

Motion Carried.

Moved by Councilmember Grimes and seconded by Councilmember Moravec to approve the list of license applications as submitted by the City Clerk to the City Council, a list of which is on file in the office of the City Clerk, and further, that such list be incorporated into and made a part of this motion as though set forth in full herein.

Motion Carried.

Moved by Councilmember Irving and seconded by Councilmember Joselyn to adjourn the meeting.

Motion Carried.

Meeting adjourned at 10:25 p.m.



September 4, 1990

page 658

\_\_\_\_\_  
Mayor

ATTEST:

\_\_\_\_\_  
City Clerk

September 13, 1990

Pursuant to due call and notice given in the manner prescribed by Section 3.01 of the City Charter, the Special Meeting of the Crystal City Council was held on September 13, 1990, at 7:00 p.m., at 4141 Douglas Drive, Crystal, Minnesota. The following were present: Carlson, Moravec (arrived at 7:02 p.m.), Irving, Grimes, Herbes, Langsdorf (arrived at 7:12 p.m.). Absent was: Joseyln. Also in attendance were the following staff members: Jerry Dulgar, City Manager; Bill Monk, Public Works Director; Darlene George, City Clerk.

The City Council continued consideration of curb opening permits for a proposed bank building at 7009- 56th Avenue North (building being located in New Hope; two access points on Louisiana Avenue which is a Crystal street). Those appearing and heard were:

Jerry Choromanski, proponent  
Patty and Kevin Long, 5336 Louisiana Ave. N.  
Craig Kraft, 5513 Louisiana Ave. N.  
Estella Filkins, 5342 Louisiana Ave. N.  
Ann Evasku, 5507 Louisiana Ave. N.  
Jane and Gene Commers, 5518 Louisiana Ave. N.  
Reinold Ramm, 5425 Louisiana Ave. N.  
Mark Prince, 5407 Louisiana Ave. N.  
Eileen and Mike Doherty, 5337 Kentucky Ave. N.  
James Mourning, Maryland Avenue (did not state complete address)  
Stan Tvedt, 5437 Louisiana Ave. N.  
Barbara Commers, 5506 Louisiana Ave. N.

Concerns noted were safety of children, noise, increased traffic.

Moved by Councilmember Moravec and seconded by Councilmember Langsdorf to approve curb opening permits for the proposed bank building at 7009 - 56th Avenue North with conditions set forth by the Public Works Director and contingent upon the City of New Hope rezoning the property as follows:

1. Two curb cuts, one at the north and one at the south end of the site.
2. Curb cuts permitted exclusively for use as part of the bank proposal as detailed on site plan dated 6-28-90.
3. Improvements to be constructed with the curb cut include concrete curb installation along the entire Louisiana Avenue frontage. Further, the owner shall commit to remove said curb cut upon the discontinuance of the bank use.
4. Establishment of no parking zones along the commercial frontage on Louisiana Avenue in both Crystal and New Hope.

September 13, 1990

Moved by Councilmember Grimes to amend the motion to include one single full access curb cut to be located in the center of the site in lieu of two curb cuts. Councilmembers Moravec and Langsdorf accepted the amendment.

On the main motion: Voting Aye: Carlson, Moravec, Grimes, Langsdorf; voting no: Irving, Herbes; absent not voting: Joselyn.  
Motion Carried.

Meeting adjourned at 8:45 p.m.

---

Mayor

ATTEST:

---

City Clerk

September 13, 1990

Pursuant to due call and notice given in the manner prescribed by Section 3.01 of the City Charter, the Special Meeting of the Crystal City Council was held on September 13, 1990, at 7:00 p.m., at 4141 Douglas Drive, Crystal, Minnesota. The following were present: Carlson, Moravec (arrived at 7:02 p.m.), Irving, Grimes, Herbes, Langsdorf (arrived at 7:12 p.m.). Absent was: Joseyln. Also in attendance were the following staff members: Jerry Dulgar, City Manager; Bill Monk, Public Works Director; Darlene George, City Clerk.

The City Council continued consideration of curb opening permits for a proposed bank building at 7009- 56th Avenue North (building being located in New Hope; two access points on Louisiana Avenue which is a Crystal street). Those appearing and heard were:

Jerry Choromanski, proponent  
Patty and Kevin Long, 5336 Louisiana Ave. N.  
Craig Kraft, 5513 Louisiana Ave. N.  
Estella Filkins, 5342 Louisiana Ave. N.  
Ann Evasku, 5507 Louisiana Ave. N.  
Jane and Gene Commers, 5518 Louisiana Ave. N.  
Reinold Ramm, 5425 Louisiana Ave. N.  
Mark Prince, 5407 Louisiana Ave. N.  
Eileen and Mike Doherty, 5337 Kentucky Ave. N.  
James Mourning, Maryland Avenue (did not state complete address)  
Stan Tvedt, 5437 Louisiana Ave. N.  
Barbara Commers, 5506 Louisiana Ave. N.

Concerns noted were safety of children, noise, increased traffic.

Moved by Councilmember Moravec and seconded by Councilmember Langsdorf to approve curb opening permits for the proposed bank building at 7009 - 56th Avenue North with conditions set forth by the Public Works Director and contingent upon the City of New Hope rezoning the property as follows:

1. Two curb cuts, one at the north and one at the south end of the site.
2. Curb cuts permitted exclusively for use as part of the bank proposal as detailed on site plan dated 6-28-90.
3. Improvements to be constructed with the curb cut include concrete curb installation along the entire Louisiana Avenue frontage. Further, the owner shall commit to remove said curb cut upon the discontinuance of the bank use.
4. Establishment of no parking zones along the commercial frontage on Louisiana Avenue in both Crystal and New Hope.

September 13, 1990

Moved by Councilmember Grimes to amend the motion to include one single full access curb cut to be located in the center of the site in lieu of two curb cuts. Councilmembers Moravec and Langsdorf accepted the amendment.

On the main motion: Voting Aye: Carlson, Moravec, Grimes, Langsdorf; voting no: Irving, Herbes; absent not voting: Joselyn.  
Motion Carried.

Meeting adjourned at 8:45 p.m.

---

Mayor

ATTEST:

---

City Clerk



## CRYSTAL PLANNING COMMISSION MINUTES

September 10, 1990

The meeting of the Crystal Planning Commission convened at 7:00 p.m. with the following present: Anderson, Barden, Christopher, Kamp, Magnuson, Nystrom and Smith; the following were absent: Elsen, Guertin and Lundeen; also present were Community Development Director Olson and Recording Secretary Scofield.

Moved by Commissioner Christopher and seconded by Commissioner Barden to approve the minutes of the July 9, 1990, meeting.

Motion carried.

Moved by Commissioner Kamp and seconded by Commissioner Anderson to approve the minutes of the August 13, 1990, meeting.

Motion carried.

1. Chairperson Magnuson declared this was the time and the place as advertised for a public hearing at which time the Planning Commission will sit as a Board of Adjustments and Appeals to consider Variance Application #90-34 for a 16' x 31' family room addition which will encroach 11' in the required 40' rear yard setback at 5817 Elmhurst Ave. N. as requested by William and Sharon Buscher. The Buschers withdrew their request.
2. Chairperson Magnuson declared this was the time and the place as advertised for a public hearing at which time the Planning Commission will sit as a Board of Adjustments and Appeals to consider Variance Application #90-35 for an off street parking variance of the required 415 parking spaces at 4947 West Broadway (Knights of Columbus) as requested by Father William Blum Home Association, Inc. The proponent presented the following: Rick Griswold of the Knights of Columbus stated the lower level would be for weddings and receptions and the upper level for the members' use including video games machines. Have a reciprocal agreement with Doyle's Bowling for parking overflow. Plan to tear down the house next door which is rental, and the boats, etc. are owned by renters, but the trailer is used by the Knights of Columbus during Crystal Frolics.

No one appeared in opposition.

Moved by Commissioner Christopher and seconded by Commissioner Kamp to close the public hearing.

Motion carried.

Moved by Commissioner Christopher and seconded by Commissioner Barden that pursuant to Section 515.55 of the Crystal City Code to recommend to the City Council to vary or modify the strict application of Section 515.09, Subd. 8

v) to grant a variance of 54 off-street parking spaces of the required 415 parking spaces at Knights of Columbus, 4947 West Broadway, P.I.D. #09-118-21-11-0061, as requested in Application #90-35 of the Father William Blum Home Association, Inc.

The findings of fact are: Since Knights of Columbus have an agreement with Doyle's for parking overflow and no need for additional parking for members in the lounge, but in that many occupants do require 415 parking spaces, they have complied by removing the house to the north. It was suggested to put agreement with Doyle's in writing.

Motion carried.

3. Chairperson Magnuson declared this was the time and the place as advertised for a public hearing to consider the proposed platting of property to be known as Atlantic Addition, located at 5160 West Broadway and to consider Application #90-36 as submitted by Wash Me #9 Limited Partnership to rezone property from B-3 (Auto-Oriented Commercial) District to I-2 (Heavy Industrial) District. The proponent presented the following: Bruce Hubbard of Wash Me #9 Limited Partnership stated there are two accesses on West Broadway for the car wash, and very few people would come in and go out for mini-storage development.

John Olson stated there is no requirement for square footage in an I-2 District. Depending on the site plan they may need a variance to the conditional use permit allowing stacking of cars to be reduced from 30 to 20. It was suggested to try to increase the size of the curb cut for the car wash.

- A. Moved by Commissioner Smith and seconded by Commissioner Anderson to continue until October 8 the discussion of the preliminary plat of Atlantic Addition which is a re-plat of Lot 1, Block 1, Crystal Securities 2nd Addition, property is located at 5160 West Broadway as submitted by Wash Me #9 Limited Partnership.
- B. Moved by Commissioner Smith and seconded by Commissioner Kamp to set 7:00 p.m., or as soon thereafter as the matter may be heard, Monday, October 8, 1990, as the date and time for a public hearing at which time the Planning Commission will sit as a Board of Adjustments and Appeals to consider a Variance Application to grant a variance to the conditional use permit regarding car stacking requirements (Section 515.35, Subd. 4 b) 2) for Wash Me #9 Limited Partnership at 5160 West Broadway, P.I.D. #09-118-21-24-0023, if

staff deems it necessary after seeing the revised site plan.

- C. No action was taken regarding Application #90-36, as submitted by Wash Me #9 Limited Partnership to rezone property from B-3 (Auto-Oriented Commercial) District to I-2 (Heavy Industrial) District, located at 5160 West Broadway, legally described as proposed Lot 2, Block 1, Atlantic Addition pending continuation of public hearing on proposed plat.
- 4. Consideration of a building permit for mini-storage buildings at 5160 West Broadway as requested by Wash Me #9 Limited Partnership.

No action was taken regarding authorization to issue a building permit for mini-storage buildings located at 5160 West Broadway, P.I.D. #09-118-21-24-0023, subject to standard procedure pending continuation of public hearing on proposed plat.

- 5. Consideration of a building permit for an airplane hangar at Lot 78C-1 Crystal Airport as requested by Patrick Scharber.

Moved by Commissioner Barden and seconded by Commissioner Christopher to recommend to the City Council to approve authorization to issue a building permit for a 40' x 50' airplane hangar located at Lot 78C-1, Crystal Airport, subject to standard procedure.

Motion carried.

- 6. Discussion items:
  - A. Would like a representative from MAC to address Planning Commission as to plans for airport.
  - B. Highway 100 development--State will make six lanes out of existing four lanes. Preferred developer and Nicklow's have not signed papers yet.
  - C. Public forums for the Comprehensive Plan will be October 17 and 18 after the Community Survey is completed.
  - D. Walgreen's has submitted a site plan and bond.
  - E. Firestone is in a holding pattern of not developing any new stores.
  - F. Might look at amendment regarding home occupation such as the chiropractor's request (34th & Winnetka) when the area is so large.

Moved by Commissioner Smith and seconded by Commissioner Barden to adjourn.

Motion carried.

The meeting adjourned at 7:55 p.m.

---

Chairperson Magnuson

---

Secretary Elsen



CITY OF CRYSTAL

APPLICATION FOR APPOINTMENT TO THE

Economic Development Advisory Commission

Name Phillip L. Eder Address 5630 Lakeland Ave. N. Crystal, MN 55429 Zip #

Phone (home) 865-6167 (Office) 533-2504

Resident of Crystal Since (year) Business owner 14 years

President, Dorian Ent., Inc. dba

Occupation The Iron Horse Employer Dorian Enterprises, Inc.

Education: (please indicate highest grade completed or highest degree and major course of study) B.A. Double major Biology & History. Graduate work MBA

Civic and other activities: (please list past and present civic activities and organizational memberships, particularly those which may be relevant to the appointment you are seeking)

Twinwest Chamber of Commerce

Crystal Business Council

Excelsior Blvd. Redevelopment District Advisory Committee - Chairman

1976 - 1986 (St. Louis Park)

Comments (please briefly describe other qualifications, experience and other information which you would like the City Council to consider or which you believe are particularly relevant to the appointment you are seeking. Use additional pages if necessary.)

Having served on a similar advisory Board in another community, I am familiar with the subject matter involved. Special emphasis was placed on the developer selection process, plan review and community impact studies.

I also offer a unique perspective as a condemned party. My business in St. Louis Park was taken through condemnation, giving me first-hand knowledge of this process and problems faced by displaced businesses. I feel this experience can be of great value to the community at large, as well as those directly effected by redevelopment.

Date Submitted: August 24, , 19 90 .

(Return to: City Manager, 4141 Douglas Drive North, Crystal, Minnesota 55422)





CHARLES R. KNAEBLE POST NO. 494  
5222 56th Avenue, North  
Crystal, Minnesota 55429

9-17-90

CITY COUNCIL:

WE WOULD LIKE TO REQUEST YOUR  
PERMISSION TO HOLD A BRATWURST  
DINNER OUT OF DOORS ON 9-30-90  
WE WILL HAVE A FOOD TENT TO  
SERVE OUR MEAL. We are going  
to serve. Reg Beer. Free. 2:00 PM. to 7:00 PM.

RESPECTFULLY  
LYNN MIEDEMA

Eleanor Lentgen Jr. Vice

DATE: September 11, 1990  
TO: Jerry Dulgar, City Manager  
FROM: Bill Barber, Building Inspector  
SUBJECT: Request for building permit to build a 40'x50'  
airplane hangar on Lot 78C-1, Crystal Airport

Patrick Scharber is requesting a building permit to build a 40'x50' airplane hangar on the east side of the airport. I have received a letter from MAC stating that they have approved the lease.

This request is standard and I therefore recommend your approval.

#### Planning Commission Update

The Planning Commission recommended approval of this item.  
Note: The Planning Commission has requested a representative of MAC to come to their next meeting and speak on plans for the Airport.

kk

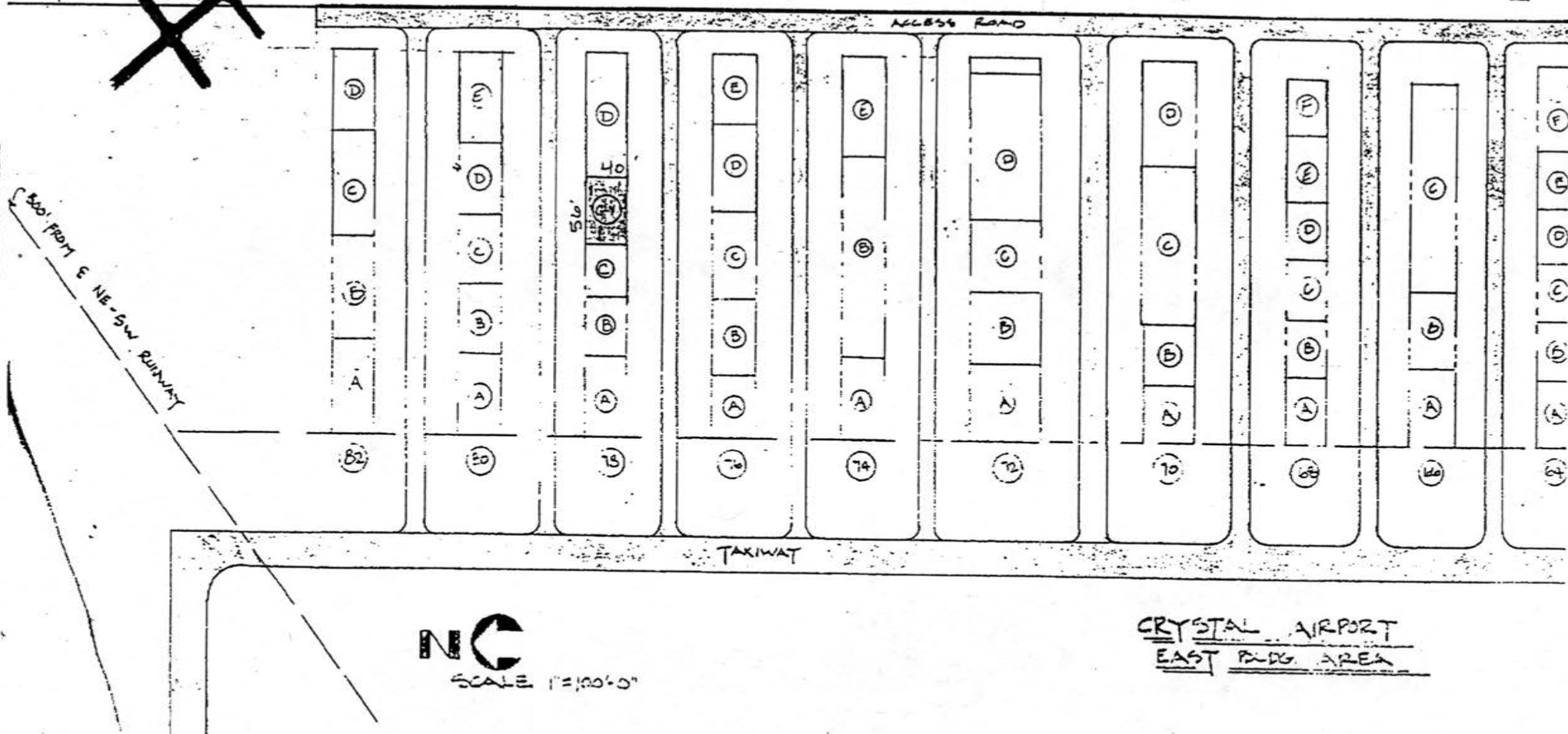
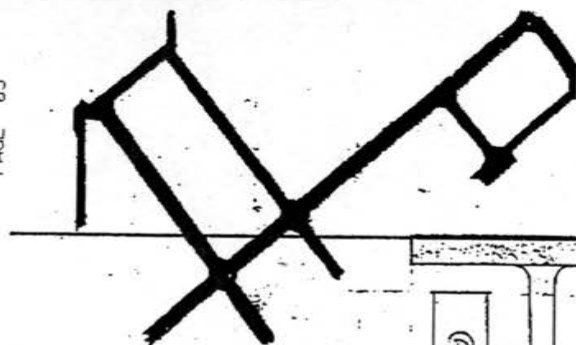

DATE: September 11, 1990  
TO: Jerry Dulgar, City Manager  
FROM: Bill Barber, Building Inspector  
SUBJECT: 4947 West Broadway, Knights of Columbus  
Variance #90-35; Parking Variance

The Knights of Columbus are proposing an addition to their existing building. The addition will be 32'x55', 2 story which will require an additional 79 parking spaces. There currently are 321. With rearranging the existing layout slightly and adding spaces where now sits a house and garage, they can add 40 spaces. This will leave them short 54 spaces of the required 415.

As you will note, the only request we have is for the parking. They do not want to spend the money on architectural and engineering fees if the request does not pass.

Staff has looked at the entire site and feel that this would work well. A detailed site plan and building layout will be submitted when they request approval for a building permit. At that time, we will also be looking at the site improvements that are needed.

#### UPDATE FROM PLANNING COMMISSION

The Planning Commission recommended approval based on the following findings of fact:

1. The additional parking may not be needed if the building addition is for a members lounge.
2. The KC Hall has reduced it's size of addition
3. They have a verbal agreement with Doyles to use parking in Doyles' lot as an overflow.

kk

PARKING REQUIREMENTS	415
PARKING PROVIDED	361
VARIANCE	54

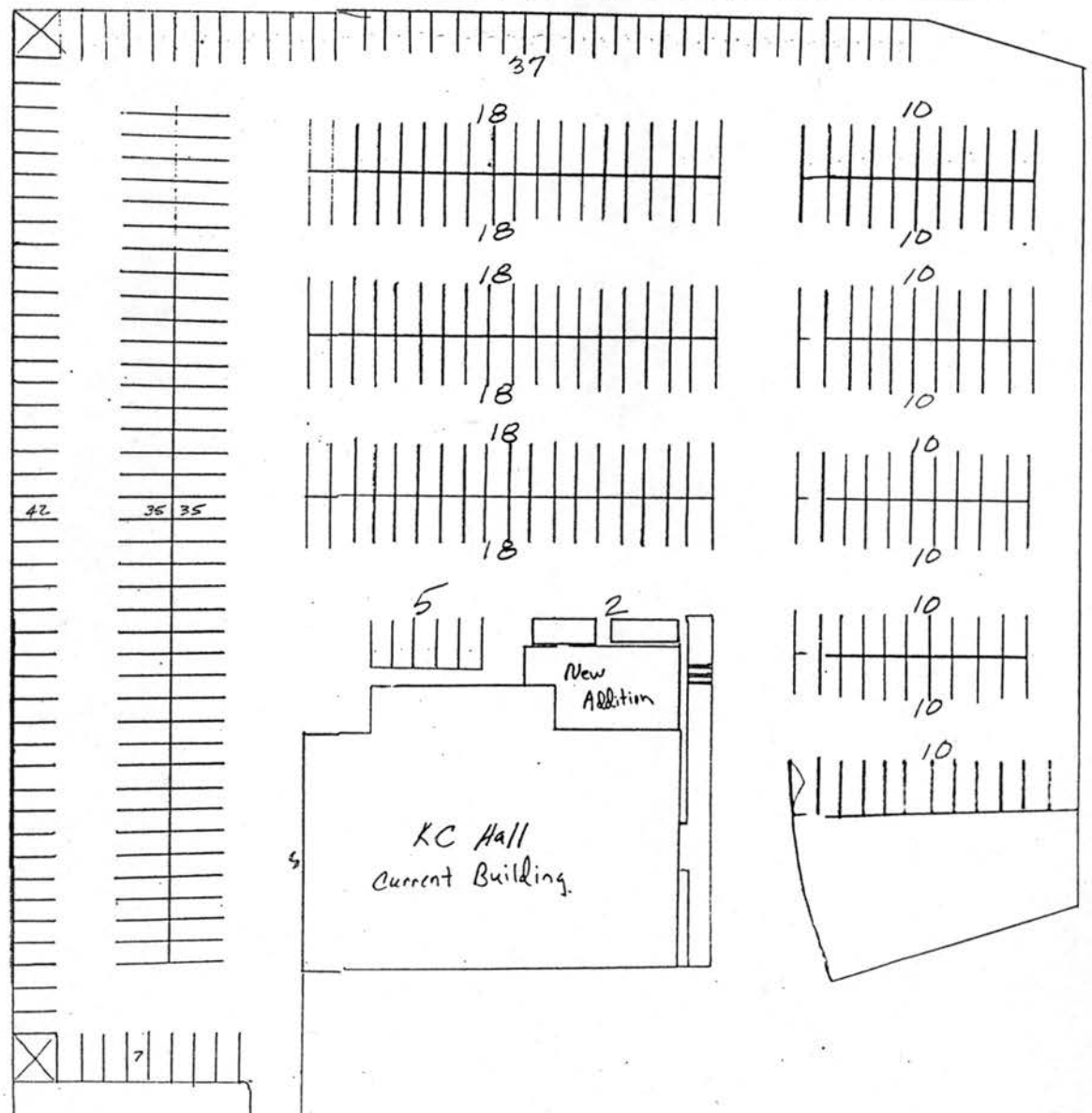



SEPTEMBER 13, 1990

CRYSTAL CITY COUNCIL  
CITY HALL  
CRYSTAL, MINNESOTA

WE THE UNDERSIGNED HAVE A CURRENT AGREEMENT THAT PERTAINS  
TO OVERFLOW PARKING AT OUR PLACES OF BUSINESS.

WHEN EVER ONE OF OUR PARKING LOTS EXCEEDS ITS CAPACITY,  
OVERFLOW IS ALLOWED TO PARK AT THE OTHERS BUSINESS ESTABLISHMENT.

CRYSTAL KNIGHTS OF COLUMBUS

*Grand Knight*  
*Donald J. Churchill Sr.*  
DOYLES BOWL

*Wayle A. Steinhaus*

DATE: September 10, 1990  
TO: Jerry Dulgar, City Manager  
FROM: Bill Monk, City Engineer  
SUBJECT: Parking at 42nd and Brunswick Avenues

The attached resolution formalizes the Council's action of September 4 regarding parking restrictions to be signed and enforced. Also attached is a copy of the letter sent to Arie Mann following that meeting.

Approval of the resolution is necessary for this item to proceed.



WM:jrs

Encls

RESOLUTION NO. 90-

RESOLUTION RESTRICTING PARKING  
IN THE AREA OF 42ND AND BRUNSWICK AVENUES

WHEREAS, long term parking is proving to have a negative impact on local businesses in the area of 42nd and Brunswick Avenues.

NOW, THEREFORE, BE IT RESOLVED that the Crystal City Council hereby restricts parking along the west side of Brunswick Avenue between 42nd and 43rd Avenues by requiring permits issued by the Crystal City Manager. Said permit parking restrictions are to be in effect between the hours of 8 a.m. to 6 p.m., Monday through Saturday. Further, parallel parking along the north side of 42nd Avenue east of Brunswick Avenue is hereby restricted to a two-hour limit.

Adopted this 18th day of September, 1990.

\_\_\_\_\_  
Mayor

ATTEST:

\_\_\_\_\_  
City Clerk



4141 Douglas Drive North • Crystal, MN 55422-1696 • 537-8421

ADMINISTRATIVE OFFICE

September 6, 1990

Mr. Arie Mann  
4208 Brunswick Avenue North  
Crystal, MN 55422

Dear Mr. Mann:

As you are aware, on September 4 the Crystal City Council approved the following five-step plan for addressing the parking situation at your commercial complex at the corner of Brunswick and 42nd Avenues:

- 1) Provide the west side of Brunswick Avenue North between 42nd and 43rd Avenues for parking of business owners and employees. This can be accomplished by establishing a policy restricting parking in this area to individuals with a validated permit between 8 a.m. and 6 p.m. Monday through Saturday. Enforcement of such a policy would keep students from parking in this area while allowing area residents to use the parking every evening and Sundays. Twelve permits would be issued to the impacted businesses.
- 2) Maximize the parking along 42nd Avenue for customers by requesting MTC relocate the bus stop presently located at the corner of 42nd and Brunswick Avenues.
- 3) Prohibit parking in the front yard area along 42nd Avenue.
- 4) Designate the boulevard area adjacent to the building along Brunswick Avenue as a loading/delivery zone.
5. Place a time limit on parking along 42nd Avenue to encourage usage by customers of area businesses.

Until the items listed above are completed, which I estimate to take three weeks, parking in the front yard along 42nd Avenue and the Brunswick Avenue boulevard will not be cited

Mr. Arie Mann  
September 6, 1990  
Page2

as violations. You and your tenants are encouraged, however, to park along the west side of Brunswick adjacent to the church to alleviate the safety concerns noted at the Council meeting. I will contact you directly as the approved signage is to be installed and the permits are ready for use.

I am aware you still have objections to the manner in which this matter was resolved. However, the City is prepared to work with you and impacted businesses to make the parking changes functional. I appreciate your assistance. .

Sincerely,

William Monk  
City Engineer

WM:jrs

cc: Jerry Dulgar  
James Mossey



**ORDINANCE NO. 90-****CITY OF CRYSTAL****INTERIM ORDINANCE FOR THE PURPOSE OF PROTECTING  
THE PLANNING PROCESS AND HEALTH, SAFETY AND WELFARE OF THE  
RESIDENTS, AND RESTRICTING DEVELOPMENT WITHIN  
REDEVELOPMENT PROJECT NO. 2.**

The City Council of the ~~City~~ City of Crystal ordains:

Section 1. Background.

1.01 The Crystal Economic Development Authority ("EDA") and the City Council have approved creation of Redevelopment Project No. 2 ("Project") and Tax Increment Financing District No. 2-1 ("TIF District"), generally located at the intersection of Highway 100 and 36th Avenue in the City.

1.02 The City Council has also authorized and is currently conducting a major update of the City's comprehensive plan.

1.03 The comprehensive plan update will analyze long term development and redevelopment issues in the City, including the Project area and the TIF District.

1.04 There is a need for an interim ordinance to be adopted for the purpose of protecting the planning process and the health, safety, and welfare of the citizens of the City and to ensure that the City and its citizens retain the benefits of the City's comprehensive plan and zoning ordinance until the comprehensive plan update has been completed. In light of the City's particular interest in the Project area and the area's importance to the City as a whole, there is a need to restrict development within the Project area until the comprehensive plan update has been completed and any modification to the City's zoning and land use regulations are accomplished.

1.05 Minnesota Statutes, Section 462.355, subd. 4 (the "Act") authorizes the City to adopt interim zoning ordinances applicable to all or a part of the City for the purpose of protecting the planning process and the health, safety and welfare of its citizens, which ordinances may regulate, restrict or prohibit any use or development within the City for a period up to one year, which period may be extended for additional periods up to 18 months.

1.06 It is hereby found and determined that it is in the best interests of the sound, economic, and efficient development of the Project area and the City as a whole, that the authority granted by the above section of the law be used by the City with reference to the Project area.

## Section 2. Interim Zoning.

2.01 A special zoning district of the City to be known as the Interim Zoning (IZ) District is hereby created. The boundaries of the IZ District are the boundaries of the Project Area as described in the Redevelopment Project Plan therefore dated April 3, 1990.

2.02 Commencing on the effective date of this ordinance and ending on the date of its termination in accordance with Section 3.01, the following rules shall apply:

1. No building permit for the construction, reconstruction or alteration of any structure within the Project area will be granted by this Council except:
  - a. permits for the necessary repair of existing buildings, and
  - b. permits to be issued pursuant to a planned development which has received Council approval prior to the effective date of this ordinance, and
  - c. permits for which application had been duly made to the City prior to September 4, 1990.
2. No proposal for rezoning of property in the Project area shall be approved by the Planning Commission or the Council, except that the Commission and the Council may consider rezoning proposals in connection with the comprehensive plan update as it relates to the Project area.
3. No land within the Project area shall be replatted or subdivided except for the purpose of consolidation of parcels of land in single ownership, land description clarification, or the facilitating of the conveyance of parcels of land in single ownership.

2.03 The City Council recognizes that the strict application of the rules set out in Section 2.02 may, in certain cases, cause undue hardship to properties and property owners in the Project area. The Council, acting as the Board of Adjustments and Appeals, may hear requests for such variances and shall grant them only upon a finding that

- 1) the variance will not affect the integrity of the comprehensive planning process; and
- 2) the intent and purpose of this ordinance will be served thereby.

Applications for and administration of variances under this section shall be in accordance with Section 515.55 of the City Code (Appendix I, "Zoning") except that no public hearing is required.

Section 3. Effective Date.

3.01 This ordinance is effective in accordance with Crystal City Code, Subsection 110.11. The provisions of this ordinance expire on May 31, 1991, provided that the City Council specifically reserves its right to renew this ordinance for a period of time as permitted by the Act.

Dated: \_\_\_\_\_

First reading: \_\_\_\_\_

Adopted: \_\_\_\_\_

\_\_\_\_\_  
Betty Herbes, Mayor

Attest:

\_\_\_\_\_  
Darlene George  
City Clerk

ORDINANCE NO. 90-\_\_\_\_\_

AN ORDINANCE RELATING TO LAWFUL GAMBLING:  
AMENDING CRYSTAL CITY CODE BY ADDING  
A SECTION: REPEALING CRYSTAL CITY  
CODE SUBSECTION 1100.19

THE CITY OF CRYSTAL ORDAINS:

Section 1. Crystal City Code is amended by adding a section to read as follows:

Section 1102 - Lawful Gambling

1102.01. Lawful Gambling. Subdivision 1. General Rule. Pursuant to the provisions of Minnesota Statutes, Section 340A.410, Subdivision 2, lawful gambling may be conducted on premises licensed for the sale of intoxicating liquor by organizations licensed by the Charitable Gambling Control Board (Board) under Minnesota Statutes, Sections 349.11 to 349.213 when a premises permit therefor has been issued by the Board. Non-profit organizations licensed by the Board may conduct lawful gambling on the licensed premises or adjoining rooms of on-sale liquor establishments provided the gambling is in compliance with the law and the requirements of this section are complied with.

1102.03. City Review. Subdivision 1. City Investigation. Upon receipt of an application for a premises permit or renewal thereof and payment of the investigation fee required by Subsection 1102.17 the City Manager will refer the application to the Police Chief for investigation. The Police Chief must as part of the investigation, obtain from the Board data received by the Board in the license application and premises permit application of the organization and other information that the Board may have in its possession relating to the eligibility and qualifications of the licensed organization to conduct or continue to conduct lawful gambling at the premises specified in the permit application.

Subd. 2. City Council Action. The City Council will review the application for a lawful gambling premises permit or renewal thereof.

a) If the application is for an initial premises permit the Council will by resolution approve the permit application if the application is made by an organization licensed by the Board.

b) If the application is for the renewal of an existing premises permit, the Council may by resolution decline to approve the application if (i) in its judgment the conduct of lawful gambling at the premises by the applicant will adversely affect the public health, safety and welfare or (ii) the applicant has engaged in conduct constituting grounds for the revocation or suspension of an intoxicating liquor license as specified in Subsection 1005.21 of this code or both (i) and (ii) as the case may be.

Subd. 3. Prior Board Approval. The City will not consider an application for a lawful gambling premises permit or renewal thereof unless (i) the application for the permit has been approved by the Board or (ii) the Board has indicated in writing to the City Clerk that Board approval is granted pending only the approval of the City Council.



1102.05. Eligible Organizations. The City will consider for approval only premises permits by organizations licensed by the Board. When an application is submitted to the City the City will presume that the applicant is eligible for the permit under state law but will make no independent investigation of that fact.

1102.07. Limit of Licenses. On-sale establishments authorized to allow gambling are limited to one yearly lessee at premises licensed for on-sale liquor sales in the City. The City Council may by resolution authorize more than one organization to conduct lawful gambling activities at various locations for a limited period in connection with an annual civic celebration.

1102.09. Hours. Lawful gambling may be conducted only during the permitted hours of operation of the licensed on-sale establishment.

1102.11. Leases: Filing. A copy of the lease agreement between a non-profit organization and an on-sale licensee must be filed with the City Clerk within one week after execution of the lease. The lease must provide that the lessee may operate only after issuance of a license and premises permit from the Board and be subject to the terms of this Section.

1102.13. Contributions to City. 10 cents of each dollar of profits from lawful gambling within the City must be pledged and annually, prior to December 1, contributed to the City by the organization for use in lawful purposes as defined in Minnesota Statutes, Section 349.12, Subdivision 11, in the trade area of the City. For purposes of this subdivision the term "net profits" means profits less amounts expended for allowable expenses; the terms "profits" and "allowable expenses" have the meanings given them by Minnesota Statutes, Chapter 349 and rules and regulations promulgated thereunder; and the term "trade area" means the area within the boundaries of the City and within the boundaries of the cities of New Hope, Robbinsdale, Golden Valley, and Brooklyn Park: a contribution to Independent School District No. 281 is deemed to have been made in the trade area of the City. If an organization certifies to the City that at least 10% of its net profits have been expended in the trade area of the City for the lawful purposes specified by the City, the payment required by this subdivision need not be made. The contributions to the City required by this subdivision must be deposited by the City in a special City fund which must be administered by the City without cost to the fund.

1102.15. Filing. Organizations conducting lawful gambling in the City must file with the City Clerk copies of records and reports filed with the Board pursuant to Minnesota Statutes, Chapter 349 and the rules and regulations promulgated thereunder.

1102.17. Investigation Fees. An organization applying for or renewing a premises permit to conduct lawful gambling in the City must pay the investigation fee set by Appendix IV to the City Clerk. If the fee is not paid the Council will not approve the permit under Subsection 1102.03.

Sec. 2. Crystal City Code, Subsection 1100.19, is repealed.



Sec. 3. This ordinance is effective in accordance with Crystal City Code, Subsection 110.11 and applies to gambling premises permit applications received after August 1, 1990.

Dated: \_\_\_\_\_, 1990.

\_\_\_\_\_  
Mayor

Attest:

\_\_\_\_\_  
City Clerk

**DAVID J. KENNEDY**  
Attorney at Law

Direct Dial (612) 337-9232

**HOLMES & GRAVEN**

**CHARTERED**

470 Pillsbury Center, Minneapolis, Minnesota 55402

(612) 337-9300

September 7, 1990

Mr. Tom Anzele  
Director  
Charitable Gambling Control Board  
Gaming Division  
Mail Station 3315  
St. Paul, Minnesota 55146-3315

Re: City of Crystal, Minnesota

Dear Mr. Anzele:

I am the City Attorney for the City of Crystal, Minnesota. The City is in the process of amending its City code provisions regarding charitable gambling to conform to the legislative changes in Laws 1990, Chapter 590. The ordinance making these changes will be finally adopted by the City Council at its meeting on September 18. I have enclosed a copy of the ordinance for your information. The City Council has directed me to ask for your reactions to Subsection 1102.03, Subdivision 2 and Subsection 1102.05 of the ordinance.

The ordinance has been prepared based on the following assumptions about the provisions of Chapter 590:

- a) Charitable gambling licenses are issued by the Charitable Gambling Control Board.
- b) Gambling premises permits and bingo hall licenses are issued by the Board.
- c) Section 23 of Chapter 590, relating to premises permit issuance by the Board is effective on January 1, 1991.
- d) Section 37 of Chapter 590, relating to local approval of bingo hall licenses and premises permits, was effective on August 1, 1990.

Subdivision 3 of ordinance Subsection 1102.03, states the City Council's judgement that there is little point in the City reviewing a premises permit application or bingo hall application unless it has some indication that the Board has issued or will issue the permit or license. The Council assumes that the Board will have investigated the applicant (and that the applicant is licensed by the Board) and that the data revealed by that investigation will be made available to the City of its review. Note, too, that because no amendment was made to Minnesota Statutes, Section 349.16, Subd. 4, on local investigation fees, after January 1, 1991 it will not be possible for the City to charge a fee for investigating applicants for charitable gambling premises permits.

It appears to the City that the clear intent of the law is that the eligibility of an organization for a license or a premises permit are matters for the Board to decide. The City must decide whether the conduct of gambling by a licensed organization at a particular premises is permissible under its ordinances and in the City's interest in the general welfare of its citizens. The procedure set out in Subsection 1102.03 of the ordinance reflects that intent and is consistent with the plain language of the statute.

Representatives of licensed organizations have testified to the Council that they have been told informally by representatives of the Board that the Board intends not to consider premises permit applications until the City has approved them. For the reasons stated above the City does not think that is the correct procedure, and it is not the procedure that will be followed under the ordinance when it becomes effective.

I would appreciate any comments you may have on the ordinance provision prior to the September 18 Council meeting.

As for Subsection 1102.06 of the ordinance it merely states the Council's view that there is no reason to consider a premises permit for an organization that is not licensed by the Board nor is there any reason for the Council to duplicate the Board's determination that the applicant is eligible for the premises permit.

Also, I want to point out that because of the differing effective dates discussed above, the City will continue to process license applications as it has in the past until January 1, 1991.

Thank you for your prompt consideration.

Yours very truly,

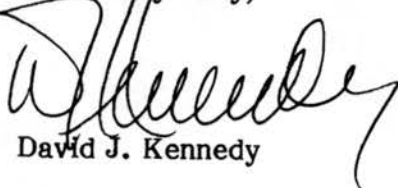
A handwritten signature in dark ink, appearing to read "David J. Kennedy", is written over the typed name.

David J. Kennedy

DJK:caw

cc: Jerry Dulgar, City Manager

**HOLMES & GRAVEN**

**CHARTERED**

470 Pillsbury Center, Minneapolis, Minnesota 55402

(612) 337-9300

**DAVID J. KENNEDY**

Attorney at Law

Direct Dial (612) 337-9232

September 7, 1990

Mr. Tom Anzele  
Director  
Charitable Gambling Control Board  
Gaming Division  
Mail Station 3315  
St. Paul, Minnesota 55146-3315

Re: City of Crystal, Minnesota

Dear Mr. Anzele:

I am the City Attorney for the City of Crystal, Minnesota. The City is in the process of amending its City code provisions regarding charitable gambling to conform to the legislative changes in Laws 1990, Chapter 590. The ordinance making these changes will be finally adopted by the City Council at its meeting on September 18. I have enclosed a copy of the ordinance for your information. The City Council has directed me to ask for your reactions to Subsection 1102.03, Subdivision 2 and Subsection 1102.05 of the ordinance.

The ordinance has been prepared based on the following assumptions about the provisions of Chapter 590:

- a) Charitable gambling licenses are issued by the Charitable Gambling Control Board.
- b) Gambling premises permits and bingo hall licenses are issued by the Board.
- c) Section 23 of Chapter 590, relating to premises permit issuance by the Board is effective on January 1, 1991.
- d) Section 37 of Chapter 590, relating to local approval of bingo hall licenses and premises permits, was effective on August 1, 1990.

Subdivision 3 of ordinance Subsection 1102.03, states the City Council's judgement that there is little point in the City reviewing a premises permit application or bingo hall application unless it has some indication that the Board has issued or will issue the permit or license. The Council assumes that the Board will have investigated the applicant (and that the applicant is licensed by the Board) and that the data revealed by that investigation will be made available to the City of its review. Note, too, that because no amendment was made to Minnesota Statutes, Section 349.16, Subd. 4, on local investigation fees, after January 1, 1991 it will not be possible for the City to charge a fee for investigating applicants for charitable gambling premises permits.

It appears to the City that the clear intent of the law is that the eligibility of an organization for a license or a premises permit are matters for the Board to decide. The City must decide whether the conduct of gambling by a licensed organization at a particular premises is permissible under its ordinances and in the City's interest in the general welfare of its citizens. The procedure set out in Subsection 1102.03 of the ordinance reflects that intent and is consistent with the plain language of the statute.

Representatives of licensed organizations have testified to the Council that they have been told informally by representatives of the Board that the Board intends not to consider premises permit applications until the City has approved them. For the reasons stated above the City does not think that is the correct procedure, and it is not the procedure that will be followed under the ordinance when it becomes effective.

I would appreciate any comments you may have on the ordinance provision prior to the September 18 Council meeting.

As for Subsection 1102.06 of the ordinance it merely states the Council's view that there is no reason to consider a premises permit for an organization that is not licensed by the Board nor is there any reason for the Council to duplicate the Board's determination that the applicant is eligible for the premises permit.

Also, I want to point out that because of the differing effective dates discussed above, the City will continue to process license applications as it has in the past until January 1, 1991.

Thank you for your prompt consideration.

Yours very truly,

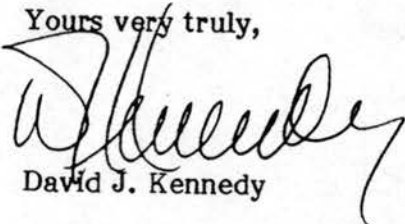

David J. Kennedy

DJK:caw

cc: Jerry Dulgar, City Manager



DATE: September 12, 1990  
TO: Dave Kennedy, City Attorney  
FROM: Bill Barber, Building Official  
SUBJECT: Updating City Code Section 400 - Building Code -  
to reflect current requirements

Would you please take a look at our current City Code adopting the 1987 State Building Code. On July 16, 1990 the 1990 Minnesota State Building Code became effective. If the ordinance can be ready for the September 18 Council meeting, that would be great.

I have enclosed a copy of the composition and use of the State Building Code. If you have any questions, give me a call.

kk

**HOLMES & GRAVEN**

**CHARTERED**

470 Pillsbury Center, Minneapolis, Minnesota 55402

(612) 337-9300

**DAVID J. KENNEDY**

Attorney at Law

Direct Dial (612) 337-9232

September 10, 1990

Mr. Bill Barber  
Building Inspector  
City of Crystal  
4141 Douglas Drive North  
Crystal, Minnesota 55422

Dear Bill:

Enclosed find a draft ordinance for first reading amending the building code section as you requested.

Sec. 2 and Sec. 3 are some editorial matters on other subjects included here for convenience.

Yours very truly,

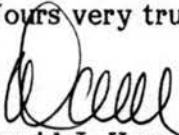

David J. Kennedy

DJK:caw

Enclosure

cc: Jerry Dulgar

ORDINANCE NO. 90-\_\_\_\_\_

AN ORDINANCE RELATING TO CITY GOVERNMENT:  
AMENDING CRYSTAL CITY CODE, SUBSECTION  
400.02, SUBDIVISION 2, CLAUSE a): SUBSECTION  
115.01 AND SUBSECTION 100.07

THE CITY OF CRYSTAL ORDAINS:

Section 1. Crystal City Code, Subsection 400.02, Subdivision 2, Clause a), is amended to read:

a) As provided in the ~~1987~~ 1990 State Building Code, the following are hereby adopted by reference:

- (1) ~~1985~~ 1988 Edition of the Uniform Building Code, identified as "UBC".
- (2) ~~1984~~ 1990 Edition of the National Electrical Code, identified as "NEC".
- (3) American National Safety Code for Elevators, Dumbwaiters, Escalators and Moving Walks, identified as ANSI ~~A17.a-1984~~ A17.1a-1987 and Supplement, ANSI ~~A17.1a-1985~~ A17.1a-1988 and ANSI A17.3-1986.
- (4) Minnesota Plumbing Code, identified in the Minnesota State Building Code as Chapter 1355, ~~1987~~ 1990 Edition.
- (5) Flood Proofing Regulations, June, 1972, Office of the Chief of Engineers, U.S. Army, identified in the Minnesota Statute Building Code as Chapter 1335.
- (6) One and Two Family Dwelling Code, ~~1975~~ 1986 Edition.
- (~~7~~) Minnesota Heating, Ventilation, Air Conditioning and Refrigeration Code, identified in the Minnesota Statute Building Code as Chapter ~~1345~~.
- (~~8~~) (7) 1983 Model Energy Code, identified in the Minnesota State Building Code as Chapter ~~4215~~ 1370.
- (~~9~~) (8) Solar Energy Systems, identified in the Minnesota ~~Statute~~ State Building Code as Chapter 1325.
- (~~10~~) (9) State of Minnesota Manufactured Home Rules, 1983 Edition, identified in the Minnesota Statute Building Code as Chapter 1350.
- (~~11~~) (10) Minnesota Prefabricated Building Code, identified in the Minnesota State Building Code as Chapter 1360.
- (~~12~~) (11) Technical Requirements for Fallout Shelters, identified in the Minnesota State Building Code as Chapter 1330.
- (~~13~~) (12) Variations in Snow Loads, identified in the Minnesota State Building Code as Chapter 1365.

~~(14)~~ (13) ~~1985~~ 1988 Uniform Building Code Appendix Chapter 35 (Sound Transmission Control).

Sec. 2. Crystal City Code, Subsection 115.01 is amended to read:

115.01. General Rule. ~~Any~~ A person who violates a provision of this Code is guilty of a misdemeanor and upon conviction thereof may be punished by a fine of not more than ~~\$500~~ \$700 and imprisonment for a term not to exceed 90 days, or both. Each act of violation and ~~every~~ each day on which a violation occurs or continues is a separate violation.

Sec. 3. Crystal City Code, Subsection 100.07, is amended to read:

100.07. Official Statutes; Codes, Regulations; and Ordinances. References in this Code to Minnesota Statutes are to Minnesota Statutes ~~1986~~ 1988, Minnesota Statutes, ~~1987~~ 1989 Supplement, and Laws of Minnesota ~~1988~~ 1989 unless otherwise provided in this Code. References in this Code to Rules and Regulations of state agencies, codes, and ordinances of other municipalities are to those documents in effect on July 1, ~~1988~~ 1990, unless otherwise provided.

Sec. 4. This ordinance is effective in accordance with Crystal City Code, Subsection 110.11.

\_\_\_\_\_  
Mayor

Attest:

\_\_\_\_\_  
City Clerk

DATE: September 12, 1990  
TO: Dave Kennedy, City Attorney  
FROM: Bill Barber, Building Official  
SUBJECT: Updating City Code Section 400 - Building Code -  
to reflect current requirements

Would you please take a look at our current City Code adopting the 1987 State Building Code. On July 16, 1990 the 1990 Minnesota State Building Code became effective. If the ordinance can be ready for the September 18 Council meeting, that would be great.

I have enclosed a copy of the composition and use of the State Building Code. If you have any questions, give me a call.

kk



**HOLMES & GRAVEN**

**CHARTERED**

470 Pillsbury Center, Minneapolis, Minnesota 55402

(612) 337-9300

**DAVID J. KENNEDY**

Attorney at Law

Direct Dial (612) 337-9232

September 10, 1990

Mr. Bill Barber  
Building Inspector  
City of Crystal  
4141 Douglas Drive North  
Crystal, Minnesota 55422

Dear Bill:

Enclosed find a draft ordinance for first reading amending the building code section as you requested.

Sec. 2 and Sec. 3 are some editorial matters on other subjects included here for convenience.

Yours very truly,



David J. Kennedy

DJK:caw

Enclosure

cc: Jerry Dulgar

ORDINANCE NO. 90-\_\_\_\_\_

AN ORDINANCE RELATING TO CITY GOVERNMENT:  
AMENDING CRYSTAL CITY CODE, SUBSECTION  
400.02, SUBDIVISION 2, CLAUSE a): SUBSECTION  
115.01 AND SUBSECTION 100.07

THE CITY OF CRYSTAL ORDAINS:

Section 1. Crystal City Code, Subsection 400.02, Subdivision 2, Clause a), is amended to read:

a) As provided in the ~~1987~~ 1990 State Building Code, the following are hereby adopted by reference:

- (1) ~~1985~~ 1988 Edition of the Uniform Building Code, identified as "UBC".
- (2) ~~1984~~ 1990 Edition of the National Electrical Code, identified as "NEC".
- (3) American National Safety Code for Elevators, Dumbwaiters, Escalators and Moving Walks, identified as ANSI ~~A17.1a-1984~~ A17.1a-1987 and Supplement, ANSI ~~A17.1a-1985~~ A17.1a-1988 and ANSI A17.3-1986.
- (4) Minnesota Plumbing Code, identified in the Minnesota State Building Code as Chapter 1355, ~~1987~~ 1990 Edition.
- (5) Flood Proofing Regulations, June, 1972, Office of the Chief of Engineers, U.S. Army, identified in the Minnesota Statute Building Code as Chapter 1335.
- (6) One and Two Family Dwelling Code, ~~1975~~ 1986 Edition.
- (~~7~~) Minnesota Heating, Ventilation, Air Conditioning and Refrigeration Code, identified in the Minnesota Statute Building Code as Chapter ~~1345~~.
- (~~8~~) (7) 1983 Model Energy Code, identified in the Minnesota State Building Code as Chapter ~~4215~~ 1370.
- (~~9~~) (8) Solar Energy Systems, identified in the Minnesota ~~Statute~~ State Building Code as Chapter 1325.
- (~~10~~) (9) State of Minnesota Manufactured Home Rules, 1983 Edition, identified in the Minnesota Statute Building Code as Chapter 1350.
- (~~11~~) (10) Minnesota Prefabricated Building Code, identified in the Minnesota State Building Code as Chapter 1360.
- (~~12~~) (11) Technical Requirements for Fallout Shelters, identified in the Minnesota State Building Code as Chapter 1330.
- (~~13~~) (12) Variations in Snow Loads, identified in the Minnesota State Building Code as Chapter 1365.

~~(14)~~ (13) 1985 1988 Uniform Building Code Appendix Chapter 35 (Sound Transmission Control).

Sec. 2. Crystal City Code, Subsection 115.01 is amended to read:

115.01. General Rule. Any A person who violates a provision of this Code is guilty of a misdemeanor and upon conviction thereof may be punished by a fine of not more than ~~\$500~~ \$700 and imprisonment for a term not to exceed 90 days, or both. Each act of violation and ~~every~~ each day on which a violation occurs or continues is a separate violation.

Sec. 3. Crystal City Code, Subsection 100.07, is amended to read:

100.07. Official Statutes; Codes, Regulations; and Ordinances. References in this Code to Minnesota Statutes are to Minnesota Statutes ~~1986~~ 1988, Minnesota Statutes, ~~1987~~ 1989 Supplement, and Laws of Minnesota ~~1988~~ 1989 unless otherwise provided in this Code. References in this Code to Rules and Regulations of state agencies, codes, and ordinances of other municipalities are to those documents in effect on July 1, ~~1988~~ 1990, unless otherwise provided.

Sec. 4. This ordinance is effective in accordance with Crystal City Code, Subsection 110.11.

\_\_\_\_\_  
Mayor

Attest:

\_\_\_\_\_  
City Clerk

Memorandum

DATE: September 4, 1990  
TO: Jerry Dulgar, City Manager  
FROM: Nancy Gohman, Assistant Manager  
SUBJECT: Contract Renewal - Employees Assistance Program

The contract between Metropolitan Clinic of Counseling, Inc. (Employees Assistance Program) and the City of Crystal has expired. The new contract for the EAP for Crystal runs September 1, 1990 through August 31, 1991. I recommend the contract be reviewed by the City Council and approved at their regular City Council meeting of September 18, 1990.

The Employees Assistance Program works with the City to provide problem assessment and short term counseling for all of our employees and volunteer firefighters. This service allows our employees to confidentially seek out counseling for themselves and their family members. The program also allows supervisors to refer their employees to counseling if it is found that personal problems are leading to poor job performance.

The program has benefited many of our employees and families in the 1989-90 contract year. Thirteen employees or family members have used the program during the contract period. The program continues to be a very worthwhile tool for supervisors to use when dealing with employee problems.

I recommend the City Council approve the contract between Metropolitan Clinic of Counseling, Inc. and the City of Crystal for a period of September 1, 1990 through August 31, 1991 at a fee of \$8.50 per employee for a total of \$1,032.00. The price of \$8.50 per employee is the same price we paid for the 1989-90 contract. Money for this program has been budgeted in the 1990 Budget under Account 01-4310-000-32.

attachment

NG/js

STATEMENT OF AGREEMENT  
between  
METROPOLITAN CLINIC OF COUNSELING, INC.  
and  
CITY OF CRYSTAL

This agreement is for the period September 1, 1990 to August 31, 1991. In this agreement the term EMPLOYER refers to CITY OF CRYSTAL, and MCC refers to Metropolitan Clinic of Counseling, Inc.

1. SERVICES. MCC has agreed to provide diagnostic (problem assessment and short-term counseling) and referral services-(motivational counseling, referral to competent care and follow-up) to all employees of the EMPLOYER, and to the employees' dependents and household members.
2. SERVICE AVAILABILITY. Confidential assessment and referral services will be available from any of MCC's eight office locations in the Minneapolis-St. Paul metropolitan area, and two days a week in Northfield. Professional staff at MCC will respond to emergency and after-hours calls on a 24-hour daily basis.
3. ADDITIONAL SERVICES. MCC agrees to periodically provide (at no cost) promotional brochures to maintain employee awareness. MCC agrees to periodically provide to the EMPLOYER a monthly statistical report regarding utilization of the services, and a detailed report at year-end.
4. EMPLOYER REPONSIBILITIES. To assure adequate acceptability and utilization of this program, the EMPLOYER agrees to participate in recommended program exposure and employee education regarding available services. If the EMPLOYER chooses to conduct a mailing to employees, the mailing will be at the EMPLOYER's expense. The EMPLOYER agrees to provide MCC with: a) roster of names of employees covered under this program; and b) copy of current health plan coverages including hospitalization.
5. FEE. The base retainer fee for the agreement period is \$1,096.50. (This fee is based upon the per employee rate of \$8.50 for 129 employees.) The base retainer fee will cover all assessment and referral services up to a 3.0% annual utilization.

The utilization fee will be billed for each one percent (1%) or portion thereof increase in the utilization above 3.0%, in accordance with the following schedule:

<u>Base retainer fee:</u> (3.0% usage)	8.50/employee = \$1,032.00
3.01 - 4.00%	11.34/employee = \$1,462.86
4.01 - 5.00%	14.17/employee = \$1,827.93
5.01 or more + maximum fee	17.00/employee = \$2,193.00

As utilization increases, the above specified amounts will be added to the EMPLOYER's account, and will be integrated into subsequent billings.

Pro-rata adjustments in the retainer fee will be computed quarterly when deviations occur which are greater than five percent (5%) of the original number of employees as stated in this agreement.

Invoices are due and payable within 30 days of invoice date. Past due accounts are subject to 1.5% per month service charge, which is 18% per annum.

  
METROPOLITAN CLINIC OF COUNSELING, INC.

8-26-90  
DATE

CITY OF CRYSTAL

DATE



MEETING MINUTES OF THE CRYSTAL ECONOMIC  
DEVELOPMENT AUTHORITY ADVISORY COMMISSION  
14 AUGUST 1990  
7:00 P.M.  
COMMUNITY ROOM

The Chair called the meeting to order at 7:03 p.m. recognizing a quorum upon the arrival of Paulette Magnuson at 7:05 p.m.. Those members present were: Art Cunningham, Mark Hoffmann (arrived 7:51 p.m.), Paulette Magnuson (arrived 7:05 p.m.), Jane Elsen, Gail Wawrzyniak, Adrian Rygg, Ed Krueger, and Garry Grimes (Council Liaison). Those members absent were: Merle Mattson, Tony Brace, and John Neznik. Staff members present were: John Olson, Assistant City Manager/Community Development Director; and Julie Jones, Community Development Coordinator. The special guest present was: Fred Hoisington, Hoisington Group Inc.

Gail Wawrzyniak moved to approve the July 20 meeting minutes as written. Paulette Magnuson seconded the motion.

Motion carried.

The Chair called upon Fred Hoisington, Hoisington Group Inc., to explain the purpose of the discussion to follow and the intended use of the information received from the Economic Development Authority Advisory Commission. The following questions were asked by Mr. Hoisington and discussed:

1. What does Crystal offer in the way of economic incentives/assets?  
Answer: Tax Increment Financing
2. What kinds of economic development projects have the City of Crystal been involved with in the past?  
Answer: Bass Lake Road TIF District and industrial revenue bonds to Timesavers.
3. A. Which projects have been successful?  
Answer: Bass Lake Road TIF District  
B. Which projects have been failures?  
Answer: Failed Senior HOusing Projects and lack of having a planner on City staff.
4. What are the City's current economic development policies?  
Answer: There are none.
5. What kinds of economic development projects would you like to be able to recommend to the EDA in the future?  
Answer: Require EDA to establish economic development policies.

Mr. Hoisington suggested that the EDA Advisory Commission discuss recommended policies and projects further in the future. Mark Hoffmann moved to direct the Chair to request that the EDA develop an economic development policy for inclusion in the Comprehensive Plan. Jane Elsen seconded the motion. The item was discussed. It was agreed that the Advisory Commission should develop a policy and recommend it's approval to the EDA. Mark Hoffmann withdrew his motion.

Paulette Magnuson moved that the EDA Advisory Commission supply recommendations to the EDA for establishment of an economic development policy. Gail Wawrzyniak seconded the motion. Mr. Hoisington indicated that he would prefer to have an approved economic development policy by October, so that it could be included in the Comprehensive Plan update.

Motion carried.

Under other business Julie Jones distributed copies of EDA Resolution 90-7, a Resolution Relating to the Economic Development Authority Advisory Commission Communication Guidelines. Adrian Rygg moved to request the EDA to delay action on Resolution 90-7 until the October EDA meeting so that the Advisory Commission could have time to review the Resolution at their September meeting. Ed Krueger seconded the motion.

Motion carried.

The Chair declared the meeting adjourned at 9:03 p.m.

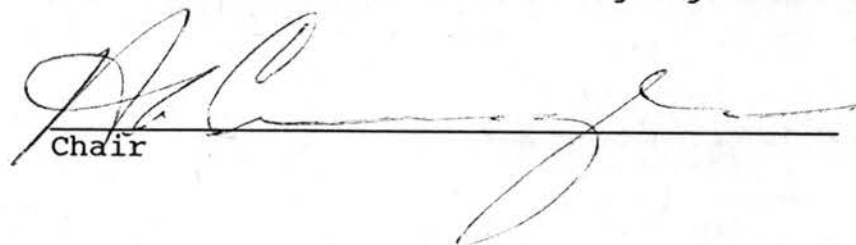
  
Chair

  
Secretary

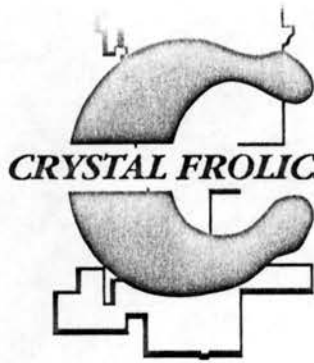

**CRYSTAL FROLICS COMMITTEE** P.O. Box 28074 • Crystal, MN 55428

ED THONANDER, PRESIDENT

September 1, 1990

Dear Crystal Frolics Supporters and Contributors:

I personally want to thank you for your involvement in the 1990 Frolics this year. You have helped to make this year one of the biggest and best frolics ever held.

Those of us who help organize and put the Frolics together know we couldn't do it without your support and contributions - it is truly a community effort. Plans are underway for the 1991 Frolics and we hope we can count on your continuing support.

I would also appreciate any comments - suggestions - criticisms, that you may have, so we can deal with them before the next frolics.

Thanks again.

Sincerely,

CRYSTAL FROLICS COMMITTEE



Ed Thonander  
President

## CITY OF CRYSTAL

1990 EXPENDITURE REPORT AS OF AUGUST 31, 1990

NORMAL %=

66.67%

DEPARTMENT	#	ADOPTED BUDGET AMOUNT	REVISED WORKING BUDGET	PRIOR MONTH YTD EXPENSES	ENCUMBRANCES	CURRENT EXPENDITURES	TOTAL EXPENSES	RATIO	UNENCUMBERED BALANCE
Mayor & Council	10	\$126,670	\$126,670	\$87,380.19	\$200.00	\$4,665.92	\$92,046.11	72.8%	\$34,423.89
Administration	11	\$349,244	\$321,092	\$175,972.16	\$607.90	\$34,543.14	\$210,515.30	65.8%	\$109,968.80
Assessing	12	\$126,382	\$131,140	\$65,309.82	\$0.00	\$13,612.39	\$78,922.21	60.2%	\$52,217.79
Finance	13	\$149,580	\$157,898	\$82,748.38	\$225.96	\$16,090.87	\$98,839.25	62.7%	\$58,832.79
City Buildings	14	\$147,340	\$153,053	\$85,250.75	\$810.00	\$14,827.28	\$100,078.03	65.9%	\$52,164.97
Police	15	\$1,686,964	\$1,768,607	\$930,500.81	\$3,937.10	\$178,266.66	\$1,108,767.47	62.9%	\$655,902.43
Fire	16	\$209,791	\$212,250	\$100,401.79	\$3,076.26	\$17,923.19	\$118,324.98	57.2%	\$90,848.76
Planning & Inspection	17	\$70,202	\$74,565	\$41,292.77	\$0.99	\$7,154.23	\$48,447.00	65.0%	\$26,117.01
Civil Defense	18	\$40,626	\$41,740	\$23,896.20	\$30.00	\$3,143.06	\$27,039.26	64.9%	\$14,670.74
Engineering	19	\$234,631	\$222,349	\$126,975.74	\$0.00	\$21,540.63	\$148,516.37	66.8%	\$73,832.63
Street	20	\$487,534	\$500,805	\$244,491.29	\$2,617.01	\$48,173.71	\$292,665.00	59.0%	\$205,522.99
Park Maintenance	21	\$383,583	\$391,001	\$206,480.74	\$4,566.98	\$44,072.16	\$250,552.90	65.2%	\$135,881.12
Recycling **	22	\$78,859	\$78,859	\$0.00	\$0.00	\$0.00	\$0.00	0.0%	\$78,859.00
Recreation	25	\$480,788	\$483,636	\$264,951.62	\$4,997.42	\$75,921.20	\$340,872.82	71.5%	\$137,765.76
Health	26	\$144,180	\$150,802	\$77,297.38	\$517.00	\$16,230.55	\$93,527.93	62.4%	\$56,757.07
Civil Service	27	\$11,750	\$11,750	\$5,225.79	\$2,200.00	\$375.00	\$5,600.79	66.4%	\$3,949.21
Legal	28	\$142,000	\$140,200	\$77,687.52	\$0.00	\$8,876.41	\$86,563.93	61.7%	\$53,636.07
Elections	29	\$23,475	\$20,975	\$927.88	\$15.00	\$572.49	\$1,500.37	7.2%	\$19,459.63
Swimming Pool	31	\$76,242	\$75,742	\$63,210.39	\$428.82	\$27,913.47	\$91,123.86	120.9%	(\$15,810.68)
Non-Departmental	32	\$1,053,660	\$845,281	\$490,925.78	\$319.00	\$2,983.40	\$493,909.18	58.5%	\$351,052.82
Community Center	33	\$106,203	\$105,532	\$7,541.24	\$495.71	\$13,256.81	\$20,798.05	20.2%	\$84,238.24
Tree Disease	34	\$43,609	\$43,609	\$13,437.16	\$0.00	\$9,768.45	\$23,205.61	53.2%	\$20,403.39
EDA	37	\$22,758	\$73,606	\$59,904.05	\$700.46	\$19,073.68	\$78,977.73	108.2%	(\$6,072.19)
TOTALS		\$6,196,071	\$6,131,162	\$3,231,809.45	\$25,745.61	\$578,984.70	\$3,810,794.15	62.6%	\$2,294,622.24
Recycling Fund #80		\$205,344	\$205,344	\$68,810.35	\$0.00	\$13,866.71	\$82,677.06	40.3%	\$122,666.94
Street Lighting #82		\$108,330	\$108,330	\$61,582.76	\$0.00	\$8,826.56	\$70,409.32	65.0%	\$37,920.68
Utility Fund-#81									
Water	23	\$1,025,829	\$1,025,829	\$335,341.69	\$598.56	\$17,819.36	\$353,161.05	34.5%	\$672,069.39
Sewer	24	\$1,267,029	\$1,267,029	\$791,236.65	\$7,621.42	\$94,325.71	\$885,562.36	70.5%	\$373,845.22
TOTALS		\$2,292,858	\$2,292,858	\$1,126,578.34	\$8,219.98	\$112,145.07	\$1,238,723.41	54.4%	\$1,045,914.61
Water Slide Fund #83		\$0	\$0	\$1,505.62	\$0.00	\$5,482.03	\$6,987.65		(\$6,987.65)

\*\* Salaries, Utilities and Other Expenses for the Water Slide have not yet been recieved or allocated from the Swimming Pool activity. This will be done when the season ends and all bills are in.

## CITY OF CRYSTAL

## SUMMARY OF REVENUES AS OF AUGUST 31, 1990

NORMAL PERCENT =

66.67%

GENERAL FUND - 01 ACCT#		ESTIMATED REVENUE	PRIOR MONTH YEAR-TO-DATE	RECEIPTS CURRENT MONTH	RECEIPTS YEAR-TO-DATE	PERCENTAGE RECEIVED
<b>TAXES</b>						
3011	Current Ad Valorem Taxes	\$2,806,137	\$1,033,081.32	\$0.00	\$1,033,081.32	36.8%
	Homestead Credit	\$0	\$416,095.77	\$0.00	\$416,095.77	
3012	Delinq Ad Valorem Taxes	\$0	\$14,927.84	\$0.00	\$14,927.84	
3013	Penalties and Interest	\$10,000	\$4,261.35	\$0.00	\$4,261.35	42.6%
3014	Forfeited Tax Sale	\$0	\$457.67	\$0.00	\$457.67	
3015	Prepaid Special Assessments	\$0	\$0.00	\$0.00	\$0.00	
	<b>Total Taxes</b>	<b>\$2,816,137</b>	<b>\$1,468,823.95</b>	<b>\$0.00</b>	<b>\$1,468,823.95</b>	<b>52.2%</b>
<b>LICENSES AND PERMITS</b>						
3111	Liquor Licenses On Sale 06/30	\$55,000	\$30,250.00	\$0.00	\$30,250.00	55.0%
3112	Liquor Licenses Off Sale 06/30	\$1,600	\$1,600.00	\$0.00	\$1,600.00	100.0%
3113	Beer & Tavern Licenses 06/30	\$6,000	\$6,603.75	\$0.00	\$6,603.75	110.1%
3114	Club Licenses 06/30	\$2,000	\$3,086.00	\$0.00	\$3,086.00	154.3%
3115	Garbage & Refuse License 06/30	\$1,500	\$2,575.00	\$0.00	\$2,575.00	171.7%
3116	Taxi Cab Licenses	\$150	\$0.00	\$0.00	\$0.00	0.0%
3117	Music Box-Misc Amusements	\$5,600	\$1,672.00	\$0.00	\$1,672.00	29.9%
3118	Food Handling Licenses	\$15,900	\$6,121.25	\$335.00	\$6,456.25	40.6%
3119	Gas Pump & Station Licenses	\$1,400	\$64.50	\$0.00	\$64.50	4.6%
3121	Bowling Alley Licenses	\$1,200	\$0.00	\$0.00	\$0.00	0.0%
3123	Cigarette Licenses	\$1,350	\$120.00	\$0.00	\$120.00	8.9%
3124	Misc Licenses	\$1,600	\$2,269.50	\$20.00	\$2,289.50	143.1%
3125	Billboard-Sign Hangers License	\$1,000	\$954.25	\$66.00	\$1,020.25	102.0%
3126	Plumbing-Gas Licenses & Cards	\$5,000	\$2,714.75	\$90.75	\$2,805.50	56.1%
3127	Sign Licenses 05/15	\$11,000	\$6,538.19	\$0.00	\$6,538.19	59.4%
3128	Tree Trim Licenses	\$600	\$495.00	\$0.00	\$495.00	82.5%
3150	Dog Licenses & Impound Fees	\$5,900	\$2,899.50	\$535.00	\$3,434.50	58.2%
3151	Building Permits	\$40,000	\$32,070.50	\$6,172.17	\$38,242.67	95.6%
3152	Misc Fire Permits	\$0	\$653.00	\$63.00	\$716.00	
3153	Plumbing Permits	\$5,000	\$3,786.85	\$676.50	\$4,463.35	89.3%
3154	Sewer Permits	\$600	\$489.50	\$105.00	\$594.50	99.1%
3155	Water Permits	\$800	\$647.50	\$52.50	\$700.00	87.5%
3157	Driveway Permits	\$500	\$67.50	\$17.50	\$85.00	17.0%
3158	Street Excavation Permits	\$700	\$3,595.00	\$0.00	\$3,595.00	513.6%
3159	Miscellaneous Permits	\$0	\$0.00	\$0.00	\$0.00	
3161	Gas Permits	\$3,000	\$2,591.50	\$305.00	\$2,896.50	96.6%
3162	Burglar Alarm Permits 05/15	\$1,200	\$858.00	\$0.00	\$858.00	71.5%
3163	Mechanical Permits	\$10,000	\$5,667.57	\$381.25	\$6,048.82	60.5%
3164	Sign Permits	\$2,700	\$1,524.50	\$370.00	\$1,894.50	70.2%
3165	Parking Pemits	\$0	\$10.00	\$10.00	\$20.00	
3166	Restaurant Hoods	\$1,200	\$950.00	\$125.00	\$1,075.00	89.6%
	<b>Total Licenses and Permits</b>	<b>\$182,500</b>	<b>\$120,875.11</b>	<b>\$9,324.67</b>	<b>\$130,199.78</b>	<b>71.3%</b>



GENERAL FUND - 01 ACCT#	ESTIMATED REVENUE	PRIOR MONTH YEAR-TO-DATE	RECEIPTS CURRENT MONTH	RECEIPTS YEAR-TO-DATE	PERCENTAGE RECEIVED
STATE SHARED TAXES					
3350 Local Government Aid	\$1,845,183	\$922,591.50	\$0.00	\$922,591.50	50.0%
3351 State Aid Streets	\$3,239	\$102,353.50	\$0.00	\$102,353.50	3160.0%
Total Shared Taxes	\$1,848,422	\$1,024,945.00	\$0.00	\$1,024,945.00	55.4%
OTHER SERVICES					
3500 Miscellaneous Receipts	\$3,000	\$2,853.86	\$212.03	\$3,065.89	102.2%
3501 NWSCC and CAC	\$4,800	\$2,284.20	\$0.00	\$2,284.20	47.6%
3503 Bicycle Licenses	\$400	\$275.00	\$25.00	\$300.00	75.0%
3504 Northern Mayors Association	\$0	(\$6,808.66)	\$3,371.52	(\$3,437.14)	
3511 Special Rezoning App Charge	\$5,200	\$3,775.00	\$400.00	\$4,175.00	80.3%
3512 Sale of Maps-Documents etc	\$200	\$137.80	\$32.00	\$169.80	84.9%
3513 Engineering & Clerical Fees	\$50,000	\$0.00	\$0.00	\$0.00	0.0%
3514 Weed Cutting Charges	\$600	(\$615.00)	\$275.00	(\$340.00)	-56.7%
3515 Filing Fees	\$0	\$0.00	\$0.00	\$0.00	
3516 License Investigations	\$500	\$1,560.00	\$250.00	\$1,810.00	362.0%
3517 Jail & Breathalyzer Tests	\$3,000	\$0.00	\$0.00	\$0.00	0.0%
3518 Electrical Permit Applications	\$0	\$9.50	\$6.00	\$15.50	
3568 Accident Reports	\$1,600	\$1,262.50	\$163.50	\$1,426.00	89.1%
3569 Special Assessment Searches	\$3,000	\$952.00	\$112.00	\$1,064.00	35.5%
3570 Sanitarian Costs & Reimburse	\$85,033	\$9,135.00	\$52,618.80	\$61,753.80	72.6%
3571 Confiscated Funds	\$0	\$35.00	\$0.00	\$35.00	
3580 Recreation Program Receipts	\$171,550	\$100,879.45	\$10,838.70	\$111,718.15	65.1%
3581 Crystal Facilities Used	\$500	\$771.00	\$323.00	\$1,094.00	218.8%
3582 Non-Budget Account	\$0	\$6,937.00	(\$8,407.00)	(\$1,470.00)	
3586 Water Tests	\$0	\$0.00	\$0.00	\$0.00	
3587 Swimming Pool Receipts	\$49,020	\$72,782.11	\$16,113.56	\$88,895.67	181.3%
3588 Community Center Revenue	\$21,000	\$4,273.20	\$3,428.09	\$7,701.29	36.7%
3590 Refunds & Reimbursements	\$115,500	\$200.00	\$7,045.77	\$7,245.77	6.3%
3591 Insurance Refunds	\$0	\$0.00	\$0.00	\$0.00	
3592 Misc Land & Equip Sales	\$43,000	\$81,227.55	\$26,837.14	\$108,064.69	251.3%
3593 Miscellaneous Transfers	\$0	\$0.00	\$0.00	\$0.00	
3594 Building Sub-Rental	\$700	\$540.00	\$0.00	\$540.00	77.1%
3595 Waste Oil Revenues	\$1,500	\$51.90	\$349.77	\$401.67	26.8%
3596 Leased Properties	\$0	\$0.00	\$100.00	\$100.00	
3599 Interest Earned	\$110,000	\$0.00	\$0.00	\$0.00	0.0%
3610 Court Fines	\$210,000	\$70,772.76	\$0.00	\$70,772.76	33.7%
3611 Alarm Charges	\$3,000	\$2,600.00	\$0.00	\$2,600.00	86.7%
3612 Alarm Penalties	\$0	\$42.85	\$0.00	\$42.85	
3630 Forfeited Bail	\$0	\$4,655.00	\$0.00	\$4,655.00	
3772 Donations	\$1,000	\$9,545.76	(\$921.94)	\$8,623.82	862.4%
Total Other Services	\$884,103	\$370,134.78	\$113,172.94	\$483,307.72	54.7%
Previous Year Fund Balance	\$400,000	\$0.00		\$0.00	0.0%
TOTAL REVENUES	\$6,131,162	\$2,984,778.84	\$122,497.61	\$3,107,276.45	50.7%

RECYCLING FUND - 80		ESTIMATED	PRIOR MONTH	RECEIPTS	RECEIPTS	PERCENTAGE
ACCT#		REVENUE	YEAR-TO-DATE	CURRENT MONTH	YEAR-TO-DATE	RECEIVED
3330	County Grants	\$35,765	\$38,220.00	\$0.00	\$38,220.00	106.9%
3500	Misc Revenues	\$0	\$3,754.96	\$3,340.55	\$7,095.51	
3510	Containers, Wheels & Lids	\$0	\$299.42	\$35.88	\$335.30	
3780	Recycling Revenue	\$90,720	\$48,179.79	\$8,645.37	\$56,825.16	62.6%
3781	Recycling Penalties	\$0	\$1,214.87	\$176.42	\$1,391.29	
3782	Recycling Bin Revenue	\$0	\$11,498.67	(\$0.73)	\$11,497.94	
3783	Recycling Bin Penalty	\$0	\$337.06	\$15.47	\$352.53	
3590	Refunds and Reimbursements	\$78,859	\$41,950.27	\$0.00	\$41,950.27	53.2%
	Total Recycling	\$205,344	\$145,455.04	\$12,212.96	\$157,668.00	76.8%

UTILITY FUND - 81		ESTIMATED	PRIOR MONTH	RECEIPTS	RECEIPTS	PERCENTAGE
ACCT#		REVENUE	YEAR-TO-DATE	CURRENT MONTH	YEAR-TO-DATE	RECEIVED
3500	Miscellaneous Receipts	\$0	\$0.00	\$0.00	\$0.00	
3599	Interest Earned	\$35,000	\$0.00	\$0.00	\$0.00	0.0%
3739	Misc Income - Water	\$2,000	\$1,391.37	\$189.00	\$1,580.37	79.0%
3740	Water Sales	\$885,000	\$441,750.21	\$93,014.25	\$534,764.46	60.4%
3741	Penalties Earned - Water	\$17,500	\$9,870.45	\$1,290.64	\$11,161.09	63.8%
3742	Sales of Meters-Horns	\$2,000	\$2,625.75	\$120.00	\$2,745.75	137.3%
3743	Joint Water Commission Reimb	\$15,000	\$0.00	\$12,069.60	\$12,069.60	80.5%
3744	Metro Waste Reimbursement	\$5,200	\$0.00	\$0.00	\$0.00	0.0%
3759	Misc Income - Sewer	\$500	\$0.00	\$0.00	\$0.00	0.0%
3760	Sewer Service Revenue	\$995,000	\$606,555.15	\$120,832.80	\$727,387.95	73.1%
3761	Penalties Earned - Sewer	\$18,500	\$13,768.84	\$1,454.67	\$15,223.51	82.3%
	Total Utility Revenue	\$1,975,700	\$1,075,961.77	\$228,970.96	\$1,304,932.73	66.0%

STREET LIGHTING FUND - 82		ESTIMATED	PRIOR MONTH	RECEIPTS	RECEIPTS	PERCENTAGE
ACCT#		REVENUE	YEAR-TO-DATE	CURRENT MONTH	YEAR-TO-DATE	RECEIVED
3764	Street Lighting Revenue	\$103,683	\$50,642.09	\$10,283.85	\$60,925.94	58.8%
3765	Penalties Earned	\$2,000	\$1,305.84	\$157.85	\$1,463.69	73.2%
	Total Street Lighting Revenue	\$105,683	\$51,947.93	\$10,441.70	\$62,389.63	59.0%

WATER SLIDE FUND - 83		ESTIMATED	PRIOR MONTH	RECEIPTS	RECEIPTS	PERCENTAGE
ACCT#		REVENUE	YEAR-TO-DATE	CURRENT MONTH	YEAR-TO-DATE	RECEIVED
3581	Crystal Facilities Used		\$491.57	\$661.84	\$1,153.41	
3587	Water Slide Revenues		\$21,387.09	\$8,710.01	\$30,097.10	
	Total Water Slide Revenues	\$0	\$21,878.66	\$9,371.85	\$31,250.51	

# Star Tribune

Established 1867

Roger Parkinson Publisher and President  
Joel R. Kramer Executive Editor  
Tim J. McGuire Managing Editor  
Robert J. White Editorial Editor

12A

Monday/September 10/1990

## A license to rent

Licensing rental housing makes sense. Many cities, including some in Minnesota, have done it for a decade or more as a way to keep neighborhoods safe and livable. But only now is Minneapolis, with 90,000 rental units, getting around to joining the flock. The City Council is expected to adopt a licensing ordinance this week. It's about time.

Ninth Ward City Council Member Tony Scallon, the author of the current proposal, offered a similar plan in 1986. That one, which would have licensed landlords, failed. Scallon's new plan would target the properties instead — an approach that appears to be more workable administratively as well as more acceptable politically.

With licensing the city could close an apartment building if the owner failed to correct housing-code violations or — under a tough amendment — allowed loud parties, drug dealing or other disruptive tenant behavior. That would give officials a better way to deal with absentee slumlords and to prevent one deteriorated or carelessly run property from blighting an entire neighborhood.

The proposal has run into less opposition from property owners than from tenants advocates, who fear that closing substandard rental housing would throw low-income people onto the streets, increasing homelessness. It's a legitimate concern.

But experience in cities with rental licensing indicates that the threat of license revocation usually results in the properties being brought into compliance — only rarely do they have to be put out of business. Scallon hopes that the city's 20-year neighborhood revitalization program can provide funding to help landlords meet code requirements or — should it come to that — to provide replacement housing for displaced tenants.

Used that way, the licensing of rental property can be an important part of neighborhood revitalization. It can give responsible landlords great confidence that their own property values will be maintained and it can better assure renters of a decent living environment to which everyone has a right.

Memorandum

DATE: September 17, 1990  
TO: Jerry Dulgar, City Manager  
FROM: Nancy Gohman, Assistant Manager  
SUBJECT: Insurance Refund -- 1988-1990

Attached is information concerning an insurance refund for workers' compensation for 1988 through 1990. **The refund amount is \$53,902.00!**

The City received the workers' compensation insurance refund because our workers' compensation injuries are down. Please forward this to the City Council for their information.

NG/js



**EMPLOYEE BENEFIT ADMINISTRATION CO.**

8441 Wayzata Blvd. Suite 200  
P.O. Box 59143  
Minneapolis, Minnesota 55459-0143  
Phone (612) 544-0311

September 10, 1990

Mr. Jerry Dulgar, City Manager  
City of Crystal  
4141 Douglas Drive North  
Crystal, MN 55422

Dear Mr. Dulgar

The premium adjustments for the periods of 3-4-88 to 3-4-89 and 3-4-89 to 3-4-90 under the Optional Refund Plan selected by the City of Crystal for its workers' compensation coverage with the League of Minnesota Cities Insurance Trust indicates a net refund to the city for two years of \$53,902.00.

Since not all claims have been closed the reserves set will be either excessive or inadequate and your premiums will be adjusted annually as needed.

If you have any questions please contact me.

Sincerely,

EBA Company



Ernest Kallgren  
President

cc: LMCIT

EK:bc



EMPLOYEE BENEFIT ADMINISTRATION CO.  
TRUST ACCOUNT NO. 02  
02 P.O. BOX 59143  
MINNEAPOLIS, MN 55459-0143

MINNETONKA NATIONAL BANK  
1809 PLYMOUTH ROAD SOUTH  
MINNETONKA, MN 55343

204759

75-1524/910

PAY

#02-000665

214659

DATE

September 12, 1990

FIFTY-THREE THOUSAND, NINE HUNDRED, TWO AND 00/100 DOLLARS

AMOUNT

\*\$53,902.00\*

TO THE  
ORDER OF

CRYSTAL

4141 DOUGLAS DR N

CRYSTAL

MN

55422

*Ernest K. Halgren*

CHECK NO.  
214659

88 RETURNED PREMIUM TYPE 4, COVERAGE BEGINNING 03/04/88  
88 RETURNED PREMIUM TYPE 4, COVERAGE BEGINNING 03/04/89

-7289.00  
61191.00

EMPLOYER NO. 02-000665

AMW:RJK

204759

ENCLOSURE

M E M O R A N D U M

DATE: September 18, 1990  
TO: Jerry Dulgar and Council Members  
FROM: Mary Fandrey, Public Health Sanitarian  
SUBJECT: Blue Bell Ice Cream

On approximately August 28, 1990, I noticed a Blue Bell ice cream truck parked in the Crystal Municipal Pool parking lot.

I approached the driver of the truck and informed him that since Blue Bell was not licensed within the City of Crystal, he would not be permitted to sell ice cream within the City. He then asked me what the boundaries of the City were. I tried to basically describe those boundaries to him but then told him he would be much better off obtaining a map at Crystal City Hall. I then gave him directions on how to get to City Hall and told him to ask for a map.

In addition, I told the driver that if we were to find him selling ice cream within the boundaries of the City, we would issue a court citation to him.

Blue Bell management may be contacting Council members for further information on Crystal's licensing policies and procedures.

MEF:jt



**MINNESOTA  
HOUSING  
FINANCE  
AGENCY**



September 14, 1990

The Honorable Betty Herbes  
MAYOR  
City of Crystal  
4141 Douglas Drive North  
Crystal, MN 55422

Dear Mayor Herbes:

The Minnesota Housing Finance Agency (MHFA) is pleased to announce a program award to the City of Crystal under the Neighborhood Preservation Loan Program.

Funding totaling \$4,230,520 has been approved by the Board of the MHFA. A total of 17 neighborhoods representing 10 cities have been selected to receive Agency funding with terms and conditions which, when added to other matching funds, amounts to \$35,196,695 to be used for neighborhood preservation.

The Neighborhood Preservation Loan Program is designed to help cities preserve neighborhoods by providing home improvement financing for rental and owner-occupied housing. The program was recommended by the Governor's Commission on Affordable Housing for the 1990's and approved by the Legislature in 1989. The program is funded with \$10 million from the proceeds of taxable and tax exempt bonds.

For the City of Crystal, the MHFA Board has approved a commitment of \$80,000 for the 42nd, Douglas and West Broadway areas. Loans originated in this area, in combination with other funds, will result in \$225,000 to be used to rehabilitate 15-20 single family homes; acquire and demolish 1-2 houses; and begin construction of 1-2 new homes through Minnesota Communities Program.

We look forward to continued cooperation from your staff in making this important housing improvement program available to the neighborhood. If you have any questions or would like additional information about the program, please contact me at 296-5738, or Greg Baron, Program Coordinator at 297-3123.

Sincerely,

  
James J. Solem  
Commissioner

# **INFORMATIONAL HANDOUT ON LIGHT RAIL TRANSIT**

**Prepared by the  
Regional Transit Board**

**for the  
CRYSTAL CITY COUNCIL**

**Tuesday, September, 18, 1990  
Crystal City Hall  
4141 Douglas Drive, Crystal, MN**



REGIONAL TRANSIT BOARD

Mears Park Centre  
230 East 5th Street  
St. Paul, Minnesota 55101  
612/292-8789

September 18, 1990

**To the members of the  
Crystal City Council:**

Thank you for your interest in regional light rail transit (LRT) for the metropolitan area. By becoming more familiar with LRT planning, you can make informed decisions about this important transit option that is now being planned for the Twin Cities region.

Planning for LRT in the Twin Cities metropolitan area has been underway for more than ten years. The process involves all levels of government: local, county, regional, state and federal. Citizens' input is also vitally important.

In 1989, the Minnesota State Legislature designated the **Regional Transit Board (RTB)** as the region's coordinating agency for developing LRT. But even though the RTB serves as the chief coordinator of all LRT planning, the responsibilities of researching, planning, building and operating LRT are shared among several entities. The *county regional railroad authorities (CRRAs)* in each of the seven metropolitan area counties, the *RTB Joint LRT Advisory Committee*, *Metropolitan Council*, and *Metropolitan Transit Commission* are key players.

By having a cooperative LRT planning process, the seven-county metropolitan region will have an LRT system that serves in the public's best interest.

I urge your support of this project and I welcome the opportunity to discuss LRT with you more. Please contact my office at your convenience.

Again, thank you for your time and attention at today's committee meetings. I appreciate your consideration of this worthy transportation investment for Minnesota.

With warm regards,

Michael Ehrlichmann  
Chair  
Regional Transit Board



*"Light rail transit is a metropolitan electric railway system characterized by its ability to operate as single cars or short trains along exclusive rights-of-way at ground level, on aerial structures, in subways, or, occasionally, in streets and to board and discharge passengers at track or car-floor level."*

- definition of LRT from the  
National Transportation Research Board

# Reasons for Implementing Regional LRT

The current regional transit system lacks a method of rapid transit for moving high volumes of people. Over the past two decades, research conducted on all levels of government has consistently shown that LRT is a rapid transit method suited for the Twin Cities metropolitan area. There are several major reasons why.

## **Growing travel demands from a growing population -**

While other states lose residents, Minnesota gains them. The U.S. Census Bureau reports that Minnesota, largely because of the Twin Cities area, is the only midwestern state that keeps pace with the national growth rate. That's not too surprising. The Twin Cities area frequently appears in "Top Ten" lists of American cities for the positive aspects of life, work, and recreation that is available here. Some 2.3 million people live in the seven-county metropolitan area, but as the population grows, travel demands will also increase. That's why the regional transit system must keep pace with population growth. A three-car LRT train can easily move up to 500 people per trip. That's the almost as much as seven buses at full capacity. LRT is most successful when it travels major routes, while buses and other transit vehicles bring passengers to key LRT locations.

## **Relieves traffic congestion -**

Local roadway travel is increasing at an average annual rate of about 4 percent. LRT can play an important part in relieving auto and bus congestion; particularly during peak rush hours. A three-car LRT train has the capability of replacing between 350 and 400 automobiles. LRT also has the proven ability of attracting riders who would normally drive to work. That's because LRT is reliable, provides a quality ride, and significantly decreases travel time in comparison to buses and cars during peak hours. Many LRT passengers may still need their cars to get to LRT stations; however, motorists will find the convenience of "park and ride" lots and passenger drop-off points an appealing quality of LRT system design.

## **Better for the environment -**

LRT is more beneficial for the local air quality than the growing number of motor vehicles. Each internal combustion engine on area freeways is an individual source of pollution. On the other hand, electricity for LRT is generated from power plants which are under stringent federal regulations regarding air quality regulations. It's much easier and more cost-effective to clean the effluent of a large, centralized source such as a power plant, than the emissions of thousands of motorized vehicles in the metropolitan area. An enjoyable side benefit is that electricity makes LRT's ride pleasantly quiet.

## **Decreases regional dependency on petroleum fuels -**

LRT's use of electricity reduces the public transit system's dependency on petroleum fuels, which will help the metropolitan region and state in times of low fuel supply. The savings can translate into millions of gallons in fuel for the region each year.

### **Accessibility -**

Regional LRT will be accessible for people who have limited mobility, such as senior citizens, those with small children, and persons with disabilities. The method chosen for LRT in the Twin Cities area is the "high platform loading option" where the station platform is level with the floor of each light rail vehicle. This feature will eliminate the need to climb steps in order to board LRT.

### **All-weather reliability -**

During bouts with Minnesota's harsh weather, riding LRT is a safe and reliable transportation alternative. Unlike cars and buses, LRT isn't seriously impeded by a sudden burst of December snow, the icy conditions of February, or slick road surfaces caused by an April rainstorm. LRT's steel-wheels-on-rail are dependable all year long and in any weather condition.

### **LRT development helps focus retail, office and residential development -**

LRT can complement existing or planned developments. The close proximity of LRT can positively influence customer traffic. Likewise, the convenient, nearby location of an LRT station can increase residential real estate values. Many people will think LRT is a desirable feature for their neighborhoods, especially when LRT is attractively designed to enhance local surroundings.

### **Affordability and cost-effectiveness -**

LRT is practical and cost-effective investment for Minnesota. Average construction costs for an LRT line in the Twin Cities metropolitan area would vary from \$12 million to \$36 million per mile, which includes the right-of-way guideway, rails, electrification, stations, vehicles and maintenance facilities. This compares with the most recent metro area freeway project, Interstate 394, which averaged about \$40 million per mile. LRT is more cost-effective than an all-bus system in moving large numbers of people. This is because LRT is less labor intensive. One LRT driver can move up to 500 passengers. In the long-term, LRT's construction costs can be recovered through the savings in annual operating costs.

And there are more reasons why LRT is a transit option that is needed in the seven-county metropolitan area. Construction is adaptable to the surrounding environment. As proven elsewhere, LRT enhances ridership on existing transit; thereby increasing the regional transit system's farebox recovery rate. But most importantly, the addition of LRT will bring the metropolitan area a balanced transportation system that gives people choices.

*\* Traffic increase estimates from the Metropolitan Council.*

## Benefits of LRT

- Reduces freeway congestion to more manageable levels
- Runs reliably in all types of weather
- Runs on electricity, which reduces air pollution, helps conserve petroleum fuels, and moves large numbers of people with high energy efficiency
- Provides a smooth, excellent quality ride
- Reduces noise levels in downtowns and neighborhoods
- Reduces travel time between destinations at speeds of up to 55 mph
- Improves mobility for those who are dependent on public transit
- Provides easy and convenient access for persons with disabilities, seniors, and those with small children via "high platform loading option" (no steps)
- Higher farebox recovery than other public transit option, requiring less public operating subsidy per passenger
- Improves suburb-to-suburb bus service by integrating the bus system and LRT and providing additional services through feeder buses
- Carries more people with a single operator than buses, reducing operating costs
- Costs less per mile than equivalent increases in highway construction
- Facilitates business development by directing and stimulating consumer traffic

# Environmental Study Finds Transit Is a Solution

Transit is a reappearing solution to a glut of environmental calamities which are threatening twentieth century mankind, according to the findings of a recently released public policy study.

The report, entitled "Project 88—Harnessing Market Forces To Protect Our Environment: Initiatives for the New President," was sponsored by U.S. Sen. John Heinz (R-Pa.) and U.S. Sen. Timothy Wirth (D-Colo.). The senators considered that the new Administration and new Congress could use a document cataloguing the mounting environmental hazards and recommending the best, most cost-effective means of addressing them.

A group of more than 50 persons from academia, private industry, environmental organizations, and government contributed to the report's 36 recommendations which are designed to "increase environmental protection and economic productivity by providing incentives for business and individuals to go beyond what regulators can require."

The paramount conclusion reached by the group was the overwhelming degree to which most environmental problems are inter-related, and to which the most effective policies can be applied to address multiple problems simultaneously. "For example, the comprehensive energy-efficiency program we advocate will help fight global warming, acid rain, and local air pollution, while strengthening U.S. energy security and international competitiveness," reads the report's introduction.

The report identifies global climate changes attributed to the greenhouse effect, as the "single most important environmental threat our planet has faced since the beginning of the industrial revolution . . . Short of nuclear war, it is difficult to imagine a more sweeping transformation of the Earth as we know it."

According to the report, the most common of the greenhouse gases, CO<sub>2</sub> currently is increasing in the atmosphere by .50% per year. It is expected to account for over 50% of total global warming. The major man-made source of atmospheric CO<sub>2</sub> is fossil fuel combustion.

(See Study, page 8)

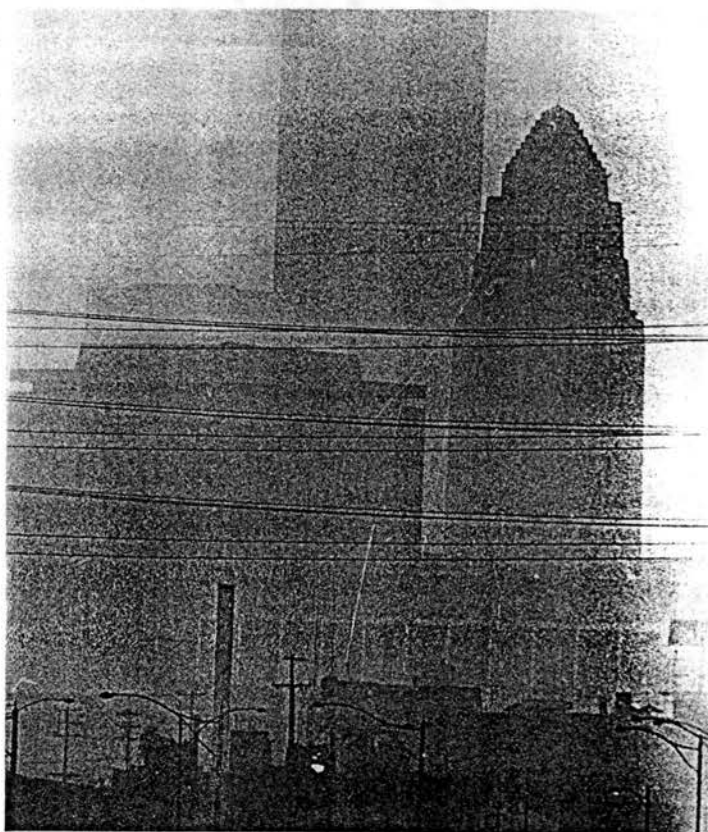

AP/WIDE WORLD PHOTOS

THE 'PROJECT 88' REPORT concludes that transit is a reappearing solution to the mounting environmental hazards facing mankind.

## Study

(From page 1)

"Project 88" offers that current fossil fuel energy production and consumption may well be inefficient because of widespread subsidization of energy consumption in general, and because of the failure of market prices for energy to reflect the true social costs of use (including environmental costs associated with global warming).

Therefore, the study concludes that more efficient energy use and demand management is essential to slowing the accumulation of greenhouse gases—the ultimate priority set by the study group.

Necessary to address this priority are innovative means of reducing vehicular emissions and vehicle miles traveled. Recommended long-term measures are increasing the use of mass transit and better land-use planning. Stated short-term approaches are the use of van pools and fleet conversions to "clean" fuels such as alcohol or natural gas.

The strengthening or initiation of incentive approaches also should be considered. For example, the study offers, a firm could earn environmental "brownie" points from the federal government by facilitating increased reliance on mass transit instead of automobile commuting.

While addressing environmental concerns, greater energy efficiency would en-

hance the nation's security and trade deficit, the study shows. Oil imports have grown 12% since the early 1970s and today account for approximately 25% of the U.S. trade deficit. The report adds that the overall supply of the world's oil is influenced greatly by production from the Persian Gulf, which it categorizes as a "region of chronic political instability."

## L.A. Metro Carries 19,000 in One Day

LOS ANGELES, CALIF.—Metro Blue Line trains carried 18,850 passengers Aug. 21, the highest one-day weekday volume since revenue operations began on Aug. 1.

This brings Blue Line ridership to 340,416 since fares have been charged and over 1.01 million passengers since the light rail began service July 14 between Long Beach and Los Angeles.

A total of 670,000 people sampled the Blue Line during the free ride program July 14 through July 31.

"We are very pleased that the public has

received the Blue Line so favorably," said Nick Patsaouras, Southern California Rapid Transit District board president. "To us, this signals that we are providing safe, clean, and efficient service to those along the Blue Line corridor who have long been seeking answers to better transit."

SCRTD personnel are along the route at each of the 17 stations to assist passengers in purchasing tickets from the automated vending machines. On Sept. 1, four additional stations in the Long Beach Loop opened.



# Pittsburgh's 'T' Is Attracting Developers

## City Center To Be Built above 'T' Station

PITTSBURGH, PA.—Opened in May 1987, the Port Authority of Allegheny County's Stage I Light Rail Transit System—The "T"—continues to attract more than riders. It's attracting developers as well.

Since construction of PAT's 1.10 mile downtown subway started in 1982, developers have been scurrying to locate their new buildings in close proximity to one of PAT's downtown stations. In fact, of 10 buildings constructed in downtown Pittsburgh over the past decade, seven of them have been built adjacent to, across from, or directly above one of the four downtown "T" stations.

Newest among the developments is Pittsburgh City Center—a \$500 million project which will be built directly above the Steel Plaza Station and is said to be one of the largest developments at a single transit station in the United States outside of Manhattan.

"The station will be nothing less than the Grand Central Station of Pittsburgh," said John Lightbody, managing director of Pittsburgh City Center. "I think you'll see one of the biggest tourist attractions Pittsburgh has ever seen."

Mr. Lightbody compares Pittsburgh City Center to such projects as Tower City Center in Cleveland, Eaton Center in Toronto, Ont., and Copley Plaza in Boston.

Pittsburgh City Center officials believe their complex could attract 100,000 people each weekday and 120,000 on weekends. That could translate into thousands of additional riders for PAT's 22.50 mile light rail transit system which currently carries approximately 36,000 riders each weekday—well ahead of projections.

Development also is occurring near other stations along the "T" as well as along PAT's Martin Luther King Jr. East Busway, a 6.80 mile transit exclusive roadway which connects the city's eastern suburbs and east end neighborhoods with downtown Pittsburgh.

Since the Martin Luther King Jr. East Busway was opened in 1983, commercial and residential developments have also occurred along the right-of-way and near stations, helping to transform once stagnant communities into more vibrant shopping and residential areas.

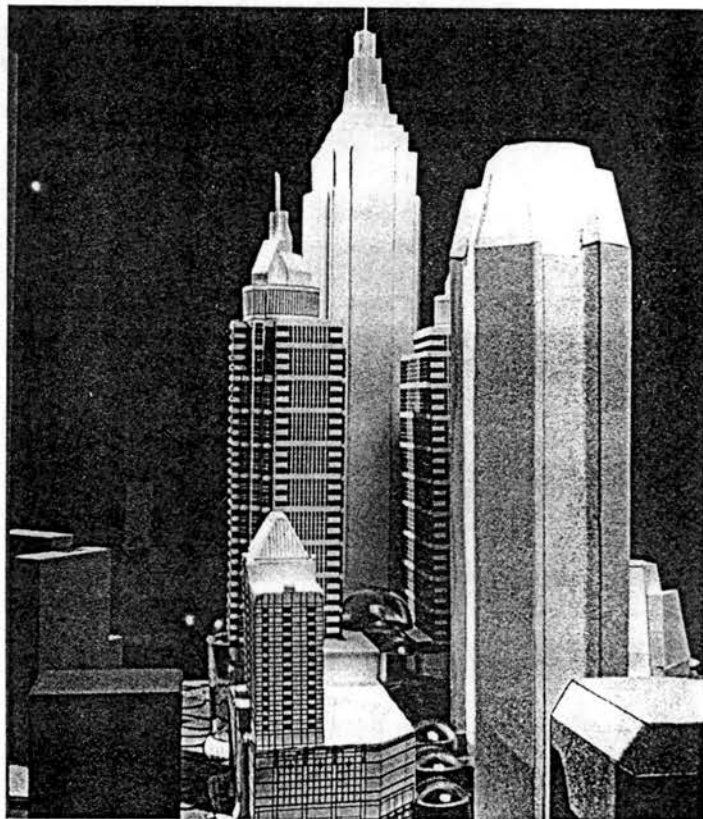

PAT'S Stage I Light Rail Transit System is attracting developers as well as riders. The photo shows a model of the \$500 million Pittsburgh City Center, which is to be built above PAT's Steel Plaza "T" Station. The domed-glass area will be the entrance to PAT's "T" station.

## LACTC Proposes New Half-Cent Sales Tax To Fight Gridlock

LOS ANGELES, CALIF.—The Los Angeles County Transportation Commission has voted to draft an ordinance on a new half-cent sales tax initiative for public transit that would appear on the November 1990 ballot. The measure, called the Anti-Gridlock Transit Improvement Fund, would increase Los Angeles County's sales tax from 6½¢ to 7¢ and generate \$400 million a year for improved public transit.

The funds would be distributed as follows:

- 40% for expanded and improved rail and bus service, including providing low polluting buses;

- 5% for expanded rail and bus security;
- 10% for increased mobility and reduced congestion through commuter rail and the construction of transit centers, park-and-ride lots, and freeway bus stops;

- 25% to provide essential county-wide transit-related improvements on freeways, streets, and highways through computerized traffic signals coordinated with "Smart Street" corridors; and traffic system management programs, which would include tow service patrols, and emergency response

teams for major incidents; and

- 20% for a Local Return Program for cities to improve their local road conditions and for transit services.

Los Angeles County has a cap of 7¼¢ on local sales tax. The County Board of Supervisors is also placing a half-cent sales tax measure on the same November ballot to raise funds for jail construction.

"The LACTC believes the voters should be given an opportunity to express their preference on whether to increase the sales tax and for which purpose," said Neil Peterson, LACTC executive director. "By placing both measures on the November ballot, the voters will have a choice."

"The money from the new half-cent sales tax would put the county on a fast-track to fight gridlock, air pollution, and our dependence on foreign oil," said Mr. Peterson. "The funds generated by Propositions 111 and 108 are being put to work to expand and improve highways, and build rail lines both locally and statewide. Not all our county mobility needs are being met," he said.

## Light Rail Extension Opens in San Jose

SAN JOSE, CALIF. — Santa Clara County's light rail system was extended farther into San Jose on Aug. 17, bringing light rail to a residential area for the first time. The new addition connects South San Jose residents with downtown San Jose, North San Jose, and Santa Clara worksites and future CalTrain service.

According to ridership statistics compiled by the Santa Clara County Transportation Agency, light rail ridership has steadily increased during the short time it's been in operation. When the first light rail station opened in December 1987, less than 1000 people rode the rails each day. Today, the number of daily riders has jumped to over 10,000—a 900% increase in just three years. With the new extension to the residential area, ridership is expected to increase even more.

The two-mile extension (opening nearly 11 weeks ahead of schedule) is part of SCCTA's 20-mile Guadalupe Corridor Project Light Rail System, one of the longest to be built in the U.S. in 50 years. With the opening of the Tamien Station and its two sister stations (Technology Center and Virginia Street), the county now has 12 miles of light rail in operation. The remaining eight miles of rail will be complete by summer 1991.

Funding for the \$550 million Guadalupe Corridor Project was provided through the joint efforts of several public agencies including: UMTA, the state of California, the county of Santa Clara, and the cities of San Jose and Santa Clara. Santa Clara County received its funding through the monies generated by the one-half cent county sales tax earmarked for transportation projects.

Tamien Station opening festivities began with welcoming remarks by Rod Diridon, chairman of the Santa Clara County Transit District Board of Supervisors, followed by comments from U.S. Rep. Norm Mineta (D-Calif.) and other state, federal, and local dignitaries. To formally open the neighborhood line, local residents and city officials joined together to cut the long

(See San Jose, page 8)



THE OPENING of the Tamien Station (and its two sister stations) marks the first time light rail service has been extended to a San Jose residential neighborhood.

## San Jose

(From page 1)

ceremonial ribbon that stretched from one end of the station to the other. Upon the cutting of the ribbon, event participants were treated to a spectacular display of daytime fireworks. A large neighborhood block party and barbecue, complete with gifts, music, and free rides all weekend on light rail and historic trolleys, highlighted the day's activities.

The Tamien Station received its name in recognition of the area's rich history as the site of a native American village. When Spanish explorers first traveled through the valley in the 1770s, they reportedly encountered many villages along the Guadalupe River. Mission Santa Clara records noted this area as "Tamien." During the construction of the new station, the remains of an early native American village were found.

Through the efforts of archaeologists and the local Ohlone Indian Council, the lifeways of Tamien's ancestors are being recorded so future generations of Santa Clara County residents can learn about the rich cultural history.



### 'On the Count of Three, Everybody Cut'

LOCAL residents and dignitaries join together to cut the long ceremonial ribbon that stretched from one end of the station to the other during the Tamien Station opening festivities.



## Maryland Ready To Proceed With 4.5 Mile Light Rail Line

ANNAPOLIS, MD.—Maryland Gov. William Donald Schaefer has announced that the state is ready to build a \$70 million trolley line linking Bethesda to Silver Spring if Montgomery County officials can overcome any local opposition to the proposal.

The 4.50 mile transit line, to be built along a portion of an abandoned CSX Corporation rail line that links Silver Spring to Georgetown, would affect approximately 30,000 households. Montgomery County

purchased the rail line last year for \$10 million.

Gov. Schaefer's proposal came with the announcement of a \$100 million transportation program. The proposal also included funds to start Ride-On bus service in Prince George's County and extending service on two Washington Metropolitan Area Transit Authority Metrorail lines in the county.

Some residents along the proposed transit line say there will not be enough riders to justify the line's expense and the disruption to their neighborhoods. Others fear the line will just lead to more development and not fewer cars on the area roads.

Proponents of the line say traffic will be reduced along the East-West Highway with nearly 18,000 to 20,000 daily riders attracted to the new transit line.

Gov. Schaefer said, "I'm hoping that the people over there will see the difficulty in moving people" and decide to go ahead with the trolley's construction. If not, he said, "then we'll go elsewhere."

Montgomery County officials hope that Gov. Schaefer might be willing to look for an alternate line if this does not go through, but Gov. Schaefer said, "There's no guarantee that we would be able to find another line over there (Montgomery County) ... so it's going to be up to Montgomery County."

A decision is expected in a few months by the Montgomery County Council, then it will go on to the state legislature.

## Washington Metrorail Funding Bill Introduced in Congress

A reauthorization bill to finance construction of the final sections of Washington Metropolitan Area Transit Authority's 103-mile Metrorail system was introduced March 16 in Congress.

The bill is sponsored in the Senate by Sen. Paul S. Sarbanes (D-Md.), with Senators John Warner (R-Va.), Barbara A. Mikulski (D-Md.), Charles S. Robb (D-Va.), and Jim Sasser (D-Tenn.) as cosponsors. House sponsors include U.S. Representatives Ronald V. Dellums (D-Calif.) and Stanford E. Parris (R-Va.), and Delegate Walter E. Fauntroy (D-D.C.), and Representatives Steny H. Hoyer (D-Md.), Frank R. Wolf (R-Va.), Constance A. Morella (R-Md.), Thomas McMillen (D-Md.), Alan Wheat (D-Mo.), and Fortney H. (Pete) Stark (D-Calif.).

"As the transit system for the nation's capital, Metro has a unique and special relationship with the federal government that began in the 1950s and continues today," said Carmen E. Turner, Metro general manager. "In our initial legislation, Congress and the President recognized that Metro was essential for effective government and for preserving the beauty and dignity of the nation's capital. We believe Metro provides the quality transportation that the President and Congress envisioned."

The proposed legislation, which authorizes \$2.16 billion in federal contributions, amends the National Capital Transportation Act of 1969 which provides for con-

struction of a rapid transit system for the nation's capital. Seventy miles of the system and 64 stations are currently in operation. Another 19.50 miles and 12 stations are under construction.

"This reauthorization bill is consistent with the original intent of the region in partnership with the federal government to have a rapid rail system that serves our federal workforce, our local residents, and the millions of visitors who come here every year to enjoy the nation's capital," Mrs. Turner said.

However, both Transportation Secretary Samuel K. Skinner and UMTA Administrator Alfred A. DelliBovi questioned the availability of the funds in a recent interview with the *Washington Post*.

"I don't know where you're going to get more than \$2 billion to build the Green Line in a country that desperately needs to start rebuilding its infrastructure," said Secretary Skinner. "It would be difficult for this administration to justify a heavy federal involvement in that program when there are so many crying needs across the country."

Mr. DelliBovi said, "I believe it is totally unrealistic ... This country faces a great budget crisis and there are many competing needs." He said that WMATA does not deserve its own congressional authorization while other cities have to compete for a shrinking pool of federal funds.

## California Proposes Rail Bond Issue

SACRAMENTO, CALIF.—California legislators have proposed a \$1.50 billion bond issue to finance an array of commuter and intercity rail projects.

The bill reportedly would place the general obligation bond issue on the June 1990 ballot. In an effort to attract widespread support, the bill will specify the projects that would be eligible for the funds.

Intercity projects would include extensive upgrading of the Los Angeles-San Diego line and expanded service between the Bay Area and Sacramento.

New commuter services would include lines between San Bernardino and Los Angeles; between San Bernardino-Riverside and Orange County; and along the Ventura-San Fernando-Los Angeles corridor.

## Los Angeles Survey Shows Support For Anti-Gridlock Tax Increase

LOS ANGELES, CALIF.—Strong support among Los Angeles County registered voters exists for a half-cent sales tax increase to combat gridlock, according to a recent survey commissioned by the Los Angeles County Transportation Commission.

Based on the survey of 1008 randomly selected registered voters, LACTC found that two-thirds say they would vote for a ballot proposition to increase county-wide taxes to fund commuter rail transit, street, and highway improvements.

LACTC is investigating ways to fund the implementation of projects identified in its street and highway improvement plan, "On the Road to the Year 2000," released in 1987. Faced with a \$1.50 billion deficit by 2000 to construct needed freeway improvements, \$111 million deficit each year for street maintenance, and \$39 million annual shortfall to coordinate signal timing, LACTC is studying various ways of raising funds of which a tax increase is one.

Two years ago, the state legislation authorized counties to place local-option sales tax measures on the ballot. Since then Alameda, Contra Costa, Fresno, Riverside, Sacramento, San Benito, San Diego, San Mateo, and Santa Clara counties have approved such plans. Ventura, Orange, and San Bernardino counties are considering initiatives.

LACTC has made no decision as yet whether to pursue a ballot measure. At present it is discussing the results of the

survey with key elected officials and community groups.

The half-cent sales tax increase would amount to approximately \$350 million a year.

The voters surveyed were asked specifically if they would support the tax to fund programs and projects identified in a proposed expenditure plan. The proposed expenditure plan identified in the survey would:

- raise the sales tax by one half cent—for a total 7¢ tax on each dollar of taxable purchases—for a period of 20 years;
- spend 15% of the money to develop and operate passenger railroad service on existing rail lines;
- spend a proposed 55% of the money to be used to widen freeways, improve interchanges, install computer systems to coordinate signals, create emergency response teams to clear freeway truck accidents, and create tow service patrols; and
- provide 30% of the money to the county and its 86 cities to fill potholes and maintain all streets and traffic signals.

The survey revealed that the strongest reasons for supporting the tax was people's desire to reduce their travel time, improve the response time of emergency vehicles, and raise money locally thereby allowing Los Angeles County to control the money, and determine how it would be spent on local street and highway projects.

## Boston Funding Approved To Study Commuter Rail Service Extension

BOSTON, MASS.—Massachusetts Bay Transportation Authority announced that funding has been approved to carry out an Alternatives Analysis/Draft Environmental Impact Statement for extension of MBTA commuter rail service to Rowley and Newburyport.

An earlier MBTA study had investigated the feasibility of extending commuter rail service to Newburyport, a distance of nine miles. MBTA currently operates commuter rail service between Boston's North Station and Ipswich and has plans to extend that

service to Rowley and Newburyport. Completion of the 18 month, \$1.10 million study will advance the project to the preliminary design phase.

The state's Transportation Bond Bill, signed by Gov. Michael S. Dukakis in April 1988, includes \$12 million, or 50% of the funds required to construct the project. With the completion of the AA/DEIS, UMTA will be asked to fund the rest.

Commuter rail service to Newburyport was discontinued in 1976 due to low ridership.

## Bikes Travel on Santa Clara Light Rail

SAN JOSE, CALIF.—Santa Clara County Transit is encouraging riders to bring their bicycles aboard the district's light rail vehicles.

The Bikes On Light Rail Program is attracting both recreational riders and bicycle commuters, who include the nine miles of light rail service in their cycling routes. Normally, two bicycles per car are allowed during the weekday morning and afternoon

commute, and four per car at other hours.

Bicyclists can arrange group trips by calling the district's Customer Service Department in advance. Riders with bicycles must be 16 years or older, or accompanied by an adult.

The district now is considering allowing bikes on some bus routes. A year-long test project is being conducted on one of County Transit's 77 bus routes.