



Horticultural Society: Letters Received and Sent

Copyright Notice:

This material may be protected by copyright law (U.S. Code, Title 17). Researchers are liable for any infringement. For more information, visit www.mnhs.org/copyright.

MINNESOTA BOARD OF MANAGERS

FOR

THE WORLD'S FAIR, ST. LOUIS

THE LOUISIANA PURCHASE EXPOSITION

C. S. MITCHELL, SUPERINTENDENT

Lake City, Minn.

June 11, 1904.

A. W. Latham, Esq.,

207 Kasota Bldg.,

Minneapolis, Minn.

Friend Latham:-

Your of the 9th with vouchers received. I have O. K.-ed them and sent them on to Mitchell. He has taken a new wife and I suppose is now on duty at the Fair.

Very truly yours,



Vice-President.

MINNESOTA BOARD OF MANAGERS

FOR

THE WORLD'S FAIR, ST. LOUIS

THE LOUISIANA PURCHASE EXPOSITION

C. S. MITCHELL, SUPERINTENDENT

Lake City, Minn.

July 7, 1904.

A. W. Latham,
207 Kasota Bldg.,
Minneapolis, Minn.

Friend Latham:-

Replying to your favor of the 6th. I also received a letter from Mr. Hamlin making similar recommendations with regard to changing the door in the booth. I had thought and talked of this before but felt that we might not have apples enough to keep up the exhibit if there was any more shelf room. I have had it in my mind that in the fall just after we make our exhibit at the State Fair and when there was plenty of apples, we might go down there and make a considerable change in the exhibit, introducing the tree or perhaps something better. We are going to put up an exhibit at the State Fair that I think will be a winner and we may want to reproduce it in St. Louis. I do not like the suggestion of yours of introducing the cannon as that was used at Buffalo. If we can save enough money out of the appropriation to put up the tree, change the door to the back besides the post and fix the front where the door now is leading up to the tree in an attractive way, I think that it would make a decided improvement, or if we can put up the design that we will use at the State Fair of a tower and windmill. As I understand it, by being economical you will have enough fruit to keep the exhibit going about as it is until we get new fruits.

it I will counsel with the other members of the Commission regarding and will probably see you in the near future.

Cordially yours,



Vice-President of Minn. Board.

CONDE HAMLIN, PRESIDENT

J. M. UNDERWOOD, VICE-PRESIDENT

THEO. L. HAYS, SECRETARY

MINNESOTA BOARD OF MANAGERS

FOR

THE WORLD'S FAIR, ST. LOUIS

THE LOUISIANA PURCHASE EXPOSITION

June 21-4

CHAS. S. MITCHELL, SUPT.

Dear Friend Latham

I am still here trying to pick up
the loose ends - just came from Kent.
The fruit is scarce & poor in our exhibit
A box came in of D. Cook's apples, every one
rotten - 50 bottles from L. C. shipped the
13th not here yet - No strawberries. You
don't know how difficult it is to get any -
thing in - to an exhibit, after it reaches St. L.

MINNESOTA BOARD OF MANAGERS

FOR

THE WORLD'S FAIR, ST. LOUIS

THE LOUISIANA PURCHASE EXPOSITION

C. S. MITCHELL, SUPERINTENDENT

Lake City, Minn.

July 5th, 1904.

A. W. Latham, Esq.,

207 Kasota Bldg.,
Minneapolis, Minn.

Friend Latham:-

It is all right for you to keep the room and have Ralph help Redpath and you can go ahead and arrange to have Mr. Cook go down there and the others to follow as per program.

Cordially yours,



Vice-President.

2

Thomas & Bush are of the opinion we will
have to close exhibit unless we can get more
fruit - Don't send any one down to take
Bush's place until I see you.

We will start home Thurs'd. Must attend
a meeting of the Commission Friday. Wish
I could be at the Summer meeting but can't.
Hope you will have a good one =

Cordially
Underwood

P.S. If you are in yr office when train
arrives Friday Morning I can tell you how
I leave things

EVERGREENS THAT LIVE.

WEDGE NURSERY

FRUIT TREES THAT BEAR.

Albert Lea, Minn., June 14th, 1904.

A. W. Lathan,
Minneapolis, Minn.

Dear Mr. Lathan:-

Replying to yours of June 13th would say, that we shall be pleased to send on some Peonies to St. Louis as requested. We have some of the most beautiful varieties, but they have only been set eighteen months, and hence are not quite equal to what may be expected of them hereafter.

It is very doubtful if we shall be able to send any fruit to St. Louis before a week from this date, as the weather continues cool and moist, but I am of the impression that our people will take hold of the matter with considerable enthusiasm and that you may expect our fruit to reach you in good condition if not quite as large and handsome as could be wished.

We are very anxious to get the cases at the first possible moment, so that we can look them over and get hold of the method of filling them.

We enjoyed Mr. Elliot's visit a great deal more we presume than he has any realization, and my own feelings in the matter are ~~sure to be~~ ^{those of} ~~the old~~ ^{the family} familiar to an unusual extent. Our girls can hardly say nice enough things in his praise. I shall be away from home to morrow and the next day, but presume there is nothing in the meantime that you will particularly need to learn from us.

Very cordially yours,

Clarence Wray

Stationary at hand.

MINNESOTA BOARD OF MANAGERS

FOR

THE WORLD'S FAIR, ST. LOUIS

THE LOUISIANA PURCHASE EXPOSITION

C. S. MITCHELL, SUPERINTENDENT

Lake City, Minn.
June 25th, 1904.A. W. Latham, Esq.,
207 Kasota Bldg/
Minneapolis, Minn.

Friend Latham:-

Our train was about half an hour late yesterday morning and I knew that the Commission would be waiting for me at Hamlin's office and so I concluded not to stop at Minneapolis to see you. Would only have had a few moments and then I was in hopes that we could get through so that I could go out to the summer meeting in the afternoon, but we did not get through until nearly 3:00 o'clock and I just had time to catch the afternoon train home.

On Wednesday morning I was at our exhibit and I don't know which look^{ed} the worst, the exhibit or Tom and Bush. They had not been able to get apples from the cold storage. About everything they had was badly decayed including the Strawberries. None had been received. We all felt a good deal like throwing the balance away and shutting up the booth. I went down to the Agricultural building and returned about 12:00 o'clock; found the express had brought in apples so that the shelves were replenished and two of the refrigerators had come with Strawberries, -one from Harris and one from the Jewell Nursery Company. The Company's berries were in fine shape, well selected; Harris' over ripe and a good many culls.

Tom says that there are very few people that visit the building at all; that our location catches as many as any; that there were more people in one day at Buffalo than there would be in a week down here. The building is off at one side or in the back lot, so to speak, and cannot be approached except by way of the Agricultural building. The terminal station is a good ways off with no walk leading to the building, ground rough and muddy. The conservatory has never been installed; nothing in the basin and only palms and ferns in groups on the outside of the room sitting on the floor for sale, so that there is no travel to and from this part of the building.

I have advised that all the assistance that Taylor rendered was to come around in the morning and help to clean up, after that he sees to the fair. Mitchell was not in the building at any time to speak of. I found in the other departments that things were going "sixes and sevens" and that it was necessary to make rules. I stipulated that for the Agricultural booth Mr. Johnson, who came down to meet people and exploited the resources of Minnesota, was told that he should be in the booth at least five hours during the middle of the day. I also told Tom and Mr. Bush that I thought that much time should be given to Horticulture.

Tom thinks that he does not need anyone to help him except occasionally when he finds it necessary to be away from the booth. We find that our money is going so rapidly that it will be necessary for us to cut out some things and probably we better not send anyone down to help Tom until fall at least. He can get someone there to watch the booth while he is away from it during July and August. I will try and see you in a few days and talk this matter over. We are cutting the assistance out in the other departments all that we can.

The shipment of daries sent from here went as I requested on the evening train to Chicago, arriving at St. Louis on the evening of the next day and were taken out to the fair grounds the next morning. It is the only way to get a shipment through in time. Going through Iowa

MINNESOTA BOARD OF MANAGERS

FOR

THE WORLD'S FAIR, ST. LOUIS

THE LOUISIANA PURCHASE EXPOSITION

C. S. MITCHELL, SUPERINTENDENT

A. W. Latham- # 2.

requires two or three changes and consequently delays.

Yours very truly,



Vice-President.



United States Express Company

GEO. W. POOLER, Agent.

246 NICOLLET AVENUE.

Telephone Twin City No. 186.
" N. W. Main " 186.

Minneapolis, Minn.,

April 9, 1904

Mr. A. W. Latham,
207 Kasota Building, City

Dear Sir:-

I am in receipt of letter from our agent at St. Louis in which he advises that all express matter for the Fair for all Companies is sent out on one and the same train leaving at the present time at 8.00 o'clock in the morning but that additional service will be put on as business demands.

Relative to prepayment of charges on your shipments. Our agent advises that no doubt they can go forward collect provided your agent at the Fair would arrange with the Express Agent at the Fair Grounds to care for the charges on receipt of shipments.

The agent also advises that shipments consigned to your agent will not necessarily have to have special label, but that the address should show in what building the exhibit is located.

Yours truly,

Geo W Pooler

Agent.

MINNESOTA BOARD OF MANAGERS

FOR

THE WORLD'S FAIR, ST. LOUIS

THE LOUISIANA PURCHASE EXPOSITION

C. S. MITCHELL, SUPERINTENDENT

June 2nd, 1904.

A. W. Latham, Esq.,
207 Kasota Bldg.,
Minneapolis, Minn.

Friend Latham:-

Your letter of the first received and I am glad to note that everything is moving along satisfactorily. I hope that your Strawberry cases will work well and that the fruit will help out.

I think we will have a nice lot of Paeonias and you can correspond with John and tell him what to send.

Cordially yours,

J. M. Underwood
Vice-President.

Herb's Beuther

St Louis 4/8

My dear Latham

I have only time to say that
the U.S. Exp. agt St P. told
me that the best & quickest
way to send Exp is via Chgo.
That the route thru Iowa ~~is~~
to has too many changes.

Please see the agt there
in Mpls about it

They told me we could
ship on evening train at S. C.
leave Chgo next morning
reach ~~St L~~ on Cgo &
Alton R. R. = U. S. Express
& reach St L. at 6 PM
& be delivered that night or
next morning

Cordially
HMB

St Louis May 25th - 1904

A. W. Latham.

Dear Friend. your letter of May 23rd received. I have been to see the different States who have try to ship Strawberries. They all agree that until we get more prompt delivery it is useless to ship them. but our Association at a meeting held today said they had taken it up with Mr Taylor, and He told them Express companies could deliver perishable fruits at any time, so if we do not get them promptly it is the Express company's fault. it has been very warm for a few days 90 in the Hall afternoons. Apples will not stand long up after being in cold storage, at that temperature. Will try and make what we have do us until May 30 They have promised to give us

power Friday. They sent me a blank to fill out. and another inspector has been here. Every thing was satisfactory. Have received today 4 barrels of Apples to give away. We enjoyed a long visit from Prof Green. We asked him how he liked our exhibit. He said it was all right. He thinks it would not hurt us to put some of those apples we bought in St Louis. on the shelves. if people enquired tell them the truth. They says some of the other States are doing ^{the same} & I will try and keep nothing on but what we grew. I think it would have been better if we had half the quantity.

May 30th and balance June 5th - if you think so make that arrangement. then on June 7. our exhibit would look well.

Respectfully

Thos Redpath

MINNESOTA BOARD OF MANAGERS

FOR

THE WORLD'S FAIR, ST. LOUIS

THE LOUISIANA PURCHASE EXPOSITION

C. S. MITCHELL, SUPERINTENDENT

Lake City, Minn.
May 31st, 1904.A. W. Latham, Esq.,
207 Kasota Bldg.,
Minneapolis, Minn.

Friend Latham:-

I note your recommendations of May 28th for the men to represent Horticulture at St. Louis. There is one man I think you will like to provide for and that is our old friend Mr. Lord. I met Conductor Phelps yesterday and he said that Mr. Lord is at the depot and was feeling fine and looking well, better than he has been in a long time. It occurred to me that he might like to go down there and you can arrange it with him. I shall drop him a line and tell him how glad I am to hear that he is better and that I hope he can go down.

I have made a list of the names and the dates that you have assigned to them.

I am gratified to know that the exhibit is being complimented as reported by Mr. Taylor.

Mrs. Underwood and I expect to go down Friday evening and remain 10 or 12 days.

Cordially yours,



Vice-President.

MINNESOTA BOARD OF MANAGERS

FOR

THE WORLD'S FAIR, ST. LOUIS

THE LOUISIANA PURCHASE EXPOSITION

C. S. MITCHELL, SUPERINTENDENT

May 16th, 1904.

Thos. Redpath, Esq.,
St. Louis, Mo.

Dear Sir:-

When I called on you Saturday afternoon I did not have time to talk with you in detail about the Horticultural Exhibit and we had so much to do and so little time to do it in that I could not take time to find you afterward. Sunday Forenoon Mr. Daniels and I went over to the Building and looked the exhibit over thoroly and compared it with the other exhibits in the Building. The impression that it gave me and also the gentlemen that were with me, Messrs. Mitchell, Hamlin and Hays, was that our exhibit looks thin. There is not enough fruit, too much wood and paint.

Another thing I was disappointed in was the Bottle Display. I do not like the preparation that was used for putting it up. It looks dark and does not show the fruit off well. Then too, there are so many small bottles (vials). Standing off a little ways it looks more like an display in an' apothecary shop of medicine rather than an interesting fruit display. As soon as I got into Minneapolis this morning I talked this all over with Mr. Latham, and he is going to write you to put in some more fruit and it was understood between us that I was to see what we have here in bottle fruit that we can send you. We must have the thing look different for our dedication of the 7th of June and as much sooner as possible. I think that it is in the Oregon Exhibit near us where they have a stand of glass bottles, (it is the one next to the Washington near the entrance from the greenhouse display) and the fruit has jars of the right size, about 3 inches and 2 feet high. Now my idea is that you better put more fruit on the shelves and I will try and get you some good bottles of fruit. I will ask Mr. Mitchell to see about getting you fruit to put on there and then I think it would be wise to have a basket of good eating apples in the booth so that when one comes along that wants to know if you got some good apples to eat from Minnesota you could hand them out one without taking any of our Minnesota Wealthys.

I have not time to write you more this evening because I have just come home and have other important things to attend to.

Yours truly,



Vice President.

MINNESOTA BOARD OF MANAGERS

FOR

THE WORLD'S FAIR, ST. LOUIS

THE LOUISIANA PURCHASE EXPOSITION

C. S. MITCHELL, SUPERINTENDENT

Lake City, Minn.
May 11th, 1904.A. W. Latham, Esq.,
207 Kasota Bldg.,
Minneapolis, Minn.

Friend Latham:-

Your nice letter of the 7th was duly received and I should have answered it only I thought I might be able to see you. I thank you very much for the complete report which you made of the condition of things at St. Louis. Of course, it is gratifying to know that the Horticultural department was so complete at the opening. Sorry we could not have had our Agricultural department as well along but it was impossible for us to make the booth and take it down there and about as difficult to get anything made at St. Louis.

The Commission expects to go down Friday night and return Sunday night. I have shipped the plants for the State Building and hope to see the planting completed while I am there.

I have your favor of the 10th with the invoices which I will O.K. and pass over to Mr. Mitchell with recommendation that you be paid the \$200.00 you ask for on services.

Our Strawberry plants at this place seem to be in good condition. Are making good growth but we have dug our beds so clean and do not think we will have much fruit and may not have any suitable for shipping to St. Louis. There are others around here, however, that I think will have good berries. We got some plants from Rochester that seem to be all right.

I hope this cold wave will not kill our plums and destroy the Elm seed but it will come very near it.

Cordially your friend,

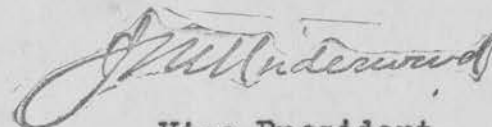

Vice-President.

MINNESOTA BOARD OF MANAGERS

FOR

THE WORLD'S FAIR, ST. LOUIS

THE LOUISIANA PURCHASE EXPOSITION

C. S. MITCHELL, SUPERINTENDENT

Lake City, Minn.

May 24th, 1904.

A. W. Latham, Esq.,

207 Kasota Bldg.,

Minneapolis, Minn.

Friend Latham:-

Replying to your favor of the 22nd will say that your suggestion of having jars shipped to St. Louis came too late and while it might have saved some expense I do not feel in sympathy with the proposition of having Mr. Redpath put up the fruit in formaline and alcohol. I have never seen fruit put up that way that I thought looked well. We have a lot of it down there now and I don't want any more. Then too I am not sure that he would have fruit there suitable and without experience in putting it up I think it would be too much of an experiment. I don't want fruit in its natural color if it looks like the fruit that is down there. The more unnatural it looks the better it would suit me if it differed from what is in the bottles now. I want something that looks attractive. As soon as John gets the fruit put up I will advise you.

As regards the sulphur process taking the color out of fruit. I do not think it ~~so~~ objectionable, as the other process ^{which} makes it look dark colored and quite as unnatural.

At our Board meetings we have sometimes said that it would be well if superintendents of departments could meet with us and report progress or offer us suggestions. If you have anything that you wish to bring before the Board, it would be well for you to come to the meeting.

It need not take much of your time. We could hear your arguments and if offer any suggestions that might occur to any of the members of the Board Do as you think about coming.

*Best*Cordially yours, *J. M. Underwood*

United States Express Company.



87, 89 and 91 E. Washington Street.

MAY 24 1904

Chicago, Ill., 190

Ag't USEX

Minneapolis

at

A. WYGANT, Gen'l Agent.
L. A. HAMLIN, Agent.
Telephone, "Central 2023."

unable to find any one who handle
the Refrigerators the fruit or
commission some say that their
fruit come in them from the
south and Traby & Co at St. Louis
keep them to Rent out but Fla
you may be able to get some
from them O.C. Dept Ag't

(529)



United States Express Company

GEO. W. POOLER, Agent.

246 NICOLLET AVENUE.

Telephone Twin City No. 186.
" N. W. Main " 186.

Minneapolis, Minn., May 23d 1904

Subject:-

Mr A. Wygant.

Gen, 1 Agent Chicago Ill.

Can you advise me if there is a dealer in Chicago
of fruit shipping refrigerators.

Agent. P

*Tracy Thomas
Atlanta Ga*

MINNESOTA BOARD OF MANAGERS

FOR

THE WORLD'S FAIR, ST. LOUIS

THE LOUISIANA PURCHASE EXPOSITION

C. S. MITCHELL, SUPERINTENDENT

Lake City, Minnesota.

March 15th, 1904.

A. W. Latham, Esq.,
207 Kasota Bldg.,
Minneapolis, Minn.

Friend Latham:-

Replying to your favor of the 10th. I conclude that you have been waiting for the weather to moderate and I guess that it is coming now and that you will soon have the car off.

I expect to come up to a meeting of our Commission to-morrow afternoon.

If our Company does anything at all with the Exposition at St. Louis, we will have to take it up after our spring delivery is over, and it may be best not to try to do anything until we get new fruits.

Cordially yours,

J. M. Underwood, Vice-Pres.

MINNESOTA BOARD OF MANAGERS

FOR

THE WORLD'S FAIR, ST. LOUIS

THE LOUISIANA PURCHASE EXPOSITION

C. S. MITCHELL, SUPERINTENDENT

Lake City, Minn.
April 8th, 1904.A. W. Latham, Esq.,
207 Kasota Bldg.,
Minneapolis, Minn.

Friend Latham:-

I congratulate you on the fulfillment of your mission to St. Louis and I do not doubt but that you are the first one to complete an installation anywhere on the grounds. I wish our Agricultural Booth was as far along but the fault lies with the St. Louis people. The nature of the installation was such that we could not make it here in Minnesota to advantage or we should have had it all completed before this time.

Yes, I met Mrs. Berthe and talked with her about the honey and I believe we came to a satisfactory understanding regarding it.

Glad to know that the fruit is in good condition. I am quite pleased with the way the Jewell's Winter is holding out. They are as sound and crisp as can be now being kept in a cellar. A good deal better keeper than the Wealthy.

Anna asked me to furnish you with a photograph in compliance with your request to her. I have some very good ones on hand made by J. Bush of Minneapolis but I do not think they are the right size for you. The best way would be for you to go to him and have one made the way you want it. He has two copies; one is good the other is not. He made a mistake in printing me one-half dozen of the poor ones, which I repudiated and then he made me one-half dozen of the good ones. One is out of focus and the expression is not good. Some say it makes me look tired and others that I look fierce. The latter is my chronic condition but does not look well on paper. He can send the bill to me and I will pay it.

Cordially yours,

J. M. Underwood.

P.S. I have just received yours of the 8th with bills and vouchers. I have O.K. them and sent them to Mitchell and requested him to send you check for the same.

J.M.U.

ESTABLISHED 1868

BY

DR. P. A. JEWELL



INCORPORATED 1884
CAPITAL STOCK \$100,000.00

CONTROL 1000 ACRES

THE JEWELL NURSERY Co.,

LAKE CITY, MINNESOTA

J. M. UNDERWOOD, PRESIDENT AND GENERAL MANAGER



"LAKE CITY, NO. 25 CALL 2"

April 14th, 1904.

A. W. Latham, Esq.,
207 Kasota Bldg.,
Minneapolis, Minn.

Dear Sir:-

Your circulars to provide fruit for the Exposition are O.K.
and clearly indicate that you are on to your job as usual.
In regard to the photographs. I will see what I can do here.

Cordially yours,

J. M. Underwood

WE WANT MEN
TO SELL
Our Northern Grown
Stock. Best Wages. Pay Weekly.

Form 202-12-14-03-10,000

MINNESOTA BOARD OF MANAGERS
FOR
THE WORLD'S FAIR, ST. LOUIS
THE LOUISIANA PURCHASE EXPOSITION

C. S. MITCHELL, SUPERINTENDENT

Lake City, Minnesota.

March 1st, 1904.

A. W. Latham, Esq.,
207 Kasota Bldg.,
Minneapolis, Minn.

Dear Friend:-

I think you were right in making the change in the motors and turning in the old one as you suggest. I expect to go up to St. Paul tomorrow for meeting of the Agricultural Society in the forenoon and possibly a meeting of the Commission in the afternoon.

Do not know of anything now that we could put in the car, but very likely there will be something. I will talk with Mitchell about it.

I think some of the wood is going to cut black. One cannot tell at this time just what the result of the winter is going to be.

Cordially yours,

J.M. Underwood, Vice-President

MINNESOTA BOARD OF MANAGERS

FOR

THE WORLD'S FAIR, ST. LOUIS

THE LOUISIANA PURCHASE EXPOSITION

Los Angeles 11-28-3

C. S. MITCHELL, SUPERINTENDENT

My Dear Latham

Your favor of 16th was found to me here. Yes I went to St. L. - I looked over the whole proposition. I think the space you selected a good one except the shape. I have intended to draw it out to a scale & see what can be done with it: but have been so very busy here that I simply couldn't do it. I am having to burn late gas now to write this letter - but you better draw one large enough so you can see just how the space looks. draw the aisles & locate the posts - There is a large one (I think 12 x 12) just on the back side in the center. - It would be well to ask the Department to send you a sketch of the section & aisles drawn to a scale of say two or four ft to the inch & also locate the posts - While I like the location, its odd shape will make it difficult to build a booth to fit it & to look well on all sides. Then too it don't look to be as large as the J. N. Co booth at Fair grounds. I think we could have the wall space back of it: but that would divide our exhibit & scatter our forces too much I'm afraid.

How would it do to have John go down & with
some matched lumber build up a frame work in
a cheap way to fit the space. Calculating to
cover it all up with fruit or some nice color of
cloth or burlap such as is used for house walls.
The space was not defined in any way so that
I could tell just how large it was & the shape
except in a general way. Taylor was away. he
was to be in Niles & I hope you saw him -
The weather here is delightful & we are having
a good time. but I will try & write you about
conditions here an other time

Cordially Yrs
J. H. Wood

Here with a poor rule I have
not accurate, but near enough to
in a booth & especially
post will make it hard to
It may be my

tried to indicate the space, it is
show how awkward it will be to fit
the one we now have, also the big
give it a front on that side -
measurements are not correct

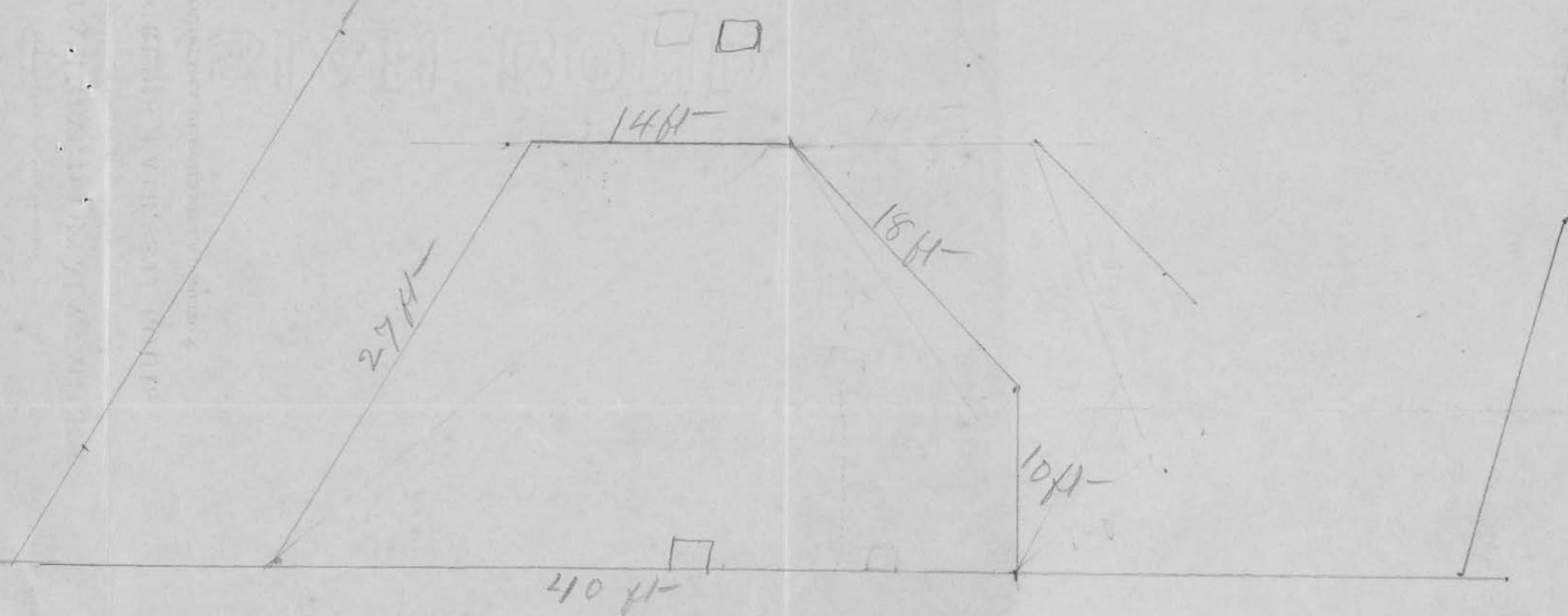

Scale 1 in = 8 ft -

ESTABLISHED 1868
BY
DR. P. A. JEWELL

INCORPORATED 1884
CAPITAL STOCK \$100,000.00

CONTROL 1000 ACRES



THE JEWELL NURSERY Co.,

LAKE CITY, MINNESOTA



J. M. UNDERWOOD, PRESIDENT AND GENERAL MANAGER

"LAKE CITY, NO. 25 CALL 2"

Dec. 15, 1903.

C
A. W. Latham, Esq.,
207 Kasota Bldg.,
Minneapolis, Minn.

Dear Sir:

Mr. Underwood has just returned the sample of the cotton fruit I sent him. He thinks it will do very well if it can be made in various sizes, and some of the fruit not quite so highly colored. I think the foliage, too, ought to be made in various sizes.

We are sending you today under separate cover, these samples, and leaving it to you to see Mr. LeMars, and order what will be needed for the tree I think we need about 4 bushels of the apples, and 4 great gross of leaves. That would be sufficient to put up a tree about 1/3 larger than the one I had at the State Fair.

Mr. Underwood also sends me cut showing the shape of the space assigned for the Minnesota Fruit Exhibit. I think it is very odd in shape, and hardly know how our exhibit can be put up in such a space to good advantage. It will necessarily have to be faced on four sides, leaving the 10 ft. space or the cut off corner, for an entrance underneath the exhibit, as you will have to have store-room below.

Now, instead of building a booth similar to the one we had at World's Fair, Chicago, figuring on taking it to our State Fair after using it at St. Louis, I think it would be advisable to build it out of rough boards and cover with mirrors and cloth as I did at State Fair, having shelving all around it, with raised center, and placing the Wealthy apple tree on top. Of course, if we had wall space 30 or 35 feet long, with floor space

WE WANT MEN
TO SELL
Our Northern Grown
Stock. Best Wages. Pay Weekly.

Form 202-9-19-03-8000

ESTABLISHED 1868
BY
DR. P. A. JEWELL

INCORPORATED 1884
CAPITAL STOCK \$100,000.00

CONTROL 1000 ACRES



THE JEWELL NURSERY Co.,

LAKE CITY, MINNESOTA



J. M. UNDERWOOD, PRESIDENT AND GENERAL MANAGER

"LAKE CITY, NO. 25 CALL 2"

A.W. Latham No. 2

16 or 18 ft. wide, I think a fine booth could be put up, placing the tree in center, as close to the wall as could be done, and show it to good advantage.

Maybe you have your plans already laid for the booth, but I could not refrain from making these suggestions.

Will you please let me know if you can secure the cotton fruit and foliage.

Yours truly,
John Nordine.

My dear friend Latham Los Angeles 1-10-4
O. K. - only question is as to expense & how best to
build it - I wrote you abt this once before, the space
is odd shaped & not easy to build to, especially
anything that can be used anywhere else - for that reason
I thot possibly you better plan to build there on the
spot same as we (our Co) do at state fair, putting in
the glass refrigeration & turn tables just the same
but you are the one to say - go ahead & do it some
way, using your best judgement & be sure to
have it on time - A letter from John said you did
not like the cotton front & he thot you did not care
for the tree - I wrote him & Roy referring the whole
matter to Roy with power to act. I doubt if they

Latham # 2

1-10-4

will do anything - Roy does not think the advertising
we got out of Buffalo paid for our effort. If this did
us any good it would be necessary for Roy to work trip
& this he ships at - & that if John could go down there
in Feb & March & help put up the exhibit he would be
better help than any one else we could get & besides
helping on the General exhibit he could do something
for the T. N. Co - Now you don't need to wait for me
or refer to me - go ahead & do as you think best -
Mr Wiggins of this place (& his wife) are old friends
& schoolmates of Mr & Mrs Beusens - We visited them
yesterday at Ocean Park - Mr W - is the one who
has done all the great exhibition work here in the

Latham - # 3

1-10-4

Chamber of Commerce, also at the World's Fair Chicago &
the Pan American - Omaha - & Paris Exhibitions - I
wish you could see the immense amount of beautiful
fruit he has in large glass jars - ready for St. L.
It makes me feel weary when I think of the little soup &
am't we have - 3 weeks from to-morrow I will start
home so we can soon talk instead of write -
Hardly a cloud & not a drop of rain since we
came here -

Cordially
J. M. Underwood

MINNESOTA BOARD OF MANAGERS

FOR

THE WORLD'S FAIR, ST. LOUIS

THE LOUISIANA PURCHASE EXPOSITION

C. S. MITCHELL, SUPERINTENDENT

Lake City, Minn. Oct. 19, 1903.

A. W. Latham, Esq.,

207 Kasota Blk.,

Minneapolis, Minn.

Friend Latham:-

Your very complete report of your trip to St. Louis received. I think what you better do is to decide exactly on the space we want for Horticulture, and we will try to get it. The managers down there are insisting that we change the location of our Minnesota Building, and we are going to make it a stipulation that in doing so we shall be granted certain concessions. The facts are that they want the ground that they had assigned to us last February to make more space around the Missouri Building, and there has long been such a pressure brought to bear and the managers do not see what to do unless we will give up the location and take another. When we chose our location it was after standing around in the cold one-half day, waiting for Louisiana to have the first choice. We went down there for the express purpose of selecting a location and made all of our plans to fit our choice, and for them to come in this late hour and insist in our changing our location, certainly entitles us to respectful consideration, if we want anything from them. I intend to make this a point in controlling the situation of our Butter Exhibit, also.

I do not understand why we may not have either block 48, 49, 51, 34 or 23, and if you have any choice in the matter I wish you would indicate it, and I will try to see if we cannot get what you want.

Regarding the space for Agriculture. I understand what you say, that if Minnesota was to have lot 41 she would have to furnish one-half of the material and one-half of the labor for installing lot 40, lying directly

MINNESOTA BOARD OF MANAGERS

FOR

THE WORLD'S FAIR, ST. LOUIS

THE LOUISIANA PURCHASE EXPOSITION

C. S. MITCHELL, SUPERINTENDENT

2.

infront of it. Is there any good reason for it? It seems to me that lot 41 is the right one for us to occupy, and that we should have it without having to improve block 40. I expect that our Commission will meet in a few days and you had, probably, better meet with us. In the mean time I will communicate with the other members and have them posted as to the result of your investigations. I expect to be up some time this week and see you in regard to the work.

Cordially yours,

J. M. Underwood, Vice-President.

MINNESOTA BOARD OF MANAGERS

FOR

THE WORLD'S FAIR, ST. LOUIS

THE LOUISIANA PURCHASE EXPOSITION

C. S. MITCHELL, SUPERINTENDENT

Oct. 12, 1903.

A. W. Latham, Esq.,
207 Kasota Bldg.,
Minneapolis, Minn.

Friend Latham:-

It will be all right to let our bill for fruit go into the next Nov. settlement.

I hope you will be able to arrange with Mr. Taylor for a meeting at St. Louis and that you can secure a favorable location, also that you will be able to give us some points on the best thing to do with our Agricultural Booth as to location.

We are thinking now that we would like to make the Ornamental Butter Exhibit the central feature of the Agricultural Booth in order to emphasize the idea of Minnesota being the bread and butter state of the union. We would find some way to represent the bread as well as the butter, but in the Dairy Exhibit, they are planning to have a large glass refrigerated case for ornamental butter and they want us to put our ornamental exhibit in that case.

I have been corresponding with them to see if they would not allow us to put our Ornamental Exhibit in the Agricultural Booth. It will cost us more to do this, but it would be a feature of the Agricultural Booth.

A Mr. Sudendorf who has charge of the Dairy Exhibit, was at our fair and met our dairyman but he did not see me nor Mr. Mitchell. He is under Taylor and as you are to see Taylor, I wish you would explain to him what you want him to do with our Ornamental Exhibit and see if we could be allowed to do that and still enter our Exhibit in competition with the Ornamental Exhibits. Of course, it would be expensive to put up two Ornamental Exhibits and we would like to avoid doing so.

Cordially yours,

J. M. Underwood, Vice Pres.

ESTABLISHED 1868

BY

DR. P. A. JEWELL

INCORPORATED 1884
CAPITAL STOCK \$100,000.00

CONTROL 1000 ACRES



THE JEWELL NURSERY Co.,

LAKE CITY, MINNESOTA



J. M. UNDERWOOD, PRESIDENT AND GENERAL MANAGER

Oct. 8, 1903.

"LAKE CITY, NO. 25 CALL 2"

A. W. Latham, Esq.,
207 Kasota Blk.,
Minneapolis, Minn.

Friend Latham:-

Here is a bill for the fruit that we furnished, which if you find correct, you can have it take its regular course for payment. It seems that Warren made a mistake in sending you and Elliot a box of Wealthys instead of Jewell's Winter. You probably will be glad that the mistake was made. I only wanted you to see whether the Jewell's Winter would keep or not.

Yours truly,

J. M. Underwood.

WE WANT MEN
TO SELL
Our Northern Grown
Stock. Best Wages. Pay Weekly.

Form 201-8-28-03-5000

MINNESOTA BOARD OF MANAGERS

FOR

THE WORLD'S FAIR, ST. LOUIS

THE LOUISIANA PURCHASE EXPOSITION

C. S. MITCHELL, SUPERINTENDENT

Sept. 24, 1903.

A. W. Latham, Esq.,
207 Kasota Blk.,
Minneapolis, Minn.

Friend Latham:-

I am sending you the W ealthy leaves. I asked John for the address and he said he would give it to me, but he has gone into the country and forgot to do so. I will look up the matter of \$2.00 to Mr. Kenny. Gloves received, much obliged. Left your umbrella with Glispie.

I have been thinking about the fruit that is put up in bottles for St. Louis. You will remember that the Strawberries did not look very showy, and I am fearful that we have not what we need to make a good display. I wish you would send me a list of just what bottles you have and what will be put into them. We have three boxes of large glass jars in your room at the Horticultural Hall. I believe that you had better have them shipped down here and let John fill them in an attractive way. If it is certain that we do not need them for fruit display, we can use them for vegetables. If we need them for the ffruit then I want to get some larger ones for the vegetables. In the mean time we will put some vegetables into crocks to be transferred.

Cordially yours,

J. M. Underwood.

P. S. John is home. Party's name L. D. de Mars, 315 1st Ave. S. Minneapolis, Minn.

J. M. U.

ESTABLISHED 1868
BY
DR. P. A. JEWELL

INCORPORATED 1884
CAPITAL STOCK \$100,000.00

CONTROL 1000 ACRES



THE JEWELL NURSERY Co.,

LAKE CITY, MINNESOTA.



J. M. UNDERWOOD, PRESIDENT AND GENERAL MANAGER

"LAKE CITY, NO. 25 CALL 2"

Sept. 10, 1903.

A. W. Latham, Esq.,
207 Kasota Bldg.
Minneapolis, Minn.

Dear Friend:-

It is a good thing that the photographer did not come down yesterday morning, for all day it was cloudy and look like rain, while to day it is bright and pleasant.

Had I better have some of our Wealthies saved for St. Louis? I am not sure whether you said you would depend on us for any or not. They are ripening up fast and falling off and must be picked at once. I think Wealthies grown on higher land could be picked later and, perhaps, would be better.

Cordially yours,

J. M. Underwood.

all apples for St Lo better be wrapped & packed in boxes dont you think

WE WANT MEN
TO SELL
Our Northern Grown
Stock. Best Wages. Pay Weekly.

ESTABLISHED 1868

BY

DR. P. A. JEWELL



INCORPORATED 1884
CAPITAL STOCK \$100,000.00

CONTROL 1000 ACRES

THE JEWELL NURSERY Co.,

LAKE CITY, MINNESOTA.



J. M. UNDERWOOD, PRESIDENT AND GENERAL MANAGER

"LAKE CITY, NO. 25 CALL 2"

Sept. 17, 1903.

A. W. Lawtham, Esq.,
207 Kasota Blk.,
Minneapolis, Minn.

Friend Latham:-

We sent a man to Morrystown at an expense of \$13.35 for which we enclose you bill. He found the apples all on the ground and came home without accomplishing anything. He said he wrote you about it and Mr. Kenny had also written you. I am starting out a force of men to secure some fruit here. I am getting a little shaky about our having enough good apples.

Cordially yours,

J. M. Underwood.

WE WANT MEN
TO SELL
Our Northern Grown
Stock. Best Wages. Pay Weekly.

Form 201-8-28-03-5000

C. N. COGGROVE, LE SUEUR,
President.

B. F. NELSON, MINNEAPOLIS,
First Vice President.

CHESTER R. SMITH, ST. PAUL,
Second Vice President.

E. W. RANDALL, HAMLIN,
Secretary.

F. J. WILCOX, NORTHFIELD,
Treasurer.

Board of Managers.

W. M. LIGGETT, ST. ANTHONY PARK.

WM. E. LEE, LONG PRAIRIE.

N. S. GORDON, CROOKSTON.

J. C. CURRYER, MANKATO.

J. M. UNDERWOOD, LAKE CITY.

L. D. BAIRD, AUSTIN.

Minnesota State Agricultural Society.

State Fair of 1903, Aug. 31 to Sept. 5.

OFFICE OF SUPT. POLICE DEPT.

J. M. UNDERWOOD, SUPT.

CAPT. W. H. HART, Asst. SUPT.

Lake City, Minn., August 21st, 1903

A. W. Latham, Esq.,
207 Kasota Bldg.,
Minneapolis, Minn.

Dear Friend:-

Roy says that the photographs can be taken after the Fair.

My only thought with regard to Howard was that he has a cold storage to put the apples in. I leave the whole matter to you. Be sure and get enough so that we can have a creditable display and keep it up from the time the Fair opens.

I notice that the St. Louis Bulletins express of Tacoma filling large glass jars with specimens of fruit. Ought you not to do something in this line, more than you have done?

You say that you have already engaged nine bushels of Duchess. Howard says that they keep as well as anything, and I suppose that you would have to have a whole lot of apples in order to keep up the exhibit during the Fair. Are you not going to want some of our nice Okabenas, or can you get something better?

I should think it would do you good to take a round through the country and see some of the orchards and look up some fruit for St. Louis, and charge your expenses up.

Cordially your friend,

J. M. Underwood.

C. N. COSGROVE, LE SUEUR,
President.

B. F. NELSON, MINNAPOLIS,
First Vice President.

CHESTER R. SMITH, ST. PAUL,
Second Vice President.

E. W. RANDALL, HAMLIN,
Secretary.

F. J. WILCOX, NORTHFIELD,
Treasurer.

Board of Managers.

W. M. LIGGETT, ST. ANTHONY PARK.
WM. E. LEE, LONG PRAIRIE.
N. S. GORDON, CROOKSTON.
J. C. CURRYER, MANKATO.
J. M. UNDERWOOD, LAKE CITY.
L. D. BAIRD, AUSTIN.

Minnesota State Agricultural Society.

State Fair of 1903, Aug. 31 to Sept. 5.

OFFICE OF SUPT. POLICE DEPT.

J. M. UNDERWOOD, SUPT.

CAPT. W. H. HART, ASST. SUPT.

Lake City, Minn., August 17th, 1903

A. W. Latham, Esq.,
207 Kasota Blk.,
Minneapolis, Minn.

Dear Sir:-

I think it would be well to have some large photographs for the St. Louis Exposition and if Mr. Shepard can come down here Roy will help him to get some good ones.

Yesterday we drove out to Bell Howards. He has a splendid showing on Duchess. The trees are large and very full of fruit and a great many of the apples are under size. They are bearing to heavily. Should have been thinned out. He has good soil to start with, puts on quantities of manure and keeps his hogs in the orchard to root up the ground. He has a nice cold storage, and I suggested to him that I thought it would be nice for him to put away some nice fruit and keep it until the weather was cooler, in the fore part of winter, and ship it to St. Louis. If this meets with your approval you might write him at once and ask him to leave some very nice fruit of the Duchess on the trees until just before the Fair and then pack them. Have him wrap them with paper very carefully.

If you have arranged for all that you need and do not care to have him save any fruit, let me know and I will tell him so. He will have Hibernian, Wealthy, Duchess and a few other kinds that will be good. If you want any tell him the quantity. I think you can get as good or better fruit elsewhere, but the only object in having him put up some, is in taking advantage of his nice cold storage.

I will try to find time to look over the premium list as you request.

We had a delightful trip out to Mr. Perkins in the rain. He has a fine showing of apples.

Cordially yours.

J. M. Underwood,