

The Timken Company

4500 Mt Pleasant St. NW

N. Canton, OH 44720

Phone: (234) 262-3000

E-Mail: CustomerCAD@timken.com • **Web site:** www.timken.com
Part Number 23232EJW33, Spherical Roller Bearings - Steel Cage

Spherical bearings are designed to manage high radial loads even when misalignment, poor lubrication, contamination, extreme speeds or critical application stresses are present.



[Specifications](#) | [Factors](#) | [Dimensions](#) | [Abutment and Fillet Dimensions](#) | [Basic Load Ratings](#)

Specifications

| | |
|-------------------------|-----------------|
| UPC Code | 087796357839 |
| Design Unit | Metric |
| d - Bore | 160 mm |
| Lubrication Type | Standard Grease |
| Cage Type | EJ |
| Cage Material | Steel |
| Superseded Part | 23232CJW33 |

Factors

ISO Factor¹

0.33

| | |
|---|----------|
| Y0 - ISO Factor² | 2.01 |
| Y1 - ISO Factor³ | 2.06 |
| Y2 - ISO Factor⁴ | 3.06 |
| Reference Thermal Speed Rating (Grease) | 1200 rpm |
| Reference Thermal Speed Rating (Oil)⁵ | 1400 rpm |
| Cg - Geometry Factor⁶ | 0.0941 |

Dimensions

| | |
|------------------------------|----------------------|
| D - Outer Diameter | 290 mm 11.4173 in |
| B' - Inner Ring Width | 104 mm 4.0945 in |
| B - Outer Ring Width | 104 mm 4.0945 in |

Abutment and Fillet Dimensions

| | |
|---|--------------------------|
| R - Inner Ring "To Clear" Radius⁷ | 2.5 mm 0.100 in |
| r - Outer Ring "To Clear" Radius⁸ | 2.5 mm 0.1 in |
| da - Inner Ring Backing Diameter | 190 mm 7.5000 in |
| Da - Outer Ring Backing Diameter | 264.000 mm 10.4000 in |

Basic Load Ratings

| | |
|---|-------------------------|
| C0 - Static Radial Rating | 1940000 N 435000 lbf |
| C1(2) - Dynamic Radial Rating (Two-Rows) | 1470000 N 330000 lbf |

¹ These factors apply for both inch and metric calculations. Consult your Timken representative for instruction on use.

² These factors apply for both inch and metric calculations. See engineering

³ These factors apply for both inch and metric calculations. Consult your Timken representative for instruction on use.

⁴ These factors apply for both inch and metric calculations. Consult your Timken representative for instruction on use.

⁵ See thermal speed ratings in the engineering section.

⁶ Geometry constant for Lubrication Life Adjustment Factor a_3 .

⁷ Maximum housing fillet radius that bearing corners will clear.

⁸ These maximum fillet radii will be cleared by the bearing corners.

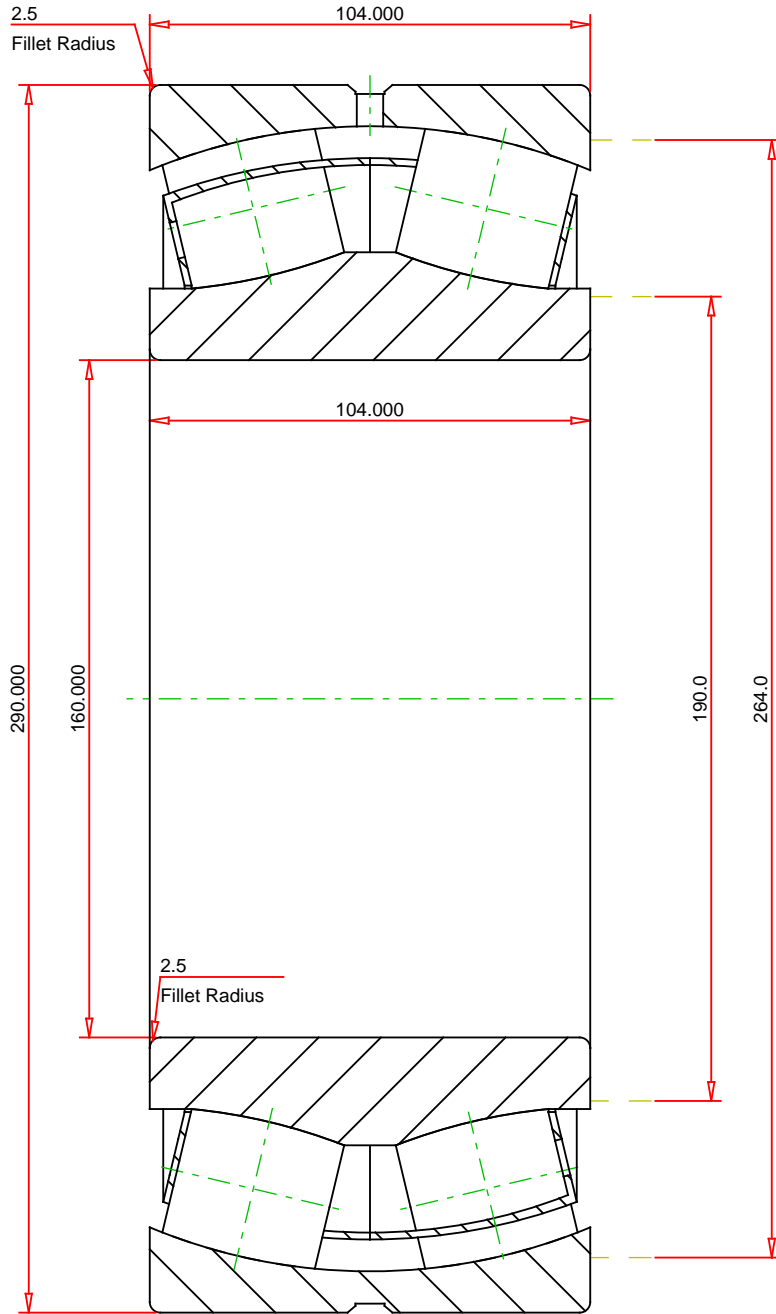

METRIC UNITS

| | |
|---------------------------|-------|
| Number of Rollers Per Row | 19 |
| ISO Factor e | 0.33 |
| ISO Factor Y0 | 2.01 |
| ISO Factor Y1 | 2.06 |
| ISO Factor Y2 | 3.06 |
| Bearing Weight | kg |
| Cage Type | EJ |
| Cage Material | Steel |

TIMKEN®

23232EJW33
SRB ASSEMBLY

THE TIMKEN COMPANY
NORTH CANTON, OHIO USA

| | | |
|----------------------------------|---------|---|
| Dynamic Radial Rating (Two Rows) | 1470000 | N |
| Static Radial Rating | 1940000 | N |

Every reasonable effort has been made to ensure the accuracy of the information contained in this writing, but no liability is accepted for errors, omissions or for any other reason.

FOR DISCUSSION ONLY