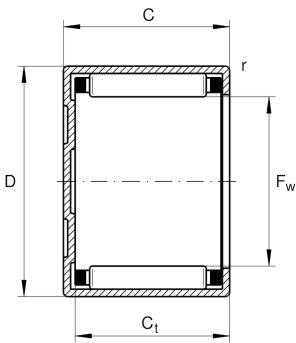

**BK2016-AS1**

Drawn cup needle roller bearing closed end

Drawn cup needle roller bearing closed end  
BK...AS1, single row, with cage

## Technical information

**Your current product variant**

Coating	Without
Sealing	Without

**Main Dimensions & Performance Data**

$F_w$	20 mm	Under roller diameter
D	26 mm	Outside diameter
C	16 mm	Width, outer ring
$C_r$	12,700 N	Basic dynamic load rating, radial
$C_{0r}$	20,100 N	Basic static load rating, radial
$C_{ur}$	2,550 N	Fatigue load limit, radial
$n_G$ Grease	7,600 1/min	Limiting speed for grease lubrication
$n_G$	12,700 1/min	Limiting speed
$n_{gr}$	9,300 1/min	Reference speed
$m$	22.3 g	Weight

**Dimensions**

$r_{min}$	0.8 mm	Minimum chamfer dimension
$C_{tmin}$	13.3 mm	Minimum width to base of drawn cup with closed end

**Temperature range**

$T_{min}$	-30 °C	Operating temperature min.
$T_{max}$	140 °C	Operating temperature max.



### Additional information

---

SD20X26X4	Sealing ring
G20X26X4	Sealing ring 2
LR17X20X16,5	Suitable inner rings LR
IR17X20X16,5-XL	Suitable inner rings IR