



# SKY WALK

CONDOMINIUM

LIVE BEYOND LIMIT  
IN THE DISTRICT OF YOUR OWN.

SKYWALK CONDOMINIUM & WELTZ RESIDENCES ES



## Woraluk Property Public Company Limited

Woraluk Property originally made history in Thailand's movie theater industry by launching EGV, which introduced a new era for Thai movie theatres with world class movie experiences previously unseen in the country. With investment of 1.5 billion baht, Mr. Wichai expanded EGV to 65 movie theaters within 18 months.

Today, Woraluk Property delivers quality real estate developments under the 'Creative Living' philosophy, meeting the needs of today's customers with innovative ideas and technologies.



CREATIVE LIVING BY  
W-PROPERTY.COM

# PROJECT CONSULTANTS

Architect Designer  
A-Seven Corporation Co., Ltd.

Landscape Designer  
Contour

M&E Engineer  
Bangkok Planner and Consultants Co., Ltd.

Contractor  
Syntec Construction PCL.

Project Management  
CEL Engineers Co., Ltd., AE Asia Co., Ltd.

CONTOUR



# TRACK RECORDS

Baan Tonmai  
Vibhavadi-Don Muang ▼



Wora  
Sukhumvit 49 ▼



Le Luk Condo  
Sukhumvit 69 ▼



Hi Residence  
Hotel  
Asok-Din Daeng ►

# LOCATION MAP

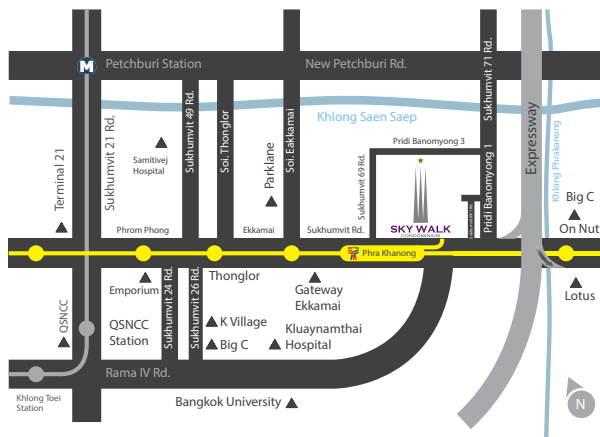

## BTS Skywalk direct to the project

- 7 minutes from BTS Asoke Station
- 6 minutes from BTS Phrom Phong Station
- 2 minutes from BTS On Nut Station



## Hospital

- 5 minutes to Kluaynamthai
- 10 minutes to Samitivej



## Shopping Center

- W District Lifestyle Mall at your door step
- 10 minutes to Emporium
- 10 minutes to K Village
- 15 minutes to Terminal 21



## Expressway

- 3 minutes to expressway



## Main street connection

- multiple entrances and exits to main street

# PROJECT DETAILS

computer generated

Forming part of the SKYWALK CONDOMINIUM project, the WELTZ RESIDENCES are special residential units located exclusively on selected floors.

The WELTZ RESIDENCES provide an extra level of luxury and comfort with a full set of fine furniture and digital door locks, ensuring the highest levels of security for residents.



**SKYWALK**  
CONDOMINIUM

## PROJECT DETAILS

### SKYWALK CONDOMINIUM

Project Description	High-rise Condominium
Number of Floors	50 Levels
Number of Units	520 units
Total Area	1 Rai 87.50 square wah
Common Area Fee	45 Baht / sq.m / month (paid 12 months in advance)
Sinking Fund	500 Baht / sq.m. (Payable upon the transfer of ownership)

### WELTZ RESIDENCES (Exclusively located on selected floors)

Number of Floors	11
Number of Units	177
Car Parking	3rd floor – 10th floor, Total 367 Spaces



## FACILITIES SURROUNDING





# MASTER PLAN



## Buildings

- A » Le Luk Condominium
- B » Weltz Residences  
at Sky Walk Condominium
- C » Egg Retails & Event Space
- D » W Market
- E » Beat Hotel



**SKY WALK**  
CONDOMINIUM

# W-DISTRICT

## STREET WALK



Information provided is deemed accurate at the time of publication.  
Changes may occur without prior notice.

## UNIT MIXES WELTZ

Unit Type	No. of BR.	Area (Sq.m.)	No. of Units	Total Units
A	Studio	36.86-37.94	12	12
E	1 BR Junior	36.69-40.06	30	144
B	1 bedroom	53.91-54.28	12	
C	1 bedroom	51.77-51.82	22	
F	1 bedroom	50.98-51.63	22	
G	1 bedroom	50.60-50.96	22	
D	1 + 1 bedroom	59.79-60.96	36	

Unit Type	No. of BR.	Area (Sq.m.)	No. of Units	Total Units
DE	2 bedroom	100.48-101.05	8	21
EE	2 bedroom	79.75-80.15	3	
I	2 bedroom	91.59	10	

TOTAL : 177 UNITS



## UNIT MIXES SKYWALK

Unit Type	No. of BR.	Area (Sq.m.)	No. of Units	Total Units
A	Studio	36.86-37.94	22	22
E	1 BR Junior	36.69-40.06	54	240
B	1 bedroom	53.91-54.28	22	
C	1 bedroom	51.77-51.82	34	
F	1 bedroom	50.98-51.63	32	
G	1 bedroom	50.60-50.96	35	
D	1 +1 bedroom	59.79-60.96	63	



## UNIT MIXES SKYWALK

Unit Type	No. of BR.	Area (Sq.m.)	No. of Units	Total Units
DE	2 bedroom	100.48-101.05	7	44
EE	2 bedroom	79.75-80.15	5	
H	2 bedroom	73.48	3	
P	2 bedroom	121.45	1	
I	2 bedroom	91.59	10	
Jr.Suite A	2 bedroom	88.26	2	
Jr.Suite B	2 bedroom	85.11	4	
Jr.Suite C	2 bedroom	100.96-101.39	8	
Jr.Suite D	2 bedroom	112.68	4	

\* Excluding Exclusive Room Type

TOTAL : 307 UNITS



# UNIT MATRIX

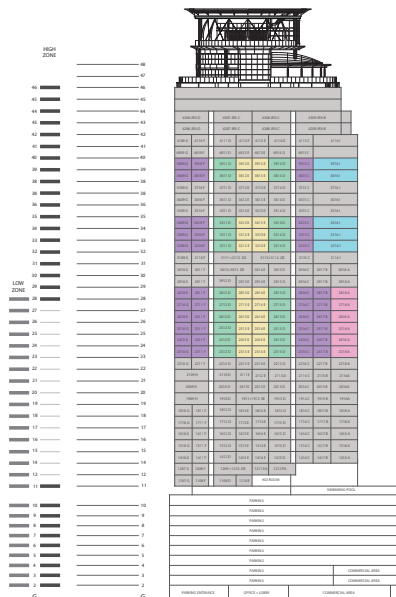

# UNIT MATRIX

EAST

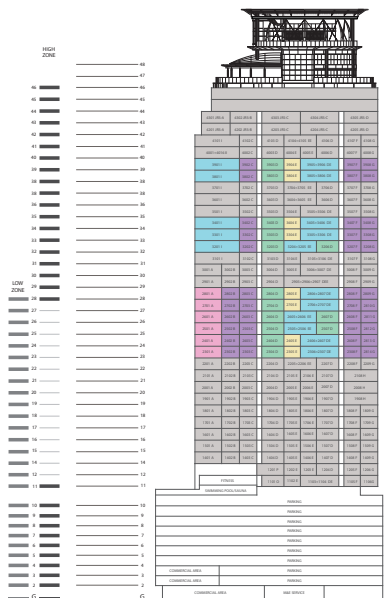

ROOM TYPES (WELTZ)

- STUDIO
- 1 BEDROOM
- 1 BEDROOM JR.
- 1+1 BEDROOM
- 2 BEDROOM

## SHOW SUITES — STUDIO

Photo taken from the actual project

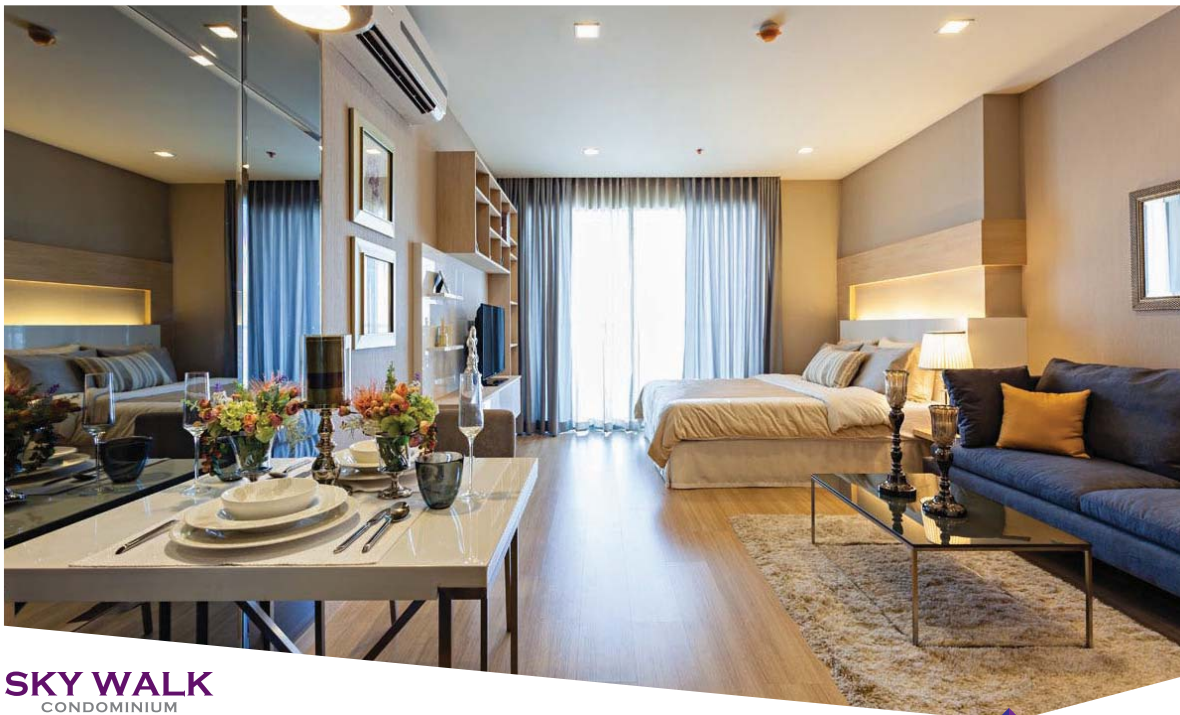

**SKY WALK**  
CONDOMINIUM





## SHOW SUITES — STUDIO

Photo taken from the actual project

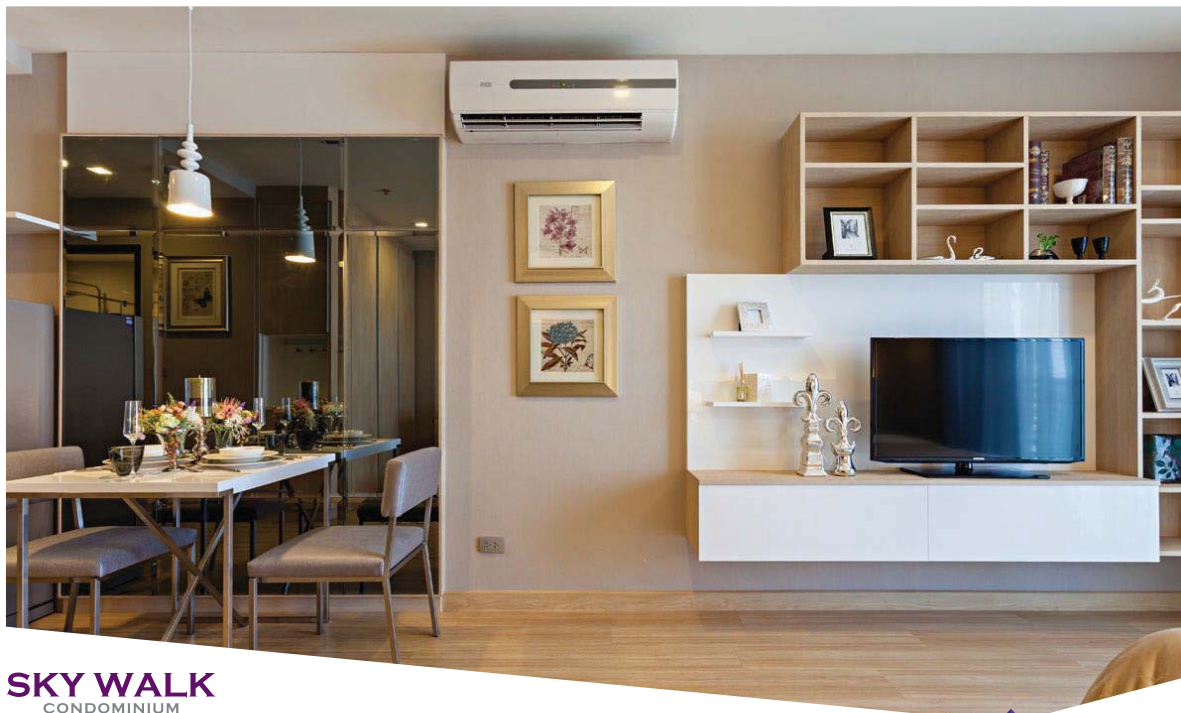

## SHOW SUITES — 1 BEDROOM

Photo taken from the actual project



**SKY WALK**  
CONDOMINIUM



## SHOW SUITES — 1 BEDROOM

Photo taken from the actual project



**SKY WALK**  
CONDOMINIUM



# RESIDENCES FACILITIES

Photo taken from the actual project



**SKY WALK**  
CONDOMINIUM





## RESIDENCES FACILITIES

Photo taken from the actual project



### LIFT HALL Ground Floor

Photo taken from the actual project

**SKY WALK**  
CONDOMINIUM



# RESIDENCES FACILITIES

Photo taken from the actual project

## SWIMMING POOL 11th Floor

Photo taken from the actual project



**SKY WALK**  
CONDOMINIUM

## RESIDENCES FACILITIES

Photo taken from the actual project



Le FITNESS  
11th Floor

Photo taken from the actual project

**SKY WALK**  
CONDOMINIUM



## RESIDENCES FACILITIES

Photo taken from the actual project

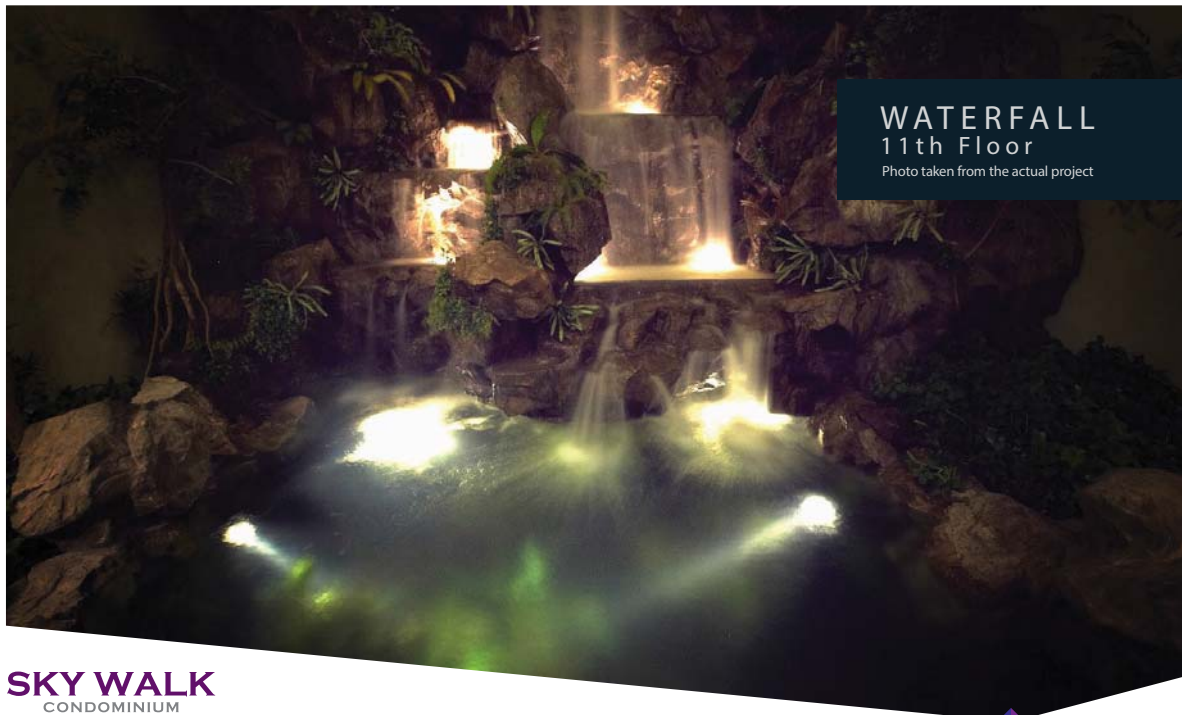

**WATERFALL**  
11th Floor

Photo taken from the actual project

**SKY WALK**  
CONDOMINIUM





## RESIDENCES FACILITIES

Photo taken from the actual project



### KID ROOM 11th Floor

Photo taken from the actual project

**SKY WALK**  
CONDOMINIUM



## RESIDENCES FACILITIES

Photo taken from the actual project



**SKY WALK**  
CONDOMINIUM

## RESIDENCES FACILITIES

Photo taken from the actual project



**SKY LOBBY**  
46th Floor

Photo taken from the actual project

**SKY WALK**  
CONDOMINIUM



# RESIDENCES FACILITIES

Photo taken from the actual project



**SKY WALK**  
46th Floor

Photo taken from the actual project

**SKY WALK**  
CONDOMINIUM



# RESIDENCES FACILITIES

Photo taken from the actual project

SKY LOBBY  
(OUTDOOR)  
46th Floor

Photo taken from the actual project



**SKY WALK**  
CONDOMINIUM



# RESIDENCES FACILITIES

Photo taken from the actual project

COMMERCIAL  
HELIPAD  
50th Floor  
Photo taken from the actual project



**SKY WALK**  
CONDOMINIUM





# FLOORPLAN

## 11<sup>TH</sup> FLOOR

SUKHUMVIT ROAD

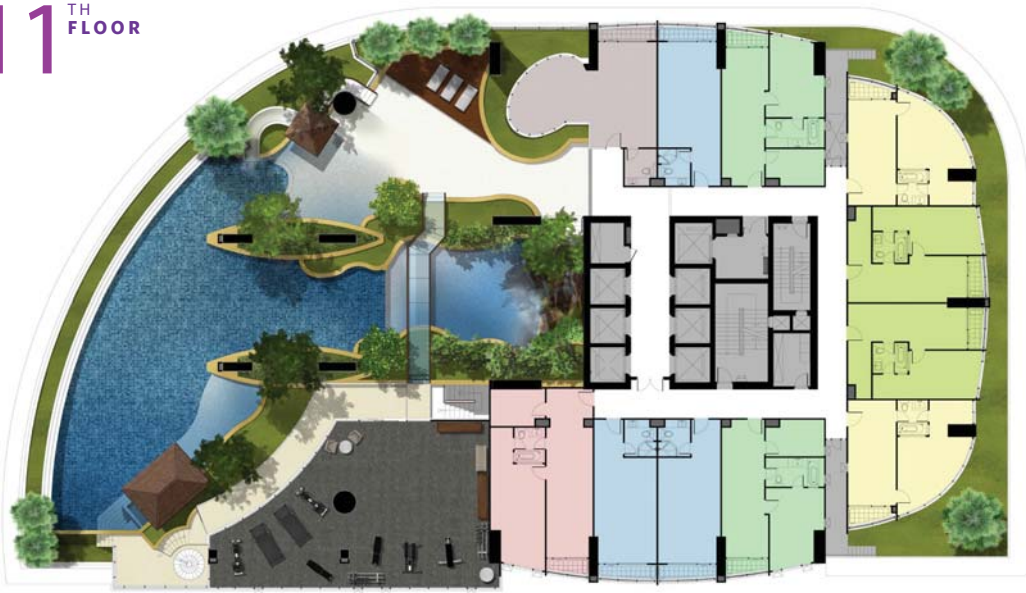

The floor layouts are subject to any amendments as required by the relevant authorities.

**SKY WALK**  
CONDOMINIUM



# FLOORPLAN

## 12<sup>TH</sup> FLOOR

SUKHUMVIT ROAD

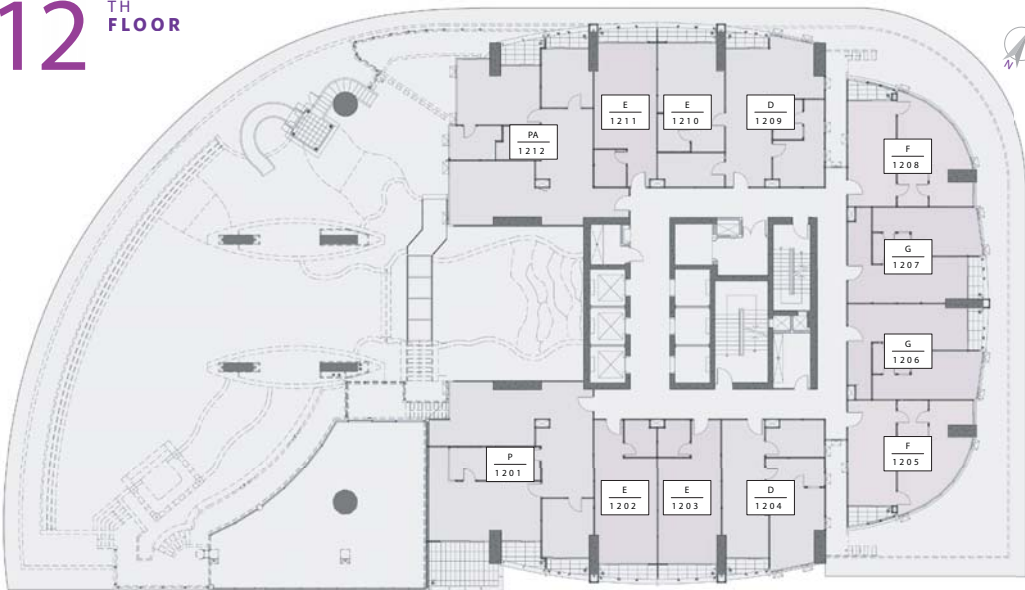

The floor layouts are subject to any amendments as required by the relevant authorities.

**SKY WALK**  
CONDOMINIUM



# FLOORPLAN

14<sup>TH</sup>  
FLOOR  
18

SUKHUMVIT ROAD

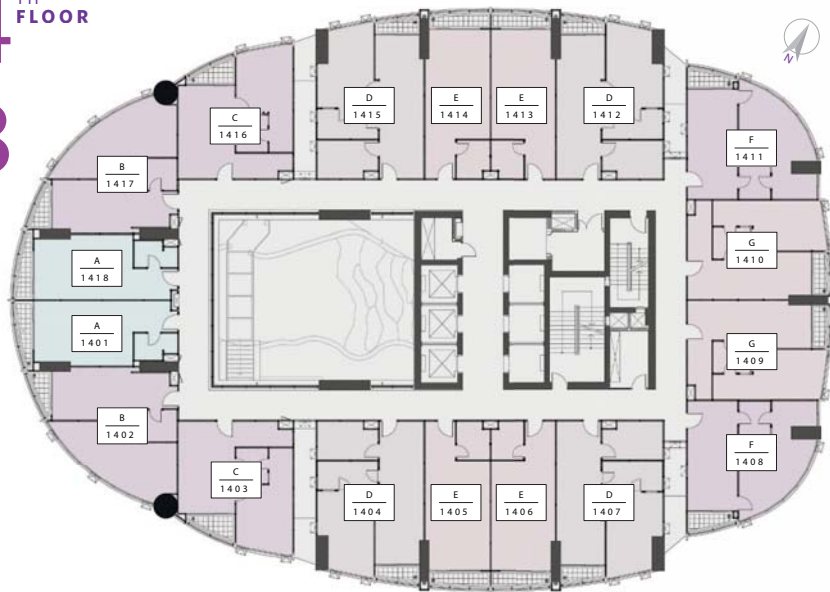

The floor layouts are subject to any amendments as required by the relevant authorities.

**SKY WALK**  
CONDOMINIUM

# FLOORPLAN

## 19<sup>TH</sup> FLOOR

SUKHUMVIT ROAD

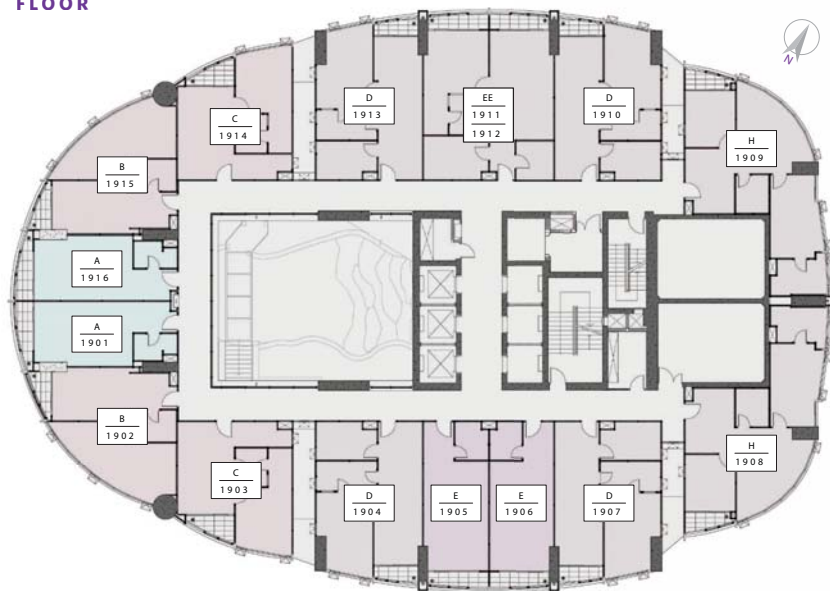

The floor layouts are subject to any amendments as required by the relevant authorities.

# FLOORPLAN

20<sup>TH</sup>  
21<sup>ST</sup> FLOOR

SUKHUMVIT ROAD

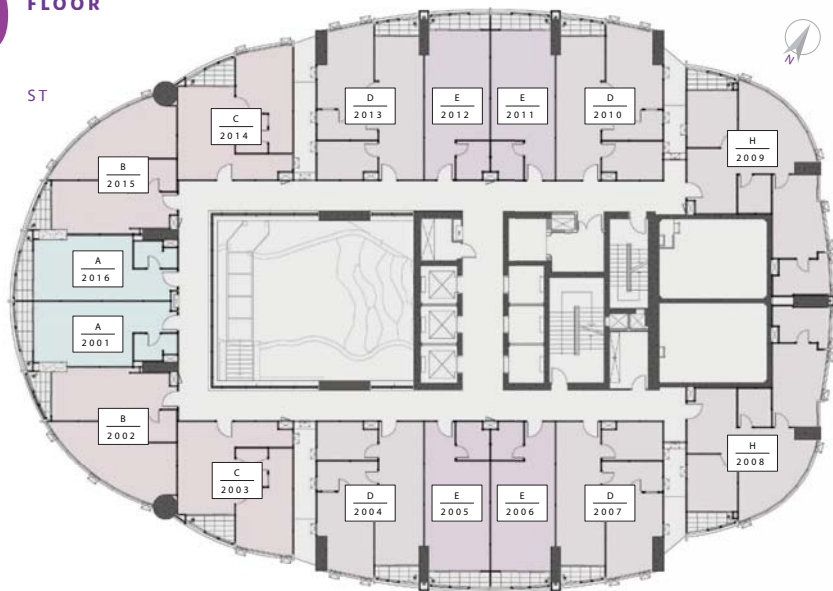

The floor layouts are subject to any amendments as required by the relevant authorities.

**SKY WALK**  
CONDOMINIUM

# FLOORPLAN

## 22<sup>TH</sup> FLOOR

SUKHUMVIT ROAD

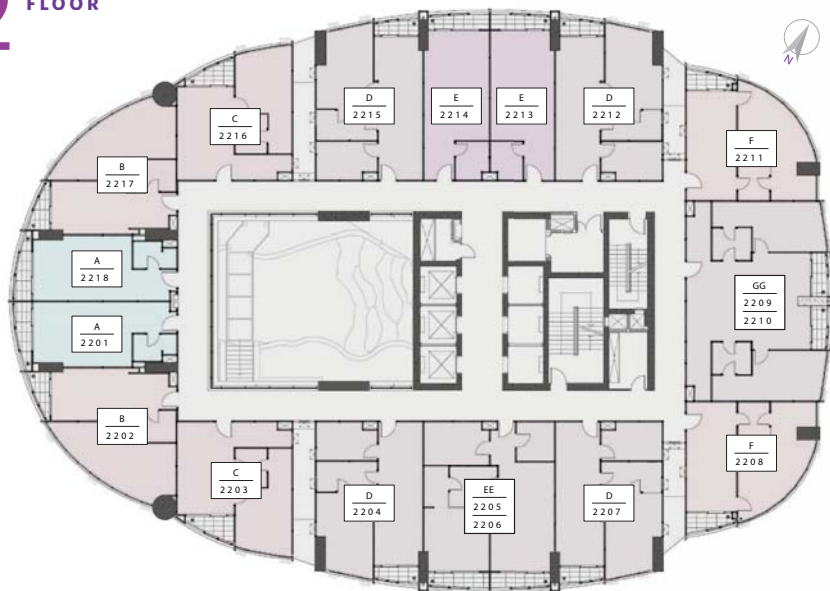

The floor layouts are subject to any amendments as required by the relevant authorities.

# FLOORPLAN

## 23<sup>RD</sup> FLOOR

SUKHUMVIT ROAD

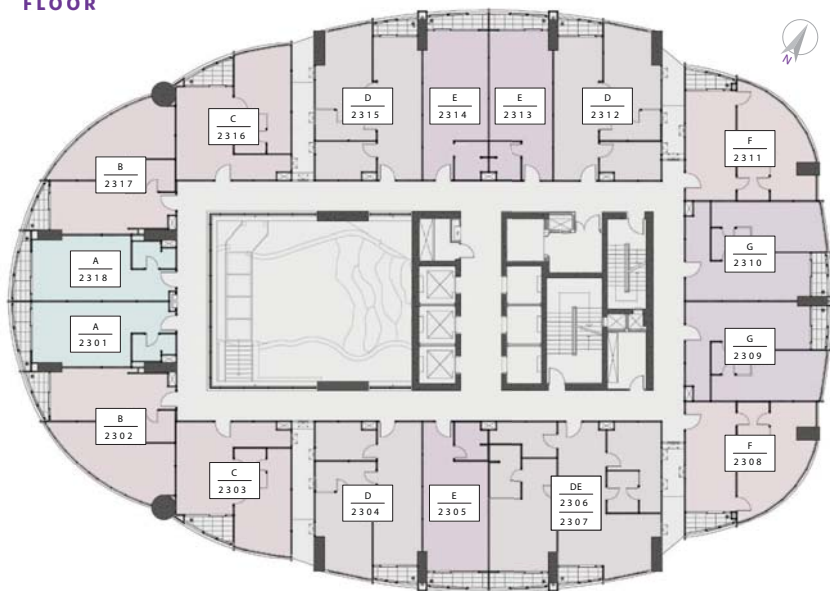

The floor layouts are subject to any amendments as required by the relevant authorities.

# FLOORPLAN

## 24<sup>TH</sup> FLOOR

SUKHUMVIT ROAD

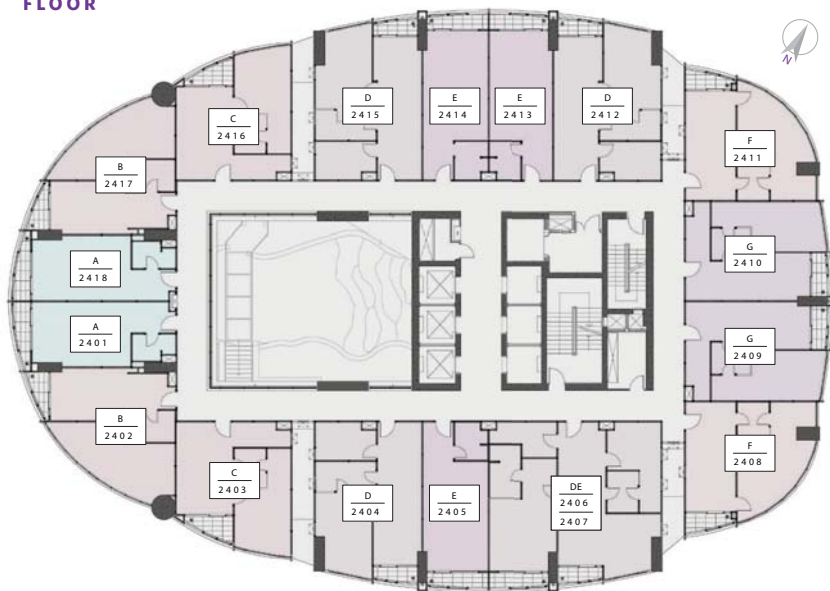

The floor layouts are subject to any amendments as required by the relevant authorities.

# FLOORPLAN

## 25<sup>TH</sup> FLOOR

SUKHUMVIT ROAD

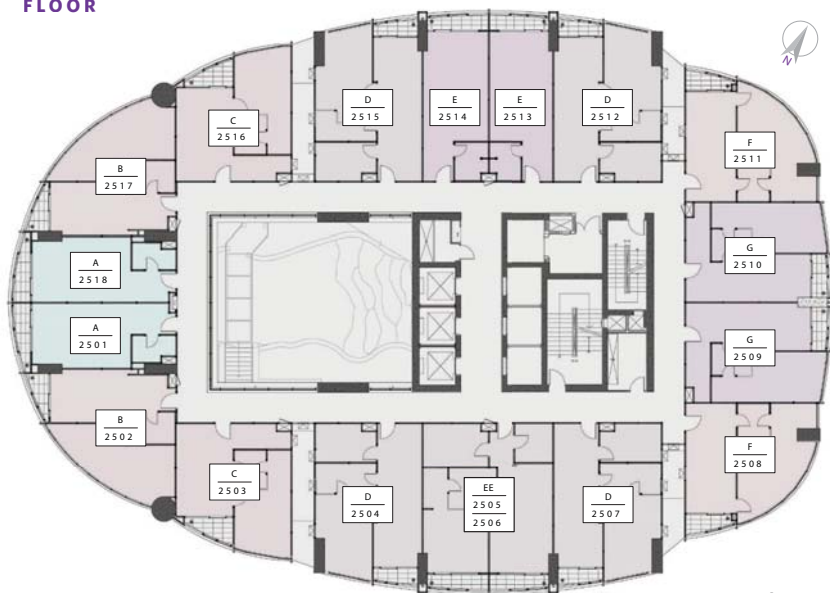

The floor layouts are subject to any amendments as required by the relevant authorities.

# FLOORPLAN

## 26<sup>TH</sup> FLOOR

SUKHUMVIT ROAD

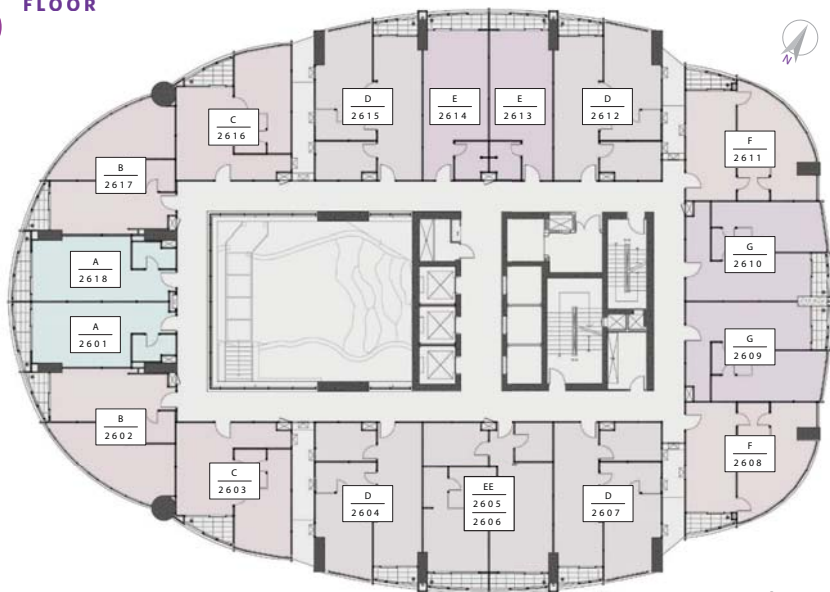

The floor layouts are subject to any amendments as required by the relevant authorities.



# FLOORPLAN

## 27<sup>TH</sup> FLOOR

SUKHUMVIT ROAD

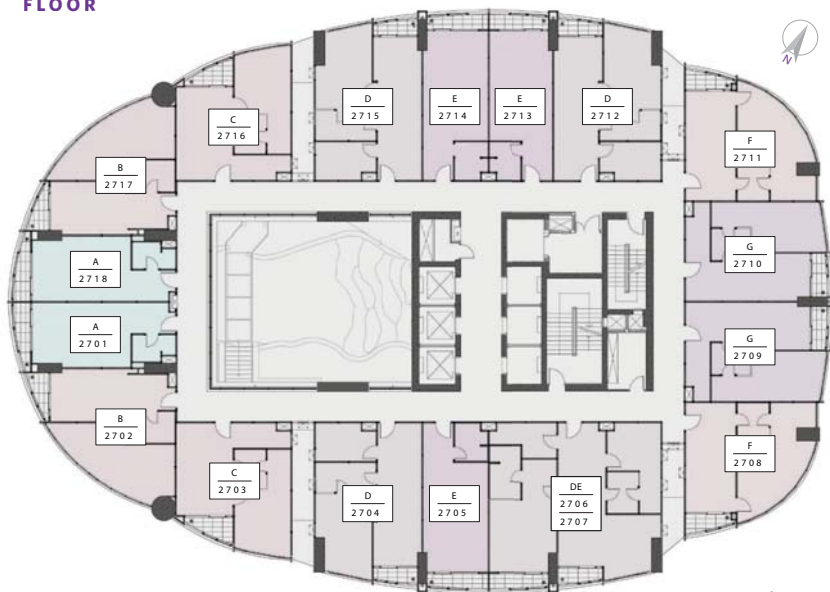

The floor layouts are subject to any amendments as required by the relevant authorities.

# FLOORPLAN

## 28<sup>TH</sup> FLOOR

SUKHUMVIT ROAD

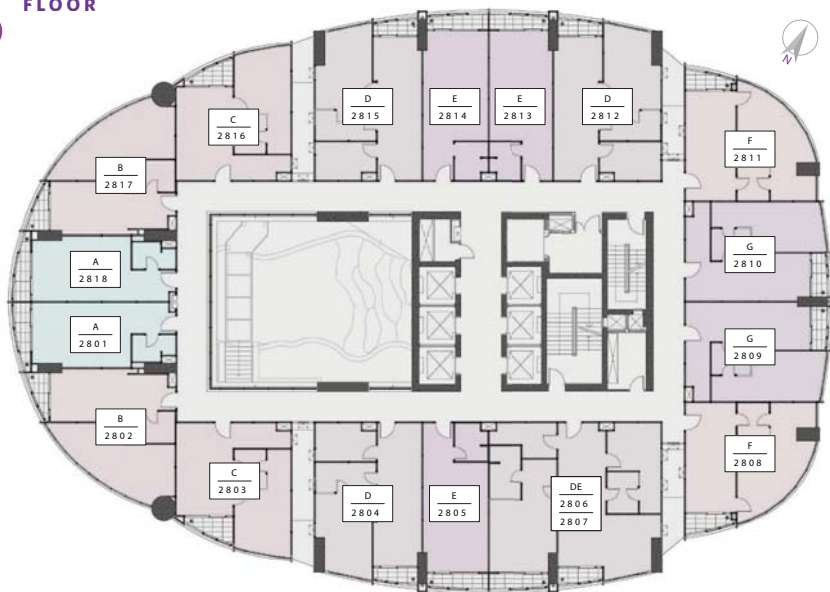

The floor layouts are subject to any amendments as required by the relevant authorities.

# FLOORPLAN

## 29<sup>TH</sup> FLOOR

SUKHUMVIT ROAD

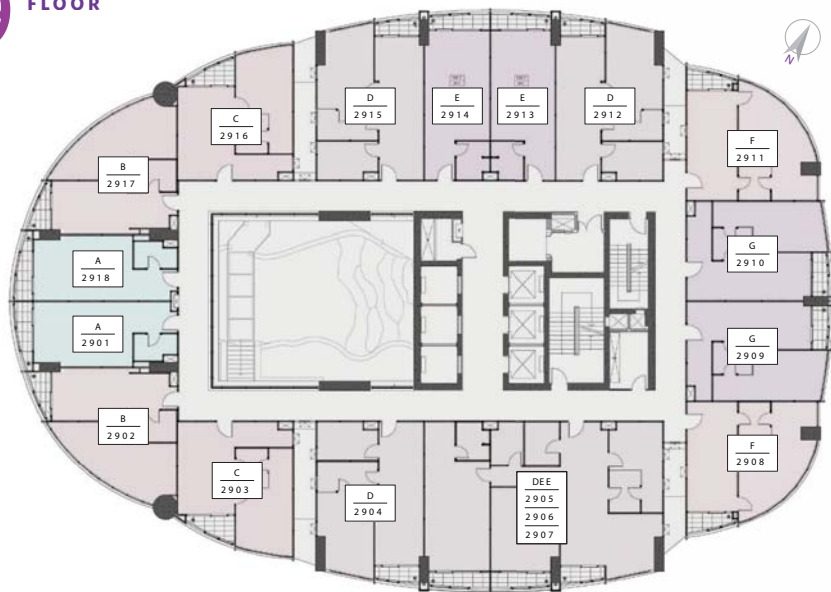

The floor layouts are subject to any amendments as required by the relevant authorities.

# FLOORPLAN

## 30<sup>TH</sup> FLOOR

SUKHUMVIT ROAD

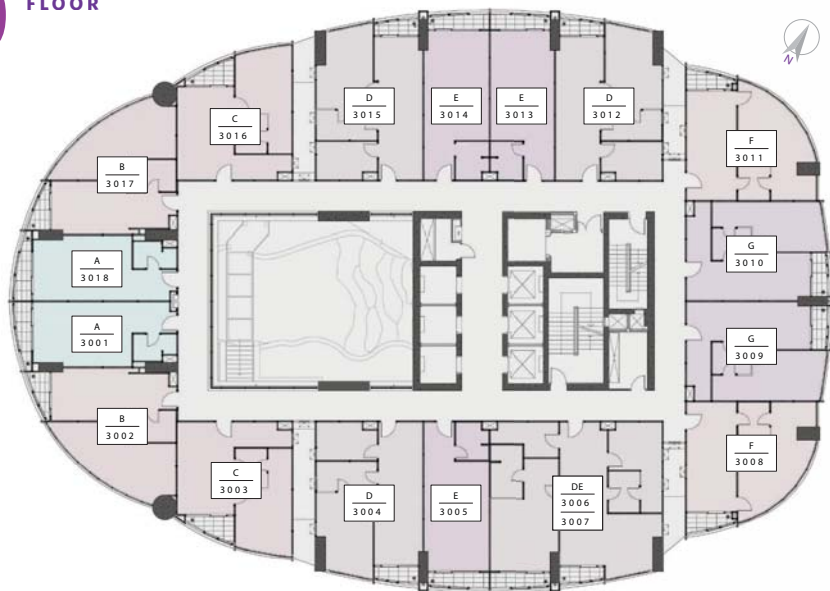

The floor layouts are subject to any amendments as required by the relevant authorities.

# FLOORPLAN

## 31<sup>ST</sup> FLOOR

SUKHUMVIT ROAD

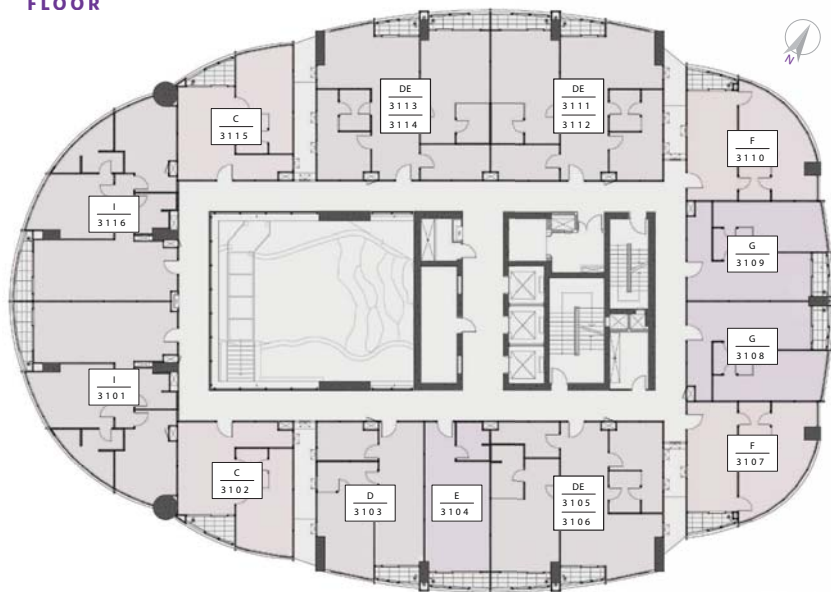

The floor layouts are subject to any amendments as required by the relevant authorities.

# FLOORPLAN

## 32<sup>TH</sup> FLOOR

SUKHUMVIT ROAD

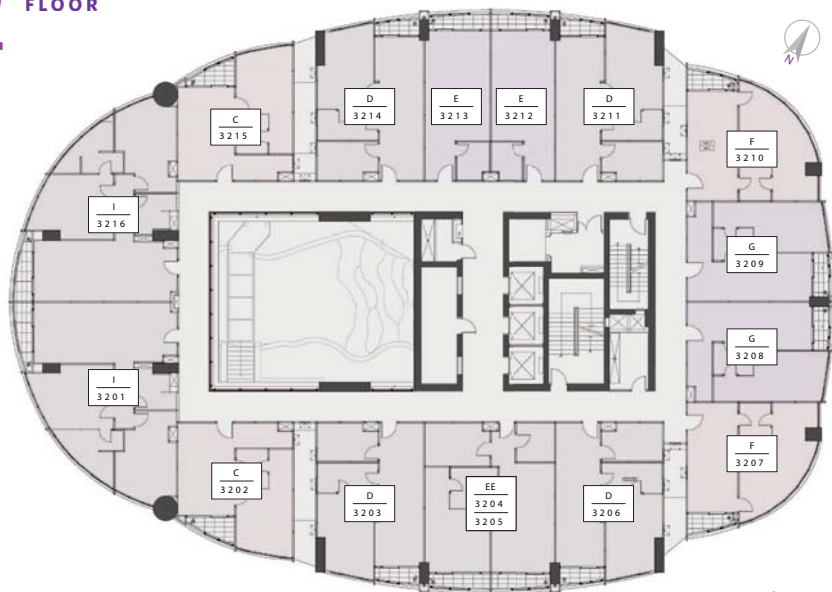

The floor layouts are subject to any amendments as required by the relevant authorities.

**SKY WALK**  
CONDOMINIUM

# FLOORPLAN

## 33<sup>TH</sup> FLOOR

SUKHUMVIT ROAD

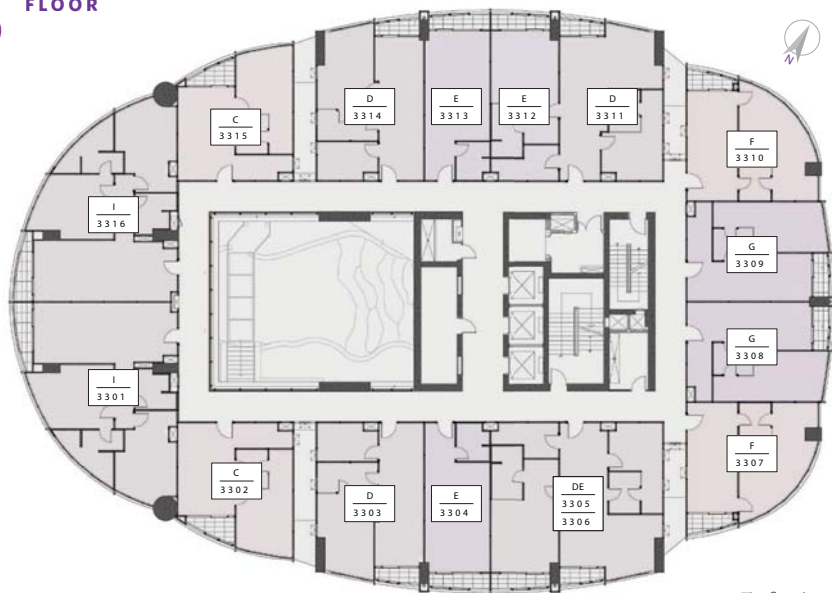

The floor layouts are subject to any amendments as required by the relevant authorities.

# FLOORPLAN

## 34<sup>TH</sup> FLOOR

SUKHUMVIT ROAD

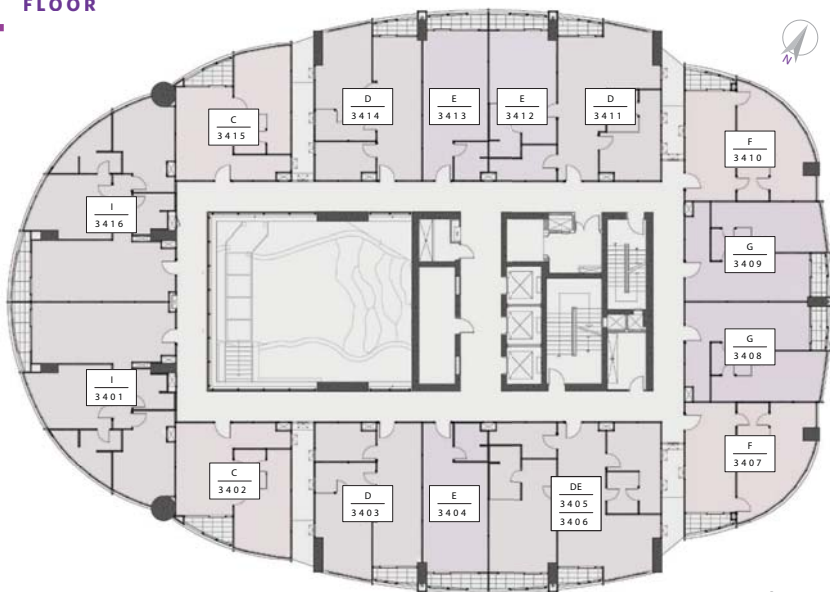

The floor layouts are subject to any amendments as required by the relevant authorities.

**SKY WALK**  
CONDOMINIUM



# FLOORPLAN

## 35<sup>TH</sup> FLOOR

SUKHUMVIT ROAD

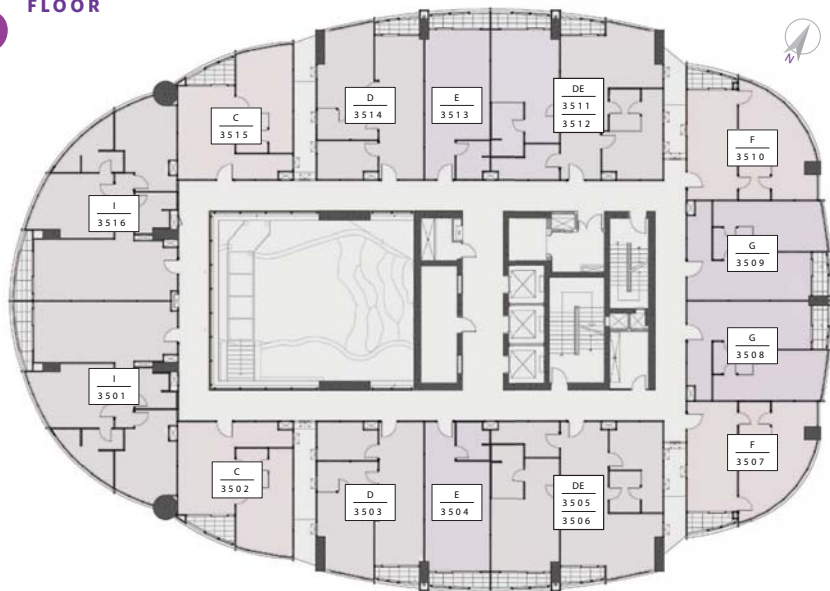

The floor layouts are subject to any amendments as required by the relevant authorities.

**SKY WALK**  
CONDOMINIUM

# FLOORPLAN

36<sup>TH</sup>  
FLOOR  
37

SUKHUMVIT ROAD

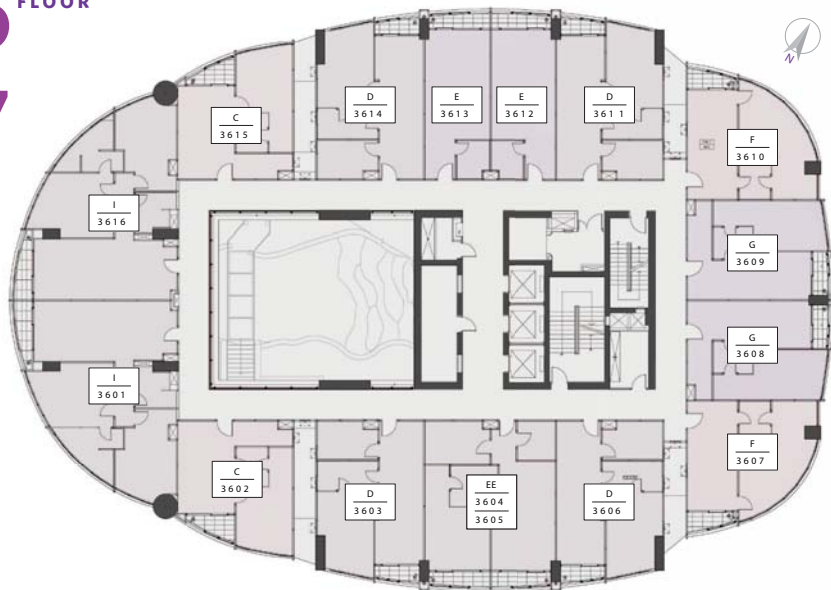

The floor layouts are subject to any amendments as required by the relevant authorities.

**SKY WALK**  
CONDOMINIUM

# FLOORPLAN

## 38<sup>TH</sup> FLOOR

SUKHUMVIT ROAD

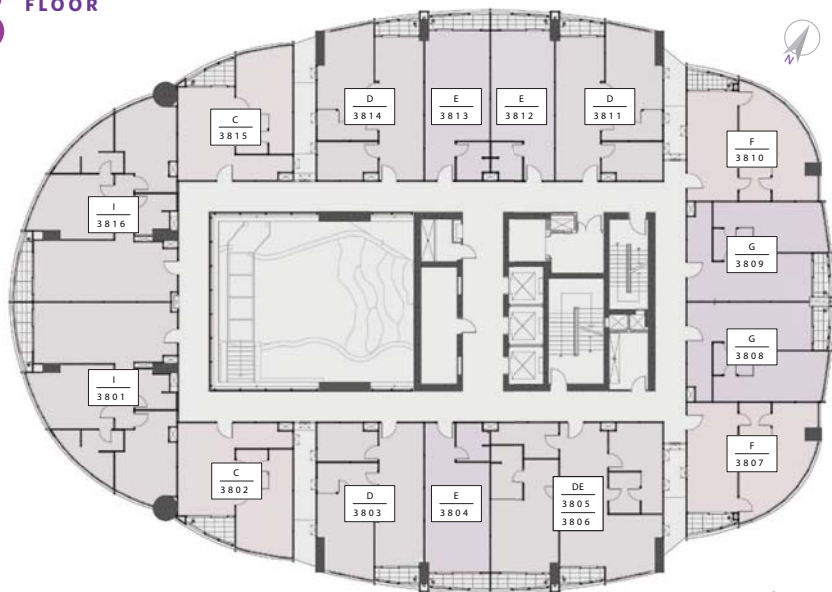

The floor layouts are subject to any amendments as required by the relevant authorities.

# FLOORPLAN

## 39<sup>TH</sup> FLOOR

SUKHUMVIT ROAD

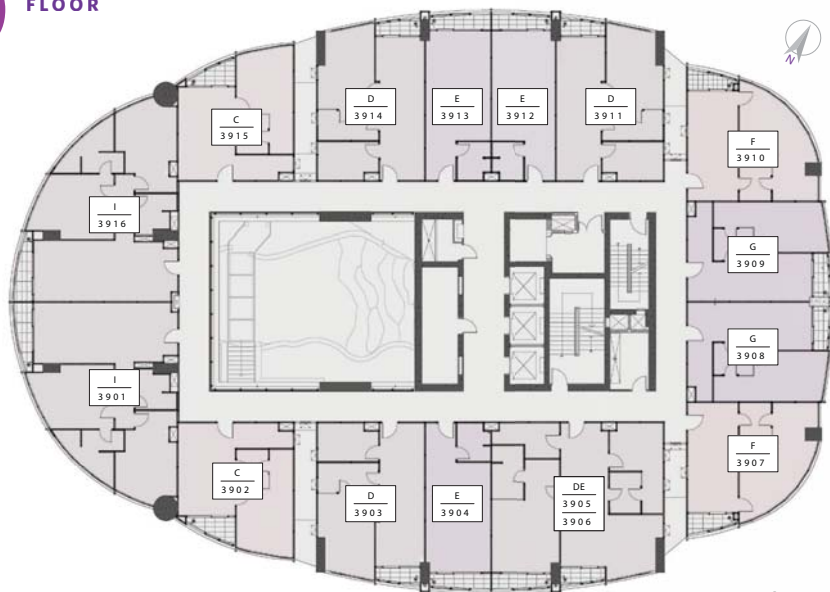

The floor layouts are subject to any amendments as required by the relevant authorities.

# FLOORPLAN

## 40<sup>TH</sup> FLOOR

SUKHUMVIT ROAD

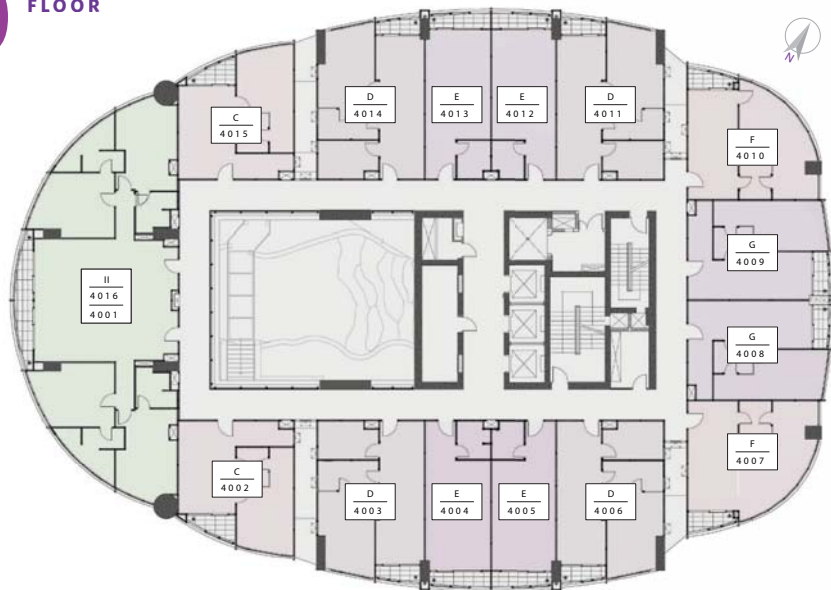

The floor layouts are subject to any amendments as required by the relevant authorities.

**SKY WALK**  
CONDOMINIUM

# FLOORPLAN

42<sup>TH</sup>  
FLOOR  
43<sup>RD</sup>

SUKHUMVIT ROAD

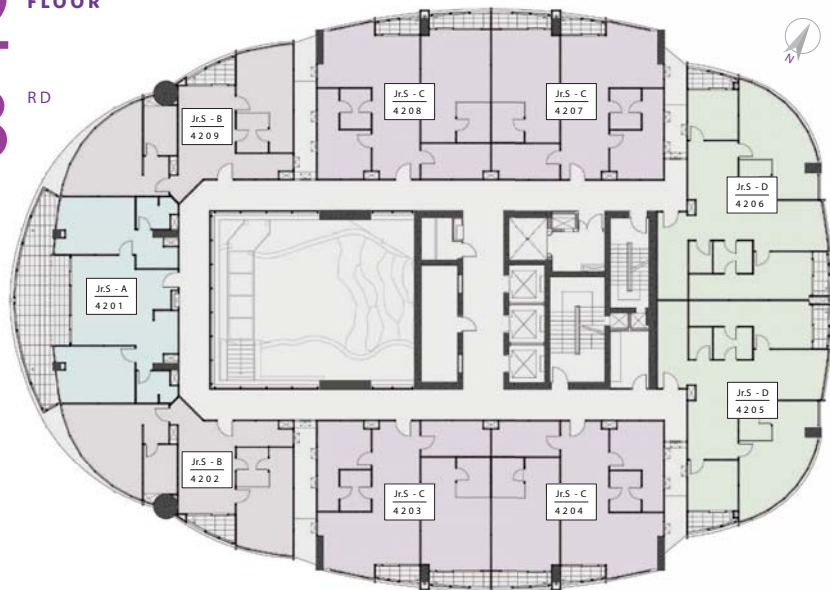

The floor layouts are subject to any amendments as required by the relevant authorities.

**SKY WALK**  
CONDOMINIUM

# UNIT LAYOUT

## TYPE A

### Studio

36.86-37.94 sq.m.

SUKHUMVIT ROAD



The unit layouts and floor layouts are subject to any amendments as required by the relevant authorities.

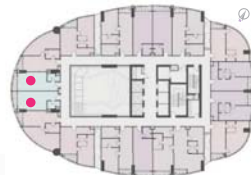

Available at Weltz  
Floor no. 23 - 28

Available at Skywalk  
Floor no. 17th/20th -  
21th /30th

**SKY WALK**  
CONDOMINIUM

# UNIT LAYOUT

## TYPE E

**1 BR Junior**

36.69-40.06 sq.m.



The unit layouts and floor layouts are subject to any amendments as required by the relevant authorities.

Available at Weltz  
**Floor no. 23 - 24, 25-26  
27,28, 32, 33-34, 38-39**

Available at Skywalk  
**Floor no. 14-21/30-31/  
35/40**





# UNIT LAYOUT

## TYPE E

### 1 BR Junior

36.69-40.06 sq.m.

The floor layouts are subject to any amendments as required by the relevant authorities.

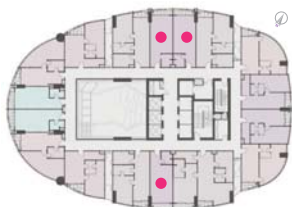

23 - 24

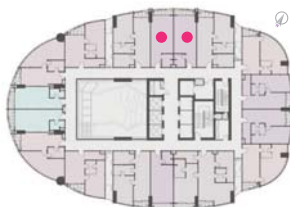

25-26

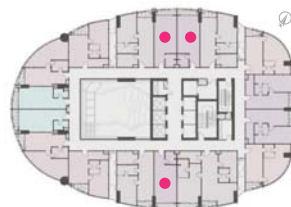

27-28

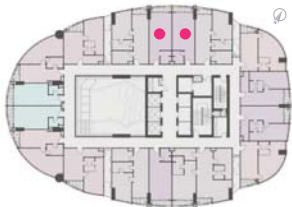

32

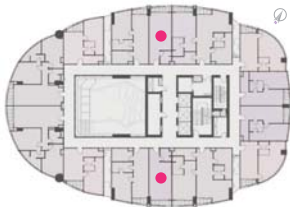

33-34

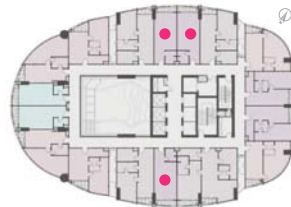

38-39

# UNIT LAYOUT

## TYPE E

**1 BR Junior**

36.69-40.06 sq.m.

The floor layouts are subject to any amendments as required by the relevant authorities.

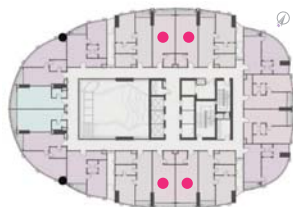

**14-18**

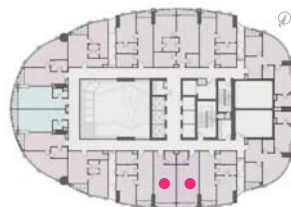

**19**

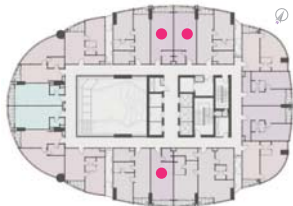

**30**

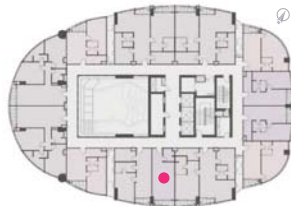

**31**

# UNIT LAYOUT

## TYPE E

### 1 BR Junior

36.69-40.06 sq.m.

The floor layouts are subject to any amendments as required by the relevant authorities.

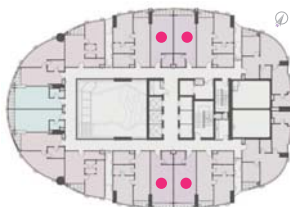

20-21

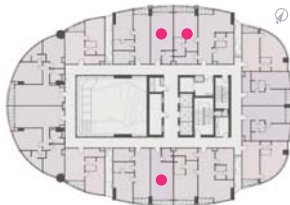

35

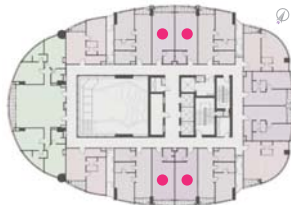

40

# UNIT LAYOUT

## TYPE B

**1 Bedroom**

53.91-54.28 sq.m.

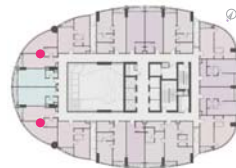

The unit layouts and floor layouts are subject to any amendments as required by the relevant authorities.

**Available at Weltz  
Floor no. 23 - 24,  
25-26, 27-28**

**Available at Skywalk  
Floor no. 17 - 19**

# UNIT LAYOUT

## TYPE C

**1 Bedroom**

51.77-51.82 sq.m.

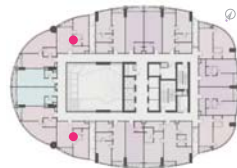

The unit layouts and floor layouts are subject to any amendments as required by the relevant authorities.

Available at  
**Floor no. 23 - 24, 25-26  
27-28, 32, 33-34, 38-39**

Available at  
**Floor no. 17 - 19**

# UNIT LAYOUT

## TYPE F

**1 Bedroom**

50.98-51.63 sq.m.

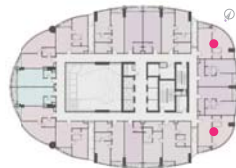

The unit layouts and floor layouts are subject to any amendments as required by the relevant authorities.

Available at Weltz  
**Floor no. 23 - 24, 25-26  
27-28, 32, 33-34, 38-39**

Available at Skywalk  
**Floor no. 12/14-18/22/  
31/35/37**



# UNIT LAYOUT

## TYPE F

### 1 Bedroom

50.98-51.63 sq.m.

The floor layouts are subject to any amendments as required by the relevant authorities.

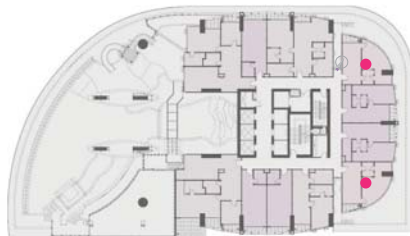

12

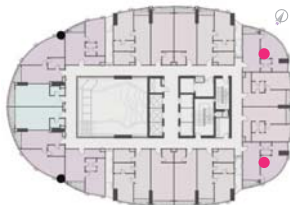

14-18

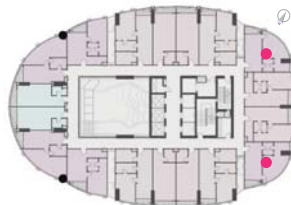

22/31/35/37

# UNIT LAYOUT

## TYPE G

**1 Bedroom**

50.60-50.96 sq.m.

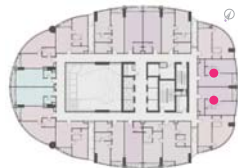

The unit layouts and floor layouts are subject to any amendments as required by the relevant authorities.

Available at  
**Floor no. 23 - 24, 25-26  
27-28, 32, 33-34, 38-39**





# UNIT LAYOUT

## TYPE D

**1 Bedroom**

59.79-60.96 sq.m.

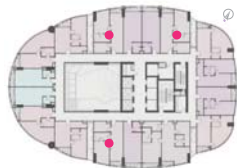

The unit layouts and floor layouts are subject to any amendments as required by the relevant authorities.

Available at  
**Floor no. 23 - 24, 25-26  
27-28, 32, 33-34, 38-39**



# UNIT LAYOUT

## TYPE D

### 1 Bedroom

59.79-60.96 sq.m.

The floor layouts are subject to any amendments as required by the relevant authorities.

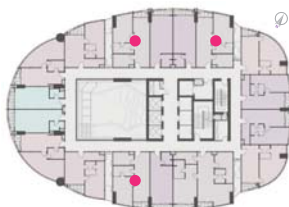

23 - 24

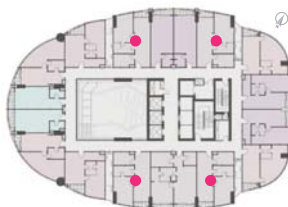

25-26

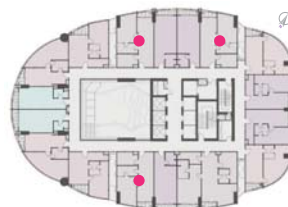

27-28

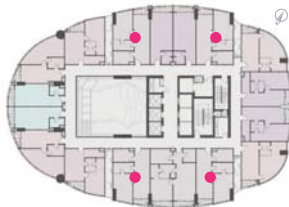

32

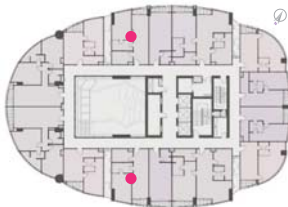

33-34

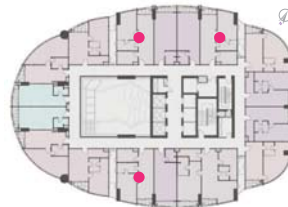

38-39

# UNIT LAYOUT

## TYPE DE

### 2 Bedroom

100.48 - 101.05 sq.m.



The unit layouts are subject to any amendments as required by the relevant authorities.

Available at  
**Floor no. 23 - 24,  
27-28, 33-34, 38-39**



# UNIT LAYOUT

## TYPE DE

**2 Bedroom**

100.48 - 101.05 sq.m.

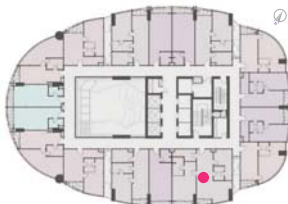

**23 - 24**

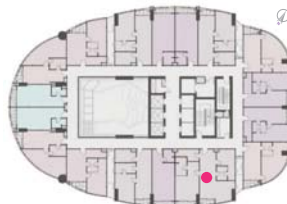

**27-28**



**33-34**

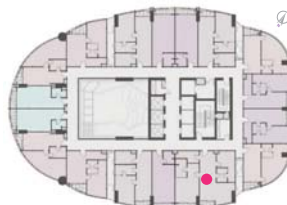

**38-39**

The floor layouts are subject to any amendments as required by the relevant authorities.



# UNIT LAYOUT

## TYPE EE

**2 Bedroom**

79.75 – 80.15 sq.m.

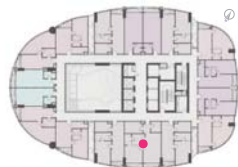

**25-26**



**32**

The unit layouts and floor layouts are subject to any amendments as required by the relevant authorities.

Available at  
**Floor no. 25 - 26, 32**

**SKY WALK**  
CONDOMINIUM

# UNIT LAYOUT

## TYPE I

**2 Bedroom**

91.59 sq.m.



The unit layouts are subject to any amendments as required by the relevant authorities.

Available at  
**Floor no. 32, 33-34,  
38-39**

**SKY WALK**  
CONDOMINIUM



# UNIT LAYOUT

## TYPE I

**2 Bedroom**

91.59 sq.m.



32



33-34



38-39

The floor layouts are subject to any amendments as required by the relevant authorities.

# SPECIFICATION

## Kitchen

Counter	: Kitchen From RCD
Hood	: TEKA
Hop	: TEKA

## Sanitary ware

Counter	: Fully counter from RCD with equipment and lockers
Water heater	: Stiebele bathtub 6 Kw. / SHOWER 4 Kw.
Toilets	: AMERICAN STANDARD
Bathtub	: Bathroom Design
Basim Faucet	: HAFELE
Shower	: AMERICAN STANDARD

## Other

Digital Door Lock	: Samsung
-------------------	-----------





## BUILT IN AND FLEXIBLE FURNISH

ITEM	DESCRIPTION	QUANTITY	UNIT
BUILT - IN FURNISH			
B-01	Wall glass	1	set
B-02	Wall mounted TV shelf w/cabinet	1	set
B-03	Wall mounted TV and dressing table	1	set
B-04	Wardrobe (lighting inside)	1	set
B-05	King size bed (included headboard and bedside lamp)	1	set
FLEXIBLE FURNISH			
F-01	Dinning table	1	set
F-02	Dinning chair	2	sets
F-03A	Fabric sofa (2 seats)	1	set
F-05A	Coffee/Tea table	1	set
F-06	King size bed	1	set

Note : Size and items will be different room type

