

CITK

How to switch Timezones for your
Dashboards



How to switch Timezones for your Dashboards

For teams with members across various time zones, personalize your dashboard experience with the Timezone Switcher. Users can manage and update time zones for the dashboards they view based on their preferences.

Step 1: Open any dashboard (private or shared)

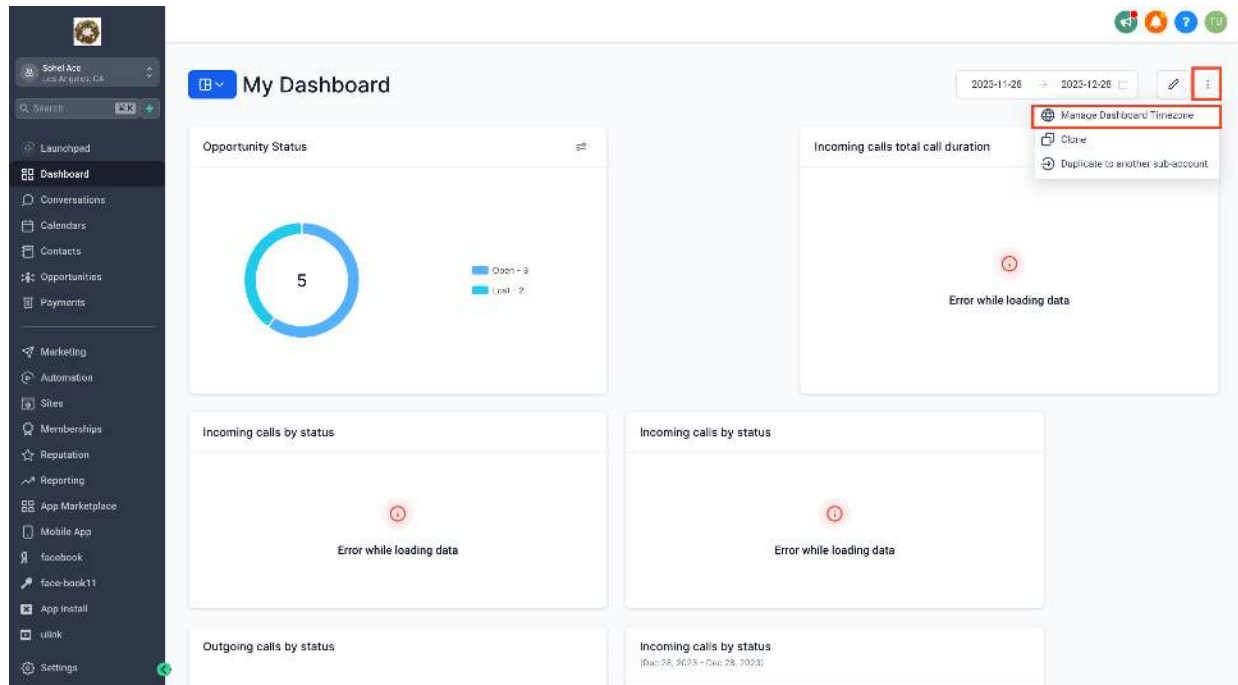

Step 3: Choose "Manage Dashboard Timezone"

Step 4: Select your desired timezone

How to switch Timezones for your Dashboards

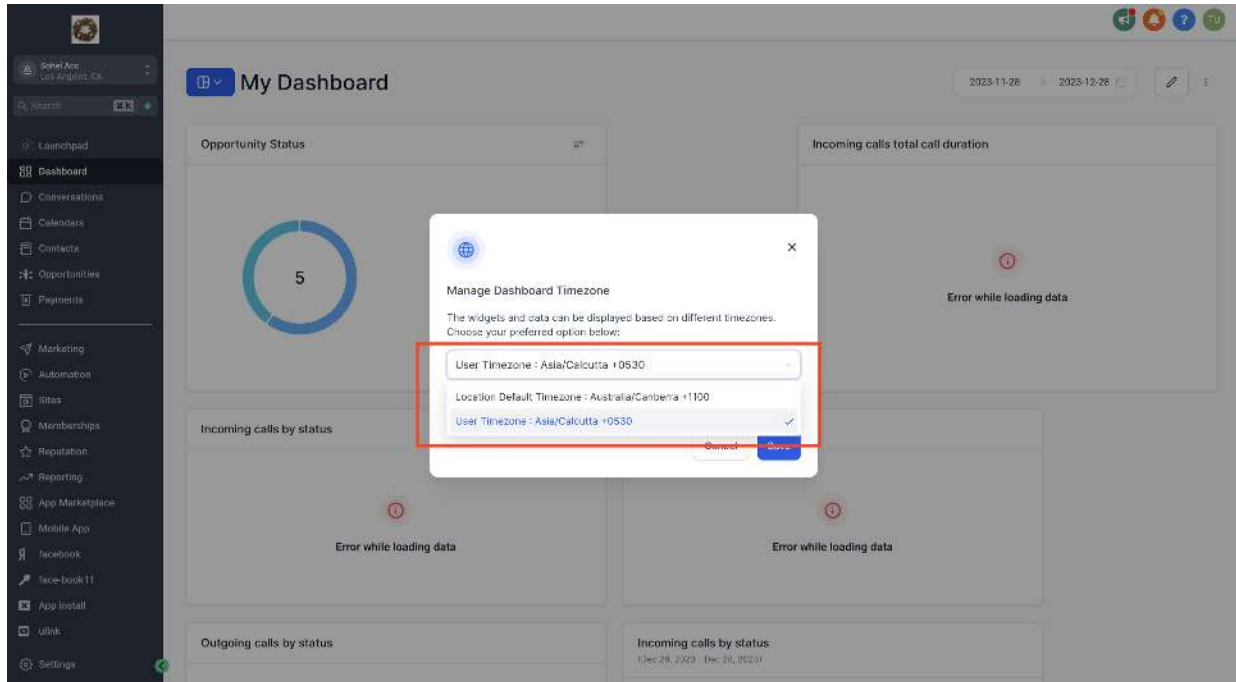

Step 5: Save your changes

Note:

The selected timezone will be applied to all dashboards you view. This feature is available across all plans and roles, allowing anyone with dashboard access to tailor the timezone for their view. Enhance your dashboard experience and stay efficient!