



BUYERS GUIDE



2024

BUYING AN ALASKAN

When it comes to choosing the right Alaskan Camper, it's important to consider your travel goals and personal needs. There are different models available, each with their unique features and benefits. Whether you're looking for a rugged off-road vehicle or a luxurious mobile home, finding the perfect camper means matching your requirements with the options available. Once you've chosen the right model, your Alaskan Camper becomes your home on the road, allowing you to explore nature's beauty and create unforgettable memories. The possibilities are endless.



6.5' CAMPER

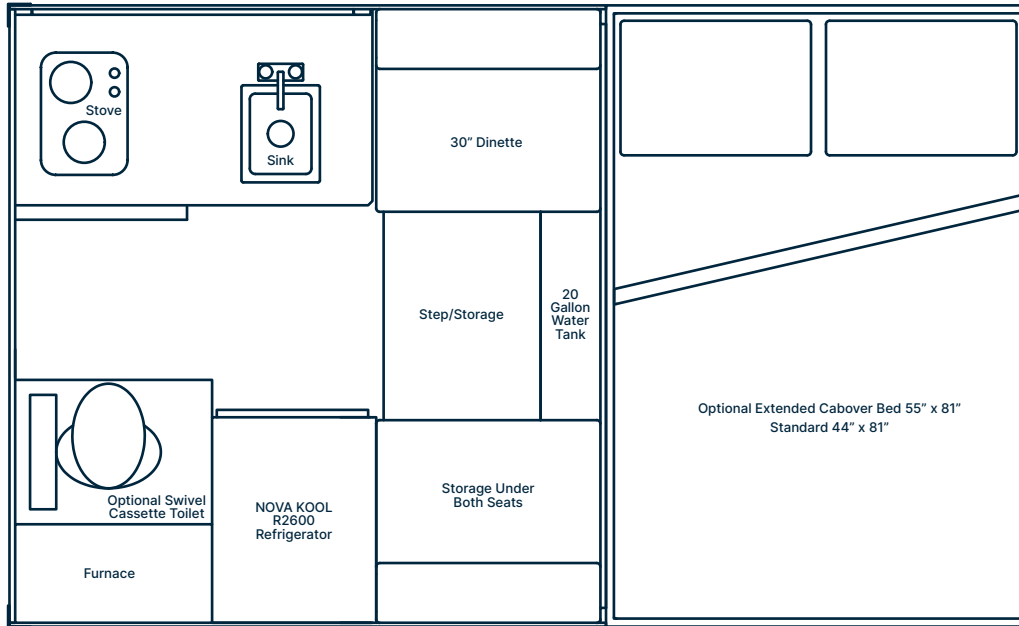

| SPECIFICATIONS | |
|-----------------|-----------------------------|
| Dry Weight | 1390 lbs |
| Wet Weight | 1550 lbs |
| Floor Length | 80" |
| Overall Length | 137" |
| Width | 83.5" |
| Interior Height | 70" |
| Exterior Height | 62.5" lowered, 83.5" raised |
| Truck Type | Short Bed |

| CAPACITIES | |
|---------------|---------------------|
| Fresh Water | 15 gallons |
| Grey Water | N/A |
| Black Water | 4.5 gallon cassette |
| Water Heater | Optional 4 gallon |
| Propane Tanks | 20 lb |
| Batteries | One Battery |

| | |
|----------------|--------------------|
| Starting Price | \$39,900.00 |
|----------------|--------------------|

Included Features

Jack Plates. Nova Kool 2600 Refrigerator. 20,000 BTU Suburban Forced Air Furnace. Stainless Steel Sink. Spray Foam Insulation R-13. 2-Burner Stove. Premium Fold Out Seating. DEKA Group 31 AGM Battery. Custom Dovetail Drawers. LED Interior, Porch & Clearance Lights. 27 Gallon Water Tank (15 Gallon in 6.5). SHURFLO Electric Water Pump. IOTA 45 Amp Converter/Battery Charger w/Smart Charger. Solid Maple Hand Sanded Trim. Custom Handcrafted Cabinetry. 20lb Propane Tank w/ Gauge. Two Maxx-Air Roof Vents w/Reverse. STEP-UP Folding Stairs. AC Wiring. Awning Rail.

Optional Add-On Features

DC to DC Converter. Back Up Camera. Sink Cover. Top Rack Mounts. Bluetooth/CD/USB 2 Speaker Stereo. Novakool 3.5 cu/ft Refrigerator. THETFORD Cassette Toilet. Nature's Head Composting Toilet. RIECO TITAN Removable Jacks w/Extensions. Outside Shower. Indoor Shower. 12 Volt Outlet w/ USB ports. Air Conditioner. Suburban 4 Gallon Water Heater. Zamp 190 Watt Solar Panel w/Control. Zamp 190 Watt Solar Panel w/Control (x2). Taruca Awning. Fiamma Awning. Insulated Floor. 12v 100Ah Lithium Battery Package. 12v 100Ah Lithium Battery Package (x2). Flatbed Design. Flatbed Side Entry. Truma Combination Heating & Hot Water. Torklift Tie Downs / Fast Gun.

7' CAMPER

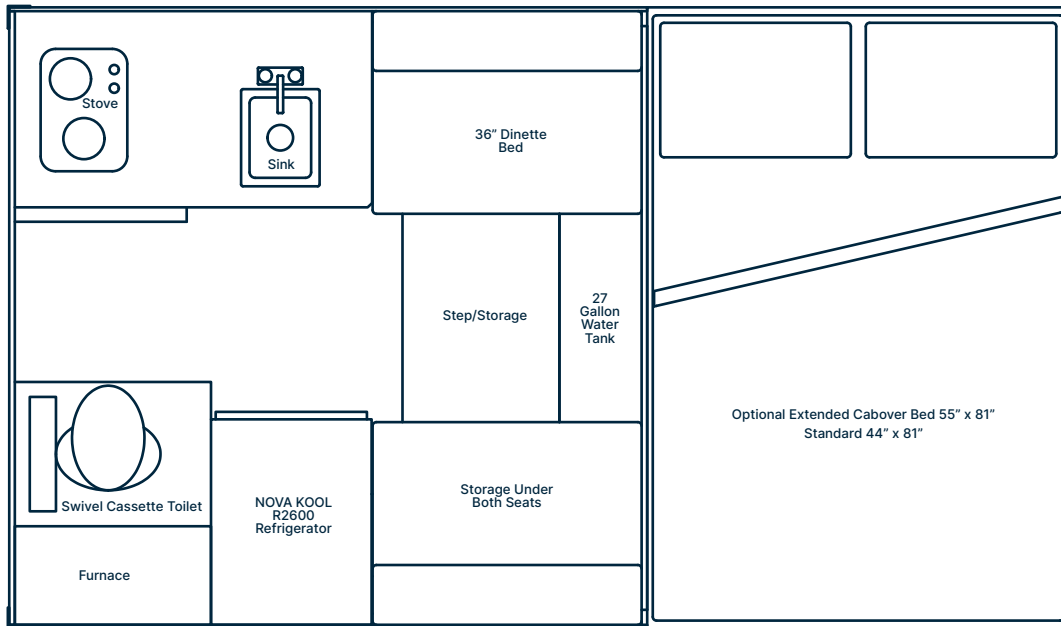

| SPECIFICATIONS | |
|-----------------|-----------------------------|
| Dry Weight | 1560 lbs |
| Wet Weight | 1816 lbs |
| Floor Length | 85.5" |
| Overall Length | 142.5" |
| Width | 83.5" |
| Interior Height | 70" |
| Exterior Height | 62.5" lowered, 83.5" raised |
| Truck Type | Short Bed |

| CAPACITIES | |
|---------------|---------------------|
| Fresh Water | 27 gallons |
| Grey Water | N/A |
| Black Water | 4.5 gallon cassette |
| Water Heater | Optional 4 gallon |
| Propane Tanks | 20 lb |
| Batteries | One Battery |

| | |
|----------------|-------------|
| Starting Price | \$40,900.00 |
|----------------|-------------|

Included Features

Jack Plates. Nova Kool 2600 Refrigerator. 20,000 BTU Suburban Forced Air Furnace. Stainless Steel Sink. Spray Foam Insulation R-13. 2-Burner Stove. Premium Fold Out Seating. DEKA Group 31 AGM Battery. Custom Dovetail Drawers. LED Interior, Porch & Clearance Lights. 27 Gallon Water Tank (15 Gallon in 6.5). SHURFLO Electric Water Pump. IOTA 45 Amp Converter/Battery Charger w/Smart Charger. Solid Maple Hand Sanded Trim. Custom Handcrafted Cabinetry. 20lb Propane Tank w/ Gauge. Two Maxx-Air Roof Vents w/Reverse. STEP-UP Folding Stairs. AC Wiring. Awning Rail.

Optional Add-On Features

DC to DC Converter. Back Up Camera. Sink Cover. Top Rack Mounts. Bluetooth/CD/USB 2 Speaker Stereo. Novakool 3.5 cu/ft Refrigerator. THETFORD Cassette Toilet. Nature's Head Composting Toilet. RIECO TITAN Removable Jacks w/Extensions. Outside Shower. Indoor Shower. 12 Volt Outlet w/ USB ports. Air Conditioner. Suburban 4 Gallon Water Heater. Zamp 190 Watt Solar Panel w/Control. Zamp 190 Watt Solar Panel w/Control (x2). Taruca Awning. Fiamma Awning. Insulated Floor. 12v 100Ah Lithium Battery Package. 12v 100Ah Lithium Battery Package (x2). Flatbed Design. Flatbed Side Entry. Truma Combination Heating & Hot Water. Torklift Tie Downs / Fast Gun.

8' CAMPER

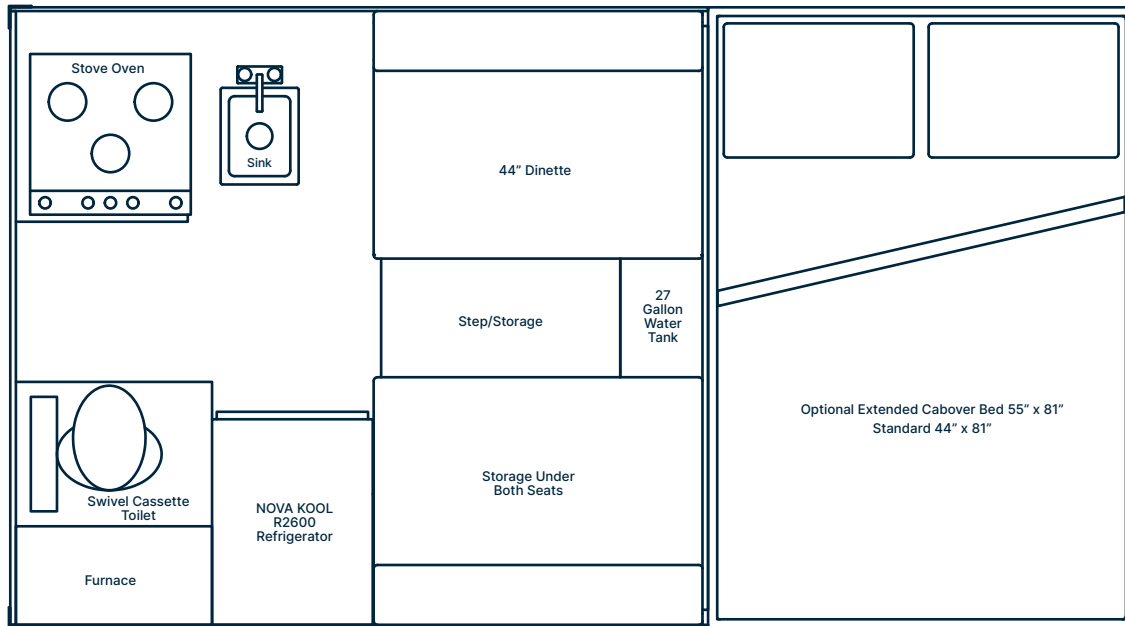

| SPECIFICATIONS | |
|-----------------|-----------------------------|
| Dry Weight | 1680 lbs |
| Wet Weight | 1936 lbs |
| Floor Length | 93.5" |
| Overall Length | 150.5" |
| Width | 83.5" |
| Interior Height | 70" |
| Exterior Height | 62.5" lowered, 83.5" raised |
| Truck Type | Long or Short Bed |

| CAPACITIES | |
|---------------|---------------------|
| Fresh Water | 27 gallons |
| Grey Water | N/A |
| Black Water | 4.5 gallon cassette |
| Water Heater | Optional 4 gallon |
| Propane Tanks | 20 lb |
| Batteries | One Battery |

| | |
|----------------|-------------|
| Starting Price | \$41,900.00 |
|----------------|-------------|

Included Features

Jack Plates. Nova Kool 2600 Refrigerator. 20,000 BTU Suburban Forced Air Furnace. Stainless Steel Sink. Spray Foam Insulation R-13. 2-Burner Stove. Premium Fold Out Seating. DEKA Group 31 AGM Battery. Custom Dovetail Drawers. LED Interior, Porch & Clearance Lights. 27 Gallon Water Tank (15 Gallon in 6.5). SHURFLO Electric Water Pump. IOTA 45 Amp Converter/Battery Charger w/Smart Charger. Solid Maple Hand Sanded Trim. Custom Handcrafted Cabinetry. 20lb Propane Tank w/ Gauge. Two Maxx-Air Roof Vents w/Reverse. STEP-UP Folding Stairs. AC Wiring. Awning Rail.

Optional Add-On Features

DC to DC Converter. Back Up Camera. Sink Cover. Top Rack Mounts. Bluetooth/CD/USB 2 Speaker Stereo. Novakool 3.5 cu/ft Refrigerator. THETFORD Cassette Toilet. Nature's Head Composting Toilet. RIECO TITAN Removable Jacks w/Extensions. Outside Shower. Indoor Shower. 12 Volt Outlet w/ USB ports. Air Conditioner. Suburban 4 Gallon Water Heater. Zamp 190 Watt Solar Panel w/Control. Zamp 190 Watt Solar Panel w/Control (x2). Taruca Awning. Fiamma Awning. Insulated Floor. 12v 100Ah Lithium Battery Package. 12v 100Ah Lithium Battery Package (x2). Flatbed Design. Flatbed Side Entry. Truma Combination Heating & Hot Water. Torklift Tie Downs / Fast Gun.

8.5' CAMPER

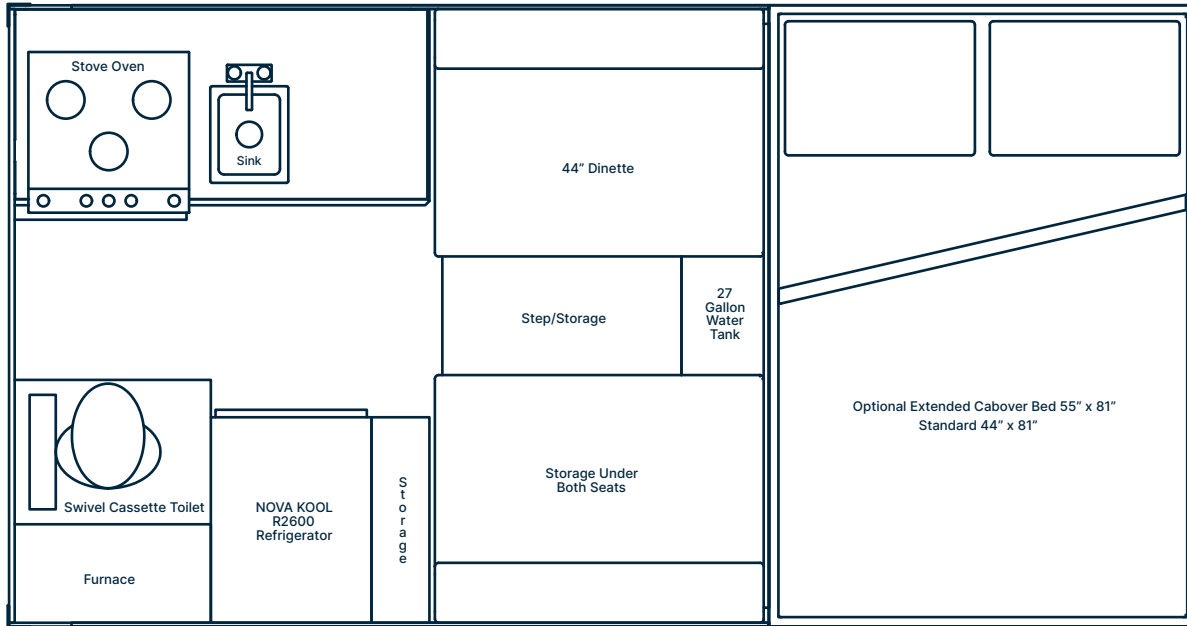

| SPECIFICATIONS | |
|-----------------|-----------------------------|
| Dry Weight | 1805 lbs |
| Wet Weight | 2061 lbs |
| Floor Length | 102" |
| Overall Length | 159" |
| Width | 83.5" |
| Interior Height | 70" |
| Exterior Height | 62.5" lowered, 83.5" raised |
| Truck Type | Long or Short Bed |

| CAPACITIES | |
|---------------|---------------------|
| Fresh Water | 27 gallons |
| Grey Water | N/A |
| Black Water | 4.5 gallon cassette |
| Water Heater | Optional 4 gallon |
| Propane Tanks | 20 lb |
| Batteries | One Battery |

| | |
|----------------|-------------|
| Starting Price | \$42,700.00 |
|----------------|-------------|

Included Features

Jack Plates. Nova Kool 2600 Refrigerator. 20,000 BTU Suburban Forced Air Furnace. Stainless Steel Sink. Spray Foam Insulation R-13. 2-Burner Stove. Premium Fold Out Seating. DEKA Group 31 AGM Battery. Custom Dovetail Drawers. LED Interior, Porch & Clearance Lights. 27 Gallon Water Tank (15 Gallon in 6.5). SHURFLO Electric Water Pump. IOTA 45 Amp Converter/Battery Charger w/Smart Charger. Solid Maple Hand Sanded Trim. Custom Handcrafted Cabinetry. 20lb Propane Tank w/ Gauge. Two Maxx-Air Roof Vents w/Reverse. STEP-UP Folding Stairs. AC Wiring. Awning Rail.

Optional Add-On Features

DC to DC Converter. Back Up Camera. Sink Cover. Top Rack Mounts. Bluetooth/CD/USB 2 Speaker Stereo. Novakool 3.5 cu/ft Refrigerator. THETFORD Cassette Toilet. Nature's Head Composting Toilet. RIECO TITAN Removable Jacks w/Extensions. Outside Shower. Indoor Shower. 12 Volt Outlet w/ USB ports. Air Conditioner. Suburban 4 Gallon Water Heater. Zamp 190 Watt Solar Panel w/Control. Zamp 190 Watt Solar Panel w/Control (x2). Taruca Awning. Fiamma Awning. Insulated Floor. 12v 100Ah Lithium Battery Package. 12v 100Ah Lithium Battery Package (x2). Flatbed Design. Flatbed Side Entry. Truma Combination Heating & Hot Water. Torklift Tie Downs / Fast Gun.

10' CAMPER

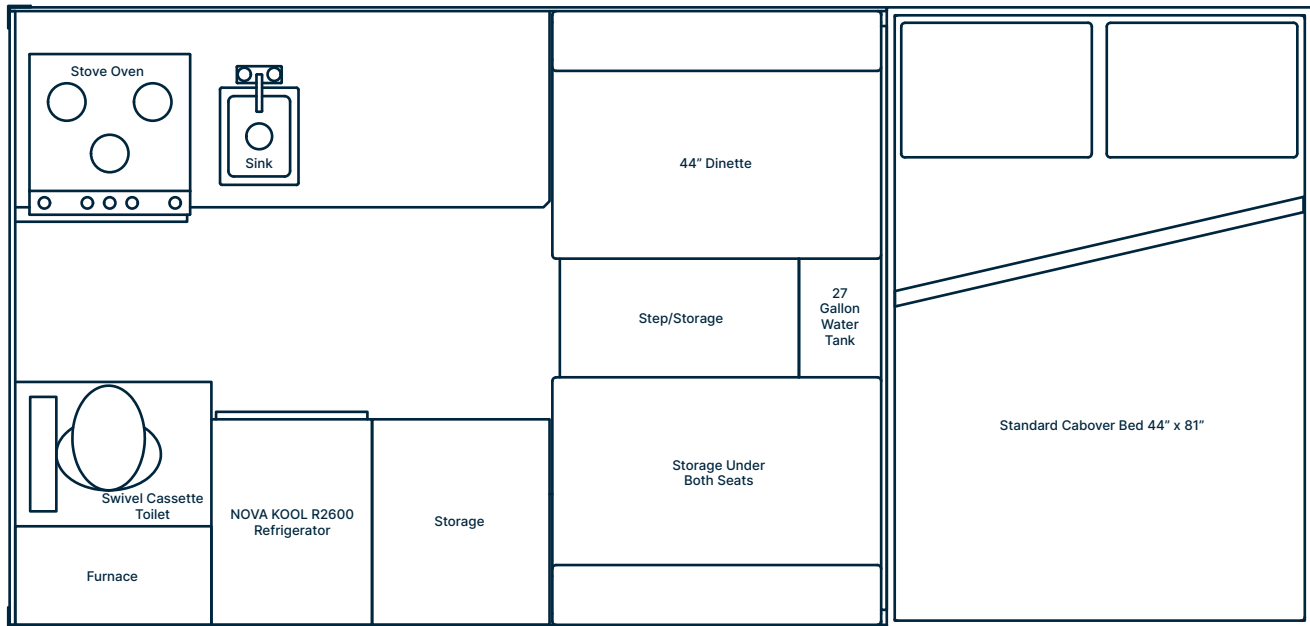

| SPECIFICATIONS | |
|-----------------|-----------------------------|
| Dry Weight | 1985 lbs |
| Wet Weight | 2250 lbs |
| Floor Length | 117.5" |
| Overall Length | 174.5" |
| Width | 83.5" |
| Interior Height | 70" |
| Exterior Height | 62.5" lowered, 83.5" raised |
| Truck Type | Long Bed |

| CAPACITIES | |
|---------------|---------------------|
| Fresh Water | 27 gallons |
| Grey Water | N/A |
| Black Water | 4.5 gallon cassette |
| Water Heater | Optional 4 gallon |
| Propane Tanks | 20 lb |
| Batteries | One Battery |

| | |
|----------------|-------------|
| Starting Price | \$44,800.00 |
|----------------|-------------|

Included Features

Jack Plates. Nova Kool 2600 Refrigerator. 20,000 BTU Suburban Forced Air Furnace. Stainless Steel Sink. Spray Foam Insulation R-13. 2-Burner Stove. Premium Fold Out Seating. DEKA Group 31 AGM Battery. Custom Dovetail Drawers. LED Interior, Porch & Clearance Lights. 27 Gallon Water Tank (15 Gallon in 6.5). SHURFLO Electric Water Pump. IOTA 45 Amp Converter/Battery Charger w/Smart Charger. Solid Maple Hand Sanded Trim. Custom Handcrafted Cabinetry. 20lb Propane Tank w/ Gauge. Two Maxx-Air Roof Vents w/Reverse. STEP-UP Folding Stairs. AC Wiring. Awning Rail.

Optional Add-On Features

DC to DC Converter. Back Up Camera. Sink Cover. Top Rack Mounts. Bluetooth/CD/USB 2 Speaker Stereo. Novakool 3.5 cu/ft Refrigerator. THETFORD Cassette Toilet. Nature's Head Composting Toilet. RIECO TITAN Removable Jacks w/Extensions. Outside Shower. Indoor Shower. 12 Volt Outlet w/ USB ports. Air Conditioner. Suburban 4 Gallon Water Heater. Zamp 190 Watt Solar Panel w/Control. Zamp 190 Watt Solar Panel w/Control (x2). Taruca Awning. Fiamma Awning. Insulated Floor. 12v 100Ah Lithium Battery Package. 12v 100Ah Lithium Battery Package (x2). Flatbed Design. Flatbed Side Entry. Truma Combination Heating & Hot Water. Torklift Tie Downs / Fast Gun.

INTERIOR OPTION PACKAGES

Diverse tastes find their match in our campers, where we've meticulously curated a range of unique interior options. From sleek, modern designs for the minimalists to cozy, rustic aesthetics for those seeking warmth, our customization allows every camper owner to tailor their mobile space to their distinct taste. Whether you crave contemporary elegance or timeless charm, our array of interior choices ensures that your camper becomes a true reflection of your individual style and preferences.



KLONDIKE INTERIOR

Countertops



Leche Vesta

Walls, Doors, & Drawers



Tahoe Oak

Ceilings

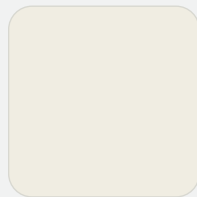

Frosty White

Bench Seat & Cushions



Mushroom

Bed Cover



Fabric - Fawn

Flooring



Gentle Fawn

Metal Finishes



Brushed Metal

Cooktop

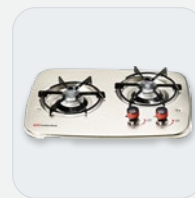

Propane



Induction

Information is subject to change without notice. Contact us for the most up-to-date information.

SITKA INTERIOR

Countertops

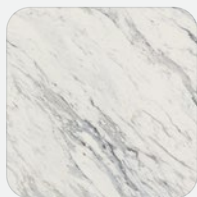

Calcutta Marble

Walls, Doors, & Drawers

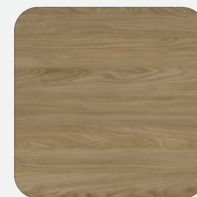

Acorn Velvet Elm

Ceilings

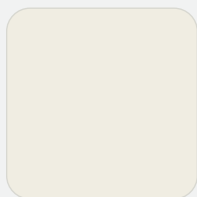

Frosty White

Bench Seat & Cushions



Mesquite

Bed Cover

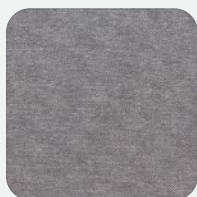

Fabric - Slate

Flooring

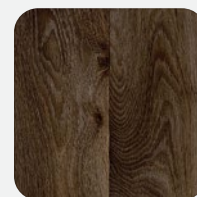

Secret Passage

Metal Finishes



Brushed Metal

Cooktop

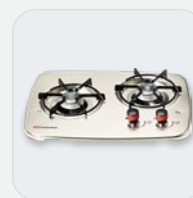

Propane



Induction

Information is subject to change without notice. Contact us for the most up-to-date information.

CLASSIC INTERIOR

Countertops



Milano Quartz

Walls, Doors, & Drawers



Monticello Maple

Ceilings



Shasta Pine

Bench Seat & Cushions



Mahogany

Bed Cover



Mahogany

Flooring



Amber Road

Metal Finishes



Brushed Metal

Cooktop

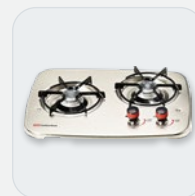

Propane



Induction

Information is subject to change without notice. Contact us for the most up-to-date information.

DENALI INTERIOR

Countertops



Lisola

Walls, Doors, & Drawers



Hidden Springs Walnut

Ceilings

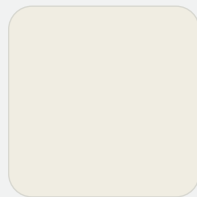

Frosty White

Bench Seat & Cushions



Flint

Bed Cover



Flint

Flooring



Silversmith

Metal Finishes



Brushed Metal

Cooktop

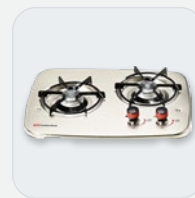

Propane



Induction

Information is subject to change without notice. Contact us for the most up-to-date information.