

# **INSTRUCTION MANUAL**

## **Lotus Pendant Light**

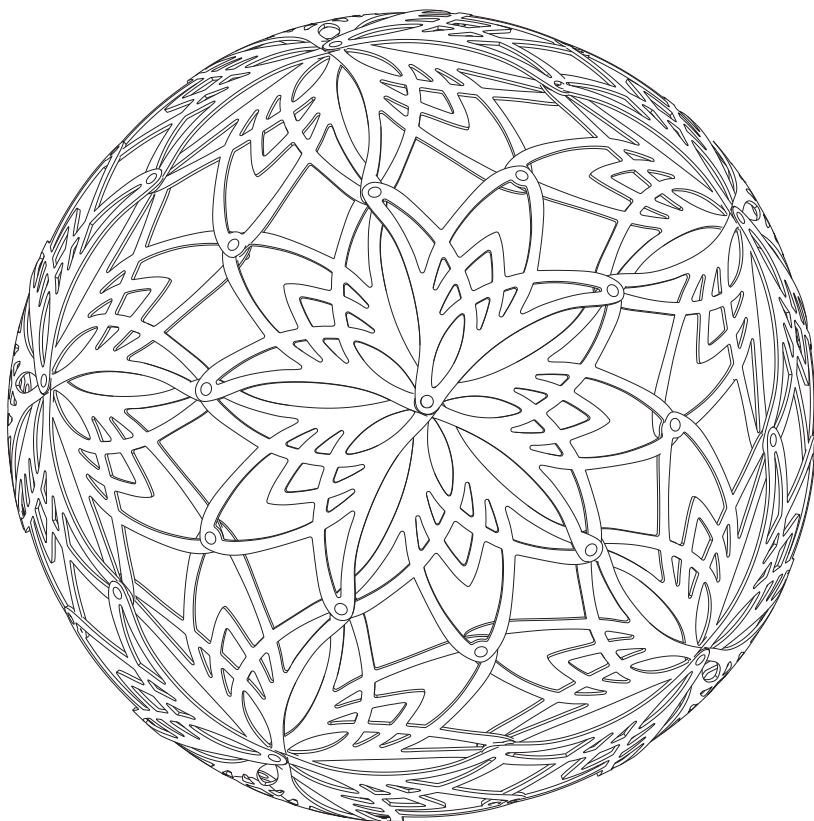

**GlowTheory**  
Patents Pending

P.O. Box 595 Clio, MI 48420

(810) 686-8252

Made in China, Designed in Hawaii, USA

Exclusively for World Wide Creations

DBA GlowTheory™

Patents Pending

## Introduction

Thank you for purchasing the Lotus Penant Light. This product is made of high quality materials and is intended to last. **Read all safety warnings, instructions, and illustrations provided in this manual.** Failure to do so may result in electric shock, fire and/or serious injury or death.

## Specifications

Model: Lotus

Diameter: 12 in. (30.48cm)

Material: ABS Plastic

## Product Use

Your product is designed for use in a variety of environments.

**DO NOT** use under wet conditions or in presence of flammable liquids or gases.

**DO NOT** let children come into contact with the product. Supervision is required when inexperienced operators use this product.

## Important Safety Instructions

- Become familiar with the operation of this product.
- Keep operating area clear of all persons, pets, and obstacles.
- Keep children away from the product at all times.
- Never defeat the safety features of this product.
- Never attempt to hang anything other than the Lotus Pendant Light from the power cord.
- Do not operate with missing, broken, or unauthorized parts.
- Install eye hook into a ceiling joist away from any electrical or water lines.
- Never install eye hook into ceiling or wall without a joist behind (it may weaken and fall over time).

## Unpacking

Remove parts from carton and discard all packaging.

## Location Selection

- Locate the Lotus Pendant Light in a clean, dry and well ventilated area.
- The Light should be located at least 12" (30.5 cm) away from walls or other obstructions.
- Locate the Lotus Pendant Light so that the Solar Light faces the sun.

## Parts

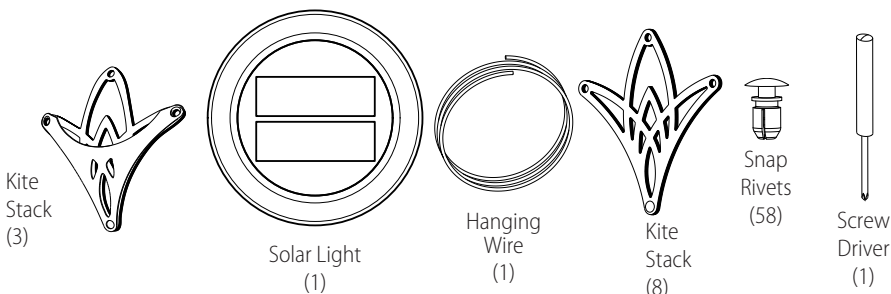

## Using Snap Rivets

Each Snap Rivet has three parts: a cap, a tip and a pin. Insert Tip of Snap Rivet into a hole and completely push the Snap Rivet through all face layers and then squeeze both sides with your fingers until a 'click' is heard.

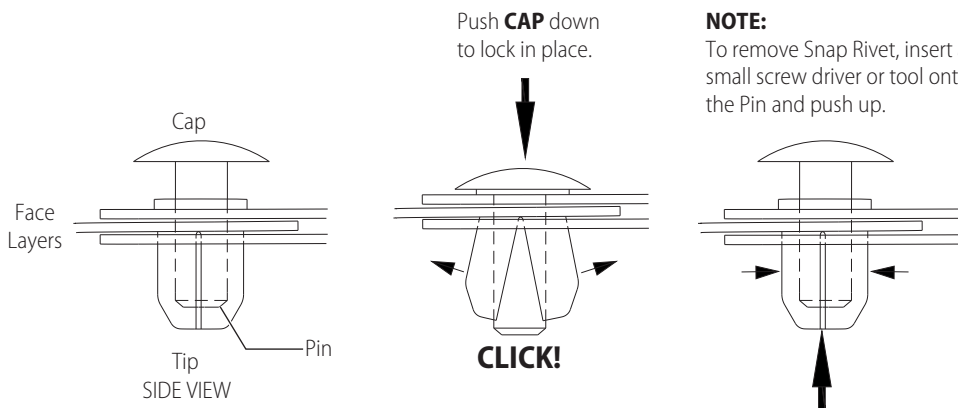

**NOTE:** Snap Rivet Cap must always face outside the lamp during assembly.

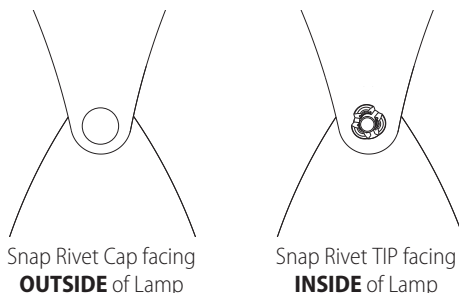

## Key Points to Remember Before you Begin

*Each Kite tip must be connected in a specific way.*

"4...3...4"



Remember this  
Golden Rule!

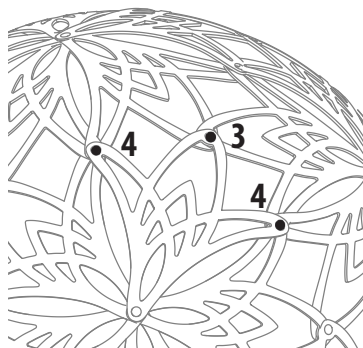
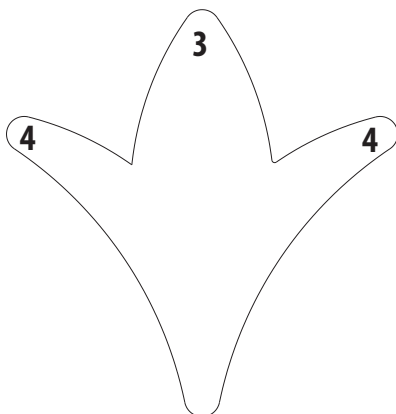

**4** = Pointed Side tips have **4** connection layers.  
**3** = Round Center tips have **3** connections layers.

## Assembly

*Each Kite tip must be connected in a specific way.*

- 1 Spread each of the **KITE STACKS** open to prepare them for assembly as shown.

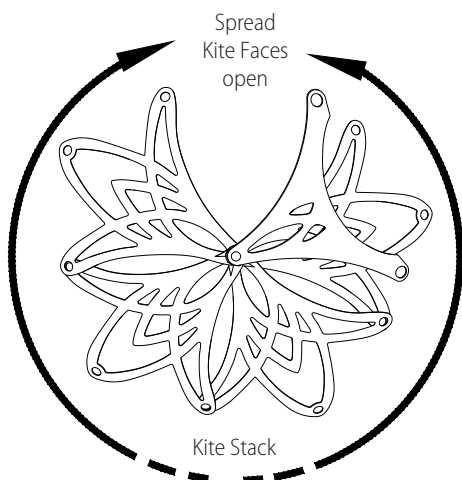

- 2 Connect **FIRST KITE STACK** to **SECOND KITE STACK** with **SNAP RIVET** as shown.

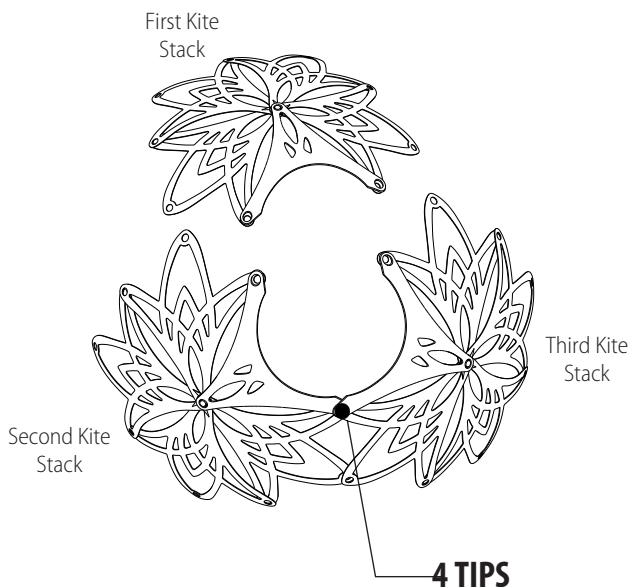

3

Connect **THIRD KITE STACK** to **SECOND KITE STACK** with **SNAP RIVET** as shown.

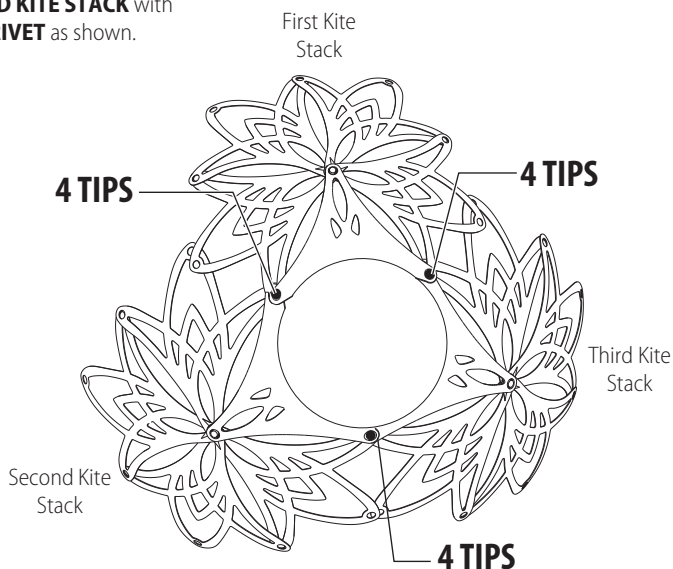

4

Begin connecting the other **KITE STACKS**. As you begin to connect the Kite Stacks together, notice the **TIP PATTERN** that emerges.



"4...3...4"



5

Continue to connect the **KITE STACKS** together paying close attention to the **TIP PATTERN** as shown.

"4...3...4"

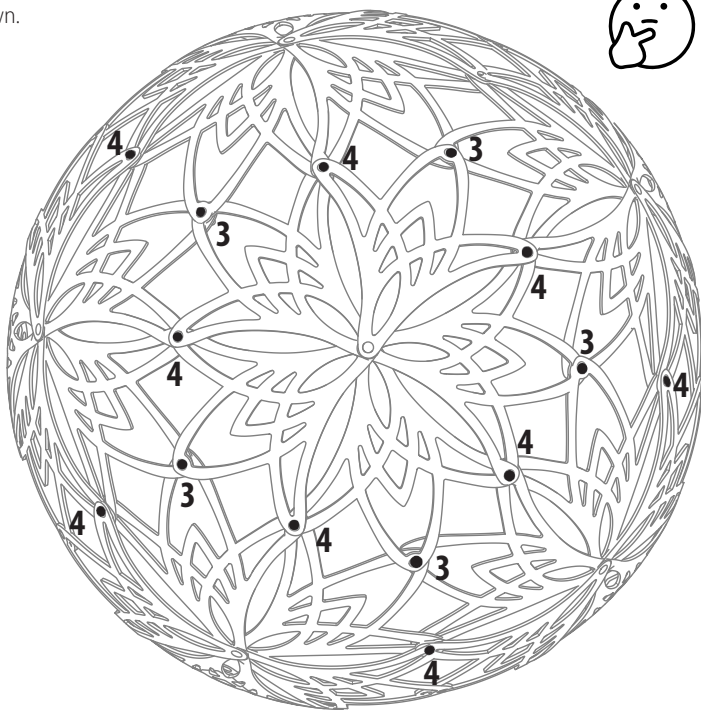

6

Turn on the **SOLAR LIGHT** by removing the **PULL TAB** and pressing the **ON** button on the bottom.

#### NOTE:

If the light does not turn on in the dark, open the case using screw driver and be sure battery is installed properly.

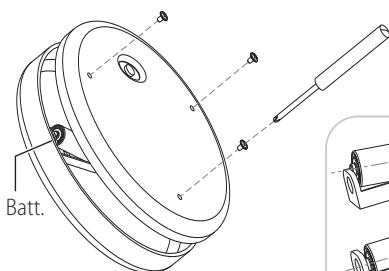
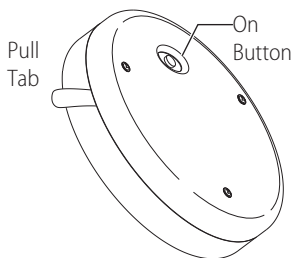

7 Insert into the **SOLAR LIGHT** Circular Face.

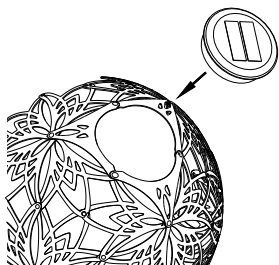

3 Position the Solar Light on the upper portion so it drops into the Circular Face and remains in place.



## Using the Solar Light

- The Solar Light has a sensor that detects when its dark and automatically turns the light on.
- Locate the Lotus Solar Light in an area pointed at the sun for maximum charge.
- Use Hanging Wire to hang the Lotus Solar light by bending a hook on each end - we suggest an upside down 'U' or upside down 'V' that simply hooks into a four-layer intersection of a riveted face of the solar light and making it as long as desired for your location.
- If the light fails to activate at night, ensure ON button is pressed - if this does not work the battery may be dead and the Solar Light will need to be replaced (do not attempt replacing battery).
- Hang the Lotus Solar Light near entryways, sidewalks and walkways and it will cast a beautiful light.
- The Lotus Solar Light can be located in the landscape on the ground or in trees - use the Hanging Wire to hang it on a branch, a screw or nail.

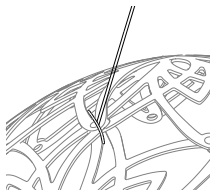
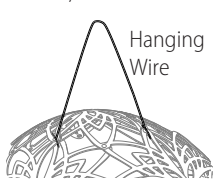

### NOTE:

Attach wire into a four-layer intersection, adjust wire to desired length in your location. Keeping in mind where the sun will charge the lamp and where the lamp will cast it shadows.

## Refunds and Warranty

For refunds or If a part is missing or damaged, contact us directly at (810) 686-8252 for support.

## Maintenance

Occasionally inspect the Eyehooks and tighten if necessary. If the Power Cord becomes frayed immediately remove the lamp from service. Clean the lamp with a damp cloth and unplug before cleaning.

## Disclaimer

This manual relates solely and exclusively to the Lotus Pendant Lamp including but not limited to the operation thereof. Failure to adhere to this manual or to properly focus on the operation of the Lotus Pendant Lamp can result in serious injury and even death. Always operate the Lotus Pendant Lamp in a safe manner and in full compliance with this manual. GlowTheory is not liable for any injuries or damages to any operators, property, or bystanders incurred as a result of using this product. GlowTheory also cannot be held liable for any and all errors in this manual or for any incidental or consequential damages that result from the use of the material presented in this manual. This manual contains proprietary information belonging solely to GlowTheory. All rights are reserved. No part of this manual may be photocopied, reproduced or translated to another language without the written consent of GlowTheory.

GlowTheory  
P.O. Box 595  
Clio, MI 48420  
Phone: (810) 686-8252  
Fax: (810) 686-5492  
GlowTheory.biz