

# IMPORTANT-READ FIRST

## NGL FLAG WHIP APP CONFIGURATION INSTRUCTIONS

Learn more about:

**Rock Lights, Camp Locator Lights, RV Power Port,  
RV Porch Light, Boat Lights at [NGLscorp.com](http://NGLscorp.com)**



3555 S 700 W • Suite A • Salt Lake City, Utah 84119  
Toll Free: +1 844-451-9958 • [NGLscorp.com](http://NGLscorp.com)

1 Manage Devices

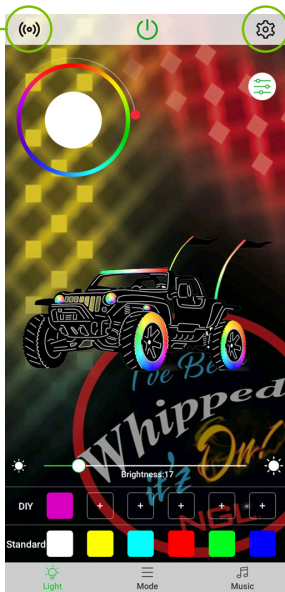

Device Configuration

2

Device Selected



Device Connected

3

↑ Please select a device  
Swipe Upward

### NOTE:

This is a critical step and often overlooked. Make sure you swipe Upward to locate your device.

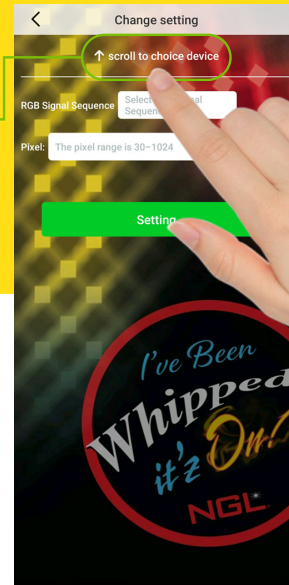

4

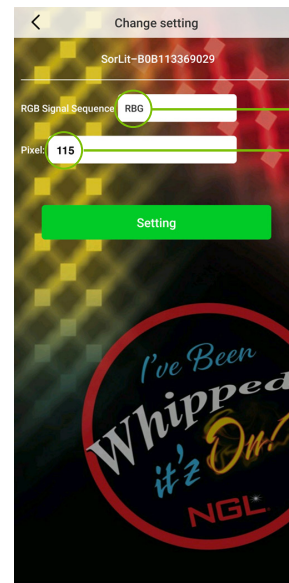

Change if red is blue or green and visa versa

Change if only a portion of your whip is lighting up

5

Devices Not Selected



Device Disconnected

# CAUTION:

To prevent damage from occurring, please read instructions carefully and completely before proceeding with Installation.

*Not following instructions as indicated may void your warranty.*

## NGL Flag-Whip Installation instructions

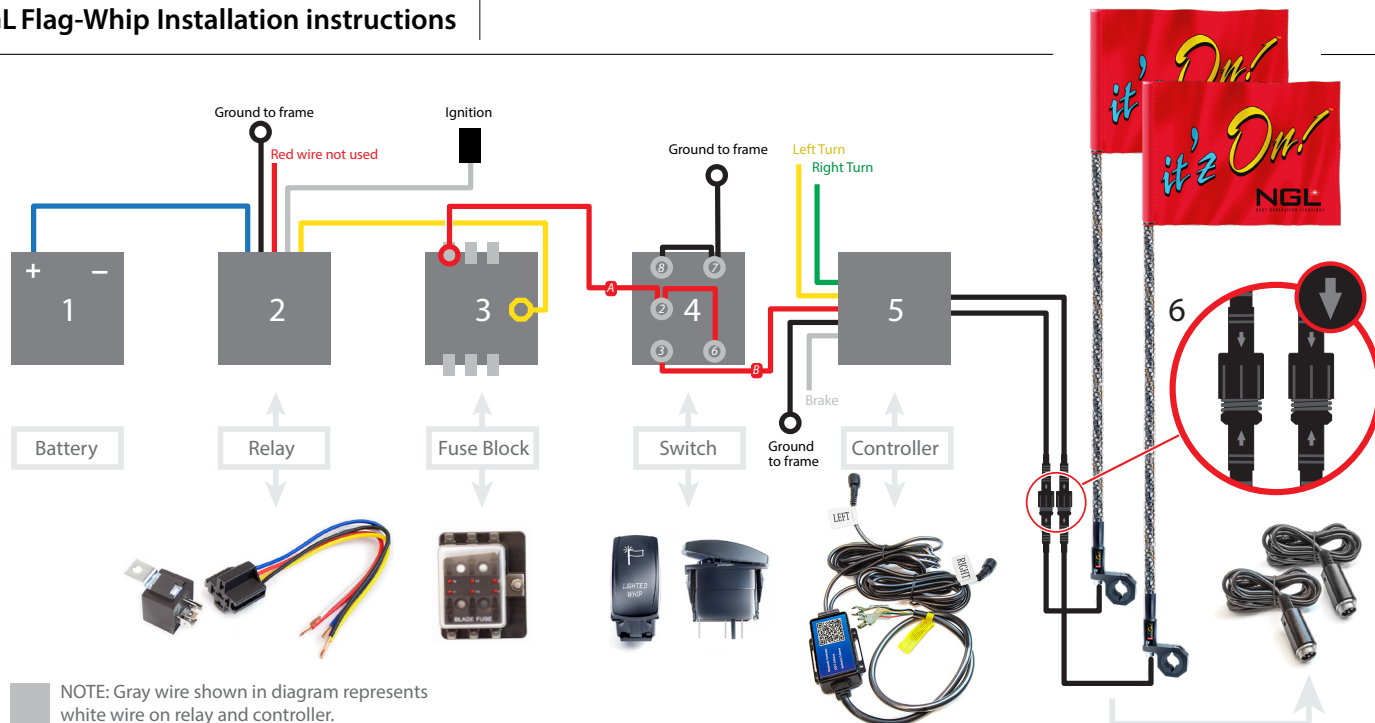

### \* NOTE: it may be necessary to remove seats, panels and trim for easy access to run wires and cables.

1. Find a suitable location where the **Controller(5)** can be safely mounted while being protected from damage (preferably under the dash with easy access to the wires) and allowing for enough cable to reach the whip cable.

• **Action:** Mount with 2 screws or bolts.

2. Find a location under the dash to mount the fuse **Relay(2)** and the **Fuse Block(3)**.

3. Choose a location for the **Switch(4)**.

• **Action:** If available remove the blank in the dash board and mount **Switch(4)**.

4. Choose a location to mount your **Flag Whip(s)(6)**.

• **Action:** If necessary or preferred, use brackets to mount to the roll cage (brackets sold separately).

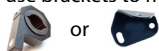

5. Run whip cable through the bracket towards the **Controller(5)** keeping the cable protected from damage.

• **Action:** Connect **Controller(5)** cables to the whip cables. **Make sure the black arrows are aligned (see 6). Protect the connections from damage.**

#### Wiring the Controller(5):

- **Red** wire goes to the **Red B** wire on **Switch(4)**
- **Black** wire to ground
- **White** wire to brake signal from SXS brake system or signal switch brake signal
- **Green** wire to right turn from signal switch
- **Yellow** wire to left turn from signal switch

#### Wiring the Relay(2):

- **Black** wire to ground
- **Blue** wire to battery positive
- **White** wire to a powered signal from a key on position
- **Yellow** wire to the stud on the **Fuse Block(3)**
- **Red** wire not used

#### Wiring the Switch(4):

- **Red A** Wire to **Fuse Block(3)**
- **Red B** wire to **Controller(5)**
- **Black** wire to ground

Learn more about:

**Rock Lights, Camp Locater Lights, RV Power Port, RV Porch Light, Boat Lights at [NGLscorp.com](http://NGLscorp.com)**



3555 S 700 W • Suite A • Salt Lake City, Utah 84119 • Support +1 844-451-9958 • [NGLscorp.com](http://NGLscorp.com)