



Nicolaudie Group

# Nicolaudie Cloud Quick Start

By Nick Clark

## Introduction

This Quick Start guide will give you a brief overview of the Nicolaudie Cloud registration process. For a more detailed information, please read the Nicolaudie Cloud Control Manual:

<https://eu-literature.n-g.co/Release/Nicolaudie-cloud-control-manual.pdf>

Cloud Control allows you to group controllers from the same place or project into sites, which are the main locations to manage permissions and licences. Each Site has an annual digital subscription, which gives you access to our cloud service and support.

## Device compatibility

Only the following devices are Nicolaudie Cloud compatible:

- DINA-DR1
- DINA-DR1-Lite\*
- DINA-DR2
- DINA-DR2-Lite\*
- DINA-SR1

\* with optional upgrade. See section: [Upgrade LITE Models](#)

## Nicolaudie Cloud Label

From June 2024, devices include a NICOLAUDIE CLOUD label with a QR code link, serial number and pre-set password. This is not necessary makes connecting faster.

## Index

1. [Setup using QR Code](#)
2. [Setup using computer](#)
3. [Set software passwords](#)
4. [Upgrade Lite Models](#)

## Setup using QR Code

If your controller has a NICOLAUDIE CLOUD label and you have a phone or tablet with a camera able to read QR codes, choose this method.

1. Connect your controller to a network with internet access using the Ethernet port
2. Point your smartphone or tablet Camera at the QR code and launch the link.
3. Login to your Nicolaudie account or create a new account to link your device to.  
(Note: If you are an installer, you can transfer to your customer's account later)
4. Create a new Site or select an existing Site to add your controller to. A Site represents a location and can contain one or more controllers.
5. The Cloud will try to connect using the serial number (S/N) and default password ...

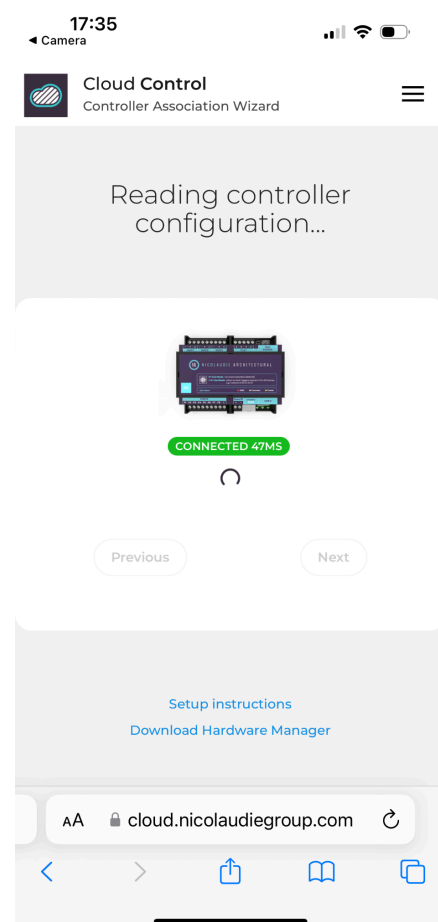
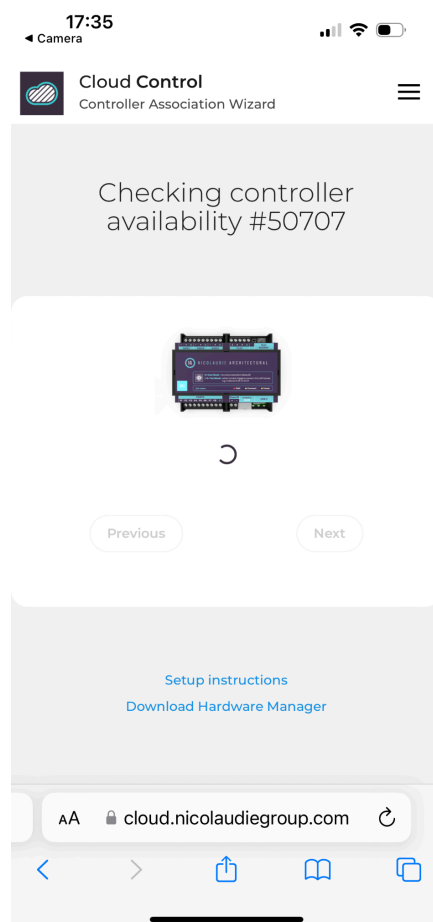

6. Enter the PIN code displayed on your controller.

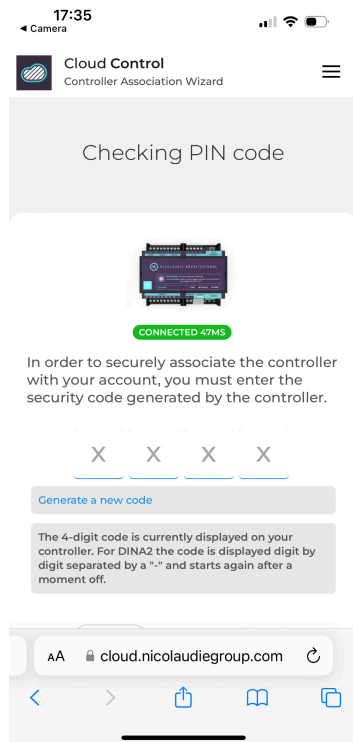

7. Customise the name of your controller

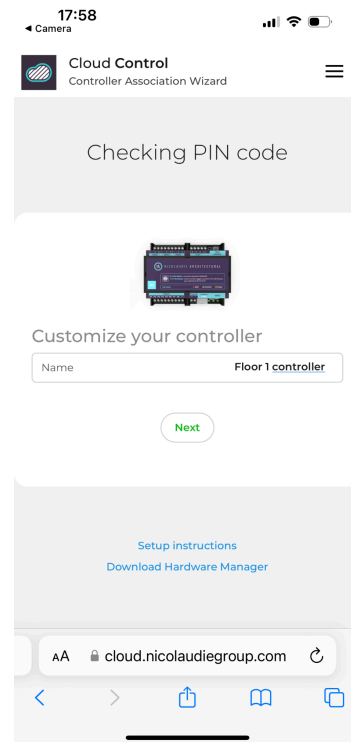

8. Everything is setup!

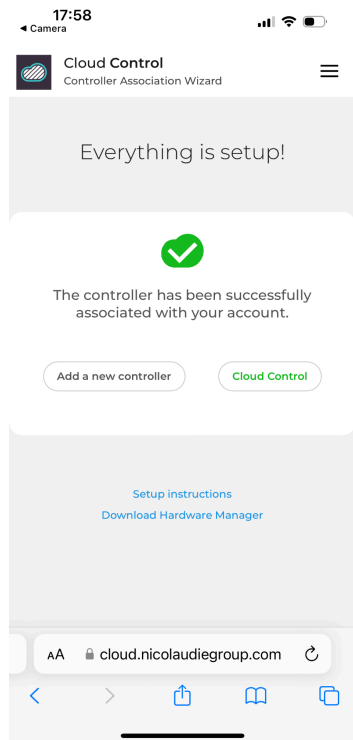

9. View controller Information

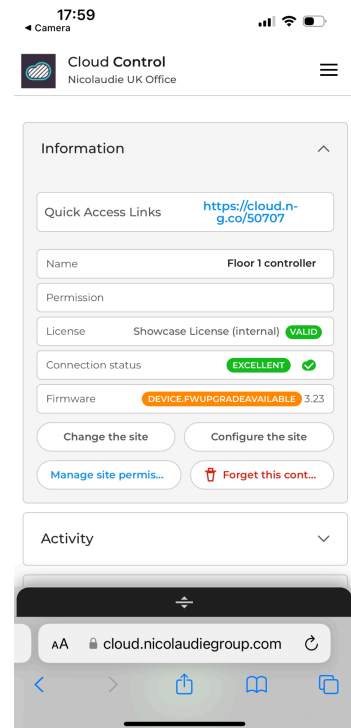

## 10. Swipe up on black bar & select Triggering

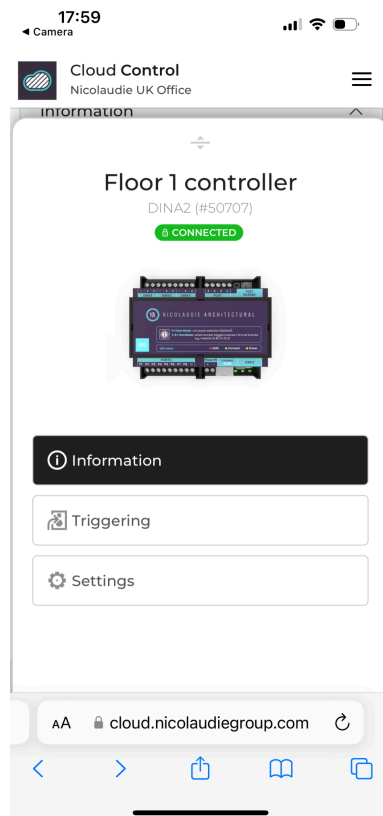

## 11. Trigger scenes

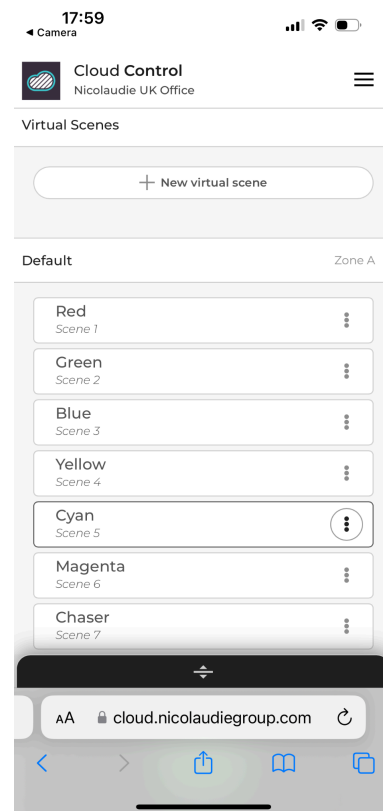

## Setup using computer

1. Go to <http://n-g.co/cloud-control> .
2. Login to the account you want to use your controller with or select 'Don't have an account?' to create one.

Note: If you are an installer, you can transfer to your client's account later.

3. Click 'Add a new controller'.

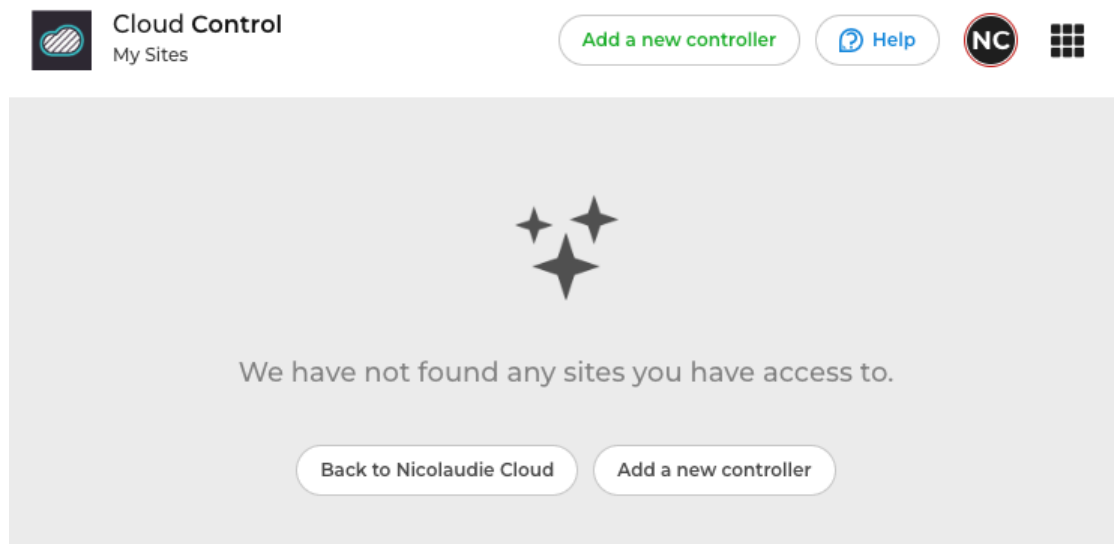

4. Create a new site or select an existing Site

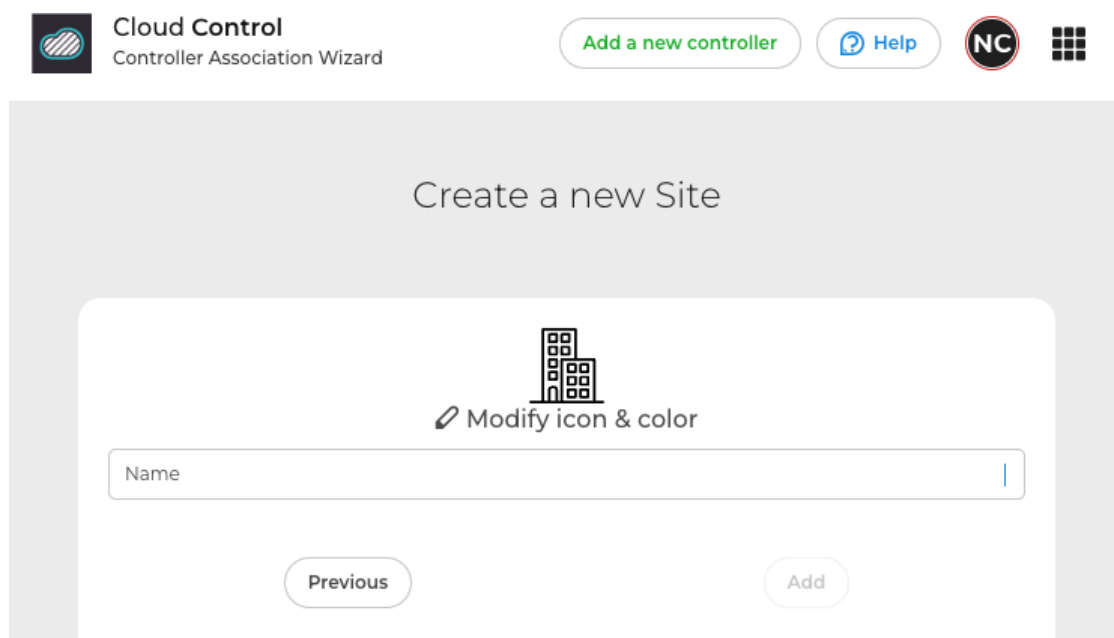

5. Enter your device Serial Number (S/N) which can be found on the NICOLAUDIE CLOUD label. If there is no label, select '*Where can I find my serial number?*'



## Find your controller

Type the serial number of your controller

[Where can I find my serial number?](#)

Previous

Next

6. Type in the password from the NICOLAUDIE CLOUD label. If your device does not have a label or if the password from the label does not work, go to the [Set Software Passwords](#) section.



## Add a new controller #470438



Type the password of your controller

Password

Your controller must have a password set. [How to set a password on my controller?](#)

Previous

Next

7. The Cloud will read the controller information to prepare registration.

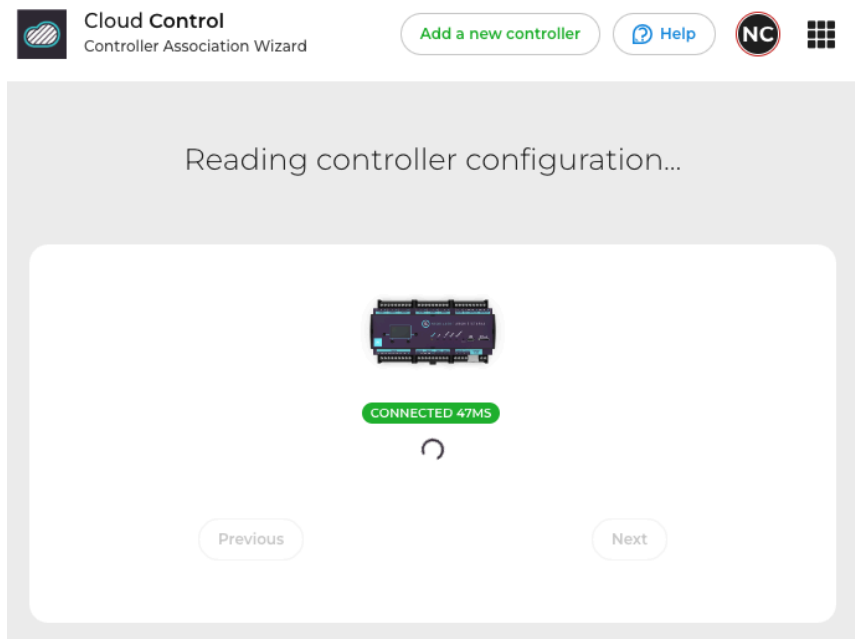

8. Enter the code displayed on your controller.  
The DINA DR1 will display these 4 digits on the small screen.  
The DINA DR2 has a single digital display. It will display the digits as X-X-X-X followed by a brief pause.

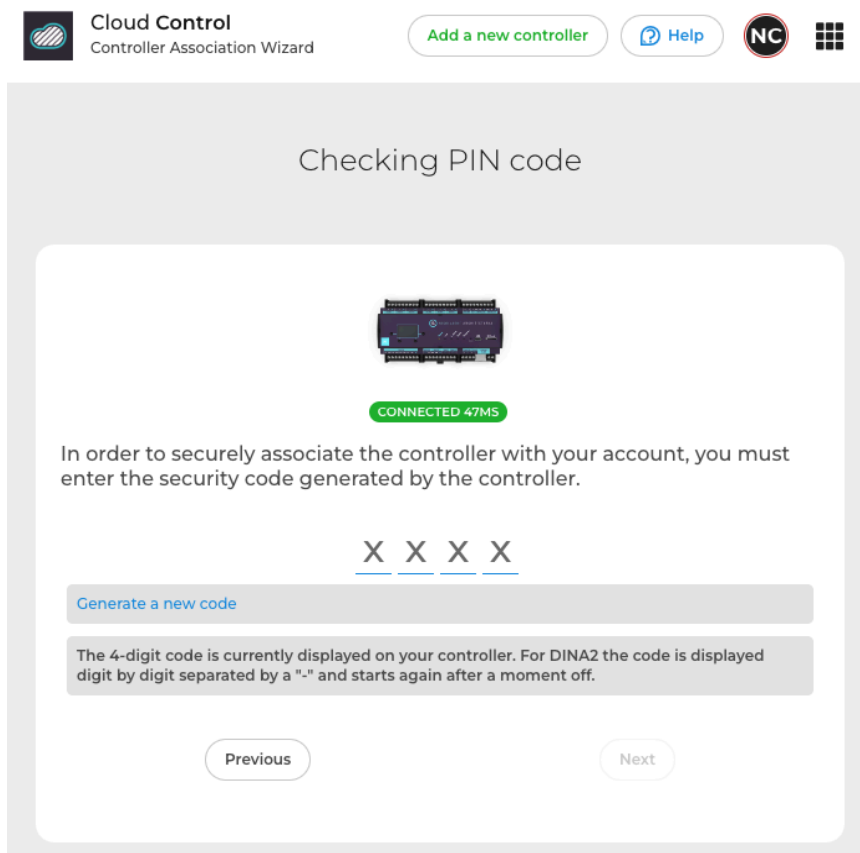

9. Customise the name of your controller then next

**Cloud Control**  
Controller Association Wizard

Add a new controllerHelpNC

Checking PIN code



Customize your controller

Optional

Next

10. Everything is setup!

**Cloud Control**  
Controller Association Wizard

Add a new controllerHelpNC

Everything is setup!



The controller has been successfully associated with your account.

Add a new controllerCloud Control



## DINA DR1 Cloud

DINA1 (#470438)

 CONNECTED



 Information

 Triggering

 Settings

### Information

Quick Access Links <https://cloud.n-g.co/470438>

Name DINA DR1 Cloud

Permission **FULL ACCESS**

License Showcase License (internal) **VALID**

Connection status **EXCELLENT** 

Firmware 4.07

Change the site

Configure the site

[Manage site permissions](#)

 Forget this controller

### Activity

Automations **ALPHA**

## Set Software Passwords

1. Open HardwareManager
2. Select your device on the left
3. Scroll down and select *Ethernet*
4. Select *Open advanced settings*
5. Set the Software and Remote Password & press save. The Software password is the main password that allows a connection to be made, the Remote password allows triggering of scenes.

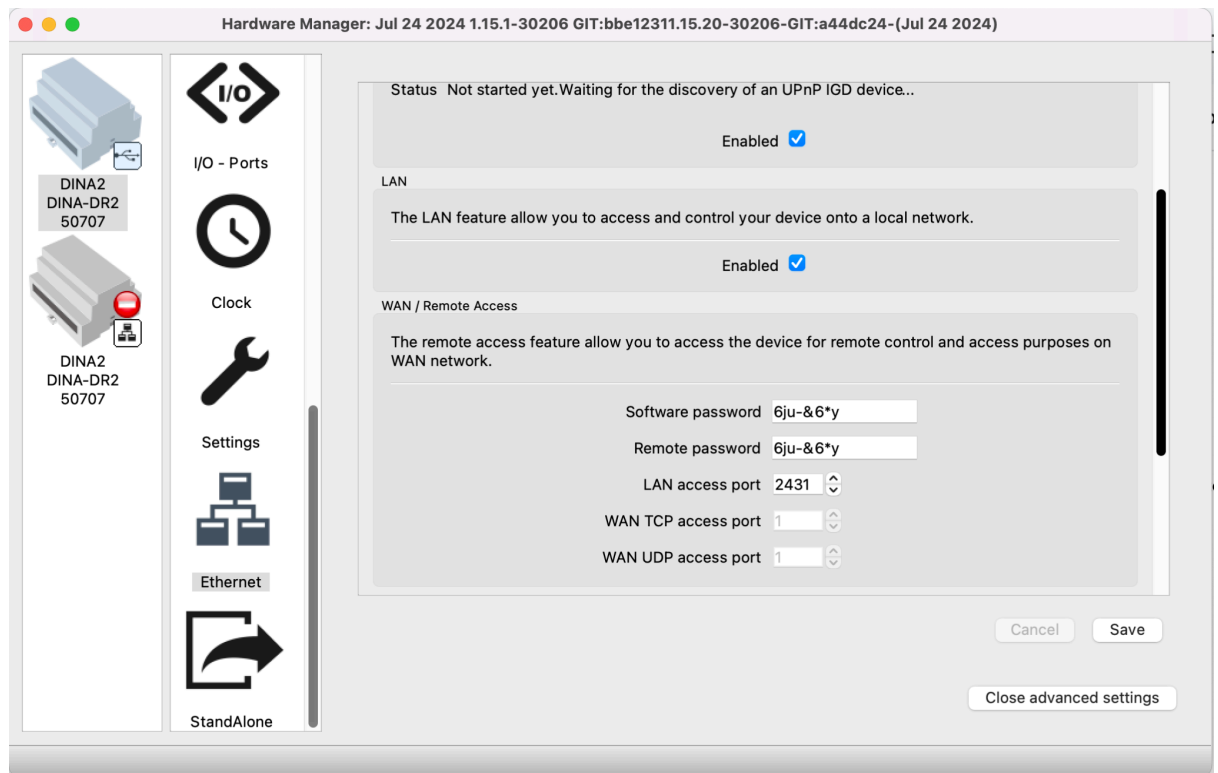

## Upgrade LITE Models

By default, the Dina DR1 and DR2 LITE models do not come with a licence to use the Nicolaudie Cloud. A one-time hardware cloud licence can be purchased to unlock this feature on these devices. Note: This is not the same as the yearly subscription required to connect to the service and provide ongoing support.

1. Register your device with our store on the My Interfaces page [https://store.nicolaudie.com/my\\_interfaces](https://store.nicolaudie.com/my_interfaces)
2. Click 'Buy applications'
3. Expand Hardware using the arrow.
4. Add the Cloud to your basket and checkout.
5. Connect your device to HardwareManager. The licence should sync automatically.
6. Go to the SUT screen and check for *Hardware : Cloud Relay : Activated*. Your device is now ready to connect.