

Wood Building



Test-fit Second floor

GFA

2,159 SQM

LFA

2,064 SQM (96,6%)

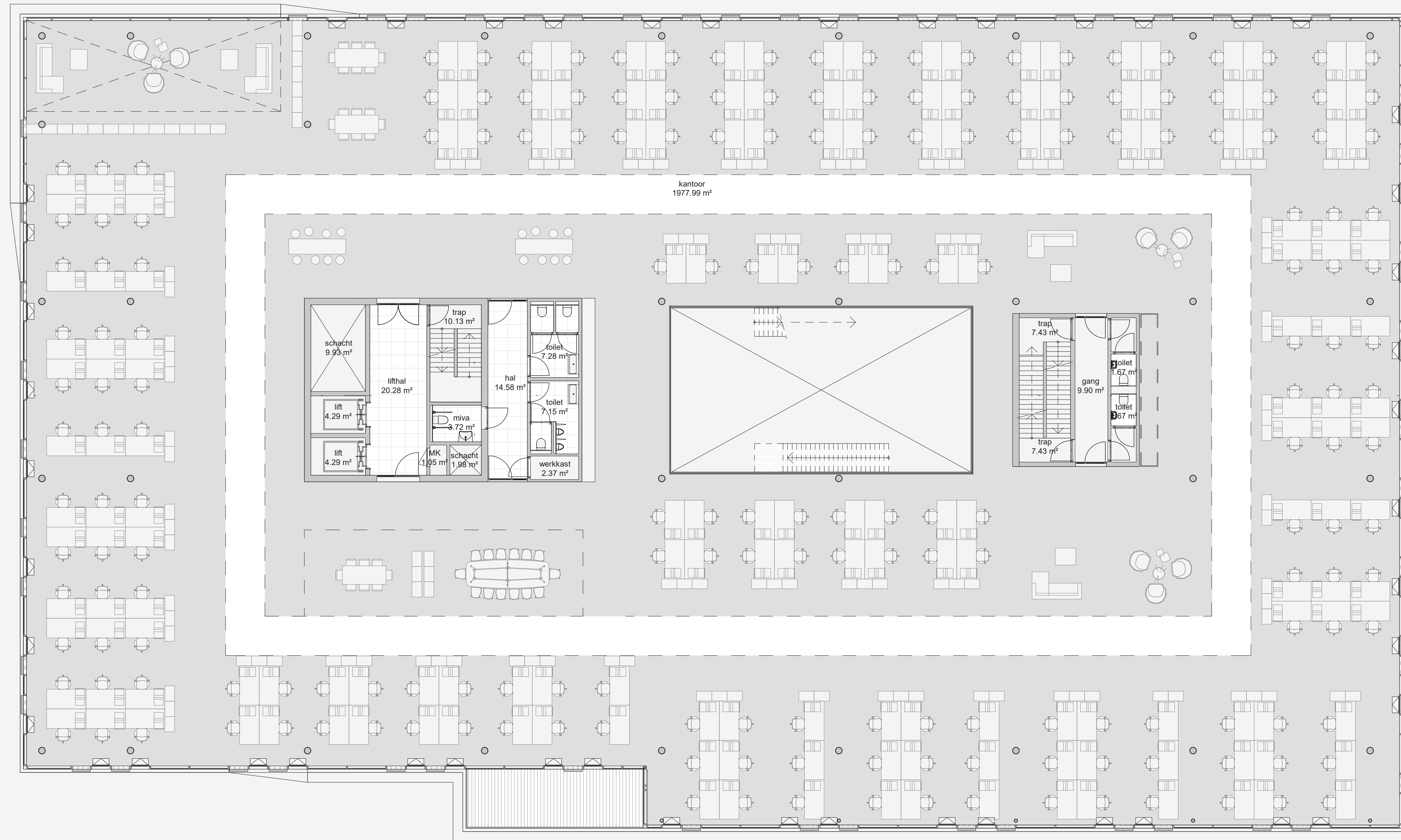

Test-fit Third floor

GFA

2,081 SQM

LFA

1,977 SQM (95%)



The Campus could be **your** **workplace!**

No rights can be derived from the content of this pdf. These test-fits are based on the conceptual design and are indicative.

welcometothecampus.com

