

# WHAT IS CHROMELOGIN

Chrome login is a solution developed by Google to facilitate users to create a chrome profile using Roche's SSO instead of the normal process of creating a chrome profile.

## IMPORTANT

Prior to using chromelogin to create a new profile in chrome; the user should be fully onboarded (password set and enrolled in PingID).

In addition to that, chrome should be already installed in the computer (or opened via [Partneraccess](#))

## HOW TO USE CHROMELOGIN

Chromelogin is a simple solution. To use it to create a chrome profile, open chrome (no matter in which profile) and go to <https://chromelogin.roche.com>

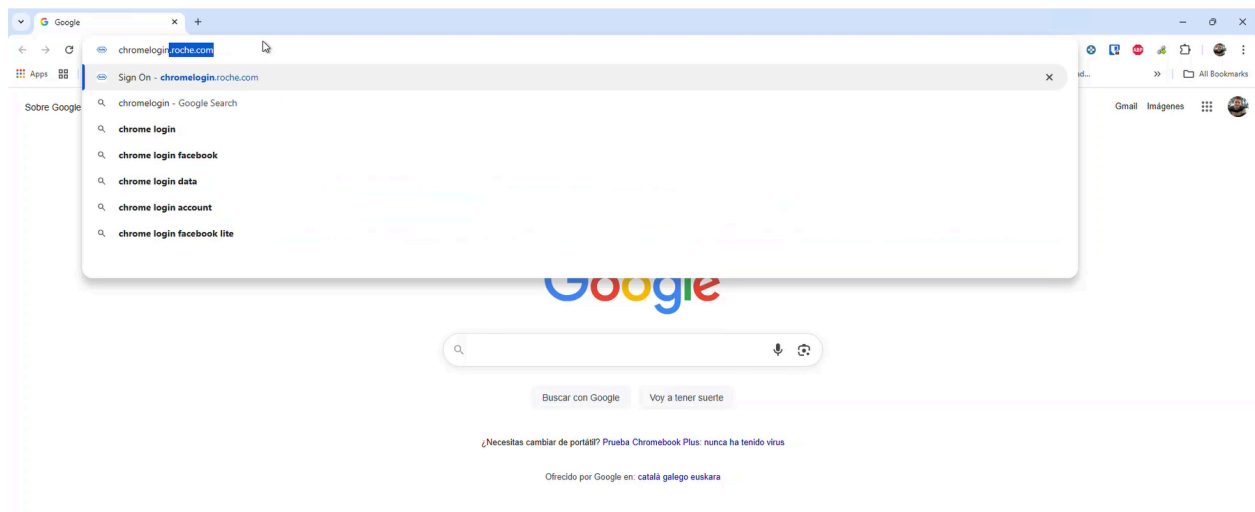

Once you reach to the Roche SSO page, type in your Roche userid, click next, then type in your password and click on login:

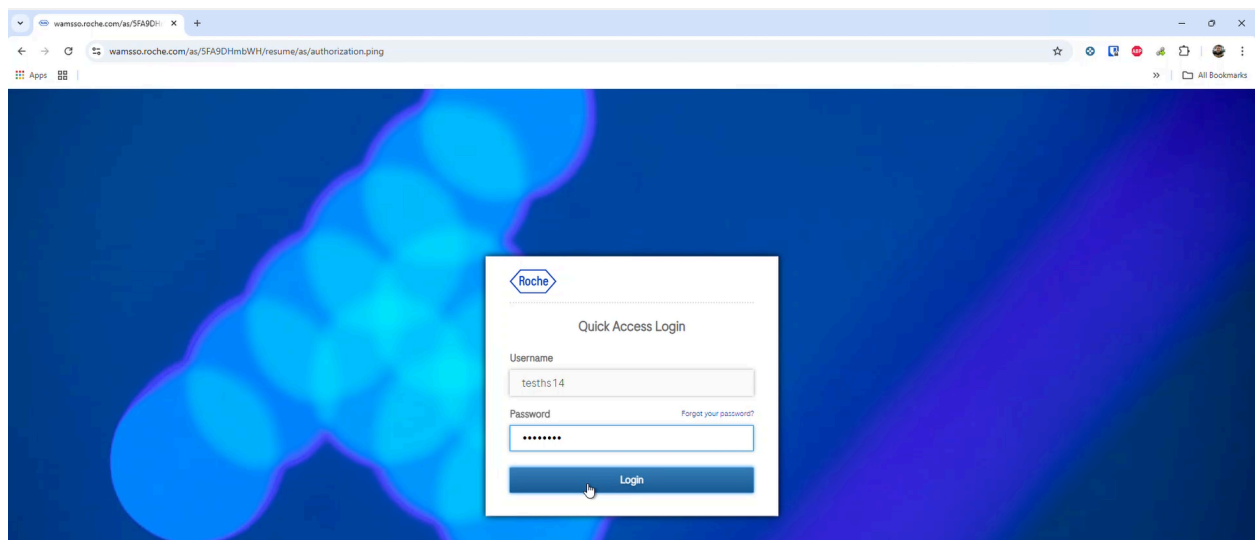
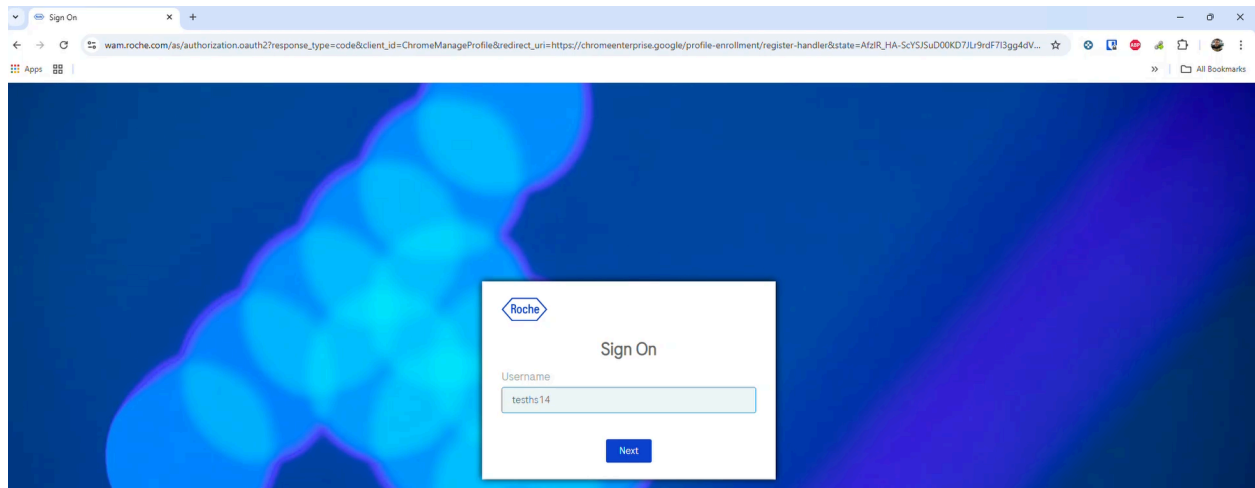

At this point you'll be asked to provide a code provided by Roche 2FA (PingID). Provide it and click on login:

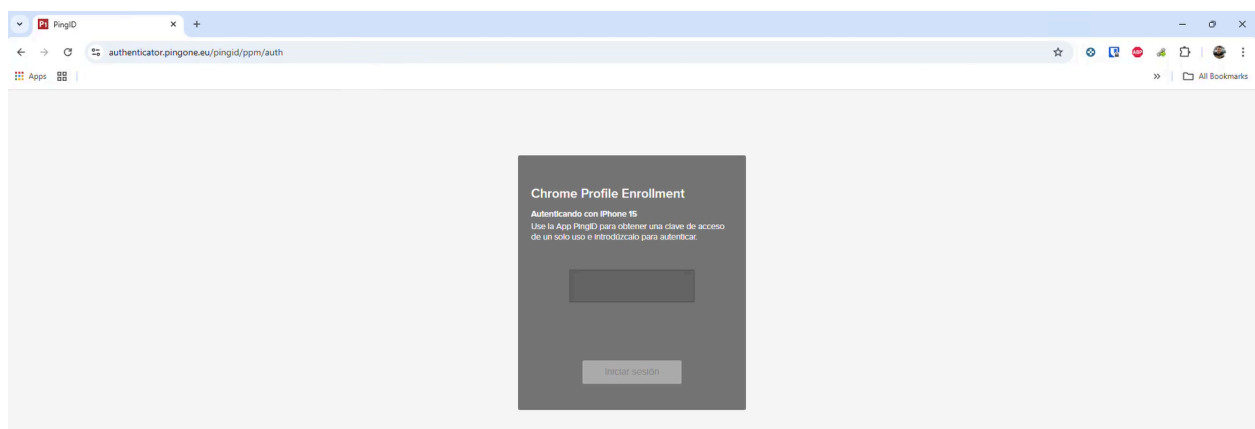

The "Set up a new profile" popup will appear, click on continue:

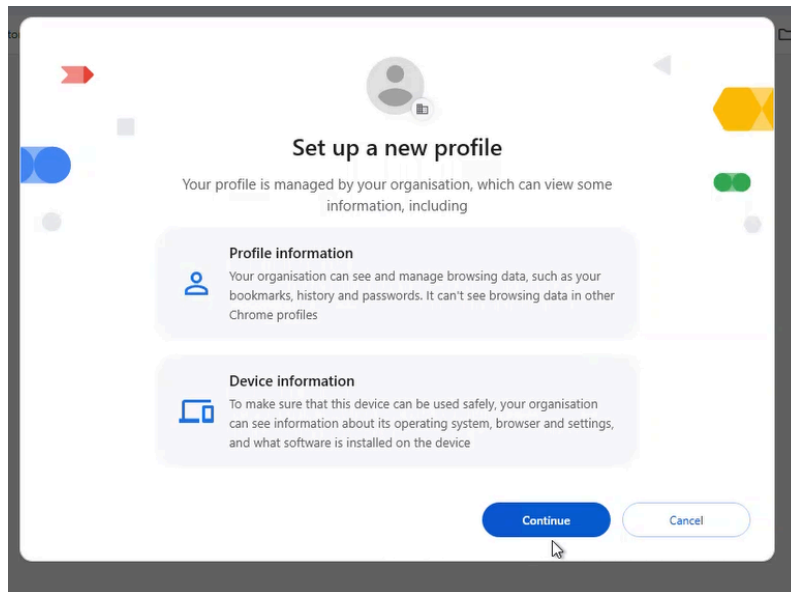

Once you receive the “You’re all set!” popup, click on continue. The new profile will open asking you to select a search engine, select Google and click on “set as default”:

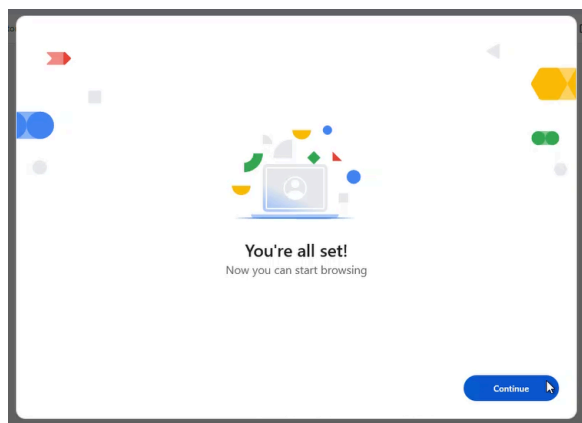

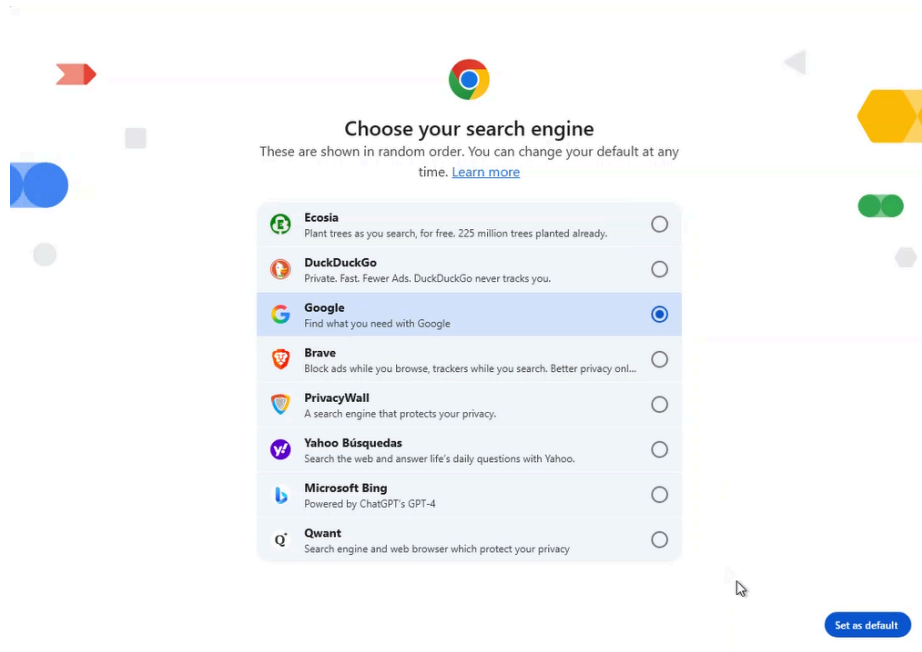

Arriving at this point, you'll have a new profile already created but you're not totally set to be able to work with Roche resources.  
Please click on the **"Verify it's you"** at the top right corner and then on the button that appears with same text

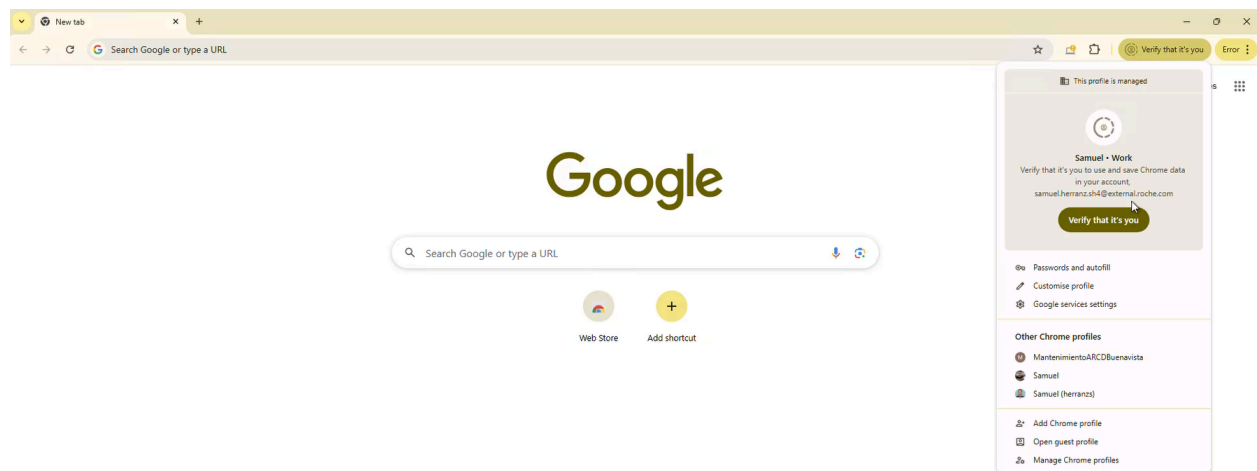

Then login on the Google page that will appear. Your roche email will autopopulate so you don't have the need of knowing it.

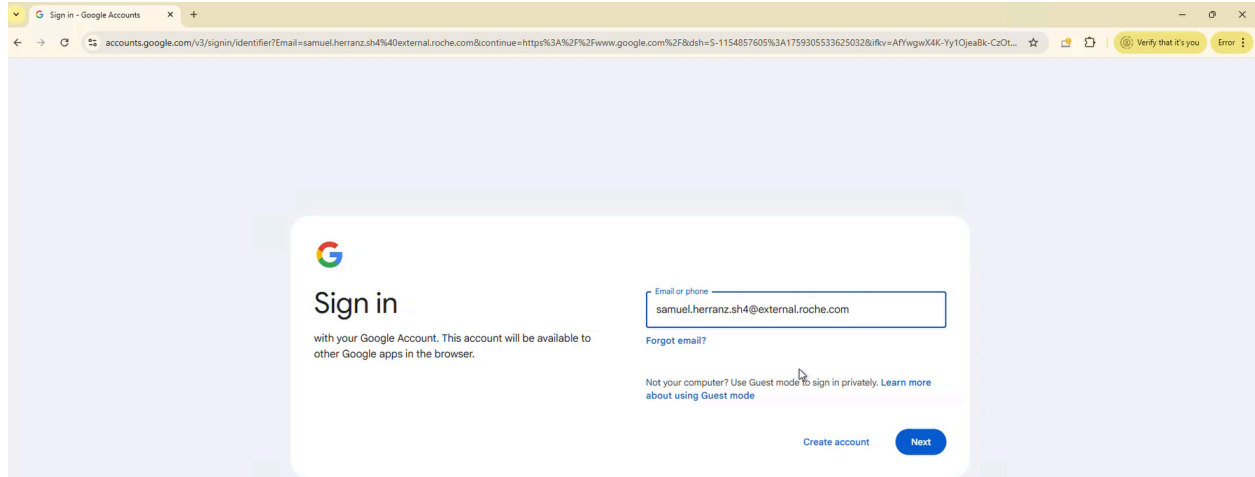

Then follow the same login process as before (userID, password and pingID) until you're fully logged in. Click on your profile name (like in the "verify it's you" step) and then "Turn on sync..." Then just click on the "Endpoint Verification icon" at the top right corner and ensure the last sync is minutes ago.

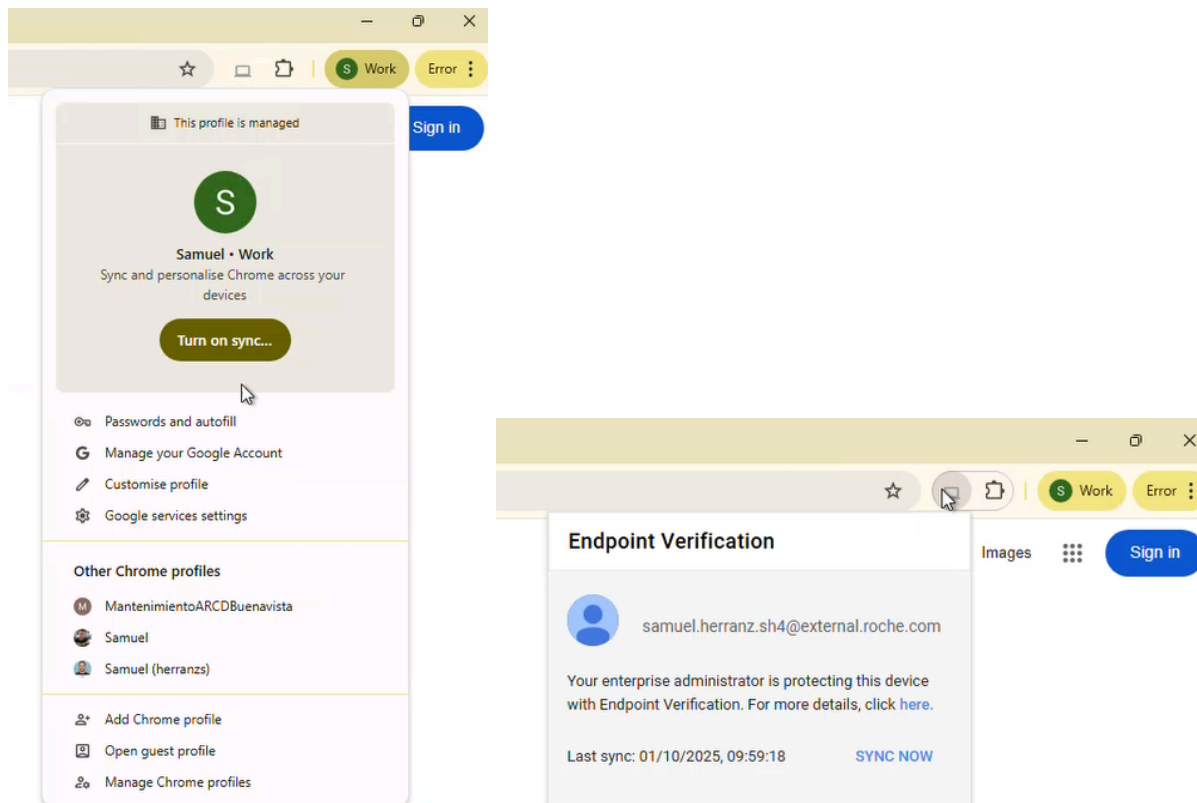

At this point, you've fully set up the new chrome profile and you can work with Roche resources

# ADDITIONAL INFORMATION FOR CIF USERS

If your user has a Cloud Identity Free license assigned (CIF) or you haven't been granted with access to Gmail or Gdrive, you'll receive this error when enabling sync on chrome

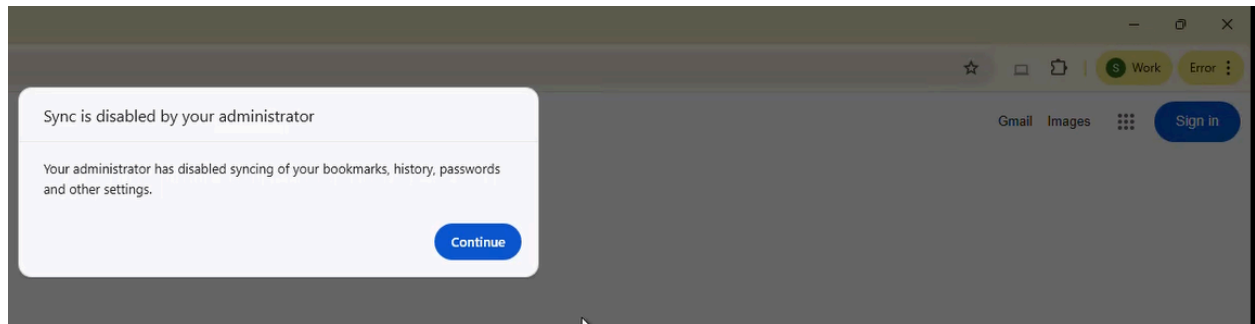

It is **normal behavior** and you can disregard it.