

Proposing an exhibition at Pātaka Art + Museum

Pātaka Art + Museum is the creative hub of Porirua City. We showcase the best in contemporary Māori and Pacific arts, as well as Aotearoa New Zealand, arts & culture.

This form is for artists and groups interested in exhibiting at Pātaka Art + Museum. We welcome exhibition proposals from artists working in all media and at all stages of their careers.

The proposal process

All exhibition proposals are considered by the Pātaka Art + Museum Exhibitions Committee. The committee endeavours to present a balanced and varied exhibition programme, representing a range of media, cultures and interests.

The exhibition programme for Bottle Creek and Toi Gallery is finalised up to one year in advance. The Exhibitions Committee meets to consider proposals twice per year. Please check our website for the current proposal rounds.

To submit your exhibition proposal please complete this form and send your completed form, along with 1–5 images of your work to exhibitions@porirua.govt.nz

If you require support preparing or submitting your proposal, please let us know.

Bottle Creek Gallery

Bottle Creek Gallery is Pātaka's community gallery. The gallery is predominantly used for local artists and groups, but also for exhibitions that reflect Porirua. The gallery has 32 linear metres of wall space which can be extended by the use of movable walls and 130m² in floor area. Please refer to floor plan on *page 8*.

- There is no rental fee for local artists and groups
- Works don't have to be for sale but if they are, Pātaka charges a 35% commission on all sold works
- Exhibitions run for 5-6 weeks



Kolose - The Art of Tuvalu Croche
By Fafine Niutao i Aotearoa, 2014

Toi Gallery

Toi Gallery is Pātaka's commercial gallery where we exhibit and sell work from local, national and international artists. The gallery has 32 linear metres and 60m² in floor space. It can be accessed through the Toi Store and from the main galleries. Please refer to floor plan on *page 9*.

- There is a \$100 per week gallery rental cost for exhibiting in the Toi Gallery
- Works displayed in this gallery must be for sale. Pātaka charges a 35% commission on all sales
- Exhibitions run for 5-6 weeks
-



Emma Panting with Peg Moorehouse
Gentle as the Dream she weaves, 2015

Main Exhibition Galleries

- These are divided into three different galleries, ranging from the smallest at 32 linear metres, to the largest space of 60+ linear metres. The exhibitions in these spaces are mainly curated in-house by Pātaka's curatorial team. Galleries are also used for touring exhibitions, both national and international. Programmes are usually scheduled between 1 - 2 years in advance.

Exhibition Proposal

Contact details

Your Name (If exhibiting as a group please list primary contact)

Name of group (If you are applying on behalf of a group)

Email

Phone

Postal Address

Artist or group details

Tell us about yourself (150 words)

- Please provide a brief artist biography, or tell us about your group.

Link to website or social media page

Exhibition details

Exhibition title (or working title)

Tell us about your exhibition (200 words)

- What is the exhibition concept or theme?
- What is the media and style of the work you intend to exhibit?
- How many works will be exhibited and what size are they?
- Are the works for sale and what is the price range?

Who is the audience for your exhibition? (100 words)

Select which gallery you would like to exhibit in.

Bottle Creek Gallery*

Toi Gallery

Main Exhibition galleries

*If you would like to exhibit in Bottle Creek Gallery.

Bottle Creek is Pātaka's community gallery. The gallery is for local artists and groups, displaying exhibitions that reflect Porirua.

Are you or your group primarily based in Porirua?

Yes

No

Please explain how your exhibition will reflect or benefit the Porirua community (100 words)

What are your preferred exhibition dates?

- Is there a reason for these dates? Eg. A local event or significant date.
(Leave blank if you do not have preferred dates)

Let us know if you have any ideas for an event or public programme associated with your exhibition (150 words)

Images of work to be exhibited.

Please send us up to 5 images of the work to be exhibited
(If the work has not yet been made yet please send relevant examples of your work)

PATAKA ART + MUSEUM
Bottle Creek Gallery

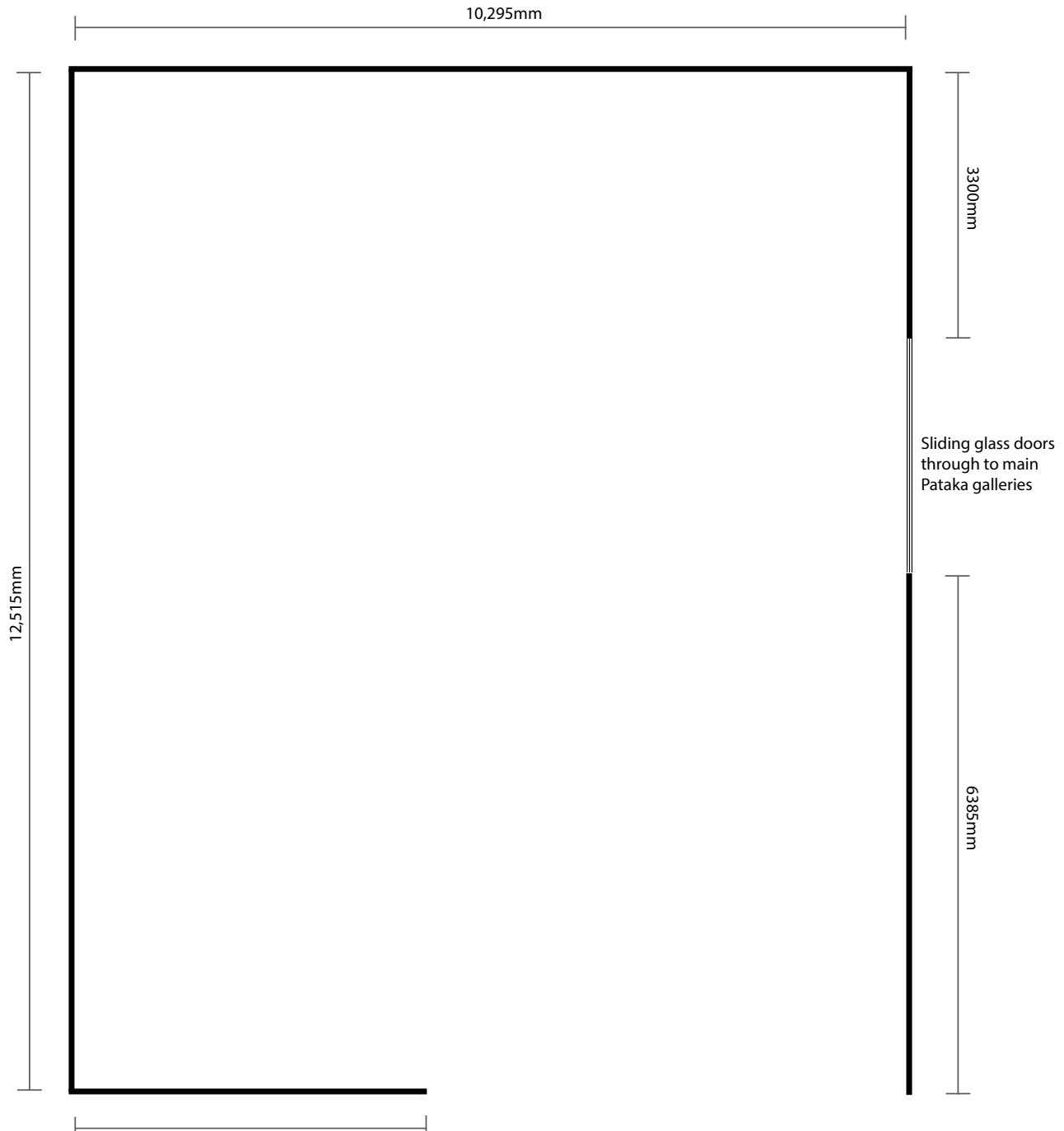

PATAKA ART + MUSEUM
Toi Gallery

