

# HAND DISPENSER & STAND

## 260000 SERIES ASSEMBLY INSTRUCTIONS



**NOTE:**

1. MODEL VIEWS MAY NOT REPRESENT EXACT MODEL PURCHASED

ALL DIMENSIONS ARE IN INCHES UNLESS NOTED OTHERWISE		DWN BY: EMK	DATE DWN: 6/7/20
CABINET SQUARENESS = ± .0625	APR BY:	DATE APR:	
FRACTIONAL VALUES = ± 1/32"	APR BY:	DATE APR:	
- ALL VALUES ± OVERALL -			

CONFIDENTIAL:  
ALL DESIGN RIGHTS RESERVED  
THE INFORMATION, DATA, DESIGN, AND DRAWINGS EMBODIED IN THIS DOCUMENT AND ALL REPRODUCTIONS THEREOF ARE THE EXCLUSIVE PROPERTY OF DIVERSIFIED WOODCRAFTS, INC.

THESE DOCUMENTS ARE SUPPLIED WITH THE UNDERSTANDING THAT THEY WILL NOT BE DISCLOSED TO THIRD PARTIES WITHOUT WRITTEN CONSENT OF DIVERSIFIED WOODCRAFTS, INC. ANY REPRODUCTION IN PART OR WHOLE WITHOUT WRITTEN CONSENT IS SUBJECT TO LEGAL ACTION.



300 South Krueger Street  
Suring, WI 54174  
diversifiedwoodcrafts.com

TITLE:  
**HAND DISPENSER & STAND  
ASSEMBLY INSTRUCTIONS**

REV.	DESCRIPTION	DATE	NAME	ECN No.
A	CREATED DRAWING	6/7/20	EMK	N/A
REVISION LEVEL				

DRAWING NUMBER:	SCALE:	SHEET:	REVISION:
260000	NTS	1 OF 8	REV A

# STAND INSTALLATION

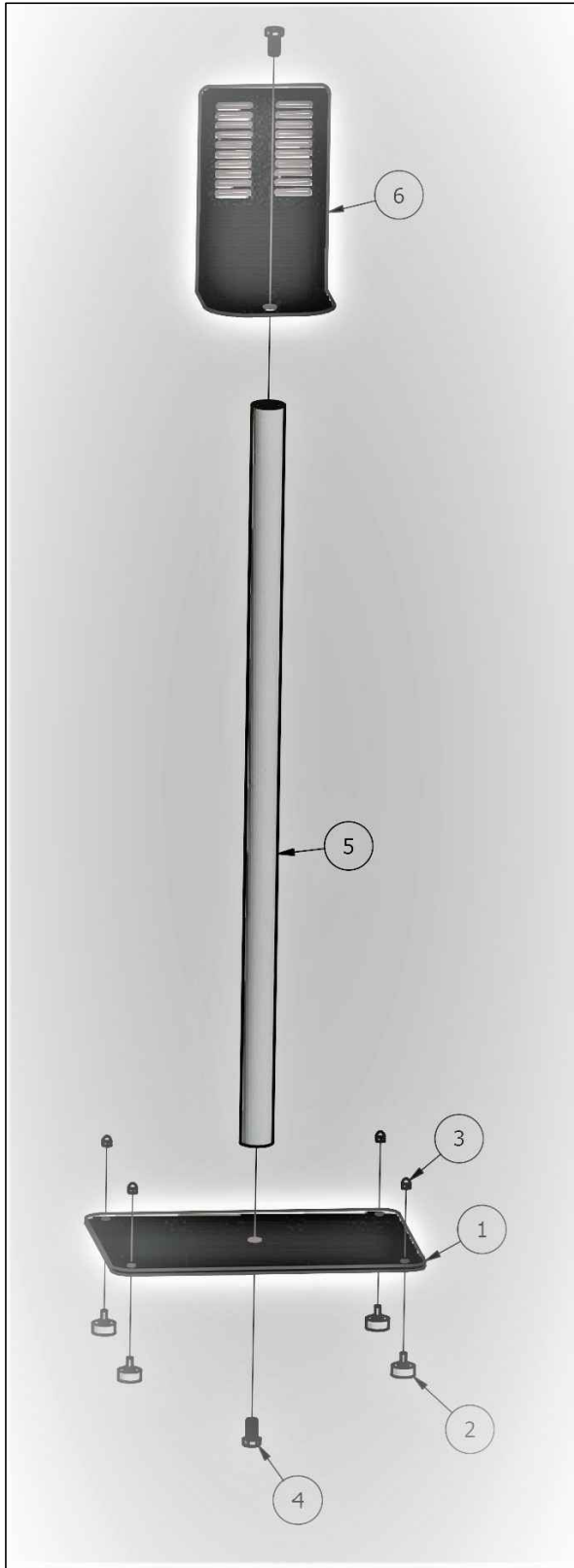

**STEP 1:**

- INSERT THE (4) FLOOR GLIDES INTO THE BASE AND ATTACH WITH THE DOME NUTS.
- INSERT A HEX BOLT INTO THE BASE AND ATTACH TO ONE END OF THE COLUMN.
- PLACE DISPENSER BRACKET ON TOP OF COLUMN AND ATTACH USING REMAINING HEX BOLT.

**Parts Included:**

Part#	Size (l x w x d)	List Price	
1	BASE	1	EA
2	FLOOR GLIDES	4	EA
3	DOME NUT	4	EA
4	HEX BOLT	2	EA
5	COLUMN	1	EA
6	DISPENSER BRACKET 10.5	1	EA

**NOTE:**

1.

ALL DIMENSIONS ARE IN INCHES UNLESS NOTED OTHERWISE	DWN BY: EMK	DATE DWN: 6/7/20
CABINET SQUARENESS = ± .0625	APR BY:	DATE APR:
FRACTIONAL VALUES = ± 1/32"	APR BY:	DATE APR:
- ALL VALUES ± OVERALL -		

CONFIDENTIAL:  
ALL DESIGN RIGHTS RESERVED  
THE INFORMATION, DATA, DESIGN, AND DRAWINGS EMBODIED IN THIS DOCUMENT AND ALL REPRODUCTIONS THEREOF ARE THE EXCLUSIVE PROPERTY OF DIVERSIFIED WOODCRAFTS, INC.

THESE DOCUMENTS ARE SUPPLIED WITH THE UNDERSTANDING THAT THEY WILL NOT BE DISCLOSED TO THIRD PARTIES WITHOUT WRITTEN CONSENT OF DIVERSIFIED WOODCRAFTS, INC. ANY REPRODUCTION IN PART OR WHOLE WITHOUT WRITTEN CONSENT IS SUBJECT TO LEGAL ACTION.



300 South Krueger Street  
Suring, WI 54174  
diversifiedwoodcrafts.com

TITLE:  
**HAND DISPENSER & STAND  
ASSEMBLY INSTRUCTIONS**

REV. A	CREATED DRAWING	6/7/20	EMK	N/A
	DESCRIPTION	DATE	NAME	ECN No.
REVISION LEVEL				

DRAWING NUMBER:	SCALE:	SHEET:	REVISION:
260000	NTS	2 OF 8	REV A

# HAND DISPENSER INSTALLATION

STEP 2:

- SCREW HAND DISPENSER TO BACK BRACKET WITH HARDWARE PROVIDED.
- NOTE: MUST TAKE OFF BACK PANEL TO ACCESS SLOTS TO MOUNT TO STAND (SEE IMAGES ON STEP 4).



BACKSIDE OF DISPENSER SHOWN

NOTE:

1.

ALL DIMENSIONS ARE IN INCHES UNLESS NOTED OTHERWISE	DWN BY: EMK	DATE DWN: 6/7/20
CABINET SQUARENESS = ± .0625	APR BY:	DATE APR:
FRACTIONAL VALUES = ± 1/32"	APR BY:	DATE APR:
- ALL VALUES ± OVERALL -		

CONFIDENTIAL:  
ALL DESIGN RIGHTS RESERVED  
THE INFORMATION, DATA, DESIGN, AND DRAWINGS EMBODIED IN THIS DOCUMENT AND ALL REPRODUCTIONS THEREOF ARE THE EXCLUSIVE PROPERTY OF DIVERSIFIED WOODCRAFTS, INC.

THESE DOCUMENTS ARE SUPPLIED WITH THE UNDERSTANDING THAT THEY WILL NOT BE DISCLOSED TO THIRD PARTIES WITHOUT WRITTEN CONSENT OF DIVERSIFIED WOODCRAFTS, INC. ANY REPRODUCTION IN PART OR WHOLE WITHOUT WRITTEN CONSENT IS SUBJECT TO LEGAL ACTION.



300 South Krueger Street  
Suring, WI 54174  
diversifiedwoodcrafts.com

TITLE:  
HAND DISPENSER & STAND  
ASSEMBLY INSTRUCTIONS

REV.	DESCRIPTION	DATE	NAME	ECN No.
A	CREATED DRAWING	6/7/20	EMK	N/A
REVISION LEVEL				

DRAWING NUMBER:	SCALE:	SHEET:	REVISION:
260000	NTS	3 OF 8	REV A

# HAND DISPENSER INSTALLATION

STEP 3:

- PUSH GRAY RELEASE BUTTON LOCATED ON TOP OF DISPENSER TO OPEN FRONT LID.



NOTE:

1.

ALL DIMENSIONS ARE IN INCHES UNLESS NOTED OTHERWISE		DWN BY: EMK	DATE DWN: 6/7/20
CABINET SQUARENESS = ± .0625	APR BY:	DATE APR:	
FRACTIONAL VALUES = ± 1/32"	APR BY:	DATE APR:	
- ALL VALUES ± OVERALL -			

CONFIDENTIAL:  
ALL DESIGN RIGHTS RESERVED  
THE INFORMATION, DATA, DESIGN, AND DRAWINGS EMBODIED IN THIS DOCUMENT AND ALL REPRODUCTIONS THEREOF ARE THE EXCLUSIVE PROPERTY OF DIVERSIFIED WOODCRAFTS, INC.

THESE DOCUMENTS ARE SUPPLIED WITH THE UNDERSTANDING THAT THEY WILL NOT BE DISCLOSED TO THIRD PARTIES WITHOUT WRITTEN CONSENT OF DIVERSIFIED WOODCRAFTS, INC. ANY REPRODUCTION IN PART OR WHOLE WITHOUT WRITTEN CONSENT IS SUBJECT TO LEGAL ACTION.



300 South Krueger Street  
Suring, WI 54174  
diversifiedwoodcrafts.com

TITLE:  
HAND DISPENSER & STAND  
ASSEMBLY INSTRUCTIONS

REV.	DESCRIPTION	DATE	EMK NAME	N/A ECN No.
A	CREATED DRAWING	6/7/20	EMK	N/A
REVISION LEVEL				

DRAWING NUMBER:	SCALE:	SHEET:	REVISION:
260000	NTS	4 OF 8	REV A

# HAND DISPENSER INSTALLATION

STEP 4:

- REMOVE HAND SANITIZER JUG (NOT SHOWN).
- LIFT BACK PANEL UP TO ACCESS BATTERY LOCATION.
- ADD BATTERIES IN CORRECT LOCATIONS (NOT INCLUDED).

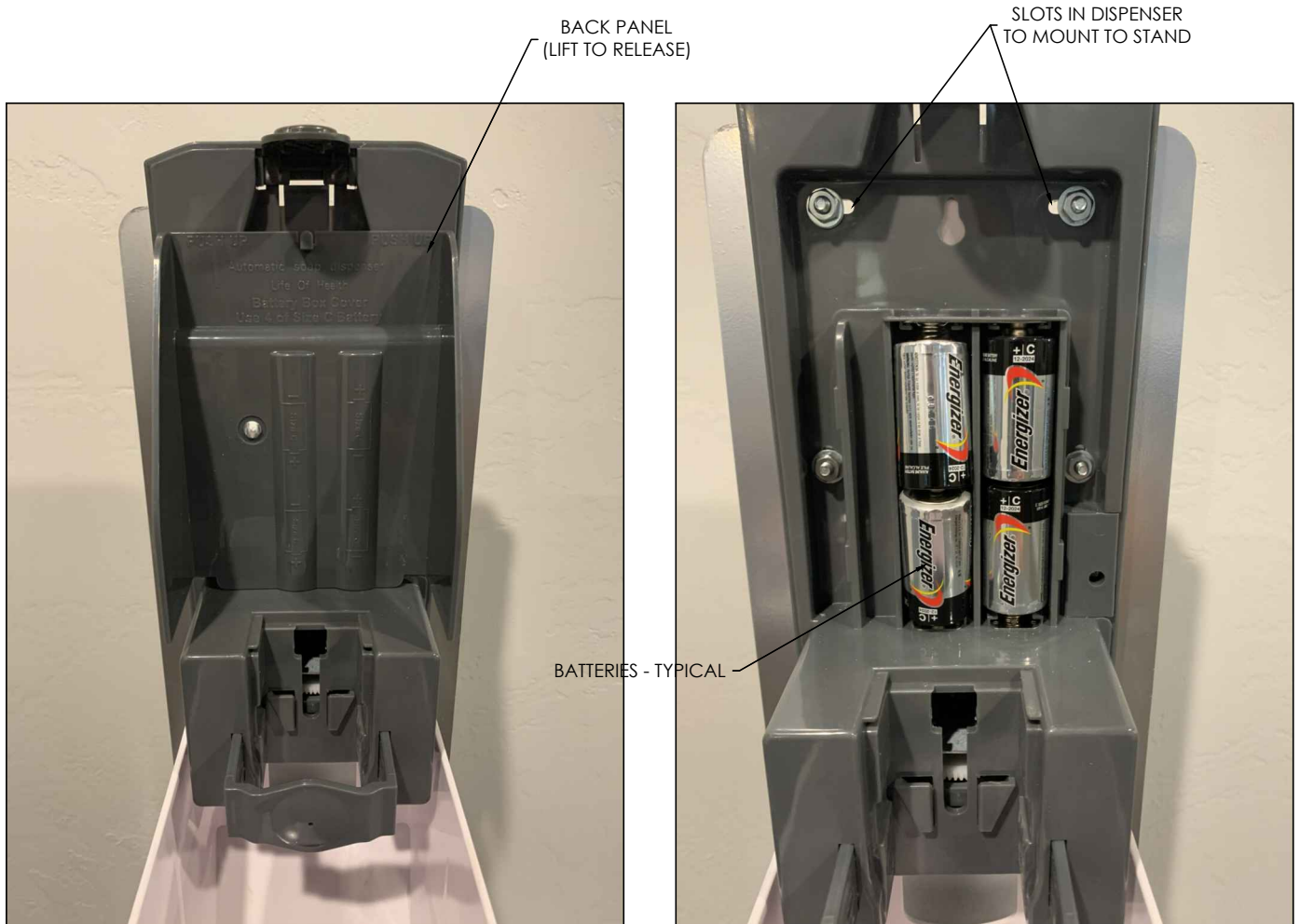

NOTE:

1.

ALL DIMENSIONS ARE IN INCHES UNLESS NOTED OTHERWISE		DWN BY: EMK	DATE DWN: 6/7/20
CABINET SQUARENESS = ± .0625		APR BY:	DATE APR:
FRACTIONAL VALUES = ± 1/32"		APR BY:	DATE APR:
- ALL VALUES ± OVERALL -			

CONFIDENTIAL:  
ALL DESIGN RIGHTS RESERVED  
THE INFORMATION, DATA, DESIGN, AND DRAWINGS EMBODIED IN THIS DOCUMENT AND ALL REPRODUCTIONS THEREOF ARE THE EXCLUSIVE PROPERTY OF DIVERSIFIED WOODCRAFTS, INC.

THESE DOCUMENTS ARE SUPPLIED WITH THE UNDERSTANDING THAT THEY WILL NOT BE DISCLOSED TO THIRD PARTIES WITHOUT WRITTEN CONSENT OF DIVERSIFIED WOODCRAFTS, INC. ANY REPRODUCTION IN PART OR WHOLE WITHOUT WRITTEN CONSENT IS SUBJECT TO LEGAL ACTION.



300 South Krueger Street  
Suring, WI 54174  
diversifiedwoodcrafts.com

TITLE:  
HAND DISPENSER & STAND  
ASSEMBLY INSTRUCTIONS

REV.	DESCRIPTION	DATE	NAME	ECN No.
A	CREATED DRAWING	6/7/20	EMK	N/A
REVISION LEVEL				

DRAWING NUMBER:	SCALE:	SHEET:	REVISION:
260000	NTS	5 OF 8	REV A

# HAND DISPENSER INSTALLATION

STEP 5:

- PUT BACK PANEL BACK ON.
- PLACE HAND SANITIZER JUG BACK INTO DISPENSER.



NOTE:

1.

ALL DIMENSIONS ARE IN INCHES UNLESS NOTED OTHERWISE		DWN BY:	EMK	DATE DWN:	6/7/20
CABINET SQUARENESS = ± .0625		APR BY:		DATE APR:	
FRACTIONAL VALUES = ± 1/32"		APR BY:		DATE APR:	
- ALL VALUES ± OVERALL -					

CONFIDENTIAL:  
 ALL DESIGN RIGHTS RESERVED  
 THE INFORMATION, DATA, DESIGN, AND DRAWINGS EMBODIED IN THIS DOCUMENT AND ALL REPRODUCTIONS THEREOF ARE THE EXCLUSIVE PROPERTY OF DIVERSIFIED WOODCRAFTS, INC.

THESE DOCUMENTS ARE SUPPLIED WITH THE UNDERSTANDING THAT THEY WILL NOT BE DISCLOSED TO THIRD PARTIES WITHOUT WRITTEN CONSENT OF DIVERSIFIED WOODCRAFTS, INC. ANY REPRODUCTION IN PART OR WHOLE WITHOUT WRITTEN CONSENT IS SUBJECT TO LEGAL ACTION.



300 South Krueger Street  
 Suring, WI 54174  
 diversifiedwoodcrafts.com

TITLE:  
**HAND DISPENSER & STAND  
 ASSEMBLY INSTRUCTIONS**

REV.	DESCRIPTION	DATE	NAME	ECN No.
A	CREATED DRAWING	6/7/20	EMK	N/A
REVISION LEVEL				

DRAWING NUMBER:	SCALE:	SHEET:	REVISION:
260000	NTS	6 OF 8	REV A

# HAND DISPENSER INSTALLATION

STEP 6:

- CLOSE AND TURN DISPENSER ON (SWITCH LOCATED ON SIDE OF DISPENSER).



ON/OFF SWITCH

SIDE OF DISPENSER SHOWN

NOTE:

1.

ALL DIMENSIONS ARE IN INCHES UNLESS NOTED OTHERWISE		DWN BY: EMK	DATE DWN: 6/7/20
CABINET SQUARENESS = ± .0625		APR BY:	DATE APR:
FRACTIONAL VALUES = ± 1/32"		APR BY:	DATE APR:
- ALL VALUES ± OVERALL -			
<p>CONFIDENTIAL:                  ALL DESIGN RIGHTS RESERVED                  THE INFORMATION, DATA, DESIGN, AND DRAWINGS EMBODIED IN THIS DOCUMENT AND ALL REPRODUCTIONS THEREOF ARE THE EXCLUSIVE PROPERTY OF DIVERSIFIED WOODCRAFTS, INC.</p> <p>THESE DOCUMENTS ARE SUPPLIED WITH THE UNDERSTANDING THAT THEY WILL NOT BE DISCLOSED TO THIRD PARTIES WITHOUT WRITTEN CONSENT OF DIVERSIFIED WOODCRAFTS, INC. ANY REPRODUCTION IN PART OR WHOLE WITHOUT WRITTEN CONSENT IS SUBJECT TO LEGAL ACTION.</p>			



300 South Krueger Street  
 Suring, WI 54174  
 diversifiedwoodcrafts.com

TITLE:  
**HAND DISPENSER & STAND  
 ASSEMBLY INSTRUCTIONS**

REV.	DESCRIPTION	DATE	NAME	ECN No.
A	CREATED DRAWING	6/7/20	EMK	N/A
REVISION LEVEL				

DRAWING NUMBER: <b>260000</b>	SCALE: NTS	SHEET: 7 OF 8	REVISION: REV A
----------------------------------	---------------	------------------	--------------------

# HAND DISPENSER INSTALLATION

STEP 7:

- PLACE HAND DISPENSER AND STAND IN DESIRED LOCATION.



COMPLETE UNIT SHOWN

NOTE:

1.

ALL DIMENSIONS ARE IN INCHES UNLESS NOTED OTHERWISE		DWN BY: EMK	DATE DWN: 6/7/20
CABINET SQUARENESS = ± .0625		APR BY:	DATE APR:
FRONTAL VALUES = ± 1/32"		APR BY:	DATE APR:
- ALL VALUES ± OVERALL -			
<p>CONFIDENTIAL:                  ALL DESIGN RIGHTS RESERVED                  THE INFORMATION, DATA, DESIGN, AND DRAWINGS EMBODIED IN THIS DOCUMENT AND ALL REPRODUCTIONS THEREOF ARE THE EXCLUSIVE PROPERTY OF DIVERSIFIED WOODCRAFTS, INC.</p> <p>THESE DOCUMENTS ARE SUPPLIED WITH THE UNDERSTANDING THAT THEY WILL NOT BE DISCLOSED TO THIRD PARTIES WITHOUT WRITTEN CONSENT OF DIVERSIFIED WOODCRAFTS, INC. ANY REPRODUCTION IN PART OR WHOLE WITHOUT WRITTEN CONSENT IS SUBJECT TO LEGAL ACTION.</p>			



300 South Krueger Street  
 Suring, WI 54174  
 diversifiedwoodcrafts.com

TITLE:  
**HAND DISPENSER & STAND  
 ASSEMBLY INSTRUCTIONS**

REV.	DESCRIPTION	DATE	NAME	ECN No.
A	CREATED DRAWING	6/7/20	EMK	N/A
REVISION LEVEL				

DRAWING NUMBER:	SCALE:	SHEET:	REVISION:
260000	NTS	8 OF 8	REV A